

SPECIFICATIONS

Transmitter :

Remote Relay Receiver	433.92MHz	
Audio/Video Frequency	2.4000GHz ~ 2.4835GHz	
Channel Frequency	Channel 1	2.414GHz
	Channel 2	2.432GHz
	Channel 3	2.450GHz
	Channel 4	2.468GHz
Modulation	FM	
Video Input Level	1V PP/75Ω	
Colour Video Input	Phase Alternate Line (PAL)	
Audio Input Level	1.0v PP (Mod 1KHz, Dev 15KHz)	
Audio Bandwidth	10Hz - 22KHz (-1dB)	
Input Connectors	DigiConnector Euro SCART x2, RCA Phono x2	
Power Source	DC	

Receiver :

Remote Relay Transmitter	433.92MHz
Audio/Video Frequency	2.4000GHz ~ 2.4835GHz
Modulation	FM
Video Output Level	1V PP/75Ω
Sensitivity	-80dBm
Audio Output Level	1.0V PP (Mod 1KHz, Dev 15KHz)
Audio Bandwidth	10Hz - 22KHz (-1dB)
Output Connectors	Euro SCART
Power Source	DC

Approvals See Declaration of Conformity

Antenna System Internal Omni-directional dipole (2.4GHz)
Omni-directional dipole (433.92MHz)

System Range ≤ 200metres free air space
≈ 40 metres in-building (through walls)

Remote Relay Protocol Coding RC5, RC6, Active Digital
IrDA 16 Channel

MODEL: DG440

DigiSender™ X7

Wireless Video Sender System



(c)2007 AEI Security & Communications Ltd. All rights reserved.

Registered in England: 02831823

AEI Security & Communications Ltd
Weslake Industrial Park
Rye Harbour Road, Rye
East Sussex
TN31 7TE
United Kingdom

DigiConnector, IR Systeme Technik and DigiEye are trademarks of AEI Security & Communications Ltd
DigiSender is a registered trademark of AEI Security & Communications Ltd



**IMPORTANT: ALWAYS KEEP THIS
INSTRUCTION MANUAL FOR
FUTURE REFERENCE**

Functions of this product are covered
by one or more patents.

Table of Contents

WARNING
To prevent damage do
not expose this unit to
rain or moisture.

Page 3 Introduction

SECTION 1: Step by Step Installation Guide

Page 4,5	Unpacking your DigiSender™ X7
Page 6,7	Install the DigiSender™ X7 Transmitter Unit
Page 8	Install the IR Systeme Technik™ Remote Extender
Page 9	OPTIONAL: Connecting Inputs 3 & 4
Page 10,11	Install the DigiSender™ X7 Receiver Unit

SECTION 2: Daily Usage

Page 12,13 Using your DigiSender™ X7 System

SECTION 3: Setup Troubleshooting

Page 14,15	Troubleshooting: Picture Problems
Page 16	Troubleshooting: Sound Problems
Page 17	Troubleshooting: Remote Extender Problems
Page 18,19	Frequently Asked Questions (FAQ) & Technical Support
Page 20,21	Rear Panel Descriptions

SECTION 3: Further Information

Page 22	Upgrades
Page 23	Declaration of Conformity



Waste electrical products should not be disposed of with household waste. Please recycle where facilities exist. Check with your local Authority or retailer for recycling waste

DECLARATION OF CONFORMITY 01022007/01/DX-DG-DV

We,

AEI Security & Communications Ltd
Weslake Industrial Park, Harbour Road, Rye, East Sussex TN31 7TE, United Kingdom.

declare under our sole responsibility that the products referred to as DigiSender, XSender and PlugSender bearing the series codes prefixed:

DXx, DGx, DVx (x refers to the specific model number)

are in conformity with the essential requirements of Directive 1995/5/EC. These products have been tested against the following standards and specifications:

Low Voltage Directive EN60950:2000	Safety of information technology equipment
Electromagnetic Compatibility Directive EN 301 489-3 V1.3.1: 11-2001 EN 301 489-1 V1.3.1: 09-2001	Specific conditions for Short-Range Devices (SRD) operating on frequencies between 9 kHz and 40 GHz Electromagnetic compatibility and Radio spectrum Matters (ERM); ElectroMagnetic Compatibility (EMC) standard for radio equipment and services; Part 1: Common technical requirements
Radio spectrum EN 300 440-1 V1.1.1: 09-2001	Electromagnetic compatibility and Radio spectrum Matters (ERM); Short range devices; Radio equipment to be used in the 1 GHz to 40 GHz frequency range; Part 1: Technical characteristics and test methods
Power Supply EN55022: 2003 EN55024: 2003 IEC 61000-3-2: 2001 IEC 61000-3-3:2001	Information technology equipment. Radio disturbance characteristics. Limits and methods of measurement Information technology equipment. Immunity characteristics. Limits and methods of measurement Electromagnetic compatibility (EMC) - Part 3-2: Limits - Limits for harmonic current emissions (equipment input current <= 16 A per phase) Electromagnetic compatibility (EMC) - Part 3-3: Limits - Limitation of voltage changes, voltage fluctuations and flicker in public low-voltage supply systems, for equipment with rated current <= 16 A per phase and not subject to conditional connection

The product is marked with the CE marking and Notified Body Number according to directive 1999/5/EC









CE 0560   

LOW POWER WIRELESS A/V PRODUCT OPERATING ON 2.4GHZ

NOTE: Original DoC has been signed

Upgrades & Accessories



DigiSender™ Receiver - Part DG44RX

- Add as many receivers as you require to your DigiSender™ system
- Connect to any SCART enabled television or use with the MOD01PIS Aerial Converter
- Supplied with PSU
- Requires DigiSender™, PCSender™, or Baby Monitor transmitter



Aerial Converter - Part MOD01PIS

- Connect a DigiSender™ receiver to an aerial socket on your T.V.
- Shares the power supply with your DigiSender
- Test Card signal for easy set up
- Compatible with every UK television
- Adds the DigiSender™ signal to your existing aerial signal

<http://www.digisender.net>
for the latest info, upgrades and technical support

INTRODUCTION

DigiSender™X7 - Advanced Wireless Video Sender

Congratulations on purchasing the **DigiSender™ X7**. This product represents state of the art wireless video and infra red technology at exceptional value for money.

This system is fully upgradable. You can add additional receivers, aerial convertors, wireless baby monitor cameras and countless other upgrades.

What makes the **DigiSender™ X7** so different is that it provides compatibility with virtually any make of **Satellite** receiver, **Cable** receiver, **VCR**, **DVD** and **Freeview** in the market today.

You also have the ability to select which video source you want to watch whilst you comfortably rest in bed. You can select between VCR, DVD and Satellite/Cable without interfering with the channel being viewed on your main TV.

Benefit from 4 video channels, stunning hi-fi quality stereo sound and digital communication providing an astounding degree of flexibility.

Your purchase of this DigiSender™ system represents an investment in the very latest wireless communication technology for the home.



CUSTOMER CARE

Telephone: 0845 1667940
E-mail: advice@digisender.net

STEP 1

Unpacking your DigiSender™ X7

All packs are computer weigh checked when packed. However, it is a good idea to check all kit contents are present before proceeding with the installation.

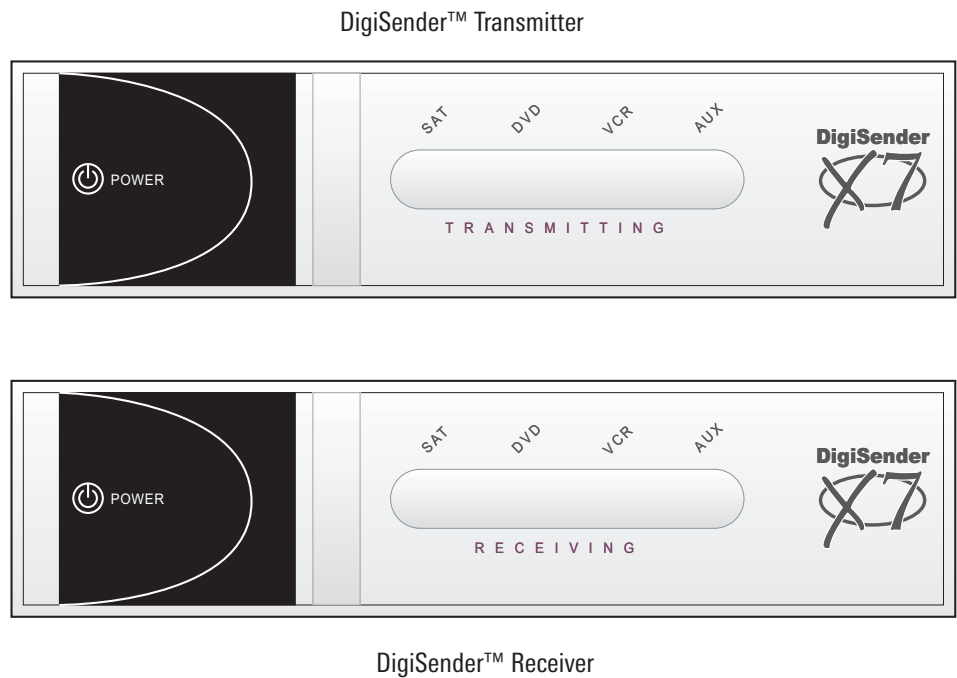

Rear Panel Descriptions

RECEIVER

- 1. Remote Extender Channel**
Default: Channel 1
See Advanced Section for details.
- 2. Audio/Video Output**
Use these jacks for connection to a RCA input on your video or Hi-Fi
- 3. Audio/Video Out (SCART)**
Use this lead to connect to an available SCART input on your remote television.
- 4. Audio/Video Channel**
Default: Channel 1
See Advanced Section for details.
- 5. Power Supply**
Connect one of the supplied power supply adaptors here.

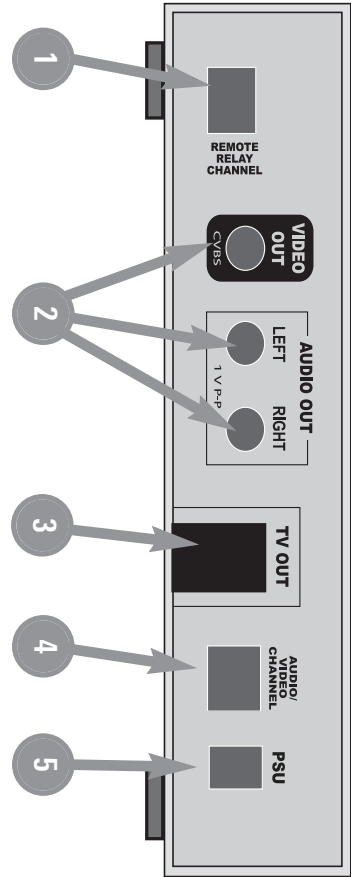

Rear Panel Descriptions TRANSMITTER

1. Remote Extender Channel
Default: Channel 1
See Advanced Section for details.

2. IR Emitter Output
Connect the supplied IR Emitter remote extender here.

3. DigiConnector™ 1
Use this to connect to your satellite, cable or terrestrial decoder

4. DigiConnector™ 2
Use this to connect to your DVD player or VCR

5 & 6. RCA Input 3 & 4
Use these to connect to a RCA phono device such as a CCTV camera

7. Audio/Video Channel
Default: Channel 1
See Advanced Section for details.

8. Power Supply
Connect one of the supplied power supply adaptors here

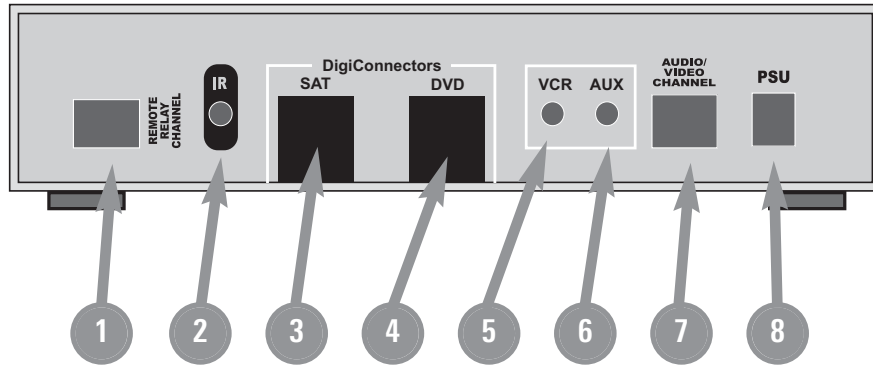

continued...

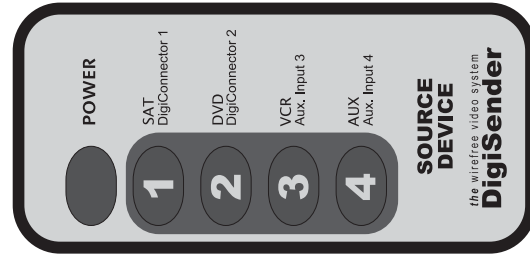

2 x RCA Phono - 4.5mm Jack Leads

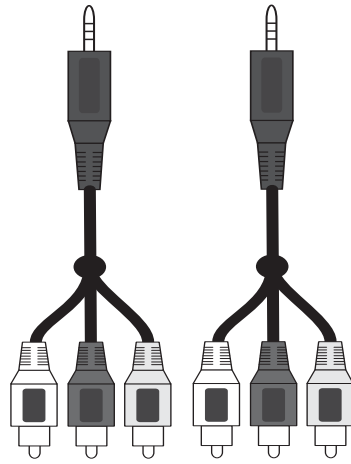

Remote Control

2 x Power Supply Unit

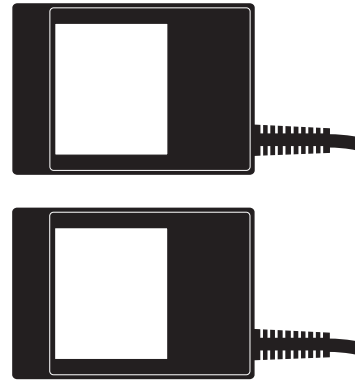

1x IR Systeme Technik IR Emitter

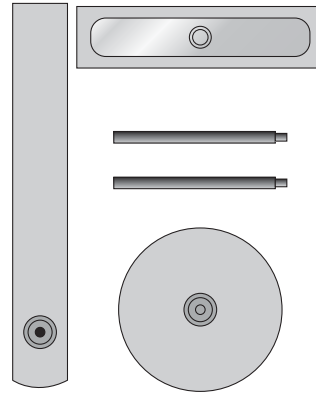

STEP 2

Install the *DigiSender™ X7* Transmitter Unit

The transmitter unit is designed to send video and sound from one of up to 4 connected sources to a receiver somewhere else in your home.

STEP 1



Place the DigiSender™ transmitter on a flat surface near to your source equipment. *Avoid placing the transmitter directly on top of other electrical devices (see troubleshooting guide)*

STEP 2



Connect DigiConnector™ 1 into your satellite or cable receiver. Use the SCART socket labelled 'TV' and connect any existing SCART lead (if present) into the rear (socket) of the DigiConnector™.

STEP 3



Connect DigiConnector™ 2 into your VCR or DVD. Where available, use SCART sockets labelled OUT or TV. Connect any existing SCART lead in to the rear socket of the DigiConnector™

What's the A/B switch for??

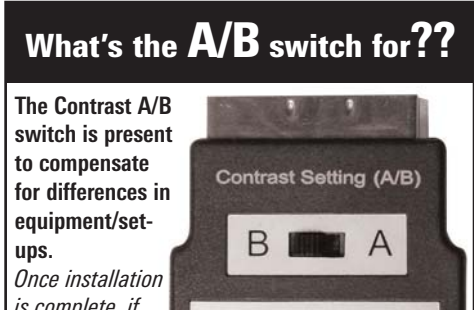

The Contrast A/B switch is present to compensate for differences in equipment/set-ups. Once installation is complete, if you experience a poor picture then adjust the A/B setting.

Audio/Video Channel

Remote Relay Channel





The DigiSender™ X7 features 4 *audio/video channels* and 4 primary *remote relay channels*. For the unit to function correctly the *audio/video channel* must be set the same on both the transmitter and receiver. Also, the *remote relay channel* must be the same on both the transmitter and receiver.



Receiver Channel Settings



Transmitter Channel Settings

	Channel 1	Channel 2	Channel 3	Channel 4
	Channel	Channel	Channel	Channel
				
1	ON	OFF	OFF	OFF
2	OFF	ON	OFF	OFF
3	OFF	OFF	ON	OFF
4	OFF	OFF	OFF	ON

Frequently Asked Questions (FAQ) & Technical Support

Q: My DigiSender™ remote control has stopped working

A: You need to replace the remote control batteries. It takes a CR2025 battery, available from most electrical outlets. Some electrical equipment may interfere with the remote controls operation. Move the DigiSender™ transmitter and receiver away from other electrical devices and keep cables neat and tidy.

Q: My DigiSender™ remote control won't change my Satellite/Cable channel!

A: The DigiSender™ Remote Control is designed for changing the input device

and/or Audio/Video channel. It will not operate any satellite or cable systems. You need to use your original satellite/cable remote control.

Q: My neighbour is changing my Satellite/Cable channel!

A: You need to change the Remote Control Extender channel of your DigiSender™. See page 19 for details.

Q: Why can I see my neighbours satellite/cable channels on my TV!

A: You need to change the audio/video channel of your DigiSender™. See page 19 for details.

AEI Security & Communications Ltd is dedicated to providing our customers with first class customer care and technical support.

We have provided you with 2 methods of obtaining technical advice on this product.

During busy periods we would suggest using the web option to obtain support.

1. On the web...

Free technical advice is available online 24/7 at our dedicated support web site:

<http://www.aei.eu>

2. By telephone...

We have a dedicated helpline, Monday to Friday, 9AM - 5PM.

Please note that calls are charged at the local rate and your call may be recorded for training purposes.

UK Customers only:
0845 166 7940

Overseas Customers:
+44 (0) 1797 226123

continued...

Avoid positioning the transmitter near to 2.4GHz wireless enabled devices such as modern games consoles, wireless controllers, laptops, DECT phones or wireless networking equipment.



Ensure that both the A/V Channel and IR Channel are set to 1.

See the trouble shooting sections for further information on the channel selection process.



Connect the **IR Systeme Technik™** IR Emitter to the socket labelled **IR** on the rear of the transmitter. Follow the steps overleaf to install the IR Systeme Technik™ IR Emitter.



Connect the power supply unit to the socket labelled **PSU**.



Connect the power supply unit (PSU) into an available wall socket. Press the **POWER** button on your DigiSender remote control to switch the transmitter on.

STEP 3

Install the *IR Systeme Technik*™ remote extender

Once set up correctly, the remote extender will enable you to utilise your remote control in the remote location in your home.

Because everyone's set up is different there are many ways you can install the remote extender system.

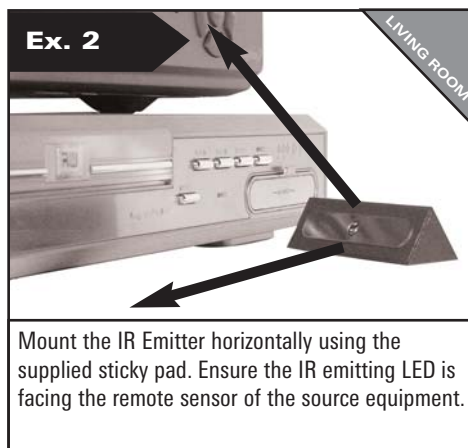
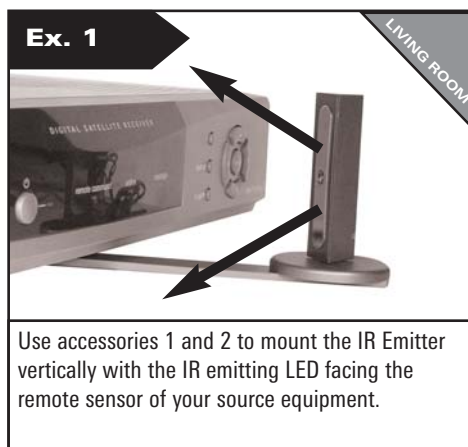
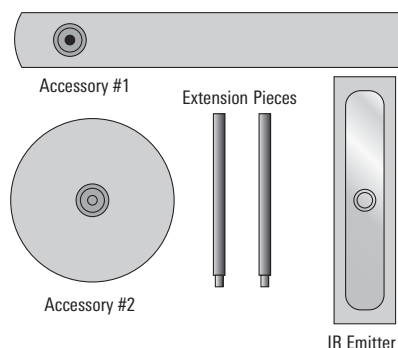

TROUBLESHOOTING

Remote Control Extender

If you have any difficulty operating your source equipment remote control in your second room please follow the advice below below:

- 1) Ensure the IR Systeme Technik™ IR Emitter is connected to the DigiSender™ transmitter.
- 2) Ensure you are using the correct remote control in the second room. For instance, if you are trying to control your satellite channel you will need to use the satellite remote control.
- 3) Ensure the IR Systeme Technik™ IR Emitter is facing the remote sensor on your source equipment.
- 4) Move the IR Emitter further away from the source equipment using the supplied extension accessory.
- 5) Move the transmitter AND receiver further away from other electrical devices.
- 6) Choose a new remote relay channel taking care that the same channel is selected on both transmitter and receiver.
- 7) Operate the remote control closer to the DigiSender™ receiver.
- 8) Replace the batteries in the source remote control.



TROUBLESHOOTING

Sound Problems

Please follow the guide below if you experience any trouble with the picture and sound. If this guide does not solve your problem please call our customer care line on 0845 1667940 for further assistance or email advice@digisender.net.

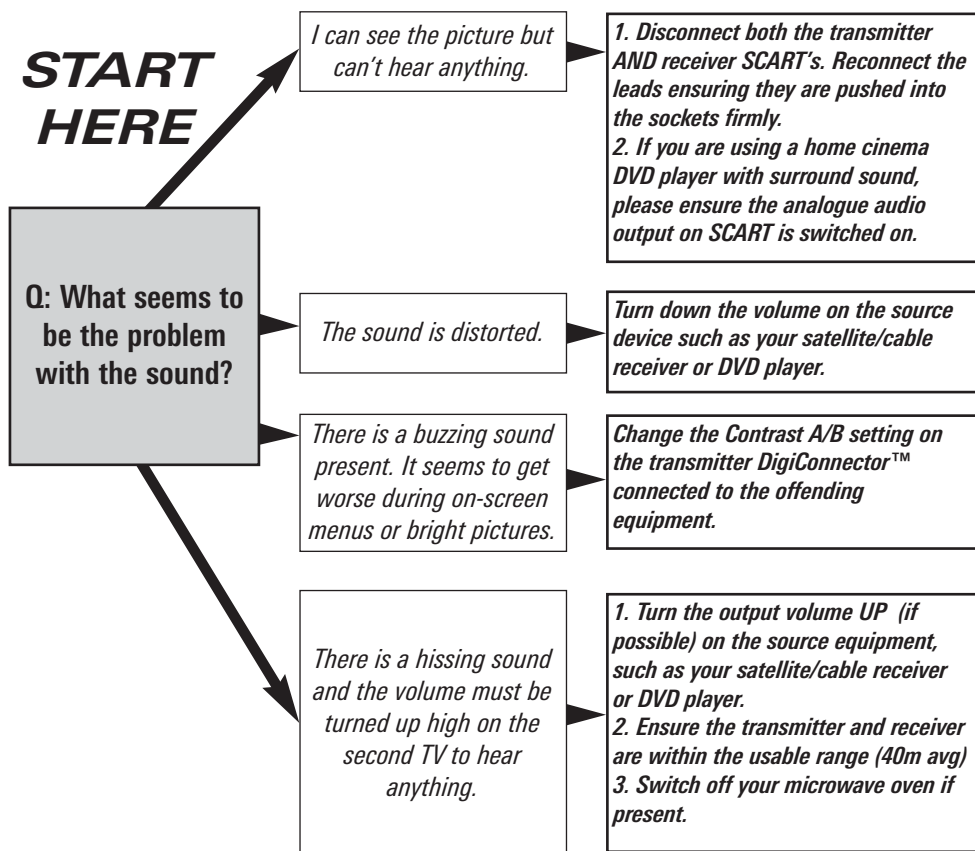

OPTIONAL

Connecting inputs 3 & 4

Inputs 3 & 4 can be used with any PAL video device featuring RCA Phono output sockets. Use the supplied 3.5mm to Phono leads to connect the device(s) to the DigiSender™ transmitter.

These inputs are ideal for:

PC with TV Out Card
Laptop
CCTV Camera
Games Console
 etc.

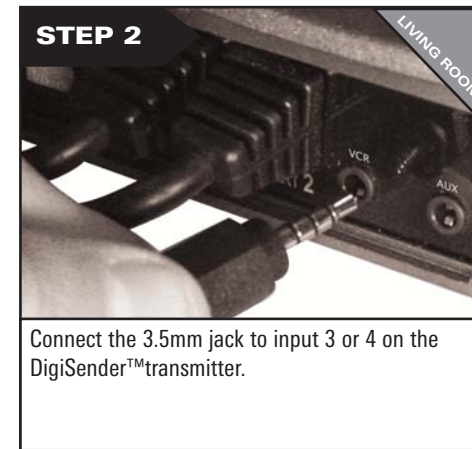
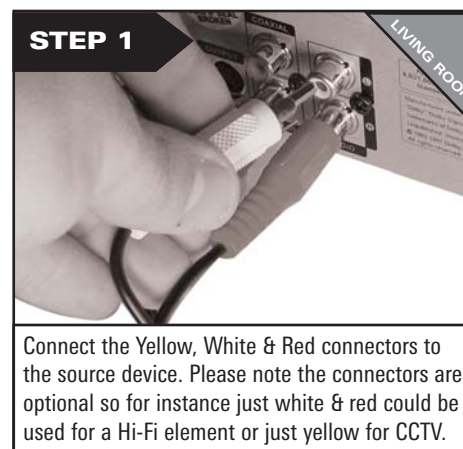
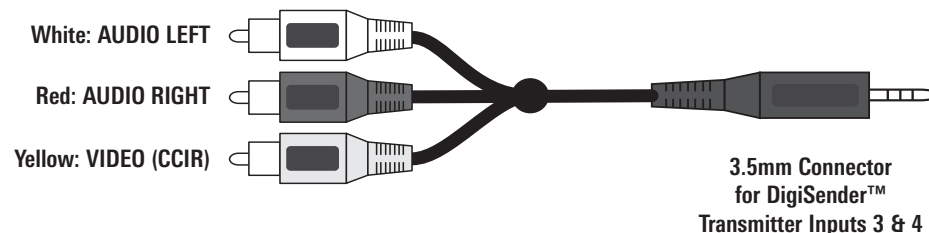

STEP 4

Install the *DigiSender™ X7* Receiver Unit

The DigiSender™ X7 Receiver will pick up transmitted signals from the transmitter unit and output them to a television. In addition, the receiver detects remote controls being used in the second room and will send those signals to the source equipment in your main lounge.

STEP 1



Place the DigiSender™ receiver on a flat surface near to your second television. Avoid placing the receiver directly on top of other electrical devices such as the television.

STEP 2



Connect the SCART output to the second television.

STEP 3

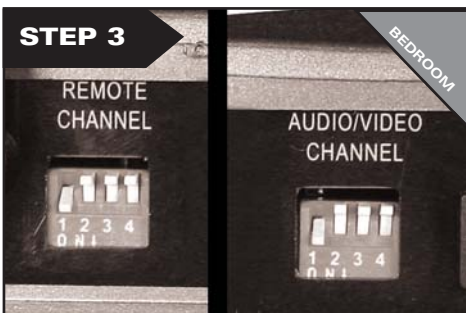

Ensure that both the **A/V Channel** and **IR Channel** are set to 1.
See the trouble shooting sections for further information on the channel selection process.

No SCART socket on the TV??

AEI produce an 'Aerial Converter' enabling you to connect the receiver to any TV without a SCART socket.

Ask for part number **MOD01PIS**



cont...

I see a snowstorm effect or plain blue screen

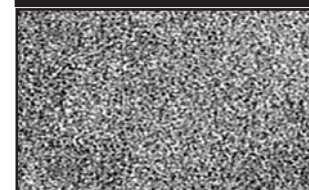

I see lines over the picture

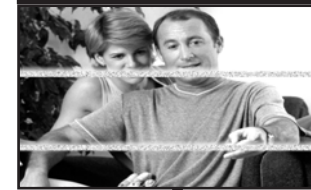

Switch OFF your DigiSender® RECEIVER.
Q: What do you now see at the *second* TV?

I now see a Black screen

NOT RECEIVING SIGNAL

1. Switch the DigiSender® Receiver back on
2. Ensure the DigiSender® Transmitter is switched on
3. Select a different audio/video channel ensuring an identical channel is chosen on both the transmitter and receiver
4. Switch off any wireless cameras and/or networks in your household.

I still see a snowstorm or blue picture

WRONG TV CHANNEL SELECTED

This indicates the SCART Channel has NOT been selected on the second television. Look for buttons on this televisions remote control which could select the AV Channel such as **EXT, AV, VIDEO, VCR, AUX, Channel 0** AND .

INTERFERENCE

This indicates one or more electrical devices are interfering with the DigiSender®. To ascertain the source of the interference, switch OFF any wireless networking equipment, laptops, 2.4GHz DECT phones, games consoles or bluetooth devices. Try all 4 audio/video channels as one or more may still be available. Visit digisender.net or contact our helpline for information on configuring your equipment to work together.

TROUBLESHOOTING Picture Problems

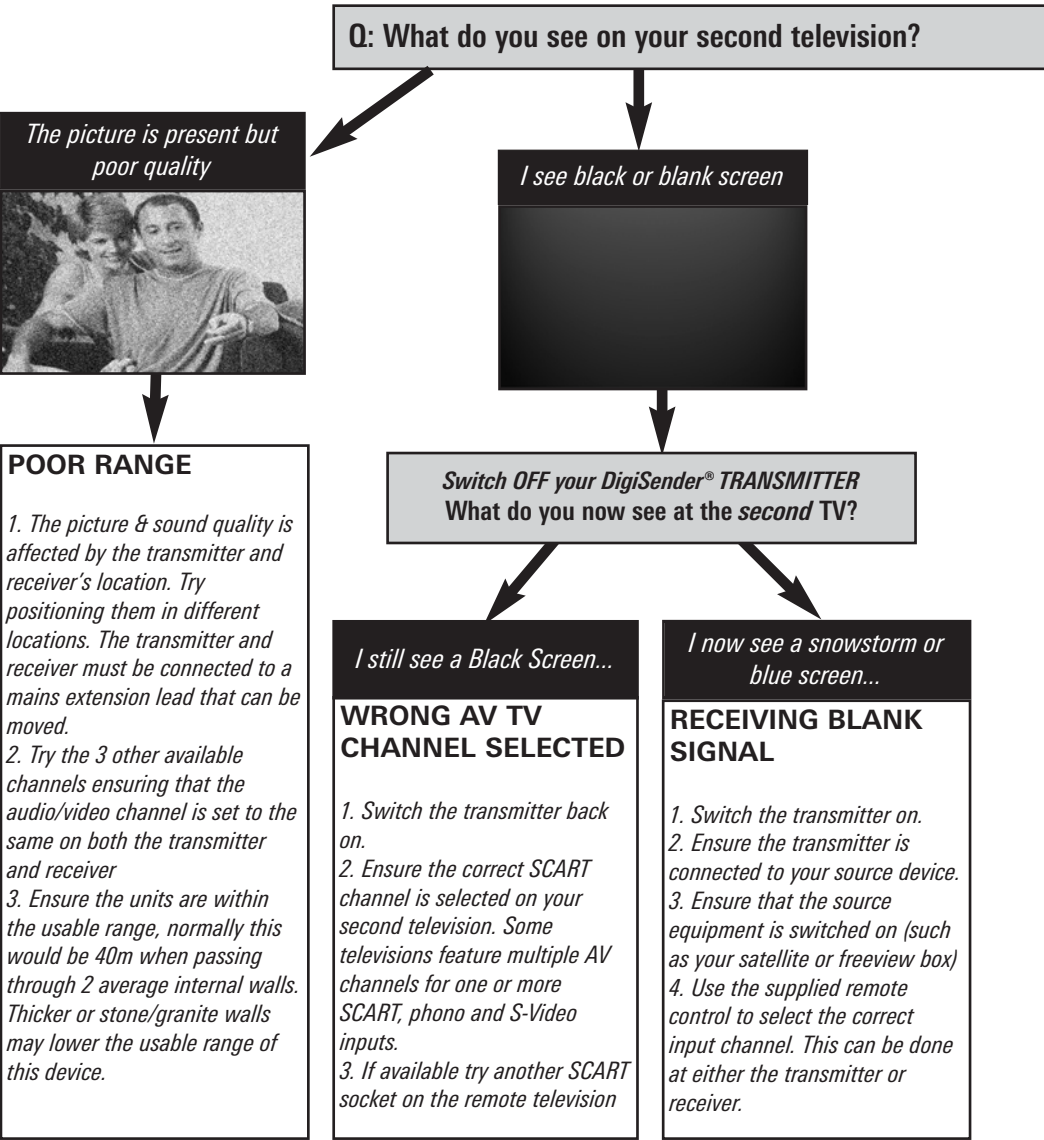

continued...

Did you know? The receiver can be connected to a Hi-Fi unit using the Left & Right Audio outputs on the rear of the DigiSender™ receiver unit. Phono cable may be required.

STEP 4



Connect the power supply unit to the socket labelled PSU.

STEP 5



Connect the power supply unit (PSU) to an available wall socket.

STEP 6



Press the POWER button on your DigiSender remote control to switch the receiver on. The power LED will be green to indicate the device is switched on.

Switch on the second television and select it's SCART channel. This will be labelled on the remote control as one of the following buttons:

AV, VIDEO, VCR, AUX, SCART, EXT, 0 

Refer to your tv's manual for further assistance.

STEP 5

Using the DigiSender™ X7

The DigiSender™X7 is designed to be simple to use once set up.

The supplied remote control can be used to switch between sources, such as Satellite/Cable, DVD and VCR.

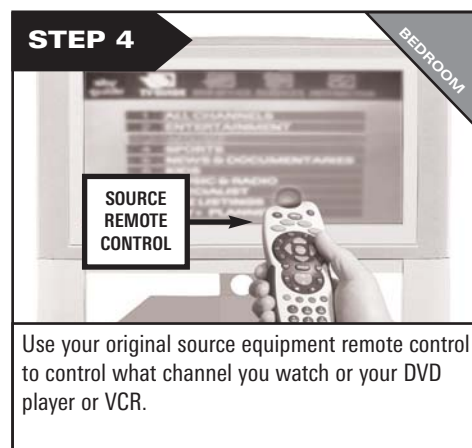
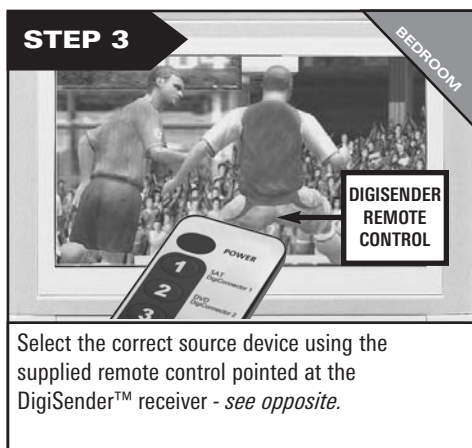

continued...

Transmitter Source Select Controls.

The POWER button toggles the DigiSender transmitter and receiver mode between STANDBY and ON. The power LED indicates the current mode - GREEN for ON, RED for STANDBY.

Press 1,2,3 or 4 with the remote pointing at your receiver, to select a device connected to your DigiSender™ transmitter. For example you could switch between your satellite/cable, DVD, VCR and CCTV camera from your bedroom.

- 1 = DigiConnector 1
- 2 = DigiConnector 2
- 3 = RCA Input 3
- 4 = RCA Input 4

Please use your original or compatible remote controls to control your source equipment. The supplied remote control cannot be used to achieve this.

