



# DVD PLAYER

DVD-927 DVD / VIDEO - CD / CD



**ELECTRONICS**

SAMSUNG ELECTRONICS AMERICA INC.  
105 CHALLENGER ROAD RIDGEFIELD  
PARK NJ 07660 U.S.A.



“FOR YOUR NEAREST SAMSUNG  
SERVICE STATION DIAL  
1-800-SAMSUNG”

AH68-10322A

BEFORE USAGE

CONNECTIONS

DVD

VIDEO-CD

C D

BASIC FUNCTIONS

SERVICE

**Excellent Sound!  
Clear Screen!**



## BEFORE USAGE

Disc Features	3
Safety Instructions	5
Descriptions-Front Panel	9
Descriptions-FLT Display	11
Descriptions-Rear Panel	13
Remote Control	15
Controlling your TV with the Remote	19
Preparation before usage	21

## CONNECTIONS

Connections	23
-------------	----

## DVD

How to Play a DVD	33
How to change to Another Title while in Play	35
How to change Audio	37
How to change Subtitle	38
How to change Angle	39
How to select Subtitle	40
How to use the On-Screen Menus	41
How to select Audio Languages	43
How to select the desired Subtitle	45
How to select the desired Screen Angle	47
How to change the SetUp Menu	49
How to set up Screen Menu Language	51
How to set up the Audio Language	53
How to set up the Subtitle Language	55
How to set up the Screen Angle Mark	57
How to set up the Parental Level	59
How to set up the Screen Ratios	61
How to set up Audio Output	63
How to set up Surround Sound	65

## VIDEO-CD

How to play a VIDEO-CD	69
How to use the Menu Function	71
How to use the Disc View Function	73

## CD

How to play a CD	77
------------------	----

## BASIC FUNCTIONS

Search and Skip Functions	80
To Perform Time or Chapter Search	81
Slow Motion and Step Playback	83
Display Function	84
Repeat Playback	85
To Program in desired order	87
To playback from the last stop point	89

## BEFORE MAKING A REPAIR INQUIRY

Disc type and characteristics	91
Maintenance and Storage	92
Troubleshooting Guide	94
Definition of Terms	95
Specifications	96
Audio & Subtitle Languages	97
Warranty	99

# Disc Features

## DVD



## VIDEO-CD



## CD



### Excellent Sound

The Dolby Digital(AC-3) system developed by Dolby Labs provides crystal clear sound reproduction.



### Screen

Both regular and Widescreen(16:9) pictures can be viewed.



### Various Functions

You can select various languages (Audio/Subtitle) and screen angles while enjoying movies.



### Repeat

You can repeat a song or movie simply by pressing the Repeat button.



### Slow Motion

An important scene can be viewed in slow motion.



### Programmed Play

You can program tracks to play in desired order.



### Parental Lock Level Control

The parental lock control allows users to set the level necessary to prevent children from viewing harmful movies such as those with violence, adult subject matter, etc...



# Safety Instructions

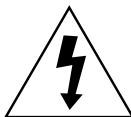

**CAUTION**  
 RISK OF ELECTRIC SHOCK.  
 DO NOT OPEN



**CAUTION:**  
TO REDUCE THE RISK OF ELECTRIC SHOCK, DO NOT REMOVE REAR COVER, NO USER SERVICEABLE PARTS INSIDE, REFER SERVICING TO QUALIFIED SERVICE PERSONNEL.



This symbol is intended to alert you to the presence of dangerous voltage within the product.

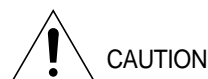

This symbol is intended to alert you to the presence of important instructions accompanying the product.

## WARNING

To reduce the risk of fire or electric shock, do not expose this appliance to rain or moisture.

## CLASS 1 LASER PRODUCT

### CLASS 1 LASER PRODUCT

This DVD player is classified as a CLASS 1 LASER product.

Use of controls adjustments or performance of procedures other than those specified herein may result in hazardous radiation.

CAUTION-INVISIBLE LASER RADIATION WHEN OPEN AND INTERLOCK DEFEATED, AVOID EXPOSURE TO BEAM.

### SPECIAL NOTICE

#### Warning:

- This unit contains no user serviceable parts. Never remove covers unless qualified to do so.
- This unit contains dangerous voltages. Always remove main plug from the socket before performing any service operation and when not in use for a long period.

#### Important:

- This unit is designed for your enjoyment in your home. We cannot be liable for the quality of the unit if you use it for commercial use.

### IMPORTANT NOTICE

#### NOTE TO CATV SYSTEM INSTALLER;

- This reminder is provided to call the CATV system installer's attention to article 820-40 of the NEC provides guidelines for proper grounding and, in particular, specifies that the cable ground shall be connected to the grounding system of the building, as close to the point of cable entry as practical.

#### READ INSTRUCTIONS

- All the safety and operating instructions should be read before the appliance is operated.

#### RETAIN INSTRUCTIONS

- The safety and operating instructions should be retained for future reference.

#### HEED WARNINGS

- All warnings on the appliance and in the operating instructions should be adhered to.

#### FOLLOW INSTRUCTIONS

- All operating and use instructions should be followed.

#### WATER AND MOISTURE

- Do not use this video product near water, for example, near a bathtub, wash bowl, kitchen sink, or laundry tub, in a wet basement, or near a swimming pool, and the like.

#### OVERLOADING

- Do not overload wall outlets and extension cords as this can result in the risk of fire or electric shock.

#### VENTILATION

- Slots and openings in the cabinet are provided for ventilation and to ensure reliable operation of the video product and to project it from overheating these openings must not be blocked or covered. The openings should never be blocked by placing the video product on a bed, sofa, rug, or other similar surface. This video product should never be placed near or over a radiator or heat register. This video product should not be placed in a built-in installation such as a bookcase or rack unless proper ventilation is provided or the manufacturer's instructions have been followed.

#### POWER CORD PROTECTION

- Power-supply cords should be routed so that they are not likely to be walked on or pinched by items placed upon or against them, paying particular attention to cords at plugs, convenience receptacles, and the point where they exit from the appliance.

#### CLEANING

- Unplug this video product from the wall outlet before cleaning. Do not use liquid cleaners or aerosol cleaners. Use a damp cloth for cleaning.

#### LIGHTNING

- For added protection of this video product receiver during a lightning storm, or when it is left unattended and unused for long periods of time, unplug it from the wall outlet and disconnect the antenna or cable system. This will prevent damage to the video product due to lightning and power-line surges.

#### OBJECT AND LIQUID ENTRY

- Never push objects of any kind into this product through openings as they may touch dangerous voltage points or short-out parts that could result in a fire or electric shock. Never spill liquid of any kind on the video product.

#### ACCESSORIES

- Do not place this video product on an unstable cart, stand, tripod, bracket, or table. The video product may fall, causing serious injury to a child or adult, and serious damage to the appliance. Use only with a cart, stand, tripod, bracket, or table recommended by the manufacturer, or sold with the video product. Any mounting of the appliance should follow the manufacturer's instructions and should use a mounting accessory recommended by the manufacturer.



## CART

- An appliance and cart combination should be moved with care. Quick stops, excessive force, and uneven surfaces may cause the appliance and cart combination to overturn.

## POWER SOURCES

- This video product should be operated only from the type of power source indicated on the marking label. If you are not sure of the type of supply to your home, consult your appliance dealer or local power company. For video products intended to be operated from battery power, or other sources, refer to the operating instructions.

## POWER LINES

- An outside antenna system should not be located in the vicinity of overhead power lines or other electric light or power circuits, or where it can fall into such power lines or circuits. When installing an outside antenna system, extreme care should be taken to keep from touching such power lines or circuits as contact with them might be fatal.

## POLARIZATION

- This video product is equipped with a polarized alternating current line plug (a plug having one blade wider than the other). This plug will fit into the power outlet only one way. This is a safety feature. If you are unable to insert the plug fully into the outlet, try reversing the plug. If the plug should still fail to fit, contact your electrician to replace your obsolete outlet. Do not defeat the safety purpose of the polarized plug.

## OUTDOOR ANTENNA GROUNDING

- If an outside antenna is connected to the antenna terminal, be sure the antenna system is grounded so as to provide some protection against voltage surges and built-up static charges.
- In the U.S.A section 810 of the National Electrical Code. ANSI/NFPA No. 70-1984, provides information with respect to proper grounding of the mast and supporting structure, grounding of the lead-in wire to an antenna discharge unit, size of grounding conductors location of antenna discharge unit, connection to grounding electrodes, and requirements for the grounding electrode. See the below figure.

## ATTACHMENTS

- Do not use attachments not recommended by the video product manufacturer as they may cause hazards.

## SERVICING

- Do not attempt to service this product yourself as opening or removing covers may expose you to dangerous voltage or other hazards.
- Refer all servicing to qualified service personnel.

## REPLACEMENT PARTS

- When replacement parts are required, be sure the service technician has used replacement parts specified by the manufacturer or having the same characteristics as the original part. Unauthorized substitutions may result in fire, electric shock or other hazards.

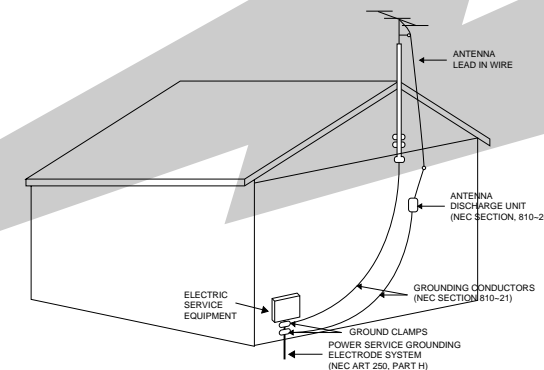

## SAFETY CHECK

- Upon completion of any service or repairs to this video product, ask the service technician to perform safety checks to determine that the video product is in proper operating condition.

## DAMAGE REQUIRING SERVICE

- Unplug this video product from the wall outlet and refer servicing to qualified service personnel under the following conditions.
  - a. When the power-supply cord or plug is damaged.
  - b. If liquid has been spilled, or objects have fallen into the video product.

- c. If the video product has been exposed to rain or water.
- d. If the video product does not operate normally by following the operating instructions. Adjust only those controls that are covered by the operating instructions as an improper adjustment of other controls may result in damage and will often require extensive work by a qualified technician to restore the video product to its normal operation.
- e. If the video product has been dropped or the cabinet has been damaged.
- f. When the video product exhibits a distinct change in performance. This indicates a need for service.

# Descriptions - Front Panel



## Front Panel

Refer to page mentioned

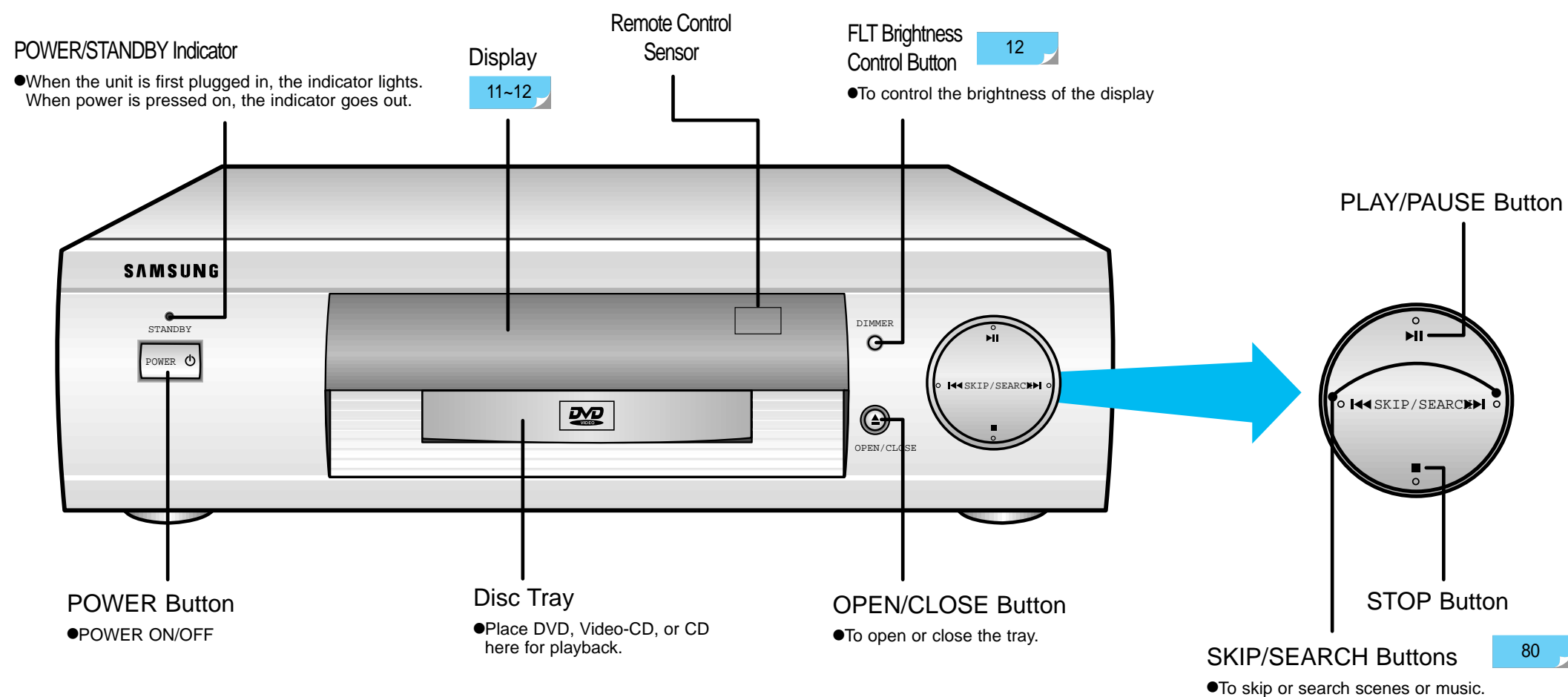

# Descriptions - FLT Display



## FLT Display

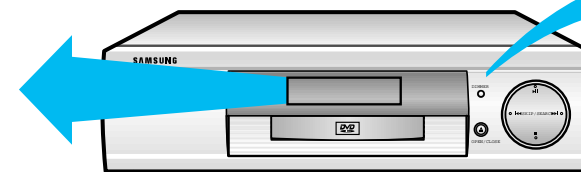
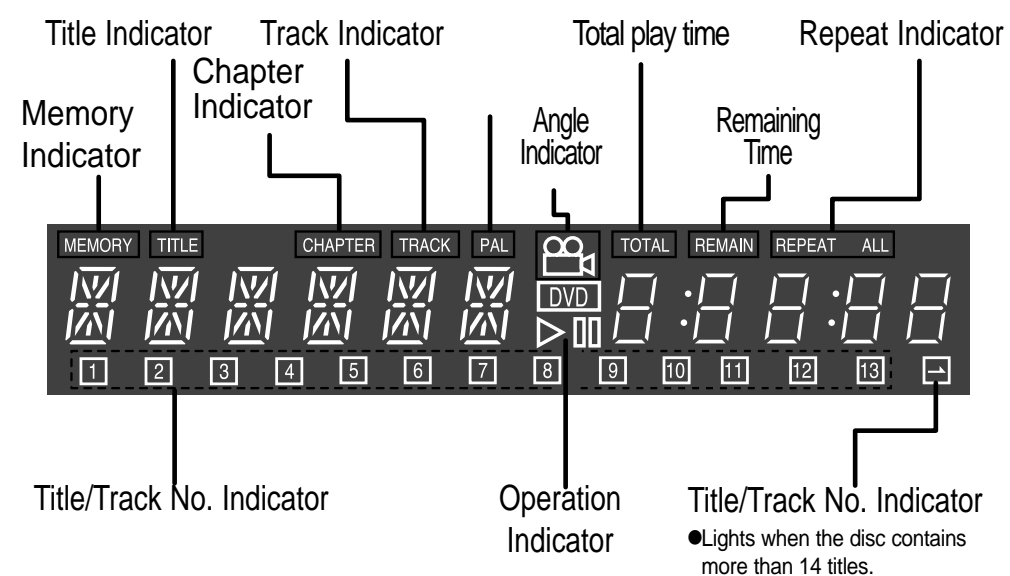

## Adjusting Display Illumination

Press 'DIMMER' Button.

- Press once to dim the display. Press again to turn the display off.
- To return to normal illumination, press a third time.

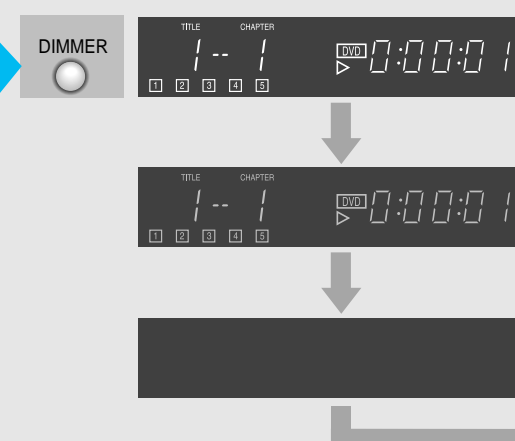

# Descriptions - Rear Panel



## Rear Panel

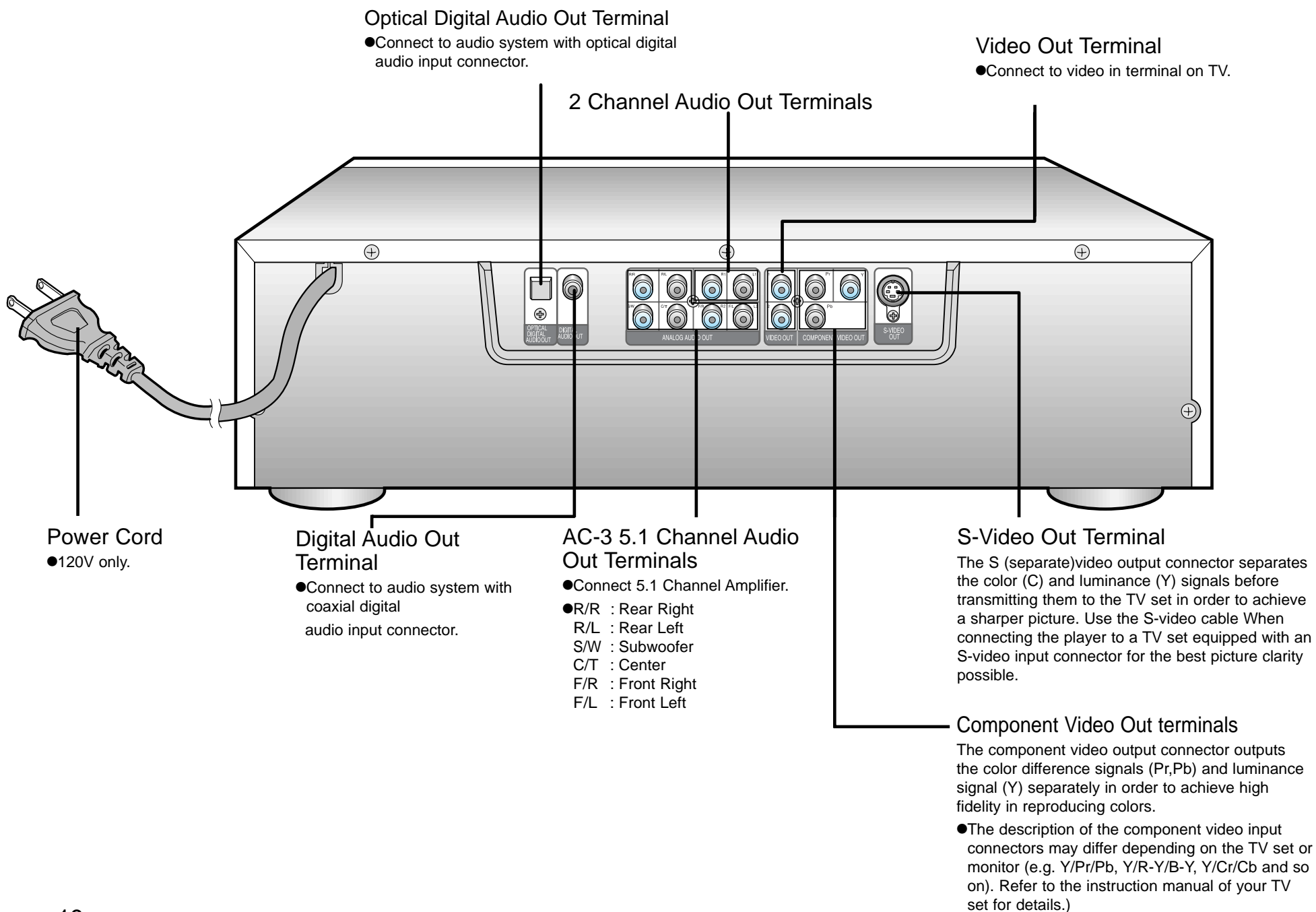

## Accessories

\* To purchase accessories, please contact SAMSUNG at 1-800-SAMSUNG.

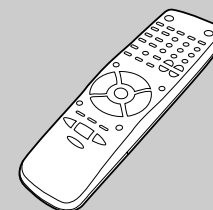

Remote Control

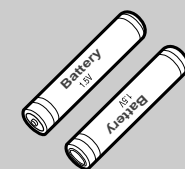

Batteries (AAA Dry-Cell 1.5V) for Remote control

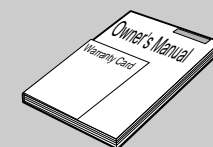

Owner's Manual

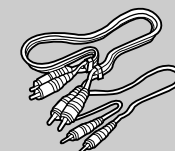

Video/Audio Connection Cable

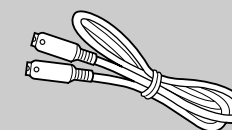

S-Video Cable

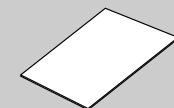

Registration Card



**Note** ●Be sure to select the proper audio and video output in the setup menu before operating the unit. Refer to pages 49-50.



# Remote Control



## Basic Operations

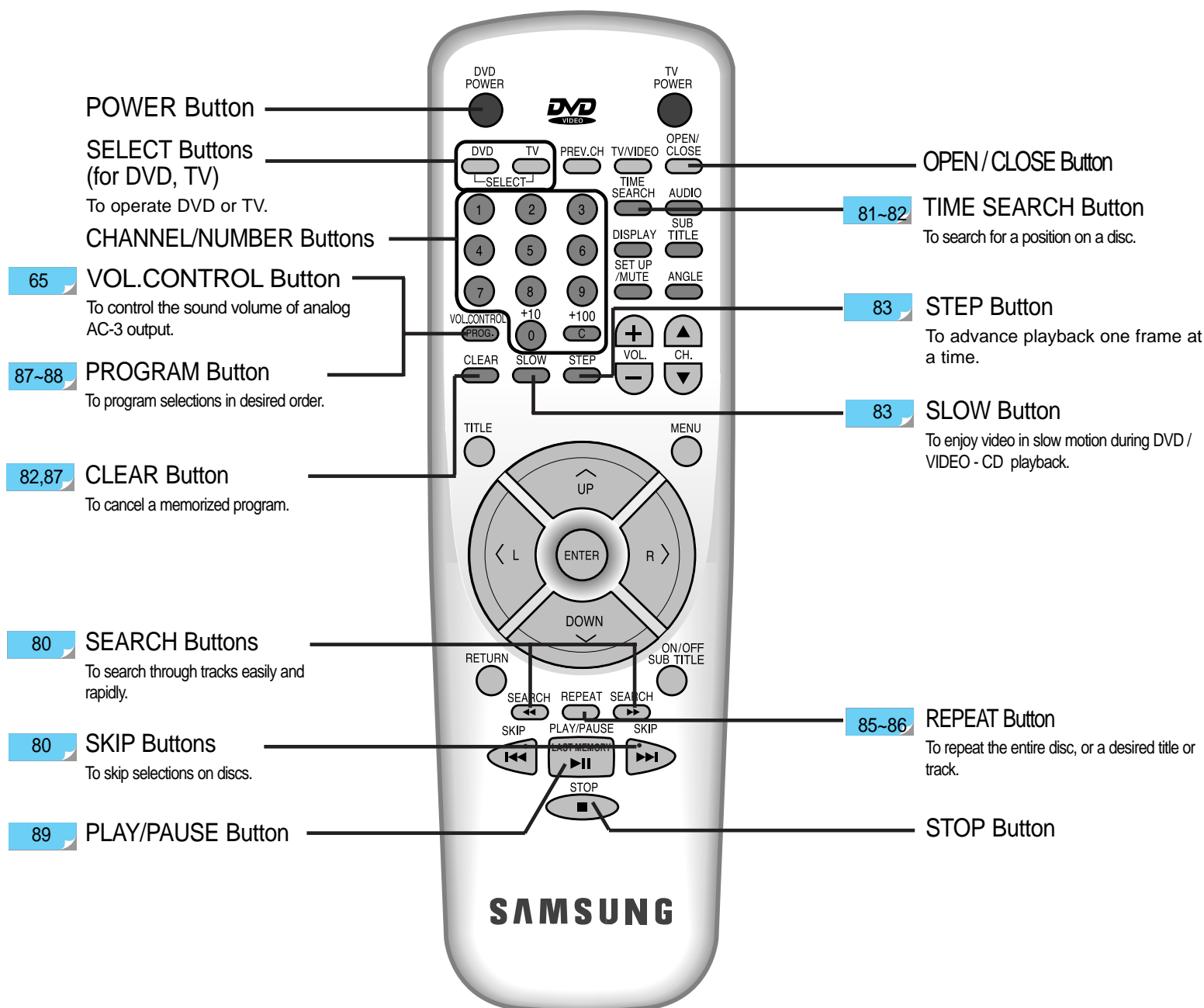

## Remote Control Battery Installation

- 1** Open battery cover in the direction shown.

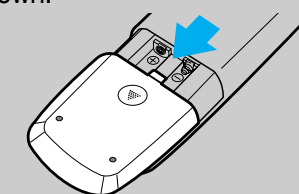

- 2** Carefully check the Polarity  $\oplus$   $\ominus$  of batteries and load them correctly into the battery compartment.

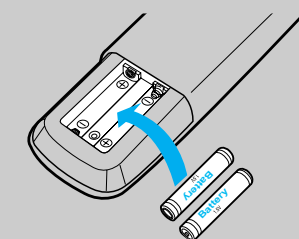

- 3** Close battery cover in the direction shown.

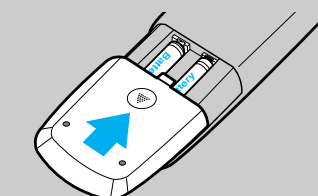

- Note**
- Remove the batteries from the remote control if it will not be used for an extended period.
  - After you press the TV button, certain DVD function buttons will not work. Press the DVD button.

# Remote Control



## Buttons for DVD

**37** **AUDIO Selector**  
To select Audio when playing a DVD disc.

**38** **SUBTITLE Selector**  
To select the sub title when playing a DVD disc.

**84** **DISPLAY Button**  
To see the current DISC mode.

**39** **ANGLE Selector**  
To change the screen angle.

**81~82** **CHAPTER Button**  
To search chapters.

**41~48,71** **MENU Button**  
To change audio, subtitle, angle, etc...

**35~36,73** **TITLE Button**

**35~65** **DIRECTION Buttons**  
When using the menus, press these buttons when you want to move to desired position.

**35~66** **ENTER Button**  
To play a selected title.

**43~66** **RETURN Button**  
To return to a previous menu.

**40** **SUBTITLE Button**  
To turn subtitles on or off.

## Buttons for TV

**PREV. CH**  
Press to select the previous channel on the TV.

**22** **TV POWER Button**

**22** **TV/VIDEO Selector**  
To select TV or VIDEO.

**49~66** **SET UP/MUTE Selector**  
To bring up the setup menu or to mute the TV sound temporarily.

**CHANNEL Selector**

**VOLUME CONTROL Buttons**

## If remote doesn't operate properly:

1. Check the polarity  $\oplus \ominus$  of the batteries (Dry-Cell)
2. Check if the batteries are drained.
3. Check if remote sensor is blocked by obstacles.
4. Check if there is any fluorescent lighting nearby

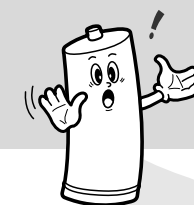

**Note** •When '!!' appears while a button is being operated, it means that the function does not work the disc currently playing.

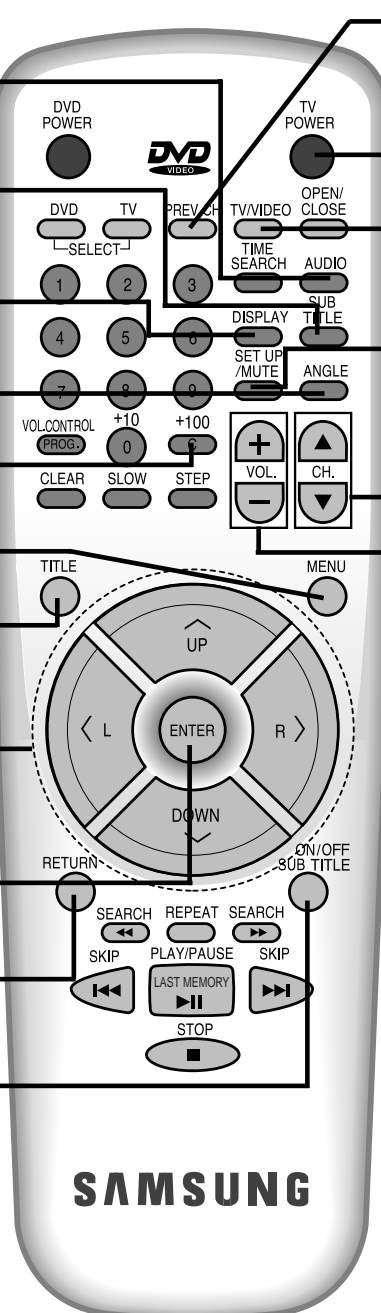

**SAMSUNG**

# Controlling your TV with the Remote

This remote control works not only with Samsung TVs, but also with other manufacturer's TVs.

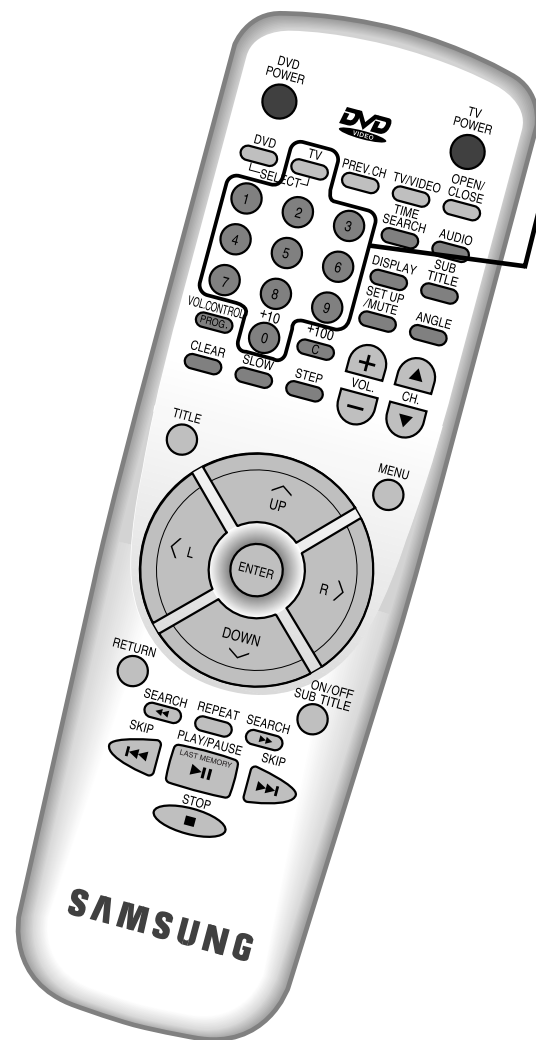

## Ex1) for Samsung TVs

●Press ①, ① key when pressing TV button.

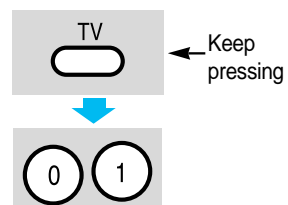

## Ex2) for Panasonic TVs

●Press ①, ② key when pressing TV button.

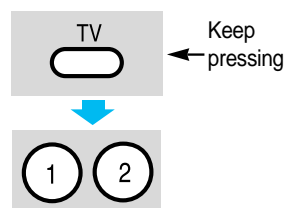

To operate DVD while watching TV

●Press DVD button, then  
press the function you  
want.



## Programming TV-List of Compatible TV's

To Control a Compatible TV

To program your DVD remote to control a specific brand of TV;

- 1 Turn the TV on and point the remote at the TV.
- 2 Press and hold down . At the same time, press the appropriate buttons respectively according to the chart below.  
When the TV turns off, programming is completed. The remote then controls the TV as shown in the chart.  
A "YES" indicates the remote button works as marked, a "NO" indicates the button does not work. Any other functions are marked.  
(For example: for an Emerson TV, works for DISPLAY.)

It will not operate all TV's made by these manufacturers. If your TV does not respond to any of the button combinations, the TV probably cannot be controlled by this remote control. The DVD remote will now control certain functions of your TV depending on the type of TV.

Press Button <"	① ①	① ②	① ③	① ④	① ⑤	① ⑥	① ⑦	① ⑧	① ⑨	① ⑩	① ⑪	① ⑫
TV Brand <"	Samsung old	Sharp new	Sony	Magnavox	Sanyo	Goldstar new	RCA/GE	Goldstar old	Toshiba	Hitachi	JVC	Panasonic 1
Select i												
POWER	YES	YES	YES	YES	YES	YES	YES	YES	YES	YES	YES	YES
①-②	YES	YES	YES	YES	YES	YES	A-K	YES	YES	YES	YES	YES
+100	YES	YES	YES	YES	YES	YES	YES	YES	YES	YES	NO	NO
CH	YES	YES	YES	YES	YES	YES	YES	YES	YES	YES	YES	YES
VOL	YES	YES	YES	YES	YES	YES	YES	YES	YES	YES	YES	YES
DISPLAY	YES	YES	YES	YES	NO	NO	YES	NO	NO	NO	YES	YES

Press Button & "	① ③	① ④	① ⑤	① ⑥	① ⑦	① ⑧	① ⑨	② ①	② ②	② ③	② ④	
TV Brand & "	Mitsubishi	Samsung new	Samsung Latin	Sharp old	Zenith	Goldstar Latin	Daewoo	Sanyo	Emerson	Sharp	Samsung Latin new	Panasonic
Select i												
POWER 	YES	YES	YES	YES	YES	YES	YES	YES	YES	YES	YES	YES
①-② 	YES	YES	YES	YES	YES	YES	A-K	YES	YES	YES	YES	YES
+100 	NO	YES	NO	NO	YES	NO	NO	YES	DISPLAY	NO	YES	NO
	YES	YES	YES	YES	YES	YES	YES	YES	YES	YES	YES	YES
	YES	YES	YES	YES	YES	YES	YES	YES	YES	YES	YES	YES
DISPLAY 	YES	YES	NO	NO	NO	NO	YES	YES	NO	NO	NO	YES

# Preparation before usage

For better performance be sure to read the following carefully.

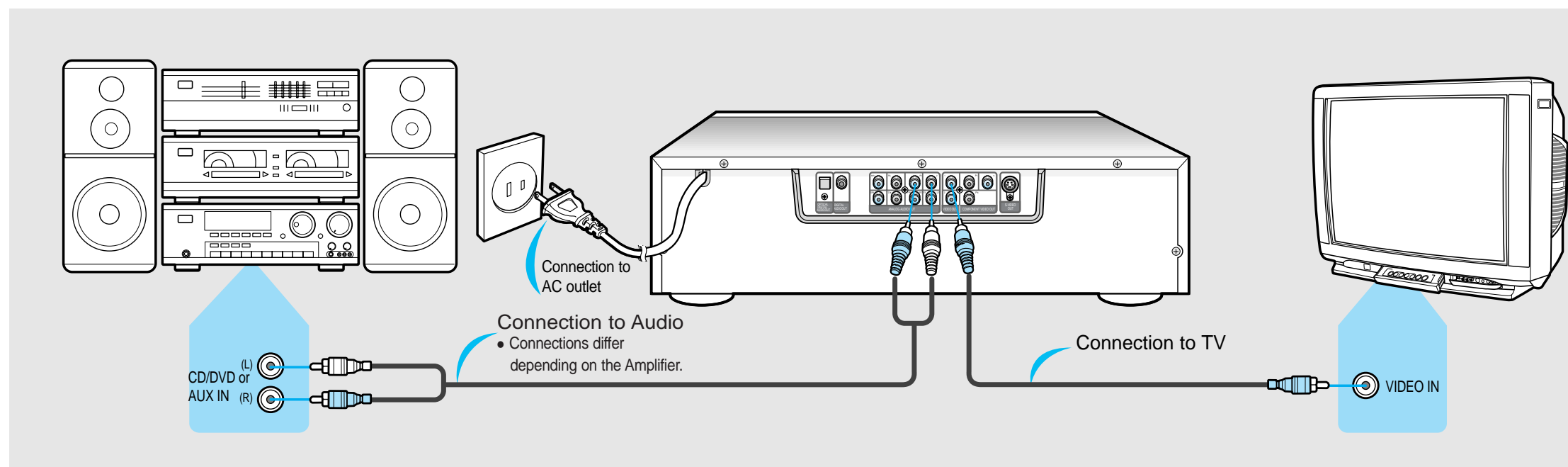

Connect TV & Audio to the unit as shown in picture above.

Refer to pages 23-30 for more detailed connections(including AC-3).

DVD-907 Audio Output Specifications

OUTPUT \ DISC		DVD	VIDEO-CD	CD
Analog Audio Out	2 Channel (R1,L1)	48/96KHz sampling	44.1KHz sampling	44.1KHz sampling
	5.1Channel (RR,RL,C,T,SW,F,R,FL)	48KHz sampling	—	—
Digital Audio Out		48KHz sampling	44.1KHz sampling	44.1KHz sampling
Optical Digital Audio Out		48KHz sampling	44.1KHz sampling	44.1KHz sampling

For DVDs, Sound having 96KHz Sampling is not output from the Optical Digital Output and Digital Audio Output connector.

## 1 DVD Power On

Press power button.

- Power is turned on while Power/STANDBY indicator light goes out.

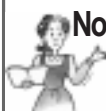

### Note • AUTO POWER OFF FUNCTION

This unit has an Automatic power off feature. If the unit is left 30 minutes in stop mode without any button being pressed, the power will automatically shut off.

## 2 TV Power On & Selection

Press TV power button & TV/VIDEO Selector and select Video function.

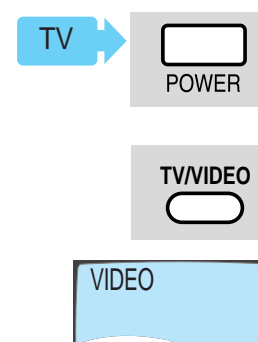

## 3 Audio Power On & Input Selection

Press audio power button & select desired input.  
●Example: CD, DVD or AUX.

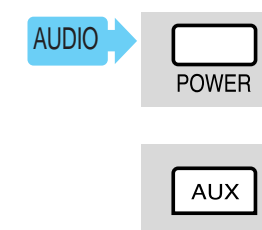



# Connections

This shows you how to connect the DVD to a TV or Audio system.  
Please make sure that the power switches of the player and other equipment are OFF before connecting.

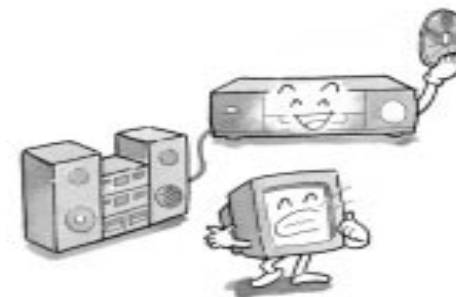

Connecting to a TV

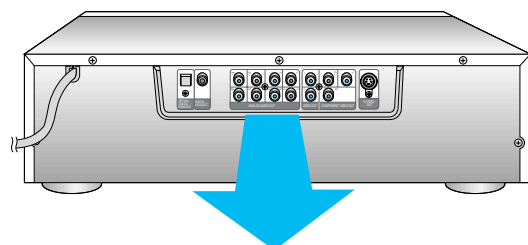

Connecting to an Audio System

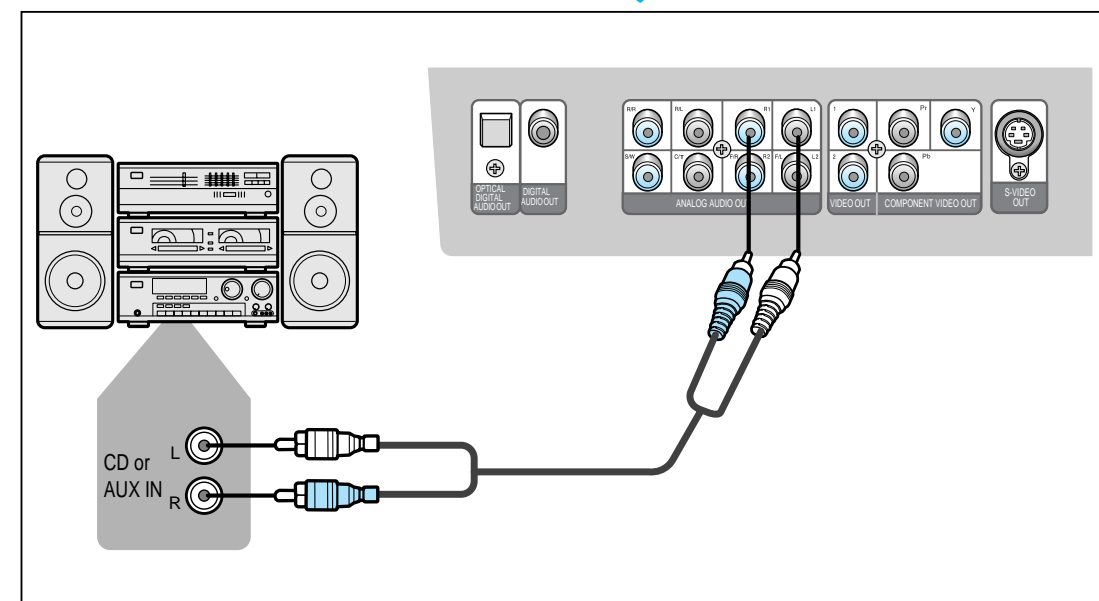
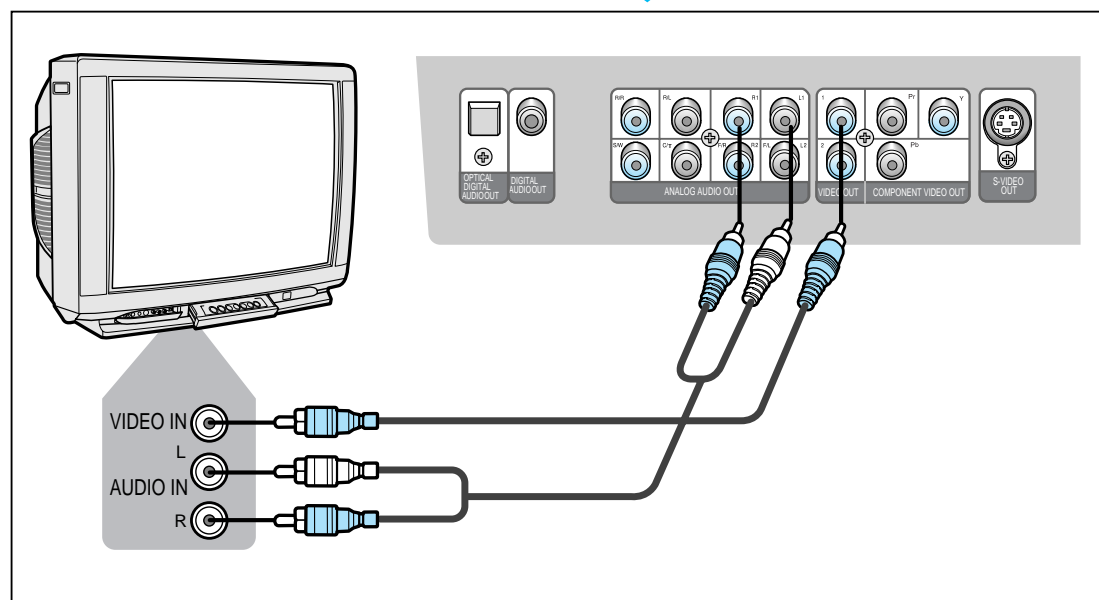
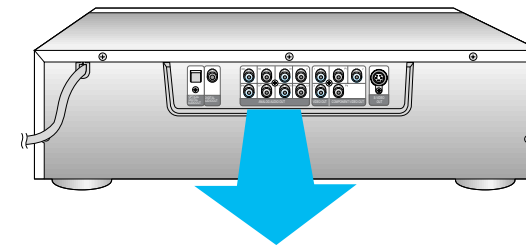

How to use the TV

**1** Turn on the TV.

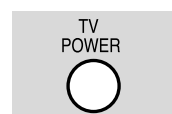

**2** Set the TV/Video button to the Video position.

● Input signal will appear.



How to use the Audio System

**1** Turn on your Audio System.

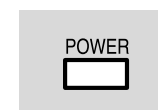

**2** Select the AUX or CD button on your Audio system.

● CD or AUX IN is selected depending on the input you use on the Audio system.



# Connections

These connections will provide superior sound and video reproduction.

## S-VIDEO Connection

★ Connect with TV having S-VIDEO IN.

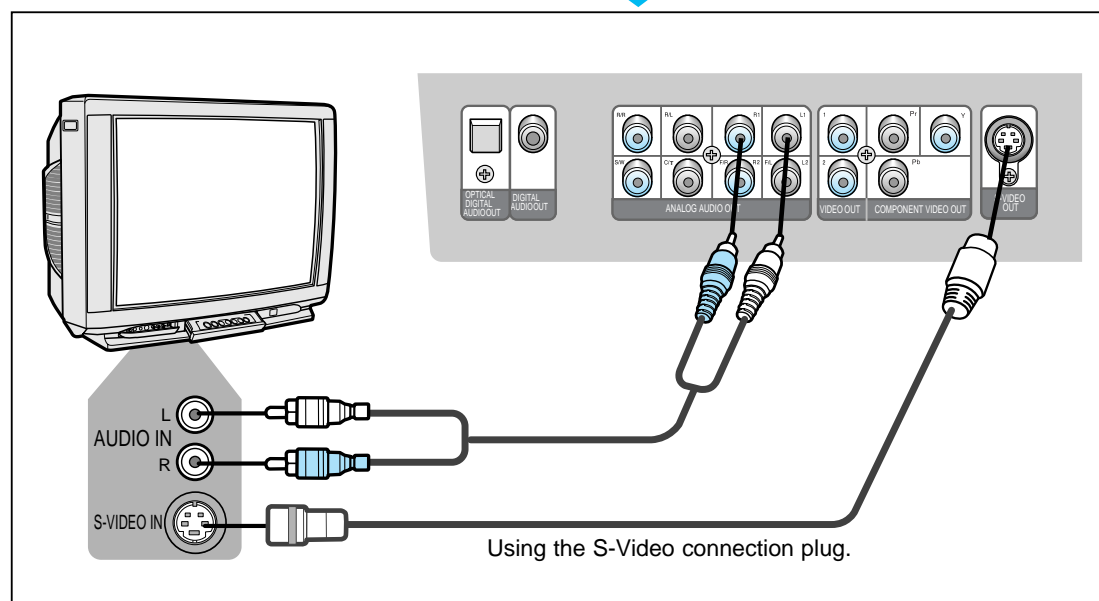
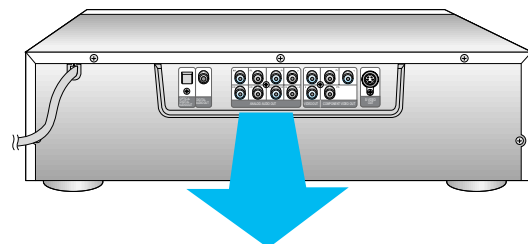

## How to use the TV

**1** Turn on the TV.

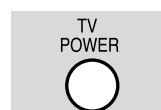

**2** Select 'S-Video' mode by pressing the TV/Video button to the Video position.

● 'S-Video' will appear depending on each TV.



AC-3 5.1 channel  
and Y,Pr,Pb Video  
connection

Manufactured under license by Dolby Laboratories Licensing Corporation. "Dolby", "AC-3", "Pro Logic" and the double-D symbol are trademarks of Dolby Laboratories Licensing Corporation.

\* Component signals(Y, Pr, Pb) are output from the Y,Pr,Pb jacks.

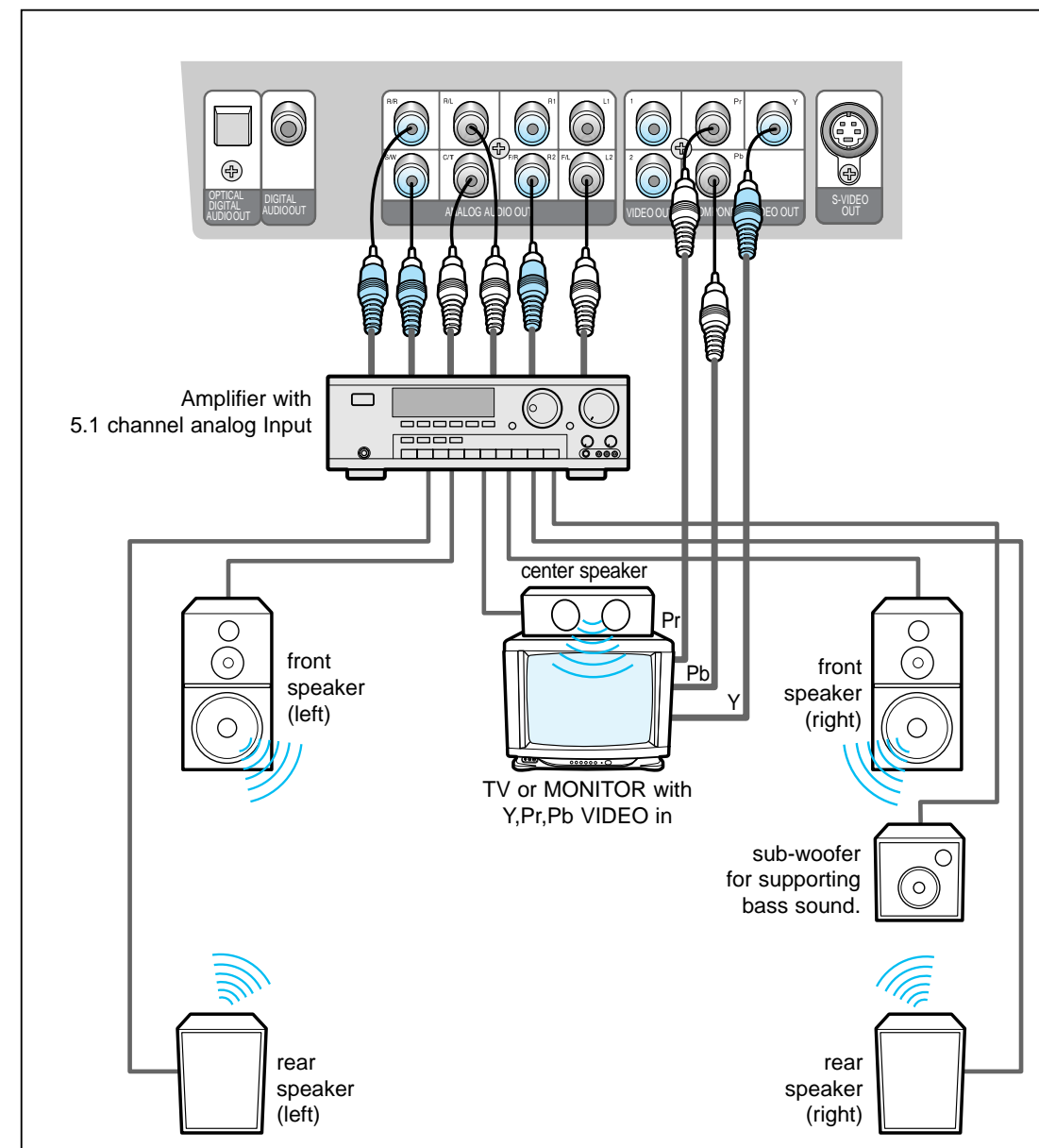

# Connections

## AC-3 5.1 channel and S-Video connection

Manufactured under license by Dolby Laboratories Licensing corporation. "Dolby", "AC-3", "Pro Logic", and the double-D symbol are trademarks of Dolby Laboratories Licensing Corporation.

\* AC-3 5.1 channel connection.

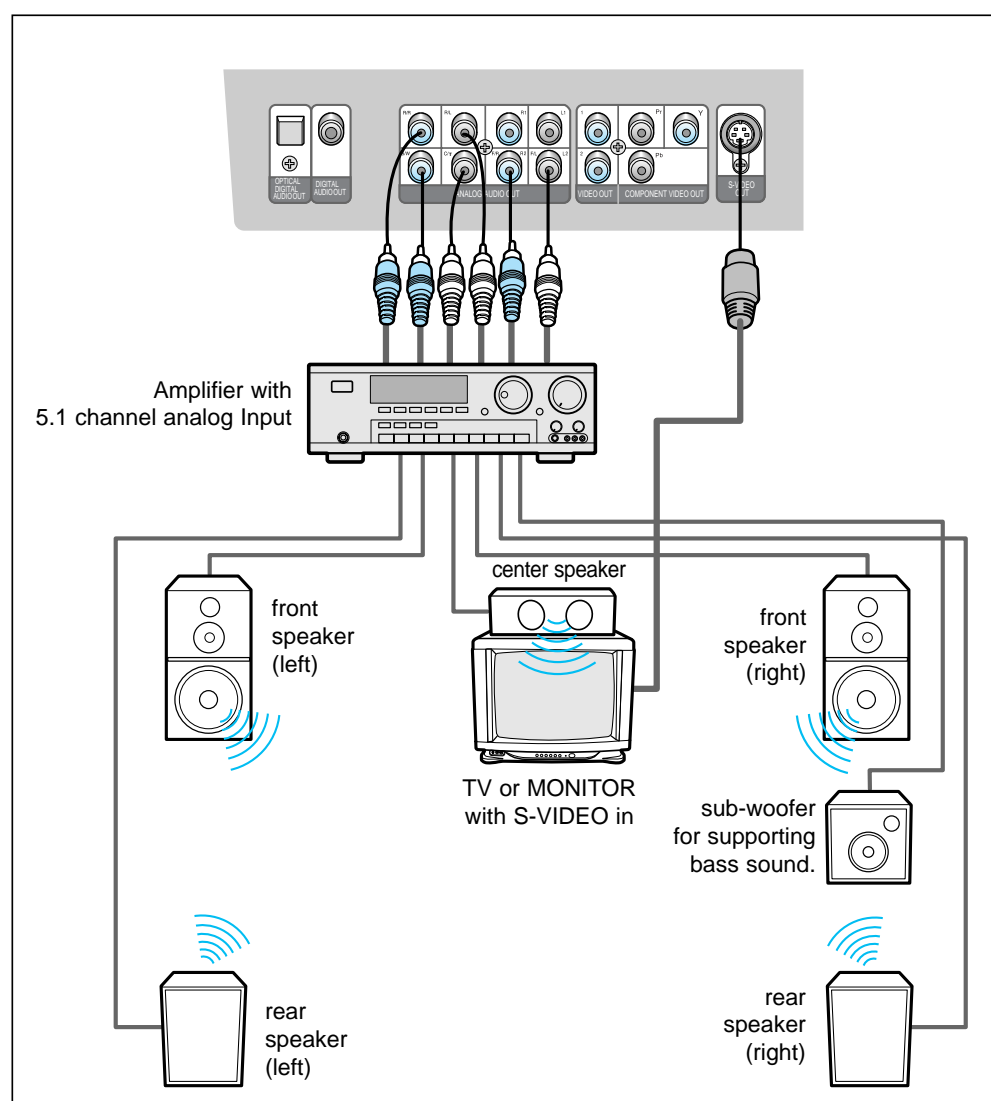

## Stereo amplifier and S-Video connection (2-channel)

\* Normal stereo amplifier and S-VIDEO connection. (2-channel)

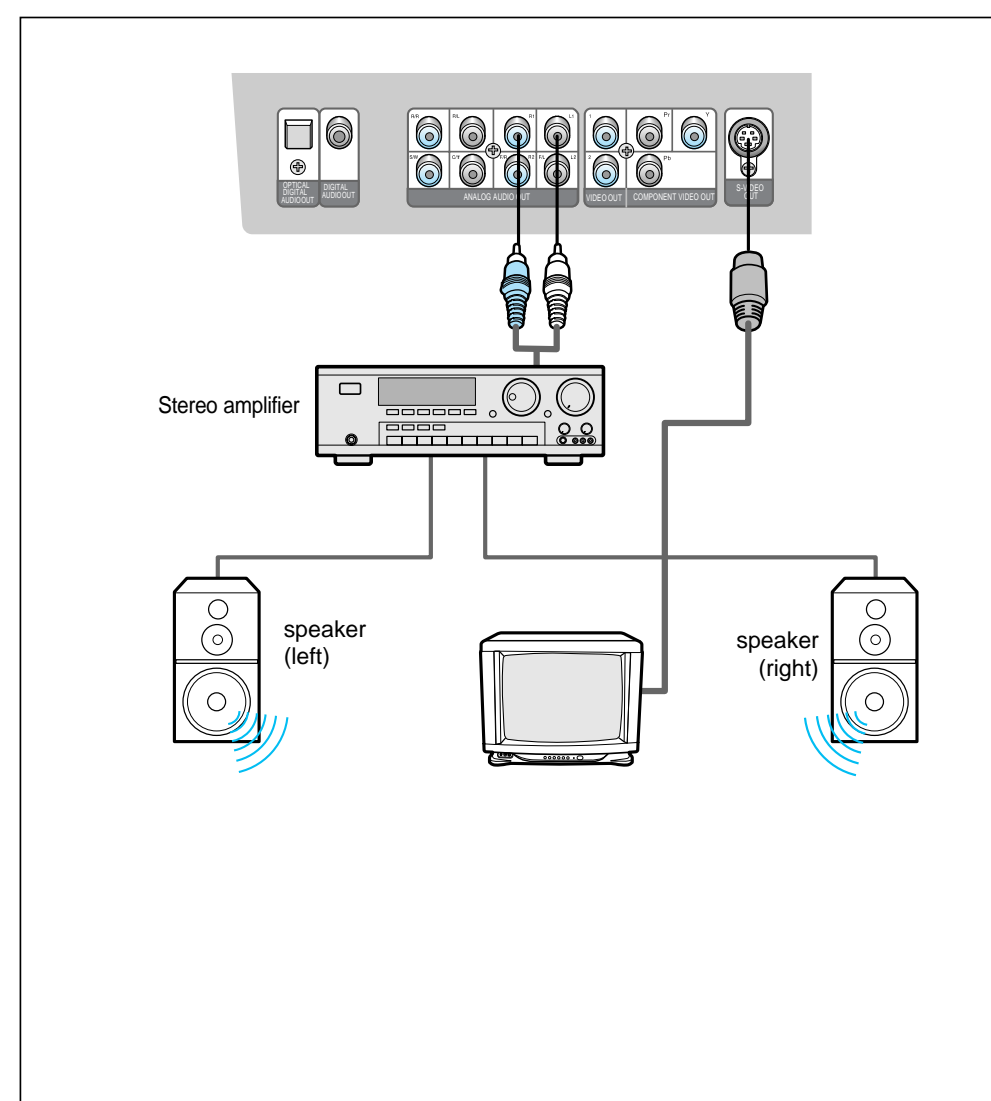

# Connections

## Dolby Pro-Logic Connection

- \* Either the Optical Digital Audio Out, Digital Audio Out or Analog Audio Out (R/L) should be connected to the Dolby Pro-Logic amplifier.
- \* The Optical Digital Audio Out and Digital Audio Out both output the same signal.

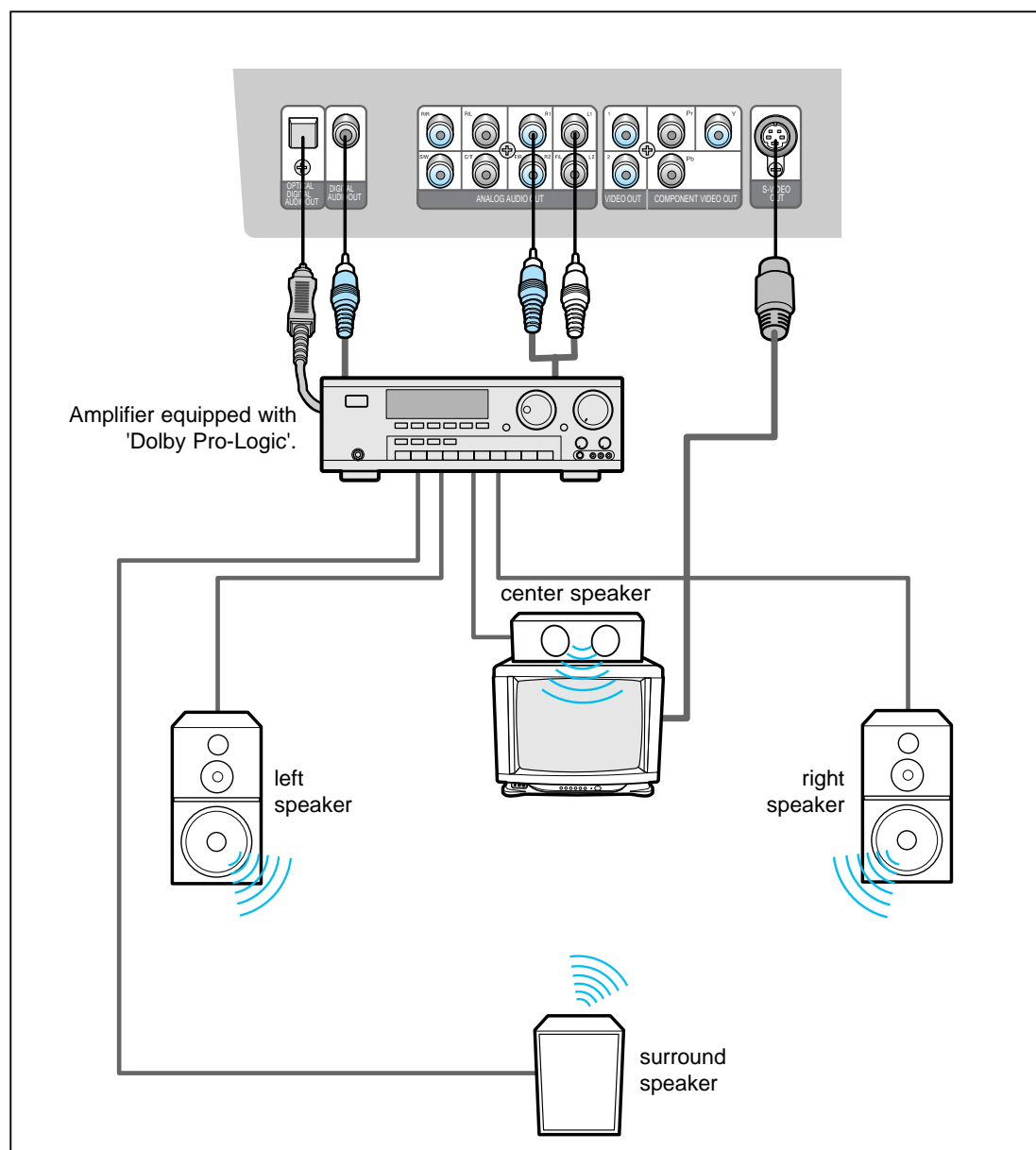

## AC-3 decoder amplifier digital connection

- \* Either the Optical Digital Audio Out or the Digital Audio Out should be connected to the AC-3 decoder amplifier.
- \* The Optical Digital Audio Out and Digital Audio Out both output the same signal.

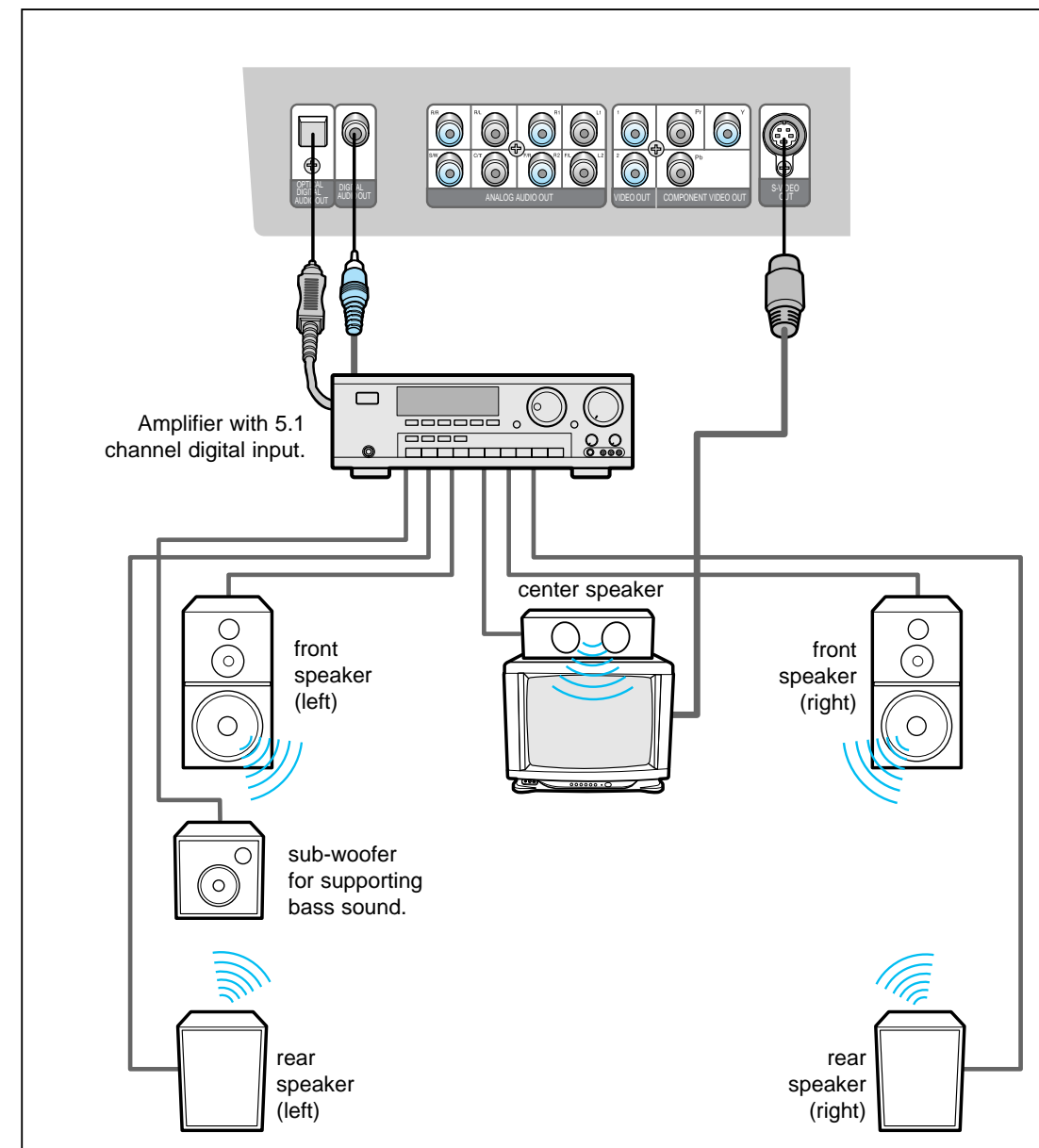



# DVD Playback



DVD LOGO

## DVD Features

DVD contains excellent sound and video due to the AC-3 digital audio and MPEG2 video systems.

DVD makes your home feel like a movie theater.

- The DVD disc contains audio and video up to 135 minutes (single side, single layer disc) of playing time.
- Various screen and audio functions can be easily selected through the on-screen menu.



Playback Region Number

This unit will only play discs with the Playback Region Number 1 (This unit can't play a disc which has a different playback region number.)

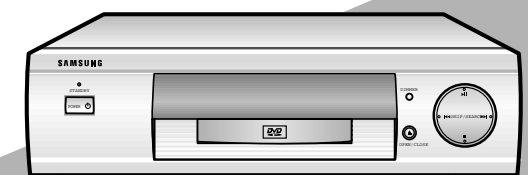

# How to Play a DVD

Press your TV and Audio system POWER Buttons ON.  
Depending on the disc, some DVD playback functions may not operate.



## TV / AUDIO selection

Select Video mode by pressing TV/VIDEO Button on the TV.

- Video mode may be marked as input.

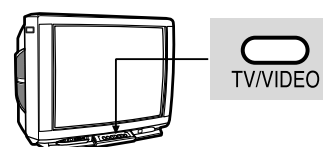

Select Audio input CD, DVD or Aux on your decoder/amp

- Each audio amplifier is different. Please refer to your audio amplifier owner's manual.

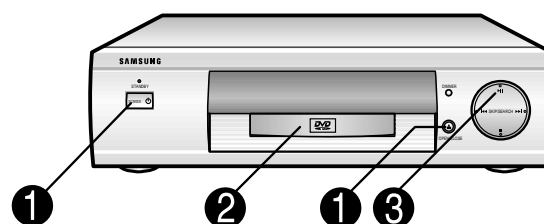
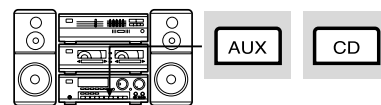

## How to play DVD

**1** Press POWER Button and OPEN/CLOSE Button.

- Power turns on, the tray opens and the STANDBY indicator light goes out.

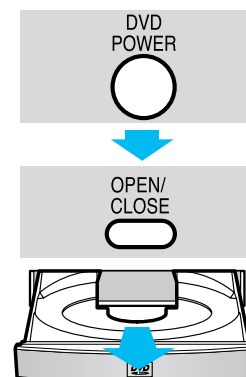

**2** Load the DVD disc.

- Load the disc label-side up.



**3** Press PLAY/PAUSE Button.

- The tray closes and playback begins.



## To Pause Playback

Press PLAY/PAUSE Button.

- To play again, press PLAY/PAUSE Button once again.



## To STOP Playback

Press STOP Button.



## To Remove Disc

Press OPEN/CLOSE Button.

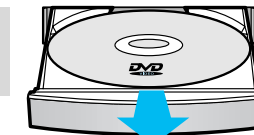
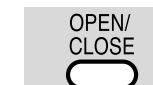

- Note**
- When play is stopped, the unit records the point where STOP was pressed (RESUME function). Press PLAY again, and play will resume from this point. When the tray is opened or STOP is pressed again, the RESUME function will be cleared.
  - If the unit is left in the STOP mode for more than one minute without any user interaction, a screensaver will be activated, and the TV screen will fade in and fade out repeatedly. Press PLAY button to resume normal play.
  - If the unit is left for 30 minutes in pause during play or menu, it will be stopped.

# How to Change to another Title while in Play

If there are two or more titles on a disc, this function allows you to select another title.

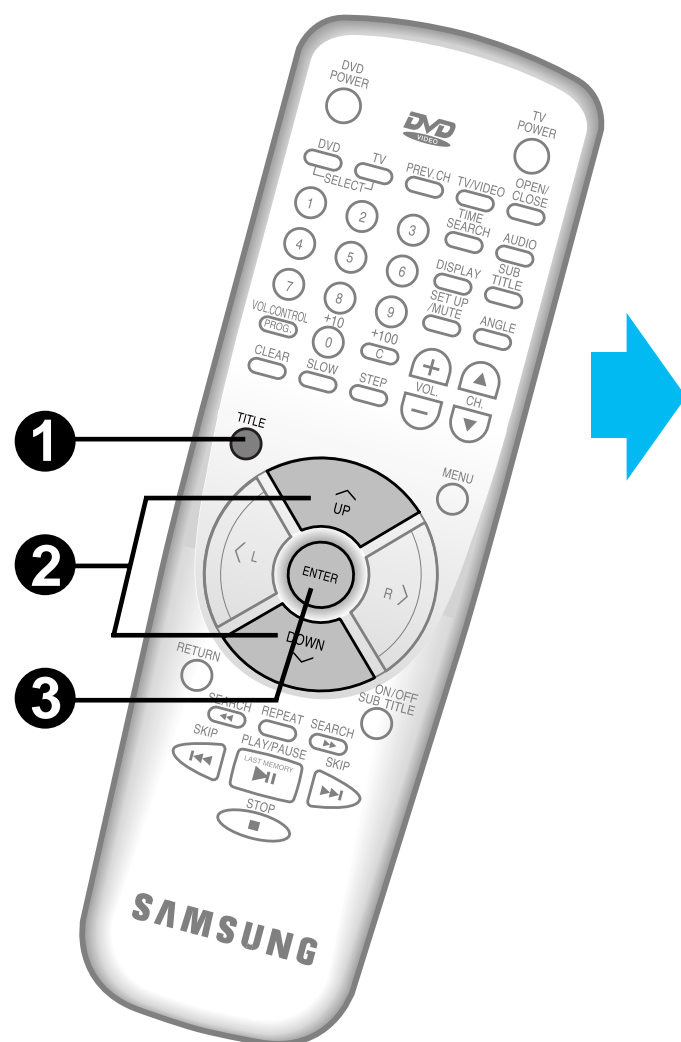

## 1 Press TITLE Button.

- You can see the title menu that is encoded on the disc.



## 2 Move to desired title by using UP or DOWN Button.

ex) You want to see 'Africa the Serengeti'

- Press the UP/DOWN Buttons until the desired title is highlighted.

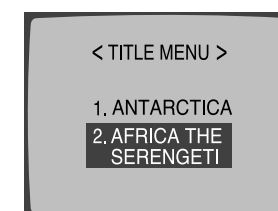
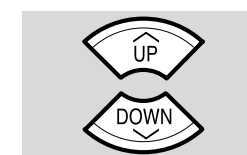

## 3 Press ENTER Button.

- Selected title will play.



## What is a Title?

Each movie is a title and a title is composed of a number of chapters.

## No screen even after pressing Title Button?

It may be that no title menu is listed on the disc and only one movie is present.

# How to change Audio

You can select a desired language quickly and easily with the AUDIO Button.  
If a menu is encoded on the disc, you can also select by use of the MENU Button

43~44

# How to Change Subtitle

You can select a desired subtitle language easily with the SUBTITLE Button.  
If a menu is encoded on the disc, you can also select by use of the MENU Button.

45~46

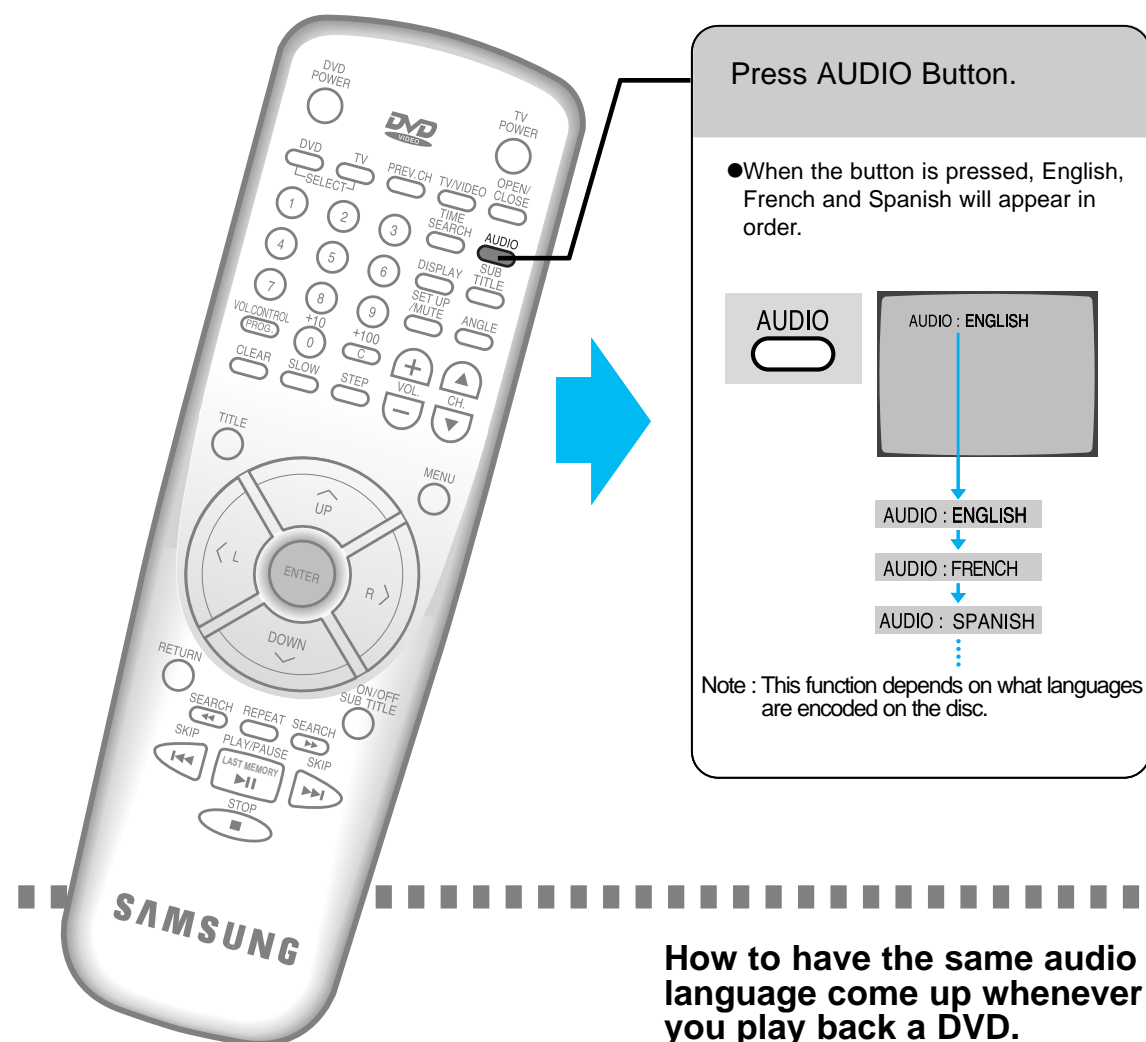

**How to have the same audio language come up whenever you play back a DVD.**

53~54

Please refer to "How to set up the Audio Language".

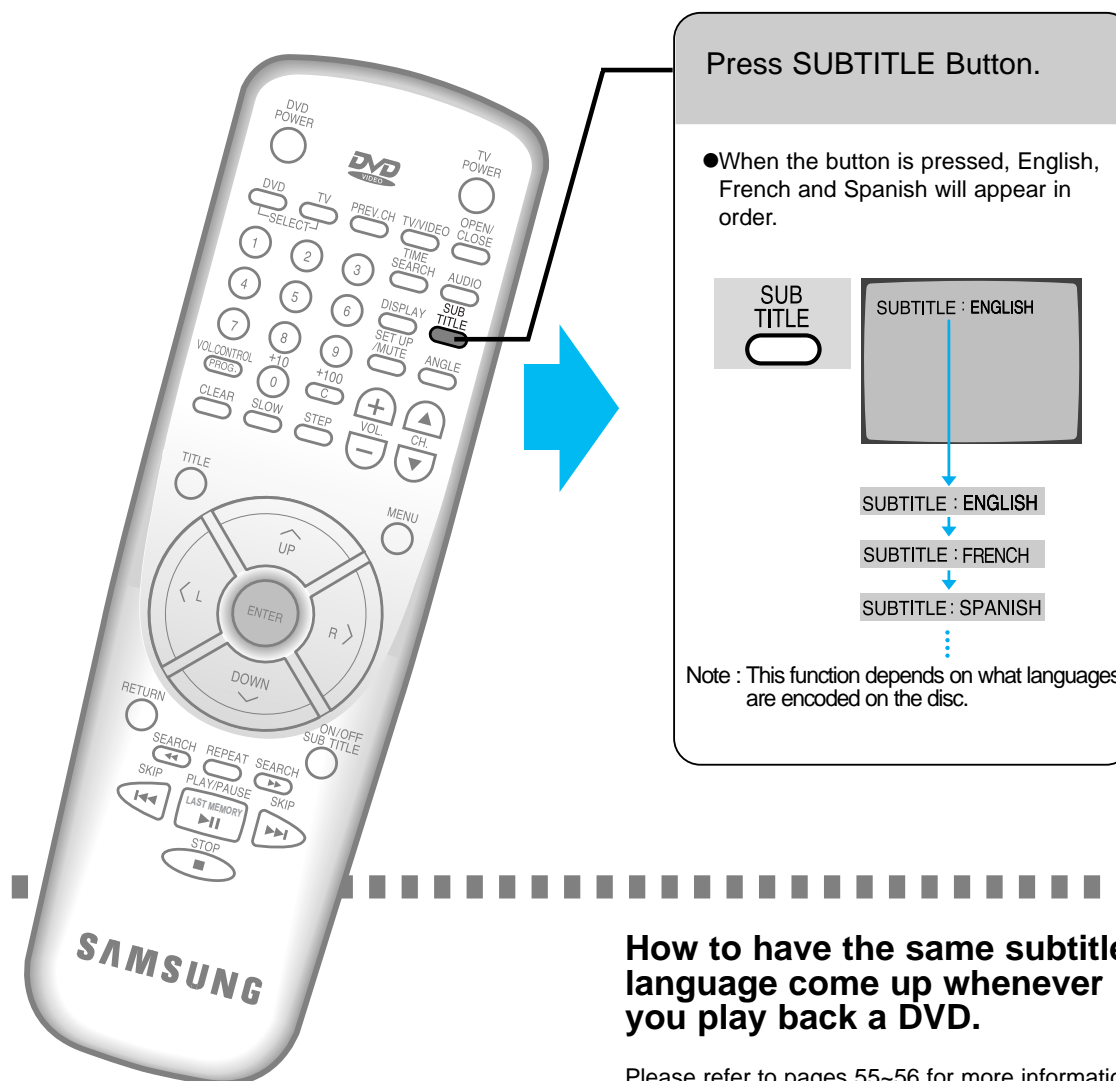

**How to have the same subtitle language come up whenever you play back a DVD.**

Please refer to pages 55~56 for more information.



# How to change Angle

By pressing the angle Button, you can view the picture from a variety of angles.

47~48

Check to see if an 'ANGLE' mark is present.



When an 'ANGLE' mark is shown, press ANGLE Button.

- When the Button is pressed, numbers 1 → 2 → 3 → 4 → ... will be selected repeatedly and the angle will be changed.

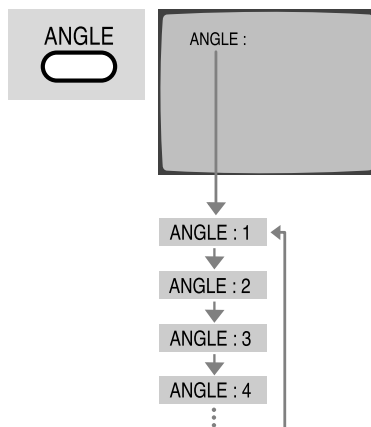

## Note

- This function will only work with discs on which angles have been encoded.

# How to Select Subtitle

If you want to see the subtitle while watching a movie, follow the steps below.

Press SUBTITLE ON/OFF button.

- The button turns the subtitles on and off. "SUBTITLE : ON" or "SUBTITLE:OFF" will appear on the display.



# How to use the On-Screen Menus

Various Menus are listed on a DVD, and menus differ from disc to disc.  
You can see the menu screen only when a menu is contained on the disc.



## To see MENU

- 1 Press MENU Button while in play mode.

MENU



&lt; MENU &gt;

1. AUDIO
2. SUBTITLE
3. ANGLE



**Note** •Menus will appear different from disc to disc.

## To make menu screen disappear.

MENU



Press MENU Button until menu screen disappears.

**Note** •Depending on the disc, the menu screen may not disappear when the menu button is pressed. You may have to press a different button.

## To move MENU

- 2 Press UP or DOWN Buttons.

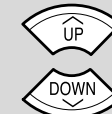

&lt; MENU &gt;

1. AUDIO
2. SUBTITLE
3. ANGLE

When menu appears as below  
•Press <L, R> button to move to the left or right.



&lt; AUDIO &gt;

1. ENGLISH 3. SPANISH
2. FRENCH 4. GERMAN

## To select MENU

- 3 Press ENTER Button after making your selection.



&lt; AUDIO &gt;

1. ENGLISH
2. FRENCH
3. SPANISH
4. GERMAN

43~44  
AUDIO selection

&lt; SUBTITLE &gt;

1. ENGLISH
2. FRENCH
3. SPANISH
4. GERMAN

45~46  
SUBTITLE selection

&lt; ANGLE &gt;

1. LEFT
2. RIGHT
3. FRONT

47~48  
ANGLE selection

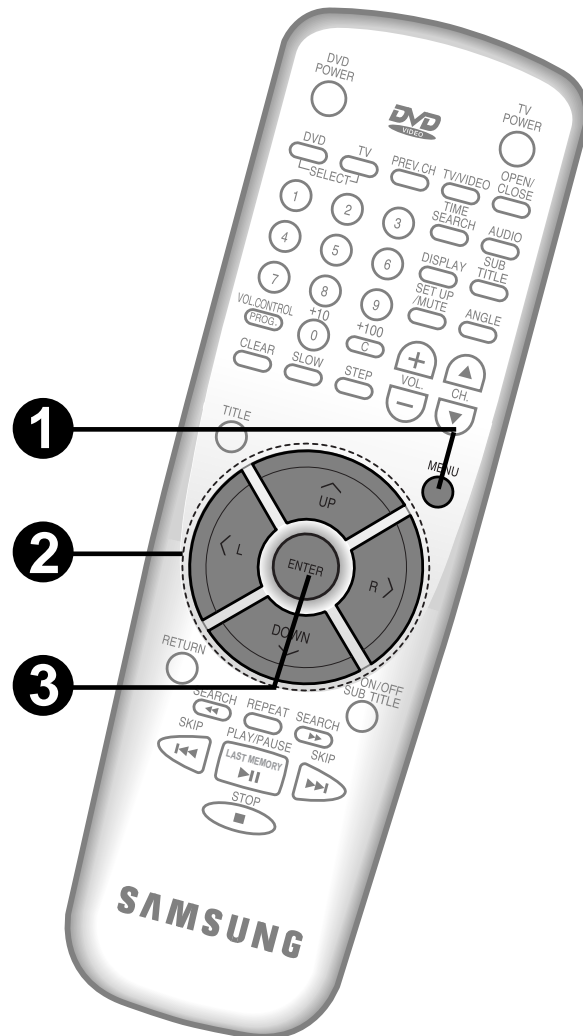

# How to select Audio Languages

You can select one of the audio soundtrack languages recorded on the disc by using the menu button.

Depending on the disc, the menus on the screen may look different.

Ex) When selecting FRENCH.

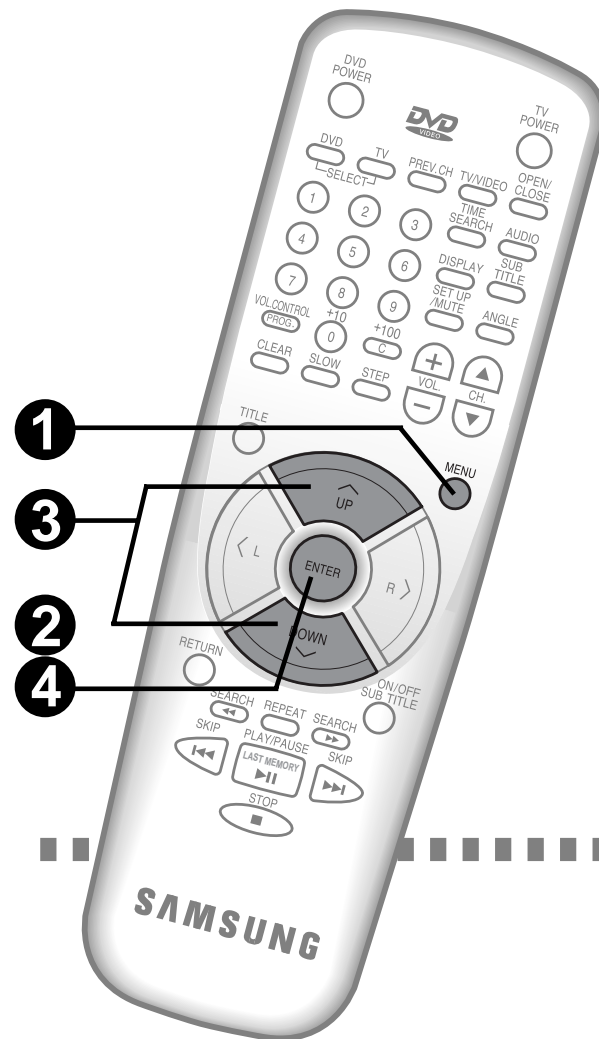

**1** Press MENU Button while in play mode.

MENU



< MENU >

1. AUDIO  
2. SUBTITLE  
3. ANGLE

**2** Press ENTER Button.

ENTER



< AUDIO >

1. ENGLISH  
2. FRENCH  
3. GERMAN  
4. DUTCH

**3** Press the UP or DOWN Button to move to "FRENCH"

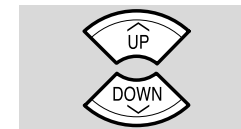

< AUDIO >

1. ENGLISH  
2. FRENCH  
3. GERMAN  
4. DUTCH

**4** Press the Enter Button

● Title plays back in FRENCH

ENTER



**Note** ● This function depends on which languages are encoded on the disc.



## If you want to return to the original menu

Press the RETURN Button.

● Depending on the disc, the RETURN Button may not work.

RETURN



< MENU >

1. AUDIO  
2. SUBTITLE  
3. ANGLE

**Note** ● Up to eight audio languages can be recorded on a DVD disc.



# How to select the desired Subtitle

You can select the desired subtitle language easily from the menu recorded on the disc.  
Depending on the disc, the menus on the screen may look different.

Ex) When selecting GERMAN.

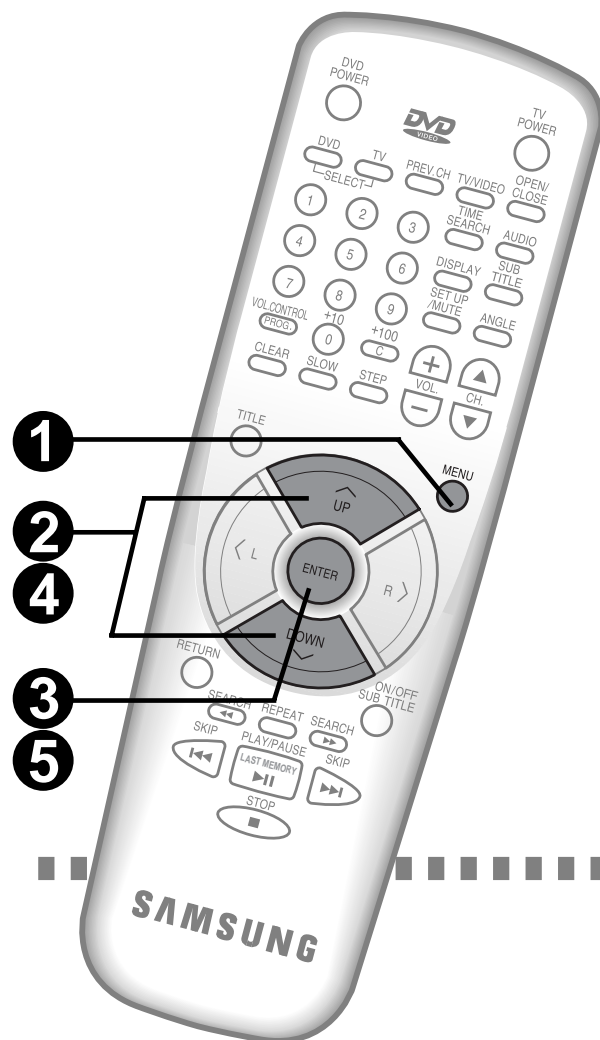

**1** Press MENU Button while in play mode.

MENU



< MENU >

1. AUDIO  
2. SUBTITLE  
3. ANGLE

**2** Press Up or DOWN Button to move to SUBTITLE.

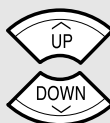

< MENU >

1. AUDIO  
2. SUBTITLE  
3. ANGLE

**3** Press the ENTER Button.



< SUBTITLE >

1. ENGLISH  
2. FRENCH  
3. SPANISH  
4. GERMAN

**4** Press the UP or DOWN Button to move to 'GERMAN'.

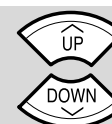

< MENU >

1. ENGLISH  
2. FRENCH  
3. SPANISH  
4. GERMAN

**5** Press the ENTER Button.

•The subtitle language changes to GERMAN.



## If you want to return to the original menu

Press the RETURN Button.

•Depending on the disc, the RETURN Button may not work.

RETURN



< MENU >

1. AUDIO  
2. SUBTITLE  
3. ANGLE



**Note** •The DVD subtitle can contain up to 32 languages.

# How to select the desired Screen Angle

You can see different angles recorded on the disc.  
Depending on the disc, the menus on the screen may look different.

Ex) How to select the 'Front angle'

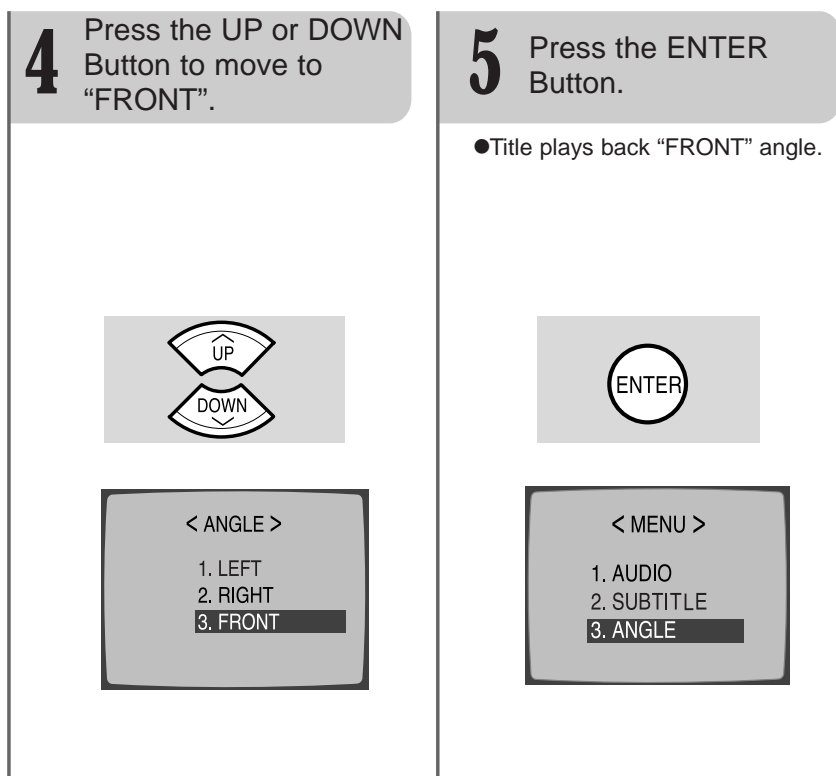
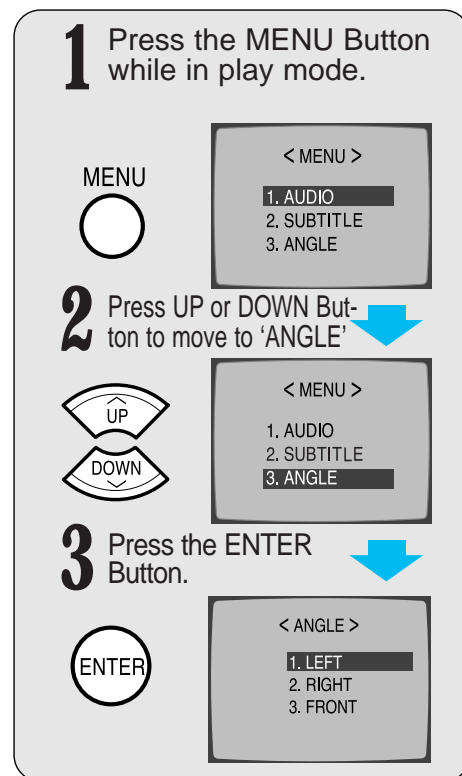
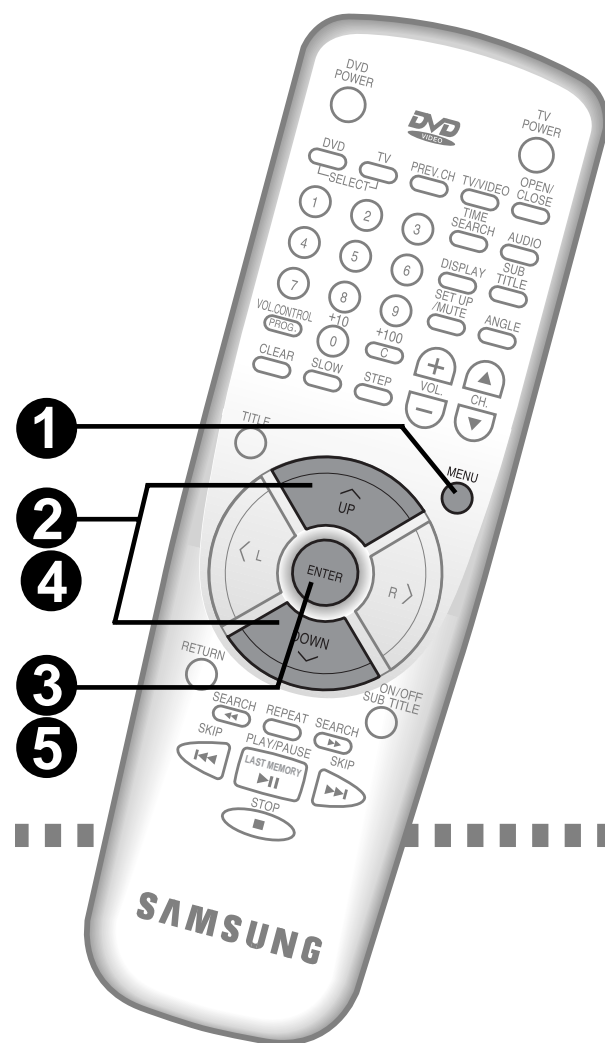

## If you want to return to the original menu

Press the RETURN Button.

●Depending on the disc, the RETURN Button may not work.

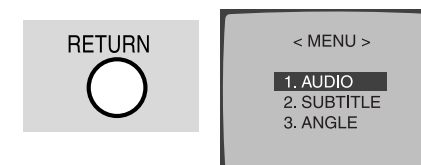

**Note** ●Angles must be recorded on the disc in order to use the screen angle function.

# How to change the SETUP MENU

The SETUP MENU allows you to preset menu value. Once this Operation is performed, the DVD will playback with the same menu values each time it is turned on.

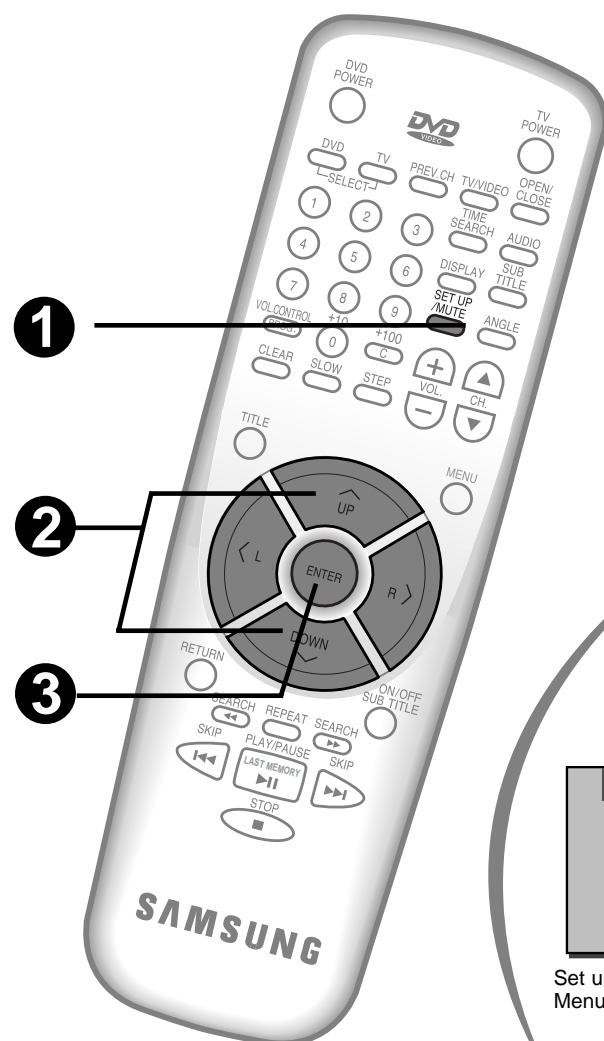

## How to view the SETUP MENU

- 1 Press SETUP/MUTE Button when in Stop mode.

SET UP  
/MUTE

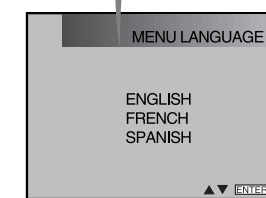
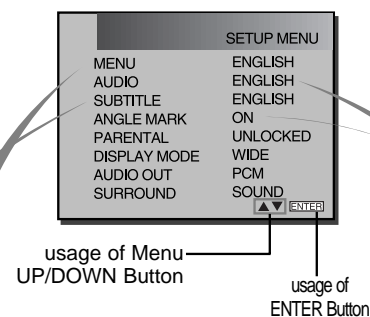

Set up of the Menu Language 51~52



Set up of the Audio Language 53~54

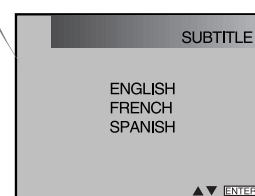

Set up of the Subtitle Language 55~56

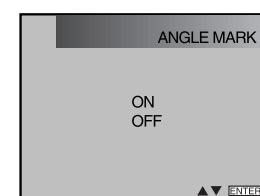

Set up of the Screen Angle Language 57~58

## To move within the SETUP MENU(up/down)

- 2 Press the UP or DOWN Button.

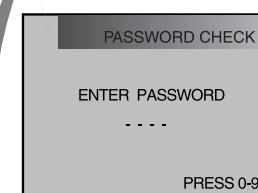
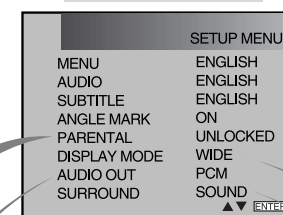
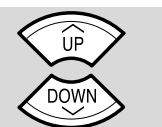

Set up of the Parental Level 59~60

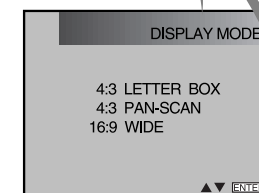

Set up of the Screen Ratios 61~62

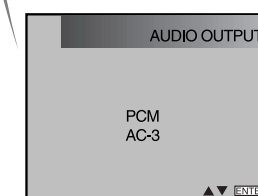

Set up of the Audio Output 63~64

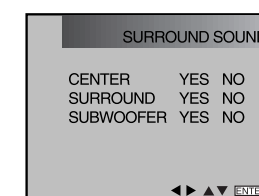

Set up of the surround Sound 65~66

## To make a selection

- 3 Press the ENTER Button.



To make the set up screen disappear after setting up



Press SET UP Button.



**Note**

- Depending on the disc, some SETUP MENU selections may not work.
- It is recommended that you perform all setups using the "SETUP MENU" before loading a disc.



# How to set up Screen Menu Language

You can select the menu language recorded on the disc.



Ex) For instance, setting up in SPANISH.

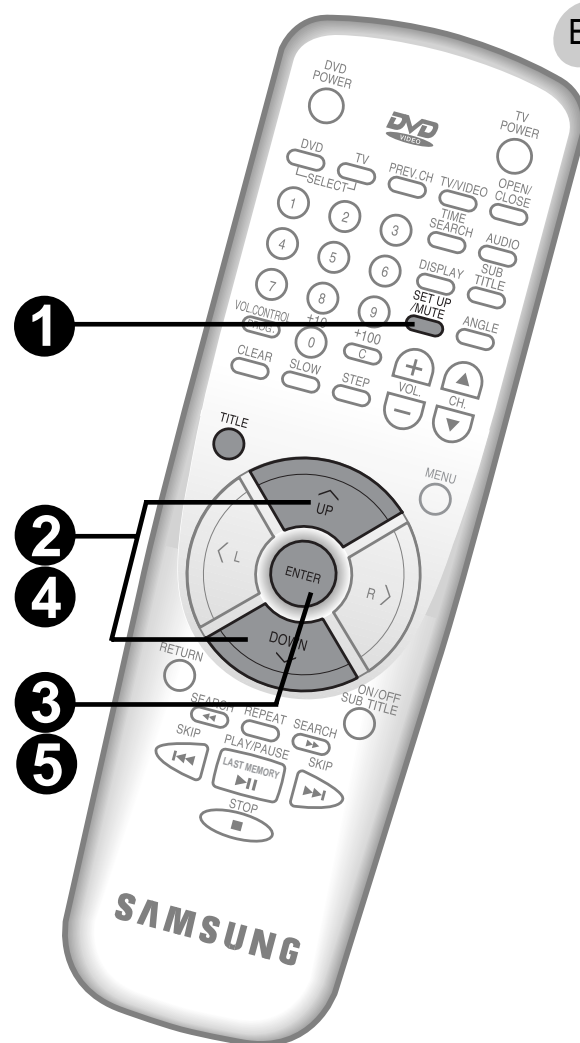

**1** Press SET UP/MUTE Button when in Stop mode.

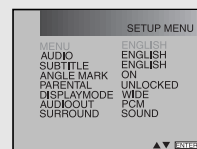

**2** Press UP or DOWN Button to move to Menu.

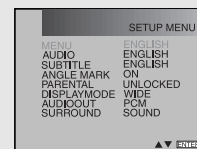
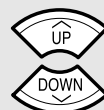

**3** Press the ENTER Button.

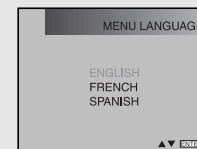

**4** Press UP or DOWN Button to select 'SPANISH'.

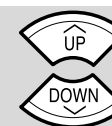

**5** Press the ENTER Button.

●SPANISH is selected and the screen returns to SETUP MENU.

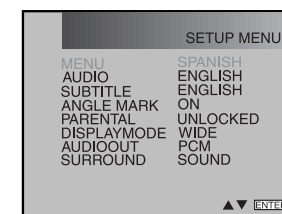

**Note** ●If the selected menu language is not recorded on the disc, the original pre-recorded language is selected.

**How to return to menu screen during set up.**

Press RETURN Button.

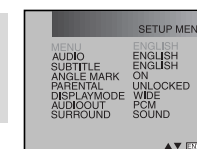

# How to set up the Audio Language

If you set up the audio language in advance, you can watch movies with pre-selected audio. You don't need to set up audio every time you watch a movie.



Ex) For instance, setting up in SPANISH.

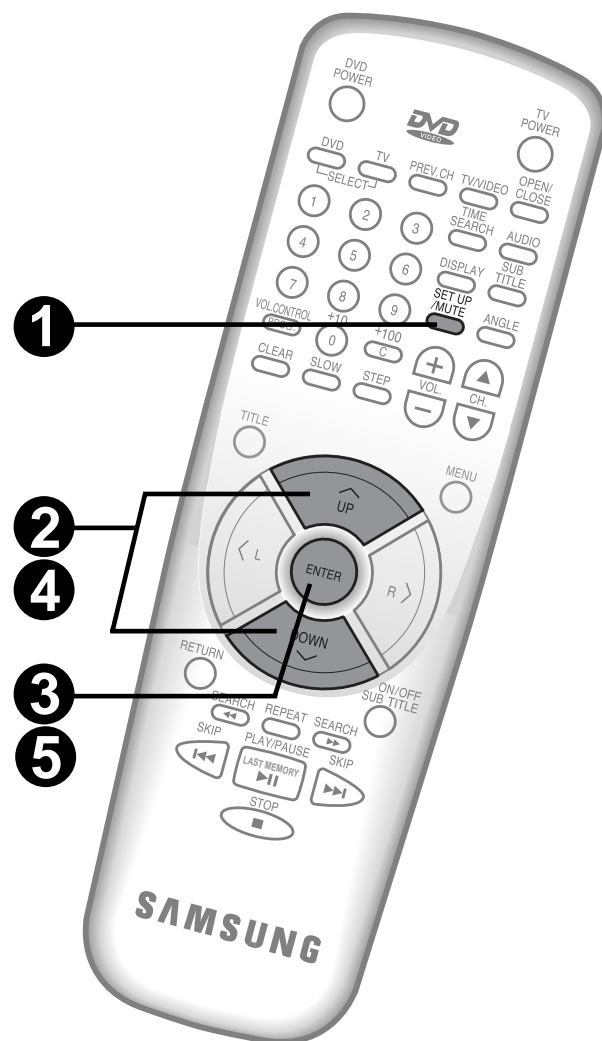

**1** Press the SET UP/MUTE Button when in Stop mode.

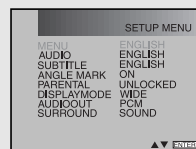

**2** Press the UP or DOWN Button to select Audio.

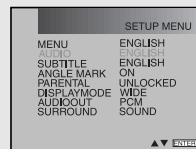
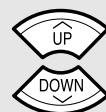

**3** Press the ENTER Button.



**4** Press the UP or DOWN Button to select 'SPANISH'.

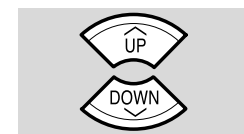

**5** Press the ENTER Button.

•SPANISH is selected and the screen returns to SETUP MENU.

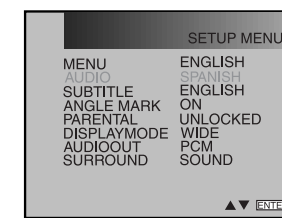

Press SETUP Button when done.



**Note** •If the selected audio language is not recorded on the disc, the original pre-recorded audio language is selected.

**How to return to menu screen during set up.**

Press RETURN Button.

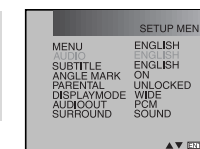

# How to set up the Subtitle Language

If you set up the subtitle language in advance, it will come up automatically every time you watch a movie.



Ex) For instance, setting up in SPANISH.

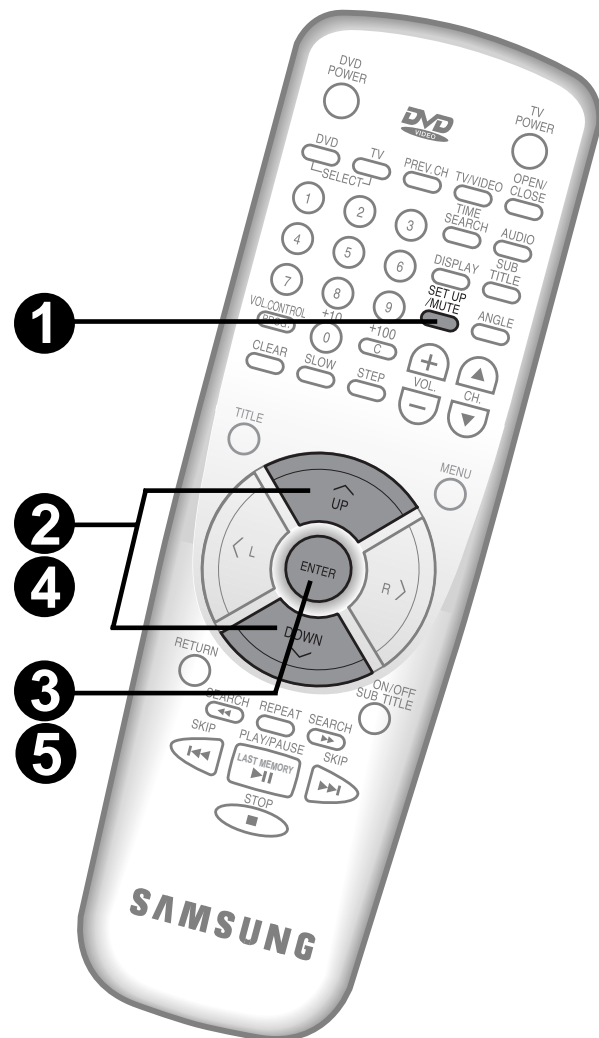

**1** Press SET UP/MUTE Button when in stop mode.

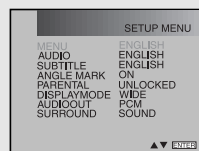

**2** Press the UP or DOWN Button to select 'subtitle'.

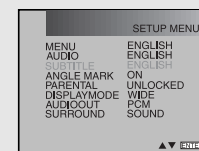
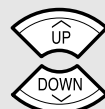

**3** Press the ENTER Button.

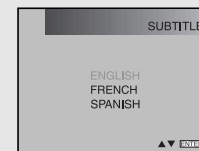

**4** Press the UP or DOWN Button to select 'SPANISH'.

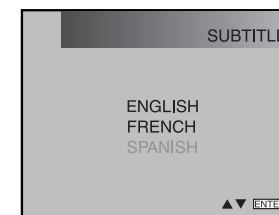
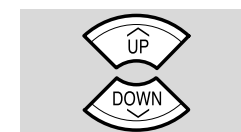

**5** Press the ENTER Button.

●SPANISH is selected and the screen returns to SETUP MENU.

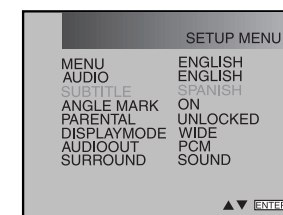

Press SETUP Button when done.



## Note

●If the selected subtitle is not recorded on the disc, the original pre-recorded Subtitle is selected.

## How to return to menu screen during set up.

Press RETURN Button.

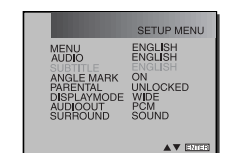

# How to set up the Screen Angle Mark

This function allows you to turn the screen angle mark on or off in order to view various screen angles.



## Ex) Setting up the ANGLE mark.

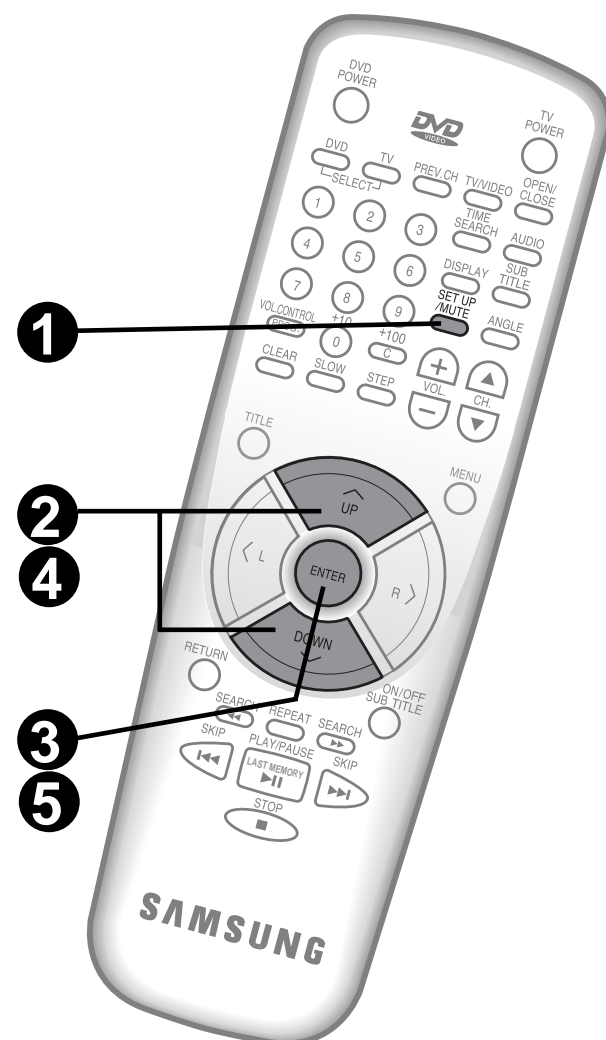

**1** Press the SET UP/MUTE Button when in stop mode.

SET UP  
/MUTE



**2** Press the UP or DOWN Button to move to angle mark. (Check to see if the ANGLE MARK is ON)

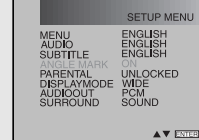
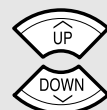

**3** If not, press the ENTER Button.

ENTER



**4** Press UP or DOWN Button to select 'ON'.

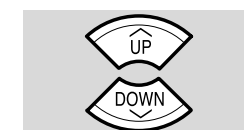

**5** Press the ENTER Button.

●'ON' is selected and the screen returns to SETUP MENU.

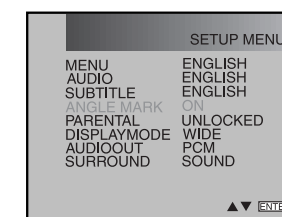

Press SETUP Button when done.

Once you set up as above,

- You can change the screen angle with the ANGLE or MENU Button when the disc is encoded with screen angles.

37,47~48



### Note

- If your DVD disc is encoded with screen angles, "⏏" will be displayed when the screen angle mark is set to 'ON'.

**How to return to menu screen during set up.**

Press the RETURN Button.

RETURN

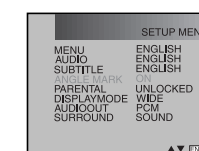





# How to set up the Screen Ratios

As DVD supplies the screen with a 16:9 ratio, you can decide which type of screen you want to watch.

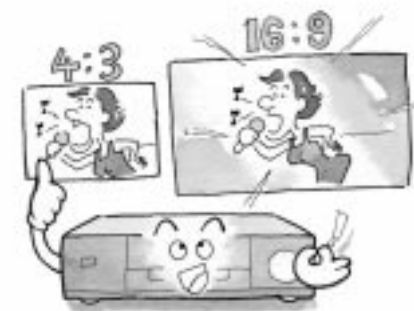

**Ex)** For instance, setting up '4:3 PAN-SCAN'

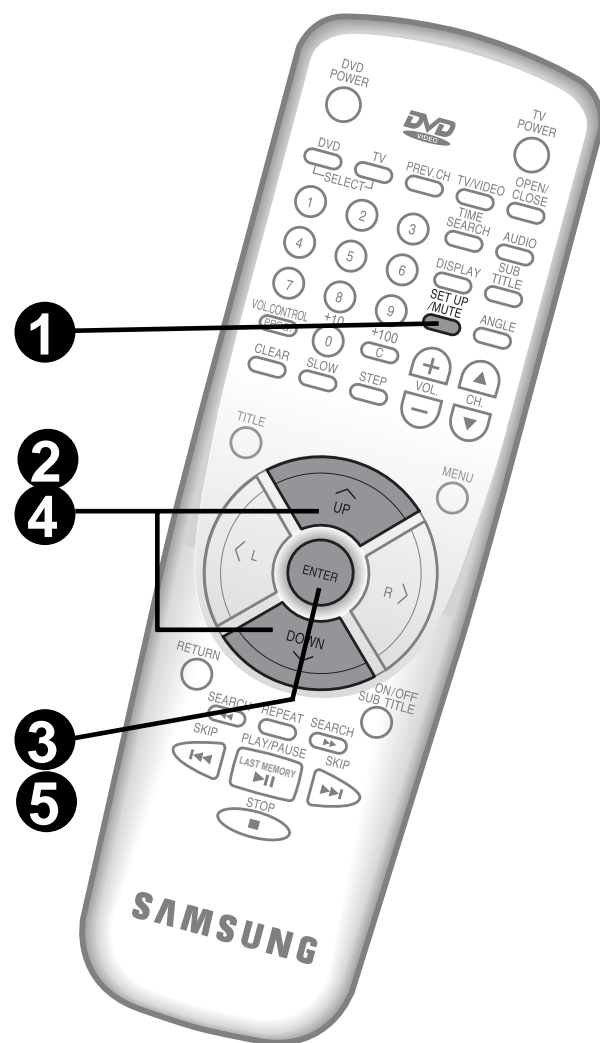

**1** Press the SET UP/MUTE Button while in the STOP mode.

SET UP  
/MUTE

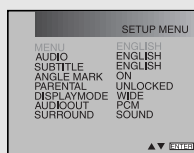

**2** Press the UP or DOWN Button to go to the DISPLAY mode.

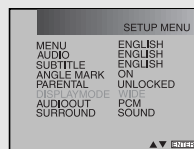
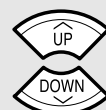

**3** Press the ENTER Button.

ENTER

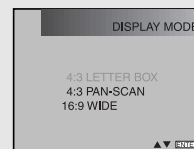

**4** Press the UP or DOWN Buttons to select '4:3 PAN-SCAN'.

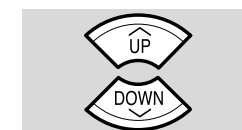

**5** Press the ENTER Button.

●4:3 PAN-SCAN is selected and screen returns to SETUP MENU.

ENTER

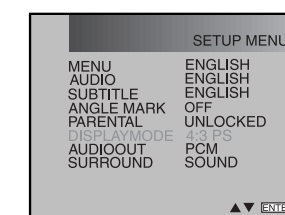

Press SETUP button when done.

## What are the 16:9 & 4:3 ratios?

●They're the screen ratios. The normal TV ratio is '4:3', '16:9' is the ratio of wide TV and is also the ratio used in movie theaters.

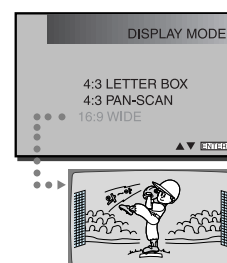

## When do you select '4:3 letter box'?

●Select when you want to see the total 16:9 ratio screen DVD supplies, even though you have a TV with a 4:3 ratio screen. The top and bottom of the picture will be black.

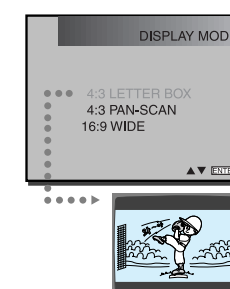

## When do you select '4:3 pan-scan'?

●You have a TV with 4:3 screen and you want to see the central portion of the 16:9 screen (sides of movie picture will be cut off.)

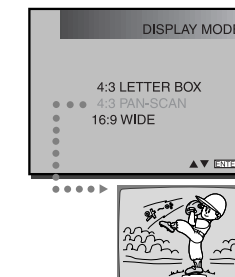

**Note** ●The Screen Ratio settings depend on What is encoded on the disc.



# How to Set Up Audio Output

You can configure the digital audio output jack to deliver Dolby Digital (AC-3) Data to any AC-3 decoding amplifier by using the setup menu.  
If you are not using an AC-3 decoding amplifier, you should configure the audio output as PCM in setup menu.

Ex) For instance, setting up AUDIO OUTPUT as AC-3

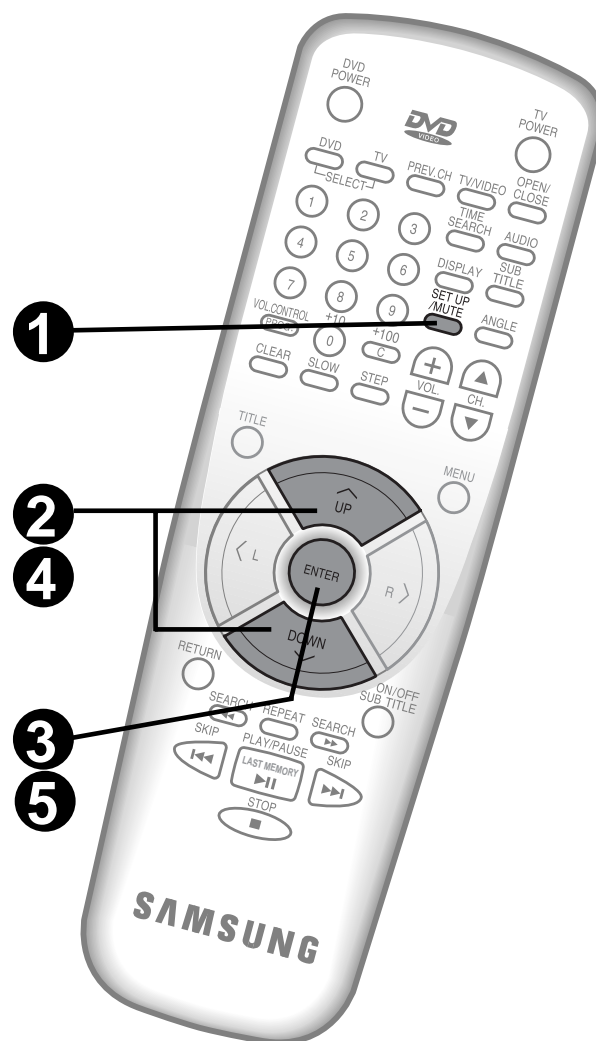

**1** Press the SET UP/MUTE Button when in Stop mode.

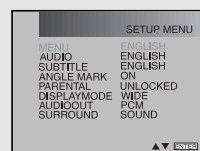

**2** Press the UP or DOWN Button to select AUDIO OUT.

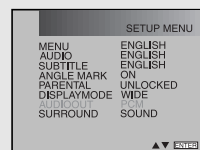
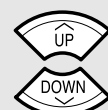

**3** Press the ENTER Button.

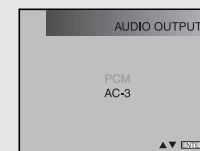

**4** Press the UP or DOWN Button to select 'AC-3'.

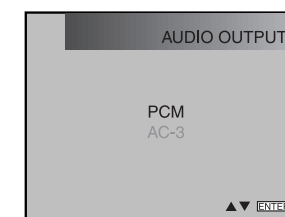
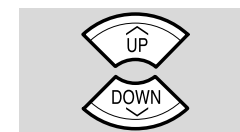

**5** Press the ENTER Button.

● 'AC-3' is selected and the screen returns to SETUP MENU.

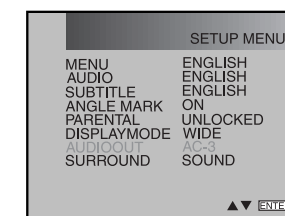

**Note**

- If you've configured the audio output as PCM, the audio output is automatically changed to AC-3 when you set either CENTER or SURROUND in SURROUND SOUND as YES.
- If you've configured the audio output as PCM, both CENTER and SURROUND in surround sound are automatically changed to NO.

**How to return to menu screen during set up.**

Press the RETURN Button.

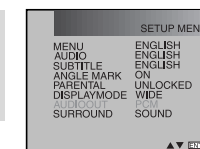

# How to Set Up Surround Sound

You can configure analog audio output as surround sound or stereo sound using the setup menu.  
If you've selected surround sound output, you should specify the status of your speaker system to hear surround sound suitable for your speaker system.

Ex) For instance, setting up SURROUND SOUND audio output for a surround speaker system which has a center speaker.

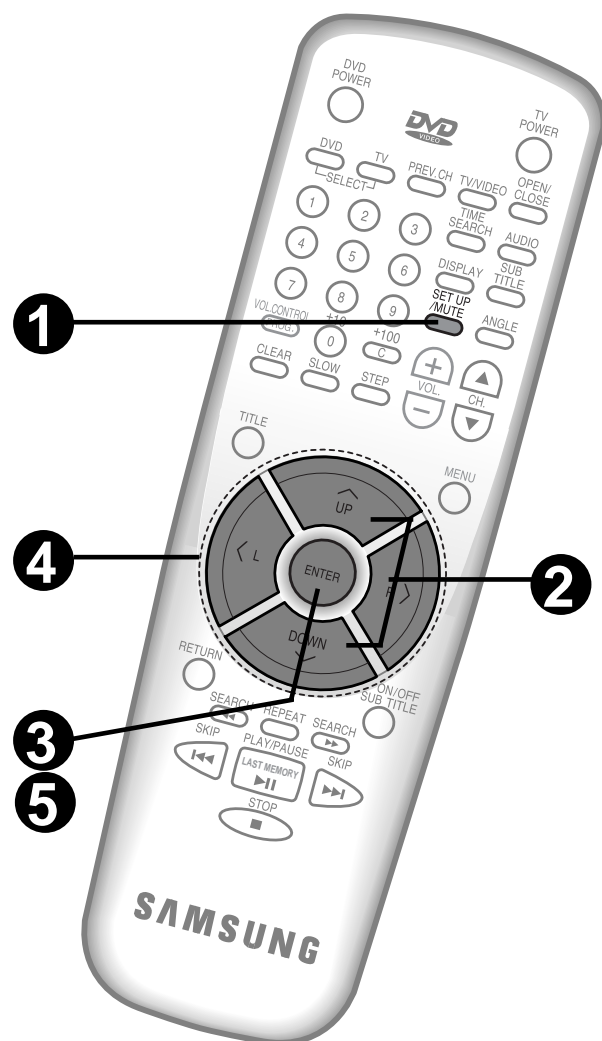

**1** Press the SET UP/MUTE Button when in Stop mode.

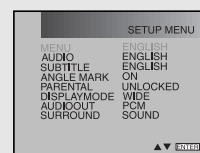

**2** Press the UP or DOWN Button to select SURROUND SOUND.

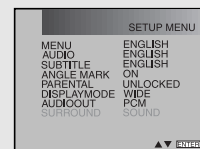

**3** Press the ENTER Button.

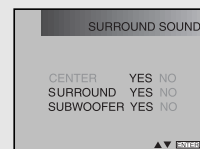

**4** Press the UP, DOWN, LEFT or RIGHT Buttons to select 'CENTER YES'.

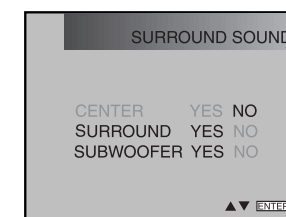
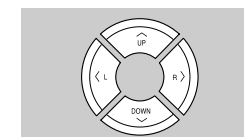

**5** Press the ENTER Button.

● 'CENTER YES' is selected and the screen returns to SETUP MENU.

ENTER



## AC-3 Output Level Control

When AC-3, 5.1 channel encoded discs are played, the sound volume of the analog output for each channel can be changed.

1. Press the VOL.CONTROL button during the PLAY mode.

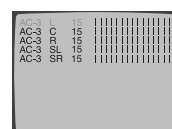

2. Press the UP or DOWN button to move to the channel whose volume you wish to change.

You can change the level by using the LEFT or RIGHT button.

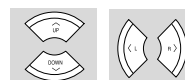

**Note**

- If you've configured the digital audio out as PCM, the selection of 'SURROUND SOUND' will not work.
- If you have only front left and right speakers, you should set center, surround, subwoofer to 'NO'.
- If you have front left, front right and center speakers only, you should set the center to 'YES'.
- If you have only front left, front right, center and surround speakers, you should set the center and surround to 'YES'.
- If you have all speakers needed for AC-3, you should set the center, surround and subwoofer to 'YES'.
- When you have configured the audio output as AC-3 and have set the CENTER of the surround sound to YES, you must have a center speaker connected to hear the dialogue.

## How to return to menu screen during set up.

Press RETURN Button.

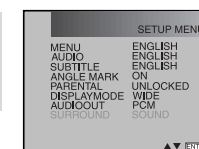

VIDEO  
CD

# VIDEO-CD Playback

Enjoy live sound and video with VIDEO-CD.

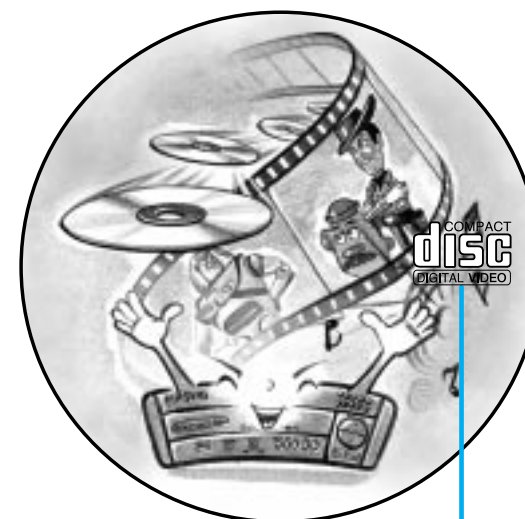

COMPACT  
disc  
DIGITAL VIDEO

VIDEO-CD LOGO

## VIDEO-CD Features

- The Video-CD contains up to 74 minutes of both music and video.
- It has the same picture quality as VHS tape and the same audio quality as CD because it is encoded with the MPEG 1 system.



# How to play a VIDEO-CD

Press your TV and Audio system Power buttons ON.



## TV/Audio Selection

To select the video mode, press the TV/Video button on the TV.

- Video mode may be marked as input.

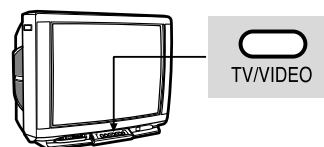

Select 'AUX' or 'CD' in function selection part of your Audio amplifier

- Each audio amplifier is different. Please refer to your audio amplifier owner's manual.

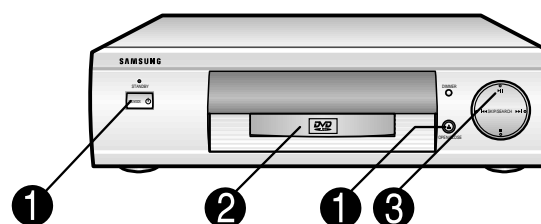
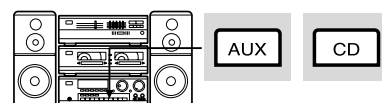

## How to playback

**1** Press the OPEN/CLOSE Button after pressing POWER Button.

- Power turns ON, the tray opens and the STANDBY indicator light goes out.

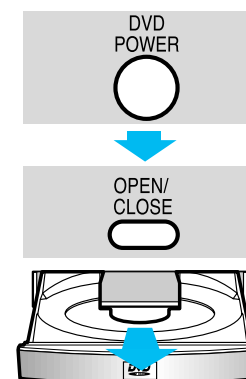

**2** Load the VIDEO-CD.

- Load the disc label-side up.



**3** Press PLAY/PAUSE Button.

- The tray closes and playback begins.



## Do you want to stop playback?

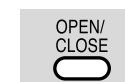

Press the STOP Button or OPEN/CLOSE Button.

- If you press OPEN/CLOSE button, the tray opens after playback stops.



## Do you want to stop playback for a moment ?



Press PLAY/PAUSE Button.

- Screen stops, no sound.



To play again

- Press PLAY/PAUSE Button again.



- Note**
- When play is stopped, the unit records the point where STOP was pressed (RESUME function). Press PLAY again, and play will resume from this point. When the tray is opened or STOP is pressed again, the RESUME function will be cleared.
  - When in VIDEO-CD 2.0 mode (menu on mode), PROGRAM, REPEAT, TIME SEARCH, DISPLAY and RESUME function are impossible.
  - If the unit is left in the STOP mode for more than one minute without any user interaction, a screensaver will be activated, and the TV screen will fade in and fade out repeatedly. Press PLAY button to resume normal play.
  - If the unit is left 30 minutes in pause mode during play or menu, it will shut off.

# To use the Menu Function

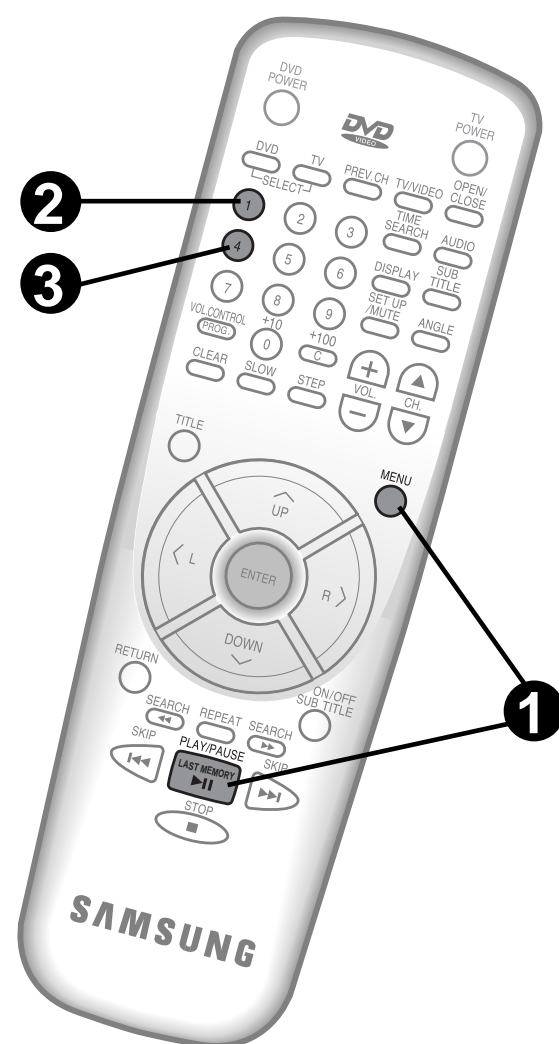

## 1 Press the MENU or PLAY/PAUSE Buttons.

- The Menu is only displayed on disc version 2.0. It is not displayed on version 1.1.

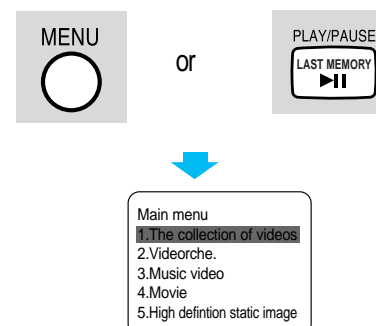

## 2 Select a number from the menu and press it.

- You can also select the desired number by pressing the UP or DOWN button.  
EX)When selecting No. 1 ; The collection of videos.

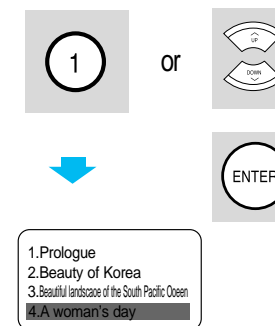

## 3 Select a number from the menu and press it.

- You can also select the desired number by pressing the UP or DOWN button.  
EX)When selecting No. 4 ; a woman's day.

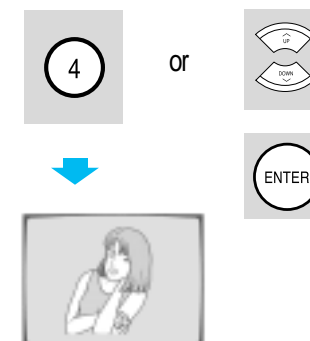

## To return to the previous menu

Press the RETURN button

- When a wrong menu is selected or other menu is about to be selected, press the RETURN button.
- Press the Button the next menu will be displayed.
- Press the button the previous menu will be displayed.



### Note

- When in VIDEO-CD 2.0 mode (menu on mode), PROGRAM, REPEAT, TIME SEARCH, DISPLAY and RESUME function are impossible.
- In disc version 2.0, the MENU button works as conversion switch between menu on mode and menu off mode.



# To use the Disc View Function

Desired music or video display can be accessed directly without using the menu function.  
TRACK VIEW is used for showing the beginning view of each track and the number of view is equal to the number of track.

INDEX VIEW is used for showing the equally divided 9 views of the current playing track.

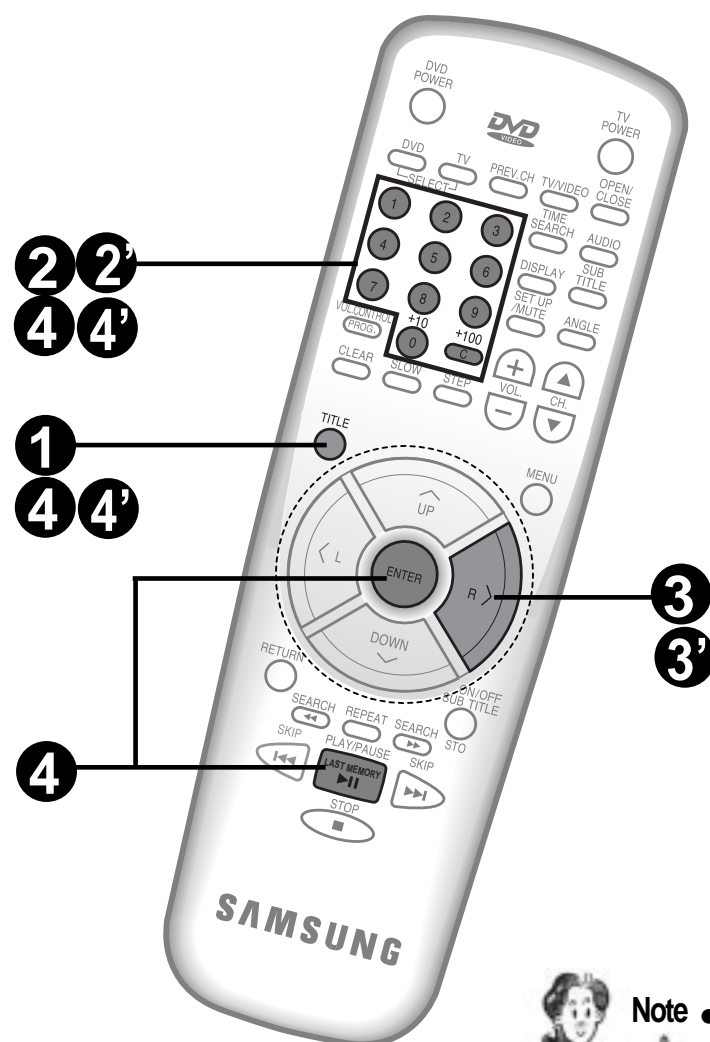

**1** Press the TITLE Button.

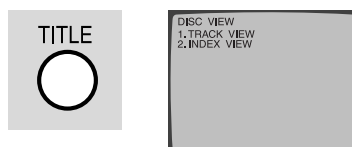

**2** Press Button NUMBER 1 to select TRACK VIEW.

- If disc has only 1 track, the number of presented video will be 1 also.  
EX) The disc has 11 tracks.

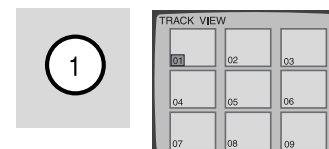

**3** Move the highlight to the number of the desired view by pressing UP/DOWN, LEFT/RIGHT Buttons.

- You can see the remaining 2 views by pressing SKIP Button.  
EX) To select the last view.

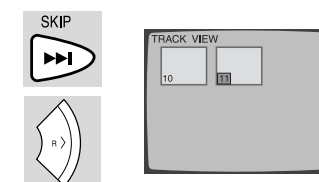

**4** Press the ENTER, PLAY or TITLE Button.

- You can also select and playback the desired view directly by pressing the number button.



**2'** Press Button Number 2 to select INDEX VIEW.

- Nine views are presented with sound.

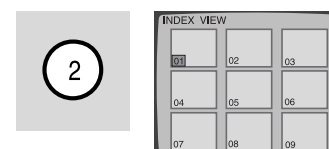

**3'** Move the highlight to the number of the desired view by pressing UP/DOWN, LEFT/RIGHT Buttons.

Ex) To select the third view.

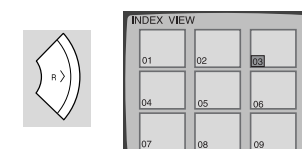

**4'** Press the ENTER, PLAY or TITLE Button.

- You can also select and playback the desired view directly by pressing the number button.



**Note** •This function is possible in VIDEO-CD 1.1 and VIDEO-CD 2.0 menu off mode.





# CD Playback



## CD Features

CD is the most popular of all discs, providing clear sound and easy maintenance.

- There are two types of CDs, 5 inch (up to 74 minutes of music program) and 3 1/2 inch (up to 20 minutes).
- CD maintains the same sound quality over time.
- ※ CD-R (Compact Disc Recordable) cannot be played in this unit.



# How to play a CD

Press POWER Button of your Audio amplifier.



Select 'AUX' or 'CD' in the function selection part of your Audio amplifier

- Each audio amplifier is different. Please refer to your audio amplifier owner's manual.

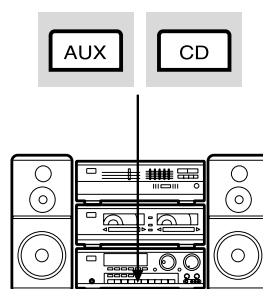

**1** Press OPEN/CLOSE Button after pressing POWER Button.

- Power turns on, the tray opens and the STANDBY indicator light goes out.

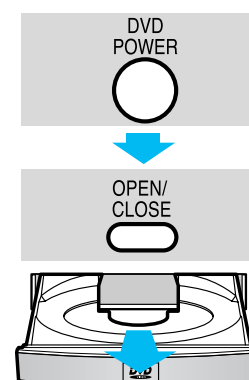

**2** Load the CD.

- Load the CD disc label-side up.



**3** Press PLAY/PAUSE Button.

- The tray closes and playback begins.

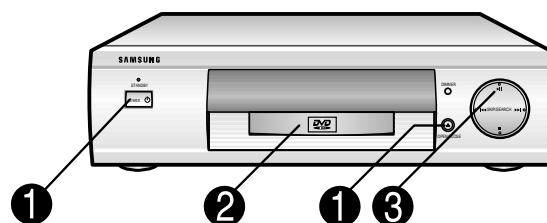
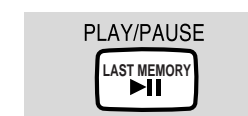

**Do you want to stop playback ?**



Press the STOP Button or OPEN/CLOSE Button.

- If you press the OPEN/CLOSE Button, the tray opens after playback stops



**Do you want to stop playback for a moment ?**



Press PLAY/PAUSE Button.



- To play again
- Press PLAY/PAUSE Button again.



- Note**
- When play is stopped, the unit records the point where STOP was pressed (RESUME function). Press PLAY again, and play will resume from this point. When the tray is opened or STOP is pressed again, the RESUME function will be cleared.
  - If the unit is left 30 minutes in pause mode during play or menu, it will shut off.

# BASIC FUNCTIONS

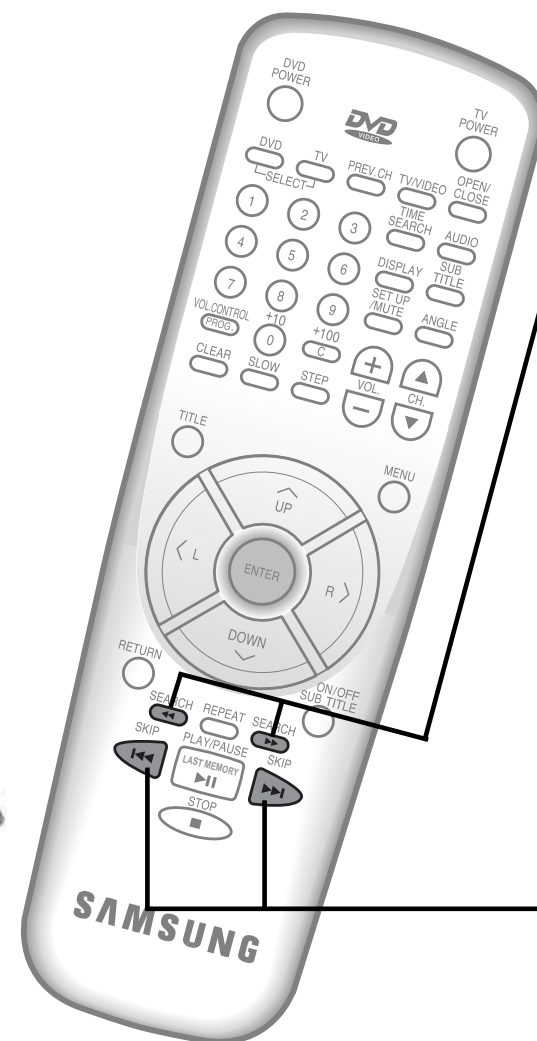

## Search and Skip Functions

During playback, you can search quickly through a track or title or use the skip feature to jump to the next selection.

### To search through a track or title

Press SEARCH Button.

- If you press ►► Button once playback will advance quickly(X2 on DVD, X4 on CD and VCD). Press two (X8 on DVD, X8 on CD and VCD) or three(X16 on DVD) times and playback will advance even quicker and scene by scene. Press the ◀◀ Button to operate the search function in the reverse direction. When playing a DVD, playback will reverse to the beginning of the current chapter and normal playback will resume.



### To return to normal speed playback

- Press PLAY/PAUSE Button again.



### If you want to skip tracks

Press SKIP Button.

- When playing a DVD, if you press ►► Button, it moves to next chapter. if you press ◀◀ Button, it moves to the beginning of chapter. One more press makes it move to previous chapter.
- When playing a VIDEO-CD or CD, if you press ►► Button, it moves to next track and if you press ◀◀ Button, it moves to the beginning of the track. One more press makes it move to previous track.

( Only when the length of the track exceeds 15 minutes )

- When playing a VIDEO-CD, if you press ►► Button, it move to the forward 5 minutes passed point. and if you press ◀◀ Button. it moves to the backward 5 minutes passed point.

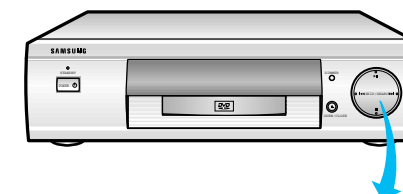

### When using the Main Button on the DVD

- It depends on how long you press SKIP/SEARCH Button.



If you press (Long touch) and hold for more than 3 seconds, Search feature operates.



If you press (Short touch) for less than 3 seconds the Skip feature will operate.



- Note**
- While in high-speed playback or search, no sound will be heard.
  - Depending on the disc, SKIP button may not work.

# To Perform Time or Chapter Search

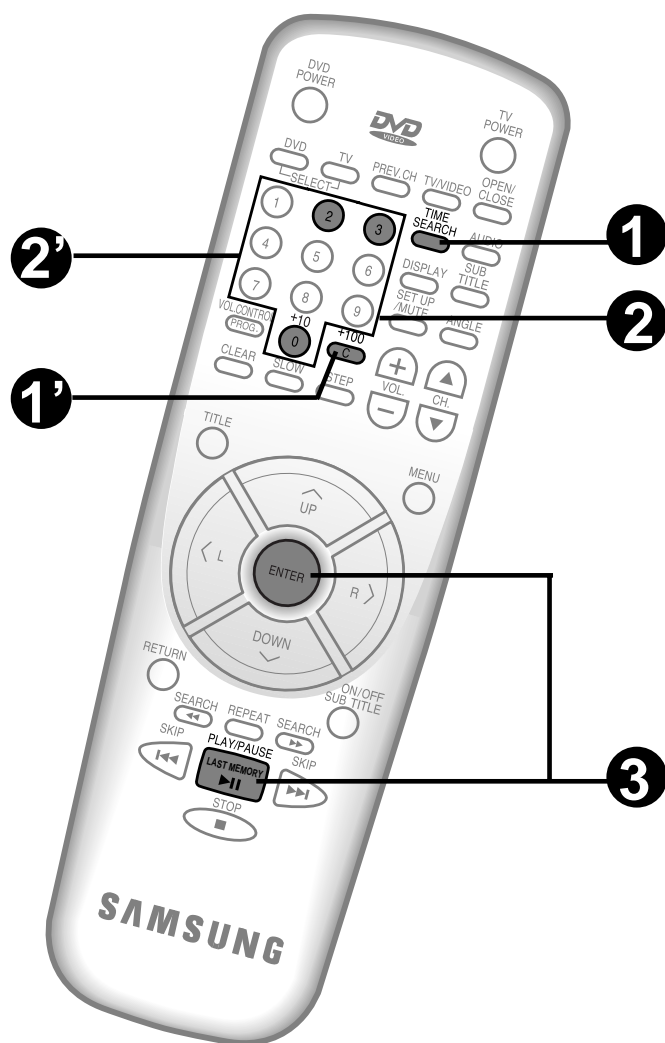

To playback from a preset time on the disc

**1** Press TIME SEARCH Button.

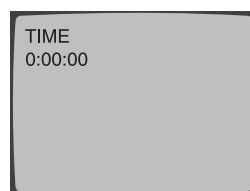
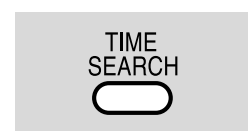

To search desired title or chapter by pressing title or chapter number

**1'** Press the C Button for chapter number selection.

- This function works with DVDs only.
- "TITLE" or "CHAPTER" will flash on the front panel display.

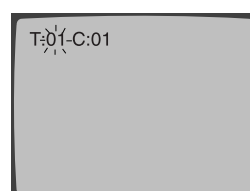
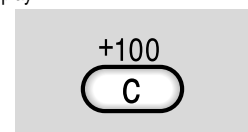

**Ex)** To search for the 2 minute 30 second point of the track.

**2** Set the time you want.

- set 2, 3, 0 for two & half minutes

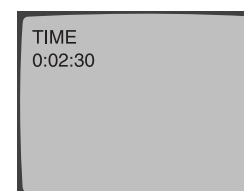
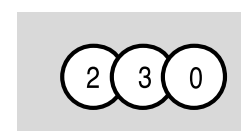

**Ex)** To move to chapter 3.

**2'** Press the RIGHT or LEFT Button for title or chapter selection and press the desired title or chapter number.

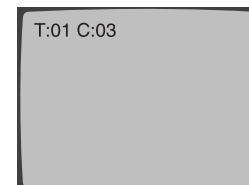

**3** Press PLAY/PAUSE or ENTER Button.

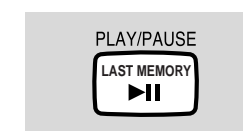

**If you enter a wrong time;**

press CLEAR Button.

- Then, the time will be erased and the display shows 00:00. You can then enter the number again.



**Note** • You can only set the time search for a track currently playing. If you set a time search that is longer than the track length, the disc will go the next track.

- When playing the VCDs (Ver 1.1, Ver 2.0 menu off mode) and CDs, you can select and playback the desired track directly by pressing the number button.
- When in VIDEO-CD 2.0 mode (menu on mode), PROGRAM, REPEAT, TIME SEARCH, DISPLAY and RESUME function are impossible.
- Depending on the DVD, TIME SEARCH button may not work.

**What is a chapter ?**

This is a detailed section of a movie. A title is usually comprised of many chapters. Depending on the disc, a chapter may be referred to under a different name.

**When the number of chapters is more than 10**

- press '0 / +10' button and then press the second number within 3 seconds.
- If you want chapter no. 27, press '0 / +10' two times and then press '7'.

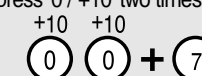

**If you enter a wrong number,**

- press the correct number again.

# Slow Motion and Step Playback

Refer to the following text to enjoy the screen pictures in slow or step motion. Slow motion & Step playback only operate in the forward direction.

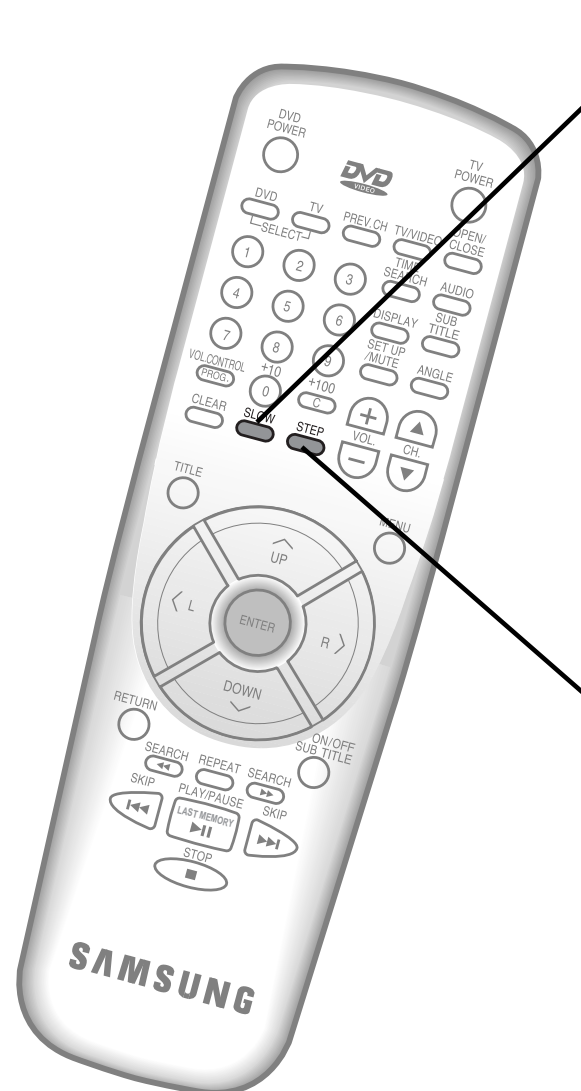

**For slow motion playback**

Press SLOW Button.

- By pressing the slow Button you can select slow motion playback for 1/2, 1/4 or 1/8 of normal speed.
- No sound is heard during slow mode.

**SLOW**

**If you want to return to normal speed**

press the PLAY/PAUSE Button.

**PLAY/PAUSE**

**For step motion playback**

Press the STEP Button.

- Each time the button is pressed, a new frame will appear.
- No sound is heard during step mode.

**STEP**

**If you want to return to normal mode**

press the PLAY/PAUSE Button.

**PLAY/PAUSE**

**Note** ● SLOW and STEP buttons do not work with CDs

# Display Function

If you want to know the total track and time, remain track and time on a VCD or CD and title, chapter, audio and subtitle information on a DVD, press the DISPLAY Button.



**When playing CDs/VCDs**

<p><b>1</b> Press the DISPLAY Button.</p> <ul style="list-style-type: none"> <li>●Current track time and total track time will be displayed.</li> </ul> <p><b>DISPLAY</b></p> <p>01 0:00:40 15 0:43:10 TOTAL</p>	<p><b>2</b> Press the DISPLAY Button again.</p> <ul style="list-style-type: none"> <li>●Current track time and remain track time will be displayed.</li> </ul> <p><b>DISPLAY</b></p> <p>01 0:00:14 15 0:42:56 REMAIN</p>	<p><b>3</b> Press the DISPLAY Button to make the screen disappear.</p> <p><b>DISPLAY</b></p>
--	--	--

**When playing a DVD**

<p><b>1</b> Press the DISPLAY Button.</p> <ul style="list-style-type: none"> <li>●Current mode will appear.</li> </ul> <p><b>DISPLAY</b></p> <p>AUDIO : ENGLISH SUBTITLE : ENGLISH SUBTITLE MODE : ON</p>	<p><b>2</b> Press the DISPLAY Button again.</p> <ul style="list-style-type: none"> <li>●Current title and chapter numbers will appear.</li> </ul> <p><b>DISPLAY</b></p> <p>This shows the title and chapter numbers. counter T:2 C:2 00:40:40</p>	<p><b>3</b> To make the screen disappear.</p> <ul style="list-style-type: none"> <li>●Press DISPLAY Button.</li> </ul> <p><b>DISPLAY</b></p>
---	---	--

**Note** ●When in VIDEO-CD 2.0 mode (menu on mode), PROGRAM, REPEAT, TIME SEARCH, DISPLAY and RESUME function are impossible.



# Repeat Playback

Repeat playback allows you to repeat a track, title, or the entire disc.

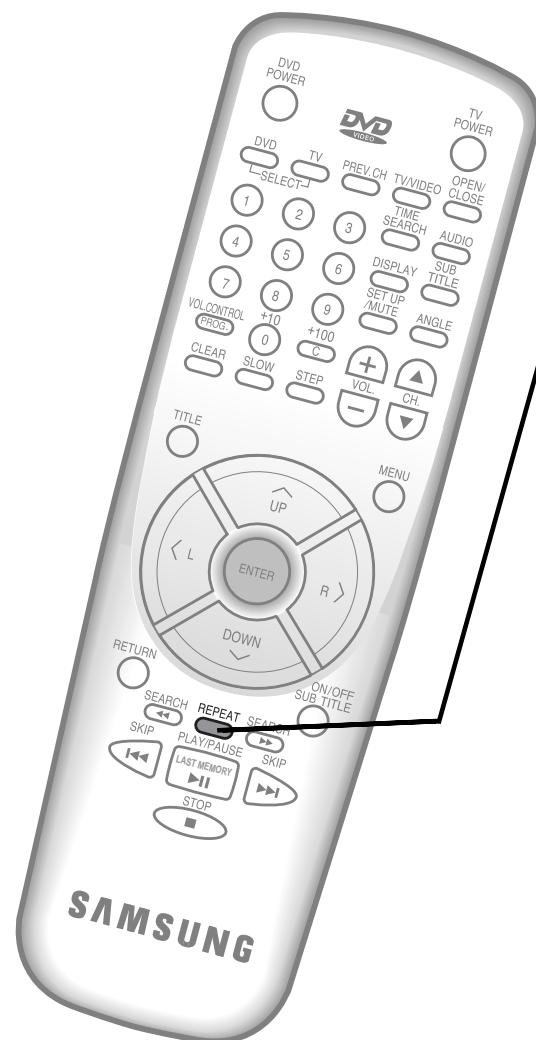

## When playing CDs/VCDs

To repeatedly play a music track

Press REPEAT Button to display 'TRACK REPEAT'.

- When you press the REPEAT Button, TRACK REPEAT→ALL REPEAT→REPEAT OFF appear in order.

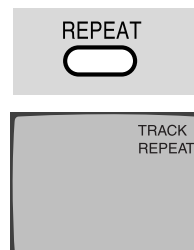

To repeat the entire disc

Press REPEAT Button to display 'ALL REPEAT'.

- When you press the REPEAT Button, TRACK REPEAT→ALL REPEAT→REPEAT OFF appear in order.

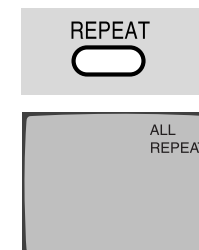

To clear repeat function

Press the REPEAT Button to display 'REPEAT OFF'

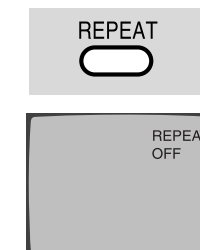

## When playing a DVDs

To repeatedly play the chapter

Press REPEAT Button to display 'CHAPTER REPEAT'.

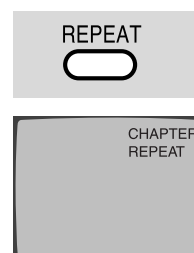

To repeat the title

Press REPEAT Button to display 'TITLE REPEAT'.

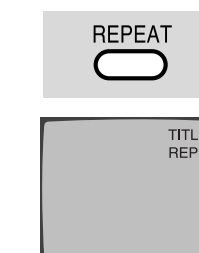

To clear repeat function

Press the REPEAT Button to display 'REPEAT OFF'

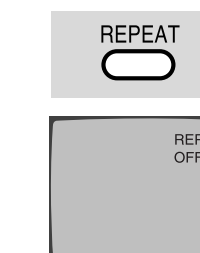

- Note**
- DVD repeats playback by chapter or title, CD and Video-CD repeat playback by disc or track.
  - Depending on the disc, the Repeat function may not work.
  - When in VIDEO-CD 2.0 mode (menu on mode), PROGRAM, REPEAT, TIME SEARCH, DISPLAY and RESUME function are impossible.



# To Program in desired order

Ex) to program tracks 5,7 and 11 in order

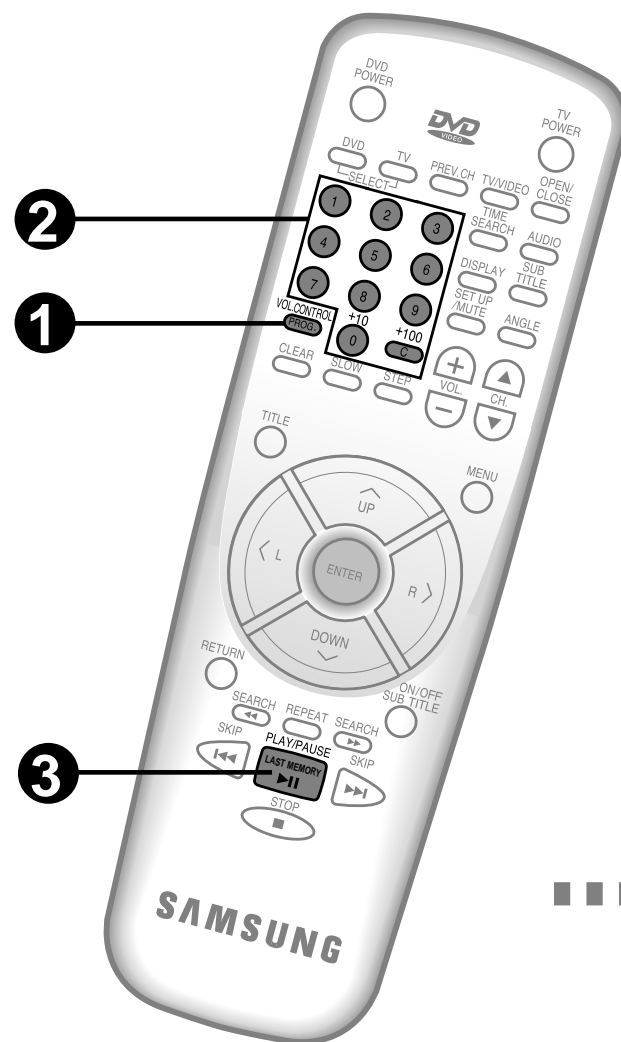

**1** Press the PROGRAM Button while in stop mode.

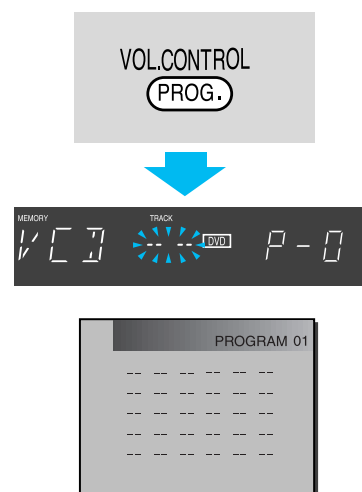

**2** Select the desired track.

- Press buttons 5→7→0→1 in order.
- Whenever you press buttons, the program numbers will be selected automatically.

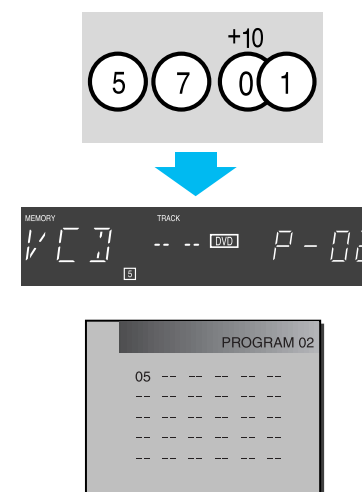

**3** Press PLAY/PAUSE Button.

- The disc will be played back in programmed order.



**Cancel** If you want to cancel the program function  
● press the STOP Button twice.

**Note** :DVDs can be programmed by title.

## When you make a wrong selection during programming

press the CLEAR Button.

- Whenever you press the Button, the programs will be erased one by one.



## If you want to correct a track

**1** Press SUBTITLE ON/OFF Button.

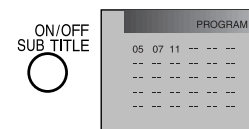

**2** Press the Button to reach the desired number to be erased. The number will blink.

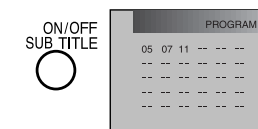

**3** Enter the number of the desired track to replace the track you want to erase.

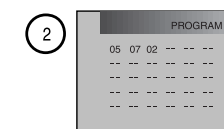

**Note** ● When in VIDEO-CD 2.0 mode (menu on mode), PROGRAM, REPEAT, TIME SEARCH, DISPLAY and RESUME function are impossible.

# To Playback from the last stop point



Press PLAY/PAUSE button

- Playback will begin from the point where you last stopped the disc.

PLAY/PAUSE  
LAST MEMORY  
▶▶



- Note**
- When the tray is opened, or the STOP button is pressed in STOP mode, the RESUME function will be cleared.
  - If the power is turned off and the tray is not opened, the last memory function will still work when power is turned ON again.
  - When in VIDEO-CD 2.0 mode (menu on mode), PROGRAM, REPEAT, TIME SEARCH, DISPLAY and RESUME function are impossible.

# Before Making a Repair Inquiry

**Is the unit not operating correctly?**

Please check carefully once again.

A lot of problems can be solved if you check them in accordance with the Owner's Manual.









Before repair inquiry

First read the  
Owner's Manual.

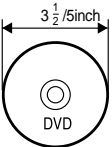
If the unit still does not operate  
properly, contact a Samsung Authorized  
Service Center.

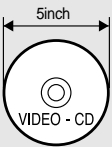
# Disc type and characteristics

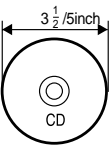
- This player can play the following Discs.

Disc Type	Mark & Play Time	Characteristics
DVD 	Audio/Video 135 minutes 	<ul style="list-style-type: none"> <li>● Excellent, dynamic audio in AC-3, 5.1 Channel theater.</li> <li>● Up to 8 audio languages can be contained on a disc.</li> </ul>
VIDEO-CD 	Audio/Video 74 minutes 	<ul style="list-style-type: none"> <li>● Max. 74 minutes play with 5inch CD</li> <li>● Video with CD sound, VHS quality &amp; MPEG1 compression technology</li> </ul>
CD 	5inch Audio 74 minutes 3 1/2 inch Audio 20 minutes 	<ul style="list-style-type: none"> <li>● An LP is recorded as an analog signal with more distortion. CD is recorded as a Digital Signal with better audio quality, less distortion and less deterioration of audio quality over time.</li> </ul>

## DISC MARKINGS

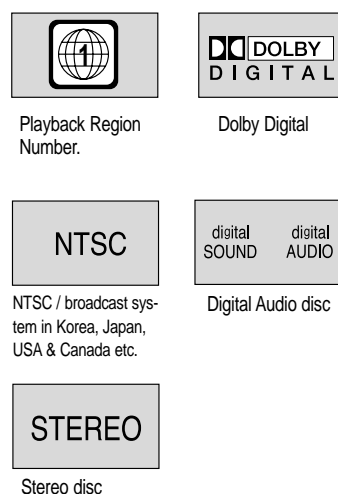

- This unit will not work with CDG, CD-ROM and CD-I.



## COPY PROTECTION.

- DVD discs may be copy protected and could distort the video if the DVD video output is connected through a VCR prior to the television set.  
To prevent this video distortion, the DVD video output should be connected directly to the television set.
- This product incorporates copyright protection technology that is protected by methods claims of certain U.S. patents and other intellectual property rights owned by Macrovision Corporation and other rights owners. Use of this copyright protection technology must be authorized by Macrovision Corporation, and is intended for home and other limited viewing uses only unless otherwise authorized by Macrovision Corporation. Reverse engineering or disassembly is prohibited.

# Maintenance and Storage

For trouble free operation, follow the instructions shown below.

## Maintenance

<b>Cleaning/Player</b> <ul style="list-style-type: none"> <li>● Do not use volatile chemicals or detergent.</li> <li>● Clean with a dry towel.</li> </ul> 	<b>Cleaning/Remote Control</b> <ul style="list-style-type: none"> <li>● Be careful not to spill liquid on the remote.</li> </ul> 
<b>Cleaning/Disc</b> <ul style="list-style-type: none"> <li>● Clean the disc by wiping in a straight line from the inside to the outside of the disc.</li> </ul> 	

## Moisture Condensation.

- When in normal temperatures, if you pour a cold liquid into a glass, water vapor in the air will condense on the surface of glass. This is called moisture condensation.  
When moving the unit from a cold place to heated place, moisture condensation may occur on the operation part or lens.  
When this occurs, the unit will not operate.  
When moisture condensation occurs, remove the disc and leave the unit turned on for 1 to 2 hours until the condensation has completely dried out.



## Disc storage

Be careful not to harm the disc because the data on these discs is highly vulnerable to the environment.

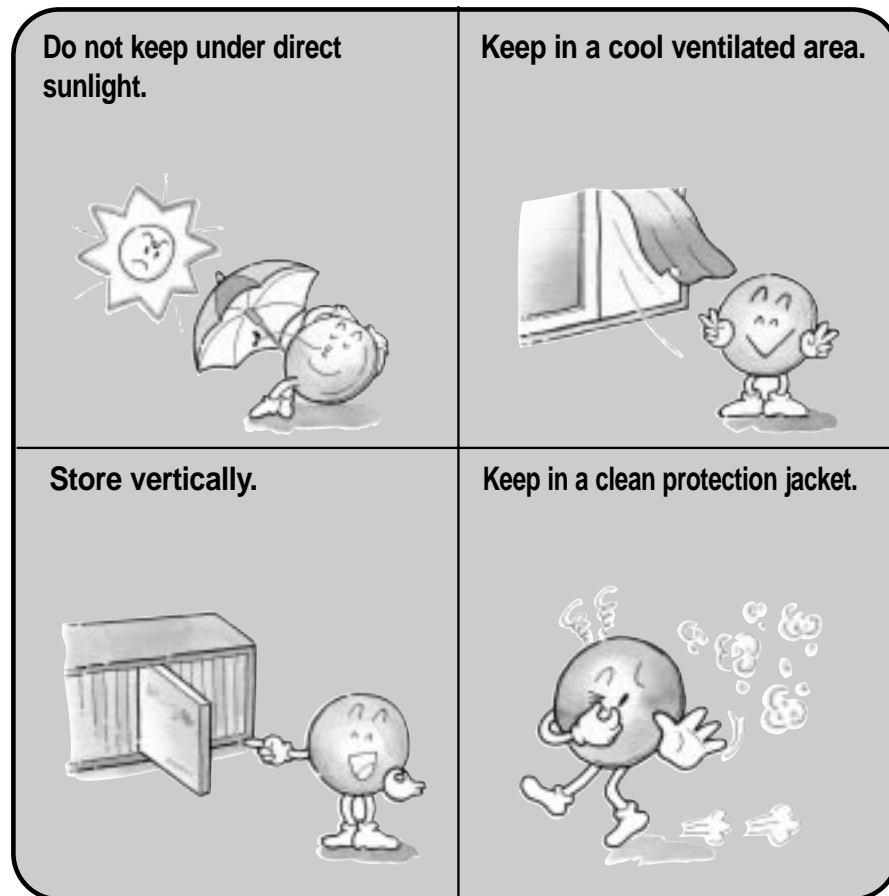

Proper function of your DVD player is mostly dependent on the discs you play. When some of the function indicated in the I/B do not work properly, it is highly probable that the disc is responsible. We strongly recommend you review the instruction book before you start using the player. For your convenience, we have enlisted some tips to help solve problems you might encounter while using the DVD player. However, if the same problem occurs repeatedly, please contact your nearest service center.

Problem	Possible Solution	I/B
Remote control doesn't work	<ul style="list-style-type: none"> <li>●Check the SELECT button on the remote control, then try other buttons.</li> <li>●Check the battery.</li> <li>●Point the remote control unit at the remote control sensor and operate.</li> </ul>	p.15
Disc does not play	<ul style="list-style-type: none"> <li>●Insert the disc with the playback side facing down on the disc tray correctly.</li> <li>●Check the region number of the DVD.</li> <li>●This player cannot play CD-ROMs, DVD-ROMs, etc. Insert a DVD, a VIDEO-CD or a CD.</li> </ul>	p.34,70,78 p.91
AC-3 5.1 channel sound is not being reproduced	<ul style="list-style-type: none"> <li>●AC-3 5.1 channel sound is reproduced only when the following conditions are met: 1)The DVD player is connected with the proper amplifier 2)The disc is recorded with AC-3 5.1 channel sound.</li> <li>●Check whether the disc being played has the "Dolby AC-3 5.1ch" mark on the outside.</li> <li>●Check whether the "AC-3" has been chosen in SETUP MENU.</li> <li>●Check and make sure your audio system is connected and working properly.</li> </ul>	p.23~30 p.63~66 p.91~92
Multi-Language & Multi-Subtitle feature doesn't work	<ul style="list-style-type: none"> <li>●The Multi-Language &amp; Multi-Subtitle feature can be selected only if the disc is encoded with Multi-languages &amp; Multi-subtitles.</li> </ul>	p.37~38 p.51~56
Camera Angle feature doesn't work	<ul style="list-style-type: none"> <li>●Multi-angle function can be selected only if the disc contains multi-angles. Angle indication "CAM" will be shown on the screen when angle selection is possible.</li> </ul>	p.39 p.57~58
Disc Menu doesn't appear	<ul style="list-style-type: none"> <li>●Check to make sure that the disc has a Menu.</li> </ul>	p.41~42
Playback mode differs from the Setup Menu selection	<ul style="list-style-type: none"> <li>●Some of the functions selected in the Setup Menu may not work properly if the disc is not encoded with the corresponding function.</li> </ul>	p.49~66
The Screen Ratio cannot be changed	<ul style="list-style-type: none"> <li>●The Screen Ratio is fixed on your DVD.</li> </ul>	p.61~62
The password for Parental Level has been forgotten	<ul style="list-style-type: none"> <li>●Press the CLEAR button 3 times successively while in the "ENTER PASSWORD"</li> </ul>	p.59~60
If you experience other problems	<ul style="list-style-type: none"> <li>●Go to the contents(p.1-2) and find the section of the instruction book that contains the explanations regarding the current problem, and follow the procedure once again.</li> <li>●Check "Before Service Inquiry"(p.90-96) to see if the problem is listed.</li> <li>●If the problem still cannot be solved, please contact your nearest authorized service center or call 1-800-SAMSUNG.</li> </ul>	

# Definition of terms

## ●ANGLE

Recorded onto some DVD discs are scenes which have been simultaneously shot from a number of different angles(the same scene is shot from the front, from the left side, from the right side, etc.) With such discs, the ANGLE button can be used to view the scene from different angles.

## ●CHAPTER NUMBER

These numbers are recorded on DVD discs. A title is subdivided into many sections, called chapters, each of which is numbered, and specific parts of video presentations can be searched quickly using these numbers.

## ●Dolby Digital(AC-3)

Digital audio compression technology that the Dolby Laboratories Corporation developed, This technology conforms to 5.1-channel surround. When connecting a component with a built-in Dolby Digital decoder, you can enjoy more real audio presence.

## ●DVD

A disc that contains up to 8 hours of moving pictures even though its diameter is the same as a CD. The data capacity of a single-layer and single-sided DVD, at 4.7GB(Giga Byte), is 7 times that of a CD. Furthermore, the data capacity of a dual-layer and single-sided DVD is 8.5GB, a single-layer and double-sided DVD 9.4GB, and a dual-layer and double-sided DVD 17GB. The picture data uses the MPEG 2 format, one of the worldwide standards of digital compression technology. The picture data is compressed to 1/40 of its original size. The DVD also uses the variable rate coding technology that changes the data to be allocated according to the status of the picture. The audio data is recorded in Dolby Digital(AC-3) as well as in PCM, allowing you to enjoy more real audio presence. Furthermore, various advanced functions such as the multi-angle and multilingual functions are provided with the DVD.

## ●OPTICAL DIGITAL OUT

The optical Digital out enables you to send the signal from the DVD to an amplifier by using an optical fiber cable.

## ●PCM

It is an abbreviation of pulse code modulation and refers to analog sound.

## ●Playback Control(PBC)

Signals encoded on VIDEO-CDs(Version2.0) to control playback. By using menu screens recorded on VIDEO-CDs with PBC functions, you can enjoy playing simple interactive programs, programs with search functions, and so on.

## ●REGION NUMBER

DVD players and discs have regional numbers. It is impossible to play a disc on a DVD player that has a different region number. The playable region number of this DVD player is 1.

## ●SUBTITLES

This is text which appears at the bottom of the screen which translates or transcribes the dialogue. Up to 32 subtitle languages can be recorded on a DVD disc.

## ●TITLE NUMBER

These numbers are recorded on DVD discs. When a disc contains two or more movies, these movies are numbered as title 1, title 2, etc. These numbers are recorded on DVD discs. When a disc contains two or more movies, these movies are numbered as title 1, title 2, etc.

## ●TIME NUMBER

This indicates the play time which has elapsed from the start of a disc or a title. It can be used to find a specific scene quickly. (It may not work with some discs.)

## ●TRACK NUMBER

These numbers are assigned to the tracks which are recorded on video CDs and audio CDs. They enable specific tracks to be located quickly.

## ●VIDEO-CD

A compact disc that contains moving pictures. The picture data uses the MPEG 1 format, one of the worldwide standards of digital compression technology. The picture data is compressed 1/140 of its original size. Consequently, a 12cm VIDEO-CD can contain up to 74 minutes of moving pictures. VIDEO-CDs also contain compressed audio information. Sounds outside the range of human hearing are compressed while the sounds we can hear are not compressed. VIDEO-CDs can hold 6 times the audio information of conventional audio CDs.

There are 2 versions of VIDEO-CDs.

-Version 1.1: You can play only moving pictures and sounds.

-Version 2.0: You can play high-resolution still pictures and enjoy PBC functions.

This player conforms to both versions.

# Specifications

## Model : DVD-927

<b>General</b>	Power Requirements	AC 120V/60Hz
	Power Consumption	18W
	Weight	11.8 lb
	Set Size	W 16.5in x D 13.3in x H 4.7in
	Operating Temperature Range	+41°F ~ 95°F
	Operating Humidity Range	10% ~ 75%
<b>Disc</b>	DVD (DIGITAL VERSATILE DISC)	Reading Speed : 11.45ft/sec Approx. Play Time(Single Sided, Single Layer Disc) : 135 minutes
	CD : 5in (COMPACT DISC)	Reading Speed : 3.9 ~ 4.6ft/sec Maximum Play Time : 74minutes
	CD : 3 ½ in (COMPACT DISC)	Reading Speed : 3.9 ~ 4.6ft/sec Maximum Play Time : 20minutes
	VIDEO-CD : 5in	Reading Speed : 3.9 ~ 4.6ft/sec Maximum Play Time : 74minutes(Video + Audio)
	<b>RCA JACK</b>	2 channel : 1.0Vp-p
		Y: 1.0Vp-p
		Pr : 0.70Vp-p
		Pb : 0.70Vp-p
<b>Video output</b>	<b>S-VIDEO</b>	Luminance Signal : 1Vp-p(75Ω load)
		Color Signal : 0.286Vp-p(75Ω load)
<b>Audio output</b>	2 channel	L(1/L). R(2/R)
	5.1 channel	F/L, F/R, R/L, R/R, C/T, S/W
	<b>Output Level</b>	Analog : 2Vrms(1KHz.)
		Digital : 1.15Vp-p
	<b>Frequency Response</b>	* Frequency Response : 48KHz Sampling 4Hz-22KHz 96KHz Sampling 4Hz-44KHz, S/N Ratio : 110dB
		* Dynamic Range : 100dB
		* Total Harmonic Distortion 0.003%
	<b>Wow/Flutter</b>	Under measureable values

\* : Nominal specification



# Audio & Subtitle Languages

The DVD disc can contain up to 8 audio languages and 32 subtitle languages. They are represented by the abbreviations shown below.

When you select audio and subtitle, please refer to the following table.

## Table of Languages and Their Abbreviations

Abbreviation	Language	Abbreviation	Language	Abbreviation	Language	Abbreviation	Language	Abbreviation	Language
<b>A</b>	aa Afar	<b>F</b>	fa Persian	<b>K</b>	kn Kannda	<b>Q</b>	qu Quechua	<b>T</b>	tk Turkmen
	ab Abkhazian		fi Finnish		ko Korean		rm Rhaeto-Romance		tl Tagalog
	af Afrikaans		fj Fiji		ks Kashmiri	<b>R</b>	rn Kirundi		tn Setswana
	a m Ameharic		fo Faroese		ku Kurdish		ro Rumanian		to Tsonga
	ar Arabic		fr French		ky Kirghiz		ru Russian		tr Turkish
	as Assamese		fy Frisian	<b>L</b>	la Latin		rw Kinyarwanda		ts Tsonga
	ay Aymara	<b>G</b>	ga Irish		ln Lingala	<b>S</b>	sa Sanskrit		tt Tatar
	az Azerbaijani		gd Scots Gaelic		lo Laothian		sd Sindhi		tw Twi
<b>B</b>	ba Bashkir		gl Galician		lt Lithuanian		sg Sangho	<b>U</b>	uk Ukrainian
	be Byelorussian		gn Guarani		lv Latvian, Lettish		sh Serbo-Croatian		ur Urdu
	bg Bulgarian		gu Gujarati	<b>M</b>	m g Malagasy		si Singhalese		uz Uzbek
	bh Bihari	<b>H</b>	ha Hauza		mi Maori		sk Slovak	<b>V</b>	vi Vietnamese
	bi Bislama		hi Hindi		m k Macedonian		sl Slovenian		vo Volapük
	bn Bengali, Bangla		hr Croatian		ml Malayalam		s m Samoan	<b>W</b>	wo Wolof
	bo Tibetan		hu Hungarian		m n Mongolian		sn Shona		xh Xhosa
	br Breton		hy Armenian		m o Moldavian		so Somali	<b>S</b>	yo Yoruba
<b>C</b>	ca Catalan	<b>I</b>	ia Interlingua		mr Marathi		sq Albanian	<b>Z</b>	zh Chinese
	co Corsican		ie Interlingue		m s Malay		sr Serbian		zu Zulu
	cs Czech		ik Inupiak		mt Maltese		ss Siswati		
	cy Welsh		in Indonesian		m y Burmese		st Sesotho		
<b>D</b>	da Danish		is Icelandic	<b>N</b>	na Nauru		su Sundanese		
	de German		it Italian		ne Nepali		sv Swedish		
	dz Bhutani		iw Hebrew		nl Dutch		sw Swahili		
<b>E</b>	el Greek	<b>J</b>	ja Japanese		no Norwegian	<b>T</b>	ta Tamil		
	en English		j Yiddish		oc Occitan		te Telegu		
	eo Esperanto		jw Javanese	<b>O</b>	o m (Afan) Oromo		tg Tajik		
	es Spanish		ka Georgian		or Oriya		th Thai		
	et Estonian	<b>K</b>	kk Kazakh	<b>P</b>	pa Panjabi		ti Tigrinya		
	eu Basque		kl Greenlandic		pl Polish				
			k m Cambodian		ps Pashto, Pushto				
					pt Portuguese				

## Warranty (for USA users only)

### SAMSUNG LIMITED WARRANTY

Samsung Electronics America Inc.(SEA), warrants that this product is free from defective materials and workmanship.

SEA further warrants that if this product fails to operate properly within the specified warranty period and the failure is due to improper workmanship or defective materials, SEA will repair or replace the product at its option.

All warranty repairs must be performed by a SEA Authorized Service Center.(The name and address of the location nearest you can be obtained by calling toll free:1-800-SAMSUNG).

<u>LABOR</u>
One year(Carry-in)

<u>PARTS</u>
One year

On carry-in models, transportation to and from the service center is the customer's responsibility.

The original dated sales receipt must be retained by the customer and is the only acceptable proof of purchase. It must be presented to the authorized service center at the time service is requested.

### EXCLUSIONS (WHAT IS NOT COVERED)

This warranty does not cover damage due to accident, fire, flood and/or other acts of God; misuse incorrect line voltage, improper installation, improper or unauthorized repairs, commercial use or damage that occurs in shipping. Operations explained in the instruction manual are not covered under the terms of this warranty. This warranty will automatically be voided for any unit found with a missing or altered serial number. This warranty is valid only on products purchased and used in the United States and Puerto Rico.

Some states do not allow the exclusions or limitations of incidental or consequential damages, or allow limitations on how long an implied warranty lasts, so the above limitations or exclusions may not apply to you. This warranty gives you specific legal rights and you may also have other rights which vary from state to state.

## Warranty (for Canada users only)

### SAMSUNG LIMITED WARRANTY

Samsung Electronics Canada Inc.(SECA), warrants that this product is free from defective material and workmanship.

SECA further warrants that if this product fails to operate properly within the specified warranty period and the failure is due to improper workmanship or defective material, SECA will repair or replace the product at its option.

All warranty repairs must be performed by a SECA Authorized Service Center.(The name and address of the location nearest you can be obtained by calling toll free:1-800-SAMSUNG).

<u>LABOR</u>
One year(Carry-in)

<u>PARTS</u>
One year

On carry-in models, transportation to and from the service center is the customer's responsibility.

The original dated sales receipt must be retained by the customer and is the only acceptable proof of purchase. It must be presented to the authorized service center at the time service is requested.

### EXCLUSIONS (WHAT IS NOT COVERED)

This warranty does not cover damage due to accident, fire, flood and/or other Acts of God; misuse, incorrect line voltage, improper installation, improper or unauthorized repairs, commercial use, or damage that occurs in shipping. Exterior and interior finish, lamps, glass, are not covered under this warranty. Customer adjustments which are explained in the instruction manual are not covered under the terms of this warranty. This warranty will automatically be voided for any unit found with a missing or altered serial number. This warranty is valid only on products purchased and used in Canada.