



**Medtronic**

# Getting Started

with Continuous Glucose Monitoring



Paradigm REAL-Time™  
**Revel**  
MINIMED

# Congratulations on your decision to use the MiniMed Paradigm® REAL-Time Revel™ System!

A solid understanding of Continuous Glucose Monitoring (CGM) basics is essential to your success. Here's what we'll cover in this guide:

## 1 UNDERSTANDING CGM

<b>Glucose Readings</b>	Blood glucose (BG) meter and sensor glucose readings come from similar, but different, places in your body
<b>Calibration</b>	A sensor needs BG meter readings to function properly
<b>Settings</b>	Personalize and adjust your settings over time

## 2 STARTING-UP CGM

- Step 1 – Inserting the Glucose Sensor
- Step 2 – Programming Settings
- Step 3 – Connecting the MiniLink® Transmitter
- Step 4 – Calibrating
- Step 5 – Reading the Display

## 3 APPLYING CGM IN YOUR LIFE

- What is CareLink™ Therapy Management Software?
- How do CareLink Software reports help me?
- How do I sign up for CareLink Software?

# Let's get started!

Your CGM system includes 3 key items:

- 1 Glucose Sensor** Measures glucose levels in the body.
- 2 MiniLink® transmitter** The MiniLink transmitter connects to the glucose sensor and sends glucose readings to your insulin pump. It is recharged and stored in the MiniLink charger when not in use.
- 3 Insulin Pump** Delivers insulin and receives and displays glucose readings.

Other items include: Sen-serter® Insertion Device, test plug, IV-3000® adhesive tape and CareLink™ USB used to download your pump information to CareLink software on a computer.



*Remember, your healthcare provider and Medtronic Diabetes are here to support you every step of the way.*

# 1 Understanding CGM



## GLUCOSE READINGS

Your BG meter measures glucose (sugar) levels in your **blood**, and your glucose sensor measures glucose levels in the fluid surrounding the cells in your tissue, which is called **interstitial fluid**.

Most of the time, glucose travels first to your blood and then to your interstitial fluid.

Because of how glucose travels, your BG meter readings and sensor readings will rarely match exactly. *This is normal and should be expected.*

Usually your BG meter readings and your sensor readings will be close.

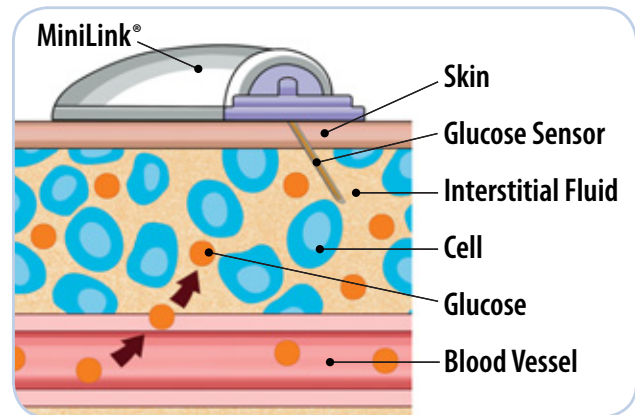

However, when glucose levels are rising or falling quickly, you should **expect** to see a larger difference between your BG meter value and the sensor glucose reading. Examples of times when this may occur include:

- After meals or after insulin
- When ↑ or ↓ arrows appear on your pump screen

Use CGM to understand your glucose trends.



Focus on what matters: the **direction** and the **speed** of the sensor glucose change. Pay less attention to each individual glucose number.

Always rely on BG meter readings for therapy adjustments.





## CALIBRATION

Your MiniMed Paradigm® REAL-Time Revel™ System uses BG meter readings to make sure the glucose sensor maintains its accuracy over time. This is called **calibration**.

To calibrate you must check your BG on your meter and enter the value into the pump. The two most common ways to calibrate are through the Bolus Wizard® and the sensor menu. The preferred method is the Bolus Wizard, which may help to prevent the stacking of insulin.

When you calibrate is important.

- On day one of a new sensor, a calibration is needed:
  - approximately 2 hours after you connect the MiniLink® transmitter to your sensor (the system will notify you)
  - again within 6 hours
  - again within 12 hours
- After day one, calibrate **3–4 times a day** for optimal sensor accuracy
- A **minimum** of 1 calibration every 12 hours is required to receive sensor glucose readings

It's easy to remember when to calibrate. Think *Before is best*. The best times to calibrate are when glucose levels are least likely to be changing rapidly, such as:

- **Before** meals
- **Before** insulin
- **Before** bedtime
- When there are **no arrows on your insulin pump screen**

### Tip:

Time your calibrations so you will not have to wake up in the middle of the night. Remember, you can calibrate early! For example, if it's 9pm and you know a calibration will be required by 3am, go ahead and calibrate before bed. This will start the 12 hour calibration clock over. To find out when your next calibration is due, press  3 times from the HOME screen.

If you notice a large difference between your BG meter and sensor glucose readings, calibration may be needed to bring them closer together again (remember, only calibrate if there are no arrows on your display).

Calibration is essential for optimal sensor performance. The glucose sensor performs best when calibrated 3–4 times per day.



CGM does **not** eliminate the need for BG meter readings (fingersticks).

You do not need to wait 6 hours (day one) and 12 hours to calibrate. You can calibrate early, as long as your glucose is stable.



## SETTINGS

Your MiniMed Paradigm REAL-Time System allows you to customize alerts to help improve your glucose control. Your healthcare provider will work with you and your trainer to determine the initial alert settings that work best for you.



In using CGM, these settings will determine how often you are alerted. You will want to find a balance between the benefit of receiving these alerts and any inconvenience that may be caused by receiving too many.

During the first several weeks on CGM, you and your healthcare provider may consider (i) waiting to turn these alerts on, (ii) turning on only certain alerts, or (iii) setting these alerts very wide. As you learn more about your glucose patterns and how to use CGM, you will be able to adjust your alert settings to meet your individual needs.

## 2 Starting-Up CGM\*



### STEP 1: GLUCOSE SENSOR INSERTION

#### Site Selection

Choose a place on your body at least:

- 2 inches from your navel
- 2 inches from your insulin pump infusion site
- 3 inches from any manual insulin injection site

For best glucose sensor performance, avoid:

- Sites where clothing may rub or constrict (for example your beltline)
- Sites where your body naturally bends a great deal
- Sites that are scarred or have hardened tissue or stretch marks

Note: clinical trials for glucose sensors were performed on sensors inserted in the abdominal area.



#### Insertion

- Wash hands.
- Remove glucose sensor from package by holding the sensor base or tape. Do not hold the glucose sensor by the introducer needle handle.
- Using an alcohol swab, clean the selected site prior to insertion.
- Allow the alcohol to dry, then follow the steps outlined on page 7 to insert the glucose sensor.



**Proper insertion is important for optimal glucose sensor performance and to prevent bleeding at the site.**

\*For more detailed information on starting up CGM, please review the sensor section of the Insulin Pump User Guide.

## Insertion:

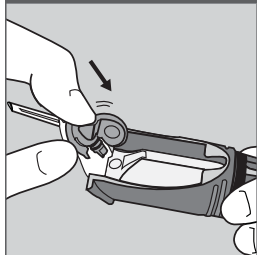

- 1** Place the glucose sensor in the Sen-serter® Insertion Device until it fits snugly.

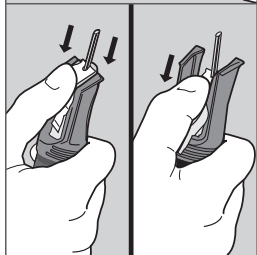

- 2** Place your thumb on the back of the white tape and push the glucose sensor down until it locks.

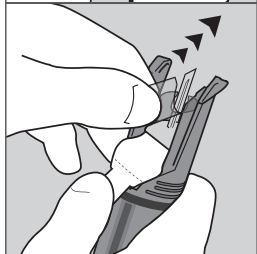

- 3** While holding down the white tape, remove the clear tape.

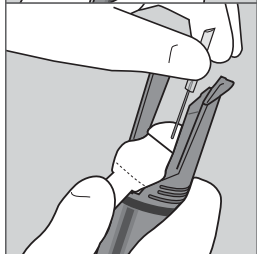

- 4** Gently remove the needle guard.

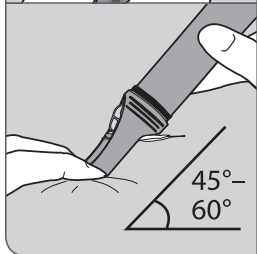

- 5** Insert the glucose sensor at a 45-60° angle. Rest the Sen-serter Insertion Device with legs flat on the skin to achieve a 45° insertion angle. Tilt it slightly up to achieve a 60° insertion angle.

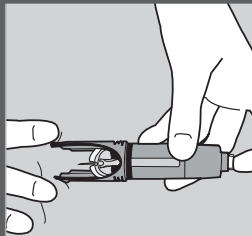

- 6** Hold the skin taut. Place two fingers on the Sen-serter base to stabilize it for insertion. Press the white button on top of the Sen-serter Insertion Device.

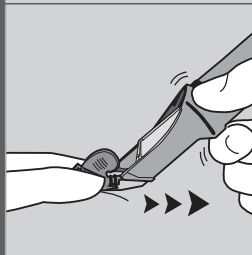

- 7** Gently hold the glucose sensor in place and gently slide the Sen-serter Insertion Device away from the glucose sensor in a horizontal motion.

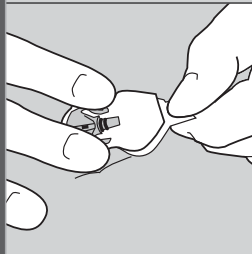

- 8** Gently hold the glucose sensor in place and remove the white paper from the adhesive pad. Press adhesive against your skin.

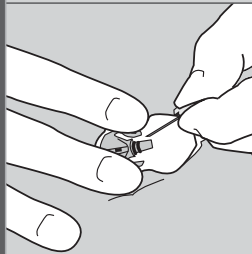

- 9** Hold the glucose sensor base with two fingers and gently remove the introducer needle at the same angle that it was inserted.

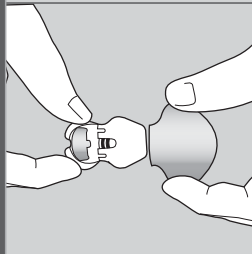

- 10** Wait 10–15 minutes before connecting the fully charged MiniLink® transmitter to the glucose sensor. Be sure to follow step 2 and 3 of this guide before connecting the MiniLink transmitter.





## STEP 2: PROGRAMMING SETTINGS

A good time to program your glucose sensor settings into your insulin pump is after glucose sensor insertion, while the glucose sensor is still wetting with interstitial fluid.



Your healthcare provider will work with you and your trainer to determine your initial settings.

To turn the SENSOR feature on, go to:

**HOME Screen > MAIN MENU > SENSOR > EDIT SETTINGS > Sensor: ON**

After you have turned your SENSOR feature on, enter your MiniLink® transmitter ID:

**HOME Screen > MAIN MENU > SENSOR > EDIT SETTINGS > Transmtr ID > SET TRANSMITTER ID**

- Use the  and  buttons to select each digit and press  to enter. The seven-digit ID (or serial number) is located on the flat side of the MiniLink transmitter. Be sure to only select the numbers.

Transmitter ID Number

**2XXXXXX**

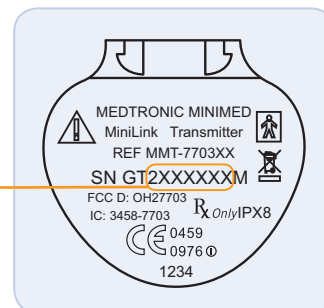

Follow these steps to personalize your sensor settings:

**HOME Screen > MAIN MENU > SENSOR > EDIT SETTINGS**

Two alerts are the HIGH SG and LOW SG alerts, which notify you when your glucose has moved above or below your programmed glucose limits. For example, if your HIGH SG alert is set at 250 mg/dL and your LOW SG alert is set at 70 mg/dL, you will receive an alert every time your glucose goes above 250 or below 70.

You can set up to 8 customizable HIGH SG and LOW SG alert limits for different periods of the day. This is especially helpful, for example, if you would like to set your glucose alert limit differently at night to prevent frequent alerts while you sleep.

To turn your sensor setting on, go to:

**HOME Screen > MAIN MENU > SENSOR > EDIT SETTINGS > SENSOR: ON**

To turn your high and low glucose alert limits on, go to:

**HOME Screen > MAIN MENU > SENSOR > EDIT SETTINGS > GLUCOSE ALERTS: ON**

To set your high and low glucose alert limits, go to:

**HOME Screen > MAIN MENU > SENSOR > EDIT SETTINGS > GLUCOSE LIMITS**

---

### Remember!

Your High and Low glucose alerts are not the same as your target glucose ranges.

High and Low alerts are useful features of the system that are meant to be adjusted as your knowledge of the system improves.

Successful CGM usage involves optimizing your settings over time.

**Predictive** alerts provide you with a warning that your glucose is trending towards your chosen high and low glucose limits 5-30 minutes before you would otherwise reach these limits. With predictive alerts, you can be made aware of potential highs and lows even before they occur. Based on your healthcare provider's recommendations, you may set a predictive low, a predictive high, both, or neither.

To set your predictive alerts, go to:

**HOME Screen > MAIN MENU > SENSOR > EDIT SETTINGS > PREDICT ALERTS: ON**

---

**Rate of Change** alerts notify you that your glucose levels are rising or falling at a certain rate. They are useful for understanding how quickly your glucose levels are affected by meals and insulin, and to recognize potentially dangerous sensor glucose changes before they become a problem. The **RISE RATE** alert can be helpful if you are prone to forgetting to take insulin, since glucose levels tend to spike significantly at these times. Likewise, the **FALL RATE** alert can be helpful in protecting you when you give yourself too much insulin, or if you skip a meal by accident.

To set your rate of change alerts, go to:

**HOME Screen > MAIN MENU > SENSOR > EDIT SETTINGS > Rate Alerts**

You will be asked first to set a fall rate of 1.1 to 5.0 mg/dL/min, or select to turn it OFF. After your fall rate is selected, you will then be asked to set your rise rate. You may set a rise rate of 1.1 to 5.0 mg/dL/min, or turn it OFF. It's often best to wait until you have adjusted to CGM to set these alerts.

---

Going to a movie or making a presentation? You can set the volume to VIBRATE if you prefer to not receive audible alerts for any reason. There is also an **Alert Silence** feature which allows you to silence specific sensor alerts in the system. You will still be able to see these alerts on the screen of your insulin pump.

To place your monitor on VIBRATE mode, go to:

**HOME Screen > MAIN MENU > UTILITIES > ALERT > ALERT TYPE > Vibrate**

To set your **ALERT SILENCE** feature, go to:

**HOME Screen > MAIN MENU > SENSOR > Alert Silence**

You can then select which alerts you would like to silence.

---

The **Repeat** setting is the time the system waits after an alert and before it alerts again if the situation is not resolved. Setting the repeat properly will prevent excessive alerts for HIGH SG and LOW SG situations which you have already taken action to correct.

To set your high repeat, go to:

**HOME Screen > MAIN MENU > SENSOR > EDIT SETTINGS > Hi Repeat**

To set your low repeat, go to:

**HOME Screen > MAIN MENU > SENSOR > EDIT SETTINGS > Lo Repeat**

---

Your personalized CareLink™ reports will help you and your healthcare provider to see where to best set your alerts over time.

Setting	What It Does	Commonly Used Settings
<b>High Repeat</b>	The amount of time until you are reminded that your sensor glucose is still above your high alert setting	2 hrs – 3 hrs
<b>Low Repeat</b>	The amount of time until you are reminded that your sensor glucose is still below your low alert setting	20 min – 30 min
<b>Cal Repeat</b>	The amount of time after you miss a calibration ( <b>Meter BG Now</b> alert) before you are reminded	1 hr
<b>Cal Reminder</b>	The amount of time until your next calibration	30 min – 1 hr
<b>Weak Signal</b>	The amount of time before you are alerted if there is a weak signal	30 min

Remember, alerts are optional and are meant to be personalized and adjusted over time. Start wide and customize your alerts as you use CGM to learn more about your glucose trends and patterns.



You can adjust your alert settings so that they are different during your bedtime hours to ensure that you get a good night's sleep.

CareLink reports help you and your healthcare provider fine tune your settings.



## STEP 3: CONNECTING THE MINILINK® TRANSMITTER

After the glucose sensor is inserted and your settings are entered, wait 10–15 minutes before connecting the MiniLink transmitter to the glucose sensor.

Once 10–15 minutes have passed, remove the MiniLink transmitter from the charger.

When you remove the MiniLink transmitter from the charger, a green light will flash on the transmitter. This indicates it has enough battery power to last at least 3 days and is ready to be connected to the glucose sensor.

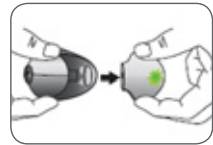

Connect the MiniLink transmitter to the glucose sensor. When properly connected, you will hear a click. Do not connect if there is blood on the glucose sensor connection point.

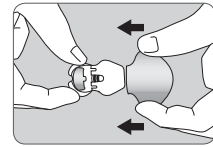

A green light on the MiniLink transmitter will begin flashing when a good connection exists and the glucose sensor is “wet” (note: it may take up to 20 seconds for the MiniLink transmitter to flash).

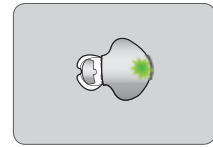

Optional: IV-3000® adhesive can be used to tape down and secure your sensor and MiniLink.

### If the MiniLink transmitter does not flash when connected to the glucose sensor:

Disconnect the transmitter and place it back in the charger to ensure it is fully charged.

If you still do not see the transmitter flash, your sensor may simply need more time to wet. With the transmitter connected to the sensor, wait 2 hours and then perform the **Sensor Start** (see below).

Perform the **Sensor Start**: **HOME Screen > MAIN MENU > SENSOR > LINK TO SENSOR > New Sensor**. The system is ready approximately 2 hours after the MiniLink transmitter is connected to the glucose sensor and the green light flashes. This 2 hour period is called **initialization**.





## STEP 4: CALIBRATING

METER BG NOW alert will sound when the system is ready for you to enter a BG meter value for initial calibration. Remember, the preferred method is to use the Bolus Wizard.<sup>®</sup> Clear the alert and follow either of these steps to enter a BG meter value:

**⌂ > ENTER BG > BG to update Sensor : YES or  
MAIN MENU > SENSOR > CALIBRATE > Enter BG**

---

After you calibrate, it will take 10–15 minutes for sensor glucose readings to appear on your insulin pump screen.

---

After your initial calibration, another calibration will be required within 6 hours.

---

1 calibration every 12 hours is the minimum required to continue to receive glucose sensor readings after the first day.

---

Calibrate 3–4 times a day thereafter for optimal glucose sensor accuracy.

### Remember!

The best times to calibrate the glucose sensor are when your glucose levels are least likely to be changing rapidly. Think *Before*: before meals, before bedtime, before insulin. Also, you do not need to wait until you are alerted to calibrate. You can calibrate at any time when your glucose is stable.

If you get a CAL ERROR on your insulin pump, don't worry. This is a feature of your system intended to ensure good performance.

- To avoid a CAL ERROR make sure you calibrate when your glucose is least likely to be changing rapidly
- If you get a CAL ERROR recalibrate if the BG is stable, otherwise wait 15–30 minutes before calibrating again



## STEP 5: READING THE DISPLAY

Your insulin pump screen displays 3-hour, 6-hour, 12-hour, and 24-hour glucose trend graphs. Press **ESC** once from the HOME Screen to display the most recently viewed trend graph. Press **^** to display the other graphs.

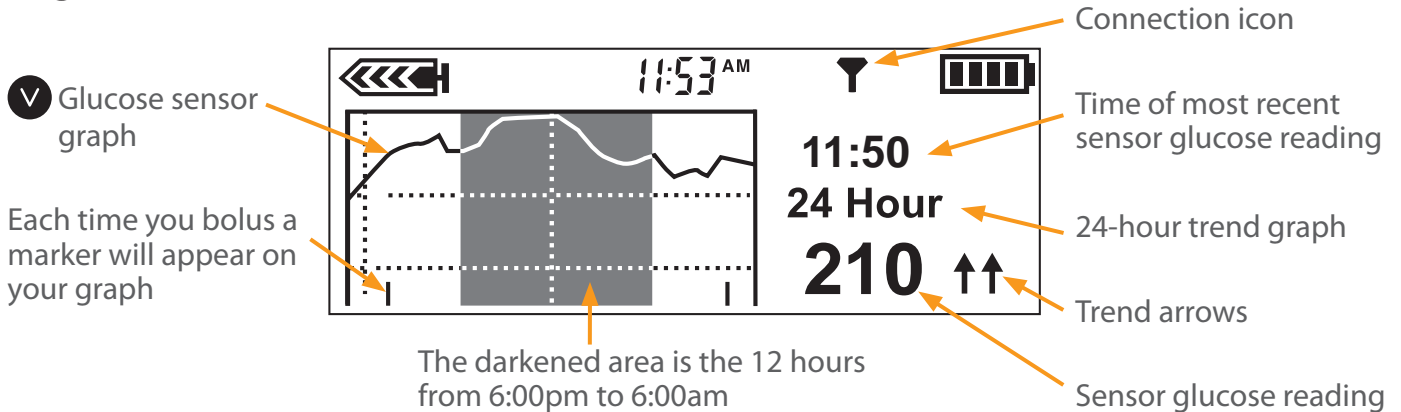

Press **V** to view individual sensor glucose readings on the graph.

### What the Sensor Icons Mean

↑ or ↓	Glucose has risen or fallen 1-2 mg/dL per minute.
↑↑ or ↓↓	Glucose has risen or fallen 2.0 or more mg/dL per minute.
Y	Insulin pump indicates that the MiniLink® transmitter and insulin pump are communicating properly.
Y	Pump has not received a signal for more than 5–7 minutes. This is okay; the MiniLink transmitter stores up to 40 minutes of data and will send these readings to the insulin pump once a signal is reestablished.

# 3

## Applying CGM in Your Life



### WHAT IS CARELINK™ SOFTWARE?

CareLink software is a Web-based software that allows you to upload information from your MiniMed Paradigm® REAL-Time System to a secure online (internet) site for viewing.

CareLink software organizes all of your insulin pump and glucose sensor information into reports (charts, tables and graphs) that help you track glucose levels, insulin usage and carbohydrate intake over time.

With CareLink software, you can grant your healthcare provider online access – or just bring a copy of your CareLink reports to your appointments – so you and your provider can work together to determine the best therapy decisions and system settings to improve your outcomes.

Don't have a computer? Your healthcare provider may be able to download the reports at your next visit.



CareLink reports help you and your healthcare provider make decisions that improve your control and fit your lifestyle.

The combination of insulin pump therapy, continuous glucose monitoring and CareLink software provides you with the tools and information you need to **optimize** your therapy.



## HOW DO CARELINK™ SOFTWARE REPORTS HELP ME?

CareLink software provides you with information you've never had before about your glucose trends and patterns. Take action and make simple changes to optimize your glucose control. CareLink software helps you answer questions like:

- Do I need to adjust my basal rate or use temporary basal rates to avoid going high or low at the same time every day?
- Am I accurately counting my carbs at meals?
- Are my carb ratios correct?
- Do I need to use the Dual Wave® or Square Wave® bolus functions for tighter control?
- Where should I set my high, low, predictive, and rate of change alerts?



## CareLink™ Software Tips

For best results using CareLink software, Medtronic Diabetes recommends:

- Finding a consistent time once a week to review your CareLink reports.
- Reviewing two CareLink reports to start: the Sensor Daily Overlay Report and the Daily Summary Report.
- Picking one or two simple adjustments to work on at a time when you review the past week's information in CareLink software.

Always remember to review and discuss your CareLink reports when you visit your healthcare provider. Note: some providers may use a different but similar version of CareLink software called CareLink Pro at their office.



## HOW DO I SIGN UP FOR CARELINK SOFTWARE?

To sign up for your free CareLink software account visit:  
[www.medtronicdiabetes.com/carelink](http://www.medtronicdiabetes.com/carelink)

Set up a meeting with your Medtronic Diabetes trainer or your healthcare provider to learn more about how to use this valuable tool.

See the difference that the combination of insulin pump therapy, CGM and CareLink software can make in your life.



CGM and Medtronic – giving you  
the confidence to live *your* life.



# Appendix

- MiniLink® Transmitter Tips
- Cleaning Your MiniLink Transmitter
- Other Useful Information

Tape Tips

X-rays, MRIs and CT scans

Air Travel

- Alerts
- Notes

# MiniLink® Transmitter Tips

Fully charge the MiniLink transmitter before each use.

---

When the MiniLink transmitter is charging, a green light on the charger will flash.

---

The green light on the charger will turn off when completely charged.

---

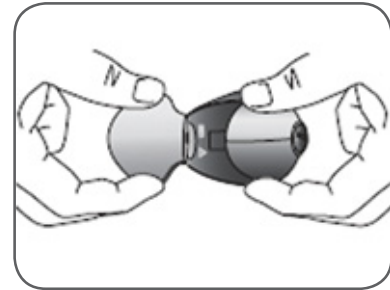

When you remove the MiniLink transmitter from the charger, a green light should flash on the MiniLink transmitter. This indicates it has enough battery power to last at least 3 days and is ready to be connected to the sensor.

---

Charging time:

- For a completely depleted transmitter: up to 8 hours.
  - Normal use: less than 20 minutes to fully recharge.
- 

Always store the MiniLink transmitter in the charger when not in use (so that it retains optimal battery life).

- To preserve transmitter battery life during periods of infrequent usage, remove the MiniLink transmitter from its charger for at least 1 minute every 1-2 months.
- 

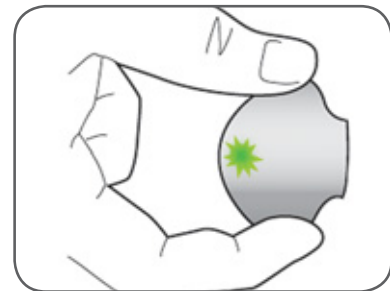

Battery status for charger and MiniLink transmitter:

- The light on the charger will flash red once every 2 seconds if the AAA battery in the charger needs replacement.
- The light on the charger will quickly and repeatedly flash red over 2 second intervals if the MiniLink transmitter battery is depleted. This should rarely happen if the transmitter is recharged after each use.

# Cleaning Your MiniLink® Transmitter

Medtronic Diabetes does not recommend cleaning the MiniLink transmitter after each sensor use.

**CAUTION:** The MiniLink charger and test plug are not waterproof and should not be immersed in water.

---

If you feel that the MiniLink transmitter needs cleaning, follow these steps:

- Attach the test plug to the MiniLink transmitter to help prevent water, soap and sanitizer from damaging the connector pins inside the MiniLink transmitter. Do not expose the connector pins to liquids.
- Wipe the MiniLink transmitter with a dampened cloth and mild liquid soap.
- Remove the soap using warm tap water. Be sure not to let water enter the MiniLink transmitter connection point.
- Wipe the MiniLink transmitter surface with anti-bacterial hand sanitizer.
- Wipe the MiniLink transmitter with a dry cloth and air dry for three minutes.

# Other Useful Information

## Tape Tips

It is highly recommended that you put a transparent dressing to secure the system in place and ensure that the sensor remains fully inserted underneath the skin. Seasonal climates, skin lotions/creams, trapped moisture or different clothing may affect your sensor tape adhesion or the way your body reacts to it. Here are some tips you may want to try:

- Cut a piece of IV-3000® in half and place it crossways so that it covers the glucose sensor and the part of the MiniLink® transmitter closest to the sensor connection. This secures the glucose sensor and MiniLink transmitter while allowing them to air dry.
- Try another type of tape from your local pharmacy or a simple Band-Aid® over the MiniLink transmitter.
- While the sensor and transmitter are safe to be worn in a hot tub, be careful as the adhesive may weaken.

---

## X-rays, MRIs and CT scans

If you are going to have an X-ray, CT scan, MRI or other type of exposure to radiation, take off your insulin pump, BG meter, MiniLink transmitter and glucose sensor and remove them from the area.

---

## Air Travel

The Federal Aviation Administration (FAA) requires that devices with radio frequency capabilities should not be used on an aircraft.

For the flight simply:

- 1) Go to: **HOME Screen > MAIN MENU > SENSOR > Turn Off Sensor**
- 2) Keep the glucose sensor in, but disconnect the MiniLink transmitter from the glucose sensor and store on the charger  
Note: During this time you will have to manually check your BG

To reconnect after the flight:

- 1) Reconnect the MiniLink transmitter to the sensor
- 2) Go to: **HOME Screen > MAIN MENU > SENSOR > EDIT SETTINGS > Sensor: ON**
- 3) Go to: **HOME Screen > MAIN MENU > SENSOR > LINK TO SENSOR > Reconnect Old Sensor**

Just like starting a **New Sensor**, there will be a two hour initialization period and a calibration will be needed.

# Alerts

To clear an alert screen, press , then .

Alert	What It Means	How to Respond
<b>Weak Signal (WeakSn)</b>	The insulin pump and MiniLink® transmitter are not communicating.	Re-position the insulin pump closer to the MiniLink transmitter.
<b>Lost Sensor (SenLos)</b>	Insulin pump has not received a signal from the MiniLink transmitter for more than 40 minutes.	Ensure the MiniLink transmitter and sensor are connected. Place the insulin pump closer to the transmitter. If this alert occurs within 20 minutes of starting a new sensor, go to <b>New Sensor</b> .  If alert occurs 20 minutes or more after starting a new sensor, go to <b>Reconnect Old Sensor</b> .
<b>Cal Error (CalErr)</b>	BG entry is out of expected BG range.	Re-calibrate if BGs are stable. Wait 15 – 30 minutes if BG was entered at time of rapid glucose change.
<b>Meter BG By (mBGby)</b>	A BG will be needed for the system to continue providing sensor readings by the time shown on the alert	Clear the alert. You will continue to receive sensor readings until Meter BG Now alert appears.
<b>Meter BG Now (mBGnow)</b>	A BG is needed for the system to continue to provide sensor readings.	Make sure there are no arrows on the pump screen, test your BG and calibrate the system.
<b>High SG (Hi)</b>	Glucose level is higher than or equal to your high glucose alert setting.	Treat as required based on BG meter reading. If this alert becomes frequent, adjust the setting and/or <b>Repeat</b> setting for this alert.
<b>Low SG (Lo)</b>	Glucose level is lower than or equal to your low glucose alert setting.	Treat as required based on BG meter reading. If this alert becomes frequent, adjust the setting and/or <b>Repeat</b> setting for this alert.



Alert	What It Means	How to Respond
<b>Sensor End (SenEnd)</b>	Sensor has been used for 72 hours.	Remove sensor and follow guide for new sensor start.
<b>Sensor Error (SenErr)</b>	Sensor signals are either too high or too low.	Clear the alert and ignore if this happens during initialization. If alert happens more than 3 times in 24 hours, replace the sensor
<b>Change Sensor (ChgSen)</b>	System has detected a sensor that isn't working correctly.	If alert occurs during initialization, wait and perform a sensor start using the same sensor. Otherwise, call our 24-Hour HelpLine.
<b>Rise Rate (UpSlp)</b>	The sensor glucose measurements are rising at a rate that is equal to or faster than the SET RISE RATE LIMIT you selected.	Consider taking corrective action after confirming with a BG meter reading.
<b>Fall Rate (DwnSlp)</b>	The sensor glucose measurements are falling at a rate that is equal to or faster than the SET FALL RATE LIMIT you selected.	Consider taking corrective action after confirming with a BG meter reading.
<b>High Predicted (PrdHi)</b>	Sensor glucose is trending to reach or go above your high glucose limit in the length of time you selected for the high predictive alert.	Consider taking corrective action after confirming with a BG meter reading.
<b>Low Predicted (PrdLow)</b>	Sensor glucose is trending to reach or go below your low glucose limit in the length of time you selected for the low predictive alert.	Consider taking corrective action after confirming with a BG meter reading.

The versions in parentheses above show how the alert will appear in the Sensor Alert History.



Still have questions?  
Our 24-Hour HelpLine is here to help.  
Call 1.800.646.4633, option 1.

[www.medtronicdiabetes.com](http://www.medtronicdiabetes.com)

**Medtronic Diabetes**

18000 Devonshire Street  
Northridge, CA 91325  
1.800.646.4633



9403341-011 012810 ©Medtronic MiniMed, Inc. 2010. All rights reserved.

IV-3000 is a registered trademark of Smith & Nephew, Inc.

Band-Aid® is a registered trademark of Johnson & Johnson Companies.

MiniLink, Sen-serter, Paradigm, and Bolus Wizard are registered trademarks of Medtronic MiniMed, Inc.

Revel and CareLink are trademarks of Medtronic MiniMed, Inc.