



SC-HT60

Operating Instructions Home Theater Audio System

Model No. **SC-HT40**
SC-HT60

Dear customer

Thank you for purchasing this product.
Please read these instructions carefully before connecting,
operating or adjusting this product.
Please keep this manual for future reference.

SC-HT60 is used in the illustrations unless otherwise mentioned.

Table of contents

Before use

Safety precautions	2
Supplied accessories	3
The remote control	3

Step 1

Speaker setup 4

Step 2

Home theater connections 8

Step 3

Other connections 9

Step 4

Settings 10

Operations

Basic operations	12
Control guide	13
Making a recording	15
The RESET function	15
MENU operation	16
The radio	17
Sound field	18
Other functions	20
Other settings	21
Remote control operation guide	22
Specifications	23

Reference

Troubleshooting guide	Back cover
Maintenance	Back cover

Safety precautions

Placement

Set the unit up on an even surface away from direct sunlight, high temperatures, high humidity, and excessive vibration. These conditions can damage the cabinet and other components, thereby shortening the unit's service life.

Do not place heavy items on the unit.

Voltage

Do not use high voltage power sources. This can overload the unit and cause a fire.

Do not use a DC power source. Check the source carefully when setting the unit up on a ship or other place where DC is used.

AC mains lead protection

Ensure the AC mains lead is connected correctly and not damaged. Poor connection and lead damage can cause fire or electric shock. Do not pull, bend, or place heavy items on the lead.

Grasp the plug firmly when unplugging the lead. Pulling the AC mains lead can cause electric shock.

Do not handle the plug with wet hands. This can cause electric shock.

Foreign matter

Do not let metal objects fall inside the unit. This can cause electric shock or malfunction.

Do not let liquids get into the unit. This can cause electric shock or malfunction. If this occurs, immediately disconnect the unit from the power supply and contact your dealer.

Do not spray insecticides onto or into the unit. They contain flammable gases which can ignite if sprayed into the unit.

Service

Do not attempt to repair this unit by yourself. If sound is interrupted, indicators fail to light, smoke appears, or any other problem that is not covered in these operating instructions occurs, disconnect the AC mains lead and contact your dealer or an authorized service center. Electric shock or damage to the unit can occur if the unit is repaired, disassembled or reconstructed by unqualified persons.

Extend operating life by disconnecting the unit from the power source if it is not to be used for a long time.

This product may receive radio interference caused by mobile telephones during use. If such interference is apparent, please increase separation between the product and the mobile telephone.

THIS UNIT IS INTENDED FOR USE IN MODERATE CLIMATES.

WARNING:

TO REDUCE THE RISK OF FIRE, ELECTRIC SHOCK OR PRODUCT DAMAGE, DO NOT EXPOSE THIS APPARATUS TO RAIN, MOISTURE, DRIPPING OR SPLASHING AND THAT NO OBJECTS FILLED WITH LIQUIDS, SUCH AS VASES, SHALL BE PLACED ON THE APPARATUS.

The socket outlet shall be installed near the equipment and easily accessible or the mains plug or an appliance coupler shall remain readily operable.

CAUTION!

- **DO NOT INSTALL OR PLACE THIS UNIT IN A BOOKCASE, BUILT-IN CABINET OR IN ANOTHER CONFINED SPACE. ENSURE THE UNIT IS WELL VENTILATED. TO PREVENT RISK OF ELECTRIC SHOCK OR FIRE HAZARD DUE TO OVERHEATING, ENSURE THAT CURTAINS AND ANY OTHER MATERIALS DO NOT OBSTRUCT THE VENTILATION VENTS.**
- **DO NOT OBSTRUCT THE UNIT'S VENTILATION OPENINGS WITH NEWSPAPERS, TABLECLOTHS, CURTAINS, AND SIMILAR ITEMS.**
- **DO NOT PLACE SOURCES OF NAKED FLAMES, SUCH AS LIGHTED CANDLES, ON THE UNIT.**
- **DISPOSE OF BATTERIES IN AN ENVIRONMENTALLY FRIENDLY MANNER.**

CAUTION!

Do not place anything on top of this unit or block the heat radiation vents in any way. In particular, do not place tape decks or CD/DVD players on this unit as heat radiated from it can damage your software.

If you see this symbol-

Information on Disposal in other Countries outside the European Union



This symbol is only valid in the European Union. If you wish to discard this product, please contact your local authorities or dealer and ask for the correct method of disposal.

System	SC-HT40	SC-HT60
AV Control Receiver	SA-HT40	SA-HT60
Front speakers	SB-PF41	SB-FS61
Surround speakers	SB-PS41	SB-FS62
Center speaker	SB-PC40	SB-PC41
Subwoofer	SB-W40	SB-W40

Supplied accessories



Please check and identify the supplied accessories.

- | | |
|--|--|
| <input type="checkbox"/> 1 AC mains lead | <input type="checkbox"/> 1 FM indoor antenna |
| <input type="checkbox"/> 1 AM loop antenna | <input type="checkbox"/> 1 speaker sticker sheet |
| <input type="checkbox"/> 2 Batteries | <input type="checkbox"/> 1 Remote control (N2QAYB000010) |

SC-HT60

- | | |
|--|---|
| <input type="checkbox"/> 16 Screws | <input type="checkbox"/> 4 Stand bases |
| <input type="checkbox"/> 1 Speaker cable | <input type="checkbox"/> 2 Speaker stands with short cables |
| <input type="checkbox"/> 2 Speaker stands with long cables | |

The remote control

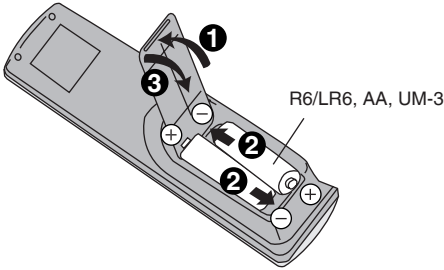

- Insert so the poles (+ and -) match those in the remote control.
- Do not use rechargeable type batteries.

Use

Aim at the sensor, avoiding obstacles, at a maximum range of 7 m directly in front of the unit.

Remote control signal sensor

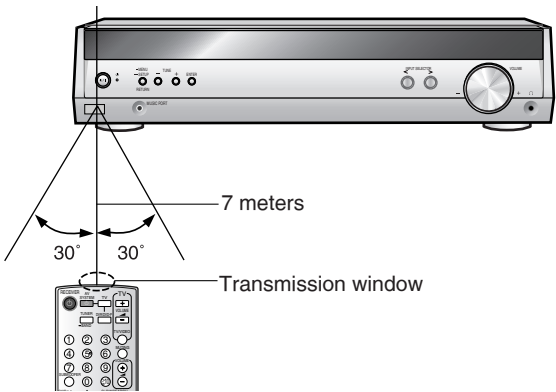

Note

- Keep the transmission window and the unit's sensor free from dust.
- Operation can be affected by strong light sources, such as direct sunlight, and the glass doors on cabinets.

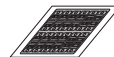

1 Placement of speakers.

Example: **SC-HT60**

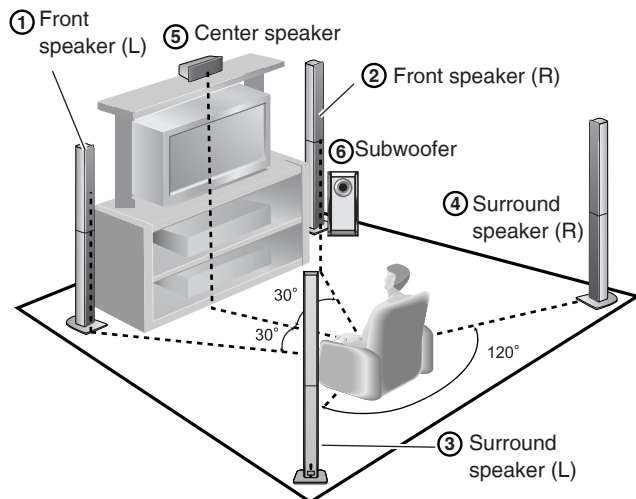

Positioning for best effect

How you set up your speakers can affect the bass and the sound field.

Note the following points.

- Place speakers on flat secure bases.
- Placing speakers too close to floors, walls, and corners can result in excessive bass. Cover walls and windows with a thick curtain.

Note

Keep your speakers at least 10 mm away from the system for proper ventilation.

Place the front, center, and surround speakers at approximately the same distance from the seating position. The angles in the diagram are approximate.

Front speakers (left, right)

Place on the left and right of the TV at seated ear height so that there is good coherency between the picture and sound.

Center speaker

Place underneath or above the center of the TV. Aim the speaker at the seating area.

Surround speakers (left, right)

Place on the side of or slightly behind the seating area, higher than ear level.

Subwoofer

The subwoofer can be placed in any position as long as it is at a reasonable distance from the TV.

Note that some experimentation can yield the smoothest low frequency performance. Placement near a corner can increase the apparent output level, but can result in unnatural bass.

If irregular colouring occurs on your television

The supplied speakers are designed to be used close to a television, but the picture may be affected with some televisions and setup combinations.

If this occurs, turn the television off for about 30 minutes.

The television's demagnetising function should correct the problem. If it persists, move the speakers further away from the television.

Caution

- The main unit and supplied speakers are only to be used as indicated in this manual. Failure to do so may lead to damage to the receiver and/or the speakers, and may result in the risk of fire. Consult a qualified service person if damage occurs or if a sudden change in performance is apparent.
- Do not attempt to attach these speakers to walls using methods other than those described in this manual.

2 Front and surround speaker assembly

SC-HT60

Attaching the stand to the base

- 1 Thread the speaker cable through the base.

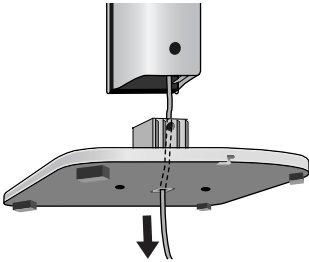

- 2 Secure the speaker stand to the base.

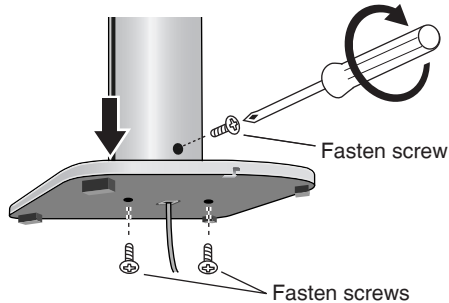

- 3 Fasten the speaker cable to the base.

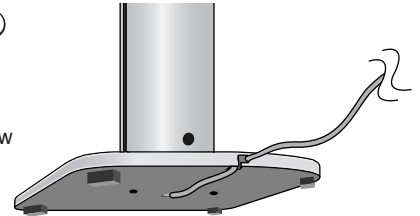

Attaching the speaker to the stand

Note

Before attaching, check the speaker label.

- **SB-FS61:** Use as front speakers. Attach the stands with the short cables.
- **SB-FS62:** Use as surround speakers. Attach the stands with the long cables.

- 1 Remove the cover from the bottom of the speaker and attach the speaker to the stand.

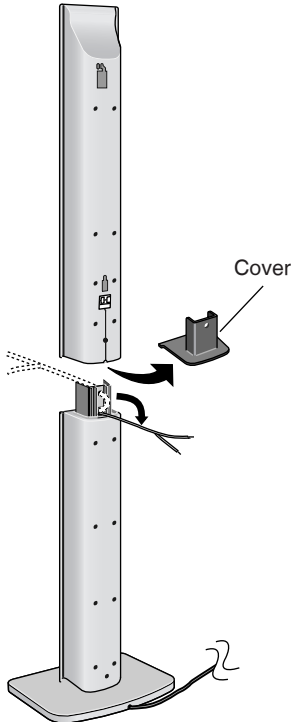

- 2 Secure the speaker to the speaker stand.

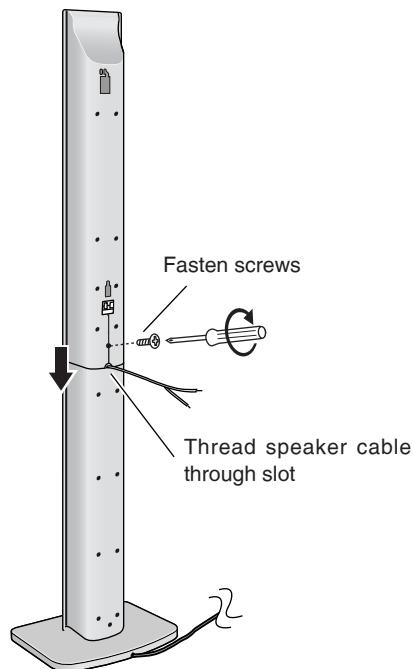

- 3 Connect the speaker cables.

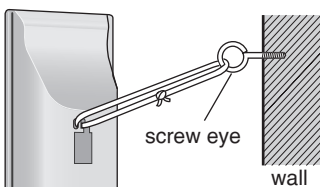
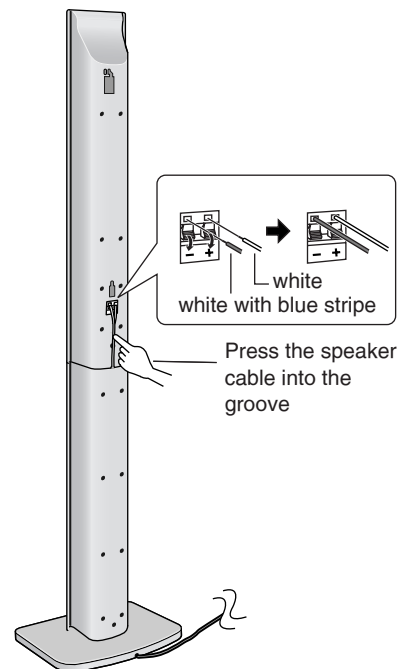

Preventing the speakers from falling over

Attach screw eyes (not included) to secure the speakers to a wall (diagram on the left).

- Obtain the screws appropriate to the walls and pillars to which they are going to be fastened.
- Consult with a qualified housing contractor concerning the appropriate procedure when attaching to a concrete wall or a surface that may not have strong enough support. Improper attachment may result in damage to the wall or speakers.

3 Attach the stickers to the speaker cables.

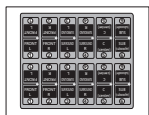

① Front speaker (L)
SC-HT40: SB-PF41
SC-HT60: SB-FS61

② Front speaker (R)
SC-HT40: SB-PF41
SC-HT60: SB-FS61

③ Surround speaker (L)
SC-HT40: SB-PS41
SC-HT60: SB-FS62

④ Surround speaker (R)
SC-HT40: SB-PS41
SC-HT60: SB-FS62

⑤ Center speaker
SC-HT40: SB-PC40
SC-HT60: SB-PC41

⑥ Subwoofer
(SB-W40)



About 10 cm

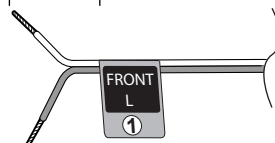

4 Connect the speakers to the receiver.

⊕ White cord
⊖ White cord with blue stripe

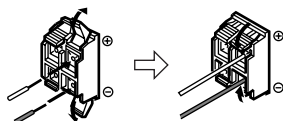

Note
Never short-circuit positive (+) and negative (-) speaker wires.

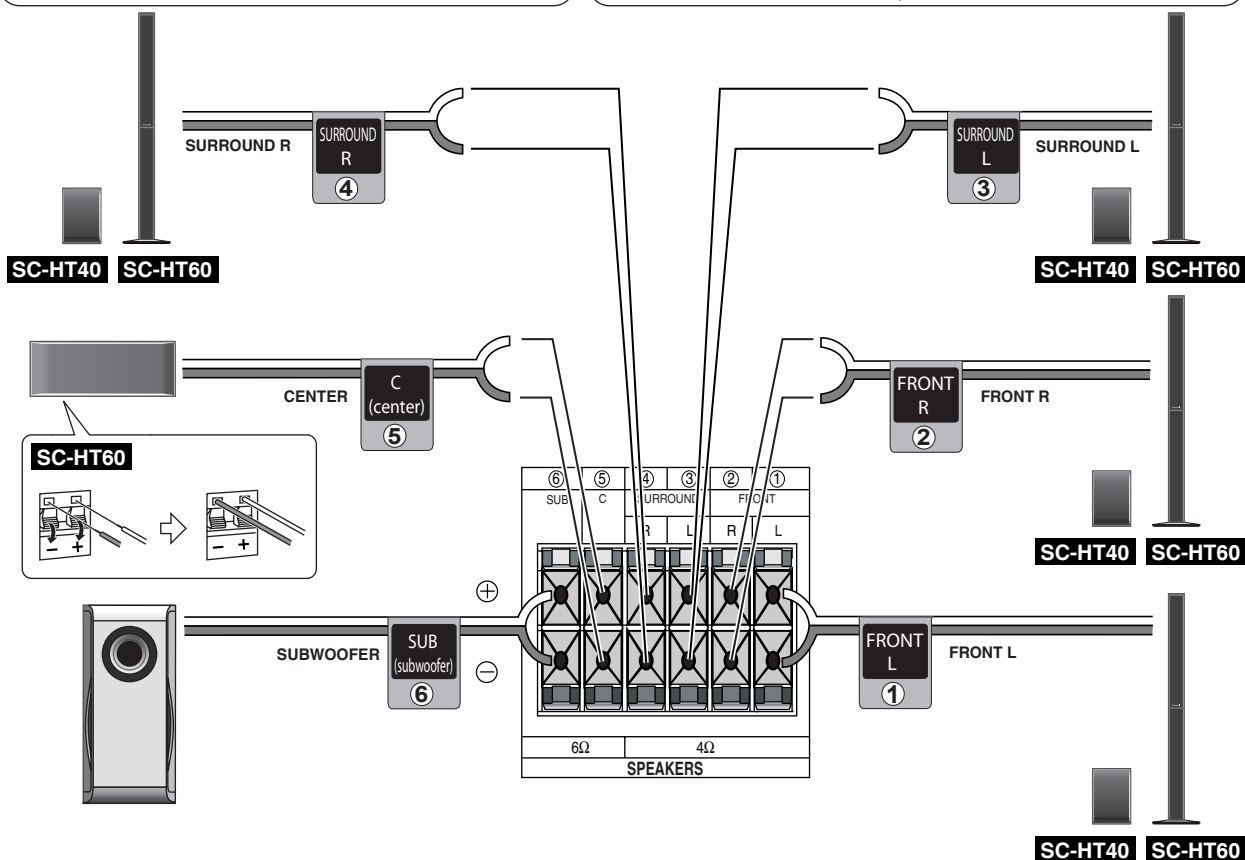

Other speaker setup options

Fitting optional speaker stands **SC-HT40**

e.g. Front and surround speakers

5mm, Pitch 0.8 mm

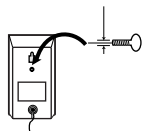

- Use the same screw type for the center speaker.
- The stands must be able to support over 10 kg.
- The stands must be stable even if the speakers are in a high position.

Attaching to a wall

Center speaker

SC-HT40

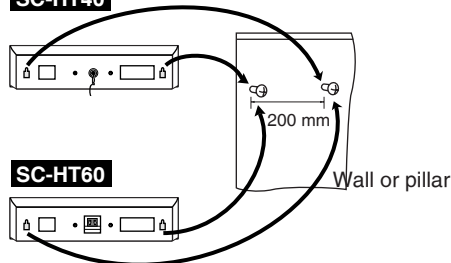

SC-HT60



Front and surround speakers

SC-HT40

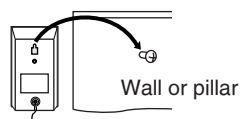

SC-HT60

Use new cables when attaching the speakers to the wall.

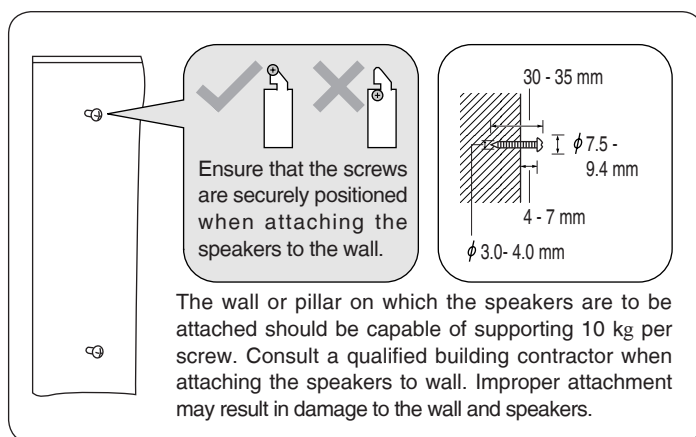

1 Secure the cover at the bottom of the speaker.

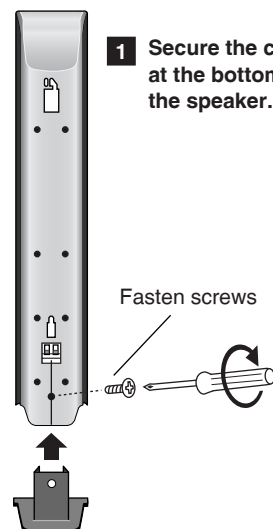

2 Press the speaker cable into the groove.

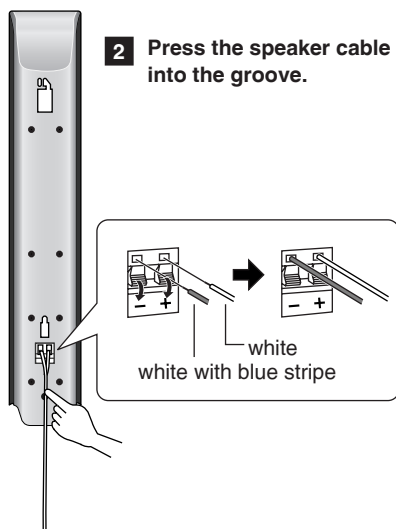

3 Fix screws at 335 mm apart onto the wall.

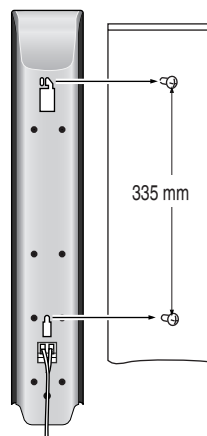

Step 2

Home theater connections

Other accessories

Stereo phono cable (not included)



Optical fibre cable (not included)



Coaxial cable (not included)



Turn off all components before making any connections.

To connect equipment, refer to the appropriate operating instructions.

Changing the digital input settings

You can change the input settings for the digital terminals if necessary. Note the equipment you have connected to the terminals, then change the settings. One of the terminals will remain unused, whatever the setting. (→ page 10)

Note

- Use digital connection to enjoy Dolby Digital or DTS.
- Do not bend the optical fibre cable.

Notes on digital input

This unit can decode the following signals:

- **Dolby Digital, DTS**
- **PCM, including PCM with sampling frequencies of 96 or 88.2 kHz**

It cannot decode:

- **Other digital signals, such as MPEG**
- **Dolby Digital RF signals from a laser disc player**

TV, DVR/DVD-P and Game/Aux

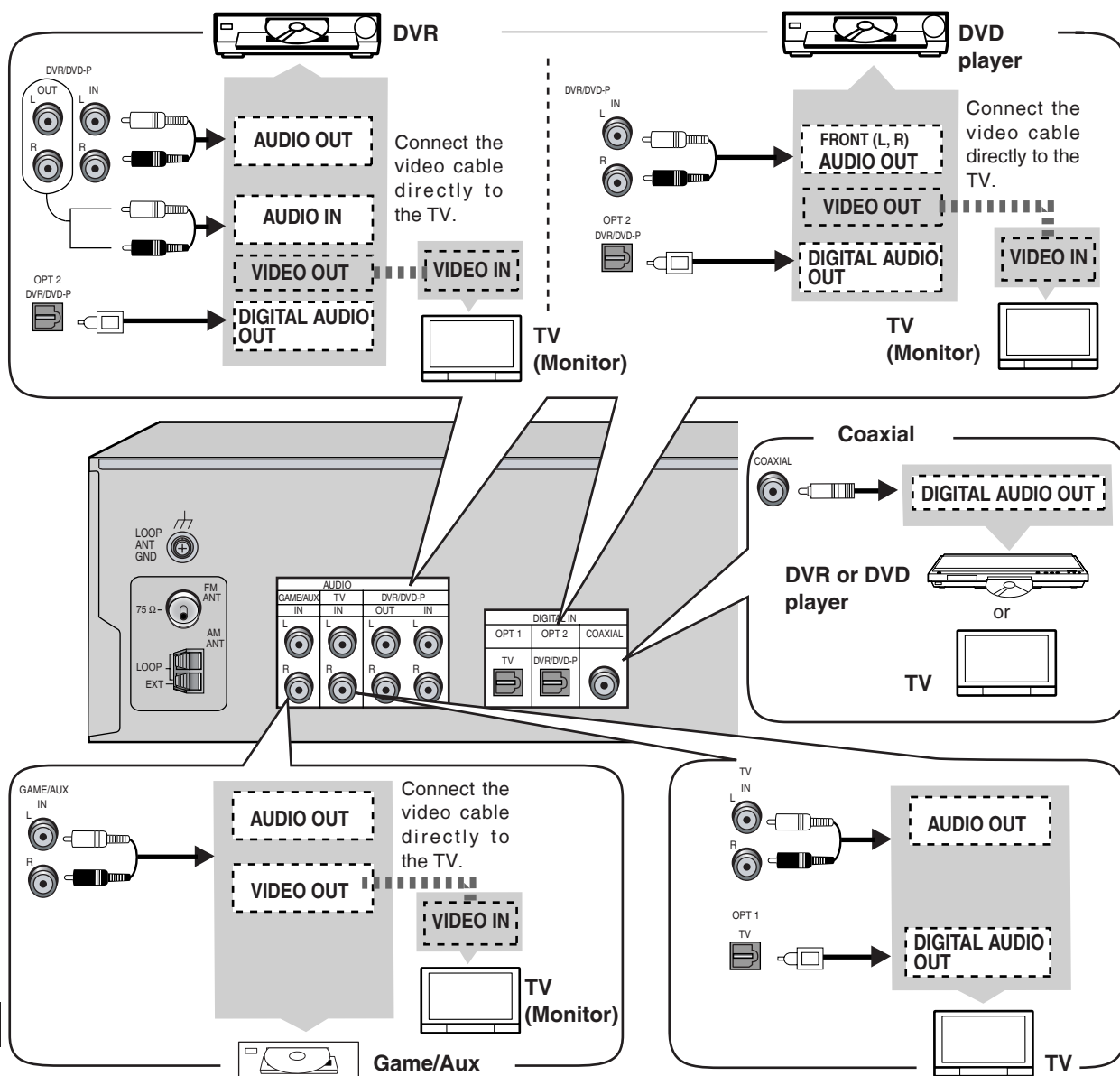

Step 3 Other connections

Supplied accessories

AC mains lead



FM indoor antenna



AM loop antenna



FM indoor antenna (included)

Adhesive tape
Fix the end of the antenna where reception is best.

For best reception

FM outdoor antenna (not included)

- Disconnect the FM indoor antenna.
- The antenna should be installed by a competent technician.

FM outdoor antenna

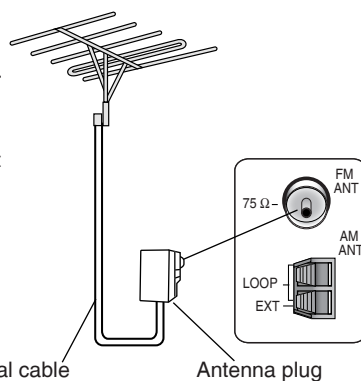

75 Ω coaxial cable

Antenna plug

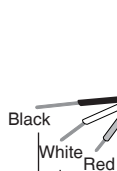
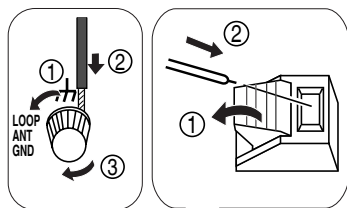

AM loop antenna (included)

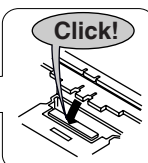

Keep the antenna cord away from DVD players and other cords.

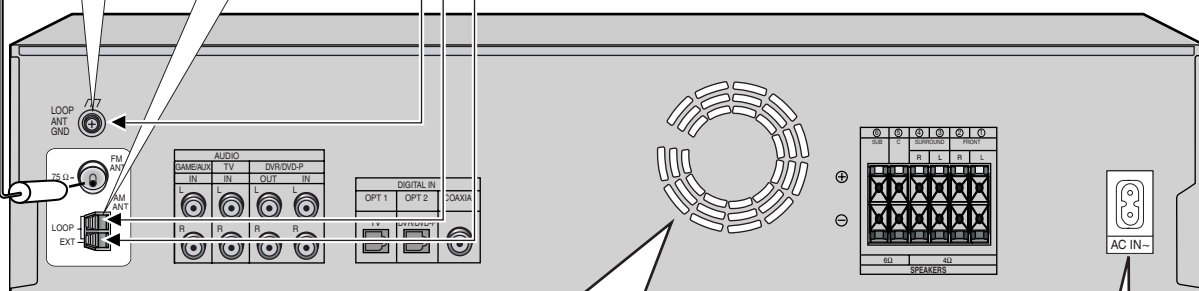

The cooling fan operates at high power output levels only.

AC mains lead (included)

Connect this cord after all other cables are connected.

Household AC mains socket
(AC 230-240 V/50 Hz)

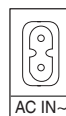

Conserving power

The unit consumes 1 W even when it is turned off with [⏻]. To save power when the unit is not to be used for a long time, unplug it from the household AC mains socket. You will need to reset some memory items after plugging in the unit.

Note

- The included AC mains lead is for use with this unit only. Do not use it with other equipment.
- Do not use an AC mains lead from any other type of equipment with this unit.

Step 4

Settings

Change the settings to suit your equipment to the environment in which you are using it. Before making any changes, read the descriptions of the settings, note the factory settings and ranges, and refer to the equipment's instructions.

DISTANCE

Enter the distance of the front, center and surround speakers from the seating position.

Change the distance so that the sound from all the speakers (except for the subwoofer) reaches you at the same time.

You can select distances between 1.0 and 10.0 m.

The factory settings are:

LR (front):	3.0 m (meters)
C (center):	3.0 m (meters)
S (surround):	1.5 m (meters)

Enter the setup mode.

- MENU
- SETUP

RETURN

Press and hold.

Select "DISTANCE".

TUNE
- +
 

DISTANCE

DIG INPUT (digital input)

Change the digital input settings for TV or DVR/DVD-P to coaxial if your equipment doesn't have an optical output terminal. (One of the terminals will remain unused, whatever the setting.)

The factory settings are:

TV:	OPT1
DVR (DVR/DVD-P):	OPT2

Select "DIG INPUT".

TUNE
- +
 

DIG INPUT

Adjusting speaker output level

C (center), SR (surround right) and SL (surround left) can be adjusted between -10 dB and +10 dB, with 0 dB being the level of the front speakers. Adjust center and surround output to the same apparent level of the front speakers.

For SUBW (subwoofer), you can select "SUBW - - -" so there is no output, "SUBW MIN" for minimum output, a level between 1 and 19, or "SUBW MAX" for maximum output. Adjust subwoofer output so it is balanced with the front speakers.

Subwoofer output is easily influenced by the source. You can also change its level while playing something for better effect (→ page 18).

Output the signal.

-LEVEL
-TEST

Press and hold.

TEST L

L - C - R - SR - SL - SUBW
↑

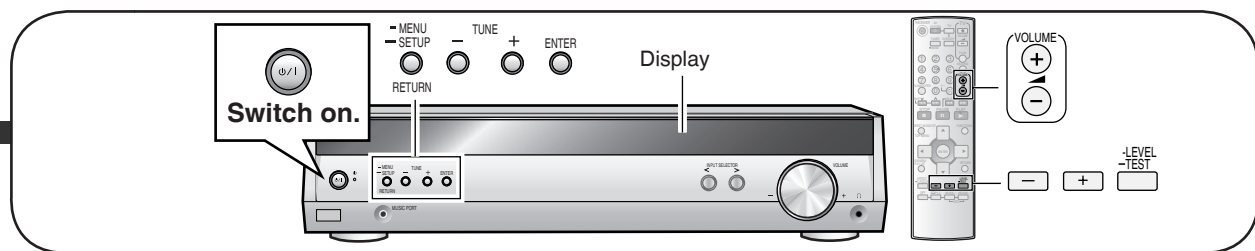

Select the speaker.

Change the setting.

Exit the setup mode.

Repeat for each speaker channel

Select the input position.

Change the setting.

Repeat for other input positions

Adjust the main volume.

Select the speaker channel.

Adjust the level.

Stop the test signal.

Repeat for each speaker channel

Basic operations

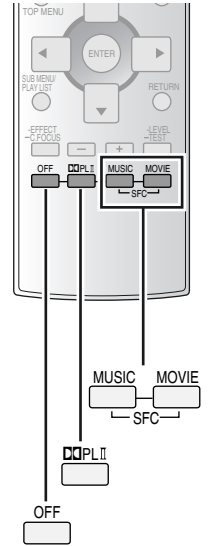
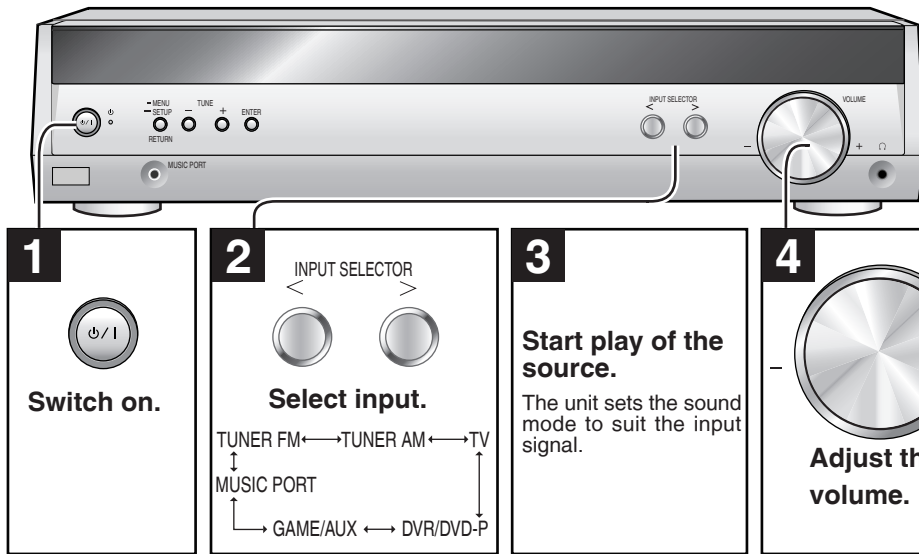

Adding surround effects to stereo sources

Using Dolby Pro LogicII

Dolby Pro LogicII processor works not only on sources recorded with Dolby Surround, but also on any stereo source.

Press **DOPLII** to select a mode from the table at right.

- To cancel, press [OFF].
- You can make fine surround settings when in the MUSIC or PANORAMA mode. (→ page 19)

DOPLII <input type="checkbox"/>	MOVIE Use this mode when playing movie software recorded in Dolby Surround.
	MUSIC Adds surround effects to stereo sources.
	PANORAMA Sound is spread out more so you feel like you are surrounded by music.

Using the Sound Field Control (SFC)

Enjoy an enhanced sound experience with greater presence and spread by using these SFC modes with PCM or analogue stereo sources.

Press **MUSIC** **MOVIE** **SFC** to select a mode from the tables at right.

- To cancel, press [OFF].
- You can adjust SFC effects. (→ page 19)

MUSIC <input type="checkbox"/>	LIVE Brings you up close for "live" stage performance and smoother vocals.
	POP/ROCK For pop, rock, and other music that has a punch to it.
	VOCAL For adding gloss to vocals.
	JAZZ Conveys the exciting and intimate atmosphere of a jazz club.
	DANCE For dance music and other sounds with a strong beat.
	PARTY This mode uses the front and surround speakers so that sound is in stereo regardless of the direction you are facing.

Note

- Dolby Pro LogicII and SFC modes remain in effect until you turn the mode off.
- When input is PCM with sampling frequencies of 96 or 88.2 kHz, you cannot add surround effects with Dolby Pro LogicII or SFC.
- When input is Dolby Digital or DTS, you cannot use SFC.

MOVIE <input type="checkbox"/>	DRAMA For dramas and other material where dialog is important.
	ACTION For action movies and other material where impact is important.
	SPORTS To make you feel like you were in the stadium.
	MUSICAL For musicals and other material where music is important.
	GAME Enjoy gaming with more impact.
	MONO For monaural sound.

Control guide

Remote control

This page describes the buttons used to control this unit.
See the guide at page 22 for the buttons that control other units.

[⏻, RECEIVER]
Standby/on button.

[TUNER, -BAND]
For switching the remote control to TUNER mode and selecting TUNER. After selecting TUNER, press and hold to switch between FM and AM.

[1, 2, 3, 4, 5, 6, 7, 8, 9, 0]
To enter radio frequencies and channels.
[≥10, -/--]
To enter two digit channels.

[SUBWOOFER]
For selecting subwoofer level.

[◀◀, ∇, ▶▶, ^, SKIP]
For selecting preset radio channels.

[-EFFECT, -C.FOCUS]
Use when adjusting Dolby Pro LogicII or SFC effects. Press and hold to select center focus mode.
[-, +]
First select [-EFFECT] or [-LEVEL, -TEST], then press [-] or [+] to adjust.
[-LEVEL, -TEST]
Use when adjusting speaker level. Press and hold to start the speaker test signal.

[TV] [DVR/DVD-P]
Input mode and remote control mode buttons.

[MUTING]
To mute the volume.
[+, -, VOLUME]
To adjust the volume.

[TUNER DIRECT TUNING]
To enable selection of radio stations by frequency.

[OFF]
To cancel Dolby Pro LogicII and SFC.
[PLII]
For selecting a Dolby Pro LogicII mode: MOVIE, MUSIC or PANORAMA.
[MUSIC]
For selecting SFC modes: LIVE, POP/ROCK, VOCAL, JAZZ, DANCE or PARTY.
[MOVIE]
For selecting SFC modes: DRAMA, ACTION, SPORTS, MUSICAL, GAME or MONO.

Control guide

Main unit

Standby indicator [⏻]

When the unit is connected to the AC mains supply, this indicator lights up in standby mode and goes out when the unit is turned on.

Standby/on switch [⏻/⏻]

Press to switch the unit from on to standby mode or vice versa. In standby mode, the unit is still consuming a small amount of power.

[-MENU, -SETUP, RETURN]

- For entering menus to make various settings.
- For returning to previous menus.

[TUNE, -, +]

For tuning the radio and selecting menu or setup items.

Remote control signal sensor

[MUSIC PORT]

- You can playback sound from portable audio equipment.
- Reduce the volume to minimum before connecting and disconnecting the equipment.
- Use an audio cord for connection.

[ENTER]

Used during menu or setup operations.

Display

[TUNED, ST, MONO]

Radio indicators

TUNED: A station is tuned

ST: A stereo FM broadcast is tuned

MONO: You have switched to monaural mode to improve reception

[SLEEP]

Sleep timer indicator.

TUNED ST MONO

SLEEP

General display

Shows the input mode, radio frequency and other general information.

[kHz, MHz]

Frequency unit indicators
kHz: AM, or PCM sampling frequency
MHz: FM

[M]

Flashes or lights during presetting.

Making a recording

[INPUT SELECTOR, <, >]
For selecting input.

[VOLUME]
Volume control.

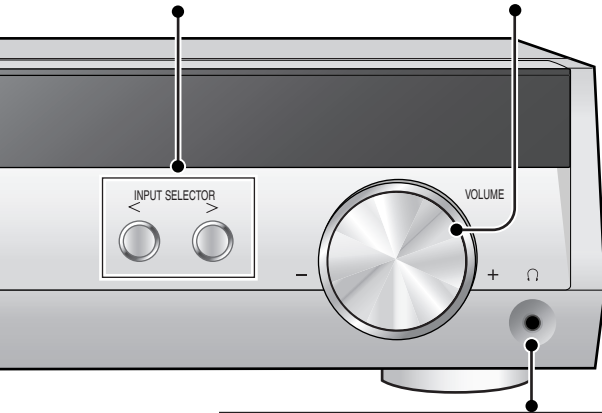

[Ω]
Headphone jack
Plug type: 3.5 mm stereo

- Sound does not come from the speakers if you connect headphones.
- Avoid listening for prolonged periods of time to prevent hearing damage.

[PCM, C. FOCUS]
PCM: Lights when the PCMFIX mode is set
C.FOCUS: Appears when you are using Center Focus

[DIGITAL INPUT]
Lights when input is digital.

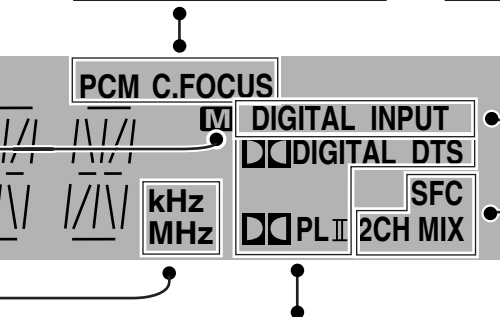

[DIGITAL, DTS, PL II]
Lights to indicate the source's input signal and decoding format used.
DIGITAL: Dolby Digital sources
DTS: DTS sources
PL II: Dolby Pro LogicII decoder is being used

[SFC, 2CH MIX]
SFC: Appears when you are using an SFC mode
2CH MIX: Appears when you are listening to a multi-channel source with headphones

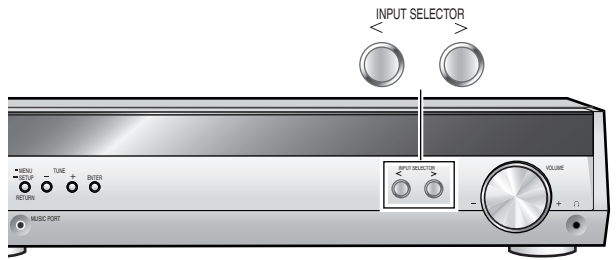

You can record to a unit connected to DVR/DVD-P OUT.
You can record any analog source except DVR/DVD-P IN.

1. Press **[INPUT SELECTOR < or >]** to select the source to be recorded.
2. **Begin recording.**
Follow your recording unit's operating instructions.
3. **Start the source to be recorded.**

Note

This unit cannot record digital sources. Connect through the analog terminals and select "ANALOG" input. (⇒ page 21)

The RESET function

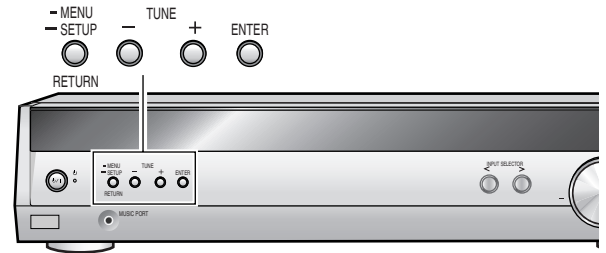

The operation settings for the unit will be initialized to the settings made at the time of shipment.
However, any preset radio stations will not be erased.

1. **Press and hold [-SETUP] to enter the setup menu.**
2. Press **[TUNE - or +]** to select "RESET" ⇒ **[ENTER]**.
3. Press **[TUNE - or +]** to select "RESET YES" ⇒ **[ENTER]**.
To cancel, select "RESET NO".

Manufactured under license from Dolby Laboratories.
"Dolby", "Pro Logic" and the double-D symbol are trademarks of Dolby Laboratories.

"DTS" and "DTS Digital Surround" are registered trademarks of Digital Theater Systems, Inc.

MENU operation

This is an outline of the operations you can perform with the MENU.

1 Press [-MENU] once.

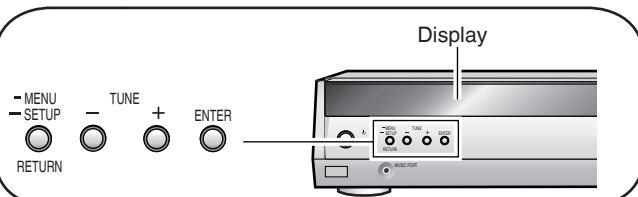

2 Main menu	3 Sub menu 1	4 Sub menu 2	5 Exit
<p>TUNE - + ENTER</p> <p>TUNER</p> <p>The radio ➡ page 17</p>	<p>TUNE - + ENTER</p> <p>FM MODE (TUNER FM only)</p> <p>MEMORY</p> <p>AUTO MEMO</p> <p>TUNE MODE</p> <p>AM STEP (TUNER AM only)</p> <p>BEAT PROOF (TUNER AM only)</p>	<p>TUNE - + ENTER</p> <p>AUTO</p> <p>MONO</p> <p>MEMO CH 1</p> <p>MEMO CH 30</p> <p>CANCEL</p> <p>START</p> <p>MANUAL</p> <p>PRESET</p> <p>AM STEP 9 kHz</p> <p>AM STEP 10 kHz</p> <p>MODE 1</p> <p>MODE 2</p>	<p>-MENU -SETUP RETURN ENTER</p> <p>Press repeatedly until "EXIT" appears.</p> <p>EXIT</p> <p>Press [ENTER] to completely exit the menu mode.</p>
<p>BASS 0</p> <p>Adjust the bass ➡ page 18</p>	<p>BASS -10</p> <p>BASS +10</p>		
<p>TREBLE 0</p> <p>Adjust the treble ➡ page 18</p>	<p>TREBLE -10</p> <p>TREBLE +10</p>		
<p>BALANCE</p> <p>You can adjust the balance of the front speakers ➡ page 18</p>	<p>L ? R</p>		
<p>DIMMER OFF</p> <p>Dim the display for better viewing in a darkened room ➡ page 20</p>	<p>DIMMER OFF</p> <p>DIMMER 1</p> <p>DIMMER 2</p> <p>DIMMER 3</p>		<p>Press repeatedly until "EXIT" appears.</p> <p>EXIT</p>
<p>SLEEP OFF</p> <p>The SLEEP timer can turn the unit off after a set time ➡ page 20</p>	<p>SLEEP OFF</p> <p>SLEEP 30</p> <p>SLEEP 60</p> <p>SLEEP 90</p> <p>SLEEP 120</p>		<p>Press [ENTER] to completely exit the menu mode.</p>

The radio

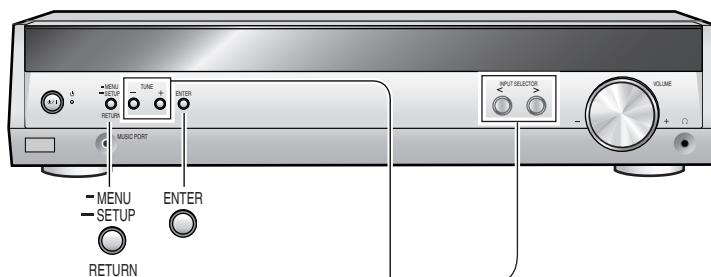
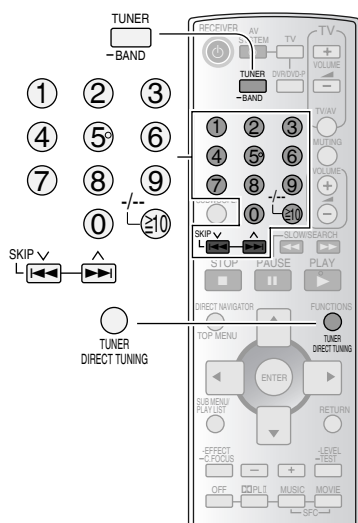

1

Press [INPUT SELECTOR < or >] to select "TUNER FM" or "TUNER AM".

2

Select the frequency.
Auto tuning starts if you press and hold the button.

Direct tuning

Input the frequency of the station.

Remote control

1. Press [TUNER, -BAND] to select "TUNER".
2. Press and hold [TUNER, -BAND] to select "TUNER FM" or "TUNER AM".
3. Press [TUNER DIRECT TUNING].
4. Press the numbered buttons to enter the frequency.

e.g. To select 107.90 MHz, press [1] → [0] → [7] → [9] → [0]

- If you do not press a button while the cursor is flashing, the display returns to the frequency being received.
- If the frequency has not been input correctly, "ERROR" will be displayed.

Automatic presetting

The FM stations the unit can receive are preset in channels 1 to 30. The AM stations the unit can receive are preset in channels 21 to 30 (FM stations are replaced if any were preset in these channels).

Preparation: Tune to either FM 87.50 MHz or AM 522 kHz.

Main unit

1. Press [-MENU] to select "TUNER" → "AUTO MEMO".
2. Press [TUNE - or +] to select "START" → [ENTER].
Select "CANCEL" to cancel.

The tuner presets all the stations it can receive into the channels in ascending order.

During automatic presetting, the memory indicator (M) flashes and the frequency scrolls. The memory indicator and channel numbers are displayed for a second when a station is preset. The last station to be preset is displayed when presetting finishes.

Manual presetting

Preset the stations one at a time.

Preparation: Tune to the station you want to preset.

Main unit

1. Press [-MENU] to select "TUNER" → "MEMORY".
2. Press [TUNE - or +] to select the channel → [ENTER].
("STORED" lights.)

For your reference

FM stations can also be preset in the MONO mode.

Selecting channels

Remote control

1. Press [TUNER, -BAND] to select "TUNER".
2. Press [SKIP √ or ^].

or

Press the numbered buttons.

For channels 1 to 9, press the corresponding number.

For channels 10 or over, press [≥10, -/-], then the two digits.

e.g. To select channel 21: [≥10, -/-] → [2] → [1]

Main unit

1. Press [-MENU] to select "TUNER" → "TUNE MODE".
2. Press [TUNE - or +] to select "PRESET" → [ENTER].
Select "MANUAL" to cancel.
3. After exiting the menu:
Press [TUNE - or +].

To change the AM frequency step

If you cannot tune to the correct AM frequency, change the frequency step to suit your area.

Main unit

1. Press [-MENU] to select "TUNER" → "AM STEP".
2. Press [TUNE - or +] to select "AM STEP 9 kHz" or "AM STEP 10 kHz" → [ENTER].

The radio (cont.)

Reducing excessive noise

■ During FM stereo reception

You can improve FM reception by switching reception to monaural.

Main unit

1. Press [-MENU] to select "TUNER" → "FM MODE".
2. Press [TUNE - or +] to select "MONO" → [ENTER].
Select "AUTO" to cancel.

■ During AM reception

When there is a lot of noise interference with an AM broadcast, try switching this mode.

Main unit

1. Press [-MENU] to select "TUNER" → "BEAT PROOF".
2. Press [TUNE - or +] to select "MODE 1" or "MODE 2" → [ENTER].

Sound field

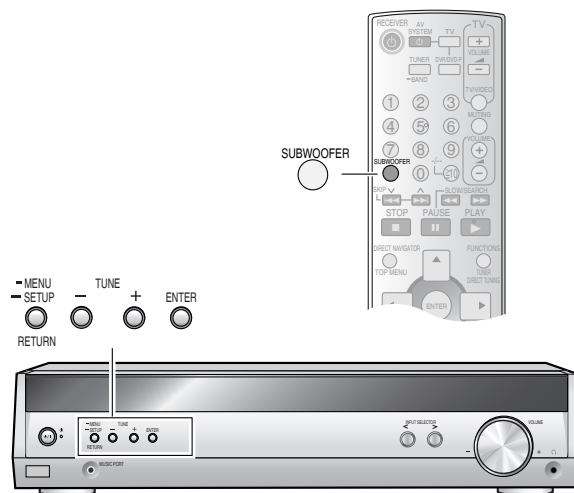

Adjusting the tone

You can adjust the level of the bass and treble.

Main unit

1. Use the menus to select "BASS" or "TREBLE".
→ MENU operation on page 16.
2. Press [-] or [+] to adjust the tone.

Input signals must be either analog or PCM, and Dolby Pro LogicII and SFC must be off (→ page 12).

Balance

You can adjust the balance of the front speakers.

Main unit

1. Use the menus to select "BALANCE".
→ MENU operation on page 16.
2. Press [-] or [+] to adjust the balance.

Subwoofer level

Remote control

Press [SUBWOOFER].

Adjust the level in 5 steps:

SUBW MIN, SUBW 5, SUBW 10, SUBW 15 and SUBW MAX.
Select "SUBW - - -" to stop output.

Note

Sound can be distorted if you raise the volume while subwoofer level is high. Reduce subwoofer level if this occurs.

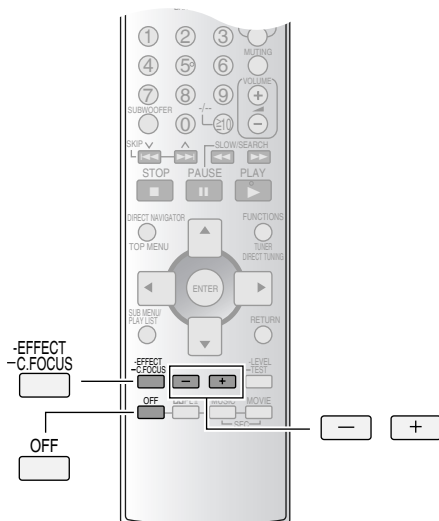

Dimension Control "DIMEN"

You can adjust the effect of the Dolby Pro LogicII MUSIC and PANORAMA modes (➡ page 12).

You can make up for differences in the output level of the front and surround speakers.

You can choose a level between -3 and +3: Increase the level to move sound to the front speakers, decrease to move it to the surround speakers.

The default level is 0.

Remote control

1. Press [-EFFECT, -C.FOCUS] to select "DIMEN".
2. Press [-] or [+] to adjust the effect.

Center Width Control "C-WIDTH"

You can adjust the effect of the Dolby Pro LogicII MUSIC and PANORAMA modes (➡ page 12).

This adjustment helps you realize a more natural sound image when listening to music. Move sound out into the front speakers to improve the overall front image, or add sound to the center speaker to fix the center image.

You can choose a level between 0 (the center speaker is dominant) and 7 (center sound is spread out).

The default level is 3.

Remote control

1. Press [-EFFECT, -C.FOCUS] to select "C-WIDTH".
2. Press [-] or [+] to adjust the effect.

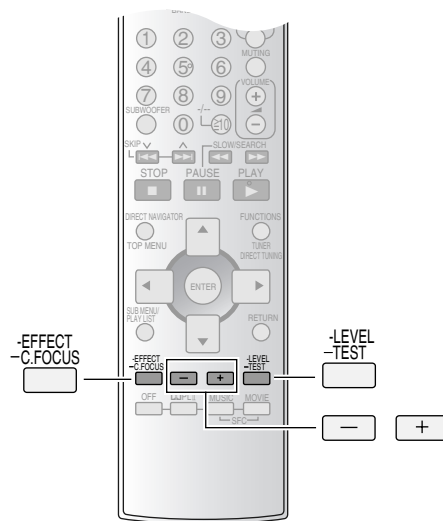

Center focus

Use with discs where the dialogue is recorded in the center channel.

You can make the sound of the center speaker seem like it is coming from within the television.

Remote control

Press and hold [-EFFECT, -C.FOCUS].

"C.FOCUS" lights.

The factory setting is off.

You cannot use this when the sound mode is STEREO.

Adjusting SFC effects

You can adjust the sound field by adjusting the level of the speakers and the delay time of the surround speakers. These adjustments can be made for each SFC mode (➡ page 12).

To adjust the speaker level

Remote control

1. Press [-LEVEL, -TEST] to select the speaker channel.

Each time you press the button:

C → SR → SL → SUBW



2. Press [-] or [+] to adjust the level.

C, SR, and SL: -10 dB to +10 dB

SUBW: - - - (off) ↔ MIN ↔ 1 - 19 ↔ MAX

To adjust the delay time

Remote control

1. Press [-EFFECT, -C.FOCUS].
2. Press [-] or [+] to change the delay time.

The default is 50 mSEC. (10 mSEC - 100 mSEC)

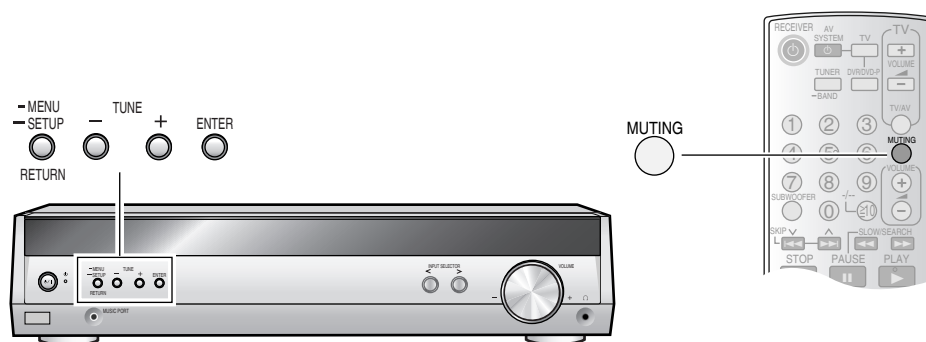

Sleep timer

The SLEEP timer can turn the unit off after a set time. It does not control any other components.

Main unit

1. Use the menus to select "SLEEP".
➔ MENU operation on page 16
2. Press [-] or [+] to select the time (in minutes).
The display changes as follows:
SLEEP OFF ↔ SLEEP 30 ↔ SLEEP 60 ↔ SLEEP 90 ↔ SLEEP 120

To check the setting

1. Press [-MENU] to enter the main menu.
2. Press [TUNE - or +] to select "SLEEP".
The time remaining appears.

To change the setting

Repeat the procedure from the beginning.

Dimmer

Dim the display for better viewing in a darkened room.

Main unit

1. Use the menus to select "DIMMER".
➔ MENU operation on page 16
2. Press [-] or [+] to select the level (1, 2, or 3) or OFF.

Muting

Remote control

Press [MUTING].

To cancel

Press [MUTING] again.

Muting also cancels when you switch the unit to standby.

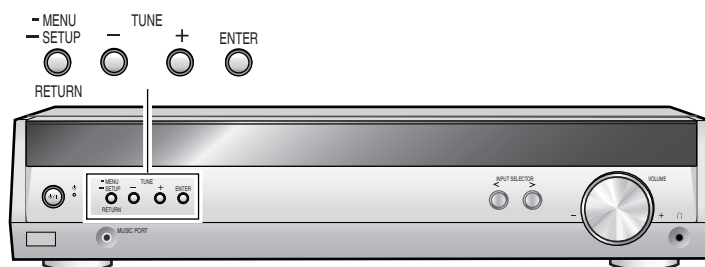

Setting descriptions

A INPUT MODE (Input mode)

This unit automatically detects whether input is digital or analog, but you can fix the input mode.

AUTO: The unit automatically detects whether input is digital or analog.

ANALOG: Select to make the unit accept analog input.

DIG: Select to make the unit accept digital input.

PCMFIX¹: Select to input to PCM.

B DRCOMP (Dynamic range compression)

Change this setting to listen to software recorded with Dolby Digital at low volume (such as late at night) and maintain audio clarity. It reduces the peak level in loud scenes without affecting the sound field.

OFF:

The software is played with the original dynamic range (factory setting).

STANDARD:

The level recommended by the producer of the software for household viewing.

MAX:

The maximum allowable compression (recommended for night viewing).

C ATTENUATOR (A/D Attenuator)

Turn the A/D attenuator on if "OVERFLOW" lights frequently when using 2-channel analog input.

D DTS-PCM

If you are playing a DTS CD that contains both DTS and PCM, but it isn't playing properly, then select "YES".

If this causes noise to occur, return the setting to "NO". (This setting is effective for each digital source.)

Changing the settings

1. Press and hold [-SETUP] to enter the setup menu.
2. Press [TUNE - or +] to select the item you want to change → [ENTER].
3. Change the settings.

A INPUT MODE

1. Press [TUNE - or +] to select "TV" or "DVR" → [ENTER].
2. Press [TUNE - or +] to change the setting.
The display changes as follows:
AUTO ↔ ANALOG ↔ DIG ↔ PCMFIX

B DRCOMP

Press [TUNE - or +] to select "OFF", "STANDARD" or "MAX".

C ATTENUATOR

Press [TUNE - or +] to select "OFF" or "ON".

D DTS-PCM

Press [TUNE - or +] to select "NO" or "YES".

4. Press [RETURN] repeatedly until "EXIT" appears → [ENTER].

¹In rare cases, the unit may have trouble recognizing PCM signals and this may cause the beginnings of tracks to be cut off. Select "PCMFIX" if this occurs.

- With DTS, the signals may not be recognized at all. Engage the DTS FIX mode if this occurs.

To engage the DTS FIX mode:

Press and hold [-MENU] and [ENTER] at the same time.

"DTS" lights.

To cancel the DTS FIX mode:

Press and hold [-MENU] and [ENTER] at the same time.

The mode cancels when input mode is set to AUTO or when the unit is turned off.

Note

When a FIX mode is on, the unit cannot process other signals. This may cause noise to be output. If this occurs, select an input mode other than PCMFIX, or cancel the DTS FIX mode.

Remote control operation guide

This remote control can operate Panasonic DVD recorders, DVD players, and televisions.

Note that this remote control cannot operate some equipment and that it may not be able to perform some operations.

Before using a Panasonic DVD recorder or player

DVD recorder

Change the remote control code to match the remote control code of the DVD recorder.

1. Check the remote control code of the DVD recorder.
2. For about one second hold down both [ENTER] and the numbered button ([1], [2] or [3]) (the same as the remote control code of the DVD recorder).

The factory setting is [1].

DVD player

Change the remote control code so you can operate a DVD player.

For about one second hold down both [ENTER] and [4].

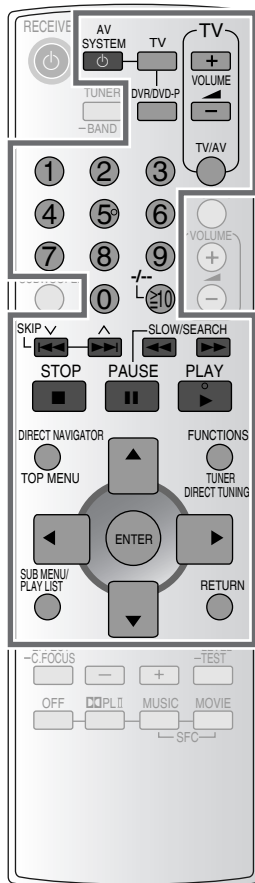

Watching DVDs/TV

Switch on



Switch on the television and select input

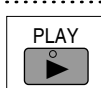
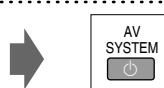

Switch on the player and start play

Switch off



Operating the DVD recorder/DVD player



Show disc menus



Show disc menus

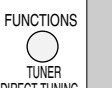

Show player menus

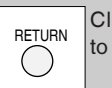

Clear menus or return to previous menus



Stop play



Pause play

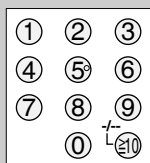
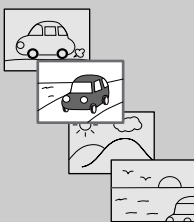

Start play from a selected item

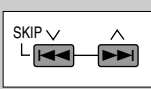

Skip items during play



Search through the disc



Start slow-motion play



To view frame-by-frame

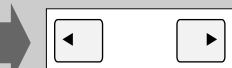

Operating the TV

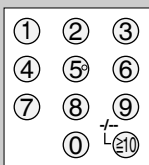

Select channels directly

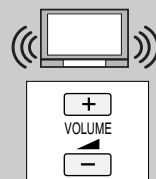

Adjust the volume

Specifications (DIN 45 500)

■ AMPLIFIER SECTION

RMS output power of each channel driven

10 % total harmonic distortion	
1 kHz front CH	90 W per channel (4 Ω)
1 kHz surround CH	90 W per channel (4 Ω)
1 kHz center CH	220 W per channel (6 Ω)
100 Hz subwoofer CH	220 W per channel (6 Ω)
Total RMS output power	800 W

Rated minimum sine wave RMS power output

1% total harmonic distortion (Dolby Digital mode)	
1kHz front CH	50 W per channel (4 Ω)
1kHz surround CH	50 W per channel (4 Ω)
1kHz center CH	150 W per channel (6 Ω)
100 Hz subwoofer CH	150 W per channel (6 Ω)
Total RMS output power	500 W

Total harmonic distortion

Half power at 1 kHz (Front CH)	0.5 % (4 Ω)
--------------------------------	-------------

Input sensitivity

GAME/AUX, TV, DVR/DVD-P	450 mV, IHF'66
MUSIC PORT	250 mV, IHF'66

S/N at rated power (4 Ω)

GAME/AUX, TV, DVR/DVD-P	80 dB (85 dB, IHF'66)
MUSIC PORT	70 dB (85 dB, IHF'66)

Input impedance

GAME/AUX, TV, DVR/DVD-P, MUSIC PORT	47 kΩ
-------------------------------------	-------

Tone controls

BASS	50 Hz, +10 to -10 dB
TREBLE	20 kHz, +10 to -10 dB

Digital input	OPTICAL	2
	COAXIAL	1

■ FM TUNER SECTION

Frequency range

87.50 MHz to 108.00 MHz

Sensitivity

S/N 30 dB	1.9 μV/75 Ω
S/N 26 dB	1.8 μV/75 Ω
S/N 20 dB	1.6 μV/75 Ω

IHF usable sensitivity

(IHF '58) 2.2 μV/75 Ω

IHF 46 dB stereo quieting sensitivity

22 μV/75 Ω

Total harmonic distortion

MONO	0.2%
STEREO	0.3%

S/N

MONO	60 dB (71 dB, IHF)
STEREO	58 dB (65 dB, IHF)

Frequency response

20 Hz to 15 kHz, +1 dB, -2 dB

Image rejection at 98 MHz

40 dB

IF rejection at 98 MHz

70 dB

Stereo separation (1 kHz)

40 dB

Antenna terminal

75 Ω (unbalanced)

■ AM TUNER SECTION

Frequency range

522 kHz to 1611 kHz (9 kHz steps)

530 kHz to 1620 kHz (10 kHz steps)

Sensitivity

500 μV/m

Selectivity (at 999 kHz)

30 dB

■ SPEAKER SECTION

Front and surround speakers (SC-HT40: SB-PF41, SB-PS41)

Type

1 Way, 1 Speaker, Bass-ref.

Speaker unit

Full range	6.5 cm cone type x 1, 4 Ω
Input power (IEC)	90 W (Max)

Output sound pressure level

76 dB/W (1.0 m)

Frequency range

110 Hz to 22 kHz (-16 dB)

120 Hz to 21 kHz (-10 dB)

Dimensions (W x H x D)

92 mm x 135 mm x 95.4 mm

Mass

[SB-PF41]: 0.65 kg
[SB-PS41]: 0.7 kg

Front speaker (SC-HT60: SB-FS61)

Type

2 Way, 2 Speaker, Bass-ref.

Speaker unit

Full range	6.5 cm cone type x 1, 4 Ω
Tweeter	6 cm cone type x 1, 4 Ω

Input power (IEC)

90 W (Max)

Output sound pressure level

82 dB/W (1.0m)

Frequency range

85 Hz to 45 kHz (-16 dB)

100 Hz to 40 kHz (-10 dB)

Dimensions (W x H x D)

250 mm x 1125 mm x 234 mm

Mass

3.6 kg

Surround speaker (SC-HT60: SB-FS62)

Type

1 Way, 1 Speaker, Bass-ref.

Speaker unit

Full range	6.5 cm cone type x 1, 4 Ω
Input power (IEC)	90 W (Max)

Output sound pressure level

80 dB/W (1.0m)

Frequency range

85 Hz to 45 kHz (-16 dB)

95 Hz to 40 kHz (-10 dB)

Dimensions (W x H x D)

250 mm x 1125 mm x 234 mm

Mass

3.6 kg

Center speaker (SC-HT40: SB-PC40)

Type

1 Way, 2 Speaker, Bass-ref.

Speaker unit

Full range	6.5 cm cone type x 2, 6 Ω
Input power (IEC)	220 W (Max)

Output sound pressure level

82 dB/W (1.0 m)

Frequency range

110 Hz to 22 kHz (-16 dB)

120 Hz to 20 kHz (-10 dB)

Dimensions (W x H x D)

270 mm x 92 mm x 95.4 mm

Mass

1.3 kg

Center speaker (SC-HT60: SB-PC41)

Type

1 Way, 2 Speaker, Bass-ref.

Speaker unit

Full range	6.5 cm cone type x 2, 6 Ω
Input power (IEC)	220 W (Max)

Output sound pressure level

85 dB/W (1.0 m)

Frequency range

95 Hz to 40 kHz (-16 dB)

110 Hz to 36 kHz (-10 dB)

Dimensions (W x H x D)

270 mm x 92 mm x 95.4 mm

Mass

1.2 kg

Passive subwoofer (SB-W40)

Type

1 Way, 1 Speaker, Bass-ref.

Speaker unit (Woofer)

16 cm cone type, 6 Ω

Input power (IEC)

220 W (Max)

Output sound pressure level

78 dB/W (1.0 m)

Frequency range

31 Hz to 500 Hz (-16 dB)

38 Hz to 400 Hz (-10 dB)

Dimensions (W x H x D)

182 mm x 392 mm x 266 mm

Mass

3.7 kg

■ GENERAL

Power supply

AC 230 to 240 V, 50 Hz

Power consumption

120 W

Dimensions (W x H x D)

430 mm x 105 mm x 385 mm

Mass

3.8 kg

Power consumption in standby mode:

1 W

Notes:



- Specifications are subject to change without notice.
Mass and dimensions are approximate.
- Total harmonic distortion is measured by the digital spectrum analyzer.



Troubleshooting guide

Before requesting service, make the below checks.

If you can't fix the unit as described or if something not listed here occurs, contact your dealer.

Common problems		Pages
No power.	<ul style="list-style-type: none"> Ensure the AC mains lead is connected. 	9
No sound.	<ul style="list-style-type: none"> Turn the volume up. Check connections to speakers and other equipment. Select the correct source. Change the DIG INPUT setting to suit the type of connection you have made. Check that the digital signals can be decoded by this unit. Turn PCMFIX or DTS FIX off. An electrostatic discharge (ESD) may interrupt sound. Turn the unit off and on again. 	12 6, 8-9 12 10-11
Display is dim.	<ul style="list-style-type: none"> Check the DIMMER level. An electrostatic discharge (ESD) may cause the display to dim. Turn the unit off and on again. 	8 21 -
"OVERLOAD", "F70", or "F76" appears on the display.	<ul style="list-style-type: none"> Turn the unit off, disconnect the AC mains lead, and consult your dealer. 	-
"FAN LOCK" appears on the display.	<ul style="list-style-type: none"> Remove the object obstructing the cooling fan. 	9

Sound			Pages
Sound is not heard from the center, surround, or subwoofer speakers.		<ul style="list-style-type: none"> The source may be stereo. Use Dolby Pro LogicII or SFC. 	12
A ticking noise interrupts the sound.		<ul style="list-style-type: none"> The speaker wires are touching each other. Check all your speaker connections. 	6
Cannot use Dolby Pro LogicII or SFC.		<ul style="list-style-type: none"> You cannot use Dolby Pro LogicII or SFC when input is PCM with sampling frequencies of 96 or 88.2 kHz. 	12

Radio		Pages
<p>The radio cannot be tuned in or there is a lot of noise and interference.</p> 	<ul style="list-style-type: none"> • Connect the appropriate antenna. (You may need an outdoor antenna or one with more elements.) • Adjust the position of the FM or AM antenna. • Reduce the treble. • Turn off nearby televisions, video decks and DVD players. • Separate the antenna from other cables, leads, and appliances. • Try changing the sound mode or turning the modes off. 	<p>9</p> <p>9</p> <p>16, 18</p> <p>-</p> <p>-</p> <p>12</p>
<p>There is a lot of noise when listening to AM.</p> 	<ul style="list-style-type: none"> • Try changing the BEAT PROOF mode. 	<p>16, 18</p>
<p>The correct AM frequency cannot be tuned in.</p> 	<ul style="list-style-type: none"> • Change the frequency step. 	<p>16, 17</p>

Maintenance

If the surfaces are dirty

To clean this unit, wipe with a soft, dry cloth.

- Never use alcohol, paint thinner or benzine to clean this unit.
- Before using chemically treated cloth, carefully read the instructions that came with the cloth.

Matsushita Electric Industrial Co., Ltd.

Web Site: <http://www.panasonic.co.jp/global/>

En.

RQTV0110-1B

H0206AO1036