



ZAPRASZAMY NA :

www.techsystem.pl

tel./fax:

+48 33 816 73 62

tel:

+48 33 816 73 61

ELECTRONIC

TOOL

CATALOG

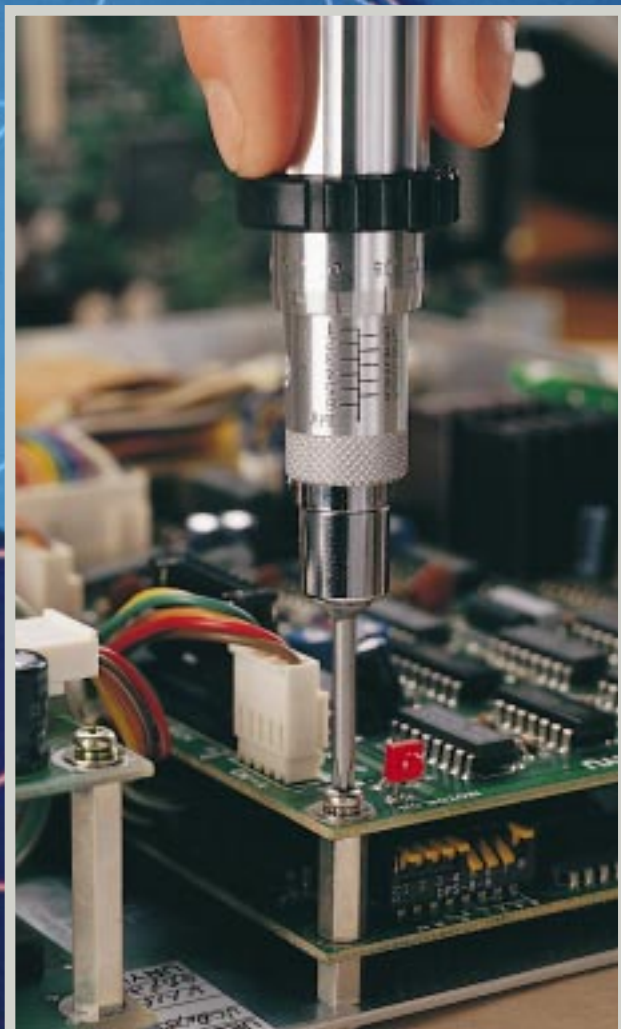



A I M C O

SCREWDRIVERS

Mechanical Torque Screwdrivers	6
Electric Screwdrivers	8
Pneumatic Screwdrivers	11
Pulse Screwdrivers	15
Battery Screwdrivers	19

QUALITY CONTROL IN TIGHTENING THREADED FASTENERS

Ensure repeatable and consistent tightening for quality control in your assembly applications with the AIMCO mechanical torque wrench series.



Torque Limiting Manual Screwdrivers

- Accurate and smooth rotary clutch disengages at the set torque.
- Lightweight and streamlined tool design ensures operator comfort and ease of use.
- Durable and high quality manufacturing for long tool life.
- 1/4" female hex spindles
- Accuracy is $\pm 3\%$ of indicated reading.

Two series are available:

TLSM Series - Micrometer Adjustable Torque Limiting Screwdriver - Allows assembly personnel to select the operating torque as required.

TLSP Series - Preset Torque Limiting Screwdriver - Preset to a specific torque value.

**ADDITIONAL
ENGLISH AND METRIC
MODELS NOW AVAILABLE
FOR ALL WRENCH
STYLES.**



SPECIFICATIONS													
MICROMETER ADJUSTABLE SERIES							PRESET SERIES						
Model	Range		Dir.		Length	Weight	Model	Range		Dir.	Length	Weight	
	Min-Max	Grad.	Min-Max	Grad.			Min-Max	Min-Max					
	In.Lbs.		Kgf.cm*				In.Lbs.	Kgf.cm					
TLSM-6	1 - 6	.025	1 - 6	.05	CW	3-7/8"	3.5 Oz	TLSP-12	4 - 10	4 - 12	CW	3-11/16"	3.25 Oz
TLSM-12	2 - 12	.05	2 - 12	.1	CW	4-9/16"	5.5 Oz	TLSP-26	10 - 22	10 - 26	CW	4"	5.25 Oz
TLSM-26	6 - 26	.1	6 - 26	.2	CW	5-1/2"	9.5 Oz	TLSP-50	20 - 40	20 - 50	CW	4-3/4"	10.5 Oz
TLSM-50	10 - 40	.25	10 - 50	.25	CW	6-1/8"	13 Oz						

*For Metric MicroMeter Adjustable Series add "A" at the end of Model Number



Click Wrench - Torque Indicating Ratchet Wrench Series

- Torque indicating tools provide a very repeatable and detectable action.
- Micrometer adjustable.
- Lightweight and streamlined tool design ensures operator comfort and ease of use.
- Overall length of the wrench is designed so the operator can comfortably apply torque without undue strain.
- 1/4" through 1/2" square drive sizes fit standard sockets
- Accuracy is $\pm 3\%$ of indicated reading.



S P E C I F I C A T I O N S										
Model	Min-Max	Range Grad.	Min-Max	Grad.	Direction	Hand Force	Sq. Drive	Length	Weight	
CWR-100	40 - 100 In Lbs	2 In Lbs	40 - 120 Kgf.cm*	2.3 Kgf.cm	CW	18.75 Lbs Max	1/4"	7.125"	.125 Lbs	
CWR-200	50 - 200 In Lbs	2.5 In Lbs	50 - 225 Kgf.cm*	2.9 Kgf.cm	CW	30 Lbs Max	1/4"	8.375"	.5 Lbs	
CWR-75F	15 - 75 Ft Lbs	1 Ft Lbs	200 - 900 Kgf.cm*	10 Kgf.cm	CW	85.75 Lbs Max	3/8"	12.75"	1.5 Lbs	
CWR-250F	30 - 250 Ft Lbs	2 Ft Lbs	4 - 28 Kgf.m*	0.2 Kgf.m	CW	131.5 Lbs Max	1/2"	38.5"	7.1 Lbs	

*For Metric Series add "A" at the end of Model Number

ELECTRA SERIES

- Ergonomic Design
- Excellent Torque Control
- Long Tool Life
- External Brush Replacement
- External Torque Adjustment
- UL Listed
- Direct Plug-In Style
- State of the Art Motor Design



S P E C I F I C A T I O N S

**PUSH-TO-START
DIRECT PLUG-IN**

Model	Fastening Torque (approx.)		Free Speed (approx.) rpm	Weight (approx.)		Length (approx.)		Bit-Shank	Power Source
	kgf-cm	in-lbs		lb	kg	mm	in		
AE-1411	3~16.1	2.6~14	1,000	1.6	.72	273	10.7	1/4" HEX	AC
AE-2411	6.9~29.9	6.0~23.4	1,000	1.6	.72	273	10.7	1/4" HEX	110/120V*
AE-1511HS	4~17.3	3.5~15	1,900	1.6	.72	273	10.7	1/4" HEX	60Hz

* 220V available upon request.

**LEVER
START**

Model	Fastening Torque (approx.)		Free Speed (approx.) rpm	Weight (approx.)		Length (approx.)		Bit-Shank	Independent Power Supply
	kgf-cm	in-lbs		lb	kg	mm	in		
AE-2000	4~1.5	.35~1.3	720	0.7	.31	204	8.0	∅ 2mm ¹	110-220 VAC
AE-4500	1.5~9.4	1.3~8.2	720	0.7	.31	204	8.0	1/4" HEX	110-220 VAC
AE-7000	7~20.1	6.1~17.4	750	1.4	.64	237	9.3	1/4" HEX	110-220 VAC
AE-8000	12~30	10.4~26	550	1.4	.64	237	9.3	1/4" HEX	110-220 VAC

¹ 1/4" bit adapter available. Order part no. AE-2000BA

ANGLE

Model	Fastening Torque (approx.)		Free Speed (approx.) rpm	Weight (approx.)		Length (approx.)		Bit-Shank	Angle Height	
	kgf-cm	in-lbs		lb	kg	mm	in		mm	in
AE-7000A	7.5~20.7	6.5~18	550	2.0	.91	325	12.8	1/4" HEX	35	1 3/8
AE-8000A	12.7~32.3	11~28	400	2.0	.91	325	12.8	1/4" HEX	35	1 3/8

**TORQUE
ADJUSTER
COVER**

Model	Part Number
AE-1411/ 1511HS/ 2411	AE-TC1424
AE-2000/ 4500	AE-TC2045
AE-7000/ 8000	AE-TC7080

**PISTOL GRIP
ADAPTERS**

Model	Part Number
AE-1411/ 1511HS/ 2411	AE-PG1424
AE-7000/ 8000	AE-PG7080

ELECTRA DC BRUSHLESS SERIES

- **Approved for Clean Room**

Environment - Can be used in Clean Room to Class 100.

- **High Reliability and Long Tool**

Life - Use of brushless electric motor and non-mechanical switch insures reliable long life and low maintenance.

- **Adjustable RPM Selection**

Allows you to choose which RPM is best suited for proper fastening speed and operator control.

- **Soft Start Selection**

Allows the choice of engaging fastener at an initial RPM for early thread engagement.



CR-PS CONTROLLER



CE-350

CR-1000
CR-1100
CR-1200

S P E C I F I C A T I O N S

Model	Fastening Torque (approx.)		Free Speed (no load) (approx.) rpm	Weight (approx.)		Length (approx.)		Bit-Shank
	kgf-cm	in-lbs		lb	kg	mm	in	
CE-350*	.86~4.0	.75~3.5	730	0.4	.20	160	6.3	∅ 2.5MM***
CR-1000	2.5~7.5	2.2~6.7	300~1,000**	1.4	.64	267	10.5	1/4" HEX
CR-1100	4~17	3.4~14.7	600~2,100**	1.4	.64	267	10.5	1/4" HEX
CR-1200	7~27	6.1~23.4	300~1,000**	1.4	.64	267	10.5	1/4" HEX

*CE-350 contains sealed brush-type motor. Not certified for Class 100 use.

**R.P.M. selection dial and soft start selection switch on Power Supply Unit

***1/4" bit adapter option available. Order no. AE-350BA

Model	Power Source	Dimensions (W x H x D) (in)	Weight (approx.)		Available for Driver Models
			lb	kg	
AE-PSL*	AC 110/120V, 60Hz	3 x 4-1/4 x 6-1/4	6.2	2.8	CE-350
CR-PS	AC 110/120V, 60Hz	3-3/4 x 2 x 7-3/4	1.6	0.7	CR-Models

*AE-PSL does not come standard with the tool. Must be ordered separately.

SLIP CLUTCH ELECTRIC SCREWDRIVER

AIMCO's Electra Series Model AE-2015 electric screwdriver offers high-speed performance for quick and consistent assembly and disassembly. To maximize ergonomics and convenience, this driver offers a combination of a slip clutch with a high speed motor to provide low torque reaction and the best power-to-weight ratio in the industry.

To insure tool reliability, an LED light notifies the operator when to change brushes. And as a safety feature, the brush cap contains a switch which shuts off the power during brush replacement.

- Direct 110V or 220V Plug-In - Eliminates the need for a bulky external power supply.
- 1/4" Hex Quick Change Chuck - Allows easy bit replacement.
- External Torque Collar - Allows easy torque adjustment.



SPECIFICATIONS							
Model	Torque Range		RPM	Length	Weight	Diameter	Power Source
	in-lbs	Kgf-cm		in.	lbs.	in.	
AE-2015	2.0 - 15.0	2.3 - 18.0	1,000	9.2	1.2	1.35	115VAC 50/60Hz
AE-2015V	2.0 - 15.0	2.3 - 18.0	1,000	9.2	1.2	1.35	220VAC 50/60Hz



TORQUE CONTROL "LITE TOUCH" SERIES

INLINE PUSH-TO-START TYPE

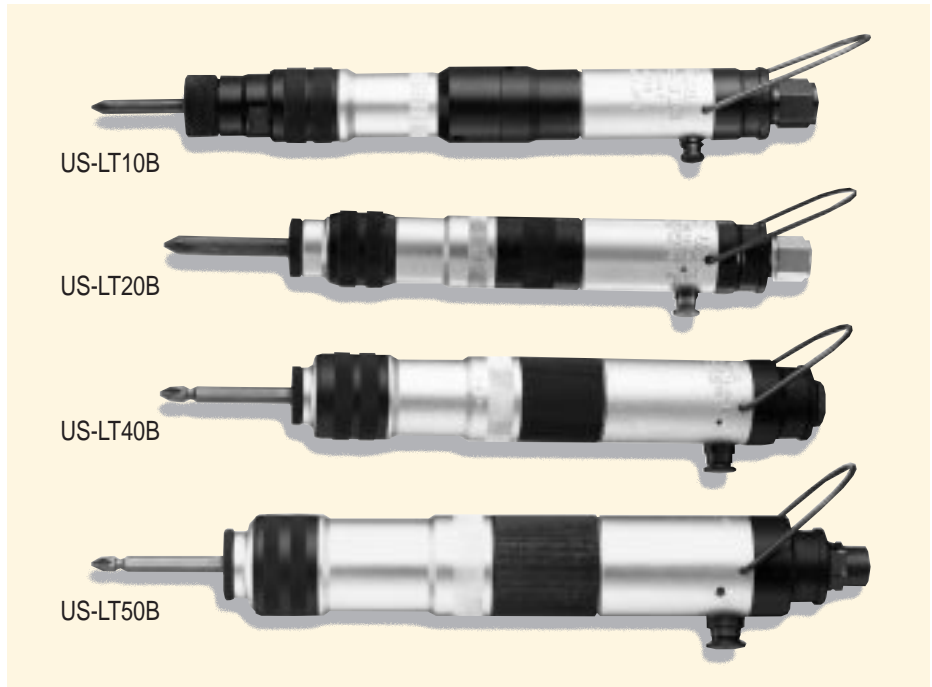

ERGONOMIC
NEOPRENE GRIPS
STANDARD WITH
MODELS LT10B -
LT40B SERIES

US-LT30B-11

Recommended Air Pressure: 85 psi

S P E C I F I C A T I O N S											
Model	Torque Range (approx.) (Soft Joint)		Free Speed (approx.)	Overall Length (approx.)		Weight (approx.)		From Center to Outside (approx.)		Noise Level dB(A)	Average Air Consumption ft ³ /min
	Nm	in-lbs	rpm	mm	in	lb	kg	mm	in		
US-LT10B	0.20-0.59	1.7-5.2	1,000	191	7.5	0.6	0.3	12	0.5	70	5.2
US-LT20B-10	0.15-1.08	1.3-9.5	1,000	180	7.1	0.7	0.3	13	0.5	71	5.6
US-LT20B-18	0.15-0.67	1.3-6.1	1,800	180	7.1	0.7	0.3	13	0.5	71	5.6
US-LT20B-26	0.15-0.34	1.3-3.0	2,600	180	7.1	0.7	0.3	13	0.5	71	5.6
US-LT30B-11	0.39-1.96	3.5-17.4	1,100	183	7.2	0.9	0.4	16	0.6	73	7.0
US-LT30B-17	0.39-1.47	3.5-13.0	1,700	183	7.2	0.9	0.4	16	0.6	73	7.0
US-LT30B-23	0.39-0.98	3.5-8.7	2,300	183	7.2	0.9	0.4	16	0.6	73	7.0
US-LT40B-08	0.98-3.92	8.7-34.7	800	205	8.1	1.4	0.6	17	0.6	74	10.5
US-LT40B-15	0.98-2.17	8.7-19.1	1,500	205	8.1	1.4	0.6	17	0.6	74	10.5
US-LT40B-21	0.98-1.67	8.7-14.8	2,100	205	8.1	1.4	0.6	17	0.6	74	10.5
US-LT50B-05	1.47-10.30	13.0-91.1	480	240	9.4	2.2	1.0	20	0.8	75	17.5
US-LT50B-08	1.47-5.40	13.0-47.7	800	240	9.4	2.2	1.0	20	0.8	75	17.5
US-LT50B-17	1.47-2.80	13.0-25.1	1,700	240	9.4	2.2	1.0	20	0.8	75	17.5

Each model is equipped with its standard clutch spring. Additional clutch springs specifications are available to provide a full torque range of each model on page 38.

Air Hose Size: 1/4" for US-LT10B - US-LT40B Series
3/8" for US-LT50B Series

Air Inlet Thread (Pipe Tap): 1/8" for US-LT10B - US-LT20B Series
1/4" for US-LT30B - US-LT50B Series

TORQUE CONTROL "LITE TOUCH" SERIES

PISTOL TYPE



US-LT31PB-05

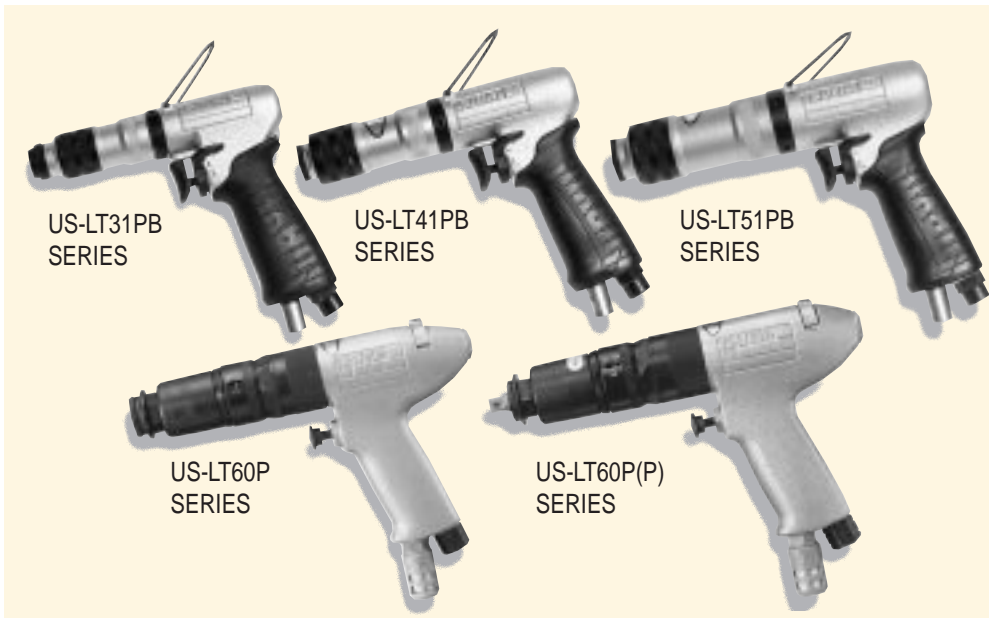

US-LT31PB
SERIES

US-LT41PB
SERIES

US-LT51PB
SERIES

US-LT60P
SERIES

US-LT60P(P)
SERIES



Torque Reaction Bar Standard
with US-LT60P Series

Recommended Air Pressure: 85 psi

S P E C I F I C A T I O N S

Model	Torque Range (approx.) (Soft Joint)		Free Speed (approx.) rpm	Overall Length (approx.)		Weight (approx.)		From Center to Outside (approx.)		Noise Level dB(A)	Average Air Consumption ft ³ /min
	Nm	in-lbs		mm	in	lb	kg	mm	in		
US-LT31PB-05	0.98~5.59	8.7~49.6	500	200	7.9	1.9	0.8	16.0	0.6	73	7.0
US-LT31PB-11	0.3 ~1.96	3.5~17.4	1,100	170	6.7	1.6	0.7	15.5	0.6	73	7.0
US-LT31PB-17	0.39~1.47	3.5~13.0	1,700	170	6.7	1.6	0.7	15.5	0.6	73	7.0
US-LT31PB-23	0.39~0.98	3.5~8.7	2,300	170	6.7	1.6	0.7	15.5	0.6	73	7.0
US-LT41PB-08	0.98~3.92	8.7~34.7	800	185	7.2	1.8	0.8	16.5	0.6	74	10.5
US-LT41PB-15	0.98~2.17	8.7~19.1	1,500	185	7.2	1.8	0.8	16.5	0.6	74	10.5
US-LT41PB-21	0.9 ~1.67	8.7~14.8	2,100	185	7.2	1.8	0.8	16.5	0.6	74	10.5
US-LT51PB-05	1.47~10.30	13.0~91.1	480	205	8.5	2.6	1.2	19.5	0.7	75	17.5
US-LT51PB-08	1.47~5.40	13.0~47.7	800	205	8.5	2.6	1.2	19.5	0.7	75	17.5
US-LT51PB-17	1.47~2.80	13.0~25.1	1,700	205	8.5	2.6	1.2	19.5	0.7	75	17.5
US-LT60P-03(P)	6.80~16.66	60.0 ~147.6	320	240	9.4	3.7	1.7	22.0	0.9	75	21.0
US-LT60P-07(P)	3.92~9.80	34.7~86.8	650	230	9.0	3.7	1.7	22.0	0.9	75	21.0
US-LT60P-11(P)	2.94~5.88	26.0~52.1	1,100	230	9.0	3.7	1.7	22.0	0.9	75	21.0

Each model is equipped with its standard clutch spring. Additional clutch springs specifications are available on page 38

(P) DENOTES 3/8" SQ. DRIVE FOR US-LT60P SERIES.

Air Hose Size: 1/4" for US-LT31PB & US-LT41PB Series
3/8" for US-LT31PB-05, US-LT51PB Series & US-LT60P Series

Air Inlet Thread (Pipe Tap) : N.P.T. 1/4"

TORQUE CONTROL "LITE TOUCH" SERIES

ANGLE AND LEVER TYPE



US-LT30B-11C

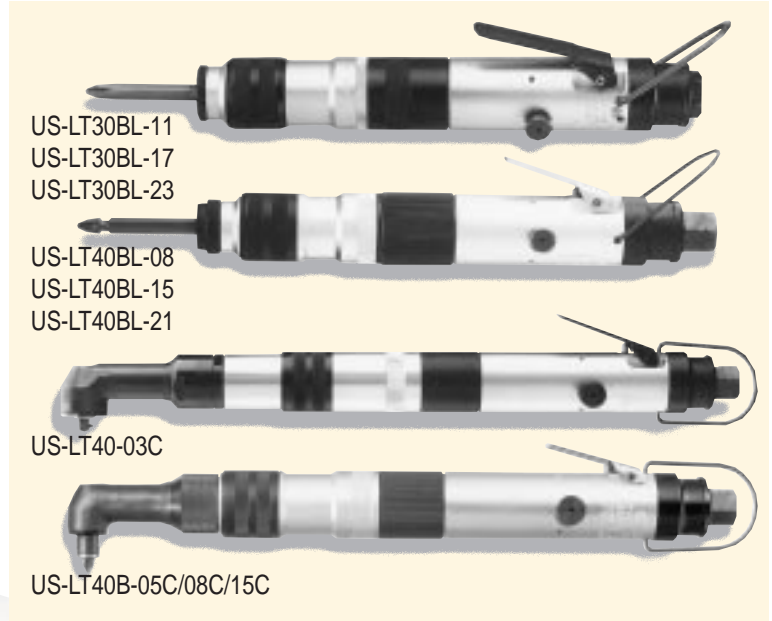

Recommended Air Pressure: 85 psi

S P E C I F I C A T I O N S												
Model	Torque Range (approx.) (Soft Joint)		Free Speed (approx.)	Overall Length (approx.)		Weight (approx.)		From Center to Outside (approx.)		Hex Bit or Drive Size	Noise Level dB(A)	Average Air Consumption ft ³ /min
	Nm	in-lbs	rpm	mm	in	lb	kg	mm	in	in		
US-LT30B-11C	0.39~2.74	3.5~24.3	1,100	273	10.7	1.5	0.7	10	0.4	1/4"	73	7.0
US-LT30B-17C	0.39~1.96	3.5~17.4	1,700	273	10.7	1.5	0.7	10	0.4	1/4"	73	7.0
US-LT40B-05C	2.26~5.60	20.0~49.5	500	322	13.0	2.1	0.9	13	0.5	1/4"	84	12.4
US-LT40B-08C	0.98~3.82	8.7~33.8	800	320	12.8	2.0	0.9	10	0.4	1/4"	74	10.5
US-LT40B-15C	0.98~2.06	8.7~18.2	1,500	320	12.8	2.0	0.9	10	0.4	1/4"	74	10.5
US-LT40-08C	0.98~3.82	8.7~33.8	800	320	12.8	2.0	0.9	10	0.4	1/4" Sq.	74	10.5
US-LT40-15C	0.98~2.06	8.7~18.2	1,500	320	12.8	2.0	0.9	10	0.4	1/4" Sq.	74	10.5
US-LT40-05C	2.26~5.60	20.0~49.5	550	322	13.0	2.1	0.9	13	0.5	1/4" Sq.	84	12.4
US-LT40-03C	4.90~9.80	43.4~86.8	315	360	14.2	2.4	1.1	13	0.5	1/4" Sq.	74	12.4
US-LT30BL-11	0.39~1.96	3.5~17.4	1,100	209	8.2	1.2	0.5	15	0.6	1/4"	73	7.0
US-LT30BL-17	0.39~1.47	3.5~13.0	1,700	209	8.2	1.2	0.5	15	0.6	1/4"	73	7.0
US-LT30BL-23	0.39~0.98	3.5~ 8.7	2,300	209	8.2	1.2	0.5	15	0.6	1/4"	73	7.0
US-LT40BL-08	0.98~3.92	8.7~34.7	800	231	9.1	1.5	0.7	17	0.7	1/4"	74	10.5
US-LT40BL-15	0.98~2.17	8.7~19.1	1,500	231	9.1	1.5	0.7	17	0.7	1/4"	74	10.5
US-LT40BL-21	0.98~1.67	8.7~14.8	2,100	231	9.1	1.5	0.7	17	0.7	1/4"	74	10.5

ANGLE

LEVER

Each model is equipped with its standard clutch spring. Additional clutch springs specifications are available on page 38

Angle Head Height: 36mm

Air Hose Size: 1/4" for all models

Air Inlet Thread (Pipe Tap): N.P.T. 1/4

US-LT SERIES

OPTIONAL CLUTCH SPRINGS

Model	Clutch Springs Provided		Torque Range Hard Joint		Clutch Spring Code Number
	Standard	Option	Nm	in/lbs	
US-LT10/10B	Black		0.20~0.59	1.7~5.2	976-379-0
US-LT20B-10	Black		0.34~1.08	3.0~9.5	976-432-0
		Red	0.20~0.67	1.7~6.1	976-431-0
		Yellow	0.15~0.34	1.3~3.0	976-430-0
US-LT20B-18	Red		0.24~0.67	2.2~6.1	976-431-0
		Yellow	0.15~0.34	1.3~3.0	976-430-0
US-LT20B-26	Yellow		0.15~0.34	1.3~3.0	976-430-0
US-LT31PB-05	Red		2.35~5.59	20.9~49.6	976-493-0
		Pink	0.98~2.74	8.7~24.3	976-471-0
US-LT30 Series, 1100 rpm	Blue		0.98~1.96	8.7~17.4	976-472-0
		Red	0.67~1.76	6.1~15.6	976-493-0
		Pink	0.39~0.98	3.5~8.7	976-471-0
		Black (not included)	1.22~2.74	10.8~24.3	976-504-0
US-LT30 Series, 1700 rpm	Red		0.67~1.47	6.1~13.0	976-493-0
		Pink	0.39~0.98	3.5~8.7	976-471-0
US-LT30 Series, 2300 rpm	Pink		0.39~0.98	3.5~8.7	976-471-0
US-LT40-03C	Red		4.90~9.80	43.4~86.8	976-516-0
US-LT40 Series, 800 rpm	Black		1.57~3.92	13.9~34.7	976-515-0
		Red	0.98~2.17	8.7~19.1	976-516-0
		Yellow	0.98~1.67	8.7~14.8	976-517-0
US-LT40 Series, 1500 rpm	Red		0.98~2.17	8.7~19.1	976-516-0
Yellow		0.98~1.67	8.7~14.8	976-517-0	
US-LT40 Series, 2100 rpm	Yellow		0.98~1.67	8.7~14.8	976-517-0
US-LT50 Series, 500 rpm	Black		4.9~10.3	43.4~91.1	976-620-0
US-LT50 Series, 800 rpm		Red	2.9~5.4	26.1~47.7	976-614-0
		Yellow	1.4~2.5	13.0~22.6	976-588-0
US-LT50 Series, 800 rpm	Red		2.7~5.4	24.3~47.7	976-614-0
		Yellow	1.4~2.5	13.0~22.6	976-588-0
US-LT50 Series, 1700 rpm	Yellow		1.4~2.8	13.0~25.2	976-588-0

EXTERNAL TORQUE ADJUSTMENT (Air Shut-off)

Set the hand driver through the slot into the key hole on the Adjusting Gear and turn clockwise to increase torque and counter clockwise to decrease.

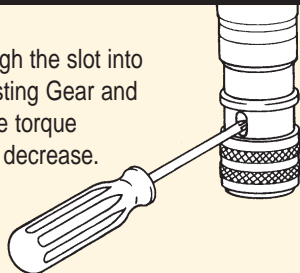

SILENCER ASSEMBLIES

Tool Model	Direct Type Silencer	Leader Hose Assembly	Exhaust Hose Assembly
US-LT10 SERIES	N/A	934-201-0	459-885-1
US-LT20 SERIES	455-088-2	934-201-0	455-885-1
US-LT30 SERIES	408-088-2	934-150-0	408-885-0
US-LT40 SERIES	496-088-1	934-150-0	496-885-1

SLOTTED HEAD BITS AND FINDERS

Bit	Overall Length (L)		Code No.
	mm	in	
	56	2 13/64	916-030-0
	75	2 61/64	916-031-0
	100	3 15/16	916-032-0
	150	5 29/32	916-033-0

Finder	Overall Length (L)		Code No.
	mm	in	
	23	29/32	917-350-0
	42	1 21/32	917-401-0
	67	2 41/64	917-402-0
	117	4 39/64	917-403-0

Finder Type Heads (Option)		
Tool	Bit Casing Connector	Bit Casing
LT20B Series	470-082-8	471-057-7
LT30B Series	471-082-7	471-057-7
LT40B Series	472-082-7	471-057-7
LT50B Series	444-082-4	471-057-7

FINDER TYPE HEADS (OPTION)

To mount Finder to US-LT series torque control type screwdrivers, Bit Casing set with Bit Casing Connector is needed to be mounted together.

Please specify "F" model as **US-LT30B-11(F)** when ordering.

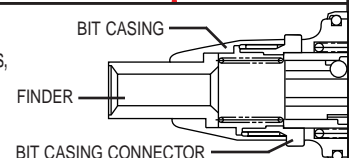

U/UX SERIES

1/4" HEX DRIVE

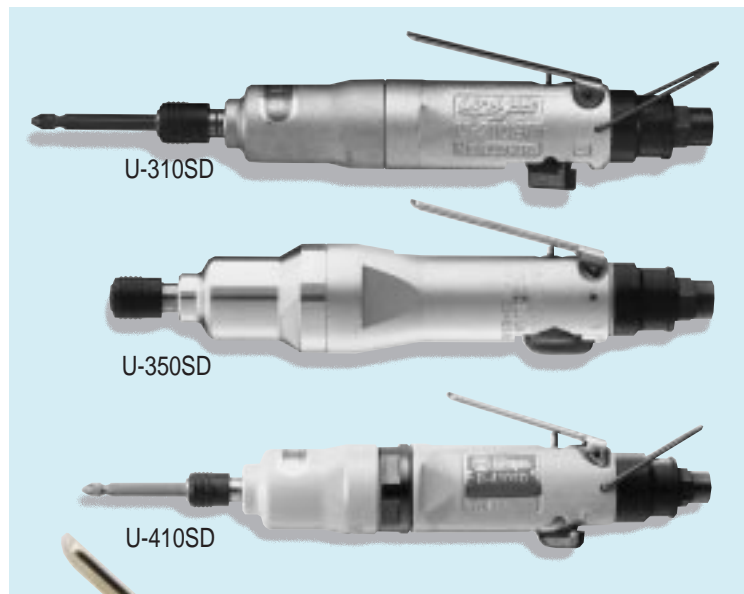

UX-500SD
UX-612SD

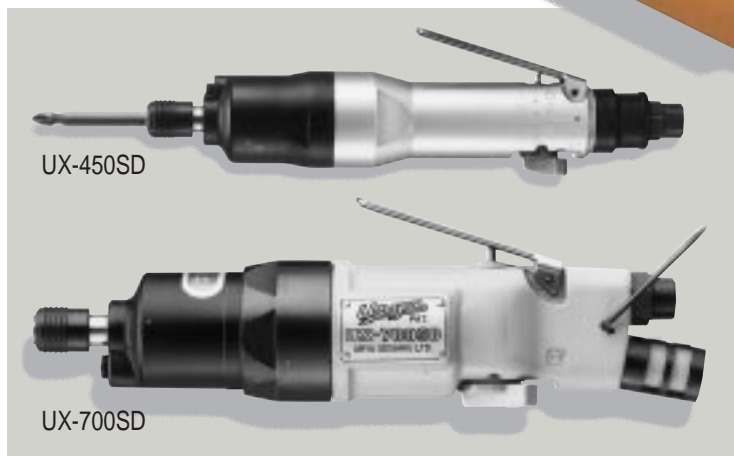

Recommended Air Pressure: 85 psi

S P E C I F I C A T I O N S											
Model	Free Speed (approx.) rpm	Torque Range (approx.)		Overall Length (approx.)		Weight less Socket (approx.)		From Center to Outside (approx.)		Noise Level dB(A)	Average Air Consumption ft ³ /min
		Nm	ft-lbs	mm	in	lb	kg	mm	in		
U-310SD	11,000	2.5~3.1	1.8~2.2	222	8.7	1.5	0.6	18	0.7	71	5.3
U-350SD	11,500	3.5~5.8	2.5~4.2	238	9.4	1.5	0.6	18	0.7	71	5.3
U-410SD	10,000	7~10	5~7.2	250	9.8	1.8	0.8	22	0.9	71	5.3
UX-450SD	9,500	8~14	5.8~10	233	9.8	1.8	0.8	22	0.9	75	7.0
UX-500SD	9,300	13~20	10~15	244	9.6	2.0	0.9	22	0.9	77	8.8
UX-612SD	9,300	16~28	12~20	253	9.9	2.2	1.0	23	0.9	79	10.5
UX-700SD	9,000	20~36	16~28	249	9.8	2.8	1.3	27	1.0	76	12.3

All Tools Standard with 1/4" Quick Change Chuck.

Air Hose Size: 1/4" for U-310SD - UX-500SD
3/8" for UX-612SD - UX-700SD

Air Inlet Thread (Pipe Tap) : N.P.T. 1/4"

NOTE: Torque ranges reflect residual B joint torque values

ALPHA/ALPHA-T SERIES

1/4" HEX DRIVE



ALPHA-T40SD
ALPHA-T45SD



ALPHA-T45SDP
PUSH-TO-START

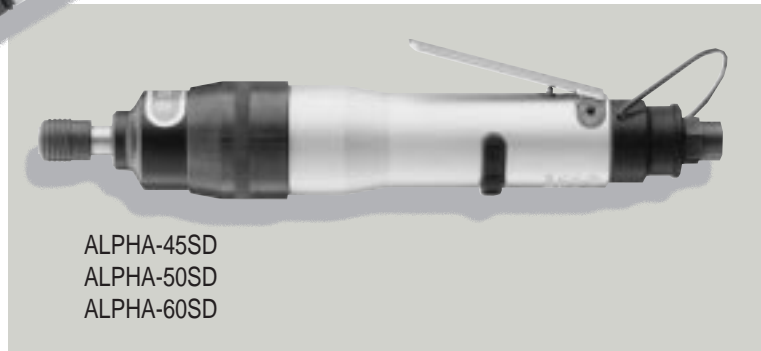

ALPHA-45SD
ALPHA-50SD
ALPHA-60SD

Recommended Air Pressure: 85 psi

S P E C I F I C A T I O N S											
Model	Free Speed (approx.) rpm	Torque Range (approx.)		Overall Length (approx.)		Weight less Socket (approx.)		From Center to Outside (approx.)		Noise Level dB(A)	Average Air Consumption ft ³ /min
		Nm	ft-lbs	mm	in	lb	kg	mm	in		
ALPHA-T40SD	3,900	3.5~6.2	2.5~4.5	270	10.6	2.2	1.0	22.5	0.9	70	7.0
ALPHA-T45SD*	6,000	8~11	5.8~8.1	270	10.6	1.9	0.8	23.8	0.9	71	8.8
ALPHA 45SD	5,500	13~20	9~14	242	9.5	1.9	0.8	21.0	0.9	71	8.8
ALPHA-50SD	7,500	18~28	13~20	232	9.0	1.9	0.8	21.0	0.9	77	10.5
ALPHA-60SD	7,000	22~35	16~25	244	9.6	2.1	0.9	22.5	0.9	80	15.8

All Tools Standard with 1/4" Quick Change Chuck.

*Available in Push-to-Start. Add suffix "P" upon ordering.

Air Hose Size: 1/4" for ALPHA-T40SD - ALPHA-50SD
3/8" for ALPHA-60SD

Air Inlet Thread (Pipe Tap) : N.P.T. 1/4"

NOTE: Torque ranges reflect residual B joint torque values

U/UX SERIES

1/4" HEX DRIVE



UX-450D
UX-500D
UX-612D



U-350D

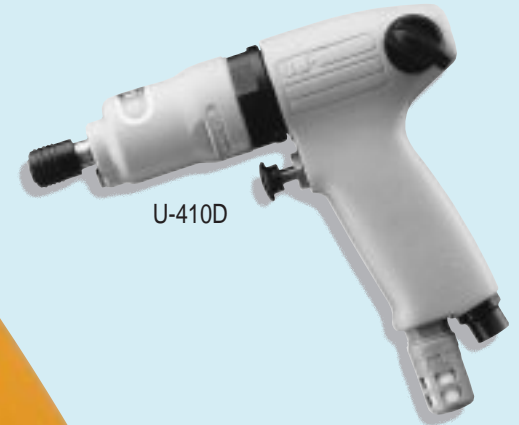

U-410D



UX-622D
UX-700D

Recommended Air Pressure: 85 psi

S P E C I F I C A T I O N S

Model	Free Speed (approx.) rpm	Torque Range (approx.)		Overall Length (approx.)		Weight less Socket (approx.)		From Center to Outside (approx.)		Noise Level dB(A)	Average Air Consumption ft ³ /min
		Nm	ft-lbs	mm	in	lb	kg	mm	in		
U-350D	11,500	3.5~5.8	2.5~4.2	155	6.1	1.6	0.8	22	0.9	71	5.3
U-410D	10,000	7~10	5~7.2	188	7.4	2.2	1.0	22	0.9	67	5.3
UX-450D	9,500	8~14	5.8~10	151	5.9	1.9	0.8	22	0.9	75	7.0
UX-500D	9,300	13~20	10~15	152	6.0	1.9	0.8	22	0.9	77	8.8
UX-612D	9,300	16~28	12~20	164	6.4	2.1	0.9	23	0.9	79	10.5
UX-622D	9,300	16~28	12~20	173	6.8	2.8	1.3	25	2.0	75	10.5
UX-700D	9,000	20~36	16~28	171	5.7	3.0	1.4	26	1.0	76	12.3

All Tools Standard with 1/4" Quick Change Chuck.
NOTE: Torque ranges reflect residual B joint torque values
Air Hose Size: 1/4" for U-350D - UX-500D
3/8" for UX-612D - UX-700D

Air Inlet Thread (Pipe Tap) : N.P.T. 1/4"

ALPHA/ALPHA T SERIES

1/4" HEX DRIVE

ALPHA-T50D



ALPHA-T40D
ALPHA-T46D

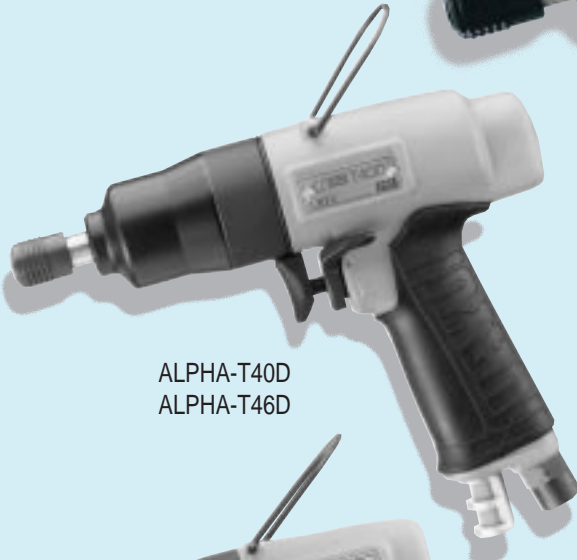

ALPHA-45D
ALPHA-50D
ALPHA-61D



Recommended Air Pressure: 85 psi

S P E C I F I C A T I O N S

Model	Free Speed (approx.) rpm	Torque Range (approx.)		Overall Length (approx.)		Weight less Socket (approx.)		From Center to Outside (approx.)		Noise Level dB(A)	Average Air Consumption ft ³ /min
		Nm	ft-lbs	mm	in	lb	kg	mm	in		
ALPHA-T40D	3,900	3.5-6.2	2.6-4.6	194	7.6	2.3	1.0	22.5	.88	70	7.0
ALPHA-T46D	6,000	6-10	4.3-7.2	193	7.6	2.3	1.0	22.5	.88	80	8.8
ALPHA-T50D	5,000	10-16	7.2-12	198	7.8	2.7	1.2	23.7	.90	80	14.1
ALPHA-45D	6,000	13-20	9.6-14.7	149	5.9	1.9	0.8	22.0	.87	71	8.8
ALPHA-50D	7,000	18-28	13-20	152	6.0	1.9	0.8	22.0	.87	78	10.5
ALPHA-61D	7,000	22-35	16-25	164	6.4	2.1	0.9	22.5	.88	77	15.8

All Tools Standard with 1/4" Quick Change Chuck.
Air Hose Size: 1/4" for ALPHA-T40D - ALPHA-50D
3/8" for ALPHA-61D

Air Inlet Thread (Pipe Tap) : N.P.T. 1/4"

NOTE: Torque ranges reflect residual B joint torque values

UBP/T CORDLESS SERIES



UBP-TL7
UBP-T7

9.6V

S P E C I F I C A T I O N S										
Model	Free Speed (approx.) rpm	Torque Range (approx.)		Overall Length (approx.)		Weight less Socket (approx.)		Noise Level dB(A)	Sq. Drive in	Number of Tightenings per Charge
		Nm	ft-lbs	mm	in	lb	kg			
UBP-TL7	2,200	4.9~9.8	3.6~7.2	241	9.4	3.9	1.8	80	1/4" Hex	600
UBP-T7	2,200	7.8~21	5.5~15.5	241	9.4	3.9	1.8	80	1/4" Hex	600

Battery: 861-402-1 (included) Charger: EY-0202B7658 (sold separately) Charge Time: 15 Min. NOTE: Torque ranges reflect residual B joint torque values



A I M C O

SCREWFEEDING AND FASTENING SYSTEMS

A-50 Screw Presenters	21
A-50 Robotic Screw Presenters	24
Acra-Feed® Automatic Screwfeeders	25
AIM/Janome Desktop Fastening Systems	26



ACRA-FEED[®]

A-50 SERIES SCREWFEEDERS



A-50 SERIES

AIMCO's A-50 series screwfeeders offer the latest technology in table-top feeder design. This system provides an easy, first step in adding automation to your assembly process. Delivery and presentation of screws can now be accomplished on time, every time, for high volume assembly.

- **Easy Interchangeability**

The A-50 units are modular! A simple rail change and readjustment is all that's necessary to change a unit for use with a variety of screw sizes. You can literally change from one fastener to another in less than 5 minutes.

- **Heavy and Durable Structural Design**

A heavy duty structural design ensures stability when the operator engages onto the screw head. No more Velcro or tie down straps are needed to keep the A-50 unit in place.

- **Serviceability**

The A-50 is built to last! If the unit requires maintenance or repair, the internal assemblies have been designed to be easily serviced.

- **Productivity**

Eliminating the need to manually handle screws and freeing up the operator's hand, the A-50 series is sure to increase the efficiency of your assembly process.

Oscillating hopper design provides quick feed rate

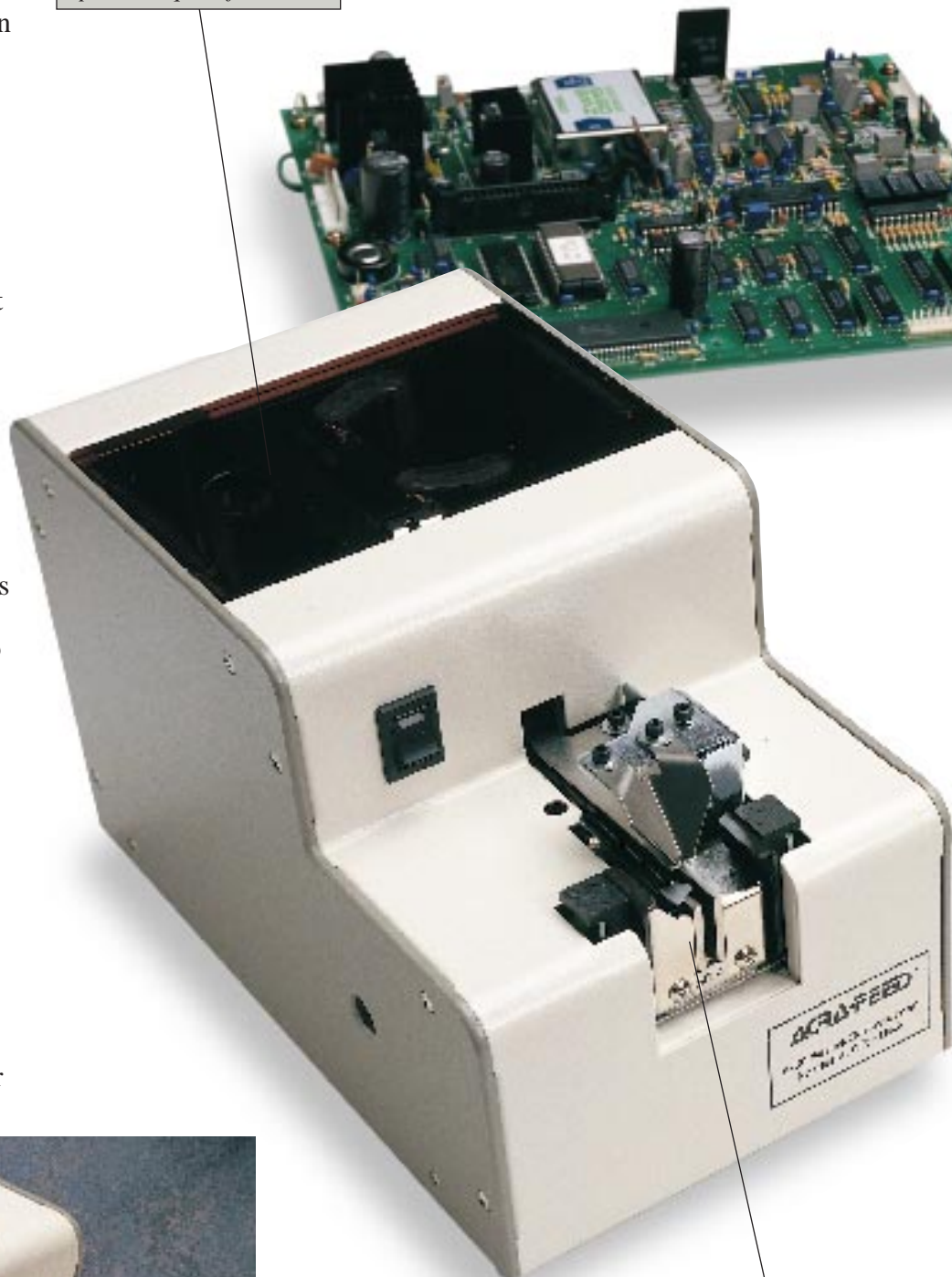

Easy access adjustment points can be changed with supplied tool



Modular screw rail system allows for simple and easy changeover.

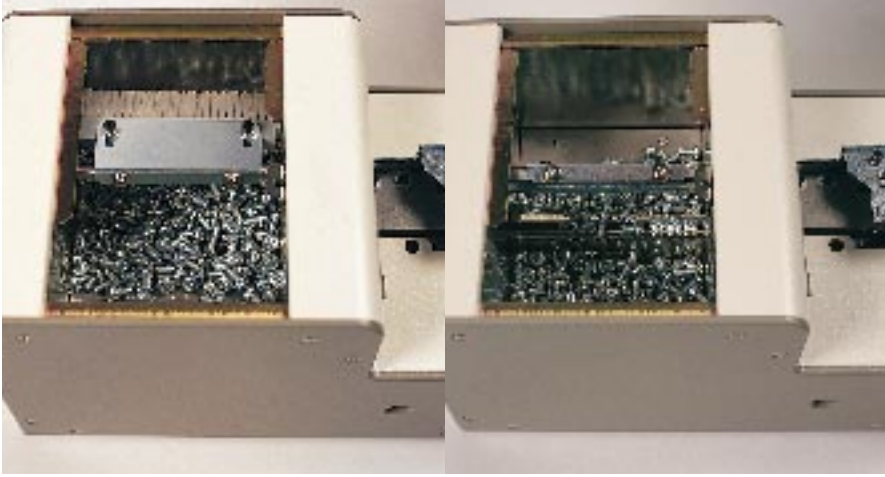

The A-50 Hopper has been designed to be easily loaded and gently oscillates the fasteners for optimal feed rate. The hopper is sized to accommodate a large number of fasteners (1200 of a #4 screw).



One piece, easy change rail packages to suit a wide range of screw sizes

Using an A-50 is as simple as one, two, three...



Load screws into the hopper. There is no particular side to load unit and no gates to limit capacity.



Address screw with magnetized bit.

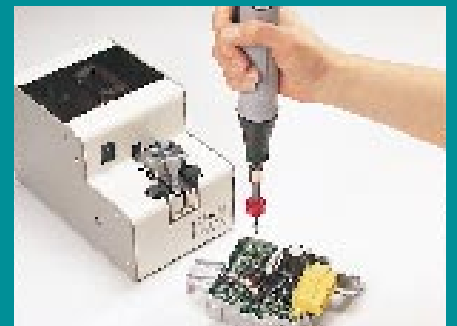

Bring screw to workpiece and fasten parts.

SPECIFICATIONS

Max Nominal Screw Size		Model No.	Additional Rail Part No.	Max Screw Length		Common Unit Specifications
				in	mm	
1.4 mm	#0	A-50A-0	AR-0	.390	10	Feed Speed: 2 screws/second
1.7 mm		A-50A-1.7	AR-1.7	.390	10	Hopper Capacity: 1,200 pcs. (#4)
2.0 mm	#1	A-50B-1	BR-1	.750	18	Dimensions (In.): 5.1(W) x 8.5 (L) x 5.3 (H)
2.3 mm	#2	A-50B-2	BR-2	.750	18	
2.6 mm	#3	A-50B-3	BR-3	.750	18	
3.0 mm	#4	A-50B-4	BR-4	.750	18	Weight (Lbs.): 7.0
3.5 mm	#6	A-50C-6	CR-6	.750	18	Power: DC12V, 500mm/A (AC adapter included)
4.0 mm	#6 - #8	A-50C-8	CR-8	.750	18	
5.0 mm	#10	A-50C-10	CR-10	.750	18	

OPTIONAL ACCESSORY

Mag-O-Net Bit Magnetizer Part No. AM3/16 (3/16" ID)

ACRA-FEED®



A-50 ROBOTIC SERIES SCREWFEEDERS

AIMCO's Robotic Style A-50 series screwfeeders offer the latest technology in table-top feeder design. The feed mechanism allows for accurate and reliable placement of fasteners for robotic or vacuum pickup. Delivery and presentation of screws can now be precisely accomplished on time, every time, for high volume assembly.

- **Easy Interchangeability**
The A-50 Robotic units are modular! A simple rail change and readjustment is all that's necessary to change a unit for use with a variety of screw sizes.
- **Heavy and Durable Structural Design**
A heavy duty structural design ensures stability when the nosepiece engages onto the screw head. No more Velcro or tie down straps are needed to keep the A-50 unit in place.
- **Serviceability**
The A-50 series is built to last! If the unit requires maintenance or repair, the internal assemblies have been designed to be easily serviced.
- **Productivity**
The A-50 Robotic units offer reliable presentation and orientation of the fasteners to ensure maximum productivity.

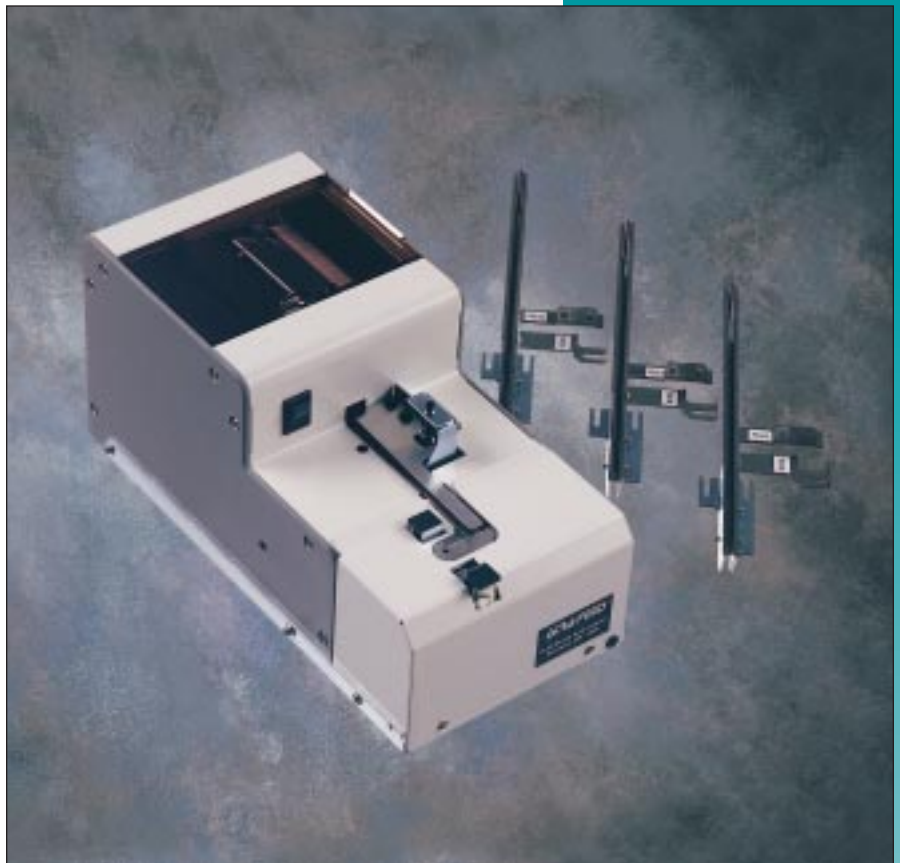

S P E C I F I C A T I O N S

Max Nominal Screw Size	Model No.	Additional Rail Part No.	Max Screw Length		Common Unit Specifications
			in	mm	
1.4 mm #0	A-50ARB-T-0	AR-RBT-0	.390	10	Feed Speed: 2 screws/second
1.7 mm	A-50ARB-T-1.7	AR-RBT-1.7	.390	10	Hopper Capacity: 1,200 pcs. (#4)
2.0 mm #1	A-50BRBT-1	BR-RBT-1	.750	18	Dimensions (In.): 5.1(W) x 10.8 (L) x 5.3 (H)
2.3 mm #2	A-50BRBT-2	BR-RBT-2	.750	18	
2.6 mm #3	A-50BRBT-3	BR-RBT-3	.750	18	
3.0 mm #4	A-50BRBT-4	BR-RBT-4	.750	18	Weight (Lbs.): 9.24
3.5 mm #6	A-50CRBT-6	CR-RBT-6	.750	18	Power: DC12V, 500mm/A (AC adapter included)
4.0 mm #6 - #8	A-50CRBT-8	CR-RBT-8	.750	18	
5.0 mm #10	A-50CRBT-10	CR-RBT-10	.750	18	

HOW TO ORDER: The A-50 robotic systems are designed for ease of setup. Use the above specification chart to determine an appropriate unit for your specific application. Should you require an A-50 preset for your specific fastener, please mark your purchase order "Robotic setup desired" and submit 50 to 75 fasteners to our Portland, Oregon facility.

- Reduce Additional Inventory - One unit can accommodate a wide variety of screw sizes
- Increase Productivity
- Reduce Downtime
- Simple Adjustment and Service
- Rails Available for #0 through #10 Screws





AUTOMATIC SCREWFEEDERS

DESIGNED FOR MODERN, HIGH SPEED PRODUCTION ASSEMBLY LINES.

The Acra-Feed® automatic screwfeeding system delivers your fastener directly to the driving tool, eliminating manual handling and placement of the fasteners.

What better combination of benefits than higher output, less fatigue, no waste, and low cost. All of this – and more – is available when you install the Acra-Feed on your production line.

Perhaps the greatest benefit with any Acra-Feed is *reliability*. Many competitive units are sitting on shelves because they became bottlenecks to efficient assembly. There are more Acra-Feed units in use today than any other unit! This speaks for itself.

No other investment in your assembly area will pay for its cost faster than the Acra-Feed.



S P E C I F I C A T I O N S

Model:	A-100
Applicable Screws:	M2-M5, (#2-#12)
Length of Screws:	6-28mm (1/4"-1")
Hopper Capacity:	450cc (500-2500 screws)
Fastening Speed:	Up to 70 screws/min.
Delivery Hose:	3.05m (10 ft.) standard
Air Pressure:	4-5kg/CM ² (55-70 psi)
Max. Air Con.:	9 CFM
Electric Power:	AC 110V, 20W
Weight:	20kg (44 lbs.) w/o driver
Dimensions:	7"Wx17"Lx16"H

Compatible for use with pneumatic or electric drivers

HOW TO ORDER: The Acra-Feed units are custom adjusted to your application. To properly adjust the unit we need a sample of the workpiece and about 100 of the fasteners. Once the samples are received a permanent file number is assigned to the application.

- Increase Productivity and Reduce Production Costs
- Ensure Reliable and Accurate Assembly
- Custom Adjusted to Fit Your Application



AIM/JANOME**DESKTOP FASTENING SYSTEM****It's as easy as X, Y, Z ...**

On today's assembly line, you not only must increase productivity to be competitive, but ensure that ergonomic, reliability and quality requirements are met!

Solutions for solving the demands placed on today's fastening applications can be found in the AIM/Janome Desktop Fastening System.

- Increase productivity through fastening efficiency and reliability.
- Increase product quality through automated assembly and quality control.
- Reduce ergonomic concerns.



JR500 & JR750 FASTENING SYSTEMS

The JR500 and 750 Series Robots are designed for minimum space and maximum performance and offer many advanced features:

- Easy teaching pad with a digital display for programming and detailed self-diagnostic messages.
- Reliable quality-control feedback functions to ensure quality fastening.
- A large memory capacity with each memory card allowing up to 10 programs with 2,000 fastening points total.
- Loose-tightening or predetermined screw depth function for various applications.
- Precise computer-controlled pulse motor for greater accuracy of x, y and z axis.
- Single operator control and monitoring of multiple units.



JR750 offers increased work area & travel speed.

SPECIFICATIONS	JR500	JR750
APPLICABLE SCREW DIAMETER (in.)	#0-#8 (M1.4-M4)	#0-#8 (M1.4-M4)
APPLICABLE SCREW HEAD TYPE	Phillips, Torx, Allen Head types	P hillips, Torx, Allen Head Types
RANGE OF OPERATION	X axis/11.8 in., Y axis/11.8 in., Z axis/3.9 in	X axis/15.7 in., Y axis/15.7 in., Z axis/5.9 in.
LOAD CAPACITY	Work (X, Y) 7.7 lbs., Tool (Z) 4.4 lbs	Work (X, Y) 11 lbs., Tool (Z) 6.6 lbs.
TRAVEL SPEED	X, Y axes 19.7 in/sec, Z axis 7.8 in/sec	X, Y axes 29.5 in/sec, Z axis 11.8 in/sec
REPEATABILITY	X & Y axes - 0.002", Z axis - 0.001"	X & Y axes - 0.002", Z axis - 0.001"
APPLICABLE TORQUE RANGE	.26-35 in.-lbs.	.26-35 in.-lbs.
MAXIMUM FASTENING RPM	1,000 RPM	1,000 RPM
PROGRAMMING	Teach Pad - computer/software	Teach Pad - computer/software
DRIVE METHOD	Pulse stepping motor	Pulse stepping motor
CONTROL METHOD	Point to point control	Point to point control
EXTERNAL INPUT/OUTPUT	10 points for input, 9 points for output	10 points for input, 9 points for output
MEMORY CAPACITY	2,000 points	2,000 points
PROGRAM SYSTEM	Supplied by memory cards	Supplied by memory cards
CPU	16 bits (TMP68303, uPD78604)	16 bits (TMP68303,uPD78604)
DIMENSIONS	Width: 20.6 in., Length: 19.5 in., Height: 26.4 in. (max)	Width: 23.4 in., Length: 23.4 in., Height: 32.3 in. (max.)
WEIGHT	64 lbs. (Less tooling)	95 lbs. (Less tooling)
POWER AND CONSUMPTION CURRENT	100V-220V, 50/60HZ	110V-220V, 50/60HZ
APPLICABLE AIR PRESSURE	70 PSI	70 PSI

When inquiring, please specify:

- Screw size ● Nominal diameter and length of the screw threads ● Screw head type
- Torque requirements ● Application material, configuration and dimension, etc.



A I M C O

TORQUE MEASUREMENT EQUIPMENT

UET Electronic Torque Testers	29
TorqueStar Torque Analyzers	30
ToolStar Joint Analyzers	32
CheckStar Rotary Transducers	34
Transducers and Joint Simulators	36
Electronic Transducerized Wrenches	38
Programmable Fastening Counters	40



UET SERIES

Electronic Torque Testers

The UET Torque Tester Series from AIMCO provides “state-of-the-art” technology for your quality requirements.

It’s durable and portable design is ideal for a variety of applications in light assembly and can be used to test hand tools, power tools - and even pulse tools.

Prominent features include:

- Serial Output
- Selectable Frequency Response - Allows user to configure the filtering necessary for testing torque tools
- Three Modes of Processing Torque Signals -
 - Peak - Records and displays highest peak of torque experienced
 - First Peak - Records and displays first peak of torque that the system experiences
 - Track - Displays all torsional strain applied to the transducer in real time (no memory)
- Selectable Engineering Units - 8 different scales are available
- Accuracy $\pm .5\%$ of Indicated Reading



All these features without sacrificing ease of use!

- NiMH Battery Technology
- Adjustable Autoclear Feature
- Keylock Security - Prevents inadvertent programming changes
- Optional Printers Available

Features include:

- One Button Operation - Easy and convenient to use
- Serial Communication - Provides data output to computers or serial printers
- Clockwise & Counter Clockwise Capability - Provides ability to test torque in both directions
- Push Button Zero - Allows user to quickly re-zero instrument reading
- NiMH Batteries - Reduces battery memory problems and allows quicker recharging (8 hours continuous battery life)
- Unit can be operated on AC power or batteries

S P E C I F I C A T I O N S

Model	Recommended Torque Range	Model	Recommended Torque Range
UET-0100 Universal Electronic Tester	0 - 100 In Oz	UET-100 Universal Electronic Tester	0 - 100 In Lb
UET-10 Universal Electronic Tester	0 - 10 In Lb	UET-250 Universal Electronic Tester	0 - 250 In Lb
UET-050 Universal Electronic Tester	0 - 50 In Lb	UET-500 Universal Electronic Tester	0 - 500 In Lb

Unit accuracy is $\pm .5\%$ of indicated reading for the top 90% of full scale. The system is supplied with a joint simulator, 1/4" hex test bit and an AC power cable (110V unless otherwise requested).



TORQUESTAR

TORQUE ANALYZERS AND
DATA COLLECTORS



The Version 4 TorqueStar Series of Torque Analyzers and Data Collectors are state-of-the-art instruments for measuring, monitoring and recording torque.

Designed to facilitate torque testing before, during or after assembly, these instruments provide solutions for most torque auditing applications in manufacturing and quality departments. Whether you are testing the capability of your power tools, verifying the accuracy of your hand tools, monitoring the capability of your fastening process or auditing the quality of your assembled joints these instruments will do the job quickly, easily and most important, accurately.

Four TorqueStar models are available:

Model I - Torque Analyzer with sequential memory of 200 samples

Model II - Torque/Angle Analyzer with sequential memory of 200 samples

Model III - Torque Analyzer/Data Collector with memory capability of up to 250 files with 20,000 samples

Model IV - Torque/Angle Analyzer/Data Collector with memory capability of up to 250 files with 20,000 samples.

Optional PC software available for file setup, transfer and further data processing.

Features include:

- Compatible with most strain gauge torque transducers
- Menu prompting LCD
- Four modes of torque measurement - Peak, Click (first peak), Track and Impulse (pulse tool)
- Visual and audible enunciators indicating Hi, Low and Good values
- Processes data to provide Cp, Cpk, X-Bar, Range and Sigma values
- Programmable Frequency Response selectable from 70-6000 Hz
- Communicates to a PC or printer via serial port.



CRANE

SPECIFICATIONS

- A/D accuracy $\pm 0.2\%$ of FSD
- Display is LCD 4 row by 16 column alphanumeric supertwist with backlight
- Ni-cad battery 8 hour continuous use / 8 hour recharge
- Serial port with hand shaking, baud rate selectable from 300 to 19,200
- Data memory backed up with internal battery
- Supplied with carrying case, operations manual, two communication cables, battery charger and shoulder strap
- Programmable Frequency Response from 70 - 6000 Hz
- Durable cast aluminum housing
- Dimensions of housing - 9 1/4" long x 5 3/8" wide x 3 1/4" deep
- Weight - 3 1/2 lbs
- Warranty - 12 months parts and labor on manufacturing defects

FEATURES FOR ALL TORQUESTAR MODELS

Model: Part Number:	TorqueStar Model I UTIS-507-0-0-0-USA	TorqueStar Model II UTIS-506-0-0-0-USA	TorqueStar Model III UTIS-505-0-0-0-USA	TorqueStar Model IV UTIS-504-0-0-0-USA
6 Languages	●	●	●	●
Transducer file	●	●	●	●
Impulse mode	●	●	●	●
Click mode	●	●	●	●
Peak mode	●	●	●	●
Track mode	●	●	●	●
Cycle end timer	●	●	●	●
Auto print mode	●	●	●	●
Measure mode	●	●	●	●
Statistical analysis	●	●	●	●
Password	●	●	●	●
Auto power off	●	●	●	●
Back light	●	●	●	●
Date/time clock	●	●	●	●
Angle		●		●
Pulse count		●		●
File capability 250			●	●
Rounds			●	●
PC Support			●	●
Cause code field			●	●
20,000 samples			●	●

OPTIONAL SOFTWARE PRODUCTS

PC COMM Software Part #UTA-405-0-0 - PC based software to support TorqueStar data collectors Models III and IV. Provides operators with a means of creating characteristics (files) on the PC, storing them and downloading files as desired to the TorqueStar.

CRANE INTERFACE to SQC PACK PLUS Part #UTA-103-0-0 (3 1/2" FD) UTA-103-1-0 (5 1/4" FD) - PC based software to support TorqueStar Models III and IV and provide the interface to SQC Pack Plus for High resolution graphics and data processing. Provides operators with a means of creating characteristics (files) on the PC storing them and downloading the files to the TorqueStar.

SQC PACK PLUS Part #UTA-406-0-0 - PC based software for statistical processing of data. This is a very powerful and easy to use software package for producing high resolution graphic charts. Will display, store and print x-bar, range, histograms, I charts, M charts, moving range, moving average and scatter plots.



TOOLSTAR

POWER TOOL AND ASSEMBLY
JOINT ANALYZER



The ToolStar instrument is designed to analyze and evaluate fasteners, assembly tools and bolted joints to ensure quality manufacturing. It is an ideal research and development instrument for measuring fastener or tool performance and joint analysis.

The ToolStar will process stored data to define fastener or tool performance and assist technicians in understanding joint characteristics. It will monitor, measure, display, record, plot and print graphs illustrating torque, angle, pulse count or bolt load. The coefficient of friction can also be calculated, displayed and printed.

These features allow you to develop torque specifications and assist in isolating causes of variation in the fastening process.

Data is processed to provide Cp, Cpk, X-Bar, Range and Sigma values. All data is time/date stamped and can be output via the serial communications port. Joint, fastener and/or tool plots can be stored, recalled, printed and/or displayed and multiple plots can be easily displayed for comparison.

Features include:

- Battery powered and completely portable
- Programmable Frequency Response selectable from 361-6000 Hz
- Menu prompting LCD screen is capable of graphic plots of fastener/tool performance and joint characteristics
- Zoom facility enables detailed examination of any point of the profile curve
- Calculates and illustrates the coefficient of friction at any point of the profile curve
- Built-in internal dot matrix printer is capable of printing low resolution graphics
- Serial communications for connection to PC or printer
- Capable of recording 8000 data readings per second



CRANE

SPECIFICATIONS

ToolStar Part #UTA-444-V-0

- Selectable A/D converter speed for plotting
- Sample rate - 8 KHz
- Menu prompting backlit LCD Supertwist 240 x 128 pixels, 4 3/4" x 2 1/2"
- Zoom facility provides over 20:1 magnification
- Selectable Frequency Response from 361 to 6000 Hz
- Auto zero
- Serial baud rate selectable from 300 to 19,600
- Keypad with 29 tactile keys and 5 soft keys
- Printer is dot matrix, 144 dots per line
- Clock is 24 hour in European or US format
- Durable cast aluminum housing - 10 3/8" long x 6 1/4" wide x 4 1/2" deep (approx.)
- Carrying case is provided with instrument along with operations manual and PC cables
- Weight - 11 lbs
- AC power requirements - 92-264 Volts 50/60 Hz
- Operating temperature from 5 to 40 degrees Celsius
- Warranty is 12 months parts and labor on manufacturing defects

ForceStar Part #UTA-444-00-00

The ForceStar adds one channel of input to the two channel ToolStar system. This channel is for a load cell or load washer to monitor clamp force. The software of the ToolStar is able to accommodate a third input channel. The fastener load washer or load cell is calibrated to the ForceStar by adjusting the ForceStar's amplifier gain.



TOOLSTAR SCREEN EXAMPLES

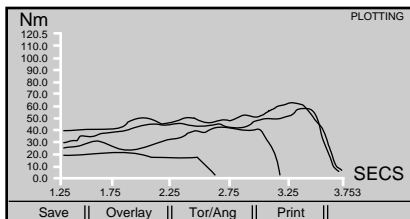

Up to 5 profiles may be overlaid for comparison purpose

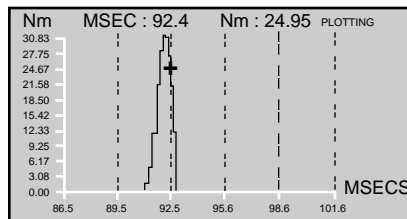

The Zoom facility enables detailed examination of any part of a curve.

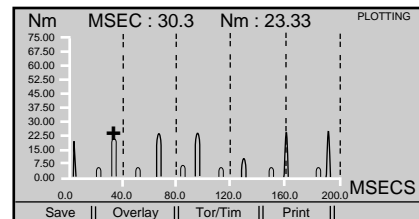

ToolStar works well with pulse tools.

OPTIONAL SOFTWARE PRODUCTS

TOOLBASE Software Part #UTA-474-0-0 - PC based software to support the ToolStar analyzer. This program builds databases of tool performance, tool plots, joint parameters and plots on joints. The software can store, recall, print and download these profile plots. Will also manipulate and overlay plots for comparisons.



CHECKSTAR

ROTARY TORQUE
TRANSDUCERS



The CheckStar Rotary Torque Transducers accurately measure dynamic torque of power tools, including pulse tools. They provide a means of verifying torque or torque/angle output of multiple or single spindle controlled tools, allowing on-line quality assurance of your assembly process.

CheckStar transducers have a patented slip ring and brush design which eliminates “brush bounce” providing confidence in torque readings. This design carries a Lifetime Warranty and assures no cost replacement of worn slip rings or brushes.

This series is available in two styles: Industry Standard (IS) and UTA styles.

- Industry Standard style is manufactured with a military type connector and the torque signal is 2 mv output per volt of excitation. This style transducer will function with most torque analyzers, readouts and data collectors.
- UTA style is manufactured with a “smart chip” in the connector and will automatically identify itself to the Crane family of torque analyzers/controllers/readouts and data collectors. When using this style the user is not required to select span, range or mv per volt parameters.

Available in torque or torque/angle models in sizes from 1/4” hex to 2 1/2” square drive.

Features include:

- No “brush bounce” when used with pulse tools, stall tools, right angle nutrunners, screwdrivers, multiples and DC powered tools
- Accurate and linear torsion shafts
- Available in torque or torque/angle models in sizes from 1/4” hex to 2 1/2” square drive
- Torque ranges from 2NM to 5000 NM full scale
- Small, compact design allows use in limited access areas
- Rugged aluminum alloy housing
- Slip ring and brush design carries a lifetime warranty



CRANE

SPECIFICATIONS

- Accuracy Better than +/- 1% FSD
- Zero Drift Better than +/- .1% FSD per degree Celsius
- Overload Capacity 125% FSD
- Operating Temperature 5 - 40 degrees Celsius
- Case Rating IP40
- Drag Friction Less than .1% rated torque or .1NM
- Angle Measurement 2-phase quadrature signed with stated resolution
- Square Drives Designed to fit ANSI, BS and DIN square standards
- Heavy Duty Coil Cable 3 feet long relaxed / 10 feet long extended
- Warranty 12 months parts and labor on manufacturing defects

Drive Size	Torque Capacity	Part Numbers	Pinned shafts	Angle Versions
1/4" Hex	15 In Lb	UTA-449-0002	-OP	-AP
1/4" Hex	44 In Lb	UTA or IS -449-0005	-OP	-AP
1/4" Hex	100 In Lb	UTA-450-0010	-OP	-AP
1/4" Hex	180 In Lb	UTA or IS -450-0020	-OP	-AP
1/4" Sq	100 In Lb	UTA-451-0010	-OP	-AP
1/4" Sq	180 In Lb	UTA or IS -451-0020	-OP	-AP
3/8" Sq	225 In Lb	UTA-452-0025	-OP	-AP
3/8" Sq	50 Ft Lb	UTA or IS -452-0075	-OP	-AP
1/2" Sq	133 Ft Lb	UTA or IS -453-0180	-OP	-AP
3/4" Sq	180 Ft Lb	UTA-454-0250	-OP	-AP
3/4" Sq	368 Ft Lb	UTA or IS -454-0500	-OP	-AP
1" Sq	550 Ft Lb	UTA-455-0750	-OP	-AP
1" Sq	1025 Ft Lb	UTA or IS -455-1400	-OP	-AP

Drive	Overall Length (A)	Thickness (B)	Width (C)	Length of Housing (D)	Side to Center (E)	Housing to Shaft End (F)	Weight
1/4" Hex*	4 9/16"	1 1/8"	2 3/16"	2 3/16"	1/2"	1 1/2"	1 Lb
1/4" Sq	2 7/8"	1 1/8"	2 3/16"	2 3/16"	1/2"	1/4"	1 Lb
3/8" Sq	3"	1 1/8"	2 3/8"	2 3/16"	9/16"	3/8"	1 1/4 Lb
1/2" Sq	3 7/16"	1 5/8"	2 3/4"	2 5/16"	7/8"	7/16"	1 1/2 Lb
3/4" Sq	4 1/8"	2"	3 1/8"	2 3/8"	1"	7/8"	2 1/4 Lb
1" Sq	4 15/16"	2 7/16"	3 5/8"	2 9/16"	1 1/4"	1 1/8"	4 Lbs

* 1/4" Hex Models have 1" Hex Engagement



STATIONARY TRANSDUCERS AND JOINT SIMULATORS



The Crane Stationary Transducers and Joint Simulators provide quick and easy torque testing, verifying and calibrating of hand torque tools and power tools.

There are two groups of stationary transducers - Industrial and Metrology.

- The Metrology group of transducers have very high accuracy and are used explicitly in torque metrology labs. The metrology transducers are only available as Industry Standard (IS) type and should never be used for testing or verifying power tools.

- The Industrial stationary transducers are available in two styles - Industry Standard (IS) and UTA.

- Industry Standard style is manufactured with a military type connector and the torque signal is 2 mv output per volt of excitation. This style transducer will work with most torque analyzers and readouts.

- UTA style is manufactured with a “smart chip” in the connector and will automatically identify itself to the Crane family of torque analyzers and controllers. When using this style the user is not required to select span, range or mv per volt parameters.

The Crane Joint Simulators provide a means of testing power tools on a repeatable, linear and accurate simulated joint. Joint rates can be modified for a variety of applications. The mechanism is engineered to have zero backlash and has a common centerline with the axis of the transducer which provides accurate torque results.

Features include:

- Transducers feature precision female square drives to facilitate testing of hand and power tools
- Transducers are available in 1/4” to 1” square drive
- Heavy duty stainless steel transducer allows 140% overload capacity
- Joint Simulators are flanged for easy mounting to work surface



CRANE

SPECIFICATIONS

- Accuracy Better than +/- 1% FSD Industrial Stationary td
Better than +/- .25% Indicated Metrology Stationary td
- Zero Drift Less than .1% rated torque per degree Celsius
- Overload Capacity 140% FSD
- Operating Temperature 5 - 40 degrees Celsius
- Square Drives Designed to fit ANSI, BS and DIN square standards
- Warranty 12 months parts and labor on manufacturing defects

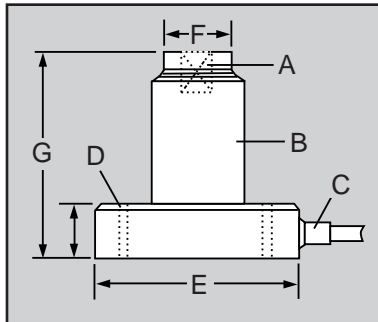

- A** Precision female square drive
- B** Protective sleeve enclosing transducer
- C** 1 meter strain-relieved cable permanently attached for connecting the transducer to the appropriate UTA Readout or TorqueStar
- D** Four mounting holes of 8.3 mm diameter on 80 mm pitch circle diameter

T R A N S D U C E R S

Drive Size (A)	Td Dia. (B)	Base Dia. (E)	Thickness (D)	Height (G)	Top Dia. (F)	Weight	Torque Capacity	Part Number
1/4"	2 1/8"	3 15/16"	1"	3"	5/8"	3 Lbs	50 In Lb	UTA-164-0-25
							100 In Lb	UTA-165-0-25
							100 In Lb	IS-165-0-0
							250 Ft Lb	UTA-166-0-25
							250 Ft Lb	IS-166-0-0
3/8"	2 1/8"	3 15/16"	1"	3 3/8"	1"	3 1/4 Lbs	50 Ft Lb	UTA-167-0-35
							100 Ft Lb	UTA-168-0-35
							100 Ft Lb	IS-168-0-0
1/2"	2 1/8"	3 15/16"	1"	3 3/4"	1 3/16"	3 1/3 Lbs	200 Ft Lb	UTA-169-0-35
3/4"	2"	3 15/16"	1"	4 7/16"	1 3/4"	4 Lbs	200 Ft Lb	IS-169-0-0
							400 Ft Lb	UTA-170-0-35
							750 Ft Lb	UTA-171-0-35
1"	2 5/16"	3 15/16"	1"	4 7/8"	2"	4 3/4 Lbs	750 Ft Lb	IS-171-0-0
							1250 Ft Lb	UTA-172-0-35
							1250 Ft Lb	IS-172-0-0

J O I N T S I M U L A T O R S

Description	Part Number
1/4" Female Joint Kit	UTA-173-1-0
3/8" Female Joint Kit	UTA-174-1-0
1/2" Female Joint Kit	UTA-175-1-0
3/4" Female Joint Kit	UTA-176-1-0
1" Female Joint Kit	UTA-177-1-0



ELECTRONIC TRANSDUCERIZED WRENCHES



The Crane Transducerized Wrenches are designed for residual torque auditing and general purpose precision torquing. They provide the user with torque readings that are not subjective to ensure accuracy and confidence in your audit process.

These transducerized wrenches are available in two styles: Industry Standard (IS) and UTA styles.

- The Industry Standard style is manufactured with a military type connector. The torque signal is 2 mv output per volt of excitation. This style transducer will work with most torque analyzers, readouts and data collectors.
- The UTA style is manufactured with a “smart chip” in the connector and will automatically identify itself to the Crane family of torque analyzers/controllers/readouts. When using this style the user is not required to select span, range or mv per volt parameters.

Wrenches are available in a range of capacities from 0-50 inch pounds up to 0-1000 foot pounds.

Features include:

- All steel torque wrench
- Lightweight, slim design
- Wrenches feature nonslip aluminum grip handle
- Not length dependent
- Transducers are heavy duty stainless steel with 140% overload capacity
- Very accurate and linear torsion shafts
- Torque ranges from 4NM full scale to 700NM full scale
- LED Enunciators to alert operator of Good/High/Low readings



CRANE

SPECIFICATIONS

- Accuracy Better than +/- 1% FSD
- Zero Drift Less than .1% rated torque per degree Celsius
- Overload Capacity 140% FSD
- Operating Temperature 5 - 40 degrees Celsius
- Square Drives Designed to fit ANSI, BS and DIN square standards
- Warranty 12 months parts and labor on manufacturing defects

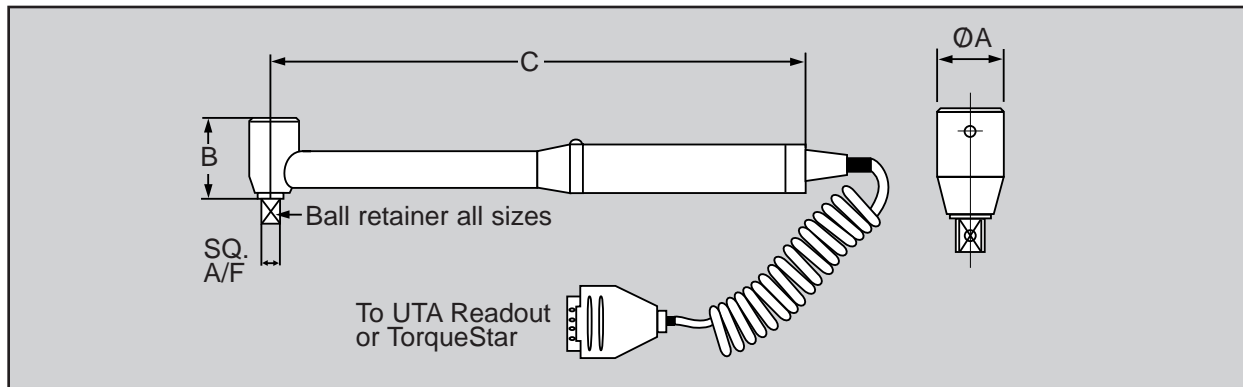

Drive Size	Head Dia. (A)	Height (B)	Length (C)	Weight	Torque Capacity	Part Number
1/4"	1"	1 3/4"	8 1/8"	1 3/4 Lbs	50 In Lb	UTA-116-1-25
					100 In Lb	UTA-117-1-25
					50 In Lb	IS-301-0-1
					100 In Lb	IS-302-0-1
					200 Ft Lb	UTA-118-1-25
3/8"	1"	1 3/4"	11 9/16"	2 1/4 Lbs	200 Ft Lb	IS-303-0-1
					50 Ft Lb	UTA-119-1-35
					50 Ft Lb	IS-304-0-1
1/2"	1 9/16"	2 1/8"	20 5/8"	5 1/2 Lbs	100 Ft Lb	UTA-120-1-35
					200 Ft Lb	UTA-121-1-35
					100 Ft Lb	IS-305-0-1
					200 Ft Lb	IS-306-0-1
3/4"	2"	3 1/8"	54 1/2"	11 1/2 Lbs	350 Ft Lb	UTA-122-1-35
					500 Ft Lb	UTA-123-1-35
					350 Ft Lb	IS-307-0-1
					500 Ft Lb	IS-416-0-1



AIMCO

PROGRAMMABLE FASTENING COUNTERS

Eliminate missing or untightened fasteners during assembly

Daily distractions for an assembly line operator can easily create missing or untightened fasteners. Unchecked, these quality defects can create costly problems.

AIMCO's line of programmable fastening counters allow you to eliminate the problem before it leaves the workstation. Inputs for external limit switches, optical sensors and other visual or audio warning indicators ensure that each fastening cycle is virtually 100% complete.

AIMCO's A-FC1000 Series is designed to connect with virtually any electric or pneumatic torque control screwdriver.



A-FC1000E – Accommodates Electric Screwdrivers

By sensing the screwdriver's clutch disengagement, the mounted sensor registers a cycle complete.

False detection of cross threading or fastener restart is eliminated through a cycle complete timer.

Features include:

- Ensures product quality with accurate fastening count
- Compact and portable design
- Easily accommodates a variety of driver styles
- Simple setup and programming
- LED digital display



A-FC1000A – Accommodates Pneumatic Screwdrivers





A I M C O

ACCESSORIES

Balancers, Retractors & Hose Reels	42
Ergo-Arm® Tool Support Arms	45
Workstation Components & Assemblies	47
Air Hose, Swivels & Inline Filter/Reg's	49
Ergonomic Twist Plugs	50
Mag-O-Nets®	51
Bits and Nutsetters	52

BALANCERS, RETRACTORS & HOSE REELS



A I M C O

Balancers and Tool Support Systems



RETRACTORS

RPA SERIES

- Lightweight and compact
- No tools needed for setting of tension
- User friendly
- 5 ft. nylon coated steel cable
- Reinforced hanging bracket includes provision for safety cable
- Adjustable cable stop
- Non-repairable
- 3 models support weight 0.5-5 lbs.
- Tool clip included



RPA SERIES

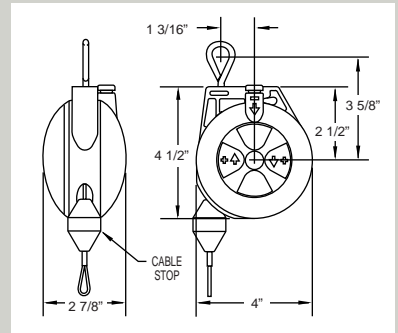

MODEL	CAPACITY
RPA-1	.5~1.5 lbs
RPA-2	1.5~3 lbs
RPA-3	3~5 lbs

RMA-L SERIES

- Steel housing with polyester finish
- Reinforced hanging bracket includes provision for safety cable
- 8 ft. of 3/32" diameter aircraft stranded steel
- Self-contained mainspring
- Permanently lubricated
- Tool clip included
- External tension adjustment
- Ratchet model (L)* allows locking of cable for tool changes or free tool applications.

* Ratchet can be disengaged by knob on backside to allow for constant tension.

RMA-L SERIES

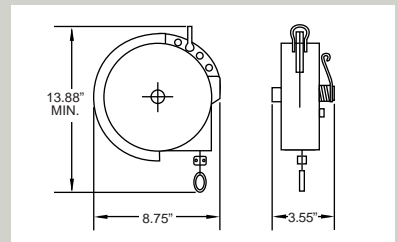

MODEL	CAPACITY
RMA-7L	5~10 lbs w/ratchet lock
RMA-15L	10~15 lbs w/ratchet lock
RMA-20L	16~23 lbs w/ratchet lock

RW SERIES

- Three models available to provide a support range of 1-11 pounds (.5 - 5.0 Kg)
- Dependable and durable 5 ft. nylon coated stranded steel 1/8" cable
- Tool clip swivels to allow 360° rotation
- Easily adjustable tension — No accessory tools needed
- Durable spring construction ensures long product life



RW SERIES

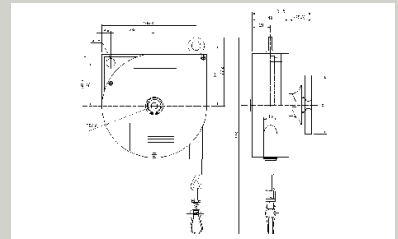

MODEL	CAPACITY
RW-0	1.1 - 3.3 lbs.
RW-3	2.2 - 6.6 lbs.
RW-5	5.5 - 11.0 lbs.

BALANCER SELECTION

When choosing a balancer, a few important items should be noted:

1. Determine if a retractor or a true balancer is required
2. Determine total cable travel needed and total weight to be suspended, including all hose/cable, tool and fixtures

To ensure maximum life span of your balancer selection should utilize weight range at the high end.

EXAMPLE: Total weight to be suspended is five pounds. The application calls for a true balance. The choices are a TW-3 (2.2~6.6 lbs) or TW-5 (5.5~11 lbs). The best choice is the TW-3. This allows the entire spring to be utilized.

Remember: "Bigger is NOT always better!"

MARKETS:

- Automotive Assembly
- Appliance
- Electronics
- Packaging
- Medical Equipment
- Meat Processing
- Furniture
- Aerospace

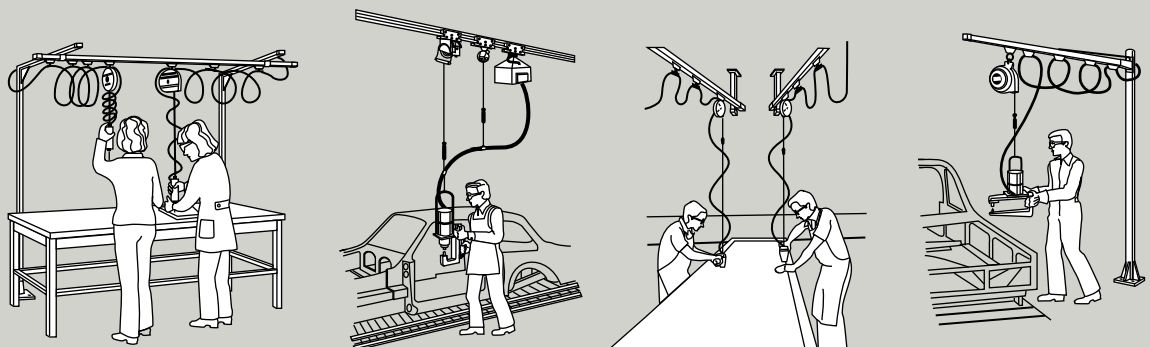

ZERO GRAVITY BALANCERS

The "TRUE" balancers

TW-O and TW-OO

- Zero gravity / true balance
- No tension build-up to cause worker fatigue
- Easy external direct drive tensioning
- Lightweight construction
- 360 degree upper swivel
- 3.3 ft. aircraft stranded steel cable 1/8" diameter (TW-OO cable length 18")
- Provision for safety cable
- Tool clip included

TW-3 through TW-15

- Four models supporting weights from 2.2 lbs. to 33 lbs.
- Tapered drum allows "true balance" throughout cable travel
- Easy external direct drive tensioning
- Heavy duty construction for maximum impact
- Permanent lubrication
- 360 degree top swivel
- 4.3 ft. of 5/32" diameter aircraft stranded steel cable
- Safety chain provision

TW-22 through TW-70

- Six models supporting weights from 33 lbs. to 154 lbs.
- Tapered drum allows for "true balance"
- Cast aluminum housing
- Easy external tensioning
- Manual drum lock
- 360 degree upper swivel
- Permanent lubrication
- 5 ft. of aircraft stranded steel 3/16"
- Automatic Safety Lock

Note: All TW Models are Zero Gravity/True Balance



TW-O & TW-OO SERIES



TW-3 TO TW-70 SERIES



LR-09B-90/200

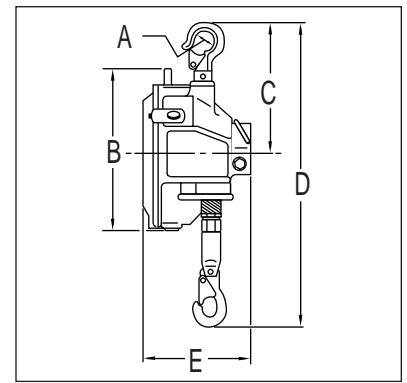

MODEL	DIMENSIONS (mm)				
	A	B	C	D	E
TW-00	8	95	63	190	38
TW-0	18	127	114	225	47
TW-3	18	149	127	252	69
TW-5	18	149	127	252	69
TW-9	24	216	165	363	136
TW-15	24	216	165	363	136
TW-22	30	264	211	455	158
TW-30	30	264	211	455	158
TW-40	30	271	211	455	188
TW-50	30	271	211	455	188
TW-60	30	271	211	455	199
TW-70	30	271	211	455	199

MODEL	CAPACITY	ZERO GRAVITY CAPACITY (LBS.)
TW-00	1.1~3.3 lbs	2.5-3.0
TW-0	1.1~3.3 lbs	2.5-3.0
TW-3	2.2~6.6 lbs	4.5-6.0
TW-5	5.5~11 lbs	8.0-10.5
TW-9	9.9~19.8 lbs	15-19
TW-15	19.8~33 lbs	26-32.5
TW-22	33~48.4 lbs	41-48
TW-30	48.4~66 lbs	58-65.5
TW-40	66~88 lbs	77.5-87.5
TW-50	88~110 lbs	100-109.5
TW-60	110~132 lbs	122-131
TW-70	132~154 lbs	144-153

SAFETY CABLE/CABLE OVERHANG SPECIFICATIONS

PART #	BALANCER MODEL	DESCRIPTION
CO1803	TW-OO, 0,3 & 5	1/8" x 3'
CO1805		1/8" x 5'
CO1810		1/8" x 10'
CO1815		1/8" x 15'
CO1820		1/8" x 20'
CO3203	TW-9 & 15	5/32" x 3'
CO3205		5/32" x 5'
CO3210		5/32" x 10'
CO3215		5/32" x 15'
CO3220		5/32" x 20'
CO1603	TW-22 through 70	3/16" x 3'
CO1605		3/16" x 5'
CO1610		3/16" x 10'
CO1615		3/16" x 15'
CO1620		3/16" x 20'

Note: If safety cable is desired, please add Part# SH-5 to order.

HOSE REEL BALANCERS

- Designed for use with small pneumatic tools for light duty applications
- Integrating air hose and support cable keep work areas tidy
- Adjustable ball stop for optional positioning
- Polyvinyl hose 1/4" NPT 1/4" inlet 700 mm
- Model LR-09B-90 - 35 1/2" hose length
- Model LR-09B-200 - 78 1/4" hose length
- 360 degree upper swivel
- 3 lb. weight capacity
- Maximum 142 PSI

CABLE OVERHANG

- Cable overhang is a section of cable which is attached to the retractable cable supplied with the balancers and allows the balancer to be mounted at a higher elevation. Safety cables are strongly recommended on all equipment used overhead.
- Cable overhang cannot be retracted.

TOOL SUPPORT SYSTEMS

Reduce operator fatigue and increase productivity with the ERGO-ARM® ergonomic tool support system series.

- For use with pneumatic and electric tools
- Custom designs available

AD-D1098-PL PRECISION LINEAR ARM

- Tracks perpendicular to workpiece on three moving axis (X,Y,Z) to provide maximum mobility and ease of movement.
- Push button relief valve for no resistance for operator
- Also compatible for use with an automatic screwfeeder head



AD-D1098-PL

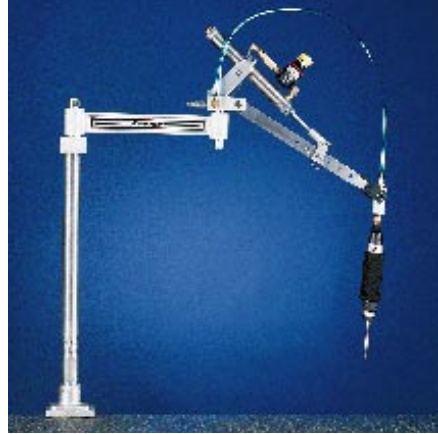

AD-D1098-SAC

AD-D1098-SAC AIR CYLINDER SERIES

- Allows universal tool motion from side to side and front to back
- 2-piece hinged forearm allows more freedom of movement in the assembly process
- Telescoping reach from end of forearm allows easy adjustment in 1-inch increments up to 6 inches
- Also compatible for use with an automatic screwfeeder head

AD-D1098 PARALLEL SERIES

- Available in air or oil cylinder styles
- Compatible for use with an air or electric screwdriver
- Eliminates operator influence



AD-D1098-PAC



AD-D1098-S

AD-D1098-S OIL CYLINDER SERIES

- Allows universal tool motion from side to side and front to back
- 2-piece hinged forearm allows more freedom of movement in the assembly process
- Telescoping reach from end of forearm allows easy adjustment in 1-inch increments up to 6 inches

AD-D1098-SBL ECONOMY

- Allows universal tool motion from side to side and front to back



AD-D1098-SBL

S P E C I F I C A T I O N S

Model	Description	Reach	Capacity	Maximum Torque*
AIR CYLINDER SERIES				
AD-D1098-PL 24	Precision Linear	24"	15 Lbs.	25 Ft. Lbs.
AD-D1098-PL 36	Precision Linear	36"	15 Lbs.	25 Ft. Lbs.
AD-D1098-SAC	Standard	4-33"	0-15 Lbs.	110 In. Lbs.
AD-D1098-PAC	Parallel	4-33"	0-15 Lbs.	110 In. Lbs.
AD-D1098-PACE	Parallel (Electric Tool)	4-33"	0-15 Lbs.	110 In. Lbs.
AD-D1098-SAC-CR	Standard Clean Room	4-33"	0-15 Lbs.	110 In. Lbs.
AD-D1098-PAC-CR	Parallel Clean Room	4-33"	0-15 Lbs.	110 In. Lbs.
OIL CYLINDER SERIES				
AD-D1098-S	Standard	4-33"	0-3 Lbs.	110 In. Lbs.
AD-D1098-SBL	Economy	19-27"	0-3 Lbs.	110 In. Lbs.
AD-D1098-P	Parallel	4-33"	0-3 Lbs.	110 In. Lbs.
AD-D1098-PE	Parallel (Electric Tool)	4-33"	0-3 Lbs.	110 In. Lbs.

■ If the above models do not meet your needs, custom designs are available. ■ Anodized or Powder Coating in custom colors available upon request.
 *Max. torque allowed may be dependent on tool clutch type and joint rate.

CLEAN ROOM ERGO-ARM®

- Blue anodized aluminum finish
- No metal-to-metal joints to create particle count
- 2-piece hinged forearm allows more freedom of movement in the assembly process
- Telescoping reach from end of forearm allows easy adjustment in 1-inch increments
- Arm achieves neutral buoyancy - will not spring away from operator when released
- Resistance can be set to suit individual operator preference
- Reduce operator fatigue
- Provide consistency and accuracy for repetitive assembly tasks
- Heavy duty construction
- For use with pneumatic *and* electric tools

CUSTOM DESIGNED ERGO-ARMS®

- Custom designed Ergo-Arms can be engineered for virtually any application or tooling. Contact AIMCO for criteria required to custom quote your needs.



AD-D1098-PAC-CR

ERGO-ARM® ACCESSORIES

End-of-the arm tooling options for the Ergo-Arm® allow you to choose the style *your* application requires. The tool holders allow the tool to swivel, rotate, swing or twist. Its heavy duty construction allows you to lock out any single or combination of rotating actions allowing only the motions required by your application. In addition, End-of-Arm Tooling brackets allow easy conversion, so one Ergo-Arm® can be used for more than one application.



EAA-21 - Pistol Grip Tool Mount

FOR USE WITH MODELS AD-D1098-S/SAC



EAA-21 - Right Angle Tool Mount



EAP-202ED - Electric Driver Tool Mount

FOR USE WITH MODELS AD-D1098-P/PAC



EAP-203 - Air Manifold Tool Mount (Standard on parallel units)



EAP-202 - Driver Tool Mount

PARALLEL ARM KIT



EAA-04 - Allows you to easily convert standard Ergo-Arms® to the parallel style. The parallel type arm allows vertical entry to the workpiece and allows locking the tool into position.

Note: Not compatible with AD-D1098-PL or AD-D1098-SBL.

WALL CLAMP



EAA-01 - Allows easy wall mounting

BENCH CLAMP



EAA-02 - Allows easy table mounting

WORKSTATION COMPONENTS AND ASSEMBLIES

COMPONENTS

TRACK

Used both for vertical and horizontal supports
Beige polyester finish



Part Number 30# Track

- AT3-3 3 ft track
- AT3-4 4 ft track
- AT3-6 6 ft track
- AT3-9 9 ft track

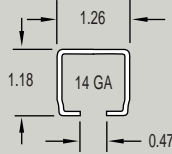

Part Number 50# Track

- AT5-3 3 ft track
- AT5-4 4 ft track
- AT5-6 6 ft track
- AT5-9 9 ft track
- AT5-12 12 ft track

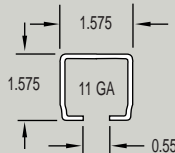

TRACK NUT: ATN-3/5

Zinc plated steel (2 required)
used to attach joint/hanger
bracket to horizontal track
ATN-3-30 lb./ATN-5 .50 lb.



END STOP: AES-3/5

Zinc oxide finish used to
prevent balancer trolley from
“overtraveling” the
horizontal track
AES-3-30 lb./AES-50 for 50 lb.

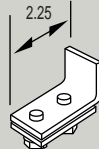

MOUNTING PLATE: AMP-5

Black polyester finish
used for a base to
mount vertical
uprights to
floor or bench top

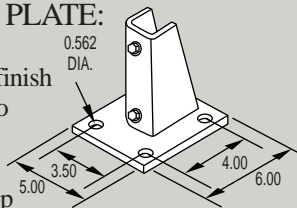

END CAP: AEP-3/5

Black molded vinyl used
to cap off ends of track for
professional finish and
avoids rough edges

- AEP-3 for 30 lb. Track
- AEP-5 for 50 lb. Track

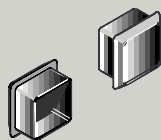

ANGLE BRACKET: AB-3/5

Black polyester finish
used to mount horizontal
track to vertical upright
(adjustable)

- AB-3 for 30 lb. Track
- AB-5 for 50 lb. Track

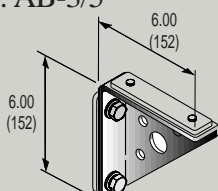

JOINT HANGER BRACKET: AJH-3/5

Black polyester finish used
to couple and hang multiple
pieces of track

- AJH - 3 for 30 lb. Track
- AJH - 5 for 50 lb. Track

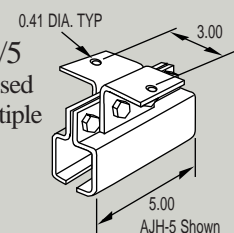

BALANCER TROLLEY: ABT-3/5

Black polyester finish
used as moving supports
for balancers, hose/cable
safety cables. Runs through
horizontal track

- ABT-3 for 30 lb. Track (1.00 dia.)
- ABT-5 for 50 lb. Track (1.25 dia.)

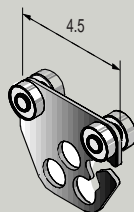

HANGER BRACKET: AHB-3/5

Black polyester finish
used to support/hang
a single piece of track

- AHB 3 for 30 lb.
- AHB 5 for 50 lb.

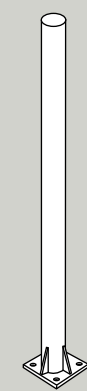
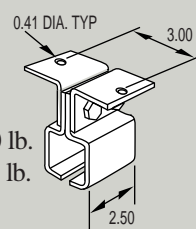

VERTICAL COLUMN: AVC-5

Beige polyester finish used
to support jibs at 90 degree
angle to column
Height: 9 ft

INTERMEDIATE CARRIER: AIC3-2 (30 lb. Track) AIC5-2 (50 lb. Track)

Black polyester finish
used to festoon cable/
hose freely along track.
Supports hose cable
OD .60-.94

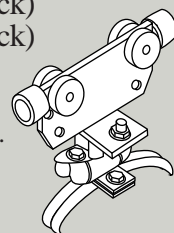

U-BOLTS: AUB-5

Zinc plated steel (3 required)
used to secure fixed/
swinging jibs (AW6S
and AW6F) to
vertical column



END CLAMP: AEC5-2

Black polyester finish
used to prevent trolleys
from “overtravel.”
Continues festoon to
end of track. Cable/hose
OD .60-.94 Used on
both AT5/AT3 Track.

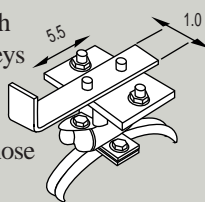

SUPPORT CLAMPS: ASC-5

Black polyester finish
used to secure the
vertical track to back
of bench/conveyor
for stability

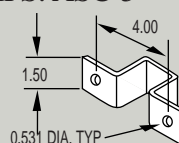

TOOL CLIP: SH-5

Steel clip with safety latch
for tool attachment and other
uses. Measures 2.375” long.



COMPLETE ASSEMBLIES

WALL MOUNTED RUNWAY: AWR6

6 ft of runway and 6 ft jibs includes balancer
trolley, two end stops, two hanger brackets and
four end caps.
50 lb weight
capacity.

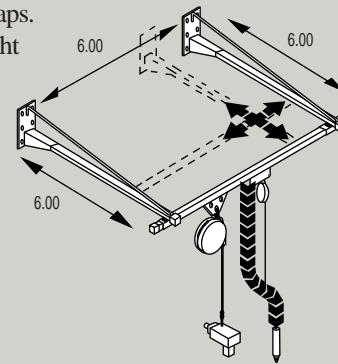

WALL MOUNTED JIBS:

- AW3S 3 ft swinging jib
- AW3F 3 ft fixed jib
- AJS3* 3 ft swinging jib for channel mount

Jibs are mounted to wall or beams
to create free standing workstations.
End stop, end cap and
balancer trolley included.
Maximum weight 30 lbs.

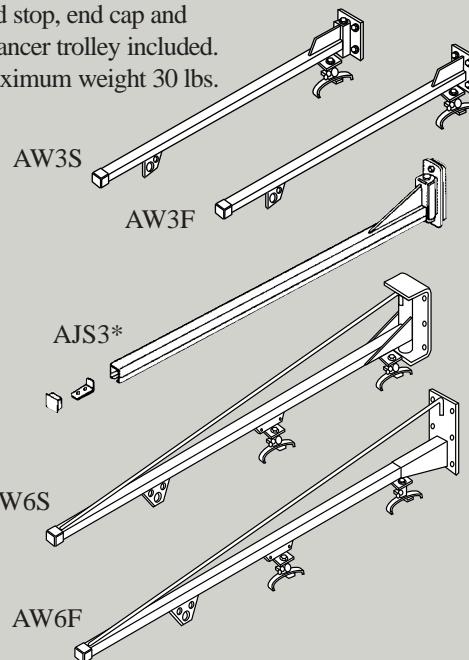

- AW6S 6 ft swinging jib
- AW6F 6 ft fixed jib

Jibs can be wall mounted or attached
to vertical column (AVC-5) to
create a freestanding workstation.
End stop, end caps and
balancer trolley are included.
Maximum weight 50 lbs.

All complete assemblies are beige polyester finish
and include balancer trolley, end caps and end stops.
Floor mounted assemblies are not able to ship via
UPS.

When choosing a workstation system, remember...
total weight capacities should include tool balancer,
balancer, hose/cable and tool/fixture. Units need to
be supported vertically and horizontally every 6 ft.

*AJS3 Does not include balancer trolley.

AW3FMS Floor mounted
3 ft swinging jib
AW3FMF Floor mounted
3 ft fixed jib
Maximum weight 30 lbs
Column height: 6 ft

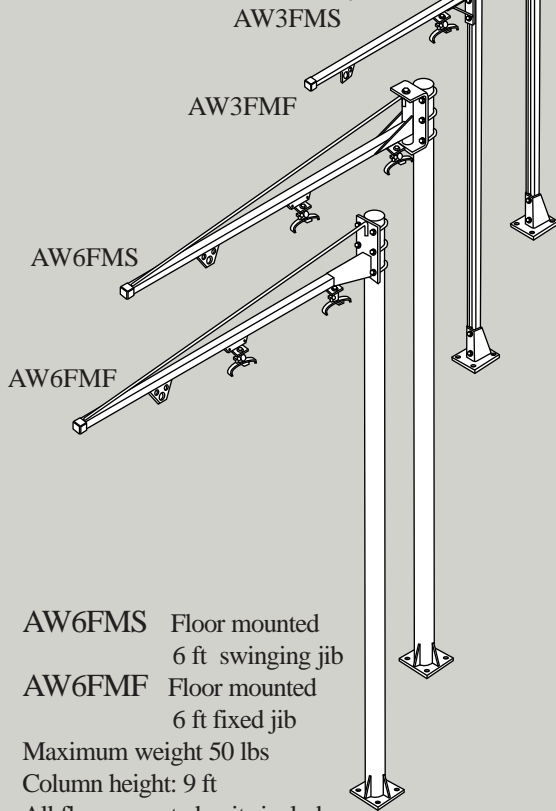

AW6FMS Floor mounted
6 ft swinging jib
AW6FMF Floor mounted
6 ft fixed jib
Maximum weight 50 lbs
Column height: 9 ft

All floor mounted units include:
end stop, balancer trolley and intermediate carrier



CREATE YOUR OWN SUPPORT SYSTEMS TO SUIT YOUR SPECIFIC NEEDS USING WORKSTATION ASSEMBLIES OR COMPONENTS, ERGO-ARMS, AND BALANCERS FROM AIMCO.

- Organize work areas to create a safe, productive working environment
- Reduce risk of cumulative trauma to worker by providing full support of tools
- Protect valuable tools, fixtures, and monitoring devices from damage by suspending them out of the way

AIMCO TOOL SUPPORT ARMS

BENCH MOUNTED WORKSTATION: JJ-30-S

- 30 lbs. maximum weight
- 48" column height including mounting plate
- 3 ft. swinging jib includes balance trolley, end stop and cap
- beige polyester finish

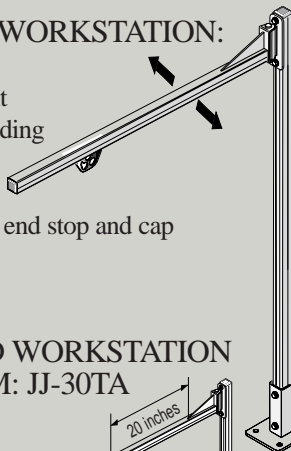

*BENCH MOUNTED WORKSTATION WITH TORQUE ARM: JJ-30TA

- 5 lb. maximum weight (RPA-3 included)
- 5' column height including mounting plate
- 38" jib length (swinging)
- 15 ft/lbs. torque rating
- 3/8" NPT inlet
- 1/4" NPT outlet
- beige polyester finish
- 1/4" braided air hose
- 21" maximum vertical arm travel

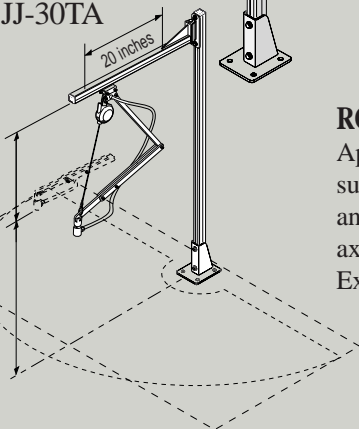

*TROLLEY MOUNTED TORQUE ARM WITH 3 LB. RETRACTOR AND HOSE: FA50-2

Application: To move front to back along overhead jib

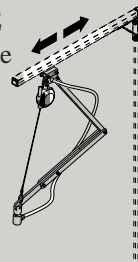

*TROLLEY MOUNTED TORQUE ARM WITH 3 LB. RETRACTOR AND HOSE: TA50-2

Application: To move along overhead tool rail or side to side

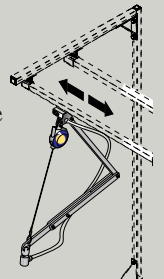

ROLLING HANGER: ABT5-R

Application: To support a runway and allow X/Y axis movement
Example: Crosstracker

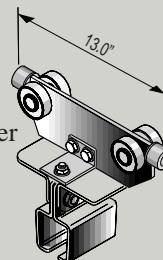

90° CONNECTOR FOR 3/8" HOSE: WSCH

Brass fittings attach to balancer trolley for stable transfer of air line to tool below

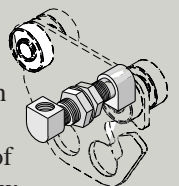

*For use with pneumatic tools only.

Additional AIMCO Accessories



AIMCO SINGLE AIR HOSE

- Durable Polyurethane Hose
- Excellent Recoil Memory
- Maximum Flexibility and Lightweight
- Transparent Hose Color (opaque available)
- Custom Colors Available
- High Chemical Resistance

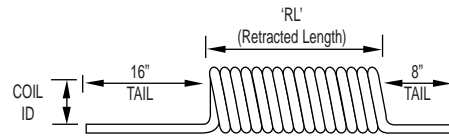

SINGLE AIR HOSE ASSEMBLIES (COILED)

Part Number	Description	Retracted Length	Fittings
	Working Pressure 100PSI (OD x ID x length)		
ASH-250C-10MSZ	3/8" x 1/4" x 10'	7"	1/4"
ASH-250C-15MSZ	3/8" x 1/4" x 15'	9 1/2"	1/4"
ASH-250C-25MSZ	3/8" x 1/4" x 25'	15 1/2"	1/4"
ASH-375C-15MSZ	21/64" x 3/8" x 15'	8 1/2"	3/8"
ASH-375C-25MSZ	21/64" x 3/8" x 25'	14"	3/8"
ASH-500C-15MSZ	3/4" x 1/2" x 15'	11 3/4"	1/2"
ASH-500C-25MSZ	3/4" x 1/2" x 25'	23"	1/2"

- Assemblies include reusable swivel fitting
- Burst pressure 428 PSI @ 68° F
- Working Temperature: -104° F to 175° F

TOOL SWIVELS

For use with most portable air tools, including screwdrivers, drills, grinders, sanders, buffers, staple guns and more. Rotates 360 degrees for awkward angles.

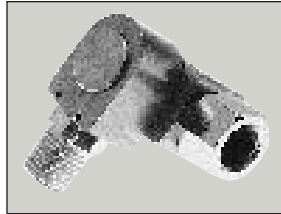

Part Number	Inlet	Weight	Recommended PSI	Tool CFM Range
7021	1/4 NPT	3 oz.	Up to 125	25
7041A	3/8 NPT	5 oz.	Up to 125	50
7051	1/2 NPT	10 oz.	Up to 125	60

* Not to be used with percussive tools.

INLINE MINI REGULATORS

Allows you to easily adjust your airflow with the turn of a dial.

932-100-0	1/8" NPT Capacity
932-110-0	1/4" NPT Capacity

SINGLE AIR HOSE (COILED) CUSTOM

Part Number	Description
	(OD x ID x length)
ASH-250C	1/4" I.D.
ASH-375C	3/8" I.D.
ASH-500C	1/2" I.D.

SINGLE AIR HOSE (STRAIGHT) CUSTOM

ASH-250Z	1/4" I.D.
ASH-375Z	3/8" I.D.
ASH-500Z	1/2" I.D.

INLINE MINI LUBRICATORS

These mist-type inline lubricators keep your air operated tools performing with greater efficiency. The patented "on the tool" mist lubricator system saves money.



Part Number	Description	Weight	Length	NPT	Tool CFM Range
7006	Mini Lube	2 1/2" oz	2 1/4"	1/4"	3-7 CFM
7007	Midget Lube	3 1/2" oz	2 1/2"	1/4"	7-15 CFM
7008	Master Lube	5 oz.	3 1/4"	3/8"	15-30 CFM



AIR HOSE FITTINGS

250-RZ	1/4" NPT Rigid Fitting
250-SZ	1/4" NPT Swivel Fitting
375-RZ	3/8" NPT Rigid Fitting
375-SZ	3/8" NPT Swivel Fitting
500-RZ	1/2" NPT Rigid Fitting
500-SZ	1/2" NPT Swivel Fitting

ERGONOMIC TWIST PLUGS



These unique, ergonomically designed hose fittings provide 360° rotation and 45° angled rotation in any direction.

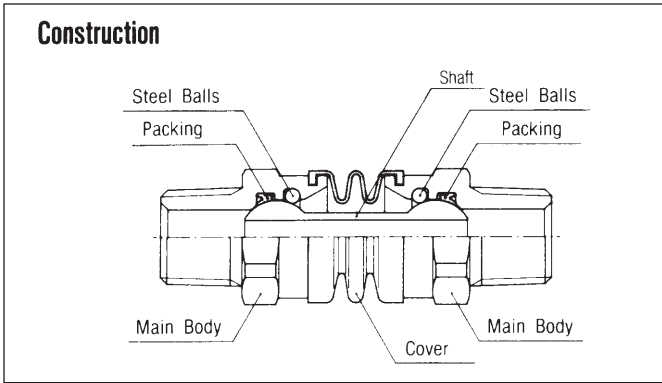

- Two rotation points prevent kinking of air hose
- Lightweight and streamlined design
- Design ensures full flow of air pressure
- Rotating joint is supplied with polyurethane dust cover
- Steel construction for maximum life

SPECIFICATIONS	
Part Number	Description
TS-20NP-3NPT	1/4 NPT Female x 3/8 NPT Male
TS-30NP-2NPT	3/8 NPT Female x 1/4 NPT Male
TS-20NP-2NPT	1/4 NPT Female x 1/4 NPT Male
TS-20US-2NPT	1/4 US Plug x 1/4 NPT Male
TS-20US-3NPT	1/4 US Plug x 3/8 NPT Male
TS-30US-2NPT	3/8 US Plug x 1/4 NPT Male
TS-30US-3NPT	3/8 US Plug x 3/8 NPT Male



AIMCO

MAG-O-NETS

A revolutionary way to convert standard bits to magnetic bits.

AIMCO Mag-O-Nets, available in commonly used sizes, easily slide onto virtually any standard screwdriver bit turning it into a magnetized bit.

These magnetic collars are an easy, cost effective alternate to the traditional magnetic bit holder and insert bit combination. The “wobble” effect typically experienced with the bit holder is eliminated and thus improves torque transfer onto the application.

Mag-O-Nets allow easy adjustment of the magnetic pull you require by moving the magnetic collar closer or farther from the fastener.



Let AIMCO help you improve productivity and quality through Mag-O-Nets and our many other fastener tool products.

Features include:

- Fits virtually any standard screwdriver bit.
- Increase productivity by easily locating fasteners and eliminating dropped fasteners.
- Reusable and interchangeable - Once you wear out a bit, simply remove your Mag-O-Net and slide it onto the next.
- Lifetime guarantee on magnetic pull
- A full line of screwdriver bits are available - Contact your AIMCO sales representative for a complete catalog.

SPECIFICATIONS

Part No.	Inner Diameter (ID)	Outer Diameter (OD)	Length (mm)	Dimensional Drawings
AM1/4	7mm	17.5mm	10mm	
AM5	6mm	15.0mm	10mm	
AM3/16	3/16"	15.0mm	10mm	

AIMCO



BITS AND NUT SETTERS



BITS AND NUT SETTERS

AIMCO has assembled the most complete package of commonly used screwdriver bits and nut setters in the industry. Our goal is to supply you with the highest quality bits and nut setters for all your fastener needs. If you're in the electronics, aerospace or general industry, AIMCO has the bits and nut setters to fit your needs.

Most items are available in both American and Japanese industrial standards to properly fit your fasteners.

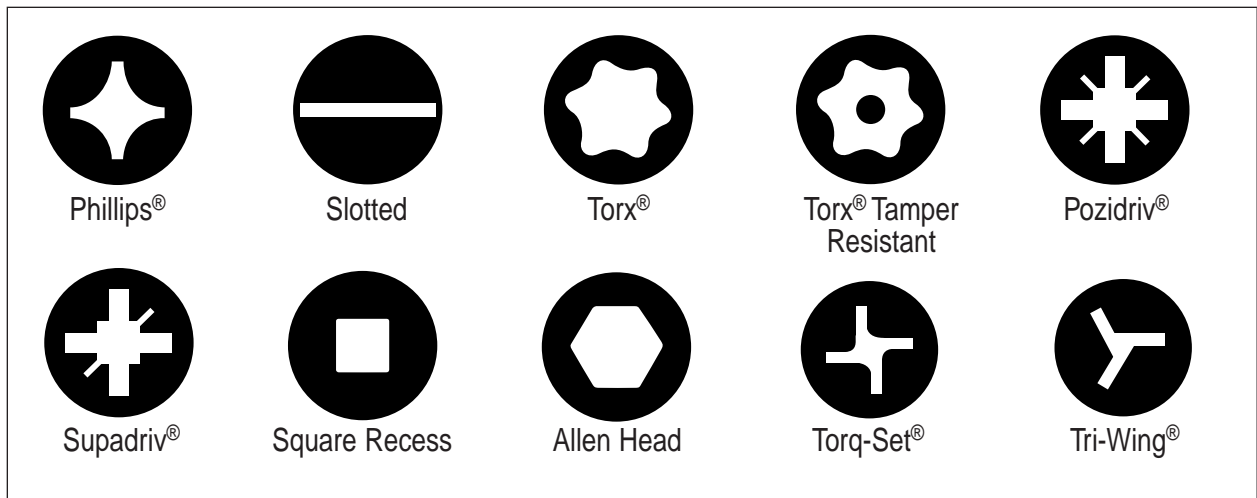
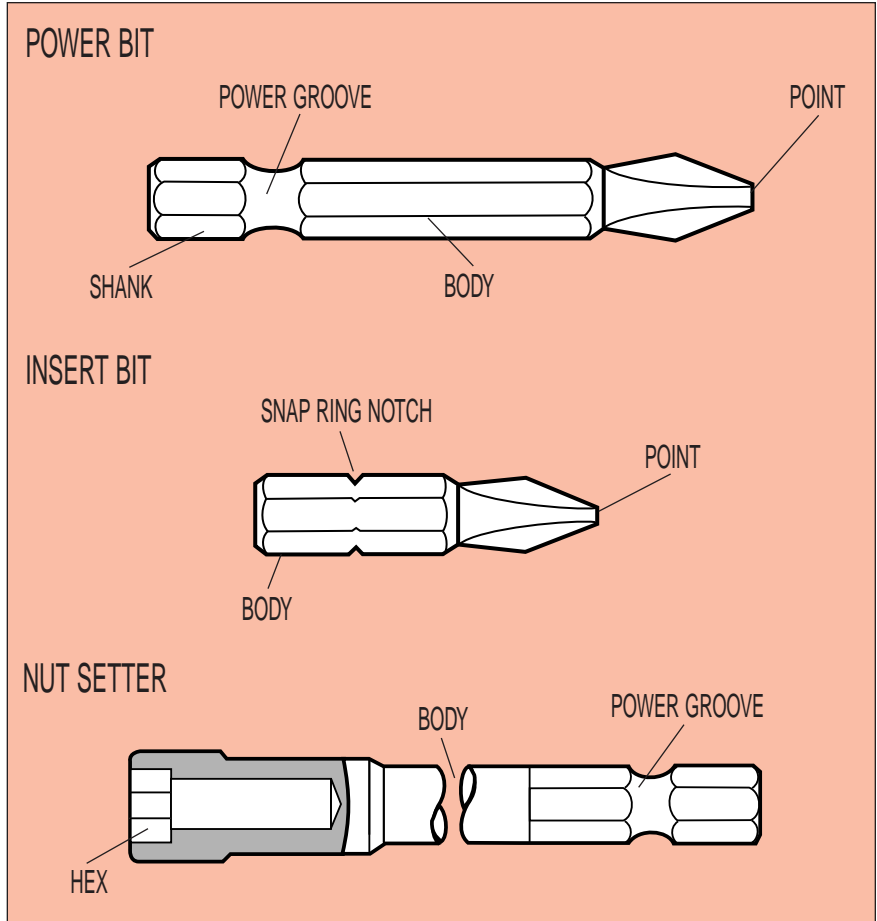

Made to order specials are available upon request.

PHILLIPS® POWER BITS

Puntas Phillips®

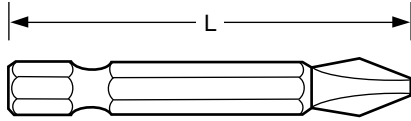
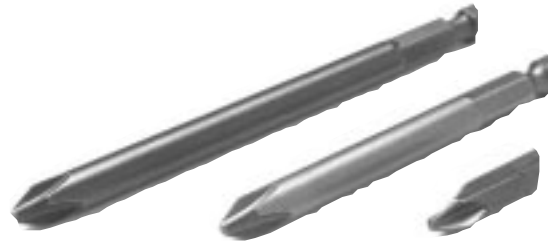

Part No.	Point Size	Length	
		mm	in
A3S0-2	0	50	1.969
A3S1-2	1	50	1.969
A3S1-2.75	1	70	2.756
A3S1-3	1	75	2.953
A3S1-3.5	1	90	3.543
A3S1-4	1	100	3.938
A3S1-6	1	150	5.906
A3S2-1.2	2	30	1.181
A3S2-1.6	2	40	1.574
A3S2-2	2	50	1.969
A3S2-2.75	2	70	2.756
A3S2-3	2	75	2.953
A3S2-3.5	2	90	3.543
A3S2-4	2	100	3.938
A3S2-4.7	2	120	4.724
A3S2-4.75	2	125	4.921
A3S2-6	2	150	5.906
A3S2-8	2	200	7.874
A3S2-10	2	250	9.842
A3S2-12	2	300	11.811
A3S3-2	3	50	1.969
A3S3-2.75	3	70	2.756
A3S3-3	3	75	2.953
A3S3-3.5	3	90	3.543
A3S3-4	3	100	3.938
A3S3-4.7	3	120	4.724
A3S3-6	3	150	5.906
A3S3-8	3	200	7.874
A3S3-10	3	250	9.842
A3S3-12	3	300	11.811

PHILLIPS® POWER BITS DOUBLE ENDED

Puntas de Doble Punta

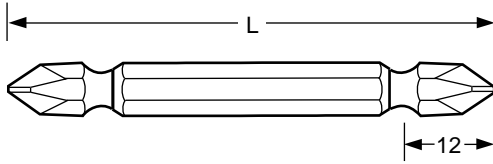
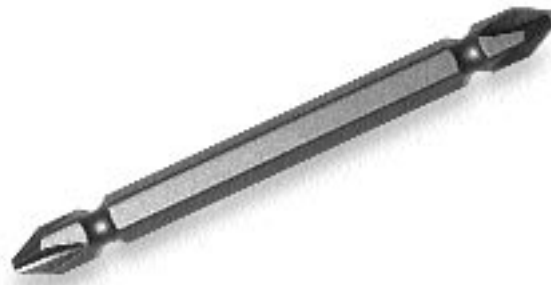

Part No.	Point Size	Length	
		mm	in
A3W1-3	1	75	2.935
A3W1-4	1	100	3.938
A3W2-2	2	50	1.968
A3W2-3	2	75	2.935
A3W2-4	2	100	3.938
A3W2-6	2	150	5.906
A3W2-8	2	200	7.874
A3W2-10	2	250	9.842
A3W2-12	2	300	11.811
A3W3-2	3	50	1.968
A3W3-3	3	75	2.935
A3W3-4	3	100	3.938
A3W3-6	3	150	5.906
A3W3-8	3	200	7.874

PHILLIPS® INSERT BITS

Insertos Phillips®

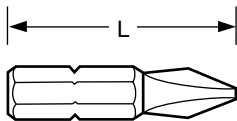

Part No.	Point Size	Length	
		mm	in
A38S0-1	0	25	0.984
A38S1-1	1	25	0.984
A38S1-1.5	1	38	1.496
A38S1-2	1	50	1.969
A38S2-1	2	25	0.984
A38S2-1.5	2	38	1.496
A38S2-2	2	50	1.969
A38S2-2.5	2	65	2.559
A38S3-1	3	25	0.984
A38S4-1	4	25	0.984
A38S4-1.25	4	30	1.181

Reduced Nose Diameter

Insertos Phillips®

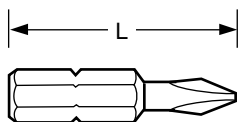

Part No.	Point Size	Length	
		mm	in
A39S1-1	1	25	0.984
A39S2-1	2	25	0.984
A39S2-1.5	2	38	1.496
A39S2-2	2	50	1.969

ACR® PHILLIPS POWER BITS

Puntas Phillips®

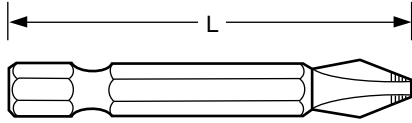

Part No.	Point Size	Length	
		mm	in
A3S1-2ACRI	1	50	1.969
A3S1-2.75ACRI	1	70	2.756
A3S1-3.5ACRI	1	90	3.543
A3S1-6ACRI	1	150	5.906
A3S2-2ACRI	2	50	1.969
A3S2-2.75ACRI	2	70	2.756
A3S2-3.5ACRI	2	90	3.543
A3S2-6ACRI	2	150	5.906
A3S3-2ACRI	3	50	1.969
A3S3-2.75ACRI	3	70	2.756
A3S3-3.5ACRI	3	90	3.543
A3S3-6ACRI	3	150	5.906

ACRI = INSTALL

Part No.	Point Size	Length	
		mm	in
A3S1-2ACR	1	50	1.969
A3S1-3.5ACR	1	87.5	3.445
A3S1-6ACR	1	150	5.906
A3S2-2ACR	2	50	1.969
A3S2-2.75ACR	2	70	2.756
A3S2-3.5ACR	2	90	3.543
A3S2-6ACR	2	150	5.906
A3S3-2ACR	3	50	1.969
A3S3-2.75ACR	3	70	2.756
A3S3-3.5ACR	3	90	3.543
A3S3-6ACR	3	150	5.906

ACR = REMOVE

Part No.	Point Size	Length	
		mm	in
A3S1-2ACRB	1	50	1.969
A3S2-2ACRB	2	50	1.969
A3S3-2ACRB	3	50	1.969

ACRB = BOTH INSTALL AND REMOVE

ACR® PHILLIPS INSERT BITS

Insertos Phillips®

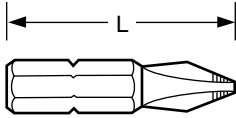

Part No.	Point Size	mm	Length	in
A38S1-1ACRI	1	25.4		1.000
A38S2-1ACRI	2	25		0.984
A38S3-1ACRI	3	25.4		1.000

ACRI = INSTALL

Part No.	Point Size	mm	Length	in
A38S1-1ACR	1	25		0.984
A38S2-1ACR	2	25		0.984
A38S3-1ACR	3	25		0.984

ACR = REMOVE

Part No.	Point Size	mm	Length	in
A38S1-1ACRB	1	25.4		1.000
A38S2-1ACRB	2	25.4		1.000
A38S3-1ACRB	3	25.4		1.000

ACRB = BOTH INSTALL AND REMOVE

Reduced Diameter Insertos Phillips®

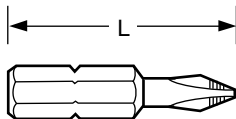

Part No.	Point Size	mm	Length	in
A39S2-1ACRI	2	25.4		1.000
A39S2-1.5ACRI	2	37.5		1.476
A39S2-2ACRI	2	50		1.969

ACRI = INSTALL

Part No.	Point Size	mm	Length	in
A39S2-1ACR	2	25.4		1.000
A39S2-1.5ACR	2	37.5		1.476
A39S2-2ACR	2	50		1.969

ACR = REMOVE

SLOTTED POWER BITS

Puntas Agujereadas

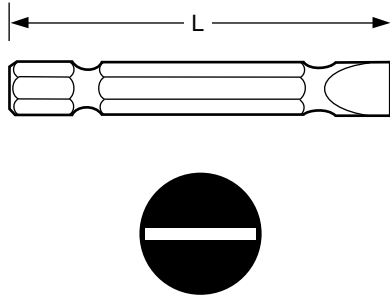

Part No.	Screw Size	Length		Blade Thickness	Blade Width
		mm	in		
A3M8-2	8	50	1.969	.042	0.275
A3M8-2.75	8	70	2.756	.042	0.275
A3M8-3	8	75	2.953	.042	0.275
A3M10-2	10	50	1.969	.046	0.312
A3M10-2.75	10	70	2.756	.046	0.312
A3M10-3	10	75	2.953	.046	0.312
A3M12-2	12	50	1.969	.050	0.360
A3M12-2.75	12	70	2.756	.050	0.360
A3M12-3	12	75	2.953	.050	0.360

Reduced Diameter
Puntas Ranurados Con Diametro Reducido

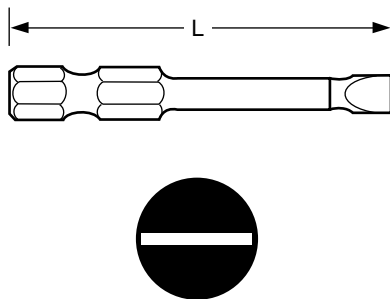

Part No.	Screw Size	Length		Blade Thickness	Blade Width
		mm	in		
A3MT1-2	1	50	1.969	.022	0.122
A3MT1-3	1	75	2.953	.022	0.122
A3MT3-2	3	50	1.969	.030	0.154
A3MT3-3	3	75	2.953	.030	0.154
A3MT4-2	4	50	1.969	.034	0.188
A3MT4-2.75	4	70	2.756	.034	0.188
A3MT4-3	4	75	2.953	.034	0.188
A3MT5-2	5	50	1.969	.036	0.250
A3MT5-2.75	5	70	2.756	.036	0.250
A3MT5-3	5	75	2.953	.036	0.250
A3MT6-2	6	50	1.969	.038	0.250
A3MT6-2.75	6	70	2.756	.038	0.250
A3MT6-3	6	75	2.953	.038	0.250

SLOTTED INSERT BITS

Insertos Ranurados

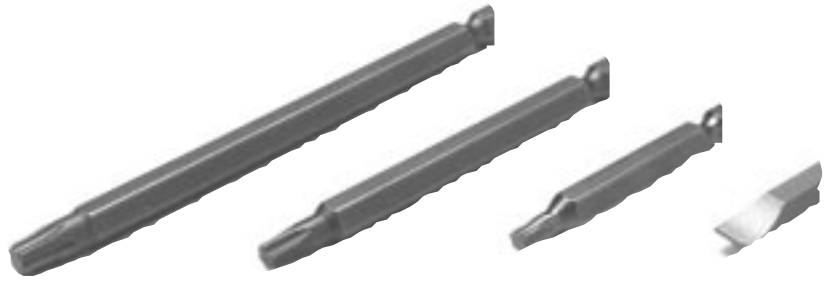
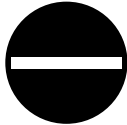
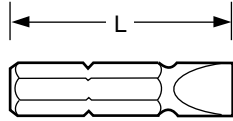

Part No.	Screw Size	Length		Blade Thickness	Blade Width
		mm	in		
A38M2-1	2	25	0.984	0.026	0.281
A38M2-1.5	2	38	1.496	0.026	0.138
A38M3-1	3	25	0.984	0.030	0.154
A38M3-1.5	3	38	1.496	0.030	0.154
A38M4-1	4	25	0.984	0.030	0.170
A38M4-1.5	4	38	1.496	0.034	0.188
A38M5-1	5	25	0.984	0.036	0.219
A38M6-1	6	25	0.984	0.040	0.219
A38M6-1.5	6	38	1.496	0.040	0.218
A38M8-1	8	25	0.984	0.042	0.250
A38M8-1.5	8	38	1.496	0.042	0.250
A38M10-1	10	25	0.984	0.046	0.281
A38M10-1.5	10	38	1.496	0.046	0.281
A38M12-1.5	12	38	1.496	0.050	0.297
A38M14-1.5	14	38	1.496	0.550	0.344

TORX® POWER BITS

Puntas Torx®

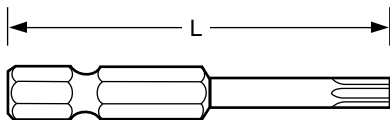

Part No.	Torx Size	Length	
		mm	in
A3T6-2	T6	50	1.969
A3T7-2	T7	50	1.969
A3T7-2.75	T7	70	2.756
A3T7-3.5	T7	90	3.543
A3T7-6	T7	150	5.906
A3T8-2	T8	50	1.969
A3T8-2.75	T8	70	2.756
A3T8-3.5	T8	90	3.543
A3T8-6	T8	150	5.906
A3T9-2	T9	50	1.969
A3T9-2.75	T9	70	2.756
A3T9-3.5	T9	90	3.543
A3T9-6	T9	150	5.906
A3T10-2	T10	50	1.969
A3T10-2.75	T10	70	2.756
A3T10-3.5	T10	90	3.543
A3T10-6	T10	150	5.906

TORX® POWER BITS

Puntas Torx®

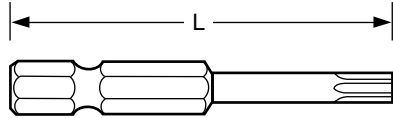

Part No.	Torx Size	Length	
		mm	in
A3T15-2	T15	50	1.969
A3T15-2.75	T15	70	2.756
A3T15-3.5	T15	90	3.543
A3T15-6	T15	150	5.906
A3T20-2	T20	50	1.969
A3T20-2.75	T20	70	2.756
A3T20-3.5	T20	90	3.543
A3T20-6	T20	150	5.906
A3T25-2	T25	50	1.969
A3T25-2.75	T25	70	2.756
A3T25-3.5	T25	90	3.543
A3T25-6	T25	150	5.906
A3T27-2	T27	50	1.969
A3T27-2.75	T27	70	2.756
A3T27-3.5	T27	90	3.543
A3T27-6	T27	150	5.906
A3T30-2	T30	50	1.969
A3T30-2.75	T30	70	2.756
A3T30-3.5	T30	90	3.543
A3T30-6	T30	150	5.906
A3T40-2	T40	50	1.969
A3T40-2.75	T40	70	2.756
A3T40-3.5	T40	90	3.543
A3T40-6	T40	150	5.906

TAMPER RESISTANT

Torx® (Extra Resistencia)

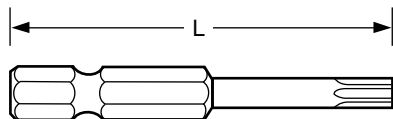

Part No.	Torx Size	Length	
		mm	in
A3T10-2TR	T10	50	1.969
A3T15-2TR	T15	50	1.969
A3T20-2TR	T20	50	1.969
A3T25-2TR	T25	50	1.969

TORX® INSERT BITS

Insertos Torx®

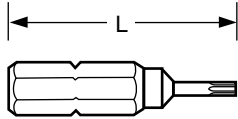

Part No.	Torx Size	Length	
		mm	in
A38T6-1	T6	25	0.984
A38T7-1	T7	25	0.984
A38T8-1	T8	25	0.984
A38T9-1	T9	25	0.984
A38T10-1	T10	25	0.984
A38T15-1	T15	25	0.984
A38T20-1	T20	25	0.984
A38T25-1	T25	25	0.984
A38T27-1	T27	25	0.984
A38T30-1	T30	25	0.984
A38T40-1	T40	25	0.984

TAMPER RESISTANT

Torx® (Extra Resistencia)

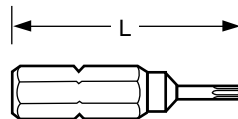

Part No.	Torx Size	Length	
		mm	in
A38T7-1TR	T7	25	0.984
A38T8-1TR	T8	25	0.984
A38T9-1TR	T9	25	0.984
A38T10-1TR	T10	25	0.984
A38T15-1TR	T15	25	0.984
A38T20-1TR	T20	25	0.984
A38T25-1TR	T25	25	0.984
A38T27-1TR	T27	25	0.984
A38T30-1TR	T30	25	0.984
A38T40-1TR	T40	25	0.984

POZIDRIV® POWER BITS

Puntas Pozidriv®

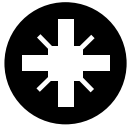
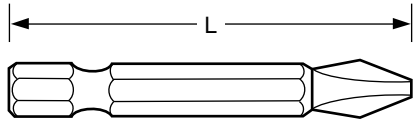

ACR® TYPE

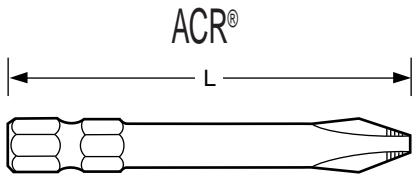

Part No.	Point Size	Length	
		mm	in
A3S1-2PZ	1	50	1.969
A3S1-2.75PZ	1	70	2.756
A3S1-3.5PZ	1	88.9	3.500
A3S2-2PZ	2	50	1.969
A3S2-2.75PZ	2	70	2.756
A3S2-3.5PZ	2	88.9	3.500
A3S3-2PZ	3	50	1.969
A3S3-2.75PZ	3	70	2.756

Part No.	Point Size	Length	
		mm	in
A3S2-2PZARCB	2	50	1.969

POZIDRIV® INSERT BITS

Insertos Pozidriv®

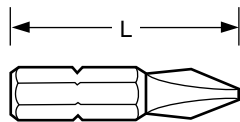

ACR® TYPE

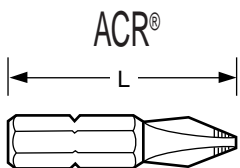

Reduced Diameter
Insertos Ranurados Con Diametro
Reducido

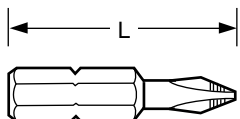

Part No.	Point Size	Length	
		mm	in
A38S1-1PZ	1	25	0.984
A38S2-1PZ	2	25	0.984

Part No.	Point Size	Length	
		mm	in
A38S1-1PZARCB	1	25.4	1.000
A38S2-1PZARCB	2	25.4	1.000
A38S3-1PZARCB	3	25.4	1.000

Part No.	Point Size	Length	
		mm	in
A39S1-1PZ	1	25	0.984
A39S2-1PZ	2	25	0.984

ACR® and Pozidriv® are registered trademarks of the Phillips Screwdriver Company.

SUPADRIV® POWER BITS

Puntas Supadriv®

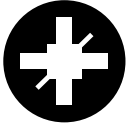
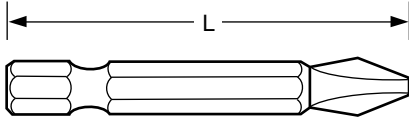
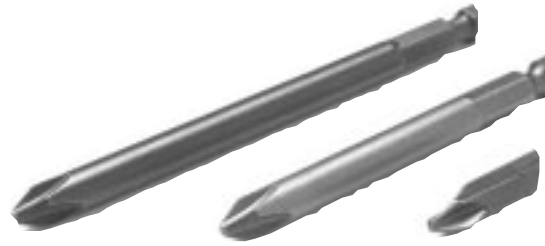

Part No.	Point Size	Length	
		mm	in
A3S1-2SDV	1	50	1.969
A3S2-2SDV	2	50	1.969
A3S3-2SDV	3	50	1.969

SUPADRIV® INSERT BITS

Insertos Supadriv®

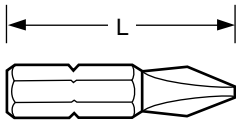

Part No.	Point Size	Length	
		mm	in
A38S1-1SDV	1	25	0.984
A38S2-1SDV	2	25	0.984

Reduced Diameter
Insertos Ranurados Con Diametro
Reducido

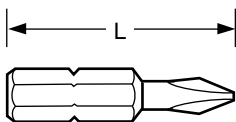

Part No.	Point Size	Length	
		mm	in
A39S2-1SDV	2	25	0.984

ALLEN DRIVE POWER BITS

Puntas Socket Cabeza Allen

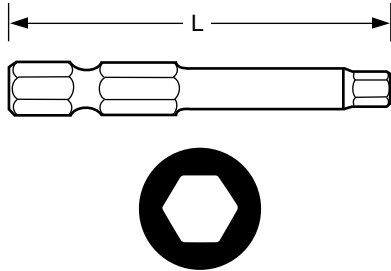

Part No.	Hex	Length	
		mm	in
A3C1/16-2	1/16"	50	1.969
A3C5/64-2	5/64"	50	1.969
A3C3/32-2	3/32"	50	1.969
A3C7/64-2	7/64"	50	1.969
A3C1/8-2	1/8"	50	1.969
A3C9/64-2	9/64"	50	1.969
A3C5/32-2	5/32"	50	1.969
A3C3/16-2	3/16"	50	1.969
A3C7/32-2	7/32"	50	1.969
A3C1/4-2	1/4"	50	1.969
A3C5/16-2	5/16"	50	1.969

Part No.	Hex	Length	
		mm	in
A3C2-2	2 mm	50	1.969
A3C2.5-2	2.5 mm	50	1.969
A3C3-2	3 mm	50	1.969
A3C4-2	4 mm	50	1.969
A3C5-2	5 mm	50	1.969
A3C6-2	6 mm	50	1.969
A3C8-2	8 mm	50	1.969
A3C10-2	10 mm	50	1.969

7/16" HEX SHANK

Puntas 7/16

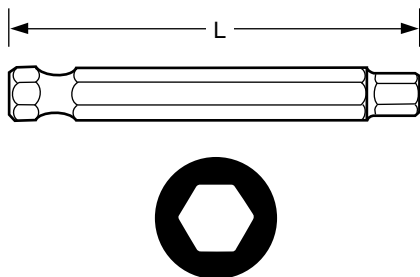

Part No.	Hex	Length	
		mm	in
A7C5-3.5	5 mm	90	3.543
A7C6-3.5	6 mm	90	3.543
A7C8-3.5	8 mm	90	3.543
A7C10-3.5	10 mm	90	3.543

ALLEN HEAD INSERT BITS

Insertos Cabeza Allen

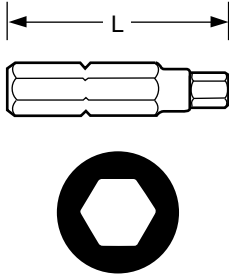

Part No.	Hex	Length	
		mm	in
A38C1/16-1	1/16"	25.4	1.000
A38C5/64-1	5/64"	25.4	1.000
A38C3/32-1	3/32"	25.4	1.000
A38C7/64-1	7/64"	25.4	1.000
A38C1/8-1	1/8"	25.4	1.000
A38C9/64-1	9/64"	25.4	1.000
A38C5/32-1	5/32"	25.4	1.000
A38C5/32 -2	5/32"	50.0	1.969
A38C3/16-1	3/16"	25.4	1.000
A38C3/16-2	3/16"	50.0	1.969
A38C7/32-1	7/32"	25.4	1.000
A38C7/32-2	7/32"	50.0	1.969
A38C1/4 -1	1/4"	25.4	1.000
A38C1/4-2	1/4"	50.0	1.969
A38C5/16-1	5/16"	25.4	1.000
A38C3/8-1	3/8"	25.4	1.000

Part No.	Hex	Length	
		mm	in
A38C1.5-1	1.5 mm	25	0.984
A38C2-1	2 mm	25	0.984
A38C2.5-1	2.5 mm	25	0.984
A38C3-1	3 mm	25	0.984
A38C4-1	4 mm	25	0.984
A38C4-2	4 mm	50	1.969
A38C5-1	5 mm	25	0.984
A38C5-2	5 mm	50	1.969
A38C6-1	6 mm	25	0.984
A38C6-2	6 mm	50	1.969
A38C7-1	7 mm	25	0.984
A38C7-2	7 mm	50	1.969
A38C8-1	8 mm	25	0.984
A38C8-1.25	8 mm	31	1.220

SQUARE RECESS POWER BITS

Puntas Cuadradas (Macho)



Reduced Diameter
Puntas Cuadradas Con Diametro
Reducido

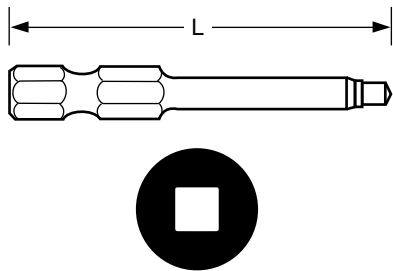

Part No.	Nominal Square Size	Length	
		mm	in
A3RT1/16-2	1/16"	50	1.969
A3RT1/16-2.75	1/16"	70	2.756
A3RT1/16-3.5	1/16"	90	3.543
A3RT3/32-2	3/32"	50	1.969
A3RT3/32-2.75	3/32"	70	2.756
A3RT3/32-3.5	3/32"	90	3.543
A3RT1/8-2	1/8"	50	1.969
A3RT1/8-2.75	1/8"	70	2.756
A3RT1/8-3.5	1/8"	90	3.543
A3RT9/64-2	9/64"	50	1.969
A3RT9/64-2.75	9/64"	70	2.756
A3RT9/64-3.5	9/64"	90	3.543

Part No.	Nominal Square Size	Length	
		mm	in
A3R1/16-2	1/16"	50	1.969
A3R1/16-2.75	1/16"	70	2.756
A3R3/32-2	3/32"	50	1.969
A3R3/32-2.75	3/32"	70	2.756
A3R1/8-2	1/8"	50	1.969
A3R1/8-2.75	1/8"	70	2.756
A3R9/64-2	9/64"	50	1.969
A3R9/64-2.75	9/64"	70	2.756

SQUARE RECESS INSERT BITS

Puntas Cuadradas (Macho)

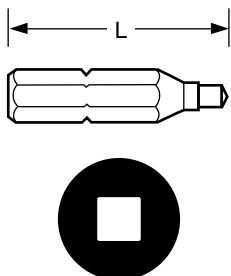

Part No.	Nominal Square Size	Length	
		mm	in
A38R1/16-1	1/16"	25	0.984
A38R3/32-1	3/32"	25	0.984
A38R1/8-1	1/8"	25	0.984
A38R9/64-1	9/64"	25	0.984

TORQ-SET® POWER BITS

Puntas Torq-Set®

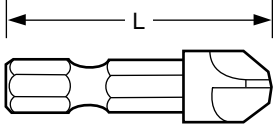

Part No.	Screw Size	Length	
		mm	in
A3TS 1/4-1.25	1/4	31	1.220
A3TS 5/16-1.25	5/16	31	1.220
A3TS 3/8-1.25	3/8	31	1.220
A3TS 7/16-1.25	7/16	31	1.220
A3TS 1/2-1.25	1/2	31	1.220
A3TS0-1.25	0	31	1.220
A3TS0-2	0	50	1.969
A3TS0-3.5	0	90	3.543
A3TS0-6	0	150	5.906
A3TS1-1.25	1	31	1.220
A3TS1-2	1	50	1.969
A3TS1-3.5	1	90	3.543
A3TS1-6	1	150	5.906
A3TS2-1.25	2	31	1.220
A3TS2-2	2	50	1.969
A3TS2-3.5	2	90	3.543
A3TS2-6	2	150	5.906
A3TS3-1.25	3	31	1.220
A3TS3-2	3	50	1.969
A3TS3-3.5	3	90	3.543
A3TS3-6	3	150	5.906
A3TS4-1.25	4	31	1.220
A3TS4-2	4	50	1.969
A3TS4-3.5	4	90	3.543
A3TS4-6	4	150	5.906
A3TS5-1.25	5	31	1.220
A3TS5-2	5	50	1.969
A3TS5-3.5	5	90	3.543
A3TS5-6	5	150	5.906
A3TS6-1.25	6	31	1.220
A3TS6-2	6	50	1.969
A3TS6-3.5	6	90	3.543
A3TS6-6	6	150	5.906
A3TS8-1.25	8	31	1.220
A3TS8-2	8	50	1.969
A3TS8-3.5	8	90	3.543
A3TS8-6	8	150	5.906
A3TS10-1.25	10	31	1.220
A3TS10-2	10	50	1.969
A3TS10-3.5	10	90	3.543
A3TS10-6	10	150	5.906

TORQ-SET® ACR® POWER BITS

Puntas Torq-Set® ACR®

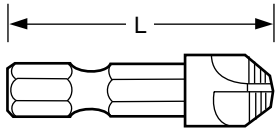

Part No.	Screw Size	Length	
		mm	in
A3TS6-1.25ACR	6	31	1.220
A3TS8-1.25ACR	8	31	1.220

TORQ-SET® INSERT BITS

Insertos Torq-Set®

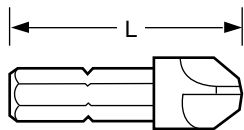

Part No.	Screw Size	Length	
		mm	in
A38TS 1/4-1	1/4	25	0.984
A38TS 5/16-1	5/16	25	0.984
A38TS0-1	0	25	0.984
A38TS1-1	1	25	0.984
A38TS2-1	2	25	0.984
A38TS3-1	3	25	0.984
A38TS4-1	4	25	0.984
A38TS5-1	5	25	0.984
A38TS6-1	6	25	0.984
A38TS8-1	8	25	0.984
A38TS10-1	10	25	0.984

ACR® TYPE

ACR®

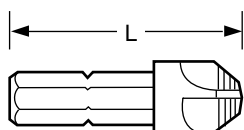

Part No.	Screw Size	Length	
		mm	in
A38TS6-1ACR	6	25	0.984
A38TS8-1ACR	8	25	0.984
A38TS10-1ACR	10	25	0.984

TRI-WING® POWER BITS

Puntas Tri-Wing®

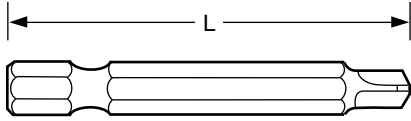

Part No.	Recess #	Length		Tension Head	Shear Head
		mm	in		
A3TW0-1.25	0	31	1.220	0-80	-
A3TW1-1.25	1	31	1.220	2-56	4-40
A3TW2-1.25	2	31	1.220	4-40	6-32
A3TW3-1.25	3	31	1.220	6-32	8-32
A3TW4-1.25	4	31	1.220	8-32	10-32
A3TW5-1.25	5	31	1.220	10-32	1/4-32
A3TW6-1.25	6	31	1.220	1/4-28	5/16-24
A3TW7-1.25	7	31	1.220	1/4-28	5/16-24
A3TW8-1.25	8	31	1.220	3/8-24	7/16-20

ACR® TYPE



Part No.	Recess #	Length		Tension Head	Shear Head
		mm	in		
A3TW3-1.25ACR	3	31	1.220	6-32	8-32
A3TW4-1.25ACR	4	31	1.220	8-32	10-32
A3TW5-1.25ACR	5	31	1.220	10-32	1/4-28
A3TW6-1.25 ACR	6	31	1.220	1/4-28	5/16-24

TRI-WING® INSERT BITS

Insertos Tri-Wing®

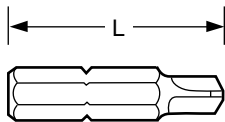

Part No.	Recess #	Length		Tension Head	Shear Head
		mm	in		
A38TW0-1	0	25	0.984	0-80	-
A38TW1-1	1	25	0.984	2-56	4-40
A38TW2-1	2	25	0.984	4-40	6-32
A38TW3-1	3	25	0.984	6-32	8-32
A38TW4-1	4	25	0.984	8-32	10-32
A38TW5-1	5	25	0.984	10-32	1/4-28
A38TW6-1.25	6	31	1.220	1/4-28	5/16-24
A38TW7-1.25	7	31	1.220	5/16-24	3/8-24
A38TW8-1.25	8	31	1.220	3/8-24	7/16-20

ACR® TYPE

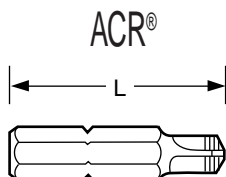

Part No.	Recess #	Length		Tension Head	Shear Head
		mm	in		
A38TW3-1ACR	3	25	0.984	6-32	8-32
A38TW4-1ACR	4	25	0.984	8-32	10-32
A38TW5-1ACR	5	25	0.984	10-32	1/4-28
A38TW6-1.25ACR	6	31	1.220	1/4-28	5/16-24

Tri-Wing® and ACR® are registered trademarks of the Phillips Screwdriver Company.

ELECTRIC BITS

Puntas Electricas

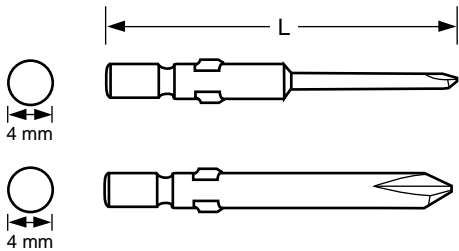
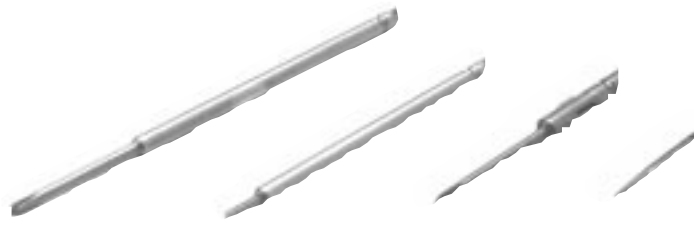

Part No.	Point Size	Length	
		mm	in
A00X4X40	00	40	1.754
A00X4X60	00	60	2.362
A0X4X40	0	40	1.754
A0X4X80	0	80	3.149
A1X4X40	1	40	1.754
A2X4X40	2	40	1.754

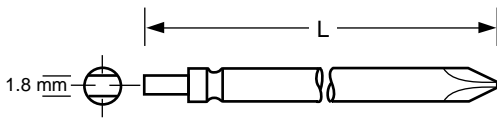

Part No.	Point Size	Length	
		mm	in
A26S0-1.25	0	31	1.22
A26S0-2.75	0	70	2.755
A26S1-1.25	1	31	1.222
A26S1-2.75	1	70	2.755
A26S2-1.25	2	31	1.22
A26S2-2.75	2	70	2.755

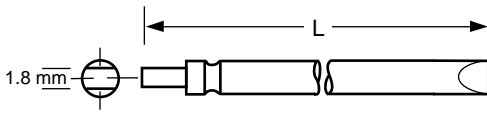

Part No.	Screw Size	Length		Blade Thickness	Blade Width
		mm	in		
A26M2-1.25	2	31	1.255	0.026	0.138
A26M3-1.25	3	31	1.255	0.03	0.154

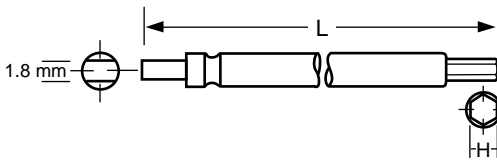

Part No.	H	Length	
		mm	in
A26C1.5-2	1.5 mm	50	1.968
A26C2-2	2 mm	50	1.968
A26C2.5-2	2.5 mm	50	1.968

NUT SETTERS

Encajes para Destornillador

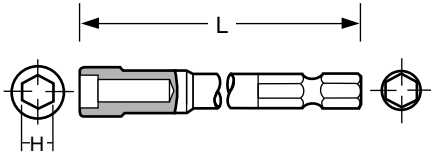

Part No.	Hex	Length	
		mm	in
A3B1/4-2	1/4	50	1.969
A3B1/4-2.5	1/4	63.498	2.5
A3B5/16-2	5/16	50	1.969
A3B5/16-2.5	5/16	63.498	2.5
A3B3/8-2	3/8	50	1.969
A3B3/8-2.5	3/8	63.498	2.5
A3B05-2.75	5 mm	70	2.756
A3B55-1.2	5.5 mm	30	1.181
A3B55-2.75	5.5 mm	70	2.756
A3B55-4	5.5 mm	100	3.937
A3B06-2.75	6 mm	70	2.756
A3B07-1.2	7 mm	30	1.181
A3B07-2	7 mm	50	1.969
A3B07-2.75	7 mm	70	2.756
A3B07-4	7 mm	100	3.937
A3B08-1.2	8 mm	30	1.181
A3B08-2	8 mm	50	1.969
A3B08-2.75	8 mm	70	2.756
A3B08-4	8 mm	100	3.937
A3B08-6	8 mm	150	5.906
A3B08-8	8 mm	200	7.874
A3B09-2.75	9 mm	70	2.756
A3B09-4	9 mm	100	3.937
A3B10-1.2	10 mm	30	1.181
A3B10-2	10 mm	50	1.969
A3B10-2.75	10 mm	70	2.756
A3B10-4	10 mm	100	3.937
A3B10-6	10 mm	150	5.906
A3B10-8	10 mm	200	7.874
A3B11-2.75	11 mm	70	2.756
A3B11-4	11 mm	100	3.937
A3B12-1.2	12 mm	30	1.181
A3B12-2	12 mm	50	1.969
A3B12-2.75	12 mm	70	2.756
A3B12-4	12 mm	100	3.937
A3B12-6	12 mm	150	5.906
A3B12-8	12 mm	200	7.874
A3B13-2.75	13 mm	70	2.756
A3B13-4	13 mm	100	3.937
A3B14-2.75	14 mm	70	2.756
A3B14-4	14 mm	100	3.937
A3B14-6	14 mm	150	5.906
A3B16-2.75	16 mm	70	2.756
A3B17-2.75	17 mm	70	2.756
A3B17-4	17 mm	100	3.937

MAGNETIC NUT SETTERS

Encajes Magneticos



MP Type

Encajes Magneticos (MP) a Presion

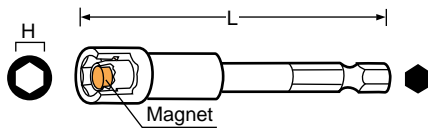

Part No.	Hex	Length	
		mm	in
A3BMP1/4-2	1/4	50	1.969
A3BMP1/4-2.5	1/4	63.498	2.5
A3BMP5/16-2	5/16	50	1.969
A3BMP5/16-2.5	5/16	63.498	2.5
A3BMP3/8-2	3/8	50	1.969
A3BMP3/8-2.5	3/8	63.498	2.5
A3BMP55-2.75	5.5 mm	70	2.756
A3BMP55-4	5.5 mm	100	3.937
A3BMP06-2.75	6 mm	70	2.756
A3BMP06-4	6 mm	100	3.937
A3BMP07-2	7 mm	50	1.969
A3BMP07-2.75	7 mm	70	2.756
A3BMP07-4	7 mm	100	3.937
A3BMP08-2	8 mm	50	1.969
A3BMP08-2.75	8 mm	70	2.756
A3BMP08-4	8 mm	100	3.937
A3BMP10-2	10 mm	50	1.969
A3BMP10-2.75	10 mm	70	2.756
A3BMP10-4	10 mm	100	3.937
A3BMP12-2	12 mm	50	1.969
A3BMP12-2.75	12 mm	70	2.756
A3BMP12-4	12 mm	100	3.937
A3BMP14-2.75	14 mm	70	2.756
A3BMP14-4	14 mm	100	3.937

MS Type

Encajes Magneticos (MS) Modelo Deslizante

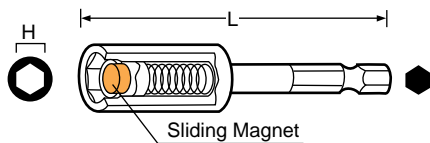

Part No.	Hex	Length	
		mm	in
A3BMS08-2.75	8 mm	70	2.756
A3BMS08-4	8 mm	100	3.937
A3BMS08-6	8 mm	150	5.906
A3BMS10-2.75	10 mm	70	2.756
A3BMS10-4	10 mm	100	3.937
A3BMS10-6	10 mm	150	5.906
A3BMS10-8	10 mm	200	7.874
A3BMS12-2.75	12 mm	70	2.756
A3BMS12-4	12 mm	100	3.937
A3BMS12-6	12 mm	150	5.906
A3BMS14-4	14 mm	100	3.937

MT Type

Encajes Magneticos (MT) Modelo Tubular

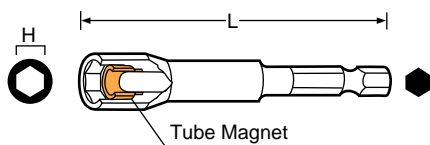

Part No.	Hex	Length	
		mm	in
A3BMT08-2.75	8 mm	70	2.756
A3BMT08-4	8 mm	100	3.937
A3BMT10-2.75	10 mm	70	2.756
A3BMT10-4	10 mm	100	3.937
A3BMT12-2.75	12 mm	70	2.756
A3BMT12-4	12 mm	100	3.937
A3BMT14-2.75	14 mm	70	2.756
A3BMT14-4	14 mm	100	3.937

UNIVERSAL NUT SETTERS

Encajes para Destornillador
Universales

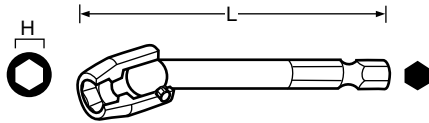

Part No.	Hex	Length	
		mm	in
A3BU08-4	8 mm	100	3.937
A3BU08-6	8 mm	150	5.906
A3BU08-8	8 mm	200	7.874
A3BU10-4	10 mm	100	3.937
A3BU10-6	10 mm	150	5.906
A3BU10-8	10 mm	200	7.874
A3BU12-4	12 mm	100	3.937
A3BU12-6	12 mm	150	5.906
A3BU12-8	12 mm	200	7.874
A3BU14-4	14 mm	100	3.937
A3BU14-6	14 mm	150	5.906
A3BU14-8	14 mm	200	7.874

MAG-O-NETS

Detachable Magnetic Rings
for Screwdriver Bits

Anillos Magéticos para
Puntas de Destornillador

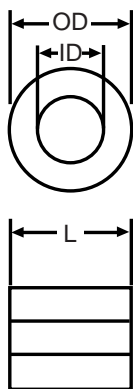
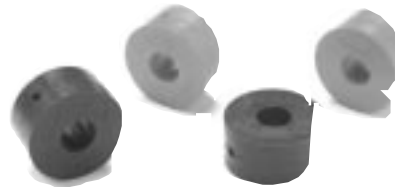

Part No.	Inner Diameter (ID)	Outer Diameter (OD)	Length mm
AM1/4	7mm	19mm	10 mm
AM5	6mm	17.5	10 mm
AM3/16	3/16	17.5	10 mm

BIT ADAPTERS

Adaptadores

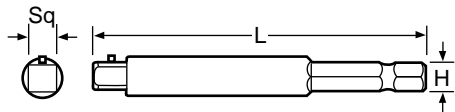

Part No.	Square Drive	H	Length	
			mm	in
A3S02A-1.375	1/4"	1/4"	35	1.378
A3S02A-2	1/4"	1/4"	50	1.969
A3S02A-3	1/4"	1/4"	75	2.953
A3S02A-4	1/4"	1/4"	100	3.937
A3S02A-5	1/4"	1/4"	128	5.039
A3S02A-6	1/4"	1/4"	150	5.906
A3S02A-8	1/4"	1/4"	200	7.874
A3S02A-10	1/4"	1/4"	250	9.843
A3S02A-12	1/4"	1/4"	300	11.811
<hr/>				
A3S03A-2	3/8"	1/4"	50	1.969
A3S03A-3	3/8"	1/4"	75	2.953
A3S03A-4	3/8"	1/4"	100	3.937
A3S03A-6	3/8"	1/4"	150	5.906
A3S03A-8	3/8"	1/4"	200	7.874

Part No.	Square Drive	H	Length	
			mm	in
A703A-1.75	3/8"	7/16"	45	1.772
A703A-2	3/8"	7/16"	50	1.969
A703A-3	3/8"	7/16"	75	2.953
A703A-4	3/8"	7/16"	100	3.937
A703A-5	3/8"	7/16"	128	5.039
A703A-6	3/8"	7/16"	150	5.906
A703A-8	3/8"	7/16"	200	7.874
A703A-10	3/8"	7/16"	250	9.843
A703A-12	3/8"	7/16"	300	11.811
A703A-15	3/8"	7/16"	375	14.764
<hr/>				
A704A-2.125	1/2"	7/16"	55	2.165
A704A-3	1/2"	7/16"	75	2.953
A704A-4	1/2"	7/16"	100	3.937
A704A-5	1/2"	7/16"	128	5.039
A704A-6	1/2"	7/16"	150	5.906
A704A-8	1/2"	7/16"	200	7.874
A704A-10	1/2"	7/16"	250	9.843
A704A-12	1/2"	7/16"	300	11.811
A704A-15	1/2"	7/16"	375	14.764

Please specify pin type or through hole.

TORX[®] SOCKETS

Sockets Torx[®]



T Type Macho

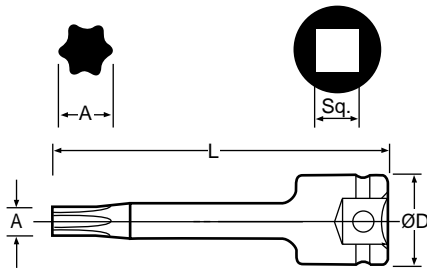

Part No.	Square Drive	Torx Size	A		D		Length	
			mm	mm	in	mm	in	
A325TT	3/8"	25TT	4.4	20	0.787	70	2.756	
A327TT	3/8"	27TT	5.0	20	0.787	70	2.756	
A330TT	3/8"	30TT	5.5	20	0.787	70	2.756	
A340TT	3/8"	40TT	6.6	20	0.787	70	2.756	
A345TT	3/8"	45TT	7.8	20	0.787	70	2.756	
A350TT	3/8"	50TT	8.8	20	0.787	70	2.756	

Part No.	Square Drive	Torx Size	A		D		Length	
			mm	mm	in	mm	in	
A430TT	1/2"	30TT	5.5	25	0.984	100	3.937	
A440TT	1/2"	40TT	6.6	25	0.984	100	3.937	
A445TT	1/2"	45TT	7.8	25	0.984	100	3.937	
A450TT	1/2"	50TT	8.8	25	0.984	100	3.937	
A455TT	1/2"	55TT	11.2	25	0.984	100	3.937	
A460TT	1/2"	60TT	13.2	25	0.984	100	3.937	

E Type Hembra

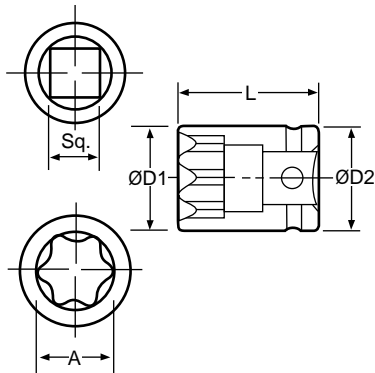

Part No.	Square Drive	Torx Size	A	D1		D2		Length	
				mm	in	mm	in	mm	in
A204TE	1/4"	4TE	3.8	7.5	0.295	13	0.512	25	0.984
A205TE	1/4"	5TE	4.7	8	0.315	13	0.512	25	0.984
A206TE	1/4"	6TE	5.7	9	0.354	13	0.512	25	0.984
A207TE	1/4"	7TE	6.2	7.93	0.312	12.7	0.500	25	0.984
A208TE	1/4"	8TE	7.5	11	0.433	13	0.512	25	0.984
A210TE	1/4"	10TE	9.4	12.7	0.500	12.7	0.500	25	0.984
A212TE	1/4"	12TE	11.1	14.28	0.562	14.28	0.562	25	0.984

Part No.	Square Drive	Torx Size	A	D1		D2		Length	
				mm	in	mm	in	mm	in
A305TE	3/8"	5TE	4.7	10.2	0.402	20	0.787	32	1.260
A306TE	3/8"	6TE	5.7	10.7	0.421	20	0.787	32	1.260
A307TE	3/8"	7TE	6.2	11.2	0.441	20	0.787	32	1.260
A308TE	3/8"	8TE	7.5	11.7	0.461	20	0.787	32	1.260
A310TE	3/8"	10TE	9.4	12.2	0.480	20	0.787	32	1.260
A312TE	3/8"	12TE	11.1	14.2	0.559	20	0.787	32	1.260
A314TE	3/8"	14TE	12.8	17.2	0.677	20	0.787	32	1.260
A316TE	3/8"	16TE	14.7	18.2	0.717	20	0.787	32	1.260

Part No.	Square Drive	Torx Size	A	D1		D2		Length	
				mm	in	mm	in	mm	in
A410TE	1/2"	10TE	9.4	14.2	0.559	25	0.984	40	1.574
A412TE	1/2"	12TE	11.1	15	0.590	25	0.984	40	1.574
A414TE	1/2"	14TE	12.8	18.2	0.716	25	0.984	40	1.574
A416TE	1/2"	16TE	14.7	19.2	0.755	25	0.984	40	1.574
A418TE	1/2"	18TE	16.6	22.2	0.874	25	0.984	40	1.574
A420TE	1/2"	20TE	18.4	24.2	0.952	25	0.984	40	1.574

Extensions and sockets are supplied standard with steel pin and rubber O-Ring. Steel O-Rings are available upon request at no extra charge.

Torx[®] is a registered trademark of the Camcar Division of Textron.

ALLEN SOCKETS

Socket Cabeza Allen

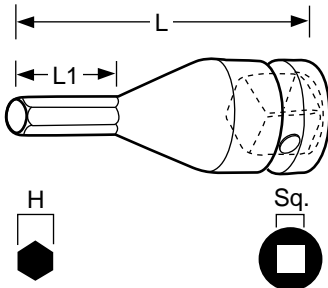

Part No.	Square Drive	Hex	L1		Length	
			mm	in	mm	in
A31/4C	3/8"	1/4"	10	0.394	42	1.654
A35/16C	3/8"	5/16"	10	0.394	42	1.654
A33/8C	3/8"	3/8"	12	0.472	42	1.654
A37/16C	3/8"	7/16"	12	0.472	42	1.654
A31/2C	3/8"	1/2"	12	0.472	42	1.654
A304C	3/8"	4 mm	10	0.394	42	1.654
A305C	3/8"	5 mm	10	0.394	42	1.654
A306C	3/8"	6 mm	10	0.394	42	1.654
A308C	3/8"	8 mm	10	0.394	42	1.654
A310C	3/8"	10 mm	10	0.394	42	1.654
A312C	3/8"	12 mm	10	0.394	42	1.654
A314C	3/8"	14 mm	10	0.394	42	1.654

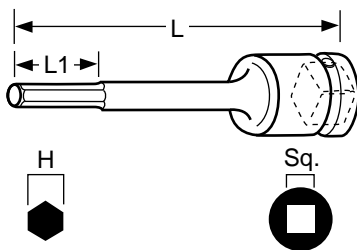

Part No.	Square Drive	Hex	L1		Length	
			mm	in	mm	in
A305C-2.3	3/8"	5 mm	20	0.787	60	2.362
A305C-3.5	3/8"	5 mm	20	0.787	90	3.546
A306C-2.3	3/8"	6 mm	20	0.787	60	2.362
A306C-3.5	3/8"	6 mm	20	0.787	90	3.546
A308C-2.3	3/8"	8 mm	20	0.787	60	2.362
A308C-3.5	3/8"	8 mm	20	0.787	90	3.546
A310C-2.3	3/8"	10 mm	20	0.787	60	2.362
A310C-3.5	3/8"	10 mm	20	0.787	90	3.546

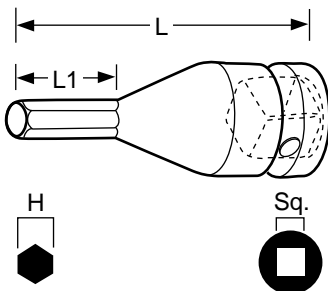

Part No.	Square Drive	Hex	L1		Length	
			mm	in	mm	in
A41/4C	1/2"	1/4"	25	0.984	50	1.969
A45/16C	1/2"	5/16"	25	0.984	50	1.969
A43/8C	1/2"	3/8"	25	0.984	50	1.969
A47/16C	1/2"	7/16"	25	0.984	50	1.969
A41/2C	1/2"	1/2"	25	0.984	50	1.969
A404C	1/2"	4 mm	25	0.984	50	1.969
A405C	1/2"	5 mm	25	0.984	50	1.969
A406C	1/2"	6 mm	25	0.984	50	1.969
A408C	1/2"	8 mm	25	0.984	50	1.969
A410C	1/2"	10 mm	25	0.984	50	1.969
A412C	1/2"	12 mm	25	0.984	50	1.969
A414C	1/2"	14 mm	25	0.984	50	1.969
A417C	1/2"	17 mm	25	0.984	50	1.969

Extensions and sockets are supplied standard with steel pin and rubber O-Ring. Steel O-Rings are available upon request at no extra charge.

For additional Allen Sockets see pg. 46



A I M C O

REFERENCE
MATERIAL

CONVERSION CHART

Tabla de Conversión







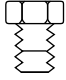

Torque Conversion Factors					Factores de Conversión de Torque					
Units to be Converted		IMPERIAL			METRIC			INTERNATIONAL SYSTEM - S.I.		
		ozf-in	lbf-in	lbf-ft	gf-cm	kgf-cm	Kgf-m	mN-m	cN-m	N.m
1 ozf-in	=	1	0.0625	0.005	72	0.072	0.0007	7.062	0.706	0.007
1 lbf-in	=	16	1	0.083	1152.1	1.152	0.0115	113	11.3	0.113
1 lbf-ft	=	192	12	1	13 826	13.83	0.138	1356	135.6	1.356
1 gf-cm	=	0.014	0.0009	0.00 07	1	0.001	0.000 01	0.098	0.01	0.0001
1 kgf-cm	=	13.89	0.868	0.072	1000	1	0.01	98.07	9.807	0.098
1 kgf-m	=	1389	86.8	7.233	100 000	100	1	9807	980.7	9.807
1 mN-m	=	0.142	0.009	0.0007	10.2	0.01	0.0001	1	0.1	0.001
1 cN-m	=	1.42	0.088	0.007	102	0.102	1.0	10	1.0	0.01
1 N-m	=	141.6	8.851	0.738	10 197	10.20	0.102	1000	100	1

Hex Socket Conversion		Conversion de Sockets Hexagonales		
6 mm = 0.236"	10 mm = 0.394"	14 mm = 0.551"	18 mm = 0.709"	22 mm = 0.866"
7 mm = 0.276"	11 mm = 0.433"	15 mm = 0.591"	19 mm = 0.748"	23 mm = 0.906"
8 mm = 0.315"	12 mm = 0.472"	16 mm = 0.630"	20 mm = 0.787"	24 mm = 0.945"
9 mm = 0.354"	13 mm = 0.512"	17 mm = 0.669"	21 mm = 0.827"	25 mm = 0.984"

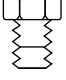
CONVERSION CHART

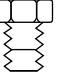
Tabla de Conversión

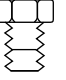
Thread Size to Hex Size

Thread - A/F size				Rosca - Talla A/F			
							
	mm		mm	UNC	Inches	SAE	Inches
M 2	4	M 27	41	1/4	7/16	1/4	7/16
M 2.3	4.5	M 30	46	5/16	1/2	5/16	1/2
M 2.6	5	M 33	50	3/8	9/16	3/8	9/16
M 3	5.5	M 36	55	7/16	11/16	7/16	5/8
M 3.5	6	M 39	60	1/2	3/4	1/2	3/4
M 4	7	M 42	65	9/16	7/8	9/16	7/8
M 5	8	M 45	70	5/8	15/16	5/8	15/16
(M 5-6)	9	M 48	75	3/4	1 1/8	3/4	1 1/16
M 6	10	M 52	80	7/8	1 5/16	7/8	1 1/4
M 7	11	M 56	85	1	1 1/2	1 1/8	1 7/16
M 8	13	M 60	90	1 1/8	1 11/16	1 1/4	1 13/16
(M 8)	14	M 64	95	1 1/4	1 7/8	1 3/8	2
M 10	16	M 68	100	1 3/8	2 1/16	1 1/2	2 3/16
(M 10)	17	M 72	105	1 1/2	2 1/4		
M 12	18	M 76	110	1 3/4	2 5/8		
(M 12)	19	M 80	115	2	3		
M 14	21	M 85	120	2 1/4	3 3/8		
(M 14)	22	M 90	130	2 1/2	3 3/4		
M 16	24	M 95	135				
M 18	27	M 100	145				
M 20	30	M 105	150				
(M 22)	32	M 110	155				
M 22	34	M 115	165				
M 24	36	M 120	170				

Socket Styles

Formas de Encajes

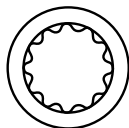

DOUBLE HEX
D (12 PT)
(DH)

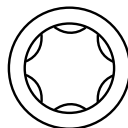

SURFACE DRIVE
(SF)

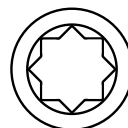

DOUBLE SQUARE
(DSQ)

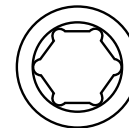

FLANK DRIVE
(FD)

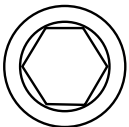

SINGLE HEX
H (6 PT)
(SH)

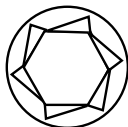

FAST LEAD
(FL)

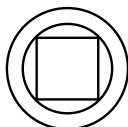

SINGLE SQUARE
(SQ)

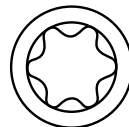

HEX LOBULE
(TORX)

REFERENCE MATERIAL

Material de Referencia

Retaining Pins and Rings

Pasadores y Anillos

Square Drive	Pin		Steel Ring		"O" Ring	
	Part No.	Size ø x L	Part No.	Size øA x øB	Part No.	Size øA x øB
3/8"	S-1	3 x 17 mm	F-1	1 x 18 mm	P-16	2.4 x 15.8 mm
1/2"	S-2	3.5 x 22 mm	F-2	1.2 x 23 mm	P22A	3.5 x 21.7 mm
1/2"	S-3	3.5 x 25 mm	F-3	1.2 x 25 mm	P-25	3.5 x 24.7 mm
5/8"	S-4	4.5 x 31 mm	—	—	P-29	3.5 x 28.7 mm
3/4"	S-5	5 x 34 mm	F-4	1.5 x 34 mm	P-34	3.5 x 33.7 mm
3/4"	S-6	5 x 38 mm	F-5	1/5 x 38 mm	P-38	3.5 x 37.7 mm
3/4"	S-7	5 x 45 mm	—	—	P-45	3.5 x 44.7 mm
1"	S-8	6 x 45 mm	F-6	1.5 x 46 mm	P-45	3.5 x 44.7 mm
1"	S-9	6 x 50 mm	F-7	1.5 x 50 mm	P-50	3.5 x 49.7 mm
1"	S-10	6 x 55 mm	—	—	P-55	5.7 x 54.6 mm
1 1/4"	S-11	6 x 55 mm	—	—	P-55	5.7 x 54.6 mm
1 1/4"	S-12	6 x 63 mm	F-8	2 x 61 mm	P-60	5.7 x 59.6 mm
1 1/2"	S-13	8 x 72 mm	—	—	P-70	5.7 x 69.6 mm
1 1/2"	S-14	8 x 83 mm	F-9	2 x 85 mm	P-80	5.7 x 79.6 mm
1 3/4"	S-15	10 x 106 mm	—	—	P-100	5.7 x 99.6 mm

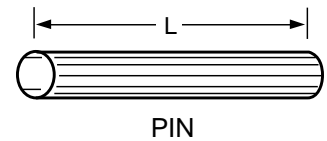
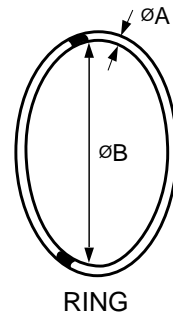

Extensions and sockets are supplied standard with steel pin and rubber O-Ring. Steel O-Rings are available upon request at no extra charge.

Pin assemblies are also available for 3/8" and 1/2" square drive extensions and are sold separately. To order use part number 891-300-1 for 3/8" and 891-304-1 for 1/2". AIMCO will install upon request.

Torx Styles - T & E Type

Estilos Torx - Tipos T & E

E32

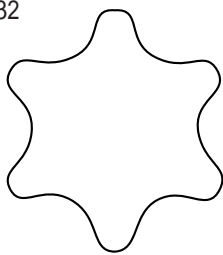

E28

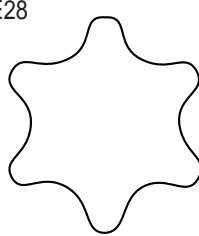

T100
E24

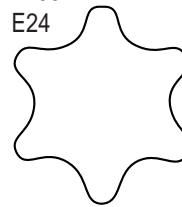

T90

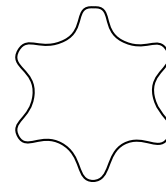

T70
E18

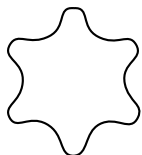

T80
E20

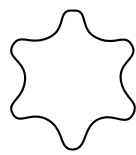

E16

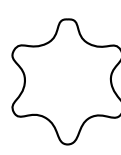

T60
E14



T55
E12



T10
T15



T20
E4



T25
E5



T27
T30
E6



T40
E8



T45



T50
E10



T= Internal and requires a bit-style drive

E= External and requires a socket-style drive

Monitor dokręcania AIMCO



Opis

System ATM

W skład systemu wchodzi:

- **Jednostka bazowa – ATM-1-1**
- **Przewód, przetwornik i zawór nadmiarowy**
- **Oprogramowanie PC i interfejsy do komunikacji**

Zalety systemu

- **Weryfikacja procesu wkręcania**
 - **Sygnalizacja końca procesu**
 - **Sygnalizacja podwójnego impulsu**
 - **Sygnalizacja zatarcia gwintu**
- **Zliczanie cykli**
- **Łatwe programowanie funkcji AutoCal**
- **Dostęp do komunikacji sieciowej**
- **I/O interfejs**
 - **Łatwa integracja z PLC, PC, sygnalizacją świetlną, selektorem nasadek itp.**

Opis możliwości

- **Możliwość odrzucenia ograniczeń nałożonych przez system – wiedząc, że proces dokręcania jest zakończony poprawnie**
- **Możliwość pracy z narzędziami impulsowymi Uryu ULT TM**
- **Sygnalizacja podwójnego uderzenia i przedwczesnego zwolnienia spustu**
- **Auto-Cal – automatyczne generowanie parametrów dla danego procesu wkręcania – proste programowanie**
- **6 wskaźników LED sygnalizujących stan procesu wkręcania OK, NOK, „dokręcanie w toku”**
- **8 możliwych do wyboru programów dla jednego narzędzia**

Opis możliwości

- Zliczanie serii widoczne na wyświetlaczu
- Zliczanie cykli widoczne na wyświetlaczu dla danej serii
- Sygnalizacja dźwiękowa dla cyklu OK. i NOK.
- 5 izolowanych wejść i 8 wyjść dla sterownika PLC
- Parametry widoczne na wyświetlaczu podczas cyklu wkręcania
- Możliwość podłączenia programatora lub klawiatury PC dla ułatwienia obsługi

Opis możliwości

- **Przełącznik elektryczny z kluczem dla trybu programowania i trybu zabezpieczenia dostępu**
- **Możliwość podłączenia interfejsów sieciowych**
- **Pamięć ostatniego cyklu dla zdiagnozowania i usunięcia błędu**
- **Pamięć ostatnich 1000 cykli**
- **Możliwość użycia programatora lub oprogramowania PC**

Skrócona instrukcja obsługi

Aby uruchomić funkcję AutoCal musimy wykonać następujące kroki.

- **Włączyć zasilanie i przekręcić klucz w pozycję PROG**
- **Gdy na wyświetlaczu pojawi się ACAL należy wcisnąć przycisk SET**
- **Należy sprawdzić poprawność podłączeń narzędzia i przetwornika i wcisnąć przycisk SET**
- **Uruchomić narzędzie w docelowym procesie wkręcania aż do wyłączenia się**
- **Zwolnić dźwignię włącznika i przycisnąć SET**
- **Jeśli na wyświetlaczu pojawi się GOOD należy wcisnąć SET jeśli BAD wcisnąć SET i powtórzyć poprzednie kroki**

Skrócona instrukcja obsługi

- **Nacisnąć przycisk MODE dopóki nie pojawi się (X).BAT na wyświetlaczu**
- **Wcisnąć SET aby wyświetlić liczbę cykli w serii**
- **Naciskać UP lub DOWN aby ustawić właściwą wartość**
- **Wcisnąć SET aby zaakceptować nową wartość**
- **Przekręć klucz w pozycje LOCK**

Oprogramowanie PC

- Podgląd bieżących parametrów
- Edycja parametrów
- Ustawianie hasła
- Możliwość ustawienia użytkowników o różnym poziomie dostępu
- Ustawianie daty i czasu
- Menu historii zdarzeń
- Menu rozwiązywania problemów

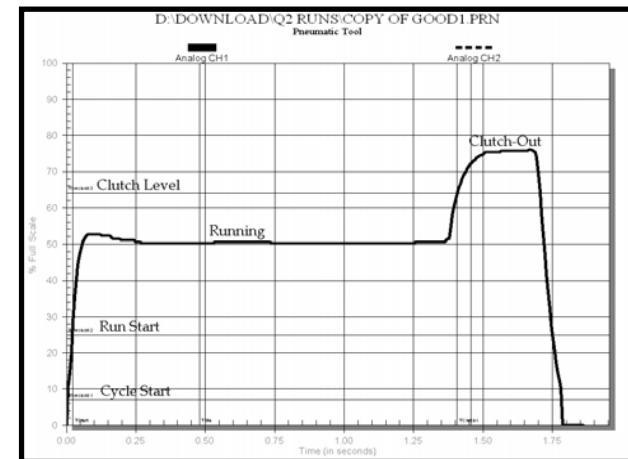
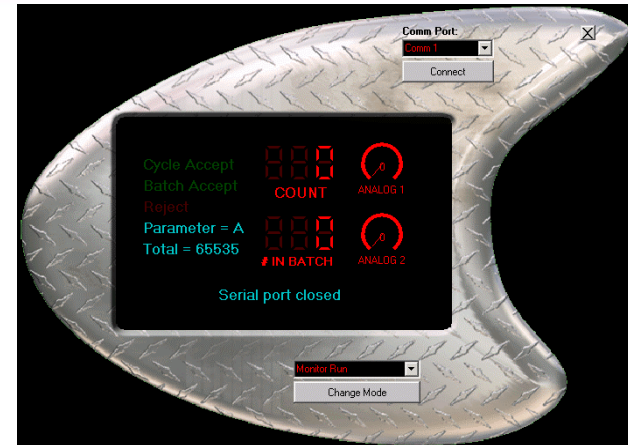

Interfejsy sieciowe



- ▶ **PFCS – Chrysler Interface**
 - ▶ RS232
 - ▶ Ethernet



- ▶ **Coss – GM DeviseNet Interface**



- ▶ **Generic DeviseNet Interface**

Dlaczego AIMCO?

- **Potrzebujesz rejestracji błędów?**
- **Potrzebujesz zliczania ilości cykli?**
- **Potrzebujesz lżejszego, szybszego narzędzia?**



Dlaczego AIMCO?

- AIMCO proponuje wszechstronne rozwiązania służące technice wkręcania
- Narzędzia AIMCO są projektowane z uwzględnieniem światowych trendów w ergonomii
- AIMCO posiada grupę profesjonalnych doradców z wieloletnim doświadczeniem w rozwiązywaniu problemów montażowych
- AIMCO posiada grupę wykwalifikowanego i doświadczonego personelu, szkolącego pracowników serwisowych, aby Państwa narzędzia pozostawały w jak najlepszym stanie.

Podsumowanie



Dystrybutor systemu *AcraDyne* w Polsce:

TECHSYSTEM Bielsko-Biała

tel. 033 816 73 61 fax 033 816 73 62 mobil 602 269 638

info@techsystem.pl

www.techsystem.pl

