

Step 3 – Install and charge battery

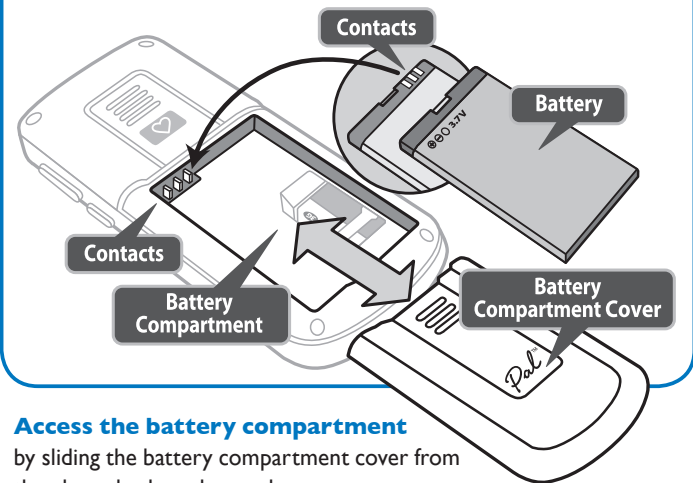

Access the battery compartment

by sliding the battery compartment cover from the phone back as shown above.

Install the battery by ensuring that the contacts on the battery and battery compartment are engaged. Replace the battery compartment cover as shown above. Make sure that it snaps securely into place.

Start the battery charging process by inserting the “plug-tip” of the AC Power cord into the charging port (11) of the phone. Plug the AC Power Adapter into a 110V electrical outlet. Charging time is approximately 2-3 hours.

The battery indication on the phone LCD will begin to “blink.” If the phone is powered off, the LCD will display “charging.”

When charging is complete the battery indicator will stop “blinking.”

Step 4 – Make/Receive Calls

Press the Dial Key to dial or connect a call.

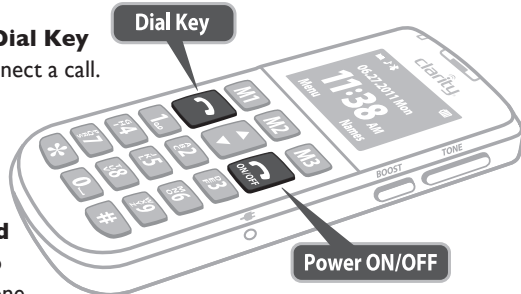

Press/Hold Power Key to turn **ON** phone.

Press/Hold the Power Key again to turn **OFF** the phone.

Make a call

Three methods for making a call.

- 1) Phonebook** – Find the number you want to dial, and press **Dial Key**.
- 2) Call Register** – Enter the list of missed calls, received calls or dialed calls, and then choose the number, and press Dial Key.
- 3) Manual** – In idle mode, input the number by pressing the numeric keys, then press the Dial Key.

Receive a call

On incoming calls, the ring will be a sound, or the phone will vibrate.

Press **Dial Key** to answer, or press **Reject** (M3 key) to refuse call.

You can also receive the call by selecting “**Option**” (M1 key), or by pressing the “**Dial**” key.

Note: To use Boost Button, Press/Hold for (1) one second.

Menu Navigation

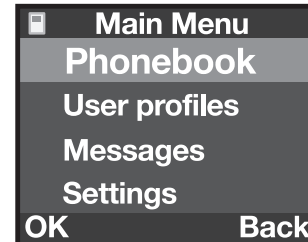

Select menu options (OK, Back, etc.) by pressing the **M1** or **M3** **Memory Keys**.



Scroll through the menu listings by pressing the **UP/DOWN Arrow Key**.



Clarity, a Division of Plantronics, Inc.
6131 Preservation Drive, Chattanooga, TN 37416

CONTACT Tel: 800-426-3738 Fax: 800-325-8871
E-mail: claritycs@plantronics.com
Website: ClarityProducts.com

©2012 Clarity, a Division of Plantronics, Inc. All Rights Reserved.
Clarity, Clarity Pal, and Smart for Seniors are trademarks or registered trademarks of Plantronics, Inc.
Printed in China

Quick Setup Guide

SMART FOR SENIORS™

Clarity Pal[®] Amplified Mobile Phone



clarity® ClarityProducts.com

Thanks for choosing the Clarity Pal™ mobile phone

*More than just a mobile phone, this is mobile peace of mind. The Clarity Pal™ mobile phone gives you the freedom to stay connected with the ones you love, and know that help is available wherever you go.**

- Designed especially for seniors on-the-go. Only 5 inches in length and one-half inch in thickness. Easily fits in your pocket or purse.
- Clarity Power™ technology amplifies incoming sound and is Hearing Aid compatible.
- Full-keypad features large buttons for viewing and easy dialing.
- Prominently located Emergency Button for quick access.
- See User's Manual at ClarityProducts.com/Pal for more features.

*Requires cell phone service.

Contents

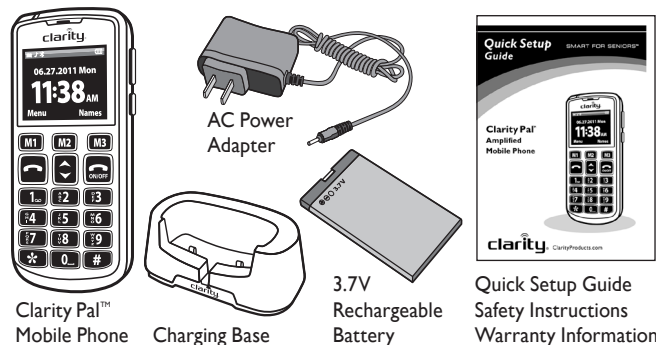

Step 1 – Review Basic Phone Features

- 1 Volume Adjust Button
- 2 Headset Port
- 3 **M1*** Memory Key – Long-press/Memory (Short-press key to access and select menu options.)
- 4 **M2** Memory Key
- 5 **M3*** Memory Key – Long-press/Memory (Short-press key to access and select menu options.)
- 6 Dial Key (Press to connect call)
- 7 ON/OFF Key (Long-press to Power ON/OFF)
- 8 Arrow Key (Menu Scroll)
- 9 TONE Button
- 10 BOOST Button (Amplify)
- 11 AC Power (Charging Port)
- 12 Emergency Button (Located on back of phone)
- 13 Phone Status Icons
- 14 AC Power Adapter

Important: Before using phone, please read Safety Instructions.

Additional information is available online at: ClarityProducts.com/Pal

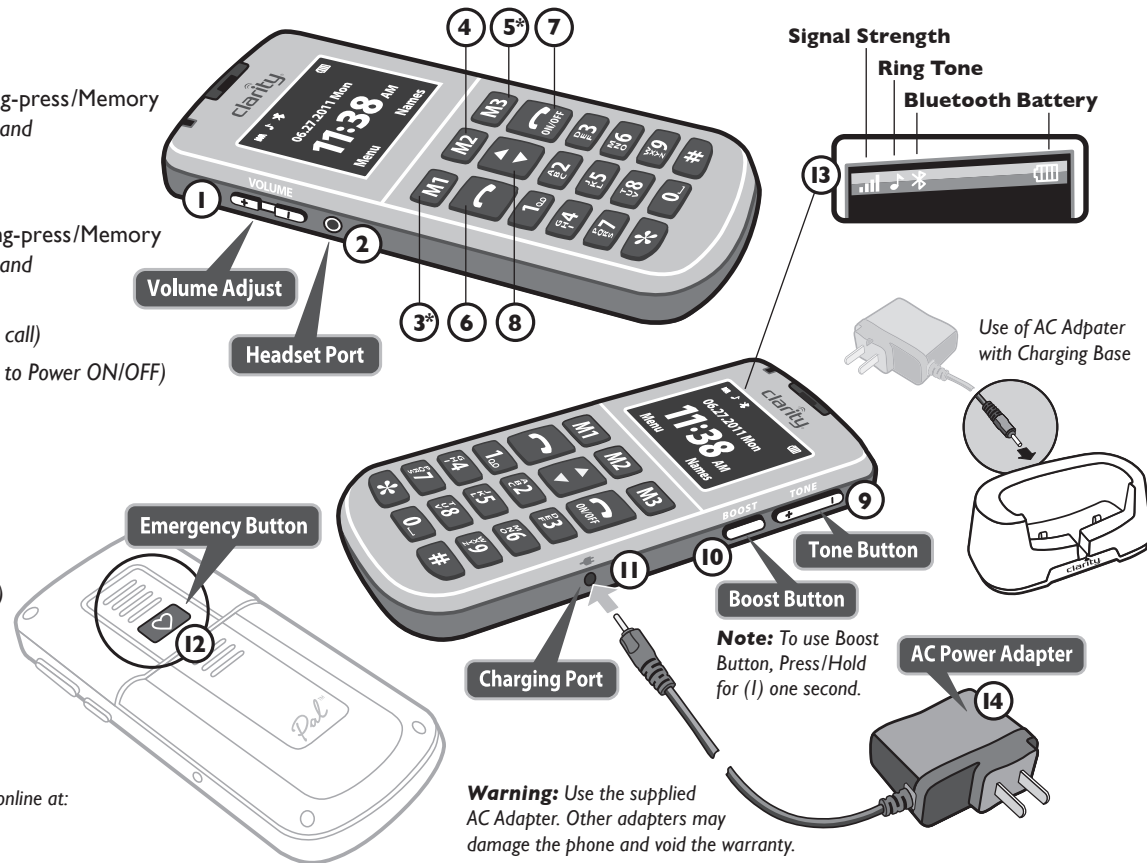

Step 2 – Install SIM card

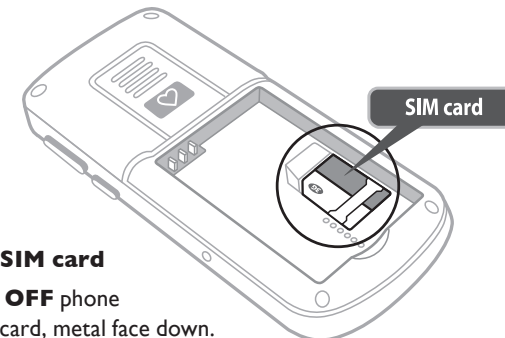

Install SIM card

- Power **OFF** phone
- Insert card, metal face down.

Warning: Do not remove SIM card while phone is charging, or connected to AC power.

Install SIM card and connect to a network

A network provider (of your choice) will provide you with a SIM card that is key for entering the GSM network and their particular network.

First install the SIM card, then battery. (See STEP 3 for battery installation instructions.) Once SIM card and battery are installed, power-on the phone. The phone will begin searching for a registered network, or other available networks. Once connected, the name of network supplier will show on the LCD.

If the LCD prompts **“Emergency Call Only”**, it means you are out of the network service area. However, you may still make emergency calls according to signal strength.