

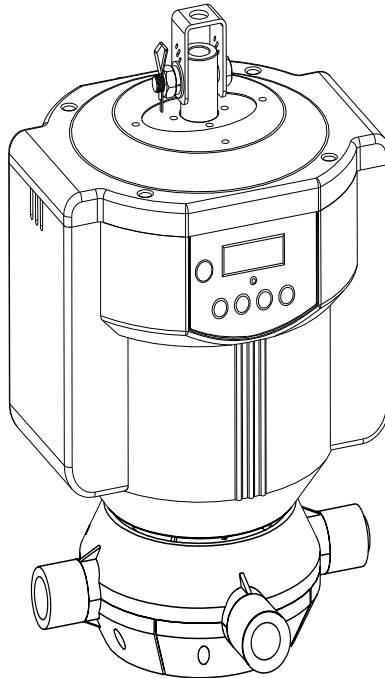

# STREAMER



## Users Instructions

Elation Professional®  
4295 Charter Street  
Los Angeles CA. 90058  
[www.elationlighting.com](http://www.elationlighting.com)

## **Features**

We would first like to congratulate you on the purchase of this magic fibre lighting-**STREAMER!**

### **Its main features include:**

- USITT DMX512(1990) multiplexed digital control, via 3 pin XLR connector.
- Light plastic material case(IP:V0).
- Slave, Auto and Audio function modes available.
- 9 built-in chasing patterns plus a sequence of 9 patterns(AUTO).
- 0~100(/0.1s) DMX fade time setup.
- Stand by function allows you to kill overall output instantly.
- Individual fibre lighting color adjustment and rotatable.
- 4-digit Segment Display shows current activities or your desired levels.
- At your most convenience, this unit can be entirely controlled except DMX address setting by its Remote Control(Included).
- EEPROM for at least 10 years.

Every effort has been made to design dependable and reliable products. New products are constantly being designed to meet the needs of the entertainment lighting industry. Your comments regarding our products and services are welcome. Please send us an e-mail to [info@elationlighting.com](mailto:info@elationlighting.com) and let us know how we can improve to better serve you.

It is both a privilege and a pleasure serving you.

## **General Information**

Every **STREAMER** has been thoroughly tested and has been shipped in perfect operating condition. Carefully check the shipping carton for damage that may have occurred during shipping. If the carton appears to be damaged, carefully inspect your controller for any damage and be sure all equipment necessary to operate the unit has arrived intact. In case damage has been found or parts are missing, please contact us or your nearest dealer/distributor for further instructions.

To make the most of it's possibilities and for a correct functioning of this unit in years to come, we suggest all users to read carefully this manual before connecting or putting the spot in use. By doing so, you will gain experience with its commands and connections and you will be able to use it easily. Once manual has been thoroughly read, we recommend you should file it for future reference.

**Caution!** There are no user serviceable parts inside this unit. Do not attempt any repairs yourself, doing so will void your manufactures warranty.

**Hint!** When unpacking and installation, make sure that your unit has been taken out from the cylinder gently and placed properly by the correct directly.

In the unlikely event your unit may require service, please contact **NCW** customer support.

**Do not discard the packing carton in the trash. Please recycle when ever possible.**

**NOTE:**

Specifications and improvements in the design of this product and this manual are subject to change without prior notice.

# Controls & Functions

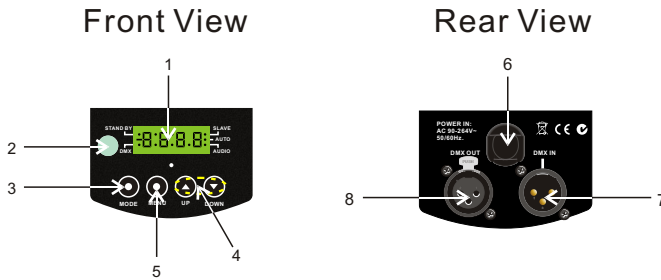

## 1. Digit Segment Display

The 4-digit LED display shows the menu and operating functions which users can choose from. It also shows user desired levels including DMX address, pattern numbers and fade time.

Segment Display	Related Info.
R: XXX	DMX Address(001-512)
P: XX	Chasing patterns(1-9& Auto)
F: XXX	DMX Fade time(0-100)

## 2. Infrared Sensor

To receive infrared remote signals.

## 3. Mode Button

Tap this button to select different function modes according to users requirement including Slave, Auto and Audio modes.

## 4. Up/Down Button

Tap UP/DOWN button to select your desired DMX address, DMX fade time or chasing patterns during operation.

## 5. Menu Button

Tap this button to enter the sub-menu in the Slave mode for user operation.

## 6. Power In

The line cord supplies power to the device. Plug into a AC90~264V-50/60Hz outlet.

## 7. 3-pin XLR DMX Input Jack

This input receives DMX signal from a DMX controller or previous device.

## 8. 3-pin XLR DMX Output Jack

This output feeds DMX signal through to the next DMX device in line.

# Unpacking Notice

Unpack:  
Remove the base cover and take out the fiber tube from paper cylinder.

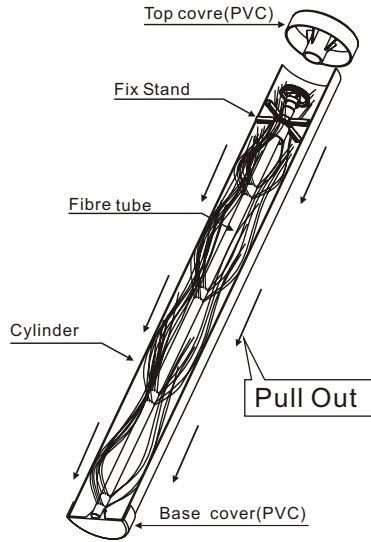

## Installation Procedures

Before installation, please make sure that KIT ASM-A has been hanged fully and safely.

1. The first Fibre Tube(A1) Installation(See figure-2)

Step1

Firstly assemble A2(Plastic cover)and E(Aluminum sheet) together with one screw by the screwdriver.

Step2

Select any of these 4 Fibre tubes(A1) and place it on KIT ASM-A properly, and install A2(Plastic cover) ,then screw them with two screws by the screwdriver, at last fasten them with C(Plastic tube).

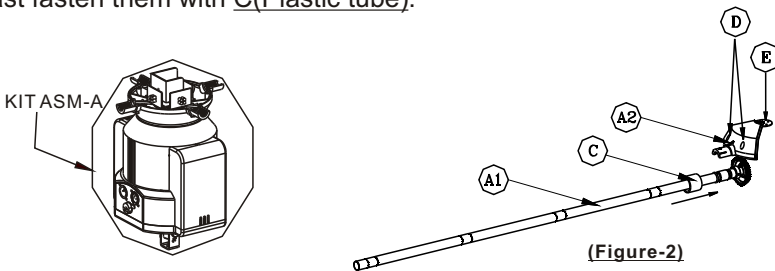

(Figure-2)

# Installation Procedures

2. The second Fibre Tube(A1) Installation(See figure-3)

Step3

And repeat Step2 to install the second A1(Fibre tube) and fix them well.

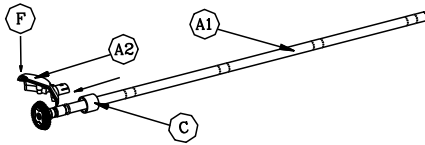

(Figure-3)

3. The third Fibre Tube(A1) Installation(See figure-4)

Step4

In like matter, select any of the rest two Fibre Tube(A1) and place it on KIT ASM-A well, assemble Plastic cover(B2) and screw with two screws by the screwdriver, then fix them with C(Plastic tube).

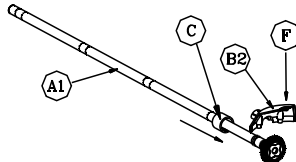

(Figure-4)

4. The last Fibre Tube(A1) Installation(See figure-5)

Step5

And repeat Step4 to install the last fibre tube. And please check and ensure all screws have been secured tightly.

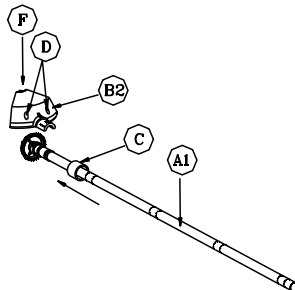

(Figure-5)

Step6

Push a STICKER with "ELATION" printing into the top and rotate it clockwise or anti-clockwise.



(Figure-6)

# Operation Guide

## **Slave Mode**

In this mode, users can have DMX address setting and DMX fade time , and daisy chain up to some units together to get a sync lighting show.

### DMX Control

Channel 1 is the rotary speed for motor, channel 2 is the rotary direction for motor (0~127 is to rotate clockwise and 128-255 is anticlockwise movement), and Channel 3-6 is the color for the fibre lighting tube.

*Please follow the set-up specifications( RGB color and DMX value Table ) that come with your DMX controller.*

### **DMX Signal Indicator**

When STREAMERs are receiving DMX signal for Master-Slave operation, its DMX indicator on the screen will blink constantly.

1. Press the Mode button to access the Slave Mode, the readout of an "A" followed by three numbers will be indicated and the Slave indicator will be lit on the LED-display.



2. And use Up/Down button to select your desired DMX address within the range of 1-512.

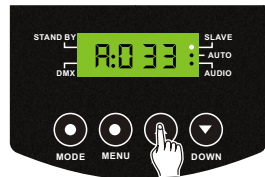

3. Press the Menu button to change between DMX address and DMX fade time setting.

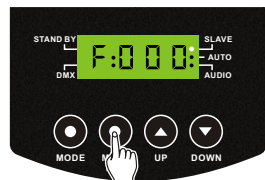

4. And use Up/Down button to select your desired DMX fade time within the range of 0-100(0.1s).

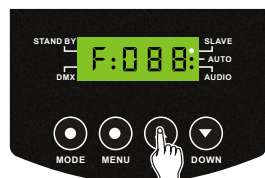

# Operation Guide

## **AUTO** Mode

1. Press the Mode button to access the AUTO mode, the AUTO indicator will be lit on the LED-display. And your unit patterns will run automatically.

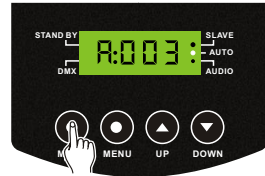

2. And use Up/Down button to select your desired chasing patterns within the range of 1-9 & AUTO.

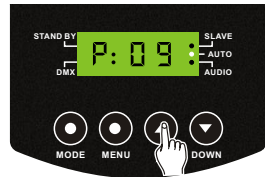

## **AUDIO** Mode

1. Press the Mode button to access the AUDIO mode indicator will be lit on the LED-display. And your unit will run with the music beat.



2. And use Up/Down button to select your desired chasing patterns within the range of 1-9 & AUTO.

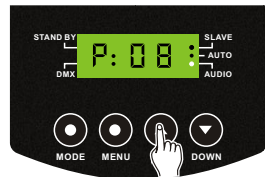

## **Master-Slave Operation**

This function will allow you to link up to some units together to run in a Slave Mode. In Master Slave operation, one unit will serve as the Master and the others will serve as the Slave. However, the only one unit can run in AUTO or AUDIO mode and others run in Slave mode.

And only some STREAMERS with the same DMX signals can be connected together for Master-Slave operation successfully. Or else, it can result out of control.



# Operation Guide

## RGB color and DMX value Table

DMX (N) (Decimal)	Red (%)	Green (%)	Blue (%)	Color
0	0	0	0	Black
1-2	100	0	0	Red
3-33	100	(N-2)x3	0	***
34	100	100	0	Yellow
35-65	100-(N-34)x3	100	0	***
66-69	0	100	0	Green
70-100	0	100	(N-69)x3	***
101	0	100	100	Cyan
102-132	0	100-(N-101)x3	100	***
133-136	0	0	100	Blue
137-167	(N-136)x3	0	100	***
168	100	0	100	Purple
169-199	100	0	100-(N-168)x3	***
200-206	100	(N-199)x6	(N-199)x12	***
207	100	50	100	***
208-210	100-(N-207)x12	50+(N-207)x12	100	***
211	50	100	100	***
212-215	50-(N-211)x6	100	100-(N-211)x12	***
216-218	50-(N-215)x6	100	50-(N-215)x6	***
219-222	(N-217)x6	100	25-(N-219)x6	***
223-225	38+(N-223)x6	100	(N-219)x6	***
226-228	50+(N-225)x12	100	25+(N-225)x6	***
229	100	100	50	***
230-232	100	100-(N-229)x12	50+(N-229)x12	***
233	100	50	100	***
234-236	100-(N-233)x12	50-(N-233)x6	100	***
237	50	25	100	***
238-240	50-(N-237)x6	25-(N-237)x6	100	***
241-244	25-(N-241)x6	(N-239)x6	100	***
245-247	(N-243)x6	(N-239)x6	100	***
248-251	25+(N-247)x6	50+(N-247)x12	100	***
252-254	50+(N-251)x12	100	100	***
255	100	100	100	White

### **NOTE:**

1. " N " denotes DMX value(0-255).

For example:

If DMX value is 239, blue intensity will be  $50-(239-237) \times 6 = 38\%$ ,  
red intensity will be  $25-(239-237) \times 6 = 13\%$ ,  
green intensity be 100%.

2. " \* " denotes unnameable color.

# Operation Guide

## Using the Remote Control Properly

When using your Remote Control(included), please ensure to operate it within the effective range of the infrared sensor, so that you may operate your STREAMER at any safe place.

### Overview

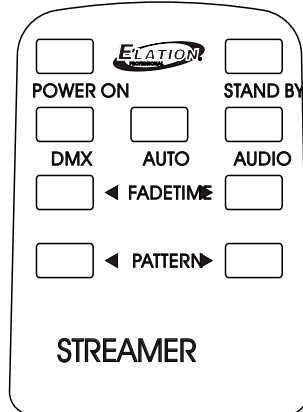

### Remote Control

- |                        |  |
|------------------------|--|
| <b>POWER ON</b> key:   | To turn the power on.  |
| <b>STAND BY</b> key:   | To allow you to kill overall output instantly.   |
| <b>DMX</b> key:        | To access Slave Mode.  |
| <b>AUTO</b> key:       | To access AUTO Mode.   |
| <b>AUDIO</b> key:      | To access AUDIO Mode.  |
| <b>◀FADETIME▶</b> key: | To set up DMX fade time within the range of 0~100(/0.1s), only in Slave Mode .                     |
| <b>◀PATTERN▶</b> key:  | To select built-in chasing patterns within the range of 1~9 plus AUTO, only in AUTO or AUDIO Mode. |

### \*Notes concerning use:

Periodically clean the Infrared receive sensor with a soft cloth. Do not expose this unit to strong light, it may interfere with operation.

## Technical Specifications

Power Requirement.....	AC90~264V-50/60Hz
LED-display Screen.....	4-digit segment display
DMX In.....	3-pin XLR male socket
DMX Out.....	3-pin XLR female socket
Accessory.....	Remote Control(Included)
Weight.....	Appro.4.5Kg

Elation Professional®  
A Division of the American DJ Group of Companies  
4295 Charter Street Los Angeles, CA 90058 USA  
Tel: 323-582-3322 Fax: 323-582-3311  
Web: [www.elationlighting.com](http://www.elationlighting.com)  
E-mail: [info@elationlighting.com](mailto:info@elationlighting.com)

24-004-1843  
Rev1.1



