

# Cuisinart®

## INSTRUCTION BOOKLET



**Grind & Brew™ Thermal 10-Cup Automatic Coffeemaker**

**DGB-650C Series**

For your safety and continued enjoyment of this product, always read the instruction book carefully before using.

---

# IMPORTANT SAFEGUARDS

When using electrical appliances, basic safety precautions should always be followed to reduce the risk of fire, electric shock and/or injury to persons, including the following:

- 1. READ ALL INSTRUCTIONS.**
- Do not touch hot surfaces. Use handles and knobs.
- To protect against electric shock, do not place cord, plug, or base unit in water or other liquids.
- This appliance should not be used by or near children or individuals with certain disabilities.
- Always unplug from outlet when not in use and before cleaning. Allow to cool before putting on or taking off parts and before cleaning the appliance.
- Do not operate any appliance with a damaged cord or plug or after the appliance malfunctions or has been dropped or damaged in any manner.
- The use of accessory attachments not recommended by Cuisinart may cause injuries.
- Do not use outdoors.
- Do not let cord hang over edge of table or counter, or touch hot surface.
- Do not place on or near a hot gas or electric burner, or in a heated oven.
- Always fill water reservoir first, then plug cord into the wall outlet. To disconnect, push the Off button, then remove plug from wall outlet.
- Do not use appliance for other than intended use.
- Snap lid securely onto carafe before serving any beverages.
- Scalding may occur if the lid is removed during the brewing cycle.
- The thermal carafe is designed for use with this appliance only. It must never be used on the range top.
- Do not set a hot carafe on a wet or cold surface.
- Do not use a damaged carafe or a carafe having a loose or weakened handle.
- Do not clean carafe or resting plate with cleansers, steel wool pads, or other abrasive materials.
- 19. WARNING: TO REDUCE THE RISK OF FIRE OR ELECTRIC SHOCK, DO NOT REMOVE THE BASE PANEL. NO USER SERVICEABLE PARTS ARE INSIDE. REPAIR SHOULD BE DONE ONLY BY AUTHORIZED PERSONNEL.**
- Avoid contact with moving parts.
- Check grinder basket for presence of foreign objects before using.
- Use the coffee grinder to grind roasted coffee beans only. Grinding other substances, such as nuts, spices or unroasted beans, may dull the blade and cause poor grinding or injury.
- Do not place cloth or otherwise restrict airflow beneath coffeemaker.
- Use only the Cuisinart® Gold Tone Commercial Style Filter or standard #4 basket paper filter with this unit. OTHER GOLD TONE PERMANENT FILTERS MAY CAUSE THE COFFEEMAKER TO OVERFLOW.

## SAVE THESE INSTRUCTIONS FOR HOUSEHOLD USE ONLY

## WARNING: RISK OF FIRE OR ELECTRIC SHOCK

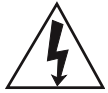

The lightning flash with arrowhead symbol within an equilateral triangle is intended to alert the user to the presence of uninsulated dangerous voltage within the product's enclosure that may be of sufficient magnitude to constitute a risk of fire or electric shock to persons.



The exclamation point within an equilateral triangle is intended to alert the user to the presence of important operating and maintenance (servicing) instructions in the literature accompanying the appliance.

## SPECIAL CORD SET INSTRUCTIONS

A short power-supply cord is provided to reduce the risks resulting from becoming entangled in or tripping over a longer cord. Longer extension cords are available and may be used if care is exercised in their use.

If a long extension cord is used, the marked electrical rating of the extension cord must be at least as great as the electrical rating of the appliance, and the longer cord should be arranged so that it will not drape over the countertop or tabletop where it can be pulled on by children or tripped over.

## NOTICE

This appliance has a polarized plug (one blade is wider than the other). To reduce the risk of electric shock, this plug will fit into a polarized outlet only one way. If the plug does not fit fully into the outlet, reverse the plug. If it still does not fit, contact a qualified electrician. Do not modify the plug in any way.

## OPERATING NOTICE

Clogging and backing up of water and/or coffee in the filter basket can occur under any or a combination of any of the following conditions: The use of too finely ground coffee, using two or more paper filters, using the gold tone filter in conjunction with a paper filter or not properly cleaning coffee grounds from the gold tone filter, or allowing coffee grounds to spill over the filter.

**Caution:** Never open the filter basket during the brewing cycle, even if no water is draining from the filter basket, since extremely hot water/coffee can spill out from the filter basket and cause injury. If water/coffee is not draining from the filter basket during the brewing cycle, unplug the unit and wait 10 minutes before opening and checking the filter basket.



# CONTENTS

Important Safeguards . . . . .	2-3
Important Unpacking Instructions . . . . .	4
The Quest for the Perfect Cup of Coffee. . . . .	4
Features and Benefits . . . . .	5
Control Panel . . . . .	6
Programming Your Coffeemaker . . . . .	7
Setting the Program Time . . . . .	7
Before Brewing your First Pot . . . . .	8
Making Coffee with Whole Beans . . . . .	8
Making Coffee with Pre-Ground Beans . . . . .	9
Charcoal Water Filter . . . . .	9
Brew Pause™ Feature. . . . .	10
Cleaning and Maintenance . . . . .	10
Warranty . . . . .	11

## IMPORTANT UNPACKING INSTRUCTIONS

1. Place the box on a large, sturdy, flat surface.
2. Remove the instruction book and any other literature.
3. Turn the box so that the backside of the coffeemaker is down and slide the coffeemaker from the box.
4. After the coffeemaker has been removed, place the box out of the way and lift off the packaging material.
5. Grasp the carafe by its handle, remove it from the resting plate and remove the polybag.
6. Remove the polybag covering the coffeemaker.

Save all packing materials in case you have to ship the machine in the future. **KEEP ALL PLASTIC BAGS AWAY FROM CHILDREN.**

## THE QUEST FOR THE PERFECT CUP OF COFFEE

### Element 1: Water

Coffee is 98% water. The quality of that water is as important as the quality of your coffee. If water doesn't taste good from the tap, it won't taste good in your coffee. Cuisinart includes a charcoal water filter to remove chlorine, bad tastes and odours, for the purest coffee flavor, every time you brew.

### Element 2: Coffee

While coffee is 98% water, all of the flavour comes from the beans. To achieve the same great taste you enjoy at a coffee bar, buy only a two-week supply of fresh coffee beans at a time. Once the bean is broken, its flavour degrades quickly. That's why Cuisinart grinds your beans just prior to brewing.

### Element 3: Grind

The grind is critical for proper flavour extraction. If the grind is too fine, over extraction and bitterness will result. Too fine a grind may also clog the filter. If grind is too coarse, the water will pass through too quickly and the maximum flavour will not be extracted. Your coffeemaker is preset for medium, the optimal grind for this type of brewing process.

### Element 4: Proportion

Coffee that is too strong or too weak is always a disappointment. Follow the recommended portions of whole beans or ground coffee in the instructions under MAKING COFFEE, and later adjust the amount to your taste.

**DO NOT OVERFILL OR THE GRINDER COULD MALFUNCTION AND/OR THE COFFEEMAKER COULD OVERFLOW.**

# FEATURES AND BENEFITS

## 12. Water Reservoir with Water Level Indicator

- 1. Reservoir Cover with Release Button**  
Flips back for easy filling. Removable for easy cleaning. A safety interlock system prevents operation of the unit if the reservoir cover is open.
- 2. Shower head (not shown)**  
Distributes water evenly over coffee, reducing temperature loss as water passes through grounds.
- 3. Control Panel**  
See detailed drawing, page 6.
- 4. Filter Basket Compartment**  
See detailed drawing, page 6. Contains: Filter Basket, Filter Basket Cover, Cuisinart Gold Tone Commercial Style Filter
- 5. Filter Basket Door**
- 6. Filter Basket Door Release Button (not shown)**
- 7. Brew Pause™**  
Stops flow of coffee from basket when carafe is removed from resting plate so a cup can be poured in mid-brew, if desired.
- 8. Resting Plate**  
Scratch-resistant with nonstick coating.
- 9. Thermal Carafe with Hands-Free Lid**  
An easy-pour, dripless double-wall insulated 10-cup thermal carafe with ergonomic handle.  
  
Coffee brews through and pours through a unique lid that seals out air to preserve fresh-brewed flavor. No need to turn or adjust lid.
- 10. Cord Storage (not shown)**
- 11. Measuring Scoop and Brush (not shown)**

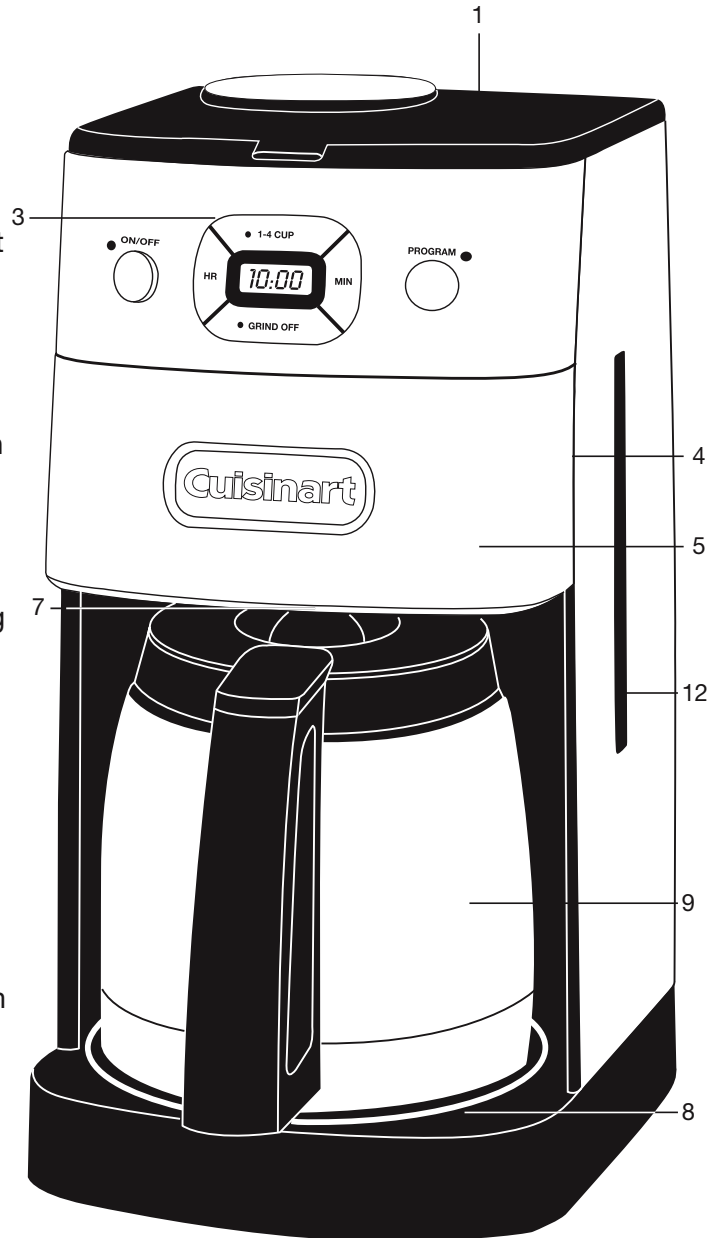

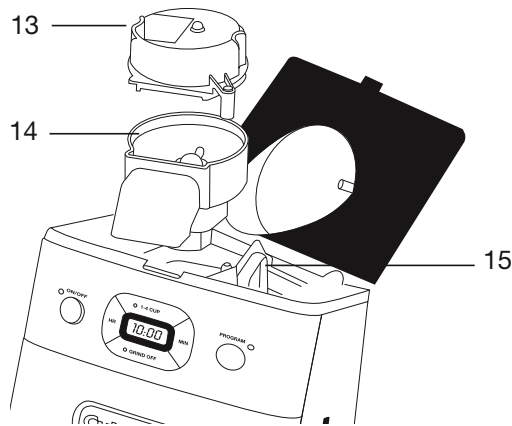

### 13. Grinder Basket Lid

Use the recess on each side of the lid to remove lid for easy addition of beans.

### 14. Grinder Basket

### 15. Charcoal Water Filter

Charcoal water filter eliminates chlorine, bad tastes and odours from tap water.

**NOTE:** Follow directions for preparing and inserting filter on page 9.

### 16. Filter Basket Cover

To put on or remove, grasp cover in area indicated by arrows. Cover becomes hot after coffee is brewed. Use caution when removing cover.

### 17. Gold Tone Commercial Style Filter

**A note about filters:** When using our permanent filter, position handle toward front of the unit so it does not interfere with the flow of coffee into the filter basket. Also note: using our permanent filter may allow some fine coffee grounds to fall into, and appear as sediment in the carafe.

### 18. Filter Basket

Holds our commercial style permanent filter or paper filter. **NOTE: FILTER BASKET MUST BE IN PLACE FOR UNIT TO OPERATE CORRECTLY.** Removable for easy cleaning.

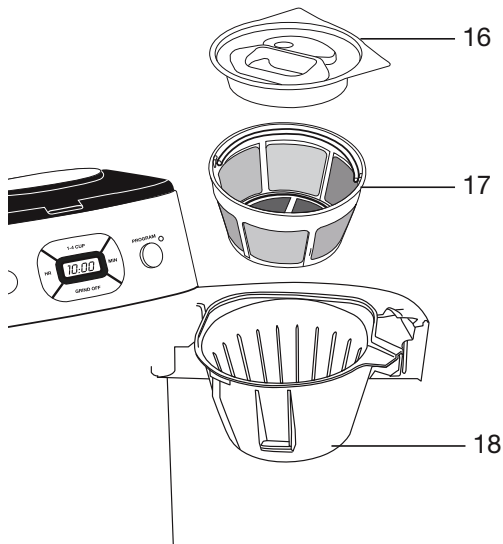

## GETTING TO KNOW YOUR CONTROL PANEL

(Detailed programming instructions on page 7.)

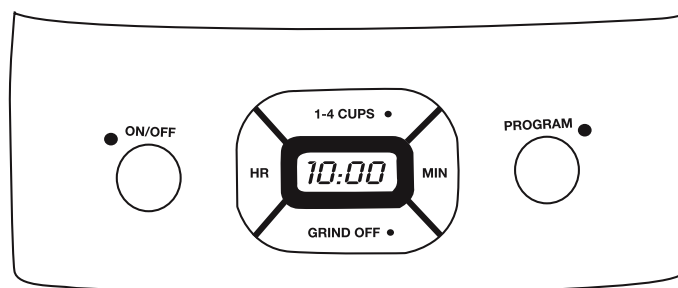

### Clock/LCD Display

Displays time of day and Auto On times.

### On/Off button with LED Indicator

Manually turns coffeemaker on or off.

### Audible Tone (not shown)

An audible tone sounds 5 times when brew cycle is complete.

### 1-4 Cup Setting

Improves extraction, flavour and temperature when brewing fewer than 5 cups.

### Hour and Minute Buttons

Use to program clock and Auto On function.

### Grind Off Button with LED Indicator

Turns off the grinder when using pre-ground coffee.

### Program Button with LED Indicator

Sets and/or displays programmed Auto On time.

---

# PROGRAMMING YOUR COFFEEMAKER

## SETTING THE CLOCK

When the coffeemaker is plugged in, 12:00 will appear until you set the time.

### Entering Time Set Mode

Hold down the Hour or Minute button until the clock begins flashing. Press either button to select the desired time. Hold buttons down to scroll through the digits, or press and release to advance one digit at a time. When scrolling, the numbers will advance slowly and then speed up.

When the number displayed approaches the desired time, press and release to advance one digit at a time. Be sure the PM indicator is on if a PM time is desired.

### Exiting Set Time Mode

- a. Press any function button besides Hour or Minute to exit mode.
- b. If you do nothing for a period of five seconds the mode will be exited.

## SETTING THE PROGRAM TIME

When you press the Program Set button, it displays a previously selected auto-on time, or the default time (12:00pm).

### Entering Set Program Time Mode

Press and hold the Program set button until the green light and LCD display begin to flash. You are now in Set Program Time mode. Set the time you want coffee to begin brewing by following the instructions in "Entering Time Set Mode."

The coffeemaker will start to brew at the programmed time. The Program mode cannot be entered if the coffeemaker is in its brew cycle.

### Exiting Set Program Time Mode

- a. Press and release Program button.
- b. Press any function button besides Hour or Minute to exit mode and activate the selected function.
- c. If you do nothing for a period of five seconds the mode will be exited.

## **BEFORE BREWING YOUR FIRST POT OF COFFEE**

During the manufacturing process, dust can get trapped in your coffeemaker. We recommend flushing out the system before brewing your first pot of coffee. Simply follow “Making Coffee with Pre-Ground Beans,” page 9. Skip step #1 and be sure to use only water and a paper filter...no coffee!

Once you’ve done that, brew a pot of real coffee and get ready to enjoy Cuisinart at its best!

## **MAKING COFFEE WITH WHOLE BEANS**

Follow instructions in “Before Brewing Your First Pot of Coffee” above.

### **1. Insert Charcoal Water Filter**

Follow directions for the preparation and insertion of the charcoal water filter on page 9.

### **2. Fill the Water Reservoir**

Open the reservoir cover and pour in water, using the water level window indicator to measure the number of cups desired. **NOTE:** Do not exceed the 10-cup line. Doing so could cause carafe to overflow.

### **3. Add Beans**

Lift the grinder basket lid, using the recess on either side. Fill the basket with the desired quantity of beans. **NOTE:** Use 1 level scoop of whole beans per cup. For 1 to 4 cups, use 1½ level scoops per cup. Do not add over 14 scoops. This could cause the grinder to malfunction and/or the coffeemaker to overflow.

### **4. Insert Coffee Filter**

Press the filter basket door release Button to open door.

- Paper Filter – place a #4 basket paper filter in the basket, making sure the filter is completely open and touching the side walls and bottom of basket.
- Cuisinart’s® Commercial Style Permanent Filter – Be sure the

filter handle is facing away from the grinder basket, so it does not interfere with the flow of ground coffee into the filter basket. **NOTE:** Some ground coffee may flow into the carafe.

### **5. Put Filter Basket Lid in Place and Close Filter Door**

### **6. Close Reservoir Lid**

Press down to lock. This coffeemaker is equipped with a safety interlock system, which prevents the unit from operating if the cover is open or the grinder cover is left out. If you try to turn the unit on with the cover open, the unit will beep continuously until the missing parts are installed and you close the lid. If you open the cover during the grinding process, it will beep, the grinder will stop grinding and, if brewing, the brewing will stop. Once the missing parts are in place and the cover is closed, the beeping stops. The brewing process can be restarted by pressing the On button. Restarting the process will not affect coffee results. If you do not want the grinder to come on again, press the Grind Off button before pressing the On button.

### **7. Prepare the Carafe**

Remove thermal carafe lid by turning in the direction of the “unlock” arrow. **PREWARM CARAFE BY RINSING IT OUT WITH HOT WATER.**

**PREWARMING THE CARAFE WILL HELP KEEP THE COFFEE HOTTER.**

Return the carafe lid to the carafe and lock by turning it in the direction of the “lock” arrow until it fits tightly on carafe and arrow lines up in the center of the pour spout. This ensures cover is closed and in the proper position for brewing and pouring. Make sure you have replaced the thermal carafe in its position on the resting plate.

### **8. Brewing To Brew Right Away**

- a. Push the 1-4 cup button if you are brewing fewer than 5 cups.

**NOTE:** Coffeemakers traditionally



produce cooler coffee when brewing small pots because the heater doesn't have time to warm up. This setting double heats water for piping hot coffee.

- b. Press On/Off button. Red LED will light up and brewing will begin.

#### To Program Brew Time

- a. To select the time you want coffee to start brewing, press the Program button and hold it. The time displayed in the window is the programmed start time. To change time, follow "Setting the Program Time" instructions on page 7.
- b. Push the 1-4 cup button if you are brewing fewer than 5 cups.
- c. Press and release Program button. Green LED indicates that the unit is in programmed-start mode and the brew cycle will begin at the time you selected.

#### 9. After Brewing

When brew cycle is complete, five beeps will sound and unit will automatically shut itself off. Coffee will continue to stream from the filter for several seconds. The thermal carafe will keep coffee hot for hours. **Bottom of thermal carafe is hot to touch for several minutes after brewing. Use caution.**

#### TIPS AND HINTS

- If you buy large portions of beans, separate them into one or two week portions and store them in airtight containers in the freezer. Preserve freshness by minimizing exposure to air, light, and moisture. Once beans are removed from the freezer, keep them in a sealed container at room temperature, since damaging condensation can occur when beans move from cold to warmer temperatures.
- Some experts feel freezing dark-roast beans can cause oils to coagulate; others disagree. You'll have to decide that one for yourself!

## MAKING COFFEE WITH PRE-GROUND BEANS

Follow instructions in "Before Brewing Your First Pot of Coffee", page 8.

## CHARCOAL WATER FILTER

Your coffeemaker comes with a charcoal water filter that eliminates chlorine, bad tastes and odours from tap water.

#### Inserting the Water Filter

- Remove the filter from polybag and soak it, fully immersed, in cold tap water for 15 minutes.
- Lift the water filter holder out of the water reservoir (see page 6, #13).
- Press down on the filter compartment and pull toward you to open.
- Place filter into the holder and snap it closed. Be careful – improper placement can tear the filter skin.
- Flush filter by running cold tap water through holes in bottom of compartment for 10 seconds.
- Allow the filter to drain completely.
- Slide the water filter holder back into the channel in the water reservoir, pushing it down to the base of the unit.

NOTE: We recommend changing the water filter every 60 days or after 60 uses, and more often if you have hard water.

Replacement filters can be purchased in stores, by calling Cuisinart customer service.

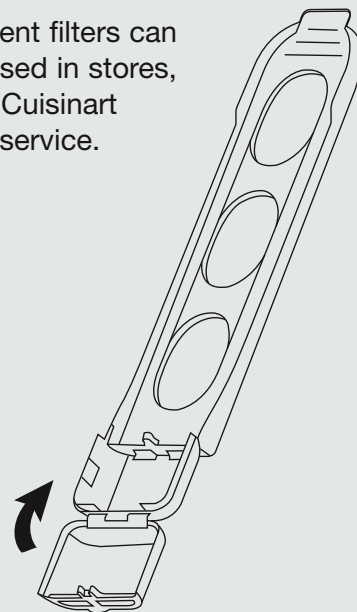

---

### 1. Fill the Reservoir and Insert Filter

See steps #1 and #2 in “Making Coffee with Whole Beans.”

### 2. Add Pre-Ground Coffee

Our recipe suggestion: Use 1 level scoop of ground coffee per cup. Adjust the recipe according to taste. NOTE: The maximum capacity for ground coffee is 16 level scoops, using either a paper or permanent filter. Exceeding that amount may cause overflow if the coffee is too finely ground.

### 3. Press Grind Off Button

When this function is activated, an amber LED will come on.

### 4. Follow steps #4 through #8 in

#### **Brew Pause™ Feature**

Our Brew Pause™ feature interrupts the flow of coffee from the basket to let you pour that first cup mid-brew. Be aware that using this feature will weaken the flavour strength of the finished pot, because the flavour profile of coffee brewed at the beginning of the cycle differs from coffee made at the end.

**NOTE:** Removing carafe for more than 20 seconds may cause filter basket to overflow.

“Making Coffee with Whole Beans.”

## **CLEANING AND MAINTENANCE**

### **COMPLETELY CLEAN AND DRY ALL PARTS AFTER EVERY USE**

Always turn coffeemaker OFF and remove the plug from the electrical outlet before cleaning.

Open the reservoir lid\*. Remove the grinder basket lid by using the recessed area on each side of the lid. Then remove grinder basket. Open filter basket door. Remove filter basket cover and filter basket. The grinder basket, grinder basket lid, filter basket and filter basket cover can be washed in warm soapy water and rinsed thoroughly, or cleaned in the upper rack of the dishwasher.

Dry all parts after every use. Do not put any water in the unit once the grinder basket has been removed.

Wipe the area under the grinder basket with a damp cloth. If water gets into the grinder motor, the motor may become damaged and may malfunction.

Once clean, reverse the above steps. Remove the carafe from the resting plate. Discard any remaining coffee. The carafe and lid can be washed in warm soapy water and rinsed thoroughly, or placed in a dishwasher.

The carafe and carafe lid should be placed on the upper rack only. Do not use scouring agents or harsh cleansers on any part of the coffeemaker. Never immerse base unit in water or other liquid. To clean base, simply wipe with a clean, damp cloth and dry before storing.

Wipe resting plate with a clean, damp cloth. Never use rough, abrasive materials or cleansers to clean the resting plate. Do not dry the inside of the water reservoir with a cloth, as lint may remain.

**MAINTENANCE:** Any other servicing should be performed by an authorized service representative.

**\*Note:** Reservoir lid can also be removed for easy cleaning. Open the lid 60° and gently pull toward you. To replace, reverse steps.

### **DECALCIFICATION**

Decalcification refers to removing the calcium deposits which form over time on the metal parts of the coffeemaker.

For best performance from your coffeemaker, decalcify the base unit from time to time. The frequency depends upon the hardness of your tap water and how often you use the coffeemaker.

To clean, fill the water reservoir to capacity with a mixture of 1/3 white vinegar and 2/3 water. Turn the coffeemaker on by pressing the ON button. One cycle should be sufficient to adequately clean the coffeemaker. When the cycle is completed and five beeps sound, turn coffeemaker off. Repeat operation, this time using fresh cold water.

---

# WARRANTY

## LIMITED THREE-YEAR WARRANTY

We warrant that this Cuisinart product will be free of defects in material or workmanship under normal home use for 3 years from the date of original purchase.

This warranty covers manufacturer's defects including mechanical and electrical defects. It does not cover damage from consumer abuse, unauthorized repairs or modifications, theft, misuse, or damage due to transportation or environmental conditions. Products with removed or altered identification numbers will not be covered.

This warranty is not available to retailers or other commercial purchasers or owners.

If your Cuisinart product should prove to be defective within the warranty period, we will repair it or replace it if necessary.

For warranty purposes, please register your product online at [www.cuisinart.ca](http://www.cuisinart.ca) to facilitate verification of the date of original purchase or keep your original receipt for the duration of the limited warranty.

This warranty excludes damage caused by accident, misuse or abuse, including damage caused by overheating, and it does not apply to scratches, stains, discoloration or other damage to external or internal surfaces that does not impair the functional utility of the tool/gadget. This warranty also expressly excludes all incidental or consequential damages.

If the appliance should become defective within the warranty period, do not return the appliance to the store. Please contact our Customer Service Centre:

Toll-free phone number: 1-800-472-7606

Address: Cuisinart Canada  
100 Conair Parkway  
Woodbridge, ON.  
L4H 0L2

Email: [consumer\\_Canada@conair.com](mailto:consumer_Canada@conair.com)

Model: DGB-650C

To facilitate the speed and accuracy of your return, please enclose:

- \$10.00 for shipping and handling of the product (cheque or money order)
- Return address and phone number
- Description of the product defect
- Product date code\*/copy of original proof of purchase
- Any other information pertinent to the product's return

\*Product date code can be found on the underside of the base of the product. The product date code is a 4 or 5 digit number. Example, 90630 would designate year, month & day (2009, June 30th).

Note: We recommend you use a traceable, insured delivery service for added protection. Cuisinart will not be held responsible for in-transit damage or for packages that are not delivered to us.

To order replacement parts or accessories, call our Customer Service Centre at 1-800-472-7606.

For more information, please visit our website at [www.cuisinart.ca](http://www.cuisinart.ca)

# Cuisinart®

SAVOR THE GOOD LIFE®



Coffeemakers



Food Processors



Toasters



Blenders



Cookware



Ice Cream Makers

Cuisinart offers an extensive assortment of top quality products to make life in the kitchen easier than ever. Try some of our other countertop appliances and cookware, and Savor the Good Life®.

**[www.cuisinart.ca](http://www.cuisinart.ca)**

©2011 Cuisinart Canada  
100 Conair Parkway,  
Woodbridge, Ontario L4H 0L2

Printed in China

Consumer Call Centre E-mail:  
[Consumer\\_Canada@Conair.com](mailto:Consumer_Canada@Conair.com)

1-800-472-7606

11CC120840

Any other trademarks or service marks of third parties referred to herein are the trademarks or service marks of their respective owners.

IB-8336A-CAN