

Outdoor IR Speed Dome PTZ Camera **User's Guide**

CM-Z2212GY



ZMODO TECHNOLOGY CORP. LTD.
1201-1205, Sangda Mansion, High Technology Park,
ShenZhen, Guangdong, China
Tel: 0755-3363-1636 Fax: 0755-3363-1639





SAFETY PRECAUTIONS

WARNING

1. Be sure to use only the standard adapter that is specified in the specification sheet. Using any other adapter could cause fire, electrical shock, or damage to the product
2. Incorrectly connecting the power supply or replacing battery may cause explosion, fire, electric shock, or damage to the product.
3. Do not connect multiple cameras to a single adapter. Exceeding the capacity may cause abnormal heat generation or fire.
4. Securely plug the power cord into the power receptacle. Insecure connection may cause fire.
5. When installing the camera, fasten it securely and firmly. A falling camera may cause personal injury
6. Do not place conductive objects (e.g. screwdrivers, coins, metal things, etc.) or containers filled with water on top of the camera. Doing so may cause personal injury due to fire, electric shock, or falling objects.
7. Do not install the unit in humid, dusty, or sooty locations. Doing so may cause fire or electric shock.
8. If any unusual smells or smoke come from the unit, stop using the product. In such case, immediately disconnect the power source and contact the service center. Continued use in such a condition may cause fire or electric shock.
9. If this product fails to operate normally, contact the nearest service center. Never attempt to modify this product in any way. (ZMOD0 is not liable for problems caused by unauthorized modifications or attempted repair.)
10. When cleaning, do not spray water directly onto parts of the product. Doing so may cause fire or electric shock.

CAUTION

1. Do not drop objects on the product or apply strong shock to it. Keep away from a location subject to excessive vibration or magnetic interference.
2. Do not install in a location subject to high temperature (over 120F), low temperature (below -5F), or high humidity. Doing so may cause fire or electric shock.
3. If you want to relocate the already installed product, be sure to turn off the power and then move or reinstall it.
4. Remove the power plug from the outlet when there is a lightning. Neglecting to do so may cause fire or damage to the product.
5. Keep out of direct sunlight and heat radiation sources. It may cause fire.
6. Install it in a place with good ventilation.
7. Avoid aiming the camera directly towards extremely bright objects such as sun, as this may damage the CCD image sensor.
8. Apparatus shall not be exposed to dripping or splashing and no objects filled with liquids, such as vases, shall be placed on the apparatus.
9. The Mains plug is used as a disconnect device and shall stay readily operable at any time.

	CAUTION RISK OF ELECTRIC SHOCK DO NOT OPEN	
<p>CAUTION: TO REDUCE THE RISK OF ELECTRIC SHOCK, DO NOT REMOVE REAR COVER. NO USER SERVICEABLE PARTS INSIDE. REFER TO QUALIFIED SERVICE PERSONNEL.</p>		
	This symbol alerts you that important literature concerning operation and maintenance has been included with this product.	
	This symbol indicates high voltage is present inside. It is dangerous to make any kind of contact with any inside part of this product.	

PRODUCT OVERVIEW

Product Overview

It is a economical, PTZ Dome camera, with a performance of 22X Optical Zoom and 10X Digital Zoom and 420 TV Lines of Horizontal Resolution. Also with functions such as 128 preset positions, full 360° of endless pan, auto flip 180° of tilt rotation and weatherproof, it offers exceptional performance at an affordable price. This constant dome camera will provide the user with all the basic functions needed for surveillance, such as low-light sensitivity of 0Lux, Day & Night auto switch, 360°pan rotation and 360°tilt rotation and built-in housing. It will provide crisp and clear images, indoors and especially outdoors, 24 hours a day.

Main Features

- 1/4" Sony Super HAD Color CCD Image Sensor
- 420 TV Lines, Horizontal
- 4~88mm Vari-focal Lens
- Signal: NTSC
- Weatherproof
- IR Night Vision Distance: 260' (80m)
- Minimum Illumination: 0Lux (12 LEDs)
- 22X Optical Zoom and 10X Digital Zoom
- Pan Rotation: 0°~360° (Endless)
- Tilt Rotation: Auto Flip180°
- PT Speed: Pan: 0.5~350°/sec, Tilt: 0~90°/sec
- 128 Presets
- Communication: Rs485
- Protocols: PELCO-D, PELCO-P
- Video Connector: BNC
- Power Connector: RCA12V DC, 3A

Package includes

Please check your camera and accessories included in the package. Those components are as shown below:

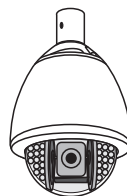

Camera

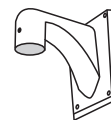

Mount Bracket



Screws

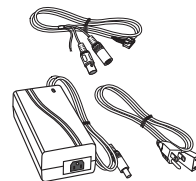

Power & Cables



Package Box

- 1) CM-Z2212GY Weatherproof IR PTZ Camera
- 1) Mount Bracket
- 1) Cable
- 1) 12V DC Power Supply
- 4) Screws
- 1) Package Box

SCHEMATIC DIAGRAM

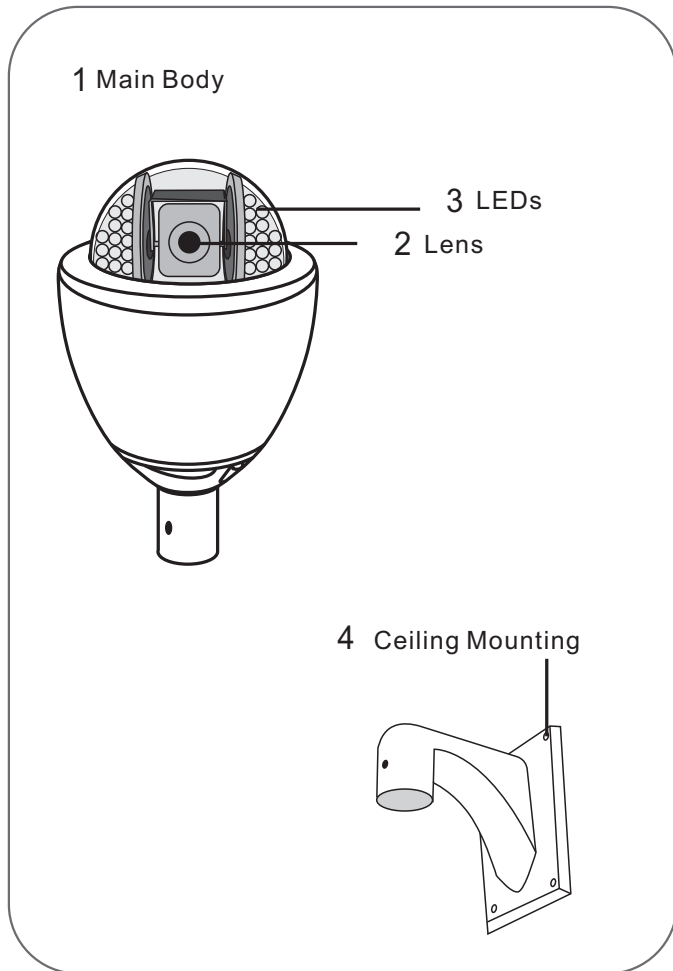

All Dimensions = in
(cm)

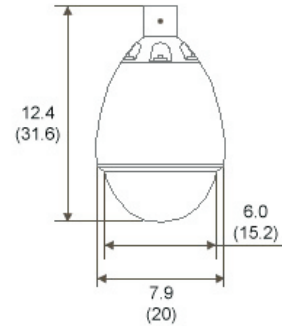

Application Drawing



CONNECTING CABLES

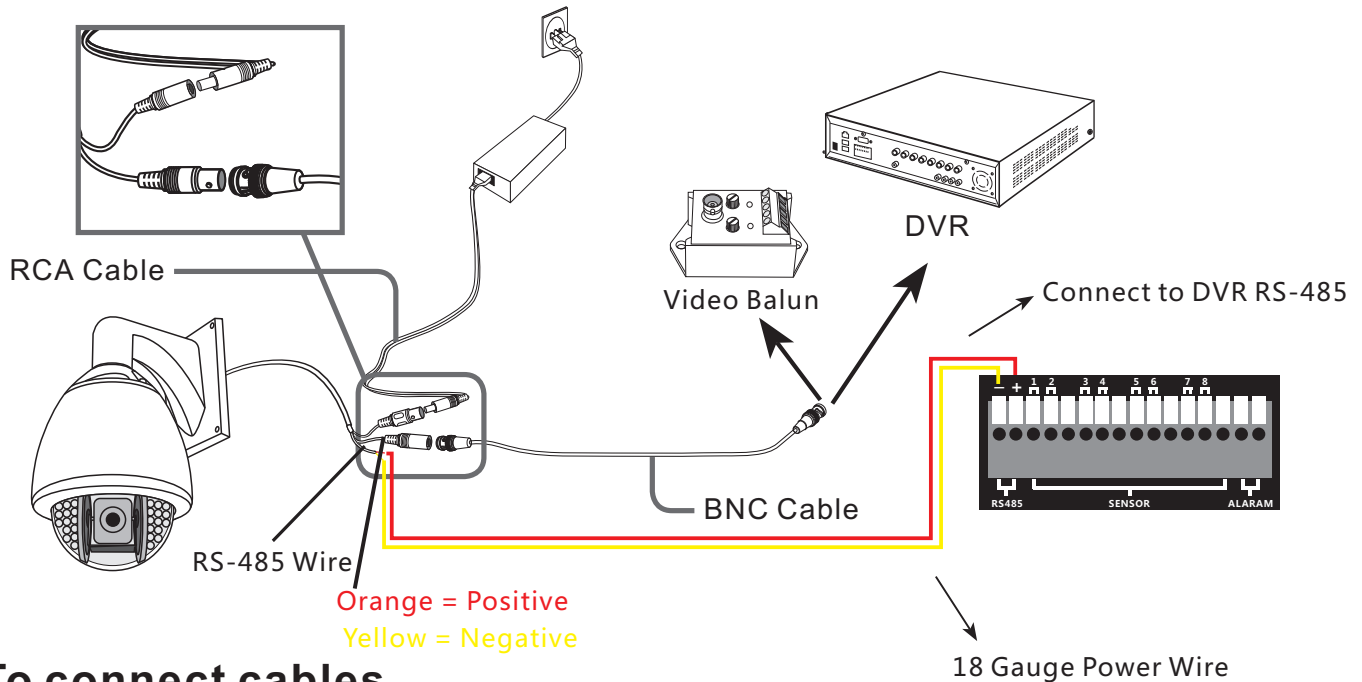

To connect cables

1. Connect the BNC cable to the video connector attached on your camera
2. Connect the BNC cable to the Video Input on a DVR or Video Balun.
3. Connect the power adapter to the RCA Power connector attached on your camera. And then connect the power adapter to a power source nearby.
4. Run an 18 gauge power wire for the RS-485 (Control Wire) and connect it to the DVR and the Camera using the above guide.

Note

It is very important that you identify these ends before installing the cable so that you have the correct ends at the correct location.

HOW TO INSTALL

Before installation

Please read the following instructions before installing your camera:

- You have to check whether the location (ceiling or wall) can bear five times the weight of your camera.
- Do not allow the cable to be caught in a pinched area, otherwise the electric line cover may be damaged. This may cause cable breakdown or fire.
- When installing your camera, don't allow anyone to walk or stand under your installation site, and remove all valuable items. A dropped camera may cause injury to bystanders or harm to valuable items.

Installation procedure

- To install your camera

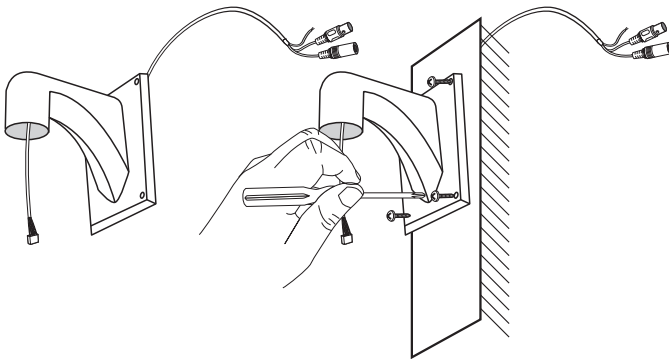

step

- 1** Go through the short cable that come with the Main Body from the Wall Mount Bracket. Fix the Mount Bracket on the wall with the screws supplied in the package using a screwdriver.

HOW TO INSTALL

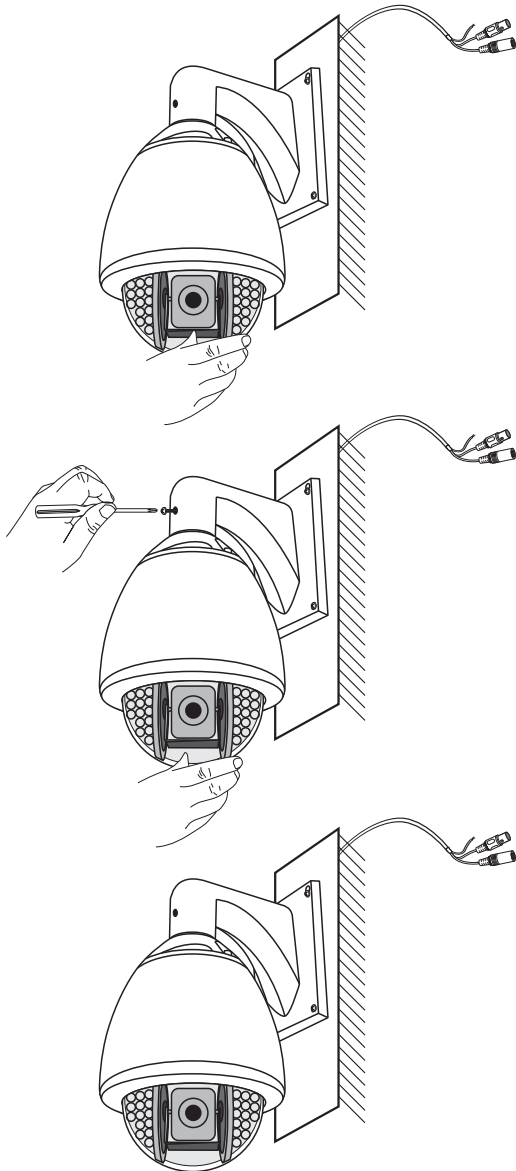

step

2 Attach the Main Body to the Mount Bracket by twisting the screws into the three holes using a screwdriver.

step

3 The camera is now installed on the mounting location. What you need to do next is wiring cables!

Note

You can also install the camera on the ceiling. The same as before, go through the short cable supplied in the package from the Ceiling Mount Bracket. Fix the Mount Bracket onto the ceiling with the screws supplied in the package. And then attach the Main Body to the Mount Bracket. But we do not offer ceiling Mount Bracket in this package.

CAMERA SPECIFICATION

Specifications for NTSC & PAL Standard

Item	Details	
Product type	Outdoor Speed Dome IR PTZ Camera	
Weatherproof	Yes	
Power input	DC 12V, 5A	
Broadcast type	NTSC Standard color system	PAL Standard color system
	(525 Lines, 60 Fields)	(625 Lines, 50 Fields)
Power Consumption	Min. 3800mA	
Image device	1/4 inch SONY Super HAD Color CCD	
Effective Pixels	510(H) x 492(V), 250,920 pixels	
Scanning mode	NTSC Standard	PAL Standard
	525 Lines	625 Lines
Horizontal resolution	420 TV Lines	
IR Lamps	12 LEDs	
Minimum illumination	1 Lux (Color), 0Lux (infra LED on)	
IR Distance	Visible up to 260'(80m)	
Lens	4~88mm Vari-Focal	
Number. of Presets	128	
Dome Movement	Pan: 0°~360° (Endless), Tilt: Auto Flip 180°	
Zoom	Optical: 22X Digital: 10X	
P/T Speed	Pan: 0.5~180°/ sec, Tilt: 0~90°/ sec	
Electronic Shutter	1/50 to 1/120,000	
S/N Ratio	> 50dB	
Controls	Auto Back Light Compensation	
	Auto Switching between Color and B&W by day and night change(D/N)	
Communication	RS-485	
PTZ Control	PELCO-D	
Baud Rate	1200/2400/4800/9600 selectable	
Operation temperature	-5F—120F	
Size (package)	15.4"x 12.6"x 11.8"	
Weight	11.24 lbs	

FCC Statement

This device complies with part 15 of the FCC Rules. Operation is subject to the following two conditions:

- 1) This device may not cause harmful interference.
- 2) This device must accept any interference received including interference that may cause undesired operation.

Note

This equipment has been tested and found to comply with the limits for a Class A digital device, pursuant to part 15 of FCC Rules. These limits are designed to provide reasonable protection against harmful interference when the equipment is operated in a commercial environment. This equipment generates, uses, and can radiate radio frequency energy and, if not installed and used in accordance with the instruction manual, may cause harmful interference to radio communications. Operation of this equipment in a residential area is likely to cause harmful interference in which case the user will be required to correct the interference at his own expense.

Correct Disposal of This Product



(Waste Electrical & Electronic Equipment) (Applicable in the European Union and other European countries with separate collection systems) This marking shown on the product or its literature, indicates that it should not be disposed with other household wastes at the end of its working life. To prevent possible harm to the environment or human health from uncontrolled waste disposal, please separate this from other types of wastes and recycle it responsibly to promote the sustainable reuse of material resources.

Household users should contact either the retailer where they purchased this product, or their local government office, for details of where and how they can take this item for environmentally safe recycling. Business users should contact their supplier and check the terms and conditions of the purchase contract. This product should not be mixed with other commercial wastes for disposal.

Zmodo

SKU: CM-Z2212GY

CE FC



8 4 6 6 5 5 1 0 0 2 7 5 0

