



Kit Code **717126**

Kit Code **717206**

Kit Code **717207**

Compact Router Table

Hole assembly instructions including all three table tops, fence assembly and optional UJK table insert



UJK Pro Cast Iron Table Top



UJK Phenolic Table Top



UJK MDF Table Top



Index of Contents

Index of Contents	02
Introduction	02
What's Included	03-04-05-06
UJK Router Table Stand	
UJK Router Table Tops	
UJK Fence Assembly	
Optional Accessories	7-8
Kit Specifications	08-09
General Instructions for 230V Machines	09
General Safety Instructions	10
Assembly	11-19
UJK Router Table Stand Assembly	11-12
Router Table Top Assembly	13-14
Optional Table Inserts	14-15
UJK Fence Assembly	16-17-18-19
Mitre Fence Assembly	19
Tool Storage Holders	19
Overview Description	20-21
Mounting the Router	22-23
Operating Instructions	24
Parts Drawing/List	(Router Table & Stand Assembly (E Type) 25-26
Parts Drawing/List	(Router Table Fence Assembly) 27-28
Notes	29-30-31

Introduction

The UJK Technology Compact Leg Stand with splayed legs is of sturdy construction, very stable and of a size that offers portability around the workshop or on site. Provision is made for storage of the supplied mitre fence assembly. Measuring 370mm high, with a footprint of 580 x 390mm, this leg stand is such a useful size and could also be used for mounting many other small machines.

The Phenolic or MDF Router Table Tops are additional options that you can choose from when making up your UJK router table. Phenolic resin is a very stable material and may be a good choice if your workshop suffers from damp or humid conditions. The MDF Router Table Top is a very sturdy versatile unit capable of many routing operations. An extruded aluminium track is provided which includes a standard 19mm track for the use of a mitre fence and a T-track slot is also provided for other jigs and accessories.

The fence is a superb quality single aluminium section supplied with a transparent dust port for efficient extraction from above the table. Provision is made for the fitting of guards and accessories with a T-slot at both the top and front of the fence.

An adjustable transparent guard is included for your safety.

Adjustable scales are provided for attachment at either side of the table and the fence is attached to these and locks into place at the required position. A scale is also provided for the top of the fence with the zero position at the centre. Adjustable in-feed and out-feed fences attach to either side of the aluminium section and the central aperture can be opened and closed according to the diameter of the cutter in use. Fence measures 904 x 90mm high.



Warning

The symbols below advise that you follow the correct safety procedures when using this tool.



Fully read manual and safety instructions before use



Ear protection should be worn



Eye protection should be worn



Dust mask should be worn

UJK Router Table Stand

Quantity	Item	Part	Code
			502533

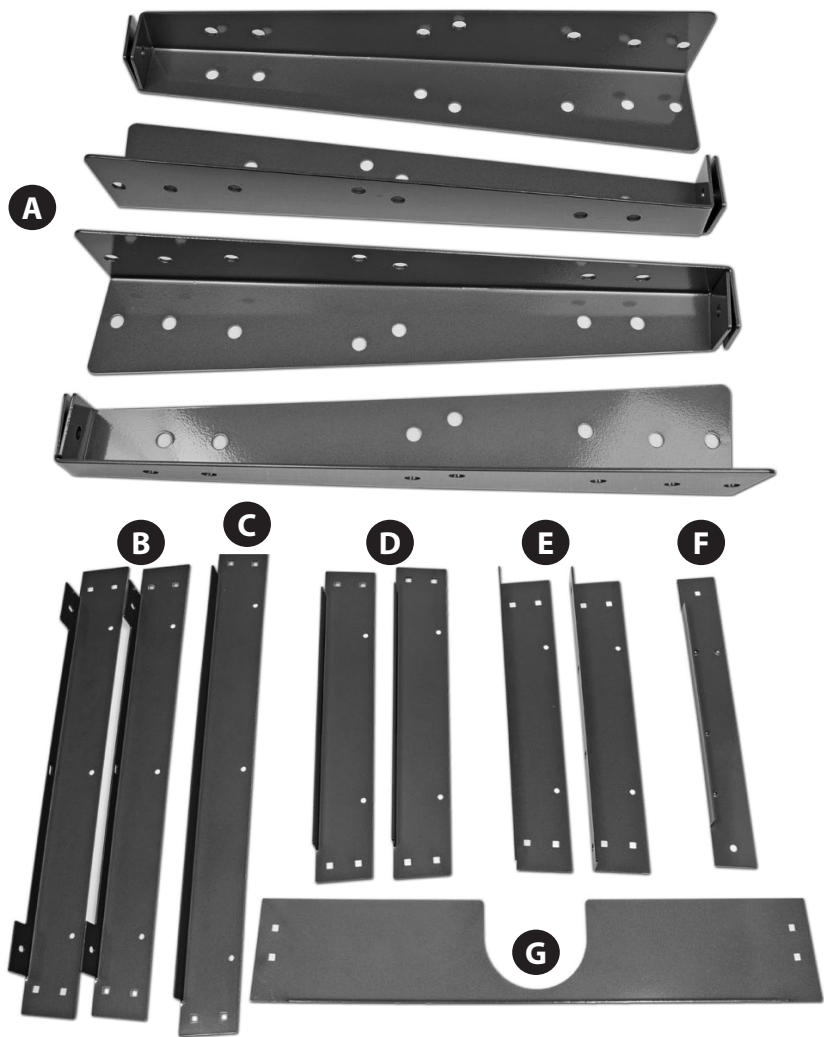
Bag 1 Containing:			
1 No	Mitre Fence Bracket Holder with two Phillips screws and washers	1	
Bag 2 Containing:			
1 No	Tool Bracket (with two pre-drilled holes)	2	
4 No	Rubber Feet	3	
4 No	Phillips Screws (M6x20mm)	4	
2 No	Phillips Screws (M4x20mm)	5	
34 No	Coach Bolts (M6x12mm)	6	
38 No	Flat Washers (M6)	7	
38 No	Nuts (M6)	8	
2 No	Nuts (M4)	9	
1 No	Mitre Fence	10	
1 No	Mitre Fence Extension (with two Butterfly nuts and washers)	11	



What's Included

UJK Router Table Stand

Quantity	Item	Part
4 No	Leg Supports Brackets	A
2 No	Front and Back Upper Panels	B
1 No	Front Lower Panel	C
2 No	Side Lower Panels	D
2 No	Side Upper Panels	E
1 No	Side Centre Panel	F
1 No	Rear Extractor Panels	G



UJK Router Table Tops

Quantity	Item	Part	Code
1 No	UJK Compact Cast Iron router table top	A	502532
1 No	UJK Compact Phenolic router table top	B	502746
1 No	UJK Compact MDF router table top	C	502744

Bag Containing Code **502532-502746**

10 No	Countersink Phillips Screws (M6x20mm)
10 No	M6 Nuts
10 No	Hex Bolts (M6x12mm)
10 No	M6 Washers
10 No	Spring Washers

Bag Containing Code **502744**

10 No	Countersink Phillips Wood Screws
6 No	Phillips Head Wood Screws



UJK Pro Cast Iron Table Top



UJK Phenolic Table Top



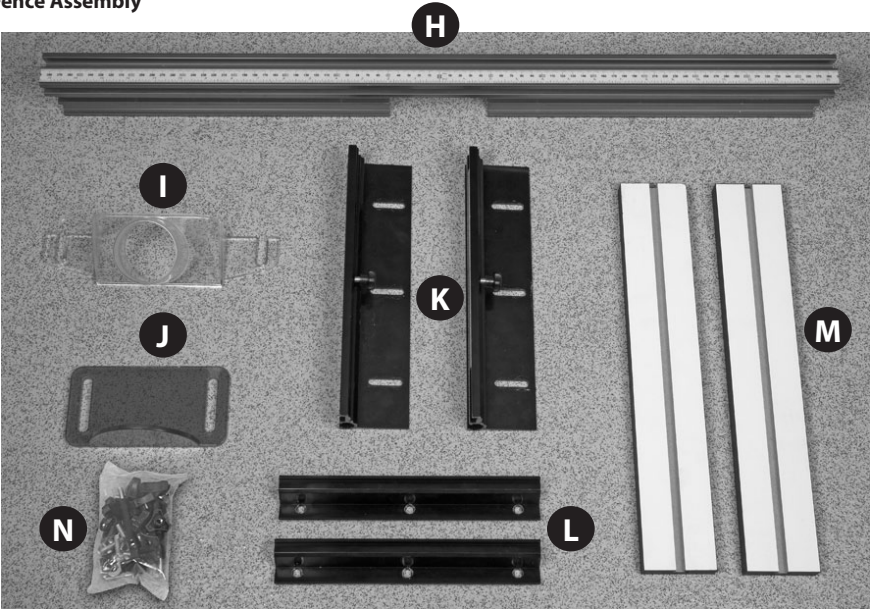
UJK MDF Table Top

UJK Fence Assembly

Quantity	Item	Part	Code
1 No	Fence	H	502534
1 No	Extraction Moulding	I	
1 No	Dust Shield	J	
2 No	Fence Fixing Brackets with Scale	K	
2 No	Fence Fixing Brackets	L	
2 No	Adjustable Wood Faces	M	
1 No	Bag Containing	N	
2 No	Locking Handle Knob (5/16")	a	
8 No	M8 Locking Knobs	b	
2 No	Fence Spacers	c	
8 No	'T' Bolts (M8x43mm)	d	
6 No	Hex Screws (M6x12mm)	e	
6 No	Hex Bolts (1/4") (with flat & spring washers)	f	
2 No	Lock Hex Nuts (5/16")	g	
6 No	Square Nuts (1/4")	h	
10 No	M8 Flat Washers	i	
6 No	M6 Flat Washers	j	

What's Included

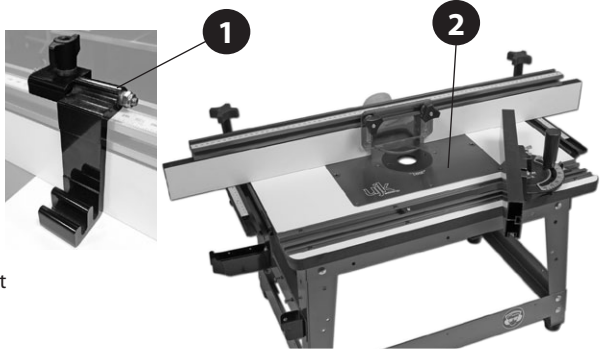
UJK Fence Assembly



Optional Accessories

1) UJK Technology QuickStop (Code 502569)

- A hinged stop to fit the UJK Technology router tables.
- An excellent device for stopped chamfers or rebates.
- Attaches to the top of the router table fence.
- Simply flips up out of the way when not required.



2) UJK 6mm Aluminium Table Insert (Code 502749)

- Threaded lead-in pin.
- To fit 230 x 306mm aperture.
- Twist lock insert ring supplied with wrench.

502566

502567



3) Router Table Inserts

- A range of central inserts for the
- Axminster or UJK router elevator
- Also suitable for UJK Technology aluminium and phenolic router table insert plates.
- Sizes include 12.6mm, 38mm, 63.4mm plus a guide bush adaptor.
- Blank insert available for making your own hole size.
- Available as a set of four or individually.

(Code 502565) 12.6mm

(Code 502566) 38mm

(Code 502567) 63.4mm

(Code 951187) Blank Insert

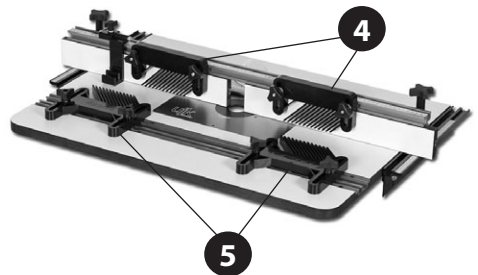
(Code 502525) Guide Bush Adaptor

4) Vertical Feather Boards (Code 502751)

- Gives downward pressure against workpiece.
- Excellent for safer routing.

5) Horizontal Feather Boards (Code 502750)

- Holds work piece against fence.
- Excellent for safer routing.
- Use as singles or stacked for more support.



6

6) Power Tool NVR Switch (Product Code 910065)

- Versatile NVR switch for remote switching of table mounted power tools.
- Offers very convenient solution.



7

Continues Over...

Optional Accessories



7) UJK Technology Router Elevator
(Code 502701)

The UJK Technology router elevator is a logical solution for fast, accurate production on many router table installations. This compact design was developed by us to fit straight into our own router tables and most table set-ups can accommodate this size of insert (305 x 229 x 6mm). The unit can be made to fit flush into the tabletop by the provision of levelling screws at each corner of the table insert. Height adjustment is carried out by inserting a handle through a measurement dial set into the machine table. Each rotation of the handle raises or lowers the cutter by exactly 2mm and the integral scale is graduated into increments enabling very accurate adjustments to be carried out.



8) UJK Technology Dust Extraction Box
(Code 502538)

- Dust collection device.
- Efficient extraction from above and below the table.
- Access door with magnetic catch.
- 63mm extraction hose included.
- 100mm outlet.



Dust extraction from a router table can be difficult and for it to work effectively it needs to extract from both above and below the table. Designed to fit the UJK Technology Pro and Compact router tables this device fits below the table top enclosing the router. It could also be fitted to other custom made tables of your own design. The 100mm diameter outlet on the back also incorporates a 62mm inlet and hose which enables extraction from both above and below the table simultaneously. An access door is provided on the front with a magnetic closure enabling access to your router for adjustments if required. Measures 330 x 260 x 350mm high with an access aperture of 225 x 170mm.

Kit Specification

UJK Technology Compact Router Table with Cast Iron Table Top

Code	717126
Rating	Trade
Table Size	686 x 406 x 40mm
Fence Size	779 x 90mm
Dust Extraction Outlet	62mm

UJK Technology Compact Router Table with Phenolic Table Top

Code	717206
Rating	Trade
Table Size	600 x 400 x 22mm
Fence Size	779 x 90mm
Dust Extraction Outlet	62mm

UJK Technology Compact Router Table with MDF Table Top

Code	717207
Rating	Trade
Table Size	600 x 400 x 32mm
Fence Size	79 x 90mm
Dust Extraction Outlet	62mm

General Instructions for 230V Machines

Good Working Practices/Safety

The following suggestions will enable you to observe good working practices, keep yourself and fellow workers safe and maintain your tools and equipment in good working order.



WARNING! KEEP TOOLS AND EQUIPMENT OUT OF THE REACH OF YOUNG CHILDREN

General Advice

If you are totally unfamiliar with the use of a power router, please seek some basic tuition and advice from an informed, qualified source. An amateur woodworker or hobbyist just starting out is advised to undertake a short course on the use of woodworking machines run by a professional woodworker. These are often offered by your local authority as evening classes.

Mains Powered Tools/ Primary Precautions

These tools are supplied with a moulded 13 Amp. plug and 3 core power cable. Before using the tool inspect the cable and the plug to make sure that neither are damaged. If any damage is visible have the tool inspected/repared by a suitably qualified person. If it is necessary to replace the plug, it is preferable to use an 'unbreakable' type that will resist damage on site. Only use a 13 Amp plug, make sure the cable clamp is tightened securely and check that a 13 Amp fuse is fitted. It is also recommended that a switched power outlet is used. If extension leads are to be used, carry out the same safety checks on them, and ensure that they are correctly rated to safely supply the current that is required for your machine.

General Safety Instructions

- Carefully study and observe the safety instructions issued with the router being used in the table.
- In addition, the following precautions, specific to the use of router tables, should be adhered to.
- Ensure that the router is securely fixed to the router table, both when first commissioned and periodically thereafter.
- Fix the router table to a firm base such as a workbench or a heavy table. If the table is attached to a false base this in turn should be firmly fixed to a workbench or other solid surface.
- Always wear appropriate safety equipment such as safety goggles or face shield, dust mask and ear defenders. Ties, loose clothing and jewellery are all potential safety hazards and should be avoided.
- The router table is intended for cutting timber and plastics only, do not use it with other materials. Long lengths of timber will need to be supported on both the in-feed and out-feed sides of the table.
- Timber should be fed into the cutter from the right hand side of the table, as indicated on the safety label attached to the fence. A push block or custom made work holder should be used when cutting small pieces.
- Router cutters should be installed correctly in the router with the recommended minimum length of shaft engaged in the collet and the collet tightened to the correct degree.
- When making any adjustments to the router, such as changing the cutter, ensure that the router is switched off and the power cable is removed from the power supply before proceeding.

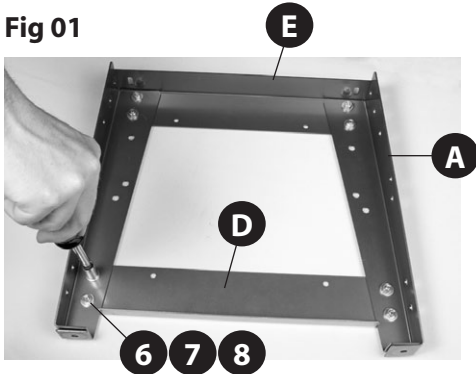
General Safety Instructions

- 1.** Make sure that the operator has been properly trained and has read and understands the Owner's Manual before operating any machinery.
- 2.** Be sure to read, understand, and follow all instructions, warnings, and safety guidelines supplied with your router.
- 3.** Keep the work area well lit, clean, and free of debris.
- 4. STAY ALERT!** Give your work your undivided attention. Even a momentary distraction can lead to serious injury.
- 5.** Do not wear loose clothing, gloves, bracelets, neck-laces, or other protection devices. Wear protective hair covering to contain long hair and wear nonslip footwear.
- 6.** Keep hands and other body parts well away from bits or cutting tools. When working close to the cutting tool, always use a feather board or push-stick to hold or guide the work piece. Do not clear chips and sawdust away with hands; use a brush.
- 7.** Fine particulate dust is a carcinogen that can be hazardous to health. Always work in a well ventilated area and whenever possible use a dust collector to minimize health hazards.
- 8.** Be sure the router is running up to speed before feeding the work piece.
- 9.** Use a suitable support if stock does not have a flat surface.
- 10.** Keep children and visitors at a safe distance when the router is in operation - do not permit them to operate the router and/or table.
- 11.** Childproof and taper proof your shop and all machinery with locks, master electrical switches and switching keys, to prevent unauthorized or unsupervised use.
- 12.** Secure the table to a work surface and never stand or lean on it. Serious injury can occur if the table is tipped or if unintentional contact is made with the spinning router bit.
- 13.** Keep all guards and safety devices in place and in good working order. If a guard must be removed for maintenance or cleaning make sure it is properly reinstalled before using the machine again.
- 14.** Hold the work piece firmly against the table and use suitable support if the work piece does not have a flat surface.
- 15.** Feed the stock into the bit against the rotation direction of the bit. Never run the stock between the fence and the bit.
- 16.** Do not operate with a damaged cutter in the router.
- 17.** Always disconnect the router from the power source before changing accessories or before performing any maintenance and adjustments or if the machine will be left unattended.
- 18.** Be sure that all adjustment tools, wrenches, or other clutter are removed from the table surface and safely stored before routing.
- 19.** Make sure the router's switch is in the "OFF" position before plugging in to a power source.
- 20.** Avoid working from awkward or off-balance positions. Do not overreach and always keep both feet firmly on the floor.
- 21.** Never leave the router unattended while running or with the power "ON".
- 22.** Do not use this router table for any purposes other than its intended use. If used for other purposes, Axminster Tool Centre disclaims any real or implied warranty and holds itself harmless for any injury which may result from such use.

UJK Router Table Stand Assembly

Step 1 Locate the bag containing the coach bolts (M6x12mm) (6), M6 flat washers and nuts (7-8), leg support brackets (A) and side upper/lower panels (D-E). Offer up the pre-drilled holes in the leg supports with the holes in the upper/lower panels as shown in fig 1 and secure using the M6 nuts bolts washers. DO NOT OVERTIGHTEN. Repeat for the remaining legs (A) and panels (D-E).

Fig 01

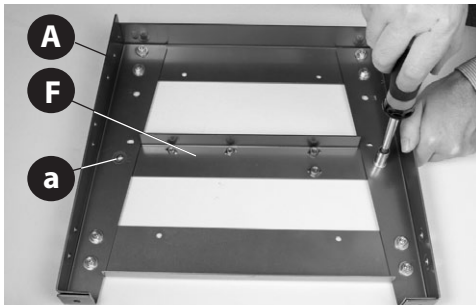


Step 2 Locate the side centre panel (F) and one of the stand sides, offer up the holes in the centre panel with holes in the centre of the leg supports (A) and secure with M6 fixings (6-7-8), (See fig 2)



NOTE Leave fixing hole (a) clear to mount the tool bracket (2) later in the assembly.

Fig 02



Step 3 Find the rear extractor panel (G) and front lower panel (C). Lightly tighten both panels to the stand side as show in fig 3, using the M6 fixings. Attach the remaining stand side to the other end, (See fig 4).

Fig 03

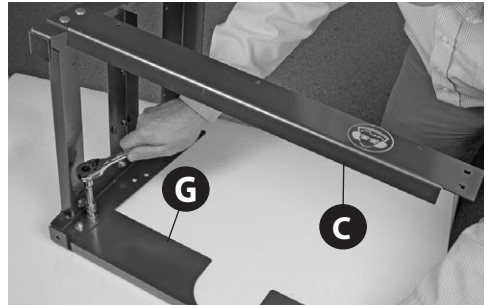


Fig 04

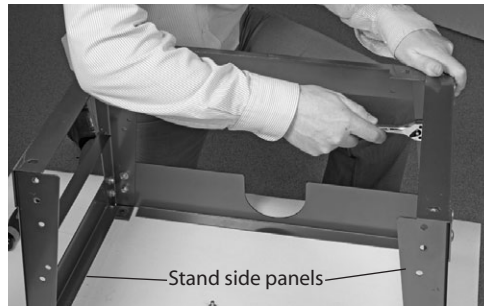
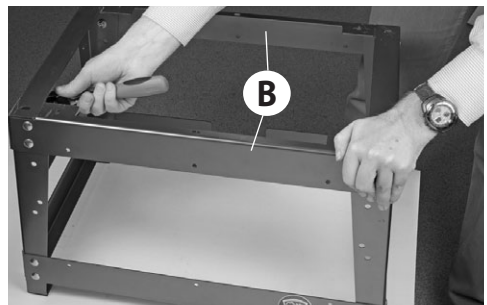


Fig 05



Step 4 Locate the front and back upper panels (B) and attach it to the frame work as shown in fig 5, then go round and tighten all the fixing.

Assembly

Step 5 Locate the four rubber feet (3), (M6x20mm) Phillips screws (4), flat washers (7) and M6 nuts (8), see fig 6. Turn the stand over, place a rubber foot on top of the leg support bracket (A) and line up the pre-drilled holes. Place a flat washer (7) over the Phillips screw (4) and insert the screw into the foot's recess, secure in place with the nut (8), (See fig 6-7). Repeat the process for the remaining feet, see fig 8.

Fig 06-07

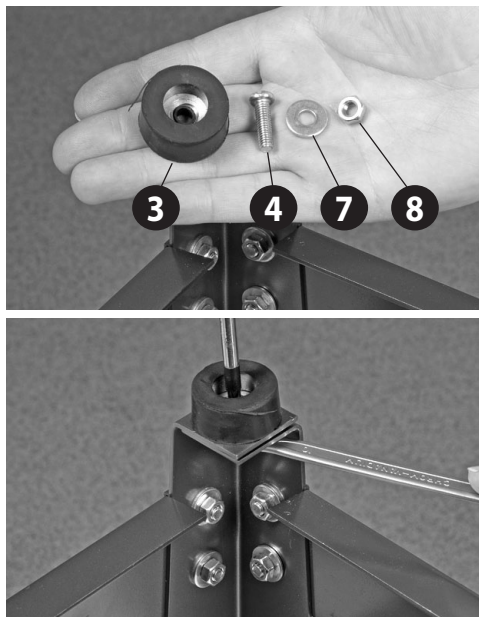
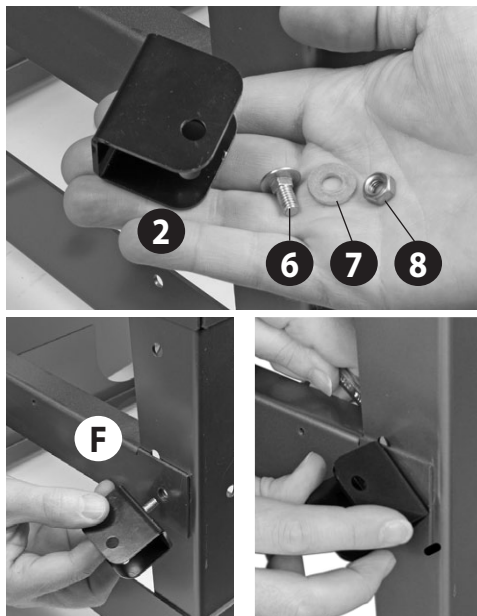


Fig 08



Step 6 Turn the stand over, locate the tool bracket (2) and M6 fixing 6-7-8. Insert the coach bolt (6) through the centre hole in the tool bracket (2) and

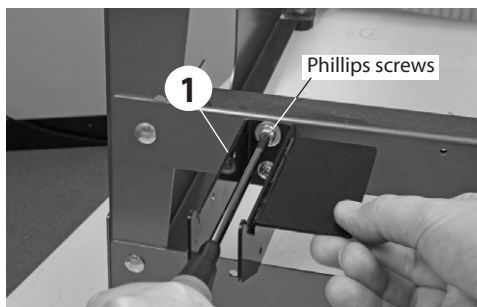
Fig 09-10-11



into the pre-drilled hole in the centre panel (F), angle the bracket and secure using fixing (7-8), (See figs 9-10-11)

Step 7 Turn the frame over, locate the mitre fence bracket holder and two Phillips screws/washers (1). Lineup the holes in the bracket with threaded holes

Fig 12

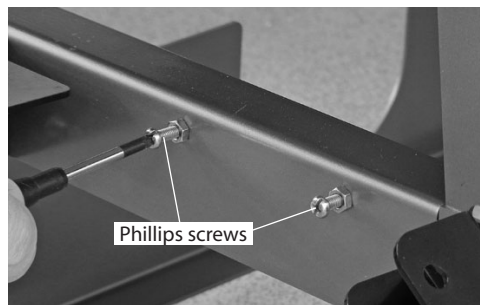


in the centre panel (F) and secure in place with the Phillips screw. (See fig 12).

Step 8 Locate the two (M4) Phillips screws and nuts (5-9), place a nut onto the Phillips screws an screw

them into the two threaded hole in the centre panel (F), (See fig 13). The Phillips screws are for hanging tools for storage. **Note: Adjust the screw depth and clamp in position using the nut for larger tools.**

Fig 13



UJK Router Table Top Assembly



WARNING! THE CAST IRON TOP IS VERY HEAVY SEEK HELP!

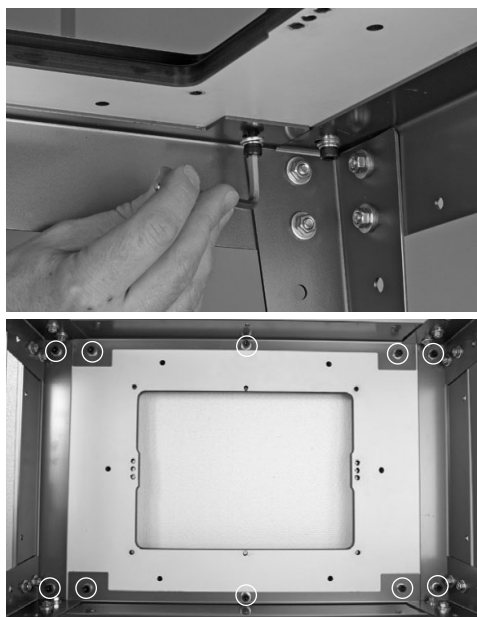
There are three router table tops that can be mounted to the stand the Cast Iron, Phenolic and MDF. The follow instructions show the Phenolic top but it will apply for the other two table tops.

Step 1 Unpack the table, and it fixings. Lift the table (B) on top of the stand assembly, see fig 14. Locate

Fig 14



Fig 15-16

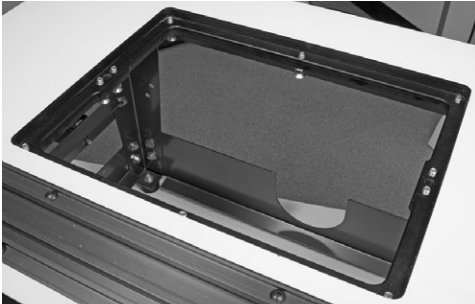


the ten Hex screws, flat washers and spring washer and place a spring and flat washer over the Hex threads. Lineup the threaded holes in the table with the holes in the stand and secure in place with the Hex screws, (See figs 15-16)

Step 2 Locate the ten countersink Phillips screws and M6 locking nuts, place a nut onto each of the Phillips screws and screw the countersink screws into the ten threaded holes beneath the table insert recess. (See figs 17-18)

Fig 17-18

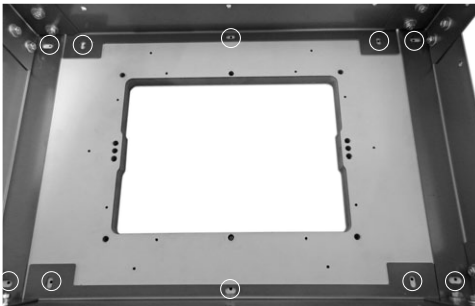




UJK Router Table MDF Top

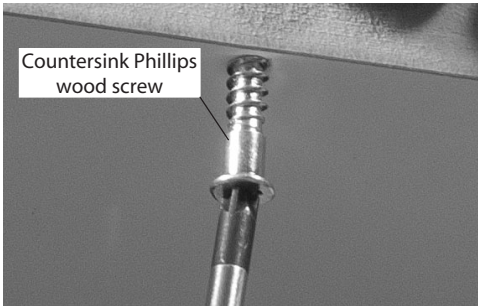
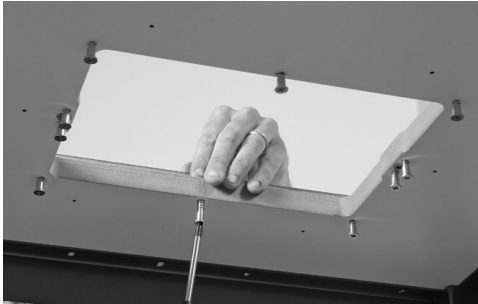


Fig 19-20



Step 3 Locate the ten countersink Phillips wood screws and screw them into the threaded holes beneath the MDF table insert recess. (See figs 21-22)

Fig 21-22



Stand and Table Assembled



Optional Table Inserts

NOTE: There are four options to choose from:

- 6mm Aluminium Table Insert (Code 502749)
- 10mm Phenolic Insert (Code 502747)
- 10mm Aluminium Insert with Universal Base (Code 502748)
- UJK Technology Router Elevator (Code 502701)

The following instructions are for the optional UJK 6mm Aluminium table insert but it will apply for the other options as well.

Step 1 Locate the table insert, four grub screws and the two countersink Hex screws. Place the UJK table insert into the tables recess, adjust the ten countersink Phillips screws beneath the table, see fig 23 until the table insert is roughly level with the table surface. Adjust the locking nuts to lock the countersink screws in position. (See figs 24-25)

Fig 23

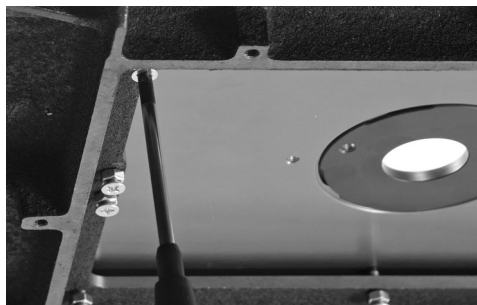
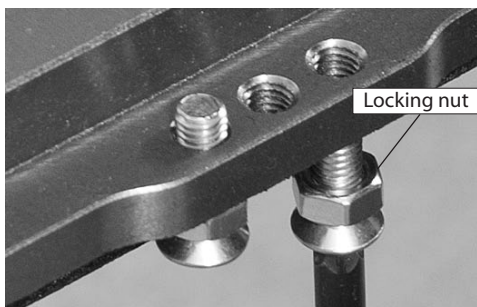
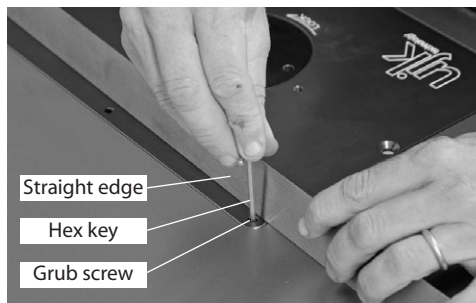


Fig 24-25



Step 2 Insert a grub screw into each threaded corner of the table insert, place a straight edge across the table insert and using a Hex key adjust the grub screws until the table insert is level with the table top. (See fig 26)

Fig 26



Step 3 Insert the two countersink Hex screws down into the countersink holes in the table inset to lock the insert in position. (See fig 27)

Fig 27

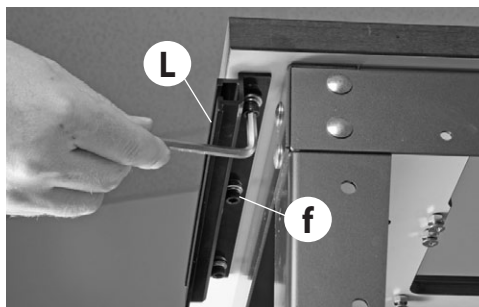
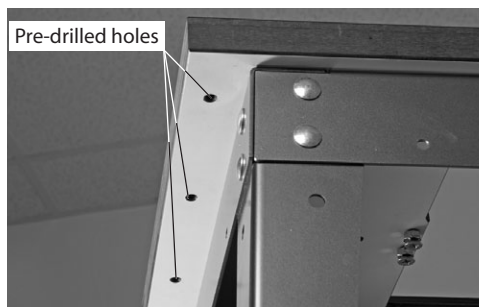


Assembly

UJK Fence Assembly

Step 1 Locate the fence fixing brackets (L) and the six Hex screws flat and spring washers (f). Line up one of the brackets with the pre-drilled holes beneath the edge of the table and secure in place with four Hex screws (f), see figs 28-29. Repeat for opposite side.

Fig 28-29



Step 2 Insert three (1/4") square nuts (h) into the machined slot to each fixing bracket (L), see fig 30. Locate the two fence fixing brackets (K), M6 Hex screws (e) and flat washers (j), line up the machined slots in the bracket (K) with the square nuts (h) and secure both brackets with the M6 Hex screws (e), see fig 31. **DO NOT OVERTIGHTEN**

Fig 30

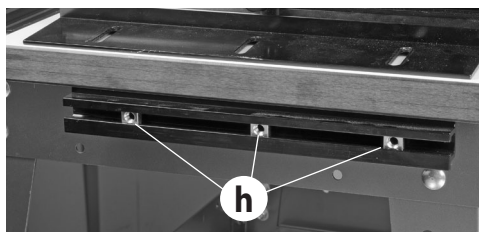
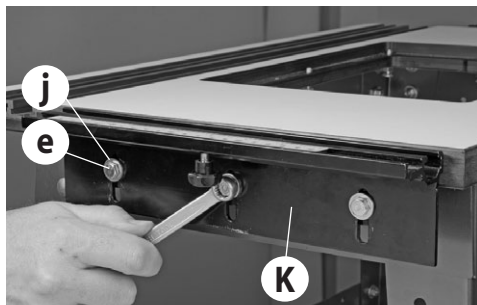
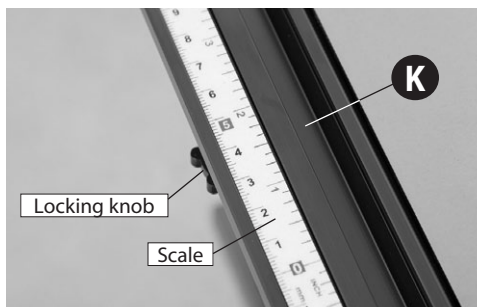


Fig 31



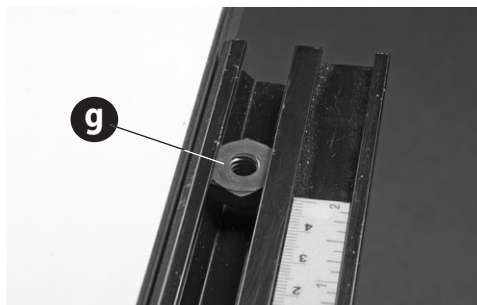
Step 3 Loosen the two locking knobs beneath the fixing brackets (K), slide the two scales into the top of fixing brackets recess and lightly tighten the knobs, see fig 32.

Fig 32



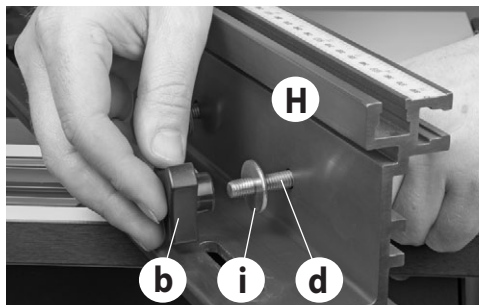
Step 4 Locate the two lock Hex nuts (g) and slide each one into the machined recess in the fixing brackets (K), see fig 33.

Fig 33



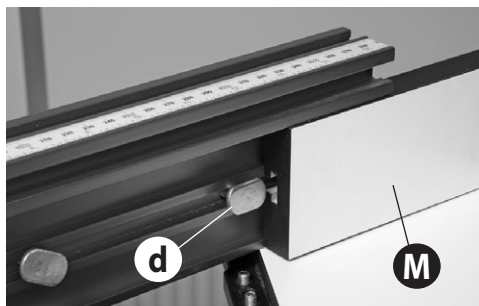
Step 5 Locate the fence assembly (H), 'T' bolts (d) and flat washers (i). Insert six 'T' bolts into the pre-drilled holes in the fence (H), place a washer (i) on each 'T' bolt and screw on the locking knobs (b). (See figs 34-35)

Fig 34-35



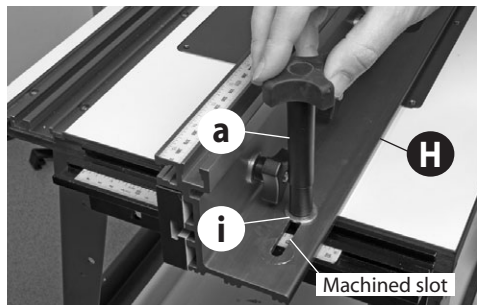
Step 6 Locate the two adjustable wood faces (M), lineup the 'T' bolts (d) with the 'T' slots in the wood face (M) and slide on the wood face, lightly tighten. (See fig 36). Repeat for the other side.

Fig 36



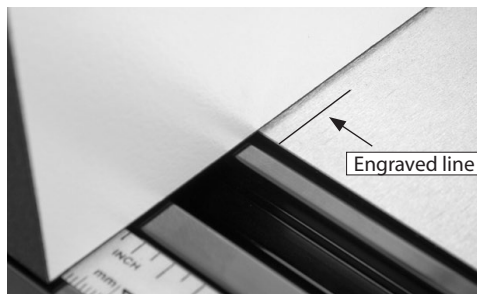
Step 7 Locate the two locking handle knobs (a) and flat washers (i). Line up the machined slots in the fence (H) with the two locking Hex nuts (g) in the fixing bracket (K). Place a washer (i) over the thread on the locking handle knobs (a), screw the handle knobs through the fence base clamping the fence assembly to the table top. (See fig 37).

Fig 37



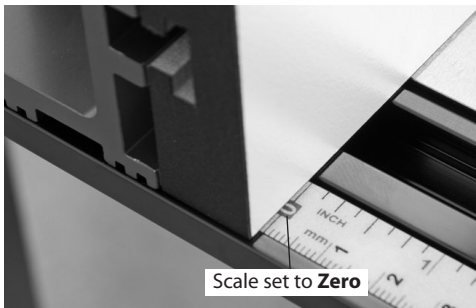
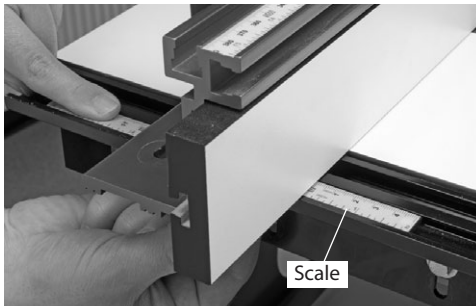
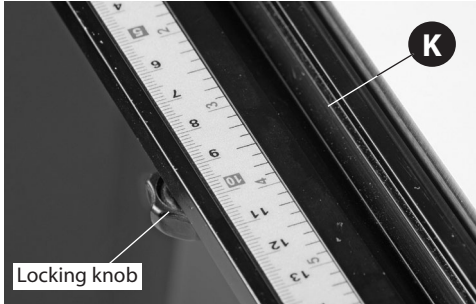
Step 8 Slide the fence assembly forward until the front face lines up with engraved index line embedded in the table, (see fig 38) clamp down

Fig 38



the fence assembly. Loosen the two locking knobs beneath the fixing brackets (K), slide the two scales until it reads **(ZERO)** to the front face of the fence assembly, lightly tighten the locking knobs. (See figs 39-40-41)

Fig 39-40-41



Step 9 Locate the extraction moulding (I), loosen the two locking knobs (b) either side of the extraction surround on the fence (H), slide the extraction moulding (I) over the 'T' bolts (d) and retighten the locking knobs (b). (See fig 42)



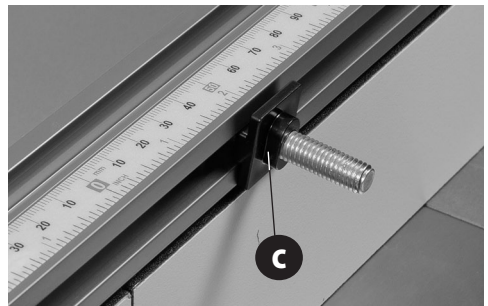
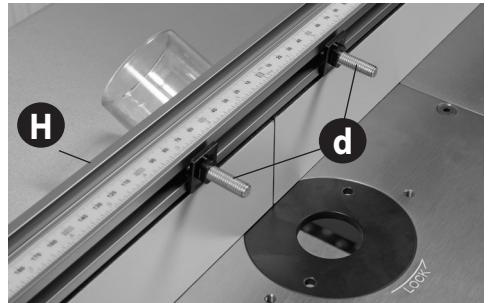
WARNING! DO NOT OVERTIGHTEN THE LOCKING KNOBS AS THE EXTRACTION MOULDING IS ONLY PLASTIC!

Fig 42



Step 10 Locate two 'T' bolts (d), fence spacers (c) and flat washers (i). Slide the 'T' bolts into the fence (H) 'T' slot and position the bolts roughly the width of the extraction moulding (I) and place a fence spacer (c) over the 'T' bolt thread. (See figs 43-44)

Fig 43-44



Step 11 Mount the dust shield (J) through the 'T' bolts (d), place a flat washer (i) over the bolts and secure using two locking knobs (b), see figs 45-46.

Fig 45

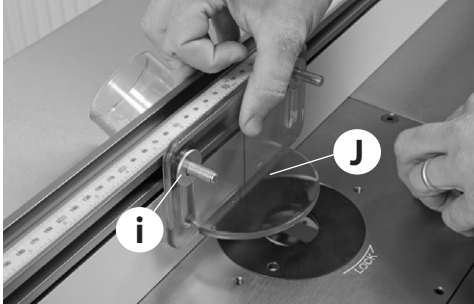


Fig 46



Mitre Fence Assembly

Step 1 Locate the mitre fence(10) and extension (11), Note: the bag of fixings will be tucked inside the extension assembly. Slide the two Hex bolts into the extension 'T' slot. Insert the Hex bolt down into the machined slots in the mitre fence and secure the assembly with the two wing nuts, **DO NOT OVERTIGHTEN!** (See fig 47)

Fig 47

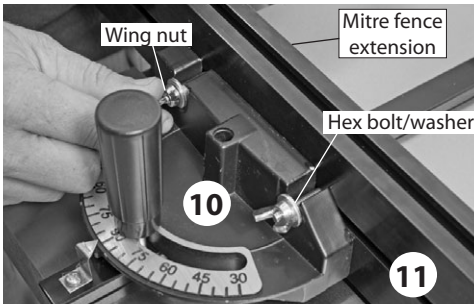
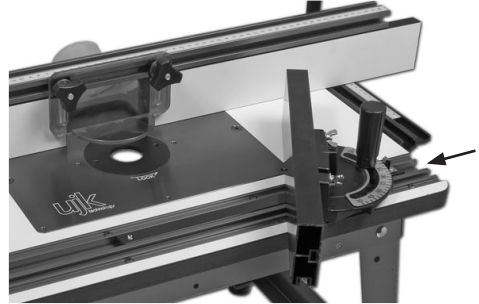


Fig 48

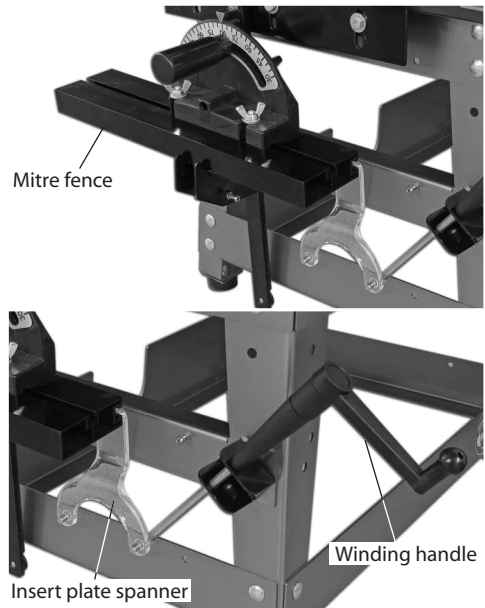


Step 2 Slide the mitre fence assembly into the tables 'T' slot, (see fig 48).

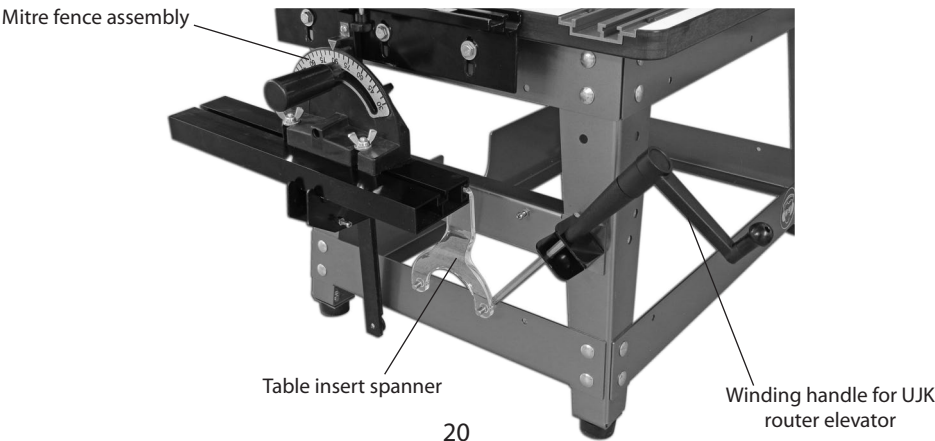
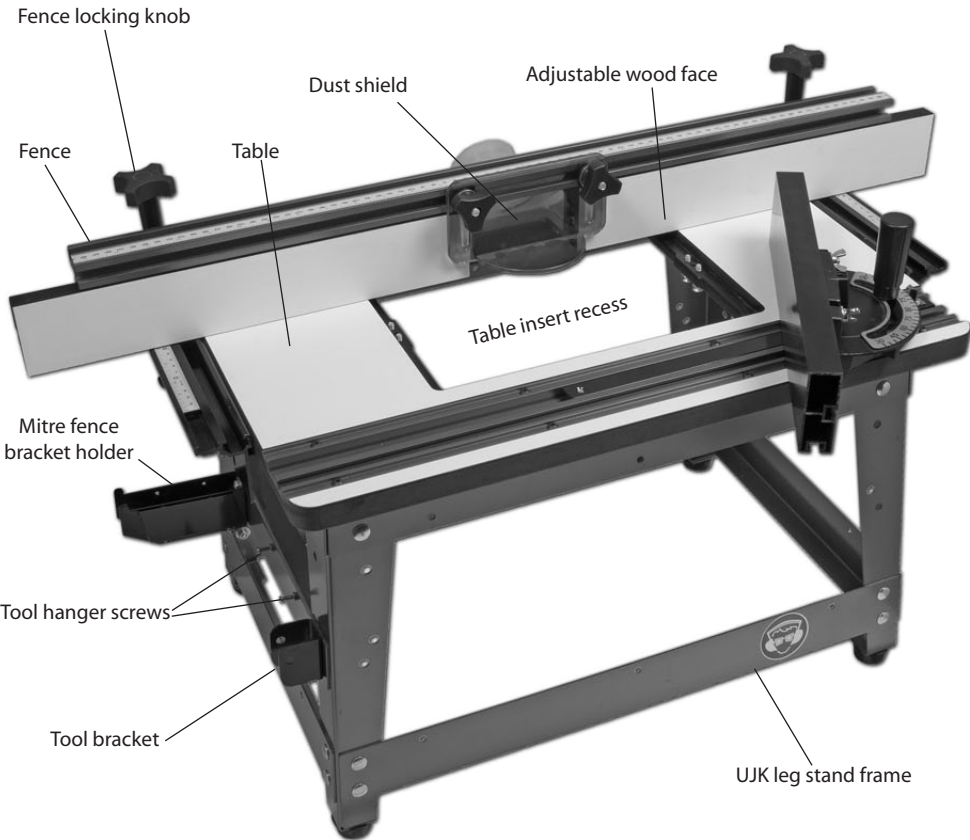
Tool Storage Holders

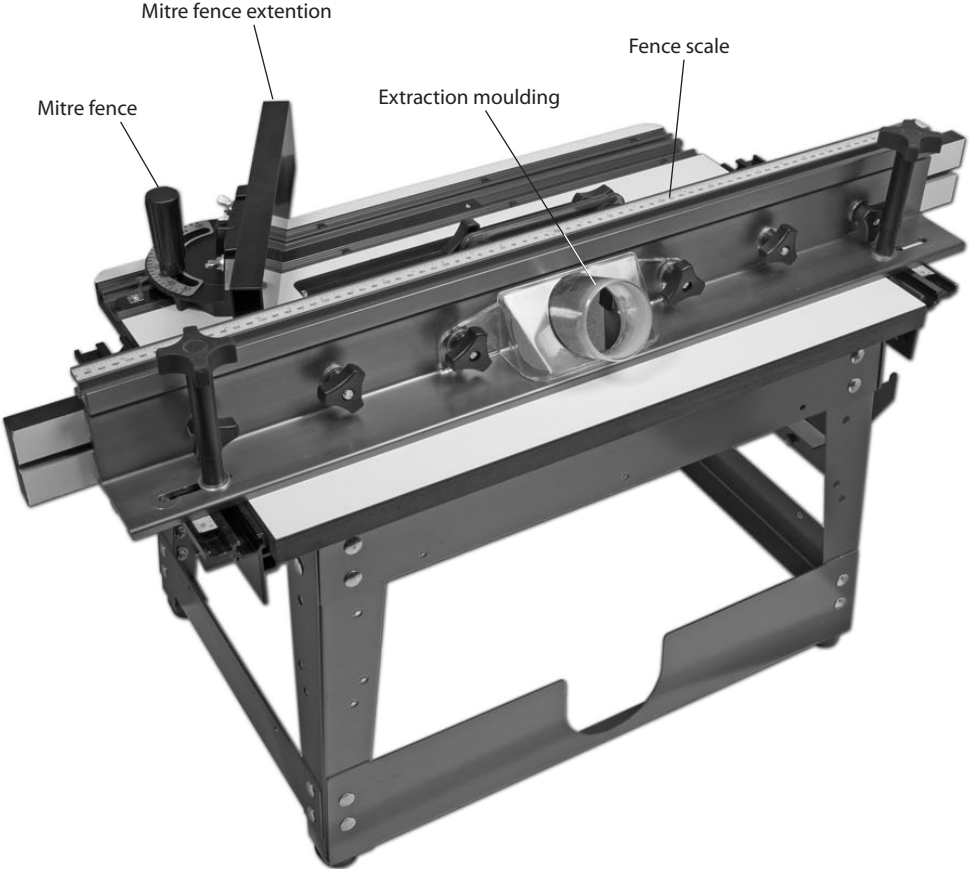
To store your tools when not in use, place the mitre fence assembly into the mitre fence bracket (1), hook the insert plate spanner over one of the two Phillips screw hangers and Insert the shaft of the winding handle from UJK router elevator, (502701) through the pre-drilled hole in the tool bracket (2). (see fig 49)

Fig 49



Overview Description





UJK technology router table with optional dust extraction box attached

Mounting the Router

10mm Universal Aluminium Insert with Universal Base Plate

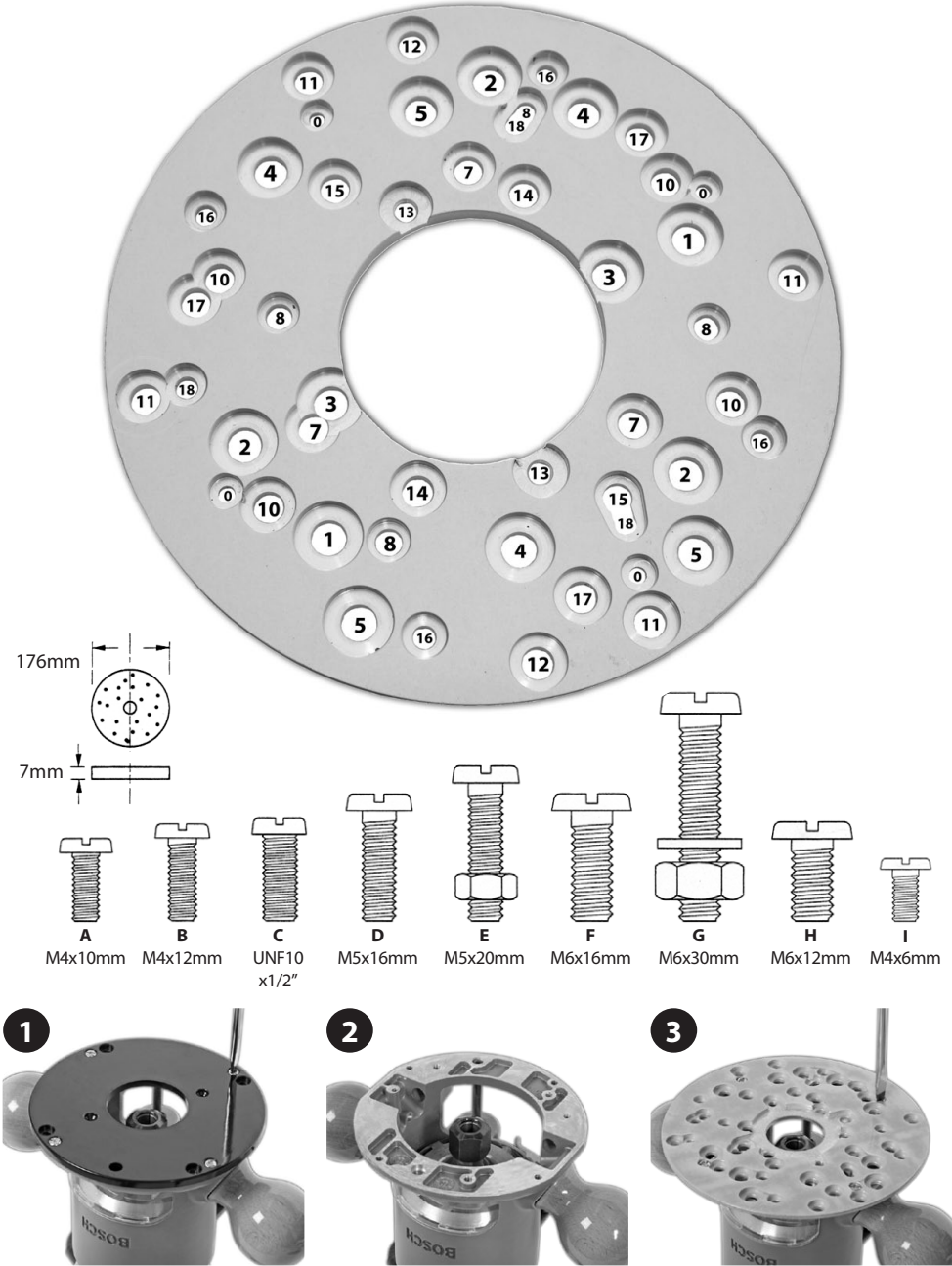
The information below is reproduced from the Axminster universal base plate fitting instructions. Hole numbers, screw types and how many required are given for mounting different router models to the

base plate. For advice on models suitable for fitting to the router elevator please call our technical sales team on **03332 406406**



Manufacturer	Router Model	Hole	Fixing Screw
ATLAS COPCO	OFSE2000	2	Fx3
BOSCH	GOF1600,1700ACE POF52	1	Fx2
	400,500A,600ACE	3	Fx2
	POF800ACE.GOF900A <2003	4	Gx3
	GOF1300ACE,900A>2003	5	Gx3
	GMF1400,GMF1600CE	0	lx4
CASALS	FT750,1000E,2000VCE	2	Fx3
CMT	CMT1E,CMT2E	1	Fx2
DEWALT	DW613,614,615,620,621	1	Fx2
	DW625EK.629	1	Fx2
DRAPER	R1900V	2	Fx3
	PT1200V	1	Fx3
ELU	OF97(E),MOF177(E),131,98,	1	Fx2
	MOF77,96(E) MK2,69'	1	Fx2
FELISATTI	R346EC	1	Ex2
FESTO	OF2000(E)	7	Ex3
	OF1E,900(E),1000(E)	8	Bx4
FREUD	FT1000(E),2000E	2	Fx3
HITACHI	M8(V)	10	Dx4
	M12V,M12SA	11	Dx4
	TR12	11&12	Dx4
MAFELL	L050E	8	Bx4
MAKITA	3620,3612BR,3600B	13	Dx2
	3612(C)	14	Ex2
	RP0910,1110C	1	Fx2
PERFORMANCE	CLM1250R<11/03	18	Ax3
PRO	CLM1250R >11/03,CLM2050R	1	Fx2
PERLES	OF808(E)>1999/2-808(E)	1	Hx2
	OF9(E)	1	Hx2
PEUGEOT	DEF570E,DF55E	15	Ex2
RYOBI	RE600N,R600N,RE601	13	Dx2
	ERT1500V	13	Dx2
	R500,502	16	Ax4
	R150,151,RE120,155K	15	Ex2
SKIL	1835U.1875U1	17	Cx3
TREND	T3,T4,T5,T5MK2,T9,T10,T11	1	Hx2
WADKIN	R500	16	Ax4

Universal Base Plate



Operating Instructions

Using the optional NVR Switch

The NVR switch main function is the remote switching of power tools such as routers when mounted in a table (Max wattage 2000W).

The plug-in NVR switch offers a very convenient solution; fit the switch in a convenient position on the table, plug the tool into the switch and then plug the lead on the switch into the mains supply and away you go. You will need to devise a way of holding the machine switch in the on position so that it is over-ridden by the NVR; such as cable ties or plastic tape.

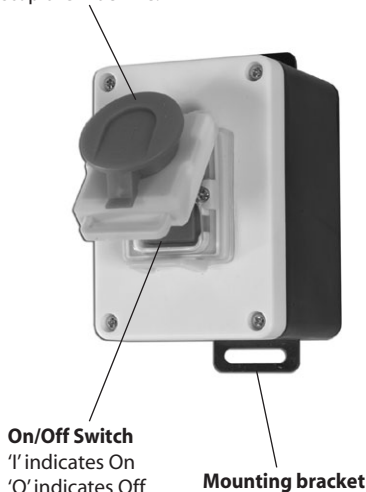


BEFORE TURNING ON THE SWITCH ON YOUR ROUTER MAKE SURE THE SWITCH ON THE SWITCH BOX IS IN THE OFF POSITION AND THAT THE SWITCH BOX IS NOT YET CONNECTED TO A POWER SOCKET.

There are two mounting brackets either side of the switch with slots to secure the assembly to the router table. Decide where you are going to mount the switch then drill two holes in the table or use the pre-drilled holes in the stand, using self tapping screws or two bolts, washers and nuts. Secure the switch to the stand (See fig A).

Fig A

Emergency stop button In an emergency “Slap” down cover to stop the machine.



Connecting a Dust Extractor



BEFORE ROUTING CONNECT THE MACHINE TO A DUST EXTRACTION SYSTEM. ALWAYS TURN ON THE DUST EXTRACTOR BEFORE STARTING THE ROUTER AND ALWAYS STOP THE ROUTER BEFORE TURNING OFF THE DUST EXTRACTOR.

There is a 62mm dust outlet on the rear of the fence assembly allowing for the connection of a dust extractor (**not included**).

Be sure to use an appropriate size hose and fittings and check that all connections are sealed tightly to minimize airborne dust.

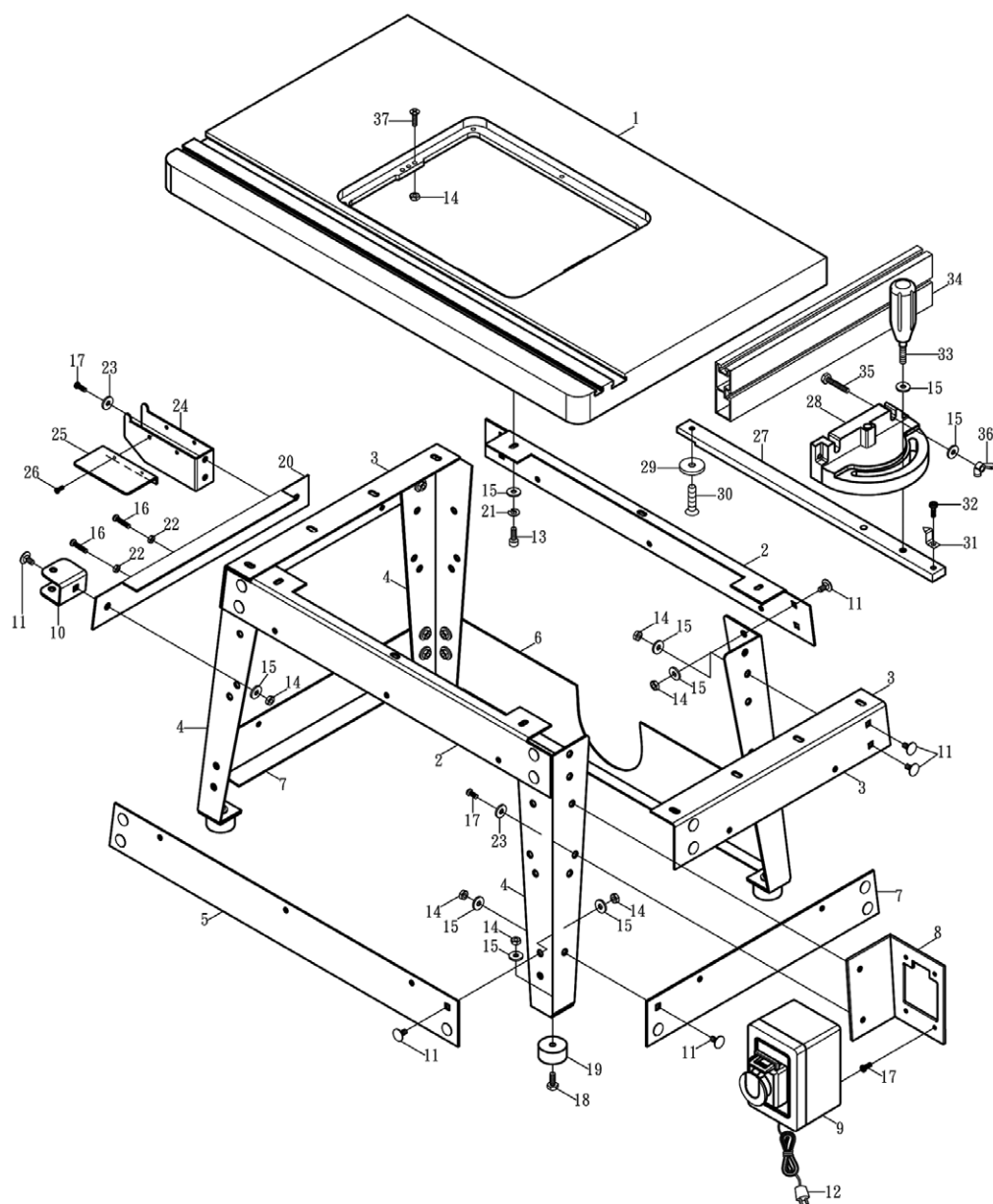
If you do not already own a dust extraction system, consider contacting Axminster Tool Centre on **03332 406406** for information on our complete line of dust extraction systems or visit our website at **axminster.co.uk**.



MAKE SURE TO READ, AND FOLLOW ALL OPERATING INSTRUCTIONS AND SAFETY GUIDELINES THAT CAME WITH YOUR ROUTER FAILURE TO DO SO MAY LEAD TO SERIOUS INJURY AND/OR DAMAGE TO THE ROUTER, TABLE, OR WORK PIECE.

- Install the required bit in your router according to the instructions supplied with your router.
- Make sure that the router is firmly attached to the table insert and that the plate is properly fitted and level in the table opening.
- The router table should be installed on a flat, sturdy, and stable surface.
- When jointing, groove cutting, and/or profile cutting always perform a test cut on a scrap piece of wood before cutting your final piece.

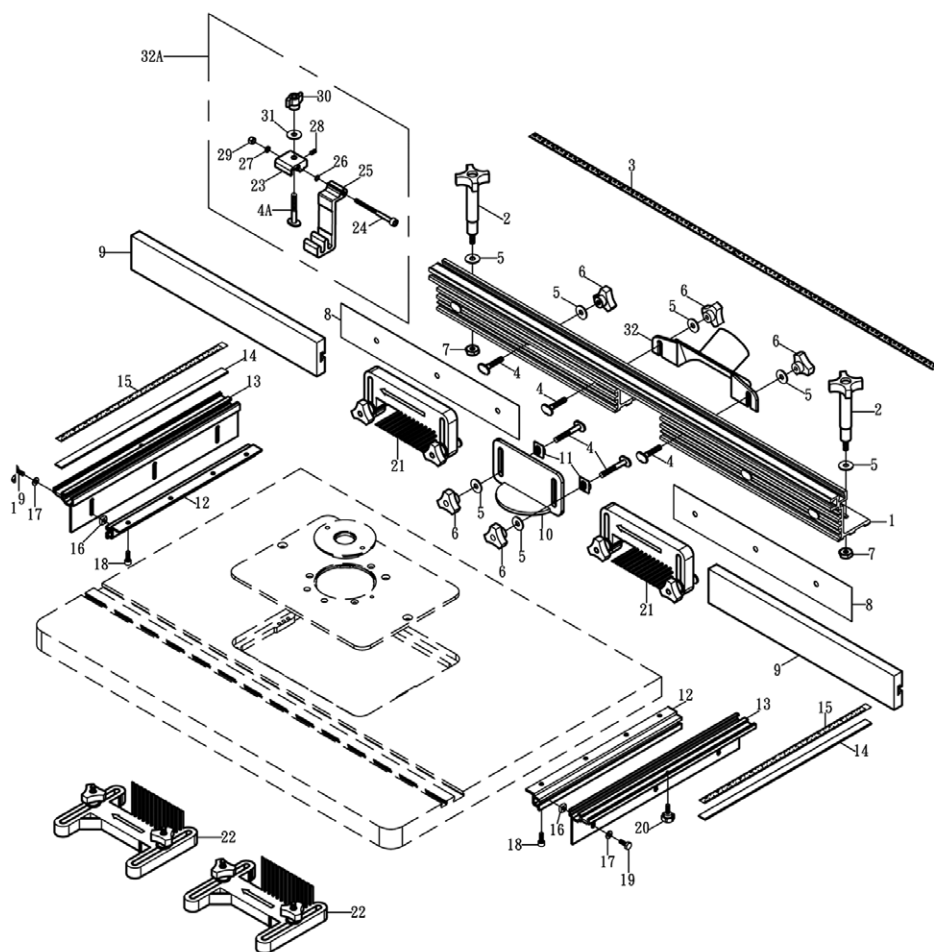
Router Table & Stand Assembly(E Type)



Router Table & Stand Assembly (E Type)

Index No	Part No	Description	Size	Qty
1	2716E014	Router Table	(686mm×407mm)	1
2	27160015	Stand Cross Relief		2
3	27160016	Stand Side Support		2
4	27160017	Stand Leg		4
5	27160018	Stand Tie Bar (Front)		1
6	27160018A	Stand Tie Bar (Rear)		1
7	27160019	Stand Tie Bar (L&R)		2
8	27160022	Switch Base (OPTIONAL)		1
9	53224002	Switch Box (OPTIONAL)		1
10	27160020	Handle Bracket		1
11	909M06012	Carriage Bolt	M6×12	34
12	L3224001	Power Cord (OPTIONAL)	1.5 mm ² ×3C	1
14	910M06000	Hex Nut	M6	48
15	914M061602	Flat Washer	M6	41
16	906M04020	Round Head Screw	M4×20	2
17	906M05008	Round Head Screw	M5×08	8
18	904M06020	Hex Cap Bolt	M6×20	4
19	30100016	Rubber Foot		4
20	27160021	Tool Storage		1
22	910M05000	Hex Nut	M4	2
23	914M051201	Flat Washer	M5	4
24	10400109	Fence Hook		1
25	32240056	Hook Extension Plate		1
26	906M04005	Round Head Screw	M4×5	2
27	22100118	Guide Bar		1
28	22100119	Miter Gauge Body		1
29	10100206	Guide Washer		1
30	905M06008	Flat Head Screw	M6×8	1
31	22100120	Pointer		1
32	906316014	Round Head Screw	3/16"×1/4"	1
33	938014025	Lock Knob	1/4"×25	1
34	32240057	Miter Fence		1
35	904M06030	Hex Cap Bolt	M6×30	2
36	913M06000	Butterfly Nut	M6	2
37	905M06020	Flat Head Screw	M6×20	10

Router Table Fence Assembly



Router Table Fence Assembly

Index No	Part No	Description	Size	Qty
1	32240032	Router Table Fence	905mm	1
	27160032	Router Table Fence	778mm	1
2	60100001A	Lock Handle	5/16"	2
3	T3224002	Scale	905mm	1
	T2716002	Scale	778mm	1

Parts Drawing/List

Index No	Part No	Description	Size	Qty
4	32240033	T-Bolt		8
5	9145162302	Flat Washer	M8	10
6	939M08000B	Lock Knob	M8	8
7	32240034	Lock Nut	M8	2
8	32240035	Shim For Sub Fence (Optional)	401mm	2
	32240035	Shim For Sub Fence (Optional)	338mm	2
9	32240036	Router Table Fence Faces	451mm	2
	27160036	Router Table Fence Faces	388mm	2
10	32240037	Safety Guard		1
11	32240038	Fence Spacer		2
12	32240039	Side Bracket Base	320mm	2
	27160039	Side Bracket Base	240mm	2
13	32240040	Side Bracket	375mm	2
	27160040	Side Bracket	280mm	2
14	32240041	Rule Plate	300mm	2
	27160041	Rule Plate	205mm	2
15	T3224003	Scale	300mm	2
	T2716003	Scale	205mm	2
16	935014000	Square Nut	1/4"	6
17	9140141602	Flat Washer	M6	6
18	901M06012	Hex Socket Cap Screw 3224	M6×12	8
	901M06012	Hex Socket Cap Screw 2716	M6×12	6
19	904014058	Hex Bolt	1/4"×5/8"	6
20	940M06012	Lock Knob	M6×12	2
21	32240042	Fence Feather board	(Optional)	2
22	32240043	Table Feather board	(Optional)	2
23	32240044	Clamping Bracket	(Optional)	1
24	32240045	Hex Socket Cap Screw (Optional)	M6×75	1
25	32240046	Clamping	(Optional)	1
26	32240047	Flat Washer	(Optional)	1
27	32240048	Flat Washer	(Optional)	1
28	908M06016	Set Screw	(Optional) M6×16	1
29	912M06000	Nylon Nut	(Optional) M6	1
30	939M08000C	Lock Knob	(Optional) M8	1
31	9145161802	Flat Washer	(Optional) M8	1
32	32240013	Dust Port		1
32A	32240043A	Flip Stop Assembly	(Optional)	1



Please dispose of packaging for the product in a responsible manner. It is suitable for recycling. Help to protect the environment, take the packaging to the local recycling centre and place into the appropriate recycling bin.

Only for EU countries



Do not dispose of electric tools together with household waste material. In observance of European Directive 2002/96/EC on waste electrical and electronic equipment and its implementation in accordance with national law, electric tools that have reached the end of their life must be collected separately and returned to an environmentally compatible recycling facility.