

Using the Documentation

Copyright.....	2	Text appearance.....	10
Documentation structure.....	3	Title page.....	11
Datapool, documentation object.....	3	Abbreviations.....	12
Documentation concept.....	3	Printer names.....	15
Documentation format.....	6	Display messages.....	15
Printing the documentation.....	7	Parameters.....	16
Navigation aids.....	8	Index.....	17
Symbols and note signs.....	9		
Safety notes.....	9		
Symbols.....	9		



- The documentation is an essential part of the device it belongs to.
Operating and service personnel must have access to the documentation and all other device documents supplied by the manufacturer at all times.
- Read topic section "Safety Notes".
This contains general safety instructions and other general, but important information. How to use the device properly, possible operating dangers and general operating instructions are also described.
In addition, this is where you can find information regarding the use and application areas of each individual manual.

Copyright

© 1997-2003 by Avery Dennison Deutschland GmbH. All rights reserved.

Reprinting and reproduction of these documents, including extracts, is only allowed with the express permission of the manufacturer. More detailed information is available from your supplier.

Copyright

The documentation is subject to copyright. The copyright claims include all forms and types of material and information which may be protected by current copyright laws. No part of the documentation may be copied, reproduced in any other manner, processed or translated into another language, irrespective of the manner and fashion or with which means this takes place.

Copy

Electronically stored device information (CD ROM, Internet) supplied by the manufacturer may be printed out by the user, provided that the print medium serves the use or servicing of the described product.

Protected rights

Names are generally given without any mention of existing patents, registered designs or trademarks. The absence of a corresponding remark does not give any implication that the name can be used at will. All trademarks are recognised.

Alterations

No liability is assumed for the accuracy of the contents of this documentation. The manufacturer reserves the right to alter technical or other specifications with no prior notice. Deviations in the documentation from prevailing conditions do not represent an obligation to redeliver.

Guarantee

The manufacturer does not guarantee the existence or non-existence of properties with the description of subject contents. Nor does the manufacturer give any express or tacit guarantee declarations whatsoever.

Documentation structure

Datapool, documentation object

The overall documentation is a part of the datapool, which is provided for the printer user and the service personnel on CD or other electronic media.

Datapool

This datapool includes:

- this printer documentation,
- the printer drivers and
- the software Adobe Acrobat Reader for reading and printing the documentation elements.

Printer doc

Here the overall documentation (abbr.: documentation) is to be understood as the printer documentation.

The printer documentation contains all the information which is required for using the product. Using the product means preparing it for use, putting it into operation, setting it up, the operation, servicing and maintenance, fault searching and the service for optional extensions, settings and repairs.

Doc object

The documentation object includes

- various printer families (printer series), consisting of different printer models (devices),
- standard and optional additions for the printer (options) and
- the printer language Easy Plug.

Documentation concept

The wide range of products which must be documented and the demand for documentation distribution and use, both in electronic form (CD/Internet, PC) as well as in paper form, have resulted in the following documentation concept:

Structure

The documentation consists of

- topic sections (generally comparable to chapters),
- manuals (handbooks, instructions),
- link pages and the
- start page (start page of the CD documentation).



Subject section

Thematically-related subject contents are described in each topic section. A topic section is the smallest unit of information with its own

- page numbering,
- header bar,
- list of contents,
- index,
- device classification and
- its own revision status.

Subject sections form the basis of the manual. A topic section can be simultaneously assigned to several manuals. Subject sections are in one, in some cases two, languages.

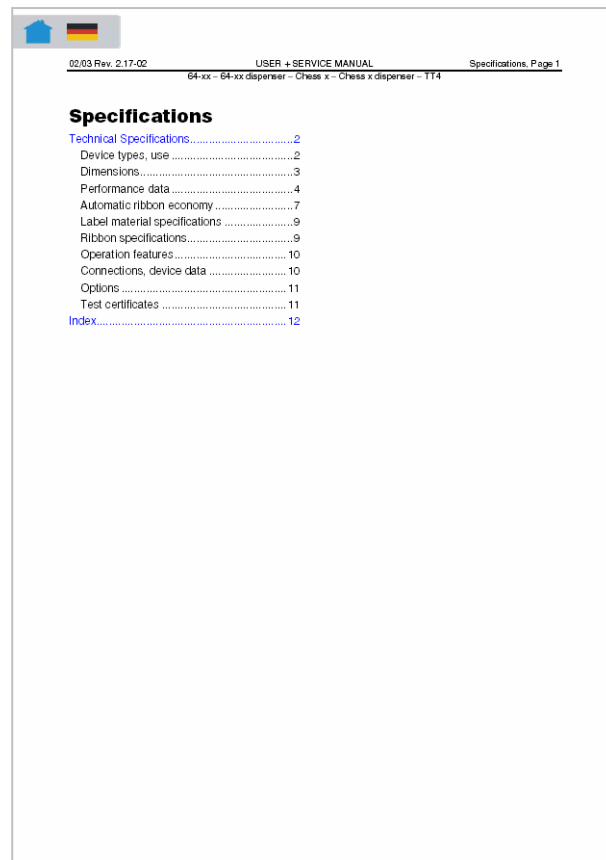

Specifications	
Technical Specifications.....	2
Device types, use	2
Dimensions.....	3
Performance data	4
Automatic ribbon economy	7
Label material specifications	9
Ribbon specifications.....	9
Operation features.....	10
Connections, device data	10
Options	11
Test certificates	11
Index.....	12

Fig. 1 Example: First page of topic section "Specifications"

Manual

A manual is composed of different topic sections. The following features characterize a manual:

- Title page with a list of contents, device classification and revision status (see Fig. 2).
- The list of contents contains the designations of the topic sections and also serves as a link distributor to these topic sections.
- The contents of a manual refer to a certain device, a device family or an option (documentation object).
- A manual is assigned to a certain language and only contains topic sections in this language.

- A manual is assigned to a certain user group. There are *Service Manuals* (mainly for the Service), *User Manuals* (mainly for the user) and just *Manuals* (for Service and user).

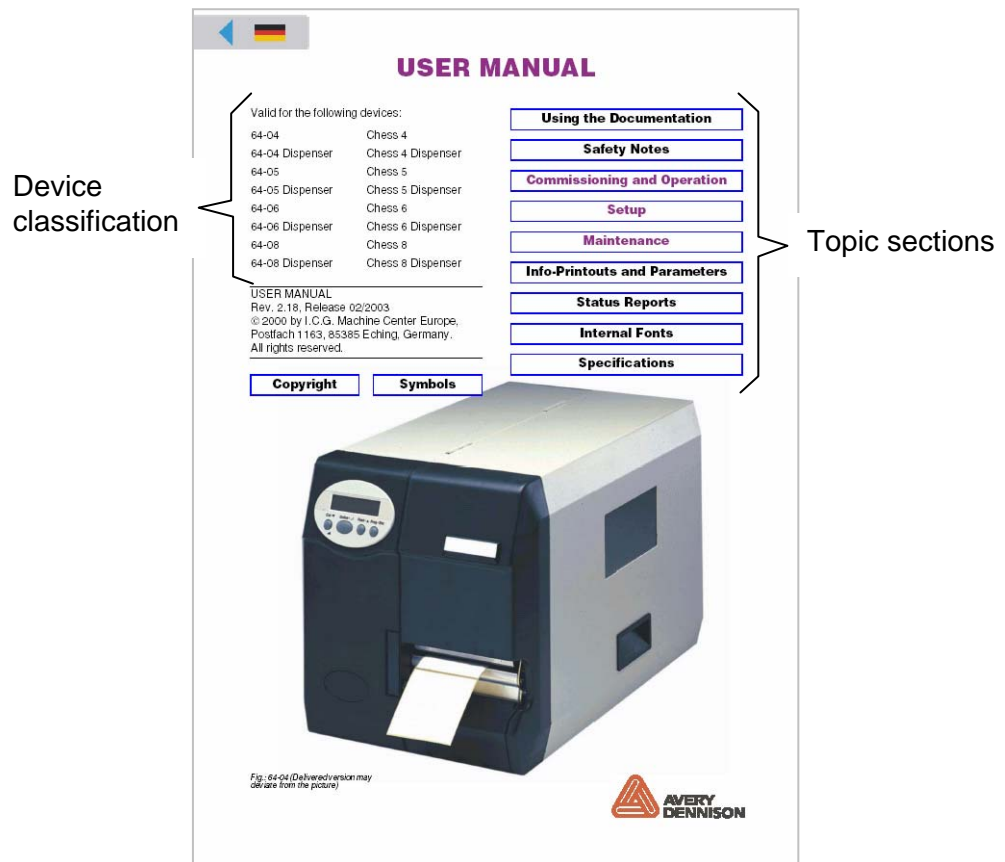

Fig. 2 Each Manual title page provides a list of topic section in its right half.

To a certain extent manuals are only virtual, as the same topic section can be simultaneously assigned to different manuals (the topic section physically only exists once).

Subject sections which are only assigned to a single manual are colour-coded on the title page of the manual (in the same colour as the title of the manual, see "Symbols and note signs").

Link page

A link page is only an organisational component of the datapool available on electronic media. The following features characterize a link page:

- Assignment to a single language
- Function as a link distributor to the individual manuals (access to the overall documentation of the corresponding language)
- Function as a link distributor to other components of the datapool provided on the electronic medium (e. g. printer drivers and print and design software in the corresponding language)

Start page

The start page is also only an organisational component and is displayed when the CD starts, or on the Internet on the link to the printer datapool. The following features characterize a start page:

- Assignment is irrespective of the language or multilingual
- Function for the language selection made by the user
- Function as a link distributor to the link page with the selected language.

This gives the following documentation hierarchy:

Hierarchy

1. Start page (selection of the language)
2. Link page (selection of the manual)
3. Manual title page (selection of the topic section)
4. Subject section contents page (selection of the subtheme)

In most cases, the subtheme selected in step 4 equates to the information being searched for. For instance, the selection of the status number in the list of contents of the topic section leads straight to the description of this status number.

Documentation format

All elements of the printer overall documentation are in Adobe PDF (Portable Document Format). This has the following practical advantages:

Printing

- The documents can be printed in the required quality irrespective of the printer type and the fonts which are used.

Memory

- Less memory is required for saving the document due to differentiated data compression (faster loading, faster printing).

Internet

- Internet compatibility due to the relatively small amount of data.

License

- Simple distribution without the need to purchase licenses (Acrobat Reader licenses are provided free of charge by Adobe worldwide and in many languages).

Platform

- Can run on different platforms (Win/Mac)

Links

- Links within and between Acrobat documents, as well as links to documents in other formats and executable files.
- Other Acrobat Reader functions such as page returns, bookmarks, thumbnails, document-overlapping search function with an automated index, etc.
- More detailed information about the Acrobat Reader is contained in the Acrobat online help.

Printing the documentation

In order to make the documentation readable without a PC, the documents can be printed in A4 as well as in Letter format. For printing, the Acrobat Reader uses the print capabilities of the platform it is run on. The layout of the printed documents equals the appearance on the monitor screen.

Mind the following hints before you start to print:

When printing several manuals, it is not necessary to print out all topic sections starting with the title page.

- Only print out the topic sections marked in black once. These topic sections are referenced from different Manuals. Physically, they consist of the same data.
- Always print out all subjects marked in purple. Reference is only made once in the respective manual to each purple topic section.

When printing all of only one manual, it is necessary to print out all topic sections in this manual starting from the title page.

Example

- In order to print a *user manual*, proceed as follows:
 1. Print the title page.
 2. Click the topic sections on the right half of the title page one after the other. Print each topic section completely.
- In order to print the *service manual* additionally, switch to the title page of the service manual and only click the topic sections written in purple. Print those topic sections. The remaining black topic sections are already printed with the user manual.

Text integration

It is also possible to integrate documentation text (and images) in other documents using the Windows clipboard. As a result, e. g. order information (spare part designations and part numbers) can be used simply and with no additional effort.

- ▣▶ Pay attention to copyright restrictions. Information on this subject can be found under "Copyright".

Navigation aids





Info search

The following options are available for quickly searching for information in the paper documentation:

- The title page of each manual with a list of contents of the topic section
- The detailed list of contents with page numbers on the first page of each topic section
- The own page numbering of each topic section
- The index at the end of each topic section.

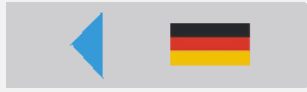
Links

In the top left corner of each title page and on the first page of each topic section, you find small graphics, which ease the change back to higher levels of the documentation (see Tab. 1).

Symbol	Meaning
	<i>Triangle</i> : Link to the next higher page. <i>Flag</i> : Link to the german page of identical content. On the corresponding german page, a british flag symbolizes the cross-reference to the british page.
	<i>House</i> : Link to the link page. <i>Flag</i> : Link to the german page of identical content. On the corresponding german page, a british flag symbolizes the cross-reference to the british page.
	<i>Arrow</i> : Link to the next higher level.
	<i>House</i> : Link to the link page of the same language. Is used instead of an arrow, if a link back to the next higher page is impossible; e.g., if the topic section in question is referenced to from several pages.
	<i>Houses with flags</i> : Links to the link pages in different languages. Is used in bilingual topic sections (e.g. spare parts lists).

Tab. 1 Navigation aids can be found on the first pages of the PDF-documents.

Symbols and note signs



Safety notes

Safety notes are marked by a warning sign (exclamation mark in a triangle) at the left text margin and by a gray frame which encloses the warning sign and the warning text. Safety notes warn of a possibly dangerous situation. Injury is possible, if care is not taken.

	<p>CAUTION!</p> <p>What is dangerous? What injuries could occur?</p> <ul style="list-style-type: none"> - Take care by... - ...
--	--

Symbols

	<p>Warning sign and arrow: This symbol combination is used to draw the attention to some important warning notes. If those warnings are ignored, material damage or data loss is possible.</p>
	<p>Stop: Imperative! Read and pay attention!</p>
	<p>Note arrow: special note. Pay attention!</p>
	<p>Tools required for the described service action.</p>
	<p>Marks additional information, which has not necessarily to be read to operate the machine, but which improves the understanding for the described function.</p>
	<p>Lefthand version (LH version): Symbol marking a text section which refers to the LH version of a device. (Only important for DPM and ALX 92x)</p>
	<p>Righthand version (RH version): Symbol marking a text section which refers to the RH version of a device. (Only important for DPM and ALX 92x)</p>

	CE label: Documents the CE conformity of the device.
	Recycling: Notes about disposal. Pay attention to environmental protection!
Arrow at the right bottom corner: paragraph is continued on the following page.	
	

Text appearance

<ol style="list-style-type: none"> 1. (Numbered) Action instructions, introductory text: 2. follow the sequence! 	
→ Focus arrow: action instructions, sequence not stipulated.	
● Focus point: feature, extra paragraph.	
○ Focus circle: Reference to another text position or info source.	
✓ Exists. Completed. Yes. Applies.	
<i>Italic text</i>	Introductory text in safety instructions. Heed without fail in order to avoid possible injury and/or damage! In Spare Parts Lists: Comment, doesn't belong to the part designation.
<u>Blue underlined text</u>	Link to other positions in the documentation (click). Exception: In lists of contents, the black text is also linked.

Title page

Link	Black text in the blue frame: link to topic sections which occur several times in different manuals (click).
Link	Purple text in the blue frame: link to a topic section which only occurs once and belongs specifically to the manual (click).
Link	Blue text in the blue frame: A click on the text starts an executable program, e.g. the printer driver unpacking program starting from the "Manual printer driver" title page.

Abbreviations

AC	Alternating Current
Accu	Accumulator
AI	Applicator Interface
APSF	Automatic Product Speed Follower:
ASIC	Application Specific Integrated Circuit
CCITT	Comité Consultatif International Télégraphique et Téléphonique (international standardisation committee in the telecommunications field)
CD	Compact Disk
CE	CE conformity label (CE: Communauté Européenne)
CE	Communautés Européennes: European Community
CF card	Compactflash card
CN...	Plug connector (on circuit boards)
cos phi	Power factor (rated output in VA x cos phi = true power in W)
CPU	Central processing unit
CRC	Cyclic redundancy check
CRLF	Carriage return line feed:
CUT	CUT button
DB	Data designator
db(A)	Decibel (assessed noise level at 7 m)
DC	Direct Current
DCE	Data communication equipment
dd:mm:yyyy	day-month-year
DEE	Data terminal equipment DTE
DFÜ	Remote data transmission
DIN	Deutsches Institut für Normung e. V.: German Standards Institution
Doc	Documentation
Dot/mm	Dots per millimetre (printer definition)
DPM	Dispensing Printing Module
DTE	Data terminal equipment
DÜE	Data communication equipment DCE
EEPROM	Electrically Erasable Programmable Read-Only Memory:
EIA	Electronic Industry Association: national standards institution in the USA
EMC	Electromagnetic compatibility
EN	European standard
ENTER	ENTER button (acceptance, confirmation)
EPROM	Electrically Programmable Read-Only Memory:
ERR	Error: fault, malfunction
EU	European Union
EVU	Power supply company
EWG	European Economic Community EEC
EXC Mode	Extended alphanumeric compaction mode
FEED	FEED button
FIFO	First In First Out (batch memory principle)
H	Hexadecimal (also hex)
hHour	
hh:mm:ss	Hours-minutes-seconds
HxWxD	Height x Width x Depth (dimensions)

All devices

Hz	Hertz (frequency of alternating current)
I/O	Input/Output
IC	Integrated Circuit
ID	Identification number
IEC	International Electrotechnical Commission
Info	Information
IP...	Internal Protection (protection rating: contact, foreign body and water protection in line with DIN VDE 40050)
IR	Infrared
ISO	International Standards Organization
LCD	Liquid Crystal Display
LED	Light Emitting Diode
LS	Photoelectric switch
LSB	Least significant bit
LW	Drive
LWA	Noise level in line with CEE Standard 535/536 (L: sound output level, W: power, A: assessed factor corresponding to the human hearing ability)
LxWxH	Length x Width x Height (dimensions)
MB	Megabyte (memory capacity, 1 MB = 1024 Bytes)
mm:ss	Minutes-seconds
MS	Microsoft Corporation
MSB	Most significant bit
NC	Normally closed (opener)
NMI	Non-maskable interrupt
NO	Normally open (closer)
OD sensor	Outer diameter sensor: a sensor which checks the diameter of the material roll (ALX 924) and indicates the near material end.
OEM	Original equipment manufacturer
OLV	Online verifier: a scanner which verifies the barcode immediately after printing.
ON/OFFLINE	ON/OFF button (switching between on-line/off-line)
OSI	Open Systems Interconnection (7 layer model)
PC	Personal computer
Pot.	Potentiometer
PROM	Programmable Read-Only Memory
RAM	Random-Access Memory
REV	Real effective value
Rev.	Revision (Ex.: Rev. 2.01-02 = CD/Internet Version 2.01, work status -02)
RFID	Radio Frequency Identification Device
RMS	Root mean square (actual value measurement)
ROM	Read-Only Memory
RS232	Recommended Standard Number 232: serial interface in line with US Standard EIA RS-232
RS232C	Recommended Standard Number 232, Revision C: serial interface in line with US Standard EIA RS-232-C
RS485	Recommended Standard Number 485: interface definition in line with US Standard EIA RS-485
RUN	Program run
SCI	Serial communication interface
SELV	Safety extra-low voltage: (in line with EN 60730)
SP	Spare part
SPI	Serial periphery interface
SPS	Programmable Logic Controller (PLC)
tt:mm:jjjj	Day-month-year

TP	Test point (e. g. measuring point on boards)
Transponder	Tag with RFID antenna
U/min	Revolutions per minute (rotation speed)
USI	Universal Signal Interface
V.24	CCITT recommendation V.24 (definition of serial interface circuits)
V.28	CCITT recommendation V.28 (serial interface, electrical properties)
VA	Volt-ampere (apparent power)
VBG	Book of regulations issued by the German trade associations
VDE	Verband Deutscher Elektrotechniker e. V. (Association of German Electrical Technicians)
WP	Wearing parts
X	X direction, X axis (printer: at right angles to feed direction)
Y	Y direction, Y axis (printer: lengthwise to feed direction)
Assy.	Assembly (assembled parts, module)

Printer names

If there is not enough space to call all printers by their full names, the abbreviated spellings listed in Tab. 2 are used.

Spelling	Meaning	Example, note
1050/XXL/105	TTX 1050, Tiger XXL, S 105	
350/Ocelot	TTX 350, Ocelot	
450/Puma/45	TTX 450, Puma, S 45	
64-04/05	64-04, 64-05	
64bit series	64-xx, DPM, ALX 92x, Novexx PA-1x6	
64-xx	all Avery 64bit types	64-04, 64-05
650/Lion/65	TTX 650, Lion, S 65	
950/Tiger/95	TTX 950, Tiger, S 95	
ALX 92x	ALX 924, ALX 925, ALX 926	
Chess x	all Novexx 64bit types	Chess 4, Chess 5
Chess 4/5	Chess 4, Chess 5	
Novexx PA-1x6	Novexx PA-146, Novexx PA-156, Novexx PA-166	
Ocelot/Puma/Lion/Tiger/XXL	Ocelot, Puma, Lion, Tiger, Tiger XXL	
S 45/65/95/105	S 45, S 65, S 95, S 105	
TDI	all TDI types	TDI/STDI/XXTREME
TDI/STDI/XXTREME	TDI, STDI, XXTREME	
TTX 350/450/650/950/1050	TTX 350, TTX 450, TTX 650, TTX 950, TTX 1050	
TTX 67x	TTX 674, TTX 675	
TTX x50	All Avery TTX x50 types <i>without</i> TTX 350	TTX 350/450/650/950/1050 S 45/65/95/105 Ocelot/Puma/Lion/Tiger/XXL
Wildcats	All Novexx Wildcats types <i>without</i> Ocelot	Ocelot, Puma, Lion, Tiger, Tiger XXL
Wildcats plus	Puma plus, Lion plus	

Tab. 2 Abbreviated spelling of printers.

Display messages

Display, 4-figure	Meaning	Example
CDxx	xx = 2-figure value	CD parameter where

		xx = cut distance (e. g. CD15)
--	--	--------------------------------

Tab. 3 Spelling of TTX x50 type display messages in the documentation.

Parameters

Menu item (4-figure display)	Meaning
IFAC/PORT	Parameter PORT (interface type) in the menu IFAC (interface parameter)

Tab. 4 Spelling of TTX x50 type parameters in the documentation

Menu item (32figure display)	Meaning
<i>INTERF. PARAM./ Interface</i>	Parameter "Interface" in the menu "INTERF. PARAM."
<i>INTERF. PARAM.> Interface</i>	

Tab. 5 Spelling of 64bit type parameters in the documentation

Index

A

- Abbreviations 11
- Alterations, technical 2

C

- Copy 2
- Copyright..... 2

D

- Datapool 3
- Documentation
 - concept 3
 - format 6
 - object 3
 - structure 3

H

- Hierarchy 6

I

- Info-Suche 8

L

- Link page..... 5

M

- Menüpunkt
 - Darstellung 32stelliges Display 15

N

- Note signs 9

P

- Paper documentation..... 7
- Patents..... 2

R

- Redelivery, documentation 2
- Registered designs 2
- Reservation..... 2

S

- Start page 6
- Subject section 4
- Symbols 9

T

- Trademarks..... 2