

2013 Catalog Addendum - New

Lewmar SX Windlass Foot Switch

COMPOSITE BLACK PLASTIC BODY AND LID

- IP67/5 rated for water resistance
- Twin sealed switch compartment
- Lower-profile design with updated styling
- Open top lid
- Power: Voltage 9VDC-32VDC only
- Max Draw: 5 Amps
- Designed for use with Lewmar 12V and 24V dc product control systems
- H = 9/16", D = 2-3/8", C = 1-1/8", Cutout = 1-1/8"

Item **002048** Model **68001027**



Ship 1 lbs **Net \$78.99**

Lewmar SX Windlass Foot Switch

COMPOSITE PLASTIC BODY AND STAINLESS STEEL LID

- IP67/5 Rated for water resistance
- Twin sealed switch compartment
- Lower-profile design with updated styling
- Power: Voltage 9 Volt DC-32 Volt DC only
- Max Draw: 5 Amps
- Designed for use with Lewmar 12V and 24V dc product control systems
- H = 9/16", D = 2-3/8", C = 1-1/8", Cutout = 1-1/8"

Item **002050** Model **68001026** Open Lid
Model **68001030** Closed Lid



Ship 1 lbs **Net \$119.99**
1 lbs **119.99**

Lewmar Rope / Chain Replacement Gypsy

- Gypsy Designed for 1/2" Line and 1/4" BBB or G4 Chain
- Material: Plastic
- Designed for Simpson Lawrence Sprint 400/500/600 and Horizon 500

Item **002049** Model **605298RC6**



Ship 2 lbs **Net \$149.99**

Cruising Guide to the Virgin Islands - 16th Edition

AUTHOR: NANCY SCOTT, SIMON SCOTT, ASHLEY SCOTT

- Revised and updated for 2012-2013
- Detailed sketch charts based on the author's own surveys, and aerial photos of most anchorages
- Includes clear and concise navigational information
- By far the most popular guide to the area, it covers the islands from Martinique to Grenada, with dazzling scenic photography, unsurpassed onshore information, sections on exploring, provisioning, water sports, services, restaurants and photography
- Information is linked to the author's web site where you can download town maps, GPS waypoints from the sketch charts, and obtain links to local weather, news and more.
- Format: Spiral-bound
- Pages: 420 pages

Item **050281** Model **CGP041**

Ship 2 lbs **Net \$30.99**



Maptech Waterproof Chartbook

The Maptech WPB San Francisco Bay and the Delta Chartbook covers the Delta to Stockton and Sacramento, San Francisco Bay and Bodega Bay.

Features:

- Waterproof
- Planning charts
- GPS waypoints
- Courses
- Marinas
- Scales: 1:740,000 to 1:10,000
- 30 chart pages
- Detailed harbor charts
- Latitude/Longitude grids
- Ramps
- Dimensions: 12" x 17"

Item **050788** Model **WPB1210-02**

Ship 1 lbs **Net \$49.99**



Paradise Cay 2013-2014 Sailors Guide to the Windward Islands

AUTHOR: CHRIS DOYLE

Revised and updated for 2013-2014, A Sailors Guide to the Windward Islands features detailed sketch charts based on the author's own surveys, and aerial photos of most anchorages. It also includes clear and concise navigational information.

Features:

- Covers the islands from Martinique to Grenada
- Dazzling scenic photography
- Unsurpassed onshore information
- Sections on: Exploring, Provisioning, Water sports, Services, Restaurants, Photography
- Format: Spiral bound
- Pages: xxx pages

Item **050794** Model **9780944428948**

Ship 2 lbs **Net \$29.99**



Woodcharts

WATER CARVED IN WOOD!

This product is an artwork quality bathymetry chart; it is the equivalent of an above-water topographic lake map. If you are giving one of our charts as a gift and do not know what to call it, here is a long list of names we have heard people call our charts: wood chart, wood nautical chart, wood lake art, lake art, ocean art, wood ocean chart, wood carved chart, nautical art chart, relief chart, relief art, wood relief art, framed lake artwork, and lake artwork.



Item	Description	Dimensions	Ship	Net
402301	Baja Peninsula/Gulf of California	13.5" x 43"	10 lbs	\$298.00
402302	Catalina Island	16" x 20"	7 lbs	138.00
402303	San Francisco / Bay Area	16" x 20"	7 lbs	138.00
402304	San Francisco / Bay Area	24.5" x 31"	15 lbs	248.00
402305	Lake Tahoe	16" x 20"	7 lbs	128.00
402306	Lake Tahoe	24.5" x 31"	15 lbs	225.00
402307	Florida Keys, Lower	13.5" x 31"	8 lbs	225.00
402308	Siesta Key	24.5" x 31"	15 lbs	298.00
402309	Key Biscayne	13.5" x 31"	8 lbs	168.00
402310	Longboat Key	13.5" x 43"	10 lbs	225.00
402311	Sanibel Island	24.5" x 31"	15 lbs	248.00
402312	Cape Cod	24.5" x 31"	12 lbs	298.00
402313	Martha's Vineyard	16" x 20"	6 lbs	138.00
402346	Block Island	16" x 20"	3 lbs	138.00
402314	Nantucket	16" x 20"	6 lbs	128.00
402315	Chesapeake Bay	24.5" x 31"	12 lbs	298.00
402316	Bar Harbor / Mt Desert Island	24.5" x 31"	12 lbs	298.00
402317	Arbutus	16" x 20"	7 lbs	128.00
402318	Burt & Mullet	24.5" x 31"	15 lbs	248.00
402319	Crystal Lake	16" x 20"	7 lbs	128.00
402320	Grand Traverse Bay	16" x 20"	15 lbs	248.00
402321	Grand Traverse Bay	24.5" x 31"	7 lbs	138.00
402322	Higgins Lake	24.5" x 31"	15 lbs	225.00
402323	Lake Ann	16" x 20"	7 lbs	128.00
402324	Lake Charlevoix	16" x 20"	7 lbs	128.00
402325	Lake Superior	24.5" x 31"	15 lbs	248.00
402326	Long Lake	16" x 20"	7 lbs	128.00
402327	Silver Lake	13.5" x 31"	8 lbs	138.00
402328	Spider Lake	16" x 20"	7 lbs	128.00
402329	Straits Of Makinac	24.5" x 31"	15 lbs	248.00
402330	Walloon Lake	16" x 20"	7 lbs	128.00
402331	Glen Lake	16" x 20"	7 lbs	128.00
402332	Lake Huron	16" x 20"	7 lbs	138.00
402333	Walloon Lake	16" x 20"	8 lbs	138.00
402334	Torch Lake	13.5" x 31"	8 lbs	138.00
402335	Great Lakes	16" x 20"	7 lbs	138.00
402336	Great Lakes	24.5" x 31"	15 lbs	298.00
402337	Lake Michigan	16" x 20"	15 lbs	248.00
402338	Lake Michigan	24.5" x 31"	7 lbs	138.00
402339	Lake Erie	13.5" x 31"	8 lbs	168.00
402340	Seneca Lake	13.5" x 43"	10 lbs	225.00
402341	Lake George	13.5" x 43"	10 lbs	248.00
402342	Long Island Sound	24.5" x 31"	12 lbs	298.00
402343	Lake Washington	13.5" x 31"	8 lbs	168.00
402344	Puget Sound	24.5" x 31"	15 lbs	248.00
402345	San Juan Islands	24.5" x 31"	15 lbs	298.00

Nikon Aculon Binoculars

- Aspherical eyepiece lens eliminates image distortion even at the lens periphery (except zoom models)
- Multilayer-coated lenses for brighter images
- Turn-and-slide rubber eyecups facilitate easy positioning of eyes at the correct eyepoint (except zoom models)
- Rubber armour for shock-resistance and a firm, comfortable grip
- Smooth zooming with finger-tip zoom control (zoom models only)
- Can be fixed to a tripod using optional tripod adaptor (Tripod adaptor TRA-2 is a supplied accessory for the ACULON A21 | 16x50 and 10-22x50)



Item	Model	Description	Ship	M.A.P.
800612	8244	7 x 35	3 lbs	\$79.95
800613	8245	8 x 42	3 lbs	89.95
800614	8246	10 x 42	3 lbs	99.95
800615	8247	7 x 50	3 lbs	109.95
800616	8248	10 x 50	3 lbs	119.95
800617	8249	12 x 50	3 lbs	129.95
800618	8250	16 x 50	3 lbs	139.95
800619	8251	8-18 x 42	3 lbs	159.95
800620	8252	10-22 x 50	4 lbs	179.95

2013 Catalog Addendum- New

Vetus Porthole / Portlights

- Euro-styled low profile portlights complement the aesthetics of any craft
- Extruded aluminum inner and outer frames are anodized in silver
- Opening portlights feature silver inner and outer extruded aluminum frames
- Complete with stainless steel mounting screws for quick installation
- 10 mm Smoke-Gray acrylic window
- Beveled edge and is fitted with glass reinforced insect screen
- White moulded dress trim and stainless steel mounting screws
- Trim accommodates up to 40 mm (1-9/16") thickness
- Note: All opening portlights must be installed above the water line



**RECTANGULAR, HEAVY DUTY VERSION, CE CLASSIFIED
AI IS SUITABLE FOR USE IN THE HULL SIDE**

Item	Model	Cutout Size	Ship	Net
901559	PZ611	10-7/8" x 5-1/2"	6 lbs	\$169.99
901560	PZ621	13-9/16" x 6-1/8"	5 lbs	179.99
901561	PZ631	23-9/16" x 6-13/16"	11 lbs	224.99
901562	PZ641	14-11/16" x 6-13/16"	8 lbs	189.99
901563	PZ651	14-12/16" x 6-9/16"	8 lbs	194.99
901564	PZ661	14-3/4" x 8-1/4"	8 lbs	199.99
901565	PZ671	16-13/16" x 9-13/16"	10 lbs	214.99

RECTANGULAR, STANDARD VERSION CE CLASSIFIED

AIII IS SUITABLE FOR USE IN AND ABOVE DECK CABIN BULKHEAD

Item	Model	Cutout Size	Ship	Net
901566	PZ613	10-7/8" x 5-8/16"	6 lbs	\$154.99
901567	PZ623	13-9/16" x 6-1/8"	7 lbs	169.99
901568	PZ633	23-9/16" x 6-13/16"	10 lbs	209.99
901569	PZ643	14-11/16" x 6-13/16"	7 lbs	174.99
901570	PZ653	14-3/4" x 6-9/16"	7 lbs	184.99
901571	PZ663	14-3/4" x 8-1/4"	8 lbs	194.99
901572	PZ673	16-13/16" x 9-13/16"	9 lbs	199.99

OVAL CLASS A1 Porthole, SUITABLE FOR USE IN THE HULL SIDE

Item	Model	Cutout Size	Ship	Net
901588	PM111	8-11/16" x 4-13/16"	4 lbs	\$154.99
901589	PM121	10-5/8" x 5-13/16"	6 lbs	169.99
901590	PM131	12-5/8" x 6-7/8"	7 lbs	174.99
901591	PM141	13-5/16" x 4-13/16"	6 lbs	182.99
901592	PM151	14-7/16" x 7-11/16"	8 lbs	189.99

OVAL CLASS A111 Porthole, SUITABLE FOR USE IN AND ABOVE DECK CABIN BULKHEAD

Item	Model	Cutout Size	Ship	Net
901601	PW203	6-7/8" diameter	4 lbs	\$154.99
901602	PW213	7-11/16" diameter	5 lbs	164.99
901603	PW223	9-5/16" diameter	6 lbs	169.99

ELLIPTICAL CLASS A111 Porthole, SUITABLE FOR USE IN AND ABOVE DECK CABIN BULKHEAD

Item	Model	Cutout Size	Ship	Net
901604	PX 45	16-7/16" x 6-5/8"	7 lbs	\$154.99
901605	PX 46	18-7/16" x 7-1/8"	8 lbs	164.99
901606	PX 47	20-8/16" x 7-7/8"	8 lbs	172.99

Vetus Rectangular White Porthole Trim

- Designed to fit Porthole Model Numbers WPO00S
- Frame: Plastic, Color: White

Item	Model	For Porthole Model	Ship	Net
901578	WTP00W	WPO00S	1 lbs	\$19.99
901579	WTP01W	WPO01S	1 lbs	28.99
901580	WTP02W	WPO02S	1 lbs	32.99
901581	WTP03W	WPO03S	1 lbs	36.99
901582	WTP04W	WPO04S	1 lbs	42.99

Vetus Rectangular Porthole Screen

- Designed to fit Porthole Model Number WPO00S
- Frame: Anodized Aluminum

Item	Model	For Porthole Model	Ship	Net
901583	WSP00K	WPO00S	1 lbs	\$28.99
901584	WSP01K	WPO01S	1 lbs	29.99
901585	WSP02K	WPO02S	1 lbs	32.99
901586	WSP03K	WPO03S	1 lbs	34.99
901587	WSP04K	WPO04S	1 lbs	36.99

BEP Digital Volt Sensing Relay

- Designed for (2) battery bank system
- Power input 12/24 VDC
- This system ensures there will always be a fully charged reserve battery

Item	Model	Ship	Net
204914	714-140A-DVSR	1 lbs	\$139.99
204916	710-140A	1 lbs	89.99



NEW! Simrad NSO Package with Monitor

The NSO15 Package is a plug & play combination, consisting of Simrad's powerful NSO marine processor, GS15 GPS antenna, OP40 wired remote controller, Simkit1 cable kit and an SD card reader. NSO Processor The NSO Offshore marine processor is a vital component of our premier navigation system. Combining extensive integration capabilities, including dual display output, with lightning-fast performance and robust



construction, the NSO Offshore processor is capable of matching a wide range of vessel requirements.

Kit Includes:

- Argonaut G7 Series 17" LED Marine Monitor - 12 Volt (24V available by Special Order)
- Simrad OP40 Wired Remote Controller
- Simrad NSO Marine Processor
- Simrad GS15 N2K GPS Antenna
- Simrad SimNet I Starter Kit
- SD Card Reader

Item	Model	Ship	Net
254551	000-11098-001 & G717	32 lbs	\$3699.99

Icom SP-35 External Speaker

- Output: 5 Watts (7 Watts peak)
- Includes 3.5 mm Speaker Jack
- Audio cable wired to the rear panel terminates to a mono mini plug
- Includes 2 Meter Cable
- Includes Hinged Mounting Bracket



- Supports from the top, bottom or back
- The SP-35 external speaker replaces the SP-22 or SP-25 external speakers currently supplied with some of our Icom's radios

Item	Model	Ship	Net
254844	SP-35	1 lbs	\$58.99

Poly Planar ACX10 USB / AUX Accessory Input

- Includes a waterproof panel/dash mount with rubber cover
- Includes 6.5 foot extension cable
- Provides easy access to accessory inputs

Item	Model	Ship	Net
254955	ACX-10	1 lbs	\$25.00



Lumitec Rail2 LED Rail Light

- Lumitec's original rail light amazed customers when it was first introduced in 2008
- Rail2 raises the bar with up to 3 times greater output than its predecessor and a sleek new look
- The integrated microprocessor controls dimming and color change from two wires, with no external control modules
- As with all Lumitec luminaires, the Rail2 is IP67 compliant, which means despite its great looks it is just at home on a spray-drenched hard top as a teak-adorned salon
- Proudly made in the USA
- Light Color: White and Blue, Dimmable
- Power: 10-30 Volt DC
- Draw: 220 mA @ 12 Volt DC or 160 mA @ 24 Volt DC
- Dimensions: 11.89" L x 0.75" H

Item	Model	Ship	M.A.P.
701408	101081	1 lbs	\$82.72



2013 Catalog Addendum- New

Scanstrut Pod Instrument Rail Mount

Designed to fit (1) standard instrument.

Item	Model	Ship	Net
259512	SPR-11-RM	1 lbs	\$127.99
259513	SPR-7-RM	4 lbs	285.99
259514	SPR-11-AM	2 lbs	149.99
259515	SPR-7-AM	5 lbs	299.99



Scanstrut Rok-Lok Adjustable Mount

- Designed for Rail Diameter: 3/4" and 1"
- Designed for Lowrance HDS-5, Mark / Elite Series and Garmin 100, 160 and 300
- 360 Degree Rotation, 180 Degree of Swivel / Tilt

259521	RL-503-ARM	2 lbs	\$79.99
259522	RL-504-ARM	2 lbs	79.99
259523	RL-505-ARM	2 lbs	79.99



Scanstrut Rok-Lok Non-Adjustable Mount

- Designed for Rail Diameter: 3/4" and 1"
- Designed for Lowrance HDS-5, Mark / Elite Series and Garmin 100, 160 and 300

259524	RL-503-RM	1 lbs	26.99
259525	RL-504-RM	1 lbs	26.99
259526	RL-505-RM	1 lbs	26.99



Scanstrut Scanpod Mast Pod 3/4 Maxi

- Maximum Cutout Area: 7.65" W x 19" H
- Color: White, Accommodates 3/4 Maxi Style Instruments such as the 20/20
- Provided Uncut

259527	SPM-MAXI-W	4 lbs	\$614.99
--------	------------	-------	----------



Caframo 743 Camano Single Speed Marine Fan

An economical fan that provides a versatile solution to many of the airflow challenges a boater may face in hot and humid weather. The model 743 Camano 12VDC fan is easy to install and will enable any boater to "Cruise in Comfort". Ideal for any tight spot that needs some additional airflow whether it is in the corner of the V-berth or under a cupboard in the galley.

- Mount in any orientation (up, down or sideways)
- Fan stays in place in rough seas
- Quiet & easy to use
- Battery friendly
- Touch control in center of fan
- 2000+ hour motor
- Locking ball-joint base
- Current Draw on High Speed
- Color: White
- Greater boater safety
- Single speed motor
- Compact design
- High efficiency blade
- Fully guarded on front and back
- Dimensions: 6"W x 8.5"H x 2.5"D
- Warranty: 1 Year

Item 900995	Model 743CA-WBX	Ship 1 lbs	Net \$24.99
-------------	-----------------	------------	-------------



Caframo 757 Ultimate 2-Speed Marine Fan

The model 757 Ultimate 12VDC fan has long been a favorite among Caribbean sailors where good boat ventilation is a must. The two speed motor and Fingersafe™ blade move large masses of air throughout the boat from the V-berth to the galley. This is the fan that will let boaters enjoy their boating investment.

- Maximum airflow
- Easy to install
- Direct air in any direction
- Fan stays in place in rough seas
- Direct wire
- Long life, low power drawing motor
- Color: White
- Current Draw on High Speed: 0.5 Amps
- Easy to clean
- Quiet, dependable operation
- Match any boat interior
- Two speeds
- Comes with permanent mounting option
- Adjustable base and tilting head
- Dimensions: 7" (w) x 9" (h) x 5.5" (d)
- Warranty: 1 Year

Item 900996	Model 757DC	Ship 2 lbs	Net \$39.99
-------------	-------------	------------	-------------



Raymarine Dragonfly Sonar / GPS with Transducer

Raymarine's Dragonfly Sonar / GPS with dual-channel CHIRP technology enables anglers to target fish with sonar and explore underwater structures with photo-like clarity using Dragonfly's high-resolution DownVision™ sonar. Just power up and start fishing!

Winner of the 2013 Innovation Award for Consumer Electronics, Mobile Applications and Software presented by the National Marine Manufacturers Association (NMMA) and Boating Writers International (BWI) at the Miami International Boat Show

FEATURES:

Dragonfly Sonar / GPS with Dual-Channel CHIRP Sonar Technology

- Engineered for high performance and simple operation – ideal for smaller boats of almost any kind
- Photo-like imagery of bottom structure using DownVision™ – the first high-resolution imaging sonar for anglers to use CHIRP technology
- CHIRP powered Dual Channel sonar – view high resolution CHIRP DownVision structure imagery and target fish independently, or simultaneously in split screen mode
- Built-in 50-channel GPS sensor with fast-acquisition technology
- Available with industry leading Navionics® Silver or Gold charts on MicroSD
- Super bright 5.7" display optically bonded for maximum visibility and high contrast in all conditions
- Uncomplicated user interface simplifies display choices and menu options
- Automatic sonar optimization – no adjustment required
- Simple 3-button control
- Uni-controller (joystick cursor and rotary dial) lets anglers quickly and easily dial through DownVision, sonar and GPS displays
- MicroSD chart and memory reader
- Rugged enclosure built to IPX6 and IPX7 waterproof and submersion standards
- Tilt / swivel quick-release holster with optional locking core for added security
- Single power and transducer connector with thumb-friendly locking collar

CPT-60 Transducer

- Dual-element CHIRP DownVision transducer
- Engineered to be a perfect acoustical match to Dragonfly's CHIRP sonar
- Equipped with an ultra-wide 60° x 1.4° fan-shaped beam for DownVision – optimized for maximum bottom imagery
- Second element provides conical-shaped beam for imaging fish targets, ensuring you'll never miss any of the action below your boat
- Transom mount (optional trolling motor mount offers added mounting flexibility)
- Hydrodynamic design provides excellent high-speed performance
- Built-in, fast-response temperature sensor

Item	Model	Ship	M.A.P.
259530	E70085	6 lbs	\$649.99

- CHIRP-Powered Dual Channel Sonar with DownVision, Internal 50-Channel GPS
- Chart Compatibility: Navionics Silver, Gold and HotMaps (Not Included)
- Operating Voltage: 10.8 - 15.6 Volt DC, Power Consumption: 8 Watts

Item	Model	Ship	M.A.P.
259530	E70085	6 lbs	\$649.99

- CHIRP-Powered Dual Channel Sonar with DownVision, Internal 50-Channel GPS
- Includes Navionics Silver US Coastal and Lakes Charts on MicroSD
- Operating Voltage: 10.8 - 15.6 Volt DC, Power Consumption: 8 Watts

Item	Model	Ship	M.A.P.
259532	E70085-GLD	5 lbs	\$719.99

- CHIRP-PoweredCHIRP-Powered Dual Channel Sonar with DownVision, Internal 50-Channel GPS
- CHIRP-PoweredIncludes Navionics Gold North American Coastal and Lakes Charts on MicroSD
- CHIRP-PoweredOperating Voltage: 10.8 - 15.6 Volt DC, Power Consumption: 8 Watts

Item 900997	Model 902BP-8D	Ship 2 lbs	Net \$36.99
-------------	----------------	------------	-------------

Caframo 902 EZ PowerPak

- Provides portable 12VDC power
- Maximum draw: 3 amps
- Load it with 8 D-Cell batteries and store it until needed
- Power a multitude of accessories requiring 2.5 amps or less, waterproof
- Color: Yellow
- Dimensions: 3.75"W x 8"H x 3.5"D
- Warranty: 1 Year



LOWRANCE

Elite & Mark Series

NEW!



ALL ELITE & MARK SERIES (ELITE-4, ELITE-5, ELITE-7) FEATURE:

- **Brighter Displays:** Maximum visibility and viewing detail in ALL conditions. (Mark series: 16-level Gray scale 480 x 480; Elite Series: 256 color TFT with LED backlighting)
- **Trackback™ Feature:** Easily scrollback through sonar history to review and zoom-in for a closer look at bottom structure, baitfish and game fish. Save a waypoint on chartplotter models to quickly find that location again
- **Smart Menus:** with quick and easy access to all the features you need with one-thumb operation
- **Advanced Signal Processing™:** On fishfinder models, automatically see fish, structure and bottom detail more clearly
- **Easy Installation:** Plug-and-play functionality saves you time and hassles, and works with existing Lowrance or Eagle® unplug cables

NEW! ONLY THE ELITE-7 SERIES FEATURES:

- **70% Larger Elite Color Display:** Brilliant, widescreen visibility and viewing detail in all conditions
- **Multi-Window Displays:** Lets you choose up to three panels in split-screen mode to view chart, sonar and DownScan Imaging™ all on one screen simultaneously
- **Page Selector:** An easier-to-use menu system with quick access to all features using one-thumb operation
- **Advanced NMEA 2000® Networking capability**

NEW! ELITE-7 HDI FISHFINDER/CHARTPLOTTER FEATURES

- **Hybrid Dual Imaging (HDI):** The power of two award-winning technologies combined to provide the best-possible view beneath your boat. Broadband Sounder™. Excellent for marking fish arches and tracking lure action, PLUS DownScan Imaging that reveals easy-to-understand, picture-like detail of structure and bottom with no interpretation needed
- **HDI Transducer Options for Fishfinder Models:** Broadband Sonar-4 frequencies- 83/200 & 50/200kHz and DownScan imaging 455/800. Also Standard 83/200 and 50/200 skimmer transom mount transducers are available

FOR MORE INFORMATION PLEASE VISIT WWW.DEFENDER.COM/LOWRANCE.JSP

Item	Model	Description	Transducer	Ship	M.A.P.
COMBINATION CHARTPLOTTER AND FISHFINDERS					
259498	000-10970-001	ELITE-7 Base Map Combo	N/A	5 lbs	\$599.00
259495	000-10966-001	ELITE-7 Base Map Combo	83/200 and 455/800 HDI Skimmer Transducer	6 lbs	699.00
259497	000-10967-001	ELITE-7 Base Map Combo	50/200 and 455/800 HDI Skimmer Transducer	7 lbs	799.00
259506	000-10968-001	ELITE-7 Base Map Combo	83/200 (Non- HDI) Skimmer Transducer	6 lbs	599.00
FISHFINDER ONLY					
259494	000-10965-001	ELITE-7X Fishfinder	N/A	5 lbs	\$449.00
ACCESSORIES					
259501	000-10976-001	HDI Skimmer Transducer	83/200 and 455/800	2 lbs	\$114.99
259502	000-10977-001	HDI Skimmer Transducer	50/200 and 455/800	3 lbs	227.99
259503	000-10978	HDI Trolling Motor Adapter	For HDI Dual Imaging Broadband Skimmer Transducer	1 lbs	18.99
259504	000-10979-001	ELITE-7 Flush Mount Kit	For Elite-7 Series Displays	1 lbs	14.95
259505	000-11069-001	ELITE-7 Suncover	For Elite-7 Series Displays	1 lbs	18.99

ADDENDUM

SHOP 24/7 AT WWW.DEFENDER.COM

Airmar H2183 Heading Sensor

- Solid-State, Three-Axis Compass
- Maintains 2° of Accuracy during Pitching and Rolling up to 30°
- Outputs NMEA 0183 and NMEA 2000 Data Simultaneously

Item 259528 Model H2183-10 Ship 2 lbs Net \$624.99



Airmar GH2183 Network GPS Compass

- GPS Positioning and Highly-Accurate Heading Information in (1) Antenna
- Maintains 2° Heading Accuracy in Dynamically Changing Conditions
- Outputs NMEA 0183 and NMEA 2000 Data Simultaneously

Item 259529 Model GH2183-10 Ship 3 lbs Net \$779.99



Fiamm Fultone Pneumatic Dual Marine Horn Kit with Air Compressor

- Includes (2) 114 Decibel Horns (High=300 Hz / Low=260 Hz), Hose and Switch
- Tone: Dual Note
- Materials: 304 Stainless Steel and Painted Aluminum

Item	Model	Voltage	Draw	Ship	Net
550499	62330-14	12VDC	20 Amps	6 lbs	\$169.99
550500	62340-12	24VDC	10 Amps	5 lbs	169.99



Fiamm Toronado Pneumatic Marine Horn Kit with Air Compressor

- Includes (1) 120 Decibel Horn (320 Hz), Hose and Switch
- Tone: Low Note
- Materials: 304 Stainless Steel and Chrome Plated Brass

Item 550501 Model 63210-14 Voltage 12VDC Draw 20 Amps Ship 4 lbs Net \$144.99



Fiamm Toronado Pneumatic Dual Marine Horn Kit with Air Compressor

- Includes (2) 122 Decibel Horns (High=380 Hz / Low=320 Hz), Hose and Switch
- Tone: Dual Note
- Materials: 304 Stainless Steel and Chrome Plated Brass

Item	Model	Voltage	Draw	Ship	Net
550502	63230-14	12VDC	20 Amps	6 lbs	\$219.99
550503	63330-14	24VDC	10 Amps	5 lbs	269.99



Woody Wax Kit Bonus Pack

The Woody Wax Kit Bonus Pack has everything you need to maintain and restore metals and fiberglass, and keep your boat looking like new! This quick, easy, and effective system will protect your T-tops, Towers, Outriggers, Anodized Aluminum, Aluminum, Stainless and Chrome from corrosion, salt water, sun light, oxidation and pollution for up to 6 months!

- 16 oz. Woody Wax Fiberglass & Non-Skid Deck Wax and Metal Restoration & Protection
- 8 oz. Metal Sealant
- (1) Foam Applicator Brush
- (1) Fine Bronze Wool Pad

BONUS!!! Also includes:

- 4 oz. Ultra Pine Wash'N'Wax Boat Soap
- 4 oz. Ultra Gloss Restoring Compound
- 4 oz. Carnauba Glass Coat Topside/Hull Wax

Item	Model	Ship	Net
756088	WWAXSPEC	3 lbs	\$48.00



Sea-Dog Heat Shrink Terminal Crimper Tool

- Crimps 22-10 gauge heat shrink terminals
- Great addition to any tool box
- Material: Powder Coated/Stainless Steel

Item	Model	Size	Ship	Net
756093	429920-1	9" x 2-3/16"	1 lbs	\$34.99



2013 Catalog Addendum - New

Sudbury Isin Zoap Plus Cleaner Polish

- Sudbury Isin Zoap Plus Cleaner Polish Cleans and protects eisenglass dodger windows and enclosures
- Cleans quickly and easily without leaving streaks or swirls
- Seals plastic and leaves a protective coating
- Provides anti-static, anti-fog and resists finger prints
- Will remove marks form crayons, markers, and paint over-spray

Item	Model	Size	Ship	Net
Ⓢ 756079	430	8 oz.	1 lbs	\$6.99



Sudbury Isin Zoap Polish

Removes small scratches!

- Sudbury Isin Zoap Polish Cleans, protects and removes small scratches from eisenglass dodger windows and enclosures
- Cleans quick and easy without leaving streaks or swirls
- Seals plastic and leaves a protective coating
- Provides anti-static, anti-fog and resists finger prints
- Will remove marks form crayons, markers, and paint over-spray

Item	Model	Size	Ship	Net
Ⓢ 756080	425	8 oz.	1 lbs	\$6.99



Sudbury Vinyl Restorer & Protector

- Sudbury Vinyl Restorer & Protector renews the appearance and color of vinyl
- Keeps it pliable, fresh looking and well-protected
- Spray on and wipe off to provide a beautiful luster

Item	Model	Size	Ship	Net
Ⓢ 756081	2141	12 oz.	2 lbs	\$14.99



Sudbury Hull Cleaner & Stain Remover

Sudbury Hull Cleaner & Stain Remover penetrates and removes deep stains, rust and marine growth from fiberglass and aluminum surfaces without scrubbing.

- Features:**
- Trigger spray allows quick and easy direct application
 - Strong and effective, but safe to use
 - 100% biodegradable earth-friendly formula

Item	Model	Size	Ship	Net
Ⓢ 756082	815Q	32 oz.	3 lbs	\$14.99



Sudbury Marine Toilet Conditioner

- Sudbury Marine Toilet Conditioner Cleans, lubricates, deodorizes and keeps all parts of marine toilets clean and in efficient working condition
- Contains a special non-mineral oil that will not harm leather, rubber or fittings
- Conditions by impregnating and lubricating all parts
- Eliminates rather than masks odors
- Non-caustic
- For use with fresh or salt water
- 95% Biodegradable earth-friendly formula
- Container: 32 Fluid Ounces (946 ml)

Item	Model	Size	Ship	Net
Ⓢ 756083	825Q	32 oz.	3 lbs	\$13.99



Sudbury Eco Bilge Cleaner

- Sudbury Eco Bilge Cleaner cleans hard to reach bilge areas, controls odor, protects paint, fiberglass and wood from solvent attachment and minimizes the build up of combustible fumes
- Can be used in fresh and salt water
- Eco Bilge is a new Bilge formula that meets the strict standards of the US EPA
- Design for the Environment (DfE) Program
- Sudbury is committed to providing green maintenance products to help you protect your investment

Item	Model	Size	Ship	Net
Ⓢ 756084	801Q	32 oz.	3 lbs	\$12.99



Sudbury Eco Zoap

Sudbury Eco Zoap is an all-purpose green formula that removes bird droppings, harbor scum, and dirt from all marine surfaces.

- Features:**
- Works in fresh and saltwater
 - Environmentally friendly, biodegradable formula packaged in a recycled quart container
 - Meets strict standards of the US EPA's Design for the Environment program

Item	Model	Size	Ship	Net
Ⓢ 756085	806Q	32 oz.	3 lbs	\$12.99



Sudbury Eco Zoap Plus

Sudbury Eco Zoap Plus is a heavy-duty formula that removes stubborn dirt, stains and residue from all marine surfaces.

- Features:**
- Works in fresh and saltwater
 - Environmentally friendly, biodegradable formula packaged in a recycled quart container
 - Meets strict standards of the US EPA's Design for the Environment program

Item	Model	Size	Ship	Net
Ⓢ 756086	811Q	32 oz.	3 lbs	\$13.99



Zodiac Replacement Oarlock Repair Kit

- Color: Black
- (2) per Package

Item	Model	Ship	Net
456033	Z69346	2 lbs	\$44.99



Lewmar SX Windlass Foot Switch

Designed for use with Lewmar 12 Volt and 24 Volt DC product control systems

- Top Style: Closed
- Power: 12 or 24 Volt DC, Maximum Draw: 5 Amps
 - Body Material: Black Plastic, Cap: Black Plastic
- Direction: Specify Down Only or Up Only**
- IP67/5 rated for water resistance
 - Twin sealed switch compartment
 - Composite plastic body and lid
 - Lower-profile design with updated styling
 - Power: Voltage 9 Volt DC to 32 Volt DC Only
 - Max Draw: 5 Amps

603354	Model 68001107	Down Switch	Ship 1 lbs	Net \$65.99
	Model 68001030	Up Switch	1 lbs	65.99



Ongaro Heavy Duty Pantograph Wiper Arm

- Shaft: 5/8"
- Material: Powder Coated 304 Stainless Steel, Color: Black
- Replaces all Competitive Arms on Heavy Duty Motors

- Features:**
- Deluxe Adjustable parallel arm from 12.5" to 18"
 - Powder coated 304 Stainless steel
 - Heavy Duty stainless steel spring

Item	Model	Ship	Net
550504	39318	2 lbs	\$82.99



Blue Dolphin Painters Masking Tape

Use for Painted Walls & trims, Lacquered/varnished woodwork, Glass, plastic, metal UV resistant.

- 14 Days Clean & easy removal
- Overall Grade: Painter's Grade
- Backing: Crepe paper
- Adhesive: Non-solvent, specially modified UV stable adhesive
- Tensile Strength: 3,3 (kg/cm)
- Service Temperature Range: -10 to +60 C or 14 to 140 F

Item	Model	Size	Ship	Net
756086	756075	BDT01001" x 60 yds.	1 lbs	
756076	BDT0150	1-1/2" x 60 yds.	1 lbs	4.99
756077	BDT0200	2" x 60 yds.	1 lbs	6.99



2013 Catalog Addendum- New

EZ Hold Drink Holder Combo Pack

This stylish Drink Holder securely holds a soda can or coffee mug.



Features:

- Includes a can insulator and a slot for mug handles
- Attach the Cup Holder to the EZ Hold-it Mount (Included)
- Provides a safe, convenient way to keep drinks handy and secure
- Can easily be attached or removed from any of the EZ Hold-it Mounts you have installed

• Dimensions: 5.25" x 4.25" x 3.75"

Item	Description	Ship	Net
401396	for 1" Rail Mount	1 lbs	\$13.99
	for 7/8" Rail Mount	1 lbs	13.99
	for Flat Surface Mount	1 lbs	13.99

Strahl Stemless Wine Glass

Stemless wine glasses have been available in glass and crystal for several years but never in plastic. Now, here's the opportunity to enjoy a glass of wine without the possibility of glass breaking on your yacht, patio or deck.



Features:

- Made of unbreakable polycarbonate
- Has the look and feel of crystal, but it won't crack or craze like acrylic
- Polycarbonate doesn't give a "plastic" taste like some cheap wine glasses
- A healthy 8-oz. wine glass for your enjoyment
- Manufacturer's Lifetime Warranty

Item 401397	Model 5101	Ship 1 lbs	Net \$10.99
-------------	------------	------------	-------------

Shakespeare Omni-Directional 14" SeaWatch Marine TV Antenna



- Antenna's digital preamplifier, located in the antenna head, designed for high gain and low noise figures
- Omni-directional 360° Signal Reception
- Digital HDTV Ready

Simply connect the antenna to any TV that has a digital receiver

Older analog TVs require a connection to a digital converter box (Not Included)

- 360° Signal reception - no aiming
- Dimensions: 14.88" Diameter x 7.25" High
- Includes an innovative mount which swivels to accommodate mounting surfaces that slope up to 30 degrees
- Also mounts easily on any standard 1" - 14 thread antenna mount
- Operates on 12 Volts DC; Power supply can be wall or surface mounted
- Automatically switches to Aux Input when powered off
- Replaces the 2020-G, 2020-GE, and 2025, which are being phased out

Kit Includes:

- Antenna Head
- 12 Volt DC Power supply
- 5' Power cord
- 1" - 14 Thread adapter
- Swivel mount
- Receptacle box
- 30 Feet RG-59 coax
- (4) Screw-on "F" connectors

Item	Model	Ship	Net
259585	3020	6 lbs	\$146.99

Furuno NMEA 2000 Cable Assembly



- NMEA 2000 Cable Assembly
- CAN bus Cable
- Length: 2 meters
- Includes Connectors (Lighted) on both Ends

Item	Model	Ship	Net
259584	001-105-760-10	1 lbs	\$33.59

Hart Tank Tender for Water, Diesel or Waste - Includes Purge Valve



The Hart Tank Tender provides extremely accurate readings without electricity, without leaving the bridge, with no dip stick, site glass or float gauge.



Features:

- Completely self-contained pneumatic operation (non-electric)
- Very simple installation that requires only one 5/32" hole in each tank top over deepest port
- Easy-to-install push-in connections
- A typical 4-tank installation may read the contents of one fuel, one holding and two water tanks
- Easily embossed calibration cards to convert inch readings to gallons
- Corrosion resistant materials such as brass and stainless steel
- Medical grade components with long-term reliability
- Mounting hardware supplied with system
- Gauge includes plastic cover

Specifications:

- Includes Purge Valve
- Gauge - Scale: 30", Diameter: 2-1/2"
- Dimensions:
Panel: 6" H x 4" W x 2-7/8" D
Panel Cutout: 3-1/16" W x 5" H
Gauge: 2" Diameter

Maximum Tank Depth: 30" Water / 35" Diesel

Note: Do not use with gasoline.

Item	Model	Description	Ship	Net
304598	S30-3-PV	for (3) Tank System	4 lbs	\$599.99
304599	S30-4-PV	for (4) Tank System	4 lbs	699.99

Marine Dynamics Stingray StarFire No-Drill Hydrofoil Kit



The super-sleek profile of the StarFire's wings create a hydrofoil that is ultra-thin, easy to install, and an incredible performance improvement



Features:

- Designed to be the fastest, have the least drag, save the most fuel, and have the best top-end speed of any hydrofoil ever invented
- Sports a swept back Delta-wing profile and has a unique, inverted trailing edge designed to relieve drag
- Graphic inlays designed to resemble polished stainless steel won't scratch, tear, peel, or fade in the sun
- High quality inlay graphics
- Narrower and thinner profile than SE Sport
- Dramatically simplifies and reduces installation time
- Has a patented, integrated No-Drill attachment vs. The SE Sport which requires a cumbersome add-on Sport Clip
- NO-DRILL hydrofoil that give you the option to drill and bolt it on
- Utilizes ribbed-neck pins rather than clunky nuts and bolts used by other
- StarFire requires only (2) set screws for No-Drill installation
- The SE Sport + Sport Clip contains over (50) pieces and parts used in assemblies and sub-assemblies

Please specify color: Black, White, Gray

Item	Description	Ship	M.A.P.
301043	fits Engines 40 - 250 HP	4 lbs	\$69.95

Aqualarm Fire Alarm Kit



Features:

- Monitors heat level and activates the Red light on the warning panel
- Sounds a loud buzzer (built into the panel)
- Sounds an external bell when the temperature reaches activation temperature or rate of rise is reached
- Multiple remote fire detectors can be wired in parallel on this boat fire alarm



Kit Includes:

- The remote fire detector (UL and ULC listed)
- Warning Panel (Fire Alarm Panel size 1-3/4" x 3")
- Bell

Please specify activation temperature: 135° or 194°
Activation Temperature: 135 ° F = Model 20532
Activation Temperature: 194 ° F = Model 20534

Item	Ship	Net
552014	3 lbs	\$96.99

2013 Catalog Addendum- New

Allen Stainless Single and Double Padeyes

Manufactured from superior quality Stainless Steel. Folds down when not in use.

Single- Ships 1 lbs



Item	Model	Open Height	Inside Ring Dimensions	Stock Thickness	Fastener	Break Load lbs	MWL lbs	Net
604465	PB181/I	18mm	45mm W	5mm	10-32*	3,520	2,900	\$15.00
604466	PB182/I	20mm	55mm W	8mm	1/4**	9,900	4,900	119.00

Double- Ships 2 lbs

Item	Model	Open Height	Inside Ring Dimensions	Stock Thickness	Fastener	Break Load lbs	MWL lbs	Net
604467	PB185/I	22mm	75mm W	5mm	3/8**	19,800	9,600	\$15.00

* Fasteners: All Flathead and sold separately

Signal Mate Portable Sound & Light Signal Control System

Signal Mate Portable Sound & Light Signal Control System is a self-contained, automatic controller that provides the required USCG sound and light signals for a vessel during restricted visibility or emergency situations.



- Sound signals include vessel appropriate fog signals, Danger/Doubt signal and the Distress sound signal (continuous horn or SOS), or manual horn
- Light signals include standard repeating SOS, the Inland Distress of 50 to 70 flashes per minute continuously, or anchor light
- Controller has (2) outputs that can be used independently or synchronized – allowing for use of horn and/or light for signaling
- Push-button operation for easy selection of specific signals
- Light or horn can be operated independently or synchronized (USCG rule 36)
- (3) modes of operation: manual, automated or On/Off
- Side receptacle allows use of an additional, portable search light during restricted visibility or emergency
- Unit is pre-wired and ready for immediate use
- User friendly operation
- Includes controller, horn, 360° LED light, battery, charger and carry bag 3-stage smart charger

Specifications:

- Light Source: Energy-efficient high brightness 3NM 360° LED
- Light has 16 ft. of hoisting cable for better visibility
- Solid state SMT technology
- Material: Black powder-coated aluminum enclosure
- Warranty: 3 years

Item	Model	Input Voltage	Dimensions	Ship	Net
550505	SM-P	10 - 32VDC	7" W x 5" H x 11" L	12 lbs	\$571.99

Springfield Quick Seat Mount & Swivel Combo

Features:

- Removable Seat Bracket
- Non-Locking Seat Swivel
- Rotates 360°
- E-Coat Finish



Item	Model	Dimensions	Ship	Net
650817	I100115	7" x 7"	3 lbs	\$21.99

Sogeman Bugbusters Companionway Screen Snap Kit

Sogeman recommends their "Snap Kit" to fix companionway screens when there is no access to handrails for strap attachments.

Features:

- Easy to install
- Drill a small hole on each side of the companionway entrance
- Then put a bit of silicone and screw the male snap on deck
- Each kit comes with (2) Buckles with Snaps and (2) Screws
- Installation instructions are included



Item	Model	Ship	Net
900960	MDSNAP	1 lbs	\$18.99

Lewmar SX Windlass Foot Switch

Features:

- IP67/5 rated for water resistance
- Twin sealed switch compartment
- Composite Black, plastic lid and body
- Lower-profile design with updated styling
- Open top lid
- Open (68001027) and closed (68001031) Top Lids available
- Power: Voltage 9VDC-32VDC only
- Max Draw: 5 Amps
- Cutout = 1-1/8"



Item	Model	For use with	Ship	Net
615668	68001031	12 and 24VDC Lewmar control systems	1 lbs	\$72.99

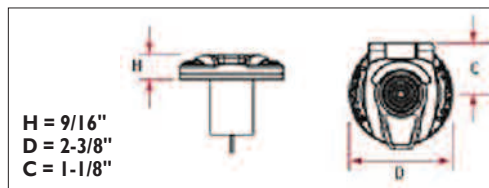

H = 9/16"
D = 2-3/8"
C = 1-1/8"

Holes Details

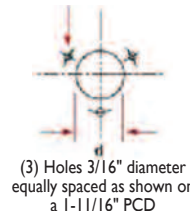

(3) Holes 3/16" diameter equally spaced as shown on a 1-1/16" PCD

Sea-Dog Side Mount Rod Holders



Accessories are not included

- Rod Holder is one piece
- No assembly required

Item	Color/Description	Dimensions	Ship	Net
650818	White, (2) Rod with knife holder	9" x 1-3/4" x 10-3/4"	1 lbs	\$9.99
650819	Black or White, (3) Rod with knife and plier holder	13-1/2" x 1-7/8" x 10-3/4"	1 lbs	13.99

Sea-Dog 30° Economy Flush Mount Rod Holder

- This Stainless Steel rod holder is a good value for your money
- Includes plastic liner, mounting gasket and integral cap
- Rod Holder angle is 30°
- Diameter Inside: 1-1/2", Diameter Outside: 2-3/16", Length : 9-3/8"
- Fasteners: #12 F.H.



Item	Model	Description	Ship	Net
650828	325171-I	Stainless Steel	2 lbs	\$21.99

Sea-Dog 90° Economy Flush Mount Rod Holder

- Includes plastic liner, mounting gasket and integral cap
- Rod Holder angle is 90°
- Diameter Inside: 1-9/16", Diameter Outside: 2-3/16",
- Fasteners Length : 8-1/4"
- Fasteners: #12 F.H.



Item	Model	Description	Ship	Net
650829	325173-I	Stainless Steel	2 lbs	\$24.99

Sea-Dog 30° Side Mount Rod Holder

- Holder slides into mounting plate (included) when in use and is easily removed when not in use for a lower profile
- Rod Holder angle is 30°
- Material: Stainless Steel
- Dimensions:

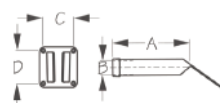

A = 9"
B = 1-1/2"
C = 2-15/16"
D = 3-1/4"

- (4) Fasteners: #10 F.H.

Item	Model	Description	Ship	Net
650830	325190-I	Stainless Steel	2 lbs	\$49.99

2013 Catalog Addendum- New

Seaview TV Satdome Mast Mount

Features:

- Sailboat & Trawler Mast Platform
- Designed for Use with Intellian and KVH and Intellian TV Satdome models: MI, 2, 3, ST37
- Material: Marine-Grade Aluminum, Anodized, White Powder Coating
- Seaview TV Satdome Mast Mounts are designed to have the satdome as close as possible to the mast
- Adjustable and designed with fore and aft adjustable rails
- Ultra heavy duty mounting feet and rivets are used to secure the Mast Mount to the mast
- Incredible Strength
- The solid underbody construction not only greatly improves strength but also hides cables
- Pre-drilled underbody allows for flood lights or horns to be mounted
- Material: Marine-Grade Aluminum Construction, Anodized, White Powder Coating



Item	Description	Ship	M.A.P.
259510	for KVH and Intellian TV Satdomes	10 lbs	\$300.00

Achilles High Pressure, Rapid Inflation Adapter

Features:

- Designed for Achilles FRB Series Inflatables
- High Pressure Adapter for use with Scott Bottles and Scuba Tanks for Rapid Inflation
- Can be used on other inflatables equipped with Over Pressurization Valves



Note : Not designed for use on Inflatable Keels.

Item	Model	Ship	Net
456138	IXI Achilles AC	3 lbs	\$343.90

Zodiac Valve Caps

Features:

- Designed for Models 2009 and Newer
- Sold (2) per Package
- Z Logo on Caps

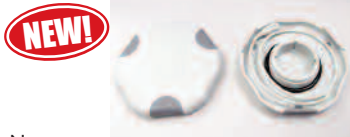

Item	Model	Ship	Net
456038	Z67079	1 lbs	\$24.99

Zodiac Valve Inserts

Features:

- Designed for Models 2009 and Newer
- Sold (2) per Package



Item	Model	Ship	Net
456038	Z67079	1 lbs	\$24.99

Nikon Aculon Series Binoculars

CENTER FOCUS MODELS FEATURE:

- Multilayer-coated optics
- Fully rubber armored
- Tripod adaptable
- Quick, easy central focus
- Aspherical eyepiece lens elements
- Turn-and-Slide eyecups



Orion Alert/Locate Commercial Distress Signal Kit

Description:

- Meets USCG regulations for ocean vessels traveling 3-50 miles from coastline or Great Lakes vessels traveling more than 3 miles from coastline

Contains:

- 3 SOLAS and uscg approved parachute flares
- 6 USCG approved red handheld flares
- 3 USCG orange smoke signals
- 1 heavy duty waterproof case



Item	Model	Ship	Net
550498	820	11 lbs	\$259.99

Please Note: This item is for pickup in our Outlet Store only.

UST Pico GLO™ Glow-in-the-Dark LED Mini Lantern

The same quality as the original Pico Lantern, with a glow-in-the-dark feature! To activate, expose to light for 5-20 minutes. The Pico Glo will be activated up to two hours. Store your lantern in a well-lighted spot so that it can easily be found in an emergency situation.



- 1W Nichia white LED – up to 123 lumens [Measured]
- 3-Mode electronic switch – HIGH, LOW & SOS-FLASHING
- Small in size with long runtime up to 91 hrs. continuous use
- Removable cap provides forward area light
- Rubberized, glow-in-the-dark housing enhances impact resistance
- Built-in recessed hook at lantern base for hanging overhead as area light
- Special textured cap for smoothing beam
- Batteries: (4) 1.5V AA Alkaline Batteries (Not Included)
- Dimensions: 5.25" H x 2.25" D
- Case Color: White / Florescent Green in the Dark

Item	Model	Ship	Net
701412	20-PL70C4B-15	1 lbs	\$25.99

Aqua Signal Series 30 LED All-Round Pole Navigation Light

Aqua Signal Series 30 LED All-Round Pole Navigation Light

Features:

- Energy saving, latest LED technology
- Housing is non-corrosive, non-magnetic, shock and seawater resistant
- Easy to fit
- Suitable for powerboats up to 65 ft.

Specifications:

- Light Color: White
- Light Source: Single LED
- Visibility: 2 NM
- Mounting: Pedestal / deck mount
- Housing Color: Black
- Operating Voltage: 12 Volt DC
- Power Consumption: 1 Watt
- Current Draw: 0.1 Amp
- Material: Rigid polycarbonate housing with shock-resistant polycarbonate prism lens
- Overall Height: 5"
- Protection: IP 67
- Approvals: USCG, IMO COLREG, ABYCA-16, CE
- Warranty: 3 years



Item	Model	Description	Ship	Net
701437	30040-7	for (3) Tank System	1 lbs	\$119.99

CENTER FOCUS ZOOM MODELS FEATURE:

- Smooth fingertip zoom control
- Multilayer-coated optics
- Fully rubber armored
- Tripod adaptable
- Quick, easy central focus



Item	800612	800613	800614	800615	800616	800617	800618	800619	800620
Model	8244	8245	8246	8247	8248	8249	8250	8251	8252
Description	7x35	8x42	10x42	7x50	10x50	12x50	16x50	8-18x42 Zoom	10-22x50 Zoom
Magnification	7	8	10	7	10	12	16	8-18	10-22
Objective Diameter	35	42	42	50	50	50	50	42	50
Real Field of View	9.3°	8.0°	6.0°	6.4°	6.5°	5.2°	4.2°	4.6°**	3.8°**
Apparent Field of View*	59.3°	58.4°	55.3°	42.7°	59.2°	57.2°	60.8°	35.6°**	36.7°**
FOV @ 1000 (m/ft)	163/488	140/420	105/314	112/335	114/341	91/272	73/220	80/241**	66/199**
Exit Pupil (mm)	5	5.3	4.2	7.1	5	4.2	3.1	5.3**	5**
Brightness	25	28.1	17.6	50.4	25	17.6	9.6	28.1**	25**
Eye Relief (mm)	11.8	12	11.6	17.6	11.8	11.5	12.6	10.3**	8.6**
Close Focus Distance (m/ft)	5.0/16.4	5.0/16.4	5.0/16.4	8.0/26.2	7.0/23.0	8.0/26.2	9.0/29.5	13.0/42.7	15.0/49.2
Ship	3 lbs	3 lbs	3 lbs	3 lbs	3 lbs	3 lbs	3 lbs	3 lbs	4 lbs
M.A.P.	\$79.95	89.95	99.95	109.95	119.95	129.95	139.95	159.95	179.95

2013 Catalog Addendum- New

Signal Mate LED Bi-Color Navigation Light

Suitable for sailboats and powerboats up to 65'

- Horizontal Surface Mount
- Light Color: Red/Green, Housing Color: Black
- Operating Voltage: 12 - 28VDC
- Current Draw: 0.17 Amp @ 12VDC

Item	Model	Dimensions	Visibility	Ship	Net
701426	2NMBI225	1.5" W x 3.25" H	2 NM	1 lbs	\$291.99



Signal Mate 360° Navigation Light Mounting Bracket

- Designed for mounting various 360° Signal Mate Navigation Lights
- Plastic isolation washer between dissimilar metals
- Material: Stainless Steel

Item	Model	Center hole	Mounting holes	Ship	Net
701433	BRKT360	1/4"	(2) #10	1 lbs	\$23.99



Signal Mate LED Combination Tri-Color Navigation/Anchor Light

Suitable for sailboats up to 65'

- Horizontal Surface Mount
- Light Color: Tri-Color/White, Housing Color: Black
- Operating Voltage: 10 - 30VDC
- Current Draw: 0.3 Amp @ 12VDC

Item	Model	Dimensions	Visibility	Ship	Net
701427	TRIANC3	1.5" W x 4.5" H	2 NM	1 lbs	\$431.99



Signal Mate Navigation Light Mounting Bracket

- Designed for easy installation of various Signal Mate Navigation Lights
- Material: ASA Black plastic with UV inhibitors
- Mounts using (2) #10 flat head screws
- Wire termination area inside of fixture or wire can be run outside

Item	Model	Dimensions W x H x D	Ship	Net
701434	BRKTTERM	2-1/8" x 3-3/4" x 2-5/8"	1 lbs	\$29.99



Signal Mate LED Combination Tri-Color Navigation/Anchor Light & Photodiode

Suitable for sailboats up to 65'

- Includes optional photodiode – automatically turns anchor light OFF at daylight, ON at dusk
- Horizontal Surface Mount
- Light Color: Tri-Color/White, Housing Color: Black
- Operating Voltage: 10 - 30VDC
- Current Draw: 0.3 Amp @ 12VDC

Item	Model	Dimensions	Visibility	Ship	Net
701428	TRIANC3P	1.5" W x 4.5" H	2 NM	1 lbs	\$461.99



Signal Mate Pole Mount Adapter for Navigation Lights

- Designed for mounting Signal Mate Anchor/Steaming Lights on a pole
- Adapter is secured to pole with (3) set screws
- ASA Black Plastic with UV Inhibitors

Item	Model	Description	Ship	Net
701435	PADPT1	Fits 1" pole	1 lbs	\$38.99
701436	PADPT75	Fits 3/4" pole	1 lbs	38.99



Signal Mate LED Combination Masthead Navigation/Anchor Light

Suitable for sailboats up to 65'

- Horizontal Surface Mount
- Light Color: White, Housing Color: Black
- Operating Voltage: 9 - 30VDC, Current Draw: 0.16 Amp @ 12VDC

Item	Model	Dimensions	Visibility	Ship	Net
701429	3NMMHANC	1.5" W x 3.75" H	3 NM	1 lbs	\$381.99



Moeller 3-Way Fuel Valve

- Connects (2) Permanent tanks to a single motor
- Provides for withdrawal from one tank at a time only
- Allows (3) connections
- Threads: 3/8" NPT
- Material: Brass

Item	Model	Ship	Net
305651	033312-10	1 lbs	\$34.99



Signal Mate LED Port Navigation Light

Suitable for sailboats and powerboats up to 164'

- Vertical Surface Mount
- Light Color: Red, Housing Color: Black
- Operating Voltage: 10 - 30VDC
- Current Draw: 0.1 Amp @ 12VDC

Item	Model	Dimensions	Visibility	Ship	Net
701430	2NMI12R	1.5" W x 3.25" H	2 NM	1 lbs	\$186.99



Signal Mate LED Starboard Navigation Light

Suitable for sailboats and powerboats up to 164'

- Vertical Surface Mount
- Light Color: Green, Housing Color: Black
- Operating Voltage: 10 - 30VDC
- Current Draw: 0.1 Amp @ 12VDC

Item	Model	Dimensions	Visibility	Ship	Net
701431	2NMI12G	1.5" W x 3.25" H	2 NM	1 lbs	\$186.99



Signal Mate LED Stern Navigation Light

Suitable for sailboats and powerboats up to 164'

- Vertical Surface Mount
- Light Color: White, Housing Color: Black
- Operating Voltage: 10 - 30VDC
- Current Draw: 0.1 Amp @ 12VDC

Item	Model	Dimensions	Visibility	Ship	Net
701432	2NMI135W	1.5" W x 3.25" H	2 NM	1 lbs	\$186.99



Moeller Tank Fittings



- All ship at 1 lbs.
- Moeller fittings are designed and tested to meet OEM specifications and fit

Item	Model	Description	Net
305647	033418-10	Mercury female fuel line, engine and tank connector, 3/8" barb	\$12.99
305648	033498-10	Honda (1991 or newer) fuel line to tank, female quick connect, 3/8" barb	18.99
305649	033488-10	Suzuki fuel line to tank, female quick connect, 3/8" barb	13.99
305650	033503-10	Suzuki (up to 75 hp) fuel line to tank, male quick connect, 1/4" NPT	9.99

2013 Catalog Addendum- New

Allen OEM Replacements for Laser Sailboats

OPEN BASE FAIRLEAD

- Location: Laser Traveler, Sold (2) per Package
- Inside Diameter: 9 mm
- Mounting Holes Size: 4 mm
- Distance between Mounting Holes: 23 mm

Item	Model	Material	Ship	Net
606361	A282A	Aluminum	1 lbs	\$18.99
606362	A282	Acetal	1 lbs	5.99



BOW FAIRLEAD

- Location: Laser Bow
- Mounting Holes Size: 5 mm
- Distance between Mounting Holes: 49 mm

Item	Model	Material	Ship	Net
606363	A134	Acetal	1 lbs	\$13.99



SINGLE V-CLEAT BLOCK WITH BECKET

- Location: Laser Upper Vang
- Line Size: 4-6 mm
- Shackle Pin: 5 mm
- Safe Working Load: 310 kg
- Breaking Load: 620 kg

Item	Model	Material	Ship	Net
606364	A93	Stainless steel and pressure die-cast aluminum with Acetal sheaves	1 lbs	\$20.99



FIDDLE V-CLEAT BLOCK

- Location: Laser Upper Vang
- Line Size: 4-6 mm
- Shackle Pin: 5 mm
- Safe Working Load : N/A
- Breaking Load: 200 kg

Item	Model	Material	Ship	Net
606365	A165LZ	Stainless steel and pressure die-cast aluminum with Acetal sheaves	1 lbs	\$24.99



SINGLE BLOCK WITH INGERFIELD CLIP

- Location: Laser Traveler (Small)
- Size: 29 mm
- Length: 69 mm
- Line Size: 8 mm
- Breaking Load: 250 kg
- Safe Working Load: 140 kg

Item	Model	Material	Ship	Net
606366	A178-74	Nylon	1 lbs	\$8.99



Dr. LED Edison SideKick 3X LED with Household Style Base

- Base: Medium Edison Screw Base E26/E27
- Power: 12 VAC/DC or 24 VDC, Draw: 3-5 watts
- Includes (3) US Made High-Power LEDs
- Warm White Replaces 60 Watt Incandescent Bulbs

Item	Model	Light Color	Ship	Net
701454	8001818	Warm White	1 lbs	\$36.99



SINGLE BLOCK

- Location: Laser Mid Boom
- Length: 66 mm
- Line Size: 10 mm
- Breaking Load: 300 kg
- Safe Working Load: 155 kg

Item	Model	Material	Ship	Net
606367	A278	Nylon	1 lbs	\$10.99



SINGLE BLOCK WITH INGERFIELD CLIP

- Location: Laser Traveler (Big)
- Size: 38 mm
- Line Size: 10 mm
- Safe Working Load: 155 kg
- Length: 86 mm
- Breaking Load: 300 kg

Item	Model	Material	Ship	Net
606368	A278-74	Nylon	1 lbs	\$12.99



SINGLE BLOCK WITH BECKET

- Location: Laser Rear Boom (with Becket)
- Size: 38 mm
- Length: 85 mm
- Line Size: 10 mm
- Breaking Load: 300 kg
- Safe Working Load: 155 kg

Item	Model	Material	Ship	Net
606369	A378	Nylon	1 lbs	\$12.99



ALLEN DRAIN PLUG

- Location: Transom (420 Lasers, etc.)
- Includes Captive Drain Plug, Plug Diameter: 17 mm
- Mounting Holes Size: 3 mm
- Distance between Mounting Holes: 38 mm
- Outside Hole Diameter: 24 mm

Item	Model	Color	Ship	Net
606370	A323	Gray	1 lbs	\$3.99



ALLEN DRAIN SOCKET

- Location: Transom (Current Lasers)
- Mounting Holes Size: 4 mm
- Distance between Mounting Holes: 36 mm
- Outside Hole Diameter: 22 mm
- Inside Hole Diameter: 17 mm

Item	Model	Color	Ship	Net
606371	A423	Black	1 lbs	\$4.99



Simrad Auto Pilot Packages - For Ruddered Vessels



- Includes:
- Starter Kit NMEA 2000 (with all below packages)

Typically Used on Boats Under 40 Feet

Item	Model	Core Pack	Rate Compass	Rudder Feedback	Ship	M.A.P.
259559	000-11036-001	AC12	RC42	RF300	8 lbs	\$1600.00
	Low CurrentVRF					
259560	000-11037-001	AC12	RC42	sold separately	6 lbs	1350.00
	Low Current					

Typically Used on Boats Over 40 Feet

Item	Model	Core Pack	Rate Compass	Rudder Feedback	Ship	M.A.P.
259562	000-11038-001	AC42	RC42	RF300	9 lbs	\$2250.00
	High CurrentVRF					
259561	000-11039-001	AC42	RC42	RF300	7 lbs	2000.00
	High CurrentVRF					

2013 Catalog Addendum- New

Digital Antenna DM547 Universal Cell Phone Cradle

The DM547 Universal Cell Cradle with built-in antenna makes amplifying your cell signal simple. The adjustable cradle holds any size cell phone, including PDA phones and the iPhone 3G. It couples to your cell phone's antenna. When used with Digital Antenna's DA4000MR 3 watt 40dB gain dual band repeater or DA4000 3 watt direct connect amplifier (both sold separately), you will experience up to 10 times the signal strength.



Cell phone not included

Features:

- Compatible with all cell phones
- Built-in antenna
- Flexible and easy to use
- Includes a 3M adhesive back mounting bracket with a screw mount option
- Quick release button
- Adjustable holding feet

DM547 Universal Cell Phone Cradle

- Frequency: 800-2500 MHz
- Connector: Mini-UHF male
- Cable: Includes 10' of premium RG174 cable
- Impedance: 50 ohm
- Insertion Loss: 2dB

Item	Model	Description	Ship	Net
259625	DM547	Cradle with built-in antenna	1 lbs	\$29.99

Simrad RS35 Fixed Mount VHF Radio



Full Featured VHF with expansion options – suitable for any user.

- Class D DSC Approved, Selectable Transmit Power: 25 /1 Watt
- Power: 12 VDC, Max Draw: 1.5 Amps
- Waterproof to JIS-7 Standard, NMEA 0183 and NMEA 2000 Compatible
- Added value with built in AIS receiver – one antenna required
- Sophisticated wireless handset with unique inductive charging
- Easy to use – large screen packed with info, proven rotary controls
- Large 57mm diameter speaker for loud and clear audio – 94dBA @ 1m
- High quality fist mic:
 - Built-in speaker for noisy environments
 - 6 keys for easy helm operation
 - Easy grip rubber over moulding
- Advanced radio features including AIS plot, waypoints, navigation and MOB features
- Track your buddy when connected to a Navico MFD
- PA/Hailer horn output with Listen back feature
- Flush mount kit and sun cover included as standard

Item	Model	Ship	M.A.P.
259473	000-10790-001	6 lbs	\$349.00

Simrad HS35 Wireless Handset



HS35 Handset features and functionality

- 2 Handsets can be connected to a RS35
- Inductive charging, no contacts to corrode
- AIS Vessel information on LCD
- 2.4GHz DSSS wireless technology
- Handset operable up to 100m from base, so potentially up to 200m handset to handset
- Squelch adjustable
- Volume control by up/down key
- Backlight adjustable
- INTERCOM function
- Built-in microphone and 0.5W speaker
- 3.7V 830mAh Li-Polymer battery
- Battery life: 8 hours

Item	Model	Ship	M.A.P.
259474	000-10791-001	2 lbs	\$149.00

Ronstan Windshift Floating Sunglasses



- Self darkening/lightening Photochromic lenses
- Lightweight, comfortable and durable
- Complies with US standard ANSI Z80.3-2001 and Australian Standard AS/NZS 1067.1-2003
- Supplied with strap and case

Item	Model	Description	Ship	M.A.P.
150438	RF4042	Polarized Gray lenses with Tortoise shell frame	1 lbs	\$67.15

Boss Audio Systems MCK1308WB.6 Marine Multimedia Receiver and Speakers Package



Kit Includes:

- MR1308UAB In-Dash, Single-Din, Multimedia, AM/FM Receiver
- (2) 6.5" MR6W Marine Speakers
- MRANT10 Marine Dipole Antenna



MR1308UAB Marine Multimedia Receiver

Features:

- Includes Bluetooth wireless compatibility
- Output Power: 50 Watts x 4 Channels
- Single-DIN Mounting
- Active Black Mask Display
- ID-3 Tag Display
- Zero Current Draw Memory
- PLL Synthesized AM/FM Tuner
- (30) Station Presets
- Switchable USA/Europe Radio Frequencies
- USB and SD Memory Card Ports
- Front Panel AUX Input
- Compatible with Audio Output of iPod®, other MP3 Players
- RCA Outputs
- Illuminated Control Buttons
- Stereo/Mono & Local/Distance Switches
- Separate Bass and Treble
- Balance and Fader Controls
- Loudness
- Quartz Digital Clock
- Wireless Remote Control

Boss MR Series Speakers Specifications:

- Size: 6.5"
- Peak Handling Power: 180 Watts
- Dual Cone
- 1" Aluminum Voice Coil
- Grill Color: White

Item	Model	Ship	Net
259628	MCK1308WB.6	7 lbs	\$104.99

Boss Audio Systems MR360UV In-Dash Multimedia Marine Stereo Radio with Monitor



Package Includes:

- Single Din Marine Receiver with 3.6" Monitor
- DVD/MP3/CD
- Drop Down Detachable Front Panel
- AM/FM/RDS, USB/SD Card Slot
- Front AUX Input
- Wireless Remote



Features:

- Chassis Mounting: Single DIN
- Screen Size: 3.6" Widescreen
- Monitor Display Format: LCD-TFT
- On Screen Display Menu
- AM Stations: (12)
- 30 Stations Preset
- RDS (Radio Data System)
- USB Input: Full Size Front panel
- Illumination Controls
- Balance and Fader Adjustment Control
- Stereo/Mono Selection Switch
- Loudness
- Auto Memory Store/Prescan Button
- ESP (Anti Skip Mechanism)
- 8x Oversampling
- Speaker Outputs Channels: 4
- SD/MMC Memory Card Port Input: Behind Panel
- Disc Player Compatible: DVD, DVDR, DVDRW, VCD, MP4, MP3, CD, CDR, CDRW, WMA
- Detachable Front Panel
- Flip-down Front Panel
- TV System Compatible: NTSC, PAL
- PLL Synthesized AM/FM Tuner
- FM Stations: (18)
- Switchable Radio Regions: USA, EUROPE
- Disk Player Mechanism: DVD
- AUX Input: Front panel
- Separate Bass and Treble Adjustment Control
- Mute
- Local Distance Switch
- Digital Clock Display
- Last Position Memory
- I-bit D/a Convertor
- Remote Control
- Total Output Power: 320 Watts

Item	Model	Ship	Net
259629	MR360UV	6 lbs	\$164.99

2013 Catalog Addendum- New

Sea-Dog Stainless Steel D-Ring

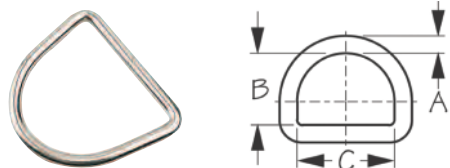

Item	Model	A	B	C	Ship	Net
756212	191830	3/16"	5/16"	1-1/16"	1 lbs	\$0.99
756213	191841	1/4"	1-3/4"	2"	1 lbs	1.99
756214	191851	5/16"	1-3/4"	2"	1 lbs	2.99

Sea-Dog Shock Cord C-Hooks

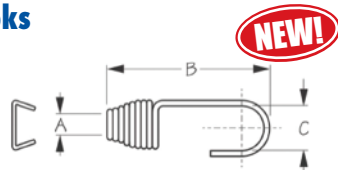

- Material: Formed 304 Stainless
- Easy hook attachment for shock cord
- Slip shock cord into attachment, tie a knot or use c-clamp to make a loop
- Includes (2) hooks and (2) crimps

Item	Model	A	B	C	Ship	Net
756198	657106-1	3/8"	2-5/8"	15/16"	1 lbs	\$3.99

(REPLACES SKU ON PAGE 179)

Boji Regular Capacity Water Softening System



SS4015



C232

- Provides filtered and softened water for drinking, bathing and washdowns
- Special water treatment cartridge eliminates water spots without wiping
- Rechargeable with pelletized water softener salt cubes

Kit contains:

- (1) Boji marine filter/softener (1) 36" Hose
- (1) Prefilter canister with Carbon filter cartridge (1) 6" Hose
- (1) Package of regeneration salt

Item	Model	Description	Grain Capacity	Ship	Net
D 502311	SS4015	Regular Capacity	4740	28 lbs	\$299.99
D 502312	SS6015	High Capacity	9622	61 lbs	349.99
502313	C232	Replacement cartridge for SS4015 and SS6015		1 lbs	15.99

Myerchin Offshore Safety/Dive Pro Knife

- Blade Type: Serrated, Non-Folding
- Sheepsfoot Blade Design
- Material: Pro-Grade German Marine Stainless Steel

Item	Model	Blade length	Total length	Ship	Net
605822	A510P	3.8"	8.5"	1 lbs	\$48.99



SPOT Satellite Global Phone

Spot's Satellite Global Phone delivers the convenience you'd expect from a mobile phone. Keep in touch with friends, family and Emergency Personnel while you travel.

Features:

- Airtime Service Plans available through SPOT (required, sold separately through SPOT)
- Crystal clear voice quality
- Data connectivity to send email and access the internet (optional data kit required)
- Most competitive airtime pricing
- Long-life Lithium-ion battery providing 4 hours of talk time or 36 hours standby
- Local phone number
- Smallest, lightest handset
- 911 Emergency Response
 - In event of life-threatening emergency, reach out to GEOS International Response Coordination Center by dialing 9-1-1
- Voicemail
 - Never miss an important connection when you are unavailable - access your voicemail easily from your phone
- Email
 - Use the optional data kit to connect your SPOT Global Phone to your computer to check and respond to emails
- Text Messages
 - SPOT Global Phone can receive 35-character text messages from friends and family back home
- Calling Features
 - Any key answer
 - Standard international dialing ("+" prefix)
 - User configurable ringtones (8)



Specifications:

- Operating Temperature Range: -20 to +55 C (-4 to +131 F)
- Storage Temperature Range: -40 to +85 C (-40 to +185 F)
- Battery Type: Lithium-Ion 3.7V, 2600mAh
- Dimensions: 5.3" H x 2.2" W x 1.5" D (13.5 cm x 5.6 cm x 3.8 cm)
- Data Network
 - Send emails, surf internet, transfer files easily and quickly
 - USB data cable (port speed up to 38,400 bps) (Sold Separately)
 - Express Data provides up to 28 kbps throughput (Uncompressed Speed 9600 bps) (Additional Fees May Apply)
- Usage Control Features
 - User-configurable call timers
 - "Minute alert" to manage costs
 - Keypad lock and security lock code
- Display: 4-line, 12-character LCD - Volume, signal and battery indicators
- Memory
 - 9 entry internal address book
 - Call history - received, missed and dialed calls

Item	Model	Ship	Net
255160	SPOT-PHONE-B-254	2 lbs	\$499.99

Shurhold Brite Bonnet Final Polish Pad

- Designed to be used to remove excess wax and buff your surface to a final shine
- Designed with a vapor barrier inside so it may be fitted over a wet wax pad for quick use
- Stretch pad and fit over Shurhold's Pro Polish Pad
- Hand wash when done and air dry



Item	Model	Description	Ship	Net
756192	3153	Shaggy microfiber pad	1 lbs	\$10.99

2013 Catalog Addendum- New

First Watch Flotation Bomber Jacket & Coat



Features:

- USCG Approved Type III PFD
- Most safety gear is bulky, cumbersome and looks awkward and clumsy to wear
 - The AB-1100 Flotation Bomber Jacket is sleek looking and modern
 - With all the weather features of First Watch's extreme Anti Exposure Suit, this great looking coat fits and moves like no other flotation jacket
- High visibility SOLAS panels and hood coloring
- Reinforced 500 Denier elbow and cuffs
- Fleece lined hand warmer pockets
- High visibility stowaway thermal hood
- Ripstop shell
- Neoprene lined wrist cuffs to minimize water ingress

First Watch Gear General Features:

- First Watch Gear Flotation Bombers, Coats and Pants are engineered to enhance comfort and safety by incorporating an exclusive MMS System
- MMS® Technology: Mobility - Moisture - Safety
- Mobility: Articulated arms and legs means the garment bends with you
 - First Watch super soft foam provides the flexibility for active boating movements
- Moisture Barrier: Soft foam provides buoyancy and creates a barrier to rain entry
 - Internal bonded foam panels form a complete water barrier
 - When immersed, MMS helps you retain precious body heat
- Safety: Foam gives USCG approved flotation and helps retain body heat

Please specify color: Orange/Gray or Red/Black

Item	Model	Size	Description	Ship	Net
150464	AB-1100	S-XXL	Jacket	5 lbs	\$179.99
150466	AC-1100	S-XXL	Coat	6 lbs	199.99

FIRST WATCH FLOTATION HIGH VISIBILITY BOMBER JACKET & COAT

Colors: Hi-Vis Yellow/Black

Item	Model	Size	Description	Ship	Net
150465	AB-1100 HV	S-XXL	Jacket	5 lbs	\$199.99
150467	AC-1100 HV	S-XXL	Coat	5 lbs	219.99

First Watch Flotation Bibs



- Designed to keep you dry and warm
- Lined with super soft flotation foam that is both thin and flexible for all-day comfort
- Although not classified as a PFD, these pants provide positive buoyancy and when worn in combination with a USCG approved PFD offer an extra layer of protection and warmth
- APPROVAL: Not classified as a PFD - must be worn with USCG approved PFD

Item	Model	Size	Ship	Net
150467	AP-1100	S-XXL	5 lbs	\$219.99



Forespar StaPlug™ Soft Cone-Shaped Emergency Plugs



- The StaPlug™ replaces the Original TruPlug Soft Cone-Shaped Emergency Plug
- The original design has been greatly improved by the addition of ridges
- This is the adaptable alternative to the hard wooden bung plug
- StaPlug is the modern solution for emergency leaks on any boat
- Developed by Artelier Studio LLC and distributed by Forespar, the StaPlug is a soft, cone shaped plug designed to conform to the unpredictable shapes of most hull breaches
- Whether it's a round hole caused by mechanical failure or an elongated tear due to impact, StaPlug's shape adapts to the leak
- Tapered circular cone shaped plug made of a proprietary foam formulation
- Solid, spongy and coated with a flexible sealer

Item	Model	Dimensions	Ship	Net
552002	150110	9"(High) x 5"(Base)	1 lbs	\$15.99

Mustang 4-One Adult Life Jacket/PFD



The first and only lifejacket to have earned (4) Regulatory Approvals in (1) compact design!

- USCG Approved Type I, Off Shore Life Vest
- Approved to USCG SOLAS, TC SOLAS, MED SOLAS and USCG Type I standards
- Eases both the hassle and financial burden associated with compliance to a variety of vessel regulations
- The design scores highly on compact storage, easy donning and in-water performance
- Attachment point for personal light (light not included)
- Buoyant buddy line
- Lifting loop
- USCG Type I Lifejacket
- USCG SOLAS
 - SOLAS grade reflective tape
 - Accessory tab with SOLAS approved whistle
- Marine Equipment Directive SOLAS
- Transport Canada SOLAS

Specifications:

- Chest Measurement Maximum: 69" (175 cm)
- Weight: Over 90 lbs (over 41 kg)
- Dimensions 24-3/4"L x 12-1/2"W x 5-3/4"D (63cm x 32cm x 15cm)

Stowing Procedure:

- Stack vests head to toe and front to front, for optimal space savings
- When stowed properly, (2) vests stacked on top of each other will take up just 11-1/2" of depth

Item	Model	Description	Ship	Net
552435	MV8040	International Orange, Adult Model	2 lbs	\$79.99

Mustang 4-One Child Life Jacket/PFD



The first and only lifejacket to have earned (4) Regulatory Approvals in (1) compact design!

- USCG Approved Type I, Off Shore Life Vest
- Approved to USCG SOLAS, TC SOLAS, MED SOLAS and USCG Type I standards
- Eases both the hassle and financial burden associated with compliance to a variety of vessel regulations
- The design scores highly on compact storage, easy donning and in-water performance
- Attachment point for personal light (light not included)
- Buoyant buddy line
- Lifting loop
- USCG Type I Lifejacket
- USCG SOLAS
 - SOLAS grade reflective tape
 - Accessory tab with SOLAS approved whistle
- Marine Equipment Directive SOLAS
- Transport Canada SOLAS

Specifications:

- Chest Measurement Maximum: 55" (140 cm)
- Weight: 33-90 lbs (15-41 kg)
- Dimensions: 22"L x 11-3/8"W x 4-3/8"D (56cm x 29cm x 11cm)

Stowing Procedure:

- Stack vests head to toe and front to front, for optimal space savings
- When stowed properly, (2) vests stacked on top of each other will take up just 11-1/2" of depth

Item	Model	Description	Ship	Net
552436	MV8035	International Orange, Child Model	2 lbs	\$73.99

2013 Catalog Addendum- New

FUSION Marine 2-Way Speakers-Pair



FUSION's Full Range Marine Speakers are designed and engineered specifically for the marine environment and include design innovations and materials that not only produce great sound, but also ensure a sustained high performance level during prolonged exposure to the marine elements.

- Incorporates the latest German 'CURV' cone technology and titanium tweeter dome for clear, powerful sound in the harsh marine environment
- Complies with IP65 Waterproof and Dust Standards and features a fully sealed cross-over, magnet and tweeter housing with waterproof cone and surrounds
- 'CURV' technology incorporates a woven fibre composite which is heat pressed to form a lighter and stronger cone
- Engineered to minimize magnetic interference to navigational equipment

Package Includes:

- (1) Pair Speakers
- (8) Stainless Steel Mounting Screws
- Manual
- Mounting Template
- (2) Tinned Speaker Wires
- (1) Pair Mounting Gaskets
- Warranty Card

Specifications:

- Tweeter Type: Titanium Dome
- Flush Mount
- Impedance: 4 Ohms

Item	Model	Size	Max power	Grills	Ship	M.A.P.
259614	MS-FR4021	4"	120 W	(1 pair) White	4 lbs	\$89.99
259615	MS-FR6021	6"	200 W	(1 pair) White and (1 pair) Black	7 lbs	149.99
259616	MS-FR7021	7"	260 W	(1 pair) White, (1 pair) Black and (1 pair) Standard	9 lbs	169.99

RAILBLAZA 32-41 RailMount with StarPort Multifunctional Mount

RAILBLAZA RailMounts are simple-to-use mounts that allow the easy attachment of RAILBLAZA accessories, and many other things, to your rails.

- The RailMount 32-41 is specifically designed for both Circular and Square 32 mm (1.25 inch) rails, and 41 mm (1 5/8") round rails (found on Hobie kayak outriggers)
- Simply screw together
- No spacers are required for 32 mm round rails
 - (1) Pair of spacers for 32 mm square rails
 - (2) Pairs of spacers for 41 mm round rails
 - Includes rubberized inserts to reduce longitudinal slippage on both types of rails, as well as rotational slippage on circular rails
- A length of self-adhesive grip tape is supplied for extra grip
- These RailMounts have been designed with the Aka rails on Hobie kayaks in mind, finally giving Hobie enthusiasts an off-the-shelf solution to mount a whole range of accessories to their rails
- Once installed with a StarPort receiver, the entire StarPort range of accessories can be attached to your rail, including bait boards, rod holders, G-Holds, hooks, drink holders and many more
- RAILBLAZA accessories are interchangeable on the mounts



Kit Includes:

- (1) RailMount 32 kit
- (4) Spacers
- (2) M6 Nuts
- (2) Non-slip rubber inserts
- (4) M6 x 65 Machine Screws

Please specify color: Black or White

Item	Model	Description	Ship	Net
701458	03-4013	RailMount with mounting hardware	1 lbs	\$24.99

RAILBLAZA Rod Holder II

- A robust, versatile, and a value for the money
- Designed to hold your rod in any position
- Rotating collar helps reduce "Strike-Theft"
- Rear gimbal lock reduces rod rotation for compatible rods; lift to slide rods through
- Fully adjustable 360° around, over 90° vertical
- Easy access to reel when in position
- Square-tooth adjustable tilt stops rotational slipping



Item	Model	Color	Ship	Net
701459	02-4020-11	Black	1 lbs	\$24.99

FUSION-Link Enabled Marine Stereo Receiver Packages



MS-RA205KTS

MS-RA205KTS D

MS-RA205KTS SYSTEM INCLUDES:

- **MS-RA205 - FUSION-Link Enabled True Marine Stereo**
 - Media AM/FM Tuner, VHF Receiver, USB, AUX, SiriusXM-Ready
 - Input: Auxiliary In, Line Out: (1) Stereo (1) Subwoofer
 - Power: 12 Volt DC
 - NMEA 2000 Certified
 - This fully featured compact marine stereo delivers powerful, clear and dynamic sound
 - Powered by the advanced ARM-9 Processor, the MS-RA205 offers quick and intuitive audio control
 - FUSION's iPod interface allows navigation of the iPod menu structure and offers selection of songs by artist, song, playlist, album, genre or composer
 - VHF Receiver: Listen to marine VHF channels, add user presets, scan channels and adjust squelch
 - Die Cast Construction: Engineered to withstand the harsh marine environment including salt spray, humidity and pounding sea
 - ☆ Complies with IPx5 Water resistant standards, on the front of the unit when correctly bulk head mounted

(2) MS-EL602 Fusion Shallow Depth Flush Mount Speakers

- Depth: 1-5/8"
- 2-Way Speaker
- Unique Polypropylene Cone and PEI Tweeter
- Diameter: 6"
- Max Power: 150 Watts
- Water Resistant

MS-RA205KTS D INCLUDES SAME COMPONENTS AS ABOVE PLUS:

- **MS-DKIPUSB Fusion Marine Portable Media Device Dock for iPod and iPhone**
 - USB Input
 - Video Output

There are two installation options for the Marine Dock for iPod:

- A fully sealed bulkhead mount dock for instrument panel or exterior installation
- A wall mount dock for cabin or interior installation

Includes adapter Sleeves Compatible with the Following iPod Models:

- iPod with video, 30GB, 60GB, 80GB
- iPod classic, 80GB, 120GB
- iPod classic, 160GB (2007)
- iPod classic, 160GB (2009)
- iPod touch
- iPod touch, 2nd gen
- iPod nano, 3rd Gen
- iPod nano, 4th Gen
- iPod nano, 5th Gen
- iPhone
- iPhone 3G
- iPhone 3GS

Item	Model	Description	Ship	M.A.P.
259654	MS-RA205KTS	MS-RA205, MS-EL602 Speakers	8 lbs	\$299.99
259655	MS-RA205KTS D	MS-RA205, MS-EL602 Speakers & MS-DKIPUSB Dock for iPod/iPhone	10 lbs	349.99

RAILBLAZA Single StarPort Multifunctional Mount

The RAILBLAZA StarPort™ is a unique and versatile multifunctional mount, which is used in a huge number of applications and allows users to fit and swap out RAILBLAZA's full range of RAILBLAZA accessories.



- Material: High grade engineered plastics (Acrylonitrile Ethylene Styrene)
- StarPort is stylish and easy to fit
- Can be surface or recess mounted on power boats, inflatables, sail boats, kayaks, ATVs, garages and many other applications
- Low profile surface mount and minimal intrusion depth when recess mounting
- Includes a stylish locking slide for securing accessories firmly in place
- Gasket and bung reduce water ingress

Kit Includes:

- (1) StarPort
- (1) Weather-tight gasket/cover
- (2) (M6 x 32 mm) Bolts, washers & nuts
- (1) Surface mount adapter rings
- (2) 12-Gauge 32 mm self-tapping screws

Please specify color: Black or White

Item	Model	Description	Ship	Net
701455	03-4015	Mounts vertically or horizontally	1 lbs	\$14.99

2013 Catalog Addendum- New

RAILBLAZA RIBPort with StarPort Multifunctional Mount

- Designed to add useful StarPort attachments to your inflatable boat without having holes cut into the tubing
- RIBPort™ comes complete with StarPort™ and suitable for both PVC and Hypalon tubes
- Completely compatible with all StarPort accessories



Kit Includes:

- (1) RIBPort (150 x 114 x 21 mm) and (1) StarPort

• Adhesive required (sold separately)

Materials:

- StarPort: AES - (Acrylonitrile Ethylene Styrene)
- RIBPort: Non-leeching
- PVC Accessories: 15% glass-filled nylon Stainless Steel Fasteners

Please specify color: Black, White or Gray

Item	Model	Ship	Net
701456	03-4004	1 lbs	\$19.99

RAILBLAZA 19-25 RailMount with StarPort Multifunctional Mount

- Simple-to-use mount
- Allows the easy attachment of RAILBLAZA accessories, and many other things, to your rails
- Combine them with a RAILBLAZA Platform or TracPort Dash 500 and the possibilities are endless
- The RailMount 19-25 can be mounted onto any 19-25 mm (.75-1") rail in minutes
- Packaged as a single RailMount and StarPort combo
- All RailMounts come complete with adapters, rubber grips, self-adhesive grip tape and the necessary stainless steel mounting screws
- Strong and quick to fit
- No clearance required underneath, the (2) screws are fitted from the top
Greater gripping power with the addition of grip tape



Kit Includes:

- (1) RailMount 19-25 (Top and Bottom Sections)
- (1) Rail diameter adapter (20 - 25 mm)
- (2) Non-slip rubber inserts
- (1) Self-adhesive grip tape
- (1) StarPort with gasket
- (2) M6 x 50 Screws
- (2) M6 Nuts

Please specify color: Black or White

Item	Model	Ship	Net
701457	03-4011	1 lbs	\$19.99