

scala rider[®]

Solo[™]

cardo
communication in motion[™]



Gebrauchsanleitung
Guide d'Utilisation
Guida di Avvio
Guia de Usuario

 Bluetooth

User Guide



© Cardo Systems, Inc.

The *Bluetooth*® word mark and logos are owned by the Bluetooth SIG, Inc. and any use of such marks by Cardo Systems, Inc. is under license.

Other trademarks and trade names are those of their respective owners.

INTRODUCTION

Dear Biker,

Congratulations, and thank you for choosing the **scala rider Solo** *Bluetooth*® Headset for bikers.

The **scala rider Solo** headset offers the following communication options:

1. *Bluetooth* headset for mobile phone communication, supporting Headset* and Handsfree* profiles (10m / 33 ft. range)
2. Transmitting GPS navigation instructions from a *Bluetooth* enabled GPS device
3. MP3 Connectivity – Listen to your MP3 Player while riding

This manual will help you operate the headset, but you should first familiarize yourself with the *Bluetooth* functionality of your mobile phone and/or GPS device before using the **scala rider Solo**.

Cardo wishes you an enjoyable and safe **scala rider Solo** experience!

* Mobile phones that do not support the *Bluetooth* Handsfree profile may prevent you from using the Redial and Call Reject features.

CONTENTS OF RETAIL BOX

Headset



CTRL – Control Button

- Power On, Power Off
- Answer or initiate calls
- Pair

Redial / Reject button

- End / Reject calls
- Redial Function

Helmet Clamp

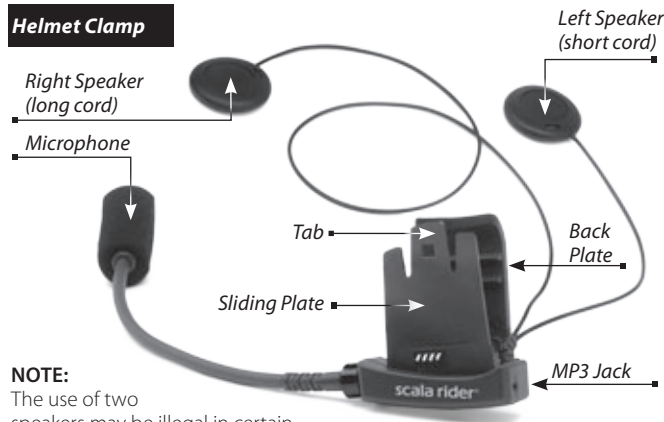

NOTE:

The use of two speakers may be illegal in certain jurisdictions. Please check the local regulations and act accordingly.



Wall Charger	
Allen Wrench	
Velcro Pads	
MP3 Cable	
MP3 Cable Holder	
Glue Plate	
Pre-moistened Towelette	
Carry-Pouch	
Microphone sponges	
Flat sponge for full-face helmets and round sponge for other helmet types	
User Guide, including Warranty and Registration form	

IMPORTANT:

The **scala rider Solo** is a water-resistant device, designed for use under moderate rain or snow conditions. However, the **headset is not waterproof** and should not be used under severe weather conditions.

The cover tongue protecting the Charging Jack should be kept tightly closed at all times to prevent moisture from entering the device.

BEFORE USING (CHARGING THE HEADSET)

Make sure that the headset is fully charged for at least four hours before initial use.

1. Connect the wall charger to the headset's Charging Jack (located between the two Volume Buttons).
2. While charging, the Red Light turns on (it may take up to 15 seconds until the Red Light turns on). When charging is complete, the Red Light will turn off.

SET UP AND CONFIGURATION

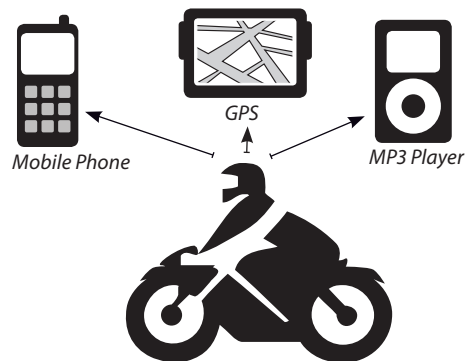

SET UP FOR MOBILE PHONE CALLS

If you have a *Bluetooth* enabled mobile phone and would like to make and receive phone calls using the **scala rider Solo**, you must first pair your headset to the mobile phone.

Pairing is a one time process. Once the headset is paired to a specific mobile phone during this Setup Procedure, they will remain paired and automatically recognize each other whenever they are within range. If the connection between the phone and headset is lost, tap the CTRL button to reconnect the devices.

TO PAIR THE SCALA RIDER SOLO TO A *BLUETOOTH* MOBILE PHONE

1. Turn on your phone and make sure its *Bluetooth* function is activated.
2. With the **scala rider Solo** headset turned OFF, press and hold the CTRL Button until the Red and Blue Lights begin rapidly alternating.
3. Search for *Bluetooth* devices on your phone by following the phone's instructions. Please consult your phone's User Manual for more information.

4. After a few seconds the phone will list the **scala-rider** as a discovered device. Select it and follow your phone's instructions to accept the pairing.
5. When prompted enter 0000 (four zeros) as your PIN or passkey.
6. Your phone will confirm that pairing has succeeded and the headset will begin flashing slowly in Blue.

NOTE: If the Pairing process is not completed within two minutes the headset will return to Standby mode.

With some mobile phones, you may need to tap the CTRL button to connect the headset to the phone after pairing is complete. The **scala rider Solo** headset will automatically connect to the last phone connected to the headset.

SET UP FOR *BLUETOOTH* GPS DEVICE



If you have a Bluetooth enabled GPS device and would like to transmit navigation instructions and sounds from the GPS device through the headset's speakers, please follow instructions described in section below "TO PAIR

THE SCALA RIDER SOLO TO A *BLUETOOTH* GPS DEVICE"

If you want to use your mobile phone and your GPS device with the **scala rider Solo** headset, you should proceed as follows:

1. Pair your GPS device to your mobile phone (Please consult your GPS device's User Manual for more information).
2. Pair your headset to the GPS device as described below.

NOTE: Not all *Bluetooth* enabled GPS devices allow connections to *Bluetooth* headsets like the **scala rider Solo**. Please consult your GPS device's User Manual for more information.

TO PAIR THE SCALA RIDER SOLO TO A *BLUETOOTH* GPS DEVICE:

1. Turn on your GPS device.

2. With the **scala rider Solo** headset turned OFF, press and hold the CTRL Button until the Red and Blue Lights begin rapidly alternating.
3. Search for *Bluetooth* headsets on your GPS device by following the device's instructions. Please consult your GPS device's User Manual for more information.
4. If your GPS device prompts for a PIN or Passkey enter 0000 (four zeros).
5. Your GPS device will confirm that pairing has succeeded. The headset will begin flashing slowly in Blue.
6. If you wish to use a *Bluetooth* mobile phone to make and receive calls through the headset, you must now pair your mobile phone to your GPS device by following your GPS and/or mobile phone's instructions.

NOTE: If the Pairing process is not completed within two minutes the headset will return to Standby mode.

ATTACHING THE CLAMP ON THE HELMET

The Helmet Clamp must be attached to the left side of the helmet. Once attached, the headset unit can be mounted or released from the Helmet Clamp at any time. If you wish to connect your MP3 player to your headset, please refer first to the assembly instructions listed in section: USING THE MP3 PLAYER WITH YOUR HEADSET.

There are two methods that can be used in order to attach the Clamp onto the helmet:

Standard Method: Recommended for most helmet types.

Glue Plate Method: Recommended for helmets to which the standard method cannot be applied, using the Glue Plate included in the box.





Standard Method

1. Use the enclosed Allen Wrench to loosen the two screws on the Back Plate.
2. Slide the Back Plate between the internal padding and the external shell of the helmet.
3. Adjust the clamp's location so that the microphone is located opposite your mouth and then tighten the screws. You may need to reposition the Clamp repeatedly until you identify the best spot. The microphone must be positioned vertically and not horizontally.



Glue Plate Method

You have the option to glue the Helmet Clamp onto your helmet, when the above standard method cannot be used, or in case you prefer to secure the Helmet Clamp with adhesive glue. This option has been successfully used for a range of high end helmets.

NOTE: While we have no reason to believe that the gluing option might negatively affect any helmet, Cardo does not assume any responsibility to that affect, irrespective of its nature and circumstances. The Glue Plate is offered as a free option that you may choose to use at your own risk and subject to renouncement of any future claims.

Caution: This process can be done only once!

1. Use the enclosed Allen Wrench to remove both Allen screws and release the Helmet Clamp's back plate.
2. Determine the location on the helmet where the Helmet Clamp must be attached.



3. Adjust the Helmet Clamp's location on the Helmet so that the microphone is located opposite your mouth. You may need to reposition the Clamp repeatedly until you identify the best spot. The microphone must be positioned vertically and not horizontally (Be sure to clean the selected area prior to the gluing process).



4. Use the pre-moistened Towelette to clean the helmet area where you want to install the Glue Plate. Allow to dry thoroughly.
5. Peel the foil cover from the Glue Plates' adhesive pad.
6. Place the Glue Plate into position according to #3. Press firmly 15 seconds on all 3 parts of the Glue Plate.
7. The adhesive pad bonds to full strength over the next 24 hours. Therefore it is recommended to not use the headset during this 24 hour period.
8. Fasten the Clamp to the Glue Plate using the Allen screws that were previously removed.

POSITIONING THE SPEAKERS

Attach the speakers to the Velcro inside your helmet opposite your ears (short speaker cord for the left ear [A] and the long speaker cord [B] for the right ear). You may want to use the supplied Velcro pad.

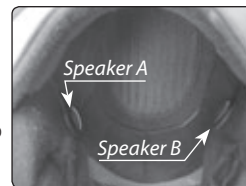

Using two speakers inside the helmet may be prohibited in certain jurisdictions. If this is the case, you should tuck away the long corded speaker underneath the helmet padding as follows:

Lead the speaker cord [B] alongside the rim of the padding to the right side and then back to the left side, near speaker [A]. Then place the speaker [B] underneath the padding.

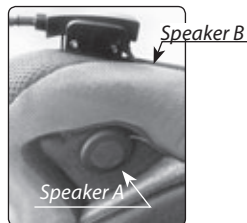
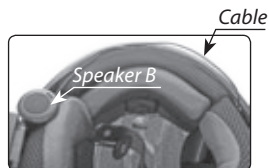

ATTACHING AND REMOVING THE HEADSET FROM THE HELMET CLAMP

ATTACHING:

Slide the headset downwards along the sliding panel until a clicking sound indicates that the headset is locked in place.



REMOVING:

Your headset can be removed for charging and storage by pressing your finger gently against the tab and sliding the headset up with the other hand.

We recommend that you remove the headset from the helmet when not in use.

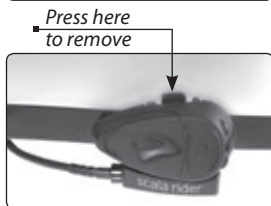

AUDIO SOURCES AND PRIORITIES

The different Audio Sources that are connected to the **scala rider Solo** are prioritized as follows:

Highest: 1. Mobile phone audio (Incoming/outgoing calls) / GPS device (GPS audio and navigation instructions)

Lowest 2. MP3 Connectivity

A high priority Audio Source will always interrupt any lower priority Audio Source. i.e. Mobile phone call overrides MP3 Player

USING THE HEADSET

GENERAL USAGE

GENERAL FUNCTIONS	
DESIRED RESULT:	REQUIRED ACTION:
Turn on the headset	Press the CTRL Button steadily for at least three seconds. Led indication: three blue flashes. Audio feedback: Ascending tone (low-high).
Turn off the headset	Press the CTRL Button steadily for at least three seconds. Led indication: three red flashes. Audio feedback: Descending tone (high-low).
Increase the volume	Tap the Volume Up Button
Decrease the volume	Tap the Volume Down Button

AGC (Automatic Gain Control): In addition to manual Volume Control, the **scala rider Solo** will automatically increase and reduce its volume according to ambient noise and driving speed.

INITIATING AND RECEIVING MOBILE PHONE CALLS

Voice Recognition – VR (VOX)

The VR feature allows you to answer or reject incoming calls by voice Control without having to remove your hands from the handlebars. The default mode of this feature is ON (enabled).

Each time you switch off and turn on the headset, the VR feature will be automatically enabled.

To disable / enable the VR feature press and hold the Volume Up and Volume Down simultaneously for three seconds during Standby. You will hear an ascending / descending tone confirming the change each time you switch this feature ON or OFF respectively.

Note: The VR feature works well while driving up to 70km/h or 44m/h with 3/4 helmet and up to 120km/h or 75m/h with a closed full-face helmet.

PHONE FUNCTIONS

Answer a call	Tap the CTRL Button or speak loudly any word of your choice.
Reject a call	Tap the Redial/Reject Button or remain silent for 15 seconds during an incoming call.
Terminate a call	Tap the Redial/Reject Button when a call is in progress.
Voice Dial	During Standby, tap the CTRL Button and state the name of the person you wish to call. This feature is supported only by mobile phones that support the Voice Dial feature.
Redial	During Standby, tap the Redial/Reject Button

NOTE: If your Bluetooth mobile phone is paired to a Bluetooth GPS device, not directly to the **scala rider Solo**, some of the above Phone functions may not be compatible.

STATUS LIGHTS

STATUS LIGHT	STATUS
None	Headset is off
Alternating Red/blue flashes	Mobile phone/GPS Pairing mode
1 blue flash every 3 seconds	Standby – No call is in progress
2 blue flashes every 3 seconds	Call is in progress
1 red flash every 3 seconds	Battery is low
2 red flashes every 3 seconds	Low battery while a call is in progress
Solid red	Charging

USING THE MP3 PLAYER WITH YOUR HEADSET



Your **scala rider Solo** headset can be connected to an MP3 player device by plugging it to the Helmet Clamp's jack with the MP3 cable.

In order to secure the MP3 cable tightly into place, please proceed as follows:

1. Use the enclosed Allen Wrench to remove both Allen screws from Helmet clamp and release the clamp's back plate.
2. Place the MP3 cable holder on the helmet clamp. Both pins

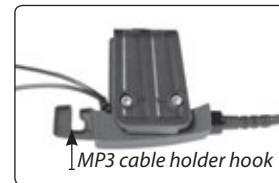

on the MP3 cable holder should be fixed into corresponding indentations on clamp.

3. Place the Back Plate on top of the MP3 cable holder and secure all parts together using the Allen screws that were previously removed, as shown in photo.
4. Attach the clamp and headset onto your helmet as described previously in section "ATTACHING THE CLAMP ON THE HELMET".
5. Attach the speakers to your helmet as described in section "POSITIONING THE SPEAKERS".
6. Connect the MP3 cable to your MP3 player device's jack and the other side to the helmet Clamp's jack, inserting the cable through the MP3 cable holder.
Make sure that the cable plug clicks into place.
7. Tuck the MP3 cable into the hook of the MP3 cable holder.
8. In order to use your MP3 player, power on the headset to have it on Standby mode, flashing slowly in Blue.

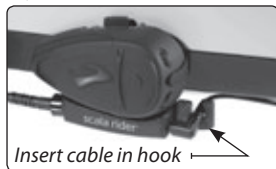

NOTE: Operate the MP3 Player device by using its buttons (FF/REW/PLAY/PAUSE).

Volume can only be adjusted through the MP3 Player.

Any other audio connection will automatically mute the MP3 Player. The audio signal will return only when headset is once again in Standby mode.

SUPPORT

For additional information please visit our website at

www.cardosystems.com

FAQ: **www.cardosystems.com/support/faq**

or contact us at: **support@cardosystems.com**

Phone:

USA and Canada: **+ 1-800-488-0363**

International: **+4989 450 36819**

NOTICES

Federal Communications Commission (FCC) Statement

15.21

You are cautioned that changes or modifications not expressly approved by the part responsible for compliance could void the user's authority to operate the equipment.

15.105(b)

This equipment has been tested and found to comply with the limits for a Class B digital device, pursuant to part 15 of the FCC rules. These limits are designed to provide reasonable protection against harmful interference in a residential installation. This equipment generates, uses and can radiate radio frequency energy and, if not installed and used in accordance with the instructions, may cause harmful interference to radio communications. However, there is no guarantee that interference will not occur in a particular installation. If this equipment does cause harmful interference to radio or television reception, which can be determined by turning the equipment off and on, the user is encouraged to try to correct the interference by one or more of the following measures:

- Reorient or relocate the receiving antenna.
- Increase the separation between the equipment and receiver.



- Connect the equipment into an outlet on a circuit different from that to which the receiver is connected.
- Consult the dealer or an experienced radio/TV technician for help.

Operation is subject to the following two conditions:

- 1) this device may not cause interference and
- 2) this device must accept any interference, including interference that may cause undesired operation of the device.

FCC RF Radiation Exposure Statement:

This equipment complies with FCC radiation exposure limits set forth for an uncontrolled environment. End users must follow the specific operating instructions for satisfying RF exposure compliance. This transmitter must not be co-located or operating in conjunction with any other antenna or transmitter.

Industry Canada (IC) Statement

15.21

You are cautioned that changes or modifications not expressly approved by the part responsible for compliance could void the user's authority to operate the equipment.

15.105(b)

This equipment has been tested and found to comply with the limits for a Class B digital device, pursuant to part 15 of the IC rules. These limits are designed to provide reasonable protection against harmful interference in a residential installation. This equipment generates, uses and can radiate radio frequency energy and, if not installed and used in accordance with the instructions, may cause harmful interference to radio communications. However, there is no guarantee that interference will not occur in a particular installation. If this equipment does cause harmful interference

to radio or television reception, which can be determined by turning the equipment off and on, the user is encouraged to try to correct the interference by one or more of the following measures:

- Reorient or relocate the receiving antenna.
- Increase the separation between the equipment and receiver.
- Connect the equipment into an outlet on a circuit different from that to which the receiver is connected.
- Consult the dealer or an experienced radio/TV technician for help.

Operation is subject to the following two conditions:

- 1) this device may not cause interference and
- 2) this device must accept any interference, including interference that may cause undesired operation of the device.

IC RF Radiation Exposure Statement:

This equipment complies with IC radiation exposure limits set forth for an uncontrolled environment. End users must follow the specific operating instructions for satisfying RF exposure compliance. This transmitter must not be co-located or operating in conjunction with any other antenna or transmitter.

European CE Notice

The **scala rider Solo** headset (the "Product") is in conformity with the following essential requirements of Council Directive 1999/5/EC (referred to as R&TTE Directive): Articles 3.1a, 3.1.b and 3.2. The Product is manufactured in accordance with Annex II of the above directive.

Declaration of Conformity (DOC)

The **scala rider Solo** headset is compliant with and adopts the *Bluetooth®* Specification 2.0 and has successfully passed all interoperability tests that are

specified in the *Bluetooth*® specification. However, interoperability between the device and other *Bluetooth*®-enabled products is not guaranteed.

WAIVER AND GENERAL RELEASE

By using the *scala rider Solo* you will waive substantial legal rights including the right to sue. Please read the following carefully before using the device. If you do not accept all terms of this agreement, you should immediately return the product for a full refund. By using the headset you agree to be bound to this agreement and forfeit the right to sue.

Using a communication device while riding a motorcycle, scooter, moped, ATV, quad-bike or any other vehicle or equipment, whether on land, water or air (jointly referred to as “Vehicle”) requires your complete and undivided attention. Cardo Systems, Inc., including its Officers, Directors, Affiliates, Parent Company, Representatives, Agents, Contractors, Sponsors, Employees, Suppliers and Resellers (jointly referred to as the “Company” or “Cardo”) strongly advises you to take all necessary precautions and remain alert to the traffic, weather and road conditions if you choose to use the ***scala rider Solo*** headset, including all derivative models irrespective of its commercial name or branding (the “Device”), and stop your Vehicle on the roadside prior to initiating or receiving calls. Any publications, advertisements, announcements or similar notes that refer to using the Device while riding a Vehicle are solely intended to address its technical capabilities and should not be misconstrued as if encouraging users to operate the Device while actively involved in traffic.

By way of purchasing this Device and not returning it for a full refund (see below), you are irrevocably releasing, indemnifying from any liability, loss, claim and expense (including attorneys fees) and holding Cardo harmless for any bodily injuries, harm or death as well as losses or damages in goods, to any Vehicles including your own, or to any property or asset that belong to you or to third parties, any of which may result from using the Device under any circumstances or conditions and irrespective of jurisdiction. Cardo will

not be responsible for any physical damages, irrespective of reasons, conditions or circumstances, including malfunctioning of the Device, and all risks associated with operating it rest solely and entirely with the user of this Device, irrespective of whether the Device is used by the original purchaser or any third party.

Cardo hereby notifies you that using this Device may also be in contravention to local, federal, state or national laws or regulations, and that any use of the Device is entirely at your sole risk and responsibility.

1. You, your heirs, legal representatives, successors or assigns, hereby voluntarily and forever release, discharge, indemnify and hold harmless Cardo from any and all litigation, claims, debts, demands, actions and liability which may arise, directly or indirectly, from using the Device for any distress, pain, suffering, discomfort, loss, injury, death, damages to or in respect to any person or property however caused, WHETHER ARISING FROM THE NEGLIGENCE OR OTHERWISE, and which may hereafter accrue to you on some future date as a result of said use, to the fullest extent permitted by law.
2. You fully understand and assume the risks in using the Device, including risk of negligent acts or omissions by others.
3. You confirm that you are physically capable to use the Device and that you have no medical conditions or needs that may infringe upon your abilities to do so in a safe manner. You confirm that you are at least eighteen (18) years of age and that you have been advised of the risks associated with the use of the Device. You further confirm that you will not consume any alcohol that may affect your alertness or any mind-altering substance, and will not carry, use or consume these substances before or during the use of the Device.
4. You fully acknowledge our warnings and understand that: (a) risks and dangers exist in using the Device while in traffic, including but not limited to injury or illness, strains, fractures, partial and/or total paralysis, death or other ailments that could cause serious disability; (b) these risks and dangers may be caused by the negligence of the manufacturers or its agents or any third party involved in de-



signing or manufacturing the Device; (c) these risks and dangers may arise from foreseeable or unforeseeable causes. You hereby assume all risks and dangers and all responsibility for any losses and/or damages, whether caused in whole or in part by the negligence or other conduct of others, including the Company.

5. You confirm that you have read this release of liability and fully understand its terms and that you have given up substantial rights by not returning the Device for a full refund (see refund option below).

Disclaimer of Warranty

CARDO DISCLAIMS ALL EXPRESS AND IMPLIED WARRANTIES WITH REGARD TO THE ENCLOSED DEVICE, INCLUDING WITHOUT LIMITATION ANY IMPLIED WARRANTIES OF MERCHANTABILITY, FITNESS FOR A PARTICULAR PURPOSE, AND NON-INFRINGEMENT. THE DEVICE AND ITS ACCESSORIES ARE PROVIDED "AS IS" AND "AS AVAILABLE" WITHOUT WARRANTY OF ANY KIND BEYOND THOSE ASSUMED IN THE ENCLOSED MANUAL.

Limitation of Liability

IN NO EVENT SHALL CARDO BE LIABLE FOR ANY SPECIAL, INDIRECT, PUNITIVE, INCIDENTAL, EXEMPLARY OR CONSEQUENTIAL DAMAGES, OR ANY DAMAGES WHATSOEVER RESULTING FROM THE USE OF THE DEVICE, WHETHER BASED

ON BREACH OF CONTRACT, TORT (INCLUDING NEGLIGENCE), PRODUCT LIABILITY OR OTHERWISE, EVEN IF ADVISED OF THE POSSIBILITY OF SUCH DAMAGES. YOU ACKNOWLEDGE AND AGREE THAT THE LIMITATIONS SET FORTH ABOVE ARE FUNDAMENTAL ELEMENTS OF THIS AGREEMENT AND THE DEVICE WOULD NOT BE PROVIDED TO YOU ABSENT SUCH LIMITATIONS. SOME STATE STATUTES MIGHT APPLY REGARDING LIMITATION OF LIABILITY.

RETURN FOR FULL REFUND

IF YOU ARE UNWILLING TO ACCEPT AND AGREE TO THE ABOVE CONDITIONS, YOU MAY RETURN THIS DEVICE TO THE STORE FOR A FULL REFUND, PROVIDED THAT YOU DO SO NO LATER THAN 7 BUSINESS DAYS FOLLOWING THE PURCHASE OF THE DEVICE (proof of purchase required) AND SUBJECT TO THE RETAIL BOX AND ALL ACCESSORIES BEING COMPLETE AND INTACT. WHEN DOING SO, PLEASE REFER TO THIS SECTION. BY NOT RETURNING THE DEVICE FOR REFUND WITHIN THE PERIOD PROVIDED, YOU ARE EXPLICITLY IN AGREEMENT WITH THE ABOVE, AND RENOUNCE ALL RIGHTS TO FUTURE CLAIMS AND DEMANDS AGAINST CARDO AS DEFINED ABOVE.

www.cardosystems.com