

# **RAYTEL**

**Bluetooth Hands Free Car Kit**

**TellPhone<sup>®</sup>**  
4200

**Installation Instruction / Operating Manual**

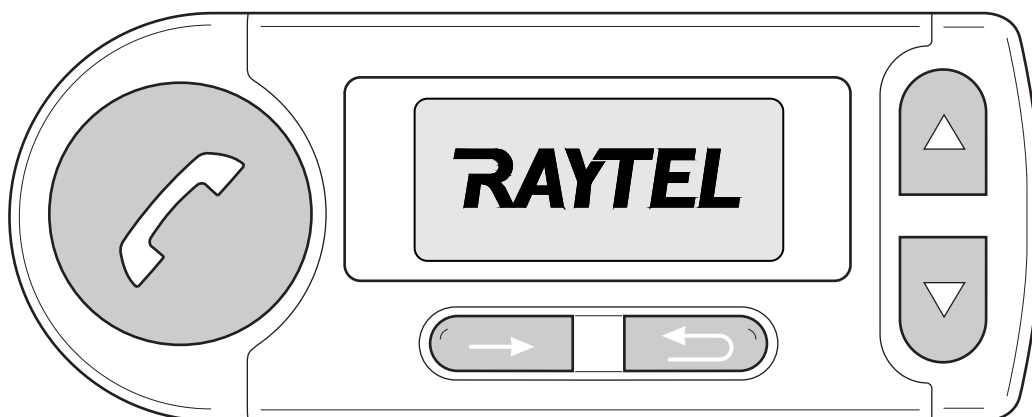

TellPhone 4200

**RAYTEL**

**RAYTEL LLC a Nevada Limited Liability Company**

8820 Kenamar Drive, Suite 506  
San Diego, CA 92121, USA

Phone: +1 858 566-2170  
Fax: +1 858 566-2179

[www.tellphone.com](http://www.tellphone.com)

As a result of technical progress, informations and illustrations in the installation manual as well as the extent of supply are subject to modification. All rights reserved. Reprinting and reproduction, in part or in full, is not permitted without express written consent !

## Table of Contents

<b>Installation Instructions</b> .....	4
<b>Operating Instructions</b> .....	13
<b>1 Display and controls</b> .....	14
<b>2 First Operation</b> .....	15
<b>3 Signalling elements</b> .....	16
<b>4 Menu</b> .....	17
4.1 Direct dialling .....	17
4.2 Messages .....	17
4.3 Call log .....	17
4.4 Phone book .....	18
4.5 Audio .....	21
4.6 Settings .....	22
<b>5 User Administration</b> .....	23
<b>6 Making calls</b> .....	24
<b>7 Voice Control</b> .....	25
<b>8 Accessories and spare parts</b> .....	33
<b>9 Specifications</b> .....	33
<b>10 Software updates</b> .....	34
<b>11 Hot line</b> .....	34
<b>12 Troubleshooting</b> .....	35

## Installation Instruction

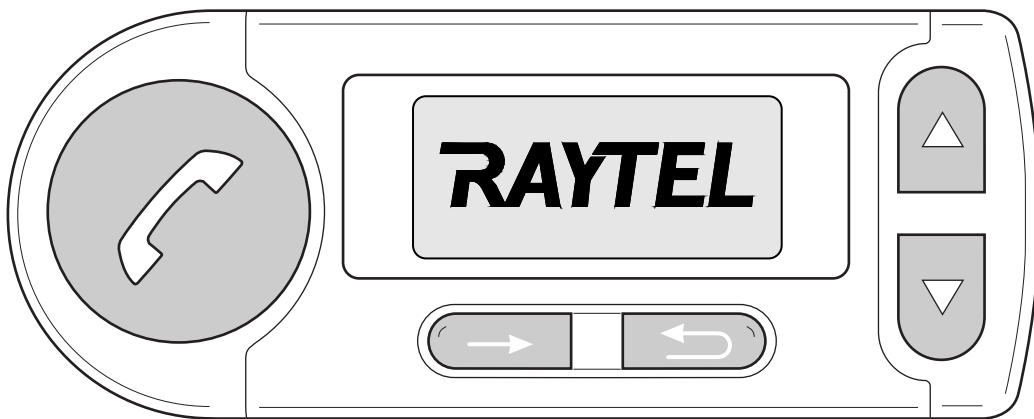

## Safety Instructions



### **Improper installation**

Improper installation may cause damages to the unit or to the vehicle! The installation of the hands-free car kit requires special knowledge and special abilities. We therefore strongly recommend to have the installation done by a professional.



### **Personal injury**

Inappropriate places for the installation may cause personal injuries in accidents or may disable the safety equipment. Note the directions in the chapter "Installation"!



### **Personal injury / Material damage**

When you remove coverings or armature parts, sharp tools may cause personal injuries or material damage. Remove the parts carefully. Don't submit the connecting cables to pressure.



### **Negative effects on road safety**

Talking whilst driving reduces your concentration. This may cause dangerous situations on the road. Also in hands-free mode, you should draw your attention to the traffic. In complex traffic situations you should refrain from using the mobile phone!



### **Damage of the air bag**

A wrong place selected for the installation of the components may cause damage to the air bag or impair the functioning of the air bag. Install the components out of range of action of the air bag!



**Insulation damage**

Damaged insulations may cause damages of the unit. The cables installed should not be exposed to tensile stress. Install the cables such as they are not pinched or chafed.



**Damage caused by polarity reversal or short circuiting**

Incorrectly connected cables or a short circuit may cause serious damage to the equipment. It is essential to disconnect the car battery before you begin installation.



**Damage of important vehicle components**

Drilling mounting holes or driving in self-tapping screws may cause damage to important vehicle components or to cables. Make sure there is enough space left also behind the screws and drilling holes!



**Effects on the vehicle's electrical system**

Although the hands-free car kit produces low amounts of radiation, improper installation of the hands-free car kit may influence the electronic equipment of the car. Note the directions of the vehicle manufacturer!



**Proper use**

This system is intended for use exclusively with mobile phones in motor vehicles.



**Damages caused by false replacement parts**

False replacement parts may cause disturbances. Only use the replacement parts listed in the chapter "Replacement parts and Accessories"!

## KIT

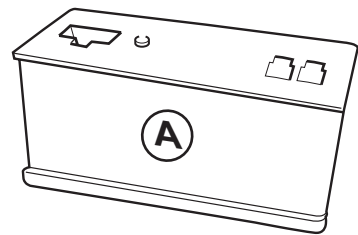
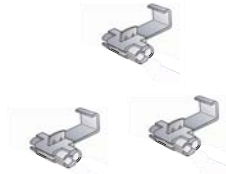
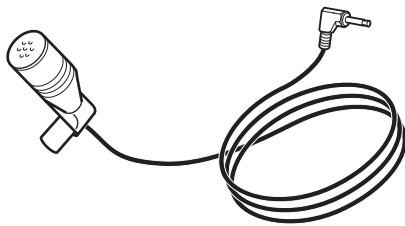
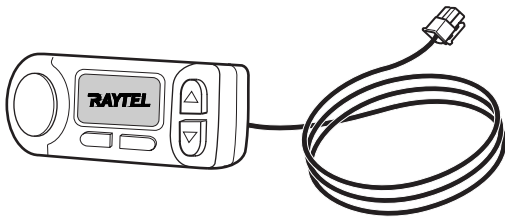

## Tools



Ø 2 mm

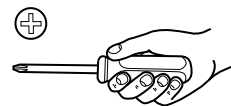
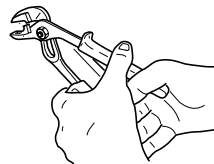
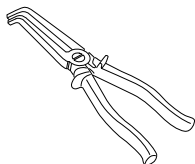

Cleaner



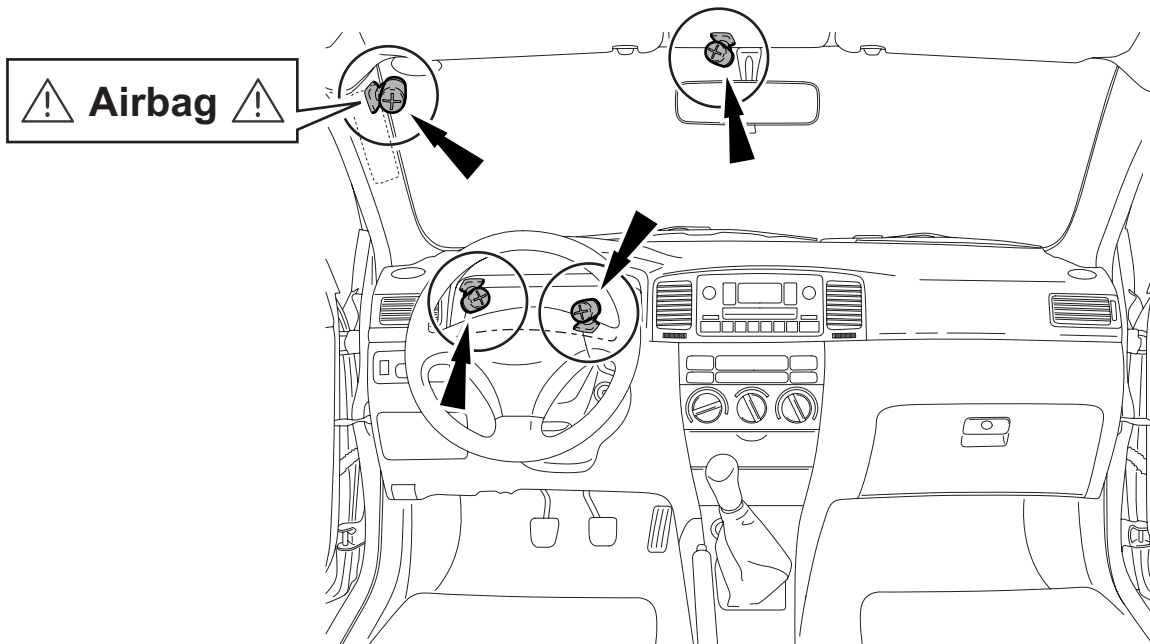
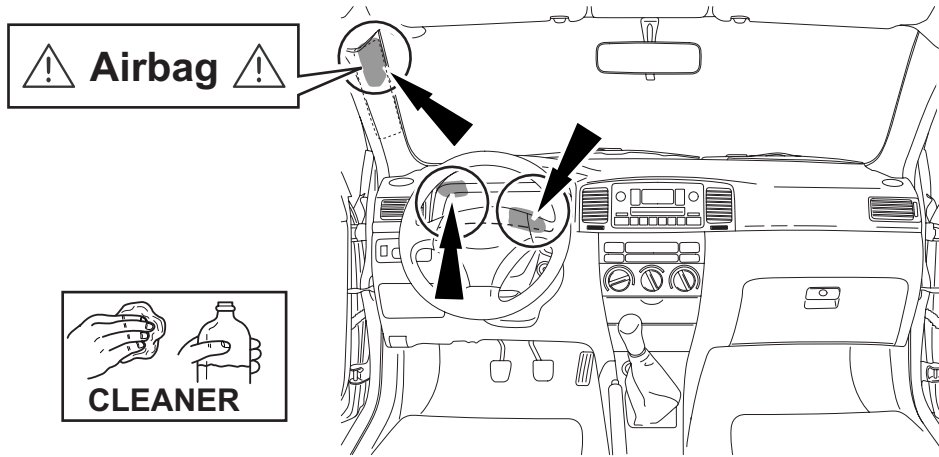
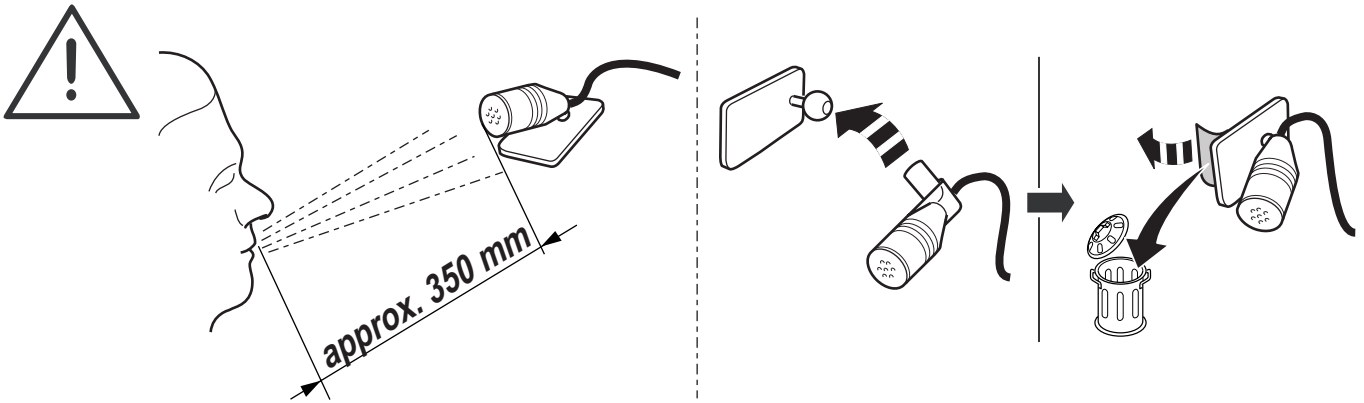



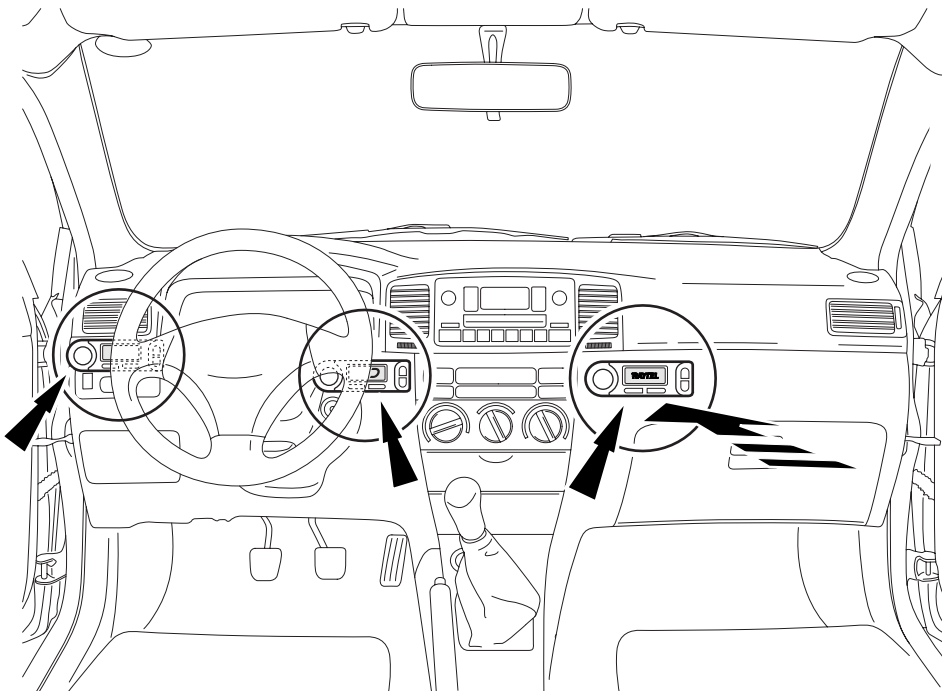
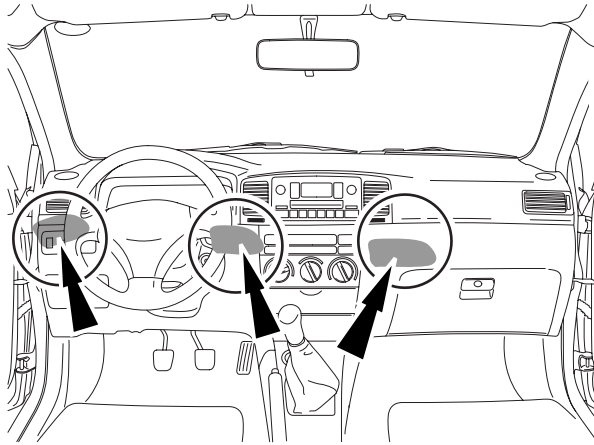
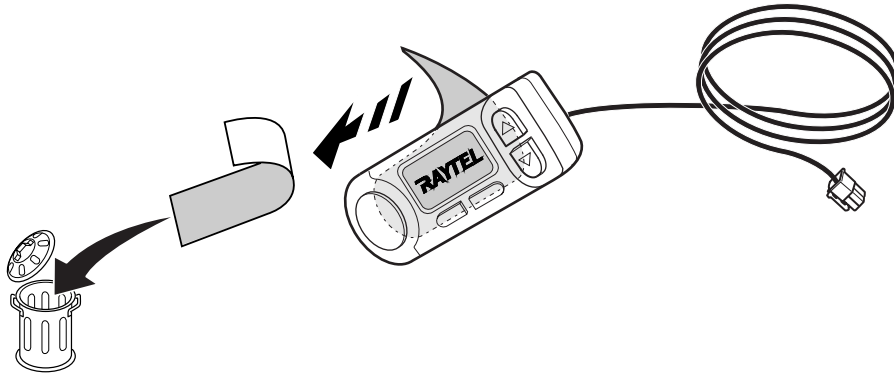

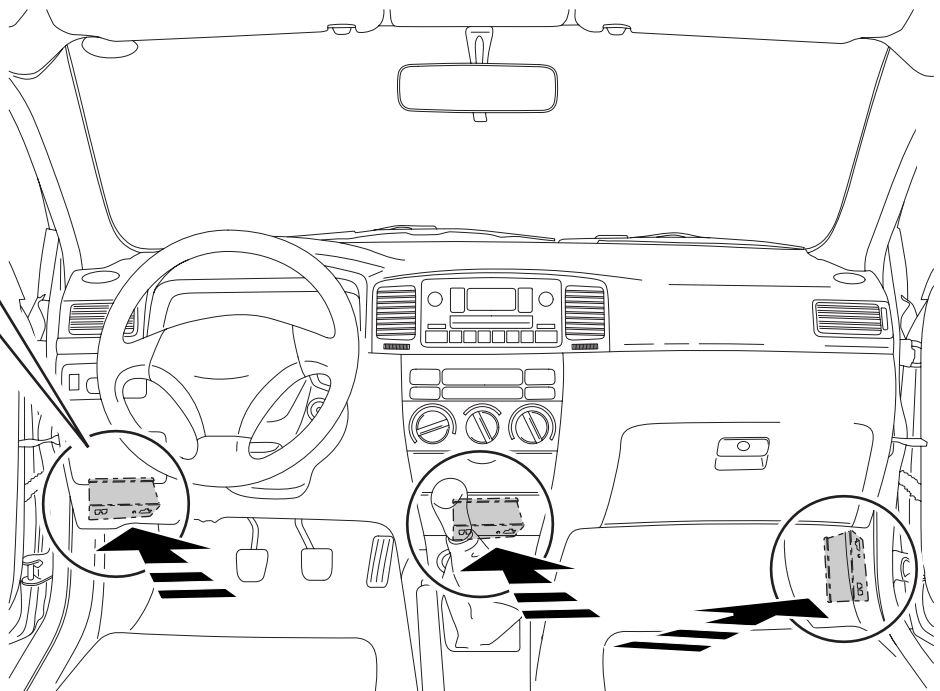
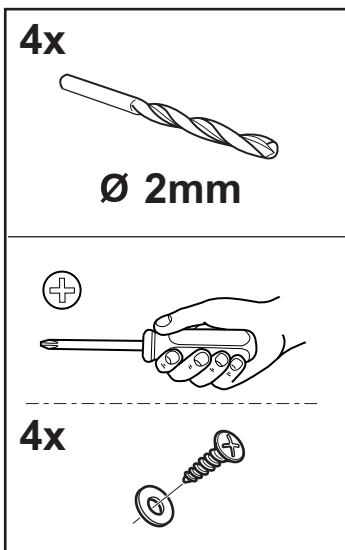
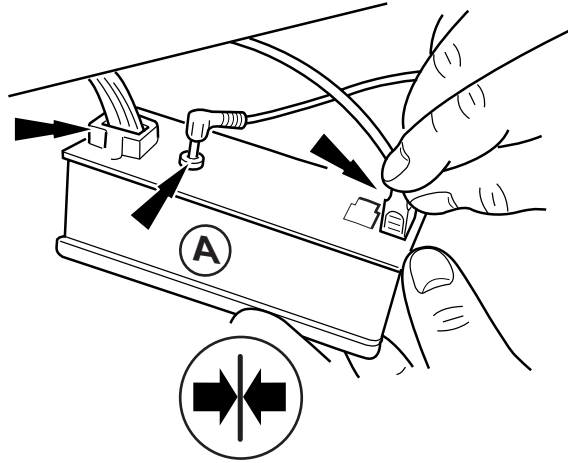

## Operating Instructions - TellPhone 4200

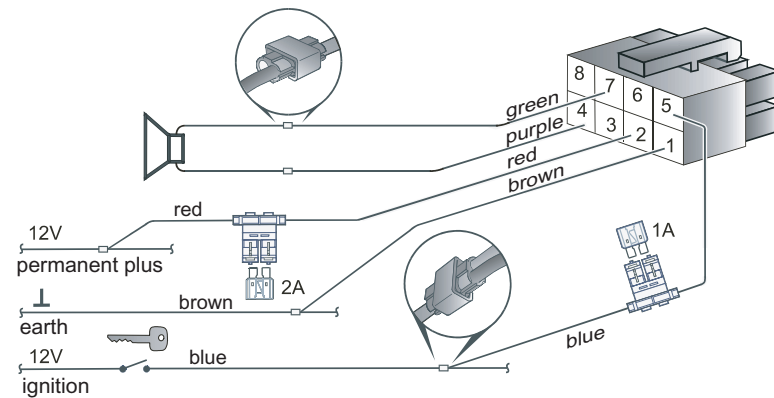
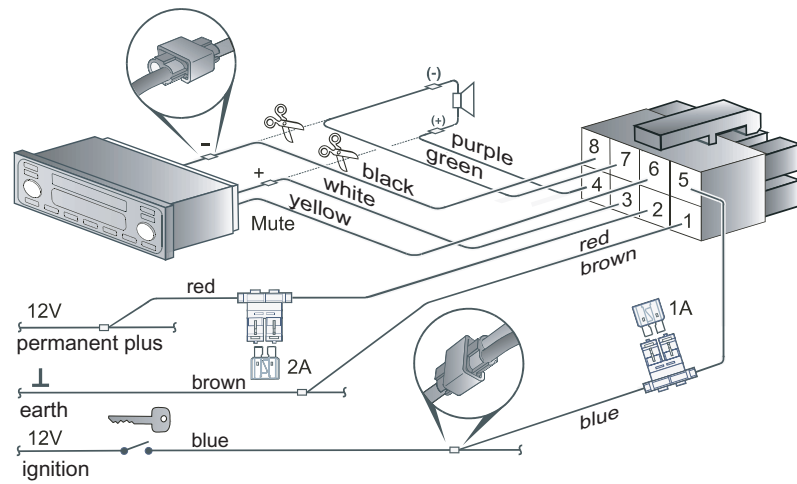
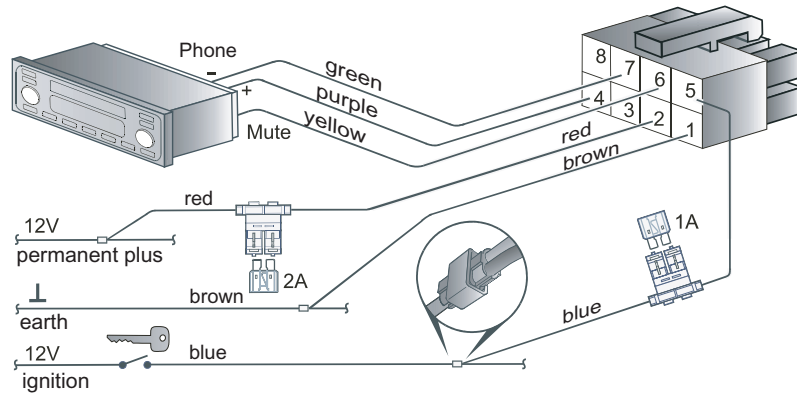
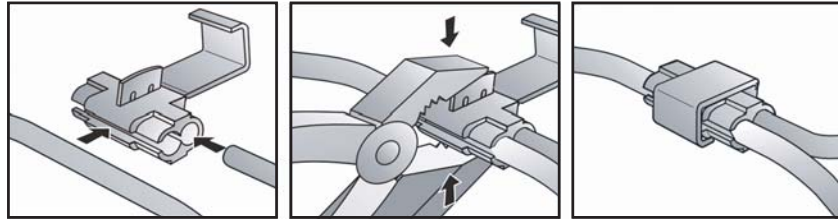

TellPhone 4200

**RAYTEL**

RAYTEL LLC a Nevada Limited Liability Company

8820 Kenamar Drive, Suite 506  
San Diego, CA 92121, USA

Fon: +1 858 566-2170  
Fax: +1 858 566-2179

[www.tellphone.com](http://www.tellphone.com)

## Operating Manual

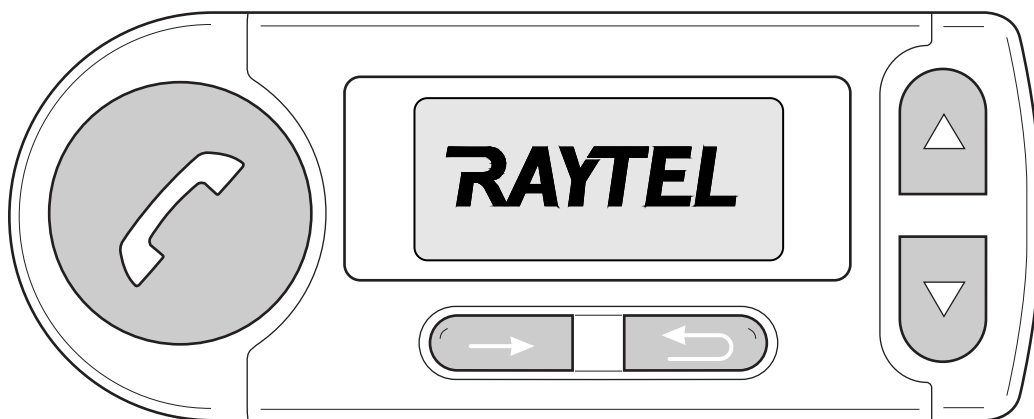

## 1 Display and controls

The Audio blue has 5 buttons. The following basic functions are assigned to the individual buttons.

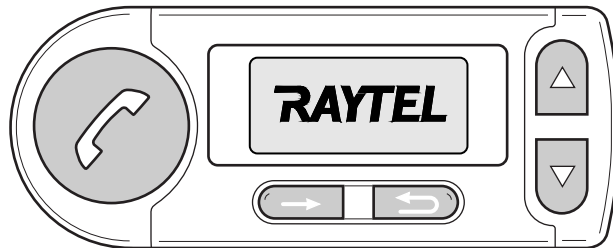

- Activates voice control when depressed for a few seconds
- Accepts incoming call
- Ends call
- Confirms yes/no queries
- Accepts highlighted elements



- Accepts incoming calls
- Opens main menu
- Selects and opens menu sub-items
- Confirms yes/no queries



- Rejects or ends call
- Leaves menu or moves up to a higher menu level
- Changes user and logs off main screen
- Deletes or aborts entry of letter or number



- Leaves through menus and phone book
- Leaves through speller
- Regulates volume during a call
- Selects yes/no

## 2 First Operation

The following describes the procedures to use when operating the system for the first time. An "egg timer" appears when the system is switched on. The control unit might be updated then. If so, a pocket knife will appear. After that, the FwD logo will appear. See 10 software updating

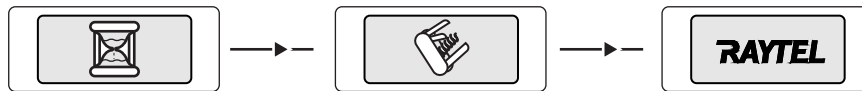

### User log-on:

- At the end of the starting procedure, the menu for language selection for the display menu appears.
- Please switch the Bluetooth in your mobile phone on and activate "visibility".
- The Audio blue uses the Bluetooth headset and hands-free profile.

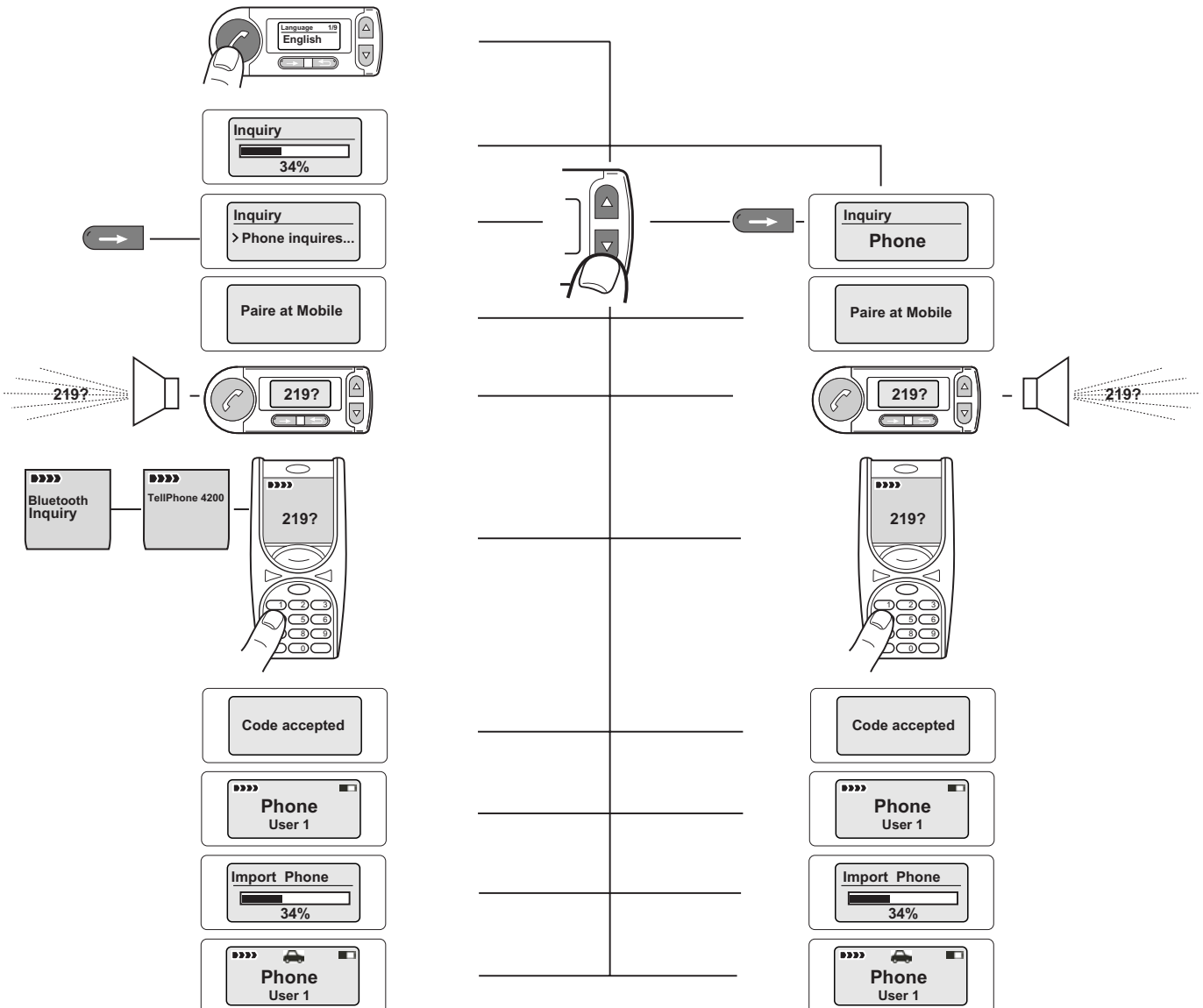

### 3 Signalling elements

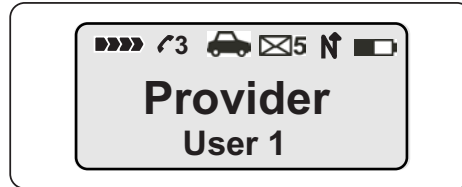

#### Symbols



Field intensity display \*



Calls during absence \*



Battery charging \*



New SMS \*



Battery indicator \*



Connection in Bluetooth hands-free profile \*



Connection in Bluetooth headset profile \*



Bluetooth with user selection



Deactivation



Activation



Deactivation



Activation



Capital letters to lower case letters



Lower case letters to numbers



Numbers to special characters



Special characters to capital letters

\* depends on mobile phone



## 4 The Menu

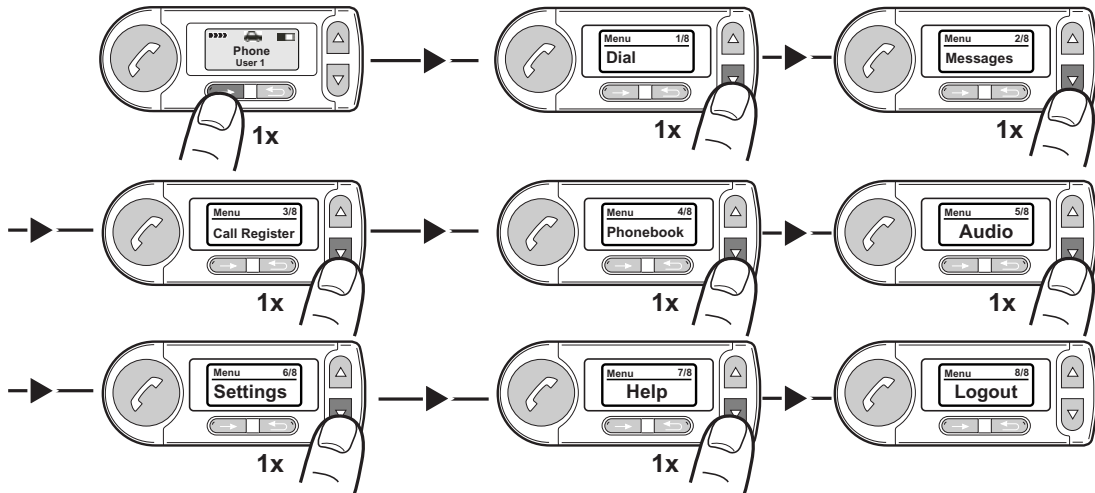

### 4.1 Dial

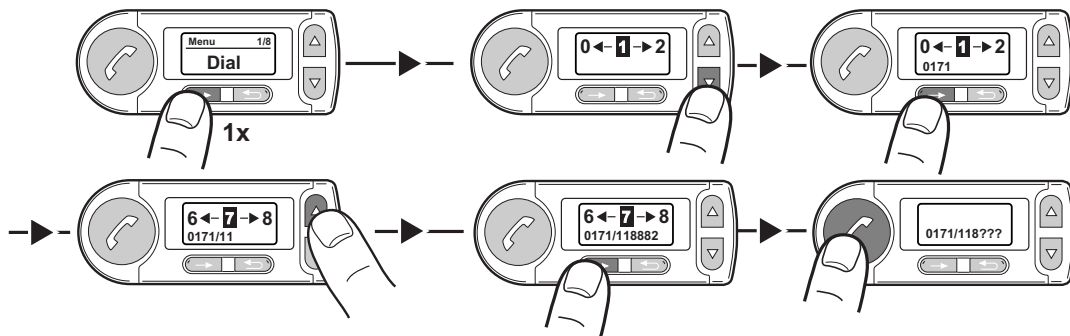

### 4.2 Messages

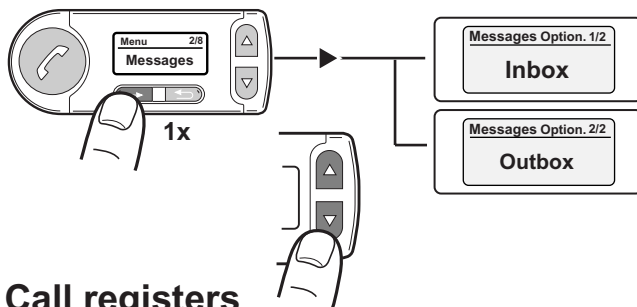

### 4.3 Call registers

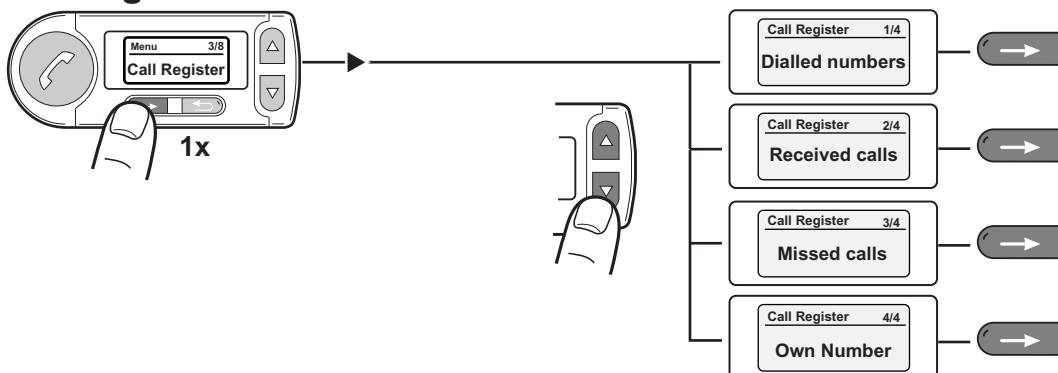

**4.4 Phonebook**

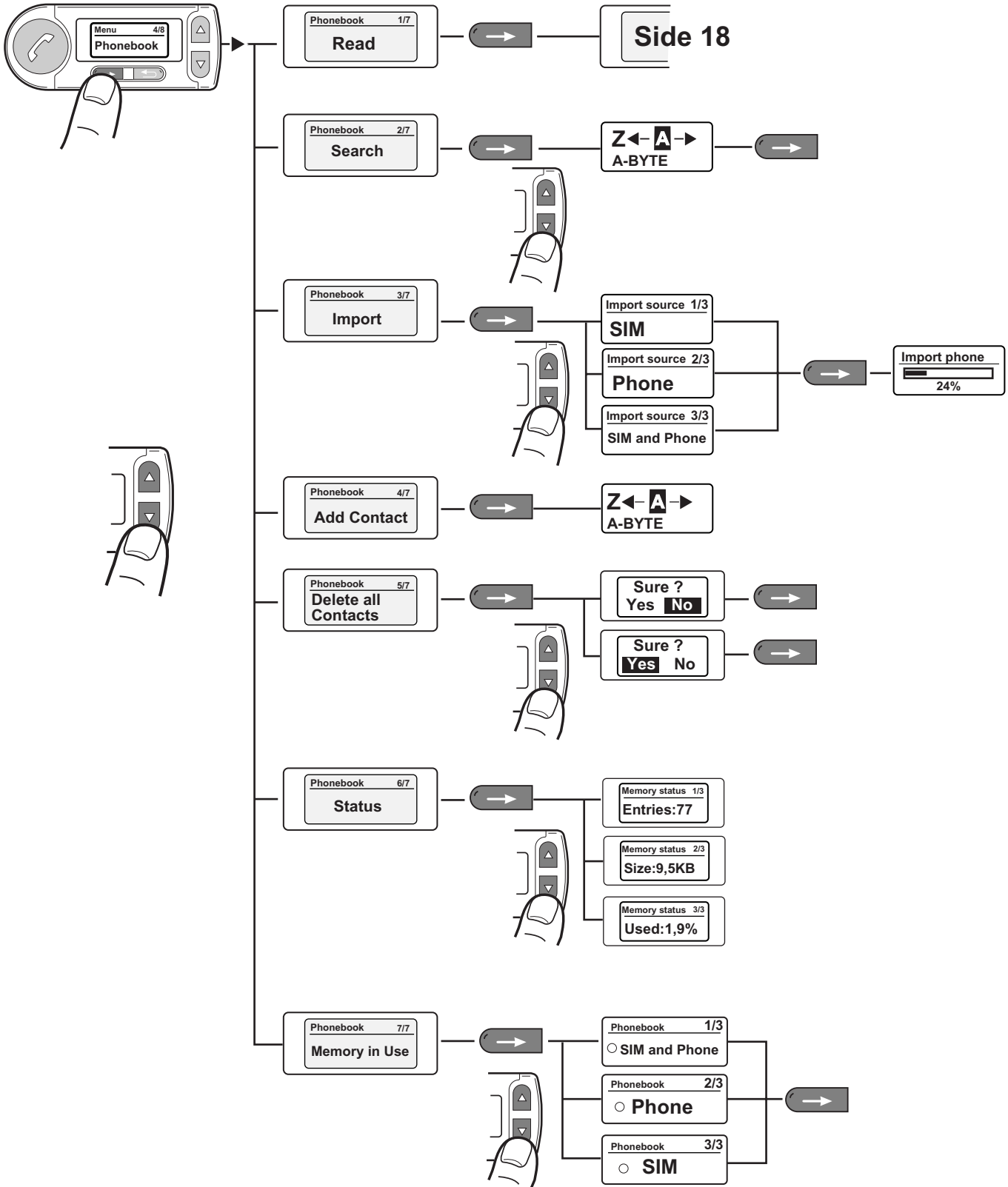

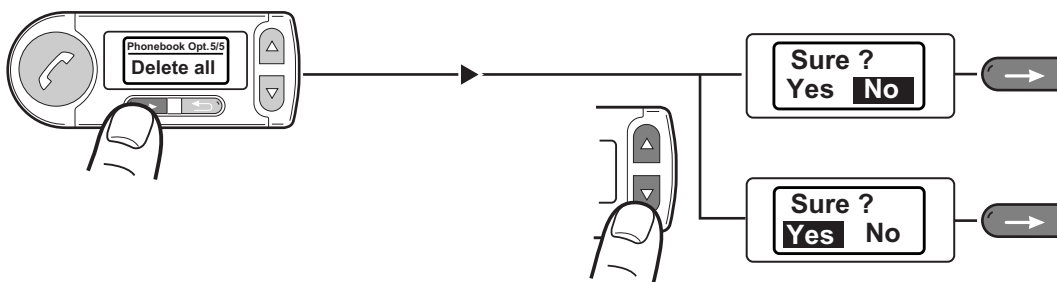
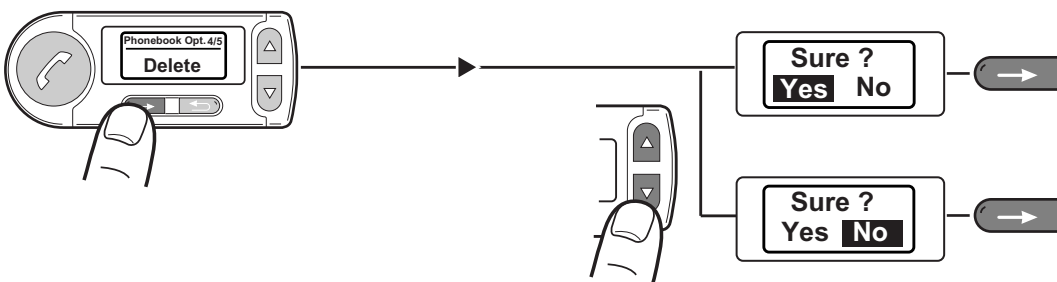
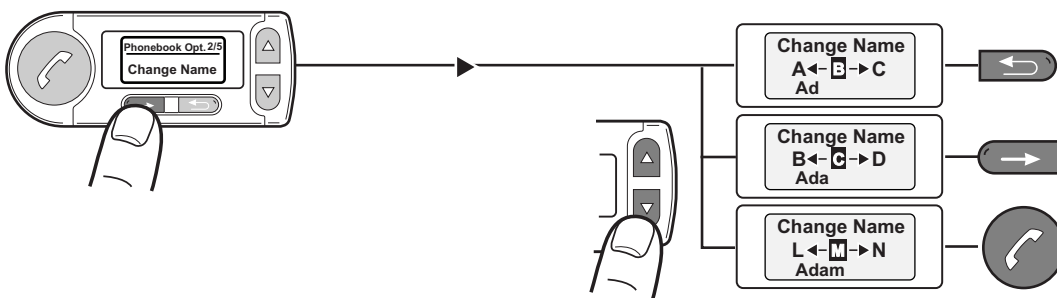
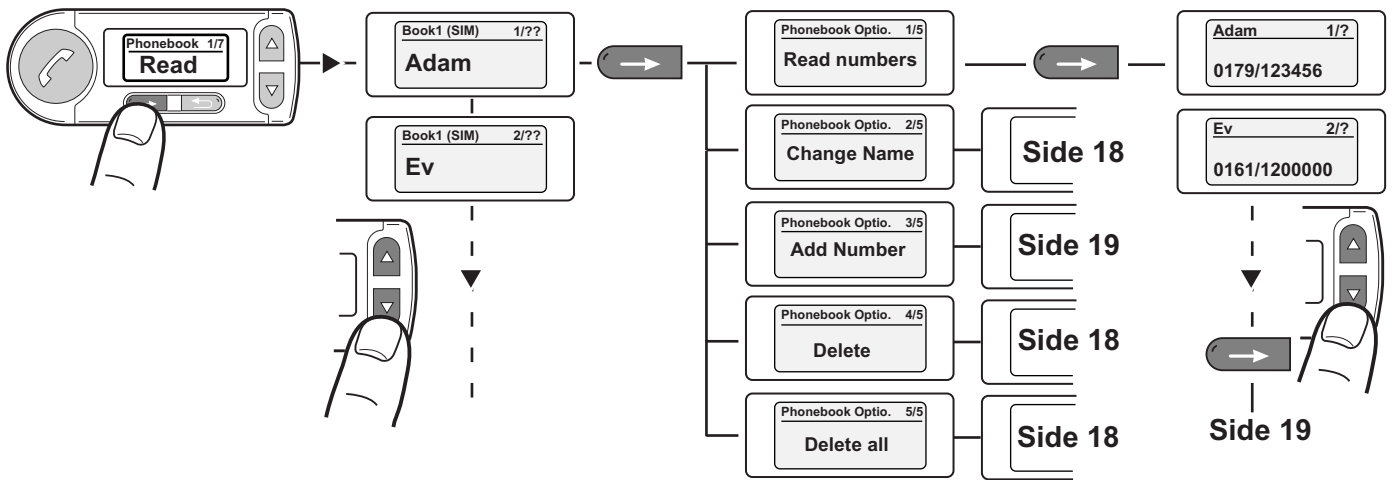

## Operating Instructions - TellPhone 4200

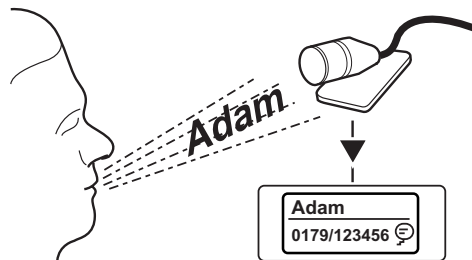
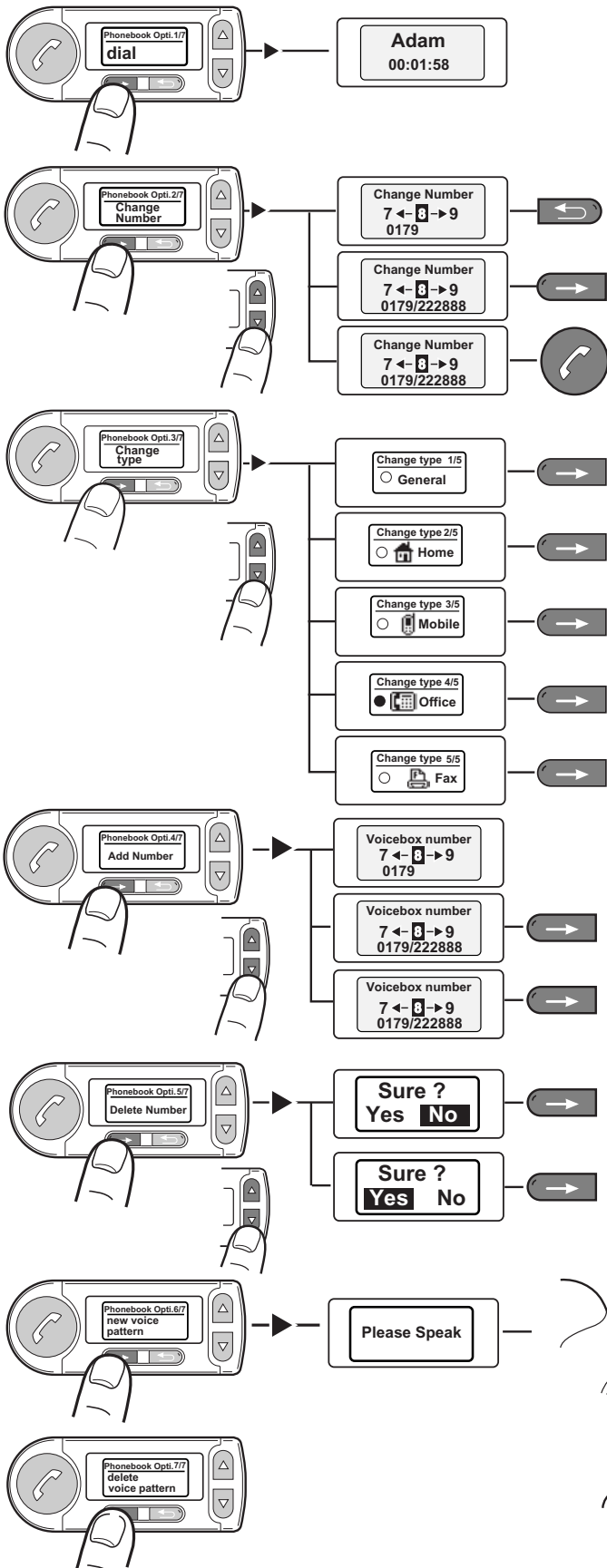

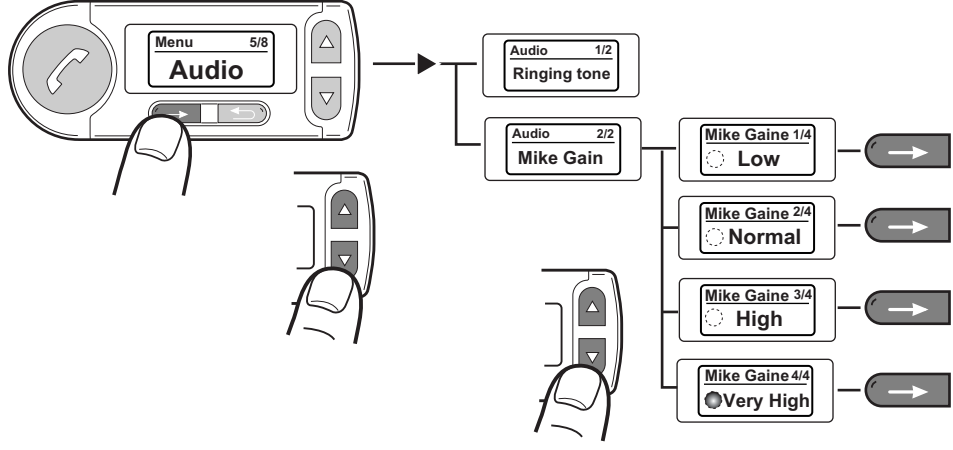

## 4.5 Audio

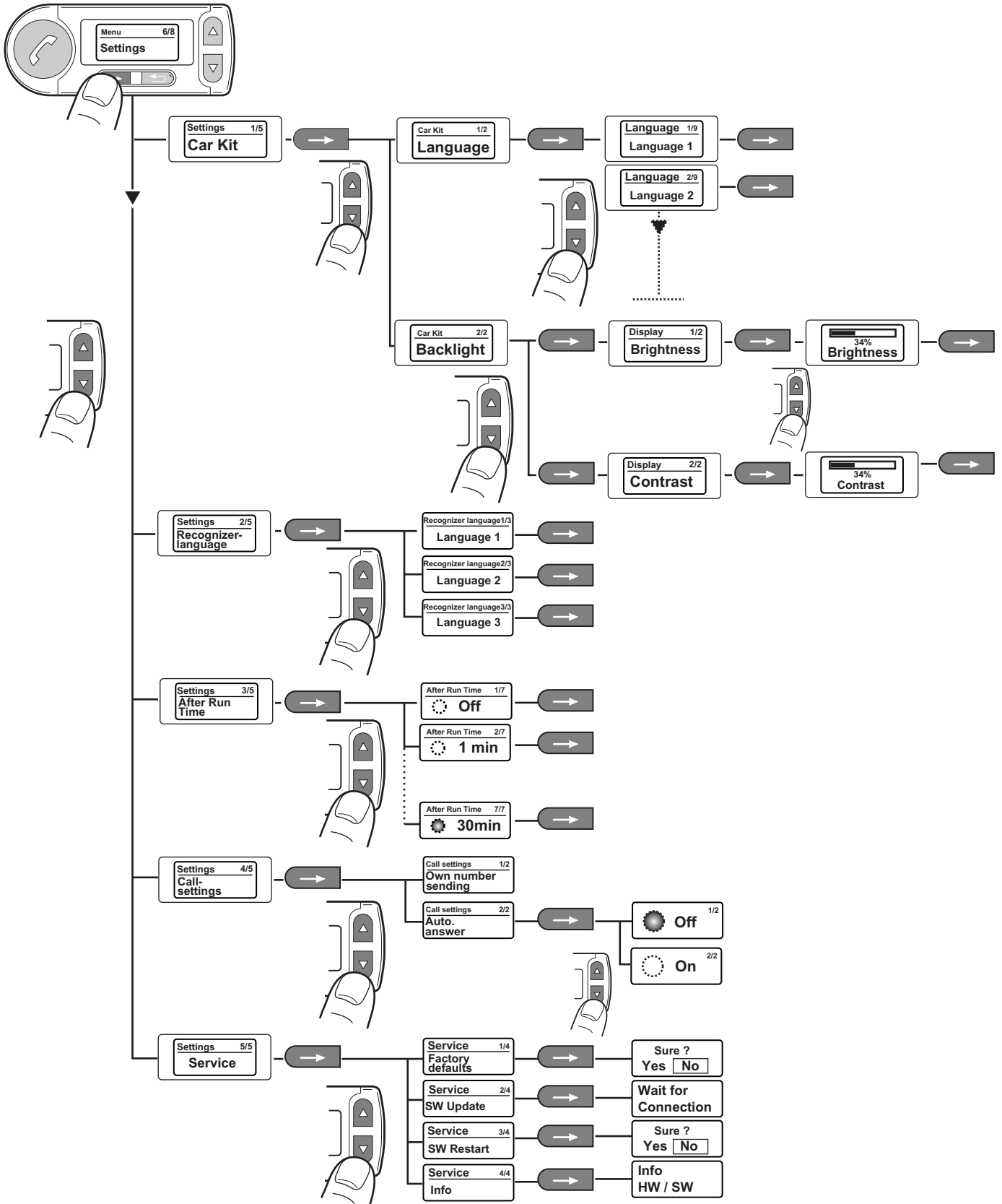

## 4.6 Settings



## 5 User Administration

- Phone book
- Bluetooth hands-free  / headset profile 
- Display brightness
- Display contrast
- Ringing tone
- Display language
- Volume setting

### Open user administration:

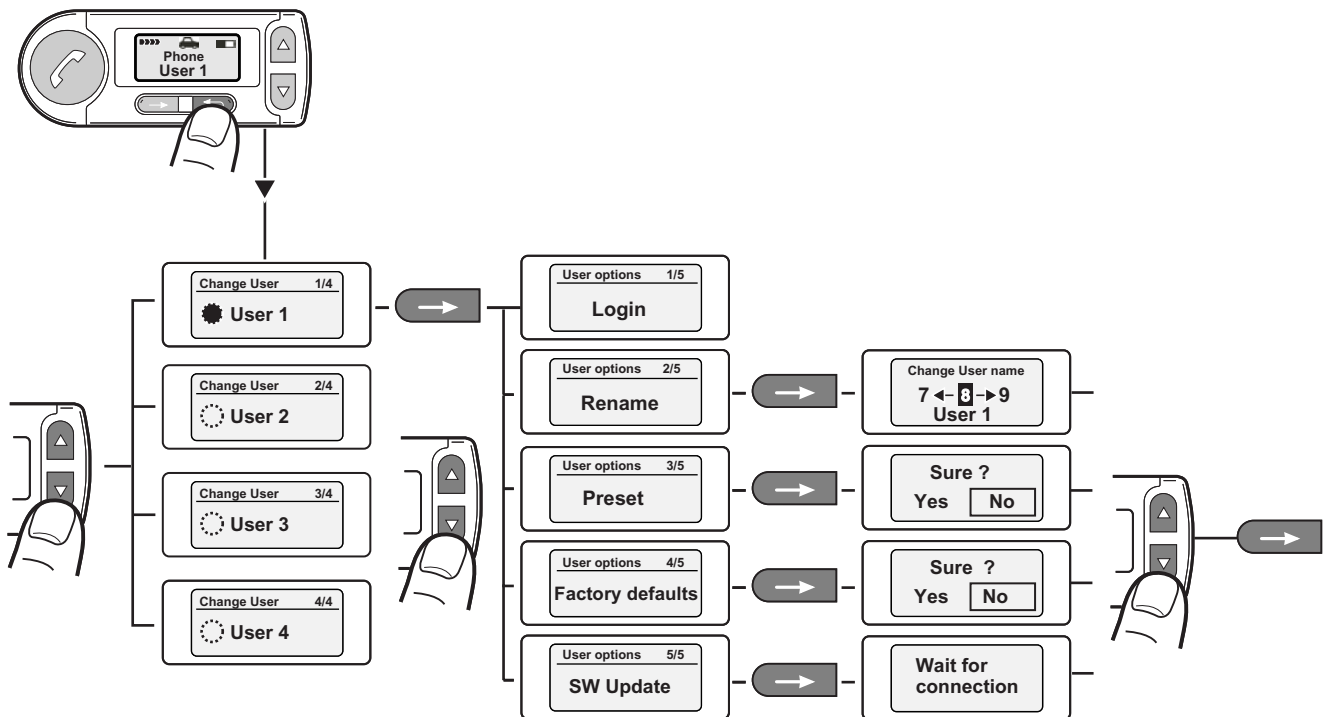

## 6 Phoning

### Incoming Call:

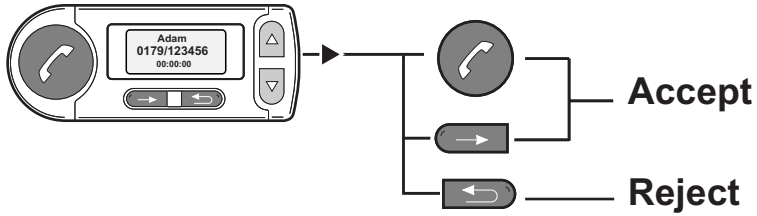

### Private Mode:

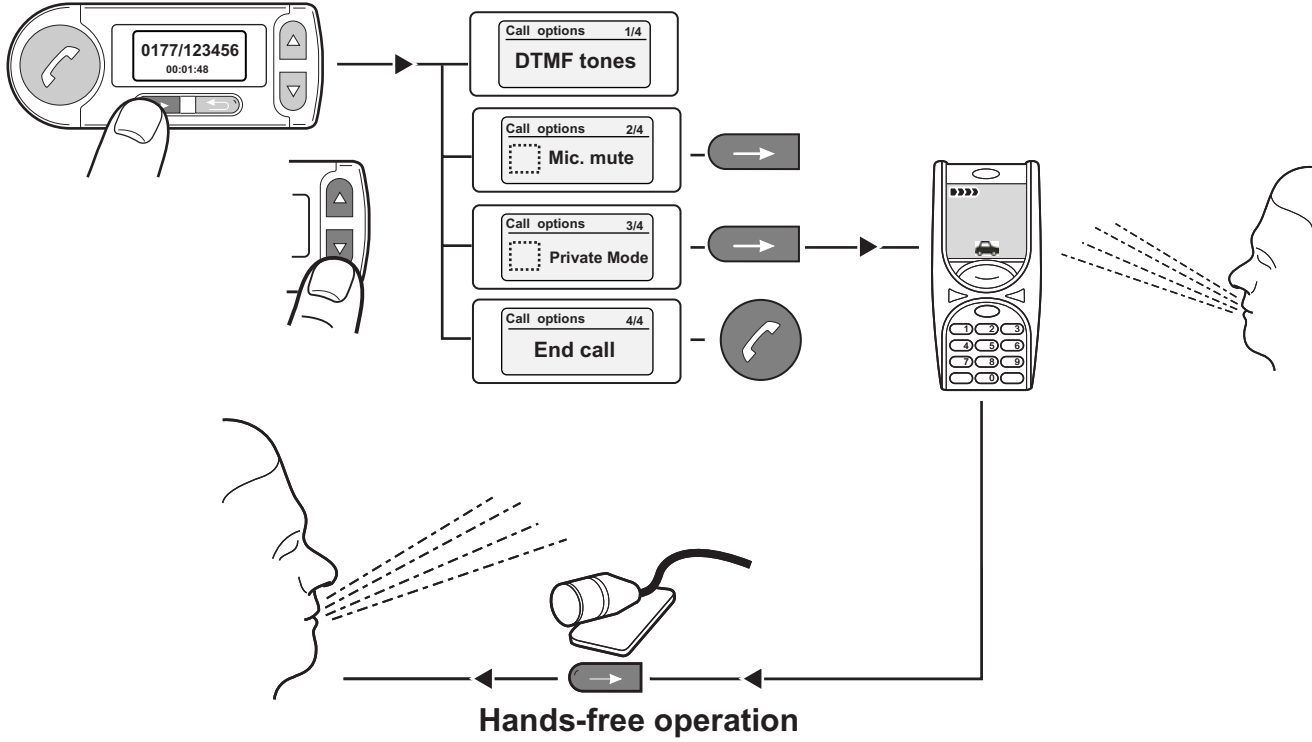

### Volume setting during the call:

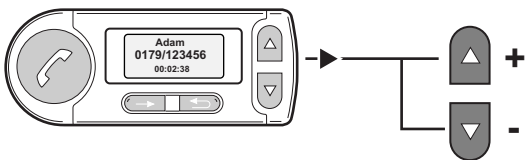



## 7 Voice Control

Dial number:

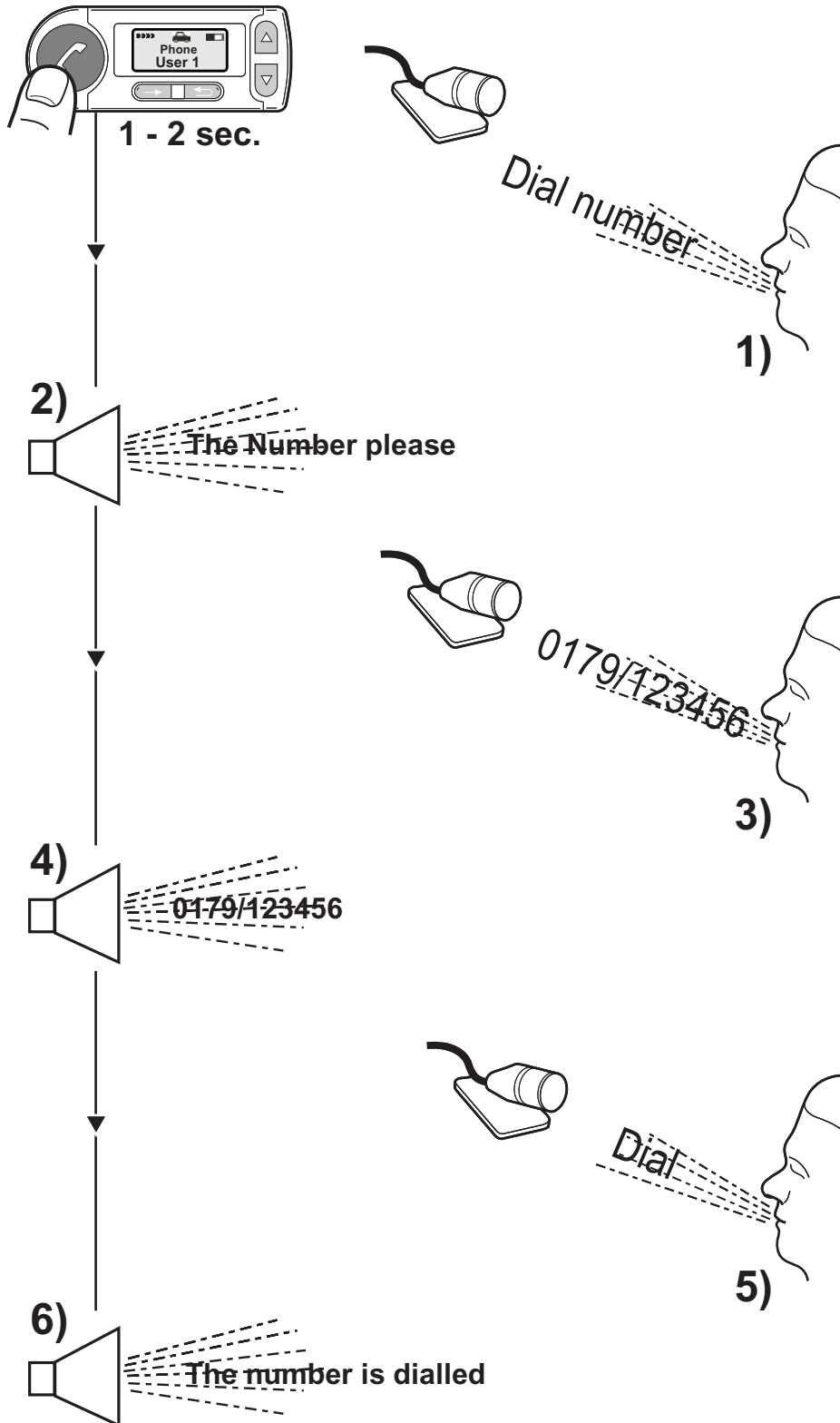

## Store numbers:

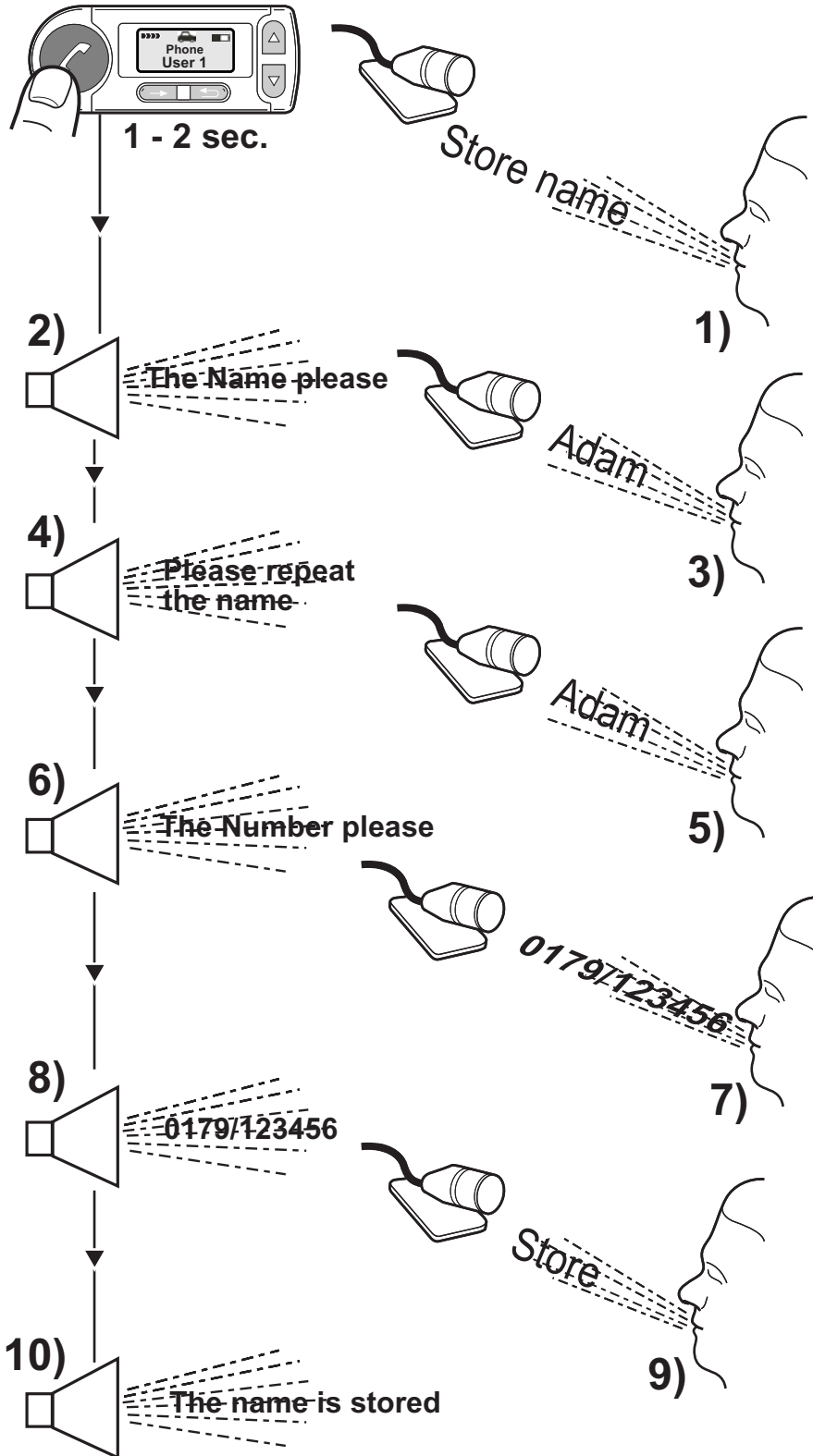

## Dial name:

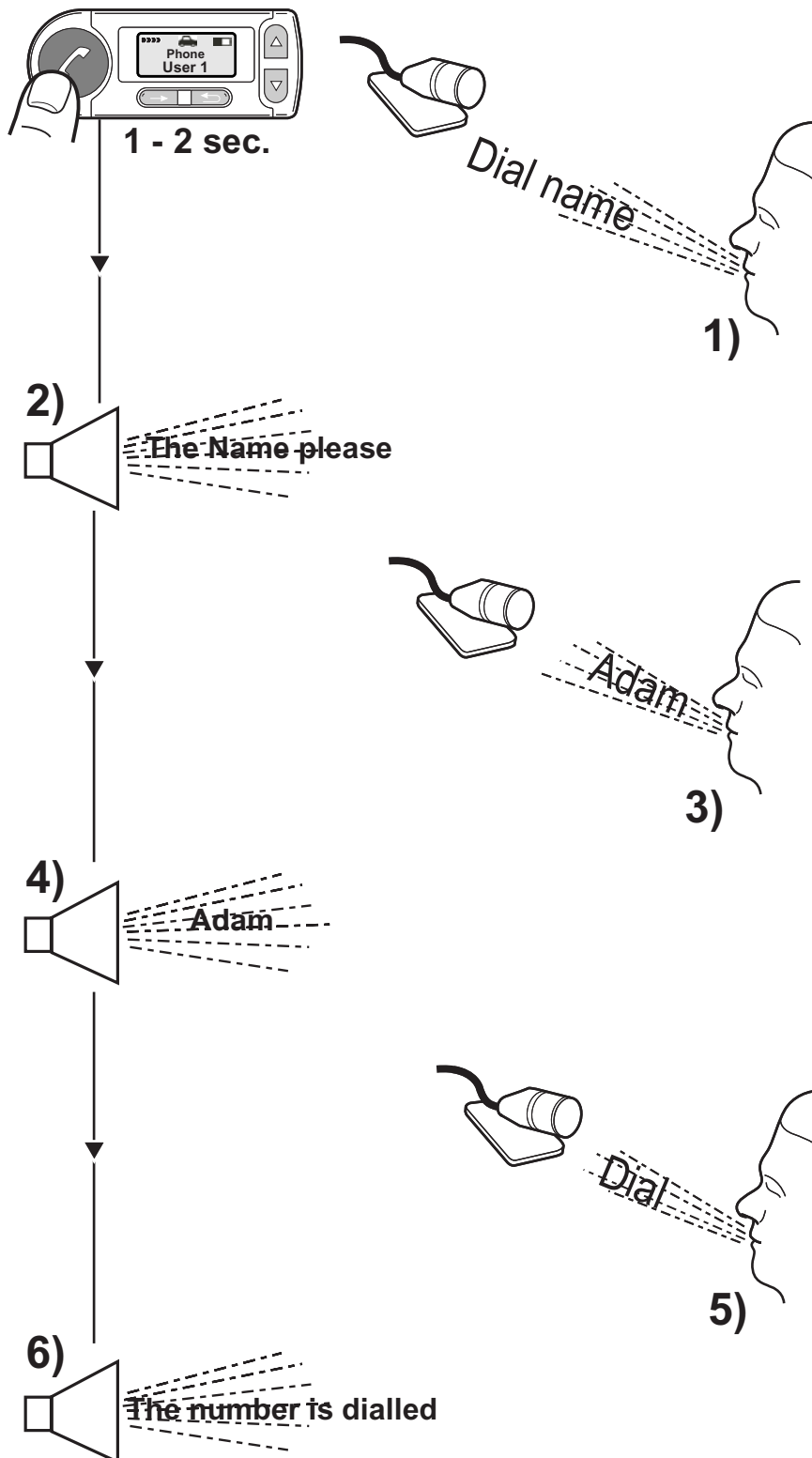

## Say names:

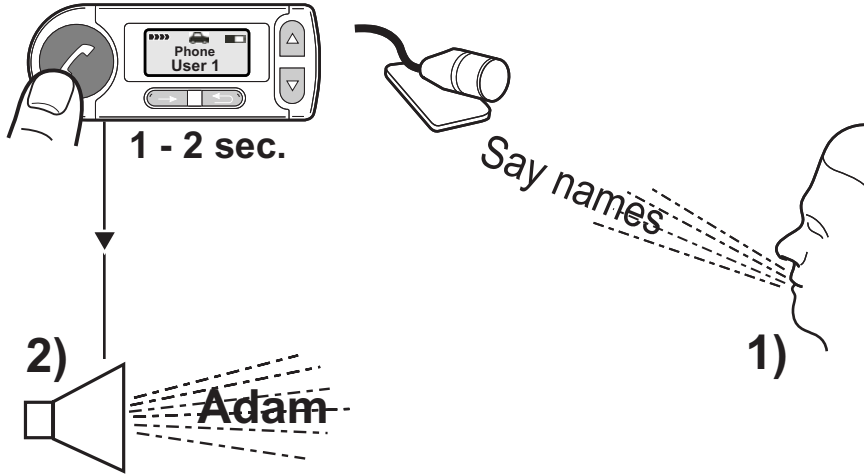

## Delete names:

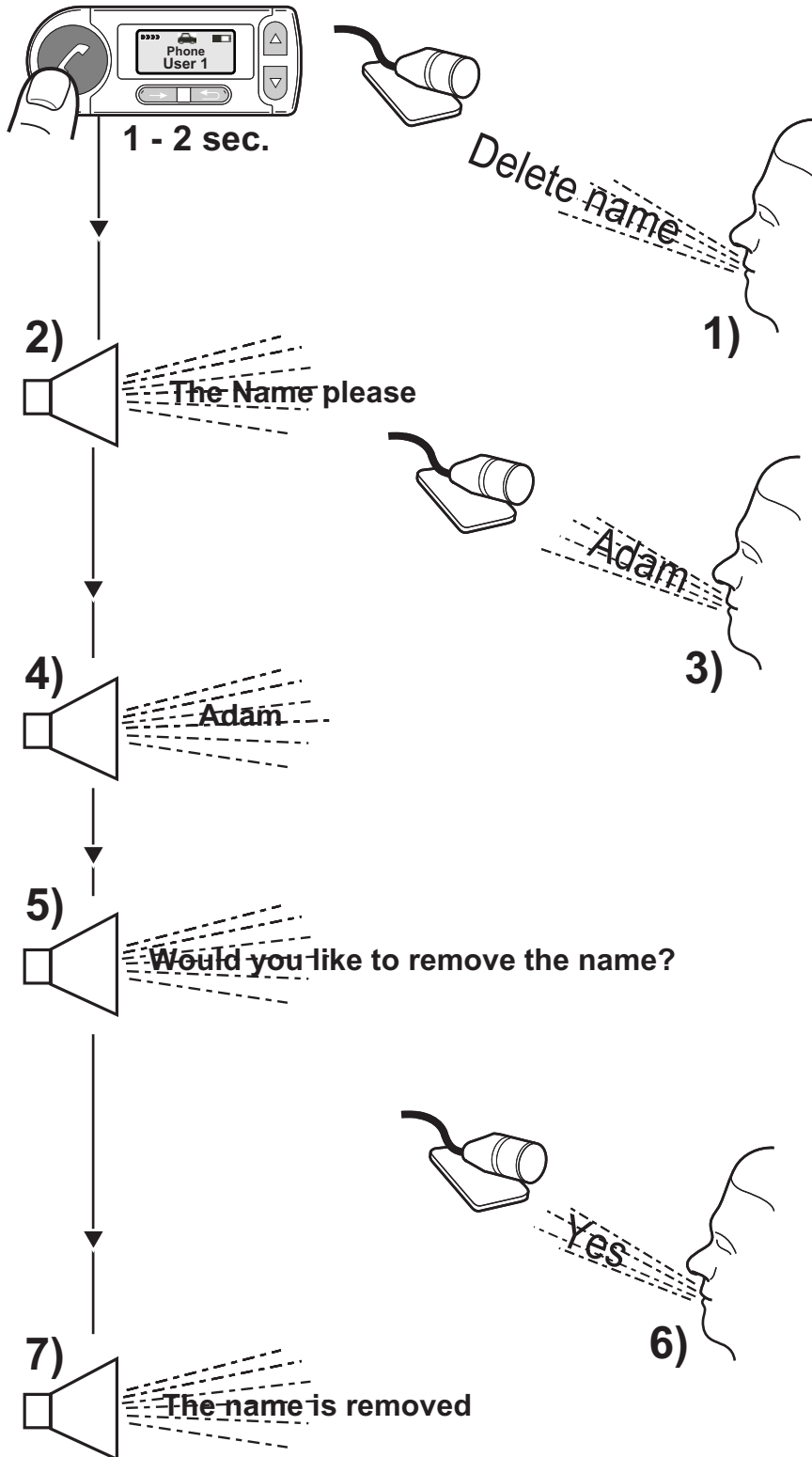

Delete all names:

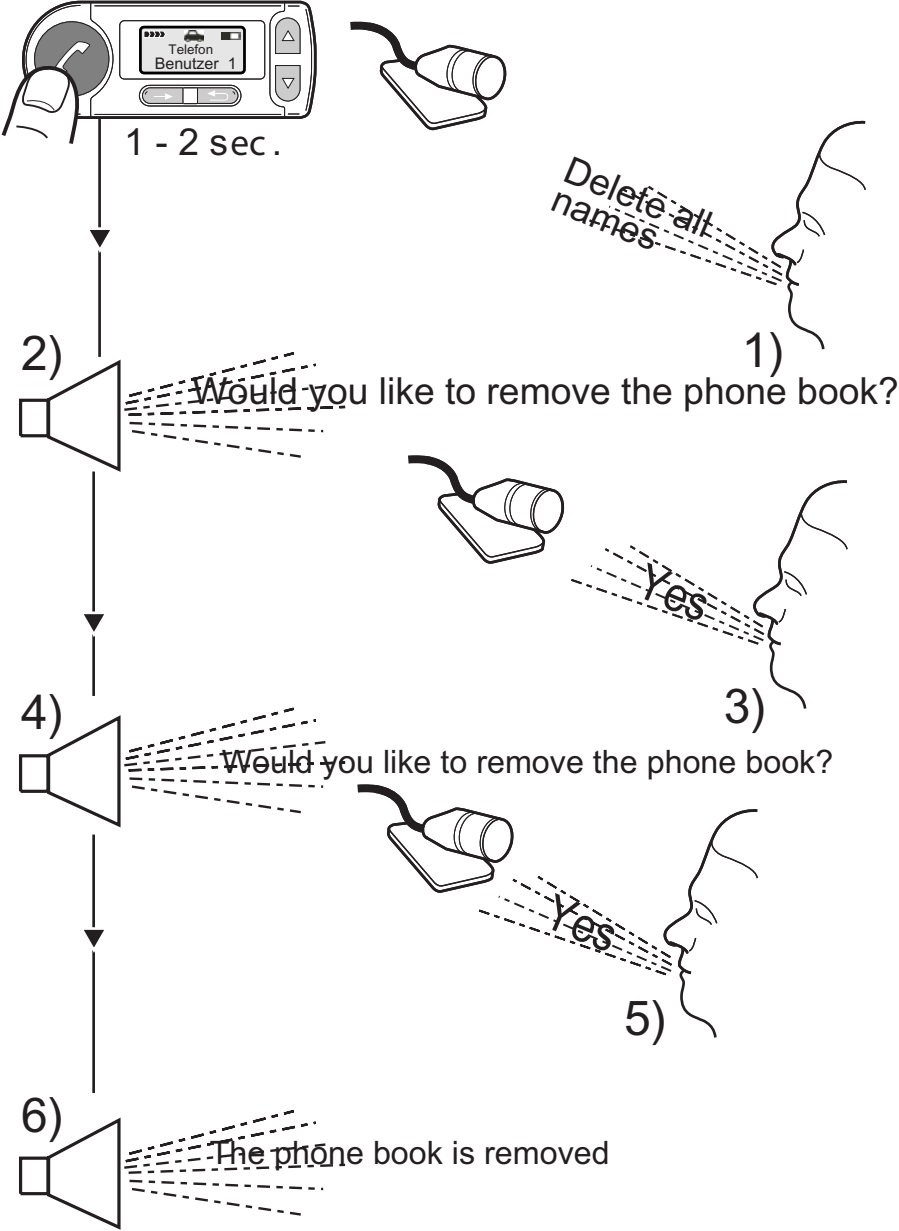

## Redial:

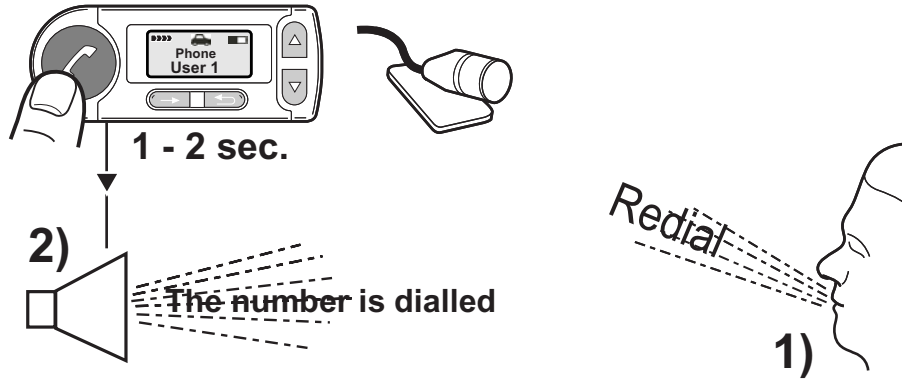

## Voice Options:

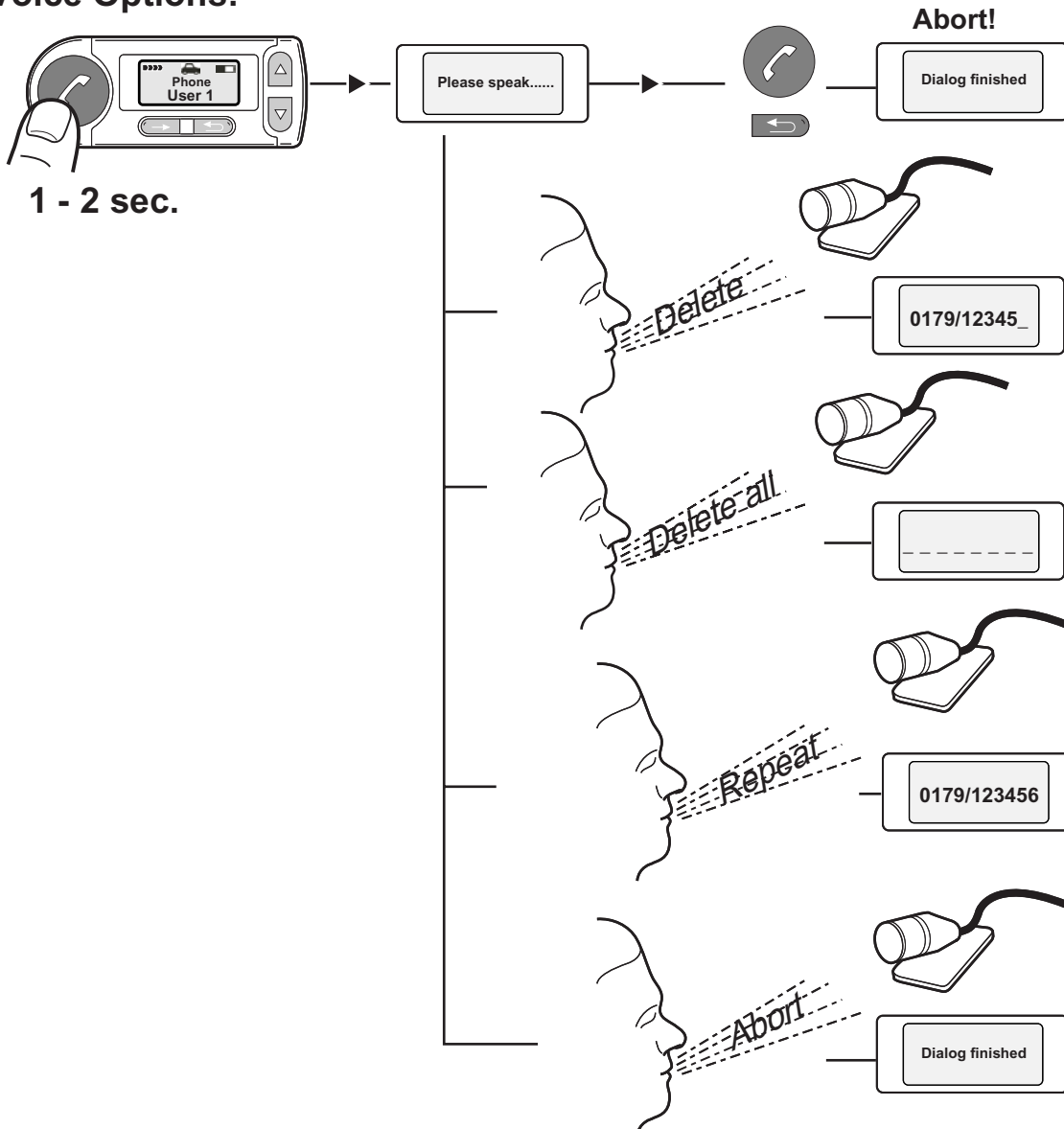

## Voice Control Mobile Phone:

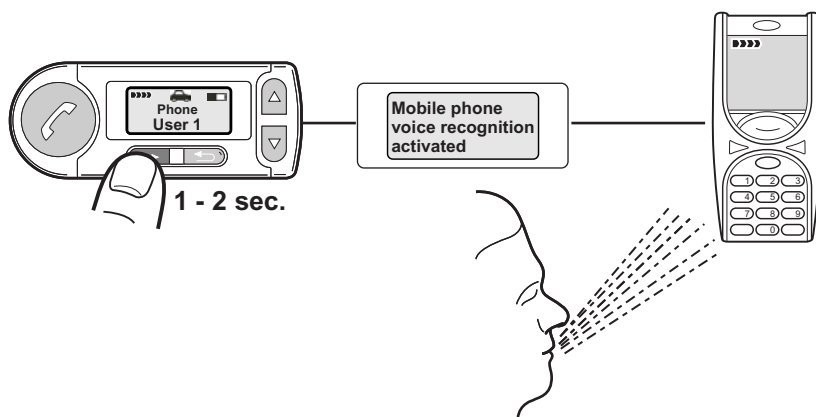



## 8 Accessories and spare parts

For information on the currently supported mobile phone models, visit [www.tellphone.com](http://www.tellphone.com) on the Internet. Your dealer will also be happy to advise you on all issues in this respect.

### Spare parts:

- ① microphone
- ② control unit
- ③ electronics box
- ④ connection cable set

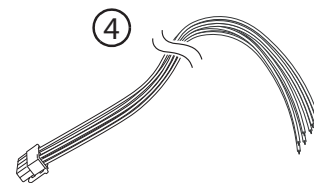
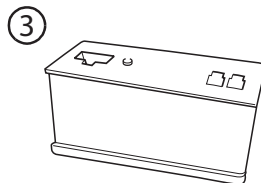
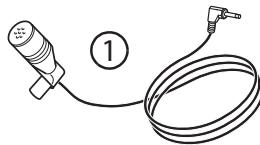

## 9 Technical Data

Dimensions of the electronics box	128mm x 76mm x 29mm
Dimensions of the Control Unit	90mm x 33mm x 18mm
Operating voltage	11 V to 15 V
Closed-circuit consumption	max. 0,1 mA
Open-circuit amperage	max. 750 mA
Fuse	1A and 2A
Operating temperature	-10 °C to +55 °C

## 10 Software Updating

You will find the current software under [www.tellphone.com](http://www.tellphone.com)

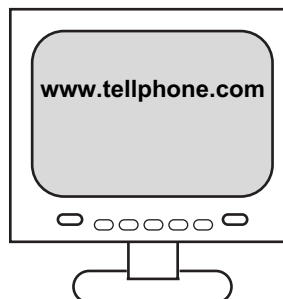

## 11 Hotline

Our hot line is open every business day from 8 a.m. to 6 p.m.

Procedure:

- Check if you can solve the problem with the aid of the "Troubleshooting" section.
- Keep the type designation of the hands-free system and the cradle set to hand.
- Try to describe the problem as precisely as possible.

You can call our hot line under the following numbers:

Phone: +1 858 566-2170

Fax: +1 858 566-2179

## 12 Troubleshooting

<b>Problem</b>	<b>Cause</b>	<b>Remedy</b>
TellPhone 4200 does not switch on.	There is no supply voltage.	If necessary, replace the fuse and check the cable and connections.
	The ignition is not turned on.	Turn on the ignition.
	The ignition line is interrupted.	Check cable and 1A fuse.
The person you are calling cannot hear you.	The microphone is not inserted or the microphone cable is damaged.	Connect the microphone plug to the electronics box. If the cable is defective, it must be replaced.
The person you are calling complains about interference noise.	The microphone is in an air stream.	Mount the microphone somewhere else or perhaps reduce ventilation.
	The phone is very close to the TellPhone 4200 parts or the car radio.	Increase the distance between your phone and the TellPhone 4200 or radio.
The person you are calling complains about echoes	The microphone and the speaker are not far enough apart.	Increase the distance between them or reduce the volume.
	The volume is too loud or the microphone sensitivity is too high.	Reduce the volume or perhaps reduce the microphone sensitivity at the electronics box.

<b>Problem</b>	<b>Cause</b>	<b>Remedy</b>
During device pairing, the phone cannot find the "TellPhone 4200".	The TellPhone 4200 is not in the pairing mode.	Initiate the device pairing (see section on Device Pairing).
	The phone does not support the set profile.	Abort the pairing, set another device class and try again.
Unclear, scratchy sound	Bad Bluetooth® connection	Reduce the distance between the phone and the Bluetooth® adapter or remove any (metallic) obstructions.
The paired phone is not connected when the ignition is turned on.	The phone is not within range.	Bring the phone within range of the Bluetooth adapter.
	The Bluetooth® interface is deactivated in the phone.	Switch your phone Bluetooth® "on" (the "automatic" option is not enough).
	The phone demands confirmation of the connection set-up.	Confirm the connection on the phone. Deactivate the security query (see operating instructions with the phone).
	One of the two devices does not have a valid connection code any longer.	Delete the respective other device from the list of paired devices in the two devices and start the pairing process again.

This device works with the Bluetooth® radio technology. In some countries, the use of this device might not be permitted or only allowed with restrictions. Please obtain information on such restrictions and do not use the device if you are not sure if its use is allowed in a specific country or not.

Bluetooth is a trademark owned by Bluetooth SIG, Inc.

## **Declaration of conformity**

The firm of

Funkwerk Dabendorf GmbH  
Märkische Strasse  
D-15806 Dabendorf

herewith declares that the

**Hands-Free Car Kit  
„TellPhone 4200“**

complies with the basic requirements and the other relevant provisions in the 1999/5/EC Directive.

The declaration can be seen at [www.fwd-online.de](http://www.fwd-online.de).

**CE 0681**

TellPhone 4200

---

**RAYTEL**

TellPhone 4200

---

**RAYTEL**

TellPhone 4200

---

**RAYTEL**

RAYTEL LLC a Nevada Limited Liability Company

8820 Kenamar Drive, Suite 506  
San Diego, CA 92121, USA

Phone: +1 858 566-2170  
Fax: +1 858 566-2179

[www.tellphone.com](http://www.tellphone.com)

---