



# STRATOCASTER® GUITAR AND CONTROLLER

Don't Just Play Games—*Play Guitar*

**The world's first electric guitar that's also  
an officially licensed Rock Band™ 3 video  
game controller**

- Compatible with the Pro mode of all Rock Band™ 3 game systems when used with the Mad Catz® MIDI PRO-Adaptor™ (sold separately)
- Position-sensing fingerboard turns your gameplay into real musical performances
- Use as a MIDI controller with your favorite sequencer and recording software

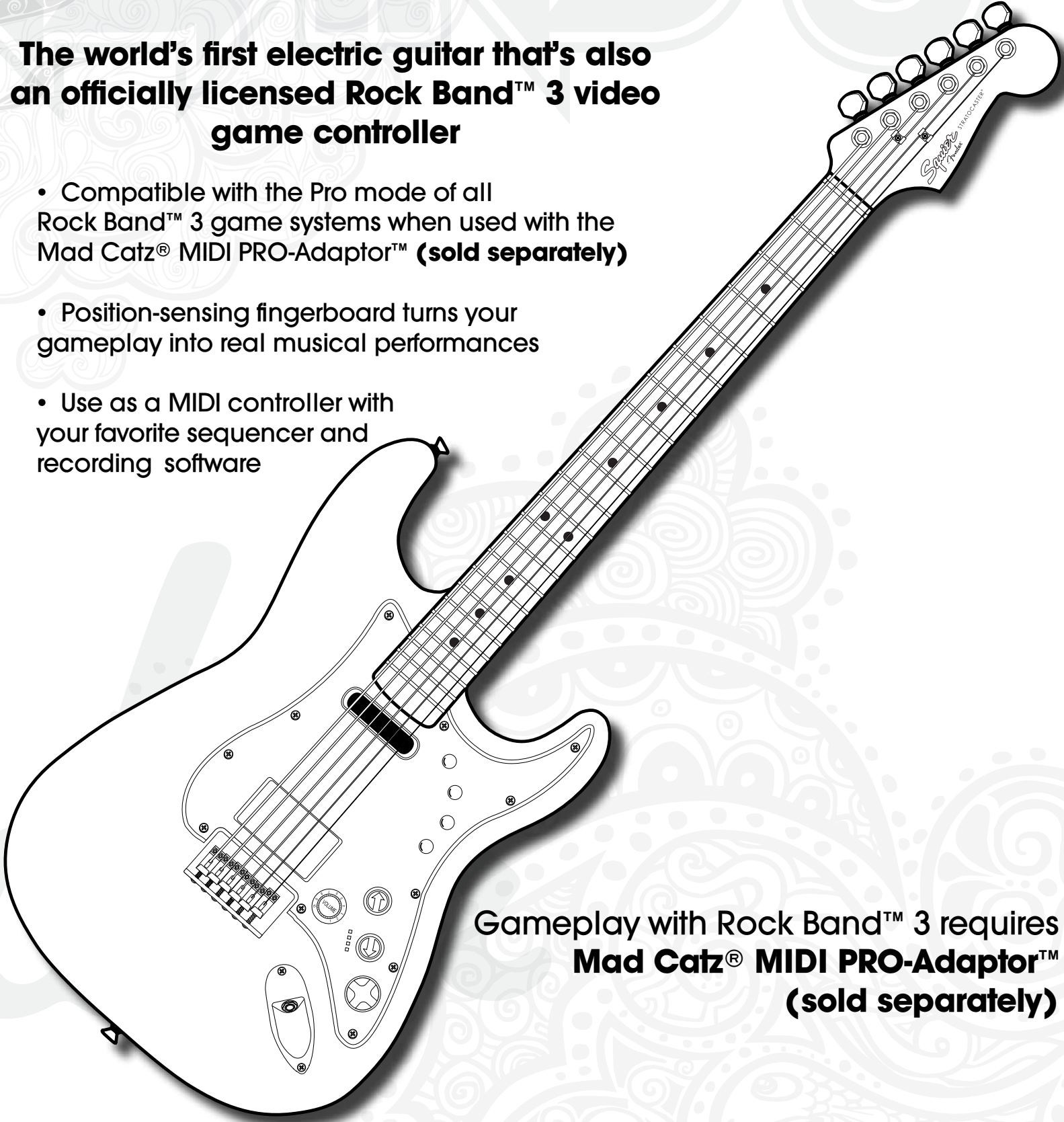

Gameplay with Rock Band™ 3 requires  
**Mad Catz® MIDI PRO-Adaptor™**  
(sold separately)

# Table of Contents

**2 Introduction**

**3 Features**

**4 Video Game and MIDI Connections**

**5 Guitar Amp Connection and Use**

**6 Video Game and Midi Use**

**9 FAQ/Problems and Solutions**

**11 Proper Care**

**11 Proper Setup**

**15 Service/Warranty**

## **Congratulations** on your purchase of the **Squier® by Fender® Stratocaster® Guitar and Controller**.

**Fender**, the name synonymous with rock 'n' roll, brings you the world's first electric guitar that is also an officially licensed **Rock Band™ 3** video game controller. Blending state-of-the-art gaming and guitar technology with the authenticity of **Fender** design and engineering, the **Squier by Fender Stratocaster Guitar and Controller** is created for musicians and gamers alike and rocks both worlds—whether plugged into a guitar amp or into a video game console.

Designed for the **Rock Band™ 3 Pro** mode, your new **Squier by Fender Stratocaster Guitar and Controller** elevates the gaming experience to the level of real music making by letting you play the actual notes and chords to your favorite songs while racking up high scores. Its position-sensing fingerboard responds to your touch, turning your gameplay into real performances.

The **Squier by Fender Stratocaster Guitar and Controller** is a full-size electric guitar loaded with quality features such as a contoured wood body, maple neck, steel strings, enclosed tuners, adjustable bridge and custom bridge pickup. Plug into your favorite guitar amplifier and turn it up, or use it as a MIDI controller in your home recording studio.

If you're not already a guitarist, you soon will be. If you're already a guitarist, you'll be a better one. The **Squier by Fender Stratocaster Guitar and Controller** is compatible with the **Wii™**, **Xbox 360™** and **PlayStation™ 3** systems. When used as a controller for **Rock Band™ 3**, the **Mad Catz® MIDI PRO-Adaptor™ (sold separately)** is required. Be sure to get the proper adaptor for your console.

In this manual, you'll find an overview of your **Squier by Fender Stratocaster Guitar and Controller's** features, use as a guitar, use as a game controller, general care, and service and warranty information.

**So read on, and remember: Don't just play games—play guitar.**

# Squier® by Fender® Stratocaster® Guitar and Controller

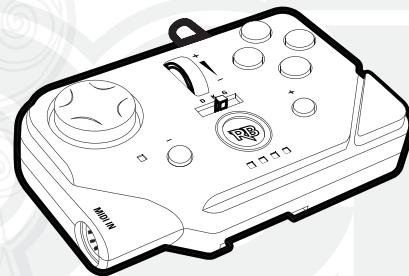

Rock Band™ 3 MIDI PRO-ADAPTER for Wii™  
Mad Catz® SKU# RB3 96071

Rock Band™ 3 MIDI PRO-ADAPTER for Xbox 360™  
Mad Catz® SKU# RB3 98071

Rock Band™ 3 MIDI PRO-ADAPTER for PlayStation® 3  
Mad Catz® SKU# Sku RB3 97071

**Mad Catz® MIDI PRO-Adaptor™  
REQUIRED FOR GAMEPLAY  
SOLD SEPERATELY BY MAD CATZ®**

Enclosed Tuners

Headstock

Neck and 22-fret  
position-sensing  
fingerboard

On/Off Switch

Battery Compartment  
(3 AA batteries included)

Strap Button

Truss Rod  
Adjustment  
(side of neck)

Green Button

Red Button

Yellow Button

Blue Button

Back Button

Volume Knob

Start Button

Indicator LEDs

4-way Navigation  
pad

5-Pin MIDI connector  
(side of body)

BACK OF GUITAR

String Mute

Pickguard

Pickup

Contoured Body

Adjustable Bridge

Strap Button

Recessed 1/4" Output Jack



# VIDEO GAME AND MIDI CONNECTIONS

## Rock Band™ 3 Gameplay

When used for **Rock Band™ 3** Pro mode gameplay, the **Squier® by Fender® Stratocaster® Guitar and Controller** connects to your **Wii™**, **Xbox 360™** or **PlayStation™ 3** video game console using the **Mad Catz® MIDI PRO-Adaptor™** (sold separately).

The diagram below illustrates the proper connection to the gaming system:

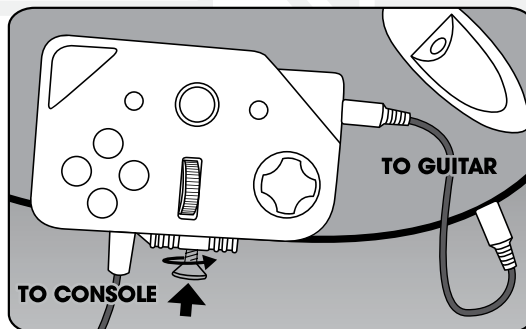

Guitar to Mad Catz® MIDI PRO-Adaptor™  
(sold separately)

## Use as a MIDI controller

To use the **Squier by Fender Stratocaster Guitar and Controller** as a MIDI controller for sequencers and recording software, the diagram below illustrates proper connection:

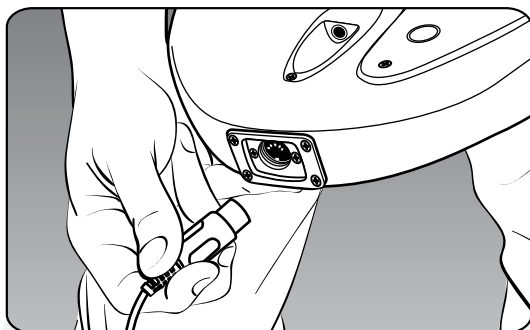

Guitar MIDI connector

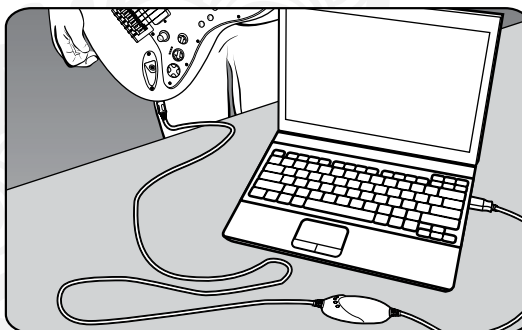

Guitar to MIDI controller to laptop computer

## GUITAR AMP CONNECTION AND USE

In addition to gameplay and MIDI use, what makes your **Squier® by Fender® Stratocaster® Guitar and Controller** so revolutionary is that it's also a fully functional electric guitar that can be played on its own through any guitar amplifier.

Simply plug one end of a standard guitar cable into the **Squier by Fender Stratocaster Guitar and Controller's** recessed ¼" output jack, and plug the other end into the amplifier, just as you would with any electric guitar (see the diagram below).

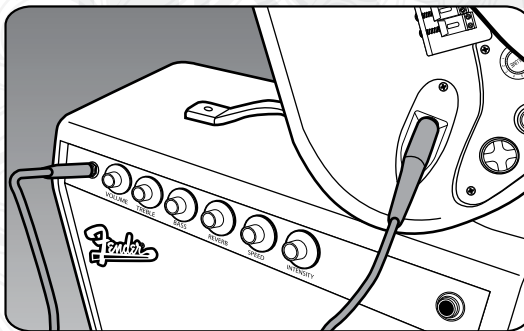

Guitar to Amp Connection

When played through a guitar amplifier, it is *not* necessary to engage the string mute or to turn the **Squier by Fender Stratocaster Guitar and Controller** on using the rear power switch. Just plug it in, turn it up and start playing.

# VIDEO GAME AND MIDI USE

## Rock Band™ 3 Gameplay

To use the **Squier® by Fender® Stratocaster® Guitar and Controller** with **Rock Band™ 3**, please refer to the **Rock Band™ 3** user manual and **Mad Catz® MIDI PRO-Adaptor™** instructions. Note that for **Rock Band™ 3** gameplay, the string mute should be engaged (by pressing on it so that it pops up and dampens the strings), and the **Squier by Fender Stratocaster Guitar and Controller** must be turned on via the rear power switch.

## MIDI Use

In addition to **Rock Band™ 3** gameplay capability, the **Squier by Fender Stratocaster Guitar and Controller** is MIDI-enabled, which means that it can be connected to MIDI synthesizers and that it can be used for recording on a computer.

## MODES

There are two modes of operation for MIDI use—**NORMAL** and **SYNTH**. Toggle between these two modes using the Start button, located near the volume knob and closest to the strings.

In **NORMAL** mode, the **Squier by Fender Stratocaster Guitar and Controller** generates what are called “MIDI note-on events,” which means that a signal is produced when the strings are strummed. **NORMAL** mode use is indicated by the illumination of the first of the four LEDs on the pickguard, as seen in the diagram below:

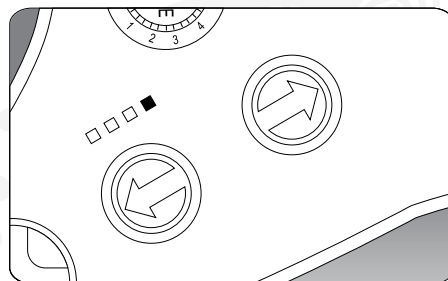

1st LED ON

In **SYNTH** mode, the **Squier by Fender Stratocaster Guitar and Controller** generates what are called “MIDI note-on/offs,” which means that a signal is produced when the strings are fretted and released (rather than strummed). **SYNTH** mode use is indicated by the blinking of the first of the four LEDs on the pickguard, as seen in the diagram below:

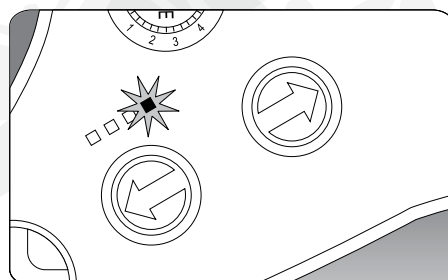

1st LED BLINKING

## PROGRAM CHANGES

The **Green and Red buttons** on the pickguard are used to send “program change up/down” messages in order to change sounds. On startup, the default program is “27,” which is the general MIDI program for “Electric Guitar (clean).”

## OCTAVE CHANGES

The **Yellow and Blue buttons** on the pickguard are used to transpose MIDI notes up or down by one octave. On startup, the low E string is set to E2.

## MIDI PITCHBEND

To toggle the MIDI pitchbend, first press and hold the **Back Button** and then press the **Yellow Button**. The third of the 4 LEDs will illuminate to indicate Pitchbend is enabled (see diagram below).

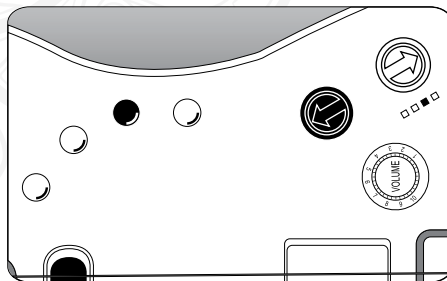

**PRESS ←+YELLOW WHEN 3rd LED IS ON**

Pitchbend is controlled by the angle of the neck, as seen in the three diagrams below:

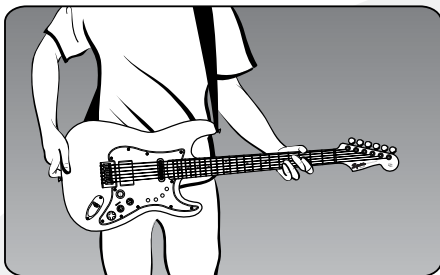

**NECK STRAIGHT OUT (CC Value = 0)**

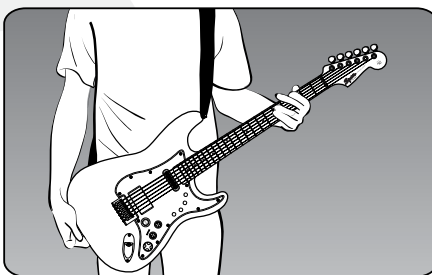

**NECK AT NORMAL POSITION (CC Value = 64)**

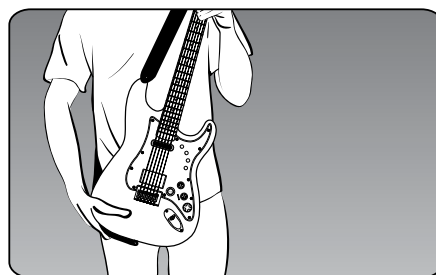

**NECK UP (CC Value = 127)**



## MIDI EXPRESSION CONTROL

To toggle the MIDI expression control, first press and hold the **Back Button** and then press the **Blue Button**. The fourth of the 4 LEDs will illuminate to indicate Expression Control is enabled (see diagram below).

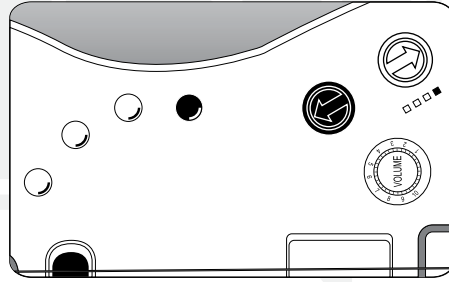

**PRESS ← + BLUE WHEN 4th LED IS ON**

Expression output is controlled by the angle of the **Squier® by Fender® Stratocaster® Guitar and Controller's** body, as seen in the three diagrams below:

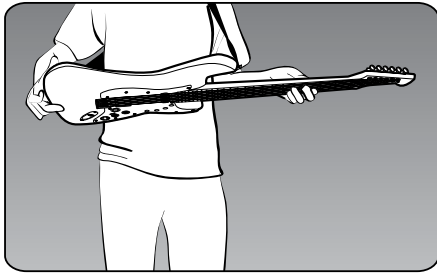

**PICKUP DOWN (CC Value = 0)**

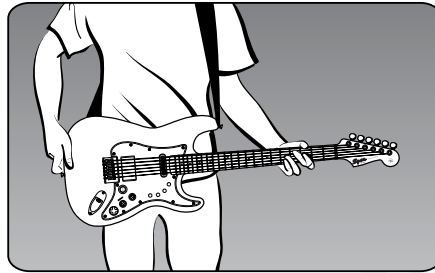

**PICKUP PARALLEL TO PLAYER (CC Value = 64)**

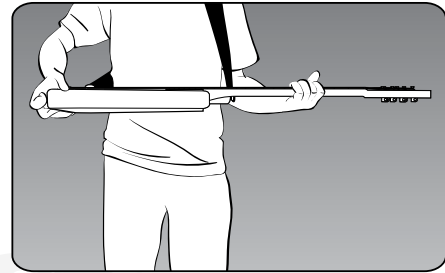

**PICKUP UP (CC Value = 127)**

## MIDI PANIC

Simultaneously pressing the Start and Back buttons cancels all notes.

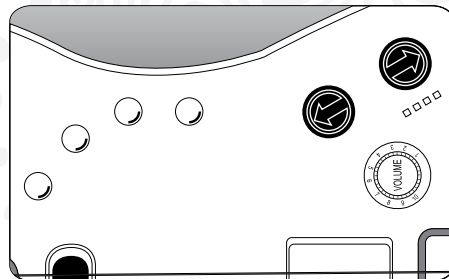

**PRESS ← + → SIMULTANEOUSLY**

## FAQ/PROBLEMS AND SOLUTIONS

**Q: Is the Squier® by Fender® Stratocaster® Guitar and Controller compatible with Rock Band™ 2 or The Beatles: Rock Band™?**

**A:** No. It is only compatible with **Rock Band™ 3**.

**Q: Can the Squier by Fender Stratocaster Guitar and Controller be used in the Standard mode of Rock Band™ 3?**

**A:** No. It can only be used in Pro mode to play guitar parts.

**Q: Is the Squier by Fender Stratocaster Guitar and Controller wireless? How do I connect it to Rock Band™ 3?**

**A:** It is not wireless; it must be connected to a gaming console using the Mad Catz® MIDI PRO-Adaptor™ required for your gaming system (see page 4 of this manual for connection information).

**Q: Do I need to properly tune the Squier by Fender Stratocaster Guitar and Controller in order to play Rock Band™ 3?**

**A:** No, but proper tuning is recommended nonetheless. If tuning is not possible, a good rule of thumb is to simply tighten the strings so that they do not touch the frets.

**Q: Should I use a guitar pick when playing Rock Band™ 3?**

**A:** Yes. We recommend using a pick (**sold separately**) for best performance.

**Q: Why does the Squier by Fender Stratocaster Guitar and Controller have a string mute? Do I need to use it when playing Rock Band™ 3?**

**A:** The string mute helps stabilize the signal sent to the game console. And yes, it should be engaged when playing **Rock Band™ 3**.

**Q: Should I engage the string mute when playing the Squier by Fender Stratocaster Guitar and Controller through a guitar amp?**

**A:** No.

**Q: Can I connect the Squier by Fender Stratocaster Guitar and Controller to a guitar amp while I'm using it to play Rock Band™ 3?**

**A:** Yes, but if you disengage the string mute to get a better amp sound, you'll lose points in the game.

**Q: Can I bend notes when playing Rock Band™ 3?**

**A:** You can, but bending notes is not recommended because the game won't properly detect it.

**Q: What are the four LEDs on the pickguard for?**

**A:** They're used in MIDI mode to indicate various MIDI functions, such as Pitchbend and Expression Control.

**Q: How do I trigger Overdrive when playing Rock Band™ 3?**

**A:** Overdrive is triggered by tilting the neck up, pressing the Back button or by pressing the Overdrive button on the **Mad Catz® MIDI PRO-Adaptor™**.

**Q: Will triggering Overdrive change the sound of the Squier by Fender Stratocaster Guitar and Controller's audio output?**

(9) **A:** No. Triggering Overdrive is a **Rock Band™ 3** function only.

## PROBLEMS AND SOLUTIONS

**Problem: The game doesn't recognize my Squier® by Fender® Stratocaster® Guitar and Controller.**

**Solution:** Make sure the **Squier by Fender Stratocaster Guitar and Controller** is properly connected to the **Mad Catz® MIDI PRO-Adaptor™**, and that the **Mad Catz® MIDI PRO-Adaptor™** is properly connected to the game console.

**Problem: My Squier by Fender Stratocaster Guitar and Controller shows up as a drum in the game.**

**Solution:** Make sure that the "Instrument Select Switch" on the **Mad Catz® MIDI PRO-Adaptor™** is set to "G" for "guitar."

**Problem: My Squier by Fender Stratocaster Guitar and Controller shows up as a keyboard in the game.**

**Solution:** Again, make sure that the "Instrument Select Switch" on the **Mad Catz® MIDI PRO-Adaptor™** is set to "G" for "guitar."

**Problem: The game is asking for a microphone, but I don't want to be the singer.**

**Solution:** This happens because when a stock controller is connected to the console, the game will look for a microphone (the controller is used to adjust the vocalist's settings). Make sure the **Squier by Fender Stratocaster Guitar and Controller** is properly connected to the **Mad Catz® MIDI PRO-Adaptor™**, and that the **Mad Catz® MIDI PRO-Adaptor™** is properly connected to the game console.

**Problem: The MIDI Input Indicator on the Mad Catz® MIDI PRO-Adaptor™ is flashing an "S.O.S." message. Why?**

**Solution:** This happens because the **Mad Catz® MIDI PRO-Adaptor™** is recognizing the absence of MIDI signal input. The message will stop as soon as the **Squier by Fender Stratocaster Guitar and Controller** is connected.

**Problem: When I pluck a string, sometimes the note does not score and my streak is broken.**

**Solution:** Make sure the string mute is engaged and is properly dampening the strings. Unmuted strings can miss notes and break gameplay streaks.

## PROPER CARE

### Proper Care of Your Squier® by Fender® Stratocaster® Guitar and Controller

Your **Squier by Fender Stratocaster Guitar and Controller** is precision-crafted to give you years of exciting gameplay and musical enjoyment. As with all musical instruments—electric guitars in particular—occasional maintenance will go a long way toward keeping it in great condition for many years to come. Since your **Squier by Fender Stratocaster Guitar and Controller** works as a fully functional electric guitar, here are a few tips for proper care:

- **Keep it clean.** Dirt, dust, sweat, skin oil, smoke and other accumulating impurities can prematurely age a guitar's finish and hardware. Wipe the strings, neck, fretboard and bridge often with a lint-free cloth. Do not use liquid cleaners on the neck and fretboard, since liquids can adversely affect the performance of electronic components housed in the neck. Use Fender-approved polish on the finished surfaces, and wipe other metal parts clean using a soft, dry polishing cloth (visit [www.fender.com](http://www.fender.com) to find products to do this with).
- **Tighten the strap buttons.** Strap buttons can and do loosen. Untreated, this can cause problems, so tighten them with a screwdriver every so often.
- **Avoid extreme weather.** Extremes of temperature and humidity can damage the **Squier by Fender Stratocaster Guitar and Controller** as they would damage any musical instrument. If such exposure can't be helped, however, loosen the strings to minimize harmful effects.
- **Prolong battery life.** When the **Squier by Fender Stratocaster Guitar and Controller** is not being used for gameplay, leave its on/off switch on the back in the off position. When finished with gameplay, remember to return this switch to the off position. Also, as noted earlier, it is not necessary to turn the switch on when playing through a guitar amplifier.

## PROPER SETUP

### Proper Setup for Your Squier by Fender Stratocaster Guitar and Controller

Your **Squier by Fender Stratocaster Guitar and Controller** works as a fully functional electric guitar. It's worth noting here that electric guitars are machines, and as such they benefit from and occasionally require periodic setup adjustments in order to maintain peak performance. Please feel free to familiarize yourself with several of the adjustments listed here regarding strings, tuning, truss rod adjustment, bridge adjustments (string height and intonation) and pickup height.

## STRINGS

The **Squier by Fender Stratocaster Guitar and Controller** is designed for use only with strings of .009 to .042 gauge. Heavier strings may damage the instrument. The warranty is void if strings of a heavier gauge than .009 to .042 are installed.

The **Squier by Fender Stratocaster Guitar and Controller** is designed for use only with nickel-plated steel strings. Pure nickel and stainless steel strings will not have good tracking results and should not be used. For optimum tracking results, use only **Fender 250 nickel-plated**

**steel strings, gauges .009 to .042 (part number 073-0250-403).** There is no better, faster and easier way to reinvigorate the sound of an electric guitar than by simply changing the strings. It's easy to tell when strings are old, worn or dirty, because they'll sound dull and lifeless, look corroded, and feel rough to the touch. The electrical conductivity of the **Squier® by Fender® Stratocaster® Guitar and Controller's** strings can be compromised when they accumulate excessive dirt or wear. You might also find that gameplay can be affected by inaccurate tracking, and that some notes will be missed or dropped.

To ensure top performance from your **Squier by Fender Stratocaster Guitar and Controller**, make sure to change your strings on a regular basis. See your **Fender** dealer to purchase replacement **Fender nickel-plated steel strings**.

## TUNING

Tuning the strings of the **Squier by Fender Stratocaster Guitar and Controller** isn't strictly necessary for gameplay, although it is recommended. Tuning is necessary, however, when playing it through an amplifier.

Tuning is easily accomplished using an electronic tuner, which you might want to purchase (many are small and inexpensive). Simply plug the **Squier by Fender Stratocaster Guitar and Controller** into an electronic tuner and tune up as you would with any electric guitar. With the volume all the way up, pluck an open string or its 12th-fret harmonic to produce the clearest tone for the tuner (a harmonic is a chime-like tone produced by lightly touching the string at specific points with a fretting hand fingertip and plucking the string with the other hand; the 12th fret harmonic is used for tuning). Note that pressing down too hard with the fretting hand will "choke" the string and mute the sound. With a little practice, however, the light touch needed to sound the harmonic tone is easily developed.

## TRUSS ROD ADJUSTMENT

The truss rod is the unseen device inside the neck of a guitar that counteracts the bending force caused by string tension and maintains proper neck "relief" (curvature). A properly adjusted neck will have a moderate amount of relief in order to accommodate the vibration of the strings. See diagrams below.

To measure neck relief, two tools are needed—a capo (a small movable bar placed across the fingerboard of a guitar or similar instrument so as to raise the pitch of all the strings uniformly) and a set of automotive feeler gauges (.002-.025). The amount of relief is determined by fixing the capo to the first fret, fretting the low E string at the last fret and measuring the distance from the bottom of the low E string to the top of the eighth fret (the fret wire itself, not the fingerboard) using the feeler gauges. This distance should be about .010". Further, when sighting down the neck from the body end toward the headstock, you should be able to see if the neck is straight or bowed. If there is too much relief or none at all, the truss rod should be adjusted.

Your new **Squier by Fender Stratocaster Guitar and Controller** has a unique hex nut truss rod adjustment mechanism, easily accessible through the small hole in the side of the neck just below the 20th fret (see diagram below).

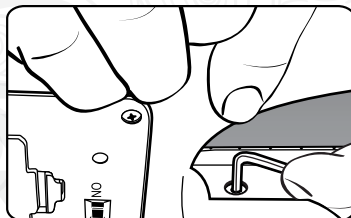

Truss Rod Adjustment

If the neck is too concave, insert the 3mm hex wrench supplied with the **Squier® by Fender® Stratocaster® Guitar and Controller** into the hex nut and turn it toward the battery holder, clockwise a quarter-turn at a time until the relief is correct. If the neck is too convex, insert the 3mm hex wrench into the hex nut and turn it toward the headstock, counter-clockwise a quarter-turn at a time until the relief is correct (see diagrams below). You can double check your adjustments by measuring the eighth-fret gap again with the feeler gauges and by sighting down the neck again.

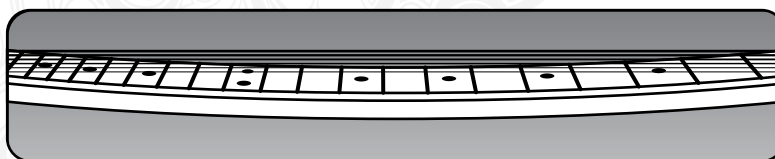

Convex Neck Relief

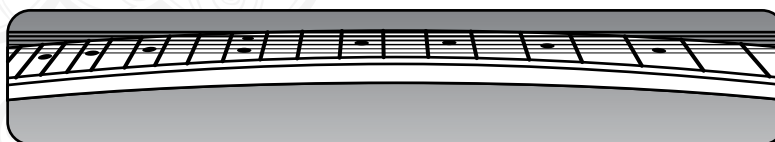

Concave Neck Relief

If you meet excessive resistance or if you're simply not comfortable performing these measurements and adjustments yourself, you can always take your **Squier by Fender Stratocaster Guitar and Controller** to your **Fender** dealer for assistance.

## BRIDGE ADJUSTMENTS (STRING HEIGHT AND INTONATION)

The bridge is where the strings are attached to the body end of the **Squier by Fender Stratocaster Guitar and Controller**, as is the case with all electric guitars. Two important adjustments can be made at the bridge—string height and intonation.

String height is mostly a matter of personal preference, although a distance of about  $\frac{4}{64}$ " (1.6 mm) from the bottom of each string to the top of the 17th fret is recommended when the instrument is more or less in tune. This distance can be measured using a small ruler with  $\frac{1}{64}$ " increments. The individual bridge saddles are easily adjusted up or down using the included small hex wrench.

Please note that string height and pickup height are factory-set for optimal performance; if you change string height significantly, pickup height must also be reset (see "Pickup Height" below).

"Intonation" refers to a precise series of measurements regarding proper string length and how accurately each string plays in tune along the entire length of the neck. The intonation on your **Squier by Fender Stratocaster Guitar and Controller** is factory-set and, under normal

circumstances, shouldn't require adjustment. As strings age, however, their intonation can deteriorate—if your **Squier by Fender Stratocaster Guitar and Controller** doesn't play in tune, start by installing a fresh set of strings. If tuning problems persist, please visit [www.fender.com/support](http://www.fender.com/support) or contact your **Fender** dealer.

## PICKUP HEIGHT

The pickup height of your **Squier® by Fender® Stratocaster® Guitar and Controller** is factory-set for maximum sensitivity for **Rock Band™ 3** gameplay. As previously noted, significant string height changes will require pickup height adjustment.

To determine and properly adjust pickup height, fret the low E string at the 22nd fret and measure from the top of the pickup to the bottom of the string using a small ruler with 1/64" increments; the distance should be no more than 1/16" (1.6 mm). Repeat this measurement for the high E string. To raise the pickup accordingly, simply turn the two Philips-head screws on either side of the pickup clockwise. To lower the pickup, turn the screws counterclockwise.

# SERVICE/WARRANTY

## SERVICE

For service in the United States and Canada, please contact an Authorized Fender Service Center, which you can find by calling our **Fender Consumer Relations Department (480.596.7195)**, emailing **consumerrelations@fender.com** or using the **“Service Center Finder”** link on the **“Support”** section of **www.fender.com**.

For service outside the United States and Canada, please contact your authorized dealer or the **Fender** distributor in your country or region—there’s a helpful global **“International Distributor”** link on the **“Resources”** section of **www.fender.com**.

## **SQUIER® by FENDER® STRATOCASTER® GUITAR and CONTROLLER 1-YEAR LIMITED WARRANTY**

**Fender Musical Instruments Corporation (“FMIC”)** warrants this **Squier by Fender Stratocaster Guitar and Controller** to be free from defects in materials and workmanship if used under normal operating conditions for a period of **one (1) year from the date of original purchase**, except that cables and any other included accessory products are warranted for a period of **ninety (90) days from date of purchase**. This warranty applies only to the original retail purchaser when this instrument is purchased from an **Authorized Squier Dealer** and is subject to the limitations set forth herein. **IMPORTANT: PLEASE RETAIN YOUR ORIGINAL SALES RECEIPT, AS IT IS YOUR PROOF OF PURCHASE VALIDATING THIS LIMITED WARRANTY.**

Should a defect in parts or workmanship occur in any component of the **Squier by Fender Stratocaster Guitar and Controller**, return the product to the **Authorized Squier Dealer** from whom it was purchased, with your sales receipt as proof of purchase, during the applicable warranty period. Defective products that qualify for coverage under this warranty will be repaired or replaced with a like or comparable model (at Fender’s discretion), without charge, by the Dealer.

All transportation costs, including freight and insurance charges, associated with obtaining warranty service and repairs on **Squier by Fender Stratocaster Guitar and Controller** instruments are the responsibility of the purchaser, as is any service initiated for the purpose of customizing adjustments beyond factory specifications. Initial standard setup and adjustment of the instrument and its components at the time of purchase are considered normal dealer preparation.

The **Squier by Fender Stratocaster Guitar and Controller** is designed for use only with strings of .009 to .042 gauge. Heavier gauge strings may cause damage to the instrument. This warranty is void if strings of a heavier gauge than .009 to .042 are installed.



# LIMITATIONS AND EXCLUSIONS

The following items are not covered by this warranty.

1. Damage to the **Squier® by Fender® Stratocaster® Guitar and Controller** caused by the use of strings heavier than .009 to .042 gauge.
2. Fret wear, saddle wear, nut wear, strings and batteries.
3. Setups, adjustments or routine maintenance of any kind.
4. Damage to finishes or cracks, splitting, or warpage of wood due to changes in temperature or humidity, exposure to or contact with sun, fire, moisture, body salts and acids of perspiration, gig bags, guitar straps, guitar stands/hangers made from vinyl, plastic, rubber or other synthetic materials, any other chemicals or non-FMIC-approved polishes.
5. Damage, corrosion or rusting of any hardware components caused by humidity, salty air, or exposure to the moisture, body salts and acids of perspiration.
6. Any damage to an instrument resulting from customization or modification.
7. Normal wear and tear on any part of the **Squier by Fender Stratocaster Guitar and Controller**, including jacks, controls, switches, plated surfaces, tuning machines, pickguards, hardware etc.
8. All other damage and deterioration due to normal usage, wear and tear, aging, accidents, neglect, abuse, or Acts of Nature.
9. Any instrument, whose serial number is missing, altered or tampered with in any fashion.
10. Any instrument purchased from anyone other than an **Authorized Squier® Dealer**.
11. Instruments that have been serviced by unauthorized persons (any person other than an **FMIC Certified Technician** at an **Authorized FMIC Service Center**).

**FMIC ASSUMES NO LIABILITY FOR PROPERTY DAMAGE RESULTING FROM FAILURE OF THIS PRODUCT NOR ANY LOSS OF INCOME, SATISFACTION, OR DAMAGES ARISING FROM THE LOSS OF USE OF SAME DUE TO DEFECTS OR AVAILABILITY OF SAME DURING SERVICE.**

Any warranties implied by law (including warranties of merchantability or fitness) are limited to the duration of this express limited warranty. Some states do not allow limitations on how long an implied warranty lasts, so the above limitations may not apply to you. Some states do not allow the exclusion or limitations of incidental or consequential damages, so the above limitation or exclusion may not apply to you. This warranty gives you specific legal rights, and you may also have other rights which vary from state to state.

**WARRANTIES STATED HEREIN ARE OFFERED ONLY BY FENDER MUSICAL INSTRUMENTS CORPORATION AND NOT HARMONIX MUSIC SYSTEMS, INC. OR MTV NETWORKS, A DIVISION OF VIACOM INTERNATIONAL INC. OR THEIR AFFILIATES.**

**SERVICE/  
WARRANTY**

**NOTE: This warranty applies only to Squier® by Fender® Stratocaster® Guitar and Controller and controller instruments purchased and serviced within the U.S.A. and Canada.**

**Warranties outside these countries are as defined by the authorized Fender Distributor for your country or region, and may vary from the above in terms and/or length.**

This equipment has been tested and found to comply with the limits for a Class B digital device, pursuant to Part 15 of the FCC rules. These limits are designed to provide reasonable protection against harmful interference in a residential installation. This equipment generates, uses and can radiate radio frequency energy and if not used in accordance with the instructions, may cause harmful interference to radio communications and there is no guarantee that interference will not occur in a particular installation. If this equipment does cause harmful interference to radio or television reception, which can be determined by turning the equipment off and on, the user is encouraged to try to correct the interference by one or more of the following measures: reorient or relocate the receiving antenna, increase the separation between the equipment and receiver, connect the equipment into an outlet on a circuit different from that of the receiver. Consult the dealer or an experienced radio/TV technician if help is needed with interference.

**NOTE:** FMIC will not be responsible for unauthorized equipment modifications that could violate FCC rules, and/ or void product safety certifications.

This warranty applies only to Fender instruments manufactured after January 1, 1998, and purchased and serviced within the U.S.A. and Canada. Warranties outside these countries are as defined by the authorized Fender Distributor for your country or region, and may vary from the above in terms and/or length.

PR1186

Fender Musical Instruments Corp.  
8860 East Chaparral Road, Suite 100  
Scottsdale, Ariz. 85250-2610 U.S.A.  
Phone: 480.596.9690  
[www.fender.com](http://www.fender.com)

© 2010 Fender Musical Instruments Corporation. All rights reserved. Fender®, SQUIER®, STRATOCASTER®, and the distinctive headstock design commonly found on those guitars are registered trademarks of Fender Musical Instruments Corporation.

© 2010 Harmonix Music Systems, Inc. All Rights Reserved. Harmonix, Rock Band and all related titles and logos are trademarks of Harmonix Music Systems, Inc., an MTV Networks company. Rock Band, Rock Band 2, Rock Band 3, Rock Band Network, Green Day: Rock Band, The Beatles: Rock Band and other related products and services developed by Harmonix Music Systems, Inc. MTV: Music Television, MTV Games and all related titles and logos are trademarks of MTV Networks, a division of Viacom International Inc. The Rock Band trademark is used under license from Harmonix Music Systems, Inc., an MTV Networks company.

Mad Catz and the Mad Catz logo registered trademarks of Mad Catz, Inc.

Microsoft, Xbox, Xbox 360 and the Xbox logos are trademarks of the Microsoft group of companies. PlayStation and PS3 are trademarks or registered trademarks of Sony Computer Entertainment Inc. (SCEI). Nintendo and Wii are trademarks or registered trademarks of Nintendo. This product is not sponsored, endorsed or approved by Microsoft, SCEI or Nintendo.

All other product names and images are trademarks or registered trademarks of their respective owners. Made in China. All rights reserved.

Product features, appearance and specifications may be subject to change without notice. Please retain this information for future reference.

US Patent No. 5,990,405

IMPORTADO POR: Instrumentos Musicales Fender S.A. de C.V., Calle Huerta # 132, Col. Carlos Pacheco, C.P. 228890, Ensenada, Baja California, Mexico.  
RFC: IMF870506R5A Hecho en Mexico. Servicio de Cliente: 001-8665045875

**SERVICE/  
WARRANTY**

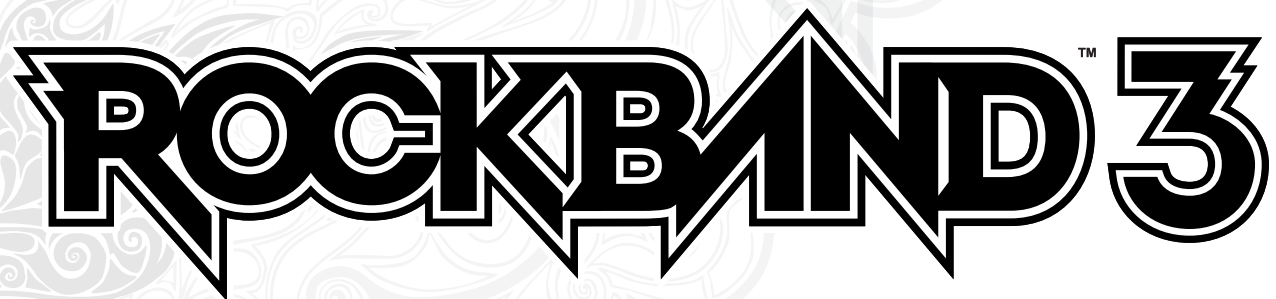
The logo for Rock Band 3, featuring the words "ROCK BAND" in a stylized, jagged, black font with white outlines, followed by a large "3" in the same style. A small "TM" trademark symbol is positioned above the "D" in "BAND".

**ROCK BAND™ 3**

The Fender logo, written in its signature black script font with a registered trademark symbol (®) at the end.

**Fender®**

P/N 0081883000 Rev. B

© 2010 FENDER MUSICAL INSTRUMENTS CORP.