

# FROSTIG

BCF201/65  
BCF162/95





## Contents

<b>Safety information</b>	<b>4</b>	<b>What to do if...</b>	<b>9</b>
<b>Product description</b>	<b>6</b>	<b>Technical data</b>	<b>10</b>
<b>First use</b>	<b>7</b>	<b>Environmental concerns</b>	<b>10</b>
<b>Daily use</b>	<b>7</b>	<b>Electrical connection for Great Britain and Ireland only</b>	<b>11</b>
<b>Cleaning and maintenance</b>	<b>8</b>	<b>IKEA GUARANTEE</b>	<b>12</b>

## Safety information

### Before first use

This appliance is intended to be used in household.

To ensure best use of your appliance, carefully read this User Manual which contains a description of the product and useful advice.

Keep these instructions for future reference.

1. After unpacking the appliance, make sure it is not damaged and that the door closes properly. Any functional fault must be reported to IKEA After Sales Service as soon as possible.
2. Wait at least two hours before switching the appliance on, to ensure that the refrigerant circuit is fully efficient.
3. The electrical installation and the electrical connection must be carried out by a qualified technician according to the manufacturer's instructions and in compliance with the local safety regulations.
4. Clean the inside of the appliance before using it.

### Precautions and general recommendations

#### Installation and connection

- The appliance must be handled and installed by two or more persons.
- Be careful not to damage the floors (e.g. parquet) when moving the appliance.
- During installation, make sure the appliance does not damage the power cable.
- Make sure the appliance is not near a heat source.
- To guarantee adequate ventilation, leave a space on both sides and above the appliance and follow the installation instructions.
- Keep the appliance ventilation openings free.
- Do not damage the appliance refrigerant circuit pipes.
- Install and level the appliance on a floor strong enough to take its weight and in a place suitable for its size and use.
- Install the appliance in a dry and well-ventilated place. The appliance is arranged for operation in places where the temperature comes within the following ranges, according to the climatic class

given on the rating plate. The appliance may not work properly if it is left for a long time at a temperature outside the specified range.

- Make sure the voltage specified on the rating plate corresponds to that of your home.

Climatic Class	Amb. T. (°C)	Amb. T. (°F)
SN	From 10 to 32	From 50 to 90
N	From 16 to 32	From 61 to 90
ST	From 16 to 38	From 61 to 100
T	From 16 to 43	From 61 to 110

- Do not use single/multi adapters or extension cords.
- For the water connection, use the pipe supplied with the new appliance; do not reuse that of the previous appliance.
- Power cable modification or replacement must only be carried out by qualified personnel or by After-sales Service.
- It must be possible to disconnect the appliance from the power supply by unplugging it or by means of a mains two-pole switch installed upstream of the socket.

#### Safety

- Do not store explosive substances such as aerosol cans with a flammable propellant in this appliance.
- Do not store or use petrol, flammable liquids or gas in the vicinity of this or other electrical appliances. The fumes can cause fires or explosions.
- Do not use mechanical, electric or chemical means other than those recommended by the Manufacturer to speed up the defrost process.
- Do not use or place electrical devices inside the appliance compartments if they are not of the type expressly authorised by the Manufacturer.
- This appliance is not intended for use by persons (including children) with reduced physical, sensory or mental capabilities, or lack of experience and knowledge, unless they have been given supervision or instruction concerning use of the appliance by a person responsible for their safety.

- To avoid the risk of children becoming trapped and suffocating, do not allow them to play or hide inside the appliance.
- Do not swallow the contents (non-toxic) of the ice packs (in some models).
- Do not eat ice cubes or ice lollies immediately after taking them out of the freezer since they may cause cold burns.

**Use**

- Before carrying out any maintenance or cleaning operation, unplug the appliance or disconnect it from the power supply.
- All appliances equipped with an automatic ice-maker and water dispenser must be connected to a water supply that only delivers drinking water (with mains water pressure of between 0.17 and 0.81 Mpa (1.7 and 8.1 bar)). Automatic ice-makers and/or water dispensers not directly connected to the water supply must be filled with drinking water only.
- Use the refrigerator compartment only for storing fresh food and the freezer compartment only for storing frozen food, freezing fresh food and making ice cubes.
- Do not store glass containers with liquids in the freezer since they may burst.

The Manufacturer declines any liability if the above advice and precautions are not respected.

**Cleaning, sanitization and maintenance of the ice and water dispenser (if present)**

Failure to observe the sanitization instructions provided may compromise the hygiene and safety of water dispensed.

- When using the appliance for the first time, discard the first 9-14 litres of water, equivalent to 6-7 minutes of dispensing (not necessarily consecutive, but before initial consumption) and discard the ice produced in the first 24 hours.
- Reposition the removable water dispenser (if present), ensuring your hands are hygienically clean.
- Periodically clean the ice bucket or drawer under running water only.
- Every six months, sanitize the water and ice dispenser system using a food grade disinfectant solution (with sodium hypochlorite) which does not taint the appliance materials. Rinse with water before use.
- Replacement of any parts of the ice and water dispenser must be carried out using original spare parts provided by the Manufacturer.
- Any work on the appliance must be carried out by a qualified technician or the After-sales Service.

**Product description**

Carefully read the operating instructions before using the appliance.

**BCF201/65**

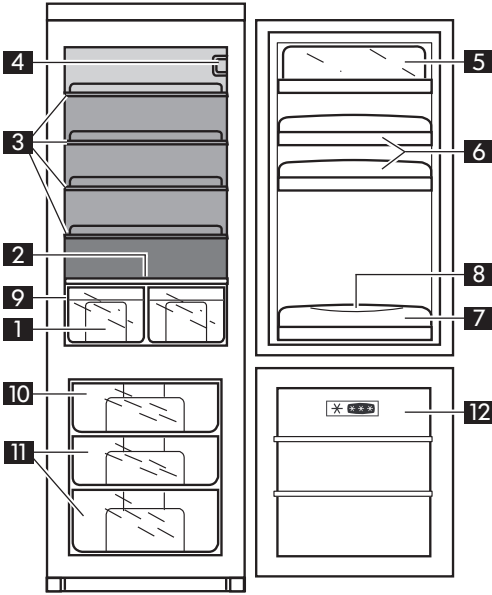

**Refrigerator compartment**

- 1 Crisper drawers
- 2 Crisper shelf
- 3 Shelves / Racks
- 4 Thermostat unit with light
- 5 Upper door tray
- 6 Door trays
- 7 Bottle rack
- 8 Removable bottle holder
- 9 Rating plate (at the side of crisper)

**Freezer compartment**

- 10 Upper basket (freezing area)
- 11 Frozen/deep frozen food storage compartment
- 12 Freezer compartment inner door

- ☐ Least cold zone
- ▒ Intermediate temperature zone
- Coldest zone

Features, technical information and images may vary depending on model

**BCF162/95**

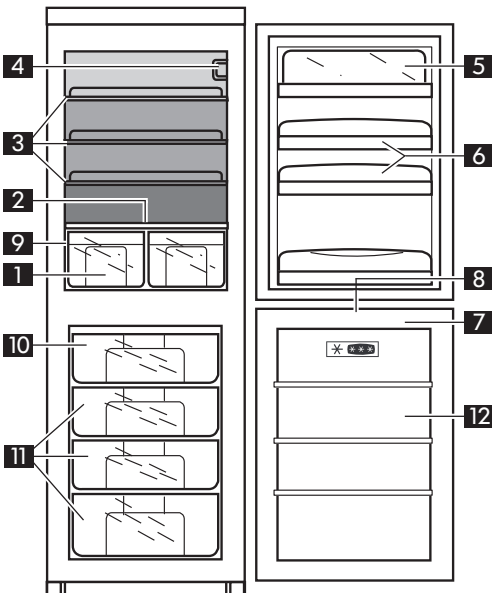

**Accessories**

Egg tray

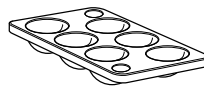

1x

Ice tray

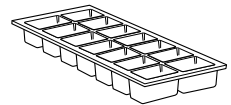

1x

## First use

Connect the appliance to the mains power supply. The ideal temperatures for preserving food have already been set at the factory (3-5/MED).

Note: After switching the appliance on, it will be

necessary to wait for 2 to 3 hours before a temperature suitable for a standard appliance load is reached.

## Daily use

### Operation of the refrigerator and freezer compartment

- If the refrigerator compartment of your appliance is fitted with a thermostat box the temperature of both compartments is adjusted using the thermostat knob as shown in figure 1. Move the knob to the ● position to switch the whole appliance off.
- If in addition to the internal thermostat box your appliance also has an external control panel with an adjustment knob, the temperatures of the two compartments must be adjusted separately. The knob of the thermostat inside the refrigerator compartment is used for adjusting the temperature of the refrigerator compartment only (see fig. 1), while the external panel is used to adjust the temperature of the freezer compartment.

The refrigerator and the freezer compartments can be switched off separately by moving the corresponding knobs to ●.

**Note:** The ambient temperature, frequency of door opening and position of the appliance can affect the temperatures inside the two compartments. These factors must be taken into consideration when setting the thermostat.

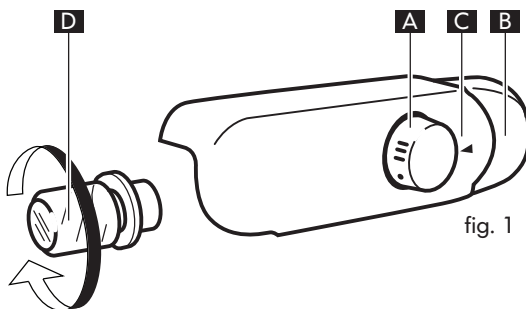

fig. 1

- A** Thermostat control knob
- B** Light button
- C** Thermostat position setting notch
- D** Light bulb (see instructions near the light bulb)

Thermostat on **1/MIN: Low refrigeration level**  
 Thermostat on **3-5/MED: Medium refrigeration**  
 Thermostat on **7/MAX: Maximum refrigeration**  
 Thermostat on **●: Both refrigeration and illumination are switched off.**

To remove the light bulb turn anticlockwise as shown in figure 1.

### Freezing fresh food

Place the fresh food to be frozen inside the freezer compartment. Avoid direct contact with already frozen food. To freeze the quantity of food shown on the serial tag, remove the top drawer and place the food directly on the rack.

### Refrigerator compartment

Refrigerator compartment defrosting is completely automatic. Droplets of water on the rear wall inside the refrigerator compartment indicate that the automatic defrost phase is in progress. The defrost water is automatically run into a drain hole and collected in a container, where it evaporates.

### Fan (if provided)

The fan operates automatically. The fan ensures a more consistent distribution of the temperature inside the refrigerator compartment, with better preservation of food and reduction of excess humidity. Do not obstruct the suction zone with food. The fan is only active when the motor is in operation.

**⚠ Caution!** The refrigerator accessories must not be placed in a dishwasher.

### Freezer compartment

This appliance is a refrigerator with a **★☆☆** star rating freezer compartment. Packed frozen foods can be stored for the period indicated on the packing. Fresh food can also be frozen, ensuring that any contact with already frozen food is avoided. The quantity of fresh food that can be frozen in a 24 hour period is given on the rating plate. Re-freezing of partially defrosted food is not recommended. This food should be consumed

within 24 hours. For further information on freezing fresh food, refer to the quick guide.

### Removing the baskets (depending on the model)

Pull the drawers out as far as they go, then lift slightly and remove.

**Note:** The freezer can also be used without the upper drawers, in order to maximise space. For correct operation of the freezer compartment the bottom drawer should not be removed. Ensure that

after placing the food on the racks, the freezer door closes properly.

### Making ice cubes (if provided)

Fill the ice cube tray up to 2/3 with water and place in the freezer compartment. Do not use sharp or pointed objects to detach the tray.

## Cleaning and maintenance

Regularly clean the appliance using a cloth and a solution of warm water, with some soft detergent suitable for cleaning the inside of the refrigerator compartment. Do not use abrasive detergents or tools. To ensure continuous and correct flow of defrost water, regularly clean the inside of the draining hole on the back of the refrigerator near the fruit and vegetable drawer, using the tool provided (see fig.1).

Before carrying out any cleaning or maintenance operation, unplug the appliance or disconnect it from the power supply.

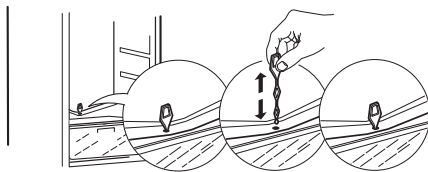

fig. 1

### Defrosting the freezer compartment

The freezer should be defrosted once or twice a year or when excessive frost is present (3 mm thickness).

The formation of frost is normal. The amount and rate at which frost accumulates depends on room conditions and how often the door is open.

To defrost the unit, switch off the freezer compartment or the whole appliance, depending on the model, and remove all food products.

Leave the freezer door open to allow the frost to melt. For appliances in fig. 2 only pull out the defrost water drain and place a container under the drain. When the operation is completed, replace the defrost water drain.

Clean the inside of the freezer. Rinse and dry thoroughly. Switch the freezer compartment, or the whole appliance, back on and store the food inside.

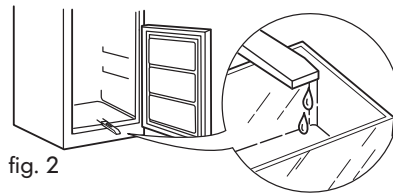

fig. 2

### Storing food

Wrap food so that no water, moisture or condensate can enter; this will prevent odours or aromas going from one part to another in the refrigerator, ensuring better preservation of frozen foods.

Never place hot food in the freezer. Cooling hot foods before freezing saves energy and prolongs the life of the appliance.

### If the appliance is not going to be used

Disconnect the appliance from the power supply, remove all the food, defrost and clean. Leave the doors open enough for air to circulate inside the compartments. This will prevent the formation of mould and bad odours.

### In case of power failures

Keep the doors of the appliance closed. In this way the stored food will stay cold as long as possible. Do not refreeze partially thawed food, consume it within 24 hours.



## What to do if...

Problem	Possible cause	Solution
The control panel is off and/or the appliance does not operate	There might be a problem with the electric power supply to the appliance.	Check that: <ul style="list-style-type: none"> <li>• there isn't a power supply failure</li> <li>• the power plug is correctly inserted in the power socket and the two-pole switch, if present, is in the correct position (on)</li> <li>• the electric circuit safety devices installed in the house are fully functional</li> <li>• the power supply cable is not broken</li> </ul>
The inside light does not work.	The lamp might need replacing.	Disconnect the appliance from the electric power supply, check the lamp and replace with a new one if necessary (see "Daily use").
The temperature inside the compartments is not cold enough.	There may be several causes (see "Solutions")	Check that: <ul style="list-style-type: none"> <li>• the doors are closed correctly</li> <li>• the appliance is not placed near a heat source</li> <li>• the temperature set is appropriate</li> <li>• air circulation through the ventilation grills at the bottom of the appliance is not obstructed</li> </ul>
There is water at the bottom of the refrigerator compartment	The defrost water drain is obstructed.	Clean the defrost water drain hole (see "Cleaning and maintenance").
The front edge of the appliance is hot at the door seal edge.	This is not a fault. It is part of the design to prevent the formation of condensation.	No solution is necessary.
Only if your product has a control panel. If red temperature alarm lights up and an acoustic signal sounds (according to the model)	Temperature Alarm Freezer Compartment The temperature alarm indicates that the freezer compartment temperature is not optimum. This can occur during first usage, after defrosting and or cleaning, when freezing big quantities of food or when the freezer door doesn't close properly.	To deactivate acoustic signal press the Rapid freezing button. When optimal temperature is reached the temperature alarm light will automatically switch off. If temperature alarm light stays on contact After Sales Service.

### Note:

- Gurgling, hissing and humming noises from the refrigerating system are normal.

**Before contacting the After-sales service:**

Switch the appliance on again to see if the problem has disappeared. If not, switch it off again and repeat the operation after an hour.

If your appliance still does not work properly after carrying out the checks listed in the troubleshooting guide and switching the appliance on again, contact the After-sales service, clearly explaining the problem and specifying:

- the type of fault;
- the model;
- the type and serial number of the appliance (given on the rating plate);
- the Service number (the number after the word SERVICE on the rating plate inside the appliance).

**SERVICE** 0000 000 00000



**Note:**

Reversing of appliance door opening is not covered by the warranty.

**Technical data**

Dimensions	BCF201/65	BCF162/95
Height	1770	1770
Width	540	540
Depth	545	545
<b>Net Volume (l)</b>		
Fridge	201	162
Freezer	65	95
<b>Defrost system</b>		
Fridge	Automatic	Automatic
Freezer	Manual	Manual
<b>Star Rating</b>	4	4
<b>Rising Time (h)</b>	19	19
<b>Freezing Capacity (kg/24h)</b>	3,5	4,5
<b>Energy consumption (kwh/24h)</b>	0,75	0,78
<b>Noise level (dba)</b>	37	39
<b>Energy class</b>	A+	A+

The technical information are situated in the rating plate on the internal side of the appliance and in the energy label

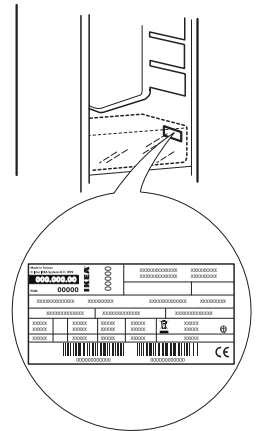

**Environmental concerns**

**1. Packing ♻**

The packing material is 100% recyclable and bears the recycling symbol. For disposal, comply with the local regulations. Keep the packing materials (plastic bags, polystyrene parts, etc.) out of the reach of children, as they are a potential source of danger.

**2. Scrapping/Disposal**

The appliance is manufactured using recyclable material. This appliance is marked in compliance with European Directive 2002/96/EC on Waste Electrical and Electronic Equipment (WEEE). By ensuring the correct disposal of this appliance, you can help prevent potentially negative consequences

for the environment and the health of persons.

The symbol on the appliance, or on the accompanying documents, indicates that this appliance should not be treated as domestic waste but must be taken to a special collection centre for the recycling of electrical and electronic equipment. When scrapping the appliance, make it unusable by cutting off the power cable and removing the doors and shelves so that children cannot easily climb inside and become trapped. Scrap the appliance in compliance with local regulations on waste disposal, taking it to a special

collection centre; do not leave the appliance unattended even for a few days, since it is a potential source of danger for children. For further information on the treatment, recovery and recycling of this product, contact your competent local office, the household waste collection service or the shop where you purchased the appliance.

**Information:**

This appliance does not contain CFCs. The refrigerant circuit contains R600a (HC) (see the rating plate inside the appliance).

Appliances with Isobutane (R600a): isobutane is a natural gas without environmental impact, but is flammable. Therefore, make sure the refrigerant circuit pipes are not damaged.

**Declaration of conformity**

- This appliance has been designed for preserving food and is manufactured in compliance with Regulation (CE) No. 1935/2004.



- This appliance has been designed, manufactured and marketed in compliance with:
  - safety objectives of the “Low Voltage” Directive 2006/95/CE (which replaces 73/23/CEE and subsequent amendments);
  - the protection requirements of Directive “EMC” 2004/108/EC.

Electrical safety of the appliance can only be guaranteed if it is correctly connected to an approved earthing system.

## Electrical connection for Great Britain and Ireland only

**Warning - this appliance must be earthed**

**Fuse replacement**

If the mains lead of this appliance is fitted with a BS 1363A 13amp fused plug, to change a fuse in this type of plug use an A.S.T.A. approved fuse to BS 1362 type and proceed as follows:

1. Remove the fuse cover (A) and fuse (B).
2. Fit replacement 13A fuse into fuse cover.
3. Refit both into plug.

**Important:**

The fuse cover must be refitted when changing a fuse and if the fuse cover is lost the plug must not be used until a correct replacement is fitted. Correct replacement are identified by the colour insert or the colour embossed in words on the base of the plug. Replacement fuse covers are available from your local electrical store.

**For the Republic of Ireland only**

The information given in respect of Great Britain will frequently apply, but a third type of plug and socket is also used, the 2-pin, side earth type.

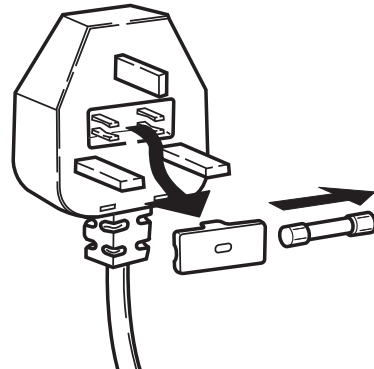

**Socket outlet / plug (valid for both countries)**

If the fitted plug is not suitable for your socket outlet, please contact After-sales Service for further instruction. Please do not attempt to change plug yourself. This procedure needs to be carried out by a qualified technician in compliance with the manufactures instructions and current standard safety regulations.

## IKEA GUARANTEE

### How long is the IKEA guarantee valid?

This guarantee is valid for five (5) years from the original date of purchase of your appliance at IKEA, unless the appliance is named LAGAN in which case two (2) years of guarantee apply. The original sales receipt, is required as proof of purchase. If service work is carried out under guarantee, this will not extend the guarantee period for the appliance.

### Which appliances are not covered by the IKEA five (5) years guarantee?

The range of appliances named LAGAN and all appliances purchased in IKEA before 1st of August 2007.

### Who will execute the service?

IKEA service provider will provide the service through its own service operations or authorized service partner network.

### What does this guarantee cover?

The guarantee covers faults of the appliance, which have been caused by faulty construction or material faults from the date of purchase from IKEA. This guarantee applies to domestic use only. The exceptions are specified under the headline "What is not covered under this guarantee?" Within the guarantee period, the costs to remedy the fault e.g. repairs, parts, labour and travel will be covered, provided that the appliance is accessible for repair without special expenditure. On these conditions the EU guidelines (Nr. 99/44/EG) and the respective local regulations are applicable. Replaced parts become the property of IKEA.

### What will IKEA do to correct the problem?

IKEA appointed service provider will examine the product and decide, at its sole discretion, if it is covered under this guarantee. If considered covered, IKEA Service Provider or its authorized service partner through its own service operations, will then, at its sole discretion, either repair the defective product or replace it with the same or a comparable product.

### What is not covered under this guarantee?

- Normal wear and tear.
- Deliberate or negligent damage, damage caused by failure to observe operating instructions, incorrect installation or by connection to the wrong voltage, damage caused by chemical or

electrochemical reaction, rust, corrosion or water damage including but not limited to damage caused by excessive lime in the water supply, damage caused by abnormal environmental conditions.

- Consumable parts including batteries and lamps.
- Non-functional and decorative parts which do not affect normal use of the appliance, including any scratches and possible color differences.
- Accidental damage caused by foreign objects or substances and cleaning or unblocking of filters, drainage systems or soap drawers.
- Damage to the following parts: ceramic glass, accessories, crockery and cutlery baskets, feed and drainage pipes, seals, lamps and lamp covers, screens, knobs, casings and parts of casings. Unless such damages can be proved to have been caused by production faults.
- Cases where no fault could be found during a technician's visit.
- Repairs not carried out by our appointed service providers and/or an authorized service contractual partner or where non-original parts have been used.
- Repairs caused by installation which is faulty or not according to specification.
- The use of the appliance in a non-domestic environment i.e. professional use.
- Transportation damages. If a customer transports the product to his home or another address, IKEA is not liable for any damage that may occur during transport. However, if IKEA delivers the product to the customer's delivery address, then damage to the product that occurs during this delivery will be covered by IKEA.
- Cost for carrying out the initial installation of the IKEA appliance.

However, if an IKEA appointed Service Provider or its authorized service partner repairs or replaces the appliance under the terms of this guarantee, the appointed Service Provider or its authorized service partner will reinstall the repaired appliance or install the replacement, if necessary. This does not apply within Ireland, customer should contact the local IKEA dedicated after sales line or the appointed Service Provider for further information.

These restrictions do not apply to fault-free work carried out by a qualified specialist using our original parts in order to adapt the appliance to the technical safety specifications of another EU country.

### How country law applies

The IKEA guarantee gives you specific legal rights, which cover or exceed all the local legal demands. However these conditions do not limit in any way consumer rights described in the local legislation.

### Area of validity

For appliances which are purchased in one EU country and taken to another EU country, the services will be provided in the framework of the guarantee conditions normal in the new country. An obligation to carry out services in the framework of the guarantee exists only if the appliance complies and is installed in accordance with:

- the technical specifications of the country in which the guarantee claim is made;
- the Assembly Instructions and User Manual Safety Information.

### The dedicated AFTER SALES for IKEA appliances

Please don't hesitate to contact IKEA appointed After Sales Service Provider to:

- make a service request under this guarantee;
- ask for clarifications on installation of the IKEA appliance in the dedicated IKEA kitchen furniture;
- ask for clarification on functions of IKEA appliances.

To ensure that we provide you with the best assistance, please read carefully the Assembly Instructions and/or the User Manual before contacting us.

### How to reach us if you need our service



Please refer to the last page of this manual for the full list of IKEA appointed After Sales Service Provider and relative national phone numbers.

- i** In order to provide you a quicker service, we recommend to use the specific phone numbers listed on this manual. Always refer to the numbers listed in the booklet of the specific appliance you need an assistance for. Please also always refer to the IKEA article number (8 digit code) and 12 digit service number placed on the rating plate of your appliance.

### **i** SAVE THE SALES RECEIPT!

It is your proof of purchase and required for the guarantee to apply. The sales receipt also reports the IKEA name and article number (8 digit code) for each of the appliances you have purchased.

### Do you need extra help?

For any additional questions not related to After Sales of your appliances please contact your nearest IKEA store call centre. We recommend you read the appliance documentation carefully before contacting us.



## BELGIË - BELGIQUE - BELGIEN

Telefoon/Numéro de téléphone/Telefon-Nummer:	026200311
Tarief/Tarif/Tariff: Lokaal tarief/Prix d'un appel local/Ortstarif	
Openingstijd:	Maandag - Vrijdag 8.00 - 20.00
Heures d'ouverture:	Lundi - Vendredi 8.00 - 20.00
Öffnungszeiten:	Montag - Freitag 8.00 - 20.00

## ČESKÁ REPUBLIKA

Telefonní číslo:	225376400
Sazba:	Místní sazba
Pracovní doba:	Pondělí - Pátek 8.00 - 20.00

## DANMARK

Telefonnummer:	70150909
Takst:	Lokal takst
Åbningstid:	Mandag - fredag 9.00 - 21.00
	Lørdag 9.00 - 18.00
	(Åbent udvalgte søndage, se IKEA.dk)

## DEUTSCHLAND

Telefon-Nummer:	06929993602
Tarif:	Ortstarif
Öffnungszeiten:	Montag - Freitag 8.00 - 20.00

## ΕΛΛΑΔΑ

Τηλεφωνικός αριθμός:	2109696497
Χρέωση:	Τοπική χρέωση
Ωρες λειτουργίας:	Δευτέρα - Παρασκευή 8.00 - 20.00

## ESPAÑA

Teléfono:	913754126
Tarifa:	Tarifa local
Horario:	Lunes - Viernes 8.00 - 20.00
	(España Continental)

## FRANCE

Numéro de téléphone:	0170480513
Tarif:	Prix d'un appel local
Heures d'ouverture:	Lundi - Vendredi 9.00 - 21.00

## ÍSLAND

Símanúmer:	5852409
Kostnaður við símtal:	Almennt mínútuverð
Opnunartími:	Mánudaga - Föstudaga 9.00 - 17.00

## ITALIA

Telefono:	0238591334
Tariffa:	Tariffa locale
Orari d'apertura:	Lunedì - Venerdì 8.00 - 20.00

## MAGYARORSZÁG

Telefon szám:	(06-1)-3285308
Tarifa:	Helyi tarifa
Nyitvatartási idő:	Héftől Péntekig 8.00 - 20.00

## NEDERLAND

Telefoon:	09002354532
	en/of 0900 BEL IKEA
Tarief:	Lokaal tarief € 0,10 p/min
Openingstijd:	Maandag t/m - Vrijdag 9.00 - 21.00
	Zaterdag 9.00 - 20.00
	Zondag 9.00 - 18.00

## NORGE

Telefon nummer:	23500112
Takst:	Lokal takst
Åpningstider:	Mandag - fredag 8.00 - 20.00

## ÖSTERREICH

Telefon-Nummer:	013602771461
Tarif:	Ortstarif
Öffnungszeiten:	Montag - Freitag 8.00 - 20.00

## POLSKA

Numer telefonu:	225844203
Stawka:	Koszt połączenia według taryfy operatora
Godziny otwarcia:	Poniedziałek - Piątek 8.00-20.00

## PORTUGAL

Telefone:	213164011
Tarifa:	Tarifa local
Horário:	Segunda - Sexta 9.00 - 21.00

## REPUBLIC OF IRELAND

Phone number:	016590276
Rate:	Local rate
Opening hours:	Monday - Friday 8.00 - 20.00

## РОССИЯ

Телефонный номер:	84957059426
Стоимость звонка:	Местная стоимость звонка
Время работы:	Понедельник - Пятница 8.00 - 20.00
	(Московское время)

## SCHWEIZ - SUISSE - SVIZZERA

Telefon-Nummer/Numéro de téléphone/Telefono:	0225675345
Tarif/Tarif/Tariffa: Ortstarif/Prix d'un appel local/Tariffa locale	
Öffnungszeiten:	Montag - Freitag 8.00 - 20.00
Heures d'ouverture:	Lundi - Vendredi 8.00 - 20.00
Orario d'apertura:	Lunedì - Venerdì 8.00 - 20.00

## SLOVENSKO

Telefónne číslo:	(02) 50102658
Cena za hovor:	Cena za miestny hovor
Pracovná doba:	Pondelok až piatok 8.00 - 20.00

## SUOMI

Puhelinnumero:	0981710374
Hinta:	Yksikköhinta
Aukioloaika:	Maanantaista perjantaihin 8.00 - 20.00

## SVERIGE

Telefon nummer:	0775-700 500
Taxa:	Lokal samtal
Öppet tider:	Måndag - Fredag 8.30 - 20.00
	Lördag - Söndag 9.30 - 18.00

## UNITED KINGDOM

Phone number:	02076601517
Rate:	Local rate
Opening hours:	Monday - Friday 9.00 - 21.00



