

**GRAND SCENIC**

**QUICK GUIDE**



## WELCOME TO YOUR GRAND SCÉNIC

### Note

Congratulations on your choice: designed for all the family, you will be immediately at home in your New Grand Scénic, which offers exceptional modularity and space, comfort perfectly tailored to suit you, and high-tech equipment to make your life easier.

In order to make your experience as pleasant as possible, we suggest you discover the main features of your New Grand Scénic by reading this document.

This document does not replace the driver's handbook.

Please read your complete driver's handbook for more detailed information on the equipment mentioned in the reference guide for your Grand Scénic.

**Detailed information regarding your vehicle's use, maintenance and warranty, as well as videos and simulators, are all only a click away in the New Grand Scénic e-Guide, available at [www.e-guide.renault.com](http://www.e-guide.renault.com).**

Translated from French. Copying or translation, in part or in full, is forbidden unless prior written permission has been obtained from RENAULT, 92100 Billancourt 2009.



|  |           |
|--|-----------|
| <b>Front and engine compartment</b>        | <b>3</b>  |
| <b>Passenger side</b>                      | <b>4</b>  |
| <b>Rear seats</b>                          | <b>5</b>  |
| <b>Rear of vehicle</b>                     | <b>7</b>  |
| <b>Accessing the vehicle</b>               | <b>9</b>  |
| <b>Adjusting the front seats</b>           | <b>10</b> |
| <b>Driver's position settings</b>          | <b>11</b> |
| <b>Starting/Stopping the engine</b>        | <b>12</b> |
| <b>Dashboard</b>                           | <b>13</b> |
| <b>Instrument panel</b>                    | <b>14</b> |
| <b>Lighting/Wipers</b>                     | <b>15</b> |
| <b>Driving position</b>                    | <b>16</b> |
| <b>Multimedia systems</b>                  | <b>17</b> |
| <b>Heating and air conditioning system</b> | <b>21</b> |
| <b>Gadgets</b>                             | <b>22</b> |

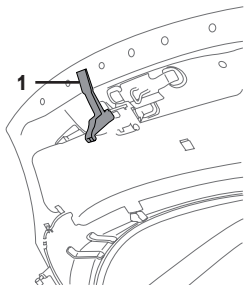

### Opening the bonnet

To open, pull the unlocking control (refer to the "Dashboard" section), lift handle **1** and raise the bonnet. Guide it when opening; it is supported by struts.

### Closing the bonnet

Check that nothing has been left in the engine compartment. To close the bonnet again, hold it in the middle and guide it down, allowing a 30 cm gap before it is closed, then release it. It will latch automatically under its own weight. Check that it is locked.

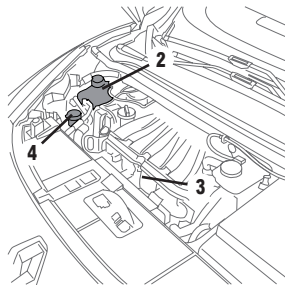

### Coolant level

The level indicated on reservoir **2** should be between the MIN and MAX markings. If it is necessary to top up this level, it is essential to do so when the engine is cold.

### Screen washer fluid level

Add some fluid to reservoir **4** if necessary. **Note:** depending on the vehicle, to find out the fluid level, open the cap and pull out the dipstick.

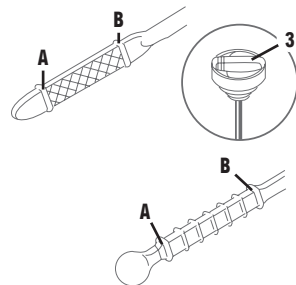

### Engine oil level

To check the oil level, use dipstick **3**. The level shown on dipstick **3** should be between MIN **A** and MAX **B**. If the oil level is at minimum, the message "Adjust oil level" is displayed on the instrument panel.

You must observe the service intervals and the standards governing the oils tested for your engine. Refer to the Maintenance Service and Warranty document for your vehicle, and to Section 4 of the vehicle handbook for the precautions to take when filling with oil.

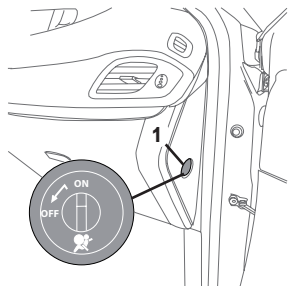

### Deactivating the front passenger air bag

If you wish to fit a rear-facing child seat on the front passenger seat, you must deactivate the air bag: with the vehicle stationary, turn switch **1** to OFF.

With the ignition on, the  warning light lights up orange on instrument panel **2**.

Reposition the switch immediately to ON as soon as you are no longer using the child seat.

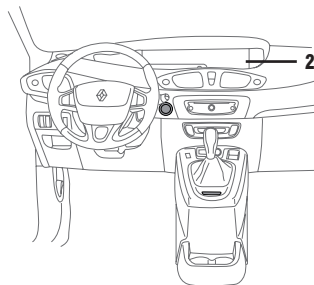

### Activation of the front passenger air bag

You should reactivate the air bag as soon as you remove the child seat from the front passenger seat to ensure the protection of the front passenger in the event of an impact.

To reactivate the air bag: when the vehicle is stationary, push and turn lock **1** to the ON position. With the ignition on, you must check that the  warning light lights up green on instrument panel **2**, then goes off after about one minute.

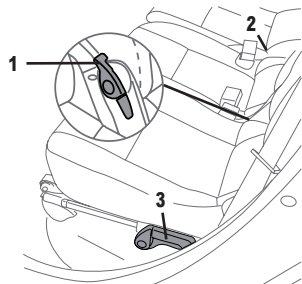

## Folding down the seat

### 7-SEATER VERSION

Move control **3**, then fold down the seatback, then the seat.

### 5-SEATER VERSION

Move control **1** or strap **2** (centre seat) to fold down the seatback.

Lift the control located under the rear of the seat to fold down the seat.

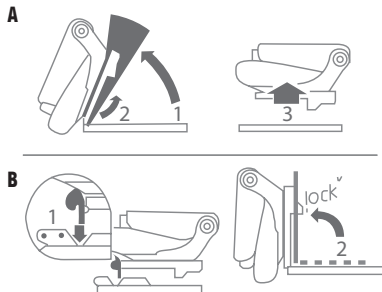

## A Removing the seat

With the seat folded down (1), gently lower it and lift handle **4** to unlock the front mountings of seat (2). Then guide the seat to the floor (3). Refer to the label located on the back of the seat.

## B Fitting the seat

Fit the seat flat on the floor, positioning the hooks opposite the arrows (1) located on the seat's front plastic trim.

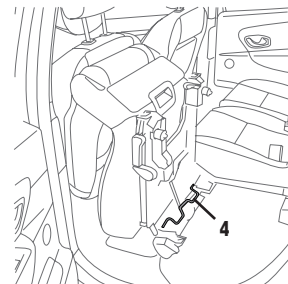

Lift it as far forward as possible (2) until control **4** locks (move the front seat forward if necessary), lower it until it is 10 centimetres from the floor and release it. Check that it is correctly locked. Refer to the label located on the back of the seat.

## Accessing the third row rear seats

From one of the rear doors, fold down the seat using handle **3** and sit in the third row seat. Reposition the second row seat. Check that it is correctly locked.

Check that the seats are correctly locked when put back in position.

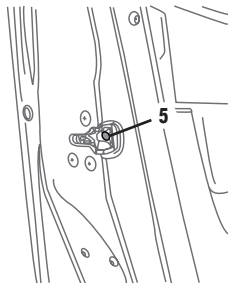

## Child locks

**Electric locking:** this is located on the driver's door controls and makes it impossible to open the electric windows and rear doors from the inside.

**Manual locking:** to make it impossible to open the rear doors from the inside, move lever **5**, visible on the edge of the door and check that the doors are definitely locked from the inside.

Refer to Section 1 of the driver's handbook.

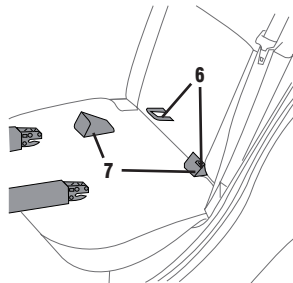

## ISOFIX system

Each second row seat is fitted with the ISOFIX child seat mounting system.

Depending on the type of child seat used, installation requires specific precautions. Refer to Section 1 of the driver's handbook.

The two rings **6** are located between the seatback and the seat base, and a third anchoring point is located behind each seat. The rings are indicated by a marking. To ensure your child seat can be easily fitted and locked on the rings **6**, use the access guides **7** on the child seat.

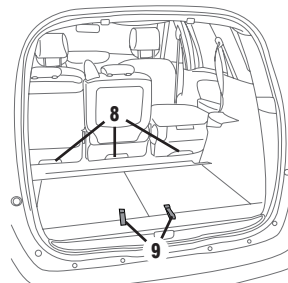

## Third row rear seats

**To pull out a seat:** from the luggage compartment, take out the luggage compartment cover, store it in its housing (refer to the "Gadgets" section) and pull strap **9**. Make sure the seat is correctly locked in position.

**To fold down a seat:** from the luggage compartment, pull strap **9** and press on the top of the seatback. Make sure the seat is correctly locked in position.

**To get out of the vehicle from the third row seats:** pull red tab **8**, fold down the seat, and get out of the vehicle.

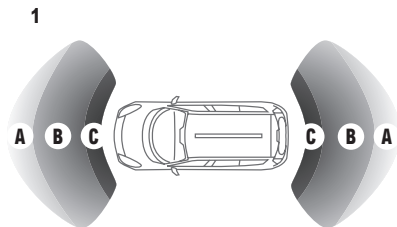

### Parking distance control

On equipped vehicles, the parking distance control measures the distance between the rear (and, depending on the vehicle, the front) of the vehicle and any obstacles that are nearby.

When approaching an obstacle during manoeuvres, the beeps become faster and then sound continuously when 30 cm from the obstacle. In addition to the beeps, there is display **1** on the instrument panel. It is made up of three zones in different colours: **A**, **B** and **C**.

Depending on the vehicle, you may have a reversing camera which allows the area to the rear of the vehicle to be displayed on the navigation screen.

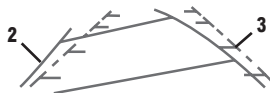

When switching to reverse gear, the camera is activated and two lines appear on the screen.

**Moving blue line 2:** this shows the vehicle's trajectory according to the position of the steering wheel.

**Fixed line 3:** this is made up of three fixed points which shown you the distance behind the vehicle. Refer to Section 2 of your driver's handbook.

You can deactivate the parking distance control permanently and adjust the volume from the vehicle settings customisation menu. Refer to Section 1 of your driver's handbook.

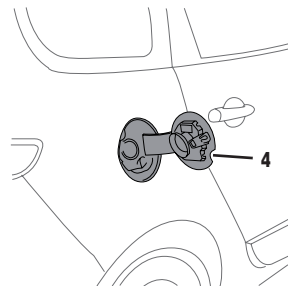

### Fuel tank

Your vehicle is fitted with an integrated fuel filler flap.

- Place your finger in recess **4** in the fuel filler flap to open it, then insert the filler nozzle;
- when driving, if the low fuel level warning light



comes on or flashes (depending on the vehicle), fill up immediately.

The fuel tank capacity is approximately 60 litres.



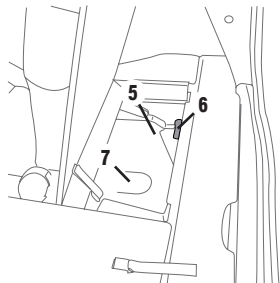

### Tools

Depending on the vehicle, these are located under the luggage compartment carpet or in a compartment behind the third row right-hand seat.

To access tools located behind the third row right-hand seat:

- lift the third row right-hand seat;
- pull tab **6**.

**Note:** marking **5** indicates the position of the compartment.

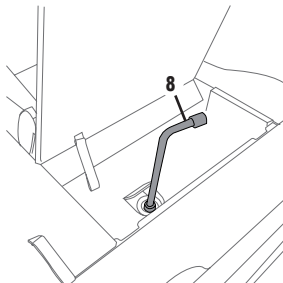

### Emergency spare wheel

If the vehicle is equipped with this, it will be located under the luggage compartment carpet or underneath the vehicle.

To access the emergency spare wheel located underneath the vehicle:

- lift cover **7**;
- unscrew the retaining cable using wheelbrace **8**.

For precautions relating to a punctured tyre, refer to section 5 of your driver's handbook.

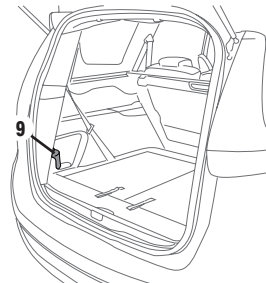

### Tyre inflation kit

If the vehicle is equipped with this, it will be located under the luggage compartment carpet or in left side storage compartment **9**, depending on the vehicle.

Refer to Section 5 of your driver's handbook.

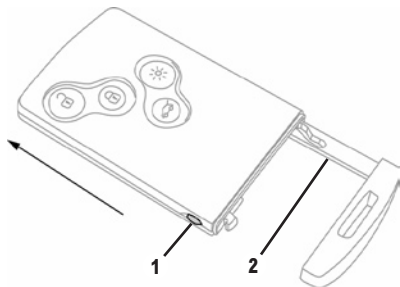

### Locking/unlocking the vehicle

The RENAULT card system replaces the traditional key. Locking/unlocking the vehicle is simple: whether from a distance or nearby, a single press is required.

For special notes relating to this system, refer to Section 1 of your driver's handbook.

Never leave the RENAULT card in the vehicle

### REMOTE CONTROL RENAULT CARD VERSION

Press:



to unlock;



to lock;



to switch the exterior lights on/off remotely (in order to find your vehicle in a car park for example);



to lock/unlock the luggage compartment only.

### HANDS-FREE RENAULT CARD VERSION

With the card on your person (you can leave it in your pocket, bag etc.), in addition to the remote control RENAULT card functions, the following are possible:

- automatic unlocking by pulling a door handle;
- automatic locking when leaving the vehicle (a beep sounds) or intentional locking by pressing the button on the driver's door handle.

**Note:** if required, you can use the manual mode or the key **2**. To release the key, press button **1**.

### SPECIAL FEATURES

- The detection zone of the card, necessary for locking and unlocking the vehicle, depends on the surrounding environment or the location of the card;
-  for vehicles equipped with deadlocking, two successive presses on this button stop the vehicle from being opened, even from the inside and, depending on the vehicle, the windows are closed.

### NOTE

In all situations:

- two flashes of the direction indicator lights confirm locking;
- one flash of the direction indicator lights confirms unlocking.

After locking/unlocking the vehicle or the tailgate only using the buttons on the RENAULT card, remote locking and unlocking in hands-free mode are deactivated.

To reactivate the hands-free mode: restart the vehicle.

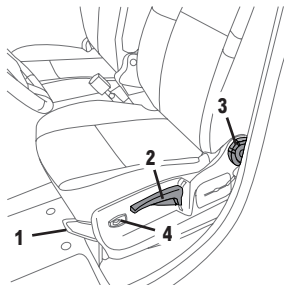

### Manual seat adjustment

#### TO MOVE THE SEAT FORWARDS OR BACKWARDS

Lift handle **1** to release. Release the handle at the desired position and make sure that it is locked.

#### TO RAISE OR LOWER THE SEAT

Move lever **2** as many times as necessary upwards or downwards.

#### TO TILT THE SEATBACK

Turn control knob **3** to the required position.

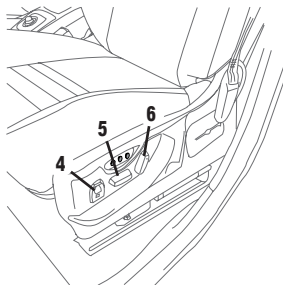

### Electric seat adjustment

#### TO MOVE THE SEAT FORWARDS OR BACKWARDS

Move switch **5** forwards or backwards.

#### TO RAISE OR LOWER THE SEAT

Move the switch **5** upwards or downwards.

#### TO TILT THE SEATBACK

Move the rear of switch **6** forwards or backwards.

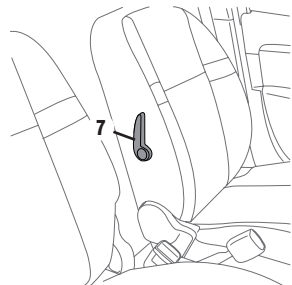

### Adjusting the lumbar support on the seat

Lower handle **7** to increase the support and lift it to decrease it.

### Heated seats

With the engine running, turn control **4** to one of the positions I, II or III.

 this indicator light illuminates on the instrument panel once the front seat heating system is operating. The system, which has a thermostat, decides whether or not the heating is needed, according to the position selected.

Carry out these adjustments when the vehicle is stationary.

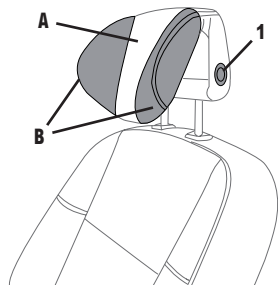

## Headrest

### RAISING THE HEADREST

Pull the headrest upwards to the desired height.

### LOWERING THE HEADREST

Press button **1** and guide the headrest down to the desired height.

### TO ADJUST THE ANGLE OF THE HEADREST

Depending on the vehicle, move section **A** towards or away from you to the required position.

### TO ADJUST SIDE SUPPORTS

Depending on the vehicle, the sections **B** can be adjusted independently.

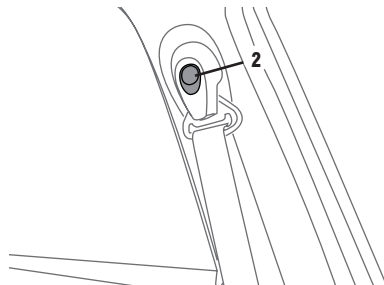

## Front seat belts

### ADJUSTING THE HEIGHT

Press button **2** and hold it, then adjust the seat belt to the desired height.

## Rear seat belts

Refer to Section 1 of your driver's handbook.

## Door mirrors

### ADJUSTMENT

Select the door mirror using switch **5**, then use button **3** to adjust it to the desired position.

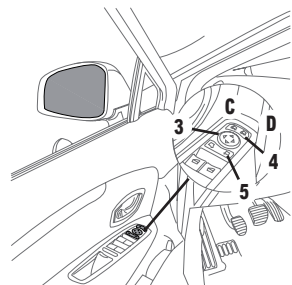

## FOLDING DOOR MIRRORS

Switch **4** in central position: the rear view mirrors will fold back automatically when the vehicle is locked. They will fold out when the ignition is next switched on.

Depending on the vehicle, to force the door mirrors to fold back or out, position switch **4** to **C** or **D**. Automatic mode is then deactivated.

To reactivate it, set switch **4** to the central position.

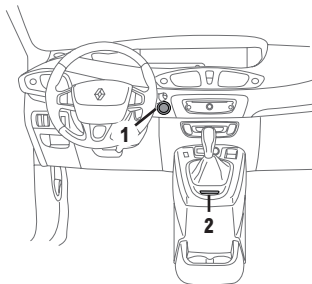

### Starting the engine

With the remote control RENAULT Card in reader **2** or hands-free RENAULT card in the interior detection zone (excluding certain high locations such as the sun visor etc.) apply the following starting conditions:

### MANUAL GEARBOX

With the gear lever in neutral, press START/STOP button **1**.

### AUTOMATIC TRANSMISSION

With the lever in position P, press START/STOP button **1**.

**Note:** for vehicles fitted with the hands-free RENAULT card, depress the brake pedal to start the engine.

### Stopping the engine

When the vehicle is stationary, press START/STOP button **1**.

Depending on the case, certain functions (radio, navigation, wipers etc.) may be switched off at the latest when the vehicle is locked.



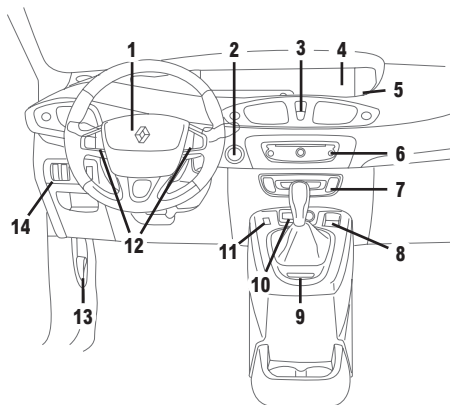

- 1 Horn and location for driver's air bag.
- 2 Engine start/stop button.
- 3 Hazard warning lights.
- 4 Instrument panel.

- 5 Front seat belt reminder warning lights and passenger air bag activation/deactivation status indicator lights:



driver's and front passenger seat belt. For the rear seat belts, a message on the instrument panel indicates the number of seat belts that are buckled.



: passenger air bag in OFF position;



: passenger air bag in ON position.

- 6 Location for radio or storage.
- 7 Heating and ventilation controls.
- 8 Electronic parking brake control.
- 9 RENAULT card reader.
- 10 Sockets for audio connection. These give you the option to connect a portable audio player, an MP3 player, a USB key, etc. to your audio system.

- 11 Cruise control/speed limiter main on/off control.

- 12 Cruise control/speed limiter controls.

- 13 Bonnet release.

- 14 Controls for:

- headlight beam height remote adjustment;
- lighting dimmer for control instruments;
- activation/deactivation of the traction control.

#### WARNING LIGHTS:



This requires you to drive carefully to a RENAULT Dealer as soon as possible. You risk damaging your vehicle if you keep driving after this warning light has come on.



this warning light requires you to stop immediately, for your own safety, as soon as traffic conditions allow. Stop your engine and do not restart it. Contact a RENAULT Dealer.

The equipment fitted, described below, depends on the version and country.

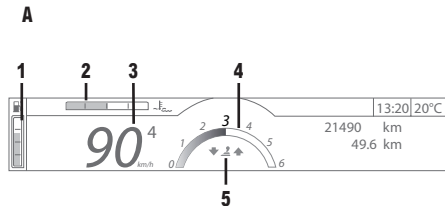

## Instrument panel “TFT Display” A

This can be customised: press button **6** until the desired display appears.

**1** Fuel level gauge. If the minimum level is reached,

the  warning light flashes and a beep sounds.

**2** Coolant temperature indicator.

**3** Speedometer (km or miles per hour).

**4** Rev counter (rpm  $\times$  1,000)

This is displayed according to how the instrument panel is customised.

**5** Fuel economy aid.

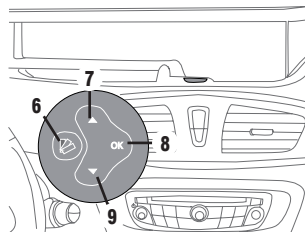

## Vehicle settings personalisation menu

For vehicles fitted with instrument panel **A**, some functions can be adjusted.

To access this menu, press **7**, **8** or **9**. Select the function to be changed by pressing **7** or **9**, then activate, deactivate or access the settings with **8**.

To change a setting, press **7** or **9** and confirm with **8**.

To exit the menu, select the “Exit” line, then confirm by pressing **7** or **9**, then **8**.

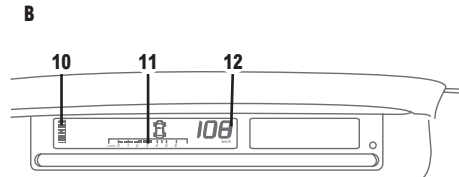

## Instrument panel B

**10** Fuel level gauge.

If the minimum level is reached, the  warning light comes on and a beep sounds.

**11** Rev counter (rpm  $\times$  1,000).

**12** Speedometer (km or miles per hour).

Carry out these adjustments when the vehicle is stationary.

Refer to Section 1 of your driver's handbook.

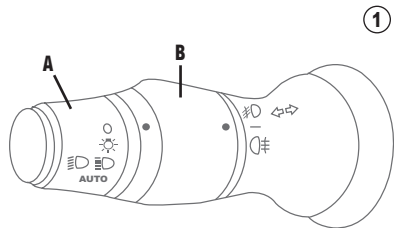

## Lighting

On stalk **1**, turn ring **A** to:



switch on the side lights;



switch on the dipped beam headlights.

**Hazard lights:** pull the stalk towards you.

**Main beam headlights:** with ring **A** in position



pull the stalk.

**AUTO:** activate the automatic headlights (depending on the vehicle).

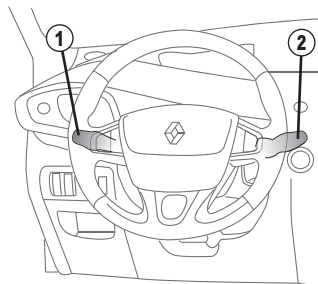

Turn ring **B**, then release it to:



switch on the front fog lights;



switch on the rear fog light.

To switch them off, repeat the operation.

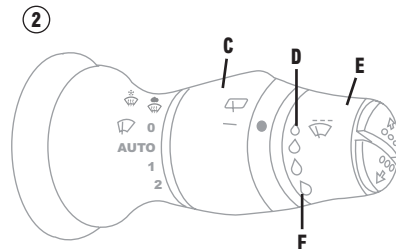

## Wiping

Stalk **2** in position:

– **0:** park;

– **AUTO:** intermittent wiping or, depending on the vehicle, automatic wiping;

**Note:** ring **E** can be used to adjust the sensitivity of automatic wiping, from minimum sensitivity (**D**) to maximum sensitivity (**F**).

– **1:** normal wiping speed;

– **2:** fast wiping speed or, with the engine switched off, maintenance position.

**Rear screen wiper:** to start/stop wiping, turn ring **C** towards you, then release it.

**Windscreen washer:** pull stalk **2**.

**Rear screen washer:** push stalk **2**.

If you move the wiper blades: place them in the maintenance position.



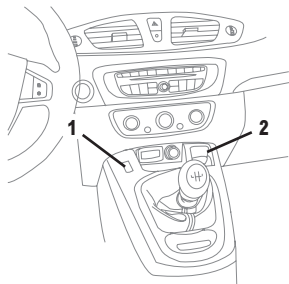

### Electronic parking brake

The parking brake is automatically activated when the engine is switched off by pressing the engine start/stop button (except if the engine has stalled).

It is released automatically: with the engine running, a gear engaged, when accelerating and, for manual gearboxes, as soon as the clutch is released.

The assisted parking brake, like the manual parking brake, also enables:

- manual engagement: lift the switch **2**;
- manual release: with the brake pedal depressed, press switch **2**.

### Cruise control/speed limiter

The cruise control helps you to keep your driving speed at a constant value.

The speed limiter helps you stay within the speed limit.

If fitted to the vehicle, select the cruise control or speed limiter by moving switch **1**:



cruise control;

**Note:** you can interrupt the cruise control operation by depressing either the brake pedal or the clutch. You can exceed the cruising speed by depressing the accelerator; the speed flashes on the instrument panel and its display zone lights up, depending on the vehicle.



speed limiter.

**Note:** You can exceed the limit speed by depressing the accelerator fully; the speed flashes on the instrument panel and its display zone lights up, depending on the vehicle.

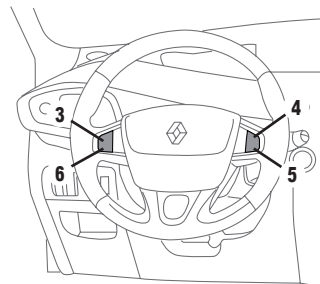

### Cruise control/speed limiter controls

- Activation, storage and increase switch for the programmed speed: button **3 (+)**;
- Decrease switch for the programmed speed: button **6 (-)**;
- Function standby with programmed speed storage: button **5 (0)**;
- Activation with programmed speed recall: button **4 (R)**;
- Function off: switch **1**.

Refer to Section 2 of your driver's handbook.

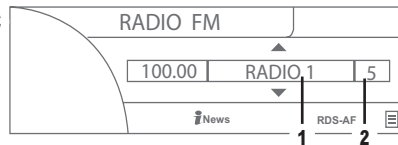
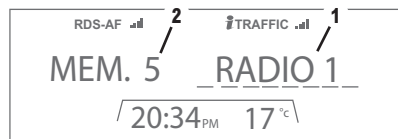
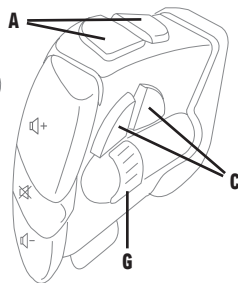
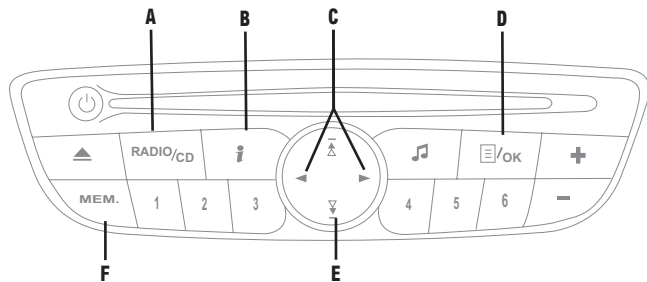

## LISTENING TO THE RADIO, A CD (AUDIO AND MP3) OR A PLAYER

Select the desired source by pressing one of the buttons **A** once or more.

If you wish to listen to an **AUXILIARY** source, connect your portable audio player to the desired socket (refer to the “Dashboard” section).

## FM RADIO SOURCE

– To select a radio station from a list in alphabetical order:

Press **C** to move to the station name field **1** then turn **G** or press **E** several times to scroll through the list of radio stations.

– To update the list:

Press **B**, then **E** or turn **G** to select the “Update FM List” field and confirm by pressing **D** or **G**.

– To store a station to one of the buttons numbered 1 to 6:

Select a radio station and press one of the buttons 1 to 6 until a beep sounds.

To recall a stored station, press the corresponding button.

– To store up to 12 FM stations:

Select a radio station, press **F**, then use **E** or turn **G** to select a location from 1 to 12 then confirm by pressing **D** or **G**.

To recall a stored station, move across to the station number **2**, then scroll through the radio stations using **E** or **G**.

To move across the displays **1**, press buttons **C**.

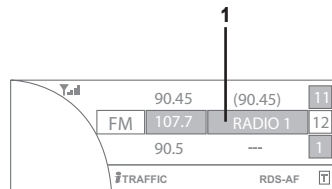
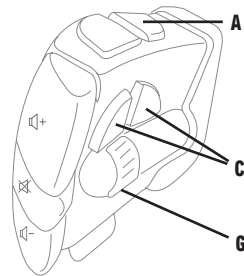
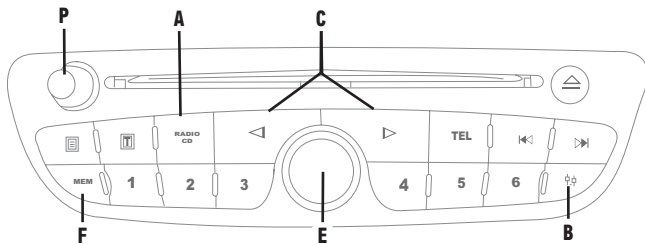

To switch the system on/off, press **P**. Adjust the volume by turning button **P**.

### LISTENING TO THE RADIO, A CD OR AN AUDIO PLAYER

Select the desired source by pressing one of the buttons **A** once or more.

If you wish to listen to an AUXILIARY source, connect your portable audio player to the desired socket (refer to the “Dashboard” section).

### FM RADIO SOURCE

– To select a radio station from a list in alphabetical order:

Press **C** to move to the station name field **1** then turn **E** or **G** to scroll through the list of radio stations.

– To update the list:

Press **B**, then turn **E** or **G** to select the “Audio settings” field then “Radio functions” and “Update FM list”; confirm by pressing **E** or **G**.

– To store a station from 1 to 6:

Select a radio station then press one of the buttons 1 to 6 until a beep sounds.

– To recall a stored station, press the corresponding button.

– Button **F** is used to store up to 12 stations (refer to the previous page).

### Pairing your Bluetooth® device

In order to use your hands-free device (telephone, portable audio player), you must pair it when using it for the first time. After this, once the vehicle is started, your device will be recognised and automatically connected to the hands-free system. Refer to the “Bluetooth® connection” section.

To move across the displays **1**, press buttons **C**.

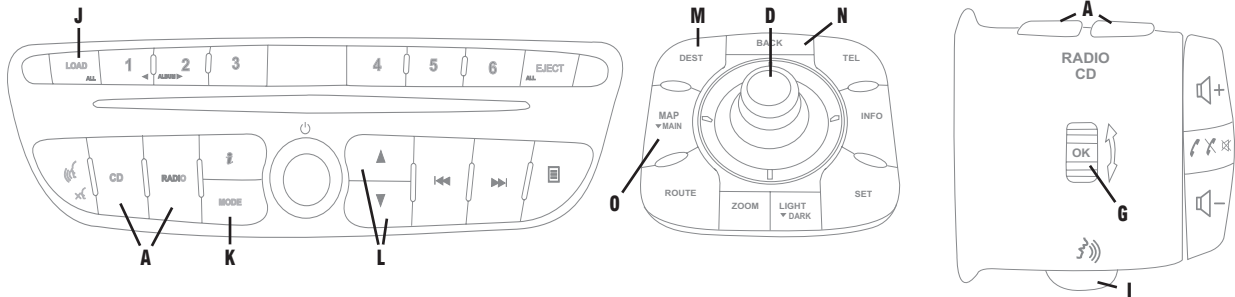

### LISTENING TO THE RADIO OR A CD

Select the source (FM radio or CD) by pressing one of the buttons **A**.

### FM RADIO SOURCE

To select a radio station from an alphabetical list, press **K**, choose the "List" mode, then select the name of the radio either using the arrows **L** or by turning control knob **G**.

To store a radio station to one of the buttons numbered 1 to 6:

- select the radio station;
- press on one of the buttons from 1 to 6, until a beep sounds.

To recall a stored radio station, press the corresponding button.

### CD SOURCE

Before inserting a CD, press button **J**. You can insert up to 6 CDs.

### VOICE RECOGNITION

Button **I**: to operate certain functions using voice control.

### STARTING THE NAVIGATION SYSTEM

- press **M**;
- turn the button **D** to select "new address" then confirm by pressing **D**;

- enter the address fields (town and street) using the keypad on the screen. To select and confirm a character, rotate then press button **D**;
- when entry is complete, select "Start" and follow the voice guidance and on-screen directions to your destination.

### CANCELLING AN ACTION

Press **N** if you wish to return to the previous menu or erase an entered character.

### DISPLAYING THE MAP

Press button **O** to return to the map at any time.

In order to use a Bluetooth® device, either a telephone or portable audio player (depending on the vehicle), from your multimedia system, please follow the instructions below.

### Pairing a Bluetooth® device

#### PRINCIPLE

Pairing will enable the multimedia system to recognise and store your Bluetooth® device. This is the first step to carry out in order to use your telephone or portable audio player.

**Note:** you can pair several devices to your multimedia system, but only one device can be used at a time (a single telephone or a single portable audio player).

#### PAIRING STEPS

Pairing is carried out directly on your device (refer to its user instructions):

- check that your multimedia system and your Bluetooth® device are on;
- activate the Bluetooth® connection on your device;
- In the multimedia system settings menu, select the field which allows you to store or pair a Bluetooth® device;
- launch a search for Bluetooth® equipment from your device;
- select “My-Radiosat” or “MY-CAR” from the list of devices found;
- enter the pairing code using your device’s keypad (it will appear on the multimedia system screen, otherwise refer to the user instructions for the system).

The device is paired.

### Connecting a Bluetooth® device

Your Bluetooth® device must be connected to the multimedia system for all its functions to be accessible.

To connect your device, select it from the list of devices stored in the multimedia system.

The multimedia system may also automatically recognise your device once it is switched on.

### Using a Bluetooth® device

With your Bluetooth® device connected, you can use some functions directly via the controls on your audio system.

You can also:

- for a portable audio system: select a music track or an album...;
- for a telephone: display the telephone address book, call a contact from the telephone address book, update the telephone address book...

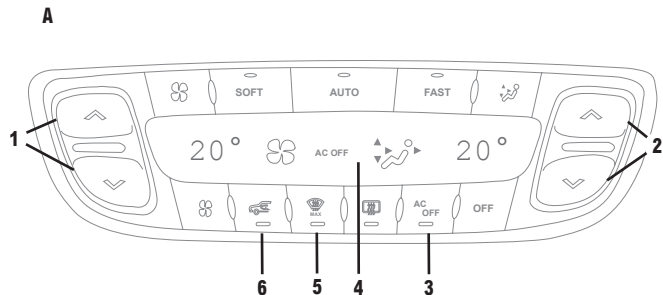

### Automatic climate control A

With the engine running, to benefit from the automatic climate control, select one of the three automatic programmes:

- **AUTO**: regular temperature regulation mode;
- **SOFT**: quietest temperature regulation mode;
- **FAST**: ventilation mode (recommended for the rear seats).

Then, choose the temperatures using levers 1 and 2.

**Note:** you can exit automatic mode by pressing any of the other buttons.

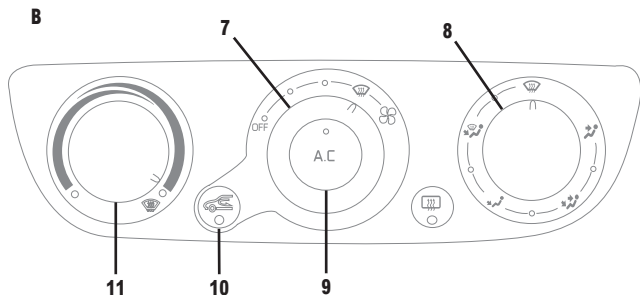

### “CLEAR VIEW” FUNCTION (DEMISTING)

Press button 5. To exit the function, press button 5 again.

### AIR CONDITIONING

Button 3 is used to deactivate the air conditioning (integrated indicator lights up and “AC OFF” is shown on the display 4).

### AIR RECIRCULATION

This is switched on when certain automatic controls are used. It can also be activated manually by pressing 6.

### Manual air conditioning B

- To adjust the ventilation speed: turn 7;
- to change the distribution of air: turn 8;
- to activate/deactivate the air conditioning: press 9;
- to activate/deactivate air recirculation: press 10;
- to choose the temperature: turn 11.

### DEMISTING

Turn 7, 8 and 11 to position .

**Note:** in certain positions, control 8 deactivates the air recirculation and activates the air conditioning.

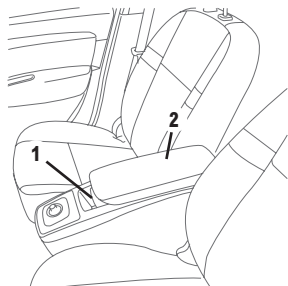

### Sliding centre console

The centre console slides to allow the length to be adjusted. Lift handle **1** and slide the entire console.

It contains two storage compartments.

To access the first, lift the armrest.

To access the second: with the armrest closed, press the button located in front of the armrest.

### Sliding armrest

To open armrest **2**, slide back the cover.

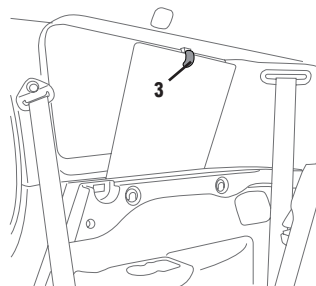

### Sun blinds

To provide shelter from the sun, you can pull the sun blinds over all the side windows, and over the rear screen.

Pull the blind upwards using hook **3** and secure the hook in its housing.

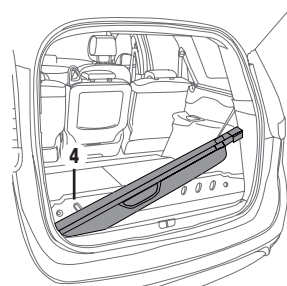

### Luggage compartment cover storage

There is a storage compartment specially designed for your luggage compartment cover.

To store your luggage compartment cover:

- lift cover **4** (7-seater version only);
- insert the left side of the roller, then the right side;
- position the luggage compartment cover so that it does not extend beyond the storage compartment.

( [www.e-guide.renault.com](http://www.e-guide.renault.com) )

RENAULT S.A.S. SOCIÉTÉ PAR ACTIONS SIMPLIFIÉE AU CAPITAL DE 533 941 113 € / 13-15, QUAI LE GALLO  
92100 BOULOGNE-BILLANCOURT R.C.S. NANTERRE 780 129 987 — SIRET 780 129 987 03591 / TÉL. : 0810 40 50 60  
RP 890-1 – 99 91 074 22R – 11/2008 – Edition anglaise



9 9 9 1 0 7 4 2 2 R

**MM**