PROLINE SERVICE MANUAL

Order No.

Front Load Washing Machine**MODEL: PFL612W-U****WARNING**

This service information is designed for experienced repair technicians only and is not designed for use by the general public. It does not contain warnings or cautions to advise non-technical individuals of potential dangers in attempting to service a product. Products powered by electricity should be serviced or repaired only by experienced professional technicians. Any attempt to service or repair the product or products dealt with in this service information by anyone else could result in serious injury or death.

©2010 Washing Machine

All rights reserved. Unauthorized copying and distribution is a violation of law.

Contents

Chapter 1	General Information	4
1-1.	General Guidelines	4
Chapter 2	Product Feature	5
2-1.	Features	5
2-2.	Specification	6
Chapter 3	Matters needing attention	8
3-1.	Safety	8
3-2.	During Use	9
Chapter 4	Operational Guidance	10
Chapter 5	Program Introduction	12
Chapter 6	Washing Methods	13
6-1.	Loading	13
6-2.	Adding detergent	13
6-3.	Selecting washing program	13
Chapter 7	Appearance brief introduction	14
7-1.	Name of parts	14
7-2.	Net dimension	15
Chapter 8	Disassembly and Installation	16
8-1.	Remove packing materials	16
8-2.	Dismantle packing bolts	16
8-3.	Adjusting the washing machine	16

8-4. Joining the Inlet Hose to the Washing Machine	1 7
8-5. Drainage Hose	1 7
8-6. Connecting to the Power Supply	1 7
Chapter 9 Wiring circuit and Self check	1 8
9-1. Wiring circuit	1 8
9-2. Self check	1 9
Chapter 10 Error Display and troubleshooting	2 0
10-1. Error Display	2 0
10-2. Examination & Troubleshooting	2 4
10-2-1. Display nothing	2 4
10-2-2. No water inletting	2 4
10-2-3. No draining	2 5
10-2-4. Abnormal noise and vibration	2 5
10-2-5. Water leaking	2 5
Chapter 11 Maintenance	2 7

Chapter 1 General Information

1-1. General Guidelines

When servicing, observe the original lead dress. If a short circuit is found, replace all parts which are overheated or damaged by the short circuit. After servicing, see to it that all the protective devices such as insulation barriers, insulation papers shields are properly installed. Confirm that the screws, parts and wiring which were removed in order to service are put in the original positions, or whether there are the portions which are deteriorated around the service places serviced or not. And be sure safety of that.

Chapter 2 Product Feature

2-1. Features

(1). 320mm diameter porthole, door may be open at a 175 degrees.

Facilitate view of wash process, facilitate unloading and easy to use with large port.

(2). Class A energy-saving

Scientific design for tub can reduce the use of water heavy during washing, consequently upgrade the energy efficiency class to A, also use scientific washing

(3). Multi-gear speed controller

According to different costuming, you can select corresponding spin speed, from 0 to 1400 rpm.

(4). Unique gasket design featuring no residual water hidden inside.

By the unique gasket, washing machine can left no residual water hidden between outer drum and front board.

(5). Delay time adjustable.

According to different costuming, you can select delay time, from 0.5h to 24h.

2-2. Specification

washing machines		PFL612W-U
1. Product identification		
Description of appliance		Washing machine
Type of appliance(FS = standing, BI = built-in)		FS
Supplier own brand		KESA
Supplier bar code (Europe)	EAN	HAIER
Commercial Brand / Model		PROLINE
Commercial bar code	EAN	
2. Key-Features		
Energy efficiency class		A
Washing performance class		A
Spin efficiency class		B
Programs	nz	11
Capacity	Kg	6
Spin speed (max.)	rpm	1200
Noise level (sound pressure level)	dB(A)	74
Energy consumption per wash circle	kWh	1.14
Water consumption per wash cycle	l	49
Annual average energy consumption *	kWh	228
Annual average water consumption*	l	9800
Residual dampness (spin result)	%	63%
Adjustable thermostat (water temp. adjust from - to)	°C	90 -※
Drum capacity dry laundry / water	kg / l	6/45
Auto water level adjust (depending on volume of filled in laundry)	AWL	I
Washing time (max.)	min	196
Washing temperatures (program-controlled)	°C	30/40/ 60 /90
Certification's (CE)		CE
Approvals (VDE/GS / TÜV / G / IMQ)		CE/VDE
* per average 200 wash cycles (EN50242) T= COLD		
3. Basics data		
Unit dimensions (H x W x D)	mm	850*595*520
Net weight	kg	65
Voltage/frequency	V/Hz	220V-240V~/50Hz
Input power / main fuse (intensity)	W / A	2000/10
Work top / removable		I/I
Control M = electromechanical, E = electronic, F = fuzzy		E
Drum S = stainless steel / Z = zinc coated		S
Tub P = Polyprop./ S = stainless steel		P
Door:		
aesthetic (R = round, Y = big eye, Q = square)		R
Diameter	cm	32
Outer door frame S= stainless steel / M = metal / P = plastic		P
Inner door G= glass / P= plastic		G
Detergent compartments	nz	3
Removable compartment for liquid detergent		-
Delay timer (from - to)	h	0.5-24
Self cleaning suds pump		-
Water inlet hose cold water / hot water		●/-
Water drain hose / -support		●/●
Adjustable feet	no	4
4. Safety systems		

Auto door lock	ADL	●
Motor overheating protection	MOP	●
No heating without water	NHW	●
Auto water cool-down (before drain 90°C boiled water)	AWC	●
Water overflow protection	WRP	●
Acqua Stop kit		-
Child protection		●
5. Programs		
1) cotton cycles (90°C/60°C/40°C/30°C/※)	nđ	-/●
2) synthetics (60°C/40°C/30°C/※)	nđ	●/●
3) wool (40°C/30°C/※)	nđ	●/●
4) Delicates (40°C/30°C/※)	nđ	●
5) quick (30°C/※, 15min)	nđ	●
6) Sport(40°C/30°C/※)	nđ	●
7) Mix(60°C/40°C/30°C/※)	nđ	●
8) Special programs	nđ	2
Single Rinse	nđ	●
Single Spin	nđ	●
Optional function keys (additional program settings)		
ON/OFF		●
Start / Pause		●
Delay		●
Extra Rinse		●
Intense		●
Eco Time		-
Spin Select		●
Temperature Select		●
Baby Care		-
Cold wash		-
Super Wash		-
Pre-wash		-
Easy ironing		-
Packing dimensions & loadability		
Packing dimensions (H x W x D)	mm	890*560*650
6. Gross weight	kg	67
40' Container load	pcs	189
Logistic / recycling information		
Packing weight	kg	2
7. Packing materials / Recycling symbols		
Carton (weight)	gr	Shrink package
Polystyren (weight)	gr	1500
Polyethylene foil (weight)	gr	200
Other packing materials (weight)	gr	
Wood (weight)	kg	300
Service		
User instruction (languages)		
8. Max. failure rate (12 Months after sales to end customer)	%	
Delivery Time of First Batch		
		Available
9.		

Chapter 3 Matters needing attention

3-1. Safety

BEFORE SWITCHING THE APPLIANCE ON FOR THE FIRST TIME

DO ...

- ... Make sure that the transportation bolt(T1,T2&T3) are removed.
- ... Use a separate earthed socket for the power supply.
- ... Make sure that the plug is accessible.
- ... Hold the plug and not the electric cable when unplugging the power supply.
- ... Make sure that the fuses in the power circuit are rated for 13A.
- ... Keep away from heat sources and direct sun light to prevent plastic and rubber components from aging.
- ... Make sure that the power cord is not caught under or in the appliance and avoid damage to the power cable.
- ... Check that hose joints and connections are firm and no water can leak. If joints are loose or there is leakage, turn off the water supply and refix. Do not use the washing machine until the hoses are properly fixed.

☐ DO NOT ...

- ☐ ... Touch or use the appliance when barefoot or with wet or damp hands or feet.
- ☐ ... Use flammable detergent or dry cleaning agent.
- ☐ ... Use any flammable sprays in close vicinity to the appliance.
- ☐ ... Remove or insert the plug in the presence of flammable gas.
- ☐ ... Allow children or infirm persons to play with the appliance or packing materials.
- ☐ ... Install the appliance outdoors in a damp place, or in an area which may be prone to water leaks such as under or near a sink unit. In the event of a water leak allow the machine to dry naturally.
- ☐ ... Place the washing machine directly on a carpet, or close to a wall or furniture.

DURING DAILY USE OF THE APPLIANCE

DO ...

- ... Pull up zips and fix loose threads to prevent the items from being entangled. If necessary, put small items into a net bag or pillow.
- ... Turn off the machine after each wash program and switch it off at the mains to save electricity and for safety. Wipe clean the lower part of the porthole.
- ... Keep the door slightly open when the washing machine is not in use to prevent formation of odours.
- ... Let the power cord be replaced by the manufacturer, his service agent or other accordingly qualified persons, in case it is damaged.
- ... Ensure that the appliance is not used by persons(including children) with reduced physical, sensory or mental capabilities, lack of experience and knowledge without supervision or instruction by a person responsible for their safety.
- ... Supervise children to ensure that they do not play with the appliance.

☐ DO NOT ...

- ☐ ... Touch the washer door during the washing process - it gets hot!
- ☐ ... Place heavy objects or sources of heat or damp on top of the appliance.
- ☐ ... Hot wash foam rubber or sponge-like materials.
- ☐ ... Open the detergent distribution drawer during the wash cycle.
- ☐ ... Force the washer door open. The door is fitted with a self-lock device and will open shortly after the washing procedure is ended.
- ☐ ... Open the washer door if the water level is visibly over the porthole.
- ☐ ... Cover the washing machine with plastic cover so that inside dampness cannot be kept in.

Chapter 4 Operational Guidance

CONTROL PANEL

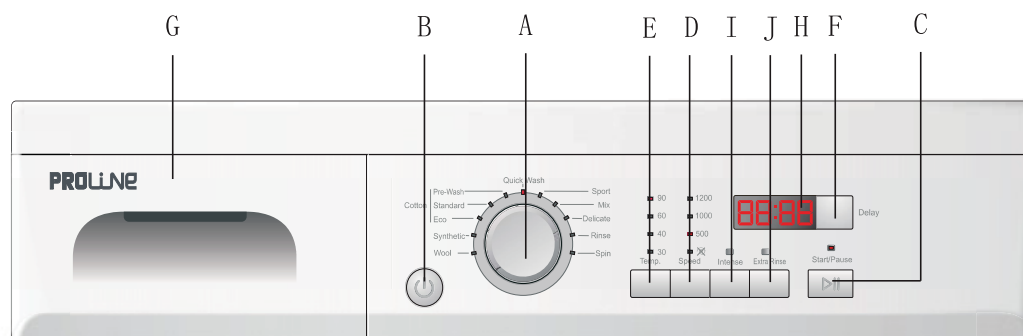

A	Program knob	G	Detergent drawer
B	Power Switch	H	Display
C	Start/Pause button	I	Intense button
D	Spinning Speed button	J	Extra rinse button
E	Washing temperature button		
F	Delay Button		

OPERATIONAL FUNCTIONS

A	→ Program knob	By turning the knob clockwise/counterclockwise, the required program can be selected. There are 11 programs available. After a program is selected, the corresponding light will illuminate.
B	→ Power Switch	Press this button to switch on the washing machine. Press it again to switch it off. Press this button gently for 2 seconds to switch off the machine as buttons are soft touch sensitive.
C	→ Start/Pause Button	When the washing machine is connected to the power socket and a program is selected, lightly touch this button to start operation. During a wash cycle, touch it lightly, operation will stop and the digits on the screen start blinking. Touch it again to resume operation.
D	→ Spinning Speed Setting Button	Touch this button lightly to select the desired speed. When a speed is set, the corresponding indicator light will be illuminated. Note: Different water temperatures and spinning speeds can be set for different laundries. Wash using the default settings if there is no special requirement.
E	→ Washing temperature button	Touch this button lightly to select the desired washing temperature. When a washing temperature is set, the corresponding indicator light will be illuminated. Select a temperature according to the type of laundry.

- | | | |
|---|---------------------------------|--|
| F | ? Delay Button | <p>_Touch this button lightly, the washing machine will start operation after a period of time and the corresponding indicator will go on. The range is 0.5-24 hours; each touch of this button increases a half hour. After the button is set, press the Start/Pause button to start countdown of the set time (the time is displayed on the screen until the program ends).</p> <p>Note: The delay time must be longer than the program time; otherwise, the washing machine will start the wash program directly.</p> |
| G | ? Detergent distribution drawer | <p>_Open the drawer, three compartments can be seen:</p> <p>Compartment 1: Prewash detergent</p> <p>Compartment 2: Detergent for programs 1 to 10.</p> <p>Compartment 3: Softener, conditioning agent, perfume, etc.</p> |
| H | ? Display | <p>_Information as remaining wash time and error messages will be shown here.</p> <p>Note: After power is switched on, the display will go on and the remaining wash time decreases. As the water pressure and temperature may differ, the remaining time may be adjusted accordingly. When the laundry is not balanced during spinning, the time may be automatically prolonged. These are normal phenomena.</p> |
| I | ? Intense button | <p>_If the laundry is heavily soiled, press this button before starting the program. When the button is pressed, the washing time increases.</p> |
| J | ? Extra rinse button | <p>_Press this button, the washing machine will perform additional rinses. Press the button once to select one additional rinse. The display will show "P-1". Press the button repeatedly and the screen will display "P-2" or "P-3", indicating two or three additional selected rinses. The "extra rinse light" is activated and flashes during the performance. "P-1/2/3" is displayed alternating with the remaining time. The light turns off and the display disappears when the extra rinse ends.</p> |

Chapter 5 Program Introduction

DETERGENT COMPARTMENTS

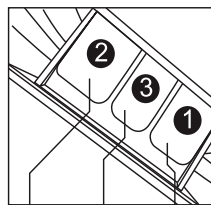

- 1 Detergent compartment for prewash mode
- 2 Detergent compartment
- 3 Compartment for softener and other additives

Program	Maximum Temperature	Preset	2	3	1	Recommended Laundry	Preset spin speed	
							PFL612W-F/U/E	PFL510W-U
1 Wool	-- to 40 °C	30°C	<input checked="" type="checkbox"/>	<input type="checkbox"/>	<input checked="" type="checkbox"/>	Woolen fabrics	500 rpm	400 rpm
2 Synthetic	-- to 60 °C	40°C	<input checked="" type="checkbox"/>	<input type="checkbox"/>	<input checked="" type="checkbox"/>	Slight-soil cotton, linen and synthetic fabrics	1000 rpm	800 rpm
3 Cotton Eco	-- to 90 °C	40°C	<input checked="" type="checkbox"/>	<input type="checkbox"/>	<input checked="" type="checkbox"/>	Cotton fabrics	1000 rpm	800 rpm
4 Cotton standard	-- to 90 °C	40°C	<input checked="" type="checkbox"/>	<input type="checkbox"/>	<input checked="" type="checkbox"/>	Cotton fabrics	1000 rpm	800 rpm
5 Prewash	-- to 90 °C	40°C	<input checked="" type="checkbox"/>	<input type="checkbox"/>	<input checked="" type="checkbox"/>	Heavy soiling	1000 rpm	800 rpm
6 Quick	-- to 30 °C	30°C	<input checked="" type="checkbox"/>	<input type="checkbox"/>	<input checked="" type="checkbox"/>	Slight-soiling	1000 rpm	800 rpm
7 sport	-- to 40 °C	30°C	<input checked="" type="checkbox"/>	<input type="checkbox"/>	<input checked="" type="checkbox"/>	Sports wear	1000 rpm	800 rpm
8 Mix	-- to 60 °C	40°C	<input checked="" type="checkbox"/>	<input type="checkbox"/>	<input checked="" type="checkbox"/>	Cotton or synthetic	1000 rpm	800 rpm
9 Delicate	-- to 40 °C	30°C	<input checked="" type="checkbox"/>	<input type="checkbox"/>	<input checked="" type="checkbox"/>	easy wear abrasion fabric	1000 rpm	800 rpm
10 Rinse	--	--	<input checked="" type="checkbox"/>	<input type="checkbox"/>	<input checked="" type="checkbox"/>	/	1200 rpm	1000 rpm
11 Spin	--	--	<input checked="" type="checkbox"/>	<input checked="" type="checkbox"/>	<input checked="" type="checkbox"/>	/	1200rpm	1000rpm



Yes



No



Optional

Chapter 6 Washing Methods

6-1. Loading

Open the door, put in the laundry piece by piece.
Close the door tightly.

Notes: 1) When first using the washing machine, let it run unloaded for one program to prevent the laundry from being tainted by oil or dirty water from the washing machine.
2) Do not overload the washing machine.



Load Reference

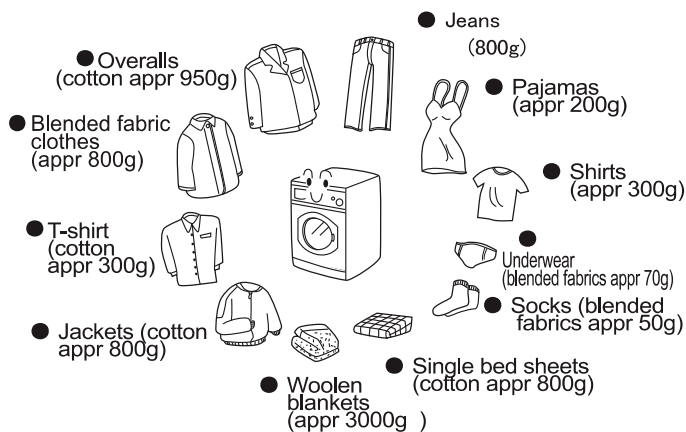

6-2. Adding detergent

2. Adding detergent

Slide out the detergent drawer and put the required detergent and softening agent into the corresponding boxes. Push back the drawer gently.

Caution:

1) For pre-washing program, detergent should be added to both compartments 1 and 2. Compartment 2 allows only solid detergents. For other programs, do not add detergent to compartment 1.

2) Do not overuse softener; otherwise, it will damage the artificial fibers. Refer to the instructions during use.

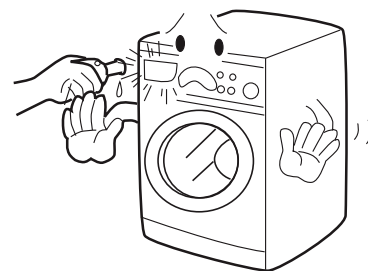

6-3. Selecting washing program

To get the best washing effect, an appropriate washing program should be selected according to the laundry type.

Chapter 7 Appearance brief introduction

7-1. Name of parts

Control panel

Door handle

Work top

Washer door

Power

Detergent distribution drawer

Filter cover

Drain hose

Water inlet valve

Power cord

Back cover screws

Back cover

Transportation bolts

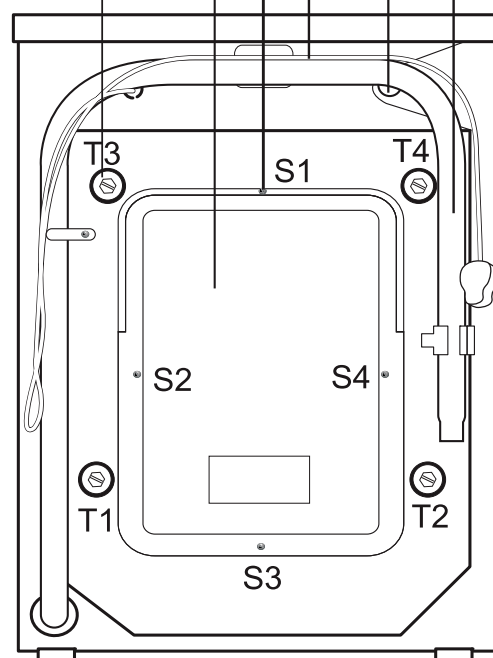

7-2. Net dimension



height:850mm / width:595mm / depth:520mm

Chapter 8 Disassembly and Installation

8-1. Remove packing materials

Remove all the packing materials (including the EPE base) to prevent vibration during use, as shown in the right picture. Upon opening of the package, water drops may be seen on the plastic bag and the porthole. This is normal phenomenon resulting from water test in the factory.

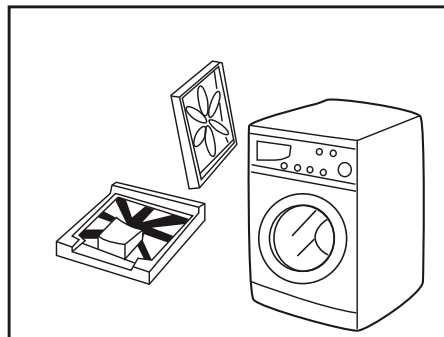

8-2. Dismantle packing bolts

● Dismantle the packing bolts as shown in Fig. 2.

The packing bolts are designed for clamping anti-vibration components inside of the washing machine during the transportation process.

Before use:

1. Remove the back plate;
 2. Remove the three packing bolts on the back plate and take out the rubber hose;
 3. Replace the back plate;
 4. Fill the holes left by the packing bolts with plastic plugs.
- (Attention: The packing bolts and rubber hose should be kept in a safe place for later use)

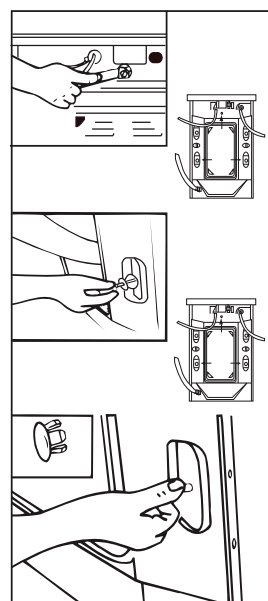

8-3. Adjusting the washing machine

Adjusting the washing machine

There are adjustable feet under the bottom of the washing machine. Before use, the washing machine should be adjusted, as shown in Fig. 3, so that it is level.

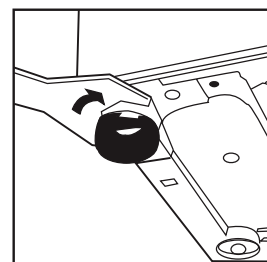

8-4. Joining the Inlet Hose to the Washing Machine

1. Place the water inlet hose nut on the connector of the water inlet valve.

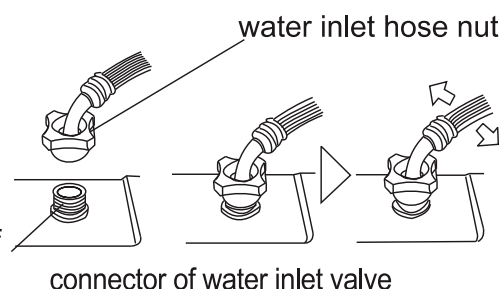

2. slightly shake the water inlet hose nut to see if it is tightly and properly fixed.

8-5. Drainage Hose

- The height of the terminal of the water drainage hose should be between 80cm-100cm, the water drainage hose must be securely placed on the clip on the back of the washing machine.

- Use the water drainage support supplied as an accessory for proper installation of the water drainage hose. Fix the water drainage hose support with waterproof string. Do not use an excessively long water drainage hose and contract the authorized technician if the water drainage hose needs to be extended. The water drainage hose should not be extended more than 250cm. (longer extension will result in concurrent water inflow and outflow). The diameter of the extension hose should be the same as the original hose.

caution: water drainage hose must not be immersed in water. the original and extension hoses should be tightly connected.

- The appliance is to be connected to the water mains using new hose-sets and that old hose-sets should not be reused.

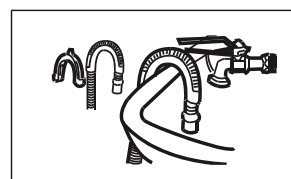
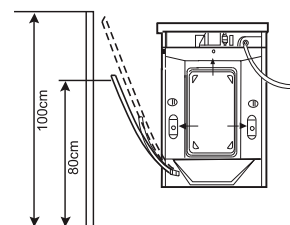

8-6. Connecting to the Power Supply

Check the following items before connection to the power supply.

- The socket conforms to the maximum power load (The maximum current load of the socket and power supply cable should not be less than 15A).
- power supply voltage conforms to the required value.
- The power supply socket and the plug of the washing machine should be compatible. if they are not compatible, Refer to a washing machine technician or a Haier designated service point for power cable replacement. The washing machine should be connected to the earth before use.
- Supplementary earth cable should not be necessary if the socket is connected to the earth.
- Supplementary earth cable should be installed on the upper back of the washing machine and connected to an earth if the power supply socket has no earth connection.

Caution: the supplementary earth cable should not be connected to water or heating pipes

Chapter 9 Wiring circuit and Self check

9-1. Wiring circuit

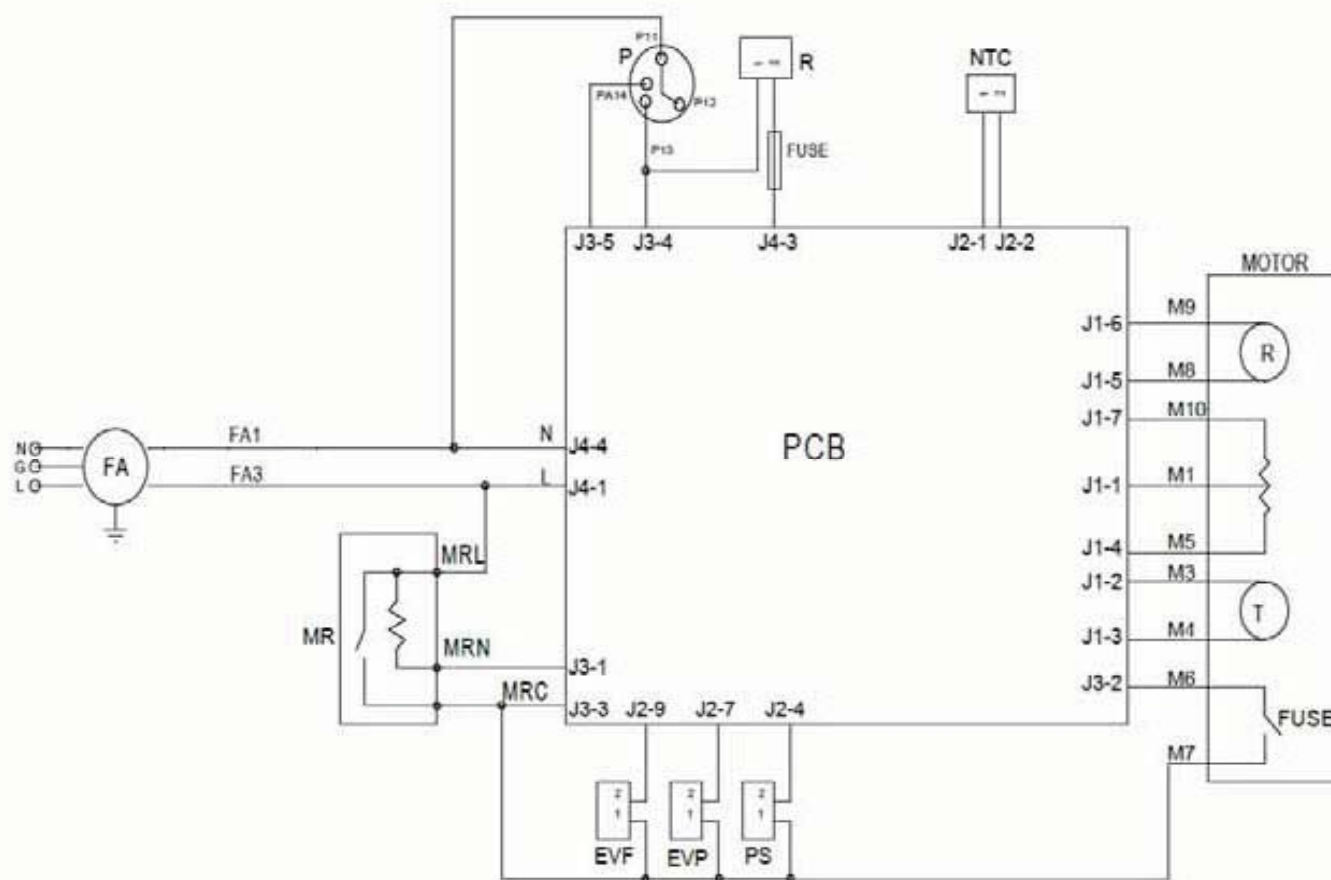

- Motor——Motor
- PCB——Printed Circuit Board
- MR——Door Lock
- R——Heating Element
- PS——Drainage Pump
- EVF,EVP——Water Inlet Magnetic Valve
- P——Pressure Switch
- FA——Interference Suppressor
- NTC——Temperature Sensor

9-2. Self check

Self check

1.How to start

Press the “°spee” and “°rt ens” button at the same time, then put the plug in to the socket, wait for about 3 seconds, the LED will display “TEST”±nd the model of the machine ,then you can press “°st d/pause” to let washing machine start test function.

2. Test item

- 1) when the door switch is closed for three seconds, 88:88 will be displayed.
- 2) when the main wash valve allows water to let in for 3 seconds, 77:77 will be displayed.
- 3) when the prewash valve allows water to let in for 3 seconds, 77:77 will be displayed.
- 4) when the softy water valve allows water to let in for 3 seconds, 77:77 will be displayed.
- 5) when the main wash valve, the prewash valve and also the softy water valve allow water to let in for 3 seconds at the same time, 77:77 will be displayed.
- 6) Heater runs for ten seconds, 66:66 will be displayed.
- 7) the drain pump runs for about 1 mins, 55:55 will be displayed
- 8) the motor runs for 10 seconds with the spin speed 400rpm, then for ten seconds with the spin speed 1000rpm, 44:44 will be displayed

Model selection

- 1.Press the extra rinse button and then put the plug in to the socket at the same time for 4 seconds, and it will enter the model-selection mode.
- 2.The default display shows 1060. Press the speed button to choose 1060/1050/0960/0950/0860/0850/0760/0750/0660/0650/1460/1450/1260/1250 till the needed model.Then press the temperature key and the model can be stored. The model can not be changed after storage.
- 3.If you want to change the model again after storage, you can cut off the NTC and do the cycle adjustment.
- 4.Model HW60-1460D you should choose 1460
5. Press On/Off button gently for 2 seconds to switch off the machine as buttons are soft touch sensitive.

Chapter 10 Error Display and troubleshooting

10-1. Error Display



Error message: Door is not properly shut 20s after program is started.

Troubleshooting:

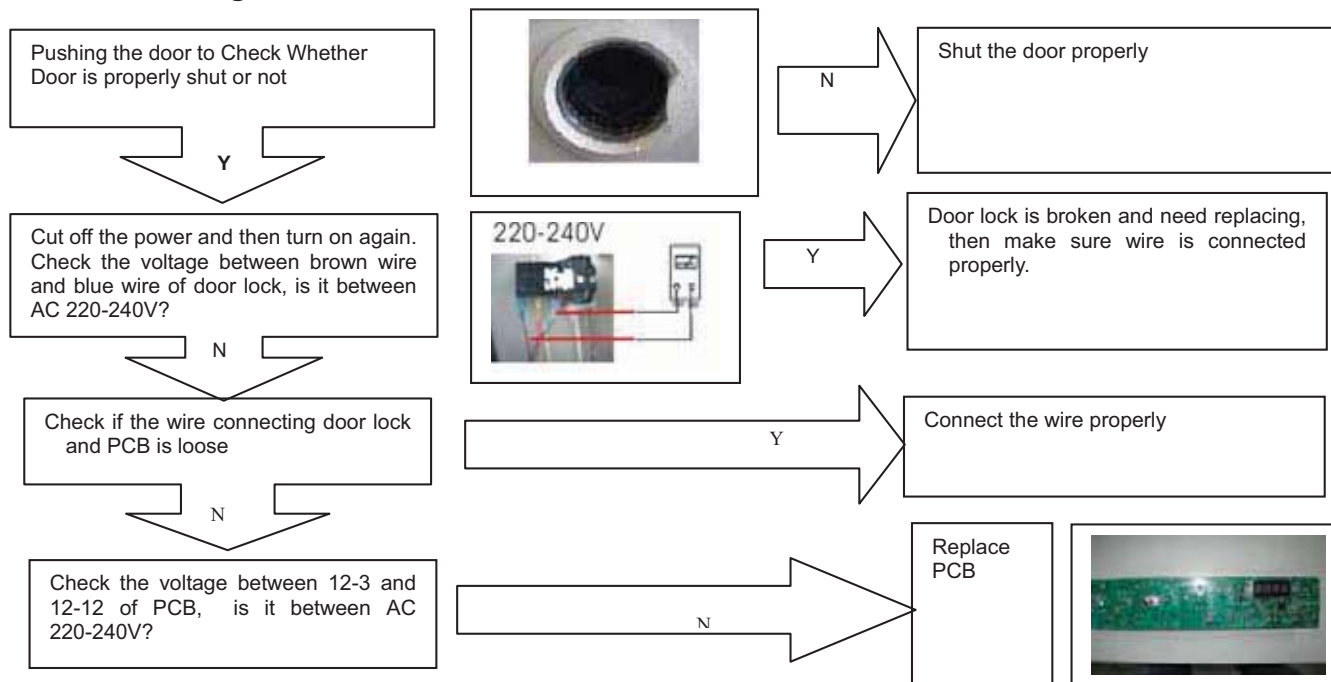

Error message: Drainage error, water not emptied within 4 min.

Troubleshooting:

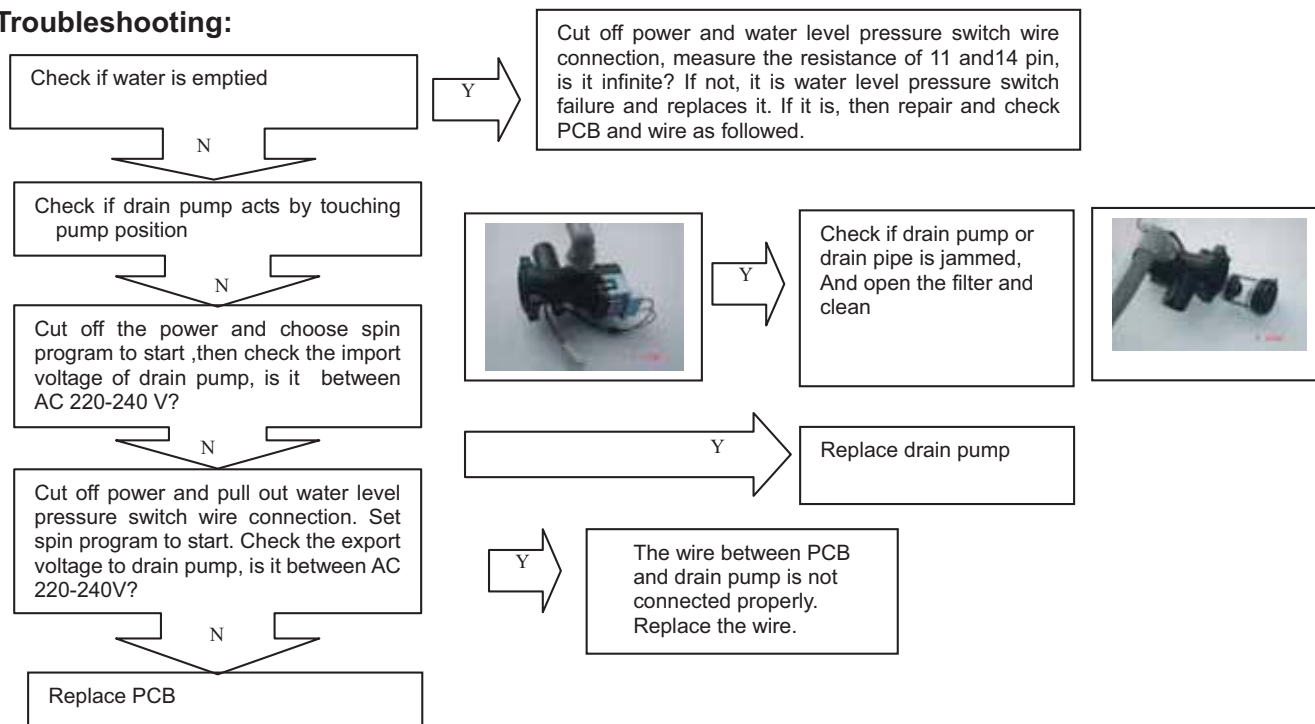



Error message:Temperature sensor is not properly connected or damaged (display at the end of a program).

Troubleshooting:

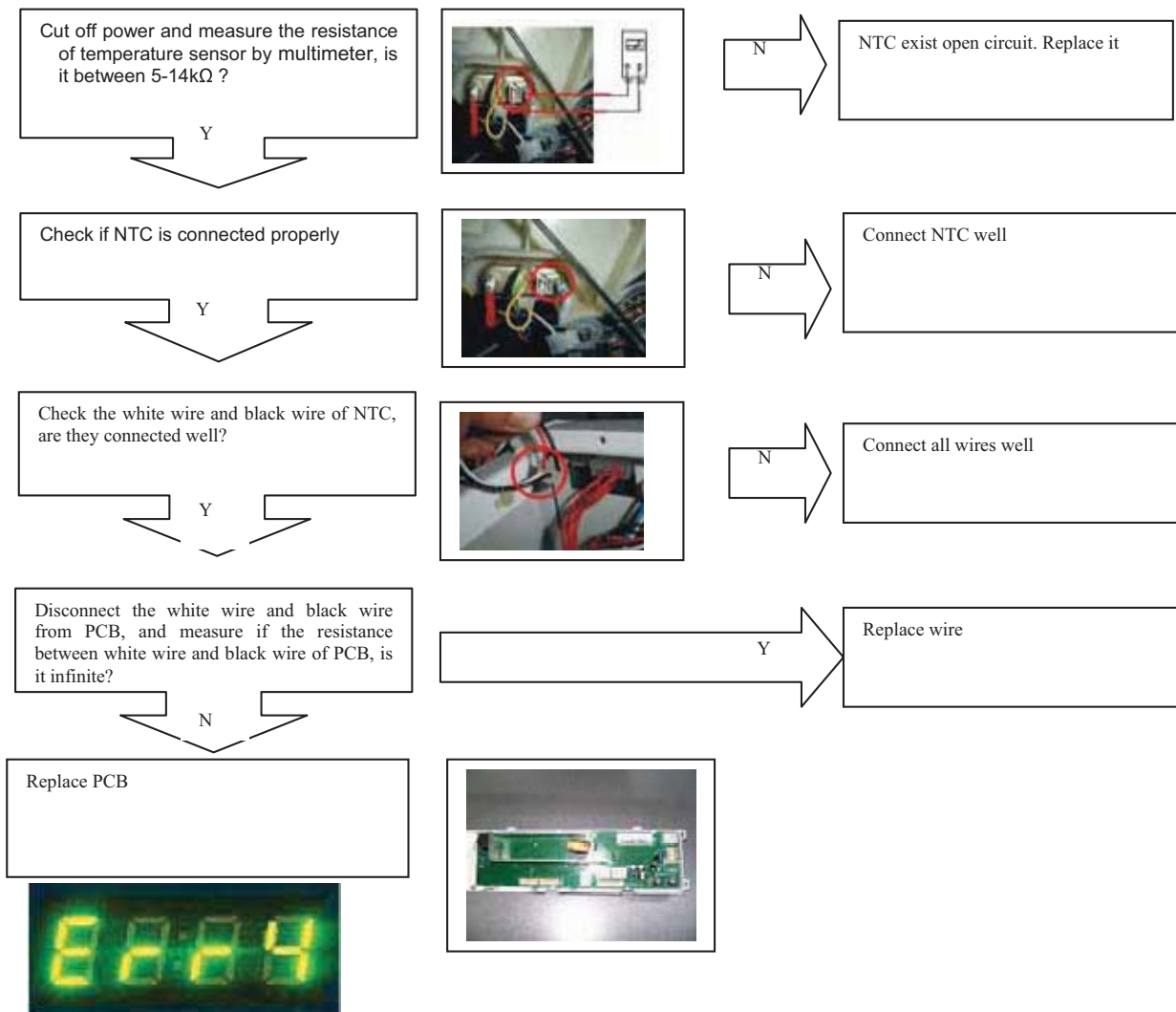

Error message:The heater may be broken

Troubleshooting:

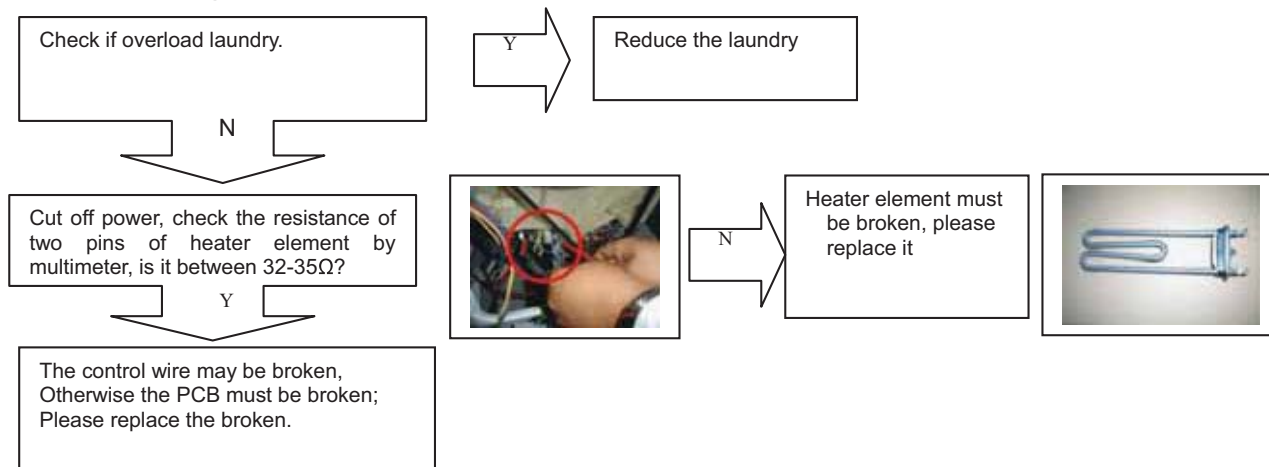



Error message: The required water level is not reached within 8 min, or the water level exceeds the protection value

Troubleshooting:

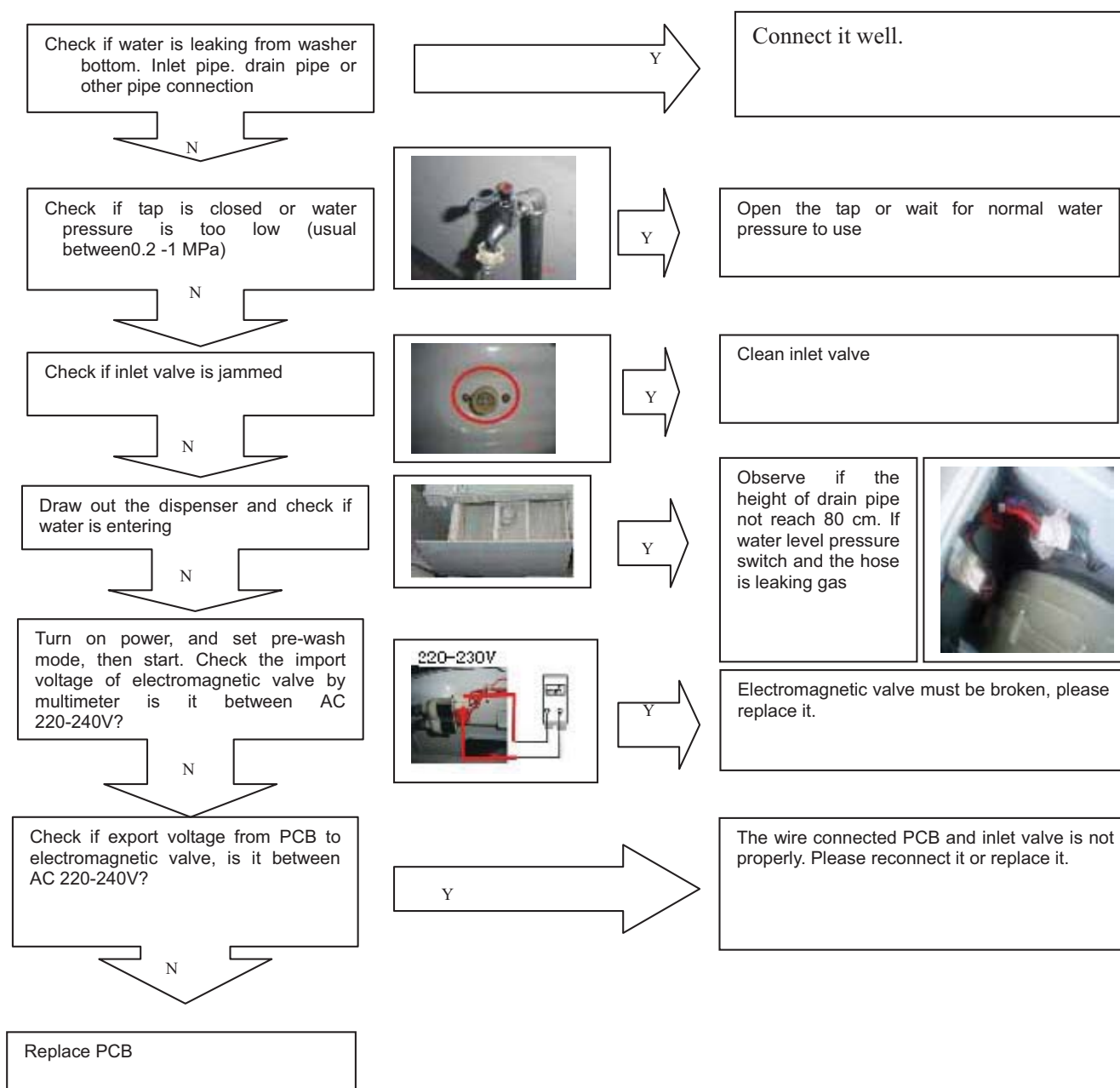



Error message. Motor overheat protection or is damaged.

Troubleshooting:

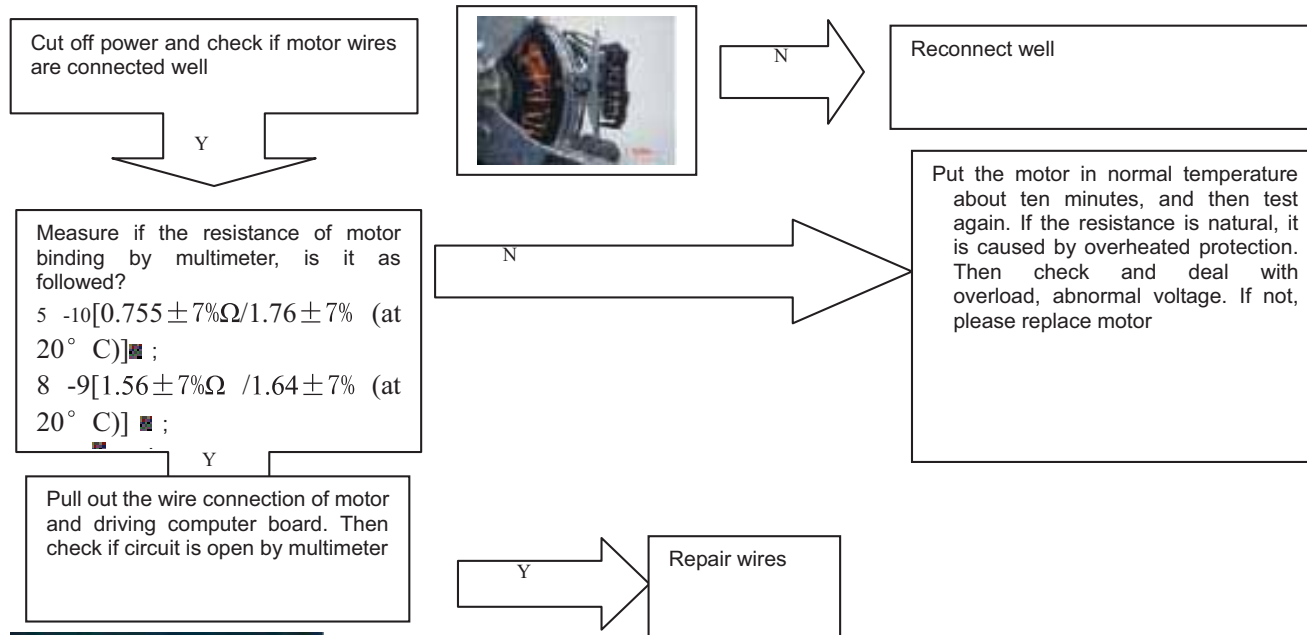

Error message. Water level exceeds protection value.

Troubleshooting:

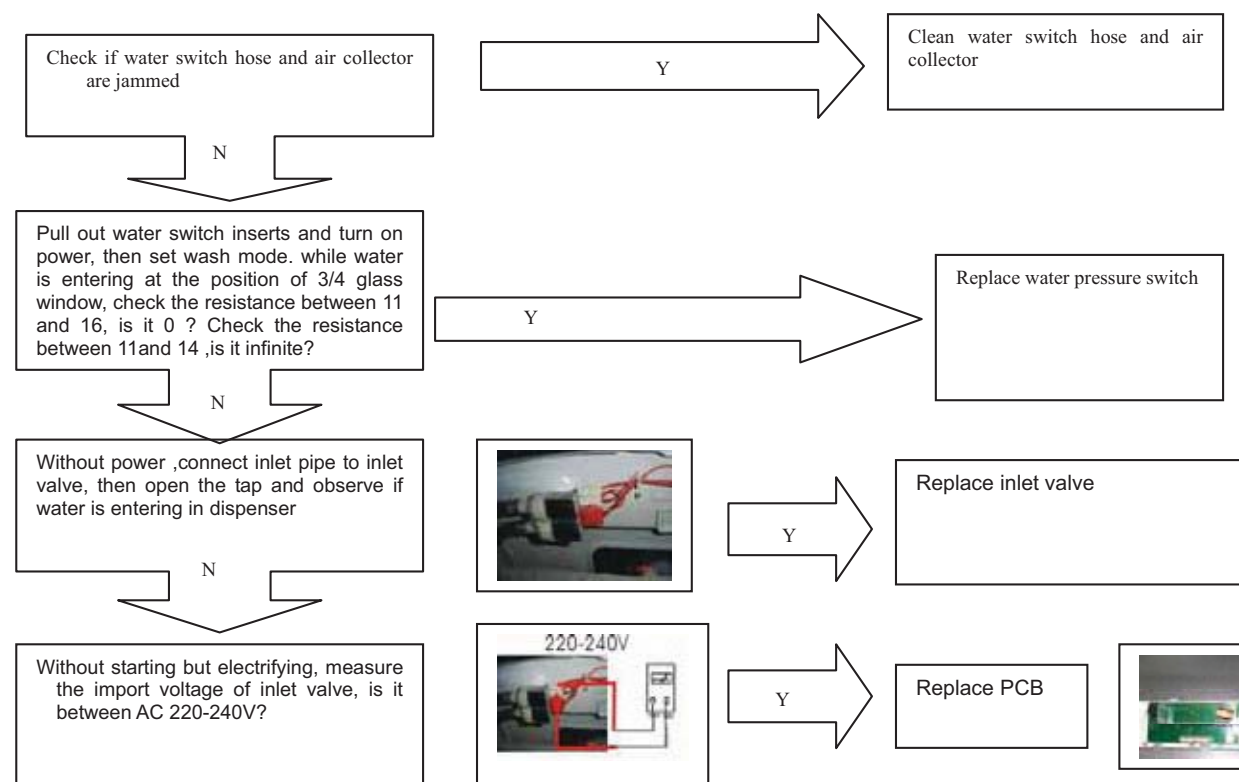

10-2. Examination & Troubleshooting

10-2-1. Display nothing

Troubleshooting:

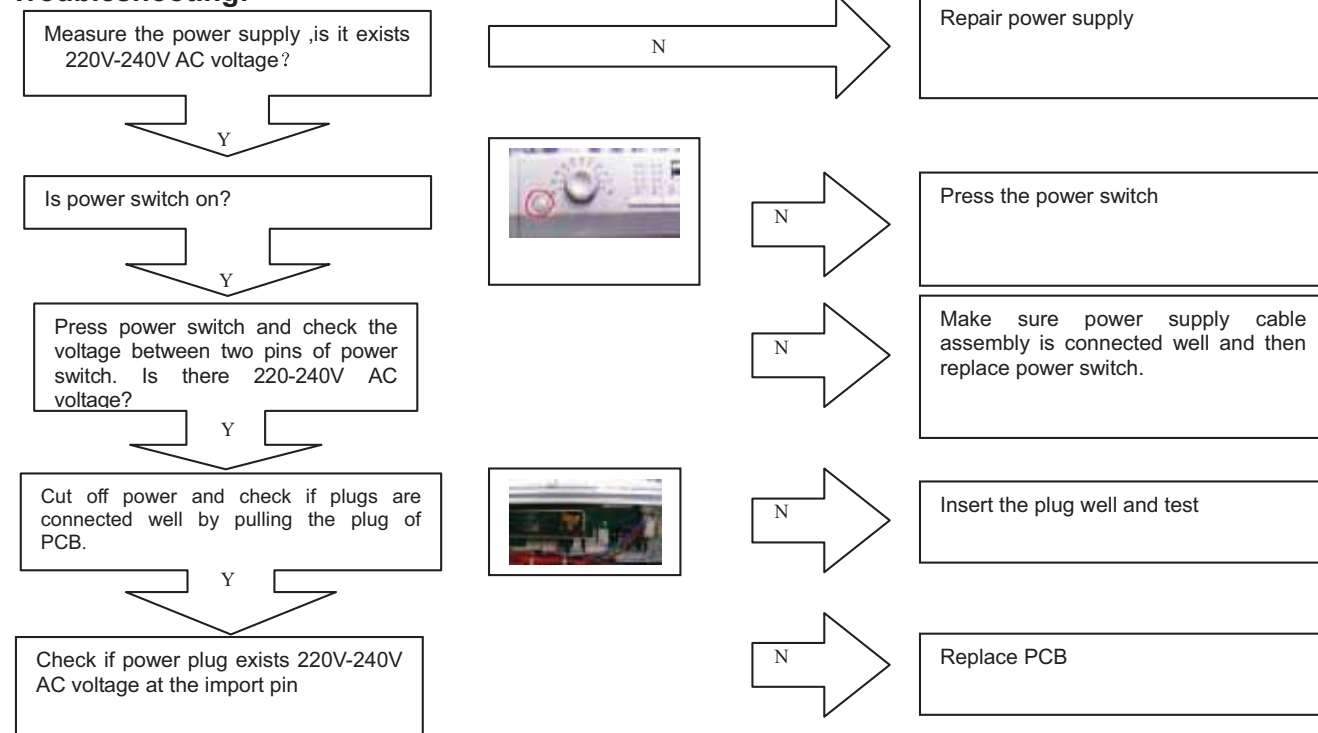

10-2-2. No water inletting

Troubleshooting:

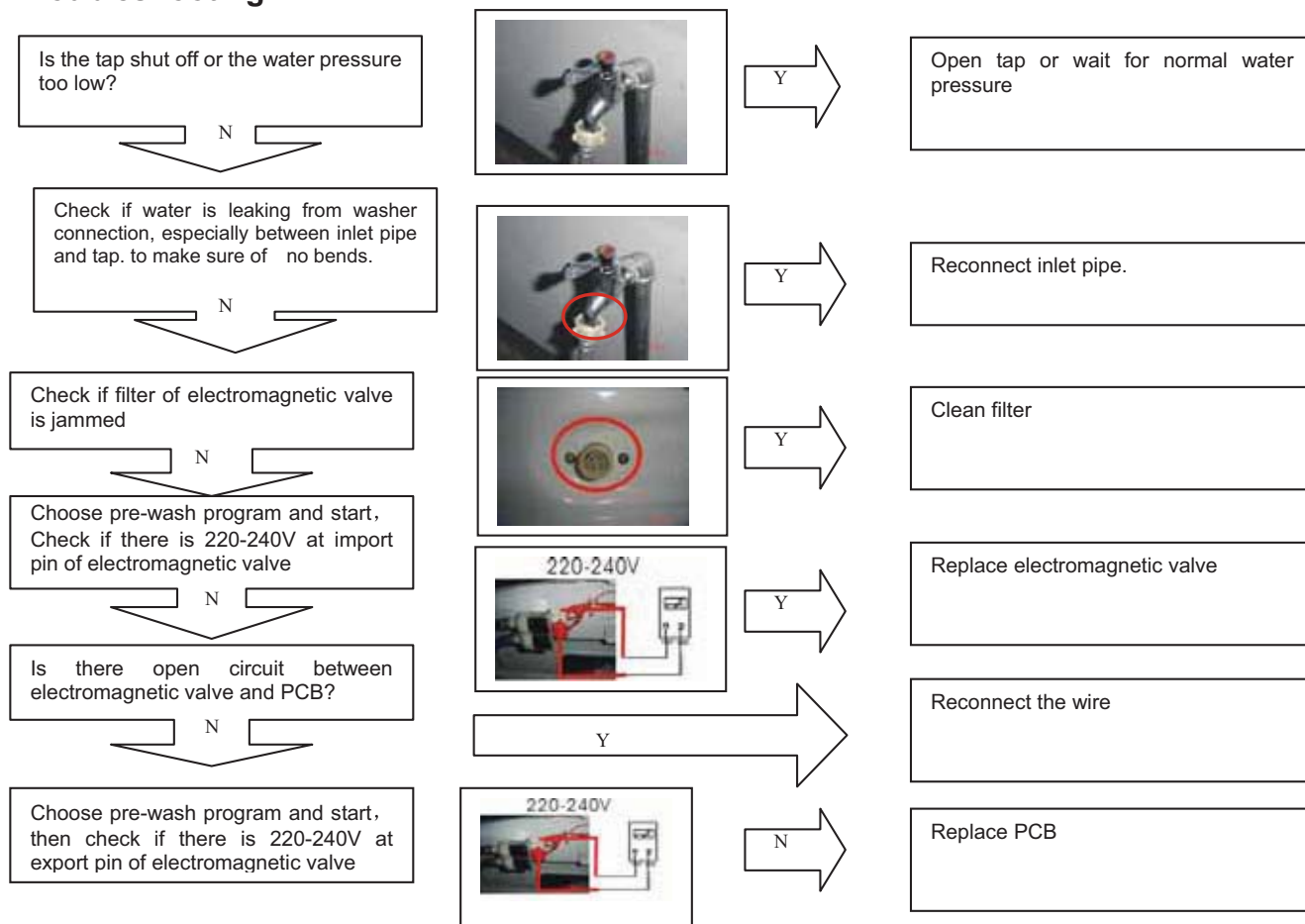

10-2-3. No draining

Troubleshooting:

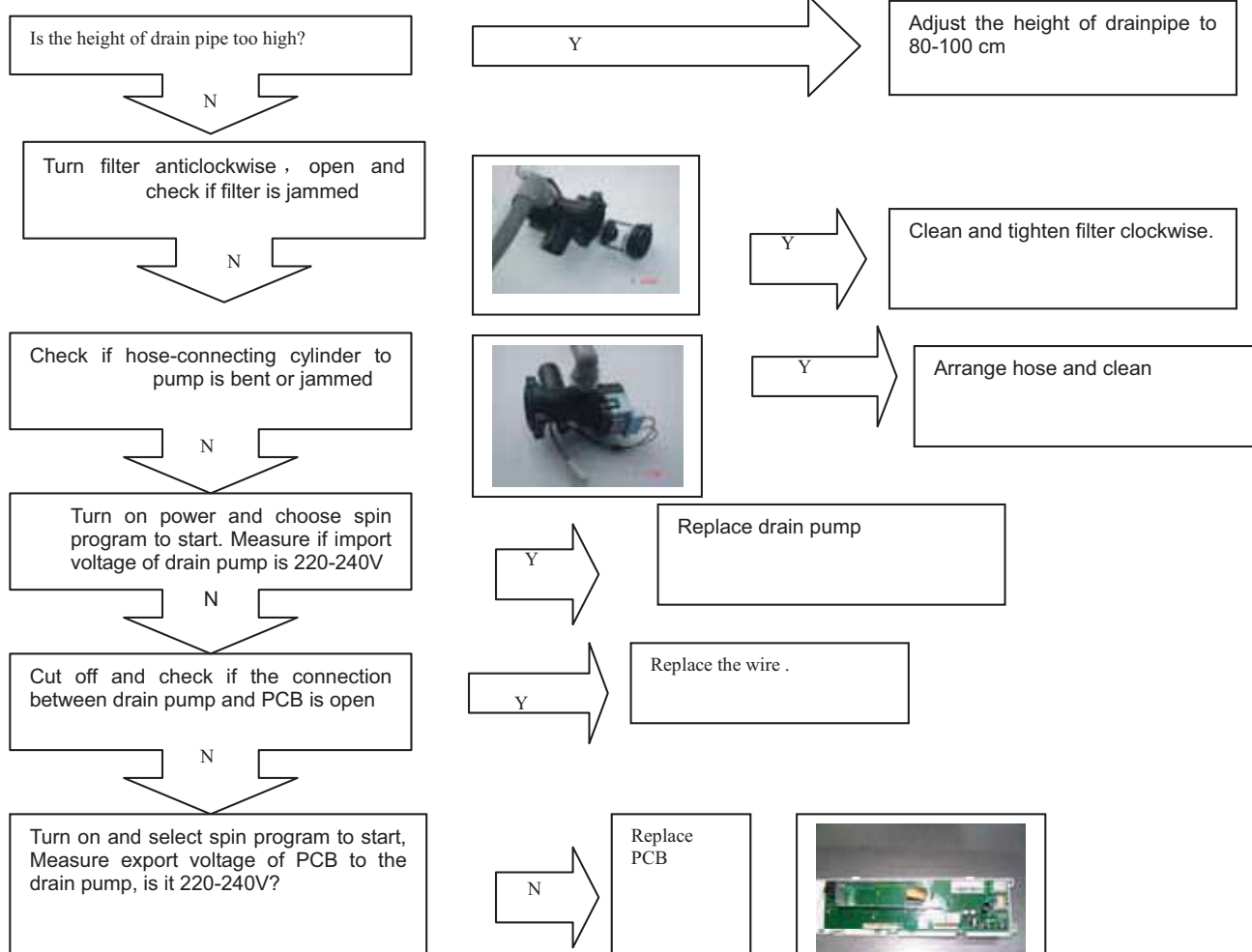

10-2-4. Abnormal noise and vibration

Troubleshooting:

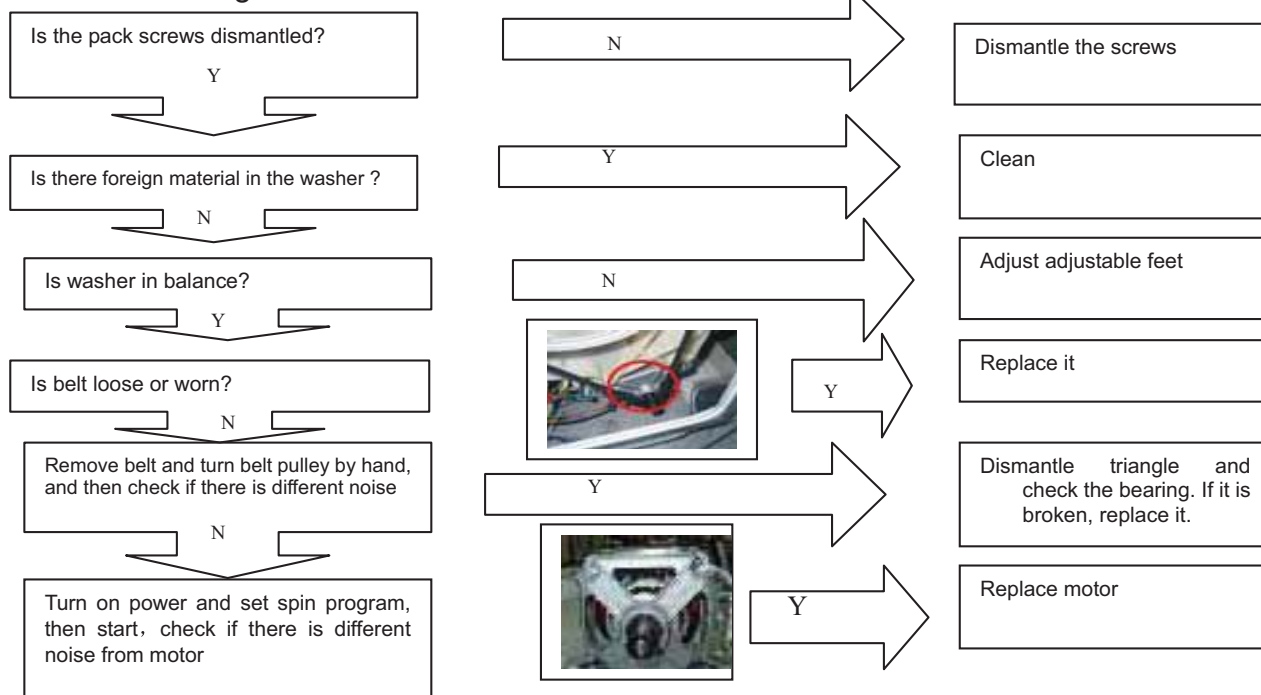

10-2-5. Water leaking

Troubleshooting:

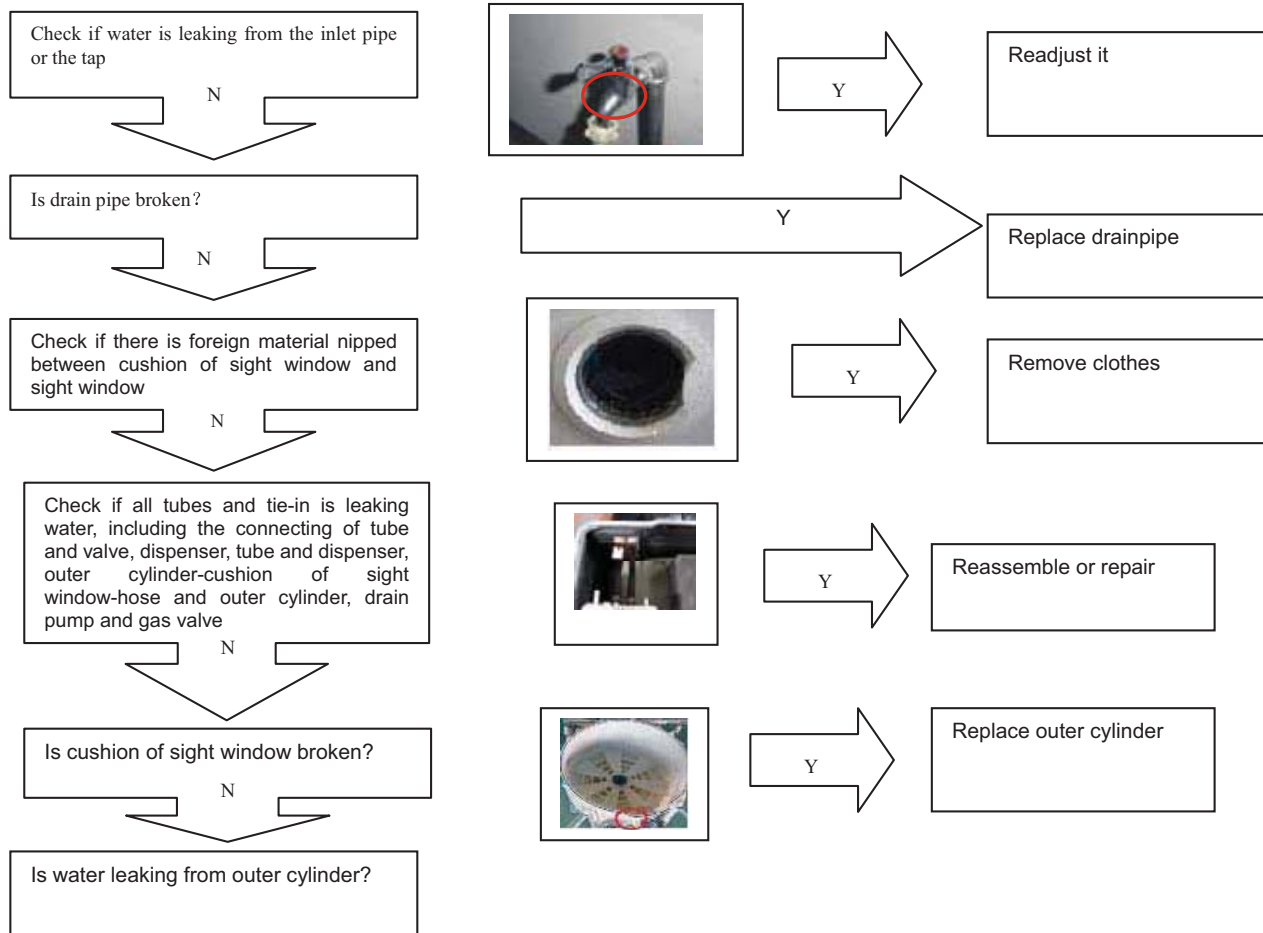

Chapter 11 Maintenance

1. Turn off the water tap and pull out electricity plug after each wash. Open the porthole to prevent formation of moisture and odors. If the washing machine is left idle for a long period, drain the water in the machine and replace the drainage hose.

2. Unplug the machine during cleaning and maintenance. Use a soft cloth dampened with soap liquid to clean the machine case and rubber components. Do not use organic chemicals or corrosive solvents.

3. Clean the detergent distribution drawer regularly. Swing out the drawer, flush it clean with water and then replace it.

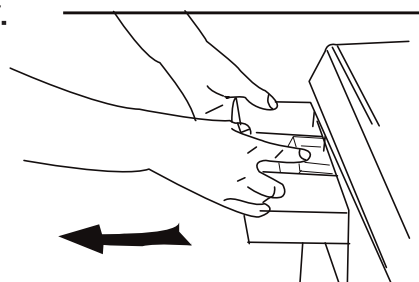

4. Clean the filter Cleaning methods (once a month)

- 1) Push out the outer cover (Fig. 1);
- 2) Screw out filter by turning counterclockwise (Fig. 2);
- 3) Flush clean with running water;
- 4) Replace the filter by turning clockwise and remount the cover (Fig. 3).

Caution: Turn the filter clockwise until it is in the place after the drain pump is cleaned.
The filter must be in place, or it may lead to leakage.

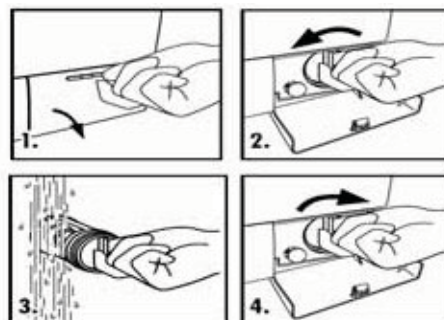

DISPLAY CODES AND SPECIAL FUNCTIONS

CODES	CAUSES	SOLUTIONS
Err1	→ Door is not properly shut.	_ Shut the door properly.
Err2	→ Drainage error, water not emptied within 6 minutes.	_ Clean the filter and check the drain hose for blockage. If error still exists, please contact the maintenance personnel.
Err3	→ Temperature sensor not properly connected or damaged.	_ Contact the maintenance personnel.
Err4	→ Heater error (Appears at the end of a cycle).	_ Contact the maintenance personnel.
Err5	→ Water level not met in 8 minutes.	_ Make sure that tap is turned on, and water pressure is normal. If problem still exists, please contact the maintenance personnel.
	→ The height of the drain hose is below 80 cm.	_ Install drain hose within 80-100 cm of height.
	→ The drain hose is in water.	_ Make sure the drain hose is not in water.
Err6	→ Motor error.	_ Contact the maintenance personnel.
Err7	→ Motor error.	_ Contact the maintenance personnel.
Err8	→ Water exceeds protective level.	_ Contact the maintenance personnel.
End	→ End of wash cycle.	
1:25	→ The remaining time is 1 hour 25 minutes.	
19:25	→ Status information: Preset time for delayed operation.	
Unb	After the last rinsing cycle finishes, spinning fails completely due to unbalance of the laundry.	Add clothes or run a spinning program again.

→ Control panel lock function: Press the "Delay" and the "Start/Pause" buttons simultaneously for 3 seconds after starting a program. It can no longer be changed by operating buttons or knobs. To unlock press the "Delay" and "Start/Pause" buttons again for 3 seconds. The display shows "CLO".

→ Power-off memory function: In case of abrupt power failure or the need to cut off the power during a program cycle, the present settings will be saved and the preset operation will resume when the power is on again.

→ To cancel a program

Press the "Start/Pause" button, then switch off the power and the program is automatically cancelled. Turn the program selector again to choose another program. If control panel lock function is of use, the program can not be cancelled.

Alarm sound can be cancelled if it is needed. Please follow the instruction as below:

Switch on the washing machine and turn the program knob to spin cycle, then press the "Delay" and "Extra rinse" button, hold on for 3 seconds. The "bEEP OFF" will be displayed on the screen which indicates that alarm sound has been canceled. To operate the above steps again so the alarm sound can be recovered and the display will show "bEEP ON".

TROUBLESHOOTING

The following circumstances do not constitute problems. Do not contact the Service Center until the problem has been confirmed.

PROBLEM	CAUSES	SOLUTIONS
Washing machine fails to operate.	<ul style="list-style-type: none"> → Poor connection to the power supply. → Power failure. → The washer door is not properly closed. → Machine has not been switched on. 	<ul style="list-style-type: none"> _ Check connection to the power supply. _ Check the power supply. _ Close the washer door properly. _ Make sure the machine is switched on.
Washing machine cannot be filled with water.	<ul style="list-style-type: none"> → The "Start/Pause" button is not pressed. → Water tap is not turned on. → Water pressure is less than 0,03 MPa. → The inlet hose is kinked. → Water supply failure. → The program knob is not properly set. → The washer door is not properly closed. → The inlet hose filter is blocked. 	<ul style="list-style-type: none"> _ press the "Start/Pause" button. _ Turn on the water tap. _ Check water pressure. _ Check the inlet hose. _ Ensure the water supply. _ Set the program knob properly. _ Close the washer door properly. _ Unblock the inlet hose filter.
Machine is draining while being filled.	<ul style="list-style-type: none"> → The height of the drain hose is below 80 cm. → The drain hose is in water. 	<ul style="list-style-type: none"> _ Install drain hose within 80-100 cm of height. _ Make sure the drain hose is not in water.
Drainage failure.	<ul style="list-style-type: none"> → Drain hose is blocked. → Drain hose end is higher than 100 cm above the floor level. → The filter is blocked. 	<ul style="list-style-type: none"> _ Unblock the drain hose. _ Make sure the drain hose end is lower than 100 cm above floor level. _ Unblock the filter.
Strong vibration while spinning.	<ul style="list-style-type: none"> → Not all transportation bolts have been removed. → Washing machine is located on an uneven surface or is not level. → Machine load is over 6(5) kg. 	<ul style="list-style-type: none"> _ Remove all transportation bolts. _ Make sure the washing machine is on an even surface and levelled. _ Reduce amount of laundry in the drum.
Operation stops before completing wash cycle.	<ul style="list-style-type: none"> → Water or electricity failure. 	<ul style="list-style-type: none"> _ Check the power supply or water supply.
Operation stops for a period of time.	<ul style="list-style-type: none"> → Washing machine gives an error message. → Washing machine is in soaking cycle? 	<ul style="list-style-type: none"> _ Check display codes. _ Press the rinse hood button or the Start/pause button again to cancel it.
Excessive foam in the drum, which is spilled to the distribution drawer.	<ul style="list-style-type: none"> → The detergent is not a low-foaming type or for manual wash. → Excessive use of detergent. 	<ul style="list-style-type: none"> _ Check if your detergent is appropriate. _ Reduce amount of detergent in the distribution drawer.
Automatic adjustment of the washing time.	<ul style="list-style-type: none"> → The washing program duration will be adjusted 	<ul style="list-style-type: none"> _ This is normal and doesn't affect the functionality.
Spinning fails	<ul style="list-style-type: none"> → Unbalance of the laundry 	<ul style="list-style-type: none"> _ Add clothes or run a spinning program again.

Sincere Forever

This document was created with Win2PDF available at <http://www.daneprairie.com>.
The unregistered version of Win2PDF is for evaluation or non-commercial use only.