

## 19" LED-LCD TV QUICK SETUP GUIDE DX-19E220A12

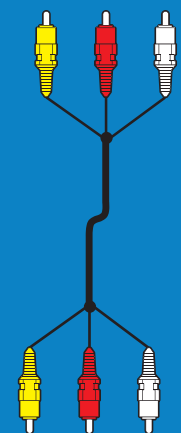

Composite cable



Remote control  
and  
2 AAA batteries

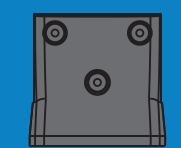

Stand column



Screws (4)



Stand base

### Front features

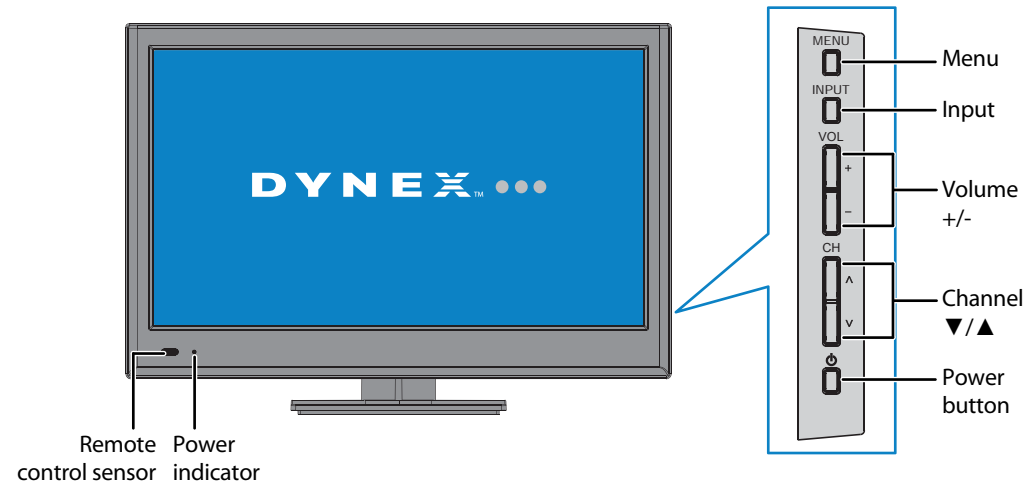

### Installing the stand

- 1 Carefully place your TV screen face-down on a cushioned, clean surface to protect the screen from damages and scratches.
- 2 Attach the stand column to the back of the TV, and then secure the stand column to the TV with three of the provided screws.
- 3 Align the stand base to the stand column, then secure the stand base to the stand column with the remaining provided screw.

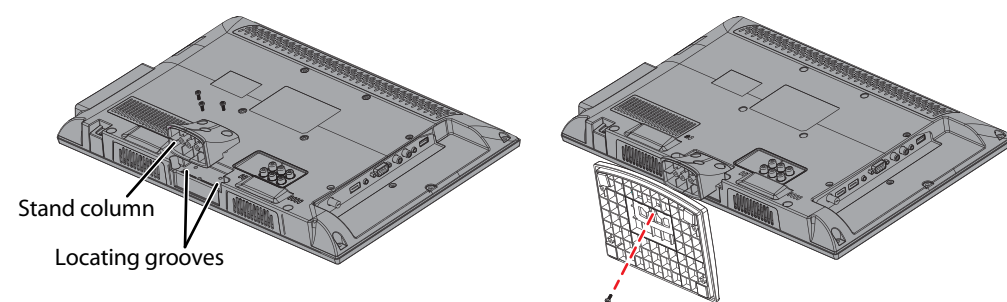

### Installing a wall-mount bracket

If you are mounting and plan on using the back inputs, a low profile wall mount may not work with your TV.

- 1 Carefully place your TV screen face-down on a cushioned, clean surface to protect the screen from damages and scratches.
- 2 Remove the three screws holding the TV to its stand column.
- 3 Remove the stand column.
- 4 Attach the wall-mount bracket to your TV using the mounting holes on the back of your TV. See the instructions that came with the wall-mount bracket for information about how to correctly hang your TV.

#### Warning

This apparatus is intended to be supported by a UL Listed wall mount bracket.

### Identifying cables

Your TV has several connection types for connecting devices. For the best video quality, connect a device to the best available connection.

Connection type	Video quality	Cable connector
HDMI video/audio	Best	
OR		
Component video and analog audio	Better	
OR		
Composite video and analog audio	Good	

You can use an HDMI jack to connect a DVI device to your TV. You need to attach an HDMI-to-DVI adapter to the end of the HDMI cable that connects to the DVI device's jack.

### Connecting a DVD or Blu-ray player, cable box, satellite receiver, or game station

Using HDMI (best)

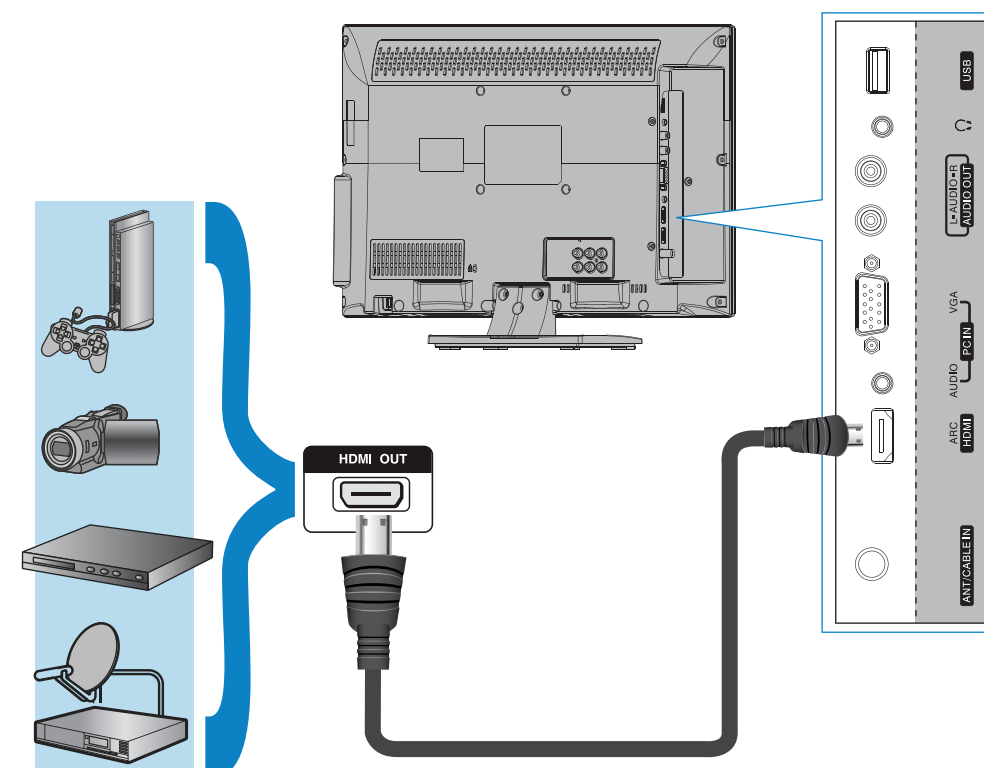

Using component cables (better)

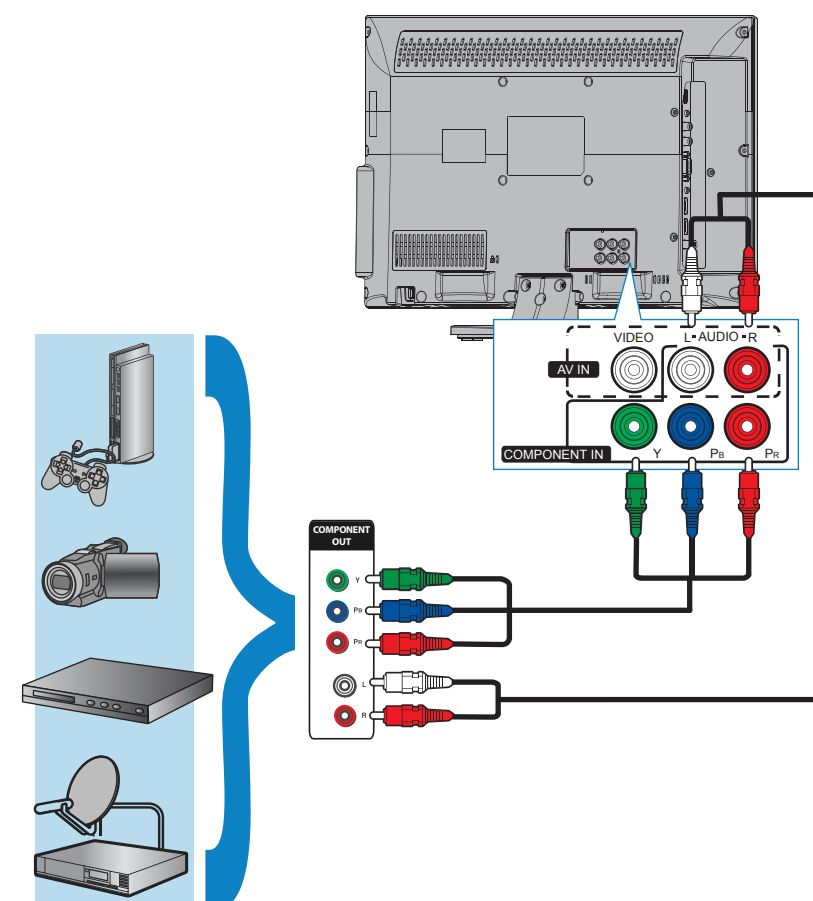

Using composite cables (good)

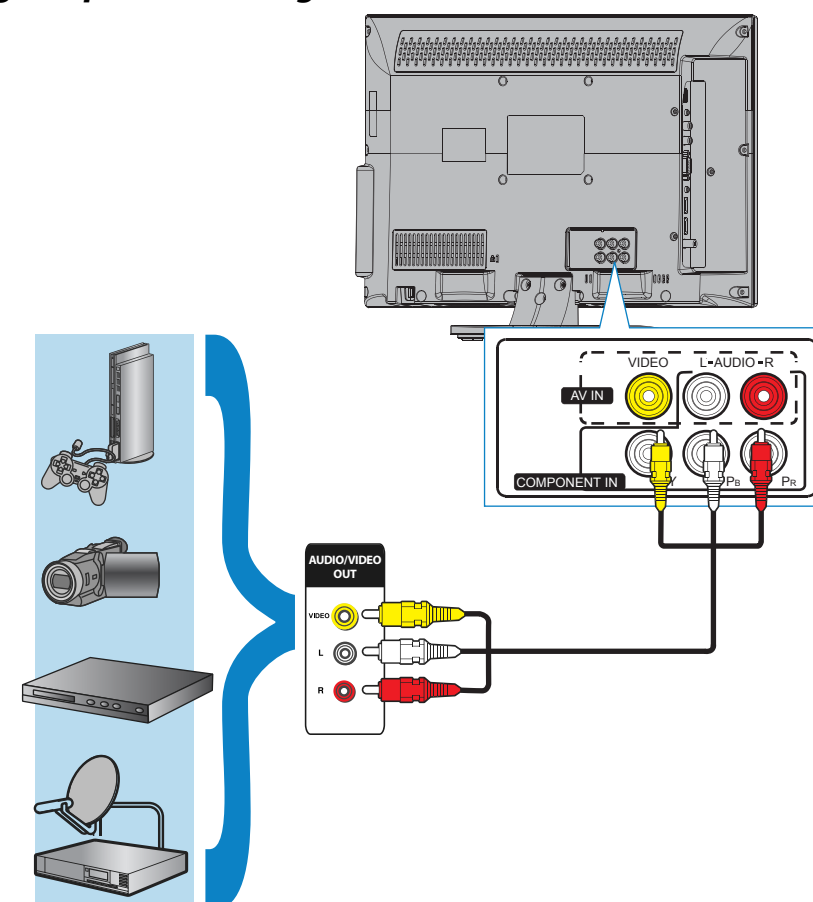

### Connecting an antenna/cable wall jack

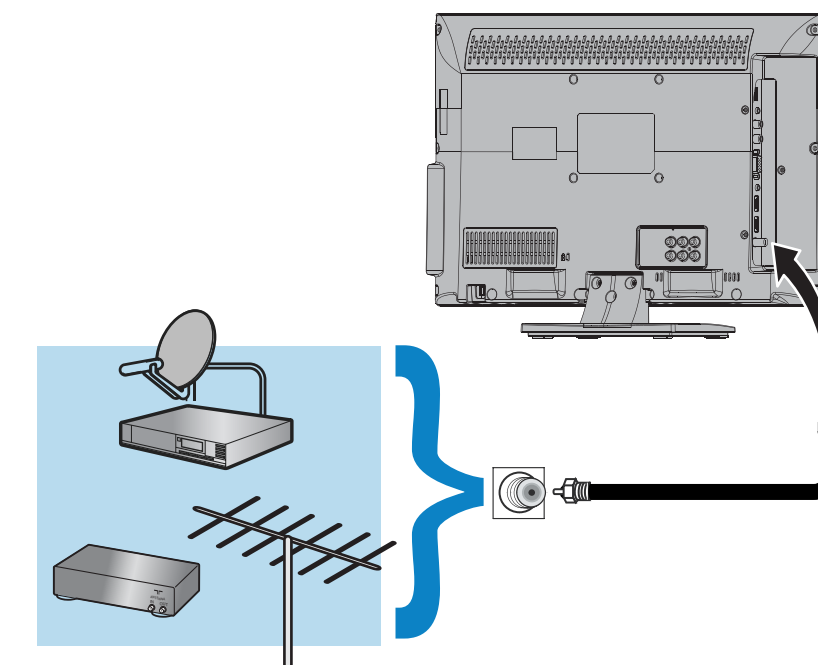

### Connecting a Home Theater System

Using Analog audio

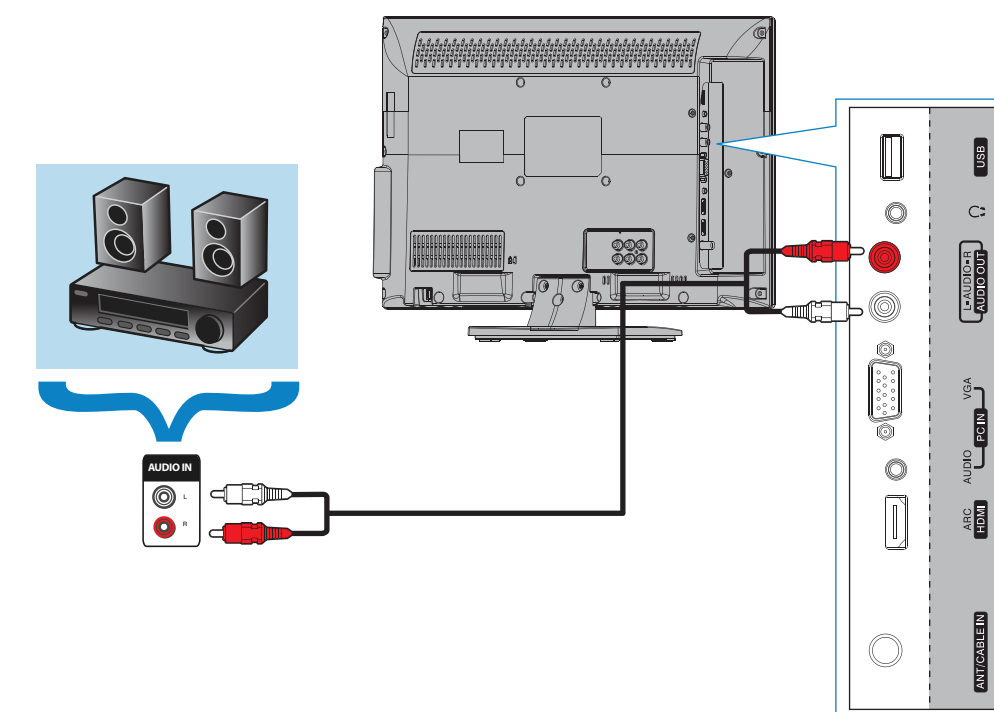

### Connecting a home theater system with multiple devices

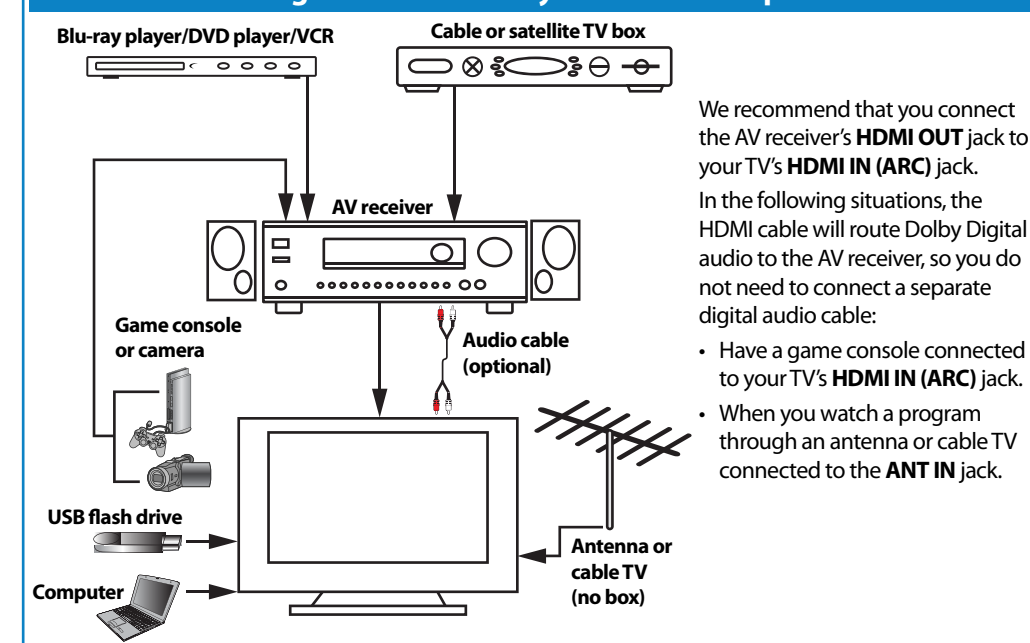

### WE ARE GOING GREEN!

A copy of your *User Guide* is not provided in the box but is available online. Go to [www.dynexproducts.com](http://www.dynexproducts.com), then click **Support & Service**. Enter your model number in the **Search** field, then press **Enter**. Click **Support/Downloads**.



Setting up and using your remote control

- 1 Press the release button on the back of the remote to remove the battery compartment cover.
- 2 Insert two AAA batteries into the battery compartment. Make sure that the + and - symbols on the batteries match the + and - symbols in the battery compartment.
- 3 Replace the cover.

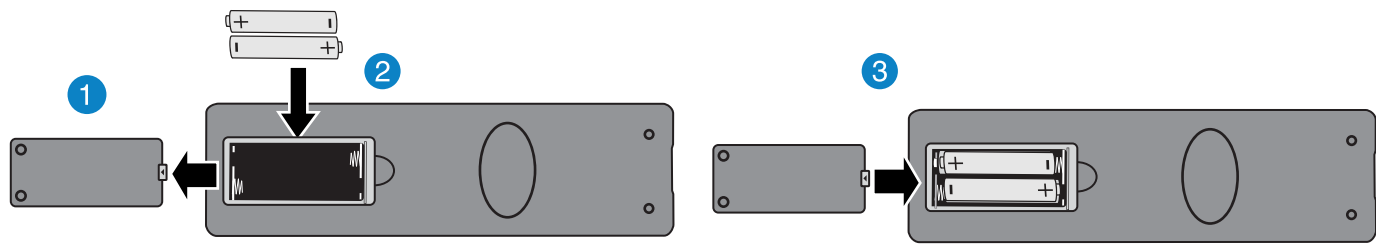

INPUT SOURCE

TV

AV

Component

HDMI

VGA

USB

DYNE X

Picture Audio Settings Channels USB

Parental Controls

Time

Closed Caption

Menu Settings

Computer Settings

Input Label

System Info

Restore Default

Move Select Back Exit

Aspect ratio options

**Normal:**

Displays the original 4:3 aspect ratio with black bars vertical on the left and right hand side of the screen. If the original aspect ratio is 16:9, then the image displays in 16:9.

**Zoom:**

Expands the image to fill the screen. The top and bottom of the image may be cropped.

**Wide:**

Use this option to view content recorded in a 16:9 (wide-screen) aspect ratio.

**Cinema:**

Stretches the image at the edges, but keeps a clear image in the center.

**Auto:**

Automatically adjusts the image based on the screen size and the TV program. **Note:** Auto is only available when Auto Zoom in the Channels menu is set to On.

**Input**

Opens the Input Source list.

**Power**

Turns your TV on or off.

**Numbers**

Enter channel numbers.

**RECALL**

Returns to the previous channel.

**GUIDE**

Displays the program guide.

**Arrows**

Navigates in on-screen menus.

**EXIT**

Closes the on-screen menu.

**Channel**

Changes the TV channels.

**FAVORITE**

Opens the Favorite Channel List.

**MTS/SAP**

Cycles through mono, stereo, and secondary audio for analog programs.

**CH-LIST**

Opens the channel list.

**CCD**

Turns closed captioning on or off.

**AUDIO**

Selects the audio modes.

**ENTER**

Confirms selections or changes.

**MENU**

Opens the on-screen menu.

**MUTE**

Mutes the sound.

**Volume**

Changes the volume.

**Quick Launch Inputs**

Selects another source connected to your TV.

**ZOOM**

Changes how the picture displays on the screen.

**PICTURE**

Selects the picture modes.

**SLEEP**

Sets the sleep timer.

**INFO**

Opens a TV status banner.

Enter a digital sub-channel number. (Example: 4.1)

Programming your remote control

To program your universal remote control to work with your new Dynex TV, see the table for common codes. If you have problems programming your remote or need a different remote control code, visit <http://www.dynexproducts.com/remotecodes> for the latest remote control code information.

Universal remote TV codes												
Universal remote controls				Cable/Satellite/Set-top box								
One for All	Philips	RCA	Sony	Cablevision	Charter	Comcast	Cox	DirectTV	Dish Network	Time Warner	TiVo	Verizon
0054	0198, 0490	135	068, 069, 078, 096, 100, 164, 168, 229, 026	068, 069, 078, 096, 100, 164, 168, 229, 026	2002, 1204, 1423, 1517, 0171, 1963, 0463, 1463, 0842, 1326, 167, 415, 424, 450, 456, 461, 507, 523, 567, 577, 586	10171, 11204, 11326, 11463, 11517, 11641, 11780, 11785, 11892, 11963, 12002	1326, 1463	10171, 11204, 11326, 11517, 11564, 11641, 11963, 12002	720	400, 450, 461, 456, 10463, 1463, 0463	0091	0198, 0490

Connecting power

Plug the AC power cord into a power outlet.

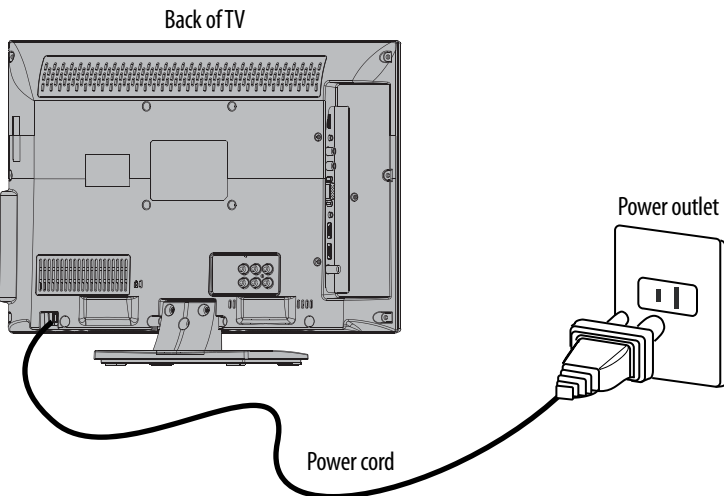

Turning on your TV for the first time

- 1 Connect the power cord to a power outlet, then press **Power**. The *Choose Your Menu Language* screen opens.
- 2 Press **Up** or **Down** to highlight a language, then press **ENTER**. The *Choose Your Time Setting* screen opens with Mode highlighted.
- 3 Press **Left** or **Right** to select **Auto** or **Manual**. If you select **Auto**, the date and time are set automatically from a digital TV signal. If you select **Manual**, you can manually set the date and time. Press **ENTER**. The *Choose Your Picture Mode* screen opens.
- 4 Press **Up** or **Down** to highlight **Home Mode** or **Retail Mode**, then press **ENTER**. If you select **Retail Mode**, a message asks you to confirm your selection. Select **Yes** or **No**. **Retail Mode** is not an energy-saving mode. The *Choose Your TV Source* screen opens.
- 5 Press **Up** or **Down** to highlight **Antenna**, **Cable**, or **Cable/Satellite box**. If you select **Antenna** or **Cable**, your TV scans for available channels. The scan may take several minutes. **If you select Cable/Satellite box, your TV does not scan for channels.**
- 6 To watch TV, press **INPUT**, then press **Up** or **Down** to select the video input source for your TV signal. For example, select **HDMI** if your TV is connected to a cable/satellite box using an HDMI cable or select **TV** if your TV is connected to an antenna or cable/satellite using a coaxial cable.

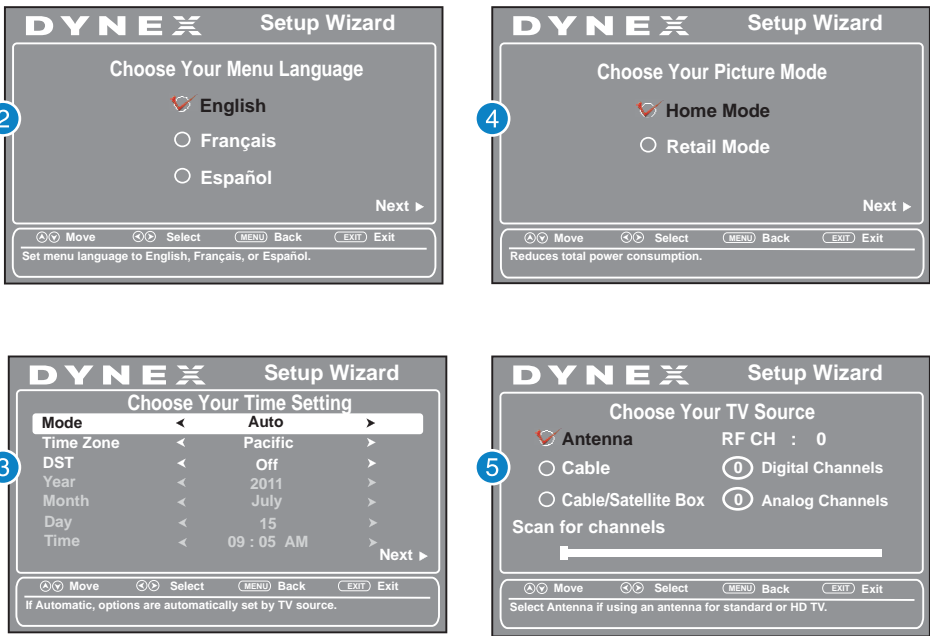

DYNE X

One-year limited warranty

Visit [www.dynexproducts.com](http://www.dynexproducts.com) for details.

Need additional help?

See your *User Guide*! This comprehensive guide includes everything from basic how-to steps to more advanced features. Go to [www.dynexproducts.com](http://www.dynexproducts.com), then click **Support & Service**. Enter your model number in the **Search** field, then press **Enter**. Click **Support/Downloads**.

We're here for you

[www.dynexproducts.com](http://www.dynexproducts.com)  
For customer service, call:  
**800-305-2204 (U.S./Canada markets)**

Distributed by Best Buy Purchasing, LLC  
7601 Penn Avenue South, Richfield, MN USA 55423-3645  
© 2011 BBY Solutions, Inc., All Rights Reserved.  
DYNE X is a trademark of BBY Solutions, Inc. Registered in some countries. All other products and brand names are trademarks of their respective owners.