

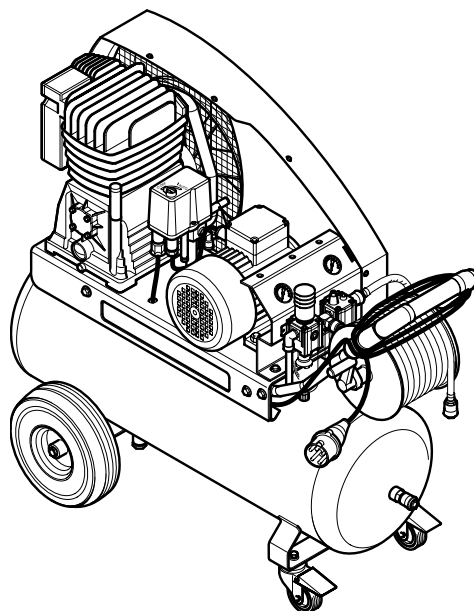

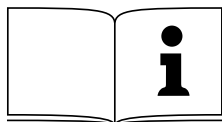

ELEKTRA BECKUM

Ein Unternehmen der Metabo-Gruppe



Mega 700 D



 Betriebsanleitung	3
 Operating Instruction	11
 Instructions d'utilisation	18
 Handleiding	26

D DEUTSCH**KONFORMITÄTSERLÄRUNG**

Wir erklären in alleiniger Verantwortlichkeit, dass dieses Produkt mit den folgenden Normen übereinstimmt* gemäß den Bestimmungen der Richtlinien**

F FRANÇAIS**DECLARATION DE CONFORMITE**

Nous déclarons, sous notre seule responsabilité, que ce produit est en conformité avec les normes ou documents normatifs suivants* en vertu des dispositions des directives **

IT ITALIANO**DICHIARAZIONE DI CONFORMITÀ**

Noi dichiariamo sotto la nostra esclusiva responsabilità che il presente prodotto è conforme alle seguenti norme* in conformità con le disposizioni delle normative **

PT PORTUGUÊS**DECLARAÇÃO DE CONFORMIDADE**

Declaramos sob nossa responsabilidade que este produto está de acordo com as seguintes normas* de acordo com as directrizes dos regulamentos **

FIN SUOMI**VAATIMUKSEN MUKAISUUSVAKUUTUS**

Vakuutamme, että tämä tuote vastaa seuraavia normeja* on direktiivien määräysten mukainen**

DA DANSK**OVERENSSTEMMELSESTEST**

Hermed erklærer vi på eget ansvar, at dette produkt stemmer overens med følgende standarder* iht bestemmelserne i direktiverne**

EL ΕΛΛΗΝΙΚΑ**ΔΗΛΩΣΗ ΑΝΤΙΣΤΟΙΧΕΙΑΣ**

Δηλώνουμε με ιδία ευθύνη ότι το προϊόν αυτό αντιστοιχεί στις ακόλουθες προδιαγραφές* σύμφωνα με τις διατάξεις των οδηγιών**

ENG ENGLISH**DECLARATION OF CONFORMITY**

We herewith declare in our sole responsibility that this product complies with the following standards* in accordance with the regulations of the undermentioned

NL NEDERLANDS**CONFORMITEITSVERKLARING**

Wij verklaren als enige verantwoordelijke, dat dit product in overeenstemming is met de volgende normen* conform de bepalingen van de richtlijnen**

ES ESPAÑOL**DECLARACION DE CONFORMIDAD**

Declaramos bajo nuestra exclusiva responsabilidad, que el presente producto cumple con las siguientes normas* de acuerdo a lo dispuesto en las directrices** Homologación de

SV SVENSKA**FÖRSÄKRAN OM ÖVERENSSTÄMMELSE**

Vi försäkrar på eget ansvar att denna produkt överensstämmer med följande standarder* enligt bestämmelserna i direktiven**

NO NORGE**SAMSVARERKLÆRING**

Vi erklærer under eget ansvar at dette produkt samsvarer med følgende normer* henhold til bestemmelsene i direktiv**

POL POLSKI**OŚWIADCZENIE O ZGODNOŚCI**

Oświadczamy z pełną odpowiedzialnością, że niniejszy produkt odpowiada wymogom następujących norm* według ustaleń wytycznych **

HU MAGYAR**MEGEGYZŐSÉGI NYILATKOZAT**

Kizárólagos felelősségünk tudatában ezennel igazoljuk, hogy ez a termék kielégíti az alábbi szabványokban lefektetett követelményeket* megfelel az alábbi irányelvek előírásainak**

MEGA 700 D

* EN 60204-1, EN 60335-1, EN 1012-1

** 98/37/EG - 93/68/EWG - 89/336/EWG - 73/23/EWG - 87/404/EWG

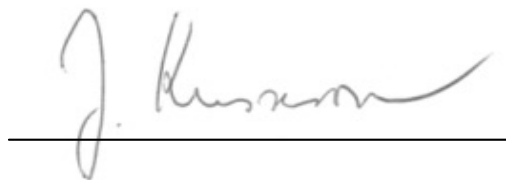

Jürgen Kusserow
Vorstand



ELEKTRA BECKUM AG – Daimlerstraße 1 – 49716 Meppen

1001014/ 01

1. Machine Overview

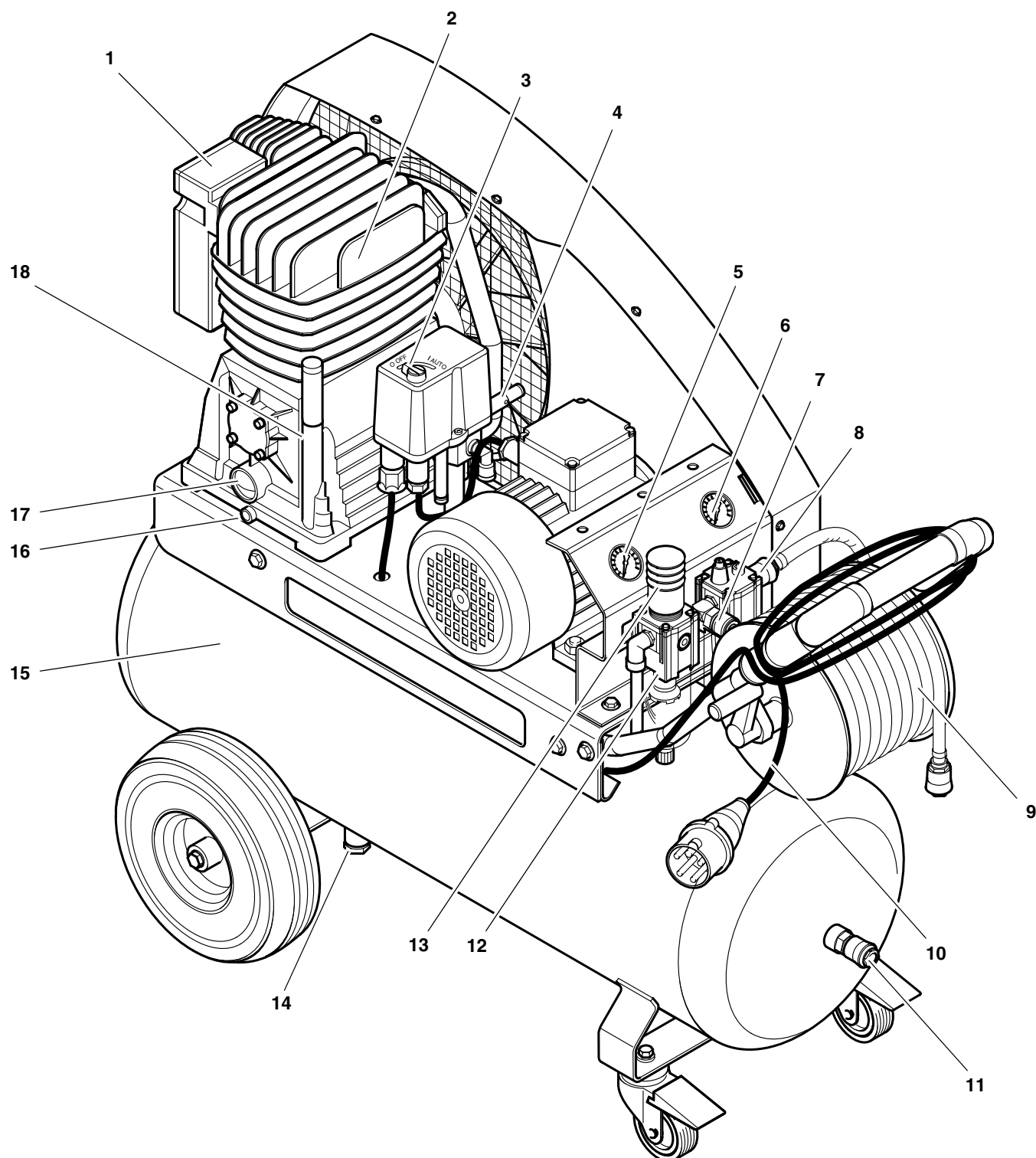

- | | | | | | |
|---|---|----|---|----|--|
| 1 | Air intake filter housing | 8 | Air outlet for regulated, filtered, lubricated compressed air | 14 | Condensate drain cock of pressure vessel |
| 2 | Compressor pump | 9 | Hose reel with air hose | 15 | Pressure vessel |
| 3 | On/Off switch | 10 | Power cable | 16 | Oil drain plug |
| 4 | Safety valve | 11 | Air outlet for non-regulated, unfiltered, oil-free compressed air | 17 | Oil sight glass |
| 5 | Tank pressure gauge | 12 | Filter/Regulator unit | 18 | Oil filler plug |
| 6 | Outlet pressure gauge | 13 | Pressure regulator | | |
| 7 | Air outlet for regulated, filtered, oil-free compressed air | | | | |

Table of Contents

1. Machine Overview	11
2. Please Read First!	12
3. Safety	12
3.1 Specified conditions of use	12
3.2 General safety instructions	12
3.3 Safety devices	13
4. Operation	13
4.1 Prior to initial operation	13
4.2 Mains connection	13
4.3 Generating compressed air	13
5. Care and Maintenance	14
5.1 Periodic maintenance	14
5.2 Machine storage	15
6. Available Accessories	15
7. Trouble Shooting	16
8. Repairs	16
9. Environmental protection	17
10. Technical Specifications	17
11. Available Accessories	35

2. Please Read First!

- Read these instructions before use. Pay special attention to the safety instructions.
- If you notice transport damage while unpacking, notify your supplier immediately. **Do not** operate the machine!
- Dispose of the packing in an environmentally friendly manner. Take to a proper collecting point.
- Keep these instructions for reference on any issues you may be uncertain about. When the compressor is used commercially, also keep the test certificates of the individual compressed air components.
- If you lend or sell this machine be sure to have the instructions go with it.

3. Safety

3.1 Specified conditions of use

This machine is intended to generate compressed air required for the operation of air tools.

Any use for medical purposes, food processing as well as filling of oxygen cylinders for breathing equipment is not permitted.

Explosive, combustible gases or gases detrimental to health may not be compressed. Operation in hazardous locations is not permitted.

Any other use is not as specified. Use not as specified, alteration of the

machine or use of parts not approved by the equipment manufacturer, can cause unforeseeable damage!

Children, juveniles and persons not having been instructed in its usage are not permitted to operate this machine and any air tools connected to it.

3.2 General safety instructions

When using this electric tool observe the following safety instructions, to exclude the risk of personal injury or material damage.

Please also observe the special safety instructions in the respective chapters; Keep all documents, supplied with the machine, for future reference.

Observe the statutory accident insurance institution regulations and regulations for the prevention of accidents pertaining to the operation of air compressors and air tools, where applicable.



General Hazard!

Keep your work area tidy – a messy work area invites accidents.

Be alert. Know what you are doing. Set out to work with reason. Do not operate electric tool while under the influence of drugs, alcohol or medication.

Consider environmental conditions.

Keep work area well lighted.

Prevent adverse body positions. Ensure firm footing and keep your balance at all times.

Make sure the electric tool stands safely and can not topple over (check air pressure of tyres).

Do not operate electric tool near inflammable liquids or gases.

Keep bystanders, particularly children, out of the work area. Do not permit other persons to touch the tool or power cable while the electric tool is running.

Do not overload electric tool – use it only within the performance range it was designed for (see Technical Specifications).



Danger! Risk of electric shock!

Do not expose electric tool to rain.

Do not operate electric tool in damp or wet environment.

Prevent body contact with earthed objects such as radiators, pipes, cooking stoves or refrigerators when operating this electric tool.

Do not use the power cable for any purpose it is not intended for.



Risk of personal injury by escaping compressed air and parts hurled about by escaping air!

Never direct compressed air against persons or animals!

Ensure all air tools and accessories

used are designed for the working pressure or are supplied via a pressure regulator.

Please note that, when disconnecting the quick coupler, the compressed air contained in the pressure hose will escape all of a sudden. You should therefore firmly hold the air hose when disconnecting it.

Ensure all screwed connections are fully tightened at all times.

Do not attempt to repair the machine yourself! Only trained specialists are permitted to service or repair compressors, pressure vessels and air tools.



Hazard generated by lubricated compressed air!

Use lubricated compressed air only for air tools requiring such supply. Do not use an air hose, used to supply lubricated compressed air, to supply air tools not designed for operation on lubricated compressed air. Do not fill tyres with lubricated compressed air.



Risk of burns from the surfaces of parts carrying compressed air!

Let tool cool off before servicing.



Risk of personal injury and crushing by moving parts!

Do not operate the electric tool without installed guards.

Please note that the compressor will start automatically when the pressure falls off to minimum! – disconnect from power supply prior to any servicing.

Ensure that when switching on (e.g. after servicing) no tools or loose parts are in the electric tool.

When coiling the air hose up or uncoiling it, do not reach between the crank and the transport handle.



Hazard generated by insufficient personal protection gear!

Wear hearing protection.

Wear safety glasses.

Wear mask respirator when work generates dust or mist detrimental to health.

Wear suitable work clothes. When working outdoors wearing of non-slip shoes is recommended.



Hazard generated by electric tool defects!

Keep electric tool and accessories in good repair. Observe the maintenance instructions.

Check electric tool for possible damage before any use: Before operating the electric tool all safety devices, protection devices or slightly damaged parts must be inspected for proper functioning as specified. Check to see that all moving parts work properly and do not jam. All parts must be correctly installed and

meet all conditions necessary for the proper operation of the electric tool. Damaged protection devices or parts must be repaired or replaced by a qualified specialist. Have damaged switches replaced by a service centre. Do not operate electric tool if the switch can not be turned ON or OFF. Keep handles free of oil and grease.

3.3 Safety devices

Safety valve

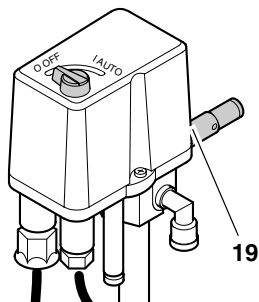

The spring-loaded safety valve (19) is incorporated into the pressure switch. The safety valve opens if the max. permissible pressure is exceeded.

4. Operation

4.1 Prior to initial operation

Filling with pneumatic oil

1. Remove cup of lubricator (20) and fill with pneumatic oil to a level between the two markings.

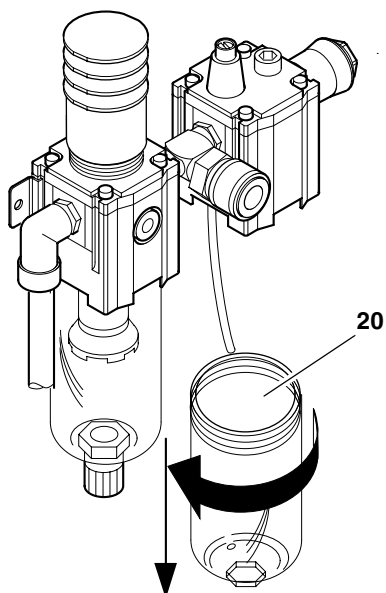

2. Replace the lubricator cup.

4.2 Mains connection

⚠ Danger! High Voltage
Operate machine in dry environment only.
Operate machine only on a power source complying with the following requirements:

- outlets properly installed, earthed and tested;
- fuse protection in accordance with the technical specifications.

Position power cable so it does not interfere with the work and is not damaged.

Always check to see that the machine is switched OFF before plugging in.



Check direction of rotation!
Depending on the phase sequence, the motor could turn in the wrong direction. This can damage the machine. Therefore the direction of rotation is to be checked every time the machine is connected to the power supply: The pulley of the compressor pump must turn in the direction indicated by the arrow on the belt guard.

If it turns in the wrong direction, two phases must be interchanged in the power cable plug:

1. Unplug.
2. Interchange phases with a screwdriver as illustrated:
 - Depress switch (21) slightly
 - and turn by 180°.

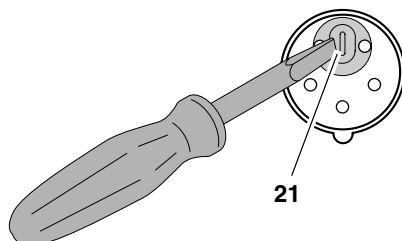

3. Plug power cable in again.

Protect power cable from heat, aggressive liquids and sharp edges.

Use only extension cables with sufficient lead cross section (see "Technical Specifications").

Do not stop the machine by unplugging, but switch OFF using the ON/OFF switch.

Unplug after use.

4.3 Generating compressed air

1. Connect air hose to compressor. Depending on the purpose of application three outlets are available.
 - Air outlet for regulated, filtered, oil-free compressed air (22).
 - Air outlet for regulated, filtered, lubricated compressed air (23).
 - Air outlet for non-regulated, unfiltered, oil-free compressed air (24).

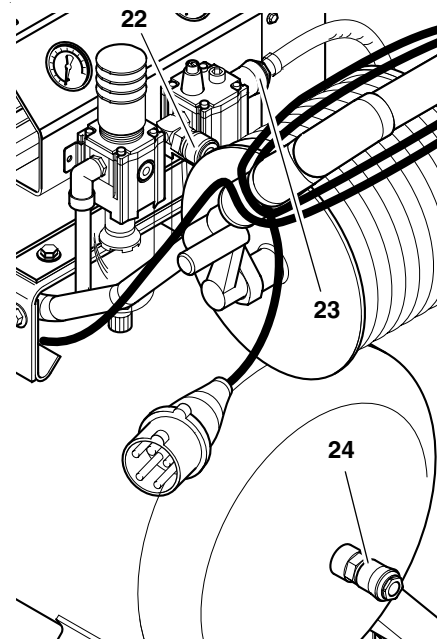

Danger!
Hazard generated by compressed air containing oil. Use compressed air containing oil only for applications that require such supply. Do not operate air tools such as tyre inflator gauges or paint spray guns on lubricated air.

An air hose, which has been used for lubricated air, must not be used for applications requiring oil-free compressed air.

2. Start compressor (25) and wait until the max. tank pressure is reached (compressor shuts off).

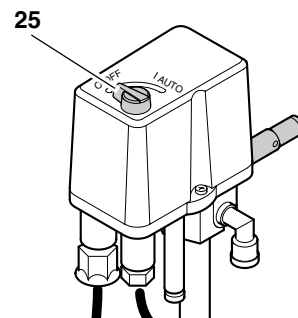

The tank pressure is indicated by the tank pressure gauge (26).

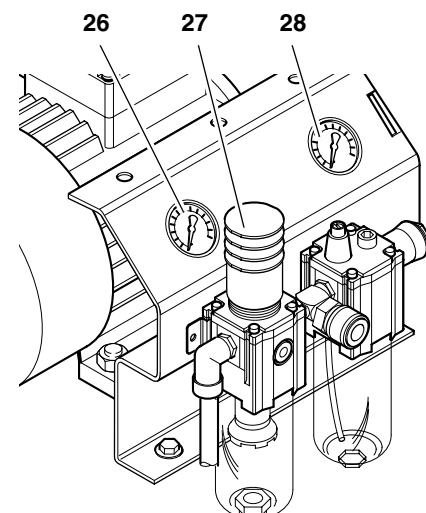

3. Set pressure regulator (27) to required working pressure. The current working pressure is indicated by the regulated pressure gauge (28).



Before connecting an air tool, make sure the max. operating pressure of the air tool used is not exceeded!

4. When using lubricated air adjust amount of oil to be added with the regulator knob (29).

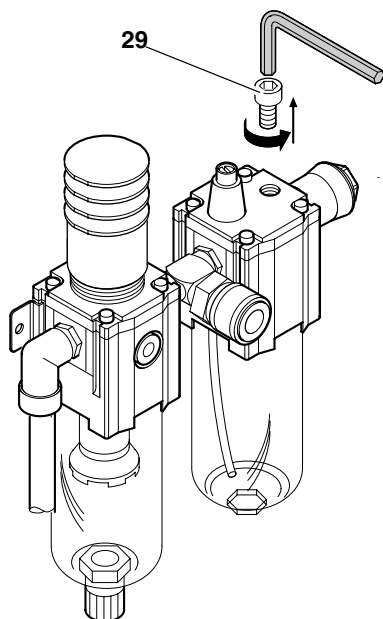

5. Connect air tool.
You are now ready to work with the air tool.
6. Switch the compressor OFF, if you do not continue working immediately afterwards. Unplug after switching OFF.

5. Care and Maintenance



Danger!

Prior to all servicing:

- Switch Off.
- Unplug.
- Wait until the compressor has come to a complete stop.
- Ensure the compressor and all air tools and accessories connected to it are relieved from pressure.

After all servicing:

- Check to see that all safety devices are operational.
- Make sure that no tools or other parts remain on or in the machine.

Repair and maintenance work other than described in this section must only be carried out by qualified specialists.

5.1 Periodic maintenance

Prior to each use

- Check oil level of lubricator (30), top up with pneumatic oil if necessary.

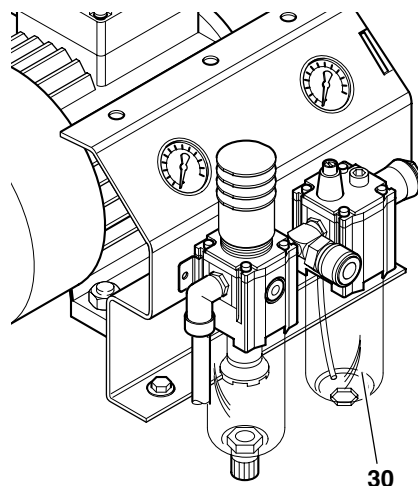

- Check air hoses for damage, replace if necessary.
- Check all screwed connections for tightness, tighten if necessary.
- Check power supply cable for damage, if necessary have replaced by a qualified electrician.

Every 50 operating hours

- Check air filter element (31) of compressor pump, clean if necessary.

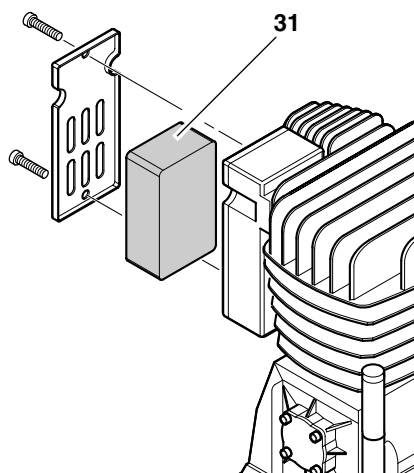

- Check oil level (32) of compressor pump, top up if necessary (33).

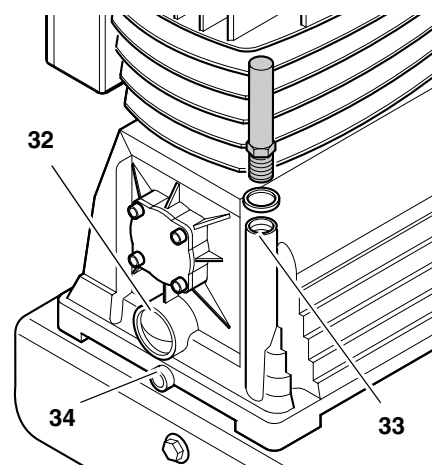

- Drain condensate from pressure vessel (35).

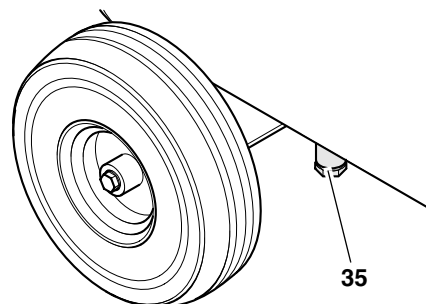

- Clean air filter element (36) of filter/regulator unit.

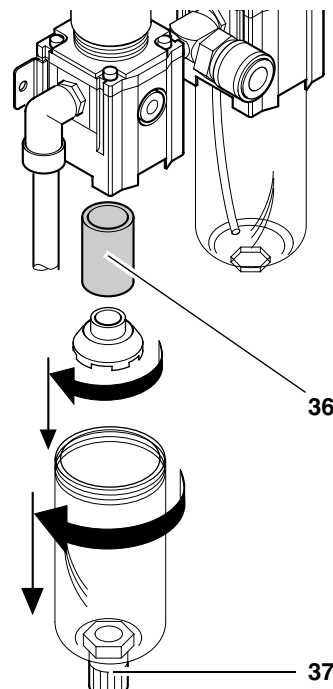

- Drain condensate from filter/regulator unit (37).
- Check V-belt:
 - Remove belt guard (38).
 - Retension V-belt or replace, if necessary.
 - To adjust the V-belt tension, loosen the four screws at the motor base and shift the motor.
 - Tighten the screws at the motor base again.
 - Replace the belt guard.

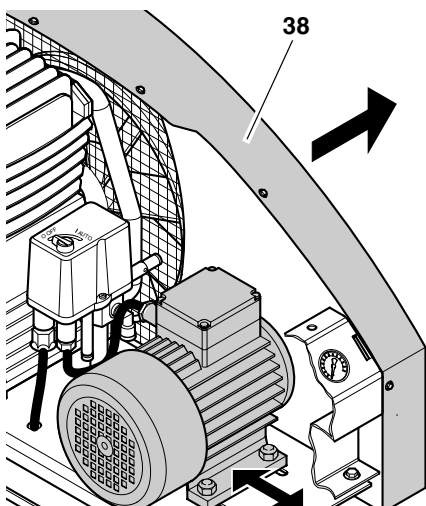

Every 250 operating hours

- Replace air intake filter element of compressor pump.
- Replace air filter element of filter/regulator unit.

Every 500 operating hours

- Drain oil from compressor pump through the drain plug (34) and fill with fresh oil.

 **Dispose of the waste oil environmentally safe by taking it to a proper collecting point!**

Every 1000 operating hours

- Have unit serviced by an authorized service station. This will extend the compressor's service life considerably.

5.2 Machine storage

1. Switch unit OFF and unplug.
2. Release pressure from tank and all connected air tools.
3. Store machine in such way that it cannot be started by unauthorized persons.

 **Caution!**
Do not store machine unprotected outdoors or in damp environment.

Do not lay machine on its side for transportation or storing.

6. Available Accessories

For special applications the following accessories are available at your specialist dealer – see back cover for illustrations:

Sealing

- A** Air Caulking Gun KP 910
for commercially available cartridges.
Stock-no. 090 101 0030

Sheet metal cutting

- B** Air Nibbler BN 540
extra small cutting radius; cuts steel sheet up to 1.0 mm thickness.
Stock-no. 090 100 6784

Drilling

- C** Air Drill BM 310
especially handy tool for low-fatigue working; right-hand rotation only.
Stock-no. 090 100 6725
- Air Drill BM 500 (not shown)
with 3/8" keyless chuck, fully reversible with quick reverse feature.
Stock-no. 090 105 4533

Stapling / nailing

- D** Combination Air Stapler/Nailer Kombi 40/50
for staples (type 90) from 20 mm to 40 mm and finishing nails (type SKN) from 20 mm to 50 mm.
Stock-no. 090 105 4720
- Combination Air Stapler/Nailer Kombi 32 (not illustrated)
for staples (type 90) from 15 mm to 32 mm and finishing nails (type SKN) from 16 mm to 32 mm.
Stock-no. 090 105 4711
 - Air Stapler KG 80/16 (not illustrated)
for staples (type 80) from 6 mm to 16 mm.
Stock-no. 090 105 4681
 - Air Stapler KG 90/25 (not illustrated)
for staples (type 90) from 15 mm to 25 mm.
Stock-no. 090 105 4690
 - Air Stapler KG 90/40 (not illustrated)
for staples (type 90) from 20 mm to 40 mm.
Stock-no. 090 105 4703
 - Air Finish Nailer SKN 50 (not illustrated)
for finishing nails (type SKN) from 20 mm to 50 mm.
Stock-no. 090 105 4738

Spray painting

- E** Spray Gun FB 2200 HVLP
High-volume low-pressure feature reduces paint mist bounce-back and provides thicker coating at less paint consumption.
Stock-no. 090 105 4460
- Paint Spray Gun FB 2200 (not illustrated)
with 0.5 l flow cup; professional spray gun; steplessly adjustable round, horizontal and vertical spray pattern.
Stock-no. 090 105 4452
 - Paint Spray Gun SB 200 (not illustrated)
with 1.0 l siphon cup.
Stock-no. 090 100 3882
 - Paint Spray Gun FB 150 (not illustrated)
with 0.5 l flow cup; for spraying primers and paints of varying viscosity.
Stock-no. 090 100 3874
 - Paint Spray Gun FB 90 (not illustrated)
with 0.75 l flow cup; for spraying primers and paints of varying viscosity.
Stock-no. 090 105 6064

Chiselling

- F** Air Hammer Set MHS 450
for construction and auto body work
Stock-no. 090 100 9210
- Air Hammer Set MHS 315 (not illustrated)
to take off plaster and tiles and for light chiselling work.
Stock-no. 090 100 6911

Tyre inflating / checking

- G** Tyre Inflator Gauge RF 480
professional version (calibrated).
Stock-no. 090 105 4630
- Tyre Inflator Gauge RF 363 (not illustrated)
same as RF 480, but not calibrated.
Stock-no. 090 105 4622
 - Tyre Inflator Gauge RF 200 (not illustrated)
for inflating tyres and balls (calibrated).
Stock-no. 090 105 6188
 - Tyre Inflator Gauge RF 100 (not illustrated)
same as RF 200, but not calibrated.
Stock-no. 090 102 6724

Cleaning

- H** Blow Gun BP 200
all plastic body.
Stock-no. 090 105 4606
- Blow Gun BP 300 (not illustrated)
all plastic body; venturi nozzle provides extra high air volume.
Stock-no. 090 105 4614
 - Blow Gun BP 70 (not illustrated)
light metal body (with 100 mm extension nozzle).
Stock-no. 090 102 6726
 - Blow Gun BP 60 (not illustrated)
light metal body (short).
Stock-no. 090 102 6718

Driving screws

- I** Impact Wrench SR 230
rugged impact wrench for DIY and automotive applications.
Stock-no. 090 105 6170
- Impact Wrench SR 340 Set (not illustrated)
professional version; many accessories included.
Stock-no. 090 105 6137
 - Impact Wrench SR 140 Set (not illustrated)
for multiple DIY and automotive applications; complete with many accessories.
Stock-no. 090 100 8582
 - Impact Wrench SR 120 Set (not illustrated)
requires only minimal amount of air, thus can be run on small compressors; complete with many accessories.
Stock-no. 090 100 6750

- Ratchet Wrench RS 320 (not illustrated)
due to narrow design and rubber-covered ratchet head it is well suited for automotive applications and work in confined areas.
Stock-no. 090 105 4541
- Ratchet Wrench RS 220 Set (not illustrated)
this set comes complete with many accessories.
Stock-no. 090 100 6717
- Air Screwdriver DS 1610 (not illustrated)
reversible with quick reversing action.
Stock-no. 090 101 2440

Spraying

- J** Spray Gun SPP 161
for spraying degreaser, oil, liquid wax, etc.
Stock-no. 090 105 4525
- Combination Spray Gun UBS 820 (not illustrated)
for commercially available 1.0 l screw-top cartridges.
Stock-no. 090 105 4479

Air hoses

- K** Hose Reel ST 200
swivels through 360°; with 30 m PU air hose.
Stock-no. 090 105 4568
- Braided Air Hose (not illustrated)
c/w quick coupler and male plug; length 5 m; outer diameter 12 mm; inner diameter 6 mm.
Stock-no. 090 105 4908
 - Braided Air Hose (not illustrated)
c/w quick coupler and male plug; length 10 m; outer diameter 12 mm; inner diameter 6 mm.
Stock-no. 090 105 4916
 - Braided Air Hose (not illustrated)
c/w quick coupler and male plug; length 10 m; outer diameter 15 mm; inner diameter 9 mm.
Stock-no. 090 105 4924
 - Bulk Braided Air Hose (not illustrated)
length 50 m; outer diameter 15 mm; inner diameter 9 mm.
Stock-no. 090 105 4932
 - Self-storing Coil Air Hose, Rilsan (not illustrated)
c/w quick coupler and male plug; 2.5 m working length; outer diameter 8 mm; inner diameter 6 mm.
Stock-no. 090 105 4940
 - Self-storing Coil Air Hose, Rilsan (not illustrated)
c/w quick coupler and male plug; 7.5 m working length; outer diameter 8 mm; inner diameter 6 mm.
Stock-no. 090 105 4959

- Self-storing Coil Air Hose, Rilsan (not illustrated)
c/w quick coupler and male plug; 10.0 m working length; outer diameter 10 mm; inner diameter 8 mm.
Stock-no. 090 105 4967
- Hand-crank Hose Reel SA 100 (not illustrated)
c/w 20.0 m braided air hose; outer diameter 15 mm; inner diameter 9 mm.
Stock-no. 090 105 4975
- Automatic Retractable Hose Reel SA 200 (not illustrated)
suitable for wall and ceiling mounting; retracts automatically by simply pulling on hose; with 8 m PU air hose; outer diameter 13 mm; inner diameter 8 mm.
Stock-no. 090 105 4550

Accessory kits

- L** Accessory Kit LPZ 7-S
comprising: Blow gun, tyre inflator gauge, tyre valve nozzle, needle tip nozzle, paint spray gun, spray gun, self-storing coil air hose.
Stock-no. 090 100 3858
- Accessory Kit LPZ 7-P (not illustrated)
comprising: Blow gun, tyre inflator gauge, tyre valve nozzle, needle tip nozzle, paint spray gun, spray gun, 10 m braided air hose.
Stock-no. 090 100 3890
 - Accessory Kit LPZ 6 (not illustrated)
comprising: Blow gun, tyre inflator gauge, tyre valve nozzle, needle tip nozzle, paint spray gun, 5 m braided air hose.
Stock-no. 090 104 4487
 - Accessory Kit LPZ 4 (not illustrated)
comprising: Blow gun, tyre inflator gauge, paint spray gun, self-storing coil air hose.
Stock-no. 090 101 3845
 - Accessory Kit LPZ 2 (not illustrated)
contains change handle with blow gun, tyre inflator gauge, paint spray gun, self-storing coil air hose.
Stock-no. 090 105 5971

7. Trouble Shooting

Danger!
Prior to all servicing:

- **Switch OFF.**
- **Unplug.**
- **Wait until the compressor has come to a complete stop.**
- **Ensure the compressor and all air tools and accessories connected to it are relieved from pressure.**

After all servicing:

- **Check to see that all safety devices are operational.**
- **Make sure that no tools or other parts remain on or in the machine.**

Compressor does not run:

- No mains voltage.
 - Check cables, plug, outlet and mains fuse.
- Mains voltage too low.
 - Use only extension cables with sufficient lead cross section (see "Technical Specifications"). Avoid using extension cable with cold machine.
- Compressor was stopped by unplugging.
 - Switch compressor OFF at the On/Off switch, then ON again.
- Motor has overheated, caused by insufficient cooling (cooling fins covered).
 - Remove cause for overheating and allow to cool down for approx. 10 minutes, then start again.

Compressor runs but does not build up sufficient pressure.

- Drain cock on cup of filter/regulator unit open.
 - Close drain cock.
- Check valve leaky.
 - Have check valve serviced by qualified service centre.

Air tool is not supplied with sufficient pressure.

- Pressure regulator not opened wide enough.
 - Open pressure regulator more.
- Hose connection between compressor and air tool leaky.
 - Check air hoses, replace defective parts if necessary.

8. Repairs

Danger!
Repairs to electric tools must be carried out by qualified electricians only!

Electric tools in need of repair can be sent to the service centre in your country. See spare parts list for address.

Please attach a description of the fault to the electric tool.

9. Environmental protection

The machine's packaging can be 100 % recycled.

Worn out machines and accessories contain considerable amounts of valua-

ble raw and plastic materials, which can be recycled.

These instructions are printed on chlorine-free bleached paper.

10. Technical Specifications

Suction capacity	l/min	600
Free air delivery (volume flow rate)	l/min	440
Filling rate	l/min	500
Working pressure (compression end pressure)	bar	10
Pressure vessel volume	l	90
No. of air outlets		3
Compressor pump type		B 5900 B
No. of cylinders		2
Speed (compressor pump)	min ⁻¹	1250
Motor capacity	kW	4.0
Supply voltage (50 Hz)	V	400
Rated current	A	7.9
Fuse protection min.	A	16 (time-lag)
Degree of protection		IP 54
Max. overall cable length when using extension cables: – at 3 x 1.5 mm ² lead cross section – at 3 x 2.5 mm ² lead cross section	m m	15 30
Oil grade (compressor pump)		SAE 40
Required oil quantity (compressor pump)	l	2.2
Dimensions length x width x height	cm	123 x 56 x 97
Weight	kg	114
Sound pressure level L _{PA} at 4 m max.	dB (A)	79 ± 3
Sound power level L _{WA}	dB (A)	99



A 090 101 0030



B 090 100 6784



C 090 100 6725



D 090 105 4720



E 090 105 4460



F 090 100 9210



G 090 105 4630



H 090 105 4606



I 090 105 6170



J 090 105 4525



K 090 105 4568



L 090 100 3858