



## Instruction manual for freestanding wine cabinet

Model code: WF332



Contact Caple on 0844 800 3830 or for spares [www.caple.co.uk](http://www.caple.co.uk)

**Thank you for purchasing this Caple Wine cabinet. Please read the instructions and warnings carefully before use to ensure safe and satisfactory operation of this product.**

**Important warnings and advice**

**For WF332**

- Unpack your wine cabinet carefully and remove all of the protective packing from inside and outside.
- Packing (plastic bags, polystyrene, nails, metal, etc.) are a source of danger. Keep out of the reach of young children..
- After unpacking, make sure that the appliance is in perfect order. If you have any doubt, do not use it and contact your retailer.
- Check that all the fittings are in the correct position on the inside of the cabinet.
- Release the mains lead which is fitted with a 13 amp UK type plug.
- Move your wine cabinet to its final location.
- **DO NOT MOVE YOUR CABINET WHILE LOADED WITH WINE** as this could distort the cabinet.
- Ensure that the specified ventilation instructions are adhered to.
- Do not try to modify the appliance's technical characteristics as this could be dangerous.
- This appliance should only be used for the specific purpose for which it was designed, i.e. storage of wine. It is not designed for food storage.
- Do not clean or maintain the appliance without disconnecting from the mains
- To prevent damaging the door gasket, make sure that the door is fully open when pulling shelves out.
- Ensure that you fully understand these instructions before operating this appliance.
- During the summer months, there may be a build up of moisture on the glass door which you can just wipe away

## Installation instructions

Before turning the wine cabinet on ensure that it is place on a solid surface and that the cabinet is perfectly level. This should minimise any vibrations during use.

Your cabinet is equipped with adjustable feet at the front use these feet to level the cabinet.

**Important: Allow the cabinet to stand upright for 12 hours before using for the first time.**

## Safety instructions

Clean the interior surface with lukewarm water using a soft cloth and dry thoroughly.

It must be installed away from any heat sources.

It must not be placed in direct sun light.

It must not be placed in a damp location (laundry, bathroom, etc.)

It must be perfectly level.

It must have a correctly installed and reliable electricity supply that is correctly earthed.

Use of a multi-socket or extension lead is not recommended

This wine cabinet must be earthed to provide protection in the event of an electrical short circuit.

Consult a qualified electrician or service engineer if the earthing instructions are not completely understood.

Warning! Incorrect earthing can result in the risk of electrical shock.

## Operating instructions

The wine cabinet should be placed where the ambient temperature is between 5-35 deg centigrade (41-95 degrees Fahrenheit). If the ambient temperature is above or below this range, the performance of the unit may be affected. For example, placing your unit in extreme cold or hot conditions may cause interior temperatures to fluctuate. The range of 5-18 °C may not be reached.

### Setting the temperature control

- When power is connected and wine cooler is working normally the LED on the circuit board will flash and the display will be show the set temperature in cabinet, the temperature range is 5-18 deg C.
- Adjusting the temperature. Press the temperature button, the temperature will increase or reduce by 1 deg C.
- The LED will flash when you set the temperature, when you stop setting , the LED will flash for 5 seconds and then show the set temperature
- Light control for your wine cooler. The light will turn on when the door is opened and the light will turn off when the door is closed.

### Door reversal

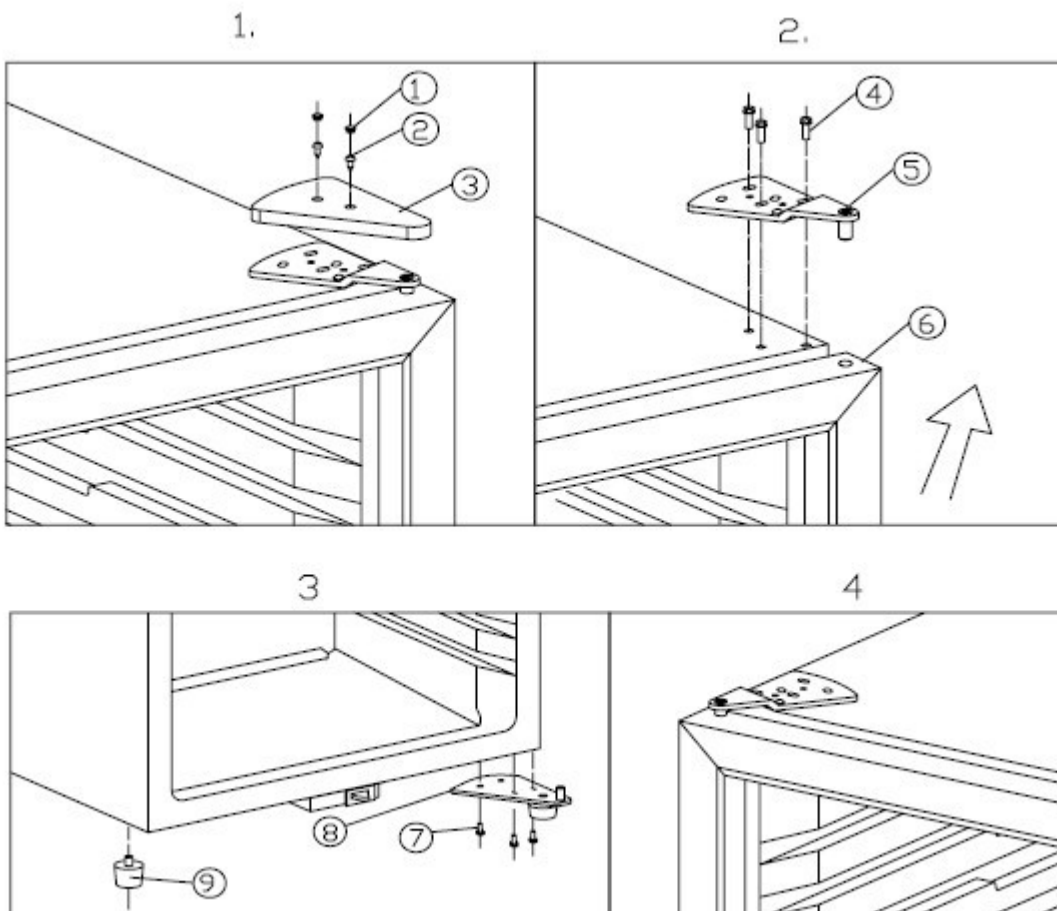

- ① Rubber cover                      ② Screw                              ③ Decorative cover
- ④&⑦ Screw                        ⑤ Top hinge module              ⑥ Door
- ⑧ Lower hinge module-Left      ⑨ Cabinet's leg-short

- Pull out the screw covers and unscrew the decorative cover. (Fig.1)
- While holding the door firmly, loosen and remove the top hinge, lift up and remove the door (See Fig.2)
- Unscrew the lower hinge (8)
- Remove the long cabinet leg (9) on the left side, and shift it to the right end side. (Fig.3)
- Install the lower hinge and tie it with the bolts
- Install the door on the axe of lower hinge (8) the same way it was removed, screw back the top hinge on the right
- Fix back the decorative cover and rubber cover.

### Storage of wine

The water reservoir should be positioned in the centre of the top rack in each compartment if used. To achieve maximum storage capacity, position the bottles alternately on the racks. (See below diagram)

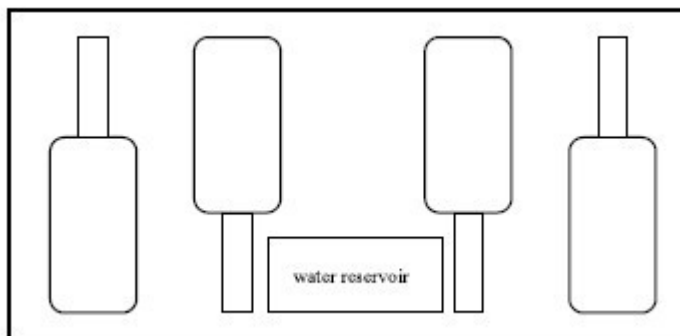

### Installation of shelves

- To prevent damaging the door gasket, make sure to have the door all the way opened when pulling shelves out of the rail compartment
- For easy access to the storage content, you must pull the shelves approximately 1/3 out of the rail compartment, however this unit was designed with a notch on each sides of the shelf tracks to prevent bottles from falling.

When removing any of these shelves out of the rail compartment. To fit or remove the shelf, tilt the shelf as per the diagram and simply pull out, or push in the shelf until it sits on the support brackets securely.

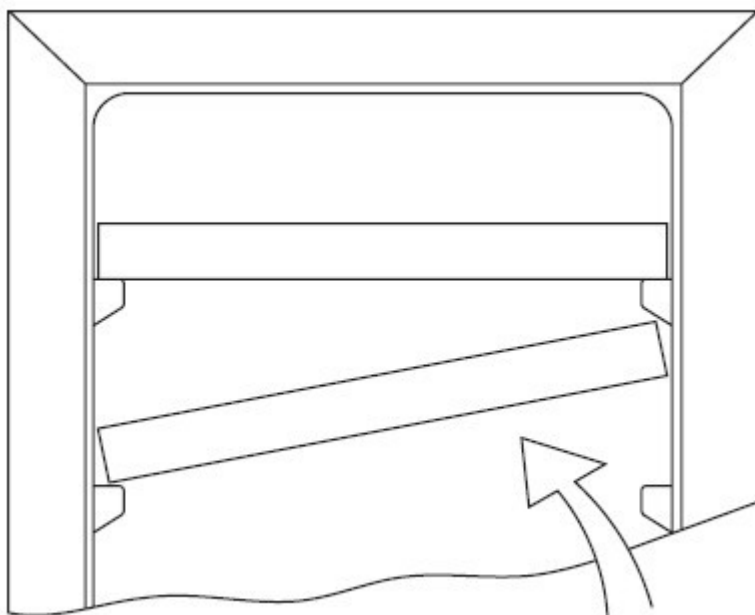

## Care and maintenance

### Cleaning

- Turn off the power, unplug the wine cabinet, and remove the bottles.
- Wash the inside with a warm water and baking soda solution. (The solution should be about 1 tablespoon of baking soda to a litre of water).
- Wash the shelves and trays with a mild detergent solution.
- The outside of the Wine Cabinet should be cleaned with mild detergent and warm water.
- It may also be necessary to periodically wipe the bottom part of the storage area as the wine cabinet is designed to retain humidity, and condensation may collect there.

### Power Failure

Most power failures are corrected within a few hours and should not affect the temperature of your appliance if you minimise the number of times the door is opened. If the power is going to be off for a longer period of time, you need to take action to protect the contents.

### Holidays

- **Short holidays:** Leave the wine cabinet operating during vacations of less than three weeks.
- **Long holidays:** If the wine cabinet will not be used for several months, remove all bottles and disconnect. Clean and dry the interior thoroughly. To prevent odour and mould growth, leave the door open slightly (blocking it open if necessary).

**Moving Your Wine Cabinet**

- Remove all bottles.
- Securely tape down all shelves inside the cabinet.
- Wind the levelling screws up to the base to avoid damage
- Tape the door shut.
- Be sure the Wine cabinet stays secure and upright during transportation. Also be sure to protect the outer casing of the wine cabinet whilst in transit. (e.g. with a blanket).

**Energy Saving Tips**

- The wine cabinet should be located in the coolest area of a room, away from heat producing appliances, and out of the direct sunlight.

## Troubleshooting

Try the suggestions below to see if you can solve the problem before calling the service engineer.

<b>PROBLEM</b>	<b>POSSIBLE CAUSE</b>
The wine cabinet does not operate.	The appliance is not plugged in. The appliance is turned off. The circuit breaker has tripped or a fuse has blown.
The wine cabinet is not cold enough.	Check the temperature control setting. During hot weather a higher setting is needed. The door has been opened too often. The door is not closed completely. The door gasket does not seal properly. There is insufficient empty space around the cabinet.
The wine cabinet turns on and off frequently.	The room temperature is hotter than normal. A large amount of un-cooled wine has been added. The door has been opened too often. The door is not closed completely. The temperature control is not set correctly. The door gasket does not seal properly. There is insufficient empty space around the cabinet
The wine cabinet vibrates.	Check that the wine cabinet is level.
The wine cabinet seems to make too much noise.	The slight rattling noise may come from the flow of refrigerant, which is normal. As each cycle ends, you may hear gurgling sounds caused by the flow of refrigerant. Contraction and expansion of the inside walls may cause popping and crackling noises. The wine cabinet is not level.
The door will not close properly.	The wine cabinet is not level. The door was reversed and not properly installed. The gasket is dirty. The shelves are out of position.
For technical advice or product service please call the Caple helpline on:	
<b>0844 800 3830</b>	



## **DEFROSTING/CONDENSATION**

Your wine cellar is designed with an “Auto-cycle” defrost system. When the RUN cycle is OFF, the refrigerated surface of the wine cellar (interior rear wall) defrosts automatically. The defrost water is channelled into a drain pan which is located at the back of the wine cellar next to the compressor from where it evaporates.

## **HUMIDITY MAINTENANCE SYSTEM**

The wine cellar is equipped with a system for maintaining the correct level of humidity. If humidity is too low, insert the small plastic reservoir on to the top shelf. Fill this reservoir 3/4 full with water. Check the water level occasionally and refill as necessary.

## **RECOMMENDED TEMPERATURE SETTINGS**

For storing ALL TYPES OF WINES 12 °c to 14 °c

## **RECOMMENDED DRINKING TEMPERATURE**

Champagne NV, Sparkling	6 °c
Champagne Vintage	10 °c
Dry White Semillon, Sauvignon Blanc	8 °c
Dry White Gewürztraminer, Riesling	10 °c
Dry White Chardonnay	10 °c
Vintage chardonnay	14 °c
Sweet White Sauternes Monbazillac, Late Harvest ice wine	10 °c
Sweet whites vintage Sauternes	14 °c
Beaujolais	13 °c
Red Pinot Noir	16 °c
Vintage Pinot Noir red	18 °c
Red Cabernet, Merlot, French, Australian, New Zealand, Chilean, Argentinean, Italian, Spanish, Californian	18 °c
Red Grenache, Syrah	16 °c