

GB User Instructions

CDE105
Reverse Action

CANDY

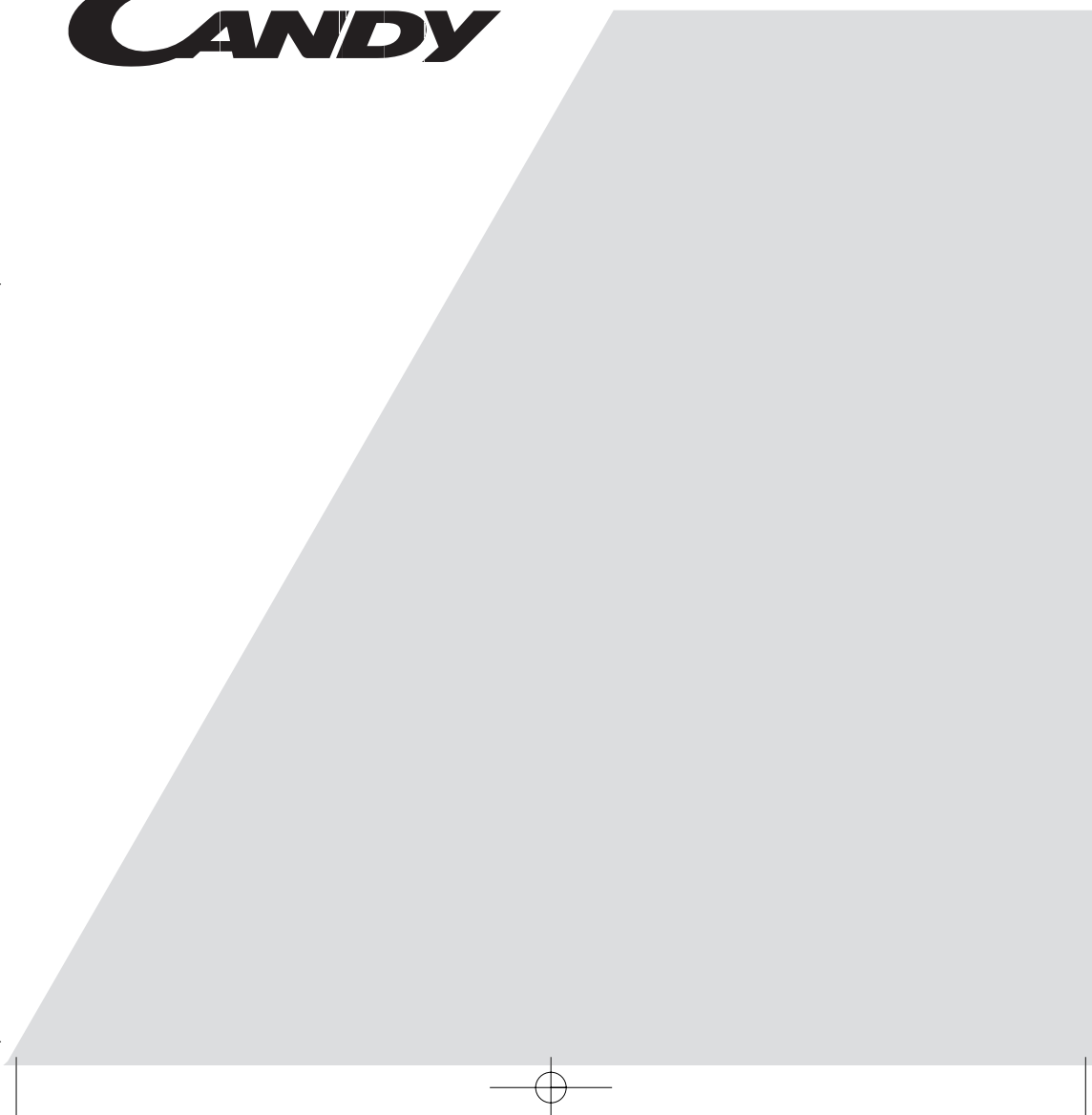

Safety reminders

WARNING Check that the product has no visible signs of damage before use. If damaged do not use and please call our national number: 08705 400 600.

WARNING Do not use the product if the fluff filter is not in position or is damaged; fluff could be ignited.

WARNING Foam rubber materials can, under certain circumstances, when heated become ignited by spontaneous combustion. Foam plastic, foam rubber and rubber-like material are not suitable for tumble drying. Articles made from these materials **MUST NOT** be placed in the dryer.

Always refer to the laundry care labels for directions on suitability for drying.

WARNING Misuse of a tumble dryer may create a fire hazard.

WARNING Where the hot surface symbol  is located the temperature rise during operation of the tumble dryer may be in excess of 60 degrees C.

User's manual. This machine should only be used for its intended purpose as described in this manual. Ensure that it is fully understood before operating.

Installation. This machine should not be installed in a bathroom or shower room.

Never install the dryer against curtains and be sure to prevent items from falling or collecting behind the dryer.

Ventilation. Adequate ventilation must be provided in the room where the tumble dryer is located to prevent gases from appliances burning other fuels, including open fires, being drawn into the room during operation of the tumble dryer.

Exhaust air must not be discharged into a flue which is used for exhausting fumes from appliances burning gas or other fuels.

Check regularly that the air flowing through the dryer is not restricted.

Check the fluff filter after use, and clean, if necessary.

The venting hose or duct should be checked periodically and any accumulation of fluff removed.

The inlet and outlets should be kept free from obstructions.

If the dryer is used frequently the period between checks should be reduced accordingly.

Dryness. Clothes should be spin dried or thoroughly wrung before they are put into the tumble dryer. Clothes that are dripping wet should **NOT** be put into the dryer.

Lighters and matches must not be left in pockets and **NEVER** use flammable liquids near the machine.

Glass fibre curtains should never be put in this machine. Skin irritation may occur if other garments are contaminated with the glass fibres.

Garments treated or contaminated with flammable cleaning sprays or liquids such as petrol, cooking oil or aerosol sprays must not be put in this machine.

Lint or fluff must not be allowed to collect on the floor around the outside of the machine.

Cool down period. The drum inside may be very hot. Always allow the dryer to complete the cool down period before removing the laundry.

Faults. Do not continue to use this machine if it appears to be faulty.

After use. Remove the plug from the electricity supply. Always remove the plug before cleaning the appliance.

Supply cord. If the supply cord on this appliance is damaged, it must be replaced by a special cord which is only available from GIAS Service or an authorised Hoover Dealer.

GIAS Service. To ensure the continued safe and efficient operation of this appliance we recommend that any servicing or repairs are only carried out by an authorised GIAS service engineer.

Installation

Before using the tumble dryer for the first time:

- please read this instruction book thoroughly.
- remove all items packed inside drum.
- wipe the inside of the drum and door with a damp cloth to remove any dust which may have settled in transit.

IMPORTANT: This dryer must only be used for drying household textiles and garments where a water solution has been used for the cleaning process.

DO NOT tumble dry fabrics treated with dry cleaning fluids.

Electrical requirements

**WARNING!
ELECTRICITY CAN BE
EXTREMELY DANGEROUS.
THIS APPLIANCE MUST BE
EARTHED.**

This appliance is fitted with a moulded-on non-rewireable plug (in the UK fitted with a 13 Amp fuse).

The plug should be accessible for disconnection after the appliance has been installed.

IMPORTANT: The wires in the mains lead are coloured in accordance with the following code:

Blue	-	NEUTRAL
Brown	-	LIVE
Green-and-yellow	-	EARTH

If the supply cord on this appliance is damaged, it must be replaced by a special cord which is only available from GIAS Service or an authorised Hoover Dealer.

Installation

Preparing the load

Installation requirements

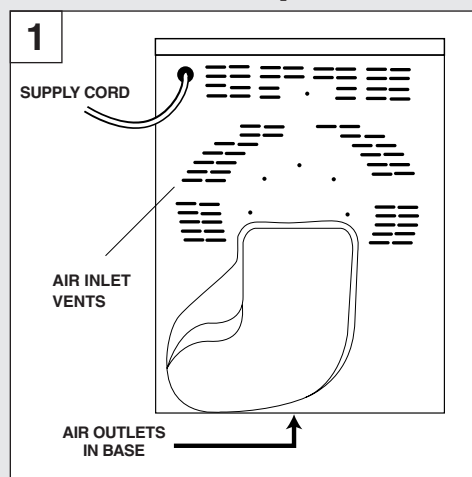

IMPORTANT: This dryer must be installed such that the air inlets and outlets are not restricted (fig. 1).

There should be a gap of at least 12mm (0.5 inches) between the sides rear and base of the machine and the surrounding walls, cabinets and floor.

To ensure adequate ventilation the space between the bottom of the machine and the floor must not be obstructed.

NEVER install the dryer up against curtains.

Prevent items from falling or collecting behind and beneath the dryer as these may obstruct the air inlets and outlets.

Preparing the load

Before using the dryer for the first time wipe the inside of the drum and door with a damp cloth.

Make sure that the laundry you are going to dry is suitable for drying in a tumble dryer, as shown by the care symbols on each item.

Clothes preparation

Check that all fastenings are closed and that pockets are empty. Turn the articles inside out. Place clothes loosely in the drum to make sure that they don't get tangled.

Warning:

Do not overload the drum, large items when wet can exceed the maximum admissible clothes load (for example: sleeping bags, duvets).

Maximum drying weight

- Cottons Max. 5 kg
- Synthetics Max. 2.5 kg

Sort the load as follows:

A) By care symbols

On the collar or inside seam:

- Suitable for tumble drying.
- Tumble drying at high temperature.
- Tumble drying at low temperature only.
- Do not tumble dry.

B) By amount and thickness

Whenever the load is bigger than the dryer capacity, separate clothes according to thickness (e.g. towels from thin underwear).

C) By type of fabric

Cottons/linen: Towels, cotton jersey, bed and table linen.

Preparing the load

Door

Synthetics: Blouses, shirts, overalls, etc. made of polyester or polyamid, as well as for cotton/synthetic mixes.

D) By drying level

- Sort into: iron dry, cupboard dry, etc.
- For delicate articles press the 'HEAT SETTING' button to select low drying temperature.
- For airing or drying very delicate articles select the REFRESH option on the 'drying time' dial (☼).

Do not tumble dry:

Woollens, silk, delicate fabrics, nylon stockings, delicate embroidery, fabrics with metallic decorations, garments with PVC or leather trimmings, training shoes, bulky items such as sleeping bags, etc.

IMPORTANT: Do not dry articles which have been treated with a dry cleaning fluid or rubber clothes (danger of fire or explosion).

Energy saving

Only put into the tumble dryer laundry which has been thoroughly wrung or spin-dried. The drier the laundry the shorter the drying time thus saving electricity.

ALWAYS try to dry the maximum weight of laundry, this will save time and electricity.

NEVER exceed the maximum weight, this will waste time and electricity.

ALWAYS check that the filter is clean before every drying cycle as this aids efficiency.

NEVER put dripping wet items into the tumble dryer, this may damage the appliance and waste time and efficiency.

Opening the door

Pull on handle to open door (fig. 2).

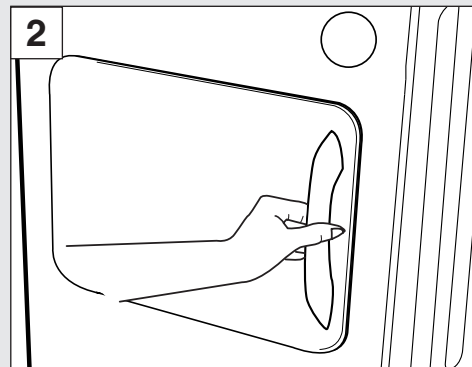

To restart the dryer, close the door and press the 'START/PAUSE' button.

WARNING!
WHEN THE TUMBLE DRYER IS
IN USE THE DRUM AND DOOR
MAY BE VERY HOT.

Filter

Filter

IMPORTANT: To maintain the efficiency of the dryer check that the fluff filter is clean before each drying cycle.

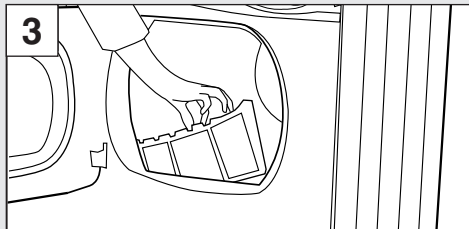

1. Pull the filter upwards (fig. 3).
2. Open filter as shown (fig. 4).

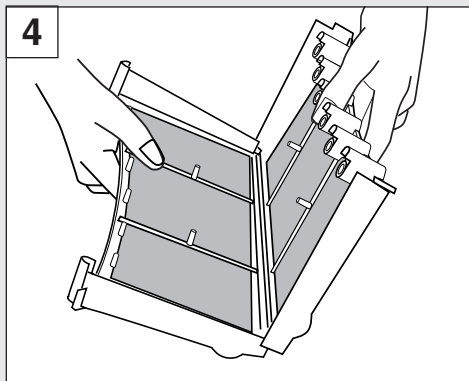

3. Gently remove lint using a soft brush or your fingertips.
4. Snap the filter together and push back into place.

Filter Care Indicator

Lights when the filter needs cleaning.
If the laundry is not drying check that the filter is not clogged.

Water container

Water Container

The water removed from the laundry during the drying cycle is collected in a container at the bottom of the dryer.

When the container is full the 'EMPTY WATER' indicator on the control panel will light, and the container **MUST** be emptied. However, we recommend that the container is emptied after each drying cycle.

Note: Very little water will collect during the first few cycle of a new machine as an internal reservoir is filled first.

To remove the container:

1. Gently pull the bottom of the kickplate so that it unclips from the dryer. The top section can then be unhinged allowing the kickplate to be completely removed (fig. 5).

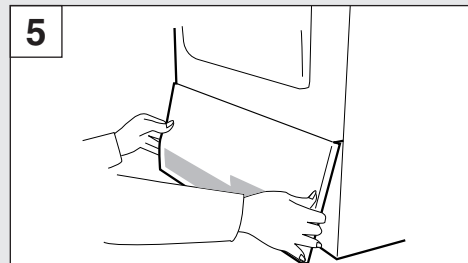

2. Pull firmly on the handgrip and slide the water container out of the dryer (fig. 6).

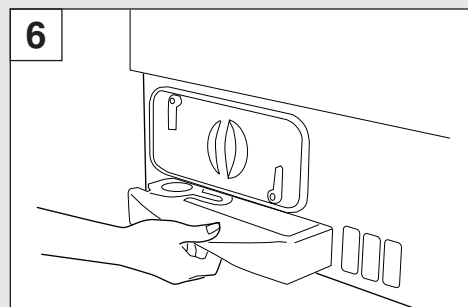

Condenser

- Support the container with both hands. When full, the water container will weigh about 4kg (fig. 7).

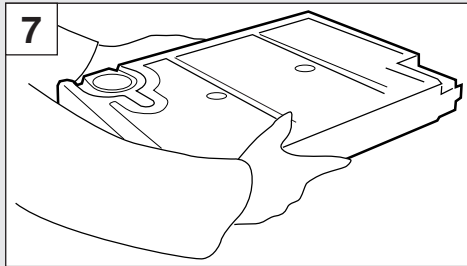

- Open the lid located on the top of the container and empty the water (fig. 8).

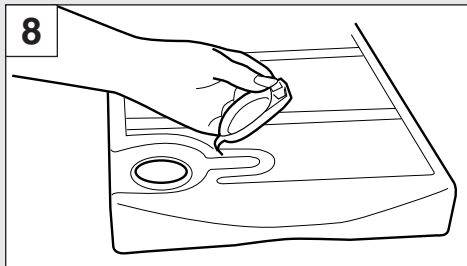

- Refit the lid and slide the water container back into position. **PUSH FIRMLY INTO PLACE.**
- Refit the kickplate by engaging the hinges at the top and 'snapping' the lower clips into place.

Condenser

IMPORTANT: Always switch off and remove the plug from the electricity supply before cleaning the condenser.

To maintain the efficiency of the dryer regularly check that the condenser is clean.

To remove the condenser:

- Remove the kickplate (fig. 5).

- Turn the two locking levers anti-clockwise (fig. 9).

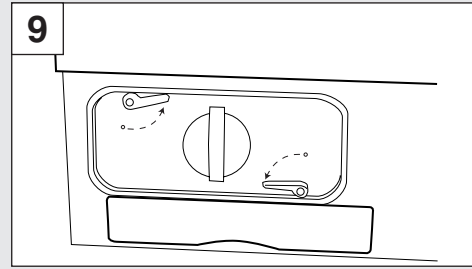

- Pull out the condenser unit (fig. 10).

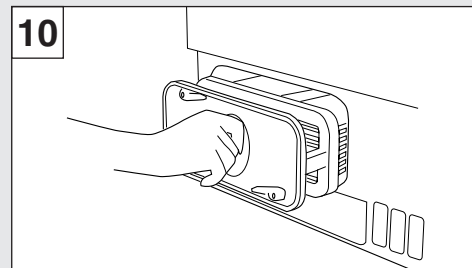

- Gently remove any dust or fluff with a cloth, then wash the unit by holding it under a running tap (fig. 11) turning it so that water flows between the plates, to remove any dust or fluff.

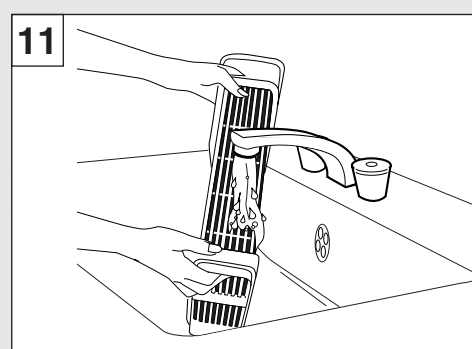

- Refit the condenser ensuring it is pushed firmly into place. Lock the two levers by turning them clockwise.
- Refit the kickplate.

Drying guide

Controls and indicators

Drying guide

The table shows approximate drying times, depending on the type of fabric and dampness of the clothes.

	HEAT SETTING	HEAVY LOAD	MEDIUM LOAD	LIGHT LOAD
COTTON	☐ HIGH	100-130 min	65-75 min	50-60 min
SYNTHETICS	☐ LOW	–	60-70 min	40-50 min
ACRYLIC	☐ LOW	–	40-55 min	30-40 min

 FAST IRON PROGRAMME: RELAXES CREASES - EASIER TO IRON

REMEMBER: During the last 15 minutes the load is always tumbled in cool air.

Programme	Drying Guide
1	Bone Dry
2	Extra Dry
3	Cupboard Dry
4	Iron Dry
5	Medium Dry
6	Damp Dry

For delicate fabrics select LOW HEAT button for all Drying Programmes. This reduces the drying temperature to protect your garments.

Operation

Control panel and indicator lights

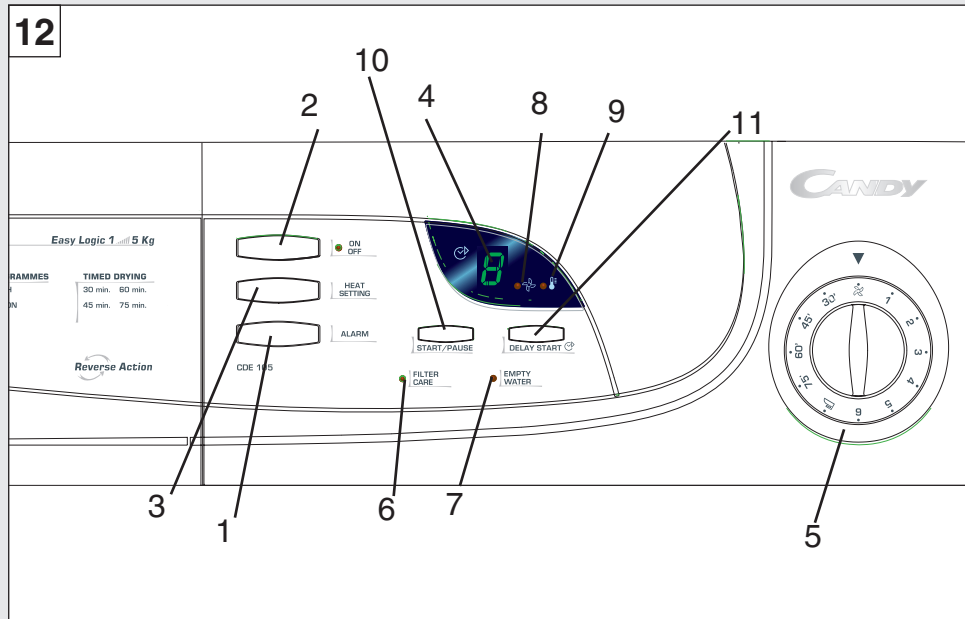

1. **'ALARM'** button – press to switch off buzzer.
2. **'ON/OFF'** button and indicator – press to switch on, the indicator will light.
3. **'HEAT SETTING'** button – press to reduce the heat level for delicate items, press again to select high temperature.
 - ▮ HIGH Heat setting
 - ▮ LOW Heat setting
4. **'DIGITAL DISPLAY'** – shows the number of hours remaining when **'DELAY START'** is selected.
5. **'PROGRAM'** dial – selects drying time program.
6. **'FILTER CARE'** indicator – lights when filter needs cleaning.
7. **'EMPTY WATER'** indicator – lights when water container is full.
8. **'COOLING INDICATOR'** – lights when the drying cycle is in the cooldown period.
9. **'HEATING'** indicator – lights when the drying cycle is in the heating period.
10. **'START/PAUSE'** button – press to start the drying cycle.
11. **'DELAY START'** button – press to delay the start of the drying cycle by up to 9 hours.

Operation

Operation

1. Open the door and load the drum with laundry. Ensure that garments do not hinder closure of the door.
2. Gently close the door pushing it slowly until you hear the door 'click' shut.
3. Press the 'ON/OFF' button to switch on the dryer. The indicator will light.
4. Turn the 'PROGRAM' dial to select the required drying program:

e.g. if you are drying cotton laundry and would like it suitable for ironing please select the iron dry option.

The FAST IRON setting shown by the symbol  on the 'PROGRAM' dial provides a conditioning and anti-crease function. The dryer will heat the load for 9 minutes followed by a 3 minute cool down period and is especially good for garments which may have been left for some time prior to ironing, in a linen basket for example. Garments may also become stiffened when dried outside on a washing line or inside on radiators. The FAST IRON process relaxes the creases in the fabric making ironing quicker and easier.

5. If drying delicate items on the 'timed' programs press the 'HEAT SETTING' button to reduce the heat level. Press again on completion, to select high temperature.

 HIGH Heat setting

 LOW Heat setting

If airing or drying very delicate items select the REFRESH option on the 'drying time' dial .

6. Press the 'START/PAUSE' button. The dryer will start automatically and the 'HEATING' indicator will light.

Drying sensor

A sensor will detect when the load is dry. The drying cycle will then go into the cooldown period and the 'COOLING' indicator will light.

After 10 minutes of cooldown the drum will stop rotating automatically.

Note:

(i) The sensor may not detect a small load of small articles. For small loads and separate items or pre-dried fabrics with low moisture content, utilise the timed programmes. Set the programme between 30 and 75 minutes depending upon the load size and dryness required and select high or low heat depending upon the fabric type. If this is not carried out the dryer will only operate for 10 minutes before going into cooldown.

(ii) If the sensor does not operate, for example when a load is too large or too wet to tumble dry, the dryer will automatically go into cooldown after 180 minutes.

The dryer can be set to start up to 9 hours after the program has been set.

To set the time delay option press and release the 'DELAY START' button until the required delay (shown in hours) appears on the display and then press the 'START/PAUSE' button. The display will flash.

As each hour passes the figure shown on the display will count down. When it gets to 0 the dryer will start.

Operation

The delay can be changed at any time simply by pressing the button until the new figure appears on the display.

If there is an interruption to the electricity supply the time delay will be lost and so will have to be re-set when the power is restored.

7. To switch off the buzzer, which sounds at the end of each cycle, press the 'ALARM' button.
8. The load is dried by tumbling in thermostatically controlled warm air. Cool air is used for the last 10 minutes to reduce creasing and cool the load ready for handling. During this time the 'COOLING' indicator is lit.
9. When the program is fully completed the drum will stop rotating. The dial remains at the position of the selected program. The 'COOLING' indicator will flash and the buzzer will sound.
10. Open the door and remove the load.

WARNING!
THE DRUM, DOOR AND LOAD
MAY BE VERY HOT.

If the load is not removed from the dryer at the end of the drying cycle, a 'creaseguard' function is activated.

Every 15 minutes the dryer will tumble the load for 5 seconds and the buzzer will sound.

This process will be repeated until the 'creaseguard' function is cancelled by opening the door.

11. Clean the filter and empty the water container after every drying cycle to ensure maximum dryer efficiency. (See 'Filter' and 'Water Container' sections.)
12. Clean the condenser after approximately every 10 drying cycles to ensure maximum dryer efficiency. (See 'Condenser' section.)

Technical specifications

Cleaning the dryer

IMPORTANT: Always switch off and remove the plug from the electricity supply before cleaning this appliance.

Clean the filter and empty the water container after every drying cycle.

Regularly clean the condenser.

After each period of use, wipe the inside of the drum and leave the door open for a while to allow circulation of air to dry it.

Wipe the outside of the machine and the door with a soft cloth.

DO NOT use abrasive pads or cleaning agents.

To prevent the door sticking, periodically clean the door gasket with a 'non-scratch cream cleaner'.

Over a period of time deposits from the water may form over the sensor plate (found inside the drum below the door opening). This sensor plate can be cleaned with a soft cloth and a dilute vinegar solution. Ensure that any excess is removed or the vinegar may stain clothing.

Technical specifications

Drum capacity	115 litres
Maximum load	5 kg
Height	85cm
Width	60cm
Depth	60cm
Energy Label Band	C

Note: For electrical data refer to the rating label on the front of the dryer cabinet (with the door open).

Trouble shooting

Trouble shooting

Should your dryer operate incorrectly, check the following points before calling for a service engineer.

Drying time is too long/clothes are not dry enough:

- Have you selected the correct drying time/programme? Go to page 8.
- Were the clothes too wet? Were the clothes thoroughly wrung or spin-dried?
- Does the filter need cleaning? Go to page 6.
- Does the condenser need cleaning? Go to page 7.
- Is the dryer overloaded? Go to page 4.
- Are the inlets, outlets and base of the dryer free from obstructions?
- Is the load too small? Go to page 10.
- Has the 'HEAT SETTING' button been selected from a previous cycle? Go to page 9.
- Is the sensor system clean? Deposits from the water may form over the sensor plate. Go to page 12 "Cleaning the dryer".

The dryer does not operate:

- Is there a working electricity supply to the dryer? Check using another appliance such as a table lamp.
- Is the plug properly connected to the mains supply?
- Is there a power failure?
- Has the fuse blown?
- Is the door fully closed? Go to page 10.
- Is the dryer switched on, both at the mains supply and at the machine? Go to page 9.

- Has the drying time or the programme been selected? Go to page 9.
- Has the machine been switched on again after opening the door? Go to page 5.
- Has the 'DELAY START' option been set and is there still time remaining? Go to page 10.
- Has the dryer stopped operating because the water tray is full and needs emptying? Go to page 6.
- Have you pressed the 'START/PAUSE' button to begin the program? Go to page 10.

Filter Care Indicator on

- Does the filter need cleaning? Go to page 6.
- Does the condenser need cleaning? Go to page 7.

Empty Water Indicator on

- Does the water container need emptying? Go to page 6.

If the supply cord on this appliance is damaged, it must be replaced by a special cord which is only available from GIAS Service or an authorised Hoover Dealer.

Should there still be a problem with your dryer after completing all the recommended checks, please call the national GIAS Service number 08705 400 600 (Eire - 018301 666) for advice. They may be able to assist you over the telephone or arrange for a suitable appointment for an engineer to call under the terms of your guarantee. However, a charge may be made if any of the following applies to your machine:

- Is found to be in working order.
- Has not been installed in accordance with the installation instructions.
- Has been used incorrectly.

Guarantee

HOOVER Spares

Always use genuine Hoover spares, available direct from GIAS Service on 01204 556111.

GIAS Service

For service and repairs call your local engineer on our national number 08705 400 600 (Eire-018301 666).

Hoovercare

To maintain your HOOVER product in peak condition you may also wish to take out a Hoovercare policy, which for an annual payment provides a comprehensive maintenance and repair scheme.

Not available in Eire.

Hoover Spares – 01204 556111
GIAS Service
Repairs and
General
Enquiries – 08705 400 600
(Eire 018301 666)

YOUR GUARANTEE

Hoover guarantees all parts of this product for 5 years from the date of purchase. During that time HOOVER engineers will replace or repair all defective parts free of charge, except for parts subject to fair wear and tear such as belts.

The engineers call out fee and labour costs are chargeable after the first 12 months.

To qualify for benefits under the guarantee, you must be resident in the UK or Eire and be able to provide proof of date of purchase and the appliance must have been installed and used in accordance with Hoover instructions. Consequential losses and accidental damage to the product are not covered by the guarantee.

If you have any trouble with your HOOVER product simply telephone the national GIAS Service number.

This guarantee does not affect your statutory or common law rights.

Hoover cannot be responsible for the results of using this machine for any purposes other than those described in these instructions.

HOOVER LIMITED PENTREBACH MERTHYR TYDFIL MID-GLAMORGAN CF48 4TU

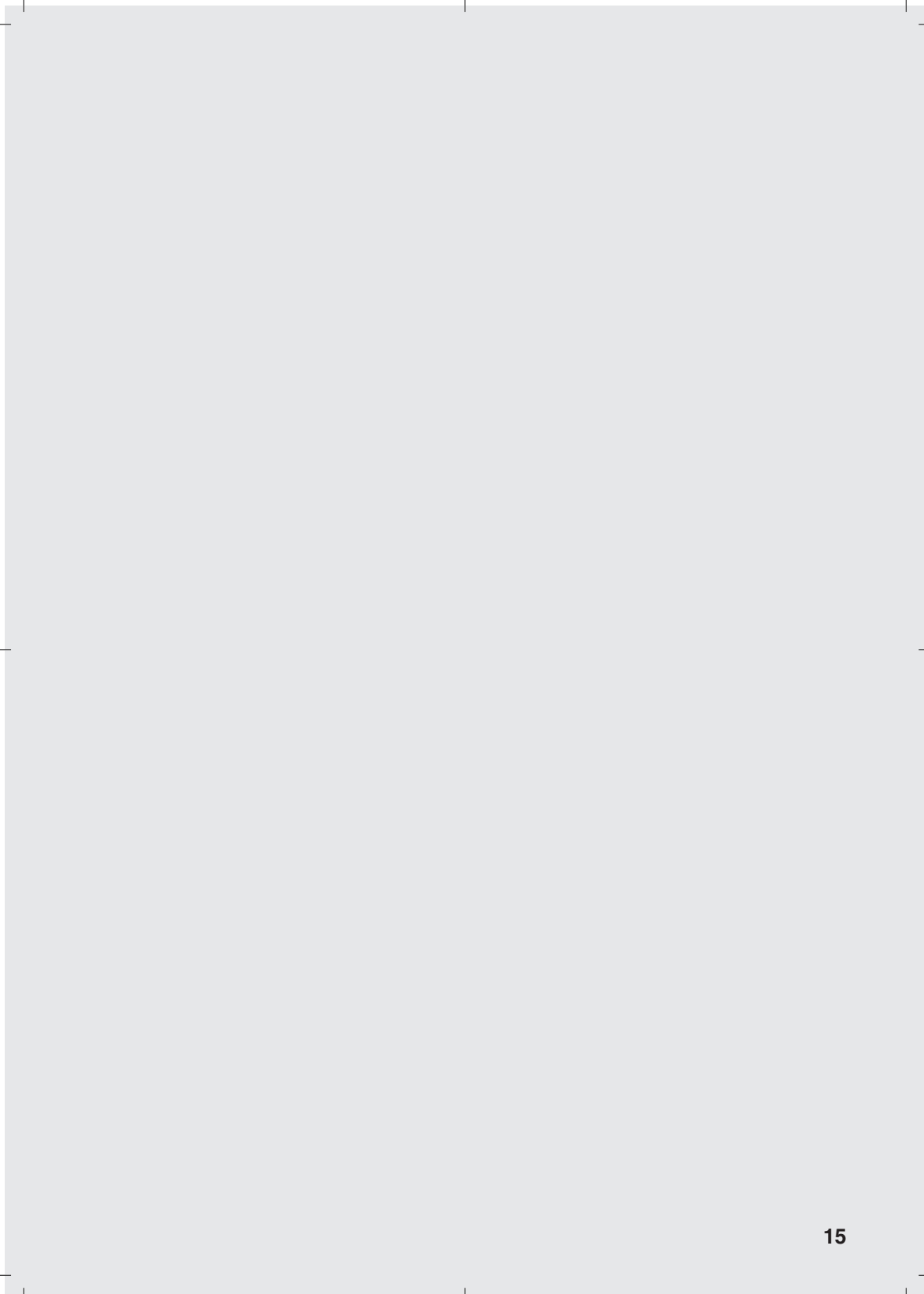

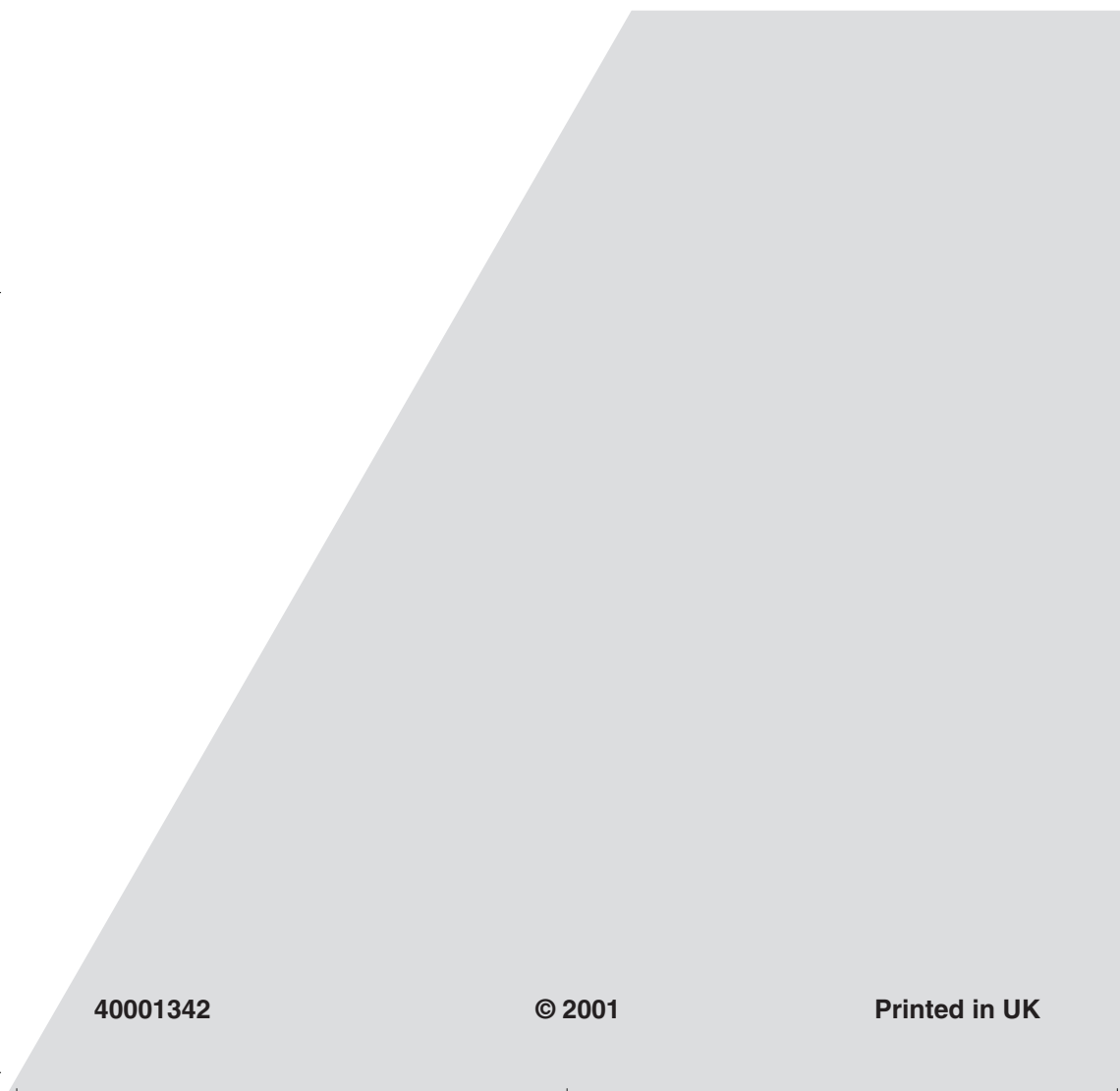
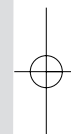
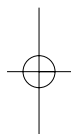

40001342

© 2001

Printed in UK

