

BURY Motion



Index

Introductory information	2
1. General	2
2. Security guidelines	2
Installation of the hands-free car kit	4
3. Scope of supply	4
4. Positioning and mounting	6
5. Installing the BURY Motion in your vehicle	7
6. Inserting and removing the iPhone	9
Operating guidelines	11
7. Turning the cradle	11
8. Using the hands-free car kit for the first time	11
9. Establishing a <i>Bluetooth</i> connection	12
10. Accepting, making, ending calls	13
11. Playing back music from your iPhone	14
12. Charging your iPhone	14
Further information	15
13. Service	15
14. Appropriate use of this system	16
15. Approvals and declaration of conformity	16

1. General

Dear customer,

Congratulations on purchasing a BURY hands-free car kit. You have chosen a high quality product that is extremely easy to use.

Please read the operating manual carefully so that you can fully enjoy your BURY hands-free car kit. If you have any further questions concerning installation or operation of your car kit, please contact your dealer. He will be happy to give you reliable advice.

You can also contact our hotline. Our phone and fax numbers are listed in the chapter Service at the end of the operating instructions.

Have a good trip!

2. Security guidelines

Installation - who and where

The installation of this system can be carried out by yourself but please observe the installation requirements of the automotive manufacturer (VAS 1978). During the installation, park the car at a place where the road traffic is not impaired.



Power supply

This system has been designed for the use in vehicles with an on-board supply system of 12 volts (passenger car). If you intend to install the device in a vehicle with an on-board supply system of 24 volts (lorry), please use a voltage converter. If you have queries regarding this subject, please contact our hotline.



Position, volume

Install the components of the device in the vehicle so that your field of vision is not impaired and the components are not mounted in the impact zone of the passenger compartment or in the airbag inflation zones.

Intended use

We shall not be liable for damages or malfunctions due to improper use of the hands-free system. Therefore, do not expose the device to moisture, extreme temperatures or shocks and carefully follow the procedure described in the installation and operating guidelines.



Use while driving

Operate the system only when the situation allows it and when you do not endanger, harm, constrain, or annoy other road users. The volume of the device has to be set in a way that exterior noise is still audible.

Faults

Do not commission the device if you detect or assume a defect. In this case, contact a Bury specialised dealer or our hotline. Improper repair efforts can be dangerous for you. Therefore, only skilled personnel may perform inspections.

Using the power supply cable with the cigarette lighter plug

Please only use this cable in connection with the BURY Motion. Do not charge up a mobile phone or laptop using the cable. The cable is not suitable for use in HGVs. The voltage output that is emitted on the mini USB plug totals 12 volts.

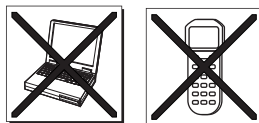

Important:

- ▶ The driver is ultimately responsible for the safe operation and control of their vehicle at all times. You should never use a hand held phone, including sending or reading text or picture messages, while driving.
- ▶ Research indicates that there is a risk to safety when the driver of a motor vehicle is distracted and using a mobile phone while driving can be a distraction.
- ▶ The manufacturer strongly recommends that you use a hands-free solution when driving.

3. Scope of supply

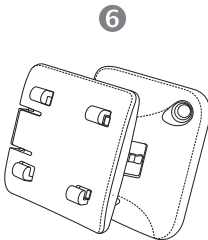
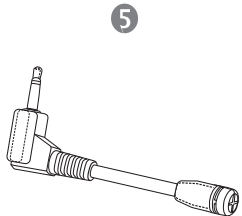
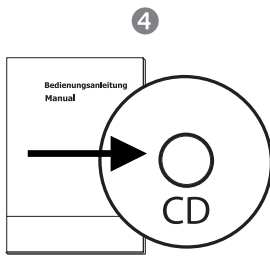
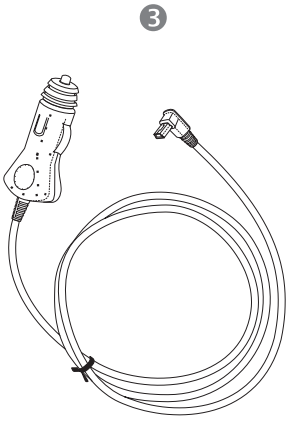
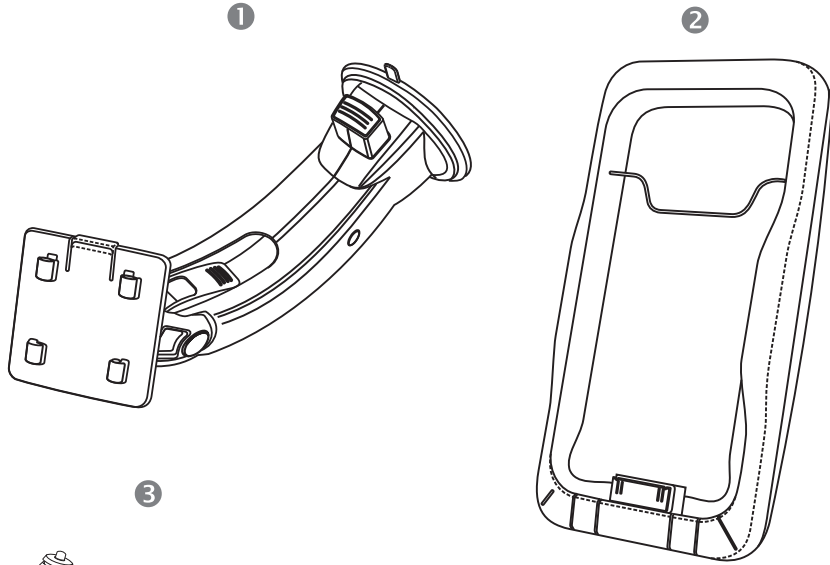

The hands-free car kit (HFCK) is supplied with different combinations of components, depending on the sales regions (countries). The operating manual refers to all versions.

Description of the components:

- 1) Window Mount
- 2) Mobile phone specific cradle with integrated electronics
- 3) 12V vehicle power adaptor cable with cigarette lighter connection
- 4) Installation and Operating manual on CD
- 5) Plug-in external microphone
- 6) Dash Mount Adapter for installation on the dashboard or console
(Depending on the version available inclusive or separately as an accessory)

Accessories - available separately / including, if applicable:

- 7) GPS module to improve the navigation reception (only for iPhone 3GS/ 3G)
- 8) Car Mount (adhesive pad for mounting on the dashboard)
- 9) ISO cable tree for fixed installation
- 10) External microphone for perfect speech input (special passive microphone)
- 11) AUX IN/OUT cable for music playback using the car radio

Note:

► If certain components are added or omitted you will receive the corresponding information on a separate enclosure.

Connection options:

- 1 Microphone
- 2 AUX IN/OUT
- 3 Power supply

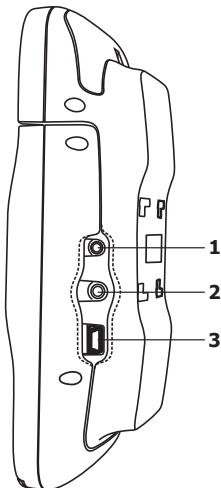

4. Positioning and mounting

First of all, please choose the most convenient position for the BURY Motion in your vehicle by checking different positions in the vehicle. In the following chapters, the Window Mount serves as an installation example. The mounting of the Dash mount Adapter may be different, depending on the vehicle. In this context, it may be necessary to purchase additional tools such as a console or a mounting bracket separately through your specialist retailer.

When using the Car Mount, please clean the subsequent adhesive point of the dashboard with a damp cloth before you remove the protective film and fit the Car Mount. Please remember that during the subsequent use, depending on the intensity of the sunlight and the structure and condition of the dashboard, a bleaching of the uncovered surfaces may occur.

If you would like to use the device during your journey, positioning it in the front area on the driver's side is advisable. Sit in the vehicle and check whether you can reach the device without difficulty.

After having found a suitable position for the BURY Motion in the vehicle you can now mount the device. Please use a cleaning cloth for degreasing the surfaces to which you want to attach the Window Mount.

Important:

- ▶ When positioning the BURY Motion please take care that the device does not impair the view onto the road, that it will not be installed in the impact zone of the passenger compartment (amongst others in the airbag inflation zones) and that the cable may be laid without any problems.
- ▶ Please avoid direct sunlight on the device or high internal temperatures, which can be rapidly reached in parked vehicles. In such cases, remove the BURY Motion and put it in the car glove pocket or glove box for instance.

5. Installing the BURY Motion in your vehicle

Step 1:

Connecting the BURY Motion with the Window Mount

Push the BURY Motion in the Window Mount until you can feel it click into place. After this, attach the Window Mount with the BURY Motion in the vehicle.

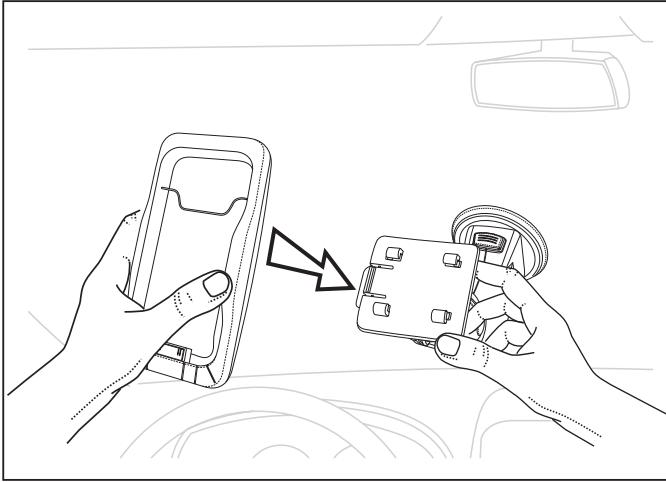

Note:

► You will find the same snap-in mechanism on the Window Mount as you do on the Dash Mount Adapter and the Car Mount.

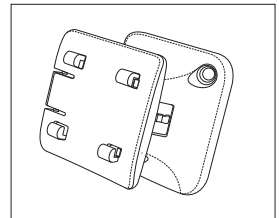
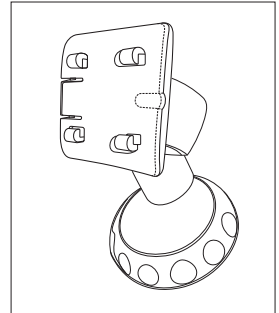
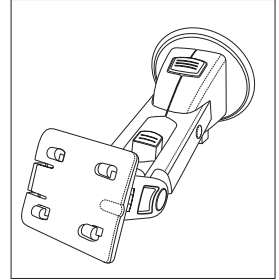

Step 2:

Attaching the BURY Motion to the windscreen

Put the Window Mount on a smooth, dry, dust-free and oil free surface. The Window Mount remains attached to almost all smooth surfaces. The suction pad attachment is especially suitable for rapid and straight-forward attachment to the front windscreen. Please use a cleaning cloth to remove grease from the windscreen.

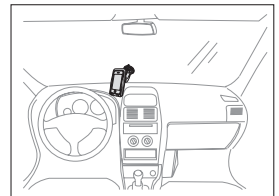

With the help of a suction pad you can attach the BURY Motion to the windscreen. To do this, use the press-stud on the Window Mount in order to either increase or decrease the pressure on the suction pad. To do this, use the press-stud on the Window Mount in order to either increase or decrease the pressure on the suction pad. If you press down on the press stud from top to bottom then the suction pad attachment loosens again.

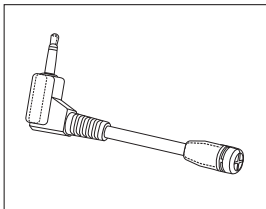
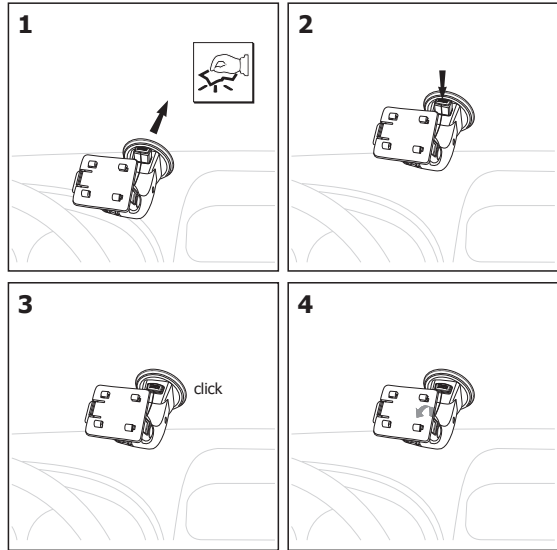

Step 3:

Attaching the plug-in external Microphone

Please connect the microphone jack with the BURY Motion.

Step 4:

The power supply connection

Connect the BURY Motion with the cigarette lighter plug. Plug the cigarette lighter plug into the appropriate connector in your vehicle.

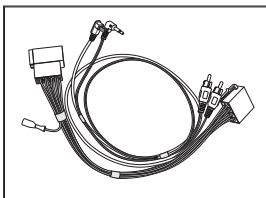

When using the ISO power supply cable, please comply with the instructions in the documentation about your vehicle and radio concerning the Pin allocations on the ISO-plugs. The Cinch plugs are for transferring the audio signals. It is possible that the radio in your vehicle has other inputs. The corresponding adapters are available through your specialist retailer.

6. Inserting and removing the iPhone

Inserting the iPhone

To insert your iPhone you have to open the front flap of the BURY Motion device. To do this, press the ejection button on the right hand side of the BURY Motion. This is how you open the front flap.

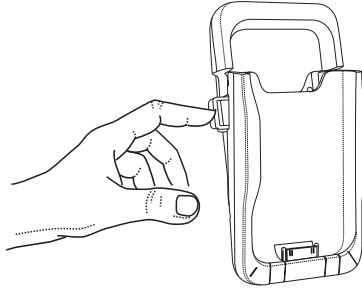

Please remove any protective from your iPhone. Otherwise your iPhone does not fit in the holder or the cover could be damaged. Place your iPhone in the opened front flap of the BURY Motion.

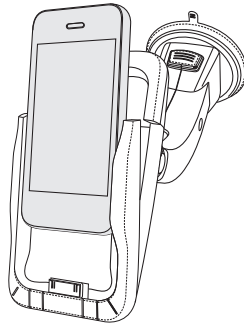

Using one hand, put the iPhone into the cradle until it snaps into place. With the other hand, hold the Window Mount in position. Make sure that your iPhone is firmly in place before you drive away.

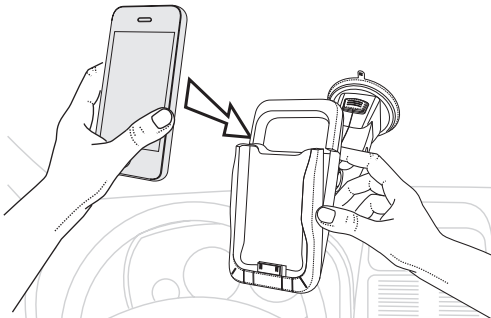

Removing the iPhone

Press down on the ejection button on the right hand side of the BURY Motion so that the front flap opens again.

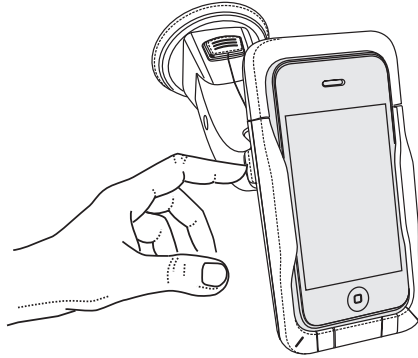

Remove the iPhone upwards from the open flap.

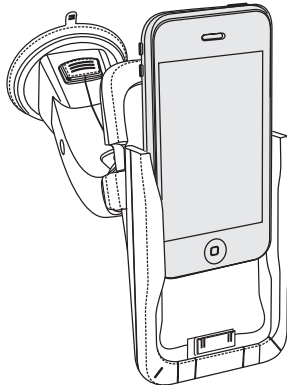

7. Turning the cradle

You can turn the BURY Motion cradle by 180 degrees (90 degrees to the left or right accordingly). Move your device so that you can use it for the different functions that you want. The horizontal format, for instance, is suitable for displaying websites in safari-view and for entering text. If you turn the device to the horizontal format, websites are automatically sized to fit the bigger screen width - with text and images shown in bigger format. In the horizontal format there is also additional space for the onscreen keyboard so that you can enter text data more quickly and with fewer errors.

Navigation applications especially benefit from the horizontal format view because all the operational elements of the software are positioned clearly. Due to the reduced horizon in the horizontal format, the 3D map presentation also contains significantly more detailed information.

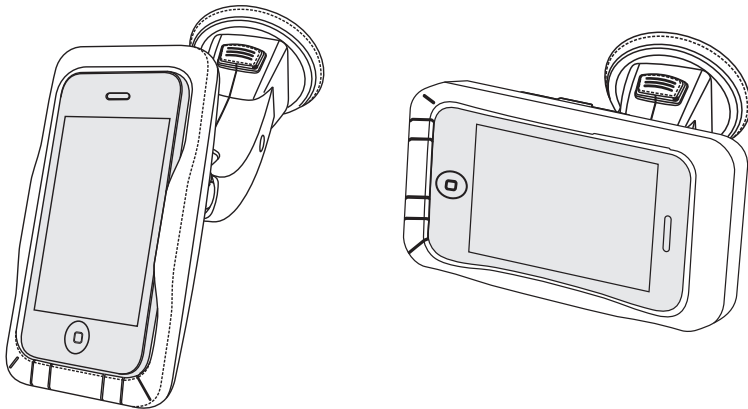

8. Using the hands-free car kit for the first time

After the power supply of the BURY Motion hands free car kit (HFCK) is successfully connected, the HFCK is activated when you have started the vehicle.

9. Establishing a *Bluetooth* connection

If you wish to establish a *Bluetooth* connection between your mobile and the HFCK for the first time, you have to activate the *Bluetooth* function of your mobile phone and search for Bluetooth® devices. In this case, search for a device labelled „BURY Motion...“. If several devices were identified, please select the HFCK and enter the **PIN number „1234“**. The *Bluetooth* connection (pairing) will then be established between your mobile phone and the HFCK. Next, press down on the ‚Pair‘ button in order to create the connection with the HFCK.

In addition it is possible that you must delete all devices connected to your mobile phone first in order to enable a correct identification of the HFCK and the establishment of a connection.

Note:

► If the rechargeable battery of the mobile phone is low, it is sometimes not possible to establish a *Bluetooth* connection.



The *Bluetooth* connection is interrupted if you deactivate the *Bluetooth* function on your iPhone or you interrupt the supply of power to the BURY Motion. In addition, the connection is disconnected, if you move too far away from the vehicle while taking your mobile phone with you and thus leave the reception radius of the HFCK.

Please note that the capacity of your mobile phone's storage battery can quickly decrease when the *Bluetooth* function is active. If you do not want to use the *Bluetooth* function anymore, e.g. if you leave the vehicle for a longer period, it is recommended to deactivate this function.

10. Accepting, making, ending calls

You can accept an incoming call with the help of the receiver key. If you want to accept the call simply press down on the key with the receiver  .

If you don't want to accept the call simply press down on the receiver key  for about two seconds. This means that you have declined the call.

During the call, you have the possibility to regulate the volume of the voice of your discussion partner through the minus  or plus  field.

If you want to end the current call, simply press down on the receiver key  .

You can initialise an outgoing call by invoking the ,Phone' application on the iPhone where you can then select someone from your contacts for instance, or enter a telephone number via the number pad. You can initialise the voice dial function of the iPhone using the ,hand set' BURY Motion button.

You don't have to put the iPhone in the BURY Motion. Thanks to the Bluetooth connection you can also make telephone calls via the BURY Motion if your iPhone is in your pocket or in the boot.

Note:



► Please comply with the country-specific laws concerning in-car telephone calls.

11. Playing back music from your iPhone

You can play back music files saved on your iPhone via the BURY Motion. Thanks to the integrated amplifier (class D) and the two speakers, the sound quality is superb irrespective of the configuration of your radio.

Thanks to the high resolution of the multi-touch screen, listening to music with the iPhone isn't just an acoustic experience, it's also a visual experience.

When you leaf through your music you can turn the iPhone by 90 degrees so that your iTunes are presented with the Cover Flow and you can see your albums' different covers.

While listening to your music you can also control the volume level by using the minus  or plus  field.

12. Charging your iPhone

On placing the iPhone in the BURY Motion it is charged continually as long as the power supply was originally made

- a) via 12V car power supply cable
- b) via ISO cable tree

It is not of any relevance as to whether a Bluetooth connection exists between the iPhone and the BURY Motion or not.

Please note:

- ▶ On certain vehicles the cigarette lighter plug is supplied with electricity at all times. For this reason, always remove your iPhone from the cradle on leaving your vehicle. This also enables you to save your vehicle's battery.
- ▶ The ISO cable tree should therefore be connected to ignition positive (clip 15) and not to continuous positive (clip 30).

13. Service

In case of general or technical queries, suggestions and comments, please do not hesitate to contact our team at any time. Suggestions and feedback are always welcomed:

Administration:

BURY GmbH & Co. KG
Robert-Koch-Straße 1-7
D-32584 Löhne
Germany

Producer:

BURY Spółka z o.o.
ul. Wojska Polskiego 4
39-300 Mielec
Poland

Hotline: +49(0)180 5 - 842 468*

Faxline: +49(0)180 5 - 842 329*

* 0.14 €/min. Deutsche Telekom AG landline,

the costs of international telephone calls which are made from abroad can vary.

E-Mail: hotline@bury.com

Warranty / Service desk:

The duration of the warranty for the components of this product totals two years subsequent to the date of sale to the end customer. Any warranty claims you may have as an end customer are to be asserted towards your contractual partner. If the corresponding contractual partner is not able to rectify a corresponding fault, please exercise your rights of purchase. If subsequent to agreement with your contractual partner the product is to be sent directly to the manufacturer, then please send it, along with a detailed description of the fault in the German or English language and a copy of the proof of purchase, directly to our service team:

BURY GmbH & Co. KG

Im Hause DPD Depot 103
Robinienweg
D-03222 Lübbenau
Germany

Information on the disposal of electrical goods in the EU

The crossed out wheellie bin symbol means that electrical and electronic products, batteries and accumulators must be disposed of separately in the European Union. Please do not dispose of any such products in your normal household waste. As the owner of a product of this sort you are legally obliged to dispose of it at your local dumping site or recycling centre, where you are able to leave your waste electrical goods free of charge.

14. Appropriate use of this system

This hands-free car kit is only intended for use with *Bluetooth* mobile telephones and music playback systems in motor vehicles. When using this system, please comply with the regulations and laws specific to the country in which you are driving and the instructions provided in the guidebook for the mobile telephone that you are using.

15. Approvals and declaration of conformity

Purchase and production as well as service and sales at BURY are subject to tough quality and environmental management conditions according to ISO 9001 and ISO 14001. The device has



the CE approval pursuant to the R&TTE 1999/5/EC regulation



e1 type approval pursuant to the 72/245/EEC (2006/28/EC) regulation
Electro-magnetic compatibility in vehicles

You can request a conformity declaration from the manufacturer of this product by post under the manufacturer's address which is stated above, or by writing to the following email address:
ce_conformance@bury.com

Please provide your email request in either English or German.

Version: 10/2010

25.1270.0-05-221010

Errors and omissions excepted.

„Made for iPhone“ means that an electronic accessory has been designed to connect specifically to iPhone and has been certified by the developer to meet Apple performance standards. Apple is not responsible for the operation of this device or its compliance with safety and regulatory standard. Apple and iPhone are registered trademarks of Apple Inc., registered in the U.S. and other countries.

The *Bluetooth*[®] word brand and the *Bluetooth*[®] logos are owned by Bluetooth SIG, Inc.

All use of these brands by BURY Technologies takes place within the scope of the corresponding licence.

All of the other stated brands are owned by their corresponding owner.

© 2010 by BURY. All rights reserved.