

# SHARP®



Plasmacluster is trademarks of SHARP Corporation.

## Plasmacluster Ion Generator OPERATION MANUAL

ENGLISH

# IG-A10J-W IG-A10J-R IG-A10J-B

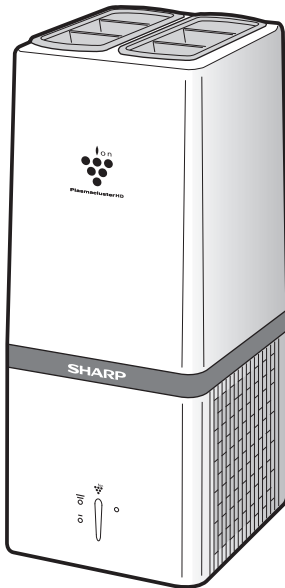

Read and keep this manual carefully.

# FEATURES



## SHARP's Original Air Disinfecting Technology.

Plasmacluster helps to improve the air quality by eliminating of airborne mould<sup>\*1</sup>, viruses<sup>\*2</sup>, allergens<sup>\*3</sup>, and adhering odour<sup>\*4</sup>.

### 1 Release Plasmacluster Ions.

Plasmacluster Ions are the same positive and negative ions found in nature. The ions are surrounded by water molecules, and are released into the air.

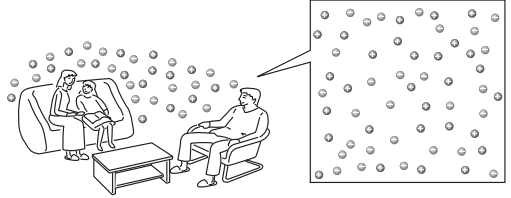

### 2 Attack Airborne microbes.

The ions form hydroxide radicals that are highly oxidizing only when they adhere to the surfaces of mould and viruses. They instantly remove the hydrogen from the surface proteins, breaking them down.

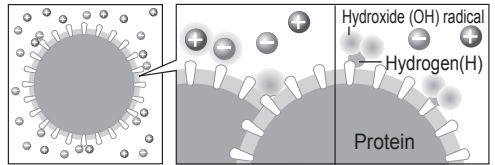

### 3 Return to the air as water.

The hydroxide (OH) radicals combine with hydrogen (H) to form water (H<sub>2</sub>O) which returns to the air.

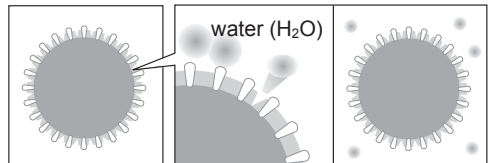

Testing and verification Organization.

\*1 Ishikawa Health Service Association.

\*2 Retroscreen Virology, Ltd, UK.

\*3 Hiroshima University.

\*4 Japan Spinners Inspecting Foundation.

GLP<sup>\*5</sup>-compliant test facilities have gathered highly reliable safety data on Sharp's Plasmacluster technology.

- Skin irritation/corrosion test
- Eye irritation/corrosion test
- Inhalation toxicity test (lung tissue genetic impact assessment)

Tested by: Mitsubishi Chemical Safety Institute

\*5 GLP(Good Laboratory Practice) is a system of management controls for test facilities and test procedures designed to ensure the reliability of chemical safety assessment tests.

## CONTENTS

<b>IMPORTANT SAFETY INSTRUCTIONS</b> .....	E-2
• WARNING .....	E-2
• CAUTIONS CONCERNING OPERATION .....	E-2
• INSTALLATION GUIDELINES .....	E-2
<b>PARTS NAME</b> .....	E-3
• FRONT .....	E-3
• BACK .....	E-3
<b>INSTALLATION POSITION</b> .....	E-4
<b>OPERATION</b> .....	E-4
<b>CLEANING AND MAINTENANCE</b> .....	E-5
• MAIN UNIT .....	E-5
• FILTER .....	E-5
<b>PLASMACLUSTER ION GENERATING UNIT REPLACEMENT</b> ....	E-6
<b>HOW TO REPLACE THE PLASMACLUSTER ION GENERATING UNIT</b> ....	E-7
<b>SPECIFICATIONS</b> .....	E-8
<b>TROUBLESHOOTING</b> .....	E-8

- While IG-A10J can inactivate and eliminate suspended viruses and other contaminants, it cannot create a completely sterile environment. SHARP does not guarantee its ability to prevent microbial infection.
- To enable stable emission of high-density Plasmacluster ions, the Plasmacluster Ion Generating Unit mounted in IG-A10J will need to be replaced periodically\*.

\*Replacement is required approximately every 2 years (17,500 hours) when operated 24 hours a day. IG-A10J will stop operating after about 26 months (19,000 hours) if the Plasmacluster ion generating unit is not replaced.

Thank you for purchasing this SHARP Plasmacluster Ion Generator. Please read this manual carefully before using the Plasmacluster Ion Generator. After reading, keep the manual in a convenient location for future reference.

# IMPORTANT SAFETY INSTRUCTIONS

When using electrical appliances, basic safety precautions should be followed, including the following:

## **WARNING - To reduce the risk of electrical shock, fire, or injury :**

- Read all instructions before using the unit.
- Use only a 220-240 volt outlet.
- DO NOT use the unit if the power cord or plug is damaged, or the connection to the wall outlet is loosened.
- Periodically remove dust from the plug.
- DO NOT insert fingers or foreign objects into the air intake or air outlet.
- Always hold the plug and never pull on the cord when removing the power plug.  
Electrical shock and/or fire from a short circuit may result.
- DO NOT remove the plug when your hands are wet.
- DO NOT use the unit near gas appliances or fireplaces.
- If the power cord is damaged, it must be replaced by the manufacturer, a Sharp Approved Service Centre or a qualified person in order to avoid a hazard.
- Be cautious when cleaning the unit.  
Strong corrosive cleansers may damage the exterior.
- DO NOT use it in the areas where the unit may get wet.
- DO NOT use spray products near the unit.
- DO NOT use in the areas where the unit might be exposed to oil component, incense, cigarettes' sparks, and chemical fumes.
- DO NOT operate when using aerosol insecticides or in rooms where there is oily residue, incense, sparks from lit cigarettes, chemical fumes in the air, or in locations where the unit may get wet, such as a bathroom.
- Only a Sharp Approved Service Centre should service this Plasmacluster Ion Generator.  
Contact the nearest Service Centre for any problems, adjustments, or repairs.
- This appliance is not intended for use by persons (including children) with reduced physical, sensory or mental capabilities, or lack of experience and knowledge, unless they have been given supervision or instruction concerning use of the appliance by a person responsible for their safety.
- Children should be supervised to ensure that they do not play with the appliance.

## **CAUTIONS CONCERNING OPERATION:**

- DO NOT block the air intake and/or air outlet.
- DO NOT use the unit near or on hot objects, such as stoves or heaters or where it may come into contact with steam.
- Always operate the main unit in an upright position.
- Clean the exterior with a soft cloth only, otherwise the main unit surface may be damaged or cracked.
- Keep the main unit away from water.

## **INSTALLATION GUIDELINES:**

- Place at least 2m away from equipment utilizing electric waves such as televisions or radios to avoid electrical interference when using the unit.
- Avoid using in locations where the unit is exposed to condensation or drastic temperature changes. Appropriate room temperature is between 0-35°C.
- Avoid locations where grease or oily smoke is generated, otherwise the main unit surface may crack as a result.

## **NOTE - Radio or TV Interference:**

If this Plasmacluster Ion Generator causes interference to radio or television reception, try to correct the interference by one or more of the following measures:

- Reorient or relocate the receiving antenna.
- Increase the distance between the unit and radio/TV receiver.
- Connect the equipment into an outlet on a circuit different from that to which the receiver is connected.
- Consult the dealer or an experienced radio/TV technician for help.

# PARTS NAME

## FRONT

### DISPLAY

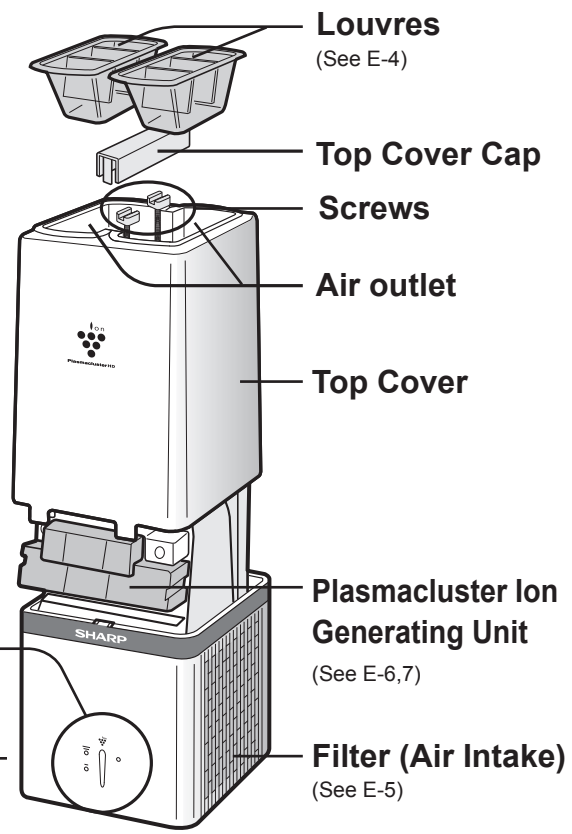
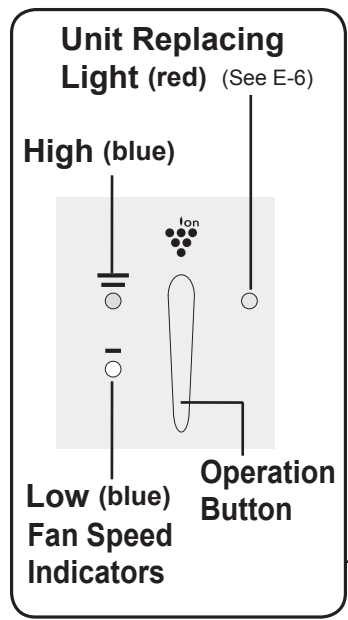

**Filter (Air Intake)**

## BACK

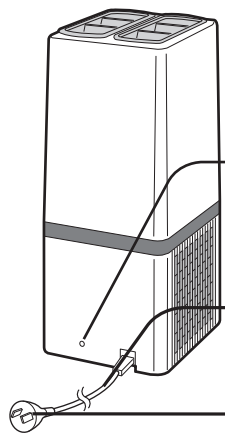

Use a pointed object, e.g a pen tip, to press this button after replacing Plasmacluster Ion Generating Unit.  
Do not press it for any other purpose.  
(This is to reset the Unit Replacing Light.)

**Power Cord**

**Plug**

# INSTALLATION POSITION

Place the main unit on a smooth, stable surface in a room and insert the plug into an outlet.

DO NOT carry the unit by holding the louvres.

## Installation Guidance.

Leave at least 15cm of clearance behind the Unit. 20cm on both sides, and 1m above the unit.

**ABOVE** More than 1m

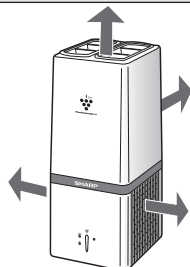

**BEHIND**  
More than 15cm

**LEFT/RIGHT SIDE**  
More than 20cm

DO NOT USE the below items near the unit.

silicone-containing products\*

SPRAY



WAX



PESTICIDES



\* Hair care products, cosmetic products, water proof sprays, polish glass cleaner, and spray on wax.

# OPERATION

Press the operation button to directly turn on the power and select the preferred mode.

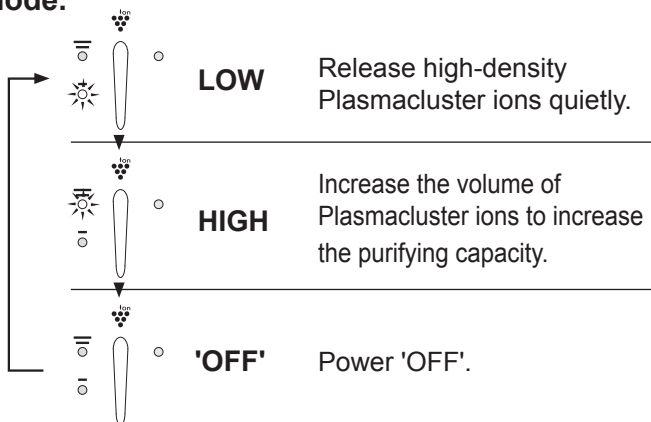
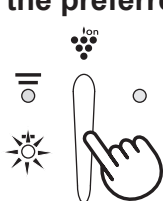

## Louvres

The air comes from the direction, which is marked with the sign  $\Delta$  on the louvres.

- When releasing ions to the entire room, put each louvre in opposite directions.
- When releasing ions to the point to deodorise the adhering odour on clothes, put both louvres in the same direction.



# CLEANING AND MAINTENANCE

## WARNING:

When cleaning the unit, be sure to first unplug the power cord, and never handle the plug with wet hands.

Electrical shock and/or bodily injury may occur as a result.

## Main Unit

Every month or more often if necessary

Wipe with a dry soft cloth.

### <For Stubborn Dirt>

Use water and a mild detergent.

Then wipe with a well wrung-out cloth.

Make sure to dry out the main unit before use.

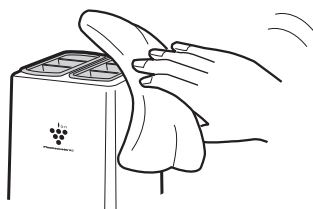

## Filter

Every 2 weeks or more often if necessary

Gently remove dust from the filters by using a vacuum cleaner.

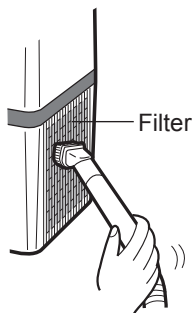

### <For Stubborn Dirt>

Detach the filter and remove dust with using a vacuum cleaner.

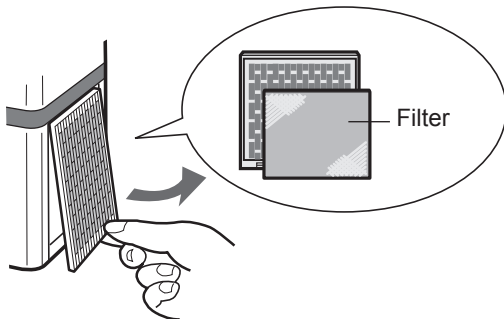

\* The filter is not disposable item. Clean it often.

# PLASMACLUSTER ION GENERATING UNIT REPLACEMENT

In order to release Plasmacluster Ions stably, it is necessary to periodically replace the Ion Generating Unit. The Unit Replacing Light will be ON as a reminder for replacement.

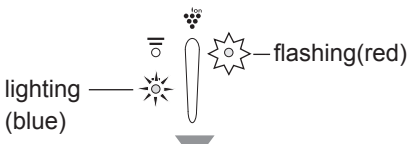
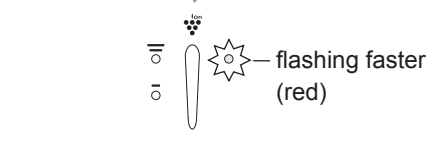
Elapsed Time	Display	Message
Beginning to use		—
approx. 17,500 hours (approx. 2 years if used 24/7)		Suggest replacing
approx. 19,000 hours (approx. 2 years and 2 months if used 24/7)		<ul style="list-style-type: none"> <li>• Stop working</li> <li>• Replace the Plasmacluster Ion Generating Unit.</li> </ul>

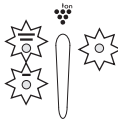
Plasmacluster Ions are not released.		All lights are flashing	Error*
--------------------------------------	--	-------------------------	--------

\*Usage environment affects the lifetime of the Plasmacluster Ion Generator. The Plasmacluster Ion Generator may stop working before estimated lifetime. In this case, press Operation button again and restart. If this does not help, replace with a new Plasmacluster Ion Generating Unit.

## Plasmacluster Ion Generating Unit for replacement

Plasmacluster Ion Generating Unit	
Model Number	IZ-CA10E

### <For Disposal>

Please dispose of the used Plasmacluster Ion Generating Unit according to any local laws and regulations.

-materials-

- Case : Polystyrene
- Unit : Polystyrene Terephthalate, Electric parts



# HOW TO REPLACE THE PLASMACLUSTER ION GENERATING UNIT

\*When replacing the Plasmacluster Ion Generating Unit, be sure to turn off the main unit, unplug the power cord, and never handle the plug with wet hands.

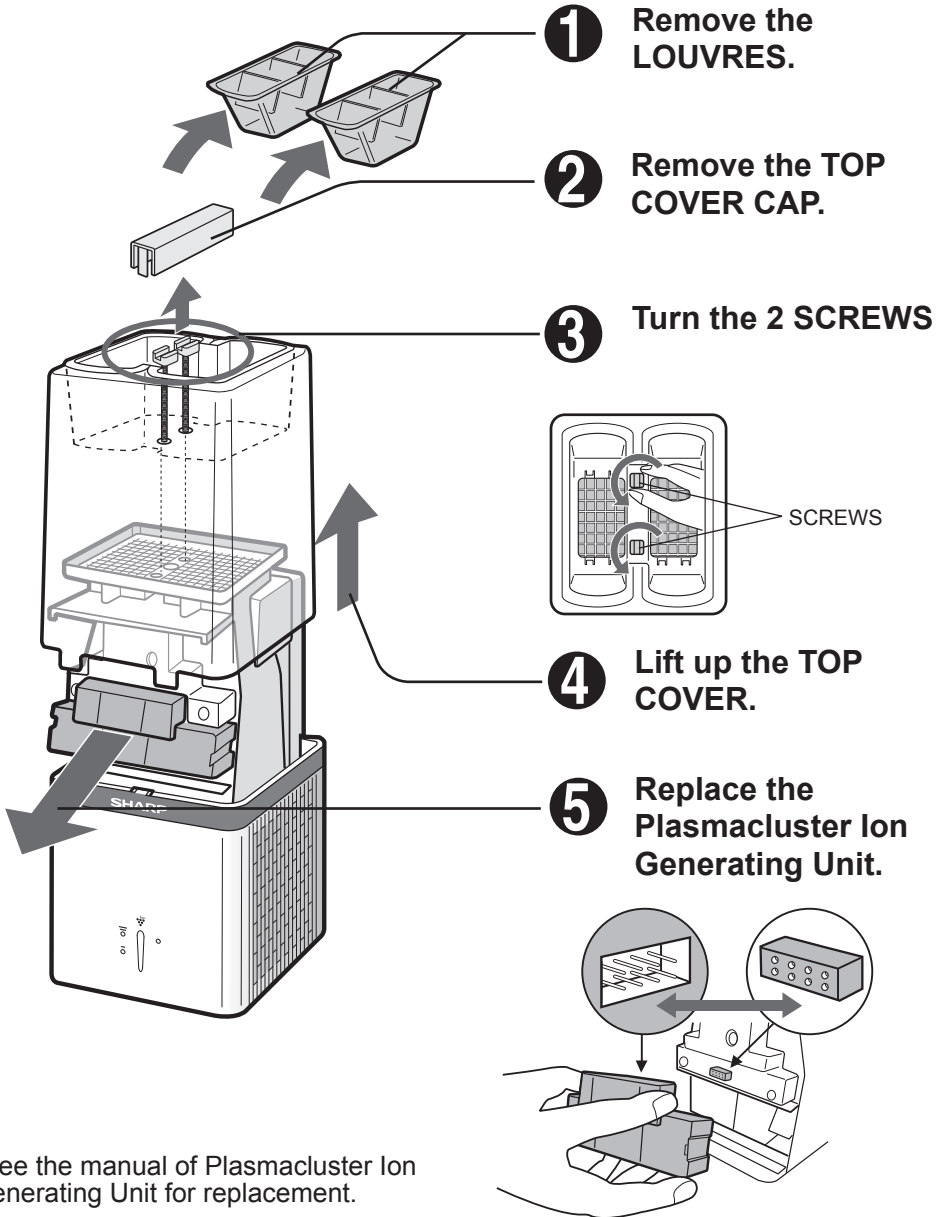

\*See the manual of Plasmacluster Ion Generating Unit for replacement.

# SPECIFICATIONS



Model	IG-A10J			
Power supply	220-240V 50Hz			
Power consumption (W)	(High)	14.0	(Low)	6.5
Operating noise level (dBA)	(High)	44	(Low)	34
Airflow volume(m <sup>3</sup> /hour)	(High)	102	(Low)	72
Applicable floor surface area (m <sup>2</sup> )*	10			
Power cord (m)	1.8			
Outer dimensions (mm)	140 × 160 × 345 (W × D × H)			
Weight (kg)	2.5			

\*The target floor surface area for which an emitted airborne ion density of about 25,000 ions/cm<sup>3</sup> can be measured at a point near the center of the room (at a height of about 1.2 m from the floor), during operation at the HIGH mode when the main unit is placed near a wall.

• The number of ions will vary according to the room conditions and the the main unit operation mode.

## TROUBLESHOOTING

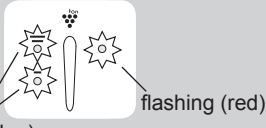
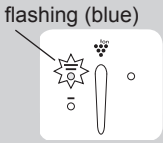
Before calling for service, please review the TROUBLESHOOTING chart below, since the problem may not be a Plasmacluster Ion Generator malfunctions.

Problem	WHAT TO DO
<p>The Plasmacluster Ion Generator does not work.</p> 	<p>Make sure to put in the plug.</p> <p>Approx. 2 years and 2 months (approx. 19,000 hours) has been passed. Replace with a new Plasmacluster Ion Generating Unit. See page E-6,7.</p>
 <p>flashing (blue)</p>	<p>Plasmacluster Ions are not released. Press the Operation button and restart.</p> <p>If all lights keep flashing, replace with new Plasmacluster Ion Generating Unit. See page E-6,7.</p> <p>Dust may block the filter, clean the filter.</p>
  <p>flashing (blue)</p>	<p>Failure Unplug and contact the store you purchased the unit from, or a Sharp Approved Service Centre.</p>
<p>The discharged air has odour.</p>	<p>The Plasmacluster Ion Generator releases a small trace of ozone which may produce odour. The level of ozone emitted by the unit is within the safety standards and does not create health risks.</p>
<p>A clicking or ticking sound comes from the unit while operating the Plasmacluster Ion Generator.</p>	<p>Loudness can be changed depending on room humidity, but the effectiveness is the same. Relocate the Plasmacluster Ion Generator if necessary.</p>

**If you still require service**, contact your SHARP Approved Service Centre.  
SHARP Approved Service Centre locations can be found in the support area of our website:  
Australia : <http://www.sharp.net.au>  
New Zealand : <http://www.sharp.net.nz>

# SHARP

**SHARP CORPORATION OF AUSTRALIA PTY.LTD.**

**A. B. N. 40 003 039 405**

1 HUNTINGWOOD DRIVE, HUNTINGWOOD, N.S.W. 2148

P.O.BOX 6827, BLACKTOWN. N.S.W. 2148

[www.sharp.net.au](http://www.sharp.net.au)

**SHARP CORPORATION OF NEW ZEALAND LIMITED**

59 HUGO JOHNSTON DRIVE, PENROSE, AUCKLAND

[www.sharp.net.nz](http://www.sharp.net.nz)

Printed in China

TINS-A359KKRZ 09K- (CN) ①