

***Energizer®***

**eZG**7250  
**eZG**7250CA

6500W GAS POWERED **PORTABLE GENERATOR**



*User Guide*



## **Let's get started.**

You're excited to power up, so we'll keep this brief!

Thank you for  
purchasing your  
eZG7250 generator.

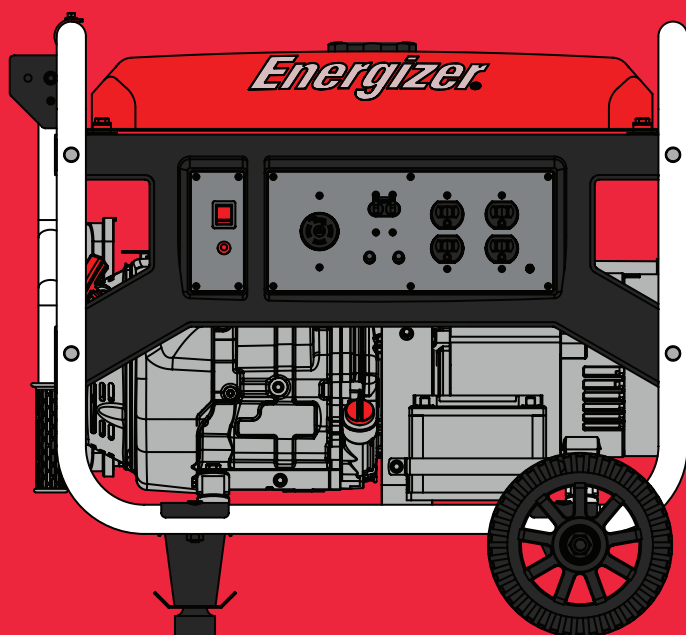

Remember to register! Take a minute to register this product online at [www.energizergenerators.com](http://www.energizergenerators.com). This will allow you to request warranty support in the future.

This manual will show you how to use the great features that sets the eZG7250 apart from the crowd.

## **We've got you covered!**

Call us at 1-887-528-3772 if you have any questions

This user guide covers the safety, operation and maintenance procedures for the eZG7250.

All information in this publication is based on the latest product information available at the time of print. Visit [www.energizergenerators.com](http://www.energizergenerators.com) for user guide updates and operation notices.

No part of this publication may be reproduced without written permission.

It is important that anyone operating this product read and understand the manual prior to use.

## Warranty Information

Warranty support, operation assistance and product support is provided by Midland International Inc., a licensed manufacturer of Energizer Power Equipment. Please contact us directly for any warranty service questions.

1-877-528-3772

[www.energizergenerators.com](http://www.energizergenerators.com)

**EZG7250 MEETS ALL CERTIFICATION  
REQUIREMENTS FROM**



**EZG7250CA MEETS ALL CERTIFICATION  
REQUIREMENTS FROM**



California Environmental Protection Agency

 **Air Resources Board**

<b>Contents</b>	<b>Page</b>
<b>Safety First</b>	8
Safety while using your generator	8
Understanding AC safety	9
Safety while maintaining your generator	9
Other safety tips	10
<b>Learn About Your New Generator</b>	11
Identification of Parts	11
Making Sure You Have Everything	13
Mounting Instructions	14
<b>Setting Up Your Generator</b>	17
Checking the Oil Level	17
Checking the Engine Fuel Level	18
Checking the Air Filter	19
Checking the Battery Connection	20
<b>Using your Generator</b>	21
Starting your Generator	21
Using your Generator with your Appliance	23
Stopping your Generator	24
<b>Maintaining your Generator</b>	25
Maintenance schedule	25
General inspection tips	25
Cleaning the air filter	26
Changing the engine oil	27
Replacing and cleaning the spark plug	28
Handling and storage	29
<b>Troubleshooting</b>	31
<b>Specifications</b>	32
<b>Wiring Diagram</b>	33
<b>Learn About your Warranty</b>	34

# Chapter 1 — Safety First

Playing it safe when working with power equipment is always a good idea. Here are some important precautions to make sure you stay safe.

## 1.1 Safety while Operating Your Generator

- Always perform an oil, fuel and air filter check before starting the engine.
- Properly clean and maintain the equipment.
- Operate the generator according to instructions for safe and dependable service.
- Read user manual carefully before operating this product! Failure to do so may result in serious harm to the user and to the equipment.
- Before operating the generator, read the user manual carefully. Otherwise, it may result in personal injuries or equipment damage.
- Never run the generator in an enclosed area to avoid harm from exhaust emissions of a poisonous carbon monoxide gas.
- Be careful not to touch the exhaust system, compressor pump or discharge tubing during operation due to risk of burns.
- Pay attention to the warning labels. The engine exhaust system will become heated during operation and remain hot immediately after the engine is stopped.
- Gasoline is a highly flammable and explosive liquid. Refuel in a well ventilated area with the engine stopped.
- When refueling the generator, keep it away from cigarettes, open flames, smoke and/or sparks.
- Connections for standby power to a building's electrical system must be done by a qualified electrician and must comply with all applicable laws and electrical codes. Improper connections may cause serious injuries to electrical workers during a power outage, and when the utility power is restored, the generator may explode or cause fires.
- Place the generator at least 3 feet away from buildings or other equipment during operation.

- Run the generator on a level surface. Tilting the generator may result in fuel spills.
- Know how to stop the generator quickly and understand operation of all the controls. Never permit anyone to operate the generator without proper instructions.
- Keep children, pets and machinery with rotating parts away during operation.
- Do not operate the generator in rain or snow.
- Do not allow any moisture to come in contact with the generator.
- Do not touch the spark plug while the engine is operating or shortly after the engine has been shut down

## 1.2 Understanding AC Safety

Before connecting the generator to an electrical device or power cord:

- Make sure that everything is in proper working order. Faulty devices or power cords can lead to an electrical shock.
- Turn off the generator immediately if the device begins to operate abnormally. Then disconnect the device and investigate the problem.
- Make sure that the electrical rating of the device does not exceed that of the generator. If the power level of the device is between the maximum output power and the running power of the generator, the generator should not be used for more than 30 minutes.
- The connections from the generator to the household power supply should be done by professional electrical technicians. Improper connections may lead to a fire hazard or damages to the generator set.
- AC Receptacle: CSA Certified or cUL Listed

## 1.3 Safety while Maintaining Your Generator

After any maintenance is performed, wash immediately using soap and clean water because repeated exposure to lubricant may cause skin irritation.

- Do not clean the filter element with flammable liquids like gasoline **because** an explosion may occur.

- Turn off the engine before performing any maintenance. Otherwise it can cause severe personal injury or death.
- Allow the generator set to cool down before performing any maintenance.
- Always wear safety glasses when cleaning the generator set with air.
- Do not clean the generator set with a pressure washer because it can cause damage to the generator set.
- Before working with batteries, ventilate the area, wear safety glasses, do not smoke and always disconnect the negative cable first and reconnect it last.
- Use rubber gloves when coming into contact with engine oil.
- Always stop the generator set before removing the oil filler cap.
- Only qualified maintenance personnel with knowledge of fuels, electricity, and machinery hazards should perform maintenance procedures.
- Lubricate all exposed metal parts regularly.

## 1.4 Other Safety Tips

- To avoid breathing in poisonous carbon monoxide from the exhaust gases, adequate ventilation should be provided if the generator set is running in a partially enclosed space.
- If the generator set is stored outdoors, check all the electrical components on the control panel before each use. Moisture can damage the generator and can lead to an electric shock.
- If you start to feel sick, dizzy, or weak after the generator has been running, move to fresh air RIGHT AWAY. See a doctor. You could have carbon monoxide poisoning.

## Chapter 2 — Learn About Your Generator

This section will show you how to identify key parts of your generator. Going over the terminology below will make sure we're on the same page.

### 2.1 Identification of Components

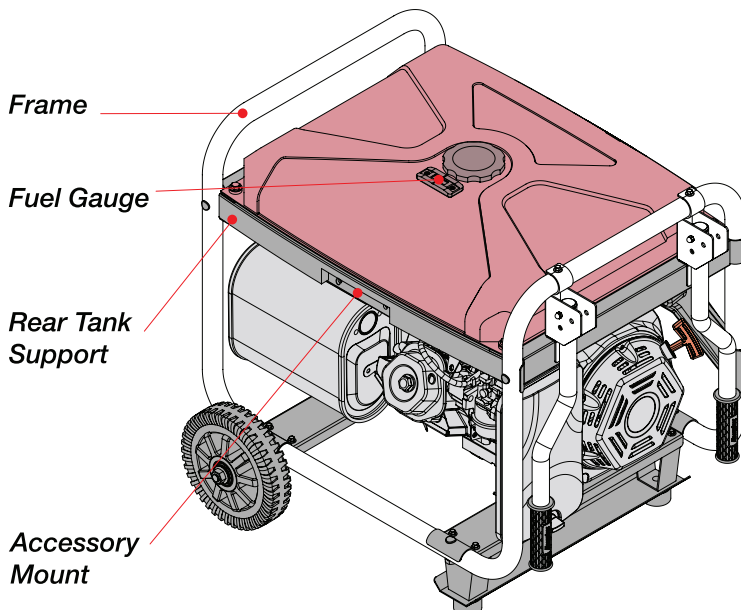
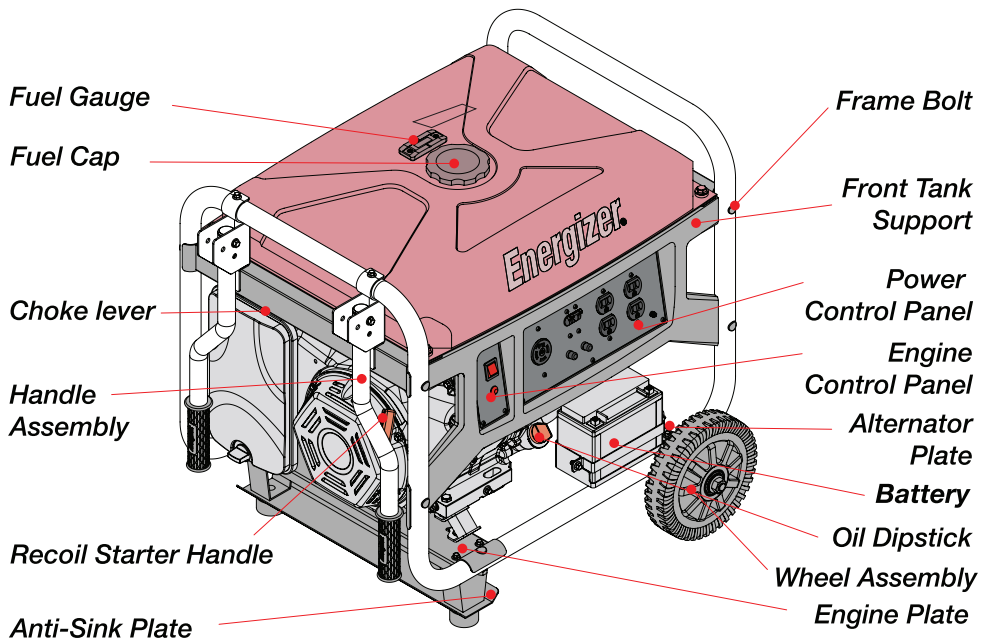

On/Off Switch

120/240V AC Outlet

Master Breaker

120V AC Dual Outlet

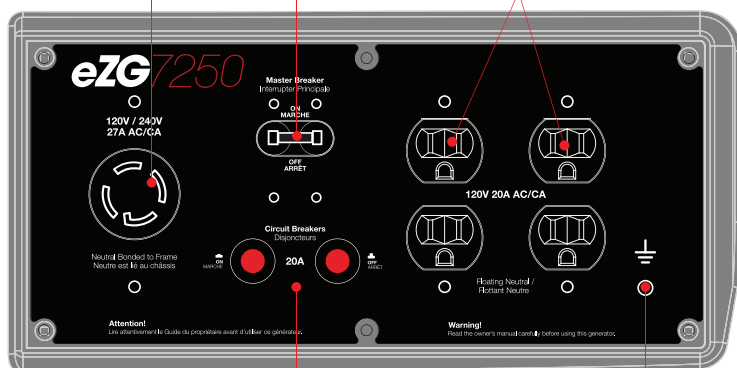
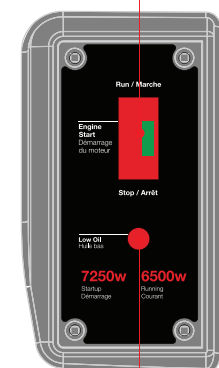

Low Oil Light

AC Breaker

Ground

## AC Receptacle: CSA Certified or cUL Listed

Type: L14-30R

Mounting: Secured to control panel by screws and nuts with mounting metal bracket.

Remarks: Provided with 0.5 mm epoxy fiberglass board underneath receptacle to ensure 12.7mm.

Electrical spacing between bare live parts and the control panel, overall 13 mm by 60 mm.

Note: The following markings appear adjacent to the receptacle: "MAX.13 A."

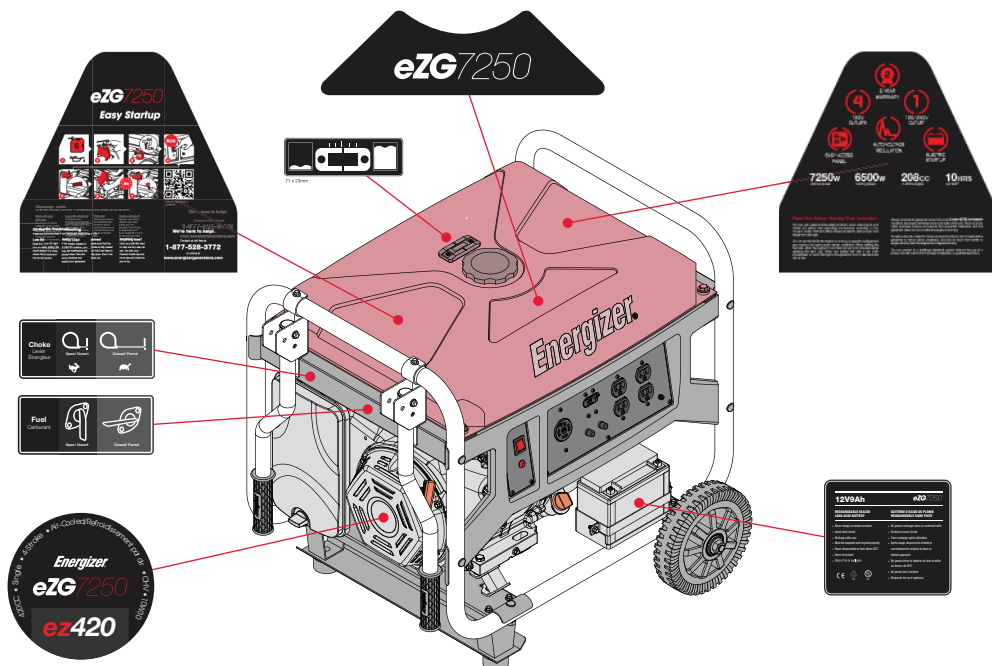



## 2.3 Mounting Instructions for eZG7250 (Refer to Figure Below)

1. Attach the handle bars to the middle of the generator frame where specified in the figure below. Tighten the bolts (14) and nuts (7) to the upper frame of the generator.
2. Attach the two peg stands at the bottom of the frame of the generator. Tighten the two bolts (6) and two nuts (7) to the lower frame of the generator.
3. Place the two wheels (5) on the wheel axle (4) and then secure the washer (8) using the split pin (9) to the wheel axle (4).
4. Attach the wheel axle (4) to the bottom of the generator frame. Align the bolts (6) with the holes on the bottom of the generator and fasten tightly with the nuts (7) provided.

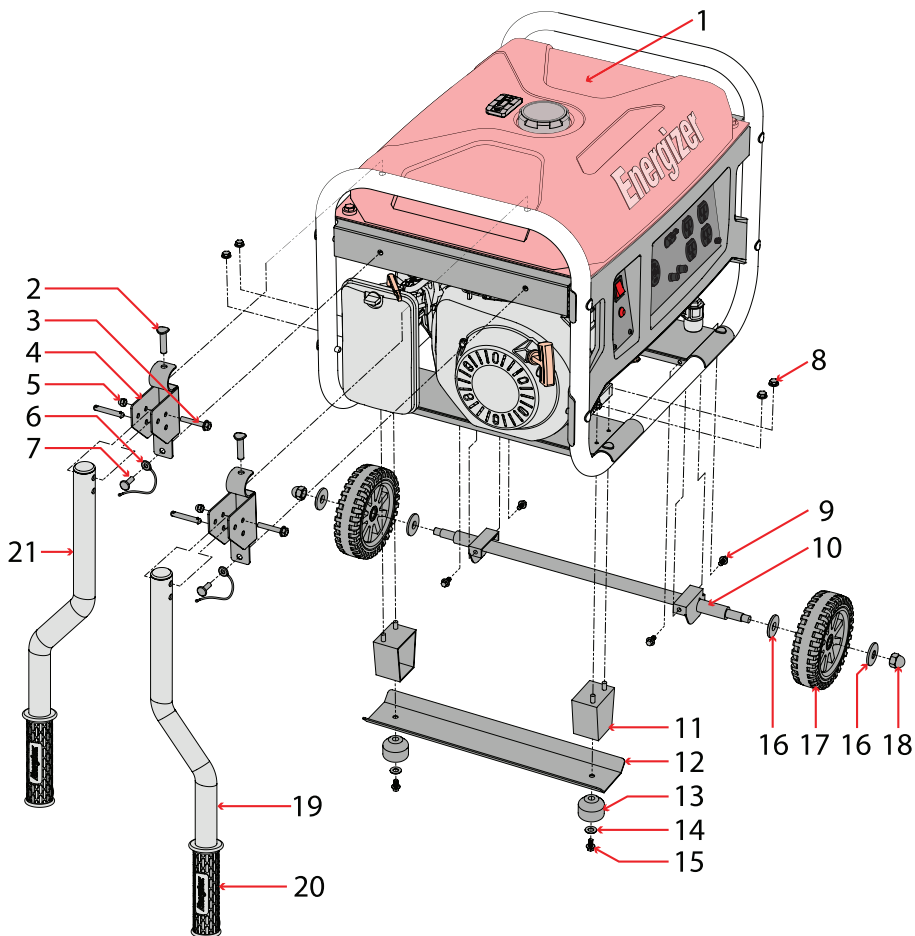

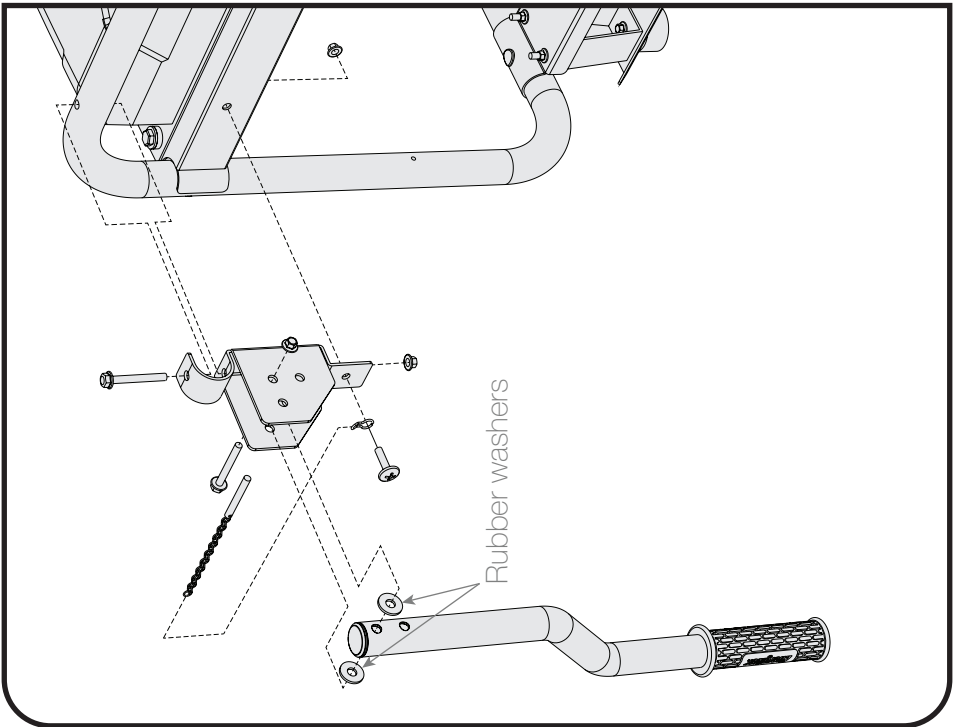
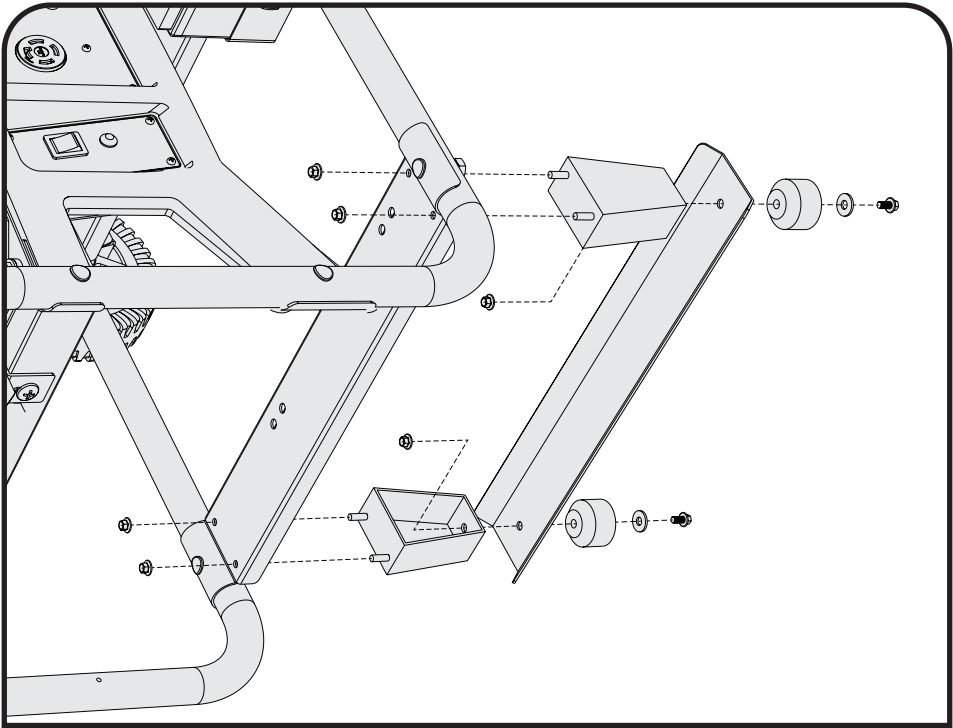

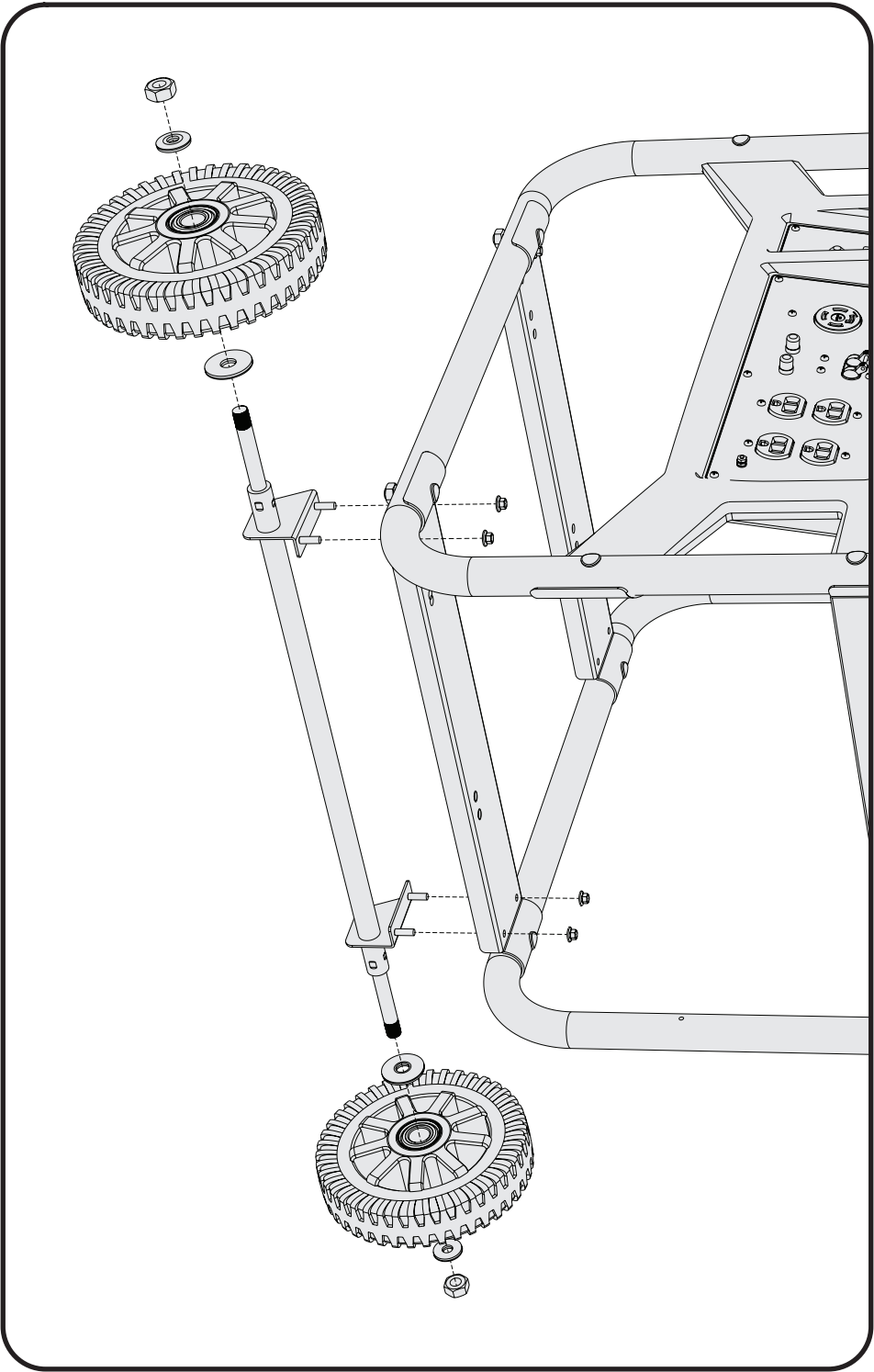

## Chapter 3 — Setting Up Your eZG7250 Generator

Setup should be done everytime you start up your generator, these quick checks will ensure you get the most out of your generator.

Exhaust gas contains poisonous carbon monoxide. Never run the generator in an enclosed area. Be sure to provide adequate ventilation. Operate the generator on a level surface. If the generator is tilted, fuel spillage may result. Keep away from rotating parts while the generator is running. The generator is air-cooled and may be damaged if ventilation is inadequate.

### 3.1 Checking the Engine Oil Level

5. Ensure the generator is on a level surface.
6. Inspect engine oil:
  - Take out the oil filler cap and clean the dipstick.
  - Check the oil level by reinserting the oil filler cap without rotating it. Remove the oil filler cap and examine the oil level. If the oil level is at or below the minimum oil level, refill the oil to the maximum oil level mark. (10W30)Reinsert the oil filler cap and tighten securely. (Refer to figure below)

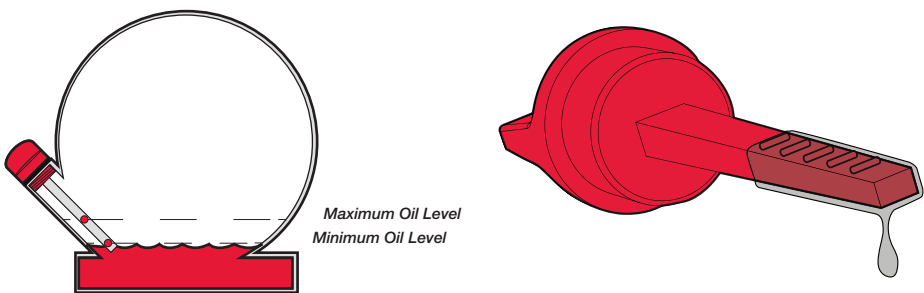

Engine oil is a major factor affecting engine performance and service life. Non-detergent or vegetable oils are not recommended.

## 3.2 Checking the Engine Fuel Level

1. Check the fuel level by reading the gauge or removing the fuel tank cap to visually check the level.
2. Refuel if level is too low. Tighten the fuel tank cap securely after refilling (Refer to Figure below)

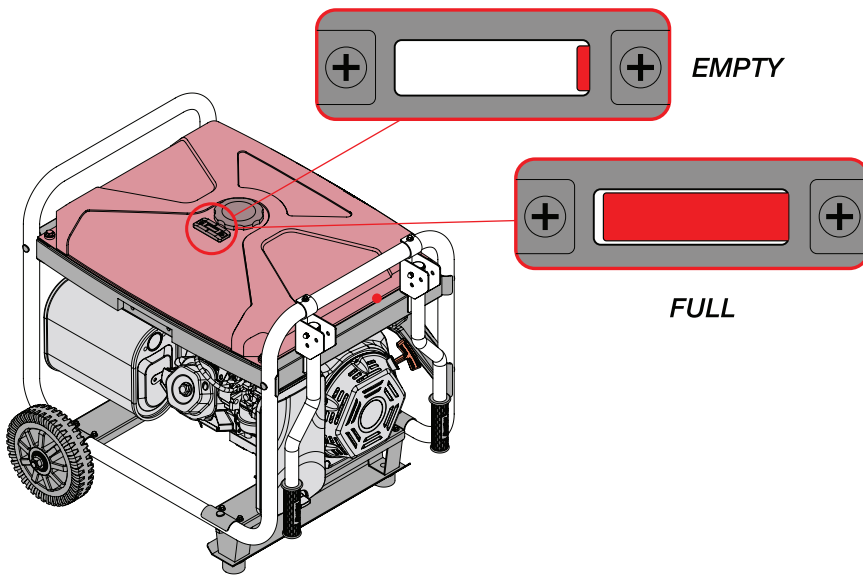

Gasoline is highly flammable and explosive under certain conditions. Refuel in a well-ventilated area with the engine stopped. Do not smoke or allow open flames or sparks in the area where the generator is being refueled or where gasoline is stored. Do not overfill the tank. Be careful not to spill fuel when refueling. Wipe up any spilled gasoline and let the area dry before starting the engine.

Gasoline substitutes such as gasohol are not recommended. They may be harmful to the fuel system components.

### 3.3 Check the Air Filter

1. Loosen the knob and remove the air filter cover. Remove the air filter element and observe for cleanliness.
2. Clean the air filter element with soap and water or solvent. Squeeze dry and then soak in clean engine oil.
3. Squeeze out all excess oil and reinstall. Replace the element if it is damaged.

**Check the air filter using the maintenance schedule. Always inspect air filter before using the generator. Clean Air Filter every 3 months or after 50hrs of operation according Section 5.4 Cleaning the Air Filter.**

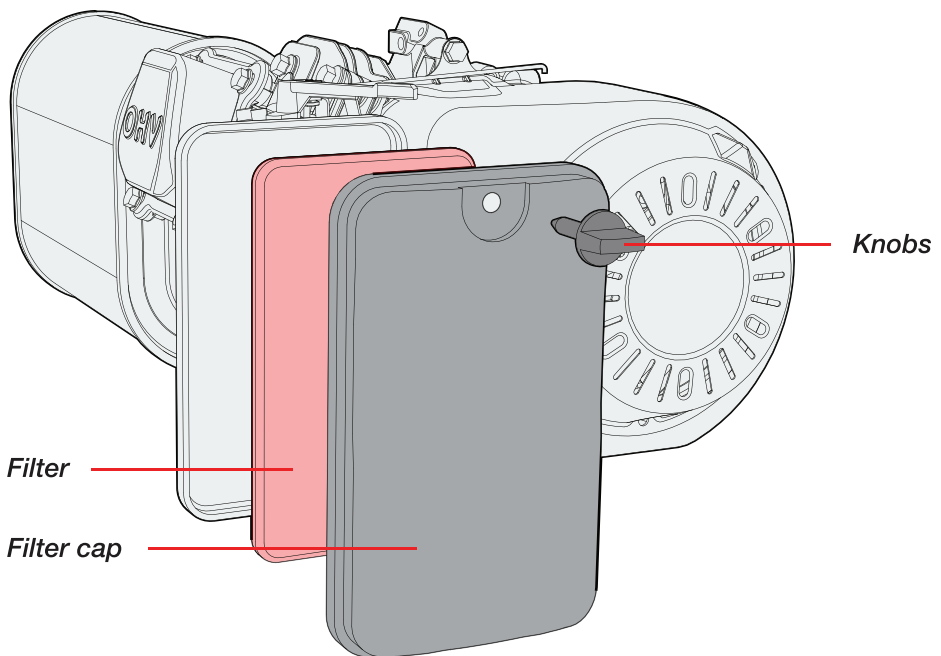

### 3.4 Electric Start Battery Connection

Batteries produce explosive gases. Keep sparks, flames and cigarettes away from the battery at all times. To prevent the possibility of creating a spark while using the battery, connect charging cables to battery terminals first, then to the generator. When disconnecting, disconnect the cables at the generator first.

1. Connect the red cable with the positive terminal of the battery. Ensure the connection is secured by using the fastener at the battery terminal.
2. Connect the black cable with the negative terminal of the battery. ensure the connection is secured by using the fastener at the battery terminal

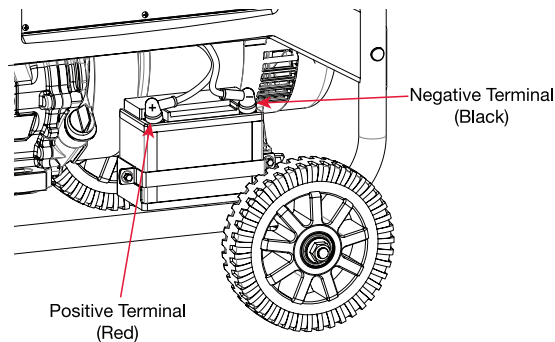

Be sure to connect the Electric Start Battery to the EZG7250 Generator set before operation. Failure to do so will cause the Output Display to function improperly.

Do not reverse the polarity of the terminals when charging the battery. Serious damage to the generator and/or battery may occur. Do not attempt to connect the battery while the generator engine is running. Disconnect the cables from the battery while the generator is in storage.

## Chapter 4 — Using Your eZG7250 Generator

### **DANGER- CARBON MONOXIDE**

#### **Using a generator indoors WILL KILL YOU IN MINUTES**

Generator exhaust contains high levels of carbon monoxide (CO), a poisonous gas you cannot see or smell. If you can smell the generator exhaust you are breathing CO. But even if you cannot smell the exhaust, you could be breathing CO. NEVER use a generator inside homes, garages, crawlspaces, or other partly enclosed areas. Deadly levels of carbon monoxide can build up in these areas. Using a fan or opening windows and doors does NOT supply enough fresh air. ONLY use a generator outdoors and far away from open windows, doors, and vents. These openings can pull in generator exhaust. Even when you use a generator correctly, CO may leak into the home. ALWAYS use a battery-powered or battery-backup CO alarm in your home. If you start to feel sick, dizzy, or weak after the generator has been running, move to fresh air RIGHT AWAY. See a doctor. You could have carbon monoxide poisoning.

#### **4.1 Starting Your Generator**

**Before using generator, a ground wire must be connected to the ground terminal. The Ground terminal is located on the Front Panel. Before using the ground terminal consult a qualified electrician.**

**Do not use the choke if the engine is warm or if the air temperature is higher than 50°F (10°C).**

We know you're excited to get using your generator. Please be sure to follow the startup instructions below thoroughly to ensure the best lifespan for your generator.

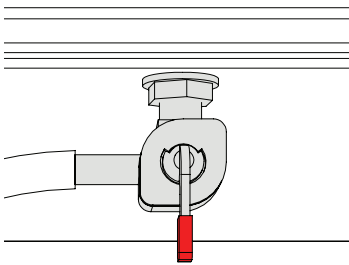

1. Rotate the fuel valve lever to ON position (Vertical position).

This is located on the left side of your generator, it is attached to the bottom of the fuel tank.

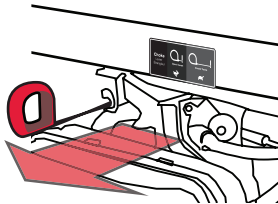

**Choke On/Closed**

2. If the engine is cold: push the choke lever into the on/closed position.

You can find the choke lever above the air filter cap on the left side of your generator.

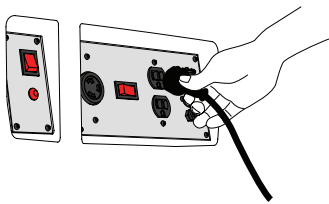

3. Disconnect all devices from the outlets on the generator panel. Then press the engine switch to the "RUN" position.



4. Grasp the recoil starter handle and pull it until the generator starts.

**Do not allow the recoil starter to snap back.**

**Return it slowly by hand.**

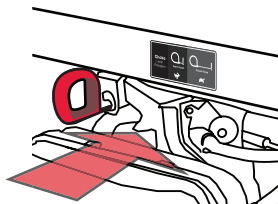

**Choke Off/Open**

5. Push the choke lever to the OPEN position as the engine warms up. The choke is used to provide the proper air-fuel mixture when the engine is cold.

## 4.2 Using the EZG7250 with your Appliances

After starting the eZG7250 you can connect your devices to it. If you want to use the 120V outlets, be sure to move the "Voltage Switch" is in the right position.

Before starting make sure that you know what you are able to power with your Generator. Here's how you can decide:

Add the watt ratings of all the loads that the generator set will be powering at the same time. Make sure that total wattage will not exceed the generator rating.

EXAMPLE:

A generator set rated 5000W can power two 1500W heaters, a 900W circular saw, a 500W drill and a 100W light at the same time (4500W combined). However, to operate a second 900W saw, it will be necessary to disconnect one of the 1500 W heaters.

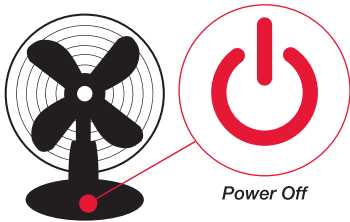

1. Turn off the switches of devices before connecting them to your generator.

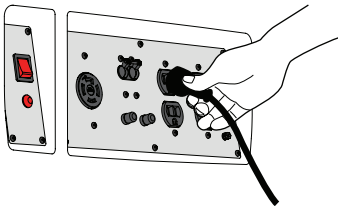

2. Insert the plug of the device into your generator based on its voltage requirements. Your eZG7250 generator includes two (2) 120V AC outlets and one (1) 120/240V AC outlet for power specific appliances such as an oven or washer/dryer.

Be sure the "Voltage Switch" is appointed to the outlet type that you require.

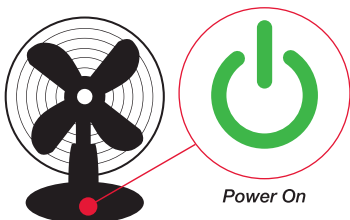

3. You can now turn your devices on and use them.

**To stop the engine in an emergency, turn the engine switch "OFF". Always connect the generator to the ground terminal to prevent electrical shock.**

# 4.4 Stopping Your Generator

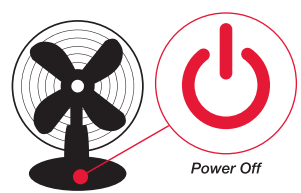

1. Turn off all of the connected devices. Let your generator run for a few minutes to cool down.

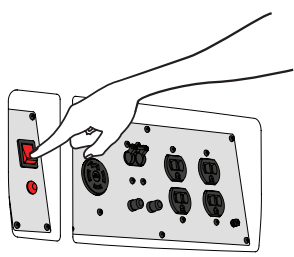

2. Stop the generator by pressing and holding the engine switch in the "off" position until the generator stops.

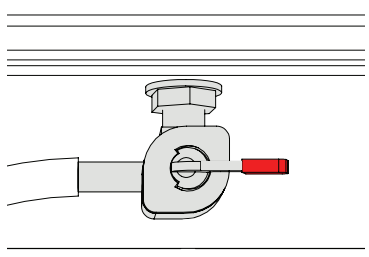

3. Rotate the fuel lever to the off position (horizontal)

## Note on Automatic Voltage Regulation (AVR)

Your generator is equipped with an Automatic Voltage Regulator which ensures a constant voltage and present a waveform similar to what you get from the city power grid. They are an improvement over basic generators but not as effective at safely running sensitive electronics as our inverter generators, which can produce almost perfect sine waveforms.

Therefore powering some sensitive electronics with this generator is not recommended, since it will risk damage the electrical componentry and can cause a risk of damage.

# Chapter 5 — Maintaining Your eZG7250 Generator

Proper maintenance ensures safe, economical and trouble-free operation. Improper maintenance may cause the generator to malfunction and can lead to serious injuries. Contact Energizer Power Customer Support if you have any maintenance questions.

## 5.1 Maintenance Schedule

Item	Task	Daily	EVERY 20 HOURS	EVERY 50 HOURS	EVERY 100 HOURS	EVERY 300 HOURS
General Inspection		•				
Engine Lubricants	Inspect Oil Level	•				
	Replace		• **		•	
Air Filter	Inspection	•				
	Cleaning			•		
Sediment Cup	Cleaning			•		
Spark Plug	Inspection & Cleaning				•	
	Replacement					•
Valve Clearance	Inspection & Adjusting					•
Combustion Chamber	Inspection & Adjusting					•
Fuel Tank and Strainer	Cleaning					•
Fuel Line	Clean every two months (replace if necessary)					

\*\* For first use of the generator.

## 5.2 General Inspection Tips

1. Look for fuel leaks around the fuel tank, fuel hose, fuel valve and carburetor. Close the fuel valve and repair leaks immediately.
2. Look and listen for exhaust leaks while the engine is running. Have all the leaks repaired before continuing operation.

3. Check for dirt and debris and clean as necessary.
4. Check the engine oil level and add oil as necessary.

**Do not use gasoline or low flash point solvents for cleaning. They are flammable and could explode under certain conditions.**

### 5.3 Cleaning The Air-Filter

**Using gasoline or other flammable solvents can cause a fire or explosion.  
Do not operate this product without an air filter.**

1. Rotate the knob counterclockwise to release.
2. Lift the filter cap to remove from the filter.
3. Remove the foam filter.

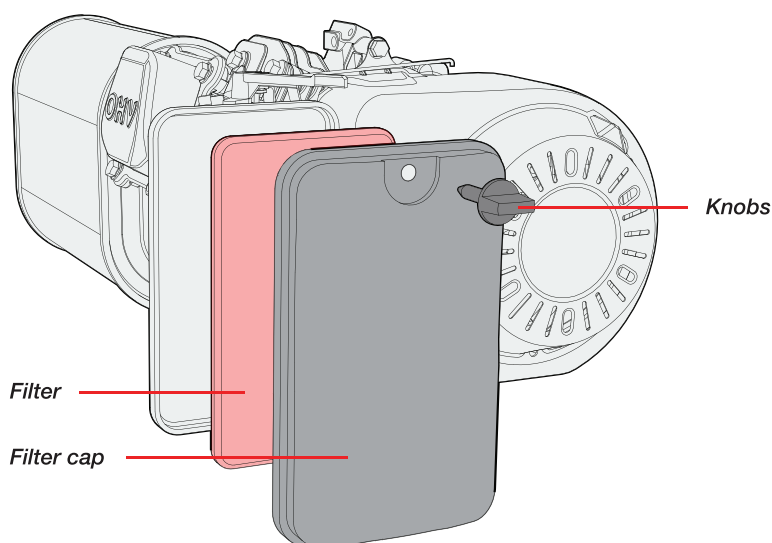

4. If the foam filter is dirty, clean it in warm soapy water, rinse, and allow it to dry thoroughly, or clean in non-flammable solvent and allow to dry.
5. Dip the foam filter in clean engine oil, then squeeze out all excess oil. The engine will smoke when started if too much oil is left in the filter.
6. Wipe dirt from the air filter unit and cover using a moist rag.

## 5.4 - Changing the Engine Oil

Used motor oil can cause skin irritations if left in long-term contact with skin. Wash hands thoroughly with soap and water after handling oil.

Do not dispose of used oil in drains or on soil. Local service shops provide environmentally-friendly disposal methods.

1. Stop the engine and remove oil filler cap.
2. Place a pan under the engine.
3. Remove the oil drain screw and allow the oil to completely drain into the pan.
4. Reinstall drain screw before filling the engine with fresh oil. Do not overfill oil reservoir. Use a funnel to prevent spillage.
5. Reinstall the oil filler cap and tightly fasten.

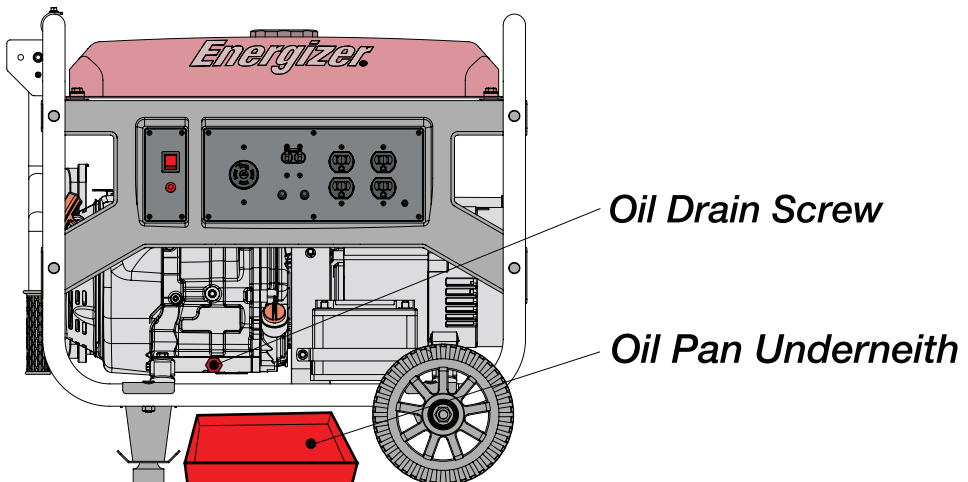

## 5.5 - Replacing and Cleaning the Spark Plug

Do not rinse spark plug in water. Follow guidelines and be careful not to overtighten the spark plug.

Tighten  $\frac{1}{2}$  turn when installing a new spark plug.

Tighten  $\frac{1}{4}$  turn when re-installing an old spark plug.

1. Disconnect and remove the spark plug using a wrench.
2. Inspect the spark plug and clean any dirt from the electrodes with a wire brush. If electrodes are worn or show signs of wear, replace spark plug.
3. Measure the electrode gap with a spark plug gauge and adjust as necessary by bending the side electrodes. Ensure that the gap is between 0.7 and 0.9mm
4. Reinsert the plug carefully. Tighten with a spark plug wrench.

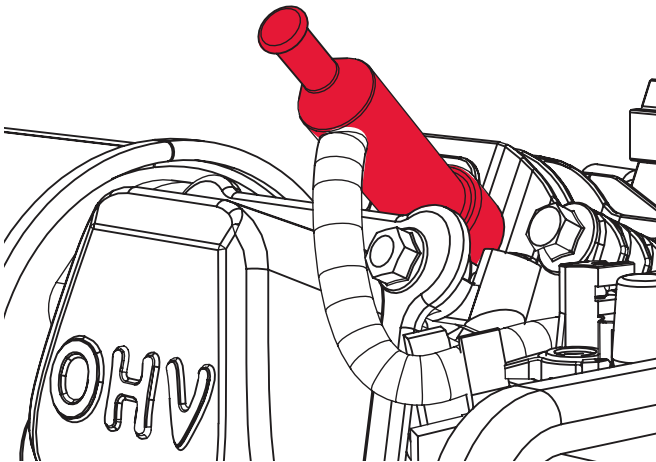

## 5.6 - Handling and Storage

### Handling

1. Turn off the engine switch and the fuel valve when transporting the generator set.
2. Do not touch engine until the engine has cooled down.
3. Keep the generator at a level position in order to prevent spillage.

### Storage

Before storing the generator set for an extended period:

1. Ensure that the storage area is free of excess humidity and dust.
2. Drain the fuel tank and the carburetor.

### Draining the Fuel Tank

1. Turn OFF the engine. Remove the fuel cap and the debris screen underneath the fuel cap.
2. Empty the fuel tank using a siphon and an approved gasoline container.

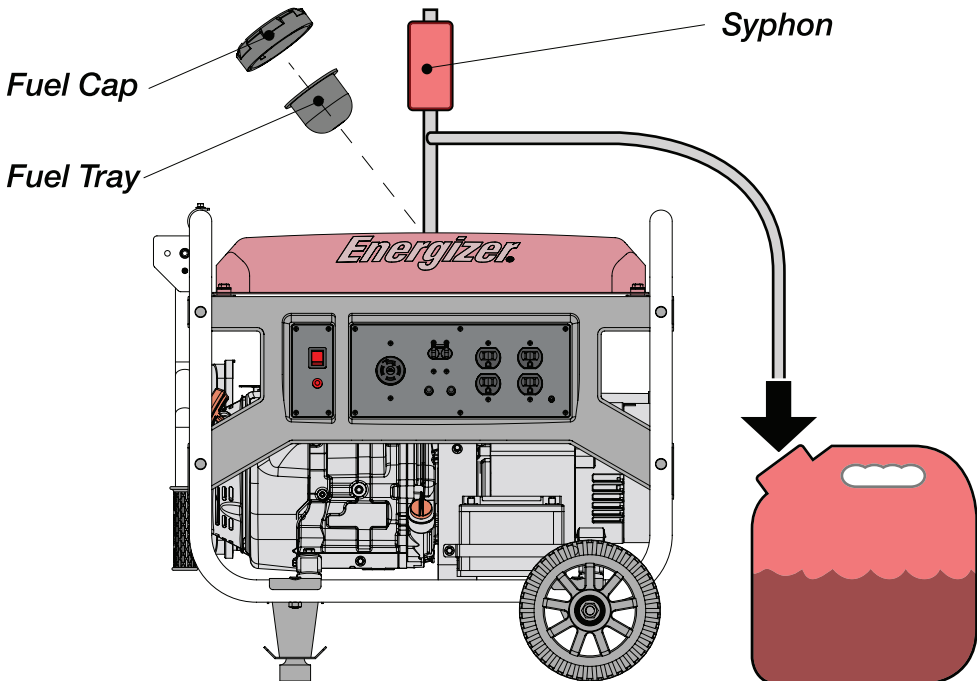

## Draining the Carburetor

1. Turn OFF the engine. Let Cool. Turn the fuel valve ON.
2. Position a container under the carburetor drain screw. Loosen the drain screw.
3. Allow fuel to drain completely drain and re-tighten the drain screw.

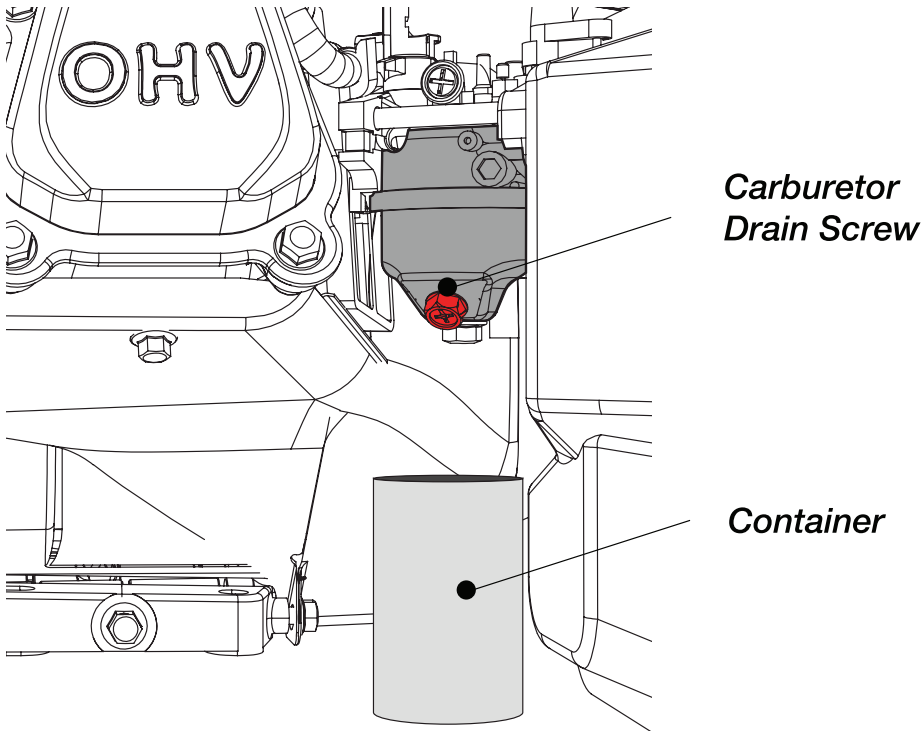

## Disconnecting the Electric Start Battery

1. disconnect red cable from the positive battery terminal
2. disconnect black cable from the negative battery terminal. Refer to figure
3. Store the battery upright in a dry, approximately room temperature environment on a scrap piece of wood or plastic shelf. Recharge it once a month.

## 6.0 Troubleshooting

Common issues can be fixed by following the instructions in this guide. If the unit will not function after following these instructions, contact technical support before attempting to use or repair the product.

ISSUE	CAUSE	ACTION
Engine cranks slowly	Engine oil is too heavy	Replace with recommended oil
	Load is connected	Disconnect load while starting
Engine is not starting	No fuel	Refill fuel tank
	Fuel valve is closed	Fully open fuel valve
	Fouled spark plug	Remove, clean or replace spark plug
	Not enough oil	Add more oil
Black exhaust	Choke stuck in closed position	Open choke
	Dirty air filter	Clean air filter
	Rich fuel mixture	Contact customer service
Engine stops	No fuel	Refill fuel tank
	Not enough oil	Add more oil
Engine has difficulty idling	Loose spark plug cable	Reconnect or repair cable
	Faulty spark plug	Remove, clean or replace spark plug
	Generator set not level	Move generator to a level surface
	Dirty fuel filter	Replace the filter
No AC Output	Tripped AC circuit breaker	Remove all loads, reset breaker and check loads for defects. Do not exceed generator rating.
No Electric Start or DC Charge Output	Corroded battery posts	Clean battery posts
	Battery cable is bad	Replace cable
	Battery is defective	Check condition, replace if defective
	DC terminals on the unit are defective	Contact an authorized service dealer

# Chapter 7- Specifications

EZG7250		
GENERATOR	Rated frequency (Hz)	60Hz
	Rated AC Output Power (W)	6500W
	Max AC Output Power (W)	7250W
	1-Phase Rated AC Voltage (V)	120V/240V
	Power Factor	1.0
ENGINE	Type	11.97 HP, Single Cylinder, forced air cooling, 4-stroke, OHV
	Displacement (cm³)	420cc
	Ignition mode	Transistor Controlled Ignition
	Starting mode	Recoil Start, Electric Start
	Max. Output (W/rpm)	7250/3600
	Fuel tank capacity	29L 25L (CA model)
	Oil capacity	1.1L (10W30)
	Fuel Type	Unleaded gasoline
	Running Volume	85dB (at 7m)
	Running Time Per Tank (hours)	10hrs with 75% load
BOX	L x W x H	713mm x 550mm x 590mm
	Gross Weight	98kg 99kg (CA model)
BAT.	Battery Size	12V 9Ah

Allow engine to rest for 30 minutes before starting another running cycle.

# Chapter 8- Wiring Diagram

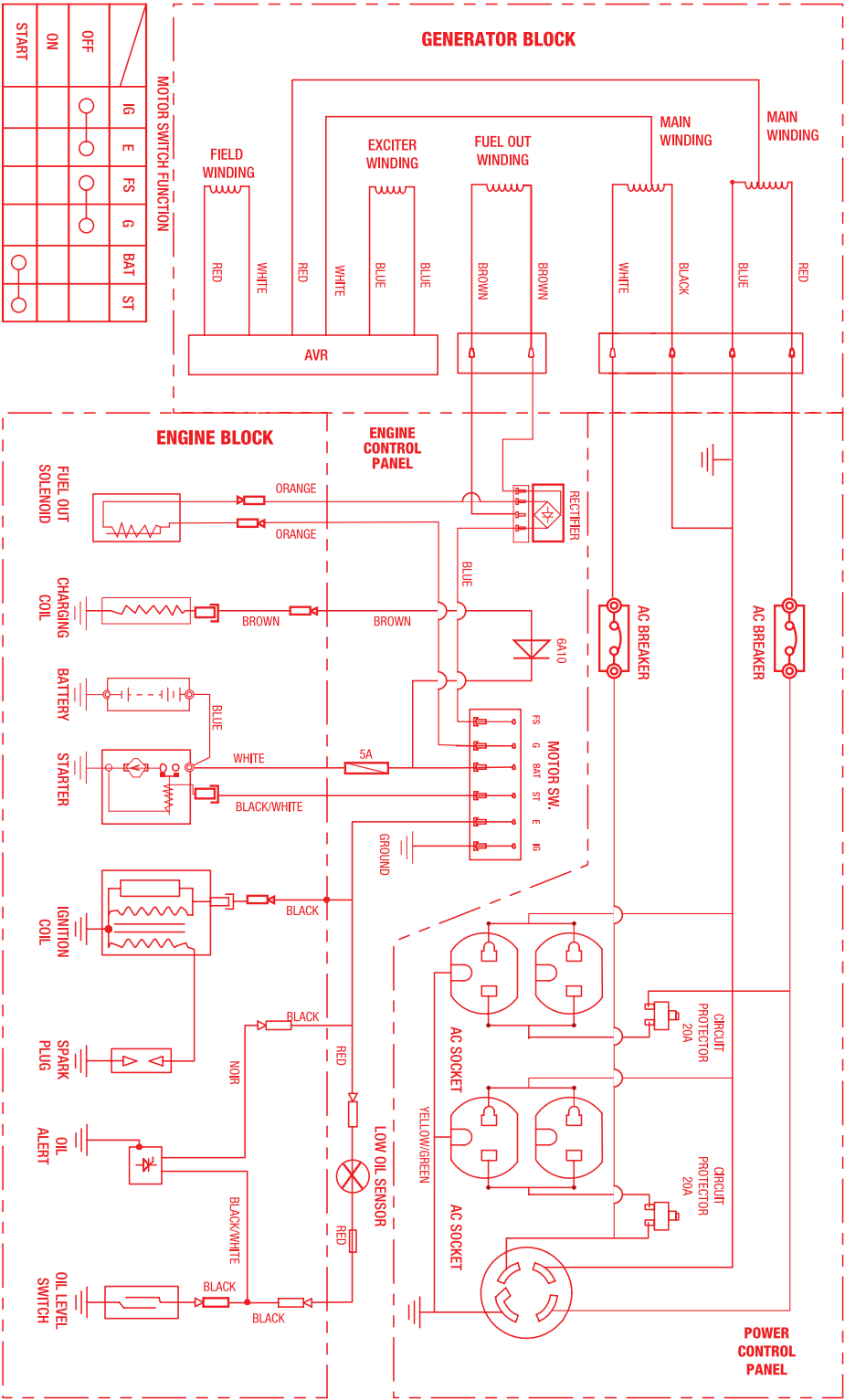

## Chapter 9 - Learn About your Warranty

Energizer Power Equipment Customer Support Center

Toll Free: 1-877-528-3772

E-mail: [support@energizergenerators.com](mailto:support@energizergenerators.com)

Online: [www.energizergenerators.com](http://www.energizergenerators.com)

### **ENERGIZER POWER EQUIPMENT PRODUCTS ARE DISTRIBUTED BY:**

Midland Power Inc. Product Registration

376 Magnetic Drive, Toronto, ON, M3J 2C4, Canada

This product is warranted to be free of defects in material and workmanship for two years from date of purchase. This warranty guarantees that any defective parts will be repaired or replaced at no cost, including diagnosis and replacement parts.

### **LIMITED WARRANTY PERIODS**

Recreational and Residential use: Two Years Limited

- 1<sup>st</sup> Year: Parts and Labor
- 2<sup>nd</sup> Year: Parts only

Commercial use: 6 months limited, parts and labor

This limited warranty begins at the initial time of retail purchase and covers manufacturer's defects caused by a defect in components or workmanship during the three (3) Year period. The warranty coverage is continual from the initial date of purchase and does not restart at anytime under any circumstances. This limited warranty is valid for residential or recreational applications only and only when the generator receives all necessary preventative maintenance as described in the Energizer Generators User Guide. The repair or replacement of a generator will take place within a reasonable period of time during normal business hours. All repair and replacement parts shall be warranted for (90) days after the initial date of installation or purchase.

### **LIMITATION OF REMEDIES AND DISCLAIMERS**

Midland International Inc. disclaims any responsibility for loss of time or use of the generator in a recreational vehicle or any vehicle in which the generator is installed, transportation, commercial loss, or any other incidental or consequential damage.

Any implied warranties are limited to the duration of this written warranty. **THE**

**FOREGOING LIMITED WARRANTY IS EXCLUSIVE OF AND IN LIEU OF ALL**

## **OTHER WARRANTIES OF MERCHANTABILITY, FITNESS FOR A PARTICULAR PURPOSE AND OF ANY OTHER WARRANTY WHETHER EXPRESS OR**

**IMPLIED.** Consumable parts, such as oil or fuel filters, fuel cut off valve, brushes, fuel injection nozzle valve, lubricant, or ignition plug, are not covered under this warranty. All expenses incurred in maintaining and replacing parts for generator shall fall on the purchaser. This warranty coverage does not include parts affected by accident and/or collision, corrosion or rust, normal wear, incorrect fuel type or fuel contamination, use in an application for which the product was not intended, unauthorized service, or any other misuse, neglect, incorporation or use of unsuitable attachments or parts. Damage to voltage regulators caused by failure to ground, shorting or overloading will not be covered under this warranty. Under this Warranty, we do not have the obligation to bear any transportation fees of any product to/from an authorized Warranty Center. Unauthorized alteration, installation or any cause other than defects in material or workmanship of the product will not be covered under the warranty.

## **EXCLUSIONS NOT COVERED BY THIS LIMITED WARRANTY**

1. Normal engine/alternator wear
2. Damage caused by lack of maintenance as described in the Energizer User Guides, or negligence by using improper or impure motor oil, coolant, or fuel
3. Damage caused by accidents, improper installation or storage;
4. Damage caused by water ingestion, submersion, or external water damage
5. Damage or non-performance caused by operation of the generator set in a marine application
6. Damage caused by operation with improper fuel, or at speeds, loads, conditions, or modifications contrary to published specifications.
7. Items not supplied by Energizer, including, but not limited to, starting batteries, battery cables, external wiring, fuel lines, filters, etc;(refer to exclusions)
8. Repairs made during the warranty period, without first obtaining a case number from Energizer

Batteries supplied with any generator product should be considered a bonus item and not covered by warranty. Batteries can be damaged by shock, shorting terminals, heat, acid spillage and a number of other factors that cannot be controlled after they have left our facility. It is the customer's responsibility to take great care when handling a battery so no spillage of acid will occur and cause corrosion; damage caused by battery acid is not covered under this warranty.

**EMISSION CONTROL SYSTEM WARRANTY PARTS:**

<b>SYSTEMS COVERED IN WARRANTY</b>	<b>PARTS DESCRIPTION</b>
Fuel Metering	Carburetor assembly (includes starting enrichment system), Engine temperature sensor, Engine control module, Fuel regulator, Intake manifold
Evaporative	Fuel Tank, Fuel Cap, Fuel Hoses, Vapor Hoses, Carbon Canister, Canister Mounting Brackets, Fuel Strainer, Fuel cock, Fuel Pump, Fuel Hose Joint, Canister Purge Hose Joint
Exhaust	Catalyst, Exhaust Manifold
Air Induction	Air filter housing, Air filter element
Ignition	Flywheel magneto, Ignition pulse generator, Crankshaft position sensor, Power coil, Ignition coil assembly, Ignition control module, Spark plug cap, Spark plug
Crankcase Emission Control	Crankcase breather tube, Oil filler cap
Miscellaneous Parts	Tubing, fittings, seals, gaskets, and clamps associated with these listed systems

Note: This list applies to parts supplied by Midland Power Inc. and does not cover parts supplied by the equipment manufacturer. Please see the original equipment manufacturer’s emissions warranty for non-Midland Power Inc. parts.

\*\*Consumable parts are covered up to a maximum of 30 days. See the Maintenance Schedule in the owner’s manual.

## Warranty Claim Procedure:

Warranty service must be performed by one of our authorized service dealers. If you feel your generator is malfunctioning due to a defect or misuse, simply contact our customer support center for technical advice, a warranty claim or general information.

Warranty service, operation assistance and product support is provided by Energizer. Contact us at the following numbers.

## PRODUCT REGISTRATION

Product registration is required for product support and warranty coverage. The owner's registration found in the user manual can be completed and mailed. You can also register Online at [www.energizergenerators.com](http://www.energizergenerators.com).

Proof of purchase may be required for warranty claims. Keep a copy of the original receipt, UPC code and serial number with this manual.

## Customer Service

1-877-528-3772 (toll-free)

[www.energizergenerators.com](http://www.energizergenerators.com)

## OUR WARRANTY RIGHTS AND OBLIGATIONS:

**California:** The California Air Resources Board and Midland Power Inc. are pleased to explain the emission control system warranty on your Midland Power Inc. engine. In California, new spark-ignited small off-road equipment engines must be designed, built, and equipped to meet the State's stringent anti-smog standards.

**Other States, U.S. territories, and Canada:** In other areas of the United States and in Canada, your engine must be designed, built, and equipped to meet the U.S. EPA and Environment Canada emission standards for spark-ignited engines at or below 19 kilowatts.

**All of the United States and Canada:** Midland Power Inc. must warrant the emission control system on your power equipment engine for the period of time listed below, provided there has been no abuse, neglect, or improper maintenance of your power equipment engine. Where a warrantable condition exists, Midland Power Inc. will repair your power equipment engine at no cost to you including diagnosis, parts, and labor. Your emission control system may include such parts as the carburetor or fuel injection system, the ignition system, and catalytic converter. Also included may be hoses, connectors, and other emission-related assemblies.



Warranty Registration Instructions:

Ownership must be registered with Energizer Power Equipment in order to ensure continued warranty and service support.

Please fill out the registration card below and mail it along with a copy of your receipt, and the original UPC barcode from your product packaging. The store, date of purchase and product purchase should be clearly visible on the receipt copy. You may also register online by visiting our website: [www.energizergenerators.com](http://www.energizergenerators.com)

If you wish, you can confirm your registration by calling customer service at or by email at [support@energizergenerators.com](mailto:support@energizergenerators.com). Please allow one week for mail delivery and processing.

PLEASE MAIL ALL ITEMS TO:

Midland Power Inc. Product Registration  
376 Magnetic Drive, Toronto, ON, M3J 2C4, Canada



Warranty Registration Card

Existing Owner Information

First NameLast NameCompany

Street Name and NumberCity

Postal/Zip CodeProvince/StatePhone Number

Other Contact NumberFax NumberEmail

Product Information

eZG7250

Model Name

Serial Number ( can be found on the Generator, or on the exterior of the packaging.)

YYYY / MM / DD

Initial Date of Purchase

YYYY / MM / DD

Warranty Expiration

Add 2 years to initial date of purchase

YYYY / MM / DD

Date of Transfer

39

eZGseries



Ownership and Warranty Transfer Instructions:

Changes in ownership must be registered with Energizer Power Equipment in order to ensure continued warranty and service support. Warranty support cannot be provided without registration (from original date of purchase and after transfer of ownership) This transfer form must be completed on or before the date that ownership change takes effect. Warranty coverage continues from original date of purchase and is not extended by transfer of ownership.

**Energizer**

Transfer of Ownership and Warranty

Existing Owner Information

First Name

Last Name

Company

Street Name and Number

City

Postal/Zip Code

Province/State

Phone Number

Other Contact Number

Fax Number

Email

New Owner Information

First Name

Last Name

Company

Street Name and Number

City

Postal/Zip Code

Province/State

Phone Number

Other Contact Number

Fax Number

Email

Product Information

The serial number can be found on the Generator, or on the exterior of the packaging.

eZG7250

Model Name

Serial Number

YYYY / MM / DD

Initial Date of Purchase

YYYY / MM / DD

Warranty Expiration

Add 2 years to initial date of purchase

YYYY / MM / DD

Date of Transfer

NOTE: Transfer of ownership does not act as a warranty extension. The original 2-Year Warranty is effective as of the Initial Date of Purchase and continues after ownership has transferred. New owners should be made aware of expired or remaining coverage.

41

eZGseries

**Enjoy!**

Be sure to check [energizergenerators.com](http://energizergenerators.com) monthly for updates regarding your generator.

***Energizer***®  
**eZG**series

***Energizer***®

TM