

WhiteWing™ II

Steam Cleaning System



INSTRUCTION MANUAL

THE WHITEWING™ II STEAM CLEANING SYSTEM INSTRUCTION MANUAL

CONGRATULATIONS

We would like to thank you, and congratulate you for purchasing the ultimate steam cleaner from WhiteWing™ II.

Dry vapor steam cleaning can deep clean and sanitize your home safely and effectively. Vapor steam is effective for killing dust mites, bacteria and mildew. It's perfect for cleaning, sanitizing and deodorizing all the rooms in your house, particularly bathrooms and the kitchen. For family members with chemical sensitivities, vapor steam cleaning is a great way to keep the house clean without using potentially harmful chemicals. Birdcages, aquariums, and pet areas; upholstery, drapery, & bedding are all made cleaner and safer for you, your family and your pets when you clean with vapor steam.

For your safety and to fully enjoy the advantages of this product, please take a few minutes to read all the important safeguards and care instructions. Keep this manual handy and review the product warranty card for your reference.

Note: your new steam cleaner may contain small amounts of water as all are factory tested prior to shipping.

IMPORTANT SAFETY INSTRUCTIONS

When using your WhiteWing™ II steam cleaner, basic safety precautions should always be followed. Please read the following instructions carefully as they provide important information concerning how to install, use and care for this steam cleaner.

- Use the steam cleaner only for its intended use.
- To protect against a risk of electric shock, do not immerse the steam cleaner in water or any other liquids.
- The steam cleaner should always be turned OFF before plugging it into or unplugging from a wall outlet. Never pull the power cord to disconnect from the outlet; instead grasp the plug and pull to disconnect.
- Do not let the power cord touch hot surfaces. Let the steam cleaner cool completely before putting it away. Wrap the power cord around the posts that are positioned in the rear of the steam cleaner when not in use.
- Do not operate the steam cleaner with a damaged cord, plug, or if the steam cleaner has been dropped or damaged. This will void any and all warranties. Please contact the place of purchase for repair procedure.
- Close supervision is necessary for any appliance being used by or near children. Do not leave the steam cleaner on while unattended.
- Do not use this unit in the presence of explosive and/or flammable fumes.
- Keep ventilation slots free from dust.
- Never drop or insert any object into ventilation slots
- To prevent overheating, unravel the electrical cord completely.
- Do not operate where aerosol (spray) products are being used or where oxygen is being administered.
- To disconnect, turn all controls to the off position, then remove plug from the main power.
- Never put away your steam cleaner while it is still hot. There is no need for emptying the tank unless you intend to leave it unused for a long period of time.
- This product is intended for household use only. Follow all user instructions in this manual.

ELECTRICAL INSTRUCTIONS

To avoid a circuit overload, do not operate another high-wattage appliance on the same circuit simultaneously with the steam cleaner. If an extension cord is necessary, a 15-amp rated cord with a polarized plug should be used. Cords rated for less may overheat and cause damage.

POLARIZED PLUG

This steam cleaner uses a polarized plug (one blade is wider than the other). As a safety feature, this plug will fit into a polarized outlet only one way. If the plug does not fit fully into the power outlet, reverse the plug. If it still does not fit, contact a qualified electrician. Do not attempt to defeat this safety feature.

WATER INSTRUCTIONS

Your steam cleaner has been planned for use with normal tap water. In order to extend the life of this product, if where you are living the level of water hardness is very high, we recommend using 50% of normal water with 50% of distilled water.

TEST FIRST, THEN CLEAN

Prior to cleaning, test the surfaces to be steam cleaned. We will not assume any responsibility where damage is done due to not testing first or misuse of the machine.

DESCRIPTION OF THE STEAM CLEANER

1. Plastic body
2. Water tank cap
3. Handle
4. Wheels
5. Steam ready light
6. Steam volume control
7. Flexible pipe connection outlet
8. Flexible hose plug
9. Low water level indicator light
10. Pressure gauge
11. General (boiler) on/off switch
12. Power supply cord with plug

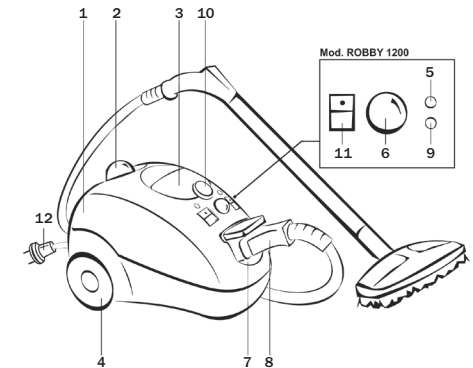

ACCESSORIES WITH STEAM CLEANER

13. Flexible hose with handle
14. Steam output switch I/O
15. Extensions (2 pieces)
16. Floor cleaning brush
17. Triangular brush
18. High pressure nozzle
19. Nylon-bristled brush
20. Brass-bristled brush
21. Squeegee
22. Funnel
23. Scraper
24. Angle adapter *

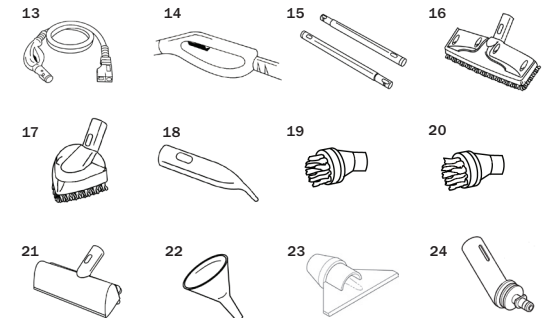

* SHIPS ATTACHED TO THE FLOOR CLEANING BRUSH (16)

HOW TO USE YOUR STEAM CLEANER

1. Remove the water tank cap (2), and fill the tank (2) up to a maximum of 1.2 quarts of water (1.2 quarts, 1.2L or 5 cups). Securely replace the cap until snug.
2. Connect the electrical cord (12) to the main power outlet.
3. Connect the flexible tube (13) to the appropriate accessory that you wish to use.
4. Turn the main switch (11) on. The ready light will come on when the unit reaches operating pressure. Approximately 10 minutes.
5. Condensation may build up in the hose when steam activation is paused. To release condensation before steaming, simply press the steam output switch (14) and direct the condensation that is emitted away from the surface to be cleaned.
6. During use, the orange steam ready light (5) will alternatively turn on and off. This is normal, and indicates that steam is being generated in the boiler.
7. Before storage you must release the steam. First turn off the power (11) switch. To release the steam simply depress the steam trigger on the steam output switch (14). Unplug the machine. Store.
8. It is safe to leave water in the pressure tank when the steam cleaner is not in use. If it is for an extended period of time (months) then it is best to flush out the remaining water. To do so, follow the water removal instructions as outlined in the maintenance of the boiler section.

WARNING: Never unscrew the water tank cap (2) while the machine is in use. Make sure that steam is not under pressure before opening the water cap. Before refilling the machine WAIT for it to cool down.

THIS MODEL IS PROVIDED WITH THE FOLLOWING FEATURES

RED CONTROL LIGHT (9)

A red warning light signals that the water needs to be refilled. If you wish to continue steam cleaning, see the “filling your tank” instructions.

STEAM REGULATION (ON FRONT OF UNIT)

With the steam volume control, it is possible to select the steam quantity that you wish during your cleaning from minimum to maximum.

PRESSURE GAUGE (10)

The pressure gauge indicates the operating pressure of the steam cleaner. If the needle is in the green section, the product is operating normally. If the needle is continuously in the red section, the steam cleaner may require service. Please contact the place of purchase for service.

USING THE ACCESSORIES

CONNECTING THE ACCESSORIES

Insert the plug at the opposite end of the steam gun/hose (13) to the connecting outlet (7) all the way, making sure it cannot be pushed in further. Connect the handle of the steam gun (14) to the extension tubes (15), pressing the locking button lightly until the button snaps in. All the accessories are connected the same way.

The angle adapter (24) is used for the squeegee (21) and triangular (17) brush in the following way: hold the brush in one hand with the bristles pointing down while with the other hand inserts the angle adapter into the brush pointing it downward.

TRIANGULAR/UPHOLSTERY BRUSH

The triangular brush is used where it is impossible or awkward to use the large brush.

UPHOLSTERY, DRAPERY, BEDDING, ETC.

Cover the brush with a clean dry cloth. Use a rapid back and forth motion, making sure that you do not over saturate the material with steam.

IMPORTANT: Prior to cleaning do a color check in an area that is not easily seen before you begin cleaning. WhiteWing™II is not responsible when these guidelines are not followed completely.

SQUEEGEE

The squeegee makes the cleaning and degreasing of windows easy. Attach the squeegee and steam clean while removing the dirt with the scraper.

CAUTION: During cold weather, warm up the windows with the window cleaner from a 2"-4" distance and with very little steam flow before starting the actual cleaning (to prevent possible damage to the window).

HIGH PRESSURE NOZZLE WITH SMALL ROUND BRUSH (NYLON & BRASS)

The high-pressure nozzle can be used with or without one of the small round brushes supplied with the steam cleaner. For items that are particularly prone to scratches, it is best to use the nozzle without a brush. For all other areas, start with the nylon brush (least abrasive) and carefully work your way up to the brass, then the stainless steel brush (optional). It is always better to use care when using the brushes to prevent damage or scratching.

The use of the steam nozzle alone is particularly good for cleaning and degreasing many working surfaces, ventilation hoods, see through oven doors, ventilation grating, kitchen furniture, stainless steel or enamel sinks, hand-basins, bath-tubs, water taps (to remove scale and water residue), doors, metal frames, car wheel rims, pet areas etc.

The nylon brush, because of its softness, is ideal for removing the dirt in grout, sinks and other surfaces where you need some light scrubbing action, but need to be careful not to scratch the surface.

Tougher cleaning jobs may require the use of the brass brush that is supplied. Please make sure you are careful that it does not scratch the surface with this tool. Brass is tougher than nylon, but softer than stainless steel. For surfaces (grout for example) where the dirt is not being properly lifted with the nylon brush, carefully using the brass brush may give the best results.

For the toughest cleaning assignments (very caked on grease, rust, barbeque grills, very dirty grout), we recommend that you purchase the optional stainless steel brush that is available through your dealer.

When using the steam nozzle with or without the brushes, you will need a cloth to wipe up the moisture and dirt that has been lifted through cleaning.

FILLING THE TANK

If the (low) water level control light (9) comes on during usage, and you would like to continue using the steam cleaner, you will need to follow the following steps:

1. Turn the main switch (11) to the off position.
2. Hold the steam control on the handle (14) until all the steam has evacuated the steam cleaner.
3. It is now safe to open the water tank cap (2). Refill the steam cleaner with cool water, refasten the water tank cap, turn main switch (11) on and wait for the steam control light to turn on.

MAINTENANCE OF THE BOILER

To maintain your steam cleaner in good condition and to ensure constant performance, we recommend that you periodically clean the boiler once or twice a year depending on the hardness of the water.

CLEANING INSTRUCTIONS

ATTENTION: Please make sure that the boiler is at room temperature, that it has not been used for at least 8 hours, and that the boiler is disconnected from the power source.

1. Unscrew and remove the filling cap (2), turn the steam cleaner over and eliminate all water remaining in the boiler.
2. Dissolve completely the contents of a single package of de-scaling powder in 2 cups (0.5L) of water (sold separately).
3. Pour the solution into the boiler.
4. Leave the solution in the boiler for one night with the filling cap off.
5. Completely empty the contents of the boiler and rinse three or four times with water in order to eliminate possible residues of scale.
6. It is a good idea to spray the first steam onto a cloth and not directly on any surface since there still may be scale in the system.

ATTENTION: IT IS NOT RECOMMENDED THAT YOU USE ANY OTHER CHEMICAL TO CLEAN THIS PRODUCT. DOING SO WILL AUTOMATICALLY VOID THE WARRANTY.

ATTACHMENT COUPLINGS

If the attachment connections dry up after intensive use, put a small amount of lubricant (Vaseline) around the O-rings on the male attachment.

TECHNICAL DESCRIPTION

120V Power	1400W
Cold water tank capacity	1.2L, 1.2 quarts, 5 cups
Working pressure	3.5Bar or 51 PSI

REPLACEMENT & OPTIONS

WW2A30N

WW2A30B

WW2A30SS

WW2A30H

WW2ACLOTH2

WW2ATRIBRUSH

WW2ASCRAPER

WW2A EXTNOZZLE

WW2AWALL

WW2ABOTTLE

Other accessories are available by contacting www.allergybuyersclub.com.

TROUBLESHOOTING

Do not operate the steam cleaner with a damaged cord, plug or if the steam cleaner has been dropped or damaged. To avoid risk of electric shock, do not disassemble or attempt to repair the unit on your own. Return the unit to WhiteWing™II (see warranty) for examination, repair or replacement.

PROBLEM	POSSIBLE CAUSES	REMEDY
No steam is released through the steam fittings.	<ol style="list-style-type: none"> 1. Steam unit is not turned on. 2. Water tank is empty. 3. Unit is not plugged in. 4. Generator is not fully heated. 5. Hose not connected properly 	<ol style="list-style-type: none"> 1. Turn steam unit onto the 2nd position. 2. Put required amount of water into tank. 3. Plug unit into outlet. 4. Wait for light (5) to turn on. 5. Remove and reconnect the hose (you will hear a 'click' sound when it is securely fastened).
Drops of water leak from the attachments.	<ol style="list-style-type: none"> 1. Unit is not fully heated. 2. Condensation was created from non-use. 	<ol style="list-style-type: none"> 1. Wait for light (5) to turn on. 2. Let water run through system until steam comes out.
Dirty water is coming out.	<ol style="list-style-type: none"> 1. Scale may have built up. 	<ol style="list-style-type: none"> 1. Follow cleaning instructions in book.
Not enough steam pressure.	<ol style="list-style-type: none"> 1. The dial on the handle may be set too low. 	<ol style="list-style-type: none"> 1. Turn the dial until the desired pressure is reached.



WhiteWing™II warrants to original purchaser of its products that every product sold by WhiteWing™II (a "WhiteWing™II Product") is free from defects in material and workmanship for a period of one year from the date of purchase, if properly used and maintained. Subject to the conditions and limitations set forth below, WhiteWing™II will either repair or replace any part of a WhiteWing™II Product that proves defective by reason of improper workmanship or materials. If the defective WhiteWing™II Product is no longer available and cannot be repaired effectively or replaced with an identical model, WhiteWing™II shall replace the defective WhiteWing™II Product with a current WhiteWing™II Product of equal or greater value. Repaired parts or replacement products will be provided by WhiteWing™II on an exchange basis, and will be either new or refurbished to be functionally equivalent to new. If WhiteWing™II is unable to repair or replace a WhiteWing™II Product, it will refund the current value of that WhiteWing™II Product at the time the warranty claim is made.

This limited warranty does not cover any damage to a WhiteWing™II Product that results from improper installation, accident, abuse, misuse, natural disaster, insufficient or excessive electrical supply, abnormal mechanical or environmental conditions, wear and tear resulting from normal use of the product, or any unauthorized disassembly, repair, or modification. This limited warranty does not extend to any indirect, consequential or incidental damages that may be suffered by a user or from the use of a WhiteWing™II Product, including without limitation, any liability for third party claims for damage, and is limited to the amount paid by the original purchaser WhiteWing™II Product with respect to which this limited warranty protection applies. This limited warranty does not apply with respect to products that have been altered or which are missing serial numbers or for products not purchased directly from WhiteWing™II or a dealer authorized by us to sell WhiteWing™II Products.

This limited warranty is the only warranty that applies to any WhiteWing™II Product, supersedes any and all terms that may be contained in any other document or purchase order and may not be altered or amended except expressly in writing by WhiteWing™II.

To obtain a repair or replacement under the terms of this warranty, please contact our customer service group at 1-888-236-7231. You will be required to submit an original receipt via fax or e-mail. The receipt must reflect that you are the original purchaser, the product was bought directly from us or from an authorized WhiteWing™II dealer and that the warranty claim is being made within the warranty period. You will be issued a return authorization number (RA#) and asked to ship the defective product together with proof of purchase and RA#, prepaid insured to the following address:

Freight collect shipments will be refused. The risk of loss or damage in transit will be borne by the customer. Once WhiteWing™II receives the defective product, it will initiate the repair or replacement process.

if you have questions you may call:
1-888-236-7231
www.allergybuyersclub.com



1-888-236-7231
www.allergybuyersclub.com