

PACKING CONTENTS

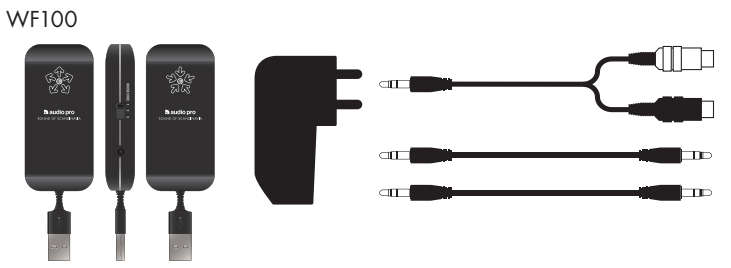

TX100 transmitter unit / RX100 receiver unit / USB AC power adaptor
2 x 3.5 mm stereo cable / 1 x Y-cable RCA to 3.5mm stereo



TX100 transmitter unit
1 x 3.5 mm stereo cable

RX100 receiver unit
1 x 3.5 mm stereo cable
1 x Y-cable RCA to 3.5mm stereo

MAC SETUP

1. Insert TX100 transmitter to a free USB socket
2. Go to System Preferences, choose Sound under Hardware.
3. Click Output in menu, choose "USB Headset"

Done! You can now send audio from your computer.

PC SETUP

Please do following setup before using music playing software (for example iTunes or Spotify).

1. Insert TX100 transmitter to a free USB socket. Wait until software has been installed. (See lower right hand corner, message window will open when sound device is ready to use.)
2. Click Start button, go to Control Panel and choose Sound & Sound devices.
3. Under playback of audio, default unit, choose "USB Headset".

Done! You can now send audio from your computer.

POWER SUPPLY

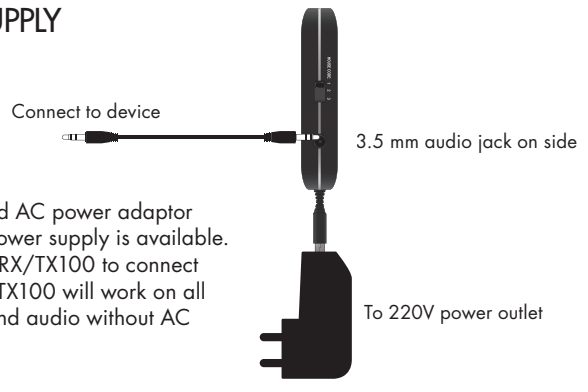

Use the enclosed AC power adaptor when no USB power supply is available. Use cable from RX/TX100 to connect to your device. TX100 will work on all computers to send audio without AC adaptor.

FEATURES

- Wireless full CD quality sound
- Robust and dedicated network for your audio
- Easy setup, get wireless music in seconds
- Wireless range room to room: Up to 20 meters
- Wireless range same room: Up to 50 meters
- Wireless range open field: Up to 100 meters
- No interference or delays
- Time delay max 10ms
- Works with both Mac and PC
- Plug 'n play, no software needed
- Flexible multiroom possibilities
- RF band: 2.4GHz
- Sample rate: 44.1 KHz
- Dedicated proprietary protocol
- USB 2.0 interface



audio pro
SOUND OF SCANDINAVIA
www.audiopro.com
www.audiopro.se



WF100/RX100/TX100 WIRELESS HIFI TRANSMITTER AND RECEIVER

OWNERS MANUAL

audio pro
SOUND OF SCANDINAVIA

GENERAL SETUP

Setting up your wireless audio network is real simple. The transmitter and receiver need power, either through a USB socket or AC adaptor power supply. RX100 receiver will need the supplied power adaptor for power. Connect WF100 to any device with audio input or output. Just try your devices, it will work. You may need to go to a retailer for some additional cables.

(USB 2.0 input on receivers and other devices is not recommended to plug RX100 to as it may cause noise and interference.)

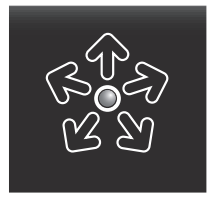

TRANSMITTER
The TX100 is the transmitter. It sends the audio signal. Connect to device which you want to play from. LED lights up blue when wireless connection is established. LED lights up red when no wireless connection is established



RECEIVER
The RX100 is the receiver. It receives the audio signal. Connect to the device you want to listen from. LED lights up blue when wireless connection is established. LED lights up red when no wireless connection is established

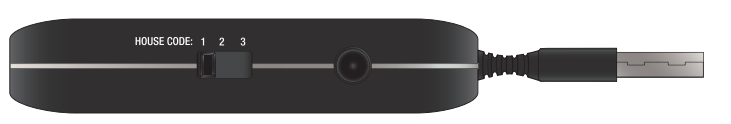

HOUSE CODE
With the unique feature of House Codes, you can have up to three transmitters in one house, and as many receiver on each House Code as you want. Perfect when the household want to listen to different wireless music sources.

TROUBLESHOOTING

- NO WIRELESS CONNECTION:**
1. Make sure corresponding House Code is the same on TX100 and RX100.
 2. Receiver is out of range from transmitter.

When wireless connection is established on same House Code, LED on both transmitter and receiver will go blue. If no connection, LED goes red.

- WIRELESS CONNECTION, BUT NO SOUND**
1. Make sure to choose correct source on receiving device.
 2. Check your audio source output is correct on transmitting device.

- POWER SUPPLY:**
1. Make sure both transmitter and receiver has power supply. Check all connections and cables.

- COMPUTER**
- Mac: Make sure you have chosen correct sound output. See "Mac Setup".
 - PC: Make sure you have chosen correct sound output unit. See "PC Setup".

1. Read these instructions.
2. Keep these instructions.
3. Heed all warnings.
4. Follow all instructions.
5. Do not use this apparatus near water.
6. Clean only with dry cloth.
7. Do not block any ventilation openings. Install in accordance with the manufacturer's instructions.
8. Do not install near any heat sources such as radiators, heat registers, stoves, or other apparatus that produce heat.
9. Protect the power cord from being walked on or pinched particularly at plugs, convenience receptacles, and the point where they exit from the apparatus.
10. Only use attachments/accessories specified by the manufacturer.
11. Unplug this apparatus during lightning storms or when unused for long periods of time.
12. Refer all servicing to qualified service personnel. Servicing is required when the apparatus has been damaged in any way, such as power-supply cord or plug is damaged, liquid has been spilled on or objects have fallen into the apparatus, the apparatus has been exposed to rain or moisture, does not operate normally, or has been dropped.
- IMPORTANT SAFETY INSTRUCTIONS**
- The lightning flash with arrowhead symbol, within an equilateral triangle, is intended to alert the user to the presence of unshielded "dangerous voltage" to the presence of unshielded "dangerous voltage" ELECTRIC SHOCK, DO NOT EXPOSE THIS APPARATUS TO RAIN OR MOISTURE.
- sufficient magnitude to constitute a risk of electric shock to persons.
- WARNING:** TO REDUCE THE RISK OF FIRE OR TO REDUCE THE RISK OF ELECTRIC SHOCK, DO NOT REMOVE COVER (OR BACK). NO USER-SERVICEABLE PARTS INSIDE. REFER SERVICING TO QUALIFIED SERVICE PERSONNEL.
- The exclamation point within an equilateral triangle is intended to alert the user to the presence of important operating and maintenance (servicing) instructions in the literature accompanying the appliance.
- CAUTION:** TO REDUCE THE RISK OF ELECTRIC SHOCK, DO NOT REMOVE COVER (OR BACK). NO USER-SERVICEABLE PARTS INSIDE. REFER SERVICING TO QUALIFIED SERVICE PERSONNEL.
1. Damage Requiring Service
- Unplug the apparatus from the wall outlet and refer servicing to qualified service personnel under the following conditions:
- A. When the power-supply cord or plug is damaged,
- B. If liquid has been spilled, or objects have fallen into the apparatus,
- C. If the apparatus has been exposed to rain or water,
- D. If the apparatus does not operate normally by following the operating instructions. Adjust only those controls that are covered by the operating instructions as an improper adjustment of other controls may result in damage and will often require extensive work by a qualified technician to restore the apparatus to its normal operation,
- E. If the apparatus has been dropped or damaged in any way, and
- F. When the apparatus exhibits a distinct change in performance this indicates a need for service.
14. Object and Liquid Entry
- Never push objects of any kind into the apparatus through openings as they may touch dangerous voltage points or short-out parts that could result in a fire or electric shock. The apparatus shall not be exposed to dripping or splashing and no objects filled with liquids, such as vases shall be placed on the apparatus. Don't put candles or other burning objects on top of this unit.
15. Batteries
- Always consider the environmental issues and follow local regulations when disposing of batteries.
16. If you install the apparatus in a built-in installation, such as a bookcase or rack, ensure that there is adequate ventilation. Leave 20 cm (8") of free space at the top and sides and 10 cm (4") at the rear. The rear edge of the shelf or board above the apparatus shall be set 10 cm (4") away from the rear panel or wall, creating a flue-like gap for warm air to escape.
17. This device has no mains switch. To disconnect this device from mains supply, the power cord must be disconnected.
18. The power supply and power cord for this apparatus is intended for indoor use only.
19. Only use the enclosed A/C adaptor.

IMPORTANT SAFETY INSTRUCTIONS CONTINUED



CONFIGURATIONS

FROM COMPUTER TO POWERED SPEAKERS

EXAMPLE: AUDIO PRO ADDON ONE & THREE

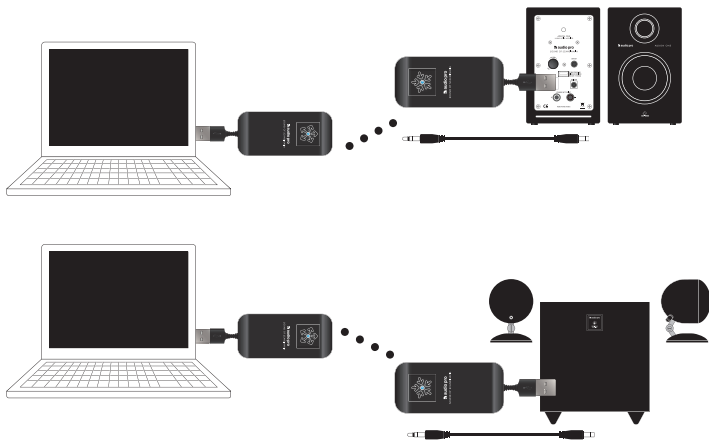

Before connecting to computer, see Mac or PC setup.

1. Connect the TX100 transmitter to the computer.
2. Connect the RX100 receiver to the USB power supply on Addon One or Addon Three
3. Connect the supplied 3.5 stereo cable to the Line in input on Addon One or Addon Three.
4. Play your music on your computer.

Note:

This setup works on all powered speakers. Connect the RX100 receiver to the supplied power adaptor instead of a USB power supply.

FROM COMPUTER TO STEREO

EXAMPLE: AUDIO PRO DVD ONE & STEREO ZERO

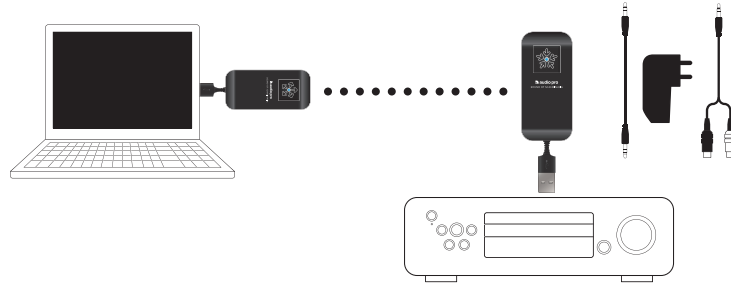

Before connecting to computer, see Mac or PC setup.

1. Connect the TX100 transmitter to the computer.
2. Connect the RX100 receiver to external USB power supply.
3. Connect enclosed cables to a Line input or AUX input.
4. Choose source to which you have connected cables. Play your music on your computer.

Note:

This setup works on all receivers and amplifiers. Connect the RX100 to any AUX input. Use the supplied RCA to 3.5 mini-jack Y cable. (you need a RCA extension cable, not supplied.) Connect the RX100 receiver to the supplied power adaptor, or aftermarket power adaptor.

FROM COMPUTER TO POWERED WIRELESS SPEAKERS

EXAMPLE: AUDIO PRO LV2

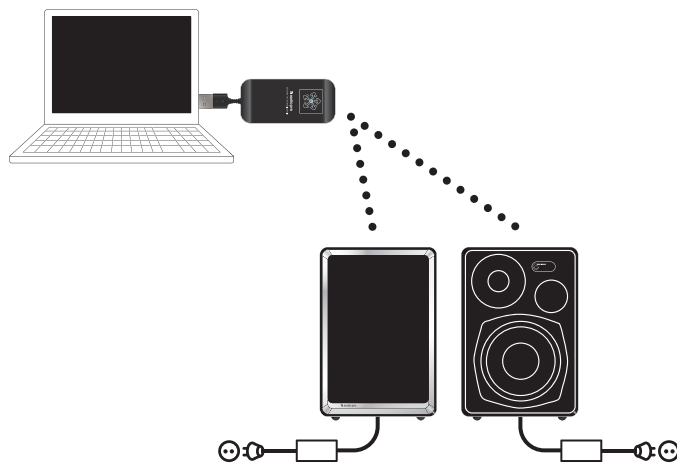

Before connecting to computer, see Mac or PC setup.

1. Connect the TX100 transmitter to the computer.
2. Play your music on your computer.

Note:

Audio Pro LV2 is an advanced fully powered digital speaker with built-in wireless receiver. LV2 is remote controlled and has added features such as zone volume control (up to 3 zones). LV2 can be mixed in an existing WF100 audio network and handles House Codes.

STEREO TO POWERED SUBWOOFER

EXAMPLE: AUDIO PRO B1.19, B1.29 & B1.40

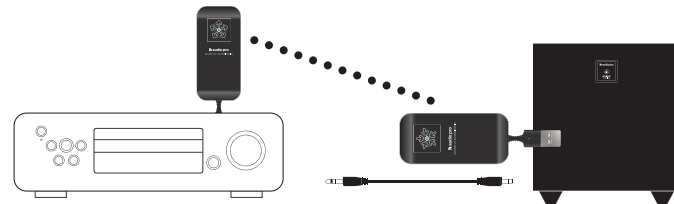

1. Connect the TX100 transmitter to the power adaptor.
2. Plug a 3.5 mm stereo/RCA cable to the SUB out and into the TX100.
3. Connect the RX100 receiver to the USB power supply on subwoofer.
4. Connect RX100 to the subwoofer line in input with appropriate cable.

Note:

This setup works on all powered subwoofers. Some Audio Pro subwoofer has the USB power supply built-in, but if your subwoofer doesn't have this feature, just use a aftermarket USB AC adaptor to power the RX100 receiver.

MAKE ANY DEVICE WIRELESS

HEADPHONES & AUDIO OUT

TV
RADIO
IPOD
MP3-PLAYER
CELLPHONE
GAME CONSOL
NETWORK PLAYER
STEREO RECEIVER



LINE IN & AUX IN

POWERED SPEAKERS
POWERED SUBWOOFER
STEREO RECEIVER
HOME THEATER RECEIVER

Use the WF100 in any configuration with all devices which has headphones out or Audio out. And connect to any device which has a AUX in or LINE in.

MULTIPLE RECEIVERS FROM ONE TRANSMITTER

EASILY ADD MORE RECEIVERS TO GET WIRELESS AUDIO IN MORE ROOMS. OR MORE SPEAKERS IN SAME ROOM.

NO LIMIT ON NUMBER OF RECEIVERS WORKING FROM ONE TRANSMITTER.

As the WF100 dongles sets up a robust and secure audio network, all RX100 receivers with same House Code as the TX100 transmitter will work in the same network. This is a convenient way to add speakers to more rooms, or add more receivers connected to any other device. Let wireless music fill every room of your home.

Note:

Volume can be adjusted on the device where the TX100 transmitter is connected, or on the devices connected to the RX100 receiver. Please be careful on your receiving devices not to have too high volume, as this may damage the device.

TX100



RX100



MULTIPLE TRANSMITTERS AND RECEIVERS, USING HOUSECODE 1, 2 AND 3

A key feature on the WF100 is the ability to handle 3 house codes. This means that the WF100 creates 3 separate audio networks and you can play from different sound sources to different loudspeakers or stereos/receiver amplifiers. This way a family can enjoy wireless sound from 3 different computers to 3 different active speakers/stereos at the same time with no interference.



HOUSECODE 1, 2 AND 3

On the side of each TX100 and RX100 is the House Code setting. Use same House code on the transmitter as on the receiver. They then create a separate audio network. And if you want one TX100 transmitter to play music on all RX100 receivers on your home, just switch House Code on receivers to match the transmitter.

