

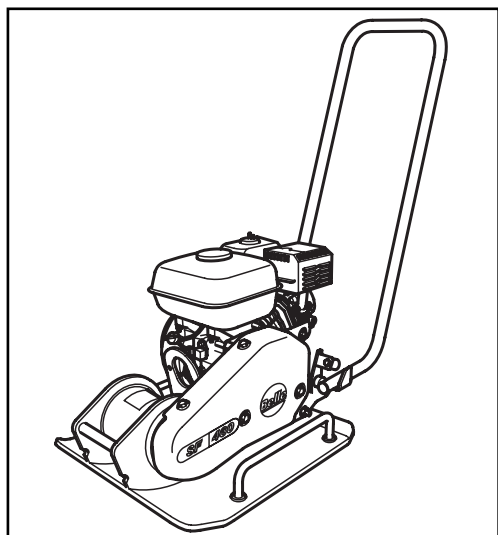

# SF460



- Spare Parts Book
- Pièces détachées
- Libro Despiece
- Lista de Peças
- Onderdelen Boekje
- Reservedele Skrift
- Ersatzteilhandbuch
- Manuale dei ricambi
- Bruksanvisning
- Bruksanvisning
- Varaosaluettelo
- Lista Części Zamiennych
- Запасные части Книга
- Varuosade nimekiri
- Rezerves daļu saraksts
- Atsarginiu daliu sarašas
- Част Списък
- Részek Oldalra dől
- Lista Pieselor de Schimb
- Rezervni djelovi Knjiga

216

(GB)	Operators Manual	6
(US)	Operators Manual	16
(F)	Manuel De L'Opérateur	26
(E)	Manual del Operador	36
(P)	Manual de Operação	46
(NL)	Handleiding	56
(DK)	Betjeningsvejledning	66
(D)	Bedienungshandbuch	76
(I)	Manuale Dell'Operatore	86
(S)	Bruksanvisning	96
(NO)	Betjene Håndbok	106
(SF)	Käyttöohje	116
(PL)	Instrukcja Obsługi	126
(RUS)	Руководство для оператора	136
(EST)	Kasutusjuhend	146
(LV)	Lietotāja rokasgrāmata	156
(LT)	Naudojimo Instrukcija	166
(BG)	Оператор Ръчен	176
(HUN)	Kezelők Kézi	186
(RO)	Manualul Operatorului	196
(HR)	Uputstvo za rukovatelja	206

# EC DECLARATION OF CONFORMITY / DECLARATION CE DE CONFORMITE / DECLARACIÓN DE CONFORMIDAD CE / DECLARAÇÃO CE DE CONFORMIDADE / EG-VERKLARING VAN OVEREENSTEMMING / EF OVERENSSTEMMELSESERKLÆRING

- (GB)** We, **Belle Group Sheen UK, Sheen, Nr. Buxton, Derbyshire, SK17 0EU, GB**, hereby certify that if the product described within this certificate is bought from an authorised Belle Group dealer within the EEC, it conforms to the following EEC directives: 98/37/EC (This directive is a consolidation of the original machinery directive 89/392/EEC), Electromagnetic Compatibility Directive 89/336/EEC (as amended by 92/31/EEC & 93/68 EEC). The low voltage directive 73/23/EEC, EN 292 Safety of machinery and associated harmonised standards, where applicable. Noise emissions conform to directive 2000/14/EC Annex VI, for machines under article 12 the notified body is **AV Technology Limited, AVTECH house, Birdhall Lane, Cheadle Heath, Stockport, Cheshire, SK3 0XU, GB**.
- (F)** Nous soussignons, **Belle Group Sheen UK, Sheen, Nr Buxton, Derbyshire, SK17 0EU, GB**, certifions que si le produit décrit dans ce certificat est acheté chez un distributeur autorisé Belle Group au sein de la CEE, il est conforme aux normes CEE ci-après: 98/37/CE (Cette norme est une codification des normes de la machine d'origine 89/392/CEE), Norme compatible pour l'électromagnétisme 89/336/CEE (modifié par 92/31/CEE et 93/68/CEE). Caractéristiques basse tension 73/23/CEE, EN 292, Norme de sécurité des machines et des critères associés et configurés, si applicable. Les émissions de bruit sont conformes à la directive 2000/14/CE Annexe VI pour machines, article 12, l'objet mentionné est **AV Technology Limited, AVTECH House, Birdhall Lane, Cheadle Heath, Stockport, Cheshire, SK3 0XU, GB**.
- (E)** La Sociedad, **Belle Group Sheen UK, Sheen, Nr. Buxton, Derbyshire, SK 17 0EU, GB**, por el presente documento certifica que si el producto descrito en este certificado es comprado a un distribuidor autorizado de Belle Group en la CEE, este es conforme a las siguientes directivas: 98/37/CE de la CEE (Esta directiva consolida la directiva inicial sobre maquinaria 89/392/CEE), Directiva 89/336 CEE sobre Compatibilidad Electromagnética (según enmiendas 92/31/CEE y 93/68 CEE), Directiva sobre Bajo Voltaje 73/23/CEE, EN 292 de Seguridad de Maquinaria y Niveles armonizados estándares asociados donde sean aplicables. Emisión de Ruidos conforme a la Directiva 2000/14/CE Anexo VI para máquinas bajo artículo 12 la mencionada unidad está **AV Technology Limited, AVTECH House, Birdhall Lane, Cheadle Heath, Stockport, Cheshire, SK3 0XU, GB**.
- (P)** O signatário, **Belle Group Sheen UK, Sheen, Nr Buxton, Derbyshire, SK 0EU, GB**, pelo presente, declara que se o produto descrito neste certificado foi adquirido a um distribuidor autorizado do Belle Group em qualquer país da UE, está em conformidade com o estabelecido nas seguintes directivas comunitárias: 98/37/EC (esta directiva é uma consolidação da directiva de maquinaria original 89/392/EEC), Directiva de Compatibilidade Electromagnética 89/336/EEC (conforme corrigido pelas 92/31/EEC & 93/68 EEC). A directiva de baixa voltagem 73/23/EEC, EN 292 Segurança da maquinaria e às normas harmonizadas afins se aplicáveis. As emissões de ruído respeitam e estão dentro das directivas para máquinas 2000/14/EC Anexo VI, artigo 12, sendo o organismo notificado **AV Technology Limited, AVTECH house, Birdhall Lane, Cheadle Heath, Stockport, Cheshire, SK3 0XU, GB**.
- (NL)** Ondergetekende, **Belle Group Sheen UK, Sheen, Nr. Buxton, Derbyshire, SK17 0EU, GB**, verklaren hierbij dat als het product zoals beschreven in dit certificaat is gekocht van een erkende Belle Group dealer binnen de EEG, het voldoet aan de volgende EEG richtlijnen: 98/37/EC (Deze richtlijn is een opvolger van de originele Machinerichtlijn 89/392/EEG), Electromagnetische Compatibiliteit Richtlijn 89/336/EEG (geamendeerd door 92/31/EEG & 93/68 EEG). De Laagspannings Richtlijn 73/23/EEG, EN 292 Veiligheid van Machines en hieraan gekoppelde geharmoniseerde Standaarden, waar deze van toepassing is. Rumoe emissies passen voor richtlijn EC Zijgebouw VI, voor toestel onder stuk 12 naar de notified troep zit **AV Technology Limited, AVTECH house, Birdhall Lane, Cheadle Heath, Stockport, Cheshire, SK3 0XU, GB**
- (DK)** Vi, **Belle Group Sheen UK, Sheen, Nr. Buxton, Derbyshire, SK17 0EU, GB**, erklærer hermed, at hvis det i dette certifikat beskrevne produkt er købt hos en autoriseret Belle Group forhandler i EU, er det i overensstemmelse med følgende EØF-direktiver: 98/37/EF, 73/23/EØF (som ændret ved 93/68/EØF), 89/336/EØF (som ændret ved 92/31/EØF), 93/68/EØF og tilknyttede, harmoniserede standarder, hvor relevant. Støjniveauet er i overensstemmelse med direktiv 2000/14/EF, bilag VI gældende for maskiner under paragraf 12. Det bemyndigede organ er **AV Technology Limited, AVTECH house, Birdhall Lane, Cheadle Heath, Stockport, Cheshire, SK3 0XU, Storbritanien**.

PRODUCT TYPE .....	TYPE DE PRODUIT .....	TIPO DE PRODUCTO .....	TIPO DE PRODUTO: .....
MODEL .....	MODELE.....	MODELO .....	MODELO:.....
SERIAL No.....	N° DE SERIE .....	N° DE SERIE .....	NO. DE SÉRIE: .....
DATE OF MANUFACTURE...	DATE DE FABRICATION.....	FECHA DE FABRICACIÓN...	DATA DE FABRIC.....
SOUND POWER LEVEL..... MEASURED (GUARANTEED):	NIVEAU DE ..... PUISSANCE SONORE MESUREE (GARANTIE)	NIVEL DE ..... POTENCIA ACÚSTICA MEDIDO (GARANTIZADO)	NIVEL DE ..... POTÊNCIA DE SOM MEDIDO (GARANTIDO)

PRODUCTTYPE.....	PRODUKTTYPE.....
MODEL .....	MODEL .....
SERIENUMMER .....	SERIENR. ....
FABRICATEDATUM .....	FREMSTILLINGSDATO.....
GEMETEN .....	LYDEFFEKTNIVEAU .....
GELUIDSSTERKTENIVEAU (GEGARANDEERD)	MÅLT (GARANTERET)



Signed by:  
Signature:  
Medido por:  
Assinado por:  
Getekend door:  
Uunderskrevet af:

  
**Ray Neilson**

Managing Director - On behalf of BELLE GROUP (SHEEN) UK.  
Le Directeur Général - Pour le compte de la SOCIETE BELLE GROUP (SHEEN) UK.  
Director Gerente - En nombre de BELLE GROUP (SHEEN) UK.  
Director-Geral - Em nome de BELLE GROUP (SHEEN) UK.  
Algemeen Directeur - Namens BELLE GROUP (SHEEN) UK.  
Administrerende direktør - På vegne af BELLE GROUP (SHEEN) UK.



# Contents

General.....	16
Machine Plate.....	17
Technical data .....	17
Safety instructions (For all Light products).....	18 - 19
Safety when driving .....	20
Safety decals, Location/Description .....	21
Pre-Start Checks .....	21
Operation.....	21 - 22
Lifting, transportation and towing .....	22
Service & Maintenance .....	23 - 24
Fuel and lubricants .....	24
Warranty.....	25

Belle Group reserves the right to change machine specification without prior notice or obligation.



## Warning Symbols



### **CAUTION**

CAUTION Indicates danger or hazardous procedure that could result in damage to machine or property if the warning is ignored.



### **WARNING**

WARNING Indicates danger or hazardous procedure that could result in serious or fatal personal injury if the warning is ignored.



## Safety Instructions



### **WARNING**

The safety instructions are included in this manual and must be studied by the operator. Always follow the safety rules and keep the manual available for future use.



### **WARNING**

Read through the entire manual before starting any maintenance operations.



## General

It is important that the machine is maintained correctly to ensure proper function. It should be kept clean so that any leakage, loose bolts and loose connections can be discovered in time.

Make a habit of inspecting the machine every day before starting up by checking all round it to detect any sign of leakage or other faults.

### SPARE A THOUGHT FOR THE ENVIRONMENT!

Do not let oil, fuel and other environmentally hazardous substances contaminate the environment. Always dispose of used filters, drained oil and any remaining fuel properly.

This manual contains instructions for periodic attention which should normally be carried out by the operator.



### **CAUTION**

There are additional instructions relating to the engine, for which the manufacturer's instructions are detailed in the engine manual.

# Machine Plate



Fill in all data below, when delivering and commissioning the machine:

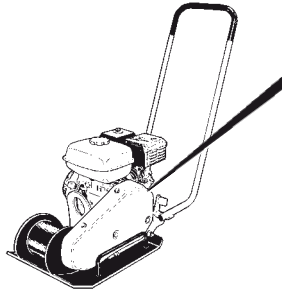

	MANUFACTURED BY: Belle Group UK Sheen, Nr. Buxton, Derbyshire, England, SK17 0EU www.bellegroup.com		
	YEAR MADE: <input type="text"/>	WEIGHT: <input type="text"/>	
MODEL TYPE: <input type="text"/>		SERIAL NO: <input type="text"/>	

Engine Model:..... Engine Number:.....

# Technical Data



		SF 460
Contact area, (sq feet)		1.90
Vibration frequency (Hz)		90
Vibration frequency (vpm)		5400
Centrifugal force, (lbf)		4.05
Amplitude, (in)		0.04
Speed of travel, (feet/min)		82
Max. tilt, °		66
Model	Honda GX160 4-Stroke Recoil start	Robin EY20 4-Stroke Recoil Start
Output, (hp)	5.5	5.0
Engine speed, rpm	3600	3600
Fuel tank, (qts)	3.8	4.0
Crank case, (qts)	0.65	0.65
Net weight, kg (lbs)	172	178
Noise level Sound pressure level at the operator's ear according to ISO 6394:		LpA dB(A) = 92
Sound power level according to ISO 3744:		LwA dB(A) = 104
Vibration values Hand - arm vibration values according to ISO 5349:		a m/s <sup>2</sup> = 8.7

The above noise level and vibration values were determined at normal engine speed with vibration on. The machine was placed on an elastic base. During operation these values may differ because of the actual operational conditions.

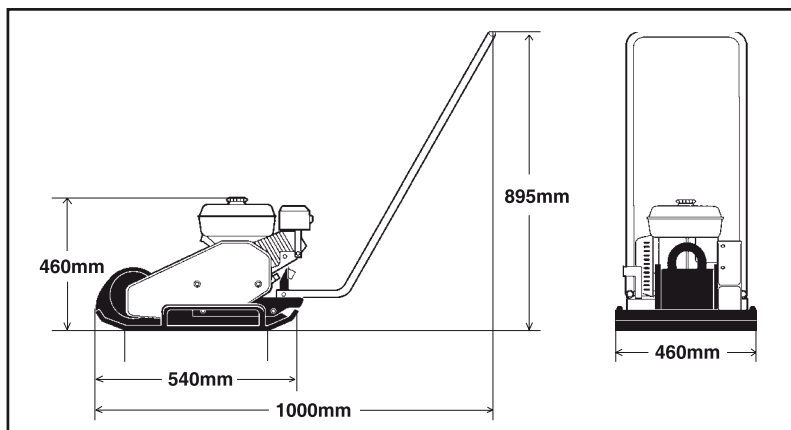

## Symbols

The signal words WARNING and CAUTION used in the safety instructions have the following meanings:



### **CAUTION**

CAUTION Indicates danger or hazardous procedure that could result in damage to machine or property if the warning is ignored.



### **WARNING**

WARNING Indicates danger or hazardous procedure that could result in serious or fatal personal injury if the warning is ignored.

## Important rules for your safety



### **WARNING**

The machine must not be modified without the prior consent of the manufacturer. Use only original parts. Use only the accessories recommended by Belle. If modifications not approved by Belle are carried out, these could result in serious injury to yourself or other personnel.

- These recommendations are based on international safety standards.
- You must also observe any local safety regulations which may be in force. Read all instructions carefully before operating the machine. Keep the instructions in a safe place.
- Signs and stickers giving important information about safety and maintenance are supplied with every machine. Make sure that they are always legible. The ordering numbers for new stickers can be found in the spare parts list.
- Use of the machine and its accessories is restricted to the applications specified in the product literature.
- For reasons of product safety, the machine must not be modified in any way.
- Replace damaged parts immediately.
- Replace all wear parts in good time.

## Be alert

Always pay attention to what you are doing, and use your common sense. Do not use the machine if you are tired or under the influence of drugs, alcohol or other substances which can effect your vision, reaction ability or judgement.



### **WARNING**

Long exposure to loud noise without ear protectors can cause permanent damage to hearing.



### **WARNING**

Long exposure to vibrations can damage the hands, fingers and wrists. Do not use the machine if you experience discomfort, cramp or pain. Consult a doctor before resuming work with the machine.

Always use approved safety equipment. The operator, and people in the immediate vicinity of the working area, must wear:

- Safety helmet
- Safety goggles
- Ear protectors
- Dust mask in dusty environments
- High-visibility clothing
- Protective gloves
- Protective shoes

Avoid wearing loosely fitting clothing that might get caught in the machine. If you have long hair, cover it with a hair net. Vibrations from hand-held machines are transmitted into the hands via the handles of the machine. Belle machines feature a handle design that absorbs a large part of the machine vibrations. The vibrations are not eliminated entirely, but it is possible to use the machines for longer periods of time without the risk of injury.

## Working area

Do not use the machine near flammable material or in explosive environments. Sparks can be emitted from the exhaust pipe, and these can ignite flammable material. When you take a pause or have finished working with the machine, do not park it on or near flammable materials. The exhaust pipe can get very hot during operation, and can cause

## Filling with fuel (Gasoline/diesel)



**WARNING** Petrol has an extremely low flashpoint and can be explosive in certain situations. Do not smoke. Make sure that worksite ventilation is good.

Keep away from all hot or spark-generating objects when handling fuel. Wait until the machine has cooled before filling the tank. Fill the tank at least 3 metres away from where you intend to use the machine. Avoid spilling petrol, diesel or oil on the ground. Protect your hands from contact with petrol, diesel and oil.

Open the tank cap slowly to release any overpressure that might exist in the tank.

Do not overfill the tank. Inspect the machine for fuel leakage regularly.  
Do not use a machine that is leaking fuel.

## Starting the machine



**WARNING** Before starting read instruction book and make your self familiar with the machine and make sure that:

- All handles are free from grease, oil and dirt.
- The machine does not show any obvious faults.
- All protective devices are securely fastened in their places.
- All control levers in "neutral" position.

Start the machine according to the instructionbook.

## Operation



**WARNING** Keep your feet well clear of themachine.



**WARNING** Do not operate the machine in poorly ventilated spaces. There is a risk of carbon monoxide poisoning.

Use the machine only for the purpose for which it is intended. Make sure you know how to stop the machine quickly in the event of an emergency situation.



**WARNING** Always take extreme care when driving the machine on slopes. Always drive straight up and down on slopes. Do not exceed the maximum gradability of the machine according to the instruction book. Stay clear of machine when operating on a slope or in a trench.

Do not touch the engine, the exhaust pipe or the eccentric element of the machine. They gets very hot during operation and can cause burn injuries.

Do not touch V-belts or rotating parts during operation.

## Parking

Park the machine on ground as level and firm as possible. Before leaving machine:

- Apply the parking brake.
- Shut off the engine and pull the ignition keyout.

## Loading/Unloading



**WARNING** Never remain under or in the immediate vicinity of the machine when it is lifted by a crane. Only use marked lifting points. Always make sure that all lifting devices are dimensioned for the weight of the products.

## Maintenance

Maintenance work must only be carried out by skilled personnel. Keep unauthorized persons away from the machine. Do not carry out maintenance work while the machine is moving or the engine is running.

## Repair

Never use a machine that is damaged. Qualified repair work requires trained personnel, please contact your nearest authorized work-shop.

## Extinguishing fires

If there is a fire in or on the machine, it is best to use an ABE-class fire extinguisher. However, a BE-class CO2 extinguisher is also suitable.

# Safety When Driving

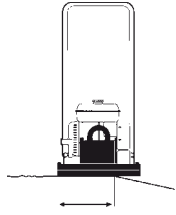

At least 2/3

## Driving near an edge

When driving near an edge, at least two thirds of the plate must be on firm solid ground.

Machine location when operating on edges

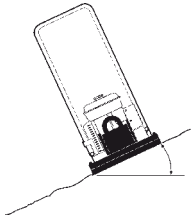

Max 20°  
or 36%

## Tilting

Make sure that the work site is safe. Wet and loose earth reduces manoeuvrability especially on sloping ground. Always observe particular caution on sloping and uneven terrain.

Tipping angle on side slopes



## **WARNING**

Where possible, avoid all driving across a slope. Instead, drive up and down on sloping ground.

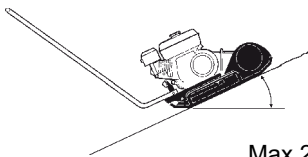

Max 20°  
or 36%

Never work on slopes that are greater than the capability of the machine. Maximum slope of the machine in operation is 20° (depending on condition of the ground).

The tilting angle is measured on a hard, level surface with the machine stationary. Vibration switched OFF and all tanks full. Remember that loose ground, vibration switched ON, and driving speed can all cause the machine to topple even on a smaller slope than specified here.

Driving on slopes



## **WARNING**

Never leave the machine unattended with the engine running.

# Safety Decals, Location/Description

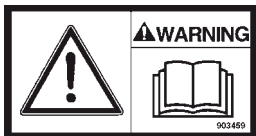
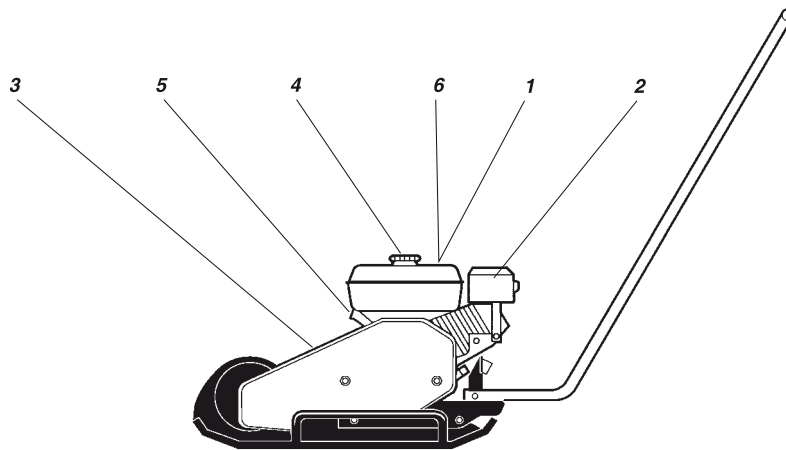

1. The operator must read the safety manual, and the operation and maintenance instructions before using the machine.



2. Warning - hot surfaces in the engine compartment. Do not touch.



3. Warning, hand and arm entanglement. Never reach into the hazardous area.



4. Petrol



5. Lifting point



6. Use ear protectors

# Pre-Start Checks



## Before start

Follow the general safety precautions. Check that daily maintenance has been carried out. We also recommend that you read the instruction manual for the engine that was delivered with the machine.

1. Check the oil level in the engine.
2. Fill the engine (cold engine) fuel tank with fuel.
3. Check that all operating controls are working.
4. Ensure that there are no oil leaks and that all screw joints are tightened.



**CAUTION** On new machines the engine oil must be changed after 20 working hours.

# Operation



## Honda Petrol Engine

### Stopping the engine

1. Push in the throttle and let the engine run on idle for a minute.
2. Turn the engine switch to the **O** position.
3. Close the fuel cock.

### Starting the engine

1. Open the fuel cock.
2. Put the throttle lever to middle position.
3. Close the choke if the engine is cold; if the engine is warm open the choke.
4. Turn the engine switch to the **I** position.
5. Pull back the handle of the recoil starter slowly until resistance is felt, then release the handle and pull sharply until the engine starts.
6. Open up the choke gradually until it is fully open.
7. Let the engine run on idle for a few minutes before running it at full capacity.

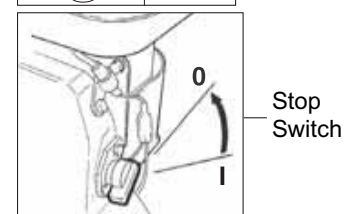
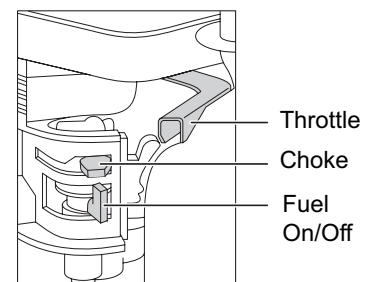



## Robin Petrol Engine

### Stopping the engine

1. Set the Speed control lever to the low speed position and allow engine to idle for 2-3 minutes.
2. Turn the engine switch to the **O** position.
3. Close the fuel cock.

### Starting the engine

1. Turn the engine stop switch to the **I** position.
2. Open the fuel cock.
3. Set the Speed control lever 1/3 of the way towards the high speed position.
4. Adjust the choke lever. If the engine is warm, open the choke lever halfway, or keep it fully open. If the engine is cold, close the choke lever fully.
5. Pull back the handle of the recoil starter slowly until resistance is felt, Return the recoil to its original position and repull swiftly.
6. Do not pull the recoil starter rope fully out.
7. After starting the engine, gradually open the choke until fully open.
8. If the engine fails to fire after several attempts, refer to the Troubleshooting Guide.

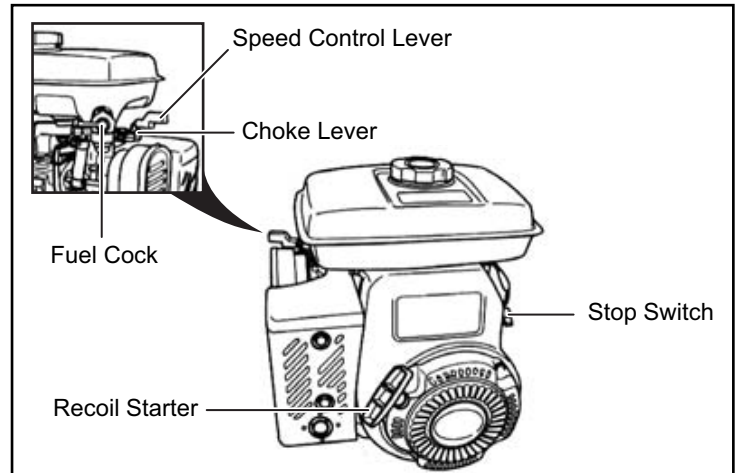

## Lifting, Transportation And Towing

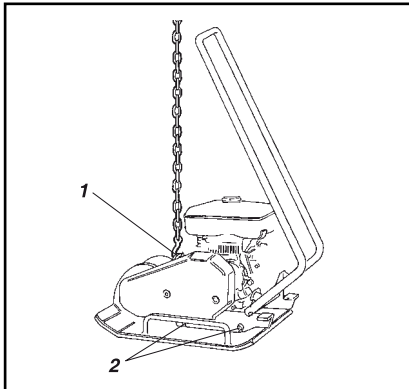

### Lifting/Towing

Machine ready for lifting

1. Lifting hook
2. Shock absorbers (rubber elements)

### Transportation

Machine ready for transportation

1. Lashing strap



**WARNING** Never walk or stand underneath a hoisted machine



**CAUTION** Use only the frame lifting hook (1) to lift the machine.



**CAUTION** All lifting equipment must be dimensioned in conformance with current regulations. Ensure before lifting that the shock absorbers (2) are securely fixed and undamaged.



**WARNING** Always secure the machine firmly during all transportation. Place lashing band in a U shape around the bottom plate and secure both front and rear.

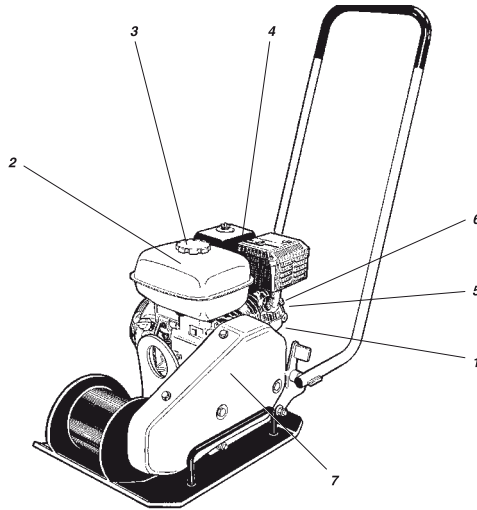

Maintenance	Every 10 Hrs / Daily	First 50 Hrs	Every 100 Hrs	Every 200 Hrs	Every 500 Hrs
Check the oil level in the engine (1)	✓				
Change engine oil (1)			✓		
Fill fuel tank (2)	✓				
Check the engine cooling system (5)	✓				
Check the air filter on the engine (4)	✓				
Clean the air filter on the engine (4)		✓			
Change the air filter on the engine (4)					✓
Check for oil leaks in the machine	✓				
Check that all screw joints are tightened	✓				
Keep the machine clean	✓				
Check and clean the spark plug (6)			✓		
Clean fuel filter and the fuel tank (3)				✓	
Check the V-belt (7)				✓	
Clean and adjust the carburettor*					✓
Clean the cooling flanges on the engine (5)					✓
Clean/Lap valves for combustion chamber*					✓
Clean the fuel line					✓
Grease both Vibrator Housing Bearings				✓	

\* = These items should be serviced by an authorized Belle or Honda dealer, unless the owner has the proper tools and is mechanically proficient.



Washing the machine

**Washing (high pressure)**

Keep the machine clean.

 **CAUTION** Use only the frame lifting hook (1) to lift the machine.

Do not spray water directly on electric components or the instrument panel. Put a plastic bag over the filler cap of the fuel tank and secure with a rubber band. This will prevent water from entering the venting hole in the filler cap. This could otherwise cause operational disturbance, for example, a clogged filter.

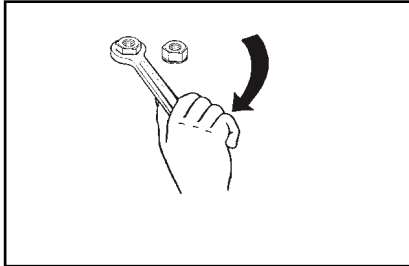

Control tighten bolts

**Bolted joints – Check**

Check and, where necessary, tighten screws and nuts.

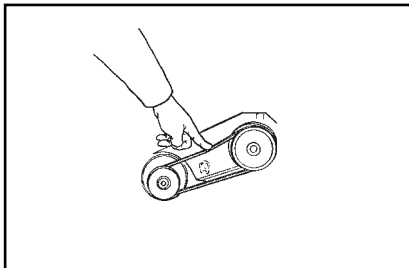



V-belt

**V-belt – Checking**

1. Remove the protective cover and inspect the V belt.
2. To adjust belt tension, loosen the four engine plate bolts and slide it into position.
3. Tighten the bolts and replace the protective cover.

 **WARNING** Never run the machine without the protective cover over the V belt.

 <p><b>ENGINE OIL</b></p>	<p><b>Honda:</b> Use SAE 15W/40 Volume: 0.6 (0.65 qts)  <b>Robin:</b> Use SAE 10W/30 Volume: 0.6 l (0.65 qts)</p>
 <p><b>FUEL</b></p>	<p>Use ordinary grade petrol (unleaded)  <b>Honda:</b> Volume: 3.6 l (3.8 qts)  <b>Robin:</b> Volume: 3.8 l (4.0 qts)</p>
 <p><b>VIBRATOR HOUSING BEARINGS</b></p>	<p>Use <b>SHELL</b> Stamina EP2 Grease or          Use <b>TOTAL</b> Multis Complex EP2 Grease</p>

The bearings in the vibrator housing have been coated with a high temperature grease at the factory. In the event of repair, the bearings will need the application of grease, which is to be liberally applied to the roller race (but not excessively), before replacement of the covers. For Maintenance Schedule, please see Page 23.

 **WARNING** Stop the engine before refilling the fuel tank. Never refuel near an open flame or sparks, which could start a fire. Don't smoke. Use pure fuel and clean filling equipment. Take care not to spill fuel.

Your new Belle Group SF460 is warranted to the original purchaser for a period of one-year (12 months) from the original date of purchase.

The Belle Group warranty is against defects in design, materials and workmanship.

The following are not covered under the Belle Group warranty:

1. Damage caused by abuse, misuse, dropping or other similar damage caused by or as a result of failure to follow assembly, operation or user maintenance instructions.
2. Alterations, additions or repairs carried out by persons other than Belle Group or their recognised agents.
3. Transportation or shipment costs to and from Belle Group or their recognised agents, for repair or assessment against a warranty claim, on any machine.
4. Materials and/or labour costs to renew, repair or replace components due to fair wear and tear.

The following components are not covered by warranty.

- Drivebelt(s)
- Engine air filter
- Engine spark plug

Belle Group and/or their recognised agents, directors, employees or insurers will not be held liable for consequential or other damages, losses or expenses in connection with or by reason of or the inability to use the machine for any purpose.

## Warranty Claims

All warranty claims should firstly be directed to Belle Group, either by telephone, by Fax, by Email, or in writing.

### For warranty claims, contact:

Belle Group Inc,  
3959 Electric Road,  
SW Suite 360,  
Roanoke, VA,  
24018  
USA

Tel : 540-345-5090

Fax : 540-345-5091

Email : [bellegroupinc@aol.com](mailto:bellegroupinc@aol.com)

# SF460

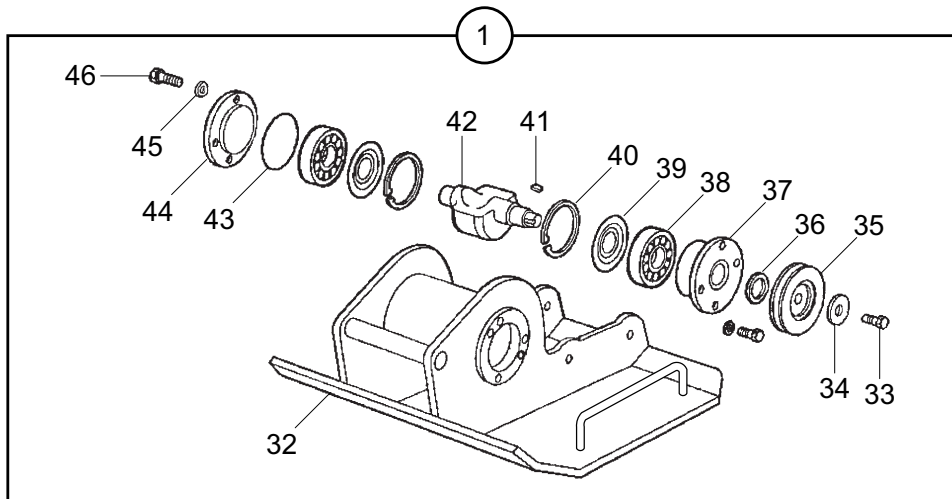
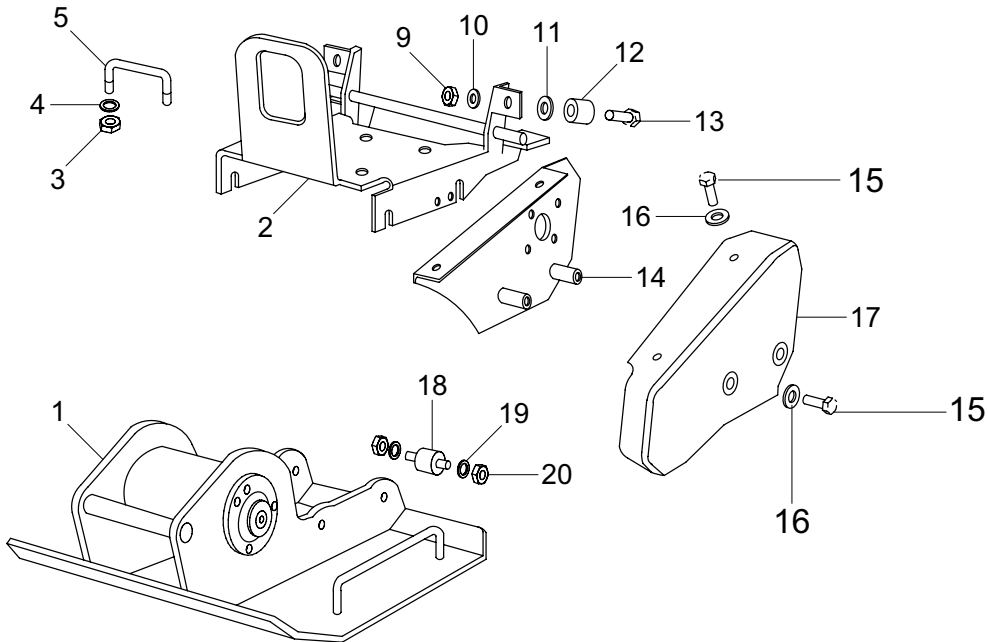
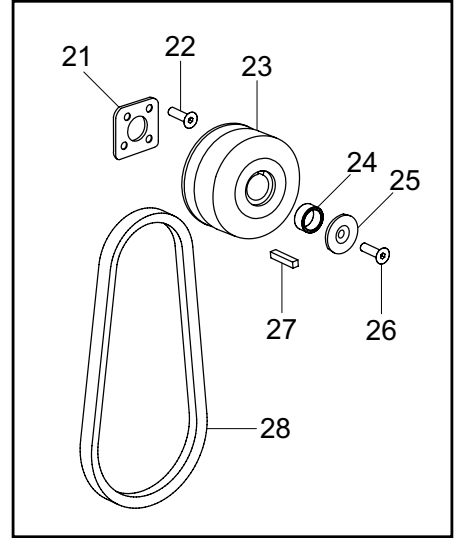
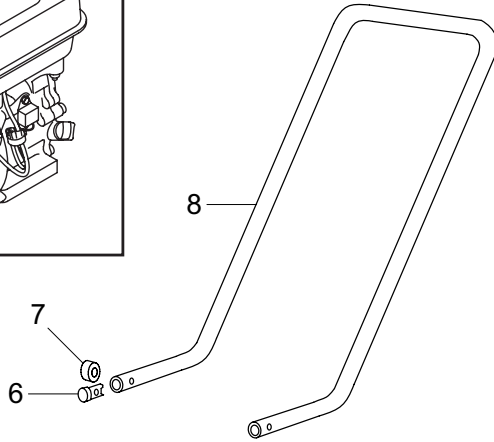
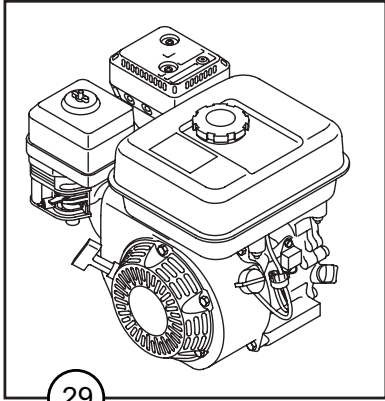

# SF460

ITEM NUMBER <sup>(1)</sup>	PART NUMBER <sup>(2)</sup>	DESCRIPTION <sup>(3)</sup>
1	164.3.003	BASEPLATE ASSEMBLY
2	164.0.016	ENGINE PLATE
3	164.0.023	NUT - NYLOC
4	164.0.026	WASHER
5	164.0.024	U CLAMP
6	164.0.021	BUSH - PLASTIC
7	164.0.022	BUSH - PLASTIC
8	164.0.020	HANDLE
9	164.0.036	NUT - NYLOC
10	164.0.025	WASHER - FLAT
11	164.0.039	WASHER - FLAT
12	164.0.034	SPACER
13	164.0.035	SETSCREW
14	164.0.030	BELT GUARD - INNER
15	164.0.012	SETSCREW
16	164.0.026	WASHER - FLAT
17	164.0.032	BELT GUARD - OUTER
18	164.0.017	ANTI VIB MOUNTING
19	164.0.019	WASHER - FLAT
20	164.0.018	NUT
21	164.0.055	SPACER - BELT GUARD
22	07.3.101	SCREW CSK SKT HEAD (5/16 X 1")
23	10.7.225	CLUTCH
24	164.0.056	SPACER - CLUTCH
25	164.0.057	WASHER - CLUTCH
26	07.3.101	SCREW CSK SKT HEAD (5/16 X 1")
27	06.8.001	KEY (3/16"SQ)
28	164.0.029	BELT
29	29.1.129	ENGINE GX160 HONDA
30	21.0.149	EXHAUST (NOT SHOWN)
31	21.0.140	SCREW (NOT SHOWN)
32	164.0.001	BASEPLATE
33	164.0.013	SETSCREW
34	164.0.015	WASHER - FLAT
35	164.0.007	PULLEY
36	164.0.006	OIL SEAL
37	164.0.003	COVER - PULLEY
38	164.0.005	BEARING
39	164.0.008	NILOS RING
40	164.0.009	CIRCLIP
41	164.0.011	KEY
42	164.0.002	ECCENTRIC SHAFT
43	164.0.010	O - RING
44	164.0.004	COVER - BLIND
45	164.0.025	WASHER
46	164.0.014	SETSCREW

(1) **Item Number** / numéro sur le schéma / número de la ilustración / número da ilustração / afbeeldingsnummer / tegningsnummeret / Teil-Nummer / numero dell'illustrazione

(2) **Part Number** / Numéro de référence de la pièce / número de pieza / número da parte / stuknummer / Styknummer / Nummer auf der Abbildung / numero di parte

(3) **Description** / Désignation / Descripción / Descrição / Omschrijving / Beskrivelse / Bezeichnung / Descrizione



# No.1 for Light Construction Equipment

[www.BelleGroup.com](http://www.BelleGroup.com)

**Belle Group Head Office**  
Sheen, nr. Buxton  
Derbyshire. SK17 OEU GB.  
Tel: +44 (0)1298 84000  
Fax: +44 (0)1298 84722  
email: [sales@belle-group.co.uk](mailto:sales@belle-group.co.uk)

**Belle Group France**  
70, av du Général de Gaulle  
94022 Creteil, Cedex.  
FRANCE  
Tel: +33 (0) 1 49 81 68 32  
Fax: +33 (0) 1 43 39 94 40  
Ventes : 0800 902 461  
SAV : 0800 905 336  
SAV Fax : 0800 909 895

**Belle Equipos SL**  
Calle Doctor Calero Cial 19,  
Local 22, 28220 Majadahonda  
Madrid, Spain  
Tel: +34 (0) 91 636 2043  
Fax: +34 (0) 91 634 1535  
email: [belleequipos@belleequipos.com](mailto:belleequipos@belleequipos.com)

**Belle Group Deutschland**  
Husumer Straße 45 a,  
D-33729,  
Bielefeld  
Deutschland  
Tel : +49(0) 5217 707505  
Fax : +49 (0) 5217 707506  
Sales: 0800 1808069  
Spares: 0800 1816673

**Belle Poland sp. z.o.o.**  
96-200 Rawa Mazowiecka  
Ul. Mszczonowska 36,  
Polska  
Tel: +48 (0) 46 8144091  
Fax: +48 (0) 46 8144700

**Belle Group Portugal**  
Rua Laura Alves, 225, 2° F  
2775-116 Parede  
Portugal  
Tel: +35 1 (21) 453 59 91  
Fax: +35 1 (21) 453 59 91

**Belle Group Netherlands**  
Tel: 0800 249861

**Belle Group Belguim**  
Tel: 0800 80295

**Belle Group Austria**  
Tel: 0800 291544

**Belle Group Russia**  
64 Nevsky pr.  
St, Petersburg  
Russia  
Tel : +7(812)314-81-34  
Moscow : +7(495)589-64-32

**Belle Group South East Asia**  
21, Jalan Ara AD 7/3B,  
Pandar Sri Damansara  
S2200 Kuala Lumpur, Malaysia  
Tel: +60 (0) 3 62721678  
+60 (0) 3 6272 9308  
Fax: +60 (0) 3 6272 9528

**Belle Group (GB), Shanghai Office**  
Room 213, Zhonghuang Building,  
1007 Zhongshan Nan Er Road,  
Xuhui, Shanghai 200030 China  
Tel: 00 - 86 - 21 - 5461 5228  
Mobile: 00 - 86 - 133 8172 2653  
Fax: 00 - 86 - 21 - 5461 5369  
email: [morgan.liu@bellegroup.com.cn](mailto:morgan.liu@bellegroup.com.cn)

**Belle Group Inc**  
3959 Electric Rd  
Roanoke  
Suite 360  
VA 24018. USA.  
Tel: +1.540.345.5090  
Fax: +1.540.345.5091  
Toll free 866 540 5090  
e-mail: [sales@bellegroup.net](mailto:sales@bellegroup.net)



**Belle Group World Parts Centre**  
Unit 5, Bode Business Park  
Ball Haye Green,  
Leek,  
Staffordshire,  
ST13 8BW  
Tel: 44+ 1538 380000  
Fax: 44+ 1538 380038

[www.BelleGroup.com](http://www.BelleGroup.com)

No.1 for Light Construction Equipment



COMPACTING...

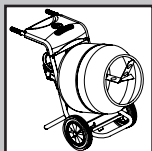

MIXING...

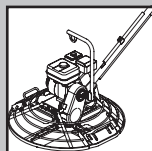

CONCRETING...

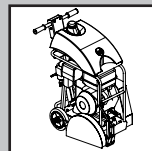

CUTTING...

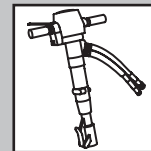

BREAKING...



MOVING