

AiriSpa



Owner's Manual

Models DS1oval110v • DSRND110V

**Oval AiriSpa
Round AiriSpa**

Manufactured by:
Comfort Line Products, Inc.
2717 N. Tamiami Trail
N. Fort Myers, FL 33903
US: (888) 891-5585
Canada: (877) 633-8827

www.comfortlineproducts.com

Version: May 2011

User's Guide WARNINGS / AVERTISSEMENTS
WARNING: CHILDREN SHOULD NOT USE SPAS OR HOT TUBS WITHOUT ADULT SUPERVISION.
WARNING: DO NOT USE SPAS OR HOT TUBS UNLESS ALL SUCTION GUARDS ARE INSTALLED TO PREVENT BODY AND HAIR ENTRAPMENT.
WARNING: PEOPLE USING MEDICATIONS AND/OR HAVING AN ADVERSE MEDICAL HISTORY SHOULD CONSULT A PHYSICIAN BEFORE USING A SPA OR HOT TUB.
WARNING: PEOPLE WITH INFECTIOUS DISEASES SHOULD NOT USE A SPA OR HOT TUB.
WARNING: DO NOT USE DRUGS OR ALCOHOL BEFORE OR DURING THE USE OF A SPA OR HOT TUB TO AVOID UNCONSCIOUSNESS AND POSSIBLE DROWNING.
WARNING: TO AVOID INJURY, EXERCISE CARE WHEN ENTERING OR EXITING THE SPA OR HOT TUB.
WARNING: PREGNANT OR POSSIBLY PREGNANT WOMEN SHOULD CONSULT A PHYSICIAN BEFORE USING A SPA OR HOT TUB.
WARNING: DO NOT USE A SPA OR HOT TUB IMMEDIATELY FOLLOWING STRENUOUS EXERCISE
WARNING: DO NOT PERMIT ELECTRIC APPLIANCES (SUCH AS A LIGHT, TELEPHONE, RADIO, OR TELEVISION) WITHIN 5 FEET (1.5 M) OF THIS SPA OR HOT TUB.
CAUTION: MAINTAIN WATER CHEMISTRY IN ACCORDANCE WITH MANUFACTURER'S INSTRUCTION.
WARNING: BEFORE ENTERING THE SPA OR HOT TUB, MEASURE THE WATER TEMPERATURE WITH AN ACCURATE THERMOMETER.
WARNING: WATER TEMPERATURE IN EXCESS OF 98.6°F (38°C) MAY BE INJURIOUS TO YOUR HEALTH.
WARNING: PROLONGED IMMERSION IN A SPA OR HOT TUB MAY BE INJURIOUS TO YOUR HEALTH.

U.L. AND E.T.L. SAFETY INSTRUCTIONS

The following instructions are required to be printed by Underwriters Laboratory (U.L.) as well as ETL Testing Laboratories, Inc. as a condition of their listing of this product. They contain important safety information, and we strongly encourage you to read and apply them. When installing and using this electrical equipment, basic safety precautions should always be followed, including the following:

IMPORTANT SAFETY INSTRUCTIONS

1. Read and Follow All Instructions.

2. WARNING - To reduce the risk of injury, do not permit children to use this product unless they are closely supervised at all times.

3. A pressure wire connector is provided in the Power Pack unit to permit connection of a minimum No.8 AWG (8.4 mm) solid copper bonding conductor between this point and any metal equipment, metal enclosures or electrical equipment, metal water pipe, or conduit within 5 feet (1.5m) of the unit as needed to comply with local requirements.

4. DANGER- Risk of Injury

- a) Replace damaged cord immediately
- b) Do not bury cord.
- c) Connect to a grounded, grounding type receptacle only.

5. WARNING -This appliance is provided with a ground-fault circuit interrupter (located near the end of the power supply and with the unit operating, push the test button. The unit should stop operating and the reset button should pop out slightly. Push the reset button. The unit should now operate normally. If the interrupter fails to operate in this manner, there is a ground current flowing, indicating the possibility of an electrical shock. Disconnect the plug from the receptacle until the fault has been identified and corrected.

6. DANGER - Risk of Accidental Drowning. Extreme caution must be exercised to prevent unauthorized access by children. To avoid accidents, ensure that children cannot use a spa or hot tub unless they are supervised at all times.

7. DANGER - Risk of Injury. The suction fittings in this spa are sized to match the specific water flow created by the pump. Should the need arise to replace the suction fittings or the pump, be sure the flow rates are compatible.

NEVER operate the spa if suction fittings are broken or missing. Never replace a suction fitting with one rated less than the flow rate marked on the original suction fitting.

8. DANGER - RISK OF ELECTRICAL SHOCK. Install at least 5 feet from all metal surfaces. As an alternative, a spa may be installed within 5 feet of metal surfaces if each metal surface is permanently connected by a minimum of #8 (SWG 8.4 mm) solid copper conductor attached to the wire connector in the Power Pack which is provided for this purpose.

9. DANGER - Risk of Electrical Shock. Do not permit any electrical appliance, such as a light, telephone, radio, or television, within 5 feet of spa or hot tub.

10. WARNING -To reduce the risk of injury:

A. The water in a spa or hot tub should never exceed 40°C (104°F). Water temperatures between 38°C (100°F) and 40°C (104°F) are considered safe for a healthy adult. Lower water temperatures are recommended for young children and when spa use exceeds 10 minutes.

B. Since excessive water temperatures have a high potential for causing fetal damage during the early months on pregnancy, pregnant or possible pregnant women should limit spa or hot water temperatures to 38°C (100°F).

C. CAUTION: Before entering a spa or hot tub, the user should measure the water temperature with an accurate thermometer since the tolerance of water temperature-regulating devices may varies.

D. WARNING! The use of alcohol, drugs or medication before or during spa or hot tub use can greatly increase the risk of fatal hypothermia. Hypothermia occurs when the internal temperature of the body reaches a level several degrees above the normal body temperature of 98.6°.

E. The symptoms of hypothermia include; an increase in the internal temperature of the body, dizziness, lethargy, drowsiness, and fainting. The effects of hypothermia include; (1) failure to perceive heat, (2) failure to recognize the need to exit spa or hot tub, (3) unawareness of impending hazard, (4) fetal damage in pregnant women, (5) physical inability to exit spa or hot tub, and (6) unconsciousness resulting in the danger of drowning.

F. Obese persons and persons with a medical history of heart disease, low or high blood pressure, circulatory system problems, or diabetes should consult a physician before using a spa or hot tub.

G. Persons using medication should consult a physician before using a spa since some medications may induce drowsiness while other medication may affect heart rate, blood pressure, and circulation.

H. Water chemistry should be properly maintained as described in this manual to prevent skin irritation.

ADDITIONAL WARNINGS

- 1.** Never use an extension cord to connect the Power Pack to a power source. The cord could cause a voltage drop which may cause damage to the control and pump motor., and create a fire hazard.
- 2.** Always operate Power Pack with the cord mounted GFCI in place and functional. Failure to do so could result in a shock hazard.
- 3.** Always operate spa with sufficient water. Water level must be above filter. Insufficient water will cause pump failure and void warranty.
- 4.** Maintain proper water PH (7.4 - 7.6 is ideal). Failure to do so may cause damage to vinyl liner, pump seals, heater element, and damage will not be covered by warranty.
- 5.** Install spa only on floors or areas that can withstand repeated water exposure. Equipment failure as well as splashing, filling and draining will spill water. If located in a multi-story building, care must be taken to protect the objects on the floors below.
- 6.** Install only on floors that can withstand the floor loading of your spa. If in doubt, please consult an architect or engineer to determine the floor rating before filing. See specifications.
- 7.** Do not open Power Pack or the GFCI. Opening either component will void the warranty.
- 8.** When storing, always drain all water from tub, plumbing and Power Pack, especially in freezing temperature as freeze damage is not covered by warranty.
- 9.** Always maintain proper water sanitation with chemicals and routine cleaning. Warm water is an ideal place for bacteria to thrive. It's your sole responsibility to maintain proper water sanitation. Read the sections on water chemistry and filter maintenance.

10. Never add water to chemicals. Always add chemicals to water to avoid strong fumes or violent reactions that may result in hazardous chemical spray.

SAVE THESE INSTRUCTIONS.

INSTALLATION INSTRUCTIONS

SITE PREPARATION

A. Structure: Your spa should always be installed on a structurally sound, relatively smooth and level surface.

B. Electrical: The installation should be a grounded 120 volt outlet within 8 feet of the spa and allow for easy access to the cord mounted GFCI for periodic testing.

C. A copper wire connector is located in the Power Pack to permit connection of a minimum No. 8 A.W.G. solid copper bonding conductor between any metal equipment, water pipe, or metal enclosures within 5 feet of the spa as required to comply with the National Electric Code, or local requirements.

INDOOR INSTALLATION

Give special consideration to the following issues when installing your spa indoors.

1. Make sure the floor can support the total spa filled weight of 2569 pounds.

2. Install your spa on water resistant, non-slip floor. The floor should have a drain to remove water splashed from the spa. Do not install the spa on carpet or other material that will be damaged by moisture.

3. Take into consideration the room humidity which will exist due to high temperatures. Providing natural or forced ventilation in the room will help maintain comfort and minimize moisture damage to the surrounding environment.

4. Avoid installing the spa indoors on a second story above finished living space due to the possibility of water and humidity damage.

5. Allow enough clearance around the spa for full access to the spa equipment for service.

Your spa may be installed on any level, smooth surface that is strong enough to support the filled unit. Observe the following considerations when deciding where to place your spa:

1. Make sure there are no sharp objects under the spa.
2. Do not install the spa on grass or dirt, as this will greatly increase the amount of debris entering the spa. Stepping stones or a solid wood 8 ft

x 8 ft square platform, 5 to 9 inches in height, will provide a sufficient area for installation.

3. Verify that there is adequate room to place the spa and permit safe access.
4. Check local code requirements for restrictions (fencing, enclosures, child proof gates, etc.)

PACKAGE CONTENTS

Refer to the following picture and product checklist to verify that all parts of the spa have been received and are undamaged. Report missing or damaged parts immediately.



- | | |
|--------------------------------|--------------------------------|
| 1. Air Loop | 7. Power Pack Connection Cover |
| 2. Power Pack | 8. Power Pack Feet |
| 3. GFCI
(120 V models only) | 9. Inflation Hose |
| 4. Spa Vessel | 10. Hand Air Pump |
| 5. Inflatable Inner Cover | 11. Foam Padding |
| 6. Inflatable Outside Cover | |

SPA ASSEMBLY

***Please note if fitting your spa with colored skin you must first inflate spa 50% and then place skin over wall edge.**

1. Take all parts out of box. Compare package contents with contents diagram found on previous page.

2. Unfold spa vessel (4), inflation connection cover (7), and inflatable inner cover (5).

3. Remove label(s) from liner-to-power pack union nut.

4. Attach the three (3) feet to the bottom of the power pack.

5. Connect the inflation hose to the blower exhaust fitting on the top of the power pack.

WARNING

The key lock pin must be inserted into the adapter of the inflation hose fitting when inflating. Failure to insert the key lock pin may result in injury.

6. Plug the power pack into the electric outlet. Press the Turbo Wave On/Off button to start the inflation.

Note: The power pack will make a rattling noise while the pump is running with no water. This is normal. Do not run the power pack without water for more than 15 minutes.

7. Using adapter shown, inflate spa vessel (4).



Note: Please note power pack will inflate vessel approximately 80% full. Shut off air blower and finish inflating with hand pump provided using pressure gauge. * Inflate to yellow zone on pressure gauge.

8. Using power pack and inflation hose, fill inflatable inner cover and connection cover until firm. * Do not over inflate!

9. Place white foam pad under spa vessel.

FILLING THE SPA

Please note: If your spa is equipped with water booster seats attach them now and fill with water and burp air out before proceeding.

1. Ensure that the power pack is not plugged in.
2. Remove the protective caps from the suction and discharge fittings inside the spa. Place the caps in a safe location.

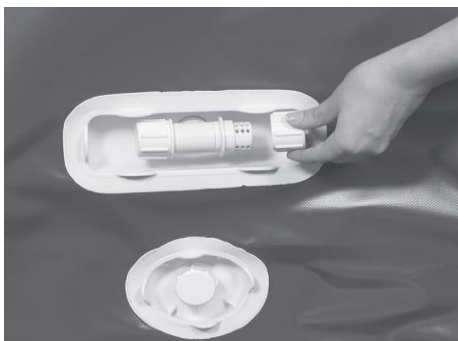

3. Using a garden hose, fill the spa with approximately 1/2 inch of water. **STOP!** With hands, smooth out any wrinkles on bottom of liner, starting from the center of liner and proceeding outwards towards the wall.

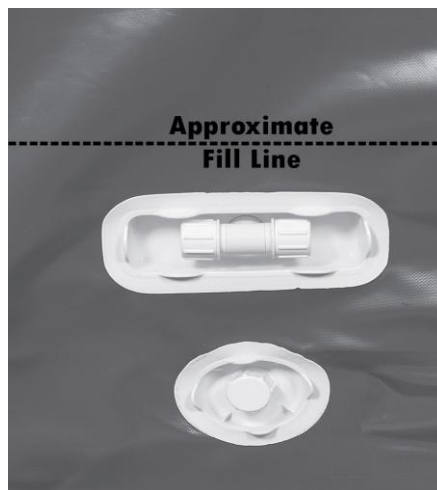

Be careful not to over fill the spa, or the spa may overflow during use.

Each average adult will raise the water level in the spa approximately two inches, and the turbo wave blower action will raise water level an additional three to four inches.

4. Bleed the air from the filter tank by turning the small black knob on the top of the filter tank counterclockwise. Allow the filter tank to bleed for approximately one minute, or until water drips from the fitting. Turn the fitting clock-wise to close the bleed valve.



⚠ WARNING _____
Plug the spa into a properly grounded electrical outlet.

5. Plug the power pack into the electrical outlet. The water pump will turn on and begin pumping water. Water should flow from the small return nozzle on the bottom inside wall of the spa behind the power pack. If water is not flowing from the return nozzle, repeat the air bleeding instructions provided in step 4.

Unplug the power pack while bleeding air.

NOTE: If the air is not properly bled from the filter tank, the water pump will be air bound and no water will flow. This will prevent the spa from heating, and the water will not be filtered. Make sure water is flowing from the return nozzle before continuing

6. Place the inflatable bladder cover on the spa. Make sure the cover is centered on the spa.

7. Place the top cover over the spa and line up the cover locks.



WARNING

Always supervise children around bodies of water. The spa cover is not a safety cover. The spa cover is not a substitute for adult supervision.

8. Connect the eight clips to secure the cover in place. The clips may be locked using the small keys provided in the patch kit.

OPERATION

WARNING

• **Test the GFCI before each use.**
(Refer to the instructions provided in the Maintenance section of this manual.)

• **Plug into a properly grounded receptacle.**

• **Do not use extension cords.**

Temperature Control

1. During normal operation, the control display on the top of the power pack displays the current water temperature.

2. To set the desired water temperature, press and release the up or down heat button. The display will flash the desired water temperature set point. To change the set point, press the up or down button once for each degree of water temperature, to a maximum of 104°F (40°C).

3. After a few seconds pass without pressing either heat button, the display will return to the current water temperature. The spa will begin heating to the desired water temperature at a rate of approximately **1 to 1-1/2 degrees F per hour.**

4. The spa is made to hold the set temperature. Do not lower the temperature set point after use. The heater will turn on and off automatically to maintain the desired temperature.

5. In case of electric power interruption, the spa temperature set point will default to 100°F when electric power is restored.

Turbo Operation

To turn the turbo wave pump on or off, push the on/off button. Look to see if the spa blows bubbles uniformly all the way around the spa. The turbo wave pump will automatically shut off after 15 minutes of operation. When the turbo wave blower system is activated, the blower pump is pumping outside ambient air into the spa, creating much of the action in the spa. Some cooling of the water will occur as the turbo wave blower operates. This is normal and the heater will recover lost temperature after use. Remember, at elevated temperatures, 15 minutes soaking time is considered safe.

The spa power pack contains a filter to help keep the water in the spa clean. If the filter becomes dirty or clogged, water flow through the power pack will be restricted. This may prevent the spa from heating up. Refer to the Maintenance section of this manual for information on checking and cleaning the filter.

Cover

After use, place the cover on the spa. Lock the plastic clips in eight locations on the outside of the spa.

WARNING

Always leave the cover locked and in place when the spa is not in use. The cover is not a replacement for adult supervision. Always supervise young children in and around water. NOTE: The cover must be in place for the spa to heat up.

MAINTENANCE

Vinyl Care – Interior

1. Empty the spa and refill with clean water every 3 months or when it becomes cloudy and proper water chemistry does not clear it up.
2. While empty, use a mild soap solution to wipe away any soil or stains on the inner liner. Rinse thoroughly before refilling the tub. Do not use cleaning aids such as steel wool, steel brushes or abrasive cleaners such as steel wool, steel bristle brushes or abrasive cleaners such as Comet or Ajax.
3. Remove and clean your filter twice a month or more often if necessary.
4. REPAIR: If your liner does get a tear or puncture, your dealer can provide you with patching material. Patch kits are also available through any local hardware store. A secure, unnoticeable repair can usually be made.

Vinyl Care – Exterior

The exterior of the spa as well as the thermal top is made to resist mildew and discoloration.

1. Cleaning: Use a mild soap and water solution to wash the exterior vinyl, then rinse with clean water. Avoid abrasive soaps or tools or any other solvents.
2. Repair: The vinyl can be repaired using standard vinyl repair

techniques. Pieces of material can be obtained through your dealer.

Vinyl Repair

If your liner does get a tear or puncture, your dealer can provide you with patching material. A secure, unnoticeable repair can usually be made.

Recommended Chemical Balances

PH: 7.4 - 7.6

Total alkalinity: 80 - 120 ppm

Calcium hardness: 150 - 250 ppm

Bromine residual: 2 - 3 ppm

Total dissolved solids below 1,500 ppm

Purchase a test kit from your dealer and test your water chemistry after each use of the spa, but no less than once per week. **Avoid a low pH, as this will cause unsightly wrinkles to form in the liner, damage to the heater and void the warranty.**

If a bromine feeder is used that requires holes to be punched in, start with one hole punched at the top of the feeder and one hole punched at the bottom.

Place in the spa water and retest water after 2 days. If the bromine level has not increased to the ideal 3-5 ppm range, punch another hole in the bottom of the feeder and retest after another 2 days.

Avoid punching too many holes in the feeder as this could cause over bromination, which could bleach out the liner and void the warranty. If the bromine level in the spa reaches 5 ppm or higher, remove

bromine feeder from the spa until sanitizer level drops to the correct level (2-3 ppm).

Chemical Additions

1. Always have the water circulating when adding chemicals. Add only one chemical at a time.
2. Completely pre-dissolve any granulated chemicals in a water filled bucket so no granules rest on the vinyl surface. Never allow bromine tablets to rest on vinyl floor surface.
3. Add chemicals. Always pre-dissolve or pre-dilute the chemicals you add. With a 5 gallon bucket, dip a few gallons of water out of the tub. Add the chemicals to the bucket and stir until they are fully dissolved or diluted. With the spa jets turned on, slowly add the bucket of water back into the tub in the stream on one of the jets to ensure mixing. If you do not premix your chemicals, you may damage your vinyl surfaces and void your warranty.
4. Do not use gas chlorination, chlorine tablets, ionizers, scents, salts or soaps without consulting with your dealer.

Cleanliness

1. Empty the spa and fill with clean water at least every 3 months or when it becomes cloudy and proper water chemistry does not clear it up. **Always unplug the power pack before draining the spa.** The spa is easily drained by using a hose to

siphon out the water. Do not lift the spa if it contains more than 1/4 inch of water.

2. Remove and clean your filter once a week, or more often if necessary. **Dirty filters will keep the spa from heating.**

Storing or Draining your Spa

1. **Winterizing / Vacationing:** If you are taking a vacation or leaving your spa unused for a week or so you should take a few simple precautions. Leave the thermal top on, turbo control off and set the thermostat dial to low. This will allow the pump to come on from time to time to filter the water and protect the spa in freezing temperatures. Upon return, check the bromine and pH levels.
2. **Storing:** The spa may be stored in its original box. Make sure all water is drained from the spa and Power Pack. We recommend the use of a wet/dry vac to blow out or suction water from spa pipes and Power Pack lines. Additional care must be taken in freezing climates as plastic becomes more brittle and susceptible to breakage when exposed to sub zero temperatures.

3. **Draining the spa:** To drain spa use a garden hose to siphon the water out. Place one end of the hose in front of the jet to start siphon action. Place hose on floor of the spa after water flows from other end of hose. Then unplug the power cord

and drain to a suitable place.
Important!

Cleaning the Filter

1. Unplug the power pack from the electrical outlet.
2. Using the three caps provided, cap the suction and discharge fittings on the inside of the spa.

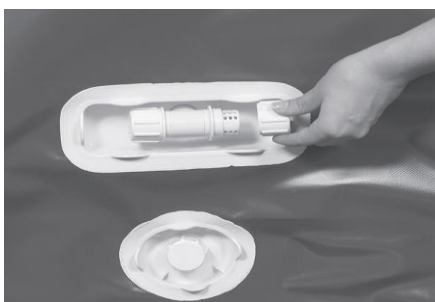

3. Open the air bleed fitting on the top of the filter tank.



4. Unscrew the retainer ring from the filter housing and remove the filter housing cover.



5. Lift the filter out of the filter housing. Clean the filter with the spray from a high pressure garden hose.

6. Place the filter back in the filter housing. Make sure the filter is properly seated in the housing and that the o-ring is properly seated in the o-ring groove.



Note: Ensure that the central post and ring on the underside of the cover aligns and fits fully into the top of the filter. Failure to do so may result in water leaks from the filter housing and/or power pack during operation.

7. Install the filter housing cover and secure with the retaining ring. Tighten the retaining ring hand tight. Do not over tighten the retaining ring.
8. Remove the caps from the spa suction and discharge fittings inside the spa.

9. Open the air bleed fitting on the top of the filter housing. Leave the bleed fitting open for one minute, or until water drips from the bleed fitting.

Close the bleed fitting.

10. Plug the power pack into the electrical outlet.

11. Finally, reset the desired temperature set point.

GFCI (120 volt units only)

The GFCI, or Ground Fault Circuit Interrupt, fitting on the power pack electrical cord should be tested monthly. There are no user serviceable parts inside the GFCI. Do not open the GFCI as this will void your warranty.

To test the GFCI, use the following procedure.

⚠ WARNING

If the GFCI device does not function properly, do not use your spa. Call the dealer or factory immediately for instructions. Do not bypass the GFCI device.



1. Turn on the turbo wave blower.

2. Push the test button on the GFCI located at the end of the power cord. The GFCI light should go out and the turbo wave blower should shut off. If the GFCI light does not go out, and the turbo wave blower does not shut off, the GFCI is faulty.

Do not use the spa. Immediately contact your dealer or the factory for instructions.

3. Press the reset button on the GFCI. The light on the GFCI should turn on. If the GFCI light does not turn on the GFCI is faulty. Do not use the spa. Immediately contact your dealer or the factory for instructions.

There are no user serviceable parts in the GFCI. DO NOT open the GFCI as this will void the warranty.

SERVICE AND TROUBLESHOOTING

Your spa was designed to minimize service requirements. If you encounter problems with your spa carefully go through the following steps.

Air Pump Blower

1. Turbo wave pump will not turn on:
A. Make sure the power pack is plugged into the electrical outlet, and that there is power to the outlet. Plug another electrical item into the outlet such as a hair dryer or lamp. If you do not have power, check the breakers at the main electrical panel.

B. Test the GFCI per the instructions in the Maintenance section of this manual. If the GFCI is faulty do not use the spa. Immediately call your dealer or the factory for instructions. **DO NOT BYPASS THE GFCI! DO NOT USE THE SPA!**

2. Turbo wave pump will not turn off: Call the factory for instructions.

3. Turbo wave pump blower trips the GFCI when you turn it on:

A. Take the air loop off the top of the power pack. Look down inside the left fitting and see if water has collected inside the power pack.

B. If water has collected inside the power pack, disconnect the large fitting connecting the power pack to the spa. Ensure the check valve in the fitting is in place and working properly.

4. Turbo wave pump makes a squealing noise: Do not continue running the turbo wave pump. Contact the manufacturer for instructions.

No Heat

1. Dirty filter: Clean the filter per the instructions provided in the Maintenance section of this manual. If the filter is more than two months old, replace it. After cleaning or replacing the filter, cover the spa, turn the temperature set point all the way up, and leave the spa for 24 hours. If the spa still will not heat, contact the manufacturer for instructions.

2. No circulation, water pump air bound: Unplug the power pack from the electrical outlet. Bleed air from the filter tank by turning the bleed fitting on the top of the filter tank counter-clockwise. After one minute, or when water drips from the fitting, close the bleed fitting and plug in. If the water pump still does not pump water, contact the manufacturer for instructions. **If** the water pump becomes air bound again, check the o-ring on the top of the filter tank. Refer to the filter changing instructions in the Maintenance section of this manual. Replace the o-ring if necessary.

3. Bad power pack: Ensure power is available to the spa. Check the circuit breaker at the main electrical panel. Connect another electrical appliance to the plug used for the spa. If power is available to the spa, test the GFCI using the instructions

supplied in the Maintenance section. If the GFCI is working properly and the power pack does not function, then the power pack is bad. If the GFCI is not working properly, do not use the spa. Immediately contact the manufacturer for instructions.

4. In some situations, the numerical temperature display may read 'OH' (overheat) and the spa will not heat until reset. To fix this problem, please use the following procedure:

A. If the spa water is still warm (over 104°F /40°C), unplug the power pack and let the water cool to below 104°F / 40°C. (Use a thermometer to verify the temperature.)

B. Plug the power pack back in and press the small reset button directly below the temperature display. This will clear the 'OH' message and the spa will resume normal operations.

Should this problem occur repeatedly, please call our customer support for further instructions.

Leaks

1. The two small connections between the power pack and the spa are leaking: Ensure the garden hose style washer inside each of these fittings is still in place and undamaged.

If the washers are in place and the connection is still leaking, there may be a small piece of plastic behind the hose washer. Remove the small piece of plastic with a utility knife or needle-nose pliers.

2. Blower connection is leaking: If the large connection between the spa and the power pack is leaking,

ensure the o-ring inside the fitting is in place and undamaged.

3. Plumbing or pressure switch is leaking: Look under the power pack. If water is coming from underneath the power pack, then the plumbing or pressure switch inside the power pack is leaking. Contact the factory for instructions.

SPECIFICATIONS

MODEL DS1oval110v AiriSpa

Capacity : Seating: 2 adults
Water: 190 gallons
Height : 28 inches with cover
Length: 74"
Width: 45"
Number of Jets : 1 return jet
Over 120 air jets
Power Pack : 1 HP turbo
blower
Fractional HP circulating pump
Single phase
(120 VAC, 60 Hz, 12 Amps)
(240 VAC, 50 Hz, 6 Amps)
1000 Watt heater
Weight : Dry: Spa – approx.
77lbs
With water: approx. 1700 lbs.

MODEL DSRND110v AiriSpa

Capacity : Seating: 4-5 adults
Water: 250 gallons
Height : 28 inches with cover
Length: 65"
Number of Jets : 1 return jet
Over 120 air jets
Power Pack : 1 HP turbo
blower
Fractional HP circulating pump
Single phase
(120 VAC, 60 Hz, 12 Amps)
(240 VAC, 50 Hz, 6 Amps)
1000 Watt heater
Weight : Dry: Spa – approx.
68lbs
With water: approx. 2250 lbs.

AiriSpa Warranty – Coverage

Comfort Line Products Inc. obligation for the above listed products is limited to the term set below. This warranty extends to the original purchaser only. The warranty period commences on the original purchase date through 12 months. This warranty is not transferable to subsequent purchasers. This warranty is subject to the obligations, limitations, and exclusions listed below:

Comfort Line Products Inc. [CLP] warrants the above listed products against defects in materials and workmanship for a period of one (1) year from the date of original purchase. (Warranty Period).

If a defect arises and a valid claim is received by CLP within the warranty period, at its option CLP will:

1. Repair the product using new or refurbished replacement parts,
2. Exchange the product with a product or component that is new or which has been manufactured from new or serviceable used parts and is at least functionally equivalent to the original product

If a defect arises and a valid claim is received by CLP after the first thirty (30) days of the Warranty Period, shipping and handling charge will apply to any repair or exchange of the product provided by CLP or its authorized service centers.

CLP warrants replacement products or parts provided under this warranty against defects in materials and workmanship from the date of the replacement or repair for ninety (90) days or for the remaining portion of the original products warranty, whichever provides longer coverage for you. When a product or part is exchanged, any replacement item becomes your property and the replaced item becomes CLP's property.

Obligations of Purchaser

The purchaser must establish, by dated sales slip, invoice, or installation receipt, the date of original purchase. In order to supply the customer with the most up to date service we respectfully request the purchaser to register their purchase by completing the attached Warranty Registration Card and mail it to CLP within 15 days of date receiving the purchase, or submit via our website:
www.comfortlineproducts.com.

*Items not covered: Filters; Chemicals; other accessories

Limitations and Exclusions

The warranty is limited warranty. It covers the performance system itself for the period stated. This warranty negates or limits all other warranties implied or expressed, except for those, which cannot be negated or limited by law of the state in which the product is used.

CLP does not authorize or permit any party, including its agents, distributors or dealers to assume for it any other obligations or liability. In no event will CLP be liable for any claim for damages arising from the use or loss of use, installation, or repair of the spa including, but not limited to freight damage, punctures, cuts in vinyl, water and/or sewage costs, freeze damage, or water damage to surrounding areas, rooms, furnishings or landscaping. Product specifications are subject to change without notice.

* Neither vinyl cover fading, nor bleaching of the product due to misuse of chemicals is considered a manufacturer's defect

* Commercial use of the product will void the warranty

* Demonstration models will carry only a 90-day warranty

Acts Invalidating Warranty

This warranty is void if the spa has been altered, misused, abused or has been repaired by an unauthorized person, or is not installed according to the factory instructions.

Other acts that will void the warranty are operating the spa without water or improper

water level, use of an extension cord, improper chemical maintenance, burying the spa below ground level, damage from ice or freezing, low voltage or excess voltage, if applicable – over inflation, prolonged exposure to direct sunshine or UV damage, defacing or removal of serial numbers. This warranty gives you specific legal rights that vary from state to state. Specifications subject to change without notice.

Obtaining Warranty Service

Please review the purchase and online self help resources offered at www.comfortlineproducts.com before seeking warranty services. Our knowledge base of troubleshooting tips is available and can answer many of our customer's most frequent questions. If the product is still not functioning properly after making use of the above resources, please contact our customer service center:

U.S. Customers:
1-866-891-5585

Canadian Customers:
1-877-663-8827

Manufactured by:
Comfort Line Products, Inc.
2717 N. Tamiami Trail
N. Fort Myers, FL 33903