

MONSTER
PERFORMANCE CAR™
FACTORY·LINK™
with  SoundGate® technology

MONSTER®
iCruze®
for iPod®

MPC FX ICRUZ

INSTALLATION & USER GUIDE

**The MPC FX ICRUZ works
in the following vehicles:**

- Any car with an Alpine® aftermarket car stereo with M•Bus CD changer control
- All Jaguar® models 92-97

**All other vehicles and factory car
stereos will require a Factory•Linx
iCruze Interface Cable and/or Module.
Ask your sales associate, see the
in-store selection guide or visit
iPodiCruze.com to be sure you have
all the required items for your vehicle.**

A NOTE FROM THE HEAD MONSTER

Thank you for purchasing the Monster Factory•Linx™ iCruze®—one of the most exciting products Monster has ever offered. Monster worked closely with the engineers at Apple to design iCruze to give you the most reliable, most complete control of your iPod® through your factory car stereo. iCruze also gives you a direct connection for crystal clear sound quality. And it charges your iPod the entire time you're driving, so when you leave the car your iPod is charged up and ready to go. You'll soon be wondering how you ever got along without your iPod and iCruze in your car.

When you put music, driving and iPod together, Life is Good.



Noel Lee,
The Head Monster

Monsterously,

A handwritten signature in black ink, appearing to read 'Noel Lee'. The signature is stylized and fluid.

Noel Lee,
The Head Monster

LOSS OF CERTAIN EXISTING FUNCTIONS

- ⚠ Use and installation of iCruze requires disconnection and loss of use of any existing factory installed non-integrated CD-changer (i.e. trunk, center console, under seat).
- ⚠ iCruze is not compatible with some vehicles that have existing, factory installed integrated CD changers. Typically this is an in-dash CD changer. Call your dealer and ask if your factory stereo has a CD or CD changer port/option on the rear of the stereo. If yes, then it is iCruze compatible.
- ⚠ Existing factory installed vehicle features, such as Satellite Radio, DVD entertainment systems, navigation systems and video cameras may be impacted by or cease to function with use and installation of iCruze, if these components were connected to the CD changer port. Check the iCruze in-store selection guide, visit iPodiCruze.com, or call customer service at 1-415-840-2000 (9am–5pm Monday through Friday PT) for more details.

INSTALLATION SAFETY PRECAUTIONS & WARNINGS

- ⚠ Monster is not responsible for any damage to your vehicle while installing iCruze. The wiring and installation of the iCruze requires technical skill. Monster recommends iCruze installation by a MECP certified professional car audio technician. If you choose to install yourself, be aware that specialized car stereo removal tools may be needed and can be found available for purchase on our website iPodiCruze.com.
- ⚠ Make sure you have purchased the correct Monster Factory•Linx Interface Cable and/or Module. See the iCruze Factory•Linx in-store selection guide or visit iPodiCruze.com to ensure you have everything you need to install iCruze in your car. Double check





the iCruze in-store selection guide, visit iPodiCruze.com, or call customer service at 1-415-840-2000 (9am–5pm Monday through Friday PT) for more details.

- ⚠ If your factory stereo is protected by an anti-theft code, have the code available so you can use your stereo once re-connected. Consult your car owner's manual or contact your local car dealer for more information.
- ⚠ Before installing iCruze, remove the cable from the negative battery terminal. Failure to do so may cause electrical shock and/or injury.
- ⚠ iCruze is designed to be installed in the dash near the car stereo. Installation elsewhere or in a dusty or moist area may cause problems or product failure.
- ⚠ Many connectors in your car may look the same. Do not force or alter the cable connectors to fit. Failure to do so may damage your vehicle's electronics, cause shock or fire.
- ⚠ While installing iCruze, make sure to avoid sharp edges which can damage wiring. Failure in doing so may cause iCruze to not work or result in a fire.
- ⚠ Do not attempt to take iCruze apart. The internal circuits are static sensitive and contain no user serviceable parts.

IMPORTANT IPOD® FUNCTION NOTES & SAFETY

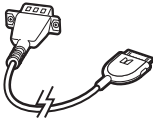
- ⚠ Monster is not responsible for any lost data on your iPod even during normal use of this product.

- ⚠ Monster is not responsible for damage caused to your iPod from misuse.
- ⚠ iCruze is compatible with iPod models with dock connector.
- ⚠ You should never leave or store your iPod in your vehicle for an extended amount of time. Failure to do so may damage your iPod from heat, cold and moisture extremes. See your iPod manual for acceptable temperature ranges.
- ⚠ For added safety and security while driving, Monster recommends placing the iPod in your glove box or other stow-away location such as a center console.
- ⚠ Your iPod must have certain firmware for proper iCruze compatibility. Minimum: version 1.2 for iPod Mini, version 1.0 for iPod Photo and version 2.2 for iPod. Visit apple.com/support for more information.
- ⚠ When you unplug the iPod from the iCruze, you will notice that the iPod will display the iCruze logo for a short time which is normal. It will revert back to the usual screen shortly after this time period.
- ⚠ The functions and control of your iPod may differ depending on your radio. iCruze is limited by the available functions of your radio. I.E. - If your radio does not have a shuffle/random this feature will not be available.
- ⚠ iCruze utilizes playlists on your iPod to access music. Be sure to refer to your installation and user guide that came with iCruze for more details on how to optimize your playlist for use with the main iCruze unit.

INCLUDED ITEMS	
	(1) Monster® iCruze® Part #153384
	(1) 2m (6.56ft) iPod Dock Connector Cable Part #156793
	(1) Monster Performance Car™ Factory-Linx™ iCruze® Extension Cable Part #152099
	(1) Installation & User Guide Part #162700
	(1) Installation CD-ROM Part #162726

Installation Diagram/ Location Overview

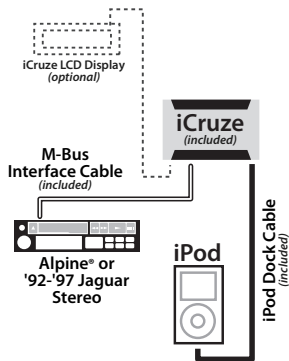

BEFORE YOU BEGIN

⚠ WARNING:

Please completely read and review this guide and the installation guides included with any required Monster Factory•Linx Interface Cable and/or Module prior to attempting installation of iCruze.

To find a professional iCruze installer near you, visit iPodiCruze.com or call 415-840-2000 or 1-877-800-8989 toll-free in the U.S. (9am–5pm Monday through Friday PT) for more details.

⚠ WARNING:

REVIEW AND FOLLOW ALL SAFETY PRECAUTIONS AND STEPS AS INDICATED IN “LOSS OF CERTAIN EXISTING FUNCTIONS”, “INSTALLATION SAFETY PRECAUTIONS & WARNINGS”, AND “IMPORTANT IPOD FUNCTION NOTES & SAFETY” BEFORE PROCEEDING.

Because iCruze emulates a CD changer, if your vehicle currently has a CD changer installed, it will need to be unplugged for iCruze to operate. In some vehicles, other features such as rear seat entertainment (DVD), satellite radio and perhaps navigation, will also be disabled.

If your car requires a Monster Factory•Linx Interface Module and/or Interface Cable, review the installation guide that came with the Cable and/or Module for specific details regarding any features that may be disabled in your car. This information is also available from iPodiCruze.com or the in-store iCruze Factory•Linx selection guide.

Determine iPod Location in Your Car

The display and the controls of your iPod won't function once it's plugged into the iCruze so put it away for safety while driving in the glove box, center console or other safe place. If mounting to dash, use Monster's iSportCase for iPod (sold separately) or visit MonsterCable.com for additional mounting solutions for your iPod. Don't leave your iPod loose so it won't go flying in case of an accident. Location of your iPod will dictate how and where the dock cable will need to be run.

Have Everything You Need to Install?

If you have an Alpine brand car stereo with M-Bus CD changer compatibility or a 1992-97 Jaguar®, then everything you need for your installation is included with iCruze.

Any other type of compatible vehicle will require either a Monster Factory•Linx Interface Cable and/or Interface Module to complete the installation. Be sure to double check the in-store iCruze Factory•Linx selection guide or visit iPodiCruze.com to make sure you have everything required for your car.

Review the Installation CD-ROM

Monster recommends a professional installer for your iCruze installation. But for you do-it-yourselfers, please watch the installation videos on the included CD-ROM before you start. It will save you time and trouble and may help further clarify certain installation procedures and requirements.

The material on the CD is also available online. For the most current version, go to: **iPodiCruze.com**. SYSTEM REQUIREMENTS: Pentium 166Mhz or Power Mac 180Mhz • 64MB of RAM • Internet Connection and Browser • Quicktime

INSTALLING iCRUZE®

Step 1: Locate & Gain Access to Your Car Stereo's CD Changer Port/Cable

Since iCruze uses the CD changer port on your car stereo, you will need access to the port on the back of the stereo, or, in some Ford®/Lincoln®/Mercury® vehicles, access to a remote tuner box in the trunk is required. These installations will specify the purchase and use of the Monster Factory•Linx M-Bus Extension Cable (sold separately). Detailed instructions pertaining to your specific vehicle are included in the Interface Cable and Interface Module packages. Please read these instructions and then refer to the specific instructions in the Interface Cable and/or Module box for additional installation specifics for your car.

Step 2: Removing Your Factory Stereo & Knowing Security Codes

⚠ WARNING:
FOR SAFETY PURPOSES, DISCONNECT THE NEGATIVE TERMINAL OF YOUR BATTERY AT THIS TIME. WE HIGHLY RECOMMEND CONSULTING YOUR OWNERS MANUAL FOR VEHICLE SPECIFIC INSTRUCTIONS AND PRECAUTIONS REGARDING BATTERY CONNECTIONS.

The review of your car's factory service manual is highly recommended for this procedure. Specialized removal tools or 'keys' may also be required, as well as dash/console disassembly and other highly specialized knowledge. Monster offers some of these removal keys available for your purchase—visit **iPodiCruze.com** for details.

Most factory stereos also use a security code for anti-theft purposes. Since you'll be disconnecting the battery (which powers your car stereo), be sure to have this code handy in order to re-activate your stereo once power is restored. Many car stereos will display "code" on the display. Follow your car's owner's manual for reactivation procedures.

NOTE: PLEASE READ CAREFULLY!

STEPS 3 & 4 ARE ONLY FOR CARS WITH ALPINE M-BUS COMPATIBLE CAR STEREOS AND JAGUAR MODELS 1992-1997. FOR ALL OTHER CARS, PLEASE REFER TO THE INSTALLATION GUIDE INCLUDED WITH THE iCRUZE FACTORY-LINX INTERFACE CABLE AND/OR MODULE REQUIRED FOR YOUR CAR.

Step 3: Connecting iCruze to the Car Stereo CD Changer Port

The included iCruze Interface Cable plugs into the iCruze "OEM Interface" port using the rectangular or Molex® end of the cable, while the round or DIN-plug end, goes directly into the CD changer port on the back of your Alpine® or Jaguar® car stereo.

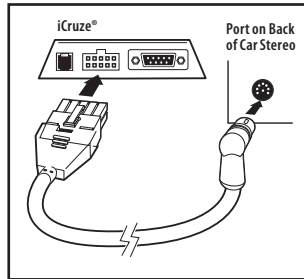

⚠ WARNING:

If you have a round port on your factory car stereo and it's not an Alpine or 92-97 Jaguar CAR stereo, DO NOT insert the included Interface Cable just because it looks like it will fit. The internal wiring is different and you may damage the iCruze and/or the stereo.

Step 4: Connect The Yellow Wire On The Included iCruze Interface Cable

⚠ WARNING:

DO NOT ATTEMPT TO MAKE THIS CONNECTION UNLESS YOU HAVE THE EXPERIENCE AND KNOWLEDGE TO DO SO. INCORRECT CONNECTIONS MAY CAUSE MALFUNCTION OF CAR STEREO AND OTHER ELECTRICAL SYSTEM COMPONENTS. CONSULT AN MECP CERTIFIED INSTALLER IF YOU DO NOT HAVE THE TOOLS OR KNOWLEDGE TO MAKE THIS CONNECTION.

The yellow wire on the included iCruze Interface Cable needs to be connected to constant battery power. Often that 12 volt power source is available in the radio's wire harness. Using your car stereo's factory service manual, find the right wire and tap into it. Be careful not to disconnect it from the car stereo.

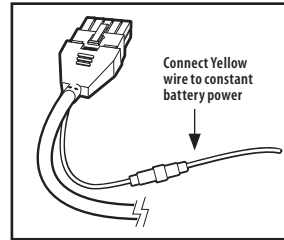

Step 5: Connect the Included iPod Dock Cable to iCruze

The included dock cable is 6.56 feet long. This should leave plenty of cable available inside the vehicle for most

in-dash installations of iCruze. Plug the matching end of the cable into the “iPod In” port on iCruze. Choose the location where you will dock your iPod and route the other end of the cable to that area. Further dash and/or console disassembly may be required in order to do this. Please consult your car’s factory service manual for details.

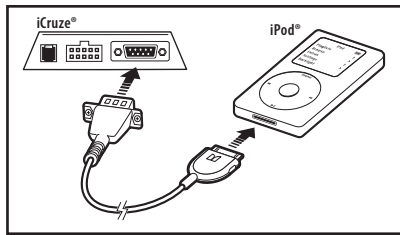

Step 6: Connect and Mount the Optional iCruze LCD Display

The iCruze LCD display shows song title and artist information in large, easy-to-read text format. It’s small enough to mount nearly anywhere on the dash and backlit for easy viewing. See more details at iPodiCruze.com. If you purchased this display, find a suitable mounting location and follow the directions included with the Display.

Step 7: Mounting iCruze Inside Your Dash/Chassis

With all of the appropriate cables connected to iCruze and to your car stereo, secure iCruze to prevent vibration and rattling. If you are installing iCruze behind the car stereo, be sure to make certain there is enough room for the car stereo to slide back completely into the dash. Also check that it’s placement does not interfere

with normal operation of the vehicle such as heat and A/C cables, accelerator/brake cables, steering column movement, or any other dash wiring. Make sure all wires are routed for safety and will not get pinched or come unplugged.

Step 8: Completing Installation

Completely reinstall your factory stereo and reassemble all dash panels. Reconnect the negative battery terminal to restore power to the car stereo.

Test to make sure all the usual functions of your stereo work. Now plug your iPod into the iCruze dock cable and select the CD changer function with the appropriate button on your car stereo. The iPod display should show the word “iCruze” and your car stereo should begin playing the first song in your first playlist on your iPod. If this does not occur, or if certain features and functions are not working, disconnect the negative battery terminal and re-check all connections and installation steps.

See “Optimizing & Organizing iPod Playlists for iCruze” to be sure your playlists are organized for proper iCruze functionality. Once you have double-checked everything, reinstall your car stereo (consult your car’s factory service manual for re-assembly instructions). See “Using iCruze” section for additional details on iCruze and iPod functions and features.

USING iCRUZE®

Safely Docking and Undocking Your iPod®

One of the main features of iCruze is that you no longer need to hold or view your iPod to use it while driving. Doing so in a moving

vehicle while driving can be very dangerous. For that reason, when you connect your iPod, it goes into dock mode and the display and buttons/clickwheel cease to function. Disconnect it from iCruze and your iPod comes out of dock mode and resumes normal functions (a 15-second delay in resuming regular iPod function may occur when undocking your iPod from iCruze – this is normal). Monster recommends docking and undocking your iPod only when it is safe to do so (i.e. when your vehicle is at a complete stop, parked and out of the way of traffic or pedestrians).

iPod Firmware Requirements

Your iPod must have certain firmware for proper iCruze compatibility. Minimum Requirements: version 1.2 for iPod Mini, version 1.0 for iPod Photo and version 2.2 for iPod. Visit apple.com/support for more information.

Connecting Your iPod

With the car stereo on or off, simply plug the iCruze dock cable into your iPod. Within 15 seconds the display should read “iCruze” and the docking is complete and iCruze is ready to use.

Charging Your iPod

As soon as you connect your iPod, iCruze will begin to charge it. It will even charge when the vehicle is turned off. For safety reasons, all charging stops when the iPod reaches full charge so your vehicle’s battery will not run down.

Optimizing & Organizing iPod Playlists for iCruze

Playlists are one the coolest things about iPod. If you’re into 60’s music, it’s easy to make a 60’s playlist with your favorite songs. Same for genre

lists like hip-hop or rap. Combine that with driving and you can make lists like hard rock for those long drives or slower songs for frustrating traffic jams.

iCruze works with iPod playlists only. If you haven’t created any playlists on your iPod, you will need to do so as iCruze can’t access songs on your iPod that are not in playlists. See your iTunes “help” section for additional information on creating playlists or visit apple.com/ipod

Depending on your factory stereo, iCruze will generally access the first 6 playlists on your iPod in cases where a CD would have been selected by hitting a preset button and the first 10 playlists on your iPod on factory stereos that have CD up and down buttons. No more than 10 playlists are ever accessible. If your car stereo can change 6 CDs, you’ll have access to the first 6 playlists on your iPod. A 10-disc changer would be able to access the first 10 playlists, and so on.

Your iPod sorts playlists by number first then letter. So a playlist titled “1-playlist” would come before a playlist titled “A-playlist”. If you want to have all your iPod songs available through your car stereo, make sure to create a playlist that includes all of them. Be sure that all tracks on your iPod are contained within the playlists that iCruze can access through your car stereo CD changer controls.

There is no limit to the number of songs in a playlist, but most stereos can only display two digits. Any song past 99 may not display correctly on your car stereo but will still play properly.

Selecting iCruze on Your Car Stereo

To access your iPod, select the “CD changer” mode on your car stereo. Consult your vehicle’s owner’s manual/car stereo manual

if you are unsure how to do so. When the CD changer is selected, it will engage the iPod and the first track from the first playlist on your iPod will start playing.

Changing Playlists

Your iPod playlists correspond to the number of discs your CD changer controls can manage. For example, “Disc 1” is playlist 1 on your iPod, “Disc 4” is playlist 4 on your iPod and so on. Simply change discs to change the playlists you want to access. Your car stereo will display which disc you currently have selected.

Moving Through Tracks in a Playlist

From here, iCruze acts just like a CD changer. The track up and down buttons move through tracks, just like they would with a CD. Your car stereo will indicate the track number. If you have the optional iCruze LCD display, Song Name and Artist info will be displayed as well.

Fast Forward and Rewind – QuickCruze™ Feature

If your stereo has a fast forward and rewind function (separate buttons or by holding the track forward/back button), with iCruze these now become plus or minus 10 track skip buttons. For example, to get from track 13 to track 33 in a playlist quickly, two presses of the fast forward button is all it takes. Same in reverse. Fast forward and rewind while listening to a song is disabled. Depending on your factory unit, you may need to press the button once or hold it for a few seconds.

Shuffle/Random/Mix

This feature is supported with iCruze. If you hit this button on your car stereo, the iPod will go into shuffle mode. Depending on your car stereo, you may need to select “Shuffle-All” if shuffle is not engaged

quickly. Because of how your iPod operates, only 99 songs will be shuffled and their track numbers will not be displayed correctly.

For example, when “Shuffle” is selected, the car stereo display will go back to track 1 no matter what track it was on previously. The next song selected will show track 2, then 3, etc. The actual track numbers (13, 77, 43 for example) will not be displayed. To see the actual track number, undo shuffle mode selection.

Shuffle mode will also only work inside the currently selected playlist. If you want a different playlist, turn off shuffle, change to that playlist and engage shuffle again. If you want all the songs on the iPod to be shuffled, you will need to create a playlist with all the songs and the select shuffle mode while that playlist is selected.

Certain Functionality Limitations

It’s important to understand that if your car stereo supports a feature like shuffle, iCruze also supports it and tells the iPod what to do. However, if your car stereo does not have a feature such as shuffle, then shuffle will not work even though the iPod offers shuffle. Because the feature is not available through your car stereo controls, there’s no way to communicate it to the iCruze and iPod. If you’re unsure about a feature, first read your vehicle owner’s/car stereo manual to see if it’s supported with your CD changer controls.

CUSTOMER SUPPORT

If you have questions, please try iPodiCruze.com for the latest updates to manuals, products and more. You can also call 1-415-840-2000 or 1-877-800-8989 (toll free) in the U.S. (9am–5pm Monday through Friday PT) for assistance.

LIMITED WARRANTY FOR CONSUMERS

United States

Monster Cable Products, Inc. 455 Valley Drive, Brisbane, CA 94005 USA, 1 (415) 840-2000 ("Monster") extends to You this Limited Warranty. Statutory or common law may provide You with additional rights or remedies, which shall not be affected by this Limited Warranty.

DEFINITIONS

"Adequate Use" means use of the Product (i) within a home or dwelling, (ii) for private (as opposed to commercial) purposes, (iii) in conformance with all applicable local, state or federal law, code or regulations (including without limitation building and/or electrical codes), (iv) in accordance with manufacturer recommendations and/or instructions in the materials and documentation that accompany the Product, and (v) with proper electrical grounding.

"Authorized Dealer" means any distributor, reseller or retailer that (i) was duly authorized to do business in the jurisdiction where it sold the Product to You, (ii) was permitted to sell You the Product under the laws of the jurisdiction where You bought the Product, and (iii) sold You the Product new and in its original packaging.

"Formal Warranty Claim" means a claim made in accordance with the section "Formal Warranty Claims" herein.

"Product" means a Product (i) that is listed in the Specifications Table below, (ii) that You bought from an Authorized Dealer new and in its original packaging, and (iii) whose serial number, if any, has not been removed, altered, or defaced.

"Product Defect" means a defect, malfunction, non-conformance to this Limited Warranty, or other inadequacy of the Product that existed at the time when You received the Product from an Authorized Dealer and that causes a failure of the Product to perform in accordance with Monster's documentation accompanying the Product, unless such failure has been caused completely or partly by (a) any use other than Adequate Use, (b) transportation, neglect, negligence misuse or abuse by anyone other than Monster's employees; (c) alteration, tampering, modification, or installation of the product by anyone other than a Monster employee; (d) accident (other than a malfunction that is caused by a Product Defect), including power surges; (e) maintenance or service of the Product by anyone other than a Monster employee; (f) exposure of the Product to heat, bright light, sun, liquids, sand or other contaminants; or (g) acts outside the control of Monster, including without limitation acts of God, fire, storms, earthquake or flood.

"Warranty Period" means the time period during which Monster must have received Your Formal Warranty Claim. The different Warranty Periods related to Product Defects are defined in the Specifications Table below. The Warranty Period commences on the date when You purchased or received (whichever occurs later) the Product from an Authorized Dealer as evidenced by the Authorized Dealer's invoice, sales receipt or packing slip. If You do not have written proof of the date of purchase or receipt, then the Warranty Period commences three (3) months after the date when the Product left Monster's factory as evidenced by Monster's records. The Warranty Period ends after the time defined in the Specifications Table

has expired or after You have transferred ownership of the Product, whichever occurs earlier. Also, You must call Monster and obtain a Return Authorization Number (as described under "How to Make a Claim") within two (2) months after You discover a Product Defect (or should have discovered it, if such Product Defect was obvious).

"You" means the first individual person that purchased the Product in its original packaging from an Authorized Dealer. This Limited Warranty does not apply to persons or entities that bought the Product (i) in used or unpackaged form, (ii) for resale, lease or other commercial use, or (iii) from someone other than an Authorized Dealer.

SCOPE OF THIS LIMITED WARRANTY

PRODUCTS. If a Product contained a Product Defect when You bought it from an Authorized Dealer and Monster receives a Formal Warranty Claim from You within two (2) months after You discover such Product Defect (or should have discovered it, if such Product Defect was obvious) and before the end of the Warranty Period for Product Defects applicable to the affected Product, then Monster will provide You with one of the following remedies: Monster will (1) repair or, at Monster's sole discretion, replace the Product, or (2) refund to You the purchase price You paid to the Authorized Dealer for the affected Product if repair or replacement is not commercially practicable or cannot be timely made. NOTE: MONSTER DOES NOT ASSUME ANY LIABILITY FOR ANY INCIDENTAL, CONSEQUENTIAL OR INDIRECT DAMAGES UNDER THIS LIMITED WARRANTY. SOME STATES DO NOT ALLOW THE EXCLUSION OR LIMITATION OF INCIDENTAL OR CONSEQUENTIAL DAMAGES, SO THE ABOVE LIMITATION OR EXCLUSION MAY NOT APPLY TO YOU.

GENERAL PROVISIONS

CHOICE OF LAW/JURISDICTION. This Limited Warranty and any disputes arising out of or in connection with this Limited Warranty ("Disputes") shall be governed by the laws of the State of California, USA, excluding conflicts of law principles and excluding the Convention for the International Sale of Goods. The courts located in the State of California, USA shall have exclusive jurisdiction over any Disputes.

OTHER RIGHTS. THIS LIMITED WARRANTY GIVES YOU SPECIFIC LEGAL RIGHTS, AND YOU MAY ALSO HAVE OTHER RIGHTS, WHICH VARY FROM STATE TO STATE. THIS LIMITED WARRANTY EXTENDS ONLY TO YOU AND CANNOT BE TRANSFERRED OR ASSIGNED. If any provision of this Limited Warranty is unlawful, void or unenforceable, that provision shall be deemed severable and shall not affect any remaining provisions. In case of any inconsistency between the English and other versions of this Limited Warranty, the English version shall prevail.

REGISTRATION. Please register Your Product at www.monstercable.com. Failure to register will not diminish Your warranty rights.

SPECIFICATIONS TABLE

PRODUCT MODEL NUMBER	WARRANTY PERIOD FOR PRODUCT
MPC FX ICRUZ	Two (2) Years

NOTES**FORMAL WARRANTY CLAIM**

HOW TO MAKE A CLAIM. (1) Call, or write to, Monster within two (2) months after You discover a Product Defect (or should have discovered it, if such Product Defect was obvious); (2) Give a detailed explanation of how the damage occurred; (3) Obtain a Return Authorization Number; (4) Upon receipt of a claim form (which may be sent to You after You filed Your Formal Warranty Claim), fill out the claim form entirely; (5) Return the Products, shipping prepaid by You (to be refunded if You are entitled to a remedy under the Scope of this Limited Warranty), to Monster for verification of damage, along with a copy of Your original sales receipts and proof of purchase (UPC label or packing slip) for such Products, the completed claim form, and printed Return Authorization Number on the outside of the return package (the claim form will include instructions for return).

TOLL-FREE TELEPHONE NUMBERS. United States: 1-877-800-8989 (toll-free), or 1-415-840-2000.

ADDRESS: Monster Cable Products, Inc. 455 Valley Drive, Brisbane, CA 94005 USA

FURTHER PROCEEDINGS. Monster will determine whether a Product Defect existed. Monster may, at its discretion, direct You to obtain a repair estimate at a service center. If a repair estimate is required, You will be instructed on how to properly submit the estimate and the resulting invoice to Monster for payment. Any fees for repairs may be negotiated by Monster.

TIMING. If You bring a Formal Warranty Claim and fully comply with all terms and conditions of this Limited Warranty, Monster will use its best efforts to provide You with a remedy within thirty (30) days after receipt of Your Formal Warranty Claim (if You reside in the United States - forty-five (45) days if You reside elsewhere), unless obstacles outside Monster's control delay the process.

Ver.12/14/2004 – US ©2005 Monster Cable Products, Inc.

MONSTER **PERFORMANCE CAR™**

455 Valley Drive
Brisbane, CA 94005 USA

Visit us on the Web at
MonsterPerformanceCar.com

Monster iCruze is designed and engineered
in the USA, and manufactured to Monster
quality specifications in China.

© Copyright 2005 Monster Cable Products, Inc.
455 Valley Drive, Brisbane CA 94005 USA

Monster, Monster Performance Car, Factory•Linx, QuickCruze, the Monster Performance Car logo and the product design are the products of registered or unregistered trademarks of Monster Cable Products, Inc. or its subsidiaries in the U.S. and abroad. iCruze and Soundgate are registered and unregistered trademarks of The Putnum Group, Inc. iPod, Apple are trademarks of Apple Computer, Inc. Alpine is a registered trademark of Alpine Electronics, Inc. Jaguar is a trademark of Jaguar Cars Limited. Images and illustrations shown may vary from actual product. Specifications subject to change without notice.