



COLTRANE SUPREME

Owners manual

Table of contents	2
Introduction	3
Marten Philosophy	3
Unpacking	4
Quick Setup	4
Connecting the loudspeakers	5
Choice of cable	
Bi-wiring/Bi-amping	
Connections	
Burn-in	5
Room Acoustics	6
Positioning	6
Loudspeaker placement	
Distance to back and side walls	
Focusing the loudspeakers	
Toe-in	
Enclosed CD	7
Care of Loudspeakers	7
Service	7
Warranty	8
Serial Number	8
Technical Specifications	9

Introduction

Congratulations! You are now the proud owner of a pair of Marten loudspeakers. At the forefront of current designs, the Coltrane Supreme will reveal the full emotional range of music with vivid dynamics and detail.

Properly installed, your Coltrane Supreme loudspeakers will give you many years of listening pleasure. To realize the highest sound quality from your loudspeakers, some important topics will be addressed in the following pages. By following these suggestions, you will be able to enjoy sound that only Marten loudspeakers can deliver.

As a Marten loudspeaker owner, you are always welcome to come to our visitors center, where, in a relaxed environment, you can listen to our full range of loudspeakers.

Marten Design Philosophy

Marten loudspeakers are extremely sensitive instruments, and will give you many enjoyable musical moments.

Marten loudspeakers create certain demands on the accompanying hi-fi equipment, the burn-in process, and the placement of the speakers in the listening room. Even small changes in any of these areas can change the sound considerably.

The sound and musicality of Marten loudspeakers depend upon such factors as your choice of cables and source components. Even the quality of the recordings matters. Marten loudspeakers will reproduce, in extremely high detail, the slightest imperfection in recordings and in stereo systems.

The pure, present, detailed sound image and musicality of a Marten loudspeaker defines high end. Emphasis is not only put on great sound, but on design as well. Marten speakers are easily integrated in any living environment.

Unpacking

When you receive your loudspeakers, you should make sure that the shipping box is in its original state. If that is not the case, please contact your dealer.

Unpack the loudspeaker carefully, as there are several parts that can be damaged. We suggest that you keep your box and inserts. You may need them for transporting your loudspeakers.

Make sure that each of your shipping boxes contains the following:

2 pcs Coltrane Supreme main loudspeaker
2 pcs Coltrane Supreme bass loudspeaker
4 pcs stainless steel stands with Black Diamond
Racing cones and pucks
16 pcs M8 bolts
1 pcs Coltrane Supreme amplifier/crossover
4 pcs Coltrane Supreme jumpers
1 pcs Owner's Manual

We recommend that at least two persons help each other in unpacking the loudspeakers.

- Open the shipping boxes close to the intended listening place.
- Make sure that the box is placed upon a soft surface.
- Open the box and remove the plastic foam material.
- Lift the speaker out from the box. One person lifting at each end and place it upside down on a soft surface.
- Remove the cloth material from the loudspeaker.
- Assemble the stainless steel stands with the cones.
- Raise the speaker upright and place it on the Black Diamond Racing pucks.

Quick Setup

Your Coltrane Supreme loudspeaker system need quite a bit of playing time in order to reach their maximum performance. The use of the burn-in CD enclosed with the Coltrane Supreme loudspeakers is recommended to speed up this process. Follow these steps:

1. Connect interconnects from your source to the Supreme amplifier/crossover.
2. Connect the interconnects from the Supreme amplifier/crossover to your main amplifier.
3. Connect the bass cables from the Supreme amplifier/crossover to the bass loudspeakers.
4. Connect the loudspeaker cables from your main amplifier to the main loudspeakers.
5. Connect the power cord to the Supreme amplifier/Crossover.
6. Switch the system on and wait at least 5 minutes before you do anything.
7. Put the CD in your CD player.
8. Choose track 1 and set it on repeat.
9. Set the volume to a moderate level.

The CD should be played for a minimum of 24 hours before attempting to adjust the loudspeaker placement. For more in-depth information about this process, please refer to the section about burn-in.

Connecting the Loudspeakers

To make the most of your Coltrane Supreme loudspeaker system, please consider the following suggestions:

Choice of cable

The impact loudspeaker cables can have on the sound is dramatic. Be sure to use the same brand, type, and length of cable on each channel. Mixing different types and/or lengths of cable can upset the precise timing and balance of your loudspeaker.

We recommend the use of Jorma Design Prime cable to achieve maximum result. It is the same as the loudspeaker's internal wiring.

Bi-wiring/bi-amping

The Coltrane Supreme loudspeaker system are designed with bi-wiring in mind. If you prefer bi-amping, we recommend that you use the same type of cable for best sound reproduction. For single-wire applications, please use the enclosed jumpers.

Connections

At the back of your Supreme loudspeaker, you will find four pairs of heavy duty terminals that will accept any standard connection. Whatever type of connection you use, make sure that the contact is tight, and has a proper contact area. Tighten the posts, and then retighten after a few days to make sure that the connections haven't loosened.

Always turn off the power of your entire system before making connections to your speakers. We recommend using an amplifier with sufficient power (typically a minimum of 30 watts).

In order to obtain the best localization of instruments and voices, as well as the deepest, most natural bass, it is important to connect your loudspeakers in phase (which means that the drivers are moving in and out in the same direction and at the same time). The connectors on the speakers are clearly marked, and those on your amplifier and speakers cables should be also be marked. Keep all markings consistent in order to ensure in-phase connections.

Burn-in

The higher the quality of a loudspeaker system, the more demanding it will be regarding burn-in time. Your newly unpacked Coltrane Supreme loudspeaker system need quite a bit of playing time to reach their optimum performance capability.

We have enclosed a CD to help speed up this process. Please allow the CD to be run for a minimum of 24 hours before attempting to adjust the placement of the loudspeakers in your listening room. Due to the high-tech materials used in the drivers, the Coltrane Supreme will sound a bit harsh in the beginning, but after 50 hours of playing your loudspeakers will sound good.

After about 200 hours of playing, your system will be optimized. The sound will be more open and detailed, and display more natural musical warmth.

Compare the process to that of a fine musical instrument, which has to be played for a period of time before reaching its full musical potential.

Room Acoustics

A good listening room has just the right amount of reflection and absorption. The performance of any loudspeaker depends upon the speaker's location in the room and the acoustical conditions in that part of the room. Furnishings, size, and proportions all effect tonal balance, imaging, and bass characteristics.

To test the sonic balance of your room, stand in the location where the speakers will be installed and clap your hands two or three times. If the room is reverberant, you will hear a sharpness or echo. If the room is dull, the sound of the clap will decay rapidly and there will be little or no echo.

Large areas of glass, mirrors, or wood panelling will reflect sound waves and often result in brittleness and extreme brightness. You can correct this by breaking up these sound waves with softer surfaces like draperies or wall hangings. Try to create random reflections. Put a lot of time into the placement of the speakers. Experimenting with this will be well worth the effort.

Positioning

Every room is shaped and decorated differently, and is therefore presents unique requirements for the positioning of loudspeakers. Your loudspeakers will function at their best when placed on a flat, stable surface.

Loudspeaker Placement

The space between the loudspeakers should be free. Ideally, the space should be symmetrical in the area around the loudspeakers. We recommend experimenting with the placement of your loudspeakers in order to obtain the best balance, openness, and perception of depth. The bass loudspeakers should be placed quite near the main speakers on the outside of them if possible (see picture 1).

Distance to back and side walls

The Coltrane Supreme loudspeaker system should be no closer than 70 cm (27.6 Inch) from the rear wall.

The main loudspeakers should not be placed close to a side wall, as reflections from these can disturb the depth of the sound image. The bass towers however can be placed quite near the side walls since you can adjust the level and phase at the amplifier/crossover.

Adjusting the level and phase

At the back of the Coltrane Supreme amplifier/crossover you will find controls for level and phase for the bass. For start positioning set the controls as picture 2 if the loudspeaker is placed similar to picture 1. After that you can adjust the level and phase to your liking.

Focusing the Loudspeakers

Due to their highly advanced technology, the Coltrane Supreme loudspeakers will deliver excellent imaging, even at a relatively close listening distance. The distance ultimately depends on the room's shape, size, and your listening taste. Please use track 2 of the enclosed CD as a guide to focusing the sound image.

The goal is to have balanced sound. Ideally, you should be able to place the recorded voice in the middle of your speaker arrangement. Ultimately, the shape, size, and furniture in the listening room all influence the end result, so take some extra time to experiment with the position of the loudspeakers.

Toe-in

The loudspeakers should normally be toed in toward the listening area to focus the sound. The amount of toe-in will depend upon your listening preferences and the room environment and dimensions.

Enclosed CD

1. Burn in Sweep
2. Focusing the Loudspeakers



Track 2 taken from the CD – “Feathers” with Jeanette Lindström & Steve Dobrogosz
© 200, PROPHONE RECORDS AB

For more information of the CD “Feathers” please visit www.prophonerecords.se

Care of loudspeakers

Marten loudspeakers require no special treatment apart from the kind of handling you would apply to any high-tech product in your home.

Because many different materials are used in the making of the loudspeakers, all-in one cleaning materials should not be used. Never apply abrasive/ aggressive cleaning fluids to the outside of the unit.

The cabinet and other parts should only be cleaned with a soft, dry or slightly damp cloth.

Service

Do not attempt to open the unit's case.
Refer all servicing to qualified service personnel.

In the event your Coltrane Supreme loudspeakers need to be serviced, please contact your dealer, who will decide whether the problem can be remedied locally, or whether to contact Marten for service.



Owners manual

Warranty

Marten provides a transferable, limited manufacturer’s warranty. This warranty covers faults or defects in material or production only. Damage caused by abuse or misuse, or by the use of defective electronics, is not covered by warranty.

Please contact your local Marten dealer for more information about this warranty.

Warranty Exclusion

Transportation damage, visible or hidden. Damage should be reported immediately to the transport company. Registration of the complaint should be sent to the Marten distributor.

Scratches in paint, wood, metal, or carbon surfaces. Complaints should be made to the dealer within three days after the sale.

Damage due to illicit handling and inappropriate use.

Transportation costs to service station or factory.

Damage through unauthorized repair and/or modification.

Subsequent damage to other appliances.

Refund of costs in case of unauthorized repair.

Malfunction caused by use for commercial or professional purposes.

All claims on Marten products obtained through unauthorized sources, with or without correct serial numbers.

Serial Number

Your unique serial number is:

Technical Specifications: Coltrane Supreme main loudspeakers

Frequency range:	90-100000 Hz +-1.5 dB
Power rating:	300 W continuous, 1500 W peak
Sensitivity:	93 dB/2.83 V
Impedance:	6 ohm (4.3 ohms minimum)
Type:	Sealed box system
Drive units:	Four 7" ceramic-woofers, 7" lower midrange, 2" diamond midrange, 3/4" diamond tweeter
Crossover frequency:	Second and first order: 300, 1200, 8000 Hz
Terminals:	Custom made, biwiring
Cabinet:	25 mm:s carbon fibre laminate sides, 60 mm wood front, back, top and bottom
Dimensions (WxHxD):	Polished steel with Black Diamond Racing cones and pucks
Net weight:	260 x 1370 x 400 mm (10.2" x 53.9" x 15.7")
Finishes:	90 kg/ ea. (200 lbs) High-gloss carbon fibre sides with Oak, Maple, Cherry or Walnut

Technical Specifications: Coltrane Supreme bass loudspeakers

Frequency range:	17-100 Hz -3 dB
Power rating:	800 W continuous, 4000 W peak
Impedance:	4 ohm (4.0 ohms minimum)
Type:	Ported system, 22 Hz
Drive units:	Six 9" ceramic-woofers
Terminals:	Custom made
Cabinet:	25 mm:s carbon fibre laminate sides, 60 mm wood front, back, top and bottom
Stands:	Polished steel with Black Diamond Racing cones and pucks
Dimensions (WxHxD):	360 x 1760 x 500 mm (14.2" x 69.3" x 19.7")
Net weight:	115 kg/ ea. (255 lbs)
Finishes:	High-gloss carbon fibre sides with Oak, Maple, Cherry or Walnut

Technical Specifications: Coltrane Supreme amplifier/crossover

Power:	2000 Watt / channel in 4 Ohms
Output principle:	Class AB bipolar
Crossover:	Lowpass:: 4:th order (24 dB/octave) digital. High pass: 4:th order (24 dB/octave) analogue Crossover frequency: 100 Hz
Power supply:	Switch mode 11 KVA
Terminals:	Custom made
Dimensions (WxHxD):	480x217x650 mm, (18.9"x8.5"x25.6")
Net weight:	36 kg (80 lbs)
Finish:	Satin aluminium

Marking of the "CE" symbol indicates compliance of this device with the EMC and LDV standards of the European Community.

Picture 1

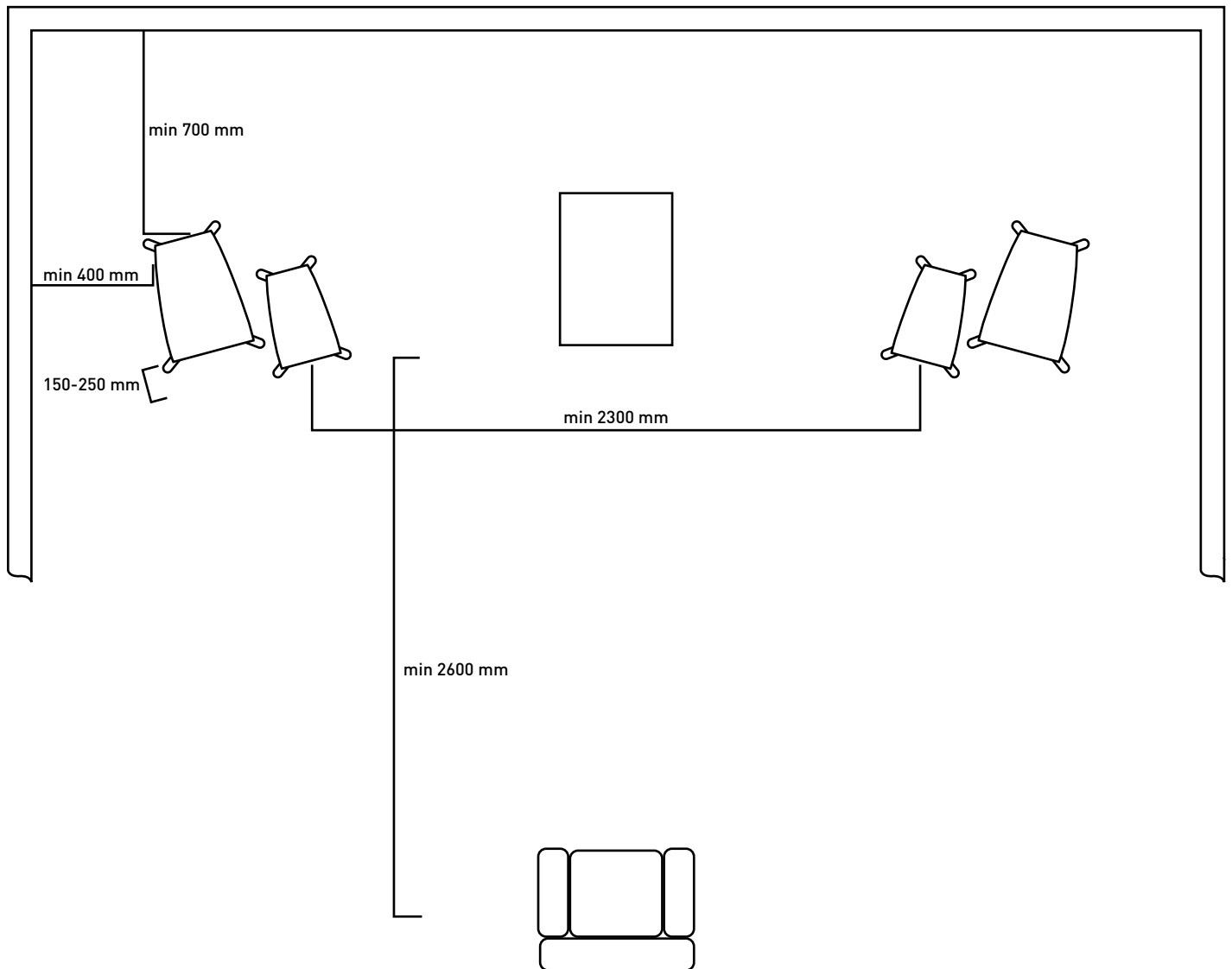

Picture 2

