

## Vehicle features



### Automatic transmission:

**P** = park  
**R** = reverse  
**N** = neutral  
**D** = drive

The selector lever can only be moved out of **P** or **N** when the ignition is on and the foot brake is depressed (selector lever lock).

To engage **P** or **R**, push the release button on the selector lever.

When position **N** is selected, depress foot brake or apply parking brake before starting.

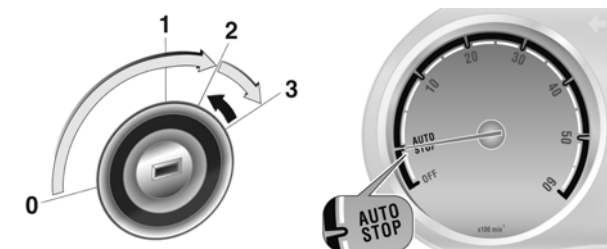

### Starting the engine:

- Turn key to position 1
- Move steering wheel slightly to release steering wheel lock
- Manual transmission in neutral with clutch depressed
- Automatic transmission in **P** or **N** with brake pedal depressed
- Do not accelerate
- Diesel engines: Turn key to position 2 for preheating and wait for 00 to extinguish in instrument cluster
- Turn key to position 3 and release when engine is running

### Manual transmission automated:

**A** = Switch between Automatic and Manual mode  
● = drive (Automatic mode)  
+ = higher gear (Manual mode)  
- = lower gear (Manual mode)  
**N** = neutral  
**R** = reverse gear

When starting off, depress foot brake and move selector lever to **A**, + or -. The transmission is in Automatic mode and first gear is engaged.

In **A**, first gear is engaged and the clutch is released when the vehicle is stopped.

### Manual transmission:

Reverse gear:  
With vehicle stationary, wait 3 seconds after depressing clutch pedal, press release button on selector lever and engage gear.

If the gear does not engage, set the foot to neutral, release the clutch pedal and depress again; then repeat gear selection.

In **A**, first gear is engaged and the clutch is released when the vehicle is stopped.



### Load compartment:

Unlock the vehicle by pressing button on remote control - or - by turning key in driver's door lock towards the front of the vehicle.

To open the tailgate, pull the button underneath the tailgate moulding.

Use interior handle to close.

Do not pull button underneath the tailgate moulding when closing or the tailgate will unlock again.

To activate an Autostop:  
■ Depress clutch pedal  
■ Shift to neutral  
■ Release the clutch pedal  
The needle points to **AUTO STOP** in the tachometer.

To restart engine, depress clutch again.

## Vehicle features



### Parking brake:

Always apply parking brake firmly without operating the release button and apply as firmly as possible on an uphill or downhill slope.

To release the parking brake, pull up lever slightly, press the release button and lower lever fully.

To reduce the operating forces of the parking brake, depress the foot brake at the same time.

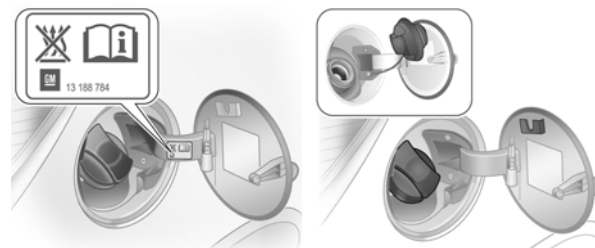

### Refuelling:

Before refuelling, switch off engine and any external heaters with combustion chambers (identified by sticker on fuel filler flap).

Fuel filler flap is located at right rear side of vehicle.

In vehicles with remote control central locking, the fuel filler flap can only be opened if the vehicle is unlocked.

Open fuel filler flap by hand.

Unlock the fuel filler cap with the ignition key, unscrew and remove.

### Opening the bonnet:

Pull the release lever located below the instrument panel on the front passenger's side and return it to its original position.

Lift the safety catch upwards and open the bonnet.

Secure the bonnet support.

If the bonnet is opened during an Autostop, the engine will be restarted automatically for safety reasons.

Before closing, press the bonnet support into its holder.

Lower the bonnet and allow it to drop into the catch. Check that the bonnet is engaged.

### Engine oil:

Check the engine oil level manually on a regular basis to prevent damage to the engine.

Ensure that the correct specification of oil is used.

Check with vehicle on a level surface. Engine must be at operating temperature and switched off for at least 5 minutes.

Pull out dipstick, wipe it clean, insert to the stop on the handle, pull out and read engine oil level.

Insert dipstick to stop on handle and make half a turn.

### Important:

It is the owner's responsibility to maintain the correct level of an appropriate quality oil in the engine.

Do not allow the engine oil level to drop below the minimum level!

### Fuel specifications:

Petrol engines - only use unleaded fuel that complies with DIN EN 228.

Diesel engines - only use diesel fuel that complies with DIN EN 590.

### Capacities:

Fuel tank capacity (All petrol/diesel engines except A13DTE) - 45 litres.

Fuel tank capacity (Diesel engine A13DTE) - 40 litres.

## Vehicle features

### Tyre pressure:

Check tyre pressures, including the spare, every 14 days and prior to any long journey; tyres should be checked when cold. This also applies to vehicles with tyre pressure monitoring system.

The tyre pressure data refers to cold tyres. It applies to summer and winter tyres.

Always inflate the spare tyre to the value specified for full load.

The ECO tyre pressure serves to achieve the smallest amount of fuel consumption possible.

Incorrect tyre pressures will impair safety, vehicle handling, comfort and fuel economy and increase tyre wear.

Consult a workshop regarding permitted tyres and further restrictions.

Tyre pressure (psi) Comfort setting for load of upto 3 people			Tyre pressure (psi) ECO setting for load of upto 3 people			Tyre pressure (psi) For full load		
Engine	Tyres	Front Rear	Engine	Tyres	Front Rear	Engine	Tyres	Front Rear
A10XEP, A12XEL, A12XER, A14XEL, A14XER	All tyres	29 26	A10XEP, A12XEL, A12XER, A14XEL, A14XER	All tyres	39 36	A10XEP, A12XEL, A12XER, A14XEL, A14XER	All tyres	38 46
A14NEL	All except below 225/40 R18	33 30 36 33	A14NEL	All except below 225/40 R18	41 38 -1) -1)	A14NEL	All except below 225/40 R18	36 46 39 46
A16LER	All except below 225/35 R18	34 32 38 34	A16LER	All except below 225/35 R18	39 36 -1) -1)	A16LER	All except below 225/35 R18	38 46 41 46
A16LES	205/45 R17 225/35 R18	34 32 38 34	A16LES	205/45 R17 225/35 R18	39 36 -1) -1)	A16LES	205/45 R17 225/35 R18	38 46 41 46
A13DTC	All except below 185/60 R15	29 26 32 26	A13DTC	All tyres	39 36	A13DTC	All tyres	38 46
A13DTE	All tyres	39 36	A13DTE	All tyres	39 36	A13DTE	All tyres	39 46
A13DTR	All except below 185/60 R15	32 29	A13DTR	All tyres	39 36	A13DTR	All tyres	38 46
Z13DTJ	All except below 185/60 R15	29 26 32 26	Z13DTJ	All tyres	39 36	Z13DTJ	All tyres	38 46
A17DTS	All except below 185/60 R15	35 32	A17DTS	All tyres	39 36	A17DTS	All tyres	38 46
All	Temporary spare	61 61				All	Temporary spare	61 61

<sup>1)</sup> Do not use ECO tyre pressure for this tyre.



# Corsa

## Quick Reference Guide

Refer to Owner's Manual for detailed information. Illustrations may depict left-hand drive vehicles. Operation is similar for right-hand drive vehicles.



Depending on the model variant, special equipment and accessories, the scope of equipment on your vehicle may differ from the descriptions in this guide.

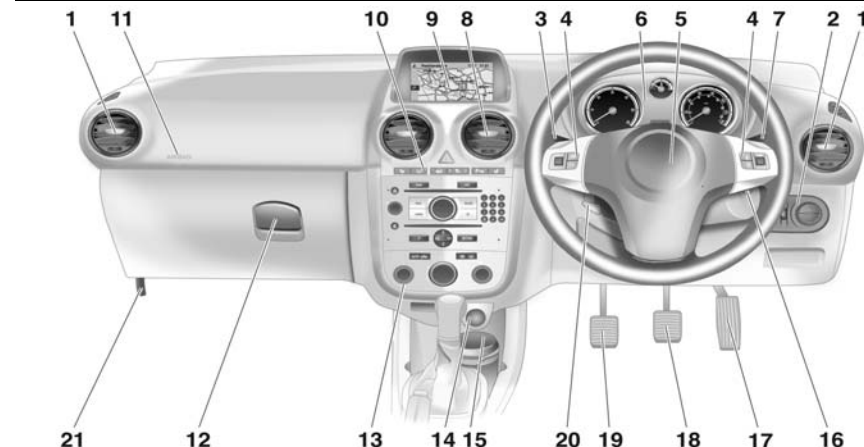

1. Side air vents
2. Light switch, fog lights, headlight range adjustment, instrument illumination
3. Turn signals, headlight flash, low beam and high beam, exit lighting, parking lights, cruise control
4. Steering wheel controls
5. Horn, driver airbag
6. Instruments
7. Wipers and washers, trip computer
8. Centre air vents
9. Info-Display, trip computer, Electronic climate control
10. Heated seats & steering wheel, tyre deflation detection, parking assist, fuel selector
11. Front passenger airbag
12. Glovebox
13. Climate control system
14. Cigarette lighter, power outlet
15. Ashtray
16. Ignition switch with steering wheel lock
17. Accelerator pedal
18. Brake pedal
19. Clutch pedal
20. Steering wheel adjustment
21. Bonnet release lever

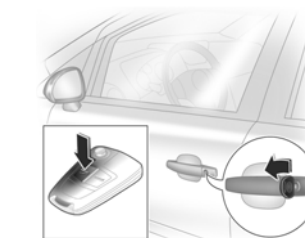

### Unlocking the vehicle:

First press button to extend key from foldaway section.

Press button on remote control - or - turn key in driver's door lock towards the front of the vehicle to unlock the doors, load compartment and fuel filler flap.

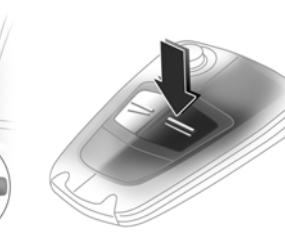

### Locking the vehicle:

Press button on remote control - or - turn key in driver's door lock towards the rear to lock the vehicle.

Make sure all doors, load compartment and fuel filler flap are closed or the central locking system will not work properly.

### Central locking:

To lock or unlock doors from inside the vehicle, press central locking button in the centre console with the doors closed.

The LED in the button illuminates for approx. 2 minutes after locking with the remote control.

If the doors are locked from inside whilst driving, the LED remains illuminated.

The vehicle can also be configured to unlock only the driver's door when pressing button once on the remote control. Pressing twice will unlock the entire vehicle.

### Electronic immobiliser:

Activated automatically when key is removed from ignition switch.

## Vehicle features



**Longitudinal seat adjustment:** Pull handle, slide seat, release handle. Ensure the backrest engages.

**Danger:**

Do not sit nearer than 25 cm from the steering wheel, to permit safe airbag deployment.



**Seat backrests:** Turn handwheel. Do not lean on seat when adjusting. Do not angle the backrest too far back. We recommend a maximum rake of approx. 25°.



**Seat height:** Lever pumping motion up = seat higher down = seat lower



**Seat folding:** Lift release lever and tilt backrest forwards. Lower the release lever and backrest engages in lowered position. Slide seat forwards. Do not operate handwheel to adjust backrest rake with backrest in folded position.

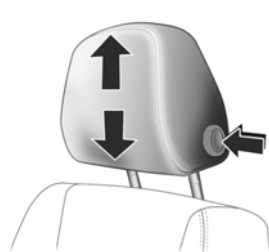

**Head restraint adjustment:** Press the release button, adjust height and engage. The upper edge of the head restraint should be level with the top of the head.



**Seat belt:** Withdraw seat belt from retractor, guide it untwisted across the body and insert latch plate in belt buckle. To release belt, press red button on belt buckle.



**Seat belt height adjustment:**  
1. Pull belt out slightly.  
2. Press button.  
3. Adjust height and engage.

Adjust the height so that the belt lies across the shoulder. It must not lie across the throat or upper arm.

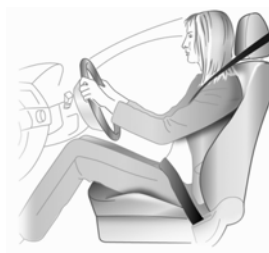

**Seat position:** Sit with buttocks as far back against backrest as possible. Adjust distance between seat and pedals so that legs are slightly angled when depressing pedals.

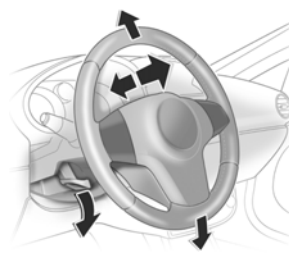

**Steering wheel adjustment:** Unlock lever, adjust steering wheel, then engage lever and ensure it is fully locked. Do not adjust steering wheel unless vehicle is stationary and steering wheel lock has been released.

## Vehicle features



**Interior mirror:** Swivel mirror housing to adjust. To reduce dazzle, adjust the lever on the underside of the mirror housing.



**Automatic anti-dazzle interior mirror:** Dazzle from following vehicles at night is automatically reduced if the vehicle is equipped with an automatic anti-dazzle interior mirror. The lever will not be present on the underside of the mirror housing.

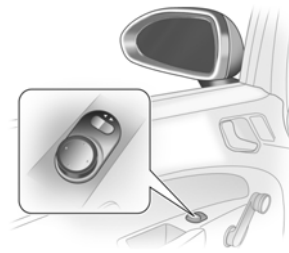

**Electrical exterior mirrors: (Version with manual window operation)** Select the relevant exterior mirror with the switch. Use the control to adjust the mirror.

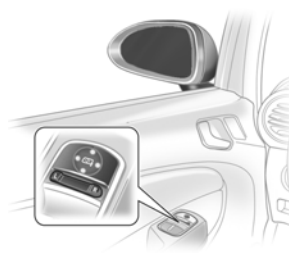

**Electrical exterior mirrors: (Version with electronic window operation)** Select the relevant exterior mirror by pressing left (L) or right (R) on the switch. Use the control to adjust the mirror.



**Power windows:** With the ignition on, power windows are operated via the switches in the door. ■ Press switch = Open window ■ Pull switch = Close window

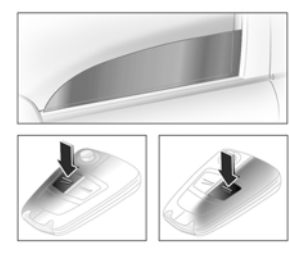

**Operating windows from outside:** Depending on the equipment level, the windows can be operated remotely from outside the vehicle. Press button or on the remote control until all windows have opened or closed.

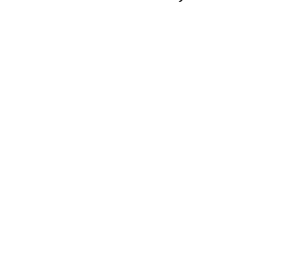

In vehicles with automatic opening and closing, operate the switch again to stop window movement. If the window glass encounters resistance during automatic closing, it is immediately stopped and opened again. If the windows are operated repeatedly at short intervals, window operation is temporarily disabled.

## Vehicle features



**Light switch:** = Activation or deactivation of automatic light control (switch returns to **AUTO**) **AUTO** = Automatic light control: Headlights are switched on and off automatically

= Sidelights = Headlights

Press switch: = Front fog lights = Rear fog light = Headlight range adjustment = Instrument illumination



**Headlight range adjustment :** Adapt headlight range to the vehicle load to prevent dazzling of other road users.

Turn thumb wheel to select the required position:  
■ Front seats occupied = 0  
■ All seats occupied = 1  
■ All seats occupied and load compartment laden = 2  
■ Driver's seat occupied and load compartment laden = 3

The setting is shown in the odometer display.



**Automatic light control:** When the automatic light control is active and the engine is running, the system switches between daytime running lights and headlights, depending on external lighting conditions.

During poor external lighting conditions, the headlights will switch on automatically. Daytime running lights increase visibility of the vehicle during daylight. The tail lights are not illuminated.

When a tunnel is entered, the headlights switch on automatically.

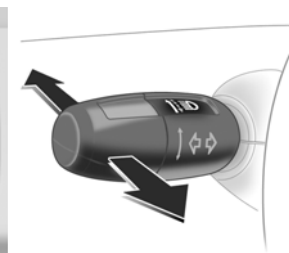

**Headlight flash, high beam and low beam:** Headlight flash = Pull lever towards steering wheel High beam = Push lever forwards Low beam = Push lever forwards again or pull towards steering wheel



**Front fog lights:** Operated with the button. Light switch in position **AUTO**: switching on front fog lights will switch headlights on automatically.

**Rear fog light:** Operated with the button. Rear fog light can only be switched on when both the ignition and headlights (with front fog lights) are switched on. Light switch in position **AUTO**: switching on rear fog light will switch headlights on automatically. Vehicle rear fog light is deactivated when towing.

## Vehicle features

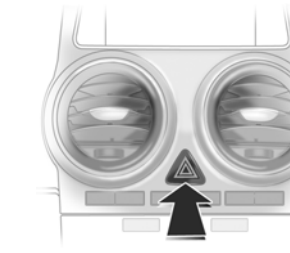

**Hazard warning flashers:** Operated with the button. In the event of an accident where the airbags are deployed the hazard warning flashers are activated automatically.

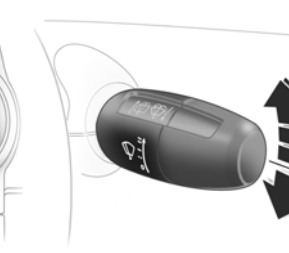

**Windscreen wiper:** = Fast = Slow = Timed interval wiping or automatic wiping with rain sensor = Off For a single wipe when the windscreen wiper is off, press the lever down. Do not use if the windscreen is frozen. Switch off in car washes.

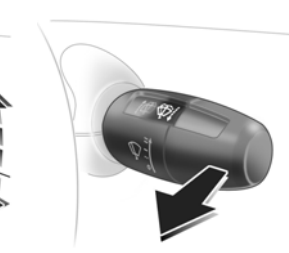

**Windscreen washer:** Pull lever. Washer fluid is sprayed onto the windscreen and the wiper wipes a few times. On vehicles fitted with a rain sensor, keep the sensor area clean by operating the washer system regularly.



**Rear window wiper/washer:** Push lever forwards. The rear window wiper wipes in timed interval mode. Switch off by pushing lever forwards again. Do not use if the rear window is frozen. Switch off in car washes. If the lever is held forwards, washer fluid is sprayed onto the rear window. Rear window wiper comes on automatically when the windscreen wiper is switched on and reverse gear is engaged. The vehicle can be configured to activate or deactivate this function.



**Heated rear window, heated exterior mirrors:** The heating is operated by pressing the button. Heating works with the engine running and is switched off automatically after a short time. Depending on engine type, heating comes on automatically during driving when the diesel particle filter is being cleaned.



**Demisting and defrosting the windows:** ■ Set air distribution to ■ Set temperature control to the warmest level ■ Set fan speed to the highest level ■ Switch cooling on ■ Switch heated rear window on ■ Open side air vents and direct them towards the door windows