



Portable Multi Steamer

USER MANUAL



MODEL: DSC21

IMPORTANT SAFEGUARDS

When using an electric appliance, basic precautions should always be followed:

READ ALL INSTRUCTIONS BEFORE USING THIS STEAMER

WARNING

DANGER OF SCALDING

CAUTION - To reduce the risk of fire, electric shock, or injury:

- To provide continued protection against risk of electric shock connect to properly grounded outlets only.
- Check that the main voltage corresponds to the voltage indicated on the rating label.
- This product is designed for domestic use only.
- Do not use outdoors.
- Do not leave the Steam Cleaner unattended while plugged in. Unplug the electrical cord when not in use and before servicing.
- Do not allow to be used as a toy. Close attention is necessary when used near children, pets or plants.
- The Steam Cleaner is not intended for use by young children or infirm persons without supervision. Young children should be supervised to ensure that they do not play with the appliance.
- Do not immerse the Steam Cleaner into water or other liquids.
- Never direct steam towards people, animals or plants, or equipment containing electrical components.
- Always unplug the power cord from the electrical socket when filling the Steamer.
- Do not use with damaged cord or plug. If the Steam Cleaner is not working as it should, has been dropped, damaged, left outdoors, or immersed into water, return it to a qualified service engineer before continuing use. If the supply cord is damaged, it must be replaced by a qualified service engineer.
- Do not pull or carry by cord, use cord as handle, close a door on cord, or pull cord around sharp edges or corners. Keep cord away from heated surfaces.
- Never force the plug into an outlet.
- Do not use extension cords or outlets with inadequate current carrying capacity.
- Unplug after use. Do not unplug by pulling on cord. To unplug, grasp the plug, not the cord.
- Do not insert any objects into openings. Do not use with any opening blocked.
- Do not handle plug or the Steam Cleaner with wet hands or operate without shoes.
- Do not touch the hot surfaces during use. Allow the accessories to cool down before changing them.
- Keep your work area well lighted.
- Never put desiccating, aromatic, alcoholic or detergent products into the Steamer as this may damage it or make it unsafe for use.
- Never block the steam openings of the product or place it on a soft surface, where the steam openings may be blocked, Keep the steam openings free of lint, hair, and the like.
- When filling with water use Measuring Cup. Do not try to overfill.
- Follow these steps before unscrewing the Filler Cap:
 - 1) Unplug the power supply and allow to cool down.
 - 2) Slowly start to unscrew the Filler Cap, wait a few seconds, then screw it off completely.
 - 3) Do not open water tank while in use.
- Use only as described in this manual. Use only manufacturer's recommended accessories and service agent.

SAVE THESE INSTRUCTIONS

KEY FEATURES

1. Handle
2. Safety Filler Cap
3. Locking Trigger Button
4. Trigger Release
5. Deluxe Hose
6. Steam Gun
7. Steam Trigger
8. Extension Tubes (2pcs)
9. Connector
10. Deluxe Floor Brush
11. Floor cotton cloth (2pcs)
12. Concentrator tool
13. Fabric Brush
14. Glass Squeegee
15. Round Brush (2pcs)
16. Funnel
17. Refill Cup(500ml)
18. Fabric Brush Pad
19. Shoulder Strap
20. Shoulder Strap Hook
21. Steam unit
22. Indicator Light

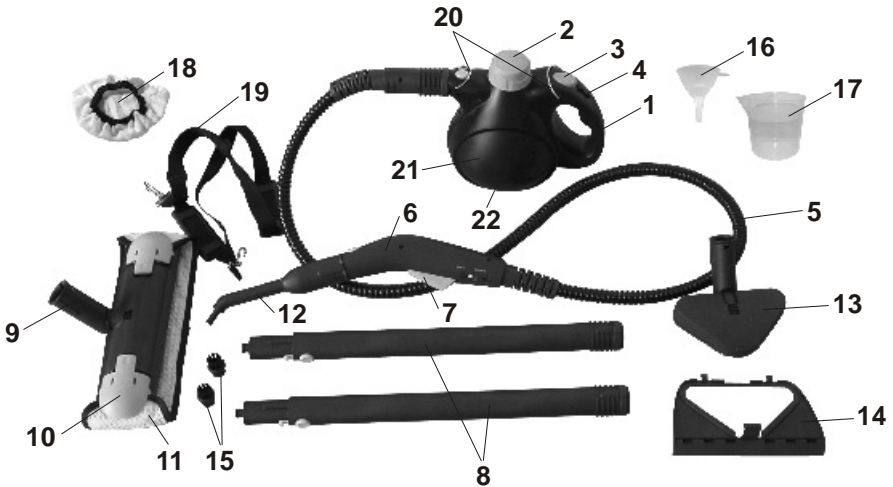

DESCRIPTION

Thank you and congratulations for choosing the Portable Multi Steam cleaner. Your **Steam Cleaner** utilizes pressurized steam to remove tough grease, dirt and grime. Steam is nature's purest and most powerful cleaner for safely cleaning all hard surfaces in your home without harsh chemicals, thus being perfectly ecological.

The appliance has various attachments so that it can be used for many purposes such as:

1. Clean upholstery, sealed grout, bathroom/kitchen tile, stovetops.
2. Easy to clean difficult to reach areas with the extension tubes and Concentrator tool.
3. Ideal for windows, mirrors, glass doors, etc.
4. Clean fabrics, window coverings, pillows, bedding etc.
5. Clean hard surface areas such as counters, sinks, shower door tracks, etc.

FILLING THE STEAM CLEANER WITH WATER

WARNING!

THERE IS A DANGER OF SCALDING. YOU MUST NEVER ATTEMPT TO REMOVE THE SAFETY CAP WHILE THE STEAM CLEANER IS SWITCHED ON OR UNDER PRESSURE. THE TOOLS AND HOSE WILL GET HOT DURING USE. ALLOW THE TOOLS TO COOL DOWN BEFORE CHANGING THEM WHILE THE STEAM CLEANER IS BEING USED.

The steam cleaner tank has a capacity of 650ml. Check that the steam cleaner is disconnected from the mains supply.

Press the Locking Trigger Button until any pressure has been released.

Unscrew the safety cap.

Check that there is no residual water in the steam cleaner. Always empty the unit first to ensure that only the correct measured volume of water can then be added.

Make sure the steam cleaner is on a stable flat surface.

Fill the measuring cup with water of 500ml and the tank with a maximum of 650ml. It is not necessary to use distilled water.

Using the funnel, pour the water into the steam cleaner.

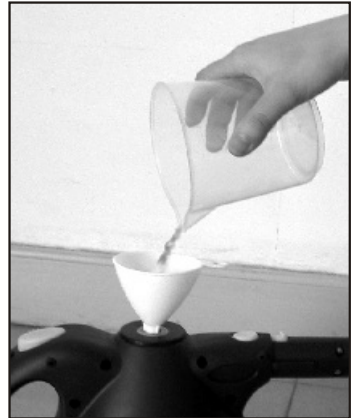

WARNING!

DO NOT OVERFILL THE TANK. USE ONLY 650ml WATER. NEVER PUT DESCALING, AROMATIC, ALCOHOLIC OR DETERGENT PRODUCTS INTO THE STEAM CLEANER, AS THIS MAY DAMAGE IT OR MAKE IT UNSAFE FOR USE.

Screw the safety cap back onto the steam cleaner and tighten by hand.

SWITCHING ON AND OFF

Mains Power

Plug the 3-pin mains plug into the mains supply.

The Indicator light will come on to show that the steamer is heating the water.

Steam will be available after approximately 3 to 4 minutes.

The steamer will provide continuous hot steam for approximately 20 minutes for each fill of the tank. (650ml).

To switch Off, unplug the power cable, the Indicator Light will go out.

NOTE: DO NOT LEAVE THE STEAM CLEANER UNATTENDED DURING THE HEATING-UP PERIOD.

USING THE STEAM CLEANER

Fitting the Accessory Tools

The tools can be fitted directly to the Gun, or to the end of the extension tubes. The two extension tubes can be fitted together to give extra reach if required.

To fit the tools or extension tubes first make sure that the aperture in the tool is aligned with the retaining lug on the Gun (or extension tube if fitted).

Push the tool or extension tube onto the end of the Gun (or extension tube if fitted) until it clicks into place and is held by the retaining lug.

To remove a tool or extension tube from the Gun, press and hold the tool release button and pull the tool off.

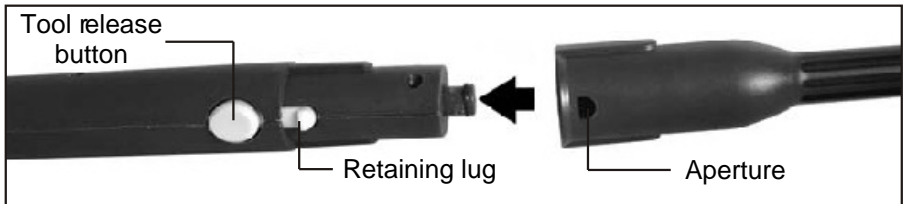

⚠ WARNING!

THE TOOLS, EXTENSION TUBES AND THE HOSE WILL GET HOT DURING USE. ALLOW THE TOOLS TO COOL DOWN BEFORE REMOVING THEM WHILE THE STEAM CLEANER IS BEING USED.

FITTING THE ACCESSORY TOOLS - CONTINUED

The tools can be fitted in a variety of different sequences. See below.

Always make sure that the tool is locked securely in place before using the steamer.

The glass squeegee must be used in conjunction with the fabric brush.

The round brushes can only be used in conjunction with the concentrator tool.

⚠ WARNING!

THE TOOLS, EXTENSION TUBES AND THE HOSE WILL GET HOT DURING USE. ALLOW THE TOOLS TO COOL DOWN BEFORE CHANGING THEM WHILE THE STEAM CLEANER IS BEING USED.

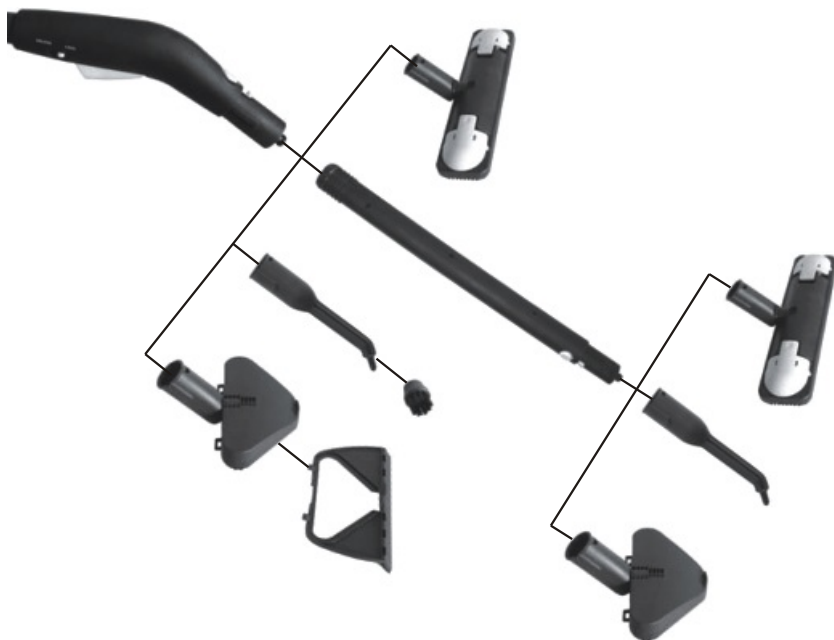

FITTING THE ACCESSORY TOOLS - CONTINUED

The floor brush cotton cloth can be fitted to the floor brush if a softer surface is required for cleaning.

To fit a floor brush cotton cloth, first press and hold down the cotton cloth retaining clip on one side of the floor brush.

Position one side of the floor brush cotton cloth under the retaining clip.

Release the retaining clip.

Wrap the floor brush cotton cloth over the bristles and then secure the end of the pad under the retaining clip on the other side of the floor brush.



The fabric brush cotton cloth can be fitted to the fabric brush if a softer surface is required for cleaning.

To fit the fabric brush cotton cloth, pull it over the fabric brush.



FITTING THE ACCESSORY TOOLS CONTINUED

The window cleaning squeegee can be attached to the fabric brush.

Remove the fabric brush pad, if fitted.

Locate the two lugs on the squeegee in the slots on the rear of the fabric brush.

Push the squeegee upwards until it clicks into place over the clip on the front of the fabric brush.



The round brush can be fitted to the concentrator tool for cleaning in corners and other areas with limited access.

To fit the round brush, push it firmly on to the end of the concentrator tool.



WARNING!

DO NOT HOLD THE EXTENSION HOSE WHEN IN USE AS IT WILL BE HOT.

NOTE: ALWAYS STORE THE TOOLS IN A SAFE PLACE.

ATTACHING THE SHOULDER STRAP

Using the detachable shoulder strap allows for greater freedom of movement when both hands are needed for various cleaning tasks. To attach the shoulder strap to the steam cleaner, simply snap to the shoulder strap hooks onto the connecting rings on the unit body. When using the steam cleaner with the shoulder strap, avoid rocking or tilting the unit excessively as this may cause water to enter the hose and be discharged along with the steam.

USING THE STEAM CLEANER

WARNING!

DO NOT USE THIS STEAM CLEANER ON ANY APPLIANCE THAT CONTAINS ELECTRICAL COMPONENTS, (SUCH AS THE INTERIOR OF OVENS), AND IS NORMALLY CONNECTED TO A MAINS OR BATTERY POWER SUPPLY. NEVER TURN THE HAND STEAMER ON ITS SIDE WHEN STEAM CLEANING, OR DIRECT STEAM AT ANY PERSON, PET OR PLANT.

CAUTION!

DO NOT USE ON DRAYLON, SOFT PLASTICS, UNSEALED WOOD AND COLD GLASS. ON SURFACES THAT HAVE BEEN TREATED WITH WAX OR SOME NON-WAX FLOORS, THE SHEEN MAY BE REMOVED BY THE HEAT AND STEAM ACTION.

NOTE: IT IS RECOMMENDED THAT A SAMPLE CLEANSING BE CARRIED OUT ON AN ISOLATED AREA OF THE SURFACE TO BE CLEANED. ALSO, CHECK WITH THE RESPECTIVE MANUFACTURER'S LITERATURE FOR THE OBJECT TO BE CLEANED.

OPERATING THE TRIGGER LOCK.

THE TRIGGER LOCK CAN BE USED TO LOCK THE STEAM TRIGGER OFF PREVENTING ACCIDENTAL STEAM RELEASE AND IT CAN ALSO BE LOCKED ON IN THE CASE OF LONG CLEANING PROCESSES WHICH MAKES IT EASIER ON THE HAND. THE TRIGGER IS LOCKED BY SLIDING THE SWITCH FORWARD AND RELEASED BY SLIDING THE SWITCH BACK.

Press the Trigger Button

Steam will be released from the tool.

Pass the tool you are using slowly over the surface to be cleaned. To sanitize specific areas, pass the tool slowly over the area at a distance of no more than one inch away.

The tools can be used to clean and sanitize work surfaces, remove the lime scale from taps and tiles, and for non-electrical oven utensils.

Non-electrical cooker parts, such as oven racks, baking trays, griddles, pan supports and removable oven linings must be steam cleaned well away from any electrical components. Ensure that these parts are completely dry prior to reassembly.

Refilling the steam cleaner while cleaning

Should the need arise to refill the steam cleaner with water while cleaning, unplug the power cable from the mains supply socket.

Press the steam release trigger until all pressure has been released.

WARNING!

ALTHOUGH THE STEAM PRESSURE IN THE STEAM CLEANER HAS BEEN RELEASED, THE STEAM CLEANER STILL CONTAINS VERY HOT WATER. DO NOT ATTEMPT TO REMOVE THE SAFETY CAP UNTIL THE STEAM CLEANER HAS COOLED DOWN.

Release Trigger button

Wait at least 5 minutes for the steam cleaner to cool, then carefully start to unscrew the safety cap. If you hear steam escaping, stop and wait until the hissing sound stops. Press steam trigger to safely release residual steam pressure.

Carefully, continue to unscrew the safety cap. If you hear steam escaping again, stop and wait for the hissing to stop. Continue in this manner until the safety cap can be removed.

Take great care, as any residual water will be very hot.

Check that there is no residual water in the steam cleaner. Always empty the unit first to ensure that only the correct measured volume of water can then be added.

Slowly fill the steam cleaner with water using the measuring jug and funnel.

Screw the safety cap back onto the steam cleaner and tighten by hand.

Plug the 3-pin mains plug into the mains socket.

The Indicator Light will come on.

Continue with the instructions for steam cleaning.

When you have finished steam cleaning, unplug the power cable from the mains supply socket.

Allow the steam cleaner and accessories to cool completely then empty any residual water. Clean and dry the accessories and store in a dry place.

MAINTENANCE

There are no user servicable parts inside the steam cleaner.

Cleaning

 **WARNING!**

THE STEAM CLEANER MUST BE UNPLUGGED FROM THE MAINS POWER SUPPLY AND ALLOWED TO COOL DOWN BEFORE ALL CLEANING AND MAINTENANCE TASKS. ALWAYS UNSCREW THE SAFETY CAP VERY CAREFULLY TO ENSURE THERE IS NO PRESSURE INSIDE UNIT. WAIT AT LEAST 5 MINUTES FOR THE STEAM CLEANER TO COOL, THEN CAREFULLY START TO UNSCREW THE SAFETY CAP. IF YOU HEAR STEAM ESCAPING, STOP AND WAIT UNTIL THE HISSING SOUND STOPS. CAREFULLY, CONTINUE TO UNSCREW THE SAFETY CAP. IF YOU HEAR STEAM ESCAPING AGAIN, STOP AND WAIT FOR THE HISSING TO STOP. CONTINUE IN THIS MANNER UNTIL THE SAFETY CAP CAN BE REMOVED. DO NOT IMMERSE THE STEAM CLEANER IN WATER.

After each use, empty any remaining water from the steam cleaner.

Rinse out the steam cleaner every month to eliminate any accumulated calcium deposits. Make sure the steam cleaner is cold and disconnected from the mains supply. Fill the steam cleaner with approximately half a measuring jug of clean water. Screw the safety cap onto the steam cleaner and tighten by hand. Shake the steam cleaner for a few seconds, remove the safety cap and empty out the water into a container.

Wipe the body of the steam cleaner with a soft, dry cloth. Do not use any abrasive cleaners.

Store the steam cleaner in a dry, cool place.

TROUBLESHOOTING GUIDE

Below is a chart detailing the most common problems, their causes and solutions. Prior to troubleshooting, isolate the unit by removing the cord from the power socket.

PROBLEM	CAUSE	SOLUTION
No steam	The steamer is not on. Water tank is empty.	Plug the power cable and make sure the Indicator light is on. Refill the water tank as instructed.
No steam, but water	Condensation is formed inside the hose.	Press the Steam Trigger and release the water until steam comes.
Puffs of steam during refill	Water tank is too hot.	Leave the steamer to cool down for a while before refill, use the provided Funnel for refill every time.

After Sales Service.

Warranty: This product is warranted to the original user for 12 months from date of purchase free from manufacturing defect at time of purchase. The product is intended for domestic use. Please keep your receipt or other evidence of purchase showing date of purchase, as this must be produced in the event of a claim.

To claim under this warranty, or for other repair or assistance with this product, please contact Domotec Customer Service Department by phoning 01844 698516.

DOMOTEC HOME APPLIANCES LIMITED. Contact
service@innovationideas.co.uk www.innovationideas.co.uk
Beverbrook Ind. Est, Calne, Wilts. SN11 9PL.

This electrical appliance complies with directive 2002/96/EC (Waste Electrical and Electronic Equipment---WEEE).



The meaning of the crossed-through waste bin symbol on the appliance is that the product must be disposed of separately to other household waste at the end of the useful life of the appliance. The user is responsible for delivering the appliance to an appropriate collection centre at that time.

Appropriate separate collection for environment-friendly treatment and recycling prevents or reduces harmful effect on the environment and human health. You can obtain information on available collection services in your area by contacting your local Council waste collection department, or the retailer from which you bought the appliance.

Domotec Home Appliances is an Innovation Ideas quality brand.

**innovation
ideas**