

Para instrucciones en Español, llamar al: 1-800-233-5921



Best for Baby™

OWNER'S MANUAL

Keep for future use.

Big Kid™

Booster Seat Child Restraint System

Child Requirements

Weight: 30 – 100 lbs (13.6 – 45.3 kg)

Height: 38 – 57 inches (97 – 145 cm)

Age: At least three years old

⚠ WARNING

*To reduce the risk
of **SERIOUS INJURY** or
DEATH, read this owner's
manual prior to installing
and using this child
restraint.*

More children are killed every year as passengers in car crashes than by any other type of injury. To reduce the risk of **SERIOUS INJURY** or **DEATH**, read this owner’s manual and your vehicle owner’s manual before installing and using this child restraint. Using a child restraint makes a big difference. By properly using this child restraint and following these instructions (and the instructions that accompany your vehicle), you will greatly reduce the risk of serious injury or death to your child from a crash. Do not be misled by the commonly used term “safety seat;” no restraint system can prevent all injuries in all crashes. Many properly restrained adults and children are injured in motor vehicle crashes, including relatively minor crashes. A properly used child restraint is the best way to minimize injuries to your child and to increase the chances for your child’s survival in most crashes.

Table of Contents

| | |
|--|----|
| Important Notice..... | 1 |
| Warnings | 1 |
| Safe Practices..... | 4 |
| Recall Information..... | 4 |
| Airplane Usage..... | 5 |
| Care and Cleaning..... | 5 |
| Know Your Vehicle | 6 |
| Know Your Booster Seat..... | 6 |
| Assembling the Big Kid Booster..... | 8 |
| Using the Big Kid Booster <i>with</i> the Backrest | 10 |
| Using the Big Kid Booster <i>without</i> the Backrest..... | 12 |
| Removing the Backrest | 14 |
| Adjusting the Armrests..... | 15 |
| Adjusting the Backrest | 15 |
| Using the Shoulder Belt Clip | 16 |
| Using the Cup Holder/Snack Trays | 17 |
| Using the Activity Light..... | 18 |
| Replacement Parts | 19 |
| Storing Your Instructions | 19 |
| Limited Warranty | 21 |

• IMPORTANT NOTICE •

This child restraint conforms to Federal Motor Vehicle Safety Standard 213. No booster seat can guarantee absolute protection from injury in every crash. This booster seat is designed for use **ONLY** by children who weigh between 30 and 100 lbs (13.6 and 45.3 kg) and whose height is between 38 – 57 inches (97 – 145 cm) and whose ears are below the top of the seat back and who is at least three years old.

Big Kid Booster Seat Child Requirements

With Backrest:

- 30 – 100 lbs (13.6 – 45.3 kg)
- 38 – 57 inches (97 – 145 cm) tall
- Child is at least three years old or older

Without Backrest:

- 40 – 100 lbs (18 – 45.3 kg)
- 40 – 57 inches (101 – 145 cm) tall
- Child is at least three years old or older
- Ears below top of vehicle seat back

AWARNING

Failure to follow each of the following instructions can result in your child striking the vehicle’s interior during a sudden stop or crash, potentially resulting in serious injury or death. These instructions and the instructions in your vehicle owner’s manual must be followed carefully. If there is a conflict between the two, the vehicle owner’s manual regarding booster seat installation must be followed.

- **NEVER** leave child unattended.
- In addition to the height and weight requirements, your child must be at least three years old to use this booster seat.

⚠️ WARNING

Location Warnings

- According to statistics, children are safer when properly restrained in a rear seating position than in the front seating position. Children under 13 should ride in the back seat of the vehicle.
- Use this booster seat only on forward facing vehicle seats. **DO NOT** use this booster seat with vehicle seats which face the rear or side of the vehicle.
- Use this booster seat only on vehicle seats with backs that lock into place.
- Some booster seats do not fit in all vehicles. If the booster seat cannot be properly installed, **DO NOT** use the booster seat. Consult your vehicle owner's manual, try a different seating location, or call Evenflo at **1-800-233-5921** for further assistance.

Air Bag Warning

- **DO NOT** use this restraint in the front seat of a vehicle equipped with an active air bag. Air bags may cause serious injury or death to children under 13 years of age. If your vehicle has an air bag, refer to your vehicle owner's manual for child restraint installation.
- If the rear seat of your vehicle is equipped with side air bags:
Vehicles built prior to the 2002 model year:
DO NOT use this restraint in a vehicle seating position equipped with a side air bag unless authorized by the vehicle manufacturer.
Model year 2002 and newer vehicles: Refer to your vehicle owner's manual before placing this restraint in a seating position equipped with a side air bag. **DO NOT** place any objects between the restraint and the side air bag, as an expanding air bag may cause the items to strike your child.

Booster Seat Position Warnings

- **DO NOT** use this booster seat rear-facing.
- When using this booster seat, the headrest on the vehicle seat that the child faces should be put in its lowest position. The vehicle seat back that the child faces must be fully padded and free of any hard objects.

⚠️ WARNING

Seat Belt Warnings

- **DO NOT** use this booster seat in a vehicle with door-mounted seat belts.
- **DO NOT** use this booster seat in a vehicle with seat belts that automatically move along the vehicle frame when the door is opened. These seat belts will not hold a booster seat properly.
- When using this booster seat, **NEVER** use a lap belt only. You **MUST** use vehicle seat belts that have a lap/shoulder combination.
- **DO NOT** use this booster seat if the child's ears are above the back of the booster seat.
- Failure to adjust the seat belts snugly around your child may result in your child striking the vehicle's interior during a sudden stop or crash. Serious injury or death may occur.
- **DO NOT** use this booster seat if it is damaged or has broken or missing parts.



Additional Warnings

- **DO NOT** use this booster seat if it has been involved in an accident. It must be replaced.
- This booster seat must be securely belted to the vehicle at all times. An unsecured booster seat may injure someone if a crash occurs.
- **DO NOT** attach additional padding, toys, or other devices not made by Evenflo to the booster seat. Items not tested with the booster seat could injure the child.
- In hot, sunny weather cover the seat with a light colored blanket when you leave the vehicle. Always check the seat for hot surfaces before putting a child into the seat.
- **DO NOT** mix old and new batteries.
- **DO NOT** mix alkaline, standard (carbon-zinc), or rechargeable (nickel-cadmium) batteries.
- Remove batteries before storing unit for a prolonged period of time.
- **DO NOT** allow unit to get wet.

Safe Practices

- **Everyone rides buckled up or the vehicle does not go.** Make no exceptions for adults or children. If someone unbuckles, stop the vehicle. Being firm and consistent from the start will mean fewer discipline problems as children get older. An unrestrained person can be thrown into and injure other passengers.
- **NEVER** try to tend to a crying child's needs while driving. Never take a child out of a booster seat for comforting while the vehicle is moving.
- **DO NOT** allow a child to have objects such as lollipops or ice cream on a stick. These objects can injure the child if the vehicle swerves or hits a bump.
- Put sharp or heavy items in the trunk. Anything loose can be deadly in a crash.
- Leather (not available on all models) can become very hot in direct sunlight. Cover your booster seat with a blanket in warm weather.
- In cold weather a child may need an extra blanket for warmth. Put the child in the booster seat and cover both the child and the booster seat with a blanket.

Recall Information

- Child restraints could be recalled for safety reasons. You must register this restraint to be reached in a recall. Send your name, address, the restraint's model number, and manufacturing date to
Evenflo Company, Inc.,
1801 Commerce Dr.,
Piqua, OH 45356
or call 1-800-233-5921 or register online at:
<https://plweb.evenflo.com/productreg.aspx>
- For recall information call the U.S. Government's Vehicle Safety Hotline at 1-888-327-4236 (TTY:1-800-424-9153), or go to: **<http://www.NHTSA.gov>**

Airplane Usage

This booster seat is **NOT** certified for aircraft use. A belt-positioning booster seat requires the use of a lap/ shoulder belt system, which is not available on aircraft.

Care and Cleaning

- Plastic parts may be wiped clean with mild soap and water and dried with a soft cloth. Do not use abrasive cleaners or solvents.
- Take care not to damage any labels.
- The seat pad (except for leather seat pads—not available on all models) can be machine washed separately in cold water, delicate cycle, tumble dry 10 – 15 minutes on low heat.
- Never use booster seat without the seat pad.
- To help protect the vehicle upholstery, place a towel beneath and behind the booster seat.

For future reference, record the *model number* of your child restraint AND the *date of manufacture* below.

Model Number: _____

Date of Manufacture: _____

Know Your Vehicle

Your vehicle may appear significantly different than pictured. Consult your vehicle Owner's Manual to help identify your vehicle components.

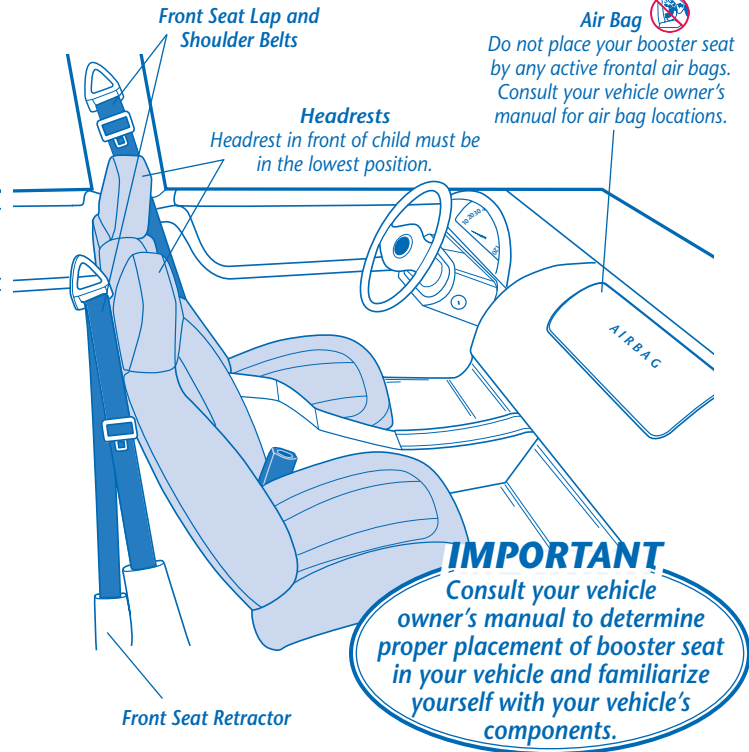
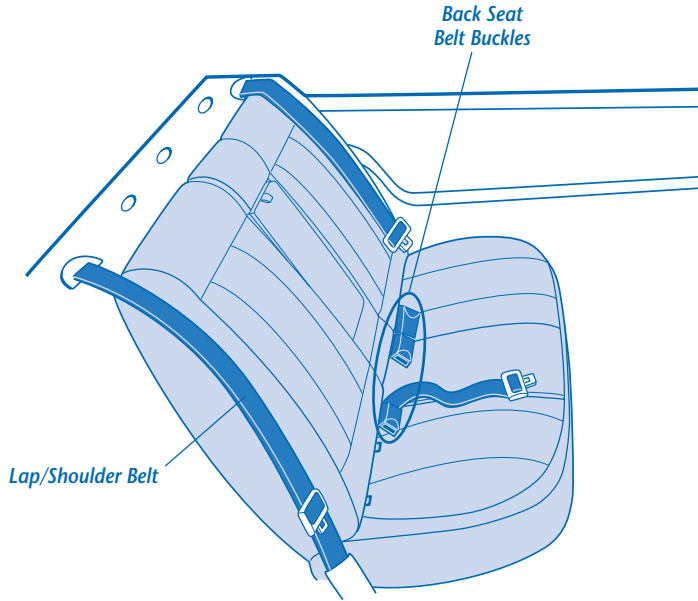

Know Your Booster Seat

Front

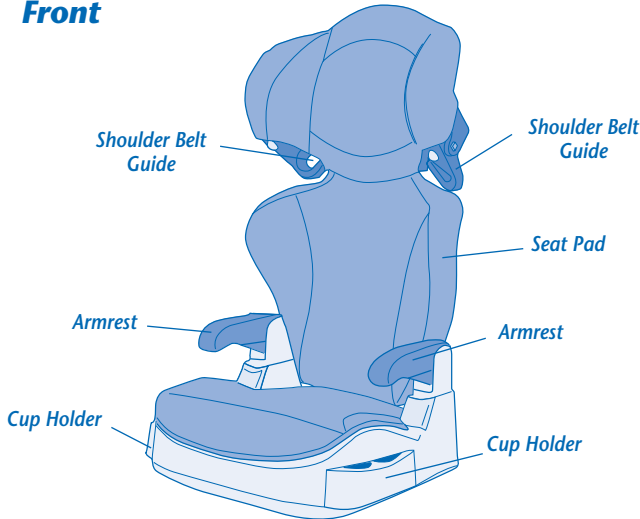

6

Back

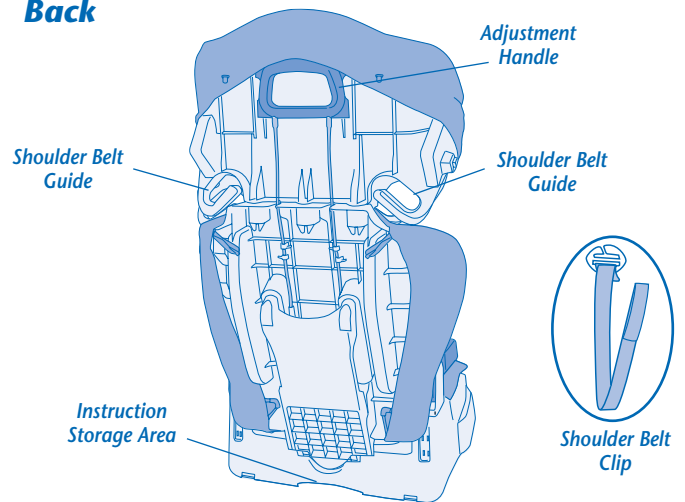

7

Assembling the Big Kid Booster

- 1. Install the armrests.** Press the tabs **A** on armrest assemblies **B** then slide them into the base **C** until they lock into place.

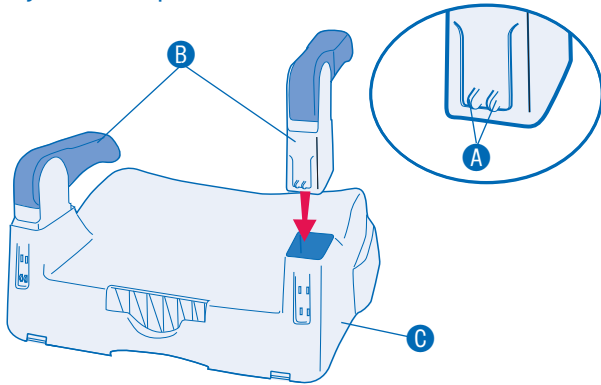

- 2. Assemble the backrest.** Insert three posts **D** on the headrest **E** into the backrest **F**, as shown. Make certain the headrest locks securely into the backrest.
NOTE: This is a one-time assembly and may require additional force to connect properly.

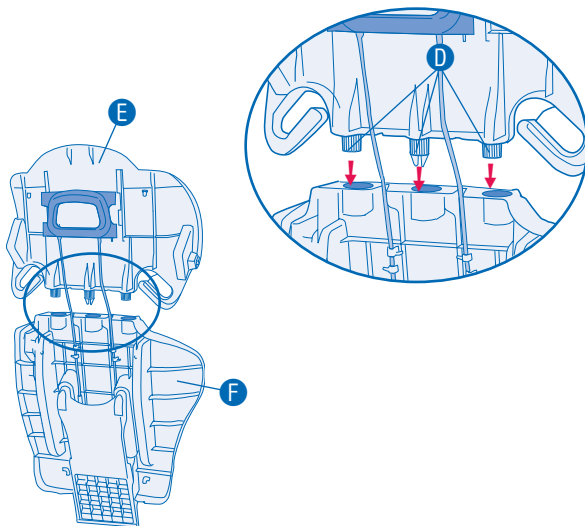

8

- 3. Install pull handle.** Align tabs **G** on pull handle **H** with the slots **I** on the back of the headrest. Press pull handle **H** against the back of the headrest and slide upward until the tabs **G** lock into place.
- 4. Attach the seat pad.** Connect seat pad straps to the hooks on backrest assembly.

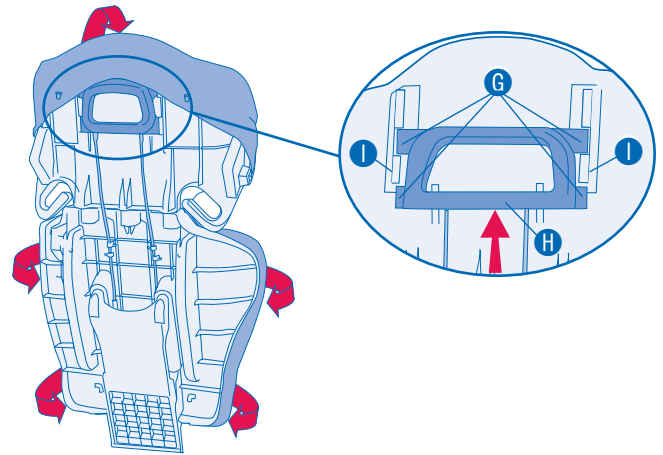

- 5. Install the backrest.** Slide the backrest assembly **J** into the base **C**. Make certain the backrest locks into place.
- 6. Check your work.** Inspect the Big Kid booster seat to make sure that the armrests are locked in place, the headrest is securely attached to the backrest, the seat pad is hooked into place, and that the backrest assembly is securely locked into the base. Repeat any assembly steps as necessary.

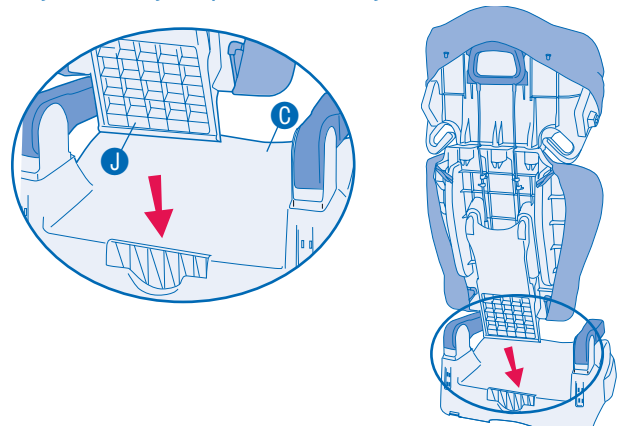

9

Using the Big Kid Booster with the Backrest

Child Requirements

Weight: 30 – 100 lbs (13.6 – 45.3 kg)

Height: 38 – 57 inches (97 – 145 cm)

Age: At least three years old

Shoulder Belt:

Must cross midway between child's shoulder and neck.



Lap Belt: Stretched low and snug across the child's hips, beneath the armrests, and fastened into the buckle.

1. Place the booster seat on the vehicle seat.

2. Set the child in the booster seat.

Make sure the child's back and bottom are flat against the back and bottom surfaces of the booster seat.

3. Adjust the back of the booster, if necessary.

Adjust the backrest so the shoulder belt guides are level with the top of the child's shoulders. This will cause the shoulder belt to properly lay midway between the child's shoulder and neck (see Adjusting the Backrest, page 15).

⚠ WARNING

The shoulder belt **MUST NOT** cross the child's neck **or** fall off the child's shoulder. If you can not adjust the shoulder belt to properly lay midway between the child's shoulder and neck, try another seating location or do not use the booster seat.



4. Adjust the armrest, if necessary.

Adjust the armrests to the most comfortable level for the child (see Adjusting the Armrests, page 15).

5. Secure the child and booster seat to the vehicle seat.

Pivot the armrests up out of the way. Stretch the lap/shoulder belt across the child and fasten the buckle. Make certain the shoulder belt is threaded through the shoulder belt guide. Pivot the armrests back down.

6. Check your work.

Make sure the lap belt is stretched low and snug across the child's hips, beneath the armrests, and fastened into the buckle. The shoulder belt must cross the child midway between his/her shoulder and neck.

IMPORTANT

Always secure the booster seat with the vehicle seat belts when not occupied. An unsecured booster seat can fly into and injure other occupants in the event of a crash.

Using the Big Kid Booster without the Backrest

Child Requirements

Weight: 40 – 100 lbs (18 – 45.3 kg)

Height: 40 – 57 inches (101 – 145 cm)

Age: At least three years old

Ears below the top of the vehicle headrest

Shoulder Belt: Must cross midway between child's shoulder and neck. Use belt clip, if necessary.

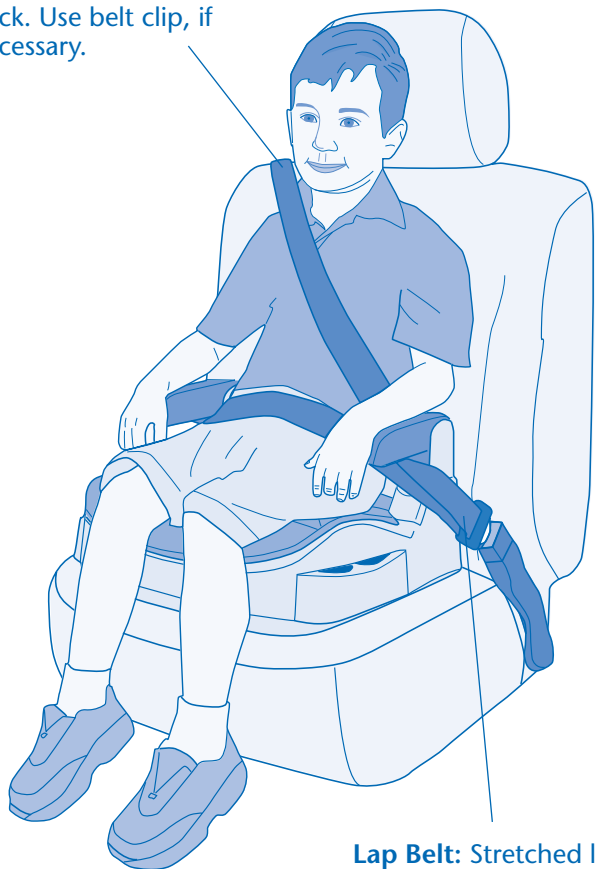

Lap Belt: Stretched low and snug across the child's hips, beneath the armrests, and fastened into the buckle.

1. Remove the backrest from the Big Kid Booster. (See Removing the Backrest, page 14.)
2. Place the booster seat on the vehicle seat.
3. Set the child in the booster seat. Make sure the child's back is flat against the vehicle seat, and the child's bottom is flat against the booster seat.
4. Adjust the armrest, if necessary. Adjust the armrests to the most comfortable level for the child (see Adjusting the Armrests, page 15).
5. Secure the child and booster seat to the vehicle seat. Pivot the armrests up out of the way. Stretch the lap/shoulder belt across the child and fasten the buckle. Lower the armrests.
6. Use the shoulder belt clip, if necessary. If the shoulder belt does not properly lay midway between the child's shoulder and neck, attach and adjust the belt clip (see Using the Shoulder Belt Clip, page 16).

WARNING

The shoulder belt **MUST NOT** cross the child's neck **or** fall off the child's shoulder. If you can not adjust the shoulder belt to properly lay midway between the child's shoulder and neck, try another seating location or do not use the booster seat.



7. Check your work. Make sure the lap belt is stretched low and snug across the child's hips, beneath the armrests, and fastened into the buckle. The shoulder belt must cross the child midway between his/her shoulder and neck. **NOTE:** If the vehicle's shoulder belt naturally crosses the child's shoulder, you do not need to use the shoulder belt clip.

IMPORTANT

Always secure the booster seat with the vehicle seat belts when not occupied. An unsecured booster seat can fly into and injure other occupants in the event of a crash.

Removing the Backrest

1. Lay the Big Kid Booster on its side.
2. Squeeze the lever **A** on the bottom of the base **B** and remove the backrest **C** from the base.

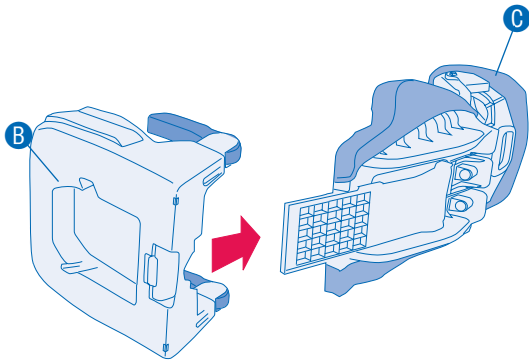
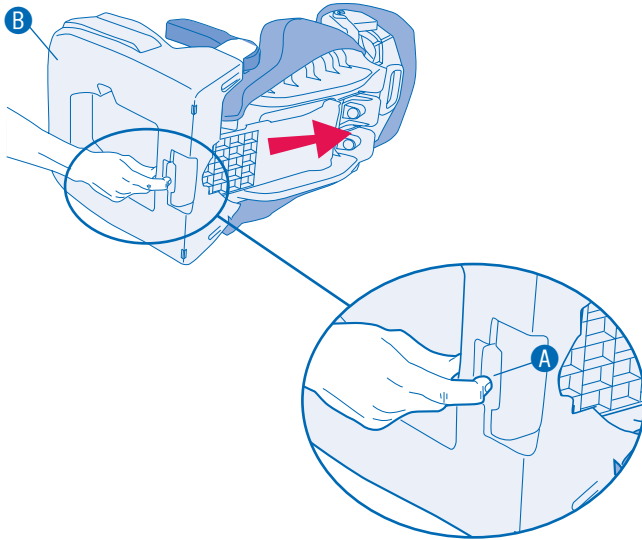

IMPORTANT
Store the backrest properly
when not in use.

Adjusting the Armrests

To adjust the armrests **A**, press the locking tabs **B** and move the armrests to either the upper or lower position.

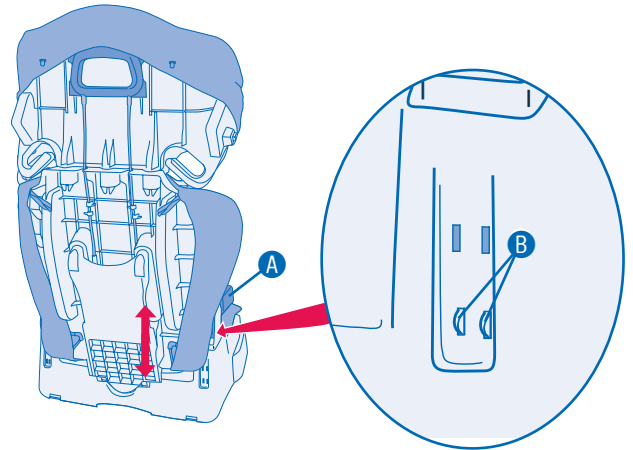

Adjusting the Backrest

To adjust the backrest **A**, pull and hold the adjustment handle **B** then slide the backrest up or down. The backrest is positioned properly when the bottom of the shoulder belt guides are even with the top of child's shoulders.

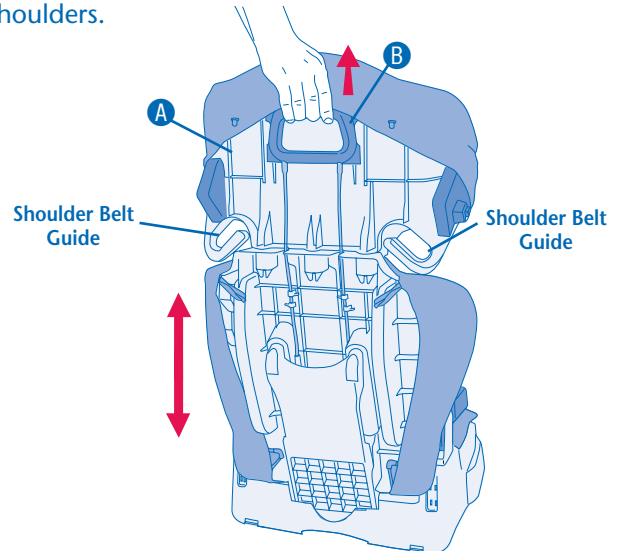

Using the Shoulder Belt Clip

1. Thread the looped end of the shoulder belt clip belt **A** through the anchor point on bottom of the booster **B**.
2. Thread the shoulder belt clip **C** through the loop at the end of the belt and pull until tight.

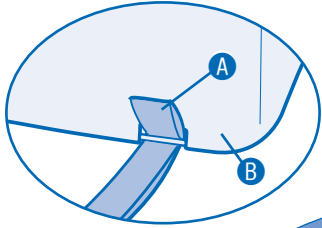

IMPORTANT

Attach the shoulder belt clip to the side of the booster seat nearest the shoulder belt.

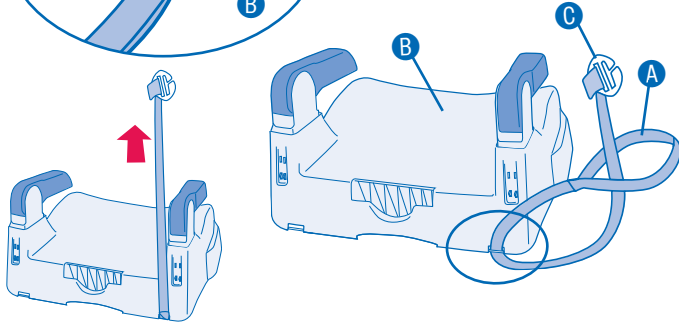

3. Place booster **B** on the vehicle and attach the shoulder belt clip **C** to the shoulder belt **D**.
4. Pull the adjustment strap **E** until belt clip **C** is even with the child's shoulder and the shoulder belt **D** lays across the child's chest midway between his/her shoulder and neck.

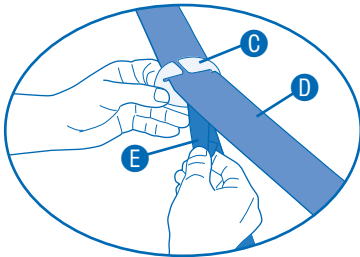

Using the Cup Holder/Snack Trays

Not available on all models.

To use the cup holders and snack trays, slide them out from the base.

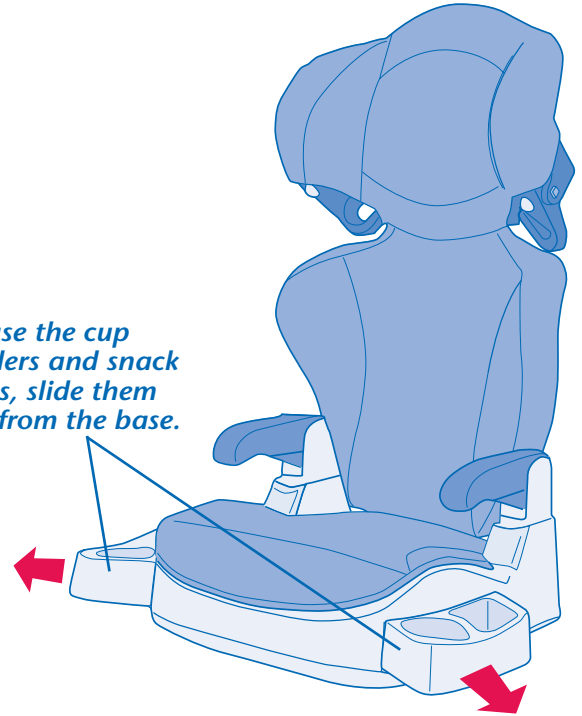

WARNING

- **DO NOT** use the cup holder to store cans or hard cups. Only for use with soft cups (such as styrofoam or paper).
- **DO NOT** place any cups that contain hot liquids (such as coffee or tea) in the cup holder.
- **DO NOT** snap any other items to this booster seat unless it has been certified for use with this specific booster seat.

Using the Activity Light

Not available on all models.

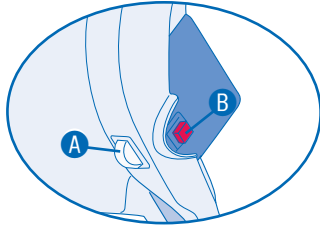
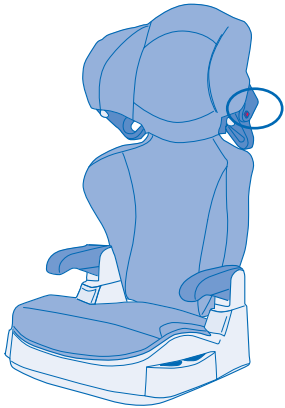

Two activity lights **A**, located on either side of the headrest, turn on and off with button **B**.

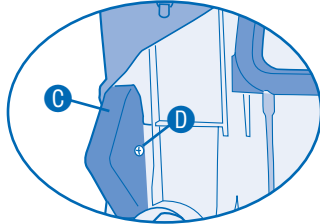
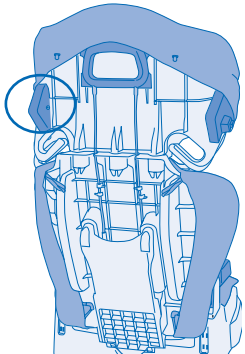

To replace either activity light unit **C** (or to install/replace the batteries), remove screw **D** and light unit from seat back.

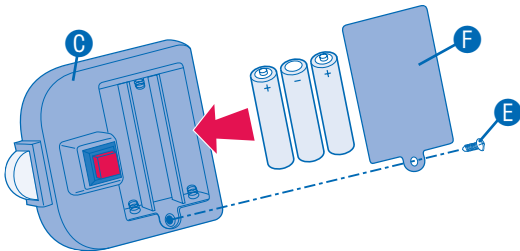

To install batteries in the activity light unit **C**, remove screw **E** and battery door **F**, install batteries as shown, then replace battery door and screw.

Replace batteries with three fresh AAA Alkaline batteries.

NOTE: Dispose of old batteries properly.

Replacement Parts

Not available on all models.

You can order replacement parts on-line at www.evenflo.com or contact Evenflo at 1-800-233-5921. When you contact us, please have the product model number and date of manufacture (found on the bottom of the child restraint).

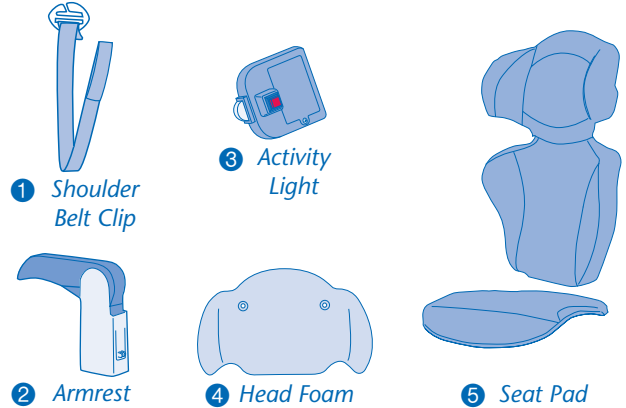

Storing Your Instructions

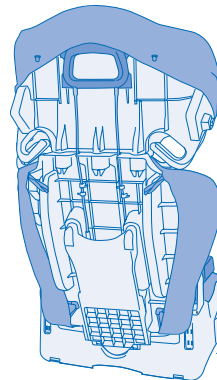

After thoroughly reading and following these instructions, **STORE THE INSTRUCTIONS IN THE SLOTS PROVIDED ON THE BOTTOM OF THE BOOSTER SEAT.**

Proper Disposal of this Child Restraint

At the end of this child restraint's useful life, Evenflo encourages you to dispose of it properly. Most of the components in this child restraint are recyclable.

1. Remove all fabric and padding.
2. Remove all screws and disassemble the restraint.
3. Recycle all plastic/foam parts and discard the rest.

If your local recycling center won't accept the padding, you may dispose of it in the landfill.

NOTE: Evenflo uses recycled materials in the manufacturing process whenever possible but never for components that are critical for safety.

Limited Warranty

For a period of 90 days from the original purchase of this Product, Evenflo warrants to the original end user ("Purchaser") this Product (including any accessories) against defects in material or workmanship. Evenflo's sole obligation under this express limited warranty shall be, at Evenflo's option, to repair or replace any Product that is determined to be defective by Evenflo and determined to be covered by this warranty.

Repair or replacement as provided under this warranty is the exclusive remedy of the Purchaser. Proof of purchase in the form of a receipted invoice or bill of sale evidencing that the Product is within the warranty period must be presented to obtain warranty service. This express limited warranty is extended by Evenflo ONLY to the original Purchaser of the Product and is not assignable or transferable to subsequent purchasers or end users of the Product. For warranty service, contact Evenflo's ParentLink Consumer Resource Center at **(800) 233-5921** or **www.evenflo.com**.

EXCEPT TO THE EXTENT PROHIBITED BY APPLICABLE LAW, ANY IMPLIED WARRANTY OF MERCHANTABILITY OR FITNESS FOR A PARTICULAR PURPOSE ON THIS PRODUCT IS HEREBY DISCLAIMED. EVENFLO SHALL NOT BE LIABLE FOR ANY INCIDENTAL, CONSEQUENTIAL, SPECIAL OR PUNITIVE DAMAGES OF ANY KIND FOR BREACH OF THE EXPRESS LIMITED WARRANTY ON THIS PRODUCT, OR ANY WARRANTY IMPLIED BY OPERATION OF LAW. OTHER THAN THE EXPRESS LIMITED WARRANTY SET FORTH ABOVE, THERE ARE NO OTHER WARRANTIES THAT ACCOMPANY THIS PRODUCT AND ANY ORAL, WRITTEN OR ANY OTHER EXPRESS REPRESENTATION OF ANY KIND IS HEREBY DISCLAIMED.



Answers. Advice. Affirmation.™

- **www.evenflo.com**
- USA: 1-800-233-5921 8 AM to 5 PM E.T.
- México: 01-800-706-12-00



Answers. Advice. Affirmation.™

- **www.evenflo.com**
- USA: 1-800-233-5921 8 AM to 5 PM E.T.
- México: 01-800-706-12-00