



**GREGG DISTRIBUTORS LTD.**

# NEW PRODUCT SUPPLEMENT CATALOGUE

# 4

# 2014

## *In this issue:*

CHAPIN® Backpack Sprayers .....	SP04-10	MECHANIX WEAR® Professional Gloves .....	SP04-21
CHAPIN® EZ Mount & Tow Sprayers.....	SP04-12	MÖLNLYCKE/TORK Paper & Hygiene Products .....	SP04-21
CHAPIN® Hand Sprayers .....	SP04-10 to SP04-11	NAOKA INC. Safety Whips.....	SP04-23
CHAPIN® Handseeders.....	SP04-12	NORSEMAN™ Canvas Belly Tarps .....	SP04-17
CHAPIN® Industrial Sprayers .....	SP04-6 to SP04-9	PHILIPS / SYLVANIA / GE / WAGNER HID Bulbs .....	SP04-17
CHAPIN® Sprayer Replacement Parts and Accessories .....	SP04-11	PHILIPS / SYLVANIA / GE / WAGNER Halogen Bulbs - Carded.....	SP04-17
CHAPIN® Spreaders.....	SP04-13	PIUSI DEF Dispensing Products .....	SP04-18 to SP04-19
CHECKERS INDUSTRIAL Gorilla® Warning Whips .....	SP04-23	REVCO Flexible Couplings .....	SP04-27
CLEAN-RITE® Wash Products .....	SP04-5	REVCO Jaw Couplings .....	SP04-26
DEWALT 20V Cordless Power Tools.....	SP04-3 to SP04-4	REVCO Sprockets.....	SP04-25 to SP04-26
FLUKE Accessories.....	SP04-4	REVCO Taper Bushings .....	SP04-26
FLUKE Thermal Imagers.....	SP04-4	RIDGID® Submersible Sump Pumps.....	SP04-14 to SP04-15
GORILLA GLUE Glue & Tape Products .....	SP04-5	SLIP-N-GRIP® Vehicle Service Products.....	SP04-22
GRIP-N-GUARD® Masking Film.....	SP04-22	TECHSPAN Deutsch Connectors.....	SP04-27
HALDEX Piggyback Kits.....	SP04-27	TEK Optical Universal Sideshields for Safety Frames .....	SP04-24
LIFT SUPPORT Gas Spring Lift Supports.....	SP04-24	TIGER TOOL Heavy Duty Truck Tools .....	SP04-2
LINK-BELT Chain Repair Tools .....	SP04-27	TRIMACO Masking Products .....	SP04-16 to SP04-17
LLOYDS LABORATORIES Chemical Products.....	SP04-20 to SP04-21	WIRE Rope Clips.....	SP04-15





### SNAP RING PLIERS

•Uniquely designed jaw easily removes and replaces Hotchkiss style snap rings on even the most corroded u-joints •Can also be used to remove plastic (push-pin) retainers on many makes and models of vehicles •The 75° head on the #70301 is designed to provide a secondary option to access those hard-to-reach areas  
**Part No. 70300**, Straight head.  
**Part No. 70301**, 75° head.



### KING PIN PRESS KIT

•Designed for use on straight and tapered king pins from 7/8" to 2-5/32" •Generates over 46,000 lbs of force and weighs only 30 lbs •User friendly design requires just one person to operate  
**Part No. 90150**.



### LEAF SPRING PIN SOCKETS

•Remove and install even the most stubborn threaded leaf spring and shackle pins  
**Part No. 15101**, International/Kenworth (small), 1.10" x .647".  
**Part No. 15102**, International/Kenworth (medium), 1.13" x .750".  
**Part No. 15100**, International/Kenworth (large), 1.54" x .653".  
**Part No. 15104**, Western Star (x-large), 1.46" x 1.26".  
**Part No. 15103**, Volvo/Mack and shackle pins, .945" x .355".



15101/15102/15100/15104



15103

### PIN & BUSHING CORE KIT

•Removes and installs both rubber-isolated and threaded pins and bushings without removing the spring packs from the axle •The hydraulic cylinder creates 20 tons of pulling power for quiet, smooth operation •Service time can be reduced by up to 70% on most jobs •Requires 10,000 psi hydraulic power source  
**Part No. 15000**.



CORE KIT ONLY. This kit requires one or more of the adapter kits listed to the right.

### ADAPTER KITS FOR #15000

•Select an add-on kit that corresponds with the OEM bushing adapter

Part No.	Application
<b>FRONT SUSPENSION</b>	
15004	Kenworth Pin and Bushing #5296, #5295
15005	Kenworth Pin and Bushing #B13-1002, B65-1008, B65-6008, B13-1000
15006	Kenworth Pin and Bushing #B65-1001
15007	Kenworth and Peterbilt Pin and Bushing #B65-6005
15008	Kenworth Pin and Bushing #B65-1012
15009	Kenworth Pin and Bushing #B65-1006
15010	Peterbilt #02-01805 and International #1065H, 1680034C1, 44409C1
15011	Kenworth and Peterbilt Pin and Bushing #B65-1013
15015	Mack Pin and Bushing #10QK254M2
15031	Freightliner and Sterling Pin and Bushing #16-14603-000
15032	Freightliner Bushing #680-322-01-50
<b>REAR SUSPENSION</b>	
15012	Peterbilt Air Trac Pin and Bushing
15030	Freightliner Airliner and Peterbilt Low Air Leaf Pin and Bushing
<b>TRAILER SUSPENSION</b>	
15040	Hendrickson Tri-Functional Wide (Intraax) Bushing
15041	Hendrickson Tri-Functional Narrow (Vantraax) Bushing
15050	Meritor Tri-Functional Bushing
<b>UNIVERSAL &amp; 5TH WHEEL ADAPTER</b>	
15003	Universal Through-Hole Bushing
15060	5th Wheel Bracket Pin Puller



15007



15030



15040

# TIGER TOOL

International Incorporated

### WHEEL STUD REMOVER & INSTALLER

•Designed for use on inboard hubs on trucks and buses •Includes a 10 ton hydraulic cylinder to provide effective removal of even the most seized studs in 10 to 15 minutes •Removal of the hub is not required  
**Part No. 10608**.  
**Part No. 10611**, Manual version.



### PITMAN ARM PULLER

•Designed to remove pitman arms on Sheppard M100 gearboxes •Can be used with up to a 3/4" impact wrench •Max glove opening is 4.1"  
**Part No. 10385**.



### PITMAN ARM PULLER

•Designed to remove pitman arms on Sheppard M110 gearboxes •May be used with up to a 3/4" impact wrench  
**Part No. 10389**.



### HUB SPINDLE NUT SOCKET

•Provides a safe way to remove the 8 point spindle nut •Machined from heat treated alloy steel to prevent the socket from slipping or spinning under extreme loads •3-1/4" socket with 3/4" drive  
**Part No. 18010**.



### HUB PULLER

•Designed to remove the most stubborn hubs with up to 25,000 lbs of force  
**Part No. 10901**, Removes Fruehauf hubs.  
**Part No. 10902**, Removes Rockwell hubs.



10901

### ENERPAC® 10,000 PSI HYDRAULIC PUMP

•Xvari® technology enables the user to better control the hydraulic application, improving productivity •Ergonomic design reduces operator fatigue •Closed hydraulic system prevents contamination and allows pump usage in any position  
**Part No. 70126**.



# TIGER TOOL

International Incorporated



### 20V MAX XR LITHIUM ION BRUSHLESS PREMIUM 3-SPEED DRILL / DRIVER KIT

•DEWALT-built high power, high efficiency brushless motor—650 unit watts out (UWO) max power for superior drilling and fastening applications performance—delivers up to 57% more run time over brushed •3-speed, high performance (0-2,000 RPM) all-metal transmission optimizes tool-to-task for fast application speeds and improved run time •Compact size - 7.9" front-to-back length and lightweight 4.6 lbs. fits tight areas •Heavy-duty 1/2" metal ratcheting chuck with carbide inserts for superior bit gripping strength •LED light with 20 second trigger release delay provides increased visibility in dark or confined spaces, improved LED tool placement minimizes chuck shadows •Includes: 1/2" Drill/Driver, (2) 20V MAX\* XR High Capacity Li-Ion Batteries, Fast charger, Belt hook, On-board bit holder, 360° side handle, and Kit box

Part No. DCD990M2.

#### Specifications

Voltage: 20V MAX  
# of Speed Settings: 3  
Max rpm: 2,000  
Clutch Settings: 11  
Chuck Size: 1/2"  
Chuck Type: Metal, ratcheting  
No Load Speed: 0-450 / 0-1,300 / 0-2,000rpm  
Tool Weight: 4.6 lbs  
Tool Length: 7.9"



### 20V MAX\* XR LITHIUM ION BRUSHLESS PREMIUM 3-SPEED HAMMERDRILL KIT

•DEWALT-built high power, high efficiency brushless motor - 650 unit watts out (UWO) max power for superior drilling and fastening applications performance—delivers up to 57% more run time over brushed •3-speed, high performance (0-2,000 RPM) all-metal transmission optimizes tool-to-task for fast application speeds and improved run time •0-34,000 BPM for fast drilling in masonry materials •Compact size—8.4" front-to-back length & lightweight 4.7 lb—fits tight areas •Heavy-duty 1/2" metal ratcheting chuck with carbide inserts for superior bit gripping strength •LED light with 20 second trigger release delay provides increased visibility in dark or confined spaces, improved LED tool placement minimizes chuck shadows •Includes: 1/2" Hammerdrill, (2) 20V MAX XR High Capacity Li-Ion Batteries, Fast charger, Belt hook, On-board bit holder, 360° side handle, and Kit box

Part No. DCD995M2.

Part No. DCD995B, Tool only.

#### Specifications

Voltage: 20V MAX  
# of Speed Settings: 3  
Max rpm: 0-450 / 0-1,300 / 0-2,000  
Max BPM: 0-7,650 / 0-22,100 / 0-34,000  
Clutch Settings: 11  
Chuck Size: 1/2"  
Chuck Type: Metal, ratcheting  
Tool Weight: 4.7 lbs



### 20V MAX XR LITHIUM ION BRUSHLESS 3-SPEED 1/4" IMPACT DRIVER

•DEWALT brushless motor delivers up to 57% more run time over brushed •3 Speed Design; application specific control •Push Button Chuck; one handed operation for accessory changes •Compact (5.25" front to back), lightweight design (3.6 lbs.); fits into tight areas •Includes: 1/4" Impact Driver, (2) 20V Max XR Premium Li-Ion Batteries, Fast Charger, Belt Hook and Accessory Storage, and Kit box

Part No. DCF895M2.

Part No. DCF895B, Tool only.

#### Specifications

Voltage: 20V MAX  
Drive Size: 1/4" Hex  
Anvil Type: Quick Release  
No Load Speed: 0 - 2850 / 1900 / 950rpm  
Impacts/Min: 0 - 3300 / 2400 / 1300ipm  
Max Torque (in-lbs): 1500 / 900 / 500in-lbs  
Max Torque (ft-lbs): 125 / 75 / 42ft-lbs  
Tool Length: 5-1/4"  
Tool Weight: 3.6 lbs



### 20V MAX LITHIUM ION GREASE GUN

•Powerful motor delivers 10,000 max psi to power through clogged grease fittings •High-volume pump pushes up to 5.0 oz/min for high-flow applications •Up to 16 cartridges per charge with a single DEWALT 20V MAX Battery (4.0 Ah) •Variable speed trigger offers precise control of the grease flow •42" extra-long and flexible hose designed for reaching hard to access grease fittings. •Bright LED light assists in locating hard to see grease fittings in low-light situations •Innovative pump filter screen prevents dirt and contamination from clogging the pump mechanism •Integrated no-mar foot design allows operators to rest the tool on flat surfaces •Air-bleeder valve assists in pump priming after cartridge changes •Includes: Grease gun, 20V MAX XR Premium Li-Ion Battery, Fast charger, Shoulder strap, and Kit box

Part No. DCGG571M1.

Part No. DCGG571B, Tool only.

#### Specifications

Voltage: 20V MAX  
Max Volume: 5.0 oz/min  
Hose Length: 42"  
Cartridge Capacity: 14.5 oz  
Bulk Capacity: 16.0oz  
Tool Weight: 9.5 lbs.



### 20V MAX LITHIUM ION LED WORK LIGHT

•Bright LED output - 110 Lumens  
•Integral hook for hands free use in multiple placements •Head rotates 120° •Low heat output compared to Xenon lights •Efficient LED bulb improves run-time

Part No. DCL040.



### 12V/20V MAX WORKSITE CHARGER RADIO

•2 AMP Charger for 12V Max & 20V Max DEWALT Battery Packs allows for quick and convenient battery charging •Runs off 12V Max and 20V Max DEWALT batteries making it a cordless radio capable or running off rechargeable and reusable battery power •2 AC Power Outlets offer more versatility for jobsite power •Auxiliary and USB Ports allows for connection to CD, MP3, Portable Satellite Receivers, and other digital audio devices •USB port allows device to be charged via USB when radio is plugged into a wall outlet •Device storage box protects electronic devices from jobsite debris while plugged into Aux or USB ports •Class D amplifier, woofers and tweeters provide full range of high and low sound for optimum sound quality

Part No. DCR015.



### 18/20V MAX\* CORDLESS/CORDED WET-DRY VACUUM

•Cordless or corded operation powered by either an 18v or 20v MAX battery - or an AC outlet •HEPA rated wet/dry filter traps dust with 99.97% efficiency at 1 micron •Easily accessible, washable/reusable filter; Tap or water rinse to clean •Heavy-duty, crush-resistant, fully-integrated 5" (by 1-1/4" diameter) hose provides durability, flexibility and ease-of-use •On-board hose, cord and accessory storage makes the vacuum easy to carry/transport •2-Gallon tank capacity provides enough storage to empty a toilet or clogged pipe

Part No. DCV581H.

Part No. DCV5801H, Replacement HEPA Filter.







## 20V Cordless Power Tools

### 12V MAX - 20V MAX LITHIUM ION BATTERY CHARGER

- Charges all DEWALT® 12V - 20V MAX Li-Ion batteries
- Charges the battery in 1 hour or less thus minimizing downtime
- Diagnostics with LED indicator communicates battery charge status: charged, charging, replace pack, and battery too hot or too cold

Part No. DCB101.



### 12V MAX - 20V MAX LITHIUM ION VEHICLE BATTERY CHARGER

- Charges all DEWALT® 12V - 20V MAX Li-Ion batteries from a vehicle's power outlet enabling batteries to be charged while driving to work or on a jobsite
- Quickly charges batteries to minimize down time
- Automatic shut-off protects excessive discharge of vehicle's battery
- Diagnostics with LED indicator communicates battery charge status: charged, charging, power line problem, replace pack, and battery too hot or too cold

Part No. DCB119.



### 20V MAX PREMIUM 4.0 Ah XR LITHIUM ION BATTERY PACK

- Premium XR Lithium Ion High Capacity Battery pack provides up to 33% more capacity than standard 20V MAX\* battery packs
- 3-LED Fuel Gauge System allows immediate feedback on state of charge
- No memory and virtually no self-discharge for maximum productivity and less downtime
- Weighs 1.42 lbs allowing user maximum run-time in a lightweight battery

Part No. DCB204.  
Part No. DCB204-2, Pack of 2.



## Thermal Imagers

### Ti90 INFRARED CAMERA

Start finding potential problems fast with the affordable wireless Ti90 infrared camera - securely connect and collaborate with others, so they can see what you see.

- The only wireless industrial infrared camera in its price class – take advantage of the benefits of Fluke Connect™ by seamlessly gathering and sharing inspection results instantly
- Superior image quality, up to 84% better spatial resolution than other competitive models in this price class
- 80 x 60 resolution
- Removable 4GB SD memory card
- 8 GB Fluke Connect™ wireless SD Card
- Get context for the infrared image by switching to the full visible (IR-Fusion® AutoBlend™ mode and Picture-in-Picture available in SmartView® software)
- 2 megapixel built-in digital camera
- 3.5" LCD
- Smart Battery System - Lithium ion smart battery pack with five-segment LED display to show charge level
- Rugged, lightweight, point-and-shoot infrared camera

Part No. TI90-9.

#### Specifications:

Infrared spectral band: 9 μm to 15 μm (long wave)  
 Operating temperature: -10°C to 50°C  
 Temperature Range: -20°C to 250°C  
 Spatial Resolution: 5.6 mRAD  
 Thermal Resolution: 80 x 60  
 Field of View: 19.5°H x 26°V  
 Thermal Sensitivity: 150 mK  
 Drop: Engineered to withstand 2 meter (6.5 feet) drop  
 Size: 11.2"H x 3.4"W x 5.3"L  
 Weight (battery included): 1.6 lb  
 Enclosure rating: IP54



### Ti95 INFRARED CAMERA

Wireless with superior image quality, easy-to-use and rugged, the Ti95 infrared camera was designed for your next thermal inspection.

- The only wireless industrial infrared camera in its price class – take advantage of the benefits of Fluke Connect™ by seamlessly gathering and sharing inspection results instantly
- Superior image quality, up to 23% better spatial resolution than other competitive models in this price class
- 80 x 80 resolution
- Removable 4GB SD memory card
- 8 GB Fluke Connect™ wireless SD Card
- Find potential problems faster and easier with IR-Fusion® picture-in-picture mode
- 2 megapixel built-in digital camera
- 3.5" LCD
- Smart Battery System - Lithium ion smart battery pack with five-segment LED display to show charge level
- Rugged, lightweight, point-and-shoot infrared camera

Part No. TI95-9.

#### Specifications:

Infrared spectral band 9 μm to 15 μm (long wave)  
 Operating temperature -10°C to 50°C  
 Center box (MIN-MAX-AVG): Fixed-size measurement box with MIN-MAX-AVG temp  
 Temperature Range: -20°C to 250°C  
 Spatial Resolution: 5.6 mRAD  
 Thermal Resolution: 80 x 80  
 Field of View: 26°H x 26°V  
 Thermal Sensitivity: 100 mK  
 Drop: Engineered to withstand 2 meter (6.5 feet) drop  
 Size: 11.2"H x 3.4"W x 5.3"L  
 Weight (battery included) 1.6 lb  
 Enclosure rating: IP54



## DMM Accessories

### REPLACEMENT FUSES

- Replacement fuses for Fluke DMMs

Part No. 943121, 440mA 1000V fuse.  
 Part No. 803293, 11A 1000V fuse.



Model	Fuse Requirements
27 (S/N>7247001)	943121, 803293
83/85/87 (S/N>6565000)	943121, 803293
83-III/85-III/87-III 87-IV/89-IV/187-IV/189/287/289/77-III/79-III/23-III/26-III 175/177/179/77-IV/27-II/28-II	943121, 803293
111/112/115/117/233	803293
1577/1587	943121
787/789	943121





# GORILLA GLUE

Glue & Tape Products

## GORILLA GLUE

The product that started it all. Original Gorilla Glue built a name for itself with its incredible, industrial holding power and versatility. Water activated, it expands into materials to form an incredibly strong bond to virtually anything. Gorilla Glue is your solution for almost any project or repair. It's 100% waterproof, safe for indoor and outdoor use and strong enough to stand up to the elements. Plus, its expansion allows it to penetrate the glued surface for a superior bond. Sand it, paint it, stain it. Simply stated, it's the Toughest Glue on Planet Earth.

**Part No. 5100502**, 4 pack of 3 g single use tubes.  
**Part No. 5100201**, 59 ml bottle.  
**Part No. 5100402**, 118 ml. bottle.  
**Part No. 51008T**, 236 ml bottle.



### Specifications:

•Clamp Time: 1-2 Hours •Open Time: 10-15 Minutes  
 •Dry Time: 80% in 1-2 Hours •Dry Colour: Light Tan •Full Cure: 24 Hours

## GORILLA GLUE WHITE

The same serious strength you expect from Original Gorilla Glue, in a dries white, faster formula. Whether indoors or out, White Gorilla Glue is 100% waterproof, resistant to extreme heat and cold, and easily bonds foam, wood, metal, ceramic, stone and much more! Storage Tips: White Gorilla Glue is a moisture activated adhesive. It is important to replace the cap tightly, and store in a cool, dry place. You should expect a year shelf life.

**Part No. 5202101C**, 59 ml bottle.  
**Part No. 5202403**, 21.2 g Precision pen.



### Specifications:

•Clamp Time: 30-60 Minutes •Open Time: 5-10 Minutes •Dry Time: 80% in 1-2 Hours •Dry Color: Soft White •Full Cure: 24 Hours

## GORILLA TOUGH & WIDE TAPE

Similar to Gorilla Tape, only bigger and tougher, Gorilla Tape Tough and Wide covers more surface area and creates a stronger bond for your tough tape-ups.

**Part No. 6003001**, 3" x 30 yds.



## GORILLA WOOD GLUE

Gorilla Wood Glue is the adhesive that woodworkers, carpenters and hobbyists trust for their woodworking projects. Gorilla Wood Glue, a PVA glue, offers the benefits of an easy-to use, water-based adhesive, with the holding power Gorilla is known for. The glue is incredibly water resistant and dries a natural color that offers an invisible bond line for your projects.

**Part No. 6212001**, 118 ml bottle.  
**Part No. 6200201**, 236 ml bottle.  
**Part No. 6205201**, 532 ml bottle.



### Specifications:

•Clamp Time: 20-30 Minutes •Open Time: 5-10 Minutes •Dry Time: 80% in 1-2 Hours •Dry Colour: Natural Wood Colour •Full Cure: 24 Hours

## GORILLA EPOXY

Gorilla takes epoxy to a new level—the Gorilla Tough level. With its superior solvent and water resistance, Gorilla Epoxy is incredibly strong and durable for household and automotive repairs alike. The easy-to-use syringe keeps the resin and hardener separate, so it is easy to dispense and won't harden over time. The two-part, gap-filling formula easily bonds steel, aluminum, wood, ceramic, tile and most plastics. Plus, it dries in an ideal, crystal-clear finish that makes projects look spotless.

**Part No. 4200601**, 25 ml bottle.



### Specifications:

•Clamp Time: 30 Minutes •Open Time: 5 Minutes  
 •Dry/Full cure Time: 24 Hours •Dry Color: Clear

## GORILLA TAPE WHITE

White Gorilla Tape offers over-the-top results with its triple-layer strength and outstanding versatility. It is perfect for both indoor and outdoor use with superior UV resistance and ability to grip to rough, uneven, unforgiving surfaces like wood, stone, stucco, plaster, brick and more.

**Part No. 6025001**, 2" x 30 yds.



## GORILLA SUPER GLUE

Its high strength and quick set time make Gorilla Super Glue the go-to for a variety of household projects. Developed for long-lasting repairs in an instant, Gorilla Super Glue dries in 10-30 seconds and is reinforced with rubber for increased impact resistance. We call it Impact-Tough® because it stands up to wear and tear unlike any other instant glue. In addition to its high-performance formula, we've added an anti-clog cap with a metal pin inside to ensure an airtight seal for maximum reusability. It's Gorilla tough, every time.

**Part No. 7900301**, 2 pack of 3 g tube.  
**Part No. 7805201**, 20 g bottle.



### Specifications:

•Clamp Time: 10-30 Seconds •Open Time: Not Repositioning  
 •Dry Time: Light Handling after 1-5 Minutes Dry Color: Translucent  
 •Full Cure: 24 Hours

## GORILLA TAPE

Gorilla Tape has taken duct tape to a new level. Gorilla Tape's toughness surpasses ordinary tapes, making the list of uses virtually endless. It sticks to rough and uneven surfaces, including wood, stone, stucco and brick, that ordinary tapes can't hold. To us, it's made the way tape should be: The Toughest on Planet Earth.

**Part No. 6101002**, 1" x 30 ft. To-Go.  
**Part No. 61012**, 2" x 12 yds.  
**Part No. 60036**, 2" x 35 yds.



## GORILLA CLEAR REPAIR TAPE

No other tape offers the clarity, strength and durability of Gorilla Clear Repair! The ideal solution for almost any repair, Gorilla Clear Repair features the strength of Gorilla Tape in a weather-proof, airtight, crystal-clear tape. Easy to tear by hand, with Gorilla Clear Repair, you can fix, patch, seal, hold and protect almost any surface with a crystal-clear appearance for a perfect fix every time.

**Part No. 6127002**, 2" x 27 ft.



QQQ/1980



# CLEAN-RITE®

Wash Products

## MICROFIBER GLASS TOWEL with FINGER POCKET

•Soft lint and streak free  
 •Cleans dirt and greasy fingerprints from glass •Towel Size: 12" x 16"  
**Part No. 3-511**, Pack of 2.



## MICROFIBER CLEANING TOWELS

•Microfiber towels - blue •12 towels per pack  
 •Towel size: 14" x 14"  
**Part No. 3-512**.



## MICROFIBER CLEANING CLOTHS

•Clean without chemicals, great for dashboards, computer screens, glass mirrors and more •12" x 16"  
**Part No. 3-606**, Pack of 6.



## MICROFIBER 2N1 WASH & SCRUB SPONGE

•Push microfiber cleans away dirt and grime  
 •Microfiber mesh scrubs away tough dirt  
**Part No. 9-21M**.





## Industrial Sprayers

### XTREME™ INDUSTRIAL CONCRETE SPRAYER WITH DRIPLESS SHUT-OFF

- 3.5 Gallon tripoxy coated sprayer with xtreme™ seals and dripless trigger grip shut-off for the concrete professional
- Xtreme™ viton® seals and gaskets
- Tripoxy steel tank with large tri-lock opening
- Spray handle, brass wand and nozzle
- Brass pump



### INDUSTRIAL CONCRETE SPRAYER WITH DRIPLESS SHUT-OFF

- 3.5 Gallon tripoxy coated sprayer with viton® seals for the concrete professional
- Viton® seals and gaskets
- Tripoxy steel tank with large tri-lock opening
- Spray handle, brass wand and nozzle
- Brass pump



### XTREME™ INDUSTRIAL CONCRETE SPRAYER

- 3.5 Gallon tripoxy coated sprayer with xtreme™ seals for the concrete professional
- Xtreme™ viton® seals and gaskets
- Tripoxy steel tank with large tri-lock opening
- Brass spray handle, 24" wand and nozzle
- Brass pump



### INDUSTRIAL VITON® CONCRETE OPEN HEAD SPRAYER

- 3.5 Gallon tripoxy coated sprayer with viton™ seals for the concrete professional (chapin's most popular industrial sprayer)
- Viton® seals and gaskets
- Tripoxy steel tank with large tri-lock opening
- Brass spray handle, 24" wand and nozzle
- Brass pump

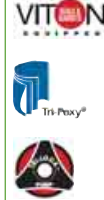

### STAINLESS STEEL XTREME™ INDUSTRIAL CONCRETE SPRAYER

- 3.5 Gallon stainless steel sprayer with xtreme™ seals for the concrete professional
- Xtreme™ viton® seals and gaskets
- Stainless steel tank with large tri-lock opening
- Brass spray handle, 24" wand and nozzle
- Brass Pump



### INDUSTRIAL VITON® CONCRETE OPEN HEAD SPRAYER WITH FILTER

- 3.5 Gallon tripoxy coated sprayer with viton™ seals for the concrete professional
- Viton® seals and gaskets
- Tripoxy steel tank with large tri-lock opening
- Brass spray handle, 24" wand and nozzle
- Brass pump

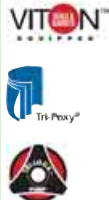

### INDUSTRIAL VITON® CONCRETE SPRAYER COMPRESSOR CHARGED

- 3.5 Gallon hammertone / tripoxy coated sprayer with viton™ seals and schrader valve for compressor hookup for the concrete professional
- Viton® seals and gaskets
- Schrader valve for compressor hookup
- Brass spray handle, 24" wand and nozzle
- Brass pump



### INDUSTRIAL VITON CONCRETE FUNNEL TOP SPRAYER

- 3.5 Gallon tripoxy coated funnel top sprayer with viton™ seals for the concrete professional
- Funnel top design
- Viton™ seals
- Brass spray handle, 24" wand and nozzle
- Metal pump handle
- Funnel top for easy filling



### INDUSTRIAL WATER SUPPLY TANK

- 3.5 gallon poly water supply tank and pump
- Poly tank sprayer
- Viton™ seals
- Ergo "comfort" handle
- Water tank used for cutting tools; hose adapter

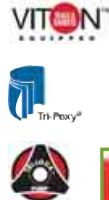

### INDUSTRIAL POLY WATER SUPPLY TANK

- 3 gallon water supply tank, great for lawn and garden use
- Made of polyethylene
- Pump length: 8" with a 3.5" wide mouth opening - includes filter



Chapin Industrial Concrete sprayers are equipped with Viton® seals and gaskets to handle the many aggressive chemicals used by professionals.



To keep up with the ever changing chemical compositions and the higher solids in today's solvents and excellerators, select Chapin Industrial concrete sprayers are equipped with Xtreme® seals and gaskets that are resistant to the most extreme chemicals and high concentrations of Acetone®, Naphtha®, Xylene® and Toluene®. These models display the large X on the tank





**INDUSTRIAL STAINLESS STEEL SPRAYER**

- 3.0 Gallon stainless steel industrial sprayer with tri-lock opening
- Stainless steel tank
- Large tri-lock opening
- Brass spray handle, 18" wand and nozzle
- Brass pump
- Part No. 1749.



**INDUSTRIAL STAINLESS STEEL SPRAYER**

- 2.0 Gallon stainless steel industrial sprayer with tri-lock opening
- Stainless steel tank
- Large tri-lock opening
- Brass spray handle, 12" wand and nozzle
- Brass pump
- Part No. 1739.



**INDUSTRIAL METAL VITON® HEAVY DUTY SPRAYER**

- 3.0 Gallon tripoxy coated funnel top heavy duty sprayer with viton™ seals for the concrete professional
- Tripoxy coated metal tank
- Surespray™ anti-clog filter
- Brass spray handle, wand and nozzle
- Funnel top for easy filling
- Part No. 1352.



**INDUSTRIAL OPEN HEAD GENERAL DUTY SPRAYER**

- 3.5 Gallon tripoxy coated sprayer with viton™ seals for the concrete professional
- Viton® seals and gaskets
- Tripoxy steel tank with large tri-lock opening
- Brass spray handle, 24" wand and nozzle
- Brass pump
- Part No. 1941.



**INDUSTRIAL OPEN HEAD GENERAL DUTY SPRAYER**

- 3.0 Gallon tripoxy industrial sprayer with tri-lock opening
- Tripoxy coated metal tank
- Large tri-lock opening
- Brass spray handle, 18" wand and nozzle
- Brass pump
- Part No. 1831.



**INDUSTRIAL POLY XTREME® SPRAYER - XP MODEL**

- 3.0 Gallon poly xtreme™ concrete sprayer resistant to the most extreme chemicals and high concentrations of acetone®, naphtha®, xylene® and toluene®. Now with 40% more pump volume per stroke.
- Xtreme™ viton® seals and gaskets
- Translucent 3.0 Gallon poly tank
- Brass spray handle, 24" wand and nozzle
- Part No. 22049XP.



**INDUSTRIAL POLY CONCRETE SPRAYER - XP MODEL**

- 3.0 Gallon industrial concrete poly sprayer for form oils, curing compounds and sealers. Now with 40% more pump volume per stroke.
- Brass shut-off with lock-on feature
- 18" Brass extension wand
- Pressure relief valve
- Part No. 22170XP.



**INDUSTRIAL POLY VITON® HEAVY DUTY SPRAYER - XP MODEL**

- 3.0 gallon industrial poly sprayer for multi-purpose use. Now with 40% more pump volume per stroke.
- Viton® seals and gaskets
- Brass shut-off with lock-on feature
- 18" Brass extension wand
- Pressure relief valve
- Part No. 22790XP.



**INDUSTRIAL POLY VITON® CONCRETE SPRAYER - XP MODEL**

- 3.0 Gallon poly sprayer with viton® seals for the concrete professional. Now with 40% more pump volume per stroke.
- Viton® seals and gaskets
- Brass shut-off with lock-on feature
- 24" Brass extension wand
- Pressure relief valve
- Part No. 22180XP.



**INDUSTRIAL POLY HEAVY DUTY SPRAYER - XP MODEL**

- 3.0 gallon Industrial Heavy Duty Poly Sprayer for general purpose professional use. Now with 40% more pump volume per stroke.
- Brass shut-off with lock-on feature
- 18" brass extension wand
- Pressure relief valve
- Part No. 22090XP.



## Industrial Sprayers

### INDUSTRIAL ACID STAINING SPRAYER WITH DRIPLESS SHUT-OFF - XP MODEL

- 2 Gallon acid staining sprayer with COPT seals and dripless shut-off for the decorative concrete professional. Now with 40% more pump volume per stroke.
  - COPT seals and gaskets to handle acid based concrete stains
  - Translucent 2 Gallon poly tank
  - Ceramic nozzle, die cast metal pump handles, a wide 4" opening
  - Pressure relief valve
  - Dripless shut-off
- Part No. 22251XP.



### INDUSTRIAL ACID STAINING SPRAYERS - XP MODEL

- Acid staining sprayer with COPT seals for the decorative concrete professional. Now with 40% more pump volume per stroke.
  - COPT seals and gaskets to handle acid based concrete stains
  - Translucent poly tank
  - Curved poly wand
  - Ceramic nozzle, die cast metal pump handles, a wide 4" opening
  - Pressure relief valve
  - Funnel top for easy filling
- Part No. 22240XP, 2 Gallon.  
Part No. 22230XP, 1 Gallon.



### ACETONE SPRAYER WITH DRIPLESS SHUT-OFF - XP MODEL

- 3 Gallon acetone sprayer with dripless trigger grip shut-off for concrete staining applications requiring acetone. Now with 40% more pump volume per stroke.
  - Dripless trigger grip shut-off for no-drip applications with Xtreme™ Viton® seals
  - EPDM seals and gaskets to handle high concentration of acetone
  - Funnel top for easy filling
  - Pressure release valve
- Part No. 21127XP.



### ACETONE SPRAYER

- 2 gallon acetone sprayer for the decorative concrete professional staining with acetone base dyes
  - EPDM seals and gaskets to handle high concentrations of acetone
  - Pressure relief valve
  - Surespray™ anti-clog filter
  - Adjustable ceramic cone nozzle
- Part No. 26127.



### BLEACH AND DISINFECTANT BACKPACK SPRAYER

- 4 gallon backpack sprayer with pro features for the cleaning with bleach solutions
  - Viton™ seals
  - 4 Stage filtration system (with in-tank removable/cleanable filter)
  - 4" Wide opening with strainer/filter basket
  - Padded shoulder straps
  - Poly cone nozzle
- Part No. 61575.



### BLEACH SPRAYER

- 1 gallon bleach sprayer for cleaning and remediation
  - SureSpray™ Anti-clog Filter
  - Translucent Tank
  - Adjustable cone nozzle
  - Ergo poly pump handle
  - Funnel top for easy filling
- Part No. 20075.



### PROFESSIONAL PEST CONTROL SPRAYERS

- 1.5 gallon stainless steel tank with tri-lock opening
  - Dripless Shut-Off
  - Viton™ seals
  - Large 4" opening for easy filling and cleaning
- Part No. 10800, Adjustable, multi pattern spray nozzle.  
Part No. 10700, Poly fan nozzle.



STAINLESS STEEL



### JANITORIAL FOAMER/SANITATION SPRAYERS

- Poly foamer/sprayer - 2 in 1 dual sprayer foamer
  - Auto/manual high pressure relief valve
  - Foam nozzle sprays a consistent foam for cleaning applications
  - Adjustable poly cone nozzle sprays coarse stream to fine spray
  - Large ergonomic pump handle
  - Funnel top design
  - Lock-on shut-off feature
  - Viton™ seals
- Part No. 2660E, 3 gallon.  
Part No. 2659E, 2 gallon.  
Part No. 2658E, 1 gallon.







**PREMIER STAINLESS STEEL SPRAYER**

- 2.0 Gallon premier series funnel top stainless steel sprayer home, yard and garden use
  - Stainless steel tank
  - Surespray™ anti-clog filter
  - Brass spray handle, wand and nozzle
  - Funnel top for easy filling
- Part No. 1253.



**PREMIER STEEL SPRAYERS**

- Premier series funnel top steel sprayer home, yard and garden use
  - Triproxy coated metal tank
  - Surespray™ anti-clog filter
  - Brass wand and brass adjustable nozzle
  - Epoxy coated zinc shut off
  - Funnel top for easy filling
- Part No. 1380, 3 gallon with 18" wand.  
Part No. 1280, 2 gallon with 12" wand.  
Part No. 1180, 1 gallon with 12" wand.



**SURESPRAY™ SPRAYERS**

- Surespray™ multi-purpose sprayer for herbicides, pesticides, fertilizers and general cleaning
  - Clean'n easy™ design
  - Surespray™ anti-clog filter
  - Adjustable nozzle with reinforced hose
  - Translucent tank
  - Ergonomic pump handle
  - Funnel top for easy filling
  - Measure cup for dry hands mixing-stores easily on tank
- Part No. 20030, 3 gallon.  
Part No. 20020, 2 gallon.  
Part No. 20010, 1 gallon.  
Part No. 10000, .5 gallon.



**PREMIER XP POLY SPRAYERS**

- Premier wide mouth poly sprayer with extended performance - now with 40% pump volume per stroke
  - Die cast pump handle
  - Surespray™ anti-clog filter
  - Adjustable brass nozzle with viton™ gasket
  - Pressure release valve
  - Epoxy coated zinc shut-off with 18 inch brass extension wand
- Part No. 21230XP, 3 gallon.  
Part No. 21220XP, 2 gallon.  
Part No. 21210XP, 1 gallon.



**POLY PRO SERIES SPRAYERS - XP MODEL**

- Pro Series poly sprayer for the lawn & landscaping professional. Now with 40% more pump volume per stroke.
  - Viton® seals and gaskets
  - 4" large opening for easy filling
  - Includes comfort grip handle, along with poly and brass adjustable nozzle
  - 20" poly wand and 34" reinforced hose with cushion grip shut-off with internal filter
  - Includes SureSpray® Anti-Clog Filter
  - Pressure relief valve
- Part No. 26031XP, 3 gallon.  
Part No. 26021XP, 2 gallon.



**CLEAN 'N SEAL DECK POLY SPRAYER**

- 2 gallon clean 'n seal poly sprayer for spraying transparent/semitransparent stains and sealants.
  - Funnel top opening for no mess filling
  - 3 Fan nozzles: 1/4 GPM - fine spray for washes, 1/3 GPM - medium spray for sealers, 1/2 GPM - course spray for semi transparent stains
  - Spray shield to control overspray
  - Locking spray handle for ease of spraying
  - Poly curved wand & reinforced hose
  - Ergo style pump handle
- Part No. 25020.



**STAND 'N SPRAY SPRAYER**

- Sprayer with external pump barrel allowing user to pump in an upright position
  - External pump with Nitrile seals and gaskets
  - SureSpray™ Anti-clog Filter
  - Translucent poly tank
  - 18" wand for NO-BEND spraying
  - Built in splash guard to protect against spillage
  - Pressure release valve
- Part No. 29003, 3 gallon.  
Part No. 29002, 2 gallon.



## Backpack Sprayers

### PRO TREE/TURF BACKPACK SPRAYER

- 4 gallon backpack sprayer with deluxe features for the landscape & turf professional
  - Piston pump
  - 4 stage filtration system with in-tank removable/cleanable filter
  - Pressure regulator valve (30-80psi)
  - Viton™ seals and gaskets
  - Chrome pump handle for left or right handed operation
  - Adjustable/cushioned shoulder, back and lumbar straps
  - 3 pc nozzle pack (poly fan, poly cone and brass cone)
  - CF valve™ included (21 PSI)
  - Brass spray handle with air pressure gauge
  - Brass extension wand
  - 48" clear reinforced hose
- Part No. 62000B.**



### PRO TREE/TURF BACKPACK SPRAYER

- 4 gallon backpack sprayer with deluxe features for the landscape & turf professional
  - Piston pump
  - 4" large diameter opening
  - Strainer/filter basket
  - Removable in tank filter
  - Cushion grip spray handle with pressure gauge
  - Adjustable padded shoulder straps with lumbar support strap
  - 3 pc nozzle pack (poly fan, poly cone and brass fan)
  - Stainless steel wand
  - Adjustable pressure control valve
  - Right and left hand use
- Part No. 61900.**



### PROSERIES BACKPACK SPRAYER

- 4 gallon backpack sprayer with deluxe features for the landscape & turf professional
  - Piston pump
  - 4" wide opening with strainer/filter basket
  - Cushion grip spray handle
  - Adjustable padded shoulder with waist straps
  - 3 pc nozzle pack (brass, poly fan, poly cone)
  - Right and left hand use
- Part No. 61800.**



### POLY BACKPACK SPRAYER

- 4 gallon backpack Diaphragm sprayer with standard features for the landscape & turf professional
  - Diaphragm pump for wettable powders
  - 4" wide opening with strainer/filter basket
  - Cushion grip spray handle
  - Adjustable padded shoulder with waist straps
  - 3 pc nozzle pack (brass, poly fan, poly cone)
  - Right and left hand use
- Part No. 64800.**



## Hand Sprayers

### WET or DRY HOSE END SPRAYER

- Hose end sprayer can accept liquid or dry materials. Has 3 spray positions. Up to 21 gallon of mixing liquid. Can hold up to 2 lb. of dry material. Insulated comfort grip with easy On/Off thumb switch. Translucent body for easy measuring.
- Part No. 6005.**



### MULTI-PURPOSE SPRAYER

- Multi-purpose hand sprayer for herbicides, pesticides, fertilizers and general cleaning
  - Nitrile seals for handling most cleaning solutions, herbicides, and pesticides
  - Adjustable cone nozzle
  - 48 oz. bottle
  - SureSpray™ anti-clog filter
- Part No. 1002.**



### INDUSTRIAL HEAVY DUTY CLEANER/DEGREASER SPRAYER

- Multi-Purpose Sprayer for cleaning-degreasing
  - Viton™ seals
  - Brass adjustable cone nozzle
  - 48 oz bottle
  - SureSpray™ Anti-clog Filter
- Part No. 1046.**



### POLY FOAMER SPRAYER

- Multi-Purpose Hand Sprayer for applying foaming solutions
  - Designed to spray foam
  - Nitrile Seals
  - Adjustable Cone Nozzle
  - 48 oz bottle
  - SureSpray™ Anti-clog Filter
- Part No. 1054.**



### ACETONE SPRAYER

- Acetone Hand Sprayer for Concrete Staining
  - EPDM seals and gaskets to handle high concentrations of Acetone
  - Adjustable cone nozzle
  - 48 oz bottle
  - SureSpray™ Anti-clog Filter
- Part No. 10027.**





**POWER MISTER**

- 32 oz. Multi-purpose trigger sprayer
  - Multi-use power mister
  - Great for watering house plants and flowers.
- Part No. 1055.



**UPSIDE DOWN SPRAYER**

- 32 oz. Multi-purpose trigger sprayer
  - Sprays upside down
- Part No. 1105.



Sprayer Replacement Parts and Accessories

Part No.	Description
6-1866	Premier Epoxy Coated Zinc Shut-off
6-1898	Industrial Brass Shut-off
6-1925	Repair Kit
6-1928	Acetone Nozzle Kit
6-1945	Poly Openhead Repair Kit with Viton
6-2000	RB/Home & Garden Shut-off - Clean & Seal
6-2001	RB/Home & Garden Hose
6-2003	Seal Kit
6-3337	Carrying Strap
6-4570	8 Position Nozzle
6-4601	XP Repair Kit-Viton
6-4602	XP Repair Kit-Acid
6-4603	XP Repair Kit-Xtreme
6-4604	XP Repair Kit-EPDM
6-4626	Poly Shut-off
6-4627	Industrial Repair Kit
6-4629	Kit OH/PL/FT Viton w/Blister
6-4631	Noz PL 1-4567 w/Blister
6-4638	Poly Shut-off, Cleaner/Degreaser
6-4645	Pressure Relief Valve
6-4646	Xtreme Repair Kit
6-4824	Fan Nozzle Kit
6-5351	Seal Kit for SNG/SNG+
6-5353	Shield for SNG
6-5354	34" Clear Reinforced Hose
6-5355	10' Coil Hose
6-5358	Spray Handle for SNG/SNG+
6-5364	Measuring Cup
6-5368	Pro Series Seal Kit
6-5369	Repair Kit, Acid Staining
6-5370	12" Curved Poly Wand, Acid Staining
6-5371	Poly Shut-off, Acid Staining
6-5372	Poly Adjust Cone Nozzle, Acid Staining
6-5373	Industrial Holster
6-5374	Pressure Relief Valve, Acid Staining
6-5378	Xtreme Conversation Kit - Hose/Seals
6-5380	Extreme Shut-Off
6-5382	Ergo Spray Handle Kit
6-5383	Relief Valve Kit - Premier Pro
6-5384	Pro + Acid Staining Kit
6-5387	O-ring kit
6-5797	Industrial Brass Fan Tip Nozzle
6-5943	Noz BR 1-5943 (female) - 1.0 gpm

Part No.	Description
6-6000	Brass Adjustable Cone Nozzle w/Viton
6-6002	Noz BR 3-6002 w/Blister
6-6003	Poly Adjustable Cone Nozzle
6-6062	Industrial Brass Shut-off w/Fitting
6-6091	48" Industrial Hose w/Fittings
6-6092	48" Heavy Duty Industrial Hose
6-6136	42" Nylon Reinforced Hose
6-6141	48" Nylon Reinforced Hose
6-7701	Ext Tube 3-7701 w/blister
6-7703	24" Industrial Brass Male Extension
6-7704	24" Industrial Brass Female Extension
6-7711	18" Premier Brass Extension
6-7734	Ext Tube 3-7734 w/blister Curved O-Ring
6-7742	18" Industrial Brass Female Extension
6-7745	Industrial Filtered Outlet Tube
6-7748	12" Poly Extension with Viton
6-7749	18" Poly Extension with Viton
6-7755	12" Poly Brass Extension with Viton
6-7756	16" Poly Brass Extension with Viton
6-7770	32" Extendable Wand with Viton
6-8093	Plastic Adj. Nozzle
6-8094	Retaining Nut
6-8095	Jet Filter
6-8096	Flat Spray Jet
6-8097	Swirl Plate
6-8098	Jet Cap
6-8099	Elbow
6-8100	O-Ring
6-8102	O-Ring
6-8104	Pin
6-8105	Hose 48"
6-8106	Hose Clamp
6-8107	Carrying Strap
6-8108	O-Ring
6-8109	Clamp
6-8110	Washer
6-8111	Retaining Nut
6-8112B	Retaining Nut
6-8114	O-Ring
6-8115	O-Ring
6-8116	O-Ring
6-8117	Valve Plate
6-8118	Spring

Part No.	Description
6-8119	Sealing Plug
6-8120B	Shut-Off Repair Kit
6-8122	Brass Adjustable Nozzle
6-8123	Strap - 61400 Series
6-8134	Piston Collar
6-8137	Straps - 61800 Series
6-8138	Shut-Off Assembly
6-8139	Poly Cone Nozzle Assembly
6-8140	Poly Fan Nozzle Assembly
6-8141	Wand Assembly
6-8142	Hose Assembly
6-8143	Straps - 61700 Series
6-8146	Filter Basket w/ Cap
6-8147	Shut-Off Assembly
6-8148	Replacement Elbow Kit
6-8151	Pressure Regulator
6-8152	Wand Clips
6-8153	O-Ring Kit
6-8154	O-Ring Kit
6-8169	4th Stage Replacement Filter
6-8178	Piston Cylinder Assembly
6-8179	Pump Piston Assembly
6-8180	Piston Pump Repair Kit
6-8181	Replacement Shoulder Straps
6-8184	Diaphragm Pump
6-8219	Spray Tube 20"

**DRIPLESS SHUT-OFF WAND**

Chapin Dripless Shut-offs seal at the nozzle tip eliminating excess buildup in the extension wand that can cause unwanted drips when the shut-off is disengaged. When the trigger grip is released from spraying, the shut-off seals at the nozzle tip keeping the excess left in the wand from dripping. Excellent for applying sealers where precise control is needed. Equipped with Xtreme® Seals to handle most extreme chemicals and high concentrations of Acetone®, Naphtha®, Xylene® and Toluene®.

Part No. 6-8135.





## EZ Mount & Tow Sprayers

### EZ MOUNT ATV DELUXE SPOT SPRAYERS

- 2.2 GPM, 12-volt diaphragm pump w/quick connect alligator clips
- Max pressure of 70 PSI with 30' max vertical sprayer & 26' max horizontal spray
- Double filtration system extends life of the sprayer
- Manifold w/pressure gauge for easy attachment of accessories
- 19" professional dripless shut off w/brass wand and nozzle (Viton® equipped)
- 15' reinforced hose for hard to reach areas
- Wide opening, chemical resistant tank for mess free mixing and drain plug to empty tank
- 15' ratchet straps included
- Part No. 97300, 15 gallon.
- Part No. 97500, 25 gallon.



### EZ TOW ATV TOW BEHIND SPRAYERS

- 2.2 GPM, 12-volt diaphragm pump w/quick connect alligator clips
- Max pressure of 70 PSI with 30' max vertical sprayer and 26' max horizontal spray
- Double filtration system extends life of the sprayer
- Manifold w/pressure gauge for easy attachment of accessories
- 19" professional dripless shut off w/brass wand and nozzle (Viton® equipped)
- 15' reinforced hose for hard to reach areas
- Wide opening, chemical resistant tank for mess free mixing and drain plug to empty tank
- Steel frame trailer w/pneumatic tires and adjustable hitch
- 7' spray boom included
- Part No. 97600, 15 gallon.
- Part No. 97700, 25 gallon.



### EZ SPRAYER TWIN NOZZLE BOOM KIT, 7-FEET, FITS ATV/UTV

- 7-foot coverage twin nozzle boom accessory sprayer kit
- Fits most atv/utility/lawn trailers-use minimum 1.8 GPM pump
- Adjustable boom mounting brackets
- For Chapin EZ mount and EZ tow sprayers
- Part No. 6328.



### EZ SPRAYER BOOMLESS ONE NOZZLE KIT, 16-FEET

- 16-Foot coverage one nozzle boomless accessory sprayer kit
- Fits most atv/utility/lawn trailers-use minimum 1.8 GPM pump
- Great for taller grass and eliminates risk of boom or nozzle damage
- For Chapin EZ mount and EZ tow sprayers
- Part No. 6329.



### EZ SPRAYER LAWN TRAILER MOUNTING BRACKET KIT

- ATV/utility vehicle accessory mounting kit
- Brackets fit most ATV's and many utility vehicles and lawn trailers
- Adjustable boom mounting brackets for optimum boom height
- For Chapin EZ mount and EZ tow sprayers
- Part No. 6330.



### EZ MOUNT REPLACEMENT PARTS

Part No.	Description
RP00004	Pressure gauge
RP00002	2.2 GPM replacement pump
RP00006	Wire harness
RP00005	Filler tank cap
RP00017	Drain plug
RP00007	3/8" in tank filter
RP00019	Manifold
RP00014	Wand clips
RP00013	3 GPM spray nozzle
RP00039	Filter basket
RP00123	2.0 GPM pump

## Handseeders

### HAND CRANK SPREADER

- Poly, scoop design with 92 cubic inch/1.5L capacity
- Easy crank design
- Adjustable for seed, fertilizer, and salt/ice melt
- Part No. 84150.



### RESIDENTIAL BAG SPREADER/SEEDER

- 25 lb. Capacity
- Heavy duty, water resistant zipper top bag
- Enclosed gear box
- Adjustable shoulder strap
- Part No. 84500.



**SURESPREAD ALL SEASON PROFESSIONAL STAINLESS STEEL PUSH SPREADERS**

- Surespread™ technology ensures an even pattern & distribution of product by combining our:
- Unique edge control to easily direct product distribution – keep unwanted product out of your flowerbeds and off of driveways/other bordering areas
- Innovative gate design and placement allows for a wide spread pattern and increased coverage – get the job done quickly!
- Positive stop dial for precise gate adjustment
- Stainless steel, heavy duty frames provide full support of hopper at its base
- T-handle with comfort grips features gate control at your fingertips
- Diamond shaped tubing ensures handle won't twist when pushing heavy loads
- 14" Fully pneumatic tires provide stability over uneven terrain
- Enclosed gear box
- Grate and rain cover included
- Easy to assemble

Part No. 82125, 125 lb. Spreader.

Part No. 82100, 100 lb. Spreader.



**SURESPREAD SALT SPREADER PROFESSIONAL STAINLESS STEEL PUSH SPREADER**

- Surespread™ technology ensures an even pattern of distribution of product by combining our:
- Innovative gate design and placement
- Unique edge control
- Enclosed metal gears to withstand the elements
- Solid steel linkage opens and closes the gate in incremental steps
- Patent pending poly conical auger helps agitate product and minimize clumping
- 43% Larger gate opening to allow product to flow smoothly
- Adjustable 360° salt baffle system helps spread salt only where you want it
- Stainless steel t-handle with comfort grips feature gate control at fingertips
- 14" Fully pneumatic tires easily handle rough terrain
- Heavy duty stainless steel frame fully supports hopper at its base
- Unique two-piece hopper design allows for easy replacement of hopper
- Grate and rain cover included
- All season spreader spreads salt/halite/ice-melt, fertilizer, seed and more with a simple gate adjustment

Part No. 82108, 100 lb. Spreader.



**ACCESSORIES**

Part No. 6-9000, Rain cover.

Part No. 6-9001, Optional grate

**SURESPREAD ALL SEASON RESIDENTIAL PUSH SPREADERS**

- Surespread™ technology ensures an even pattern & distribution of product by combining our:
- Unique edge control to easily direct product distribution – keep unwanted product out of your flowerbeds and off of driveways/ other bordering areas
- Innovative gate design & placement allows for a wide spread pattern and increased coverage – get the job done quickly!
- Positive stop dial for precise gate adjustment
- 12" Fully pneumatic tires easily handle rough terrain
- Heavy duty steel frame fully supports hopper at its base
- Enclosed acetal gears are protected from debris and the elements

Application chart to dial in the correct application setting

Part No. 80100, 100 lb. Spreader.

Part No. 80080, 80 lb. Spreader.



**SURESPREAD RESIDENTIAL PUSH SPREADER**

- Fully assembled with easy flip up handle
- 10" Solid tires w/rubber tread are virtually maintenance free – never go flat!
- Adjustable gate control conveniently located on handle
- Durable hopper w/3 hole gate opening for even distribution of materials
- Enclosed acetal gears are protected from debris & the elements

Part No. 80025, 70 lb. Spreader.



**ALL SEASON EZ TOW SPREADER**

- Enclosed metal gears to withstand the elements
- Solid steel linkage opens and closes the gate in incremental steps
- Patent pending poly conical auger helps agitate product and minimize clumping
- 43% Larger gate opening to allow product to flow smoothly
- Adjustable 360° salt baffle system helps spread salt only where you want it
- Powdercoated steel t-handle with comfort grips feature gate control at fingertips
- Easy to assemble
- 14" Fully pneumatic tires provide stability over uneven terrain
- Powdercoated steel frame directly supports hopper base and hopper
- Unique two-piece hopper design allows for easy replacement of hopper

Part No. 82175, 125 lb. Spreader.



## Submersible Sump Pumps

### RBSU25 BATTERY BACKUP SYSTEM

#### Features:

- 40 GPM at 5 ft.
- Reinforced, corrosion-resistant, thermoplastic battery backup sump pump system
- Reliable reed float switch for automatic operation
- Professional grade backup system keeps battery properly charged - requires one 40 Amp Hr or 75 Amp Hr deep cycle battery
- Alarm system, with status indicator lights, lets homeowner know when backup system is active
- Designed for easy installation without any major plumbing changes

**Part No. 47328**, 12-Volt Battery Backup System



### RSM33 BATTERY BACKUP SYSTEM WITH ADVANCE NOTIFICATION

#### Features:

- 40 GPM at 5 ft.
- Microprocessor controller checks for AC power and battery status
- Automatically checks status of backup pump every seven days
- Auto dialer calls any number you choose with a voice alert - program up to five phone numbers
- Smart charging technology eliminates surface charge and brings battery back to optimal levels
- Easily connects to any standard phone line. Telephone service required for auto dialer function
- Use any deep cycle 12V battery, maintenance free recommended
- Preassembled for quick installation

**Part No. 47323**, 12-Volt Battery Backup System with Advanced Notification



### XD PRO SUBMERSIBLE SUMP PUMPS

Rugged cast iron construction features a 1/2" solid-handling capacity and an 8 ft. power cord that operates an automatic vertical switch to prevent perimeter drainage system overflow.

#### Features:

- Energy efficient, oil-filled 1/3, 1/2, and 3/4 HP motors
- Top suction intake filters debris, minimizes airlocks and clogging for increased reliability
- 1/2" solid-handling capacity, thermally protected sump pump
- 360° stainless steel float guard, for superior switch protection from debris
- 1-1/2" discharge for easy installation and compliance to building codes
- 11" footprint allows installations into tight sump pits
- Stainless steel fittings and impeller plates for corrosion resistance
- Two-pole snap-action mechanical float switch
- Carbon/ceramic shaft seal for maximum life
- Upper and lower ball bearings for quiet performance and long life



**Part No. 47348**, 1/3 HP Sump Pump 60 GPM @ 5 ft.

**Part No. 47343**, 1/2 HP Sump Pump 70 GPM @ 5 ft.

**Part No. 47338**, 3/4 HP Sump Pump 80 GPM @ 5 ft.

### 500RSS SYSTEM

Preassembled primary and backup sump pump system with Advance Notification Battery Backup.

- Preassembled simple pump system. Job ready - installs in 20 minutes or less
- Includes check valves, primary pump and backup pump all ready for operation
- Microprocessor controller checks for AC power and battery status
- Automatically checks status of backup pump every seven days
- Auto dialer calls any number you choose with a voice alert - program up to five phone numbers
- Smart charging technology eliminates surface charge and brings battery back to optimal levels
- Easily connects to any standard phone line. Telephone service required for auto dialer function

**Part No. 47318**, Includes 1/2 HP Sump Pump System and Battery backup with Advance Notification & 12-Volt Backup Pump.



### XD PRO SEWAGE PUMPS

Rugged cast-iron construction features a 2" solids-handling capacity and a high performance permanent split capacitor (PSC) motor designed to accommodate single-family homes, multiple-family homes and small commercial applications.

#### RW50T Sewage Pump

- Piggy-back tether float switch for automatic or manual operation
- Vortex impeller generates high flow rates while handling up to 2" diameter solids
- Cast-iron motor and pump housing
- Ceramic/carbon seal for maximum life
- Upper bronze bearing and lower ball bearing for quiet performance and long life
- Designed for residential and light commercial sewage applications
- Ideal for basement or below grade installations
- Designed for 18" diameter or larger sewage basins

**Part No. 47293**, 1/2 HP - 120 Volt Sump Pump 130 GPM @ 5 ft.



#### RW50V Sewage Pump

- Snap action vertical float switch for automatic operation
- Vortex impeller generates high flow rates while handling up to 2" diameter solids
- Cast-iron motor and pump housing
- Ceramic/carbon seal for maximum life
- Upper bronze bearing and lower ball bearing for quiet performance and long life
- Designed for residential and light commercial sewage applications
- Ideal for basement or below grade installations
- Designed for 18" diameter or larger sewage basins
- Engineered flow director, shaped to reduce the likelihood of debris from interfering with switch operation

**Part No. 47298**, 1/2 HP - 120 Volt Sump Pump 130 GPM @ 5 ft.



### XD PRO EFFLUENT PUMPS

Rugged cast-iron construction features a 1/2" solids-handling capacity and 20' piggyback power cord to easily remove grey water (soiled) from septic tanks, sump pits or laundry tray systems.

#### Features:

- 1/2" solids-handling capacity, thermally protected pump
- Energy efficient, oil-filled motor
- 20' piggyback power cord for automatic or manual operation
- Top suction intake filters debris for increased reliability
- 1-1/2" discharge for easy installation and compliance to building codes
- 11" footprint allows installations into tight sump pits
- Stainless steel fittings and impeller plates for corrosion resistance
- Carbon/ceramic shaft seal for longer life
- Upper and lower sealed ball bearings for quiet performance and long life

**Part No. 47308**, 1/3 HP Effluent Pump 60 GPM @ 5 ft.

**Part No. 47303**, 1/2 HP Effluent Pump 70 GPM @ 5 ft.



# RIDGID®



**1/6 HP DEWATERING PUMP**

## Features:

- Corrosion-resistant reinforced thermoplastic housing, volute, and impeller
- Bottom suction design filters and removes water down to 3/8" of surface
- 1-1/4" NPS discharge with 3/4" garden hose adapter included
- Easy carry handle for portability

**Part No. 47283**, 1/6 HP Dewatering Pump 1 1/4" X 16 ft. Collapsible Hose 44 GPM @ 5 ft.



# RIDGID®

**1/4 HP AUTO ON/OFF DEWATERING PUMP**

## Features:

- Water detection technology, turns the pump on and off automatically with the presence of water
- Energy efficient, high flow 1/4 HP oil-free motor
- Corrosion-resistant, sealed thermoplastic construction for submersible use
- 1-1/4" discharge with garden hose adapter included
- Bottom suction design filters debris and removes water down to 3/8" of surface
- Motor rated 2.5 Amps

**Part No. 47278**, 1/4 HP Auto ON/OFF Dewatering Pump 44 GPM @ 5 ft.

**1/4 HP AUTO ON/OFF DEWATERING PUMP W/FREEZE PROTECTION**

## Features:

- Water detection technology, turns the pump on and off automatically with the presence of water
- Applications include dewatering pool covers and other situations requiring water removal
- Built-in debris and freeze protection
- Check valve reducer included to reduce short-cycling
- 25 ft. power cord
- Energy efficient, high flow oil-free motor
- Sealed thermoplastic construction for submersible use
- Strainer filters debris to minimize clogging
- ON level - 2 1/8", OFF level - 3/4"

**Part No. 47273**, 1/4 HP Auto ON/OFF Dewatering Pump w/ Freeze Protection 43 GPM @ 5 ft.

**CHECK VALVES**

**Part No. 47678**, Kit Includes: - 1 1/2" Check Valve, (2) rubber boots, (4) hose clamps

**Part No. 47668**, Kit Includes: - 1 1/2" threaded check valve, (1) rubber boot, (2) hose clamps

**Part No. 47673**, Kit Includes: - 2" check valve, (2) rubber boots, (4) hose clamps



47678

47668

47673

**UTILITY TRANSFER PUMP**

## Features:

- Rugged, cast-iron pump housing and motor for durability with easy-priming outlet
  - Cast-iron transfer pump is designed for tough pump applications
  - Easy-carry cast-iron handle for portability
  - Portable transfer pump you can take anywhere
  - High performance 1/2 HP motor
  - 3/4" brass hose adapters connect to standard garden hose
  - Applications include drainage, dewatering flooded basements, emptying stock tanks, draining water heaters, and charging poly glycol radiant heating lines
  - Boosts pressure up to 50 PSI
- Part No. 47268**, 1/2 HP cast-iron transfer pump Reinforced thermoplastic storage case Suction strainer 3/4" brass hose adapters 950 GPH @ 25 ft.



# Crosby®

Part No.	Size
1010015	1/8"
1010033	3/16"
1010051	1/4"
1010079	5/16"
1010097	3/8"
1010113	7/16"
1010131	1/2"
1010177	5/8"
1010195	3/4"
1010211	7/8"
1010239	1"
1010257	1-1/8"
1010275	1 1/4"
1010319	1 1/2"
1010355	1 3/4"
1010373	2"

**GENIUE RED U-BOLT FORGED STEEL, HOT DIP GALVANIZED CLIPS**





### CLINGCOVER® PLASTIC SHEETING

The perfect self-adhering masking film for all your construction and remodeling jobs. ClingCover clings to almost any surface. Part No. 79400, 9 ft. x 400 ft.



### EASYMASK® MASKING PAPER

Use paper to mask off window and door trim to prep for painting. Brown general purpose paper formulated for water-based materials: plaster, drywall texture, latex. Part No. 12912, 12" x 180 ft. (180 sq. ft.) Part No. 12918, 18" x 180 ft. (270 sq. ft.) Part No. 12107, 12" x 1,000 ft. (1000 sq. ft.) Part No. 12102, 18" x 1,000 ft. (1500 sq. ft.) Part No. 12104, 24" x 1,000 ft. (2000 sq. ft.) Part No. 12108, 36" x 1,000 ft. (3000 sq. ft.)



### REVERSE WOUND PROTECTIVE FILM FOR CARPETS

Easy-to-use adhesive film provides a tight bond with soft surfaces, such as carpet, yet is easy to remove. Part No. 62450/6, 24" x 50 ft., 100 sq. ft. shelf display Part No. 62410, 24" x 100 ft., 200 sq. ft. shelf display Part No. 62420, 24" x 200 ft., 400 sq. ft. Part No. 63020, 30" x 200 ft., 500 sq. ft. Part No. 63620, 36" x 200 ft., 600 sq. ft. Part No. 63650, 36" x 500 ft., 1,500 sq. ft. Part No. 63610, 36" x 1,000 ft., 3,000 sq. ft. Part No. 64850, 48" x 500 ft., 2,000 sq. ft.



### REVERSE WOUND PROTECTIVE FILM FOR HARD SURFACES

Use on hard surfaces for painting, moving and construction projects. Part No. 72420, 24" x 200 ft., 400 sq. ft. Part No. 72436, 36" x 500 ft., 1,500 sq. ft.



### ONE TUFF™ FLOOR PROTECTOR

Durable DuPont™ Sontara® is great for protecting floors and delicate surfaces and is packaged in rolls for quick and easy use. The cloth side absorbs while the coated side provides maximum protection against leakage. Part No. 90100, 24" x 100 ft., 200 sq. ft. shelf display Part No. 90200, 24" x 200 ft., 400 sq. ft. shelf display Part No. 94820, 48" x 200 ft., 800 sq. ft.



### ADJUSTABLE FILM APPLICATOR

Adjustable applicator for 24", 30" and 36" carpet and hard surface films. Unrolls reverse wound film quickly and easily Part No. 62300.



### PREMIUM CANVAS DROPCLOTHS

Full panel drops are made from high quality canvas. Each drop is shrink wrapped and boxed for easy handling. Canvas dropcloths are washable and reusable. All dropcloths are full piece, no remnants.

#### 6 OZ. PREMIUM UTILITY WEIGHT CANVAS DROPCLOTH

Part No. 56707, 4 ft. x 12 ft., runner  
Part No. 56708, 4 ft. x 15 ft., runner  
Part No. 56701, 9 ft. x 12 ft.  
Part No. 56703, 12 ft. x 15 ft.



#### 8 OZ. PREMIUM CONTRACTOR GRADE HEAVYWEIGHT CANVAS

Part No. 58905, 4 ft. x 5 ft., quick drop  
Part No. 58907, 4 ft. x 12 ft., runner  
Part No. 58908, 4 ft. x 15 ft., runner  
Part No. 58909, 6 ft. x 9 ft.  
Part No. 58901, 9 ft. x 12 ft.  
Part No. 58903, 12 ft. x 15 ft.



#### 10 OZ. PREMIUM CONTRACTOR GRADE EXTRA HEAVYWEIGHT CANVAS

Part No. 51125, 4 ft. x 5 ft., quick drop  
Part No. 51127, 4 ft. x 12 ft., runner  
Part No. 51128, 4 ft. x 15 ft., runner  
Part No. 51129, 6 ft. x 9 ft.  
Part No. 51121, 9 ft. x 12 ft.  
Part No. 51123, 12 ft. x 15 ft.



#### 12 OZ. PREMIUM CONTRACTOR GRADE SUPER HEAVYWEIGHT CANVAS

Part No. 51207, 4 ft. x 12 ft., runner  
Part No. 51208, 4 ft. x 15 ft., runner  
Part No. 51201, 9 ft. x 12 ft.  
Part No. 51203, 12 ft. x 15 ft.



### RUBBER-DUCKIE™ HEAVYWEIGHT BUTYL DROPCLOTH

Heavyweight coated dropcloth is leak resistant. Part No. 80207, 4 ft. x 12 ft., runner Part No. 80208, 4 ft. x 15 ft., runner Part No. 80201, 9 ft. x 12 ft. Part No. 80203, 12 ft. x 15 ft.



### OLD SCHOOL HEAVYWEIGHT BUTYL DROPCLOTH

Triple-coated butyl dropcloth is heavy weight, leak resistant and durable. Part No. 80427, 4 ft. x 12 ft., runner Part No. 80428, 4 ft. x 15 ft., runner Part No. 80421, 9 ft. x 12 ft. Part No. 80422, 12 ft. x 15 ft.



### ONE TUFF™ PROFESSIONAL GRADE DROPCLOTHS

Durable DuPont™ Sontara® is great for painting, staining and plastering. The cloth side absorbs while the coated side is leak-resistant. Part No. 90099, 4 ft. x 15 ft. Part No. 90088, 6 ft. x 8 ft. Part No. 90019, 9 ft. x 12 ft. Part No. 90039, 12 ft. x 15 ft.





**CAR COVER**

Lightweight, full panel cover protects car from overspray. Made of non-woven material, the cover has double stitched seams and an elastic border which conforms to car size. One Size Fits All Car Cover – compressed Part No. 36002/4.



**PEEL & STICK ZIPPER**

Creates an instant door on tarps, plastic coverings and shrink wraps. For hazardous material abatement stations. Part No. 06184, 2 3/4" x 7 ft. heavy duty fabric adhesive zipper – 2pk. Part No. 06182, 3" x 7 ft. woven poly adhesive zipper – 2pk.



**DIRT TRAPPER™ ULTRA STICKY MAT**

When placed inside jobsite or work area entrances, the sticky mat traps contaminants from shoes and carts.

Part No. 01267, 24" x 36", 30 Layer Blue Mat – 4pk  
Part No. 01274, 24" x 36", 30 Layer Clear Mat – 4pk  
Part No. 01277, 36" x 36", 30 Layer Blue Mat – 4pk  
Part No. 01276, 36" x 36", 30 Layer Clear Mat – 4pk  
Part No. 01260, 26" x 32" Non-skid Frame, 15 Layer Mat  
Part No. 01263, 24" x 30", 15 Layer Refill  
Part No. 01265, 24" x 30", 30 Layer Refill



**PHILIPS / SYLVANIA / GE / WAGNER**

HID Bulbs



Part No.	Type	Volts	Wattage
D3R	T-2 3/4	12	35
D3S	T-2 3/4	12	35
D4R	T-2 3/4	12	35
D4S	T-2 3/4	12	35

Halogen Bulbs - Careded

Part No.	Type	Volts	Wattage
BP9003SU	T-5	12.8	65/55
BP9004SU	T-4 1/2	12.8	64/45
BP9005SU	T-4	12.8	65
BP9006SU	T-4	12.8	55
BP9007SU	T-4 1/2	12.8	65/55
BPH1ST	T-2 3/4	12.8	55
BPH3ST	T-3 3/4	12.8	55
BPH4ST	T-5	12.8	60/55
BPH7SU	T-4	13.2	55
BPH11ST	T-4	13.2	55
BPH11SU	T-4	13.2	65/55
BPH13SU	T-5	12.8	65/55



All bulbs are blister packaged 1 bulb per card.

Suffixes:

**ST = SilverStar** - Whitest, Brightest, Sharpest - SilverStar's colour temperature is a white hot 4000°K, far higher than other halogens. Shines with a luminance up to 20% greater than other halogens.

**SU = SilverStar Ultra** - By providing up to 50% greater brightness, they can increase visibility down the road by up to 40%, and peripheral visibility by up to 50%. This can equate to as much as 50 to 100 feet more visibility at night—so you can see farther, wider and better.

**NORSEMAN™**

Canvas Belly Tarps



**CANVAS BELLY TARP**

Used as a barrier to keep the underside of heavy haulers free of debris and contaminants as well as helping to retain engine heat preventing oil freeze ups in cold weather.

4 ft. x 9 ft. cut size canvas belly tarp. 20 oz. per sq. yard, 2 1/2" hem. Brass grommets every 24". Waterproof and rot resistant.

Part No. 386872.



Smaller size canvas belly tarp — 4 ft. x 6 ft. cut size. Accommodates newer bumper styles. 17.6 oz. per sq. yard. Waterproof and rot resistant. Part No. 411815.





## DEF Dispensing Products

### PIUSI THREE25 TOTE DISPENSERS

Created to ensure optimum durability and efficiency, the Piusi Three25 administers a 32.5% urea solution that is protected by our 3D DEF filter which prevents the contamination of your DEF and in turn allows for an increased life of the catalyst.

This kit features our latest SB325 nozzle with break-away stainless steel spout, revolutionary AdBlue® 3D DEF filter, original Piusi Dispense Coupler (PDC) and more! With a fortified new mounting bracket and updates such as crimped DEF hose, this kit brings a whole new way to dispense DEF.

The Piusi Three25 is equipped with the SB325 automatic nozzle, featuring a sleek, innovative technopolymer design that is reliable, ergonomic, and has a flexible shell that protects it from weathering and UV radiation. The spout is used in conjunction with our Piusi Magnetic adaptor to prevent a potential miss-fill. If the magnetic adapter is not in that allocated tank then the nozzle will not engage. Safety is also guaranteed by the break-away system. In the event that a vehicle accidentally drives away with the nozzle still in the tank, the spout is designed to detach from the nozzle. This system allows for a quick repair by merely fitting a new spout on the nozzle.

Part No.	Description	Flow Rate gpm	volt/Hz	rpm	watt	Nozzle	Delivery Hose	UL Approval
F00101A10	Three25 12V	7-9	12	1700	370	Auto	20 ft.	No
F00101A00	Three25 120V	7-9	120/60	1700	370	Auto	20 ft.	Yes



### SUZZARABLU TOTE DISPENSERS

The dispensing equipment is designed for easy management and dispensing. It includes a self-priming membrane pump that has no need for a dynamic seal, which reduces the need for maintenance.

#### SUZZARABLU PRO

•Stainless steel base with nozzle holder •Heavy duty pump •Meter K24 •Automatic stainless steel nozzle •Delivery hose 20 ft. •Suction hose 4 ft. •Hose tail and clamps.

#### SUZZARABLU BASIC

•Stainless steel base •Pump •Manual nozzle •Delivery hose 20 ft. •Suction hose 4 ft. •Hose tail and clamps.

Part No.	Description	Flow Rate gpm	volt/Hz	rpm	watt	Meter	Nozzle	UL Approval
F00201A1	120V PRO	7-9	120/60	1700	400	Yes	Automatic	Yes
F00201A2	120V BASIC	7-9	120/60	1700	400	No	Manual	Yes
F00201A8	12V PRO	7-9	12	2800	260	Yes	Automatic	No
F00201A9	12V BASIC	7-9	12	2800	260	No	Manual	No



SUZZARABLU PRO



SUZZARABLU BASIC

### SUZZARABLU DRUM DISPENSERS

This dispensing equipment offers a base that can be easily transferred. The kit contains: Stainless steel base for drum •Pump •Nozzle •Delivery hose (20 ft) •Suction hose (1.5 ft)

Part No.	Description	Flow Rate gpm	volt/Hz	rpm	watt	Nozzle	UL Approval
F00201A3	DRUM manual	7-9	120/60	1700	370	Manual	Yes
F00201A4	DRUM automatic	7-9	120/60	1700	370	Automatic	Yes



SUZZARABLU MANUAL



SUZZARABLU AUTOMATIC

### HAND PUMP DISPENSER

The delivery system includes a hand pump, dispensing tube, down tube and adapter that is easy to install and remove from the drum. Flow rate: 4 gpm, Spout: 3/4" BSP, Inlet pump: 1" NPS, 9.8 ft. delivery hose.

Part No. F0033213.



### DRUM TROLLEY

Designed for easy mobility of your DEF drum. Its robust build and four wheel design allows for maximum stability and longevity while being used in a shop or semi-flat surface. Any of the five tote pump kits can be installed on the back of the trolley.

Part No. R1206801.



drum and pump sold separately

### SUZZARABLU HEAVY DUTY PUMPS

Membrane pump equipped with an electric motor, auto shutoff timer and no need for a dynamic seal, creating a reliable industrial pump with self priming capabilities.

AC PUMP Technical features:

- Voltage: 120V/60 Hz
- Hose tail connection: 3/4"
- ON/OFF switch
- 6 ft cable with socket
- 30 psi Max pressure
- 30 min. cycle



DC PUMP Technical features:

- Voltage 12 / 24 V
- Hose tail connection: 3/4"
- ON/OFF switch
- 6 ft cable with socket
- 20 psi Max pressure
- 20 min. cycle



### AUTOMATIC NOZZLES

Features a innovative technopolymer casing, break-away system, and a stainless steel spout. Safety is guaranteed by the break-away system. In the event that a vehicle accidentally drives away with the nozzle still in the tank, the spout is designed to detach from the nozzle. This system also allows for a quick repair by merely fitting a new spout onto the nozzle. Automatic nozzle design features a reliable, ergonomic, and flexible shell that protects against weathering and UV radiation.

Part No. F0061700.

Part No. F0061701, With meter.

Part No. R1917300, Replacement spout kit.

- 9 gpm flowrate
- 3/4" inlet, no swivel
- 19 mm spout



F0061701

Part No.	Description	Flow Rate gpm	volt/Hz	rpm	watt	amp
F0020300	AC pump 120V	7-9	120/60	1400	400	2
F0020400	DC pump 12V	7-9	12	2800	260	22
F0020401	DC pump 24V	7-9	24	2800	310	13



Fluid Handling Innovation



**K24 ADBLUE® FLOW METER**

The K24 is easy to install, in line or at the end of the delivery hose, and it features a compact easy readable display that can be applied directly on the nozzle. User can quickly substitute the 2 batteries. Impulse type signals: single channel, reed switch. Electronic card with LCD display: 5 digit partial total from 0.1 to 99999, 6 digit total from 1 to 999999.

**K24 PULSE-METER**

Type of output signal: raw signal (reed switch), single channel. Max 28 V Ac/dc 100 mAmp.

**TURBINOX INLINE PULSE METER**

This meter is easy to install. A tight stainless steel body provides endurance for use in all conditions. Also available a pulser display to connect an external receiver. User can quickly substitute the 2 display batteries.

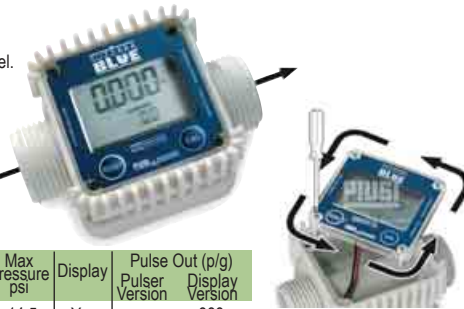

Part No.	Description	Flow Rate gpm	Max Pressure psi	Display	Pulse Out (p/g) Pulser Version	Display Version
F0040734	K24 Meter (1 socket) GAL	1.6 - 26.4	14.5	Yes	-	333
F0040721	K24 Pulser-meter (1 socket)	1.6 - 26.4	14.5	No	333	-
F0049503	Remote display with Pulse OUT	-	-	Yes	-	1-100

Display can be rotated in 4 different positions

**HOSE REEL**

Hose reel made specifically for DEF with 48 ft. EPDM supply hose.

Features: •Reduced pressure loss through the proper sizing of the hydraulic system •Includes a protective latch mechanism that prevents accidental contact with the hands •Adjustable arms for easy positioning as required  
Part No. F0075011.

Part No. F1627900, Rotating hose reel bracket.



•145 psi Max pressure  
•3/4" inlet with swivel  
•3/4" outlet hosetail  
•8.7 @ 9 gpm pressure loss

**SUZZARABLUZ NOZZLES**

Piusi nozzles are all made from materials compatible with Urea. Complete with 3/4" hose-tail fitting and 3/4" spout extension.

**Manual Nozzle** - distinguished by high efficiency, due to the low flow resistance, and inexpensive operation.

**Automatic Nozzle** - featuring a device that stops the flow when the tank is full.

**Nozzle & Electronic Flow Meter** - providing immediate reading of dispensed quantity.

Part No.	Description	Flow Rate gpm	Display
F0087002	Manual nozzle/K24 meter - with swivel	19	Yes
F0061903	Automatic nozzle with swivel	11	No
F0061902	Automatic nozzle	11	No
F1476100	Manual nozzle	20	No



Part No. F1647500, K24 adapter for automatic nozzle. 3/4" MBSP - 1" FBSP.



Part No. F1577600, Plastic adapter for K24 manual nozzle. 1" MBSP - 1" FBSP.



**BLUE BOX**

Metal box with lock. Box key included

Dimensions: 23" x 12" x 24

Part No. R1611800.



**BOTTOM CONNECTION KIT**

2" NPT.  
Part No. F1551502.



**EPV STAINLESS STEEL DISPENSE COUPLER**

by Micro Matic  
Part No. F1647700.



**EPV CONTAINER VALVE**

2.5" X 5 buttress. 3A orange key.  
Part No. F1698900.



**EPV DOWN TUBES**

HDPE 3/4" diameter.

Part No. F1699200, for 55 gal drum.

Part No. F1699100, for 275 gal IBC.

Part No. F1699000, for 330 gal IBC.



**RSV STAINLESS STEEL DISPENSE COUPLER**

by Micro Matic  
Part No. F1536000.



**GRAVITY KIT**

As an alternative to the electric pump and hand pump options, the Gravity Kit offers another method of dispensing DEF. Equipped with manual nozzle, 9 ft of hose with 2" NPT IBC bottom adapter, this is an economic means of utilizing your IBC tote to dispense from an elevated position.

Part No. F1551701.

**ADAPTERS - Stainless Steel**

Part No. F1607400, NPT/NPT.

Part No. F1645800, BSP/NPT.

Part No. F1607300, BSP/BSP.



**PLASTIC FITTINGS**

- (1) Part No. F1552200, 3/4" hose x 1" MBSP hose tail fitting.
- (2) Part No. F1643500, 3/4" hose x 1" FBSP hose tail fitting.
- (3) Part No. F1548500, 3/4" hose x 1" MBSP 90° fitting.
- (4) Part No. F1548400, 3/4" hose x 1" FBSP 90° fitting.
- (5) Part No. F1517900, 1" MBSP x 1" FBSP swivel.
- (6) Part No. F1643300, 1" FBSP 90° socket.
- (7) Part No. F1643400, 1" FBSP linear socket.



**STAINLESS STEEL FITTING**

3/4" hose x 3/4" M.BSP swivel hose tail fitting  
Part No. F1413200.



**3D FILTER / CARTRIDGE**

Part No. F00611D10.



Fluid Handling Innovation

## Chemical Products

### SPIDER CONTROL

Contains natural ingredients from chrysanthemum flower. Water based formulation (solvent free). Acts as a long lasting deterrent of insects for up to 8 weeks. For spiders, ants, cockroaches, crickets, centipedes, and silverfish. The only effective relief from spider webs and spider spots.

Part No. 00555, 350 g aerosol.



### IN-SPEC

A strong deterrent for crawling and flying insects. Broad spectrum natural insecticide for spiders, ants, flies, and roaches. Residual effect for long lasting performance. Economical 1 liter liquid trigger spray. Biodegradable ingredients and non WHMIS controlled.

Part No. 00556, 1 L bottle.



### RED LITHIUM GREASE

A speciality lithium complexed, multi-operational lubricating grease. Particularly useful in applications with extremes of -40°C to 171°C.

Part No. 61614, 300 g aerosol.



### DRAIN OPENER

A very highly active sulfuric acid based drain opener. Works fast on organic waste, paper, grease clogs, and soap. Inhibited to prevent corrosion. Great for clogged drains, large floor drains, cesspools, and regular drain maintenance.

Part No. 99550, 1 L bottle.



### SALT SHIELD - WATER-BASED SALT REMOVER & CORROSION PREVENTER

Salt neutralizer and salt remover liquid concentrate effectively removes salt residue from pores in metal and other surfaces to prevent rust and corrosion. Use on salt spreaders, snowplows, truck boxes and truck chassis for maximum longevity. Salt Shield contains actives that dissolve, release and remove salt crystals from any surface. It will work to protect against salt corrosion and reduces costly repairs caused by salt. Highly effective corrosion inhibitors leave a protective film on surface until surfaces are again exposed to water. Will not strip wax or cause streaks or spots. Spray on diluted product or use pressure/power washer. Biodegradable and non toxic to humans and the environment. Concentrated, can be diluted to 1 to 512 parts water. Do not rinse off product with water after application or corrosion inhibition is reduced. Protects aluminum, copper, brass, mild steel with over 99% effectiveness.

Part No. 27220, 500 g aerosol.

Part No. 27104, 4 L jug.

Part No. 27120, 20 L pail.

Part No. 27145, 205 L drum.



**TECHNICAL DATA**  
pH: 6.0 - 7.0  
Colour: Amber



### TOILET BOWL CLEANER

A hydrochloric acid based economical bowl cleaner for cleaning, disinfecting and descaling toilets, urinals, etc. Synergistically inhibited for plumbing protection. Works for the strongest rust and scale.

Part No. 99520, 1 L bottle.



### PURPLE POWER - CLEANER CONCENTRATE

Removes grease, oil, stains, odours, smoke, mold, pet accidents, tar, wax, air borne dirt, sap, and many others.

•All-purpose cleaning and degreasing •Biodegradable •Dilute 4:1 for heavy degreasing •10:1 for hard surface cleaning

•Non-abrasive

Part No. 57601, 1 L bottle.

Part No. 57622, 935 ml trigger sprayer.

Part No. 57620, 20 L pail.



**TECHNICAL DATA**  
pH: 11.0  
Colour: Purple  
Biodegradability: 100% in 28 days



### XTREME CLEAN - MULTI-PURPOSE INDUSTRIAL FORMULA CLEANER DEGREASER

A heavy duty water based degreaser that can be diluted 1:200 with water. Based on 100% plant-based surfactants. Free from phosphates, NPE, SLS, and Alcohol Ethoxylates. Non-corrosive and no acids. Cleans and degreases for all heavy-duty industrial applications including oil rigs, felts and equipment in paper mills, waste management, rail, shipping, equipment and truck cleaning. Can be used with pressure washer, manual cleaning, and brushless tunnel.

Part No. 58605, 400 g aerosol.

Part No. 58622, 935 ml trigger spray.

Part No. 58601, 1 L bottle.

Part No. 58620, 20 L pail.

Part No. 58645, 205 L drum.



**TECHNICAL DATA**  
pH: 12.0  
Colour: Amber  
Biodegradability: 100% in 28 days



### PURE CLEAN CARPET & FABRIC CLEANER

Formulated as an environmentally safe, non-hazardous product. Low foaming and highly effective in the cleaning of grease, mildew, molds, and stains from carpets and hard surfaces. It leaves a fresh pleasant odour based on natural extracts from orange and lemon peels. Use with carpet steam cleaners or bucket dilution method.

Part No. 72820, 20 L pail.

**TECHNICAL DATA**  
PH: 9.0  
Biodegradability: 100% 28 days







## AD OFF GRAPHIC LABEL/ DECAL REMOVER

Softens graphics and removes adhesive residue from all self-adhesive stickers and applied graphics on all surfaces. Makes light work of a very difficult task. •Low odour •User friendly •Professional performance

Part No. 77401, 535 ml spray bottle.

Part No. 77404, 4 L jug.

Part No. 77420, 20 L pail.



## CONCRETE REMOVER/ CLEANER - ACID BASED/ BUFFERED

Suitable for heavy-duty applications such as cleaning concrete trucks. •Fast acting and non-fuming acid for removal of cement •Contains corrosion inhibitors - will not be harmful and has a pleasant cherry odour •Contains wetting agent and penetrates to help speed up concrete dissolution

Part No. 87120, 20 L pail.

Part No. 87145, 205 L drum.



## CONCRETE CURE & SEAL - SOLVENT BASED

Made for curing, sealing, hardening, and dust proofing concrete. Non-yellowing, stabilized copolymer resins giving excellent stain resistance, colour enhancing and protective glossy finish. Used for interior and exterior use.

Part No. 86120, 20 L pail.

Part No. 86145, 205 L drum.



## CONCRETE GUARD & SEALER - WATER BASED

Premium satin finish, water based acrylic sealer that provides a tough flexible water resistant film for new or old concrete or terrazzo floors. Non-yellowing and durable.

Part No. 85120, 20 L pail.

Part No. 85145, 205 L drum.



**Please note: Mölnlycke/Tork Paper & Hygiene Products are sold in case lots only.**

Part No.	Description	Size	Case Quantity	Recommended Dispenser
<b>General Duty Wipers</b>				
290089	TORK H1 Advanced Hand Towel Roll, white, 1-ply	7.75" x 700 ft.	6 rolls	5511201



## ELEVATION™ INTUITION® HAND TOWEL ROLL DISPENSER

The Tork Elevation Intuition Dispenser presents the most advanced electronic system in the industry today. The touch-free electronic Tork Elevation Intuition® virtually eliminates cross contamination while cutting back on supply waste. Each unit features a choice of two dispensing modes. The towel remains inside the cabinet until the user activates the sensor, delivers maximum hygiene. An adjustable towel length of 8" to 24", and a stub roll compartment combine to deliver more precise control of consumption are a few of the features available. Batteries lasts up to 40 rolls on average with normal usage. It's easy to reach and simple to reload. Versatile Installation - Elevation Intuition® can be mounted directly to wall or within a recessed compartment. Numerous back-plate mounting slots fit most any pattern. Uses 3 "D size" batteries.

Part No. 5511201, For H1 Roll Towels.



## HI-VIS ORANGE FASTFIT® GLOVE

•Reflective 3M strip panel across top of hand for added visibility  
•Anatomically cut two-piece palm eliminates bunching for a snug fit •Trek-Dry® material helps keep top of the hand cool and comfortable during warm weather •Elastic cuff provides a secure, second-skin fit with easy on/off flexibility •Machine washable •Conforms to CE 3121 and ANSI 107

Part No. MFF-09-008, Small/size 8.

Part No. MFF-09-009, Medium/size 9.

Part No. MFF-09-010, Large/size 10.

Part No. MFF-09-011, X-large/size 11.

Part No. MFF-09-012, 2X-large/size 12.



## Vehicle Service Products

### Seat Jacket™ SEAT COVERS

Seat Jacket™ is specially designed to protect seats during the pre-owned vehicle prep process, keeping seats clean and looking like new. Seat Jacket™ conveys quality and care, delivering a premium customer experience and giving pre-owned vehicle dealers a competitive edge.

**Features:** •Similar to the seat cover we manufacture for over 90% of North American OEMs •Clings, covers, protects •Fitted/contoured styling •Advanced Slip-N-Grip® technology •Fits most vehicles •Guaranteed quality and durability •Recyclable  
**Part No. FG-P9943-16**, 36" x 57" seat jacket, double pocket seat cover. 50 per roll.



### SEAT COVERS

Slip-N-Grip® seat covers are manufactured in the USA and are the only interior protection used in both OEM and aftermarket applications. The multi-layer construction ensures that they stay in place throughout the entire service process. The bottom layer grips the seat to stay in place while the slick top layer allows easy entry and exit from the vehicle. Slip-N-Grip® seat covers tell customers that you care – and save the automotive service center money! Slip-N-Grip® seat covers deliver unmatched quality and performance, and are disposable and recyclable.

#### BEST

**Part No. FG-P9943-20**, 32" x 56" seat cover. 200 per roll.

#### BETTER

**Part No. FG-P9943-14**, 32" x 56" seat cover. 250 per roll.  
**Part No. FG-P9943-10**, 32" x 56" seat cover. 250 per box.

#### GOOD

**Part No. FG-P9943-15**, 32" x 52" seat cover. 500 per roll.



### LARGE CAR COVERS

•Dust protection •Temporary car cover •Clear  
**Part No. FG-P9943-22**, 13.6 ft. x 25 ft. 30 per roll.



### PLASTIC FLOOR MAT

•Slip-N-Grip® multi-layer construction ensures floor mat stays in place •Impervious to water, oil, grease and most shop chemicals •Mat says, "We Take Pride in Your Vehicle."  
**Part No. FG-P9943-02**, 16.5" x 21" floor mat. 500 per roll.



### ADHESIVE FLOOR MATS

•Perfect for detail shops, car washes, used car dealers, showrooms and RV outlets •21" x 24" clear mat is a full 3.0 mil thick with high-strength adhesive coating •Stay-in-place protection for up to 30 days  
**Part No. FK-P9933-61**, Custom dispenser and combo kit.  
**Part No. FB-P9933-49**, 21" x 24" mat. 300 ft. roll.



### TIRE BAGS

•Contains a minimum of 15% GreenPE® recycled resin •Ideal when returning old tires or snow tires for storage •White  
**Part No. FG-P9943-29**, 36" x 40" standard tire bags. 250 per roll.  
**Part No. FG-P9943-28**, 39" x 44" large heavy-duty tire bags. 100 per roll.  
**Part No. FG-P9933-92**, 39" x 44" large tire bags. 250 per roll.  
**Part No. FG-P9933-91**, 47" x 48" x-large tire bags. 125 per roll.



### STEERING WHEEL COVERS

•Elastic design is easier to apply and remove than stretch wrap covers  
 •Double-band and shower-cap styles  
**Part No. FB-P9943-36**, 24" cover, double band. 250 per box.  
**Part No. FB-P9943-33**, 24" cover, double band. 500 per box.  
**Part No. FB-P9943-35**, 28" cover, double band. 250 per box.  
**Part No. FB-P9933-82**, 24" cover, shower cap. 500 per box.



Double Band



Shower Cap

### KRAFT PAPER FLOOR MAT

•Keep dirt, grease, oil, spills, leaks or other shop fluids out of your customer's vehicle during service •17" x 19"  
**Part No. M1765KR1965A**, 500 per box.



### GEAR SHIFT COVERS

•Fits most vehicles •5" x 17"  
**Part No. FB-P9833-98**, 500 per box.  
**Part No. FB-P9943-80**, 1000 per box.



### "CHECK YOUR OIL FREQUENTLY" SERVICE REMINDER LABELS

•Stick-on label with fill-in boxes as a reminder for your next oil change  
**Part No. FB-P9944-30**, 500 per roll.



### KEY TAG

•Paper key tags with metal rings  
**Part No. FB-P9833-13**, 1000 per case.



### ADHESIVE CRASH WRAP

•36" x 100' roll  
**Part No. FB-P9943-41**.



## Masking Film

### SELF-ADHERING MASKING FILM

GripNGuard clings to virtually any surface with minimal or no taping required. The outer surface of GripNGuard has been tested to retain dust 3½ times better than most plastic drop cloths. Dust, paint, sawdust and other airborne particles cling to the GripNGuard surface and are not reintroduced to the area during repositioning or cleanup. That means less clean up time, lower costs and higher profits. .31 mil gauge.

**Part No. FG-P9943-77A**, 9 ft. x 400 ft.

**Part No. FG-P9934-16**, 12 ft. x 400 ft.

**SP04-22 GREGG DISTRIBUTORS LTD.**





**ALL PURPOSE WATERPROOF LIGHTED WARNING WHIPS**

- Gorilla® All Purpose Waterproof Warning Whip with stainless steel components sets the new standard for weather resistance in any working conditions.
  - These whips are ideal for extreme weather conditions such as coastal areas, corrosive environments, salt mines, and areas with high humidity.
  - Rocket™ II Super Bright Waterproof LED comes standard with 9 changeable light modes, 7 flash patterns, and steady on or off, which provides a "one light fits all" solution
  - Premium fiberglass resin creates the strongest whip in the industry
  - Internal wire is industrial grade and meets Military Spec MIL-W-16878
  - Includes a two conductor waterproof hot plug with 12" pigtail, heavy duty Day Bright™ fluorescent nylon mesh flag with 3M® Scotchlite® reflective X, Rocket™ II Super Bright Waterproof Amber LED light, and a stainless steel threaded hex base
- Part No. APW-12-A-OA, 12 ft.  
 Part No. APW-10-A-OA, 10 ft.  
 Part No. APW-8-A-OA, 8 ft.  
 Part No. APW-6-A-OA, 6 ft.  
 Part No. APW-5-A-OA, 5 ft.  
 Part No. APW-3-A-OA, 3 ft.

**REMOTE CONTROL**

- Light patterns are easy to program with remote control
- (9) Flash patterns:
  - Breathe followed by 16 strokato flashes
  - Rapid flash
  - Brighten then flash
  - Breathe then flash
  - Slow blink
  - Flash
  - Steady
  - Increasing sequential blinks
  - Off



Part No. REMOTE.

**REPLACEMENT PARTS**

- Part No. A-4LED-CB, Amber 4 LED C Board.
- Part No. B-4LED-CB, Blue 4 LED C Board.
- Part No. G-4LED-CB, Green 4 LED C Board.
- Part No. R-4LED-CB, Red 4 LED C Board.
- Part No. W-4LED-CB, White 4 LED C Board.
- Part No. RKT-4-LENS, Clear lens.
- Part No. WPP-12, 12" Waterproof Pigtail.



**Hitch Mounts**



2" hitch mount with threaded hex base and 24" power cord with 7-way plug  
Part No. FS7015PC.



2" hitch mount with threaded hex base and 24" power cord with 7-way plug and backup alarm  
Part No. FS7015PC-BU.



2" permanent hitch mount for Super Whip and Heavy Duty Gorilla Whip with 7-way power cord  
Part No. FS7015-PT.



**AURORA SAFETY WHIPS**

Each Vehicle Safety Whip is Canadian made in Northern Alberta. Naoka's Quality Assurance process meets Canadian Standards, Exceeds OSSA Requirements, and Redefines Industry Benchmarks for Safety Equipment.

**Aurora Whip Main Highlights:** •Unit is highly visible from a distance - vehicles equipped with the Aurora Whip will be noticed by larger equipment operators in any weather condition, day or night! •Yellow Flexible Fiberglass Rod provides added safety detection particularly in the winter months •The 24 encased amber LEDs provides 360° of light

**Additional Information:** •Naoka research and development testing facility immersed the whip in 3 ft. of water concluding that this product is watertight; reducing instances of replacement because the elements cannot penetrate Aurora Whip wiring •Methacrylate adhesive that absorbs vibration, resists impact, fatigue, thermal cycling/ extremes (-55°C to 121°C) and a tensile strength of 4,500 lbs. •9,500 psi shatterproof refractive material disperses lighting •Florescent vinyl mesh will overcome the objections from whipping such as cracking, peeling or fraying •Flame resistant, weather resistant, ultraviolet resistant, temperature stable. Flexible enough to withstand repeated impacts without breaking. •Steel Spring and Hex-base are also secured with marine grade materials to prevent water ingression •Military approved polyolefin, remains flexible to -55°C, resists diesel fuel, hydraulic fluid, lubricating oils •All wiring is well made and insulated to deal with extreme temperatures and exposure to industrial conditions

- Part No. AUR3F, 3 ft.
- Part No. AUR5F, 5 ft.
- Part No. AUR8F, 8 ft.
- Part No. AUR10F, 10 ft.

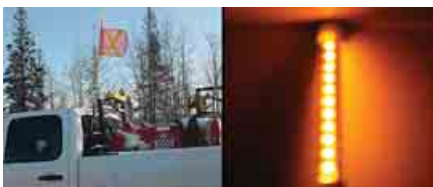



# LIFT SUPPORT



QQQ/2558/2559

## Gas Spring Lift Supports

### GAS SPRINGS

•Gas Springs are typically used for assisting in lifting a lid as well as holding it open, similar to how a hatchback on a car operates. They are also used on access covers, doors, windows, conveyors, adjustable table and seats, and more. •All gas springs contain pressurized nitrogen gas as well as hydraulic fluid that lubricates the seal and provides slam-resistant dampening at the end of the stroke. You should store and install gas springs rod-end down for longer service life. •The chart below shows universal lift supports which are not application specific,

### BLACK NITRATED "B" SERIES GAS SPRINGS

All measurements are taken from center of eye or ball stud located at 18 mm centers. The Nitrate Gas Springs come with composite end fittings.

Part No.	Extended	Compressed	Force (lbs.)
B1-0800-0250-020	8"	5.5"	20
B1-0800-0250-040	8"	5.5"	40
B1-0800-0250-060	8"	5.5"	60
B1-1000-0300-040	10"	7"	40
B1-1000-0300-060	10"	7"	60
B1-1000-0300-080	10"	7"	80
B1-1200-0300-040	12"	9"	40
B1-1200-0300-060	12"	9"	60
B1-1200-0300-080	12"	9"	80
B1-1500-0550-040	15"	9.5"	40
B1-1500-0550-060	15"	9.5"	60
B1-1500-0550-080	15"	9.5"	80
B1-1700-0675-040	17"	10.25"	40
B1-1700-0675-060	17"	10.25"	60
B1-1700-0675-080	17"	10.25"	80
B1-1950-0800-060	19.5"	11.5"	60
B1-1950-0800-080	19.5"	11.5"	80
B1-2000-0800-040	20"	12"	40
B1-2000-0800-060	20"	12"	60
B1-2000-0800-080	20"	12"	80
B3-1200-0400-030	12"	8"	30
B3-1200-0400-090	12"	8"	90
B3-1200-0400-120	12"	8"	120
B3-1500-0500-030	15"	10"	30
B3-1500-0500-090	15"	10"	90
B3-1500-0500-120	15"	10"	120
B3-1700-0600-040	17"	11"	40
B3-1700-0600-060	17"	11"	60
B3-1700-0600-090	17"	11"	90
B3-2000-0800-080	20"	12"	80
B3-2000-0800-100	20"	12"	100
B3-2000-0800-120	20"	12"	120
B3-2000-0800-150	20"	12"	150
B3-2600-1050-060	26"	15.5"	60
B3-2600-1050-090	26"	15.5"	90
B3-2600-1050-120	26"	15.5"	120
B5-2700-1175-060	27"	15.25"	60
B5-2700-1175-100	27"	15.25"	100
B5-2700-1175-120	27"	15.25"	120
B5-2700-1175-150	27"	15.25"	150
B5-2775-1000-200	27.75"	17.75"	200
B5-2800-1200-230	28"	16"	230

Rod x Tube Diameter  
 B1 - 6 x 15 mm  
 B3 - 8 x 18 mm  
 B5 - 10 x 22 mm



### BRACKETS - Steel zinc plate, 10 mm ball

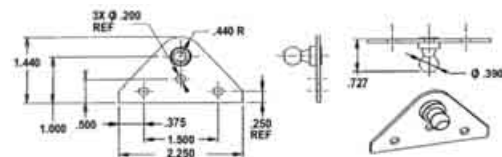

Part No. 700200Z.

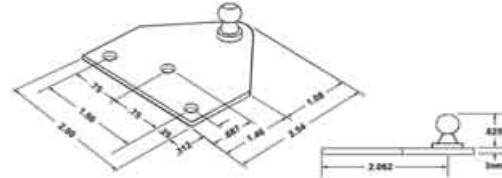

Part No. 700500Z.

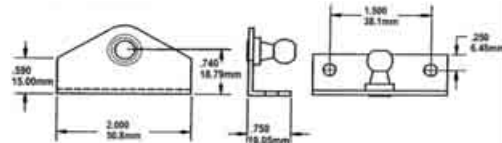

Part No. 710102Z.

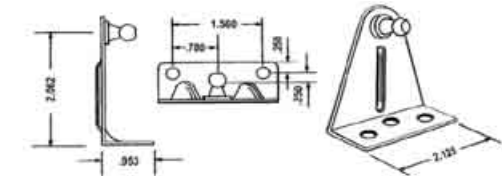

Part No. 710105Z.

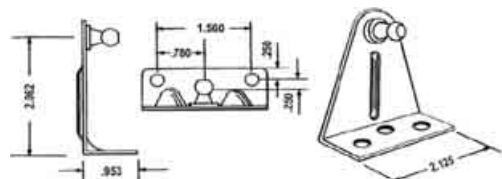

Part No. 711302Z.

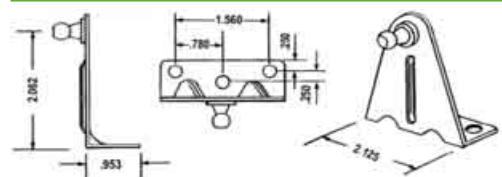

Part No. 711305Z.

### GAS SPRING HARDWARE

- Part No. 790110Z, 10 mm steel zinc stud.
- Part No. 790810Z, 10 mm steel zinc plate.
- Part No. 40302003, 6 x 1 mm end fitting 10 mm ball.
- Part No. 40302004, 8 x 1.25 mm end fitting 10 mm ball.
- Part No. 40302007, 6 x 1 mm end fitting 10 mm ball.
- Part No. 40302008, 8 x 1.25 mm end fitting 10 mm ball.
- Part No. 40303018, 6 x 1 mm blade style end fit.
- Part No. 40303002, 8 x 1.25 mm blade style end fit.
- Part No. 43303001, 6 x 1 mm end fitting.
- Part No. 43305001, 8 x 1 mm HIEM joint fit.
- Part No. 43305003, 6 x 1.25 mm HIEM joint fit.
- Part No. 43306001, 6 x 1 mm rod end fitting.
- Part No. 43306002, 8 x 1.25 mm rod end fitting.

## TEK OPTICAL

### Universal Sideshields

With patented SafetyWing™ feature. Available in single pairs or convenient packs of 10.  
 Part No. B26, 1 pair, B-26+ Wing-Mate™ sideshield; for small and medium safety frames.  
 Part No. B52, 1 pair, B-52+ Aye-Mate™ sideshield; for small, medium, and large safety frames.

### COMPLIANCE SAFEPACK™ PLUS

The CP-5226 Compliance Safepack™ Plus consists of ten (10) of the patented B-52+ Aye-Mate™ & ten (10) of the patented B-26+ Wing-Mate™ sideshields. Ideally suited to ensure proper selection of the proper sideshield/frame combination. The inclusion of both sideshields in the same package also offers the best solution to a multitude of issues created by hundreds of proprietary temple mounted sideshields and the need to be OSHA compliant. One CP-5226 Compliance Safepack™ Plus easily conquers the challenges posed by OSHA, ANSI, and all of the different frame shapes and sizes from a single dispensing pack.

Part No. CP-5226, Safepack™ Plus, contains 10 each #B26 and #B52 sideshields.

SP04-24 GREGG DISTRIBUTORS LTD.



B52



**B26+ Wing Mate.**  
 FOR SMALL AND MEDIUM SAFETY FRAMES



NNN/3725



CP-5226

**B52+ Aye Mate.**  
 FOR SMALL, MEDIUM AND LARGE SAFETY FRAMES

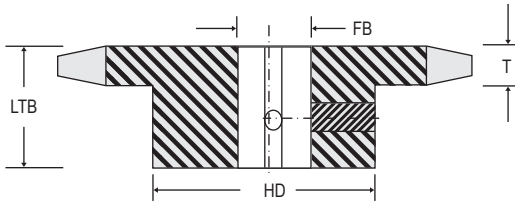

**40FB SERIES FINISHED BORE SPROCKETS**

Finished Bore Sizes Part No.				No. of Teeth	Hub Diameter	LTB	OD
1/2"	5/8"	3/4"	1"				
40FB10-050	40FB10-062	40FB10-075	—	10	1 1/4*	7/8	1.84
40FB11-050	40FB11-062	40FB11-075	—	11	1-3/8*	7/8	2.00
—	40FB12-062	40FB12-075	40FB12-100	12	1-9/16*	7/8	2.17
—	40FB13-062	40FB13-075	40FB13-100	13	1-9/16	7/8	2.33
—	40FB14-062	40FB14-075	40FB14-100	14	1-11/16	7/8	2.49
—	40FB15-062	40FB15-075	40FB15-100	15	1-13/16	7/8	2.65
—	40FB16-062	40FB16-075	40FB16-100	16	2	7/8	2.81
—	—	40FB17-075	40FB17-100	17	2-1/8	1	2.98
—	—	40FB18-075	40FB18-100	18	2-5/16	1	3.14
—	—	40FB19-075	40FB19-100	19	2 1/2	1	3.30
—	—	40FB20-075	40FB20-100	20	2-5/8	1	3.46

\*Recessed groove for chain clearance.

**50FB SERIES FINISHED BORE SPROCKETS**

Finished Bore Sizes Part No.			No. of Teeth	Hub Diameter	LTB	OD
3/4"	1"	1 1/4"				
50FB10-075	50FB10-100	—	10	1-9/16*	1	2.30
50FB11-075	50FB11-100	—	11	1 1/4*	1	2.50
50FB12-075	50FB12-100	—	12	1-63/64*	1	2.71
50FB13-075	50FB13-100	50FB13-125	13	1-7/8	1	2.91
50FB14-075	50FB14-100	50FB14-125	14	2-1/8	1	3.11
50FB15-075	50FB15-100	50FB15-125	15	2-3/8	1	3.32

\*Recessed groove for chain clearance

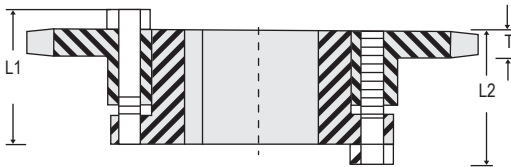

**40Q SERIES SPROCKETS**

\*Q Bushings required

Part No.	No. of Teeth	O.D.	Bushing			L1/L2	Weight (lbs.)
			No.	Min. Bore	Max. Bore		
40JA15	15	2.65	JA	1/2	1 1/4	1-1/8	0.34
40JA16	16	2.81	JA	1/2	1 1/4	1-1/8	0.40
40JA17	17	2.98	JA	1/2	1 1/4	1-1/8	0.48
40JA18	18	3.14	JA	1/2	1 1/4	1-1/8	0.54
40JA19	19	3.30	JA	1/2	1 1/4	1-1/8	0.60
40SH20	20	3.46	SH	1/2	1-5/8	1-7/16	0.76
40SH21	21	3.62	SH	1/2	1-5/8	1-7/16	0.84
40SH22	22	3.78	SH	1/2	1-5/8	1-7/16	0.92
40SH23	23	3.94	SH	1/2	1-5/8	1-7/16	1.14
40SH24	24	4.10	SH	1/2	1-5/8	1-7/16	1.22
40SH25	25	4.26	SH	1/2	1-5/8	1-7/16	1.30
40SH26	26	4.42	SH	1/2	1-5/8	1-7/16	1.44
40SH28	28	4.74	SH	1/2	1-5/8	1-7/16	1.54
40SH30	30	5.06	SH	1/2	1-5/8	1-7/16	1.72

**50Q SERIES SPROCKETS**

\*Q Bushings required

Part No.	No. of Teeth	O.D.	Bushing			L1/L2	Weight (lbs.)
			No.	Min. Bore	Max. Bore		
50JA12	12	2.71	JA	1/2	1 1/4	1-1/8	0.34
50JA13	13	2.91	JA	1/2	1 1/4	1-1/8	0.40
50JA14	14	3.11	JA	1/2	1 1/4	1-1/8	0.52
50JA15	15	3.32	JA	1/2	1 1/4	1-1/8	0.60
50JA16	16	3.52	JA	1/2	1 1/4	1-1/8	0.68
50SH17	17	3.72	SH	1/2	1-5/8	1-7/16	0.84
50SH18	18	3.92	SH	1/2	1-5/8	1-7/16	1.04
50SH19	19	4.12	SH	1/2	1-5/8	1-7/16	1.24
50SDS20	20	4.32	SDS	5/8	2	1 1/2	1.20
50SDS21	21	4.52	SDS	5/8	2	1 1/2	1.32
50SDS22	22	4.72	SDS	5/8	2	1 1/2	1.42
50SDS23	23	4.92	SDS	5/8	2	1 1/2	1.58
50SDS24	24	5.12	SDS	5/8	2	1 1/2	1.70
50SDS25	25	5.32	SDS	5/8	2	1 1/2	1.86
50SDS26	26	5.52	SDS	5/8	2	1 1/2	2.00
50SDS28	28	5.92	SDS	5/8	2	1 1/2	2.32
50SDS30	30	6.32	SDS	5/8	2	1 1/2	2.64

**Legend**

FB - Finished bore of sprocket complete with keyway and 2 set screws  
LTB - Length through bore of socket

## Sprockets

### 60Q SERIES SPROCKETS

\*Q Bushings required

Part No.	No. of Teeth	O.D.	Bushing			L1/L2	Weight (lbs.)
			No.	Min. Bore	Max. Bore		
60JA11	11	3.00	JA	1/2	1 1/4	1-1/8	0.46
60JA12	12	3.25	JA	1/2	1 1/4	1-1/8	0.60
60JA13	13	3.49	JA	1/2	1 1/4	1-1/8	0.76
60SH14	14	3.74	SH	1/2	1-5/8	1-7/16	0.88
60SH15	15	3.98	SH	1/2	1-5/8	1-7/16	1.08
60SH16	16	4.22	SH	1/2	1-5/8	1-7/16	1.26
60SDS17	17	4.46	SDS	5/8	2	1 1/2	1.38
60SDS18	18	4.70	SDS	5/8	2	1 1/2	1.56
60SDS19	19	4.95	SDS	5/8	2	1 1/2	1.76
60SDS20	20	5.19	SDS	5/8	2	1 1/2	2.00
60SDS21	21	5.43	SDS	5/8	2	1 1/2	2.20
60SDS22	22	5.67	SDS	5/8	2	1 1/2	2.44
60SDS23	23	5.91	SDS	5/8	2	1 1/2	2.70
60SDS24	24	6.15	SDS	5/8	2	1 1/2	2.94
60SDS25	25	6.39	SDS	5/8	2	1 1/2	3.24

### 80Q SERIES SPROCKETS

\*Q Bushings required

Part No.	No. of Teeth	O.D.	Bushing			L1/L2	Weight (lbs.)
			No.	Min. Bore	Max. Bore		
80SH11	11	4.01	SH	1/2	1-5/8	1-7/16	1.00
80SH12	12	4.33	SH	1/2	1-5/8	1-7/16	1.40
80SDS13	13	4.66	SDS	5/8	2	1 1/2	1.50
80SDS14	14	4.98	SDS	5/8	2	1 1/2	1.80
80SK15	15	5.30	SK	5/8	2-5/8	2-1/8	2.50
80SK16	16	5.63	SK	5/8	2-5/8	2-1/8	3.10
80SK17	17	5.95	SK	5/8	2-5/8	2-1/8	3.50
80SK18	18	6.27	SK	5/8	2-5/8	2-1/8	3.90
80SK19	19	6.59	SK	5/8	2-5/8	2-1/8	4.40

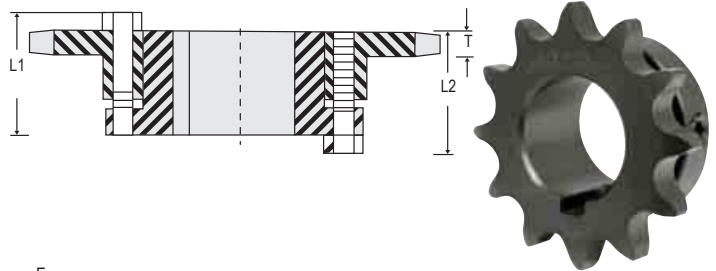

## Taper Bushings

### "Q" BUSHINGS

Bushing Sizes				Stock Bores	Keyseat Sizes
Part No.					
JA	SH	SDS	SK		
Q-JA-050	—	—	—	1/2	1/8 x 1/16
Q-JA-062	Q-SH-062	Q-SDS-062	—	5/8	3/16 x 3/32
Q-JA-075	Q-SH-075	Q-SDS-075	—	3/4	3/16 x 3/32
Q-JA-088	Q-SH-088	Q-SDS-088	—	7/8	3/16 x 3/32
Q-JA-100	Q-SH-100	Q-SDS-100	Q-SK-100	1	1/4 x 1/8
—	Q-SH-112	Q-SDS-112	Q-SK-112	1-1/8	1/4 x 1/8
—	Q-SH-118	Q-SDS-118	Q-SK-118	1-3/16	1/4 x 1/8
—	Q-SH-125	Q-SDS-125	Q-SK-125	1 1/4	1/4 x 1/8
—	Q-SH-138	Q-SDS-138	Q-SK-138	1-3/8	5/16 x 5/32
—	—	Q-SDS-143	Q-SK-143	1-7/16	3/8 x 3/16
—	—	Q-SDS-150	Q-SK-150	1 1/2	3/8 x 3/16
—	—	Q-SDS-162	Q-SK-162	1-5/8	3/8 x 3/16
—	—	—	Q-SK-168	1-11/16	3/8 x 3/16
—	—	—	Q-SK-175	1 3/4	3/8 x 3/16
—	—	—	Q-SK-188	1-7/8	1/2 x 1/4
—	—	—	Q-SK-193	1-15/16	1/2 x 1/4
—	—	—	Q-SK-200	2	1/2 x 1/4
—	—	—	Q-SK-212	2-1/8	1/2 x 1/4

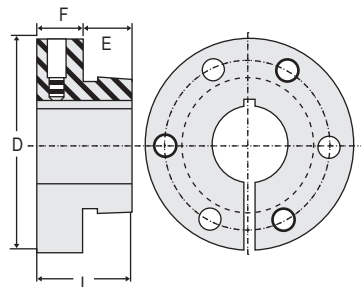

DIMENSIONS						
Bushing Size	D	L	E	F	Wrench Torque	Weight (lbs.)
JA	2	1-1/16	11/16	3/8	5	0.80
SH	2-11/16	1-5/16	7/8	7/16	9	1.00
SDS	3-3/16	1-3/8	7/8	1/2	9	1.20
SK	3-7/8	1-15/16	1-3/8	9/16	15	2.00

## Jaw Couplings

### 'L' SERIES (LOVEJOY STYLE) FLEXIBLE JAW COUPLINGS

Bore Sizes (Standard Keyways)													Dimensions		Weight	
Part No.													C	B	Min. Bore	Max. Bore
1/4"	5/16"	3/8"	1/2"	5/8"	3/4"	7/8"	1"	1-1/8"	1-1/4"	1-3/8"	1-1/2"	1-5/8"				
L050-025	L050-031	L050-038	L050-050	L050-062	—	—	—	—	—	—	—	—	15/32	1-23/32	0.3	0.2
—	—	—	L070-050	L070-062	L070-075	—	—	—	—	—	—	—	1/2	2	0.6	0.4
—	—	—	L075-050	L075-062	L075-075	L075-088	—	—	—	—	—	—	1/2	2-1/8	1.0	0.8
—	—	—	L090-050	L090-062	L090-075	L090-088	L090-100	—	—	—	—	—	1/2	2-1/8	1.5	1.2
—	—	—	L095-050	L095-062	L095-075	L095-088	L095-100	L095-112	—	—	—	—	1/2	2 1/2	1.8	1.3
—	—	—	L099-050	L099-062	L099-075	L099-088	L099-100	L099-112	—	—	—	—	3/4	2-7/8	2.5	2.0
—	—	—	L100-050	L100-062	L100-075	L100-088	L100-100	L100-112	—	—	—	—	3/4	3 1/2	3.5	2.5
—	—	—	—	L110-062	L110-075	L110-088	L110-100	L110-112	L110-125	L100-138	—	—	7/8	4 1/4	6.6	5.0
—	—	—	—	L150-062	—	—	—	—	—	—	—	—	1	4 1/2	9.1	7.0

### RUBBER (BUNA-N) INSERTS

\*Temperature Range: -40°C to 100°C

- Part No. N050, Fits L050.
- Part No. N070, Fits L070.
- Part No. N075, Fits L075.
- Part No. N090/095, Fits L090 and L095.
- Part No. N099/100, Fits L099 and L100.
- Part No. N110, Fits L110.
- Part No. N150, Fits L150.



### HYTREL® INSERTS

\*Temperature Range: -51°C to 121°C

- Part No. H050, Fits L050.
- Part No. H070, Fits L070.
- Part No. H075, Fits L075.
- Part No. H090/095, Fits L090 and L095.
- Part No. H099/100, Fits L099 and L100.
- Part No. H110, Fits L110.
- Part No. H150, Fits L150.

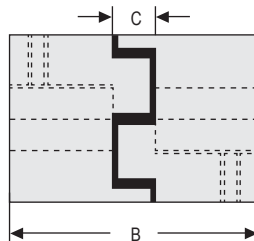





**'R-FLEX' FLEXIBLE COUPLINGS**

Bore Sizes Part No.								Coupler Dimensions				Flange Only Dimensions				
1/2"	5/8"	3/4"	7/8"	1"	1-1/8"	1 1/4"	1-3/8"	OL	OD	RD*	G(1)	OL	T	HL	OD	HD
3J-050	3J-062	3J-075	—	—	—	—	—	1-31/32	2.06	5/8	3/8	51/64	25/64	13/32	2.06	1 1/4
4J-050	4J-062	4J-075	4J-088	4J-100	—	—	—	2-11/32	2.46	5/8	5/8	55/64	7/16	27/64	2.46	1-5/8
—	5J-062	5J-075	5J-088	5J-100	5J-112	—	—	2-27/32	3.25	13/16	3/4	1-3/64	19/32	29/64	3.25	1-7/8
—	6J-062	6J-075	6J-088	6J-100	6J-112	6J-125	6J-138	3-11/32	4.00	1	7/8	1-15/64	5/8	39/64	4.00	2 1/2

\*Distance required to remove sleeve  
(1) Nominal dimensions (for reference only)

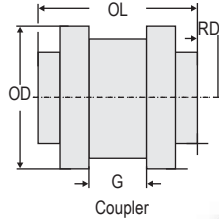
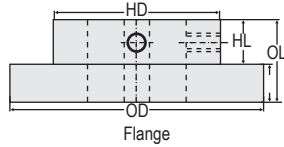

**RUBBER (EPDM) INSERTS**

- Temperature Range: -34°C to 135°C
- Part No. 3JE, Fits 3J.
- Part No. 4JE, Fits 4J.
- Part No. 5JE, Fits 5J.
- Part No. 6JE, Fits 6J.
- Part No. 7JE, Fits 7J.
- Part No. 8JE, Fits 8J.



**LINK-BELT**

Chain Repair Tools



**CHAIN BREAKERS**

Chain breakers are quality tools with forged jaws. The "push-out" pins are of tempered alloy steel. They simplify the disassembly of roller chain.  
Part No. CB3550, #35-50.  
Part No. CB60100, #60-100.



**TECHSPAN**

Deutsch Connectors

**4-WAY INDENT CRIMP TOOL**

Ratchet mechanism releases only after proper crimp force is applied assuring reliable connections every time. Locator holds contacts in place during the crimping process. This tool can also be used to crimp closed/solid barrel, screw machine pin and socket style contacts. Performs a simultaneous 4-way indent crimp for superior contact retention. Approximate length: 6 1/2". Contact Size: 22-16GA.

Part No. 76-3352EA.



**98 PC. DEUTSCH CONNECTOR ASSORTMENT KIT**

This handy assortment comes complete with 98 pieces/sets of widely used (DT-Series) Deutsch Connectors (18 types in all) in a plastic storage tray. Each part number is indexed on an affixed reference chart for easy identification and quick reorder. Dimensions: 11"W x 6"L x 1"H  
Part No. 76-3353EA.

Kit Contains:					
Reference No.	Deutsch #	Quantity	Reference No.	Deutsch #	Quantity
76-3306	0462-201-16141	10	76-3325	DT06-2S + W2S	2
76-3307	0460-202-16141	10	76-3326	DT04-3P + W3P	2
76-3308	0462-209-16141	10	76-3327	DT06-3S + W3S	2
76-3309	0460-215-16141	10	76-3328	DT04-4P + W4P	2
76-3314	1062-16-0622	10	76-3329	DT06-4S + W4S	2
76-3315	1060-16-0622	10	76-3330	DT04-6P + W6P	2
76-3316	1062-14-0122	10	76-3331	DT06-6S + W6S	2
76-3317	1060-14-0122	10	76-3332	DT04-08P + W8P	1
76-3324	DT04-2P + W2P	2	76-3333	DT06-08S + W8S	1



**HALDEX**

Piggyback Kits

**LIFE SEAL SPRING BRAKE PIGGYBACK KIT**

- Special Heat Treated Power Spring results in unsurpassed force output consistency and superior fatigue life
  - Patented Internal Check Valve; Relieves any pressure build-up in the sealed spring chamber and prevents outside air and contaminants from entering the chamber
  - Adapter Seal and Bearing; Custom design EGP guide bearing and o-ring provide a long lasting and air-tight seal
  - Save Time and Money; Piggyback kits are simple to install
- Part No. LP3030K.  
Part No. LP3030LK, Long stroke.



**GOLD SEAL SPRING BRAKE PIGGYBACK KIT**

- Superior Power Spring Technology; Advanced powder coating process; Resists corrosion and fatigue
  - Double O-ring Centerseal; Two o-rings for positive sealing and plastic bearings for long life
  - Save Time and Money; Piggyback kits are simple to install
- Part No. GP3030K.  
Part No. GP3030LK, Long stroke.



## ALBERTA

**EDMONTON - Main**  
Ph: (780) 4-GREGGS (447-3447)  
Fax: (780) 451-2528

**EDMONTON - East**  
Ph: (780) 450-2233  
Fax: (780) 450-2266

**EDMONTON - South**  
Ph: (780) 409-2000  
Fax: (780) 409-2100

**NISKU**  
Ph: (780) 979-9988  
Fax: (780) 979-9989

**ATHABASCA**  
Ph: (780) 675-3110  
Fax: (780) 675-4774

**CALGARY - Main**  
Ph: (403) 253-6463  
Fax: (403) 253-5926

**CALGARY - Foothills**  
Ph: (403) 203-1928  
Fax: (403) 236-1912

**CLAIRMONT**  
Ph: (780) 567-2238  
Fax: (780) 567-2239

**DRAYTON VALLEY**  
Ph: (780) 621-0056  
Fax: (780) 621-0057

**FAIRVIEW**  
Ph: (780) 835-5115  
Fax: (780) 835-3535

**FORT McMURRAY**  
Ph: (780) 715-4000  
Fax: (780) 743-8833

**GRANDE PRAIRIE**  
Ph: (780) 513-4000  
Fax: (780) 513-6000

**HIGH LEVEL**  
Ph: (780) 926-2521  
Fax: (780) 926-3514

**RAINBOW LAKE**  
Ph: (780) 956-2588  
Fax: (780) 956-2589

**RED DEER**  
Ph: (403) 341-3100  
Fax: (403) 341-3210

**SPIRIT RIVER**  
Ph: (780) 864-3333  
Fax: (780) 864-3330

**STRATHMORE**  
Ph: (403) 934-3710  
Fax: (403) 934-5453

## BRITISH COLUMBIA

**FORT ST. JOHN**  
Ph: (250) 785-8000  
Fax: (250) 785-8022

**LANGLEY**  
Ph: (604) 888-9588  
Fax: (604) 888-4688

**NANAIMO**  
Ph: (250) 756-0551  
Fax: (250) 756-1170

## SASKATCHEWAN

**SASKATOON**  
Ph: (306) 343-6655  
Fax: (306) 343-6656

[www.greggdistributors.ca](http://www.greggdistributors.ca)

# Proudly Canadian!