

# EUREKA

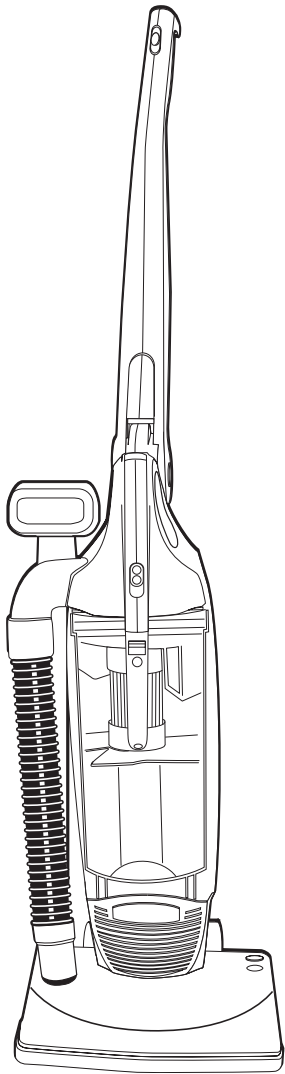

Household Type  
**Vacuum Cleaner  
Owner's Guide  
790 Series**

## Index

Important Safeguards .....	2
General Information .....	4
Use .....	5
Dust Cup .....	8
Exhaust Filter .....	10
Brush Roll .....	11
Brush Roll Belt .....	11
Warranty .....	15-16

For location of nearest  
Eureka Warranty Station  
or service information call  
**1-800-282-2886.**

[www.eureka.com](http://www.eureka.com)

# IMPORTANT SAFEGUARDS

When using an electrical appliance, basic precautions should always be followed, including the following:

**READ ALL INSTRUCTIONS BEFORE USING THIS VACUUM CLEANER.**

## WARNING

To reduce the risk of fire, electric shock, or injury:

- Do not use outdoors or on wet surfaces.
- **Do not leave vacuum cleaner when plugged in.** Turn off the switch and unplug the electrical cord when not in use and before servicing.
- Do not allow to be used as a toy. Close attention is necessary when used by or near children.
- Use only as described in this manual. Use only manufacturer's recommended attachments.
- Do not use with damaged cord or plug. If vacuum cleaner is not working as it should, has been dropped, damaged, left outdoors, or dropped into water, return it to a service center before using.
- Do not pull or carry by cord, use cord as a handle, close door on cord, or pull cord around sharp edges or corners. Do not run vacuum cleaner over cord. Keep cord away from heated surfaces.
- Do not use extension cords or outlets with inadequate current carrying capacity.
- Turn off all controls before unplugging.
- Do not unplug by pulling on cord. To unplug, grasp the plug, not the cord.
- Do not handle plug or vacuum cleaner with wet hands.
- Do not put any object into openings. Do not use with any opening blocked; keep free of dust, lint, hair, and anything that may reduce airflow.
- This vacuum cleaner creates suction and contains a revolving brush roll. Keep hair, loose clothing, fingers, and all parts of body away from openings and moving parts.
- Do not pick up anything that is burning or smoking, such as cigarettes, matches, or hot ashes.
- Do not use without dustcup and filter in place.
- Belt pulleys can become hot during normal use. To prevent burns, avoid touching the belt pulley when servicing the drive belt.
- Use extra care when cleaning on stairs.
- Do not use to pick up flammable or combustible liquids such as gasoline, or use in areas where they may be present.
- Store your cleaner indoors in a cool, dry area.
- Keep your work area well lighted.
- Unplug electrical appliances before vacuuming them.

## SAVE THESE INSTRUCTIONS

# CONSEILS DE SÉCURITÉ

Lors de l'utilisation d'un appareil électrique, quelques précautions élémentaires doivent être observées, incluant les suivantes:

**LISEZ TOUTES LES INSTRUCTIONS AVANT D'UTILISER VOTRE ASPIRATEUR.**

## AVERTISSEMENT

Pour réduire le risque de feu, de choc électrique, ou de blessure:

- Ne pas utiliser à l'extérieur ou sur des surfaces mouillées.
- **Fermez le commutateur et débranchez l'appareil lorsque vous ne l'utilisez pas ou avant le nettoyage ou l'entretien.**
- Ne permettez pas qu'il soit utilisé comme jouet. Une attention particulière est nécessaire lorsque utilisé par ou près d'un enfant.
- Suivez les recommandations d'utilisation de ce manuel. Utilisez uniquement les accessoires recommandés par le fabricant.
- Ne pas utiliser si le cordon ou la fiche sont endommagés. Si l'aspirateur ne fonctionne pas comme il le devrait, s'il a été échappé, s'il est endommagé, s'il a été laissé à l'extérieur ou échappé dans l'eau, retournez-le à un centre de service avant de utiliser.
- Ne pas le tirer ou le transporter par le cordon, ne pas utiliser le cordon en guise de poignée. Ne pas fermer une porte sur le cordon ou tirer le cordon sur des coins ou bordures pointus. Ne pas circuler sur le cordon avec l'aspirateur. Tenir le cordon à distance des surfaces chauffantes.
- Ne pas utiliser des rallonges ou des prises qui n'ont pas de capacité suffisante pour transporter le courant.
- Fermer tous les contrôles avant débrancher.
- Ne pas débrancher en tirant sur le cordon. Pour débrancher, tenez la fiche et non le cordon.
- Ne pas manipuler la fiche ou l'aspirateur avec les mains mouillées.
- Ne pas rien insérer dans les ouvertures. Ne pas utiliser si des ouvertures sont bloquées; assurez-vous qu'elles soient dégagées de poussière, mousse, cheveux ou toute autre chose qui pourrait réduire le passage de l'air.
- Cet aspirateur crée de la succion et contient un rouleau-brosse tournant. Tenir les parties mobiles et les ouvertures loin des cheveux, du linge, des doigts et de toute partie du corps.
- Ne pas ramasser des objets qui brûlent ou fument comme les cigarettes, allumettes ou cendres chaudes.
- N'utilisez pas sans le coupe de poussière de ou filtre en place.
- Les poulies du courroie peuvent devenir chaudes pendant l'utilisation normale. Pour prévenir des brûlures, évitez de touché la poulie du courroie lorsque vous réparez la courroie.
- Portez une attention particulière lorsque vous nettoyez les escaliers.
- Ne pas utiliser pour ramasser des liquides inflammables ou combustibles comme de l'essence: Ne pas utiliser dans les endroits où ces liquides pourraient être présents.
- Entrez votre aspirateur à l'intérieur dans un endroit propre et sec.
- Maintenez un bon éclairage à l'endroit où vous travaillez.
- Débrancher les appareils électrique avant de les balayer.

## CONSERVEZ CES INSTRUCTIONS

**To reduce the risk of electric shock**, this appliance has a polarized plug (one blade wider than the other). This plug will fit in a polarized outlet only one way. If the plug does not fit fully in the outlet, reverse the plug. If it still does not fit, contact a qualified electrician to install the proper outlet. Do not change the plug in any way.

**Afin de réduire le risque de choc électrique**, cet appareil est muni d'une fiche polarisée (une des lames est plus large). Cette fiche ne peut être insérée dans une prise polarisée que d'une seule façon. Si la fiche ne peut être insérée dans la prise, retourner la fiche. Si la fiche ne peut toujours pas être insérée dans la prise, faire installer une prise adéquate par un électricien qualifié. Ne pas modifier la fiche.

## GENERAL INFORMATION

The cleaner is designed to pick up dirt and dust particles. Avoid picking up hard or sharp objects with the cleaner to prevent bag tears and hose clogs.

### Service Information

The instructions in this booklet serve as a guide to routine maintenance. For additional service information telephone our toll free number for the nearest Eureka Authorized Warranty Station. **You should know the model, type and serial numbers when you call:**

**USA: 1-800-282-2886**

**Mexico: 5670-6169**

**Canada: 1-800-282-2886**

If you prefer, you can write to The Eureka Company, Service Division, 807 North Main Street, Bloomington, Illinois 61701, USA. In Canada write to The Eureka Company, 866 Langs Drive, Cambridge, Ontario N3H 2N7. Refer to The Eureka Warranty for complete service information.



**DO NOT OIL the motor or the brush roll at any time. The bearings are permanently lubricated and sealed.**

### Rating Plate

The model, type, and serial number are indicated on the rating plate located on the back of the cleaner. For prompt and complete service information, always refer to these numbers when inquiring about service.

**Model & Type** \_\_\_\_\_

**Serial No.** \_\_\_\_\_

MODEL	TYPE	SERIAL NO.
VOLTS	AMPS.	HERTZ
SERVICE INFORMATION: 1-800-282-2886		

### Thermal Cut Off

This vacuum cleaner has a special thermostat that protects the cleaner in case of motor overheating. If the cleaner suddenly shuts off, push the on/off switch off (0) and unplug the cleaner. Check the cleaner for a possible source of overheating such as a full dust cup, a blocked hose or clogged filter. If these conditions are found, fix them and wait at least 30 minutes before attempting to use the cleaner. After the 30 minute period, plug the cleaner back in and push the on/off switch on (I). If the cleaner still does not run, then take it to a Eureka Authorized Service Center for repair.

### Cleaner Care

**NOTE: Turn off the switch and unplug the electrical cord before cleaning unit.** To keep the vacuum cleaner looking new, it can be wiped with a damp cloth and a mild soap solution, then thoroughly dried. Never use any type of chemical as chemicals can damage the cleaner. When not in use, the cleaner should be stored in a clean, dry place.

## HOW TO USE

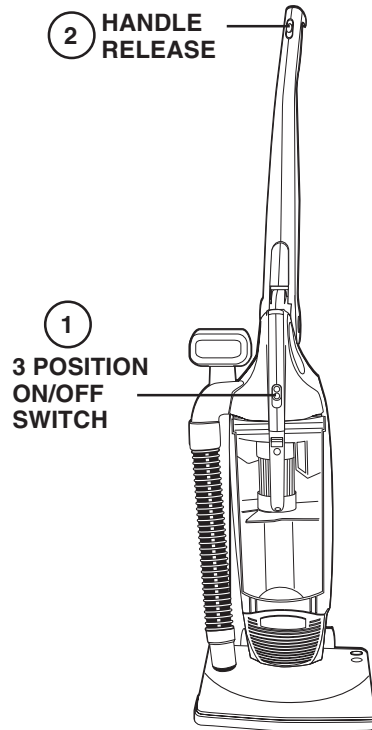

### 1 Power Switch

Top position is Off. Middle position is for floor cleaning and cleaning with accessories (brush roll does not turn). Bottom position is for cleaning carpets (brush roll turns).

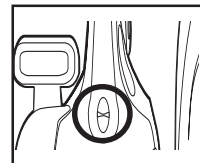

### 2 Handle Release

When handle is in collapsed position, press handle release button and rotate handle into upright position.

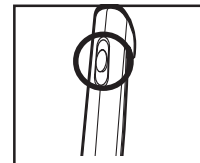

## HOW TO USE

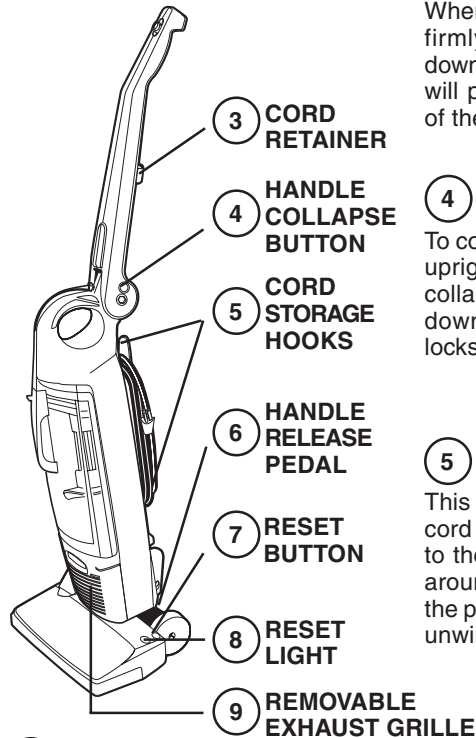

### 3 Cord Retainer

When preparing to use vacuum, firmly push the electrical cord down into the cord retainer. This will place the electrical cord out of the way while you vacuum.



### 4 Handle Collapse Button

To collapse the handle from the upright position, press handle collapse button, rotate handle down until latch in hand grip locks onto the body.

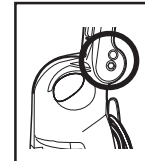

### 5 Cord Storage Hooks

This unit has two convenient cord storage hooks attached to the handle. Wind the cord around the hooks and fasten the plug to the cord to prevent unwinding.

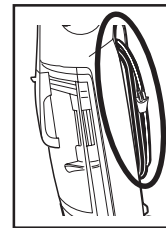

### 6 Handle Release Pedal

The handle release pedal is located next to the floor between the two wheels on the back of the cleaner. Step on the handle release pedal and pull back handle to find a comfortable operating position. Handle will automatically lock into storage position when handle is rotated into upright position.

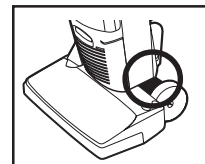

### 7 Reset Button

This unit uses a cogged, non-stretch belt. If a large object causes the brush roll to jam, the brush roll motor shuts off and the Reset Light illuminates. Turn off and unplug the unit. Check the brush roll for debris and clean if needed. Press the reset button, plug in the unit and turn on to continue cleaning.

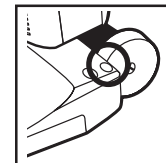

### 8 Reset Light

The reset light is a neon light that illuminates when the brush roll jams. See reset button above for actions to take when this light comes on.

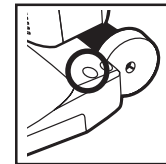

### 9 Removable Exhaust Grille

Remove this exhaust grille to clean or replace filter. Refer to page 9.

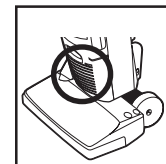

## HOW TO USE ACCESSORIES

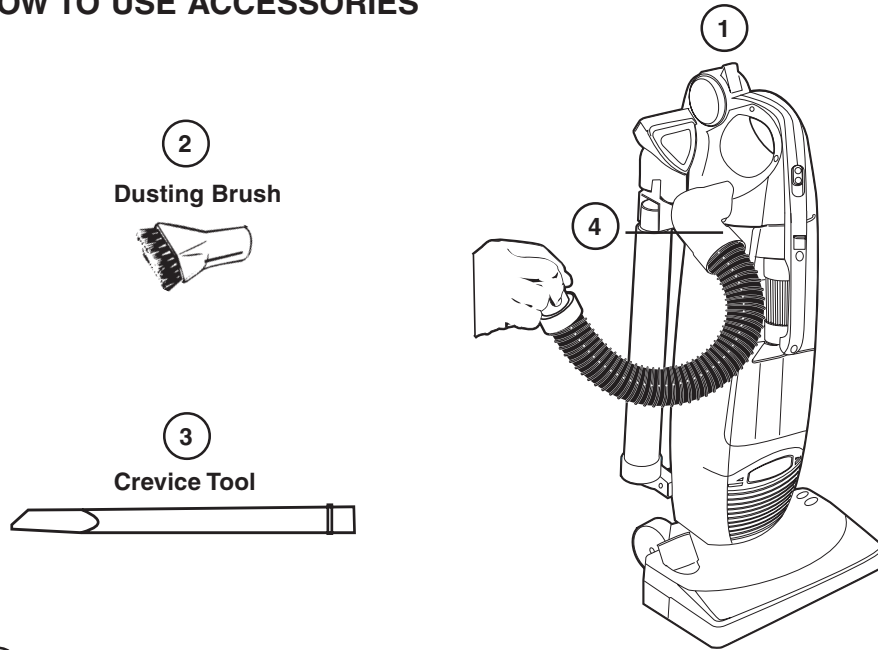

① Collapse the handle from the upright position. Press handle release button and rotate handle down and against the body of the cleaner until it locks onto the body.

② The dusting brush fits on both the hose and the wand with a built-in crevice tool. Use the dusting brush to dust furniture, blinds, books, lamps, shelves.

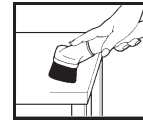

③ The crevice tool cleans corners, base boards, between cushions.

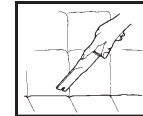

④ **To connect** the hose, align notch on top of elbow with arrow on main body to reconnect. Hose elbow rotates for easy use of the hose and attachments.

**To disconnect** the hose for inspection of blockages, align notch on top of elbow with arrow on main body. Check for blockages and clear if necessary.

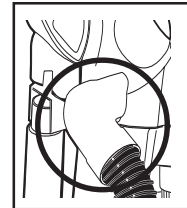

## HOW TO MAINTAIN

### How to Empty Dust Cup

**NOTE:** Turn off the switch and unplug the electrical cord before servicing the cleaner. Never operate the vacuum cleaner without the dust cup or filter.

**FOR INSTRUCTIONS ON HOW TO REMOVE THE DUST CUP FROM THE CLEANER BODY, REFER TO PAGE 8.**

### Emptying the Dust Cup:

It is clearly visible when the dust cup is full and needs emptying. Remove dust cup from cleaner body. Remove dust cup lid from dust cup by grasping lid handles and lifting up. (See below.) Then dump debris in a waste container.

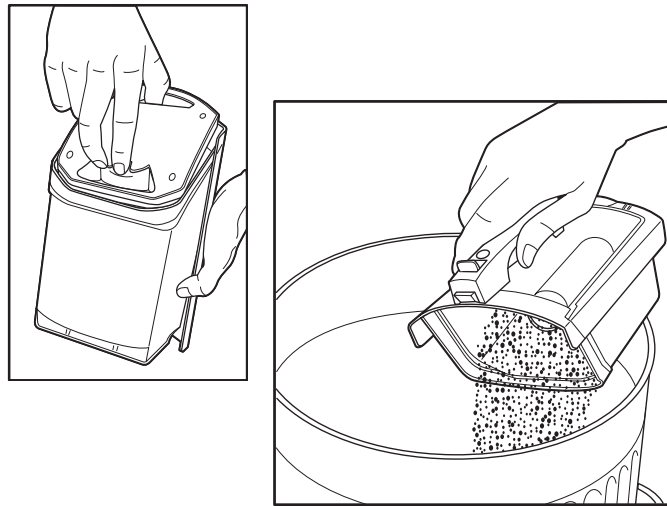

### Reinstalling the Dust Cup:

Grasp the dust cup lid by the lid handles and sit back on top of dust cup. It will fit only one way. To replace the dust cup, put bottom of dust cup in place by aligning tabs in slots and pivoting dust cup up against the cleaner body. Lift up on dust cup latch to secure in place (a).

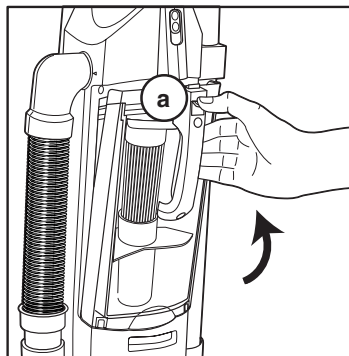



## HOW TO MAINTAIN (continued)

The instructions given in this booklet serve as a guide to routine maintenance. To avoid unnecessary service calls, check the dust cup, filter, belt, and brush roll often. Empty the dust cup if it is full; clean the filter, replace the belt if it is stretched or cracked, and clean the brush roll bristles if they are wrapped with thread and hair.

### To Change Dust Cup Pleated Filter

**NOTE:** Turn off the switch and unplug the electrical cord before changing the pleated filter. Never operate the vacuum cleaner without the dust cup or the pleated filter.

**HINT:** When cleaning new carpet for the first time, cup will fill quickly. Check often.

Remove the dust cup by pressing down on the dust cup latch (a) and pulling dust cup away from cleaner body. When replacing the dust cup put bottom of dust cup in place by aligning tabs in slots and pivot dust cup up against the cleaner body. Lift up on dust cup latch to secure in place.

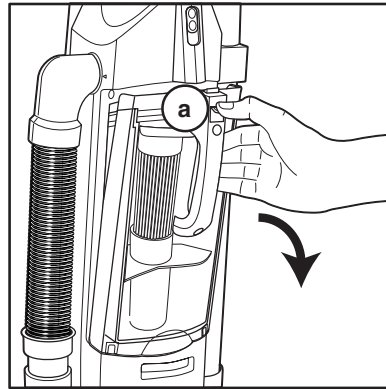

**Check and clean the Pleated Filter once a month to maintain good performance. The filter can be cleaned by washing with mild detergent and warm water. Be sure pleated filter is completely dry before reinstalling.**

### To Clean the Pleated Filter:

1. Remove dust cup from cleaner body. See above illustration (a).
2. Remove dust cup lid by grasping lid handles and lifting up.
3. To release the pleated filter from dust cup lid, press latch in the bottom lid handle. Pull pleated filter away from dust cup lid.
4. To remove debris, tap filter against waste container or brush off. You may also vacuum the filter using a different cleaner. If filter needs further cleaning, wash in warm water using a mild detergent. To clean between filter pleats, fan open under running water.
5. **When all parts are completely dry**, reattach pleated filter to dust cup lid and follow the above steps in reverse to reassemble.

**NOTE:** Do not put any parts in a dishwasher.

**NOTE:** Your dust cup filter may need to be replaced if cleaning it does not restore cleaning performance.

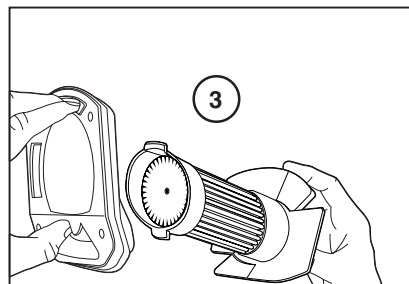

## HOW TO MAINTAIN (continued)

**NOTE:** Turn off the switch and unplug the electrical cord before servicing the cleaner. Never operate the vacuum cleaner without the dust cup or filter in place.

### FILTER

The filters should be checked at each emptying of dust cup. If the filters are dirty, clean or replace for maximum performance of your cleaner.

### Exhaust Filter

The exhaust filter is located behind the dust filter grille below the dust cup compartment.

Remove the dust cup. (The dust cup has to be removed first to enable removal of exhaust grille.) Lift up on exhaust grille handle to remove. The filter is attached to the back of the grille. If the exhaust filter is dirty, remove and clean or replace with a new filter.

To clean the exhaust filter, brush the debris off into a trash bin or vacuum with another vacuum cleaner.

To replace the exhaust filter, tuck the bottom of the filter behind the two filter retainers at the bottom of the exhaust grille. Then place the top of the filter behind the two filter retainers at the top of the grille. Press the filter down on narrow pegs in the center of the grille. Replace the grille on the cleaner and replace the dust cup.

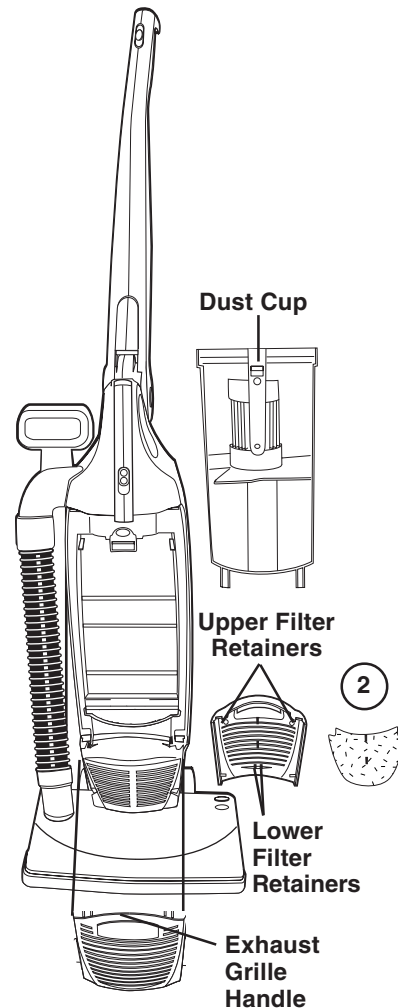

Look for the **GENUINE** symbol.  
EUREKA PRODUCT

## HOW TO MAINTAIN (continued)

**NOTE:** Turn off the switch and unplug the electrical cord before servicing the cleaner.

### REPLACE BRUSH ROLL BELT

① Remove the 10 screws on the bottom of the power nozzle. Flip the power nozzle back upright and remove the hood.

**NOTE:** The reset button cover (circled) is spring loaded so it may become displaced when you remove the hood. Keep track of reset button and spring.

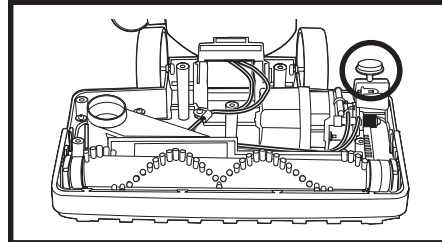

② Remove broken brush roll belt. Pinch new brush roll belt together and position new belt so teeth engage cog pulley on end of motor shaft.

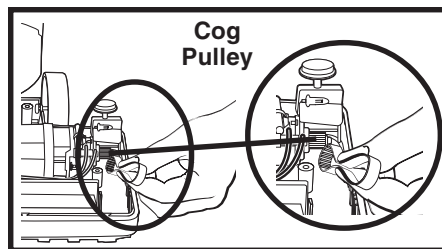

③ Place the other end of belt around brush roll. Align left end of brush roll into the base by rotating slightly until brush roll end cap slides into place.

Secure right end of brush roll into base.

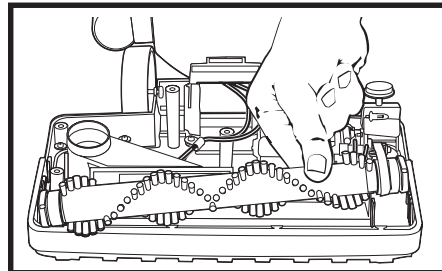

④ The brush roll belt is now installed.

⑤ **Make sure the reset button cover (circled) is in position on spring.** Replace hood. Hold body and power nozzle, turn over so bottom of power nozzle is facing up. Replace screws.

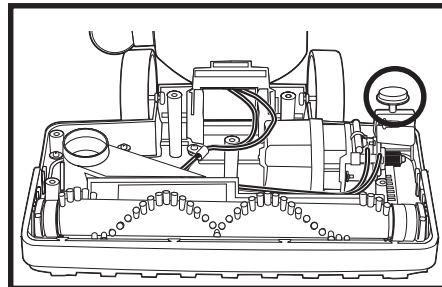

### Brush Roll

As the brush roll rotates, it sweeps and combs the carpet nap. Remove hair and threads from the brush roll so it continues brushing the carpet nap. Check brush roll occasionally for hair or string that may have wrapped around dowel. Remove with scissors.

When bristles have worn to about 1/4" in length, carpet cleaning effectiveness will be reduced. It is time to replace the brush roll. Follow the instructions in the brush roll belt section to open up the power nozzle and replace the brush roll.



The Eureka Company  
P.O. Box 2799  
Bloomington, IL 61702-2799

4/03

# ORDER FORM

(Not applicable in Canada)

S	Name		
O	Address (street address needed for UPS)		
L	City	State	Zip
D	Telephone (Day)	(Eve)	(Fax)
T			
O			

**To Order**



**By Phone**  
1-800-438-7352\*  
HOURS:  
Call between 8 a.m.  
and 4:45 p.m.,  
central standard time  
Monday through Friday.

**By FAX**  
1-309-823-5789  
\*En Mexico llame al  
5670-6169

**By Mail**

Simply fill out this  
Order Form.  
Please be sure to  
include day  
and evening  
phone numbers.

**ON-LINE**  
[www.eureka.com](http://www.eureka.com)

## Genuine Eureka Parts

	Part No.	Qty.	Price (USD)	Total
Disposable Bag (Style SL) - pkg of 3	61125		3.49	
Belt	61121		2.39	
Motor Filter	61123		1.49	
Exhaust Filter	61124		1.99	
Dust Cup Filter	61975		9.99	
Brush Roll	61128-1		17.49	
Hose Assembly	61129-1		16.49	
Dusting Brush	61126		1.99	
Nested Wands	61127		3.99	
<b>Total</b> (prices subject to change without notice)				
<b>Tax</b> (add state and local taxes as required by law)				
<b>Postage and Handling Charge</b> (Within the U.S.A.)				<b>\$5.50</b>
<b>TOTAL ENCLOSED</b>				

To Answer Problems or Questions for U.S.A. and Canada call:

**1-800-282-2886\***

8 a.m. - 7:30 p.m. (CST) Monday - Friday and 10 a.m. - 6:30 p.m. (CST) Saturday

*Method of Payment (No C.O.D.s)*

Check or money order (payable to The Eureka Company). Do not send currency.

Visa (16 digits)  DiscoverCard (15 digits)  MasterCard (13 digits)  American Express (15 digits)

Acct. number \_\_\_\_\_

Expiration date \_\_\_\_\_

Signature (Full name as shown on account) \_\_\_\_\_

# THE EUREKA LIMITED WARRANTY

## **What This Warranty Covers**

Your Eureka cleaner is warranted to be free from all defects in material and workmanship in normal household use for a period of one year. The warranty is granted only to the original purchaser and members of his or her immediate household. The warranty is subject to the following provisions.

## **What This Warranty Does Not Cover**

- Parts of the cleaner that require replacement under normal use, such as disposable dust bags, filters, drive belts, brush roll bristles, impellers and cleaning.
- Damages or malfunctions caused by negligence, abuse, or use not in accordance with the Owner's Guide.
- Defects or damages caused by unauthorized service or the use of other than Genuine Eureka parts.

## **What The Eureka Company Will Do**

The Eureka Company will, at its option, repair or replace a defective cleaner or cleaner part that is covered by this warranty. As a matter of warranty policy, the Eureka Company will not refund the consumer's purchase price.

## **Warranty Registration**

Please fill out and return the warranty registration card accompanying your cleaner.

## **Obtaining Warranty Service**

To obtain warranty service you must return the defective cleaner or cleaner part along with proof of purchase to any Eureka Authorized Warranty Station. You will find the nearest location in the Yellow Pages, under "Vacuum Cleaners—Service and Repair." Be certain that the Warranty Station is "Eureka Authorized." For the location of the nearest Eureka Authorized Warranty Station or for service information, telephone toll free:

**USA: 1-800-282-2886**

**Mexico: 5670-6169**

**Canada: 1-800-282-2886**

If you prefer, you can write to The Eureka Company, Service Division, 807 North Main Street, Bloomington, Illinois 61701, USA. In Canada write to The Eureka Company, 866 Langs Drive, Cambridge, Ontario N3H 2N7.

If it is necessary to ship the cleaner outside your community to obtain warranty repair, you must pay the shipping charges to the Eureka Authorized Warranty Station. Return shipping charges will be paid by the Warranty Station. When returning parts for repair, please include the model, type, and serial numbers from the data plate on the cleaner.

## *Further Limitations and Exclusions*

Any warranty that may be implied in connection with your purchase or use of the cleaner, including any warranty of Merchantability or any warranty for Fitness For A Particular Purpose is limited to the duration of this warranty. Some states do not allow limitations on how long an implied warranty lasts, so the above limitations may not apply to you.

Your relief for the breach of this warranty is limited to the relief expressly provided above. In no event shall Eureka be liable for any consequential or incidental damages you may incur in connection with your purchase or use of the cleaner. Some states do not allow the exclusion or limitation of incidental or consequential damages, so the above limitation or exclusion may not apply to you.

This warranty gives you specific legal rights. You may also have other rights which vary by state.



## *Questions & Answers about Genuine Eureka Products*

- Q:** Why should I use only Genuine Eureka paper bags, belts, and parts in my Eureka vacuum cleaner?  
**A:** Using Genuine Eureka Products, which are made to our exacting specifications and engineered with emphasis on quality, performance, and customer satisfaction, ensures the long life and cleaning efficiency of your vacuum cleaner. Overall, this saves you money and helps to keep your home clean.
- Q:** How can I be sure I am using only genuine Eureka products in my vacuum cleaner?  
**A:** Typically, packaged products and paper bags can be identified by a "Genuine Eureka Product" symbol (see illustration above). For further identification assistance, you may call our toll-free number, 1-800-282-2886, for the location of a nearby Eureka Authorized Warranty Station.
- Q:** Are there any differences between "made to fit" or "imitation" and Genuine Eureka paper bags, belts, and parts?  
**A:** Yes, there are some very important differences in materials, quality, and reliability. Many customers have mistakenly purchased "imitation" paper bags and parts while thinking they purchased genuine. Unfortunately, many of these customers discovered the differences after they experienced related difficulties.

**For Genuine Eureka Value, Accept No Imitations!  
THE EUREKA COMPANY**

Bloomington, Illinois 61701

Household Warranty  
abs 190