



## ***Operator's Manual***

user manual, maintenance instructions and spare parts  
***261L/U, 331L/U Brushcutter***



Read this manual carefully before operating the machine  
Original Instructions Version July 12

## Component Location

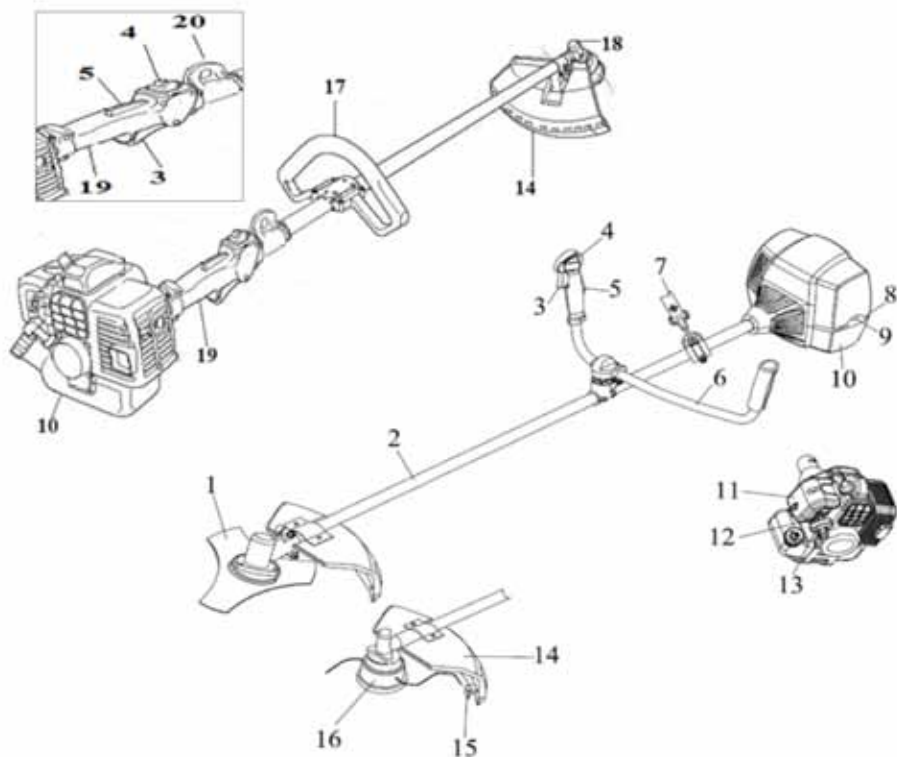

## PRODUCT DESCRIPTION

This Brush Cutter is a 2 stroke fast running power tool and is designed to be used in a domestic application for trimming grass and light brush.

## Component Location

1	BLADE	3 Point blade for grass, weed or brush cutting applications.
2	DRIVE SHAFT	Contains the drive shaft.
3	THROTTLE TRIGGER	Spring loaded to return to idle when released.
4	IGNITION SWITCH	Slide switch, forward to run, back to stop.
5	SAFETY LEVER	Prevents accidental operation of the throttle.
6	HANDLE	This handle can be adjusted for maximum comfort
7	HARNESS ASSEMBLY	Fully adjustable for maximum comfort
8	PETROL CAP	
9	PURGE BULB	Push the purge bulb to remove the air from the fuel system.
10	FUEL TANK	Contains fuel and fuel filter.
11	AIR CLEANER	Contains replaceable filter.
12	CHOKE	To help in cold starting.
13	STARTER HANDLE	Pull to start the engine.
14	DEBRIS SHIELD	Helps protect the operator from debris.
15	CUT-OFF KNIFE	Cuts the nylon line to the correct length.
16	NYLON CUTTER HEAD	Contains replaceable nylon trimming line.
17	FRONT HANDLE	This handle can be adjusted for maximum comfort.
18	GEARBOX	For attaching a blade or nylon head to.
19	REAR HANDLE	Incorporating throttle trigger, switch, and safety lever.
20	HARNESS FIXING POINT	Fixing point to attach the harness.
21	BLADE COVER	Blade cover for transportation.

## Warnings in the Manual



This mark indicates instructions which must be followed in order to prevent accidents which could lead to serious bodily injury or death.





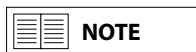







This mark indicates instructions which must be followed or it leads to mechanical failure, breakdown, or damage.



This mark indicates hints or useful directions in the use of the product.

## Safety Symbols

Warning: Danger, Caution	
Read the documentation and safety instructions which are provided in this user manual.	
When operating this machine, use protective equipment such as goggles, helmet and ear defenders.	
Wear security shoes and gloves.	
Beware: Keep hands and feet away from moving parts. Always keep a safe distance from the cutting parts.	
Hot surface: Risk of burn.	
Danger: Risk of intoxication.	
Danger: Risk of fire or explosion	
Directive 2000-14/CE. Guaranteed noise levels	
Beware of objects being thrown from the operating zone	
Warning: Keep all people, animals and vulnerable objects at least 15 metres from the working area.	

## Taking Care of Warning Labels

Always keep warning labels clean and free of scratches, which might make them illegible or difficult to read. If the warning labels provided with your brush cutter become damaged, peel off, or otherwise become illegible or difficult to read, order new labels from the authorised servicing dealer and replace the damaged labels. When applying new labels, first wipe away any dirt and dry the surface before applying the new label in the same place as the original label.

## Explanation of Symbols on the Machine

**For safe operation and maintenance, symbols are carved in relief on the machine:-**



### FUEL TANK

Fuel tank 2 stroke mix  
Position: Fuel cap



### CHOKE OPERATION

Starting mode when the engine is hot (choke off).  
Position: Air cleaner cover.



Starting mode when the engine is cold (choke on).  
Position: Air cleaner cover.

## **Safety Precautions**

### **Introduction**

Read this Owner/Operator Manual carefully. Be sure you understand how to operate this brush cutter properly before you use it. Failure to do so could result in serious injury.

Keep this manual handy so that you may refer to it later whenever any questions arise. Also note that you are able to contact the dealer from whom you purchased the product for assistance.

Always include this manual when selling, lending, or otherwise transferring the ownership of this product.

This product has been designed to be used as a Brush Cutter power tool as described previously and it should never be used for any other purpose; doing so could result in unforeseen accidents and injuries occurring. Only approved Mitox accessories should be used with this product.

This Brush Cutter is equipped with extremely sharp blades, always wear sturdy gloves when handling the blades and fit the safety guards when not in use.

When using this brush cutter for the first time, take the brush cutter to a wide, clear, open space, start the engine, and practice handling the brush cutter until you are sure that you will be able to handle it properly in actual operation.

You should never use this brush cutter when under the influence of alcohol, suffering from exhaustion or lack of sleep, suffering from drowsiness as a result of having taken medicine, or at any other time when your judgement might be impaired or that you might not be able to operate the brush cutter properly and in a safe manner.

Never allow children or anyone unable to fully understand the directions given in this manual to use this brush cutter

When planning your work schedule, allow plenty of time to perform the work and allow plenty of time for rest. Limit the amount of time you continuously use the brush cutter to 30~40 minutes per session and take 10~20 minutes of rest between work sessions. Also, try to keep the total amount of work performed in a single day to 2 hours.

Never run the engine indoors as the exhaust gases contain harmful carbon monoxide.

## **Never use the brush cutter in conditions as described below:**

When the ground is slippery or when other conditions exist which might make it difficult to maintain a steady posture while using the brush cutter.

At night, at times of heavy fog, or at any other times when your field of vision is limited and it would be difficult to gain a clear view of the area where the brush cutter is to be used. In heavy rain, during lightning storms, at times of strong or gale-force winds, or at any other times when weather conditions might make it unsafe to use this product.

Lack of sleep, tiredness, or physical exhaustion results in lower attention spans, and this in turn can lead to accidents and injury.

## **Work Clothing and Safety Equipment**

When using the product, you should wear proper clothing and protective equipment.

- Helmet
- Protection goggles or face protector
- Ear protectors
- Thick work gloves
- Non-slip sole work boots
- When using your brush cutter, always wear strong, durable, work clothing; shirts should be long-sleeved and trousers should be full-length.

## **Safety and Operation**



This brush cutter is equipped with a very sharp blade, and when used incorrectly the blades can be extremely dangerous.

Improper handling can cause accidents which may in turn lead to serious injury or death. For this reason, you should always be careful to adhere to the following instructions when using your brush cutter

Never hold the brush cutter in a way in which the cutting head is pointing towards someone else.

Never allow the blades to come into contact with your body.

Always turn off the engine before adjusting the brush cutter, or at any time when coming into close proximity with the cutting head.

Always wear thick work gloves when adjusting the brush cutter.

## Safe Handling of Fuel



The engine of the brush cutter is designed to run on a two stroke oil/fuel mixture.

This fuel is highly flammable, never store cans of fuel or refill the fuel tank in any place where there is a source of heat or fire, which might ignite the fuel.

Do not smoke whilst operating the brush cutter or refilling, keep lit cigarettes away from the brush cutter at all times.

When refilling the fuel tank always stop the engine first and carefully make sure that there are no sparks or naked flames anywhere nearby before refuelling.

If any fuel spillage occurs during refuelling, use a dry rag to wipe any fuel which has been spilled onto the brush cutter before starting the engine.

After refuelling, screw the fuel cap back tightly onto the fuel tank and carry the brush cutter to a spot 5 metres or more away from where it was refuelled before starting the engine.

## **Before Operating the Brush cutter**

Before beginning work, carefully check the work area and remove any obstacles. Within a perimeter of 15 metres of the work area should be considered a hazardous area into which no-one should enter while the brush cutter is being used, and when necessary this area should be marked with a warning rope, warning signs, or other forms of warning.

When work is to be performed simultaneously by two or more operators, care should also be taken to constantly look around to check the presence and locations of other operators within the work area to maintain a safe distance between each operator.

Before beginning work, each component of the brush cutter should be checked to make sure that it is in proper working order, make sure that there are no loose screws or bolts, fuel leaks, ruptures, dents, broken guards or any other problems which might interfere with safe operation.

Keep all parts of your body away from the cutting head when the engine is running.

## **Before Starting the Engine**

Carefully check the work area to make sure that no obstacles exist within a perimeter of 15 metres around the brush cutter before starting the engine.

To start the engine, place the brush cutter onto the ground in a flat clear area and hold it firmly in place to ensure that neither the cutting head nor the throttle come into contact with any obstacles when the engine starts.

After starting the engine, make sure that the cutting head stops moving when the throttle trigger is released (idle). If the cutting head continues to move when the engine is at idle, adjust the idle screw on the carburettor to a point where the cutting head stops moving, if this cannot be achieved, take the brush cutter to your authorised service dealer for adjustment.

## Avoid Noise Problems

Check and follow the local regulations for sound levels and hours of operation for garden machinery.

In general, operate brush cutters between 8 am and 5 pm on weekdays and 9 am to 5 pm at weekends.

Avoid using the brush cutter late at night and/or early in the morning.

## Safety when using the Brush cutter

When using the brush cutter, grip the handles firmly with both hands, place your feet slightly apart so your weight is distributed evenly across both legs, and always maintain a steady even posture while working.

- Maintain full engine speed when cutting.
- Never allow other persons to come within the work area as doing so might expose them to danger.
- Keep work area clear of all persons, particularly small children and pets. Injury may result from flying debris.
- If grass or other objects get caught in the brush cutter during operation, always stop the engine before removing the object.
- Never touch the spark plug or plug HT cable while the engine is in operation, doing so may result in an electrical shock.
- Never touch the exhaust, spark plug, or any metallic parts while the engine is in operation or immediately after shutting down the engine. These parts reach high temperatures during operation and doing so could result in serious burns.
- When you finish cutting in one location and wish to continue work in another area, stop the engine.
- Always remove fuel from the fuel tank before transportation to prevent fuel spillage.
- Never leave the brush cutter exposed to direct sunlight as this can heat the fuel tank and may cause a discharge of fuel, and flood the engine.
- Be careful not to hit the nylon cutting head against stones or the ground.



## Two-Stroke Fuel



Fuel is very flammable. Do not smoke or bring any flame or sparks near fuel.

Always stop the engine and allow it to cool before refuelling.

Refuel outdoors on bare ground, restart engine at least 5m away from the refuelling stop.

The engine is lubricated by oil mixed into petrol. Prepare a mixture of unleaded petrol and semi-synthetic two-stroke oil that meets the specifications of: API TC, ISO-L-EGC, JASO FC (Low Smoke) oil.

### **Recommended mixing ratio is 40:1.**

**FUEL WITH NO OIL (RAW PETROL) will cause severe damage to the engine which is not covered by manufacturer's warranty.**

Use fresh, unleaded petrol (95 RON) and semi-synthetic oil specially made for high performance two-stroke engines. Mix in a ratio of 40 parts petrol to 1 part of oil.

By using two-stroke oil specially made for two-stroke engines you will reduce the formation of ash and carbon deposits on the spark plug, piston, exhaust muffler and cylinder as well as reducing emissions of harmful exhaust gases.

Oil FOR 4-CYCLE ENGINES should not be used as two-stroke lubrication oil as it can cause fouling of the spark plug, exhaust port blocking, piston ring sticking and other internal engine damage.

## Fuel Storage

Mixed two-stroke fuel which has been left unused for a period of one month or more may damage the carburettor and result in the engine failing to start or operate correctly.

When storing the brush cutter for a period of more than one month, empty the fuel tank, and run the engine to empty the carburettor of fuel.

Two stroke fuel can cause deterioration of rubber and/or plastic components during prolonged storage.

It is important to only use good quality, fresh fuel mix.

## Fuelling

Shake the fuel container to thoroughly mix the two-stroke oil and petrol.

Clean dirt from around the fuel cap before removing.

Pour two-stroke fuel into the fuel tank with a filtered funnel, up to 80% of the fuel tanks capacity.

Replace the fuel cap and tighten securely. Spilled fuel must be wiped away from the hedge trimmer before starting the engine.

Move at least 5m away from the refuelling area before restarting the engine.



When refilling the tank, always turn off the engine and allow it to cool down. Take a careful look around to make sure that there are no sparks or open flames anywhere nearby before refuelling.

## Assembly of the Brush Cutter



The blade fitted to the guard is sharp and can cause injury, always wear gloves.

### Installing the Guard

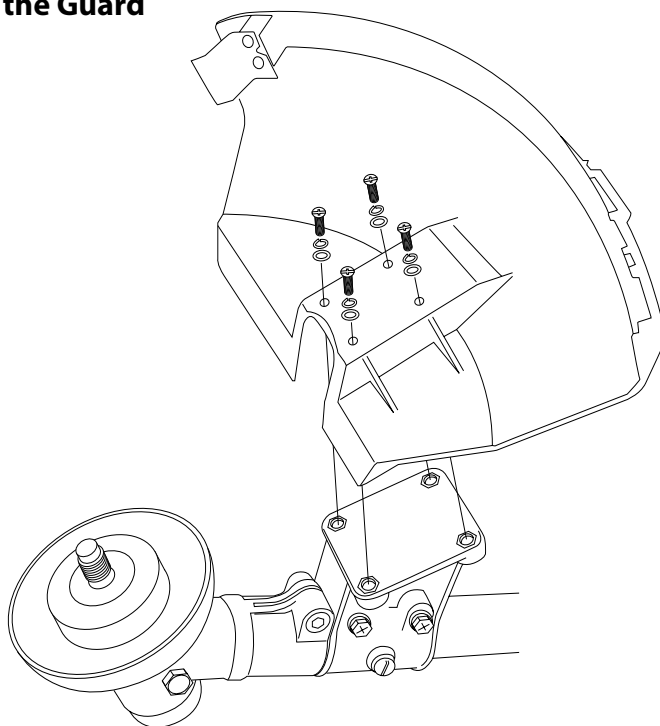

- Lay the brush cutter on its back with the gearbox shaft facing up.
- Line up the 4 screw holes in the guard with the bracket on the shaft.
- Insert 4 screws through the guard into the captive nuts in the bracket and tighten.

## Installing the Loop Handle Assembly (L models)

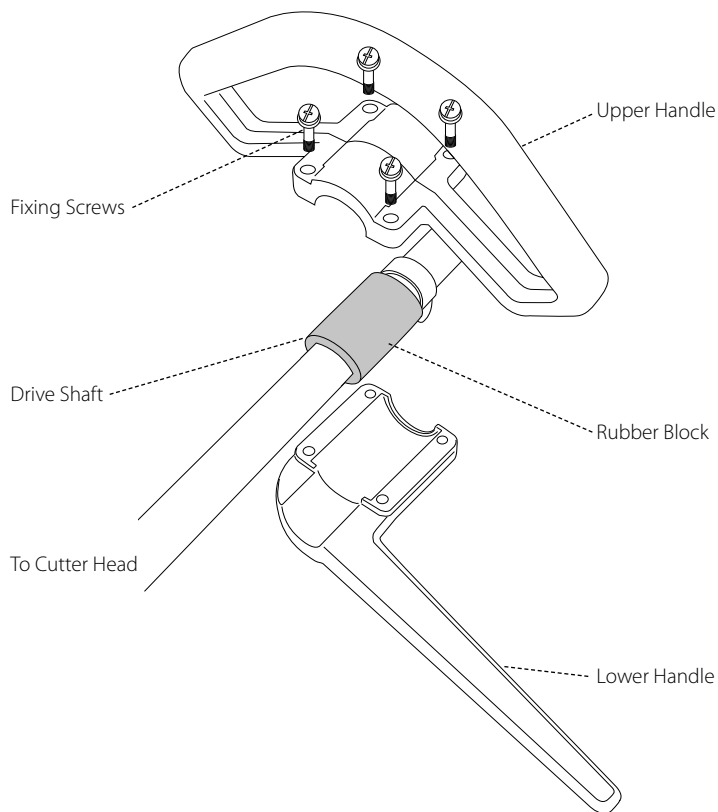

- Fix the loop-handle to the shaft over the rubber block provided. Adjust to a comfortable working position then tighten the fixing screws securely.

## Installing the Bike Handle Assembly (U models)

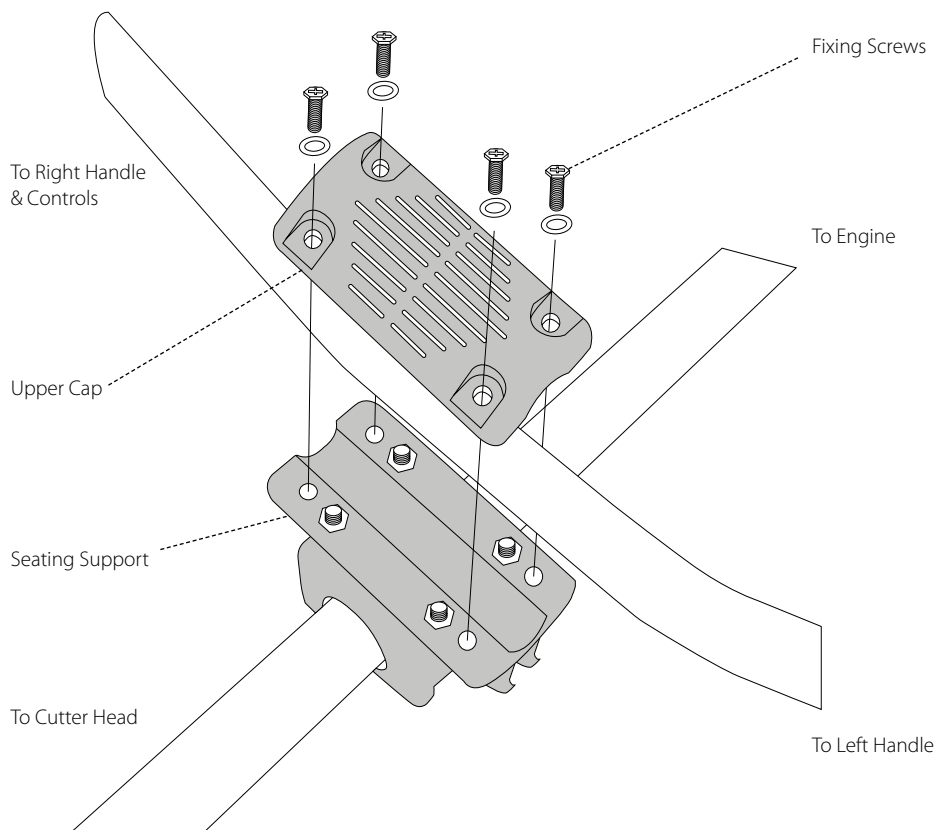

- Remove the upper cap from the bracket by undoing the 4 screws.
- Install the handle assembly into the seating support, upper cap and secure using the 4 screws making sure that the controls are located on the right and adjust the handle for maximum comfort before securing.

## Installing the 3 Tooth Blade

- Lay the brush cutter on its back with the gearbox shaft facing up.

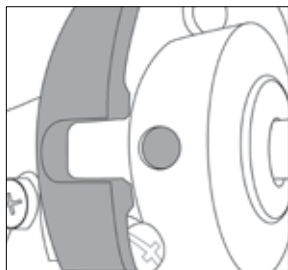

Rotate the gear box shaft until the hole in the holder lines up with the slot in the plastic guard.

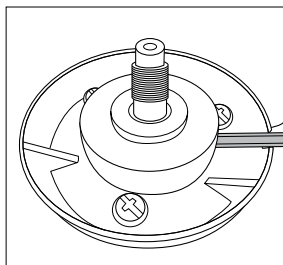

Insert the Allen key into the hole in the gear-box cover and into holder A.

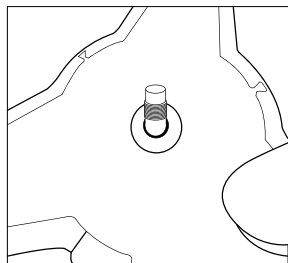

Place the 3 tooth blade on the holder A, centring the blade on the raised centre.

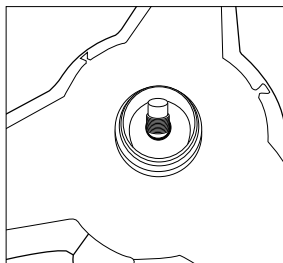

Fit the holder B and then the washer.

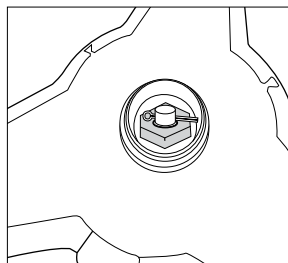

Screw the nut anti-clockwise (turn left) and tighten using the spanner provided. Fit split pin. Remove the Allen key.



**THE BLADE MUST BE CORRECTLY POSITIONED ON THE UPPER BLADE CLAMP OTHERWISE SERIOUS DAMAGE AND INJURY TO PERSONS AND PROPERTY COULD RESULT.**

## Installing the Nylon Head

- Lay the brush cutter on its back with the gearbox shaft facing up.

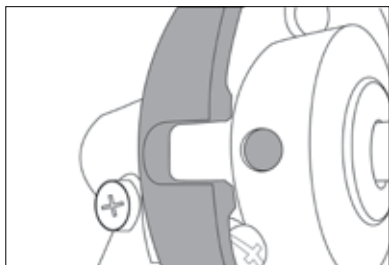

Rotate the gear box shaft until the hole in the holder lines up with the slot in the plastic guard.

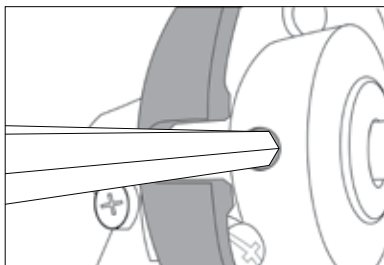

Insert the Allen key into the hole in the gearbox cover and into holder.

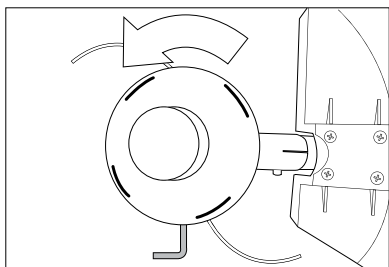

Screw the nylon head anti-clockwise (turn left) onto the threaded shaft on the end of the gearbox.

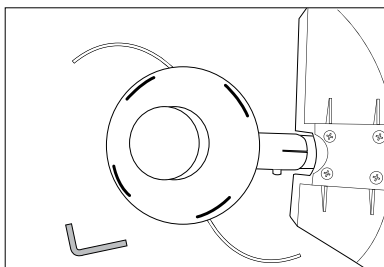

Make sure that the nylon head is securely locked in position and remove the Allen key.

## Using the Brush Cutter

### Choosing the cutting device

Choose the most suitable cutting device for the job to be done, according to these general indications:

- The cutting line head can eliminate tall grass and non-woody vegetation
- The 3-point blade is suitable for cutting brushwood and small shrubs up to 2 cm in diameter.

### Nylon Head

- Cut the grass in 1.5 metre widths, keeping the machine well balanced.
- Avoid engaging stones, piles of earth, small pieces of wood or anything that could be hidden or difficult to see in the grass. If a large object is accidentally struck, if the cutting head gets blocked, overloaded or stringy material gets wrapped in the cutting head, reduce the engine speed so the engine idles. Make sure that the cutting head has stopped rotating switch off the engine and remove the material.
- Put the brush cutter on the ground and check that the cutting head has not been damaged. If necessary, change the cutting head. If the head is only wrapped by vegetation, remove by hand and clean the cutting head.
- Always wear safety gloves for this operation and ensure the engine is switched off and the head is stationary.
- When the 2 nylon cords become too short, accelerate the engine and bump the nylon head on the ground. Automatically the 2 nylon cords will feed out and be cut to the correct length. Repeat the operation if necessary.

### **3-Point Blade**

- Start cutting above the undergrowth and then move down with the blade so as to cut the brush into small pieces.
- Avoid hitting stones, piles of earth, small pieces of wood or anything that could be hidden or difficult to see in the grass.

## Operation - L models



### WARNING

Keep clear of the blades as they may start moving when engine starts.

## Starting the Engine

**CAUTION** do not pull the starter cord all the way out and do not let go of the starter handle when the cord is extended, this can damage the starter mechanism.

## Cold Engine Starting - L models (see page 22 for U models)

Rest the unit on a flat, firm surface. Keep the cutting head off the ground and clear of surrounding objects as it may start moving when starting the engine.

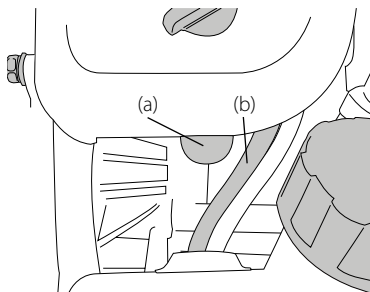

Fig 1 - Push the air purge bulb (a) until fuel is visible in the clear return fuel line (b).

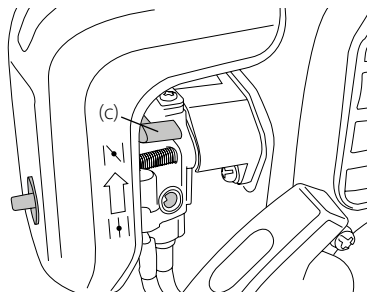
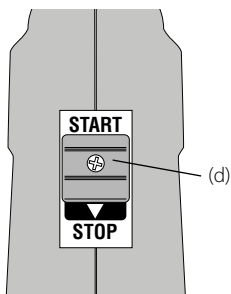
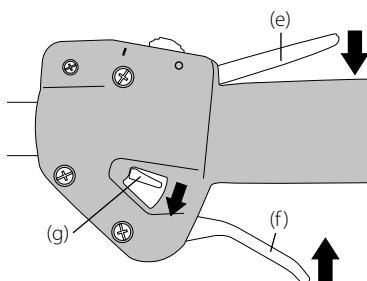



Fig 2 - Move the choke lever (c) to the closed position.



Set the ignition switch (d) to the START (I) position.



Hold the safety lever (e) down and squeeze the throttle control lever (f), push down the fast idle control (g).

- While holding the unit, pull out the starter rope firmly until engine fires (indicated by a 'cough' from the engine).
- Move the choke lever to the open position. 
- Pull the starter rope until the engine starts, then squeeze the throttle briefly to release the fast idle control and return the engine to idle.
- Allow the engine to warm up before use. When cutting, always use the brush cutter on full throttle.

## Hot Engine Starting

- Set the ignition switch to the RUN ( I ) position.
- Hold the safety lever down, and squeeze the throttle control lever. Push down and hold the fast idle control, then release the throttle control and release your hand.
- Pull the starter rope until the engine starts, then squeeze the throttle briefly to release the fast idle control and return the engine to idle.
- If the engine does not start after 5 pulls, use the cold start procedure.



### NOTE

## Overchoking

Should the engine become flooded due to overchoking, turn the ignition switch off, unscrew the spark plug, wipe it dry or replace.

## Stopping the Engine

Set the engine to idling by releasing the throttle lever.

Set the ignition switch to the off position "O" (STOP).

If the engine fails to stop, set the choke lever to the closed position to stall the engine; do not use the machine until the ignition switch is repaired.

## Operation - U models



### WARNING

Keep clear of the blades as they may start moving when engine starts.

## Starting the Engine

CAUTION do not pull the starter cord all the way out and do not let go of the starter handle when the cord is extended, this can damage the starter mechanism.

### Cold Engine Starting - U models (see page 20 for U models)

Rest the unit on a flat, firm surface. Keep the cutting head off the ground and clear of surrounding objects as it may start moving when starting the engine.

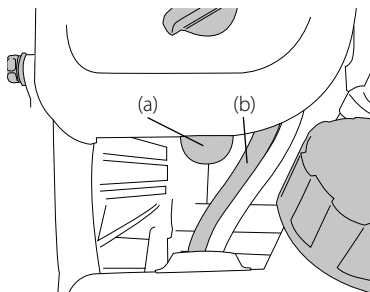

Fig 1 - Push the air purge bulb (a) until fuel is visible in the clear return fuel line (b).

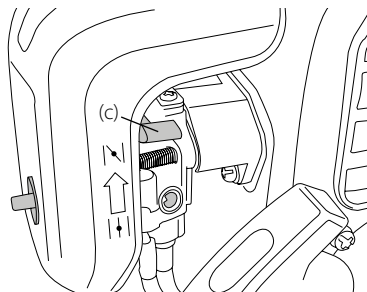
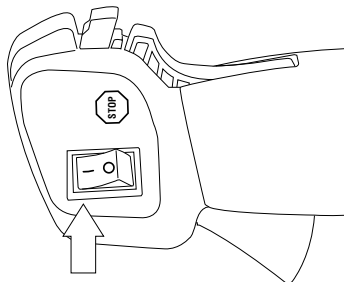
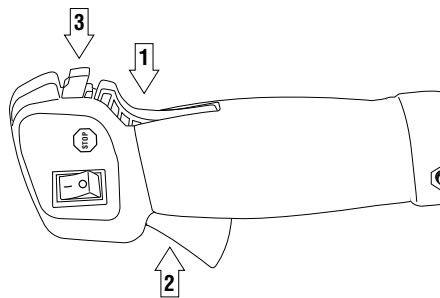



Fig 2 - Move the choke lever (c) to the closed position.



Set the ignition switch (d) to the START (I) position.



Hold the safety lever down, and squeeze the throttle control lever. Push down and hold the fast idle control, then release the throttle control and release your hand.

- While holding the unit, pull out the starter rope firmly until engine fires (indicated by a 'cough' from the engine).
- Move the choke lever to the open position. 
- Pull the starter rope until the engine starts, then squeeze the throttle briefly to release the fast idle control and return the engine to idle.
- Allow the engine to warm up before use. When cutting, always use the brush cutter on full throttle.

## Hot Engine Starting

- Set the ignition switch to the RUN ( I ) position.
- Hold the safety lever down, and squeeze the throttle control lever. Push down and hold the fast idle control, then release the throttle control and release your hand.
- Pull the starter rope until the engine starts, then squeeze the throttle briefly to release the fast idle control and return the engine to idle.
- If the engine does not start after 5 pulls, use the cold start procedure.



### NOTE

## Overchoking

Should the engine become flooded due to overchoking, turn the ignition switch off, unscrew the spark plug, wipe it dry or replace.

## Stopping the Engine

Set the engine to idling by releasing the throttle lever.

Set the ignition switch to the off position "O" (STOP).

If the engine fails to stop, set the choke lever to the closed position to stall the engine; do not use the machine until the ignition switch is repaired.

## Running In

During the first ten hours of work, avoid running the engine at maximum speed for a prolonged period until all the components have bedded in, after the engine has been run in, it will reach its maximum power.

## Transportation

Never transport the brush cutter with the engine running. An engine that is running could be accidentally accelerated causing the blade to engage.

Make sure the blade safety guards are in place when transporting the brush cutter.

When carrying by hand, the cutting head should be pointing backwards.

Ensure the Brush cutter is secure when transporting in a vehicle and the tank is drained of fuel.

## Maintenance

### IMPORTANT

After every use, check that all nuts, bolts and screws are securely fastened and tighten if necessary.

In the event of an accident, breakdown or blockage, ensure the engine is turned off before any work is carried out to rectify this.

Make sure the engine has stopped and is cool before performing any service to the machine. Contact with moving cutting head or hot muffler may result in a personal injury.

### Fuel Filter

Every 15 hours of operation, using a wire hook, take the fuel filter from the fuel tank and clean or replace with a new fuel filter.

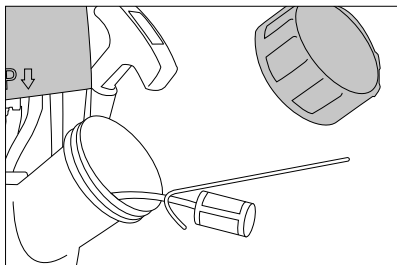

## Spark Plug

Poor starting or misfiring is often caused by a fouled or defective spark plug, clean and reset the gap to 0.65 mm, or replace the spark plug with NGK: BPRM7A as necessary.

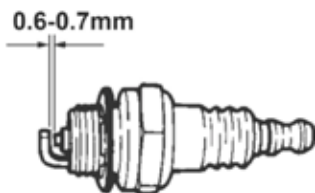

## Air Filter

Before using the brush cutter, check the air filter (a). Being clogged, will reduce the engine performance. Remove the air filter cover by undoing the cover screw clean the filter element in warm, soapy water, dry completely before installing. If the element is broken or shrunk, replace with a new one.

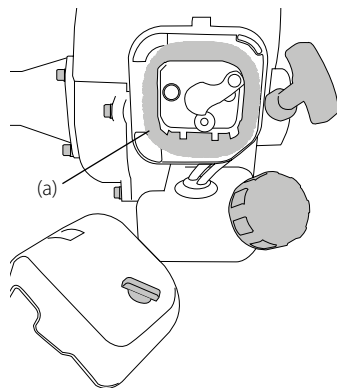

## Carburettor

The carburettor mixture setting has been set at the factory and will not need adjusting.

Adjusting the idle speed.. If adjustment is necessary turn the T screw (b) clock wise until the blades start to move, then turn the screw T anticlockwise until the blades stop.

**If the idle speed cannot be adjusted to stop the cutting head moving at idle, contact your dealer for repair before use.**

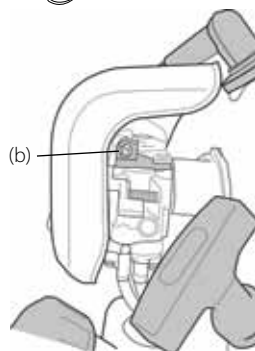

## Safety Lock

The safety lock is to prevent the throttle lever from accidentally being engaged. The throttle lever (c) can only be pressed in if the safety lock (d) is held down. Check if the safety lock and throttle lever returns to its original position and the engine returns to idling when you release your hand from the handle.

**Any defects contact your nearest service agent for repairs before using the machine.**

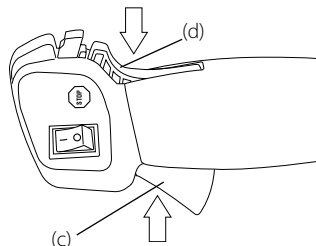

## Storage

- Remove the spark plug; pour a small amount of oil into the cylinder. Rotate the crankshaft several times using the starting rope in order to distribute the oil. Put the spark plug back in.
- Remove the fuel from the machine.

## Gear Case

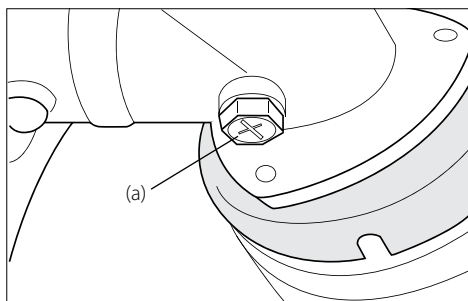

- Remove the bolt (a) on the gear case, top up the gearbox using Lithium grease and refit the bolt.

## Transportation

- Never transport the Brush cutter with the engine running. An engine that is running could be accidentally accelerated causing the blade to engage.
- Make sure the blade safety guards are in place when transporting the Brush cutter.
- When carrying by hand, the cutting head should be pointing backwards.
- Ensure the Brush cutter is secure when transporting in a vehicle and the tank is drained of fuel.

## Replacing the Nylon Cord

Check to see if the nylon head is damaged before replacing the cord. If you can see serious traces of wear or damage, you must replace the complete nylon head.

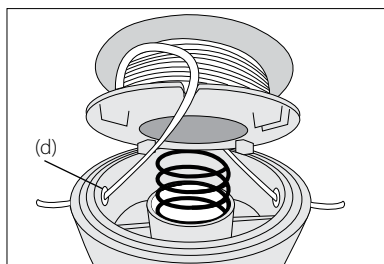
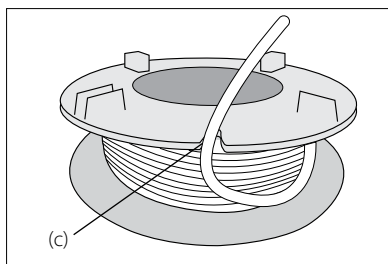
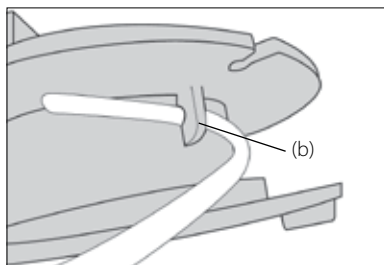
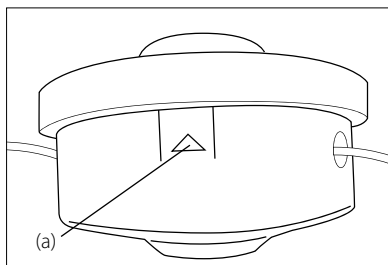

1. Stop the engine
2. Open the nylon head by pushing on the catch, (a), and twisting the cover anti-clock wise.
3. Pull the bobbin out of the nylon head and take out the rest of the nylon cords.
4. Cut the cords, 2.4mm Ø and 5 meters long into two equal lengths.
5. Make a loop folded at one end of each of the two nylon cords and insert these into the two holes provided on the bobbin, (b). Wind the lines clockwise maintaining an even and firm tension onto the bobbin, being careful not to twist the line.
6. After winding the cord, insert both ends into the notches on the bobbin, (c).
7. Introduce each end of the cords into the holes provided (d). The cords should stick out appx 15 cm either side.
8. Pull the cords to free them from the notches and refit the spool cover.

Never use a cutting device other than those supplied by the manufacturer. (Steel cord is never allowed)  
Always use original spare parts in order to benefit from continuous warranty.

## Troubleshooting

### Engine will not start, power loss:

- Check that the fuel tank is not empty. Fill with mixed fuel.
- The fuel does not reach the carburettor. Change the fuel filter in the fuel tank.
- There is water in the fuel. Drain and clean the fuel system.
- The air filter is dirty. Clean or replace the air filter.
- There are carbon deposits in the exhaust muffler restricting the engine. Clean or change the muffler.
- Spark plug is worn. Replace spark plug.

**Service Schedule**

Component	Procedure	Before use	Every 15 Hours	Every 25 Hours	Every 50 Hours	Note
Fuel leaks / spillage	Wipe up					
Fuel tank, filter	Inspect / clean		X			Replace if necessary
Idle adjust screw	See above	X		X		Adjust carburettor if necessary
Spark plug BPMR7A	Clean and readjust plug gap		X			GAP .025" (0.6-0.7mm) Replace, if necessary
Cylinder fins, Intake air cooling vent	Clean		X			
Muffler, Spark arrestor, cylinder exhaust port	Clean				X	
Throttle lever, ignition switch	Check operation	X				
Air filter	Clean	X				
Screws, nuts, bolts	Tighten / replace	X				Not adjustment screws
Grease the gear box	Check		X			

## Specifications

MODEL MITOX 261			
Engine		Type	Air cooled 2-stroke petrol engine
		Model	IE34F-2E
		Displacement : ( cm3)	25.4 cc
		Max. output	0.7 (kw) in accordance with ISO 8893
		Idle speed: rpm (min -1)	2800±150
		Max. power speed: rpm (min -1)	9800
		Fuel tank capacity	0.65L
		Fuel	Mixture (Petrol 40 : Oil 1)
		Carburettor	Diaphragm type
		Spark Plug	NGK-R BPMR7A
Transmission			Centrifugal clutch, spur gear, cam-crank
Fixation hole diameter: (mm)			25.4
Dry Weight w/o harness & gasoline			6.2 kg
Overall size (LxWxH)			1800mmx380mmx250mm
Reduction ratio			22 :17
Cutting head	Cutting width	3 teeth blade	255mm
		Nylon head	415mm
	3 teeth blade thickness		1.4mm
	Cutting line diameter		2.5mm
	Max. blade rotation speed:		7500 rpm (min -1)
	Rotation direction		Counter Clockwise(as seen from above)

## Specifications

MODEL MITOX 261			
Engine	Type		Air cooled 2-stroke petrol engine
	Model		IE36F-2E
	Displacement : ( cm3)		32.6 cc
	Max. output		0.9 (kw) in accordance with ISO 8893
	Idle speed: rpm (min –1)		2800±150
	Max. power speed: rpm (min –1)		10200
	Fuel tank capacity		1 L
	Fuel		Mixture (Petrol 40 : Oil 1)
	Carburettor		Diaphragm type
	Spark Plug		NGK-R BPMR7A
Transmission			Centrifugal clutch, spur gear, cam-crank
Fixation hole diameter: (mm)			25.4
Dry Weight w/o harness & gasoline			7.5kg
Overall size (LxWxH)			1800mmx630mmx390mm
Reduction ratio			22 :17
Cutting head	Cutting width	3 teeth blade	255mm
		Nylon head	415mm
	3 teeth blade thickness		2.8mm
	Cutting line diameter		2.5mm
	Max. blade rotation speed:		7800 rpm (min –1)
	Rotation direction		Counter Clockwise(as seen from above)

## **CONDITIONS OF WARRANTY**

The manufacturer warrants the product against faulty materials and workmanship for a period of 2 years from the date of first purchase. The warranty is applicable when the product is used in a "home owner" application. If products are used for commercial or professional purposes, the warranty period is for 3 months from the date of first purchase. Warranty does not extend to failure due to fair wear and tear.

The manufacturer undertakes to replace, any spare parts that are classified as defective by an appointed Mitox service dealer. The manufacturer will not accept liability for the replacement of the machine, either partially or wholly, and /or consequential damages and /or interest charges either directly or indirectly.

Warranty does not cover failure due to:

Insufficient maintenance.

Incorrect fuel mixture and stale fuel.

Abnormal use or accidental damage.

Incorrect assembly, adjustment or operation of the product.

Spare parts that are subject to wear e.g. safety parts, blades, blade supports, bearings, cables, guards, deflectors, spark plugs, air filters etc.

Neither does warranty extend to:

Freight and packing costs.

Use of non-genuine spare parts i.e. those from another manufacturer.

Use of the machine for any other purpose than that for which it was designed.

Use and maintenance of the machine in a manner not described in the owner's manual.

As part of our policy of continuous product improvement, we reserve the right to alter or amend this specification without notice. As a result, the product may differ from the information contained herein but any alteration will only be implemented without notice if it is classified as an improvement to the above specification.

## **READ THE MANUAL CAREFULLY BEFORE OPERATING THE MACHINE**

When ordering spare parts, please quote the part number, this can be found in the parts list included in this manual.

Retain the receipt of purchase without which no warranty can be offered.

Distributed by Mitox Garden Machinery

Wincanton Business Park

Wincanton

Somerset

BA9 9RS