



DVR009 User Manual

Please read this manual carefully before using the Digital Video Recorder

Preface

Precautions

General precautions

- Do not expose this product to dusty, dirty or sandy areas to reduce the risk of damaging components.
- Do not expose the recorder to high temperature. High temperature may shorten the life span of this electronic device.
- Do not situate the recorder under cold environment. When the product is preheated to its correct temperature, there will be moisture inside and damage the circuit.
- Do not try to disassemble or repair by yourself. Doing so may lead to electric shock from the internal high-pressure components.
- Do not drop or punch the recorder. Otherwise the internal components will be damaged.
- Do not clean the recorder with chemicals, cleaning solution or high concentration detergent. Please wipe it with slightly damp soft cloth.

Operational condition

- According to the design, the camcorder should be operated within the temperature range from 0 degree to 40 degree (32°F to 104°F)
- Do not operate or expose the camcorder under following condition:
 - Direct sunlight area
 - High temperature or dusty area
 - Near air conditioner or heaters or any other extreme temperature area
 - Violent vibration area

1 Brief Introduction of the Recorder

The features and functions are introduced in this chapter. In addition, PC system requirement, list of items and description of the hardware components are included.

1.1 PC System Requirements

The PC system needs to meet the following requirements:

- Windows Vista/XP/7 >operating system
- Intel Pentium 4 2.8GHz CPU or above (recommended 3GHz)
- At least 512 MB RAM or above (recommended 1GB)
- Standard USB2.0 port or above
- At least 64MB video card or above

1.2 Recorder appearance and feature icons

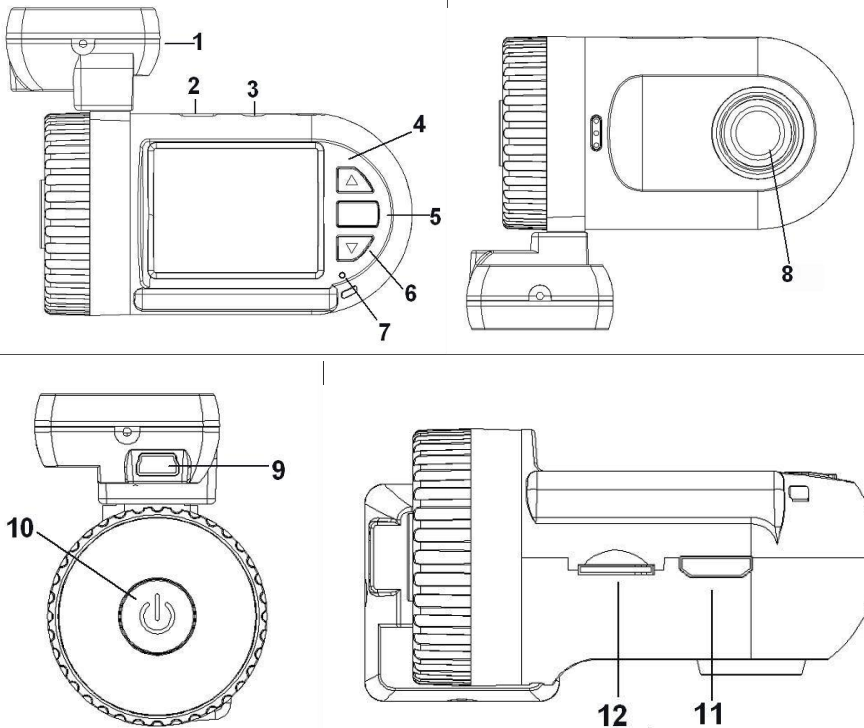

1. GPS tracker box is also a bracket .3M sticker adheres when installing to the surface.
- 2.USB port 3. AV port 4.Up button/menu/mute button
5. OK 6. Down /SOS button 7. Light indicator 8.Lens
- 9.USB power input
10. Power on/off/reset (Long press resets the unit)
- 11.HDMI port 12.TFslot

Installation

The dvr can be fitted to any flat surface but is recommended installation of the dvr is at the top of the windscreen, to give you the best field of view.

Do not install gps to tinted strips or metallic components, this may block gps signal.

Remove the 3m backing and stick the dvr onto your surface and plug the usb jack into the port on the gps and the adaptor plug into the cigarette lighter socket.

Operation

Read this chapter to know how to operate the recorder.

2.1 Inserting a TF card

Inserting a TF card into the recorder provides space to store videos, images or other files.

Please use high-speed TF card meeting the specification of TFHC. (CLASS 4 or above, Class 10 may cause

some problem because the speed of the card is too fast, it is better not to use class 10 card)

2.2 Turning on your recorder

Press Power button to turn the power on/off. Or connect to the car charger ,it will turn on when the car starts .

2.3 Take a picture

Taking a still picture

1. On recording , Long press "OK" button and take a picture
2. On stand by ,Long press "OK" button and take a picture

2.4 Reviewing the pictures

1. Long press "Down" button and into Movie reviewing ,then long press "Down" button again and then you can review the pictures.
2. Then long press "up" button for picture settings : delete file/ protect file/auto play/copy to another card/ choose card
3. Press "OK" button to confirm.
4. Long press "Down" button to go back

2.5 Before using

Before using the recorder, it is necessary to do some basic settings such as Date and Time, Language and Beep Tone .etc

2.5.1 Setting Date and Time

Power on the camcorder. Press Menu (Long press up button) ,then press up and down button to choose Date and Time and press OK button to confirm .

2.5.2 Setting Language

Power on the camcorder. Press Menu (Long press up button) ,then press up and down button to choose language and press OK button to confirm .

2.5.3 Loop setting

Off/1minutes/3minutes/5minutes

1. On / off mode,

a. The device will not auto re-write if this setting is OFF and will just record video until the card is full and then stop, it is always better to choose 1-3-5 minute option.

maximum length of each recorded video file is 3.66G. When it reaches the maximum, the recording is automatically split and saved as another file.

2. When the loop setting mode is "1 min", "3min", "5min"

- a. Power on , the device will record automatically
- b. if the space is full, the previous saved file will be automatically overwrite.

2.5.4 Setting other features

Read this chapter to know how to configure the setup and fine-tune the functions

Power on the recorder. Press Menu (Long time press up button) ,then press up and down button to choose the icons and press OK button to confirm .

- 1.Video resolution :FULL HD ,1080P30 ,720P30
- 2.Photo size: 12M,8M,5M,3M
- 3.Flicker :50/60Hz Use this function to set the flicker frequency in your area. (uk 50hz)
- 4.AE ISO :AUTO/100/200/400
- 5.White Balance

This item is for correction in different colors under different light conditions. When the white balance is set as Auto, the camcorder compensates different light conditions automatically.

AUTO/Sunny/Incandescent/fluorescent/cloudy

- 6.AE bias
- 7.AE meter mode
- 8 TV type :NTSC/PAL
- 9.AUTO power off
- 10..Date time display: Date time/off/date/time
- 11.Motion detect: off/on
13. Power off screen : off/1minutes/3 minutes/5minutes
14. Video recorder mode: Video + audio / video
15. G-sensor precision: 2.5G/3G/3.5G/4G/4.5G/5G/CLOSE
16. Beep sound: High/low/off
17. USB Mode: Mass storage/USB camera
18. Choose card : Inner card/outer card (this function is optional)
19. Language :English/Russian/Chinese
20. Default setting : Yes/No

This function will restore all the settings to the factory defaults.

21. Format: Yes/no
Use this function to Format the storage medium. Note that all the data stored in the medium will be gone.
- 23.Firmware version

2.5.5 Stamp :Date time/time /date/car/driver number/off

a.When you choose date & time and car ,the driver number will not be shown on the screen.

Under car mode ,it will display the location latitude and longitude after connect to GPS

b.When you choose date time and driver number , the GPS information will not be shown on the screen.

C. Driver number is 9 character driver number, license plate

2.5.6 GPS: Open/close

GPS tracking

1. Plug in the GPS module to the DVR, satellite searching will start automatically .
2. When GPS signal is located,  will be showed on the display .
3. When taking picture in Camera mode , location will be recorded automatically

2.6 Review/playing your video files

1. Long press "Down" button and into Movie reviewing to display the latest video files on the LCD screen .
2. Then long press "up" button takes you to the video menu : delete file/ protect file/auto play/copy to another card/ choose card
3. Press "OK" button to confirm.
4. Long press "Down" button twice to get back to other mode

2.7 Connecting PC

Connect the DVR to computer with USB cable included. (Effective under recording settings off)

2.8 Connecting the DVR to Standard TV .(Effective with AV-OUT function)

Connect your recorder and Standard TV via Accessory AV cables.

2.9 Connecting the DVR to HDTV

When connecting to HDTV, you can use high resolution to display video files or pictures.

Use HDMI cable to connect the camcorder video or audio signal to HDTV.

Attention:

When connected to HDTV, shuttering, recording and taping are not available!



3.0 Recording Mode



This mode is for recording a video or taking picture file. The files are saved into TF card.

3.1 icon meanings

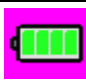
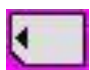
Record Mode:

About the indication of each icon and symbol, see the table below.

	Video Mode		Battery
	TF Card		Motion Detection
V:-----	Car speed monitor after GPS		White Balance Auto, Tungsten, Fluorescent, Daylight, Cloudy indicator .
FULL HD	Resolution	2008/01/01	Date and Time

		01: 07AM	
	Segmented recording time	loop	 GPS

3.2 Playback mode

Using Play back mode to display all the video files saved in the DVR .

see the table below

000:00:15	Playback time		Play
	Battery		Pause

3.3 USB mode

You can use USB mode to connect with the host PC.(Effective under recording settings off)

When the recorder is connected with the host PC, it appears as a removable disk in the Windows explorer.

4. Protection

4.1 When reviewing the video,

1. Long press "Down" button and into Movie reviewing to display the latest video files on the LCD screen .
2. Then long press "up" button you can protect files, protect one file or all ,etc .The file with  are protected.
3. Press "OK" button to confirm.
4. Long press "Down" button twice to get back to other mode

Attention: To unlock the files, repeat the steps above.

Appendix

Specification

Image Sensor	1/25" 2M/ 5M CMOS
Chip	Ambarella ,A2S60 1080 P 30FPS
Lens	135 Wide angle
External memory	Built-in TF card (up to 32 G)

Internal memory	Built-in 256/512MB (Optional)
ISO	Auto
Display	1.5" TFT
Still images	Format: JPEG (Image resolution: 3M、5M、8M (Software Interpolation)、12M (Software Interpolation)) Quality: Auto
Videos	Format: H.264 (MOV) Resolution: 1944x1080 30fps、1920x1080 30fps、1280x720 30fps、 Quality: Auto
Audio	Built-in microphone/ speaker
Tape	Yes
White Balance	Auto Tungsten Daylight Cloudy Fill light Fluorescent
Exposure compensation	-2.0EV~+2.0EV
Time ,date	On/off , date and time watermarking function
Output	HDMI HD Audio-Video output
PC Interface	USB2.0 (High-speed)
AV Output Format	NTSC/PAL
Battery	Built-in Lithium ion battery

Troubleshooting

Question	Possible reasons	Solutions
The camcorder is suddenly turned off	Auto Off Function is On. Low battery	·Turn on Charge battery
Captured images are not saved into memory	Power is off before the images are saved.	Charge battery
Memory card can not be used	Memory card is protected. Memory card contains non-DCF images from other cameras.	·Unlock the memory card. ·Format the memory card. Before formatting, make sure to backup first.

All the buttons are invalid.	Short-circuit when connecting camcorder with other equipment.	Long press the power button
------------------------------	---	-----------------------------

Light indicator

Red ,charging
blue ,stand by
Blue flashing recording

Recorder Parts

Name	Quantity (PCS)
Recorder	1
Car Adapter (Output: 5V)	1
USB cable	1
3M sticker	1
Car Fixed Bracket	1
User Manual	1

NOTE: Alterations reserved.

About the Manual

We have tried our best to make sure that what is in this manual is right and updated. However, we can not guarantee that all the content is correct without any errors. If there is a difference between the manual and recorder, please take the recorder as standard.

We keep the right to change content or technical regulations without informing you beforehand. In addition, the manufacturer keeps the right to change technical specification without informing you beforehand.

If the accessories are different from the ones inside the actual product, please take the actual product as standard.