

Wireless Vibro Speaker

User Manual



Contents

1. Introduction	1
2. Battery Precautions	2
3. Getting Started	3
4. Installation	4
5. Cable Connections	5
6. Bluetooth Connection	6
7. What the Lights Mean	6
8. Playing Music or Making Calls	7
9. Battery Charging	7
10. Product Care	7
11. Available Accessories	8

Warranty

In the unlikely event that your product fails to work during the 12 month warranty period, please return it to your place of purchase or contact Shintaro Support via email at support@shintaro.com.au for further advice.

Specifications

Vibro Speaker 10W

Power Output: 10W

Frequency Range: 40Hz - 20KHz

Power Supply: Built-in Lithium Battery / USB Cable

Impedance: Satellite 4ohms + Subwoofer 2ohms

Size: 55mm x 70mm

Weight: 273g

1. Introduction

Thank you for purchasing the Shintaro Wireless Portable Vibro Speaker - a small portable music player, speaker and amplifier. You can turn any solid surface into a speaker by simply placing this device on the surface.

2. Battery Precautions

The device can be powered by a built-in, rechargeable lithium battery. Please charge the battery for at least 8 hours before your first use of the device.

- If the device is not used for a long period of time, the battery may lose its charge. Please recharge the battery
- Rechargeable batteries are only to be charged under adult supervision
- Use only the supplied USB cable to recharge the battery. Improper charging may damage the battery or device
- Do not attempt to open the rechargeable battery or battery pack. There are no serviceable parts inside
- Should the battery leak, the device may become damaged. Clean the battery compartment immediately, avoiding contact with skin
- Keep batteries out of reach of children. If swallowed, consult a physician immediately
- Leaving a battery in hot or cold places, will reduce the capacity and lifetime of the battery. Always try to keep the battery between 15C and 25C. A device with a hot or cold battery may not work temporarily, even when the battery is fully charged.
- Do not dispose of batteries in a fire as they may explode. Batteries may also explode if damaged. Dispose of batteries according to local regulations. Do not dispose as household waste.

3. Getting Started

General Controls



LED Light



Microphone



USB Port



On/Off/BT Switch

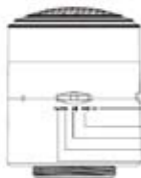

Volume Up
Next
Play/Pause/Call Controls
Previous
Volume Down

Package Contents

Portable Vibro Speaker
USB Cable
Wall Mount Adaptor
Manual



4. Installation

Rubber Stand



Remove the protective tape at the bottom of the device to reveal the rubber stand.

Note: 1. Don't throw away the protective tape, please stick it on when using a mounting socket or when not in use.
2. Use a wet finger to clean any dust off the pad.

Flat and Hard Surface



5. Cable Connections

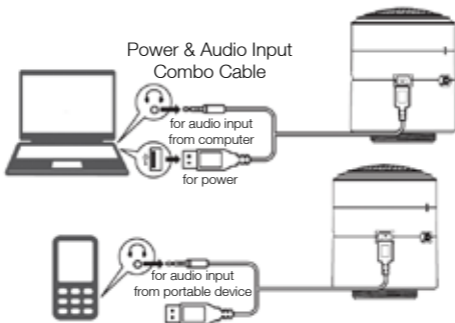

USB connection is required to power and charge the device

6. Bluetooth Connection

Slide the switch to “BT”, you will see a burst of flashes on the LED pairing it with your phone.

Put the speaker in pairing mode

When you turn on the bluetooth, the speaker will be discovered by your phone.

1. Put the speaker in pairing mode

When you turn on the bluetooth, the speaker will be discovered by your phone.

When the speaker is in pairing mode the LED will flash in blue.

2. Set your Bluetooth phone to “discover” the speaker

Follow your phone’s instruction guide, first make sure that Bluetooth is activated on your mobile phone. Then set your phone to discover the speaker. This usually involves going to “setup”, “connect” or “Bluetooth” menu on your mobile phone and selecting the option to “discover” or “add” a Bluetooth device.

3. Your phone will find the speaker

Your phone will find the speaker under name “Bluetooth”. Your phone then asks if you want to pair with the speaker. Accept by pressing “Yes” or “OK” on the phone and confirm with the passkey or pin=0000 (4 zeros). Your phone will confirm when pairing is complete.

- In the case of unsuccessful pairing, slide the switch to OFF then restart it to “BT”

7. What the Lights Mean

What you see	What this means about your this speaker
Slow blue LED flash:	In pairing mode-see Pairing section
Solid blue LED light:	Connected to phone and in standby mode
Quick blue LED flash:	Battery low

8. After pair, How to...

Play music from your phone

- > Adjusting sound volume:..... Long Press +▶▶ | or -|◀◀
- > Playing music from phone..... To start playback, press ▶||
(press ▶|| again to pause)
- > To skip to previous or next song press -|◀◀ or +▶▶|

Make a call

When you make a call from your mobile phone the call will (subject to phone settings) automatically transfer to this speaker. The inbuilt microphone will also activate, enabling you to speak directly into the Vibro Speaker.

-> Answer / Reject / End a Call.....press ►|| to answer a call, ►|| again to reject a call. After calling, press ►|| to end the call.

This device can also be used for web conferencing and Skype.

9. Battery Charging

The device has a built-in rechargeable lithium battery. This can be charged by connecting to the USB port of your computer. Refer to the battery indicator (The LED will change to red colour) for the charging status.

LED -> Quick Blue Flash.....Needs Charging

LED -> Stays Red..... Charging in Progress

LED -> Turns offCharging Complete

After charging, the device can be used without the power connection. Charge the device again when you see the battery indicator blinking.

10. Product Care

Your device is designed to be light, compact and durable. However, it is an electronic device and must be treated carefully. Putting unnecessary pressure on it or striking the device against other objects can cause damage.

To avoid damage to your device, please:

- Do not drop, crush, bend, or apply excessive force to the device
- Do not expose your device to moisture, extreme or prolonged heat, cold, humidity, or other adverse conditions.
- Avoid storing in a damp, humid or wet place. It is not waterproof
- Do not operate or store unit in places with frequent static electricity or electrical noise (eg. speaker, TV set).
- Clean the unit with a soft cloth or a damp chamois leather. Never use solvents.
- The unit must only be opened by qualified personnel.
- This device contains magnets. Keep magnetic field sensitive products such as credit cards and video screens away from this device to avoid damage or malfunction.

11. Accessories Available

- Vertical Glass Mount - SH-VM01
- Vertical Wall Mount - SH-VM02



support@shintaro.com.au

