

s400 User Manual

Warnings

Not following these simple guidelines may be dangerous or illegal. Read the complete user guide for further information.

TURN ON SAFELY

Do not turn on the phone when wireless phone is prohibited or when it may cause interference or danger.

ROAD SAFETY

Obey all road safety laws. Always use both of your hands to operate the vehicle while driving.

INTERFERENCE

All wireless phones may be sensitive to interference, which may affect performance.

TURN OFF IN HOSPITALS

Follow all restrictions. Turn off the phone near medical equipment.

TURN OFF ON AIRCRAFTS

Follow all restrictions. Wireless devices can cause interference on aircrafts.

TURN OFF WHEN REFUELING

Do not use the phone at/near refueling stations. Do not use near fuel or chemicals.

USE SENSIBLY

Only qualified personnel may install or repair this product.

ENHANCEMENTS AND BATTERIES

Use only appropriate enhancements and batteries. Do not connect incompatible products.

WATER-RESISTANCE

Your phone is not water-resistant. Keep it dry.

BACKUP COPIES

Remember to make back-up copies or keep a written record of all important information stored in your phone.

CONNECTING TO OTHER DEVICES

When connecting to any external device, read its user guide for detailed safety instructions. Do not connect with incompatible products.

Content

Your Phone	- 1 -
Keypad Descriptions	- 1 -
Start to Use	- 2 -
Charge the Battery	- 3 -
Use Touch Screen	- 3 -
Make a Call	- 4 -
Answer a Call	- 4 -
Emergency Service	- 4 -
Input Method	- 4 -
1. Backup and Restore	- 5 -
2. Browser	- 5 -
3. Calculator	- 5 -
4. Calendar	- 5 -
5. Camera	- 6 -
6. Clock	- 6 -
7. Downloads	- 6 -
8. Email	- 6 -
9. Social Networking Function	- 7 -
10. File Manager	- 7 -
11. FM Radio	- 7 -
12. Gallery	- 7 -
13. Google Service	- 7 -
14. Messaging	- 7 -
15. Movie Studio	- 8 -
16. Music	- 8 -
17. News & Weather	- 8 -
18. OOB	- 8 -
19. People	- 8 -
20. Phone	- 9 -
21. Quick Start Guide	- 9 -
22. Search	- 9 -
23. Settings	- 9 -
24. SIM Toolkit	- 11 -

25. Sound Recorder	- 11 -
26. System Update.....	- 11 -
27. ToDo	- 12 -
28. Verykool	- 12 -
29. Video Player	- 12 -
30. Wireless Input Device.....	- 12 -
31. YouTube Hot Trend	- 12 -
32. Widgets	- 12 -
Accessories	- 12 -
Care and Maintenance	- 13 -
Technical Information.....	- 15 -

Your Phone

The phone appearance is shown as below. The picture is for reference only; your phone may be different. Please take your actual phone as standard.



Keypad Descriptions

Key	Description
Power Key	Long press the key to turn on the phone. In the power on status, press the key to lock keypad and screen; long press the key to show phone options.
Option Key	Press the key to enter option menu.
Home Key	Press the key to return to standby mode. Long press the key to show recent list.

Key	Description
Back Key	In the menu mode, press the key to go back to upper menu.
Volume Key	To adjust incoming call ringtone volume. During a call, while playing music, video, or listening to radio, press the keys to adjust volume.

Start to Use

Install Memory Card, SIM Card and Battery

When you apply for a network, you will get a plug-in SIM card. SIM (Subscriber Identity Module) card that contains the phone number and service projects, and can be used to store phone numbers and personal information.

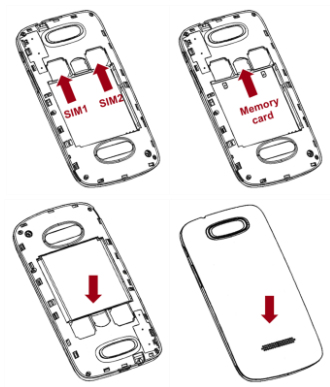

Attention: Do not bend or scratch SIM card, do not let it contact with static electricity, dust or water.

Keep all SIM cards where children cannot touch.

Note: Keep the SIM card chip contacts face downward. Make the SIM card fits card slot.

Remove Memory Card, SIM Card and Battery

Note: If the phone is turned on, long press Power Key about 3 seconds until it tips phone options and select **Power off** and then press **OK** to turn off the phone. Then, remove the battery, SIM card and memory card.

Do not plug or remove memory card in boot state, otherwise it will cause damage to the file system.

Charge the Battery

1. Before charging, check the battery slot to ensure the battery has been installed correctly.
2. Plug one end of the charger into phone.
3. Connect another end of the charger to the socket.
4. Start charging. It can be charged whether power on or power off.
 - In power on state, when the battery icon on screen start rolling means it is been charged. When the icon is full and stop rolling means charge is completed.
 - In power off state, the battery icon on screen start rolling means it is been charged. When the icon is full and stop rolling means charge is completed.
5. Unplug the charger from the socket.
6. Disconnect the charger and phone.

Use Touch Screen

- Press: Use finger to press the desired option to confirm selection or start an application.
- Long press: Long press the screen in current operation interface, icon, or input area, you can open the option menu in current

interface.

- Slide: Slide the finger on screen horizontally or vertically. For example, slide the screen in standby mode or main menu horizontally to change menu page.
- Drag: Use finger to long press desired item, drag it to anywhere on screen. For example, you can drag the icon in main menu to standby screen.

Make a Call

1. In standby mode or in main menu, press the **Phone** icon to enter dial panel, press numbers on screen to enter phone number.
2. Press dial icon, select SIM card to dial the number.
3. Press “**End**” to cancel the call.



- You need to unlock the phone if the keypad and screen is locked.
- You can make calls through call log, contacts, and messages.
- During a call, press Volume Keys to adjust the volume.
- Your phone supports intelligent dial. When input numbers, the phone will search the corresponding contact in phonebook and call log.

Answer a Call

When there is an incoming call, you can:

- Drag the icon toward right to answer the call.
- Drag the icon toward left to decline.
- Drag the icon upward to reject the call with SMS.

Emergency Service

You can call emergency service number directly without SIM card. Different networks using different emergency numbers, please query your network operator.

Input Method

Your phone has the built-in input method. In edit mode, long press “,...” to show **Input options** and set input languages and Android keyboard settings.

Input English

Press the on-screen keypad to enter corresponding letters.

Input Number

Press “?123”, you can input numbers directly by press the number icons. Long press the letter icons with number, or after long press, slide finger to the numbers to input.

Input Symbol

Press “?123” to enter symbol list. Press the desired symbol to input. Long press “,...” or “:-)...” to show symbol list, slide finger to the desired symbol to input.

1. Backup and Restore

In this menu, you can choose to **BACKUP** and **RESTORE** applications and personal data.

2. Browser

You can use your phone to access Wireless Application Protocol (WAP) sites and use WAP-based services. To browse WAP pages, you must subscribe to the data service from your service provider and configure your phone's relevant settings.

Select the website list on screen or input URL in address bar to visit.

3. Calculator

The calculator can execute simple calculations. Slide the screen toward left or right, you can change the calculator in **Basic panel** and **Advanced panel**.

4. Calendar

In the calendar, you can check schedules for current month. It has alarm for the date with schedule. Select one date to check all schedules for that day, or you can edit or delete the schedules.

5. Camera

By using the camera application, you can take photos or records for around people or events anytime. Press the **Camera** icon in main menu to enter. Press the shoot icon to take photo or record. Slide the camera icon toward right to shift camera into video recorder.

Press the icons on screen to operate the camera or recorder.

6. Clock

In the clock interface, you can check time and date. Press the alarm icon, you can add new alarm clock or turn on/off existed alarm clocks.

In the clock interface, you can also press the icons to enter count down function, stopwatch, cities settings, night mode, and settings.

7. Downloads

To check all downloads applications.

8. Email

You can use **Email** to send and receive emails.

Setup Email Account

According to the tips on screen to input email address and password, and press **Next**. You can press **Manual setup** to setup server information manually.

Check Emails

In the **Inbox**, select the email you want to check to enter. Press the icons at bottom to delete, reply, add to favorite, and mark.

Compose and Send Email

In the **Inbox**, press new mail icon to create new email. Input receiver email address, subject, and content, and then press send icon to send the email.

Delete Accounts

In the **Inbox**, press Option Key to select **Settings**. Select the account you want to delete and then select **Remove account** in the option list. Press **OK** to confirm and delete the account.

9. Social Networking Function

Your phone has several built-in social networking applications, such as Facebook, Skype, and Twitter.

10. File Manager

In this menu, you can select to check Phone storage and SD card.

11. FM Radio

Select **FM Radio** in the main menu and plug earphone to enter. Press Power icon to turn on/off the radio. Press setting icon and select **Search**, the phone will search available channels and save in the list. Press the icons on screen to operate the FM radio.

12. Gallery

You can use Gallery to view or manage photos and videos.

13. Google Service

Availability of Google applications, services, and features may vary according to your country or carrier. Please follow local laws and regulations to use them.

When you turn on your mobile phone for the first time, touch a Google services such as **Gmail**, **Local**, **Maps**, **Navigation**, **Play Store**, or **Talk**, and you may be prompted to sign in to your Google account.

Ensure that your mobile phone has an active data connection (3G/GPRS) before you sign in to your Google account.

If you already have a Google account, touch **Sign in** and enter your username and password.

14. Messaging

Select **Messaging** in the main menu or standby mode to enter. Select new message icon at left down corner to create new SMS or MMS and send.

1. Enter receiver's number or add number from contacts.
2. Press "**Type text message**" to input message content.
3. If you want to send picture or video file, press + to add pictures, videos and audio. The message will shift to multimedia message automatically.
4. Press send icon and select SIM card to send the message.

15. Movie Studio

With the movie studio function, you can play or edit video files. In the play mode, press the + at upper right corner or press Option Key to do option.

16. Music

Select **Music** in main menu. Press **Artists**, **Albums**, **Songs**, and **Playlists** at the top of screen to change category. Select one audio file to play the music. Press the icons on screen to operate the audio player.

17. News & Weather

Use this function to view local news and weather.

18. OOB

You can use this function to set basic settings for your phone quickly.

19. People

In the **People**, press search icon to search contact, press add new icon to add new contact. Press Option Key to enter:

Delete Contact

Select one or more contacts, then press OK to delete all selected contacts.

Contacts to Display

Select All contacts, contacts on SIM card, Phone, or Customize the contacts to display.

Import/Export

Copy the contacts from SIM cards, phone, phone storage or SD card, and then select location to copy.

Accounts

Select whether to Auto-sync app data.

Settings

To set display options of Sort list by, or View contact names as.

Share Visible Contacts

Select one or more contacts, press OK and then share the selected contacts via Bluetooth, Email, Gmail, MMS, SD card, or Skype, SMS.

Memory Query

To check the memory of phone and SIM cards.

Join Contacts

Use this function to merge same contacts.

20. Phone

Press the icons on screen to input numbers in sequence. After inputting numbers, press dial icon and select SIM card to dial. Press the icons at the top of screen, you can enter call log or contact.

21. Quick Start Guide

This quick start guide contains 4 useful tips and introduces you basic gestures and phone management.

22. Search

Input keyword in search bar, the phone will match applications or contacts first. If there is no result, press the icon on right to link to network and search.

23. Settings

Wireless & Networks

In this menu, you can select and set **SIM management**, **WLAN**, **Bluetooth**, **Data usage**, Under **More - Airplane mode**, **VPN**, **Tethering & portable hotspot**, **Mobile networks**, and **USB Internet**.

- **WLAN**

You can connect to a wireless LAN (WLAN), use it to access and download with high speed.

In **Menu/Settings/WIRELESS & NETWORKS**, slide the icon beside **WLAN** toward right to turn on WLAN. Press **WLAN** to check available WLAN networks. Select one open network, you can access to the network directly. If the network you selected is encrypted, you need to input password.

- **Bluetooth**

The phone supports Bluetooth. It can exchange information between devices including mobile phones wirelessly. Through Bluetooth, you can sync phone and computer, exchange data with other Bluetooth devices, and can connect to Bluetooth earphone.

In **Menu/Settings/WIRELESS & NETWORKS**, slide the icon beside **Bluetooth** toward right to turn on Bluetooth and set. Before transmit data, you may need to match with other Bluetooth devices.

Device

In this menu, you can set audio profiles and display, check storage and battery, and manage applications.

Personal

- **Location Access**

Select whether to access to my location, whether to turn on GPS satellites, or whether to use WLAN & mobile network location.

- **Security**

You can select **SCREEN SECURITY, ENCRYPTION, SIM CARD LOCK, PASSWORDS, DEVICE ADMINISTRATION**, and **CREDENTIAL STORAGE** in this menu.

- **Language & Input**

Select and set Language, keyboard & input methods, speech, and mouse/trackpad.

- **Backup & Reset**

In this menu, select **Factory data reset** and then select **Reset phone** to clear all data in the phone memory. Select **DRM reset** to delete all DRM licenses.

Accounts

- **Add Account**

To add new account of Corporate, Email, Facebook, Google, Skype[™], or Twitter.

System

- **Date & Time**

Set time and date for the phone.

- **Scheduled Power On & Off**

Set time to power on/off the phone automatically.

- **Accessibility**

To set accessibility functions for the phone.

- **Developer Options**

Whether to turn on/off developer options, and select debugging and apps to set.

- **About Phone**

To check status, battery use, legal information, etc.

24. SIM Toolkit

If your SIM card supports STK (SIM Tool Kit) function, the phone can display different first level menu according to different STK card. This function needs the network provider support. If user finds STK function can't operate normally, please contact the network provider. If the network provider does not support this function, we do not claim any responsibility whatsoever.

25. Sound Recorder

The phone support sound record function. You can send a recorded file via Bluetooth, message or email.

26. System Update

Through WLAN and high-speed wireless network, you can wirelessly upgrade, convenient stay at home to update the latest software, have better experience to the mobile phone of new features, and have a better experience with the optimized functionality to.

In the **Menu/System Update**, choose whether to open the **Automatic System Update**. When this function is turned on, the system will automatically to check for a specific interval.

27. ToDo

In this menu, you can check to-do items or done items. Press + or **Tap to add new ToDo** to add new item. When finish the item, press **DONE** to save.

28. Verykool

You need to input email address and password to enter verykool zone.

29. Video Player

You can use Video player to view or manage videos.

30. Wireless Input Device

You can add new device or check paired wireless input device in the menu.

31. YouTube Hot Trend

This app gives you tons of hot YouTube videos.

32. Widgets

In the widgets list, you can select desired widget to add to idle screen.

Accessories

You can use accessories approved by our company, the other accessories can be provided by the seller.

- Extra battery

We provide several kind of lithium battery with different capacity.

- Traveler charger

Super sleek, useful charger can charge the mobile phone very quickly. Plug the charger into the electrical plugs and connects the other side connects to the left side of the phone.

You can check the charging progress in the screen of the phone, it will not power on automatically when charging.

Care and Maintenance

● Battery Care

- Your device is powered by a rechargeable battery. When the power is weak, please charge the battery. In order to extend the lifespan of the battery, use all the battery's power before recharging.
- Unplug the charger from the electrical plug and the device when not in use. Do not leave the battery connected to a charger more than a week. Overcharging may shorten its lifespan.
- Extreme temperatures can affect the ability of your battery to charge. Battery needs the fit temperature. If the surrounding temperature is over 40°C, the battery cannot be charged.
- Use the battery only for its intended purpose. Never use any charger or battery that is damaged.

Do not short-circuit the battery. Accidental short-circuiting can occur when a metallic object such as a coin, clip, or pen causes direct connection of the positive (+) and negative (-) terminals of the battery. (These look like metal strips on the battery.) Short-circuiting the terminals may damage the battery or the connecting object.

- Leaving the battery in hot or cold places, such as in a closed car in summer or a freezer in winter conditions, will reduce the capacity and lifetime of the battery. Always try to keep the battery between 59°F and 77°F (15°C and 25°C). A hot or cold battery may not function temporarily, even when the battery is fully charged.
- Battery performance is particularly limited in temperatures below freezing.

- Do not dispose of batteries in a fire! Dispose of batteries according to local regulations. Please recycle when possible. Cellphones are not considered household waste.

- Mobile phone maintenance

- Keep the device dry. Precipitation, humidity, and all types of liquids or moisture can contain minerals that will corrode electronic circuits. If your device does get wet, remove the battery and allow the device to dry completely before replacing it.

- Do not use or store the device in dusty, dirty areas. Its moving parts and electronic components can be damaged.

- Do not store the device in hot areas. High temperatures can shorten the life of electronic devices, damage batteries, and warp or melt certain plastics.

- Do not store the device in cold areas. When the device returns to its normal temperature, moisture can form inside the device and damage electronic circuit boards.

- Do not attempt to open the device other than as instructed in this guide.

- Do not drop, knock, or shake the device. Rough handling can break internal circuit boards and fine mechanics.

- Do not use harsh chemicals, cleaning solvents, or strong detergents to clean the device.

- Do not paint the device. Paint can clog the moving parts and prevent proper operation.

- Use only the supplied or an approved replacement antenna.

Unauthorized antennas, modifications, or attachments could damage the device and may violate regulations governing radio devices.

All of the above suggestions apply to your device, battery, charger, or any enhancement. If any device is not working properly, take it to the nearest authorized service facility for service.

Caution: The manufacturer assumes no responsibility for the consequences of the users does not comply with the above suggestions or misuse of the phone.

Technical Information

Weight: 120g (with battery)

Size: 125mm*65.8mm*11.5mm

Battery capacity: 1400mAh

Networks: GSM: 850/900/1800/1900MHz

WCDMA:850/1900/2100MHz

The actual situation of the phone using is related to local environment, SIM card and way of use.

Note: If the version of user manual upgrades, we will do not notice. The company has the final interpretation of the user manual.

The pictures in user manual only for reference, please take your actual phone as the standard.

FCC Caution

§ 15.19 Labelling requirements.

This device complies with part 15 of the FCC Rules. Operation is subject to the following two conditions: (1) This device may not cause harmful interference, and (2) this device must accept any interference received, including interference that may cause undesired operation.

§ 15.21 Information to user.

Any Changes or modifications not expressly approved by the party responsible for compliance could void the user's authority to operate the equipment.

§ 15.105 Information to the user.

Note: This equipment has been tested and found to comply with the limits for a Class B digital device, pursuant to part 15 of the FCC Rules. These limits are designed to provide reasonable protection against harmful interference in a residential installation. This equipment generates uses and can radiate radio frequency energy and, if not installed and used in accordance with the instructions, may cause harmful interference to radio communications. However, there is no guarantee that interference will not occur in a particular installation. If this equipment does cause harmful interference to radio or television reception, which can be determined by turning the equipment off and on, the user is encouraged to try to correct the interference by one or more of the following measures:

- Reorient or relocate the receiving antenna.
- Increase the separation between the equipment and receiver.
- Connect the equipment into an outlet on a circuit different from that to which the receiver is connected.
- Consult the dealer or an experienced radio/TV technician for help.

Specific Absorption Rate (SAR) information:

This **GSM Mobile Phone** meets the government's requirements for exposure to radio waves. The guidelines are based on standards that were developed by independent scientific organizations through periodic and thorough evaluation of scientific studies. The standards include a substantial safety margin designed to assure the safety of all persons regardless of age or health.

FCC RF Exposure Information and Statement The SAR limit of USA (FCC) is 1.6 W/kg averaged over one gram of tissue. Device types: S400 (FCC ID: WA6S400) has also been tested against this SAR limit.

The highest SAR value reported under this standard during product certification for use at the ear is **1.01W/kg** and when properly worn on the body is **0.81W/kg**. This device was tested for typical body-worn operations with the back of the handset kept **1.5cm** from the body. To maintain compliance with FCC RF exposure requirements, use accessories that maintain a **1.5cm** separation distance between the user's body and the back of the handset. The use of belt clips, holsters and similar accessories should not contain metallic components in its assembly. The use of accessories that do not satisfy these requirements may not comply with FCC RF exposure requirements, and should be avoided.

Body - worn Operation

This device was tested for typical body-worn operations. To comply with RF exposure requirements, a minimum separation distance of **1.5 cm** must be maintained between the user's body and the handset, including the antenna. Third-party belt-clips, holsters, and similar accessories used by this device should not contain any metallic components. Body-worn accessories that do not meet these requirements may not comply with RF exposure requirements and should be avoided. Use only the supplied or an approved antenna.