



Clip II mini 606 Bluetooth Clip Headset

Table of Contents in English, Chinese, Thai, and Indonesian.

Table of Contents in English.



i.Tech Clip II mini 606 Overview

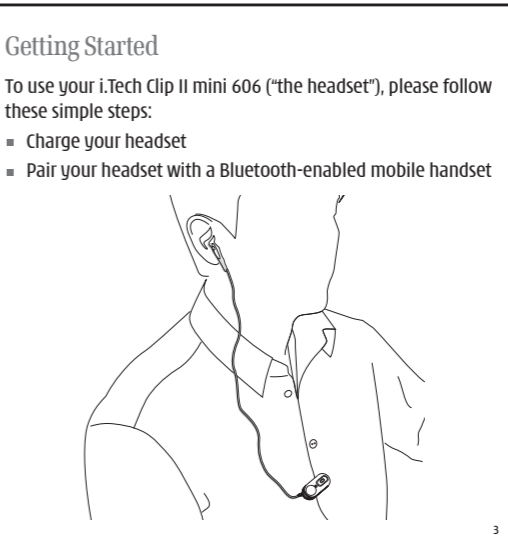

Getting Started

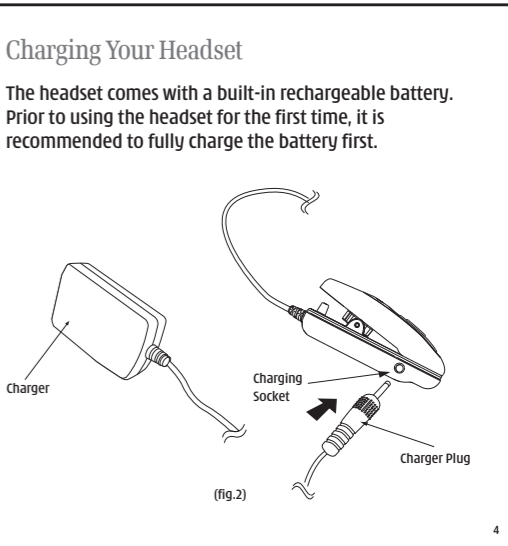

Charging Your Headset

Charging Your Headset. Connect the charger to an AC wall outlet (mains socket) and the charger plug to the headset's charging socket (fig.1).

Charging Your Headset. Low Battery. When the headset is on and the battery becomes low, the status indicator flashes red and the headset emits a beep every 1 minute.

Turning Your Headset On and Off. Turning Off the Headset. Press and hold the MFB for approximately 2 seconds until you hear a long beep.

Pairing Your Headset. 1. Place the headset and the mobile handset no more than 1 metre apart and ensure there is nothing in between.

Pairing Your Headset. 6. Enter the preprogrammed passkey "0000" and press "OK" to pair your headset and mobile handset.

Using Your Headset. Answering a Call. When there is an incoming call, you will hear ringing through the earphone and the built-in buzzer.

Using Your Headset. muting function while in standby mode. The status indicator will flash blue. IMPORTANT: If you do not wish to be disturbed at all, you may consider resetting the mobile phone setting to restrict incoming calls.

Using Your Headset. (the person's name) into your mobile handset first before using the voice dialling function. Please refer to your mobile handset's user guide on how to record the voice tags.

Multipoint Function. i.Tech Clip II mini 606 supports Multipoint function which allow simultaneous pairing with two mobile handsets.

Multipoint Function. Answer a call on the second phone whilst talking on the other. Whilst there is a second incoming call, you will NOT be able to hold the first caller.

Resetting the Headset. You may reset the headset to its original settings anytime. To do this you also clear all current pairing settings.

Care and Maintenance. Do not dispose of the headset in a fire as it will result in explosion. Do not expose your headset to contact with sharp objects as this will cause scratches and damage.

Care and Maintenance. Charger. Only use the manufacturer supplied charger when charging the headset. Do not disassemble the charger as it may expose you to dangerous voltages or other risks.

Safety Information. Never allow children to play with the headset - small parts may be a choking hazard. Observe all signs that require an electrical device or RF radio product to be switched off in designated areas.

RF exposure warning: This device complies with FCC radiation exposure limits set forth for an uncontrolled environment. This device must not be co-located or operating in conjunction with any other antenna or transmitter.

Declaration of Conformity (DoC). We, i.Tech Dynamic Ltd, declare that the following product: Product Name: i.Tech Clip II mini 606 Model No: C51-B606-XX is in conformity with the following essential requirements of Council Directive 1999/5/EC (referred to as R&TTE Directive):

Product Specifications. Bluetooth Specification: V2.1 + EDR Class 2. Bluetooth Profiles Supported: Headset and Handsfree. No. of mobile phone connected: Max 2 for stand-by (Handsfree Profile Only).

©2010 Hutchison Harbour Ring Enterprises Limited. All rights in this publication are reserved and no part may be reproduced without the prior written permission of the publisher.



Clip II mini 606 藍牙耳機

目錄. i.Tech Clip II mini 606 耳機夾概要. 開始使用. 無線耳機夾充電.



開始使用. 請按照以下的簡單步驟,使用無線耳機夾: 雙色指示燈. 無線耳機夾充電. 無線耳機夾具備內置可充電電池.

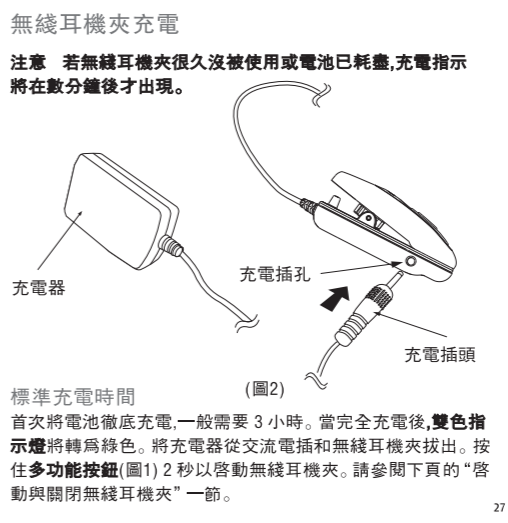

無線耳機夾充電. 通話及備用時間. 徹底充電的電池,可供通話最多8小時及備用最多140小時.

無線耳機夾配接. 首次使用無線耳機夾前,您必須將無線耳機夾與具備藍牙功能的手提電話配接.

無線耳機夾配接. 4. 按照手提電話用戶手冊指示,啟動手提電話具備的藍牙功能. 5. 設定手提電話尋找1米內的藍牙裝置名稱,並選擇"Clip II mini 606".

使用無線耳機夾. 接聽來電. 如要接聽來電,待無線耳機夾發出鈴聲,然後按下多功能按鍵. 靜音. 如要關閉麥克風,按住音量鍵2秒.

使用無線耳機夾. 聲控無線耳機夾撥號. 如您的手提電話具備聲控撥號功能,祇須按下無線耳機夾的多功能按鍵,當聽到"嗒"聲後,說出聲音短語即可.

多點配接功能. 與第二個移動電話配接. 需將重電用戶指南上的配接程序即可配接來電.

多點配接功能. 終止第一個來電. 請按一次多功能按鍵(MFB),此時您將通話耳機聽到鈴聲訊號.請再按一次多功能按鍵(MFB)以至接聽第二個來電.

保養及維修. 無線耳機夾. 無線耳機夾夾在口袋或袋內,先關掉無線耳機夾. 切勿將無線耳機夾暴露於液體、蒸氣或潮濕的地方.

保養及維修. 充電. 給無線耳機夾充電,只可使用製造商提供的充電器. 為免引致觸電或產生其它危險,請勿自行拆開充電器.

安全指引. 第十二條一經型式認證合格之低功率射頻電機,非經許可,公司、商號或使用者均不得擅自變更頻率、加大功率或變更原設計之特性及功能.

疑難排解. 藍牙耳機夾採用了藍牙規範v2.1 + EDR Class 2. 藍牙無線技術需要設備支持,藍牙設備間的互用性取決于設備的兼容性.

法律遺囑聲明(DOC). i.Tech Dynamic Ltd. 聲明以下產品: 產品名稱: i.Tech Clip II mini 606 606 型號: C51-B606-XX 符合委員會(Council Directive) 1999/5/EC (下稱 R&TTE Directive)的必要要求.

© 2010 Hutchison Harbour Ring Enterprises Limited. 本出版品版權保留. 未經出版者事先書面允許,禁止一部或全部複製. 本出版物內容出於即時準確為正確,但任何錯誤之資訊、條款、商品及服務本出版者概不負責.



Clip II mini 606 藍牙耳機

目錄. i.Tech Clip II mini 606 606 耳機夾概要. 開始使用. 無線耳機夾充電.



開始使用. 請按照以下的簡單步驟,使用無線耳機夾: 雙色指示燈. 無線耳機夾充電. 無線耳機夾具備內置可充電電池.



無線耳機夾充電. 通話及備用時間. 徹底充電的電池,可供通話最多8小時及備用最多140小時.