

MOOG

VIDEOLARM

© 2011, Moog Videolarm, Inc. All Rights Reserved



PFDW75C12N and PFDW75T12N

IP Ready™ Series - Pressurized FusionDome™

www.videolarm.com

Installation and Operation Instructions for the following models:

Before attempting to connect or operate this product, please read these instructions completely.
To be used with the 81-IN5481 Instruction Manual.

81-IN5371
01-13-2012

IMPORTANT SAFEGUARDS

- 1 Read these instructions.
- 2 Keep these instructions.
- 3 Heed all warnings
- 4 Follow all instructions.
- 5 Do not use this apparatus near water.
- 6 Clean only with damp cloth.
- 7 Do not block any of the ventilation openings. Install in accordance with the manufacturers instructions.
- 8 Cable Runs- All cable runs must be within permissible distance.
- 9 Mounting - This unit must be properly and securely mounted to a supporting structure capable of sustaining the weight of the unit.

Accordingly:

- a. The installation should be made by a qualified installer.
 - b. The installation should be in compliance with local codes.
 - c. Care should be exercised to select suitable hardware to install the unit, taking into account both the composition of the mounting surface and the weight of the unit.
- 10 Do not install near any heat sources such as radiators, heat registers, stoves, or other apparatus (including amplifiers) that produce heat.
 - 11 Do not defeat the safety purpose of the polarized or grounding-type plug. A polarized plug has two blades with one wider than the other. A grounding type plug has two blades and a third grounding prong. The wide blade or the third prong are provided for your safety. When the provided plug does not fit into your outlet, consult an electrician for replacement of the obsolete outlet.
 - 12 Protect the power cord from being walked on or pinched particularly at plugs, convenience receptacles, and the point where they exit from the apparatus.
 - 13 Only use attachment/ accessories specified by the manufacturer.
 - 14 Use only with a cart, stand, tripod, bracket, or table specified by the manufacturer, or sold with the apparatus. When a cart is used, use caution when moving the cart/ apparatus combination to avoid injury from tip-over.
 - 15 Unplug this apparatus during lightning storms or when unused for long periods of time.
 - 16 Refer all servicing to qualified service personnel. Servicing is required when the apparatus has been damaged in any way, such as power-supply cord or plug is damaged, liquid has been spilled or objects have fallen into the apparatus, the apparatus has been exposed to rain or moisture, does not operate normally, or has been dropped.

Be sure to periodically examine the unit and the supporting structure to make sure that the integrity of the installation is intact. Failure to comply with the foregoing could result in the unit separating from the support structure and falling, with resultant damages or injury to anyone or anything struck by the falling unit.

UNPACKING

Unpack carefully. Electronic components can be damaged if improperly handled or dropped. If an item appears to have been damaged in shipment, replace it properly in its carton and notify the shipper.

Be sure to save:

- 1 **The shipping carton and packaging material. They are the safest material in which to make future shipments of the equipment.**
- 2 **These Installation and Operating Instructions.**

SERVICE

If technical support or service is needed, contact us at the following number:

TECHNICAL SUPPORT
AVAILABLE 24 HOURS
1 - 800 - 554 - 1124

SAFETY PRECAUTIONS

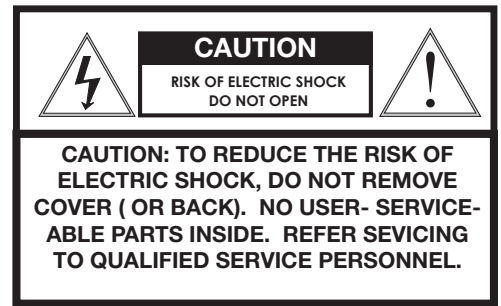

The lightning flash with an arrowhead symbol, within an equilateral triangle, is intended to alert the user to the presence of non-insulated “dangerous voltage” within the product’s enclosure that may be of sufficient magnitude to constitute a risk to persons.

Este símbolo se piensa para alertar al usuario a la presencia del “voltaje peligroso no-aislado” dentro del recinto de los productos que puede ser un riesgo de choque eléctrico.

Ce symbole est prévu pour alerter l'utilisateur à la presence “de la tension dangereuse” non-isolée dans la clôture de produits qui peut être un risque de choc électrique.

Dieses Symbol soll den Benutzer zum Vorhandensein der nicht-Isolier “Gefährdungsspannung” innerhalb der Produkteinschließung alarmieren die eine Gefahr des elektrischen Schlages sein kann.

Este símbolo é pretendido alertar o usuário à presença “di tensão perigosa non-isolada” dentro do cerco dos produtos que pode ser um risco de choque elétrico.

Questo simbolo è inteso per avvertire l'utente alla presenza “di tensione pericolosa” non-isolata all'interno della recinzione dei prodotti che può essere un rischio di scossa elettrica.



The exclamation point within an equilateral triangle is intended to alert the user to presence of important operating and maintenance (servicing) instructions in the literature accompanying the appliance.

Este símbolo del punto del exclamation se piensa para alertar al usuario a la presencia de instrucciones importantes en la literatura que acompaña la aplicación.

Ce symbole de point d'exclamation est prévu pour alerter l'utilisateur à la presence des instructions importantes dans la littérature accompagnant l'appareil.

Dieses Ausruf Punktsymbol soll den Benutzer zum Vorhandensein de wichtigen Anweisungen in der Literatur alarmieren, die das Gerät begleitet.

Este símbolo do ponto do exclamation é pretendido alertar o usuário à presença de instruções importantes na literatura que acompanha o dispositivo.

Questo simbolo del punto del exclamation è inteso per avvertire l'utente alla presenza delle istruzioni importanti nella letteratura che accompagna l'apparecchio.



Limited Warranty for Moog Videolarm Products

Moog Videolarm warrants these products to be free from defects in material or workmanship as follows:

PRODUCT CATEGORY	PARTS \ LABOR
All Enclosures and Electronics*	Five (5) Years
Poles/PolEvators™/CamEvator	Three (3) Years
Warrior Series™/Q-View™/IR Illuminators	Five (5) Years
SView Series™	Five (5) Years **6 months if used in auto scan/tour operation
Controllers	Five (5) Years
Power Supplies	Five (5) Years
EcoKit	Three (3) Years
Accessory Brackets	Five (5) Years
Liberty Dome	Three (3) Years
*DeputyDome™, NiteTrac™, Igloo Dome, PurgeDome™	Three (3) Years **6 months if used in auto scan/tour operation

During the labor warranty period, to repair the Product, Purchaser will either return the defective product, freight prepaid, or deliver it to Moog Videolarm Inc. Decatur GA. The Product to be repaired is to be returned in either its original carton or a similar package affording an equal degree of protection with a RMA # (Return Materials Authorization number) displayed on the outer box or packing slip. To obtain a RMA# you must contact our Technical Support Team at 800.554.1124, extension 101. Moog Videolarm will return the repaired Product freight prepaid to Purchaser. Moog Videolarm is not obligated to provide Purchaser with a substitute unit during the warranty period or at any time. After the applicable warranty period, Purchaser must pay all labor and/or parts charges.

The limited warranty stated in these product instructions is subject to all of the following terms and conditions.

TERMS AND CONDITIONS

1. NOTIFICATION OF CLAIMS: WARRANTY SERVICE: If Purchaser believes that the Product is defective in material or workmanship, then written notice with an explanation of the claim shall be given promptly by Purchaser to Moog Videolarm. All claims for warranty service must be made within the warranty period. If after investigation Moog Videolarm determines the reported problem was not covered by the warranty, Purchaser shall pay Moog Videolarm for the cost of investigating the problem at its then prevailing per incident billable rate. No repair or replacement of any Product or part thereof shall extend the warranty period of the entire Product. The specific warranty on the repaired part only shall be in effect for a period of ninety (90) days following the repair or replacement of that part or the remaining period of the Product parts warranty, whichever is greater.

2. EXCLUSIVE REMEDY: ACCEPTANCE: Purchaser's exclusive remedy and Moog Videolarm's sole obligation is to supply (or pay for) all labor necessary to repair any Product found to be defective within the warranty period and to supply, at no extra charge, new or rebuilt replacements for defective parts.

3. EXCEPTIONS TO LIMITED WARRANTY: Moog Videolarm shall have no liability or obligation to Purchaser with respect to any Product requiring service during the warranty period which is subjected to any of the following: abuse, improper use, negligence, accident, lightning damage or other acts of God (i.e., hurricanes, earthquakes), modification, failure of the end-user to follow the directions outlined in the product instructions, failure of the end-user to follow the maintenance procedures recommended by the International Security Industry Organization, written in product instructions, or recommended in the service manual for the Product. Furthermore, Moog Videolarm shall have no liability where a schedule is specified for regular replacement or maintenance or cleaning of certain parts (based on usage) and the end-user has failed to follow such schedule; attempted repair by non-qualified personnel; operation of the Product outside of the published environmental and electrical parameters, or if such Product's original identification (trademark, serial number) markings have been defaced, altered, or removed. Moog Videolarm excludes from warranty coverage Products sold AS IS and/or WITH ALL FAULTS and excludes used Products which have not been sold by Moog Videolarm to the Purchaser. All software and accompanying documentation furnished with, or as part of the Product is furnished "AS IS" (i.e., without any warranty of any kind), except where expressly provided otherwise in any documentation or license agreement furnished with the Product. Any cost associated with removal of defective product and installation of replacement product is not included in this warranty.

4. PROOF OF PURCHASE: The Purchaser's dated bill of sale must be retained as evidence of the date of purchase and to establish warranty eligibility.

DISCLAIMER OF WARRANTY

EXCEPT FOR THE FOREGOING WARRANTIES, Moog Videolarm HEREBY DISCLAIMS AND EXCLUDES ALL OTHER WARRANTIES, EXPRESS OR IMPLIED, INCLUDING, BUT NOT LIMITED TO ANY AND/OR ALL IMPLIED WARRANTIES OF MERCHANTABILITY, FITNESS FOR A PARTICULAR PURPOSE AND/OR ANY WARRANTY WITH REGARD TO ANY CLAIM OF INFRINGEMENT THAT MAY BE PROVIDED IN SECTION 2-312(3) OF THE UNIFORM COMMERCIAL CODE AND/OR IN ANY OTHER COMPARABLE STATE STATUTE. Moog Videolarm HEREBY DISCLAIMS ANY REPRESENTATIONS OR WARRANTY THAT THE PRODUCT IS COMPATIBLE WITH ANY COMBINATION OF NON-Moog Videolarm PRODUCTS OR NON-Moog Videolarm RECOMMENDED PRODUCTS PURCHASER MAY CHOOSE TO CONNECT TO THE PRODUCT.

LIMITATION OF LIABILITY

THE LIABILITY OF Moog Videolarm, IF ANY, AND PURCHASER'S SOLE AND EXCLUSIVE REMEDY FOR DAMAGES FOR ANY CLAIM OF ANY KIND WHATSOEVER, REGARDLESS OF THE LEGAL THEORY AND WHETHER ARISING IN TORT OR CONTRACT, SHALL NOT BE GREATER THAN THE ACTUAL PURCHASE PRICE OF THE PRODUCT WITH RESPECT TO WHICH SUCH CLAIM IS MADE. IN NO EVENT SHALL Moog Videolarm BE LIABLE TO PURCHASER FOR ANY SPECIAL, INDIRECT, INCIDENTAL, OR CONSEQUENTIAL DAMAGES OF ANY KIND INCLUDING, BUT NOT LIMITED TO, COMPENSATION, REIMBURSEMENT OR DAMAGES ON ACCOUNT OF THE LOSS OF PRESENT OR PROSPECTIVE PROFITS OR FOR ANY OTHER REASON WHATSOEVER.

PFD75C12N, PFD75T12N

IP Ready Pressurized Network Housing

IP Ready Pressurized Network Housing with 12Vdc input, wall or pendant mounting, heater & blowers, ready for standard IP PTZ cameras.

ELECTRICAL SPECIFICATIONS (OUTDOOR ONLY):



Power 12Vdc, Class 2 Only

Total Power: 22 watts (Excluding camera)

Accessories (Heater/Blower): 22 watts

Heater: 20 watts

Blower: 2 watt



NOTE: This unit is designed for operation in an upright position. Installing the housing upside down may cause damage to the internal equipment, and will void the warranty.

GENERAL INSTRUCTIONS:

Tools Required: Phillips Head Screwdriver
7/16" open-faced wrench



Be sure the bracket is properly and securely mounted to a supporting structure capable of rigidly holding the weight of the entire unit.

ASSEMBLING THE UNIT:

1. Remove content from all boxes. Contents should include:



Main Housing Assembly

Either with wall mount or pendant bracket



Dome Assembly - Clear or Tinted

Do not remove the protective film until the product is assembled and installed.





3 Packet Assemblies



Gooseneck Wall Mount

IMPORTANT SAFEGUARDS

NOTE: The PFD75C12N is a pressurized enclosure. As such, certain care is required for the safe use of the product.

1. Inspect the enclosure upon opening the box. Make sure the unit was not damaged during shipping. Immediately replace domes that have been cracked or show any signs of damage.
2. Always use safety goggles when servicing the unit.
3.  Never use an unregulated gas supply to pressurize the enclosure. The valve should be regulated with a maximum of 10 psi output.
4.  **PRESSURIZE USING AIR OR INERT GAS ONLY!**

NOTE: Periodically examine the unit and the structure to which it's attached. If any signs of wear are noticed, replace immediately.

GENERAL INSTRUCTIONS

1. The standard model is designed as a pendant mount housing. A 1½" NPT housing coupling is provided for use with a standard 1½" (NPT) pipe. This housing also includes a Videolarm WM20G wall mount bracket.
2. Install pendant pipe or wall mount bracket in the desired location.

 Be sure bracket is properly and securely mounted to a supporting structure capable of rigidly holding the weight of the entire unit.

4. Pipe threads should be clean and rust free. Although a hermetic connector protects the inside of the enclosure from all moisture, it is still recommended that a thread sealer be used on the threads of the housing coupling. Attach the housing coupling to the bracket or pendant pipe (Figure 1).

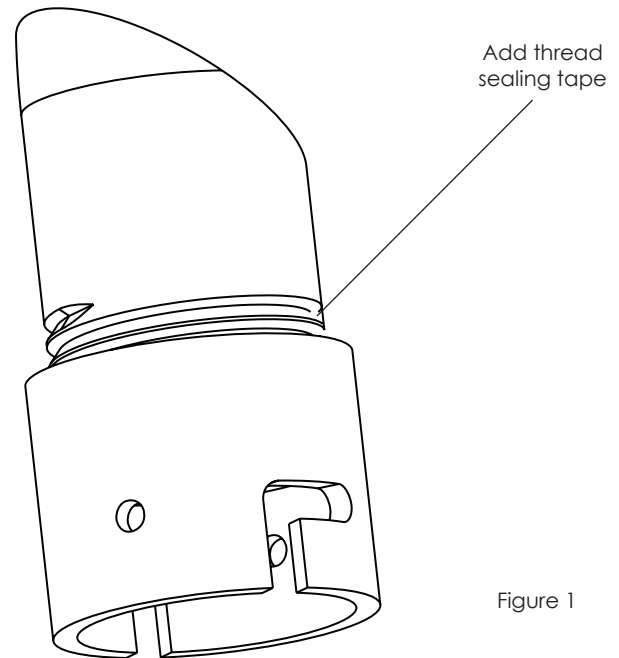

Figure 1

STANDARD INSTALLATION PROCEDURES

INCLUDES MODEL: WM20G

1. Choose an appropriate location on an outside wall to mount the WM20G.

NOTE: Be sure that the wall is sturdy enough to support the combined weight of the bracket and housing.

2. Place the base against the wall, mark the location of the four mounting holes, remove the bracket and drill the mounting holes. Pull all wiring through the wall at this time (Figure 1).

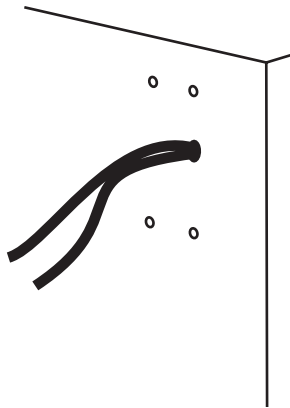

Figure 1

3. Run wiring into and through the WM20G bracket. Make sure you also have enough to run into the housing for connections.

NOTE: For applications where the wiring cannot be pulled through the wall, a starter hole is provided on the side of the bracket near the base. Use this to drill a larger hole to pass conduit into and through the bracket (Figure 2).

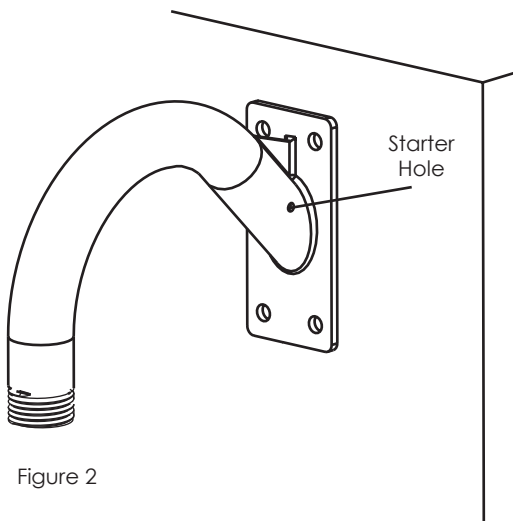

Figure 2

4. Mount the WM20G to the wall (hardware not included). (Figure 3)

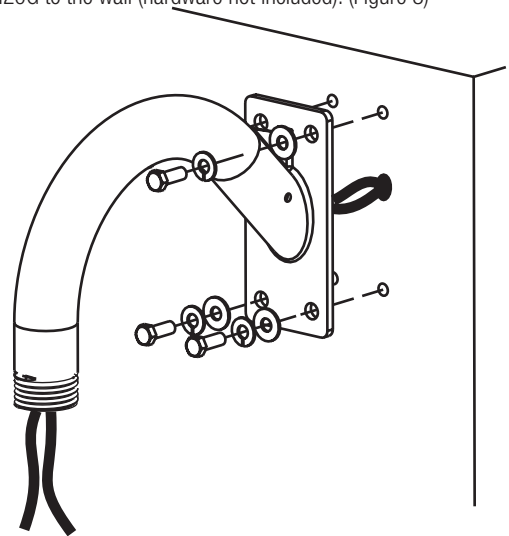

Figure 3

5. Make all wiring connections to the housing, following instructions provided with the housing (Figure 4).

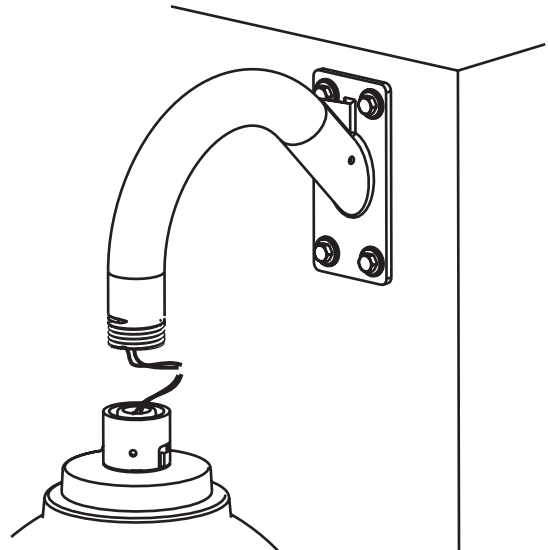

Figure 4

6. Screw the housing coupling onto the WM20G 1/2" pipe thread (Figure 5). Make sure all attachments are secure.

NOTE: Use Teflon™ tape or silicone to seal the threads

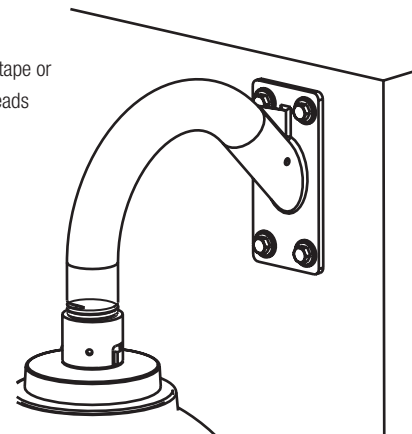

Figure 5

MOUNTING THE HOUSING

1. Mount the housing assembly to the mounting bracket and housing coupling. A safety cable is included to temporarily hold it while making wiring connections. Loop the safety cable over one of the set screws on the coupling and make the appropriate connections using the (2) screw-down connectors supplied.

**Chart A Wiring Color Code
Power and Control Inputs
(Outside of housing)**

POWER		
1	Camera and Heater/Blower (12 VDC)	Red
2	Camera and Heater/Blower (12 VDC)	Black

ALARMS		
1	Alarm 1	Blue
2	Alarm 2	Violet
3	Alarm 3	Gray
4	Common	White

RJ45 Ethernet Cable

DATA	
1	RJ45 Ethernet Connector

**Chart B Power and Control Outputs
(Inside of housing)**

CAMERA POWER

Connect power plug provided.

NOTE: Center Pin + (White Wire +).

Connect power plug to camera per camera instructions.

ALARMS		
1	Alarm 1	Blue
2	Alarm 2	Violet
3	Alarm 3	Gray
4	Common	White

GENERAL INSTRUCTIONS

The PFD75C12N is setup with (1) power input.

1. Accessory Power (yellow and green wire)

Housing Power requires 42 watts (excluding camera)

A. Be certain that you know the total power consumption of housing Heaters (40 watts) + Blowers (2 watts) + camera. Your transformer will need to be sized accordingly.

B. Check the supplied wiring chart to be sure that you have the proper gauge wire for the distance that you intend to run your power wires.

2. Undo the safety cable, twist the housing onto the housing coupling, and secure all (3) setscrews provided on the coupling.

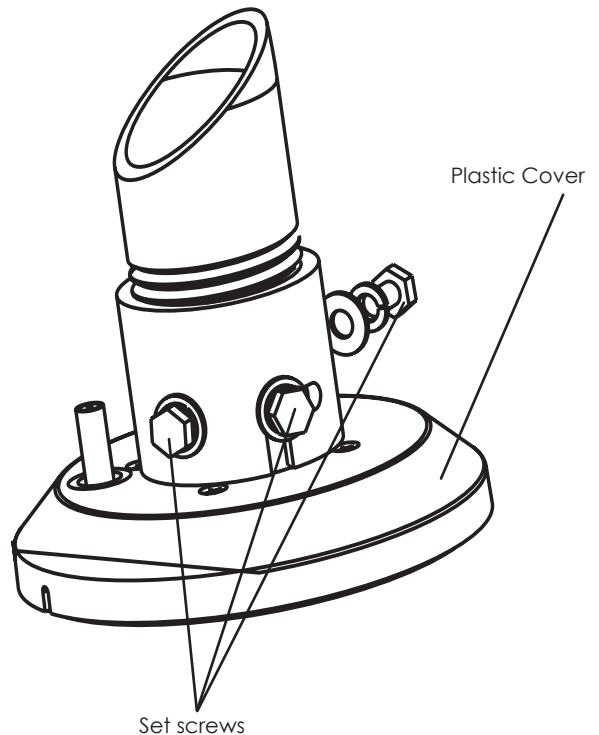

3. Clean the inside of the dome, with the text-wipe provided. Reattach the housing dome and secure the (3) captive screws. Do not overtighten the screws. Tighten only to the point at which the gap between the ring and the housing top closes.

4. Clean the outside of the dome.

CALIBRATING UNITS WITH LOW PRESSURE SENSORS

(Not supplied on 12Vdc units)

The Low Pressure alarm uses an absolute pressure sensor and must be calibrated to the local altitude. To calibrate you must power up the unit. The green LED located in the center of the camera bracket will turn on. After 30 seconds the LED will begin to blink. At that time momentarily press the red push button switch located next to the LED. LED will turn off indicating unit is calibrated. Calibration is now complete. Unit will store this base value and does not need to be recalibrated. To recalibrate repeat the above procedure.

Alarm sensor contact is open when pressurized and closed when the enclosure is not pressurized.

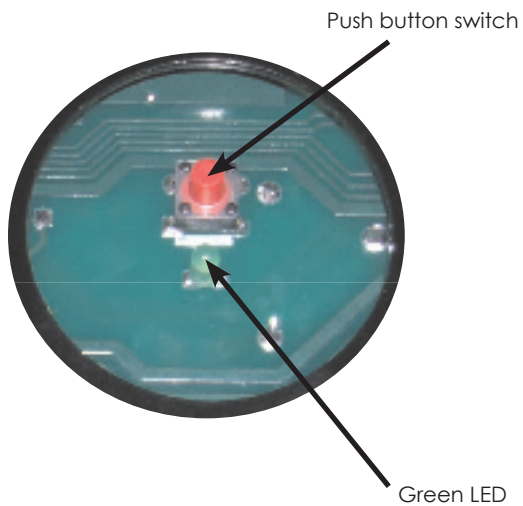

PRESSURIZING THE ENCLOSURE

Air is inserted in the enclosure through the Schraeder valve located on the top of the unit. A pressure release valve is located under the housing cap located in this same location. Air vents from the pressure release valve between the housing top and the cap (Figure 4).

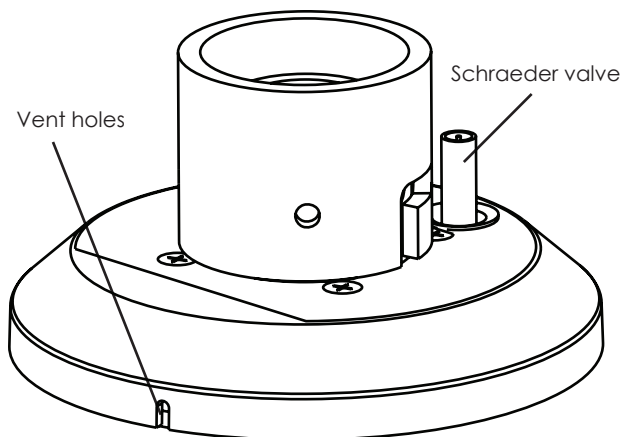

Figure 4



Before inserting air into the housing be sure the (2) cap vents are free of obstructions such as ice or debris (Figure 4).

Pressurized housings provide maximum protection for CCTV cameras and lenses. The charge of dry nitrogen inside the housing eliminates the effects of moisture, dust, insects and corrosive exhaust fumes. This allows a longer lifetime for your surveillance equipment.

To pressurize the housing, you must have the following:

1. A tank of dry nitrogen
2. A regulator on the tank
3. A hose with air chuck to connect the regulator to the housing's intake valve

Dry Nitrogen

Nitrogen is a readily available. To obtain supplies, check your local yellow pages for a medical or industrial gas provider. If the tank is to be carried from location to location, a size of 40 cubic foot is recommended. This should be enough to refill 30 individual housings. Handle the tanks with care. Although nitrogen is an inert gas, the tank is highly pressurized and if the valve or regulator is damaged the tank could be dangerous. Tanks of dry nitrogen can be kept for several years.

The Regulator

The tank will have a standard 580 fitting, but a regulator will be required. A recommended regulator for the tank would be a Harris #9296-15-580 or #425-15-580. For local distribution you can contact Harris at 800-241-0804.

The Hose

The purge valve, called a "Schraeder" or "dill" valve, is similar to the air intake valve on car or bicycle tires. To connect the regulator to the purge valve on the housing, you'll need a hose with a 1/4" barb on one end and an air chuck on the other. The barb connects to the regulator, the air chuck to the Schraeder valve. These hoses can be obtained at local auto parts stores.

Pressurizing and Purging the Housing to remove moisture)

Set the gauge on the regulator to between 10 and 20 psi. Place the air chuck on the Schraeder valve, just as you would on a tire, and press down to begin filling. Continue until you hear air venting from the pressure relief valve (located under plastic cover—see Figure 3 on previous page). Drain all air in housing and refill housing. Repeat an additional 2 times. After refilling for the third time, check pressure in housing. It should read between 5 to 7 psi.

Exploded View for Replacement Parts

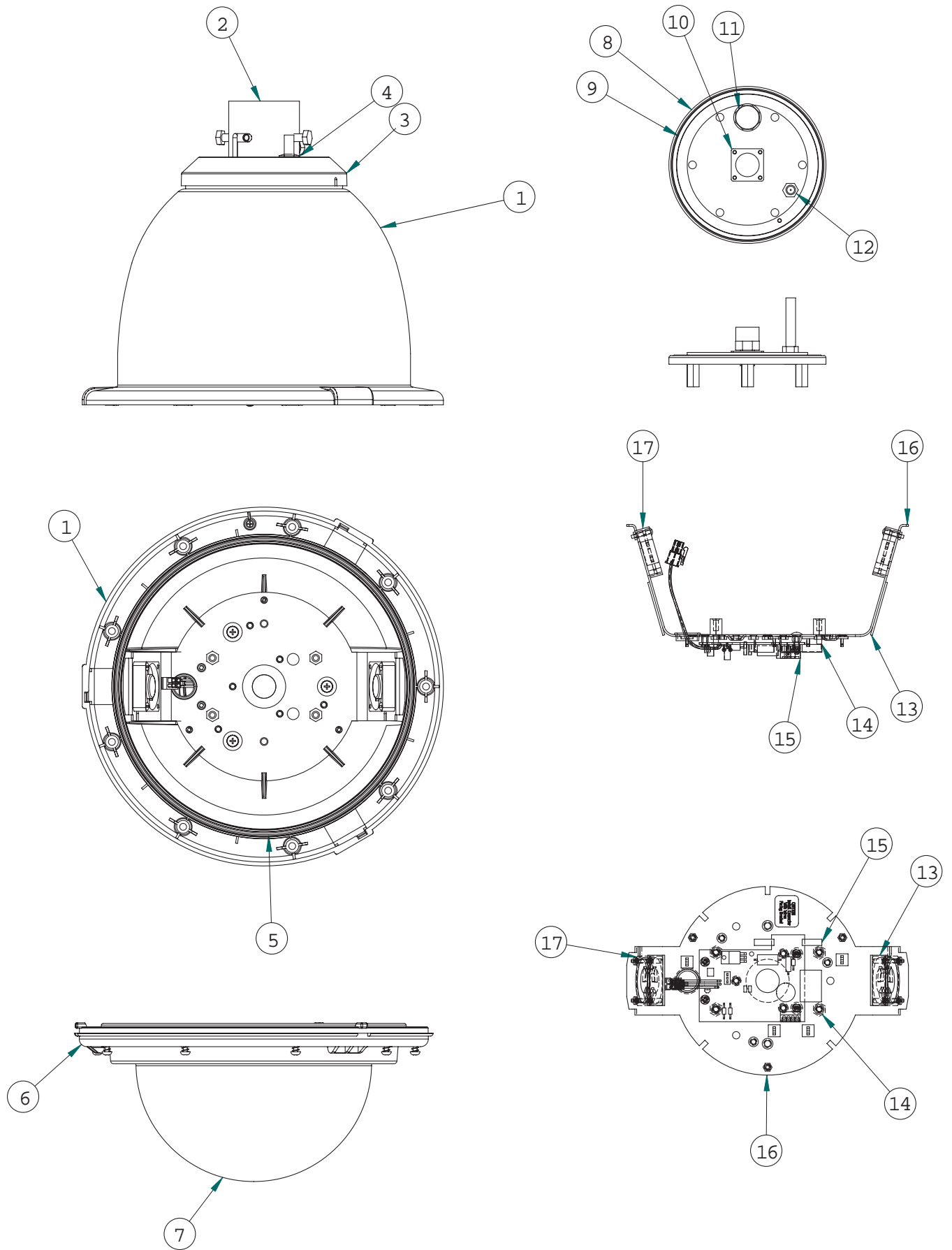

Replacement Parts List

Part No.		Description
1	RPPFDT02	Housing Top (Extended)
2	RPVL1938	Removable Pendant Coupling
3	RPVL1802	Plastic Rain Shroud
4	RPVL1795	Tank Valve Gasket
5	RP96RSORG11	Main O-ring 9.25"
6	RPPFDTR01	Trim Ring w/o Dome
7	RCPFD7	Clear Dome with sealing o-ring
7b	RCTPFD7	Tinted Dome with sealing o-ring
8	RPPFDT03	Internal Sealing Bracket Assembly
9	RP96RSORG10	Small O-ring 4.5"
10	RP70PT07a	Hermetic Connector, Gasket, Cable
11	RP95VALV08	5 to 7 psi Pressure Relief Valve
12	RP95VALV07	Tank Valve
13	RP72HT2170	12VDC Heater
14	RPVL1798a	½" Spacers (Set of 4)
15	RP77FPD8PB112	Connection PCB Assembly
16	RPF060	Main Bracket Assembly
17	RPF080	Blower
N/S	RP40CAPPFD811	External Input Video/Power Cables
N/S	RP47PKP91000	Packet Assembly

Product Registration/Warranty

Thank you for choosing Moog Videolarm. We value your patronage and are solely committed to providing you with the highest quality products available and superior customer service.

Should a problem arise, rest assure that Moog Videolarm stands behind its products by offering impressive warranty plans: 3 Years on all Housings, Poles, Power Supplies, and Accessories and 5 Years on camera systems (SView, QView, Warriors), and InfraRed Illuminators.



Register Your Products Online

Take a few moments and validate your purchase via the Online Product Registration Form at
www.videolarm.com/productregistration.jsp

Register your recent Moog Videolarm purchases and benefit from the following:

- Simple and Trouble-Free RMA process
- Added into customer database to receive product updates / news
- Eliminate the need to archive original purchase documents:
Receipts, Purchase Orders, etc...