



Installation Manual
Wireless Remote Control



Table of Contents

GETTING STARTED	2
UNPACKING.....	2
MOUNTING.....	2
INSTALLATION OF BATTERIES	2
AFTER INSTALLATION OF BATTERIES	3
TESTING THE REMOTE CONTROL.....	3
RESET TO FACTORY SETTINGS.....	4
MAINTENANCE.....	4
TECHNICAL SPECIFICATIONS	4
SAFE DISPOSAL	5
ACTIVATION IN THE ALARM SYSTEM	5

Getting started

Congratulation with your new SuperSail product. We hope that you will be satisfied with the product and we are always available to give support in case you need it.

You can contact us at: support@super-sail.dk

Regards,

SuperSail Support Team

Please read the whole installation manual before starting the installation.

Unpacking

Before you start using the unit you must ensure that the packaging has not been broken or have been injured during transport and that the product is complete and without any visible sign of damage or strained. If this is not the case please contact SuperSail before using the product.

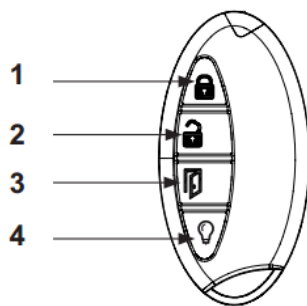

- 1 – Lock button, which turns the Alarm on
- 2 – Unlock button, which turns the Alarm off
- 3 – Not used
- 4 – Not used

Mounting

The Remote Control can be carried in the included key ring.

Installation of Batteries

Open the cover to the battery holder, by pushing the cover away from the unit. Some force is needed to do this.

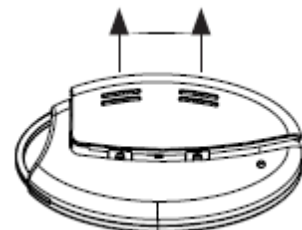

The cover can now be turned upwards and it is possible to get into the battery holder. The cover remains fastened to the Remote Control.

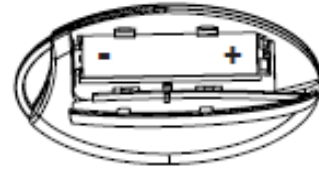

Install the included LR03/AAA/Micro battery in the battery holder as shown on the unit. The batteries are maintained by the spring in the holder.

Close the cover by turning the cover back in place and push it in place towards the center of the Remote Control until it “click” in place. Some force is needed to do this.



Used batteries should not be disposed a domestic waste.

Batteries should be disposed according to the local regulations for batteries

After installation of Batteries

When new batteries are installed, the Remote Control will initialize. This will normally be finished after approx. 2 seconds.

Ready for use is indicated by a short blink with the LED: red, orange and green.

If an error is discovered, this will be indicated by blink with the red light.

5 short red blink after activating one of the buttons	Battery level low Exchange the batteries
1 long red blink and 2 short red blink after activating one of the buttons	Remote Control is defect Exchange the unit

Even that the battery level is low and as long as the battery level allows for it, the Remote Control will remain active and report status to the Alarm system.

If the Remote Control is not able to send status due to low battery level, the error code will be shown again by the LED.

Testing the Remote Control

The Remote Control is installed and activated in the Alarm system as described below under “Activating in the Alarm system”.

When the Remote Control is activated, the alarm must be turned on via the mobile app. Hereafter the Remote Control can be tested.

Push the “Unlock” button and notice that the light in the Remote Control is turned on shortly.

After some seconds (depending on the time for SMS transfer), an SMS “Alarm turned off” is received.

Push the “Lock” button and notice that the light in the Remote Control is turned on shortly.

After some seconds (depending on the time for SMS transfer), an SMS “Alarm turned on” is received.

If a Siren is installed in the Alarm system, a sound signal is heard from the Siren when the Remote Control is used to turn on/off the alarm.

Fault search:

- The light is not turned on when a button is pushed
Remove the batteries and re-insert them – verify that they are aligned correctly.
Self-test as described above under “After Installation of Batteries”, will verify if there are any faults on the Remote Control.
- Light is turned on, but SMS is not received.
Verify if the Remote Control is activated correctly in the Alarm system, as described below under “Activation in the Alarm system”
Verify that the Remote Control ID is keyed in correctly.
Turn on and off the Alarm system from the mobile app.
Try the Remote Control again.

Reset to Factory settings

If the Remote Control for some reason does not function and the batteries have been changed without solving the problem, reset to Factory settings can be a solution to fix the problem.

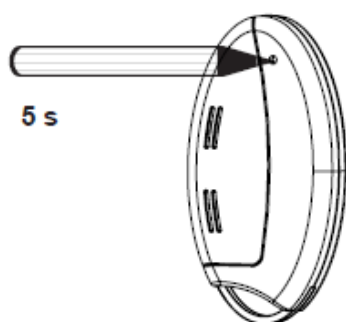

Press and hold the button for 5 seconds, until the LED starts blinking slowly with red light (use a tip pen) – release the button.

Press and hold the button for further 5 seconds, until the light in the main sensor starts blinking faster red (use a tip pen).

Release the button and the LED will stop blinking red.

The Remote Control is reset to Factory settings.

Maintenance

The Remote Control is maintenance free. Repairs should be carried out at an authorized service center.

Cleaning can be carried out with a soft cloth wrenched in lukewarm water.

Cleaning detergent containing solvent can harm the unit.

Technical Specifications

Radio frequency:	868.3 MHz
Typical outdoor range:	100 m
Power:	1 x 1.5V LR03/Micro/AAA battery
Battery life time:	Approx. 5 years (by 5 daily activations)

Protection:	IP20
Color:	Graphite black
Size:	38x75x14 mm (HxBxD)
Weight:	26g (Remote Control ex. battery)

Changes may apply.

Safe Disposal



Should not be disposed a domestic waste.

Electronic equipment should be disposed according to the local regulations for electronic and electronically equipment.

Activation in the Alarm system

After installation and test, the Remote Control must be activated in the Alarm system.

This is performed via the SuperSail app, where the Remote Control is activated via the Alarm menu.

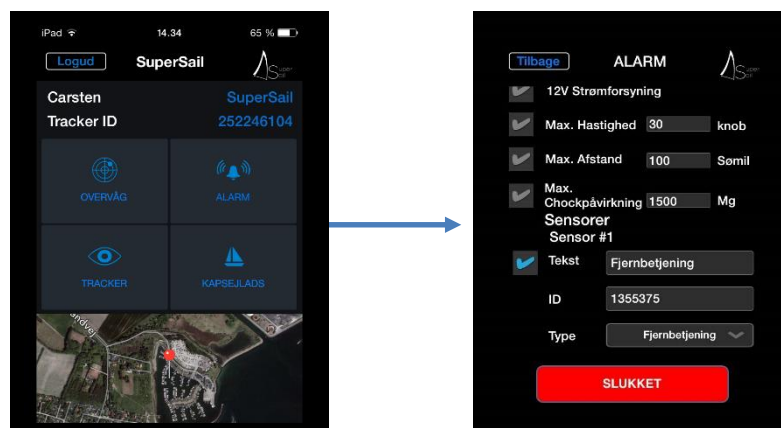

In the above example, we have decided to activate the Remote Control as sensor #1, but all sensors are available for all sensor types.

In the "Text" field you can write a short text, which identifies the installation of the Remote Control.

In the "ID" field, you write the ID written on the back of the battery cover. The ID is furthermore written on the Quick Guide which follows the Remote Control. This ID is unique for the Remote Control and makes it possible for the Alarm system to separate the wireless units. Save the ID in case the ID should be deleted from the app and need to be re-installed later.

In the "Type" field you choose "Remote Control", which specifies that the Remote Control is of the type Remote Control.

Finally the Remote Control is activated by ticking the field next to the "Text" field. This activates the Remote Control in the Alarm system.

Turn the alarm on/off via the mobile app. Only after this the Remote Control is registered correct in the Alarm system, and the alarm is now able to be turned on/off from the Remote Control.