



**User manual**

## Distributor

## Manufacturer

Proton Caretec AB  
Armaturgatan  
SE-331 21 Värnamo  
Sweden

Phone +46 (0)370-69 26 60  
Fax +46 (0)370-69 26 70

E-mail [caretec@proton.se](mailto:caretec@proton.se)  
WWW [www.proton.se](http://www.proton.se)

Certified according to  
ISO 9001 and ISO 14001

# Table of Contents

Distributor .....	2
Manufacturer .....	2
Table of Contents .....	3
Accessories .....	4
Product description.....	5
Marking .....	6
e-bed Marking .....	6
Return handling .....	7
Handling .....	7
Installation .....	14
How to assemble the bed.....	14
Headrest.....	21
How to disassemble the headrest.....	21
Headrest.....	22
How to assemble the headrest. ....	22
Disassembling .....	23
How to disassemble the bed. ....	23
Accessories.....	29
e-support and s-support. ....	29
Hand Control Unit.....	30
Multi-position setting range. ....	30
Reclining position (sleeping position).....	30
Sitting posture. ....	31
Height adjustment.....	32
Back-rest adjustment. ....	33
Leg support adjustment. ....	34
How to prepare the bed for transport.....	37
Patient lift .....	39
A few words of advice for the user .....	40
The multi-position functions and applications .....	40
How to sit up at the edge of the bed (to lay down in the bed).....	41
How to rise from the bed.....	42
Care and nursing.....	43
Sanitary care in the bed .....	43
Inspection .....	44
Cleaning .....	44
Checklist for periodic inspection.....	44
Technical information .....	45
Regulations .....	45
Technical information .....	45
Material .....	45
Weights and measurements .....	45
Environment for use .....	45
Location of faults schedule.....	46

## Accessories

	<b>Product number</b>
Raising aid side-support	19203
Side-support	19204
Side-support higher model	19205
Raising aid, turnable, right	19206
Raising aid, turnable, left	19207
Transport bag/set	13620
Transport aid for a half e-bed	14194

## Product description

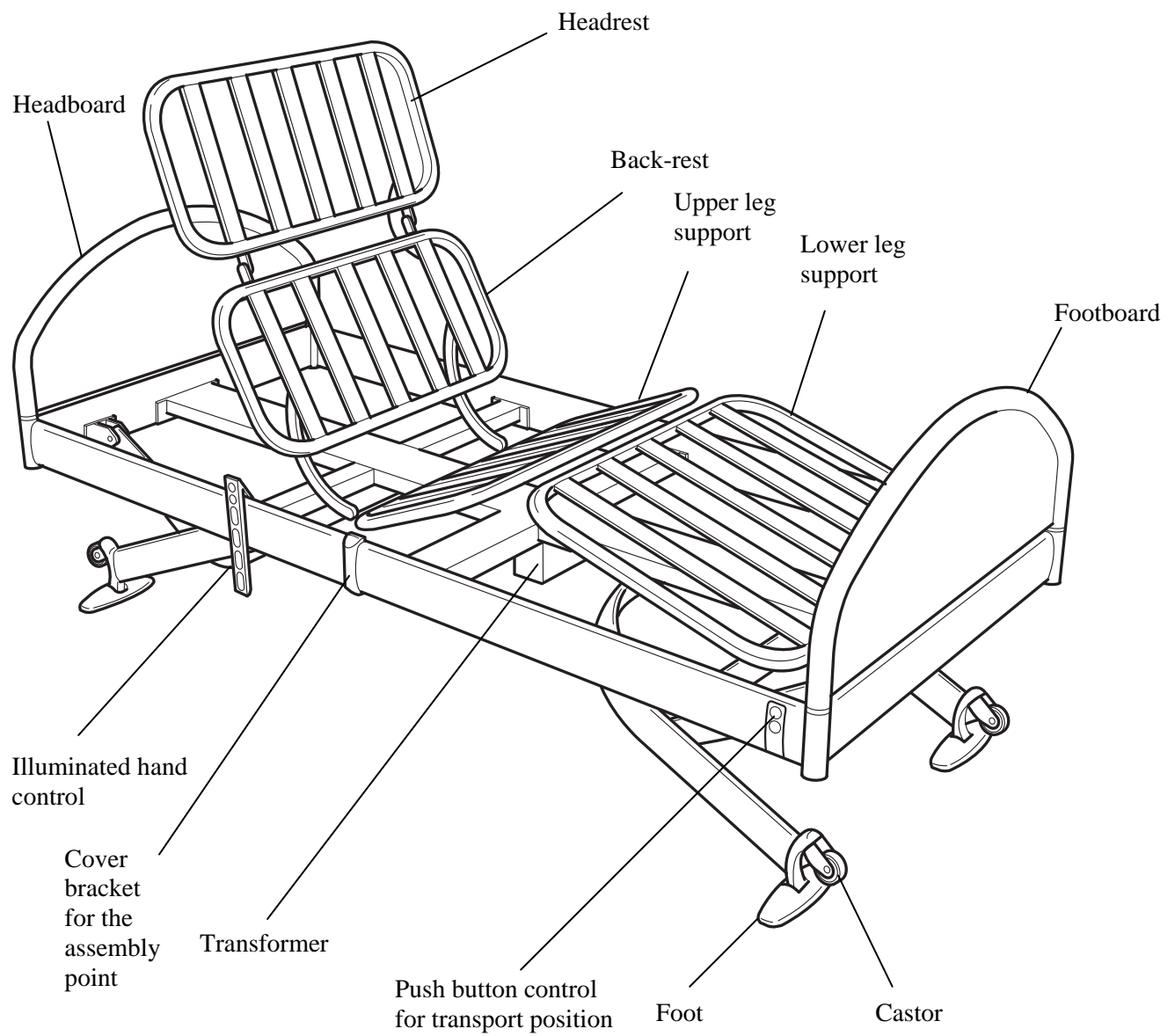

## Marking

### e-bed Marking

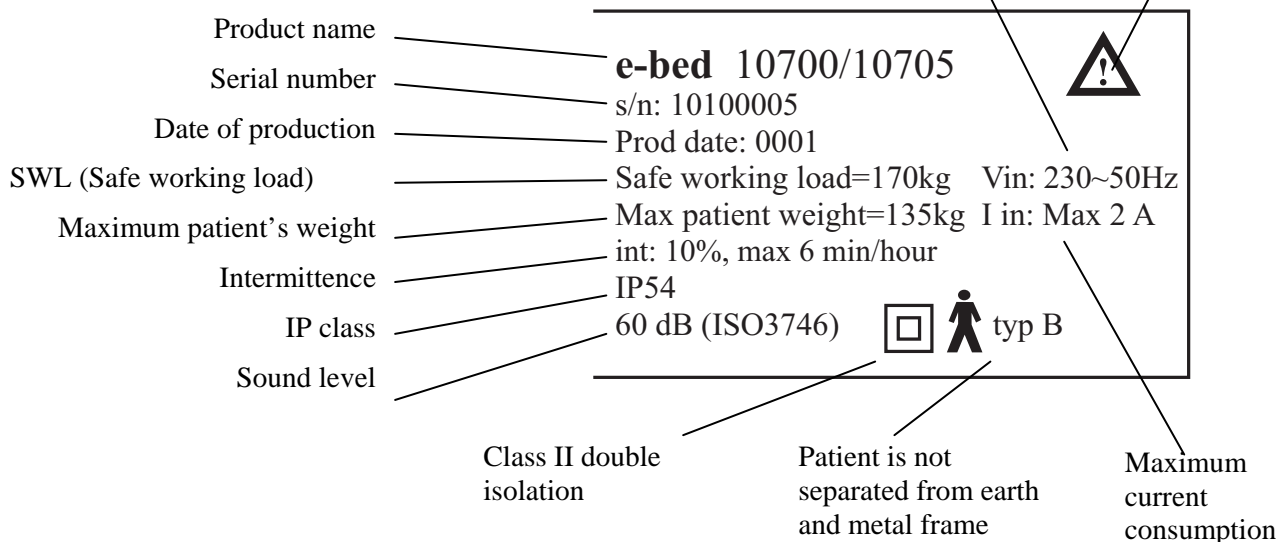
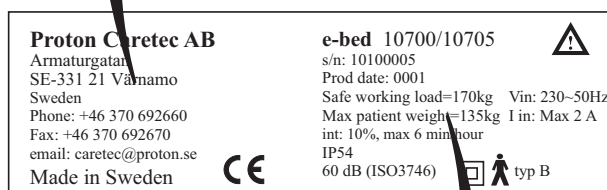
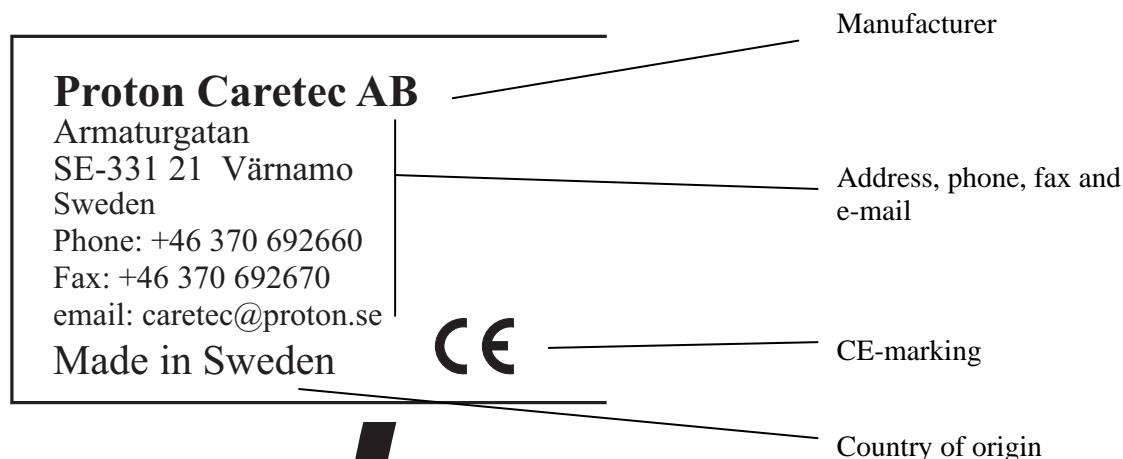

## Return handling

The bed shall be returned to the distributor or to the manufacturer to be destructed.

## Handling

Handle with care! N.B! When assembling/disassembling the bed in home environment, take care not to scratch the floor. The transport bags can be used to protect the floor!

## Installation

How to assemble the bed

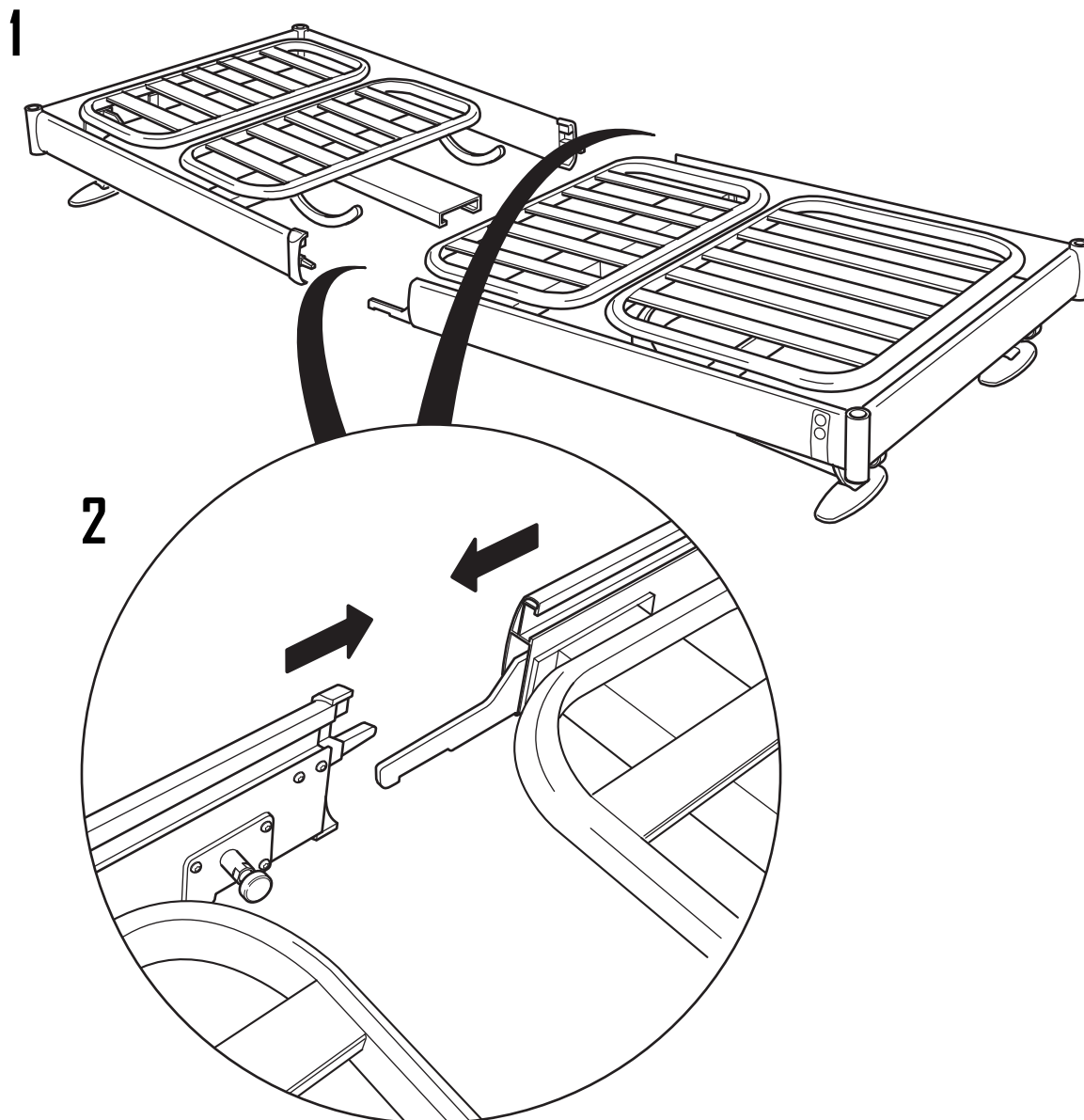



3

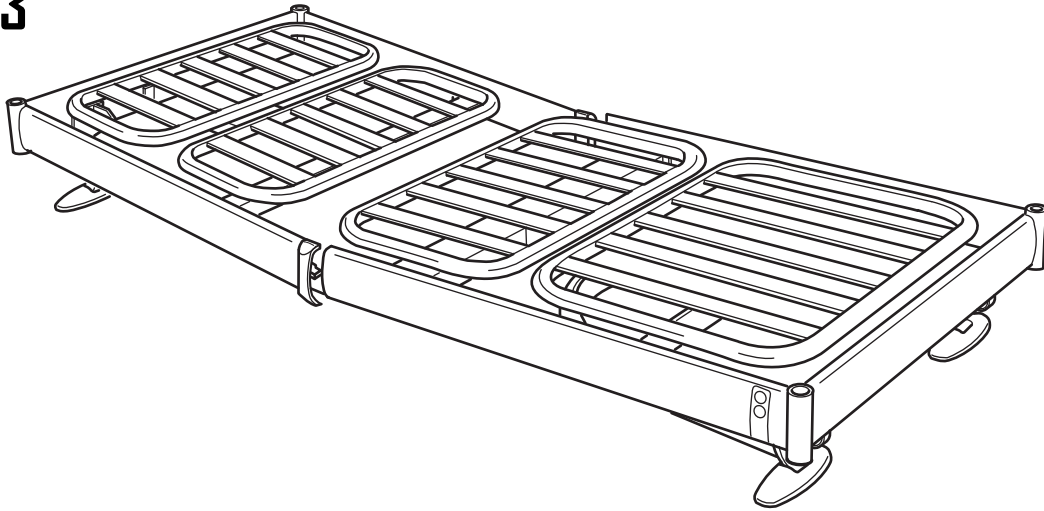

4



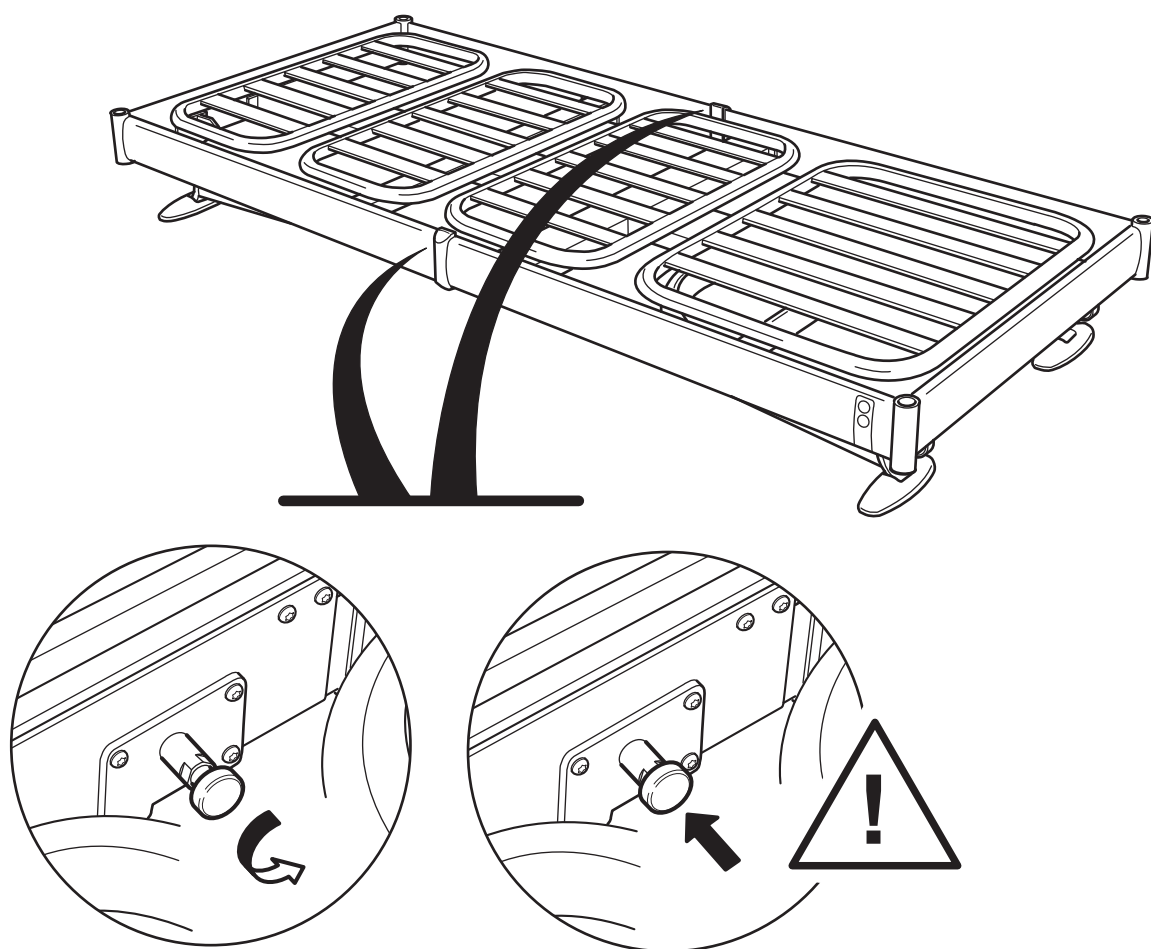

7

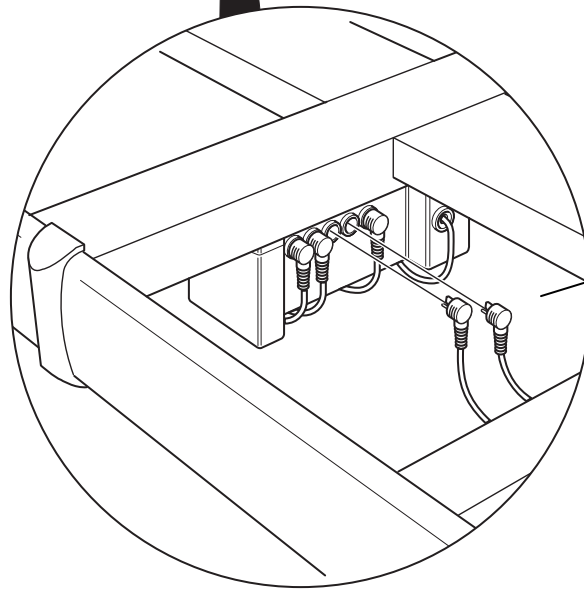
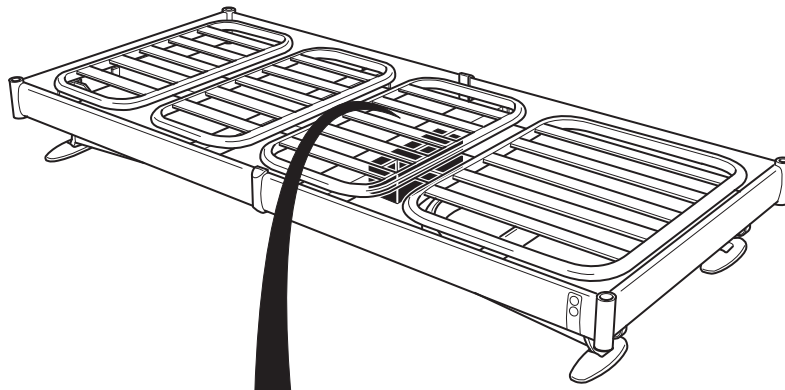

Make sure that all plugs are completely inserted to their end positions.

8

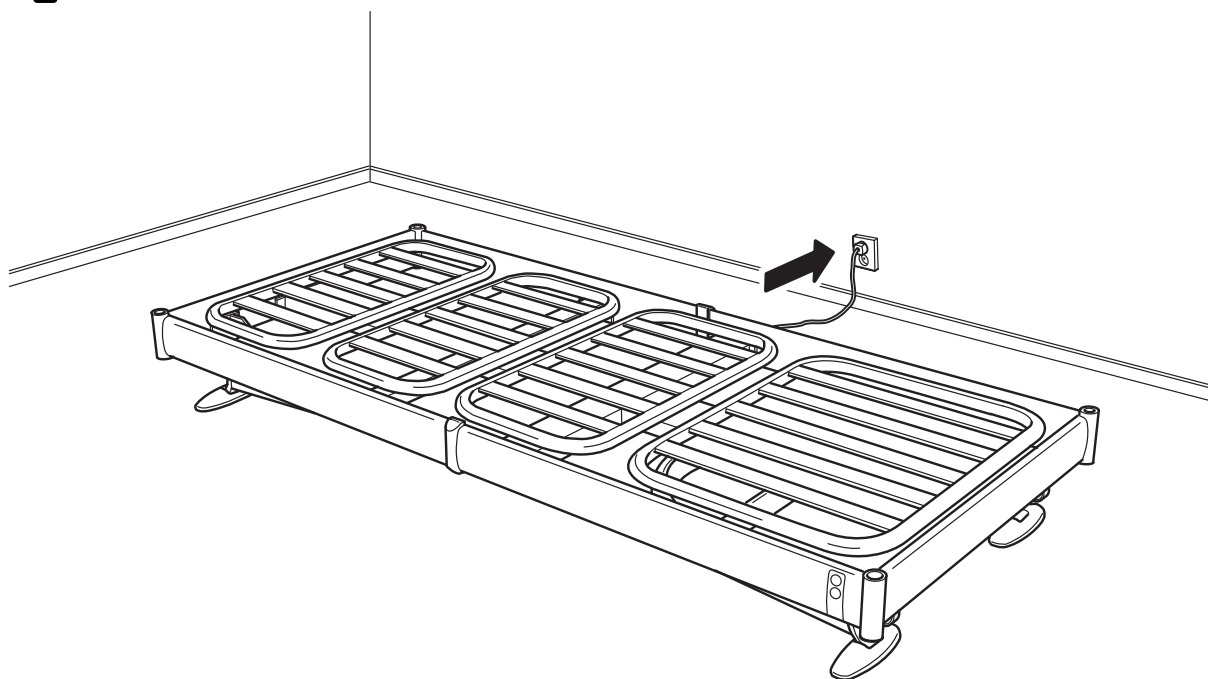

9

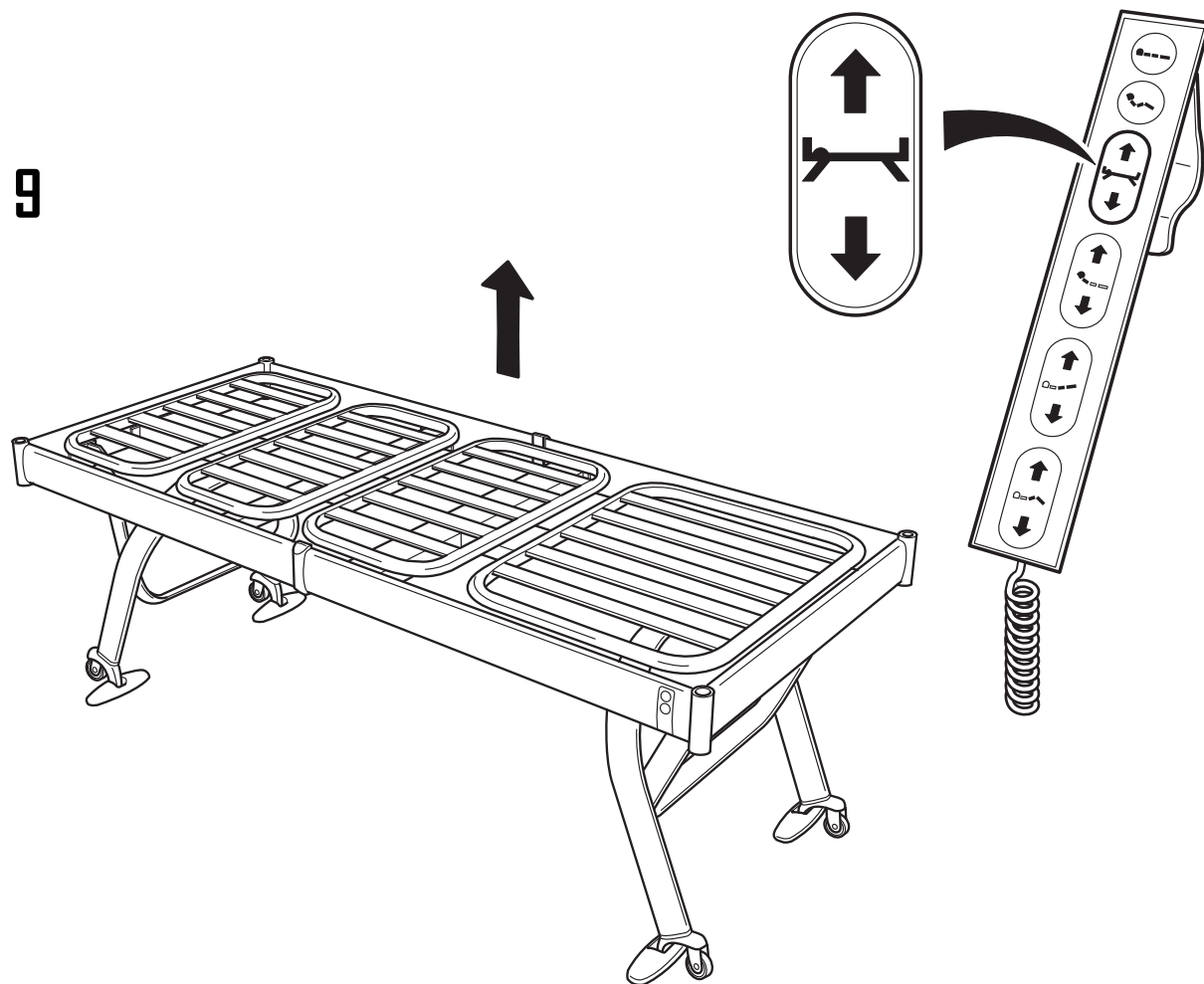

10

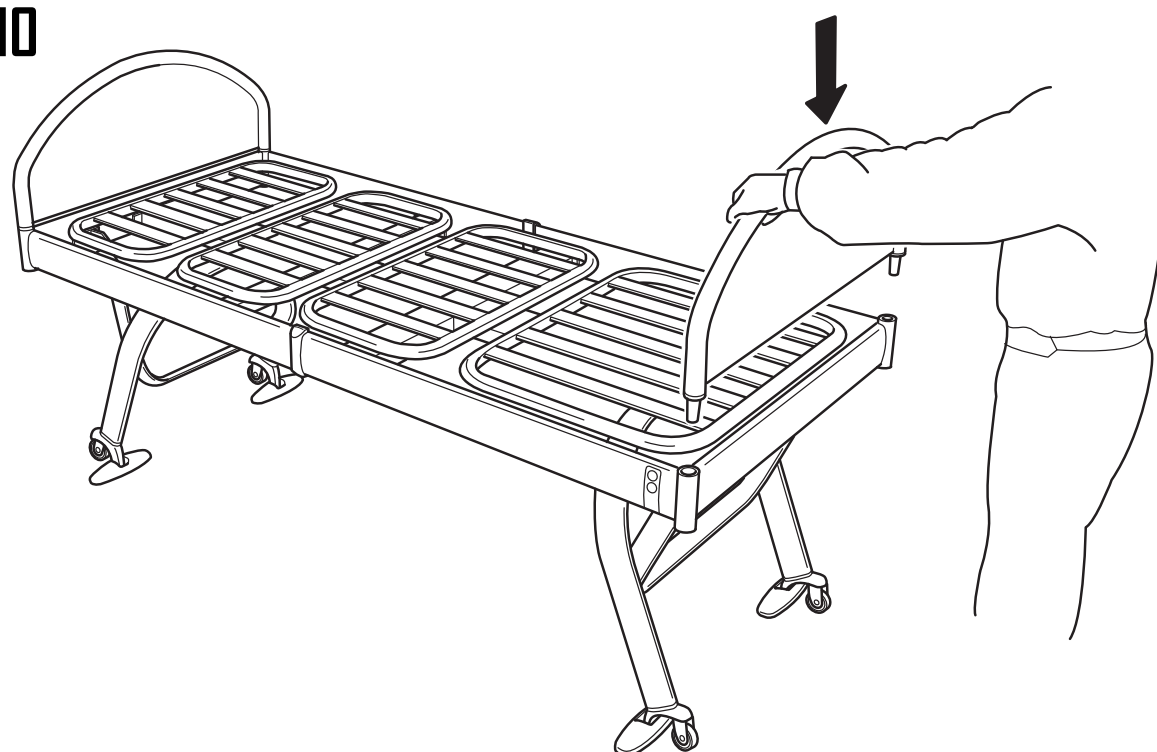

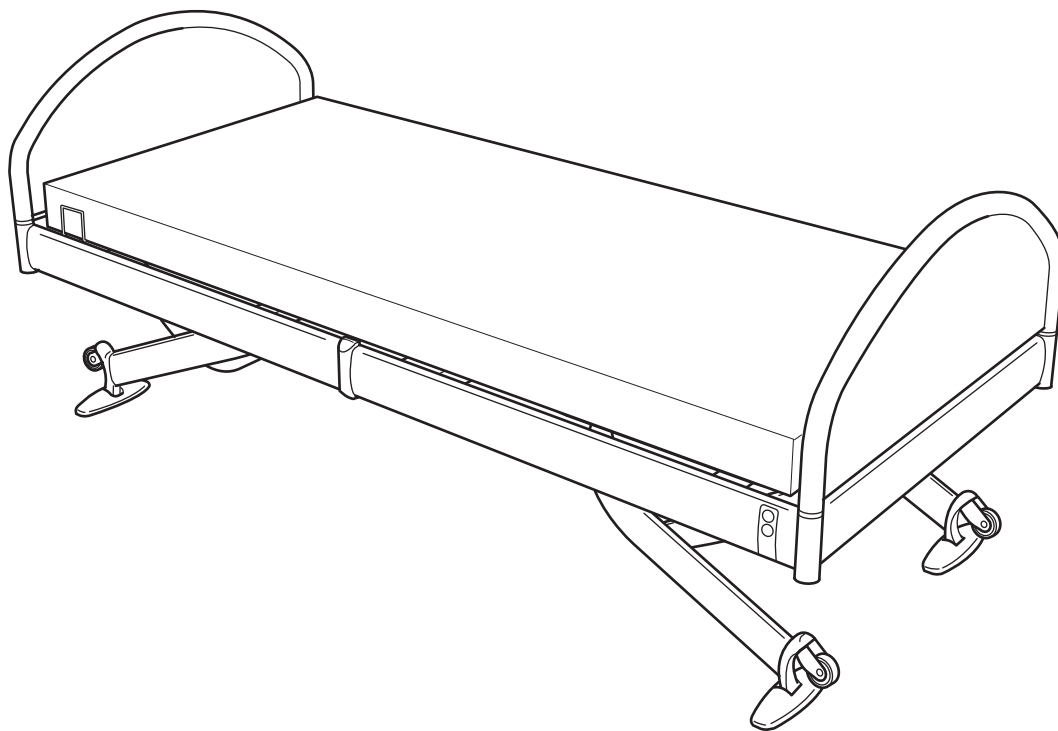

Transport. See page 38 'How to prepare the bed to for transport'.

## Headrest.

How to disassemble the headrest.

**1**

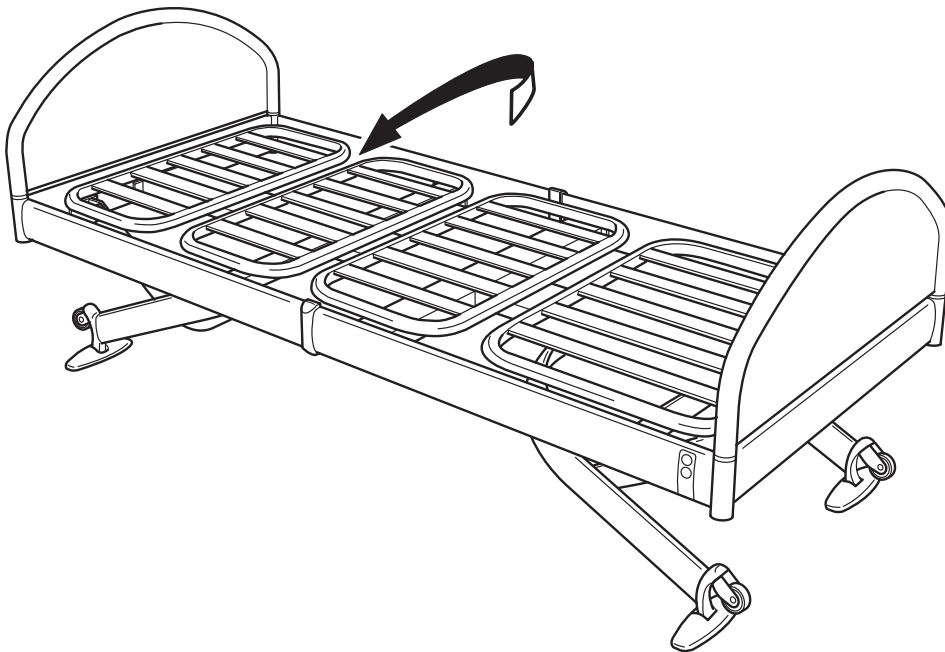
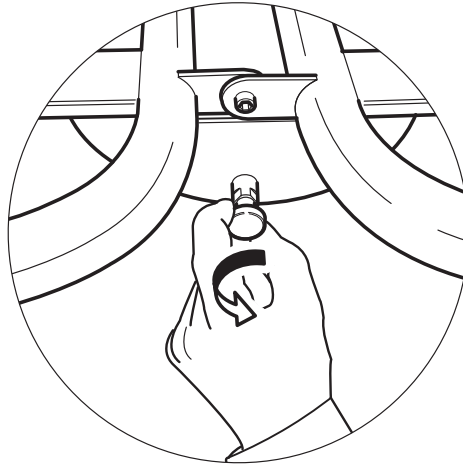

**2**

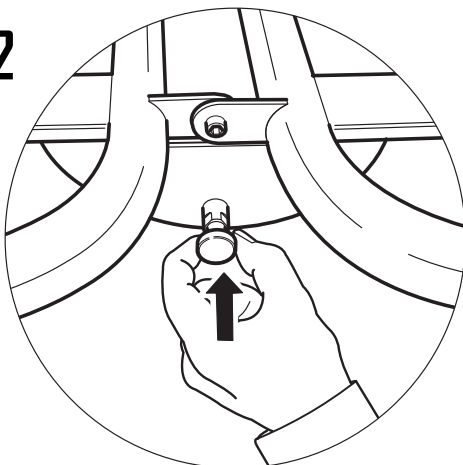

**3**

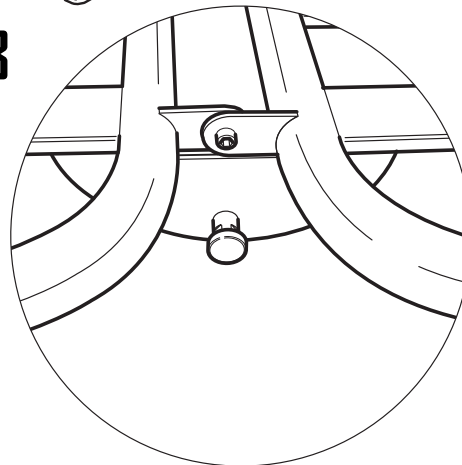

## Headrest.

How to assemble the headrest.

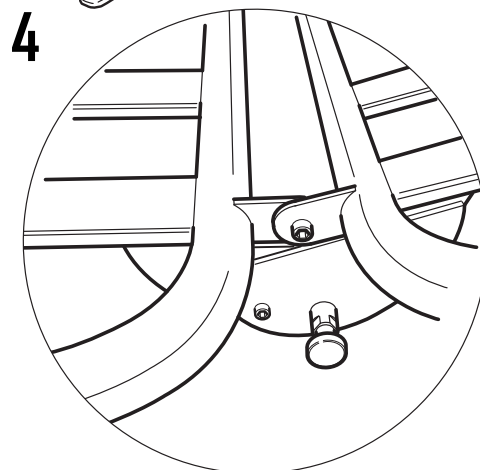
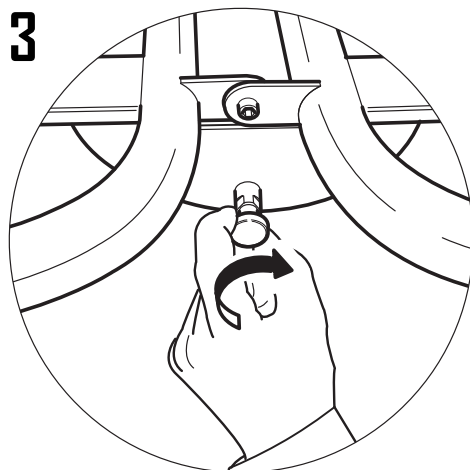
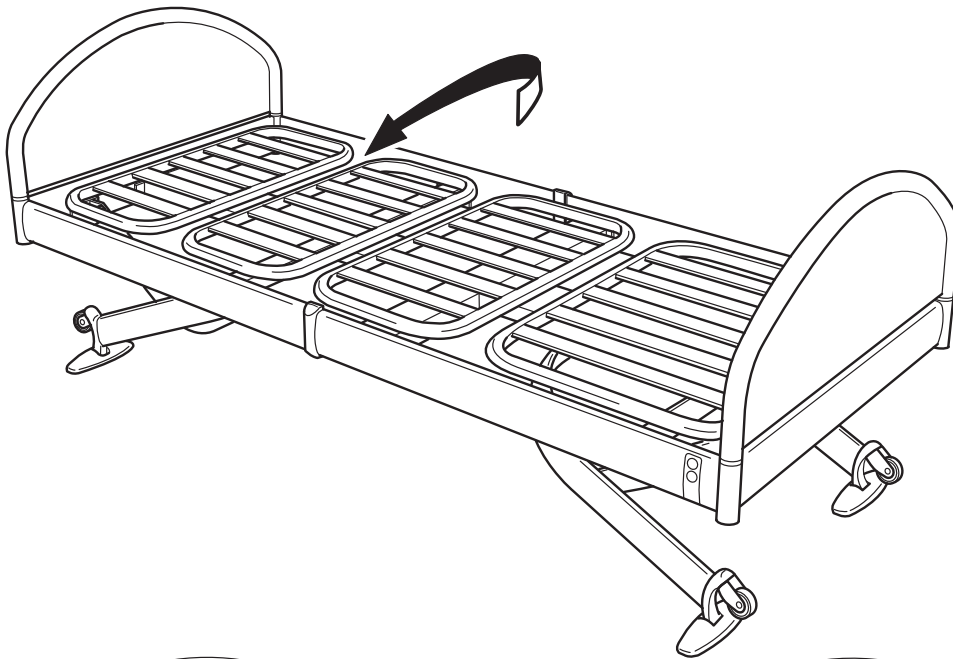
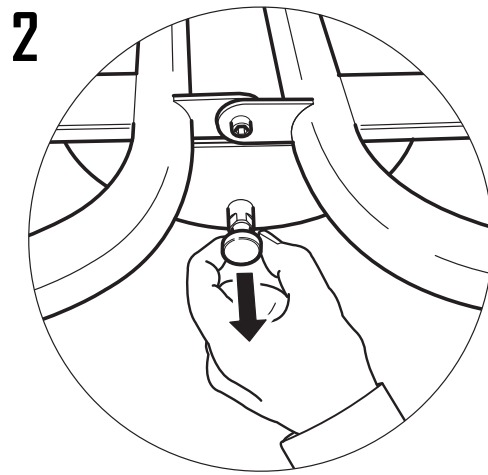
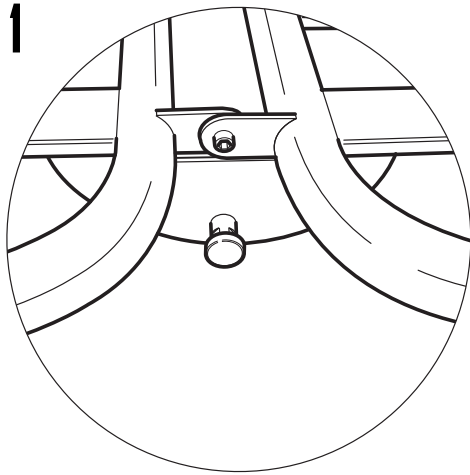



## Disassembling

How to disassemble the bed.

1

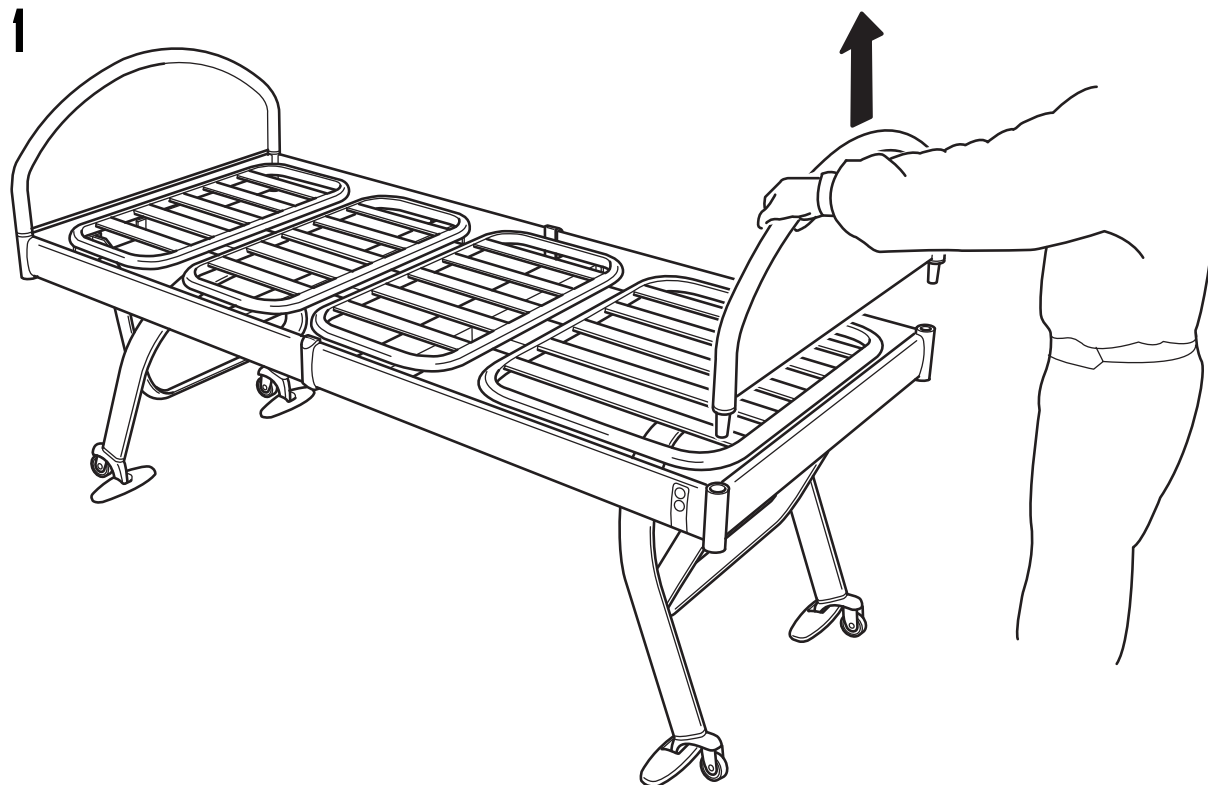

2

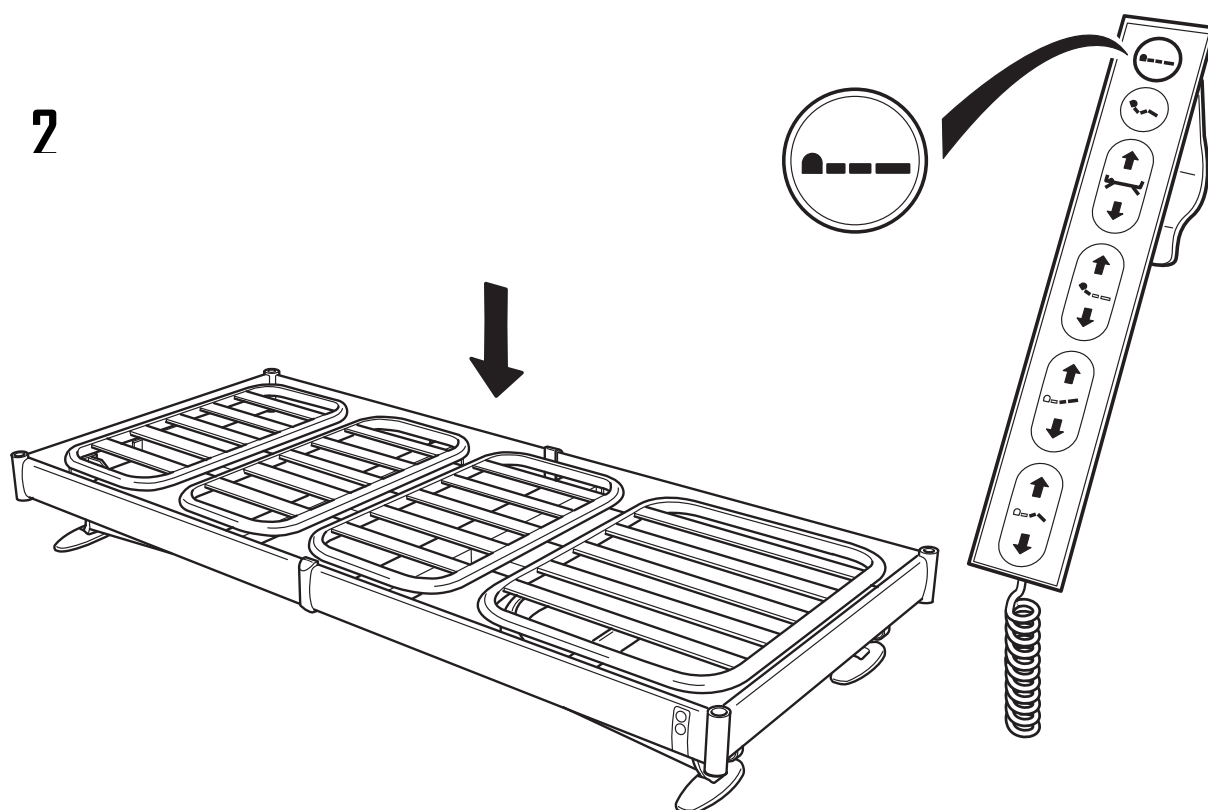

3

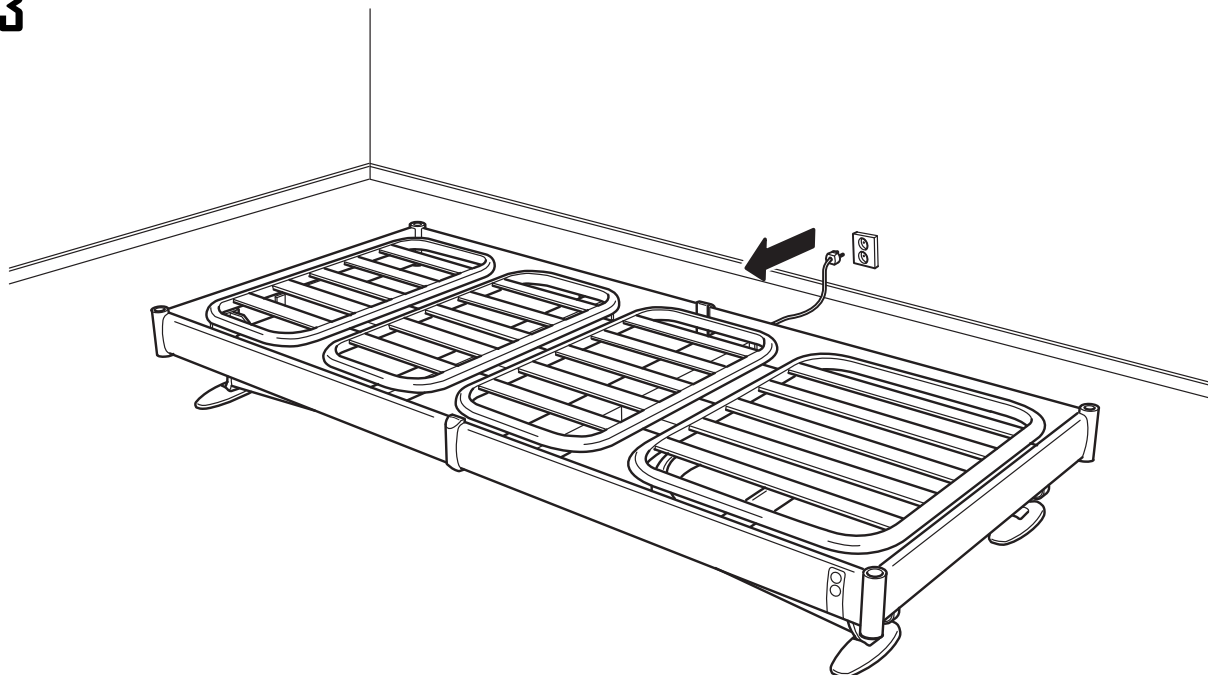

4

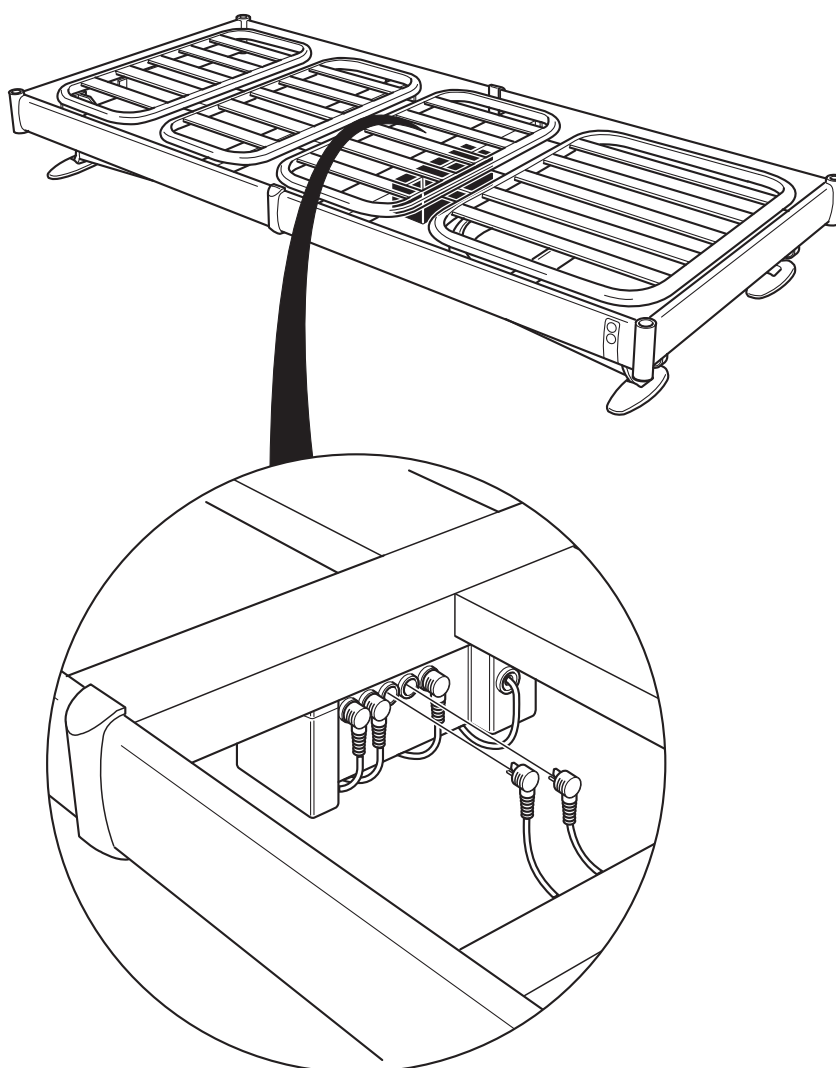

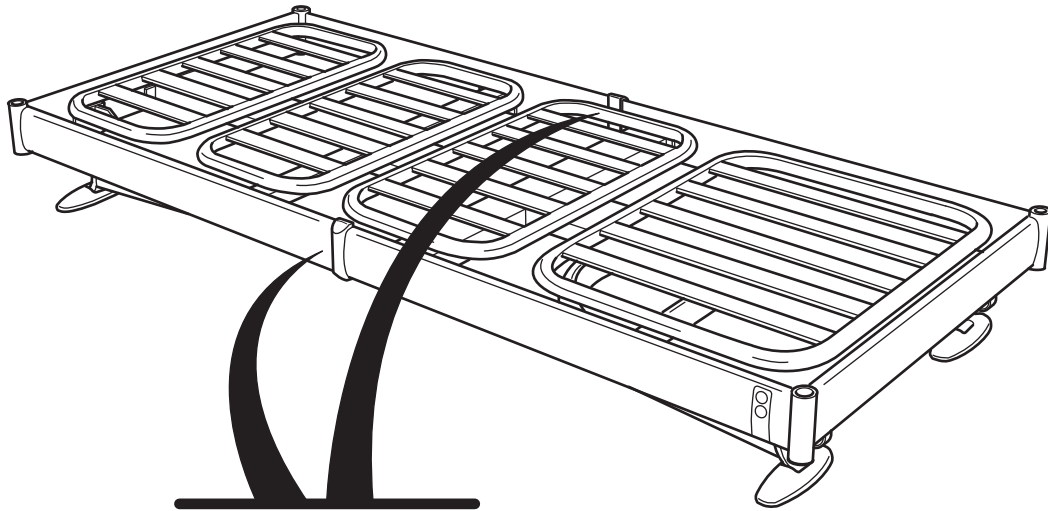

**5**

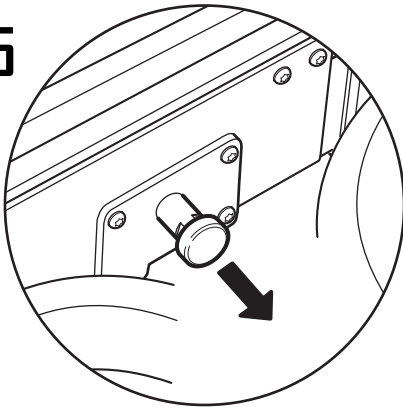

**6**

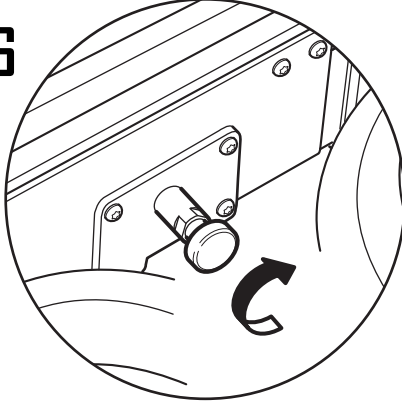

7



8

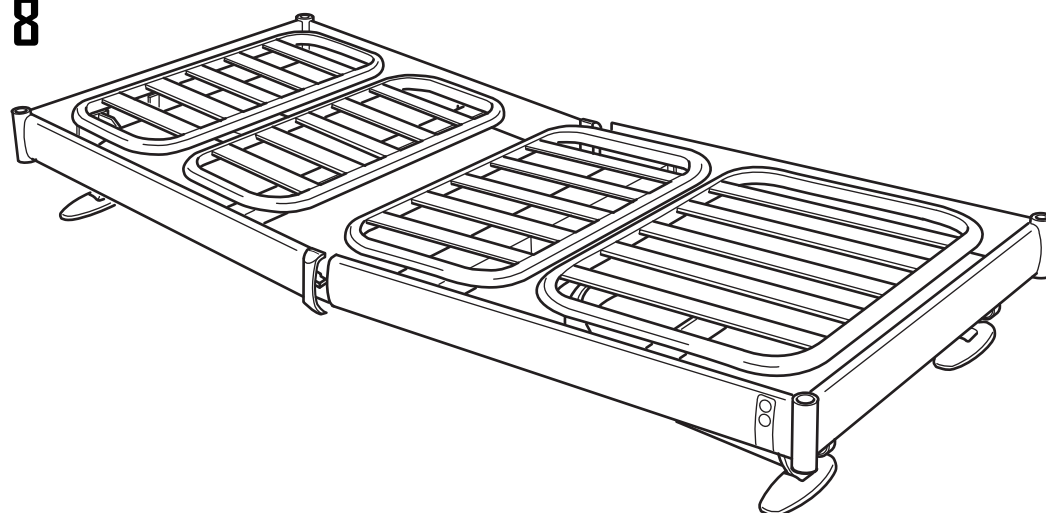

9

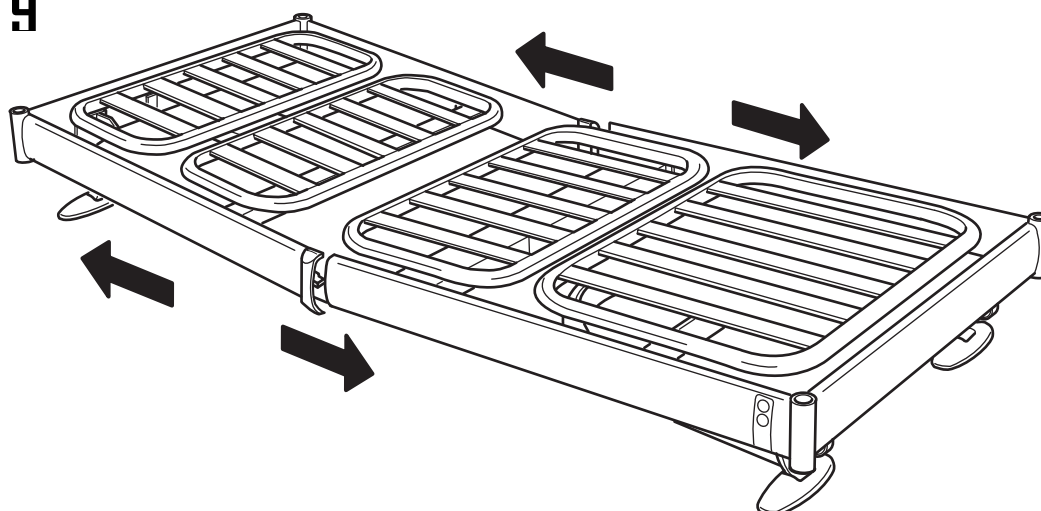

10

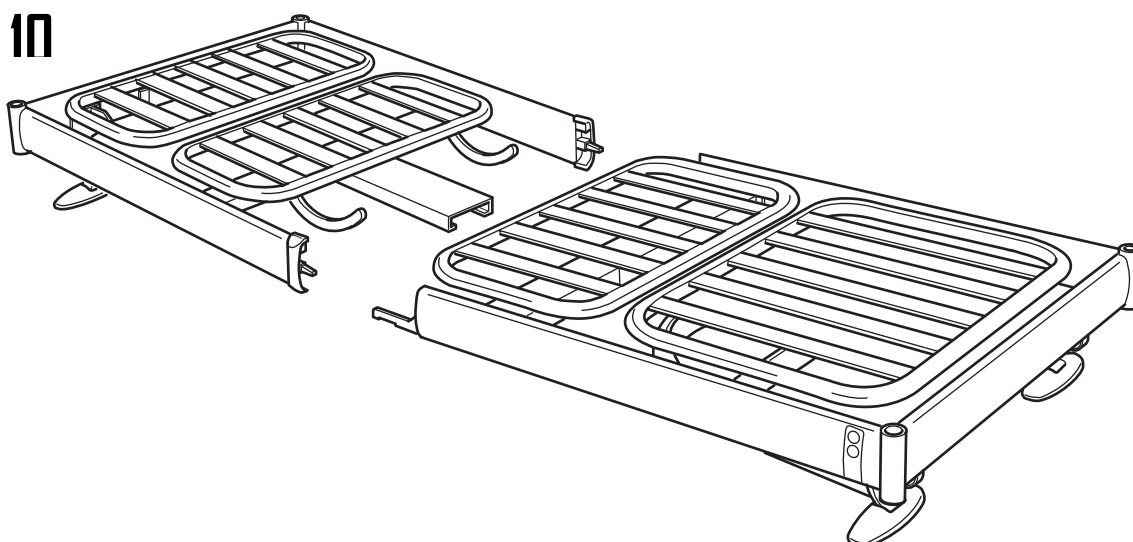

## Accessories.

e-support and s-support.

## How to attach the supports.

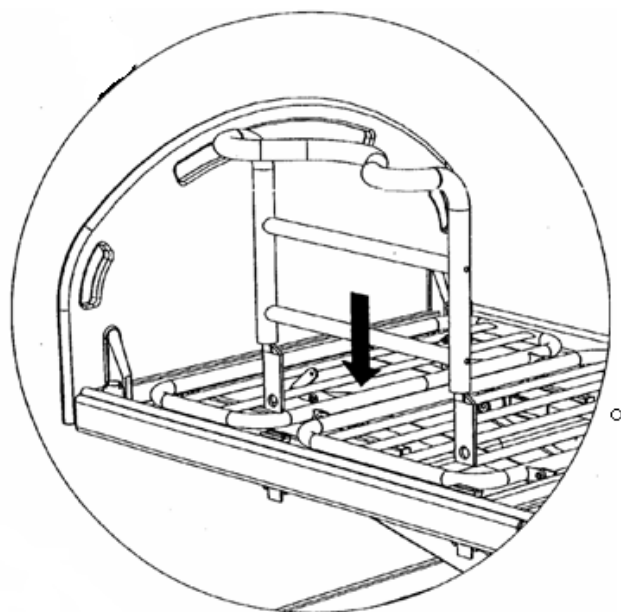

## How to remove the supports.

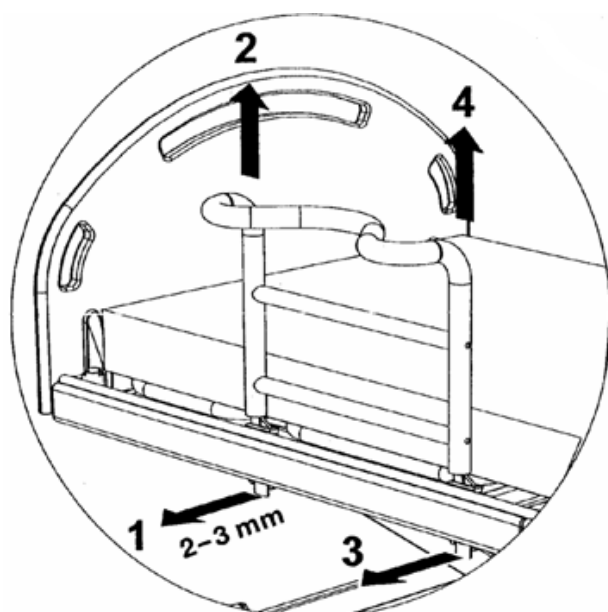

## Hand Control Unit.

### Multi-position setting range.

*N.B. ! Keep the chosen button pressed until the desired position has been reached.*

Reclining position (sleeping position).

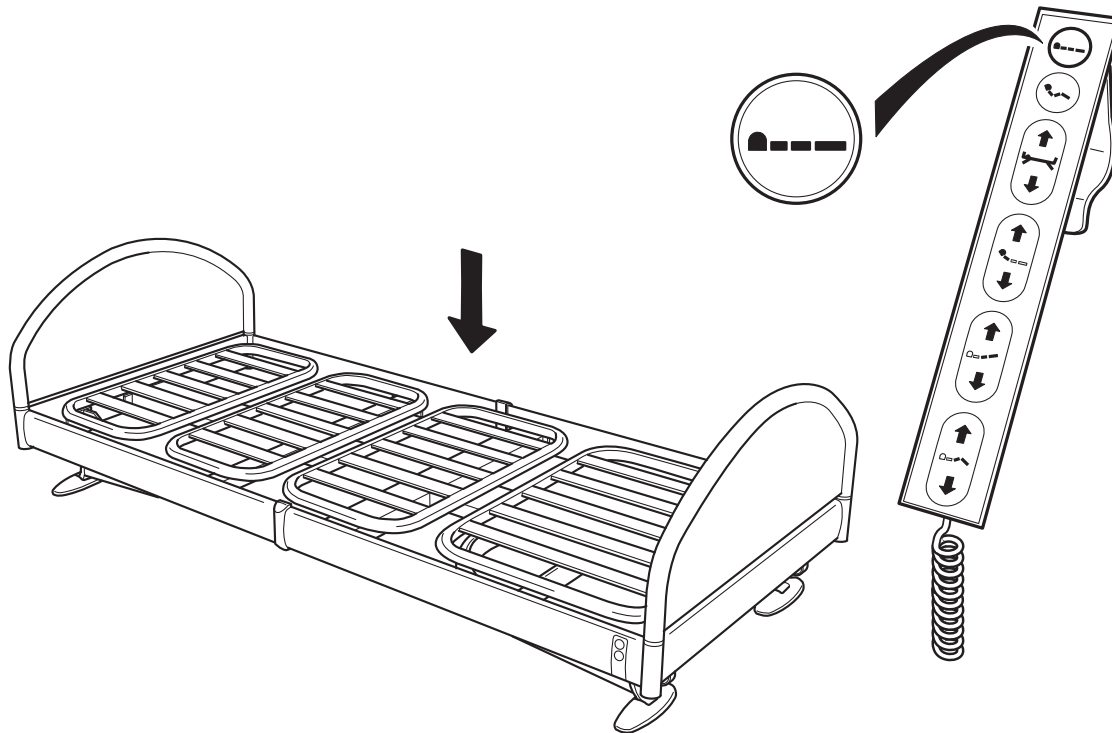



Sitting posture.

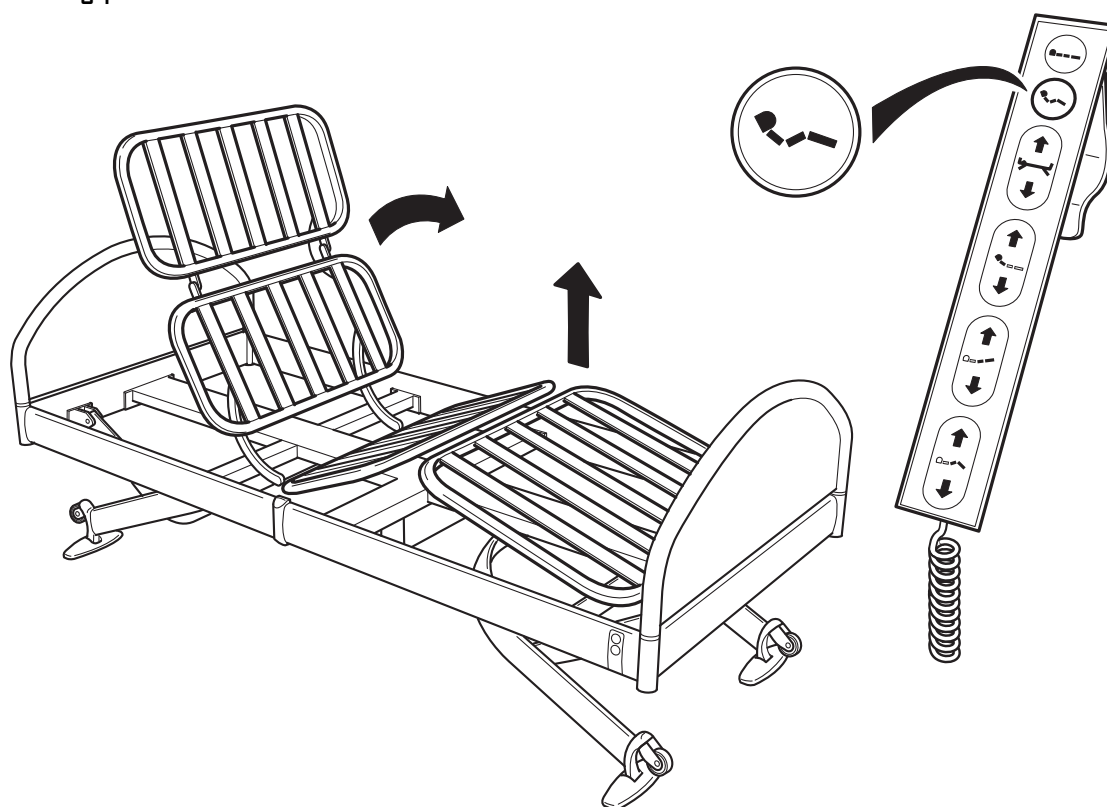

Height adjustment.

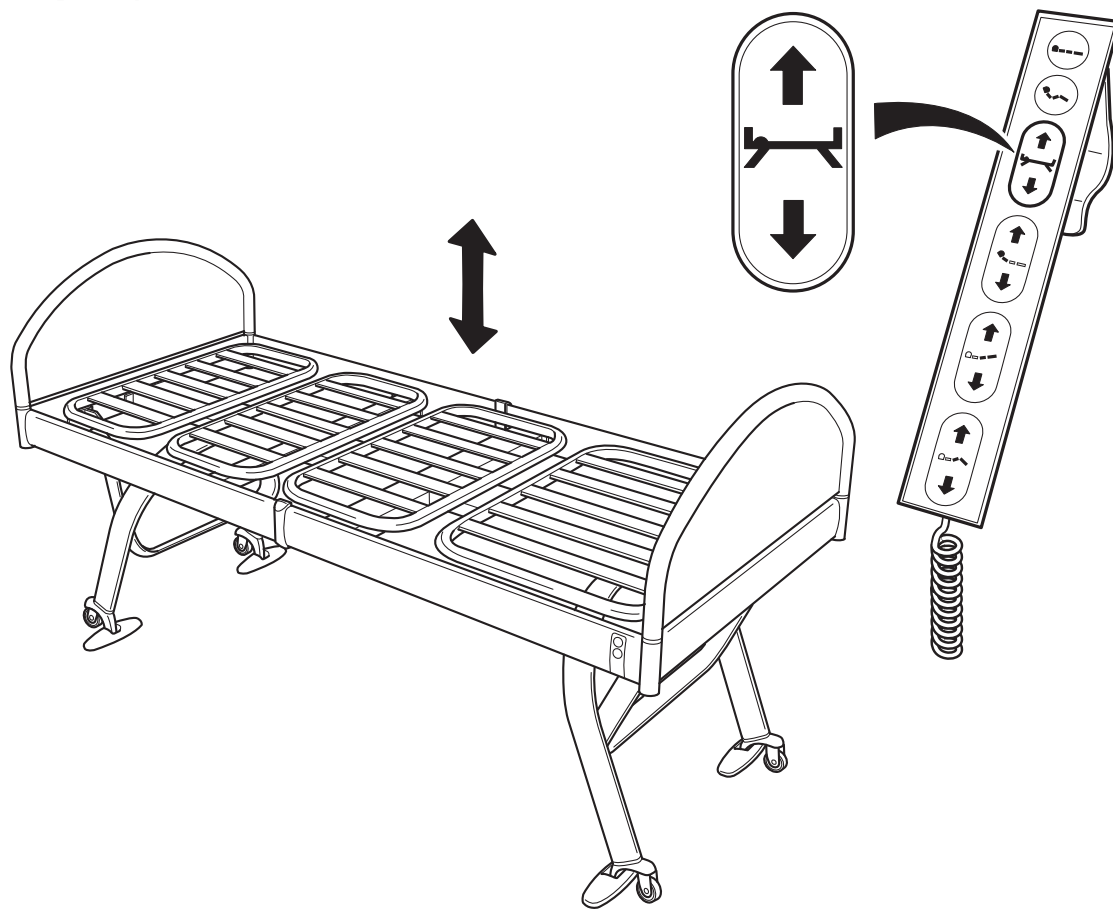

Tip! If the height adjustability is frequently used, we advise you to synchronise the lifting motors by driving the bed to its lowest position.

## Back-rest adjustment.

**a**

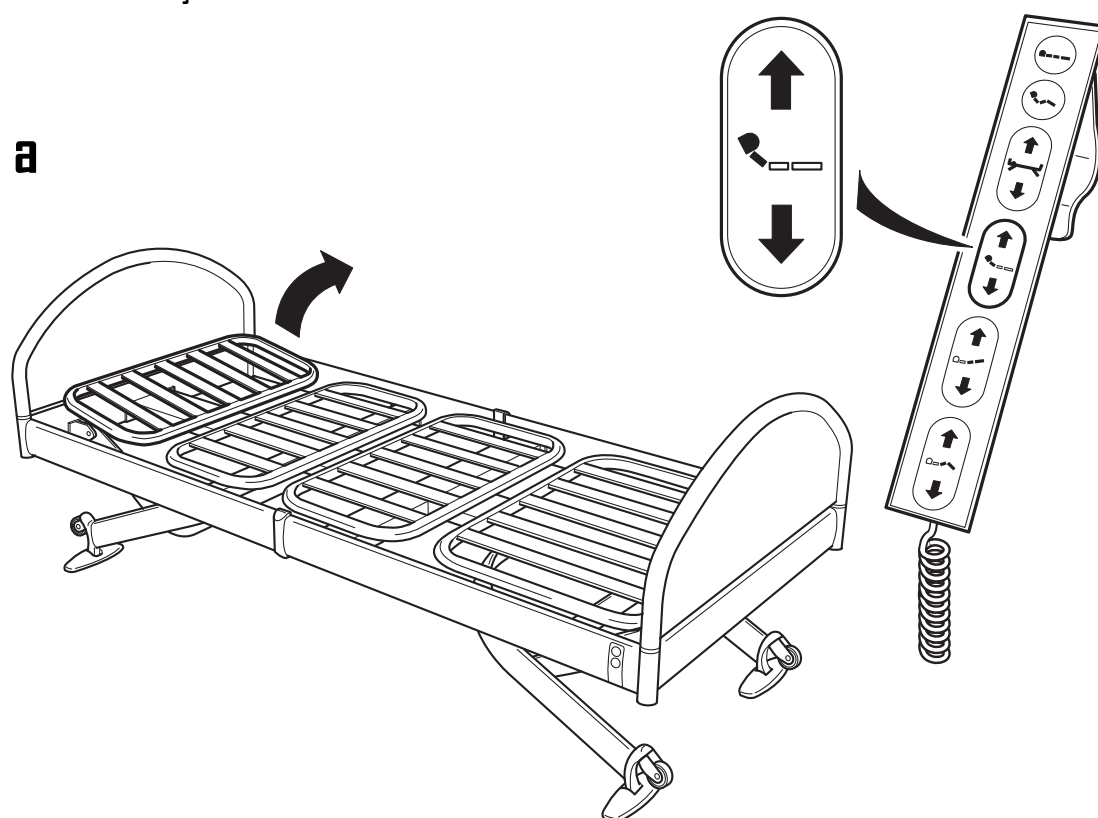

**b**

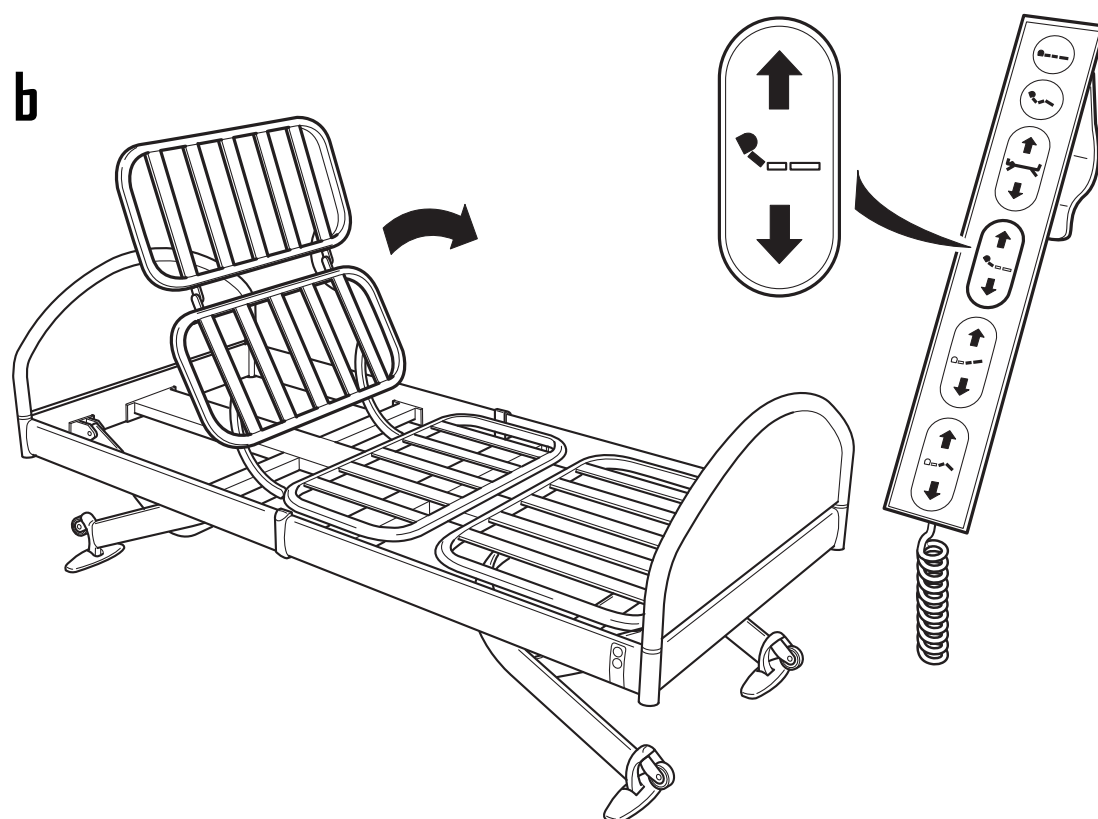

## Leg support adjustment.

1

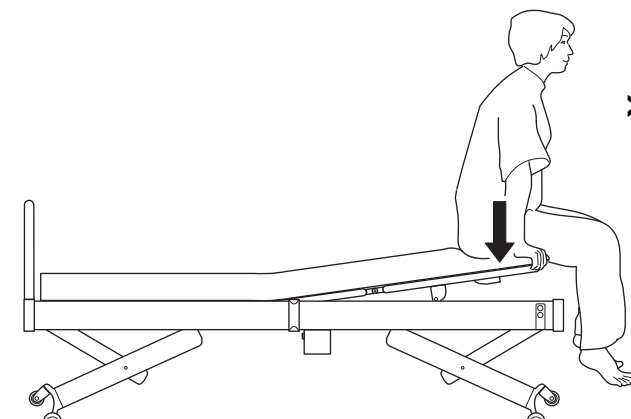
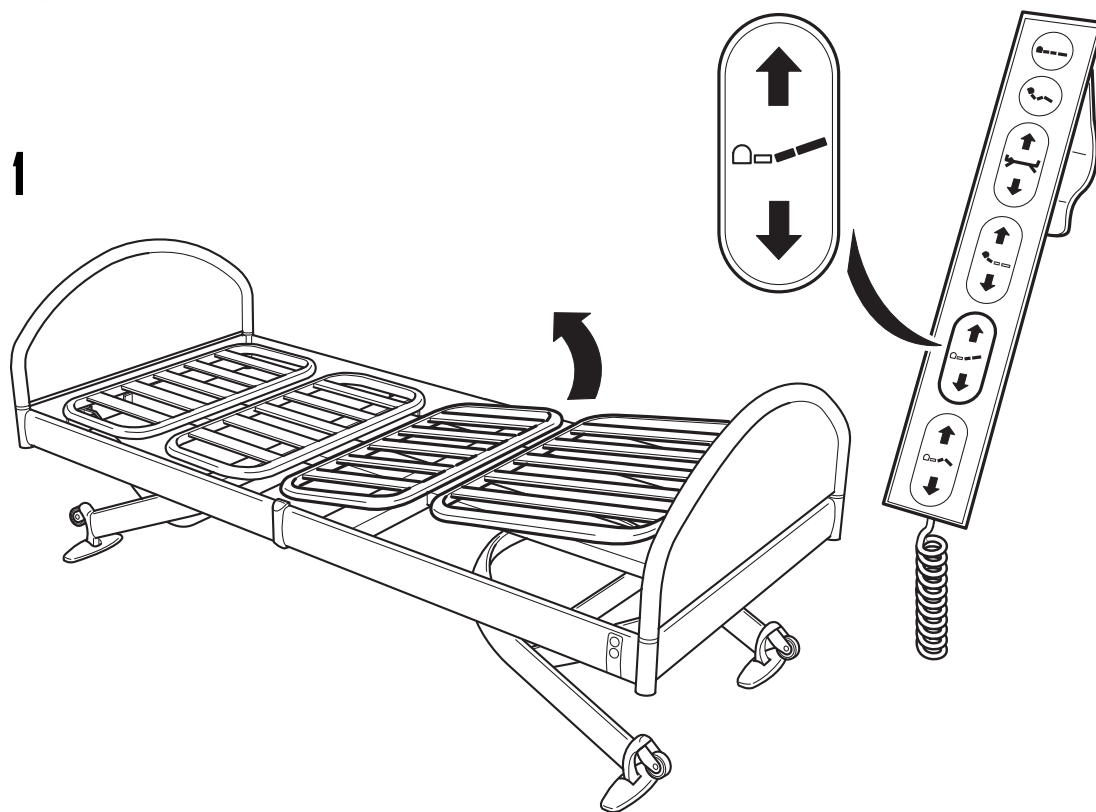

**>30 kg**

N.B! If the leg supports are elevated and loaded with more than 30 kgs, they will sink. As soon as the load has been removed they will automatically return to the elevated position.

2

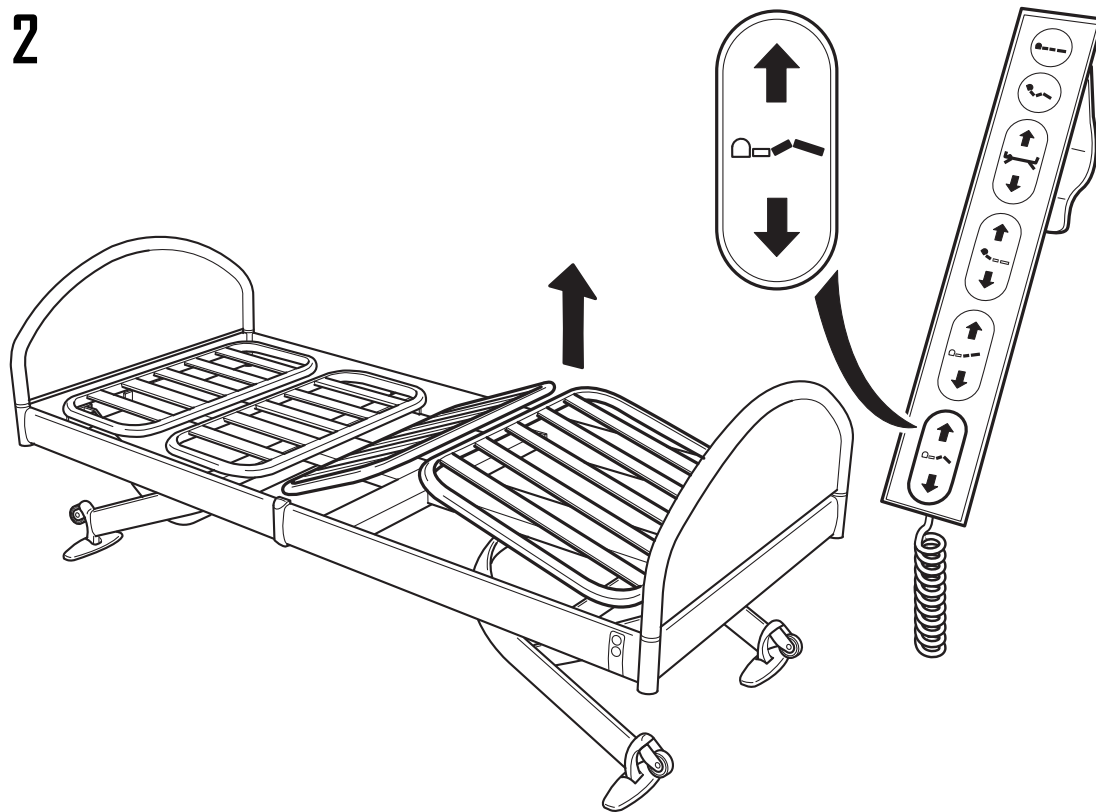

3

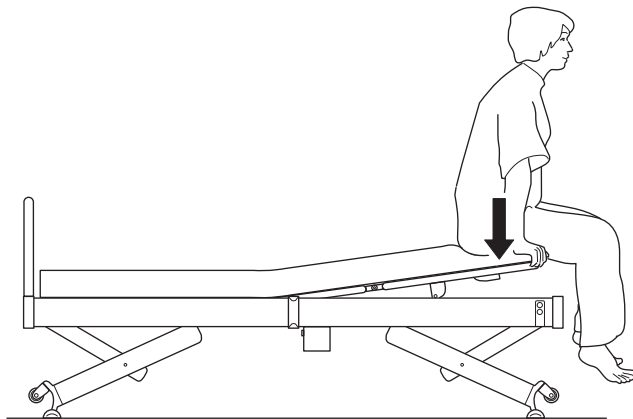
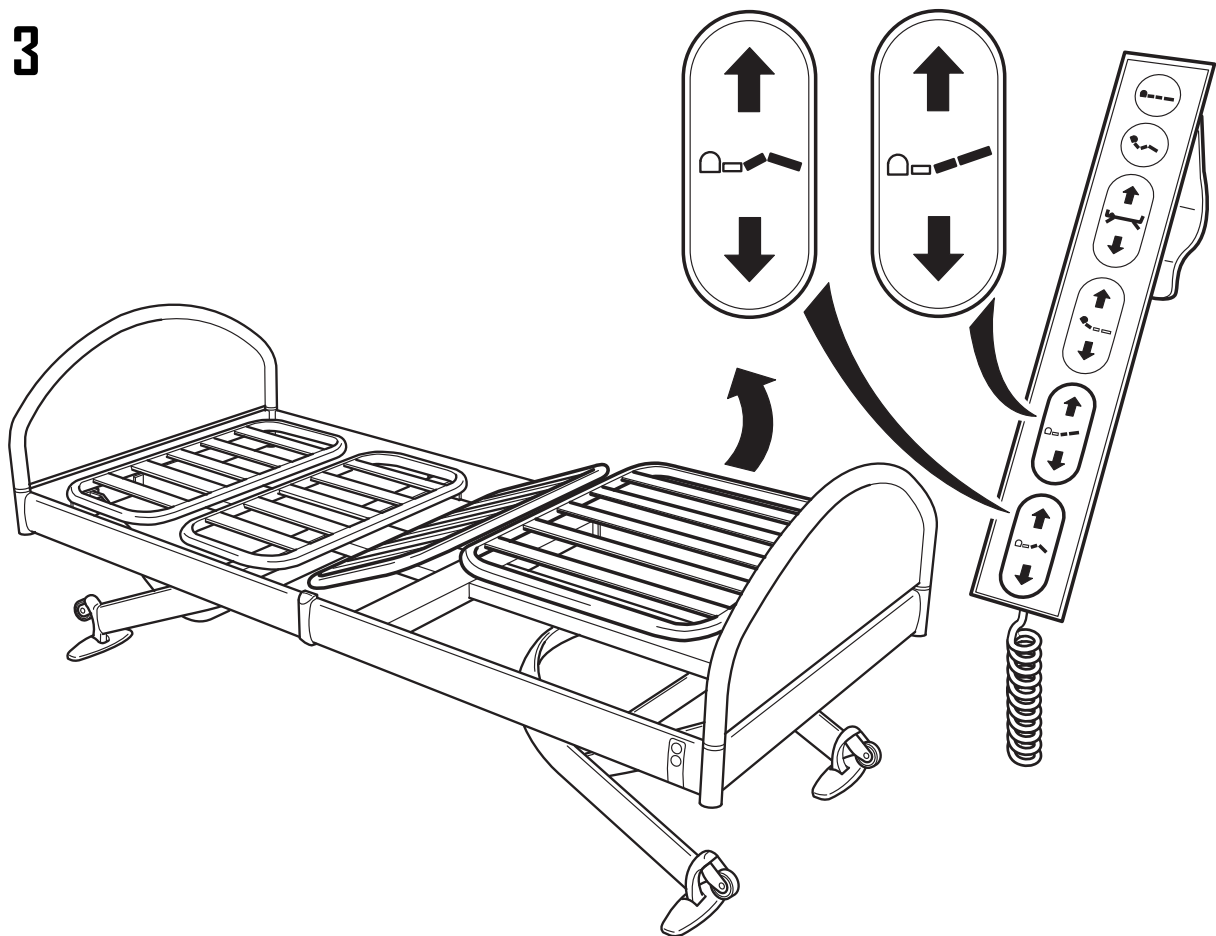

**>30 kg**

N.B! If the leg supports are elevated and loaded with more than 30 kg, they will sink. As soon as the load has been removed they will automatically return to the elevated position.

## Transport position.

How to prepare the bed for transport.

Keep the button pressed until the bed reaches and stops at its highest position.

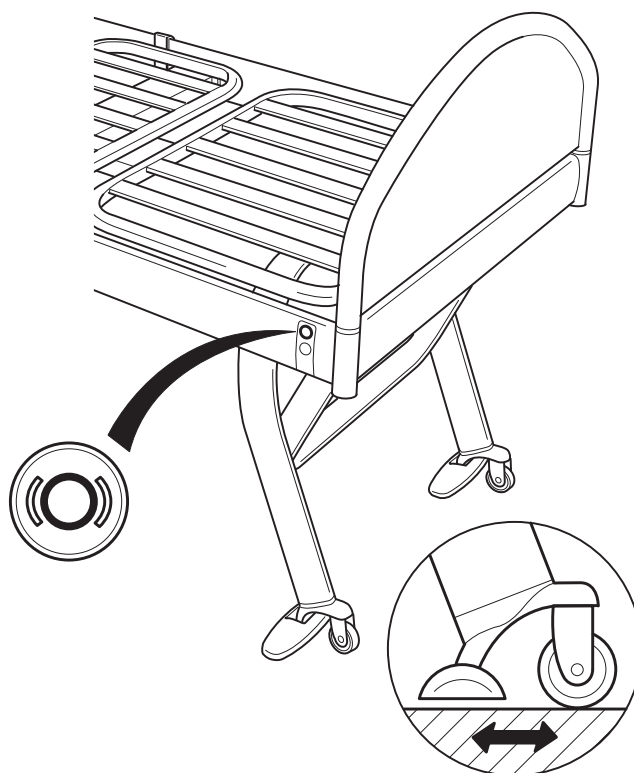

## How to re-lock the bed feet after the transport.

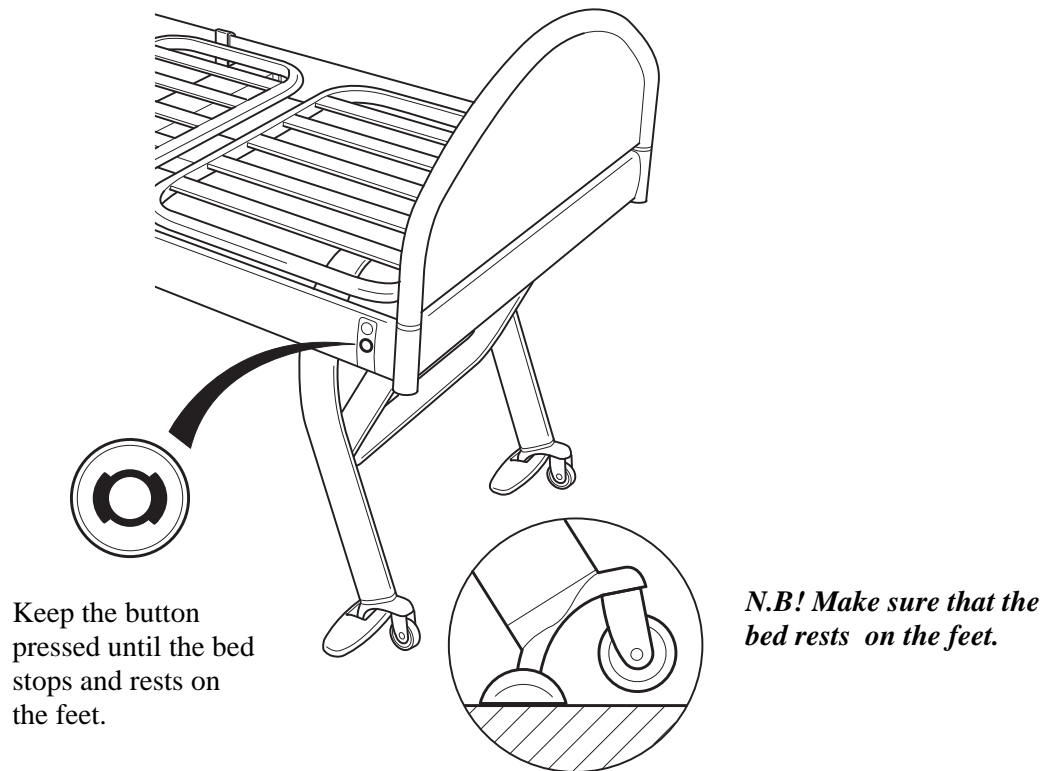



## Patient lift

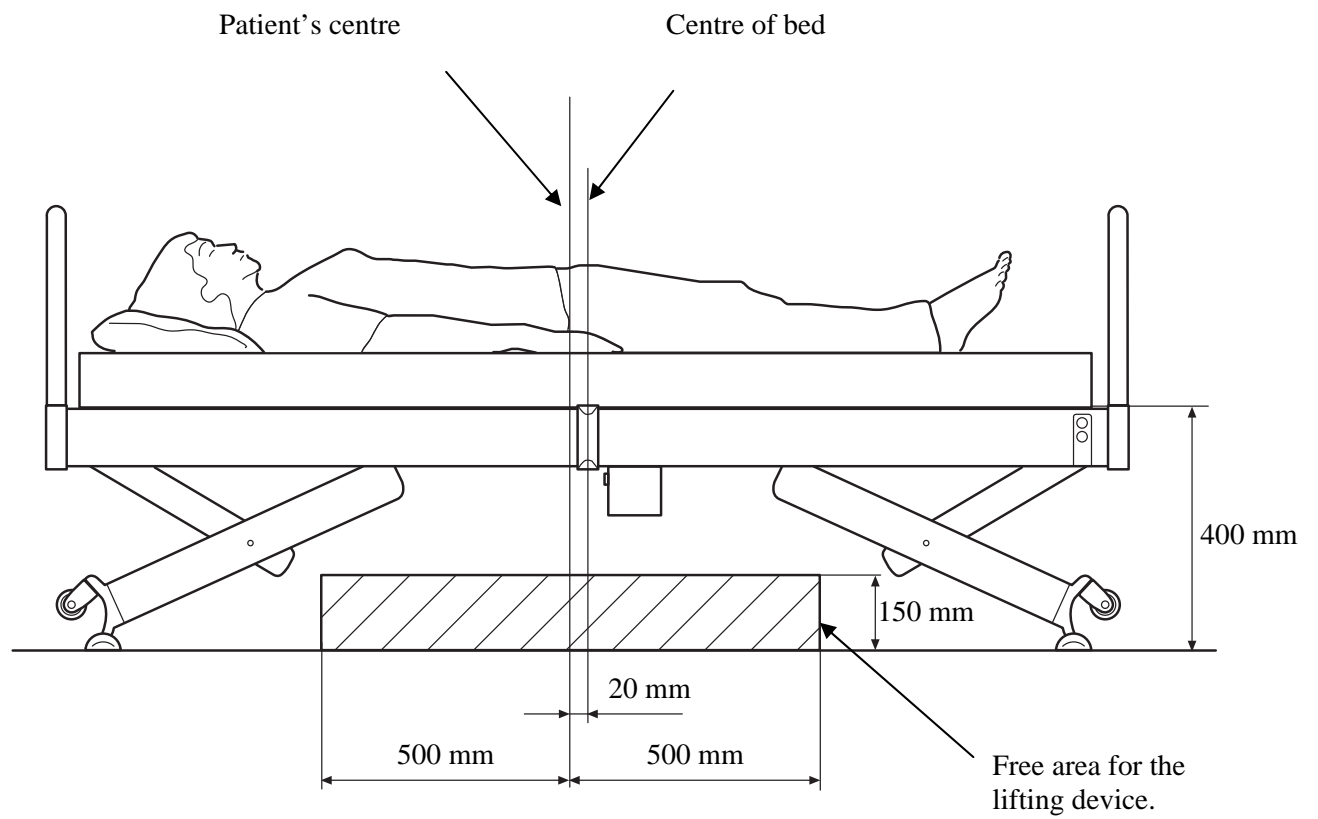

## A few words of advice for the user

Keep the following items in mind:

- Make the best of the bed user's own abilities for all transports.
- Start from the basis of a natural pattern of movements.
- Adjust the bed to achieve a comfortable posture for the bed user.
- Adjust the working height of the bed to suit the purpose intended (transport, activity).
- Adjust the working height of the bed to create a good working posture.
- If possible, move the bed from the wall to achieve an increased working area.

*Tip!*

*Remember all kinds of aids available, such as glide sheets/materials or anti-slip sheets to facilitate the transport.*

*Always start from the bed user's needs and possibilities.*

## The multi-position functions and applications

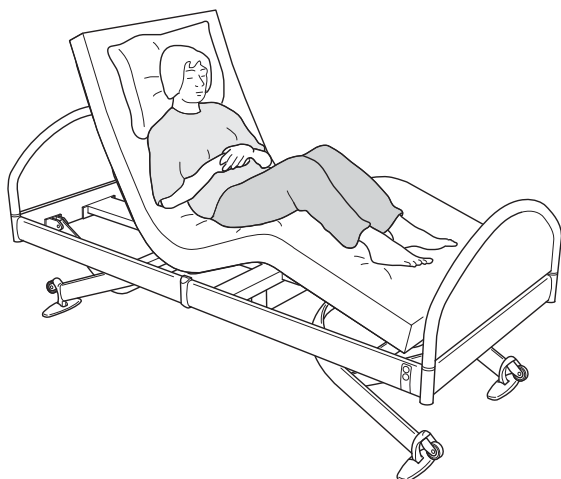

Sitting posture with a low position of the legs, which can relieve the pressure on the heart.

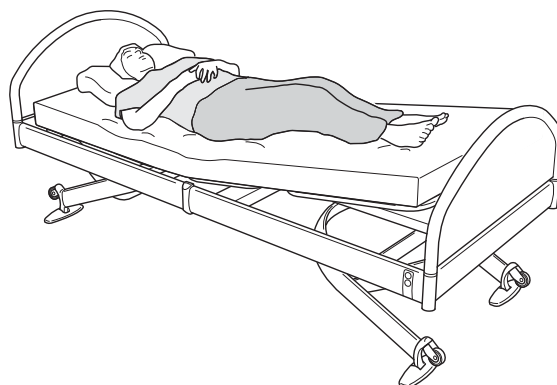

A reclining position with raised legs can relieve the pressure on swollen feet and can be used at easy dizziness conditions (the feet above the heart).

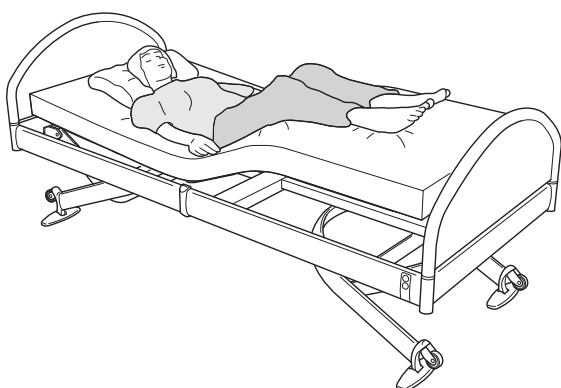

A reclining position with highly raised legs can relieve the pressure on the lower part of the back and swollen legs/feet. Can be used at easy dizziness conditions (the feet above the heart).

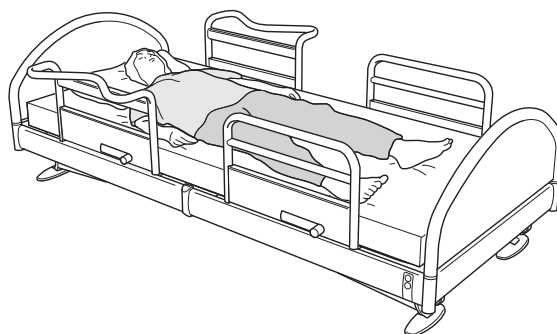

**Tip!** If the bed user is very anxious, lower the bed into its lowest position and mount the number of bed rails required.

## How to sit up at the edge of the bed (to lay down in the bed)

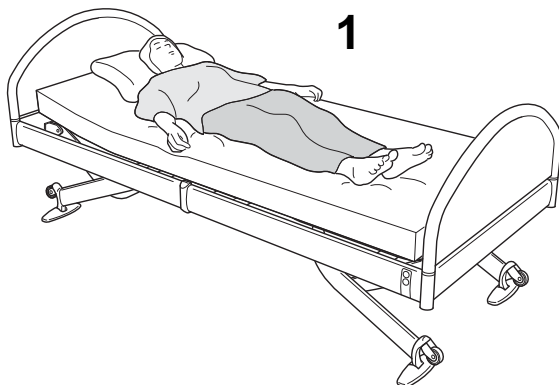

Adjust the bed user in a slight diagonal reclining position to make it easier to put the legs over the edge of the bed.

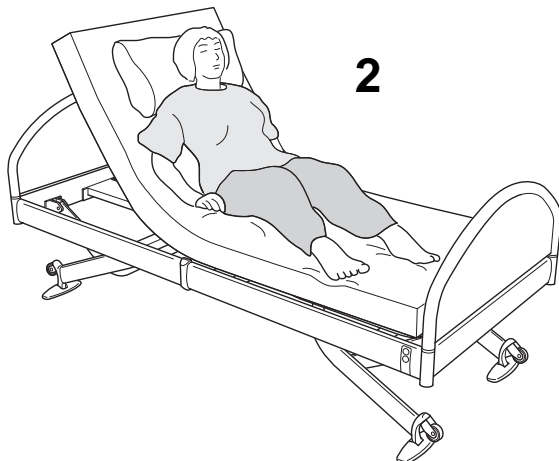

Don't forget to raise the back-rest. It supports the bed user during the whole rising operation.

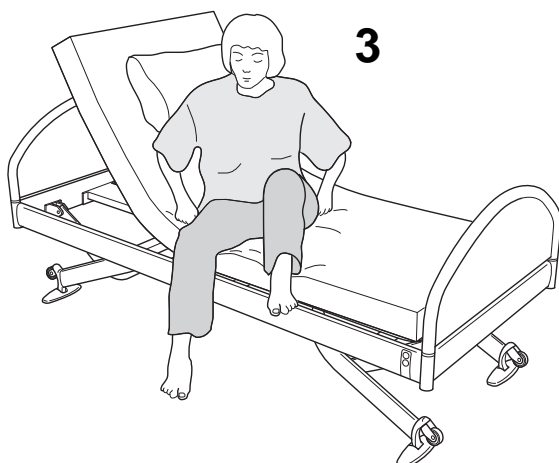

Tip; To facilitate the turning operation in the bed, put a soft swivelling plate under the bed user's seat (at the bed edge side).

1

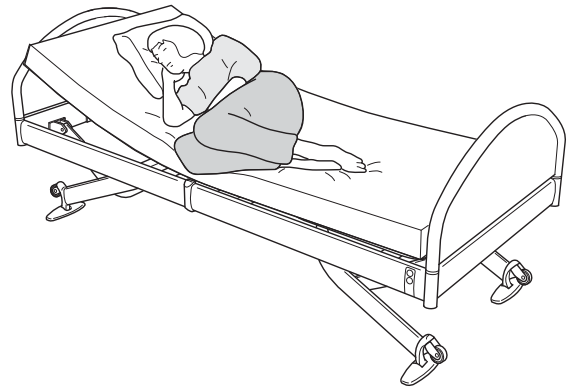

If possible, it's easier to sit up from lying on one's side.

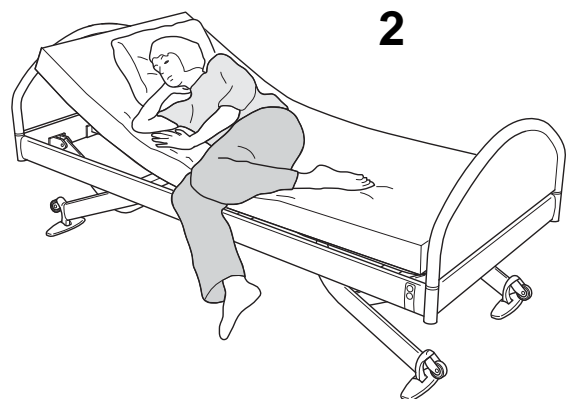

Use the back-rest to reach the sit up posture.

## How to rise from the bed.

Keep in mind that the feet must have floor contact.

Lean forwards to put the weight over the feet.

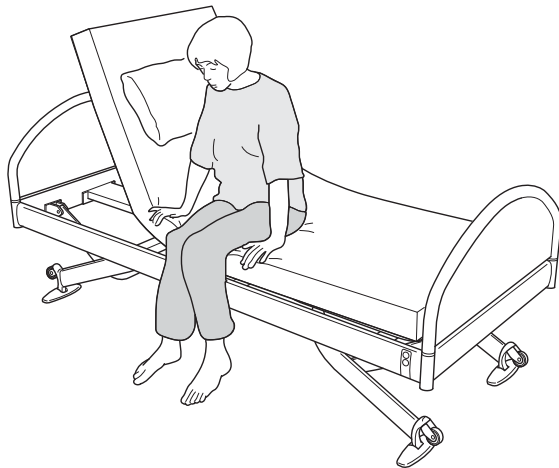

Make the rising from bed easier by elevating the bed. This will support a bed user with weak femoral and backside muscles or stiff hips.

## Care and nursing

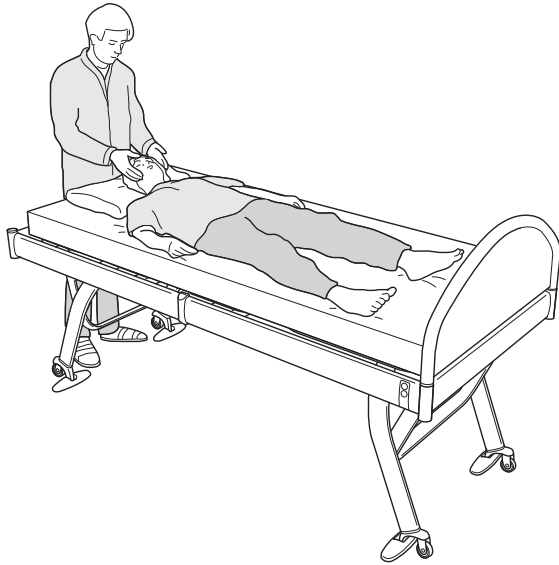

## Sanitary care in the bed

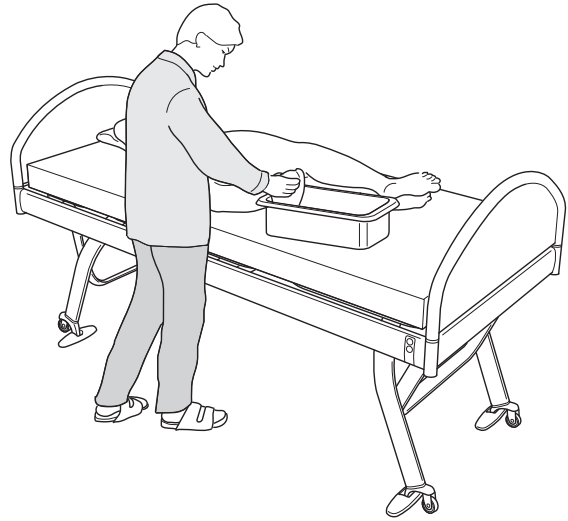

Keep in mind to elevate the bed to achieve a comfortable working posture.

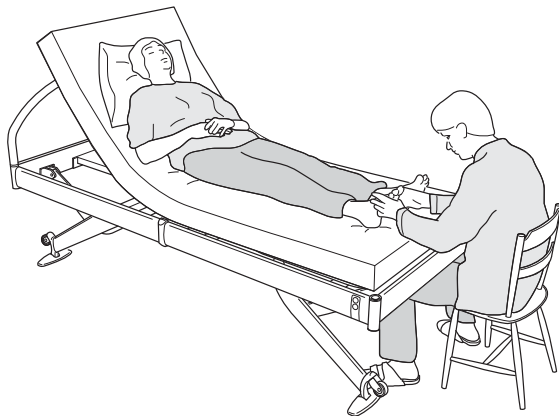

Keep in mind to raise the bed to a comfortable working posture. To make the care of the hair and the chiropody easy, swing away or remove the foot or headboard.

## Inspection

### Cleaning

Use detergents with a pH value of 6.5-7.5 in a ready-mixed wash or spirit solution.

Do not use detergents containing chlorine solutions. High-pressure cleaning shall not be used.

The bed can be rinsed with water. N.B.! The bed has to be assembled before rinsing with water. Make sure that all power plugs are completely inserted into their end positions to comply with the requests according to enclosure class IP 64.

### Checklist for periodic inspection

Once a year or on delivery to a user.

### Electric system check

1. Test all the functions.
2. Make sure that all cables and power plugs are in a perfect condition (no damages/breakdowns).
3. Make sure that all power plugs are inserted into their end positions.

### Service and maintenance

The exchange of electrical components shall be carried out by qualified staff only. For other service and maintenance, contact the supplier.

## Spare part list

Product	Product number
Mattress support head (1 piece)	14087
Mattress support foot	14143
Hand control	14038
Actuator back	94400
Actuator foot	94403
Actuator knee	94404
Control unit	94405

**N.B.! Check the design and assembly of the product and the wiring before effecting the exchange.**

## Technical information

### Regulations

The e-bed is CE-marked according to the Medical Device Directive MDD 93/42/EEC.

This bed is designed for adults of an age of more than 12 years.

The mattress to be used with it shall be within the thickness area from 10 to 15 cm.

Original accessories only are allowed to be mounted to the bed.

### Technical information

SWL (Safe Working Load)	170 kgs.
Thereof:	135 kgs max weight of patient
	20 kgs weight of mattress
	15 kgs of accessories
IP-class	IP54
Voltage	~230 V AC/50 Hz
Maximum power consumption	Max. 2 A
Effect	460 W
Class of insulation	Class II type B, the patient is not separated from earth and metal frame
Intermittence	15 %, max. 2 min 'on' and minimum 13 min. 'off'
Sound level	67 dB, according to ISO 3746.
Height adjustability	From 26.0 to 80.0 cm
Outside dimensions of the assembled bed	217.0x98.8 cm
Mains connection	The mains cable covers an area of 3.5 m from the outside edges of the bed

### Material

The e-bed parts are mainly made of aluminium.

Head and footboards and the bedsides are made of laminated sheets.

The plastic parts are made of injection-moulded Polypropene.

The metal parts are powder coated.

### Weights and measurements

Part	Weight	Measurements
Part 1 (head part)	26 kgs	98.8x113 cm
Part 2 (foot part)	33 kgs	98.8x123 cm
Board	2.0 kgs	98.8x46 cm
Mattress	----	10 to 15x85 to 90x200 to 205 cm
e-support	3.1 kgs	37.8 to 69 cm
s-support	3.0 kgs	37.8 to 69 cm

### Environment for use

Air pressure	700 to 1060 mbar
Moisture of the atmosphere	30 to 75 %
Temperature	+10 to +40 °C

## Location of faults schedule

1

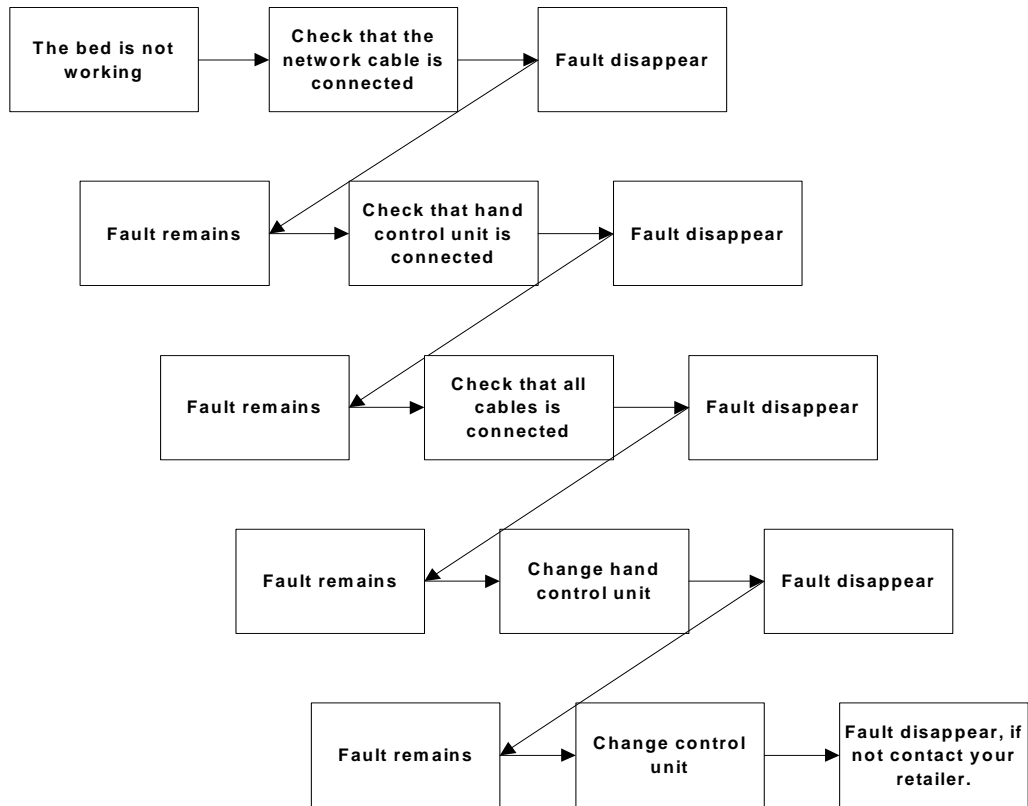

2

