

USER MANUAL

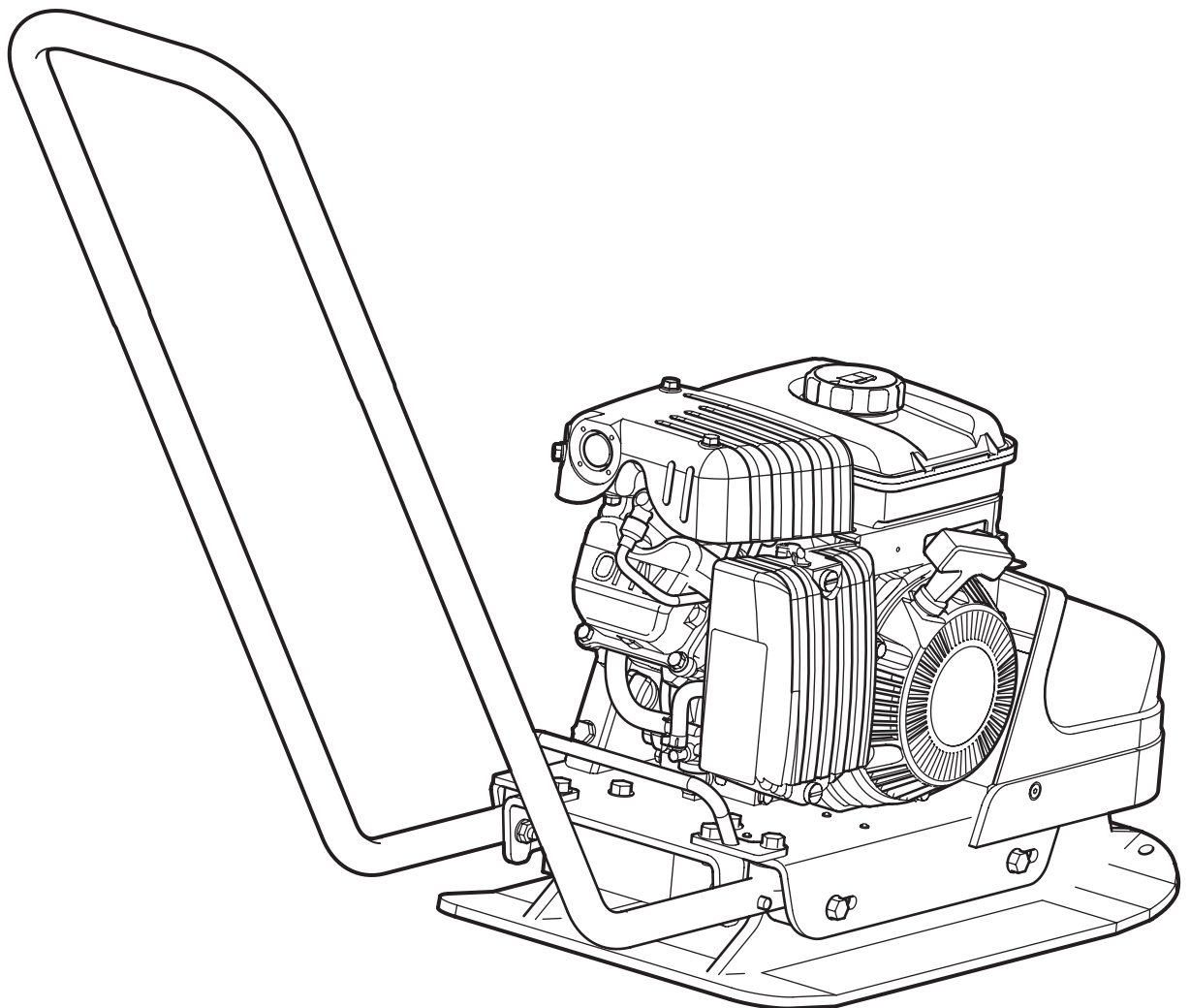

USE

SWEPAC F 50 / F75

is used to pack gravel and sand in connection with minor construction work such as the basis for concrete blocks or paving stones for gardens. The machine's compact design ensures good accessibility in tight spaces.

We reserve the right to modify our design and material specifications without prior notice.

CONTENTS

USE	3
SAFETY INSTRUCTIONS.....	4
STANDARDS	4
SIGNS	5
TECHNICAL DATA.....	6
FUNCTION	6
TECHNICAL DESCRIPTION	7
DAILY CHECKS	8
BEFORE STARTING VANGUARD ENGINE.....	9
STARTING	9
AFTER STARTING.....	9
STOPPING	9
OPERATING INSTRUCTIONS	9
BEFORE STARTING HONDA ENGINE.....	10
STARTING	10
AFTER STARTING.....	10
STOPPING	10
TRANSPORTATIONS.....	11

SAFETY INSTRUCTIONS

- Before using the machine, the operator must be informed of the manufacturer's safety instructions and instructions for use.
- The machine may only be used outdoors.
- The machine may not be used if protection and safety devices are not present or not working.
- The operator may not leave the machine unattended when the engine is on. When the vibrator is connected, the operator must be able to control the movement of the machine using the control handle and the start/stop controls. The machine may be operated only by a trained operator.
- During maintenance work or other interventions in the machine, the engine must always be off.
- Switch the engine off before adding fuel. Avoid fuel spillage and immediately wipe off any spilled fuel. Add fuel only in well ventilated areas.
- Avoid touching hot engine parts, for example the silencer.
- Before lifting the machine, check that the lifting device and its mounting are not damaged and that the rubber dampers on the base plate are undamaged and tightened.
- During transportation and storage, the fuel tank should be empty and the fuel cock switched off.
- The operator must use ear protectors when working with the machine.
- The operator must ensure that no unauthorised persons are in the immediate vicinity of the machine.

STANDARDS

Noise

Measurement in accordance with the standard EN 500-4 Rev. 1:1998, Annex C:

In accordance with the conditions in Directive 2000/14/EC, Annex VI, the following values are reported:

	F 50	F 75
Sound pressure level at the operator's ears, L _{pA}	89 dB (A)	89 dB (A)
permitted sound power level, L _{WA}	105 dB (A)	105 dB (A)
Guaranteed sound power level, L _{WA}	105 dB (A)	105 dB (A)

As the sound pressure level at the operator's ears exceeds 85 dB (A), ear protectors must be used during operation!

Hand/arm vibrations

The vibration acceleration was measured in accordance with the ISO 5349 standard during operation on a graveled surface. The measurement values were translated into the maximum daily exposure time for regular usage. For additional information about vibrations, please confer the regulation AFS 2005:15 from the Swedish Work Environment Authority, effective July 1st 2005.

	F 50	F 75
Hand/arm-vibrations, m/s ²	4,5	4,6
The maximum daily exposure time	2,5 h	2,4 h

Exhaust emissions

F 50 meets the requirements for California ExH, EYP och EPA PH2

F 75 meet the requirements for exhaust emissions in accordance with EU directive 2002/88 Euro2

SIGNS

Warning signs

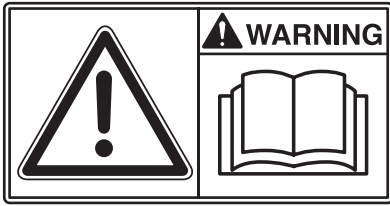

Before use, carefully read the manual and its safety instructions so that you can handle the machine safely. Ensure that the manual is always accessible.



Engine, silencer: to avoid burns or discomfort, do not touch hot engine parts when the engine is on or when the machine has recently been used.



Belt drive: Keep hands, tools and other objects away from the belt drive when the machine is on to avoid injury and damage. See the safety instructions in the manual.



As the sound pressure level at the operator's ears exceeds 85 dB (A), ear protectors must be used when working with the machine to prevent hearing damage.

Machine Signs

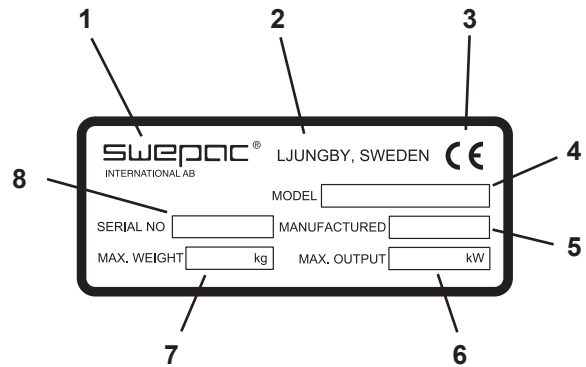

1. Manufacturer
2. Place, country of manufacture.
3. CE mark.
4. Model name.
5. Year of manufacture.
6. Max. engine power.
7. Max. weight.
8. Serial number.

TECHNICAL DATA

F 50

Net weight.....52 kg
 Base plate, w x l300 x 500 mm
 Speed.....appr 25 m/min
 Centrifugal force9 kN
 Handle vibrations115 Hz
 Drive engine.....Vanguard
 Engine power1,8 kW
 Engine RPM.....3600 RPM
 Fuel tank volume.....1,6 liter
 Fuel type.....Unleaded petrol or alkylatet
 Oil quantity, crankcase.....0,4 liter

F 75

Net weight.....75 kg
 Base plate, w x l380 x 530 mm
 Speed.....appr 25 m/min
 Centrifugal force11 kN
 Handle vibrations94 Hz
 Drive engine.....Honda
 Engine power2,9 kW
 Engine RPM.....3600 RPM
 Fuel tank volume.....2,5 liter
 Fuel type.....Unleaded petrol or alkylatet
 Oil quantity, crankcase.....0,6 liter

FUNCTION

The machine consists of a base plate with a vibration element and an upper part cushioned from the base plate. The power is transmitted from the petrol engine to the vibration element via a V-belt. The engine is fitted with an integrated centrifugal clutch. On account of the direction of rotation and the position of the vibration element at the front end of the base plate, the vibrator moves forward under its own power. The moving parts are well protected by a cover made of impact resistant polythene.

FUEL AND OIL RECOMMENDATIONS

FuelUnleaded petrol or alkylate
 Engine oil.....SAE10W-30

TECHNICAL DESCRIPTION

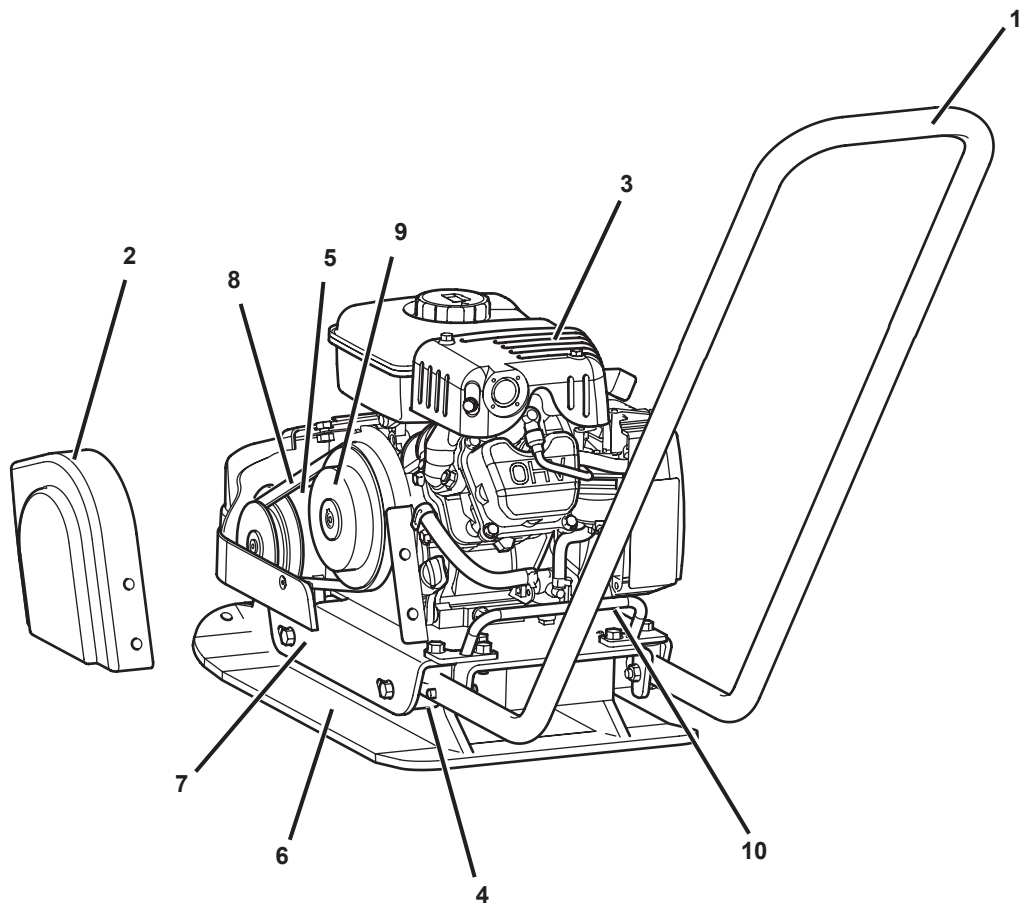

1. Handle
2. Protective cover
3. Petrol engine
4. Rubber damper
5. Vibration element
6. Base plate
7. Engine plate
8. V-belt
9. Centrifugal clutch
10. Lifting eye

DAILY CHECKS

Fuel Check

Check that there is fuel in the tank. Top up if necessary.

Engine Oil Level Check

Check the oil level in the crankcase every day. The oil must reach the edge of the filling hole when the machine is on a level surface.

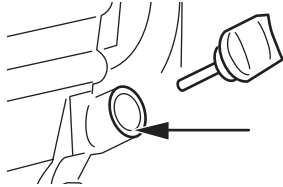

Air Filter Check Vanguard

The air filter must be checked at least once every working week. When working in dusty conditions, check daily.

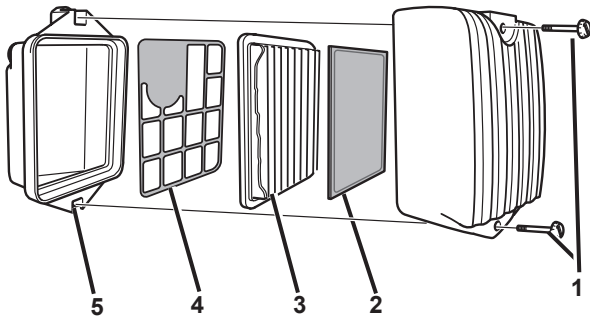

Cleaning the air filter

1. Loosen screws (1) and remove the cover (2). Clean the dust off the cover
2. Clean the pre-cleaner (3) with cleanser and water. Saturate the pre-cleaner in engine oil. Squeeze dry in clean absorbent cloth.
3. Clean the cartridge (4) by tapping it gently on a flat surface.
NOTE! Renew a damaged cartridge.
4. Make sure that the aluminum plate (5) is remounted according to illustration.
5. Remount the filter unit in opposit order..

Air Filter Check Honda

The air filter must be checked at least once every working week. When working in dusty conditions, check daily.

1. Paper element
2. Foam plastic element

Cleaning the air filter

1. Remove the foam plastic element and the paper element and check that they are undamaged. Replace damaged parts.
2. Wash the foam plastic element in liquid with a high flashpoint and let it dry properly. Dip in engine oil and squeeze dry.
3. Strike the paper element against a hard object a few times to loosen any dirt.

Oil/Fuel Leakage

Check every day that the engine is not leaking oil or fuel. If a leak is discovered, the machine may not be operated until the fault has been remedied. See also the separate engine instructions!

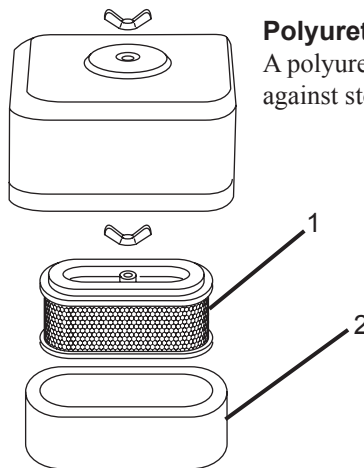

V-belt Drive

Check the tension and condition of the V-belt regularly. Replace a damaged V-belt with the new type Z25 for F50 and A28 for F75.

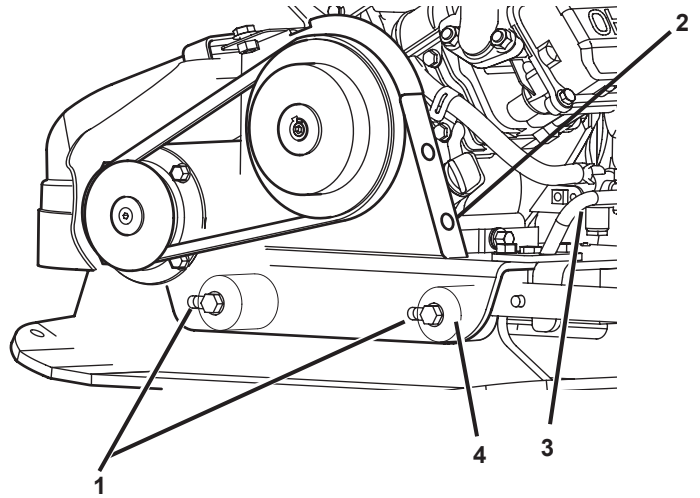

Adjustment of V-belt tension

Loosen the screws (1, 4 pcs) that hold the engine plate. Loosen the screws (2, 3 pcs) holding the cover. Remove the cover.

Tension the V-belt by pulling the handle (3). Tighten the screws. Refit the cover.

Rubber Dampers

Check the condition of the rubber dampers (4, 4 pcs) regularly. Replace damaged dampers.

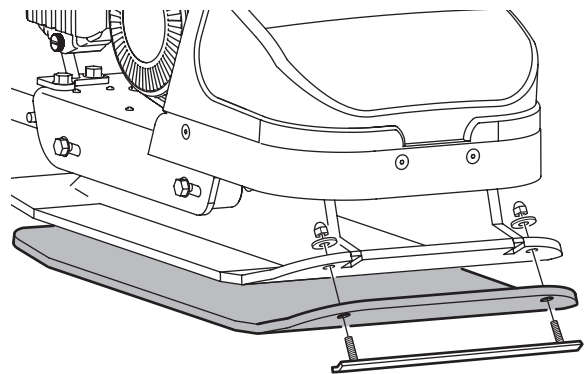

Polyuretan Pad

A polyuretan pad is used for stone paving work to protect against stones and ground clinker.

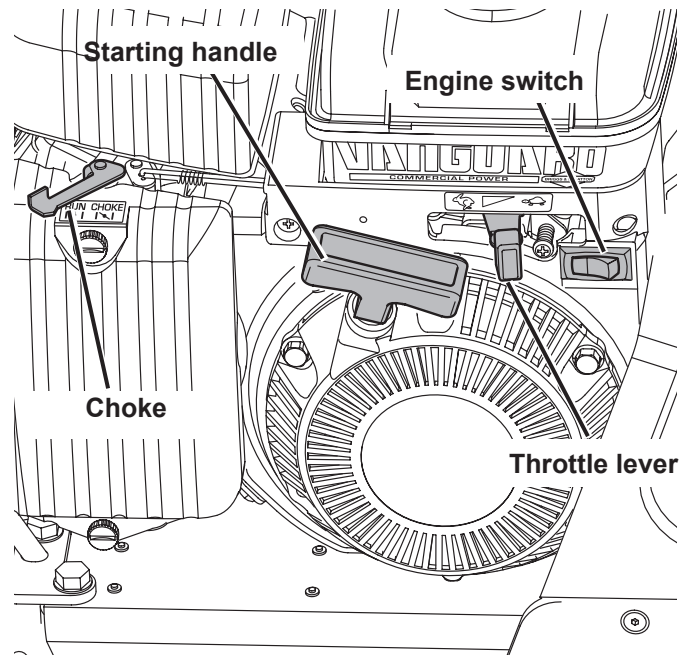
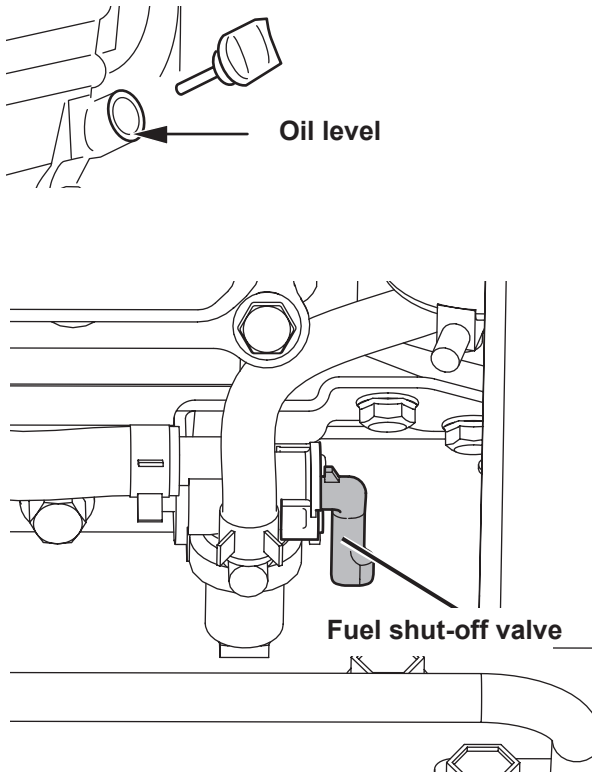

BEFORE STARTING VANGUARD ENGINE

NOTE! The machine is equipped with an oil guard, which switches off the engine if the oil level is too low. Always check the oil level if the machine cannot be started. Fill up oil to the FULL-mark on the dipstick.

Also see Daily Checks on page 8.

STARTING

Set the choke to CHOKE-position.
 Set the throttle lever to FAST-position.
 Open the fuel shut-off valve.
 Move the engine switch to position I.
 Start by pulling the starting handle.

AFTER STARTING

Open the choke gradually.
 Run the engine warm for around 5 minutes.

STOPPING

Switch the engine to idle and let it run for a few minutes.

Shut off the engine, by setting the red engine switch to position O.

OPERATING INSTRUCTIONS

The machine's vibration elements start when the throttle is increased. The best packing is achieved at full engine RPM. Avoid running the engine at other RPM as there is a risk of the clutch slipping, with abnormal wear as a result. Thanks to its compact design and low weight, the machine's is very easy to manoeuvre. The design of the base plate allows the machine to be pulled backwards without disturbing the packed surface. The machine's vibration element stops when the throttle is switched to idle. The machine is only designed to be used outdoors. Work with the machine in daylight or other adequate lighting. Ballast must be wetted or naturally damp. All other use is discouraged.

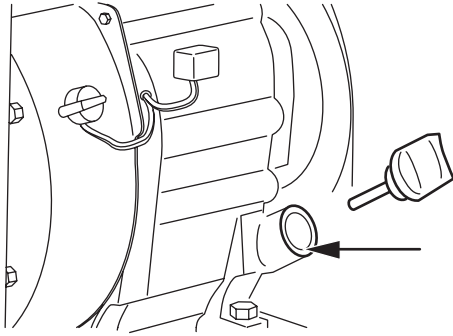

Oil level

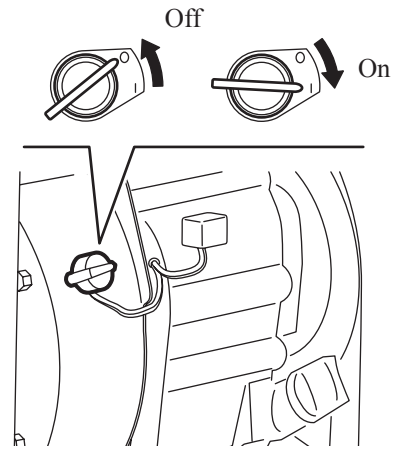

Engine power switch

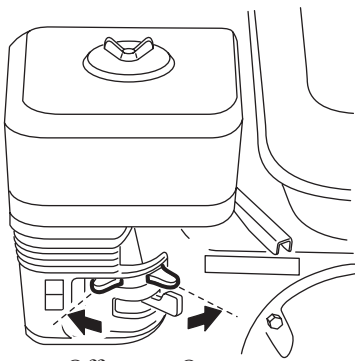

Off On
Fuel cock

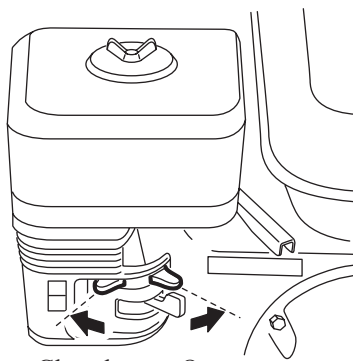

Closed Open
Choke

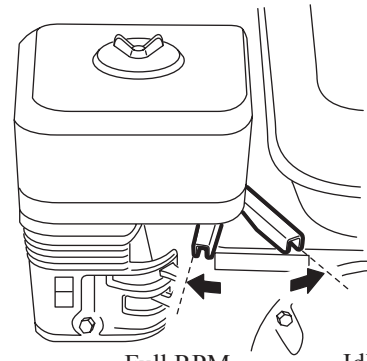

Full RPM Idle
Throttle lever

BEFORE STARTING HONDA ENGINE

See Daily Checks on page 8.

STARTING

Switch the engine power switch to “on”. Open the fuel cock.

Switch the throttle lever to 1/3 of full RPM.

Adjust the choke. If the engine is cold, close the choke completely. Do not use the choke if the engine is warm or if the air temperature is high.

Start by pulling the starting handle. Pull it first until the mechanism engages. Then pull it hard and fast.

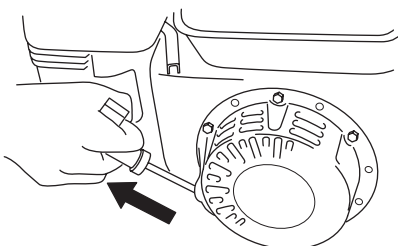

AFTER STARTING

Switch the throttle lever to idle.

Open the choke gradually.

Run the engine warm for around 5 minutes.

STOPPING

Switch the engine to idle and let it run for a few minutes.

Switch the engine power switch to “off”.

Close the fuel cock.

TRANSPORTATION

It is easy to remove the handle without tools, and the boot of a standard car is sufficient to transport the machine.

Lifting by hand

Remove the handle by tilting it forward and pulling the shafts apart.
Move the handle from side to side so that the dowels let go.

Caution! The machine must be lifted by 2 persons!

Lift by means of the handle on the back and the front edge of the machine.

Lifting with crane

Tilt the handle forward.
Fit a lifting sling to the lifting eye and thread the lifting sling between the shafts of the handle, see illustration below.

Transport locking

Secure the machine with straps according to illustration during transportation.
Note! Secure it by the base plate and not the rubber-cushioned upper part.

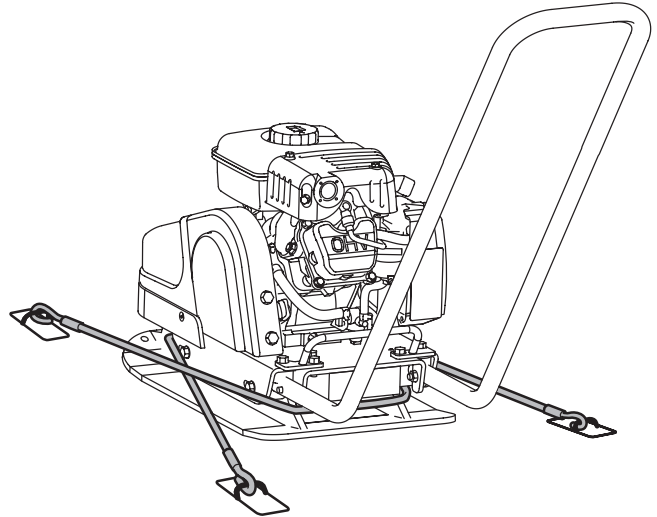
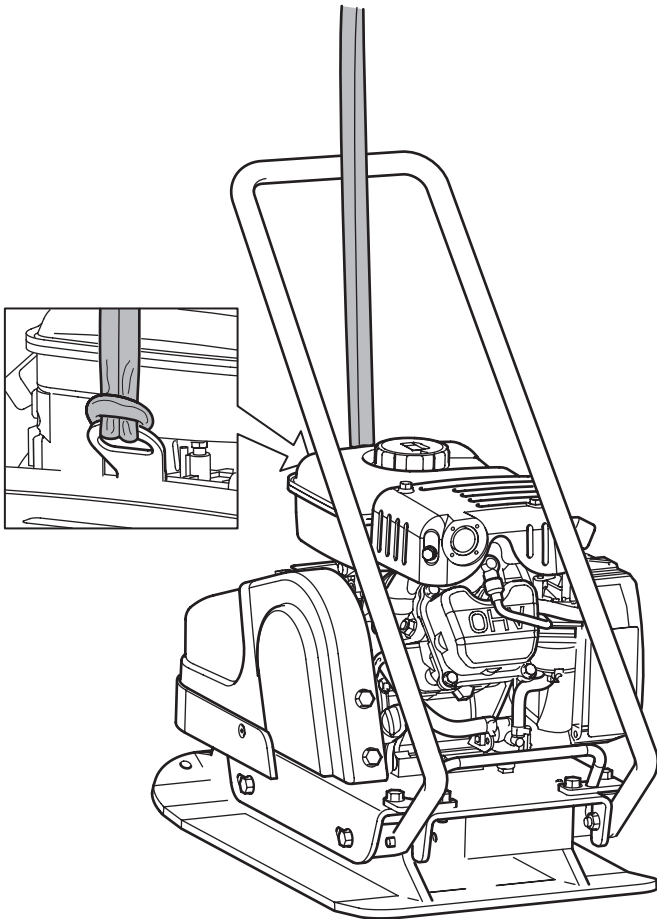

SWEPAC®
INTERNATIONAL AB

SWEPAC INTERNATIONAL AB

Address **Box 132, 341 23 Ljungby, Sweden, tel. +46 (0)372-156 00, fax +46 (0)372-837 41, E-mail mail@swepac.se,
Internet www.swepac.se**