

ATORCH®

WIRELESS CHARGING LED LIGHTS

Incorporates the innovative wireless induction charging technology.
Most convenient charging method brings a special taste of lights

FEATURES







- CREE XM-L T6
- 2200mAh 4.2V Li-ion Battery
- Innovative Wireless Charging System
- Fully Charged in 5-7 hours
- Depth Tested to 100 meters
- Superior Hard Anodized Finish
- Aircraft Grade Aluminum Alloy
- Slide Magnetic Switch
- Exceptionally Powerful Beam

DIMENSIONS

Length: 195mm ,Head Diameter:φ47.5mm
Body Diameter: φ31.2mm
Weight: 422g (Including Battery)

ACCESSORIES

Wireless Charger, 18650 2200MAH/4.2V, Lanyard

STANDARD	LOW	LOW...  HIGH	HIGH
	40lm	40 → 800lm	800lm
	30 hrs	30 → 1 hrs	1 hrs
	292m (Beam Distance)		
	9300lux (Distance 1 meter)		
	1m (Impact Resistant)		
	IPX-8, 100meters (Underwater and Diving)		

NOTICE

Stated data has been measured according to the international flashlight testing standards in the laboratory.
The data may vary with environment conditions.

STRUCTURE

- 1.AC-DC Power Adaptor
- 2.Wireless Charger Base
- 3.Charge Indicator Light
- 4.Tail
- 5.Receiver
- 6.Rechargeable Battery
- 7.Slide Magnetic Switch

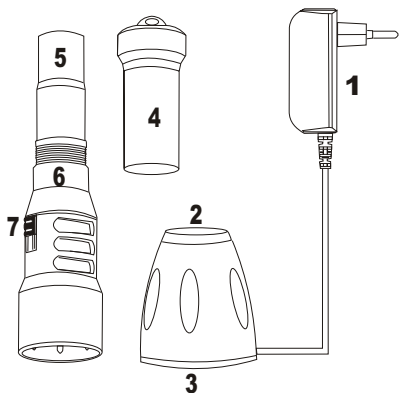

WARNING

1. Battery must be inserted with the positive (+) end toward the torch head.
2. Do not use an alternative battery (without a protected circuit).
3. Avoid any impact with the receiver and glass lens.
4. Do not shine the light directly into eyes.
5. Remove from charging base when fully charged
6. No using when charging. And take down the flashlight exceed 8hours if the Charger light still flashes, then feedback to us or local distributor.

AT01-H User Manual

BATTERY INSTALLATION

Insert 1 × 18650 Li-ion with the positive (+) end pointing toward the flashlight head. Attention to battery polarity.

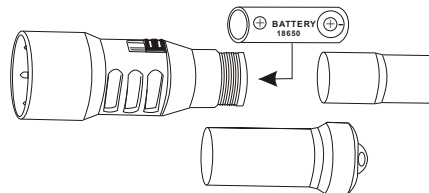

CHARGING

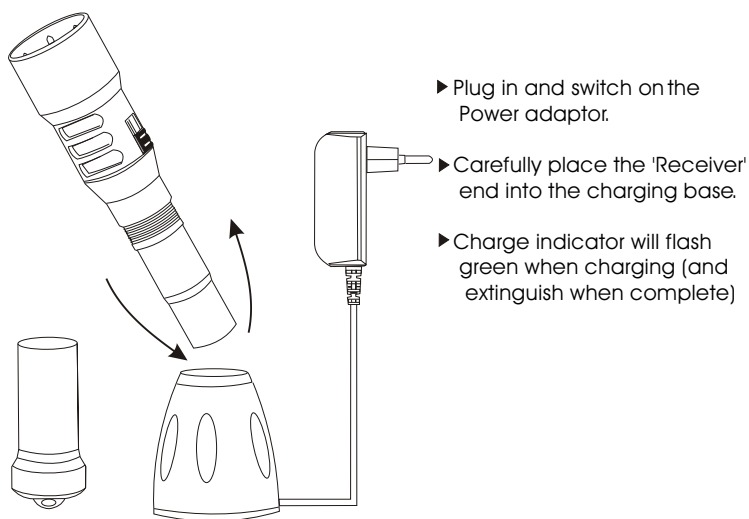

► Plug in and switch on the Power adaptor.

► Carefully place the 'Receiver' end into the charging base.

► Charge indicator will flash green when charging (and extinguish when complete)

Note:

1. It is normal for the receiver, charging base or battery to become warm Whilst charging.
2. Take care when replacing the receiver cover, to protect the O-rings.

WARRANTY

1. Your ATORCH. is covered by a full 12 months warranty.
2. Within 14 days of purchase, if a fault occurs due to a manufacturing defect your ATORCH. will be replaced (proof of purchase required).
3. After 14 days and within 12 months of purchase your ATORCH. will be repaired or replaced (excludes accidental damage or damage caused by misuse).
4. Outside the 12 months warranty period, your ATORCH. will be repaired at cost (if repairable). In all cases, the cost of any inward and outward shipping will be the customer's responsibility.

Please Note The warranty does NOT cover the following:

1. Damage caused by disassembly or modification.
2. External cosmetic damage, caused by normal use or misuse.
3. Damage caused by incorrect battery insertion (reversed polarity) or battery leakage.

Details of warranty service, please contact with your regional Distributor/dealer or send an email to info@atorch.net directly.