

■ Important Safeguards

- Please ensure the Odyssey is set up as per instructions. Ensure that induction / hand over procedures as described on page 4 are followed.
- It is imperative that the product log form is completed at the rear of the end user manual on a regular basis. This form must be used to record setups, changes to the product and scheduled maintenance checks undertaken.
- To validate the warranty it is important that each section of the end user log is actioned, recorded and initialled each time Odyssey is reviewed.
- CARE, MAINTENANCE AND CLEANING procedures must be implemented to ensure client well being.
- Always ensure that a new end-user manual is supplied each time product is re-issued. For new sets of instructions please contact a2u on +44 (0) 121 523 5004 or e-mail us at info@a2u.co.uk.
- It is imperative that all users understand the CORRECT USE of the product and also what is INAPPROPRIATE USE.
- Secure the child using the 45 deg pelvic strap before you make any other adjustments. Ensure the belt is securely adjusted and fitted each time a child is seated and for changes of clothing for secure fit. Ensure the straps are fitted from under the pelvic supports.
- Always use all of the positioning straps provided.
- Please ensure that the product is used on an indoor even surface.
- It is imperative that children are continuously monitored whilst using this equipment. **NEVER LEAVE A CHILD UNATTENDED IN THIS PRODUCT.**



PO.Box 2125 Wolverhampton, WV6 7FB
Tel / Fax +44 (0) 121 523 5004
Tel / Fax +44 (0) 1902 741675
E-mail: enquire@a2u.co.uk
Website : www.a2u.co.uk



■ Odyssey



End User manual

This manual contains essential guidance for therapists and stores personnel. This manual **must** be read thoroughly before issuing this product to an end-user.



It is the responsibility of the issuer to know this product well enough to ensure effective and safe set up and also to ensure that the end-user is aware of essential points regarding safe and effective use.

Contents

Welcome	1
Before Starting	2
Product Induction	4
Getting Started	5
Using Odyssey	6
Maintenance & Cleaning	10
Warrenty	11
Specification	12
Issuing Information	14
Product log	15

Product Log:

Date	Set up / Check / Amendments	Signature	Print Name

Product Log:

Date	Set up / Check / Amendments	Signature	Print Name

Welcome

Thank you for purchasing the Odyssey. Odyssey is a unique multi-adjustable seating system. Odyssey has been designed to complement the development of the young child for whom it has been prescribed by the health care professional.

IMPORTANT: READ THE INSTRUCTIONS CAREFULLY BEFORE USE AND KEEP THEM FOR FUTURE REFERENCE. FAILURE TO FOLLOW INSTRUCTIONS MAY IMPAIR USE AND IMPEDE FUNCTION AND MAY POSE A RISK TO THE USER.

The correct use and maintenance of your Odyssey will ensure it gives long and trouble-free use.

Here are some of the key features of Odyssey

- Only one base and three seat inserts.
- Electric height adjustment from floor.
- Seat angle / Tilt in space facility.
- Seat depth and width adjustments.
- Multi adjustable backrest.
- Multi density seat design.
- Variety of additional supports.

Before Starting

Important

- Always read instructions before use. Failure to follow instructions may impair use, impede function and more importantly may affect the user's safety.
- This user guide is for Odyssey, item Code: Ody A, Ody B & Ody C.
- Each product has a serial number which will be found on the battery pack. Please quote this number in any correspondence.
- The materials and foam within Odyssey meet all the required current regulations.
- This product conforms to CE Marking Regulations, Medical Devices Directive (MMD)93/ 42 EEC.
- Do not add any other accessories other than those supplied by a2u to this product. Ring a2u on +44 (0) 121 523 5004 for advice if unsure.
- The warranty conditions are stated on page 18 and provide further information.
- Odyssey A: maximum user weight 35KG.
- Odyssey B: maximum user weight 45Kg.
- Odyssey C: maximum user weight 55Kg.
- Service or repair must only be carried out by an a2u authorised service person. Any service or repair carried out by any other person will invalidate the guarantee and a2u cannot accept any liability for injury or damage thus caused.
- The tools required to adjust odyssey are supplied by a2u. These adjustments are to be made by the therapist only. Store these in a safe place. Keep away from children.
- Before using the Odyssey for the first time please charge the batteries for 12 hours.
- **To charge the batteries, plug the charger into the mains and connect the charger lead into the handset.**
- Batteries should be charged for 30 mins to an hour at the end of each day to maintain optimum life.
- An audible bleep sound from the handset is a low battery warning and the batteries should be charged immediately.
- Ensure that the product is fully assembled before use. Contact a2u if you need advice at this stage.
- It is essential that the equipment / system is cleaned regularly so as not to impede function and to remain hygienic. Use warm soapy water but not abrasive detergents.
- Please ensure the Odyssey is set up as per instructions. Ensure that induction / hand over procedures as described on page 4 are followed.

Product Log:

Date	Set up / Check / Amendments	Signature	Print Name

Important issuing Information

This form **must** be completed on issue or re-issue of the product

Child's Name	
Therapist Name	
Address	
Telephone	
Primary Carer's Name	
Product Issue Date	
Product Serial No.	
Product Purchase Date	

Induction Check List

Please ensure that the following sections are covered with the primary carer before the product is issued. Please initial each box when instructing carer / end user through the induction process.

Safety Information	
Daily User Guide	
Care & Maintenance	
Cleaning	
Product Log Updated	

Induction Given By

Induction Received By

Date

Safety

- It is imperative that children are continuously monitored whilst using this equipment. **NEVER LEAVE A CHILD UNATTENDED IN THIS PRODUCT.**
- If there is the slightest concern regarding the supports, use or function of the product then immediately contact a2u for advice on +44(0) 121 523 5004 or e-mail us at info@a2u.co.uk.
- Secure the child using the 45 deg pelvic strap before you make any other adjustment. Ensure the pelvic strap is adjusted for each child and for changes of clothing. Ensure the straps are fitted under the pelvic support and fitted snugly to ensure correct posture and safety.
- When doing a hoist transfer, please ensure that the hoist sling is not caught on any part of the Odyssey.
- Always ensure that the back of the Odyssey chair is held to provide additional security and control when tilting the chair.
- Ensure casters are always locked when the Odyssey is stationary.
- Due to the nature of the product, please be aware of the length of the base and the surrounding in which the Odyssey is being used.
- Do not allow other individuals to use, play with, stand on, ride on or run around the Odyssey.
- When using the chest strap or Jacket , please ensure the position of the harness is anatomically correct. Ensure the pad is not impeding on the throat.
- Please ensure that the product is used on an indoor level and even surface. If the chair is to be pulled over a small incline it is recommended that the chair is pulled backwards.
- Small parts if loose will be a potential hazard for small children.
- Keep products away from sources of heat such as naked flames, cigarettes, open fires, heaters, radiators etc.
- Always use all of the positioning straps provided.
- Before moving the Odyssey, ensure all brakes are released and the footrest is at least 1" / 25 mm above the ground level.

WARNING

- Secure the child using the 45 deg pelvic strap before you make any other adjustments. Ensure the belt is securely adjusted and fitted each time a child is seated and for changes of clothing for secure fit. Ensure the straps are fitted from under the pelvic supports.
- The safety advice and directions in this manual cannot cover all eventualities and unforeseen situations that may occur. It must be understood that common sense, general caution and care are factors that cannot be built into this product. These are factors which the person actually using this product must assume responsibility for.

Product Induction

- This product has been prescribed by the Therapist or practitioner who should have adjusted the Odyssey to meet the child’s need. If this product has not been adjusted by the therapist please do not use it.
- Before using the product please ensure you have had a product induction from your therapist. Formal induction plan is shown on page 14.
- It is imperative that you understand the responsibility you are taking as a primary carer.
- Please ensure this manual is kept in a safe place.
- It is imperative that the product log form is completed by your therapist at the rear of this manual on a regular basis. This form must be used to record setups, changes to the product and scheduled maintenance checks undertaken.
- It is imperative as a primary carer you understand the CORRECT USE of the product and also what is INAPPROPRIATE USE.
- You must understand and appreciate all SAFETY aspects of a2u products.
- CARE, MAINTENANCE AND CLEANING procedures must be followed to ensure client well being.
- DO NOT undertake any adjustments unless directed by the therapist, please contact your Therapist for directions.
- CARERS AND HOME USERS MUST BE AWARE. This product has been prescribed by the Therapist or practitioner for a specific child and should ONLY be used as directed by the prescriber.

Notes:

Odyssey Specification

	SIZE A		SIZE B		SIZE C	
	mm	inches	mm	inches	mm	inches
Seat Depth						
Min	200	8	280	11	320	13
Max	320	13	400	16	450	18
Seat Width						
Min	170	7	200	8	230	9
Max	290	11	330	13	410	16
Seat to Footrest						
Min	210	8	230	9	290	11
Max	330	13	380	15	470	19
Seat to Floor						
Min	300	12	330	13	370	15
Max	630	25	630	25	630	25
Backrest Height						
Min	360	14	420	17	460	18
Max	460	18	520	20	562	22
Overall Base						
Length	840	34	840	34	840	34
Width	450	18	450	18	450	18
User Weight	35kg	75lb	45kg	100lb	55kg	120lb
Backrest Angle	15° Prone to 25° Recline					
Tilt In Space	15° Prone to 25° Recline					

- Odyssey A, (Max User Weight 35Kg).
- Odyssey B, (Max User Weight 45Kg).
- Odyssey C, (Max User Weight 55Kg).

Getting Started

Intended Use

Odyssey has been designed to complement the development of the youngster for which it has been prescribed by the health care professional.

It is imperative that Odyssey is used correctly (as per instructions) and adjusted and maintained regularly (as per instructions) to accommodate development and growth.

Young children using this equipment should be continuously monitored and not left unattended.

Using the Odyssey

- Before using the Odyssey always check all the supports are secure and tight.
- Open the pelvic strap and any other harness fitted to the chair, before transfer.
- Lock the casters before transferring.
- When doing a hoist transfer, please ensure that the hoist sling is not caught on any part of the chair.
- Flip up the sandals if it assists transfer.
- As soon as the child has been transferred into the Odyssey, please secure the pelvic strap and any other harness, along with the foot straps immediately.
- Fit the tray and any other accessories supplied.
- Always ensure that the back of the Odyssey chair is held to provide additional security and control when tilting the chair.
- Batteries should be charged for 30 mins to an hour at the end of each day to maintain optimum life.
- To charge the batteries, plug the charger into the mains and connect the charger lead into the handset.
- It is imperative that children are continuously monitored whilst using this equipment. **NEVER LEAVE A CHILD UNATTENDED IN THIS PRODUCT.**
- Please refer to Using Odyssey section on pages 6to9 for further information.

Using Odyssey

Please ensure all the knobs and screws are secure and tight after adjusting the odyssey.

Base Height Adjustment

Use the handset to adjust the height of Odyssey ❶. When lowering the Odyssey, please ensure that the footrest is always at least 25 mm (2.5 cm / 1" inch) above the ground.

To charge the batteries, plug the charger into the mains and connect the charger lead into the handset ❷. Batteries should be charged for 30 mins to an hour at the end of each day to maintain optimum life. An audible bleep sound from the handset is a low battery warning and the batteries should be charged immediately.



Tilt In Space Adjustment

First loosen red or orange lever. Hold the back of the chair and loosen the corresponding lever on the other side of the chair. Always ensure that the back of the chair is held to provide additional security and control. Odyssey can be positioned in both recline and prone. Whilst there is a stop to control the seat angle, it is essential that the seat is positioned by holding the backrest and then secured by tightening BOTH levers on each side of the chair. Failure to secure the levers could result in angle movement which may cause distress, insecurity for the user.



Warranty

- a2u warrants that equipment sold by a2u will be free of all defects in material and workmanship for a period of 2 years from the date of purchase. We will not be held responsible for any damage, injury due to misuse or modification of our products.
- a2u will repair or replace, at our discretion, any equipment or parts proving defective within the terms and period of this warranty.
- If any part of the equipment is found to be defective within the terms and period of this warranty a2u will, at its own discretion, repair or replace it.
- For advice on the use of this product please phone our after sales line on + 44 (0) 121 523 5004.

Maintenance

This product has been prescribed by the Therapist or practitioner who must ensure that all users understand and implement correct use, safety checks, care, maintenance and cleaning. It is the user (carer for the child) who is responsible for ensuring the product is correctly used on day to day basis. The Therapist should direct the following checks to be undertaken, the frequency of the check is only a minimum and should be adjusted depending on the environment in which the equipment functions.

Daily Checks

- Check that supports and straps are securely fixed.
- Check that the pelvic strap fits the child snugly.
- Check that the backrest angle fixing is secure and tight. Yellow & Orange Knobs
- Check all upholstery for wear and tear.
- Check framework for wear and tear, splinters, breaks.

Monthly Checks

The monthly check, again the frequency is only a minimum and should be adjusted depending on the environment in which the equipment functions. As this check is a more in-depth check a suitably competent individual should be nominated by/on behalf of the prescriber.

- Check that supports and straps are functionally correct and securely fixed.
- Check that all the supports are secure and tight.
- Check for missing or worn bolts/fixings as required.
- Check straps for fraying and missing or broken buckles.
- Check all upholstery for wear and tear.
- Check framework for wear and tear, splinters, breaks.
- Check the overall structure of the Odyssey for any signs of fatigue or damage.
- Ensure end user log is updated.

Cleaning

- Metalwork and coated parts can be wiped with soapy water or antibacterial spray. Please dry the product thoroughly. Please do NOT use solvents, abrasive cleaners, caustic soda, sodium hypochlorite and organic solvents.
- Padded chest, pelvic and knee block should be wiped regularly with soapy water or antibacterial spray. Please dry material thoroughly after wiping. Please do not soak the fabric.

Using Odyssey

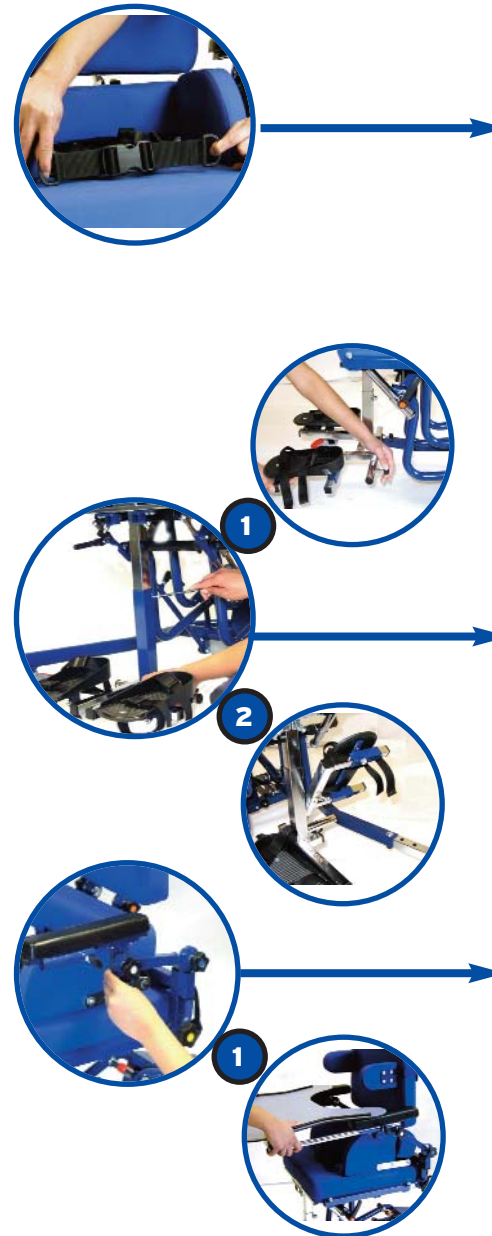

Pelvic Strap Adjustment

It is imperative that the pelvic buckle is positioned in the centre of the seat width. Once the buckle is fitted together, pull both the side D loops to enhance a more secure fitting. To release place fingers under each side of buckle and gently pull from side to side. This will release the side webbing and enable easier access. The pelvic strap is designed to fit across the pelvis NOT around the waist. The length of the lapstrap can be adjusted through the triglide under the seat.

- Readjust strap to allow for changes in clothing and change of child.
- Check that the straps go under the pelvic support and that they fit snugly.

Footrest Adjustment

The sandals fitted to round tubing are secured into position by tightening **black** wing nut ①. Sandals can also be removed this way or flipped out of the way to assist transfer. ② The sandals can be secured to the feet by means of webbing fed through buckles and secured .

Tray Adjustment

The tray height is attained by loosening **blue** knob ① and adjusting armrest to required height and secure. To angle the tray loosen **grey** knob, place arms to required angle and secure. The tray will only slide easily into the tubes if both arms are the same height and angle. Secure the tray with the **black** Wing nuts.

Using Odyssey



Dynamic Zip Jacket

The shoulder straps are fitted by two flip up buckles at the top of the backrest. The lower straps are fitted in the desired position to the H frame on the backrest **1**. Pull the D loop on the lower straps to tension the jacket. The jacket is removed by unzipping and then removing the two upper buckles on the backrest. When putting jacket on do up the zip first, pull on D ring to ensure a secure fit as low as possible on the torso. Lastly secure webbing. Check that jacket is fitted low down so that material does not ride up towards child's throat.

Groin Harness

The child is seated on top of the groin harness and the 2 padded straps are fed between and over the legs and secured at the pelvic. To remove the child from the harness undo the buckles over each leg **2**.

HOW TO FIT & ADJUST GROIN HARNESS

Place the groin harness flat on the seat. The Harness should be in-line with the square padded edge to the rear and the 2 long straps to the front of the seat. The 2 straps at rear of seat are secured on the Seat H frame. Take /work each strap individually by lengthening / shortening the webbing through the tri-glide as required. **1**.

The 2 padded long straps each need to be fed over each corresponding (same side) rear strap and secured again in the same way. It is essential that this fitting is snug. Once the desired position is attained small adjustments can be made via the webbing and the buckle fixing.

Using Odyssey

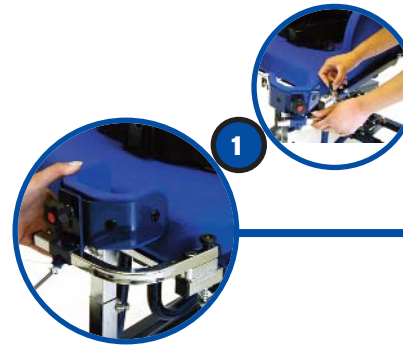

Flip Away Knee Blocks

To release the knee block and flip away lift the **black** knob **1**. To adjust the depth of the knee block undo the corner screw on the side of the seat, position and re-tighten. To adjust height loosen the **red** knob and secure. Knee block can also be adjusted laterally by loosening the corner screw located in the front on the knee block. NEVER FORCE KNEE BLOCKS INTO POSITION AS BOTH SHOULD FIT WITH EASE.

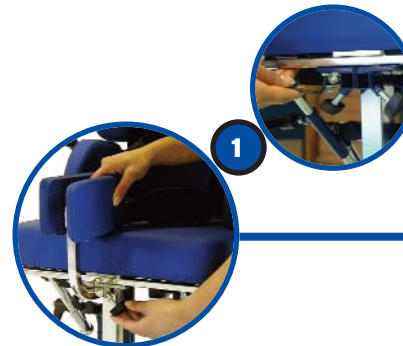

Abduction Support

Secure the abductors by slotting the stem into square brackets under the seat and secure using the **black** wing nuts. The padding should be next to the user. Width adjustment is by means of a screw adjustment, located under the seat on the square abduction support brackets.