

ELECTRIC CONNECTION

Connection scheme:

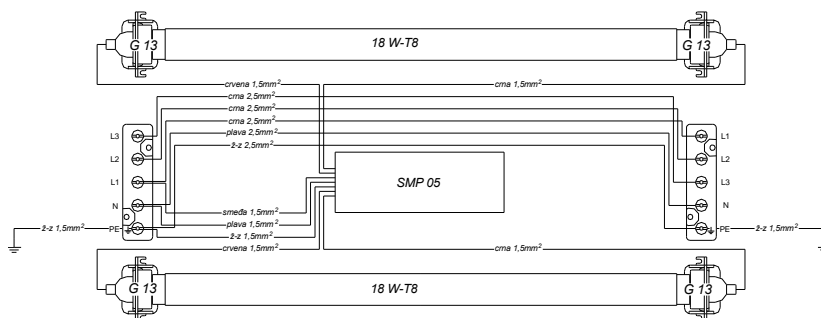

Clamps deblockade allows fixture opening, and can be done with Allen wrench number 5, turning the blockade switch by 90° counter-clockwise. Deblockade can be done only on a middle clamp on each side. Than is necessary to release four screws M4 which tighten inside reflector, and than remove reflector. Now, access to connecting clamps is allowed. Wiring cable is installed trough cable glands. Special attention must be dedicated to selection of inner gasket sealing ring of Exe gland according to diameter of connecting cable. Gland screw and gland body with threads must be tightened with torque regulated by manufacturer. Unused cable introduction must be closed with plug. The electric connection is performed by linking power supply cable to connecting terminals L1, (L2, L3), N, PE and tightening the screws of connecting terminals with tightening torque regulated by manufacturer.

It is important to pay attention on maximum number of lighting fittings installed on one automatic installation switch:

Automatic installation switch	1pB 10A	1pC 10A	1pB 16A	1pC 16A
Maximum number of light. fittings installed	10	17	16	28

Maximum voltage for dielectric strength insulation resistance test is 1 kV/AC; DC and max. 10mA only between PE and L (L1, L2, L3), and between N and PE. The closing of the enclosure should be done by a reverse sequence of action.

ASSEMBLGE AND REPLACING THE FLUORESCENT G13 TUBES

The opening of the enclosure is exclusively allowed in a non-voltage state while respecting the warnings on the label. Non-voltage state must be ensured by turning of power source on main switch. The installing of flurescent G13 tube is done by slightly pushing the left and right side of tube simultaneously into the G13 lampholders. Than, the G13 tube is need to be turned by 90° in blockade position. In that way, tube is in position which not allow it to fall out. Taking out the tube is done in reverse sequence of action.

STORAGE AND TRANSPORT

Transport and storage is only allowed in the original packaging, on the way pointed out on the carton box.

CONTROL, MAINTENANCE AND REPAIR

It is necessary to conduct review and maintenance on all parts on which the explosion proof protection depends in accordance to standards IEC 60079-17, general and individual demands of the manufacturer and the regulations of the user, and especially:

- that enclosure, the protective cover and the gasket of the cover are completely without a crack or damage
- that the Exe cable glands, plugs, and connecting terminals are tightened with torque regulated by manufacturer
- that the protective cover is only cleaning with wet cloth because of danger from electrostatic discharge, with adequate use of cleaning detergent, and wash with water temperature bellow 50°C.
- That the interval recommended by manufacturer for replacing the G13 tube is respected.

The repair of the fitting is done by the manufacturer or a person legally authorized by the manufacturer, with original parts from the products documentation, and in accordance to the IEC 60079-19 standards. If the repair is done by a third person, the manufacturer is free of all responsibility from the product, and the declaration of conformity which is given by the manufacturer becomes insignificant.

Spare parts:

- protective cover, type PSF 218,
- gasket, type PSF 218,
- electronic ballast with lampholder G13, type SMP 05/4 – 91000 set,
- connectin terminal, type SL5,
- cable gland M25, type SPU 25,
- plug M25, type SPC 25.

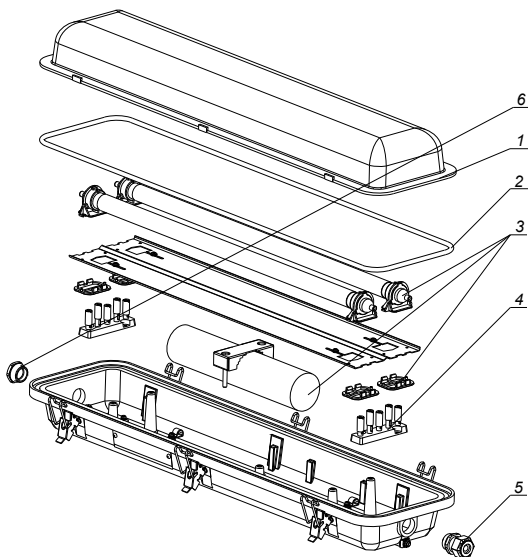

RESPONSIBILITY AND AUTHORIZATION

Responsibility and authorization are defined by the "Regulation on technical supervision over the electrical stations, installations and equipment intended for usage in potentially explosive atmospheres". This Manual represents the most relevant information about the product. Adequate national laws and regulations supplement it. The person in charge is required to secure its employment in the industrial unit. Every improper usage, as well as every unofficial restructuring, repair or restoration of the product, release the manufacturer of all responsibilities.