



Engineered For Your Mission

Mule II Transport System

User Manual



The Mule II

Disclaimer

This manual contains general instructions for the use, operation and care of this product. The instructions are not all-inclusive. Safe and proper use of this product is solely at the discretion of the user. Safety information is included as a service to the user. All other measures taken by the user should be within and under consideration of applicable regulations. It is recommended that training on the proper use of this product be provided before using this product in an actual situation.

Retain this manual for future reference. Include it with the product in the event of transfer to new users. Additional free copies are available upon request from Customer Care.

Proprietary Notice

The information disclosed in this manual is the property of Traverse Rescue, LLC Mississauga, Ontario, Canada. Traverse Rescue, LLC. reserves all patent rights, proprietary design rights, manufacturing rights, reproduction use rights, and sales use rights thereto, and to any article disclosed therein except to the extent those rights are expressly granted to others or where not applicable to vendor proprietary parts.

© Copyright Traverse Rescue, LLC . All Rights Reserved
Traverse Rescue, LLC.
2460 Tedlo St.
Mississauga, Ontario
Canada L5A 3V3

Toll Free (US and Canada):..... 1-866-998-7866

Telephone (Worldwide):905-279-7866

Fax (NA and Worldwide):905-615-1367

Website: www.traverserescue.com

Traverse Rescue, LLC manufactures its products under a strict Quality Assurance Program. We also recognize and comply to any applicable standards that apply to each product.

In accordance with the European Community Council Directive 93/42/EEC; Annex VII, Traverse Rescue LLC, declares the products that bear the CE mark conform with all the provisions of this Directive that apply to them.



1. Safety Information

1.1 Warnings

The following are warnings in this manual:



Untrained operators can cause injury or be injured. Permit only trained personnel to operate the Mule II.

Improper use of the Mule II can cause injury. Use the Mule II only for the purpose described in this manual.

An unrestrained or improperly restrained patient can suffer injuries. Always secure the patient in the Mule II with the proper restraint system suitable to the situation .

Improper operation can cause injury. Operate the Mule II only as described in this manual.

An un-attended patient can be injured. Stay with the patient at all times.

Helpers can cause injury or be injured. Maintain control of the Mule II and direct all helpers.

Improper maintenance can cause injury and damage. Maintain the Mule II only as described in this manual.

Improper parts and service can cause injury. Use only Traverse-approved parts and service on the Mule II.

Modifying the Mule II can cause injury and damage. Use the Mule II only as-sold by Traverse.

Attaching improper or inappropriate items to the Mule II can cause injury. Use only Traverse-Approved items on the Mule II.

1.2 Important

Boxes like the one below emphasize important information.

Important

Rescue procedures using ropes, harnesses, bridles and other Personal Protective Equipment require special skills and are potentially hazardous activities. No rescue personnel should attempt such rescue procedures unless he or she has received professional instruction and training

1.3 Bloodborne Disease Notice

OSHA (Occupational Safety and Health Administration) requires employers to protect workers from workplace exposure to bloodborne diseases such as HIV-1 and hepatitis. To reduce the risk of exposure when using the Mule II, follow disinfecting and cleaning instructions in this manual.

1.4 Safety Labels

Labels place important information from the Users' Manual on the Mule II.

Read and follow label instructions. Replace worn or damaged labels immediately. New labels are available from Traverse.

The Load-Limit label shown is affixed to the Mule II.



2. Operator Skills and Training

2.1 Skills

Operators using the stretcher need:

- A working knowledge of emergency patient-handling procedures.
- The ability to assist the patient
- A complete understanding of the procedures described in this manual

2.2 Training



WARNING

Untrained Operators can cause injury or be injured. Permit only trained personnel to operate the Mule II.

Trainees need to:

- Follow a training program designed or approved by their training officer
- Read this manual. For additional free users' manuals, contact Traverse Customer Care.
- Practice with the Mule II before using it in regular service
- Be tested on their understanding of the Mule II
- Record their training information. A sample Training Schedule and Maintenance Record sheet is provided (Page 8)

3. About the Mule II

3.1 Mule II Description

The Mule II is designed to transport most styles of rescue basket stretcher, backboard, or ski patrol toboggan over rough terrain during emergency rescue operations.

The Mule II is for use by trained rescue personnel. A minimum of two personnel are needed to operate the Mule II when transporting a patient, but additional help may be required in certain situations and conditions. Mule II features include:

- Design accommodates all Traverse Rescue basket stretchers and most styles of other rescue basket stretchers
- Wheel can be removed quickly for storage or transport inside the frame
- Large ATV wheel tracks well over all kinds of terrain and absorbs shock for patient comfort
- Pair of securing straps use ratchet buckles for fast and tight hold, and vinyl-coated hooks
- Optional handles provide enhanced control

3.2 General Specifications

Mule

Deployed	33in. L x 26in. W x 29in H
	83cm L x 65cm W x 72cm H
Stored	33in. L x 26in. W x 19in H
	83cm L x 65cm W x 47cm H

Mule with Handles

Deployed	104in. L x 26in. W x 29in H
	263cm L x 65 cm W x 72cm H
Stored	L x 26in. W x 32in H
	114cm L x 65cm W x 81cm H

Weight

Mule	41 lb (19 kg)
Mule with Handles	51 lb (23 kg)

Load Limit 500 lb (227 kg)

Construction

Frame	Aluminum
Axle	3/4-in. Stainless Steel
Tire	AT 22x11-8
	Operate at 10 psi maximum

Specifications are rounded to the nearest whole number.

Metric conversions are calculated before rounding the Imperial measurements. Traverse reserves the right to change specifications without notice.

3.3 Components

Mule II



Mule II (reverse side)



Mule II with Handles



4. Operating the Fasteners

4.1 Ratchet Buckles

The Mule II is equipped with two tie-down straps fitted with ratchet buckles (Fig. 1) for securing the stretcher to the Mule II.

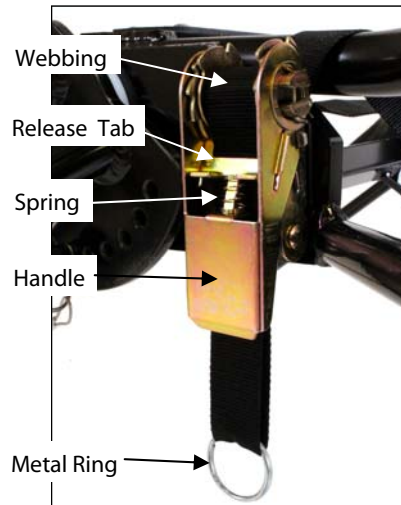

Figure 1. Ratchet buckle components

4.1.1 Releasing Tension on the Strap

1. Depress and hold release tab and fully open handle until it clicks into detent. This overrides the ratcheting function (Fig. 2).
2. Pull strap through roller to take up slack, then depress and hold release tab and close handle to release from detent.



Figure 2. Fully open handle

4.1.2 Tensioning the Strap

1. Work handle up and down until strap is properly tensioned to secure load, then close handle fully to lock and hold strap (Fig. C).

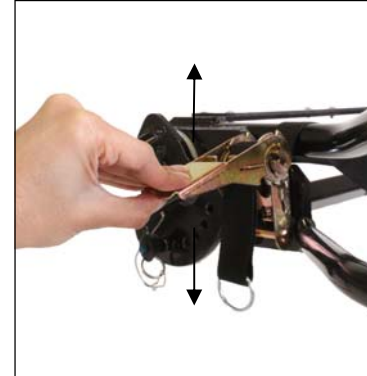

Figure C. Work handle up and down to tension strap.

4.2 Lynch Pin for Wheel

The wheel is secured on the axle with a lynch pin. The pin's self-locking ring snaps into place to securely hold the assembly and also allows quick removal. Operate the lynch pin as shown below.

1. Slide lynch pin into axle (Fig. A).
2. Pivot ring against pin to lock.

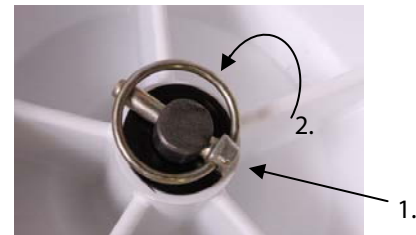
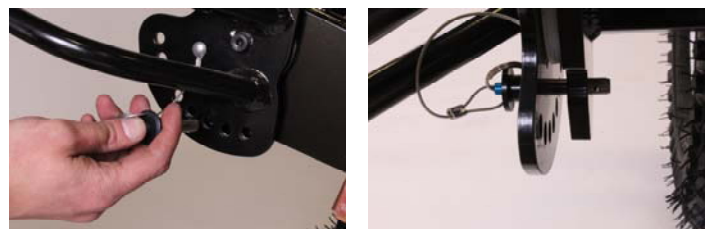

Figure A. Lynch pin in axle

4.3 Quick Release Pin for Handle Adjustments



The handles (optional feature) adjust to 8 positions. The quick release pin secures the handle in the selected position.

5. Deployment & Breakdown

5.1 Deployment without Handles

1. Begin with the Mule II in storage position and remove the lynch pin from the axle.



2. Lift the wheel out of the cradle and slide onto axle with air valve facing away from main-frame struts (Fig. B).

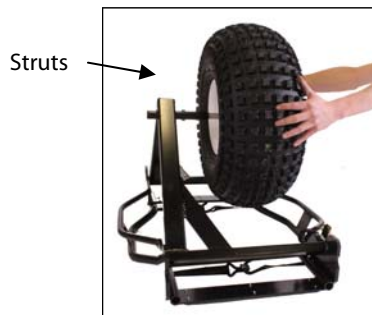

Figure B. Place wheel onto axle

3. Secure wheel on axle with lynch pin (Fig. A).



4. Turn Mule II upright onto its wheel.



5.2 Deployment with Handles

1. Begin with the Mule II in storage position and remove the lynch pin from the axle.



2. Unfold the top handle and lock in place with wire lock pin.



3. Lift the wheel out of the cradle and slide onto axle with air valve facing away from main-frame struts.



4. Secure wheel on axle with lynch pin.



5. Turn Mule II upright on its wheel.



6. Unfold the second handle and lock in position with wire lock pin.



5.3 Break Down without Handles

1. Join strap hooks on top of the Mule II and tension straps tight against the frame.



2. Turn the Mule II upside down.



3. Remove the lynch pin and slide wheel off the axle.



4. Nest wheel in frame cradle and slide lynch pin onto axle and lock.



5.4 Break Down with Handles

1. Join strap hooks on top of the Mule II and tension straps tight against the frame.



2. Remove wire lock pin from handle and fold handle over top of the Mule II.



3. Turn the Mule II upside down then remove the lynch pin and slide wheel off the axle.



4. Nest wheel in frame cradle then slide lynch pin onto axle and lock.



5. Remove wire lock pin from second handle and fold handle over the Mule II axle.



6.0 Attaching a Stretcher to the Mule II

Most styles of rescue basket stretchers, ski-patrol toboggans, and backboards can be attached to the Mule II. Attach the strap hooks to the appropriate rail, handholds, or other element of the rescue basket stretcher.

If necessary, the straps can be used full length and wrapped under and over (completely around) the rescue device. Hooks are then joined and straps are tensioned to hold the device tight against the stretcher supports.

1. Release tension on the straps and separate hooks.
2. Place stretcher on the Mule II and center it over the wheel.
3. Attach all 4 hooks to top rail of stretcher.
4. Tension both straps until stretcher is tight against stretcher supports.
5. Verify that handles on ratchets are closed.

7. Repair, Parts and Service

If the Mule II shows excessive wear or cracks (either in the material or at the welds) it is time to retire it from service. **Do not** attempt to repair or replace any metal component or weld.

If the wheel, straps, labels, or handles are damaged or missing, please call your Dealer or Traverse Rescue Customer Care for replacement parts.

Always follow the instructions packaged with accessories. Keep the instructions with this manual. Be aware of any special considerations (loading heights, door heights, etc.)

<u>Part Number</u>	<u>Description</u>

8. Limited Warranty

Traverse Rescue, LLC (Traverse) Limited Warranty

All Traverse Rescue, LLC products are warranted for a period of one year after the date of invoice, to the original purchaser. This warranty is provided against any material or workmanship flaws or defects. In the event of such a flaw or defect during this warranty period, please contact Traverse immediately. Traverse Rescue agrees to repair or replace (at our choice) the defective product. Our Limited Warranty does not cover damage due to abuse, misuse, lack of care, improper use or accidents. It also does

not cover damage due to attempted repair by the purchaser that was not authorized by Traverse Rescue, LLC. No other warranties exist or are implied by Traverse. This limited warranty excludes, and Traverse shall not be held liable for any punitive, incidental, special or exemplary damages arising out of the breach of the warranty on sales by Traverse Rescue, LLC or otherwise, or through the performance or non-performance of any third-party part, products, service or system. This limited warranty does not limit in any way, nor alter in any way, other manufacturer's warranties on products that are sold by Traverse Rescue, LLC.

9. Traverse Rescue Customer Care

Customer Care and product support are important aspects of each Traverse product.

For assistance with this, or any other Traverse Rescue product, please contact Traverse Customer Care.

Please have the serial number of your Traverse stretcher available when calling Traverse Customer Care, and include this number with any written communications

Traverse Rescue, LLC.
2460 Tedlo Street
Mississauga, Ontario
Canada L5A 3V3

Traverse Rescue, LLC

Telephone:905 279 7866

Toll Free (Canada & US):1 866 998 7866

Fax :905 615 1367

Email: info@traverserescue.com

Web site: www.traverserescue.com



Training Schedule

Date	Name	Training Method

Maintenance Record

Date	Maintenance Performed	By