

SHARP INSTALLATION MANUAL

CODE: 00ZUP3300VIME

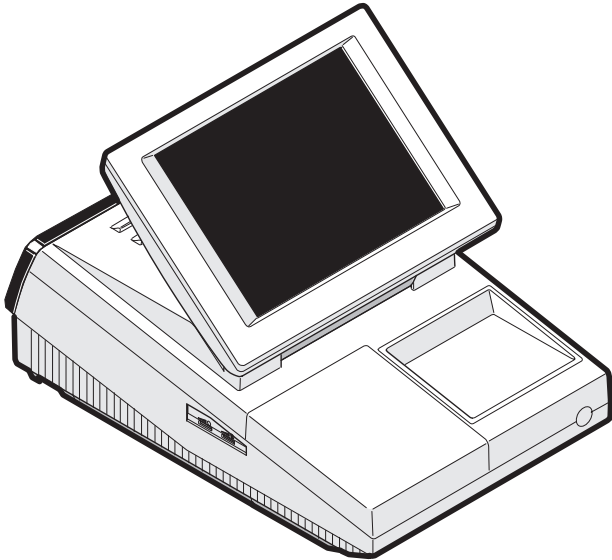

POS TERMINAL

MODEL UP-3300

("V" version)

CONTENTS

1. Removing the Rear display filter	2
2. Replacing the Rear display filter	2
3. Removing the Top cabinet	3
4. Replacing the Top cabinet	3
5. Removing the Power transformer, NF PWB and AC cord	3
6. Replacing the Power transformer, NF PWB and AC cord	3
7. Removing the LCD unit	4
8. Replacing the LCD unit	5
9. PS-RAM DISK : UP-P02MB2	5
10. RS232 I/F: ER-A7RS & EFT I/F ER-02EF	5
11. MCR UNIT: UP-E12MR2	6
12. DRAWER BOX UNIT: ER-03DW/04DW/05DW	6
13. REMOTE DISPLAY: UP-P16DP	6
14. HOW TO EXTEND DISPLAY POLE	6
15. BUILT-IN PRINTER: UP-T80BP	8
16. SRN I/F: STANDARD	12
17. RS232 I/F: STANDARD	12

Parts marked with "▲" is important for maintaining the safety of the set. Be sure to replace these parts with specified ones for maintaining the safety and performance of the set.

Precautions

- Before installation, be sure to turn off the power.
- Use gloves to protect your hand from being cut by the angle and the chassis.
- Connect all the cables securely. When connecting or disconnecting the cables, be careful not to apply stress to the cables. (It may cause disconnection.)
- Ground the human body to prevent against troubles and dust adhesion to the LCD by static electricity. When assembling the LCD, use a discharge blower to prevent against dust intrusion.
- Be careful to the high voltage of the inverter PWB transformer.
- Install the ferrite core onto the specified position of the cable securely.

Conditions for soldering circuit parts

To solder the following parts manually, follow the conditions described below.

PARTS NAME	PARTS CODE	LOCATION	CONDITIONS FOR SOLDERING
Ceramic oscillator	RCRMZ7002RCZZ	MAIN PWB: X1 (8M)	270°/3sec.
	RCRMZ7004RCZZ	MAIN PWB: X2 (7.37M)	270°/3sec.

Note for handling of Touch panel

- The transparency of the touch panel should be vitally important. Do not put finger prints or water print on the surface. Use clean finger such or gloves and masks.
- For handling, do not hold the transparent area, and do not hold the heat seal connector section to assure reliability.
- Do not overlay touch panels. The edge may damage the surface.
- Do not put a heavy thing on the touch panel.
- Do not apply a strong shock, and do not drop it.
- When attaching the protection film again, carefully check for no dirt. If there is any dirt, it is transferred.
- To clean dirt on the surface, use dry, soft cloth or a cloth immersed in ethyl alcohol.
- Check that the housing does not give stress to the touch panel.
- Be careful not to touch the touch panel with tools.
- The heat seal section is easily disconnected. Be careful not to give a stress to the heat seal section when installing.
- The touch panel is provided with an air groove to make the external and the internal air pressure equal to each other. If water or oil is put around the air groove, it may penetrate inside. Be careful to keep the air groove away from water and oil.
- Input is performed with fingers. Do not use a hard thing for inputting.

Note for handling of LCD

- The LCD elements are made of glass. BE careful not to give them strong mechanical shock, or they may be broken. Use extreme care not to break them.
- If the LCD element is broken and the liquid is leaked, do not lick it. If the liquid is attached to your skin or cloth, immediately clean with soap.
- Use the unit under the rated conditions to prevent against damage.
- Be careful not to drop water or other liquid on the display surface.
- The reflection plate and the polarizing plate are easily scratched. BE careful not to touch them with a hard thing such as glass, tweezers. Never hit, push, or rub the surface with hard things.
- When installing the unit, be careful not to apply stress to the LCD module. If an excessive stress is applied, abnormal display or uneven color may result.

Cautions on handling connectors

When connecting or disconnecting the following connectors, follow the procedures below.

1)

PARTS NAME	PARTS CODE	LOCATION
FFC CONNECTOR	QCNCW7207RC4J	MAIN PWB: CN6 TOUCH PWB: CN5

• How to Connect or Disconnect FFC

(1) Open the slider to unlock position

The slider will open only up to a fixed height (about 1.2mm). If you forcibly pull up the slider further, it may be dropped.

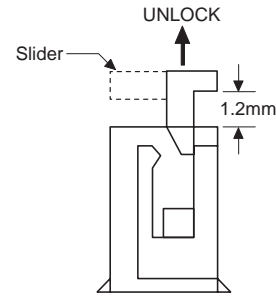

(2) Insert the FFC

Insert the FFC firmly until the FFC hits the bottom of the connector's insulator.

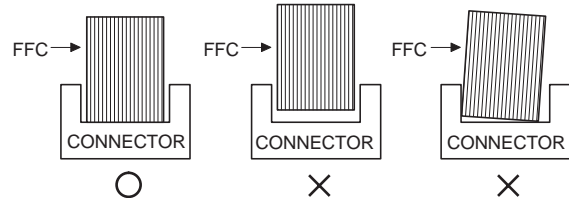
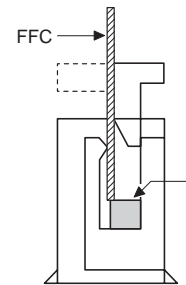

(3) Close the slider to lock position

Insert the FFC and then push the slider downward.

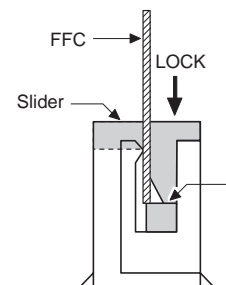

2)

PARTS NAME	PARTS CODE	LOCATION
FFC CONNECTOR	QCNCW7217RC3J	TOUCH PWB: CN1

• **How to Insert FFC**

- (1) Open the slider to unlock position
 Open the slider upwards up to an angle of 60 degrees. If the slider does not fully open, the FFC can not be smoothly inserted.

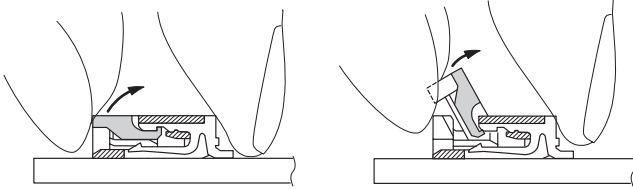

- (2) Insert the FFC
 Insert the FFC firmly until the FFC hits the bottom of the connector's insulator.

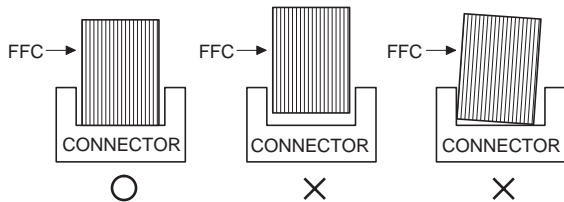
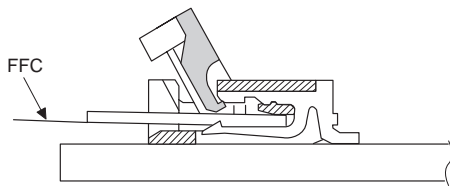

- (3) Close the slider to lock position
 Insert the FFC and then push the slider downward.

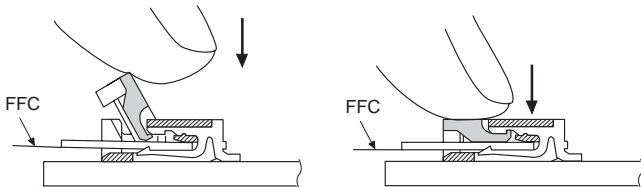

- (4) To pull out the FFC, unlock the slider to pull it out in the same procedures as (1).

1. Removing the Rear display filter

- 1) Remove the two Screws ①.
- 2) Remove the Rear display filter ②.

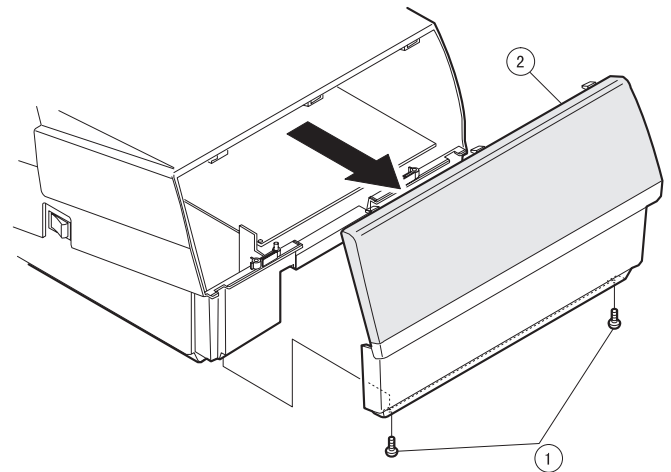

2. Replacing the Rear display filter

Install the Rear display filter in the reverse order of removing.

3. Removing the Top cabinet

- 1) Remove the two Screws ①.
 - 2) Remove the Side cabinet ⑦.
 - 2) Remove the Screw ②.
 - 3) Remove the Printer cover ③.
 - 4) Remove the Screw ④.
 - 5) Remove the Top cabinet ⑧.
 - a) Lift the top cabinet and put it straight in the direction of arrow A. (Be careful not to pull the cable between the LCD I/F PWB of the top cabinet and the MAIN PWB of the Bottom cabinet.)
 - b) Pull and remove the following cables between the LCD I/F PWB of the top cabinet and the MAIN PWB of the Bottom cabinet.
- LCD Cable ⑤ : MAIN PWB : CN6
 - Earth wire ⑥.

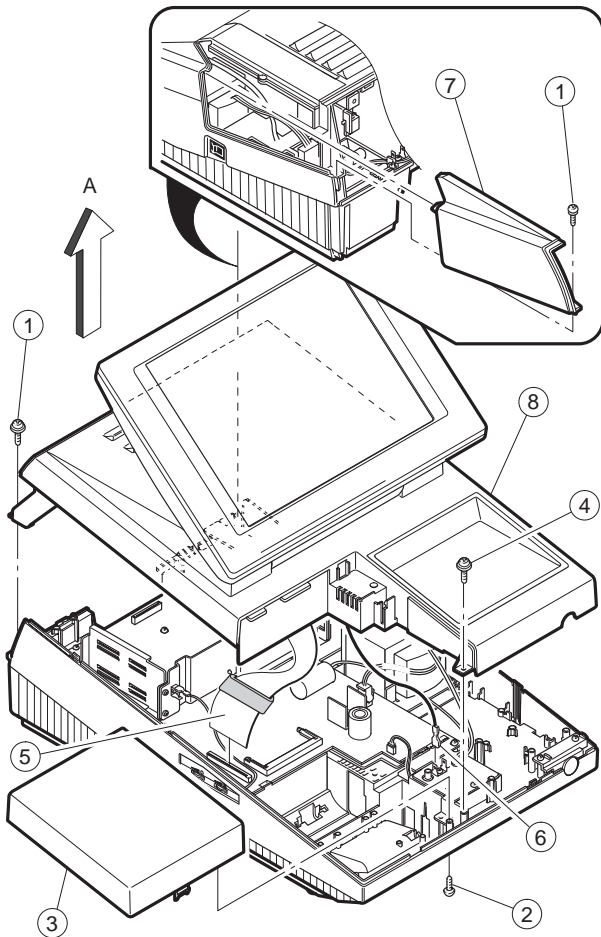

4. Replacing the Top cabinet

Install the top cabinet in the reverse order of removing. Before installing, make sure that each connector is connected securely.

5. Removing the Power transformer, NF PWB and AC cord

- 1) Remove the Power transformer ①.
 - a) Remove the four Screws ②.
 - b) Remove the two Connectors ③.
- 2) Remove the NF PWB ④.
 - a) Remove the four Screws ⑤.
 - b) Remove the two Screws ⑥ and the three Earth wire ⑦.
 - c) Remove the NF angle unit ⑧.
 - d) Remove the Screw ⑨.
- 3) Remove the AC cord ⑩.
 - a) Use a minus screwdriver to loosen the AC cord fixing screws (2 pcs.) of the NF PWB ④ unit.
 - b) Remove the two screws ⑪.
 - c) Remove the AC cord cover ⑫.
 - d) Remove the AC cord ⑩ from the NF PWB ④.

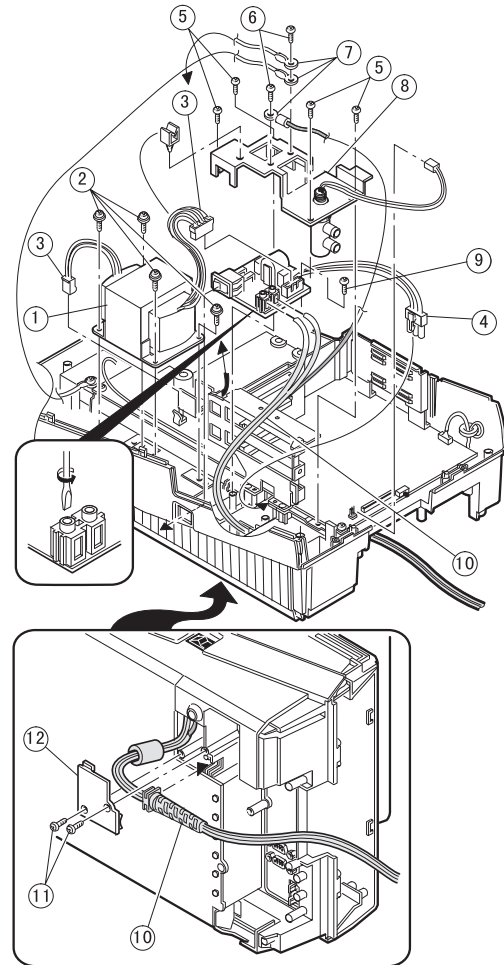

6. Replacing the Power transformer, NF PWB and AC cord

Install the in the Power transformer, NF PWB and AC cord in the reverse order of removing.

Before installing, make sure that each connector is connected securely.

* When connecting the AC cord to the power supply unit in assembly, tighten with the torque of 3 kg/cm ± 1 kg/cm.

7. Removing the LCD unit

1) Remove the LCD unit ①.

a) Remove the four Screws ②.

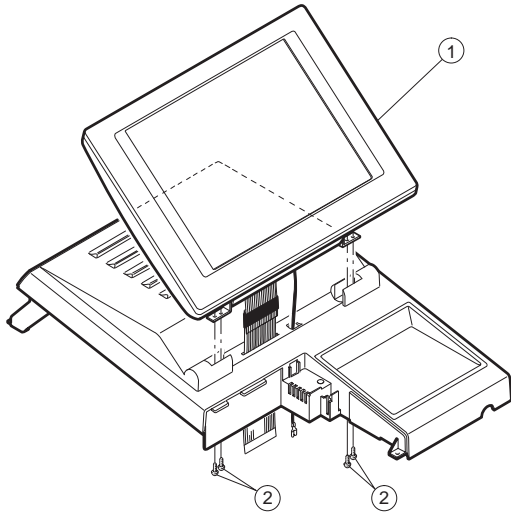

2) Remove the LCD rear cabinet ③.

a) Remove the two Screws ④.

b) Remove the pawls ① to ① of the LCD rear cabinet ③ in that order.

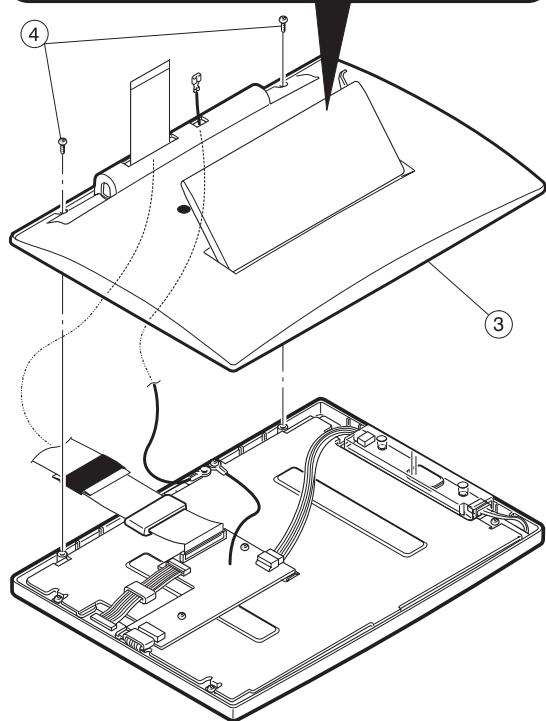
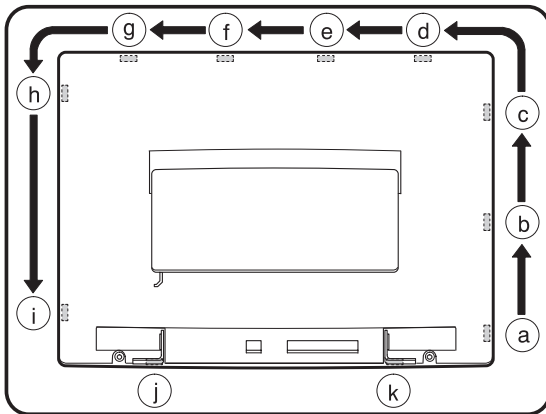

3) Remove the Inverter PWB ⑤.

a) Remove the Inverter cable ⑥.

b) Remove the CCFT cable ⑦.

c) Remove the two screws ⑧.

d) Remove the Inverter cover ⑨.

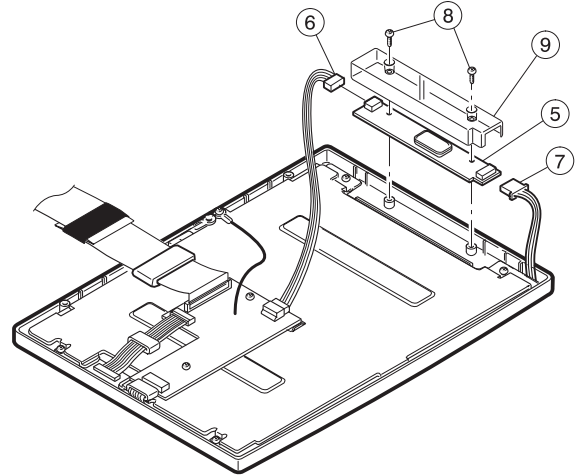

4) Remove the Touch panel PWB unit ⑩.

a) Remove the LCD cable(40P) ⑪.

b) Remove the LCD cable(30P) ⑫.

c) Remove the Inverter cable ⑬.

d) Remove the two Screws ⑭ and the two Earth wire ⑮.

e) Remove the Screw ⑯.

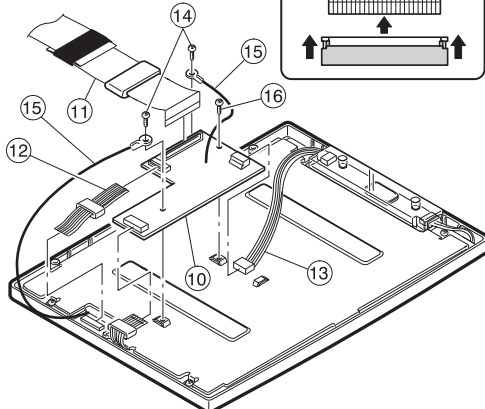
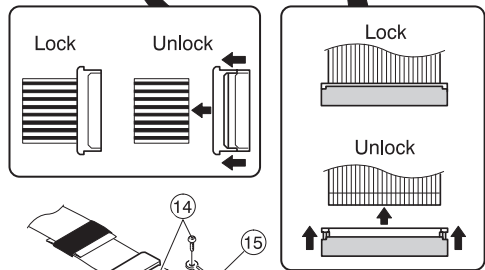
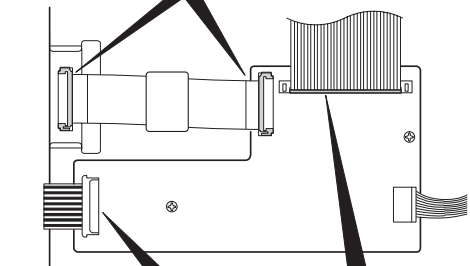
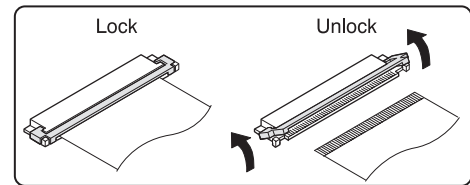

- 5) Remove the LCD 17.
 - a) Remove the five Screws 18.
 - b) Remove the LCD plate 19.
 - c) Remove the LCD PWB unit 20.

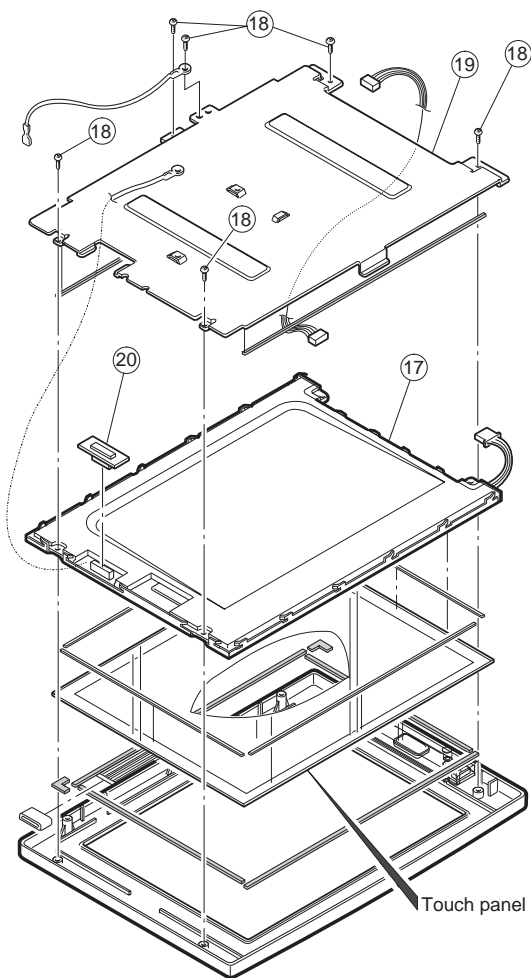

8. Replacing the LCD unit

Install the LCD unit in the reverse order of removing.
Before installing, make sure that each cables are connected securely.

9. Expansion RAM Board : UP-P02MB2

Make sure to save data before installing this option

- 1) Remove the top cabinet.
 - 2) Install the Expansion RAM Board 1 to the Option RAM connector on the Main PWB.
 - a) Insert the Expansion RAM Board aslant into the option RAM connector.
 - b) Push the RAM disk unit Expansion RAM Board is locked by the arms of the option RAM connector.
- * It is possible to install one UP-P02MB2.
- * Be careful of the direction of Expansion RAM Board to be installed. Install the Expansion RAM Board with the notch part of the PWB (Figure A) come right. Installing the Expansion RAM Board in the wrong direction may damage the connector part or make the machine out of order.

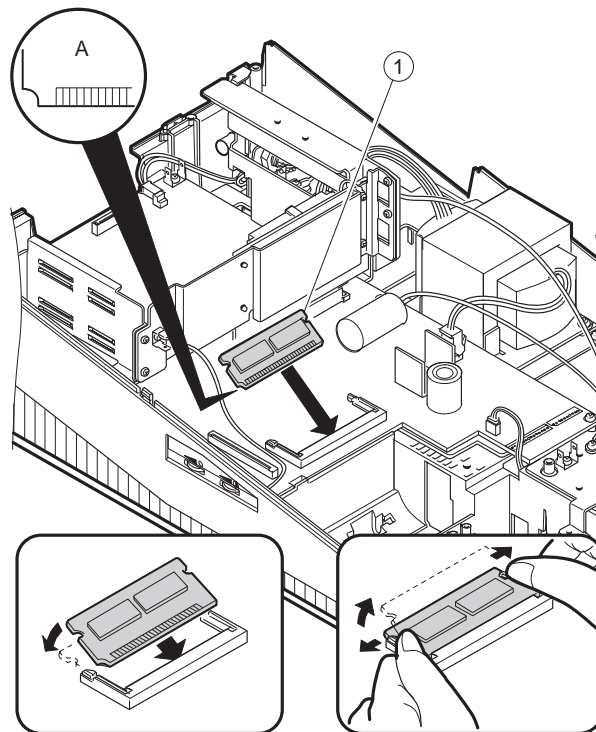

- 3) Removing the Expansion RAM Board.
 - a) Open the arms of option RAM connector right and left.
 - b) The Expansion RAM Board will be lifted automatically.

10. RS232 I/F: ER-A7RS & EFT I/F: ER-02EF

- 1) Remove the rear cover.
- 2) Remove the rear display.
- 2) Remove the two screws 1 from the shassis.
- 3) Insert the I/F PWB 2 to the connector.
- 4) Fix the I/F BRACKET to the shassis with screws 1.
- 5) Install the ferrite Core 3.
- 6) Install the Nylon band 4 to the cables.

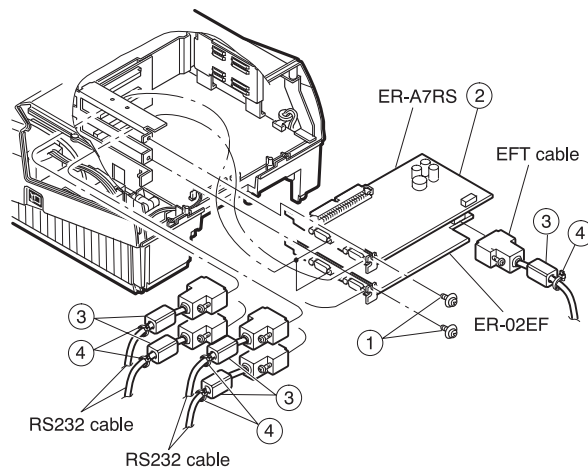

11. MCR UNIT: UP-E12MR2

- 1) Fix the MCR ANGLE ① to the lower cabinet with two screws ②.
- 2) Connect the MCR cable ③ to the MCR connector with the cable holder ⑥, and tighten the screw ⑦ on the back of lower cabinet.
- 3) Install the ferrite Core ④ to the MCR cable.
- 4) Install the Nylon band ⑧ to the cable.

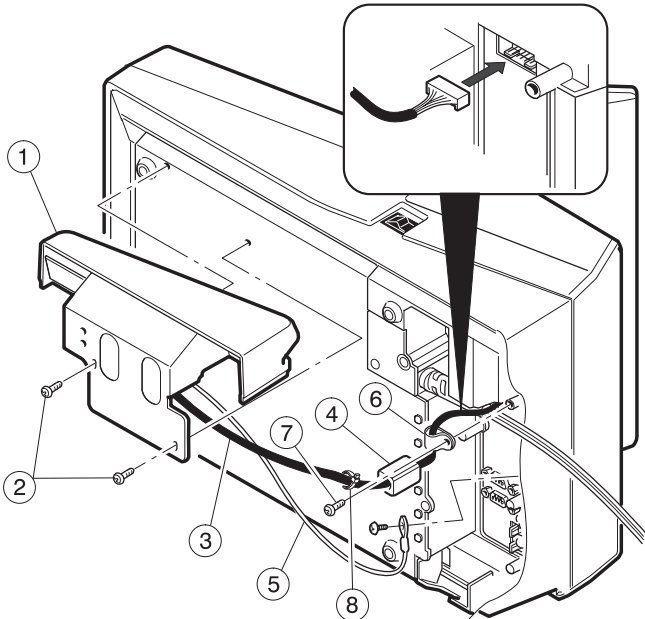

- 5) Fix the earth wire ⑤ from the UP-E12MR2 with the screw.

12. DRAWER BOX UNIT: ER-03DW/04DW/05DW

- 1) Connect the drawer cable ① to the drawer connector ②.
- 2) Fix the earth wire ③ from drawer box unit with the screw ④.

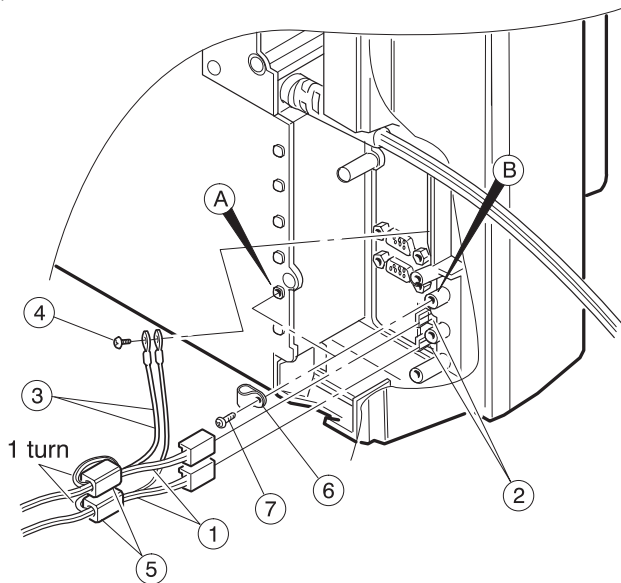

- 3) Install the ferrite Core ⑤ to the drawer cable.
- 4) Fix the drawer cable ① with the cable holder ⑥, and tighten the screw ⑦ on the back of lower cabinet ① or ②.

13. REMOTE DISPLAY

When the remote display is installed, service resetting is required.

- 1) Connect to the Display cable ① to the display connector ②.
- 2) Fix the earth wire ③ from the display unit with screw ④.

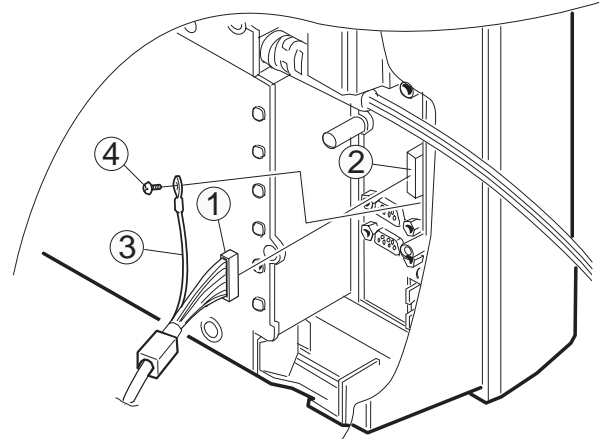

14. HOW TO EXTEND DISPLAY POLE

The pole can be extended by installing the attached pole to the standard pole.

COMPONENT LIST:

No.	NAME	USE	Q'ty
⑪	Pole cabinet	Pole extension	2
⑫	Screw (M2 × 8)	Pole connection	4
⑬	Screw (M4 × 16)	Securing the UP-P16DP to the wooden table	4
⑭	Screw (M4 × 20)	Securing the UP-P16DP to the metal table	4
⑮	Nut	Securing the UP-P16DP to the metal table	4

- 1) Remove the five screws ①.
- 2) Remove the Base angle ②.

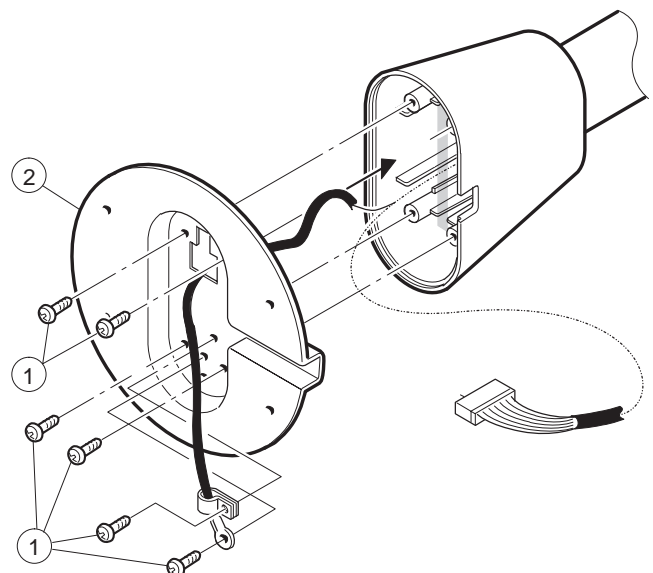

- 3) Remove the two screws ⑥.
- 4) Remove the Base cabinet ④ from the pole cabinet ⑦.

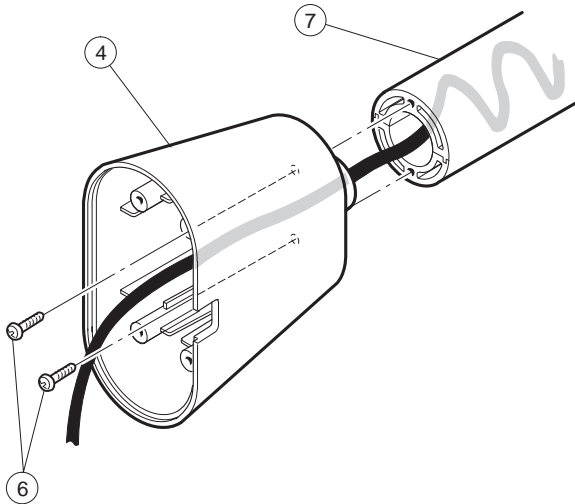

- 5) Turn the ratchet ⑨ connected to the pole cabinet ⑦ to the removing position and pull it out from the display unit ⑧ as shown in Fig. A.
- 6) Remove the two screws ⑩.
- 7) Remove the pole cabinet ⑦ from the Ratchet ⑨.

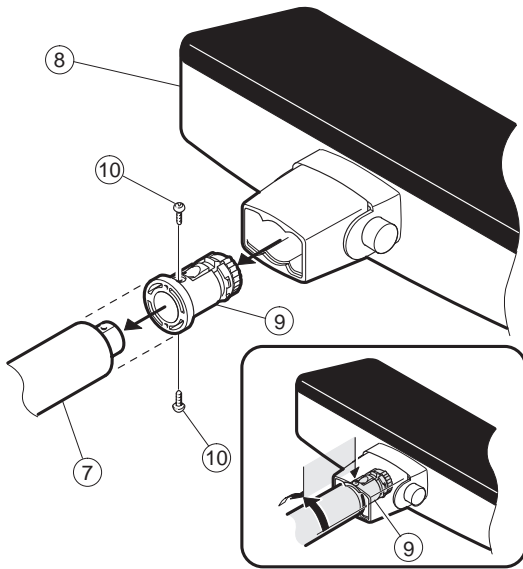
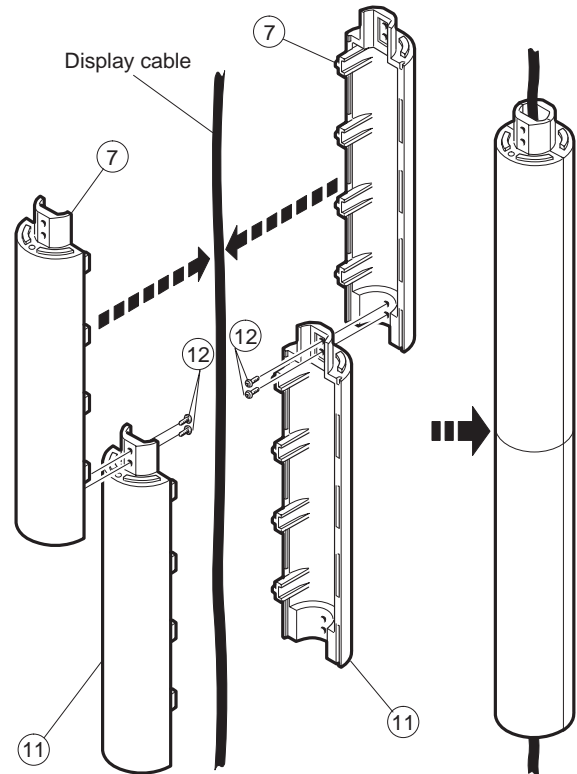

Fig. A

- 8) Install the attached pole cabinet ⑪ to the pole cabinet ⑦ to fix it with the screw ⑫.



- 9) Install the pole cabinet ⑪ in the opposite order of the disassembly.
- 10) Fastening on the table:
Secure the Base cabinet ② using the screw.

No.	NAME	USE	Q'ty
⑬	Screw (M4 × 16)	Securing the UP-P16DP to the wooden table	4
⑭	Screw (M4 × 20)	Securing the UP-P16DP to the metal table	4
⑮	Nut	Securing the UP-P16DP to the metal table	4

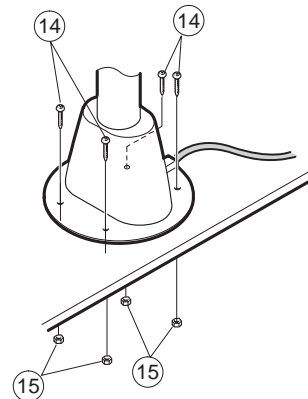
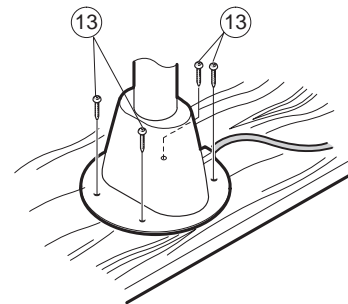

Lowering the height of the UP-P16DP

Remove the standard Pole and attach the Base cabinet ④ to the Ratch ⑨.

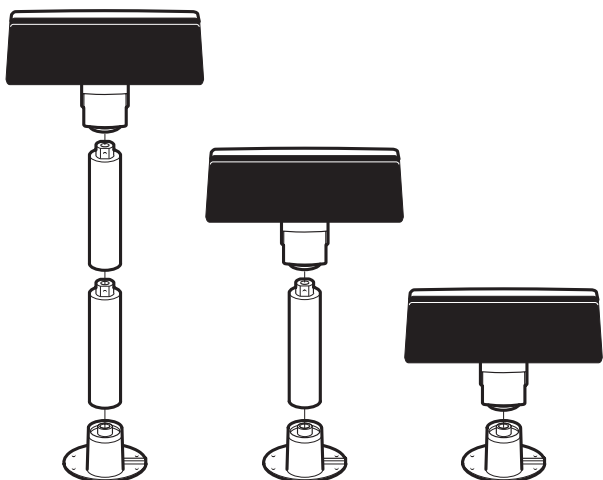

15. Built-in Printer: UP-T80BP

1. UP-T80BP INSTALLATION

1. Remove the BOTTOM PLATE ②.

- 1) Remove the three SCREWS ①.
- 2) Remove the BOTTOM PLATE ②.
- 3) Remove the SCREW ③, CABLE CLAMP ④ and POWER SUPPLY CABLE ⑤.

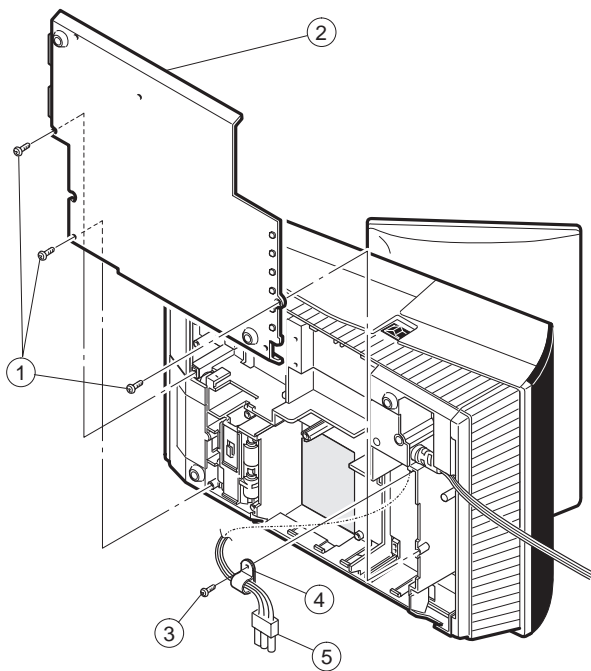
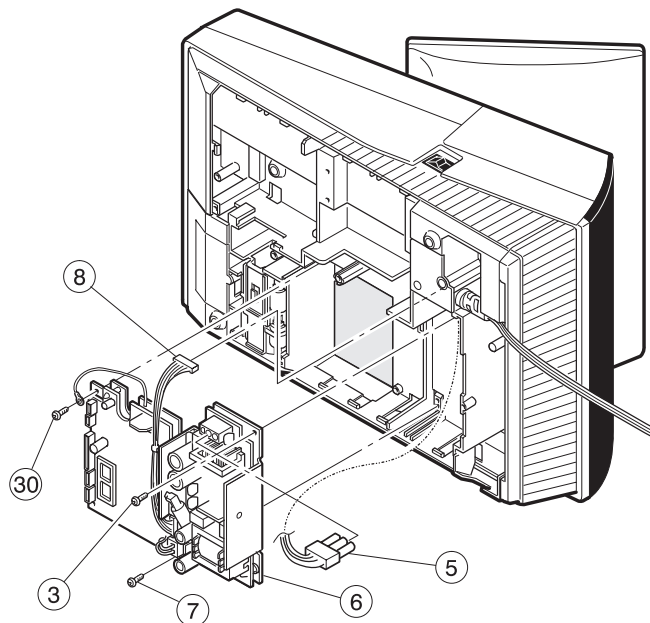

Fig. 1

2. Install the PS+CONTROL PWB ⑥.

CAUTION: The power supply unit is an important item. Make sure that the unit code is RDENC 1010RCZZ.

- 1) Fix the PS+CONTROL PWB ⑥ with three SCREWS ⑦ ⑩, ③
 - * SCREW ③: Use the screw which was fixing the CLAMP ④
 - * SCREW ⑩: fix the screw with earth WIRE.
3. Connect the POWER SUPPLY CABLE ⑤ to the PS+CONTROL PWB ⑥. (No. CN1)
4. Connect the I/F CABLE ⑧ of the PS+CONTROL PWB ⑥ to the UP-3300 MAIN PWB (No.CN20)



⑩ : XEBS30P08000 ⑦ : XHBS30P06000

Fig. 2

5. Remove the PRINTER LID ⑨.

- 1) Remove the screw ⑩.
- 2) Remove the PRINTER LID ⑨.

6. Install the four PAPER ROLLERS ⑪.

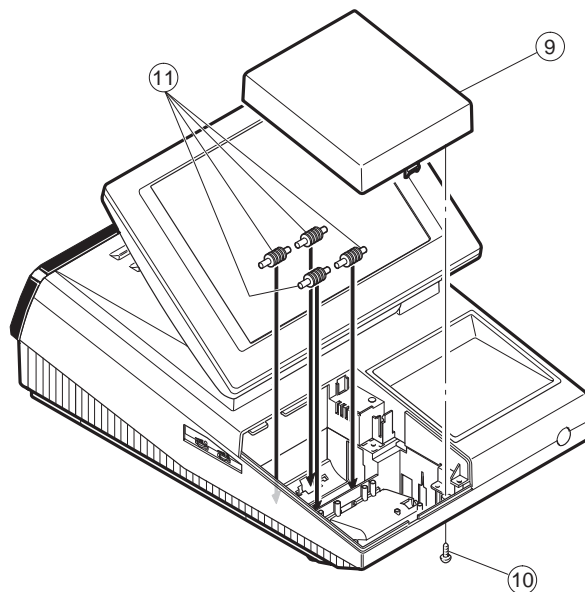

Fig. 3

7. Install the SWITCH UNIT ⑫.

- 1) Fix the SWITCH UNIT ⑫ on the cabinet pawl (A).
- 2) Pass the SWITCH UNIT CABLE ⑬ through the hole (B).

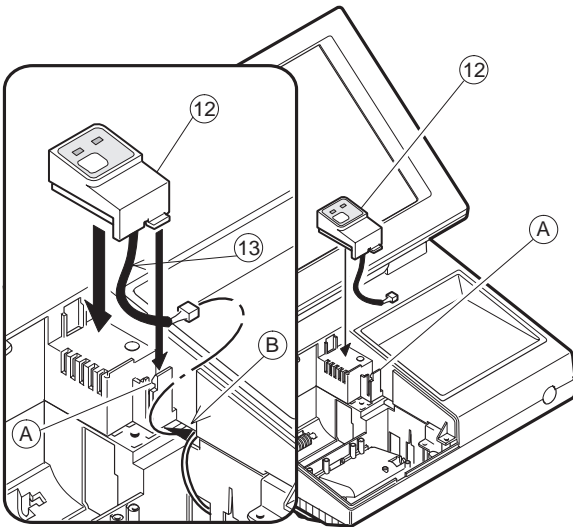

Fig. 4

8. Install the AUTO CUTTER RELAY PWB UNIT ⑭.

- 1) Install the AUTO CUTTER RELAY PWB UNIT ⑭ with SCREW ⑮.
- 2) Pass the AUTO CUTTER RELAY PWB CABLE ⑯ through the hole (C).

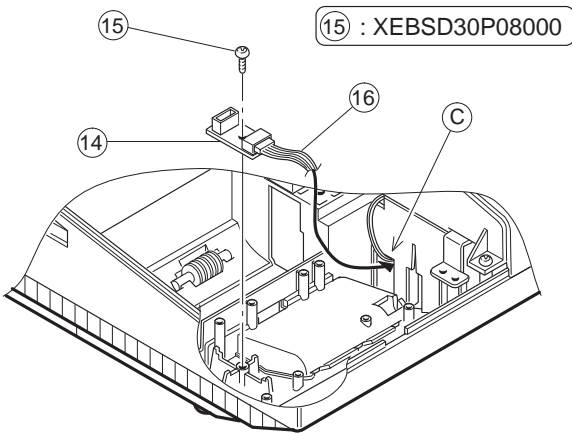

Fig. 5

9. Install the PAPER GUIDE ⑰ to the PRINTER UNIT ⑱.

10. Install the HEAD CABLE ⑲ to the PRINTER UNIT ⑱.

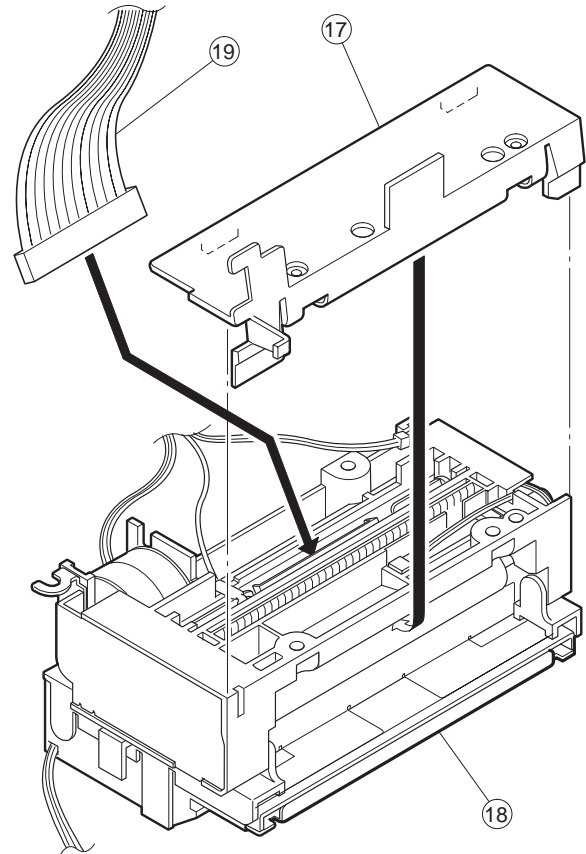

Fig. 6

11. Install the PRINTER UNIT ⑱.

- 1) Connect the AUTO CUTTER CABLE ⑳ to the AUTO CUTTER RELAY PWB ⑭.
- 2) Pass the HEAD CABLE ⑲ through the hole (C).
- 3) Pass the MOTOR CABLE ㉑ and SENSOR CABLE ㉒ through the hole (D).
- 4) Open the PRINTER UNIT ⑱.
- 5) Fix the PRINTER UNIT ⑱ with four SCREWS ㉓
* Fix the SCREWS ㉓ in the order of ㉓-a to ㉓-d.
- 6) Fix the two EARTH WIRES ㉔ with a SCREW ㉕.

23-a : XEBS26P06000	23-b : XEBS26P06000
23-c : XEBS26P08000	23-d : XEBS26P08000

25 : XHBSD30P06000

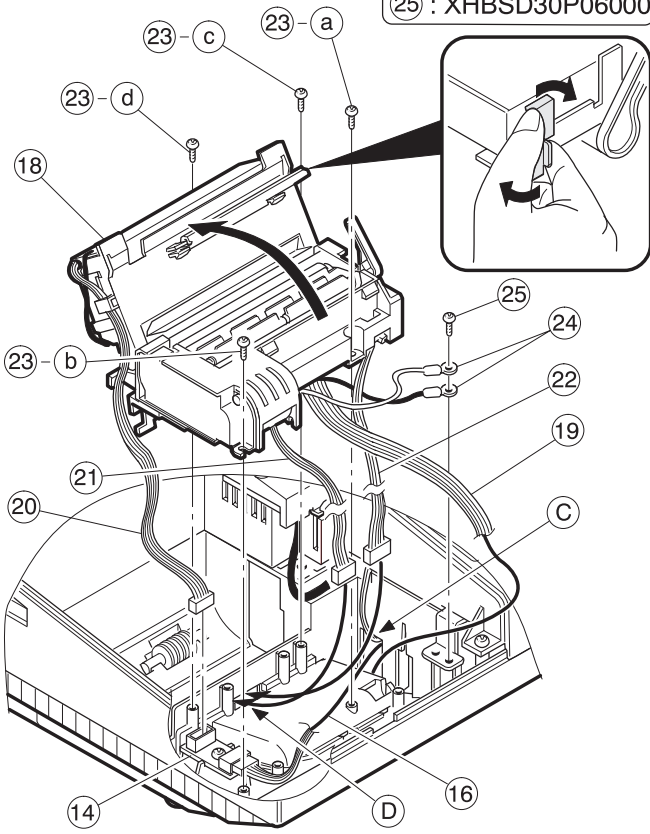
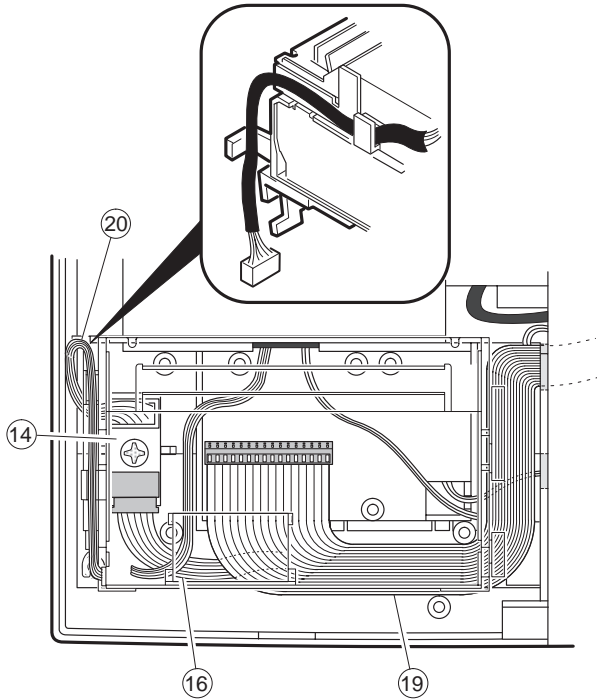

Fig. 7

12. Wiring for each cables as shown below



13. Connect the Printer cables to the CONTROL PWB.

- 1) SWITCH UNIT CABLE ⑬ : Connect to the CN7.
- 2) HEAD CABLE ⑲ : Connect to the CN5.
Attach the FERRITE CORE ⑳ and CABLE CLAMP ④.
Fix the CABLE CLAMP ④ with a SCREW ㉘.
- 3) AUTO CUTTER RELAY PWB CABLE ⑯ : Connect to the CN4.
- 4) MOTOR CABLE ㉑ : Connect to the CN2.
- 5) SENSOR CABLE ㉒ : Connect to the CN6.
- 6) I/F CABLE ⑧ : Attach the Ferrite core ㉓.

㉘ : XEBS30P08000

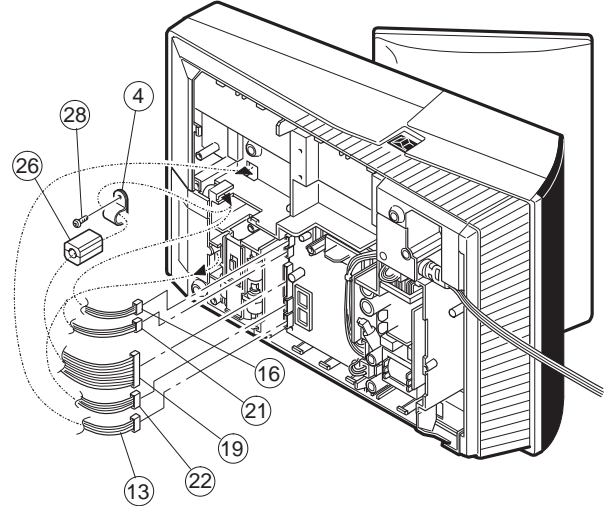

Fig. 8

14. Wiring for each cables as shown below

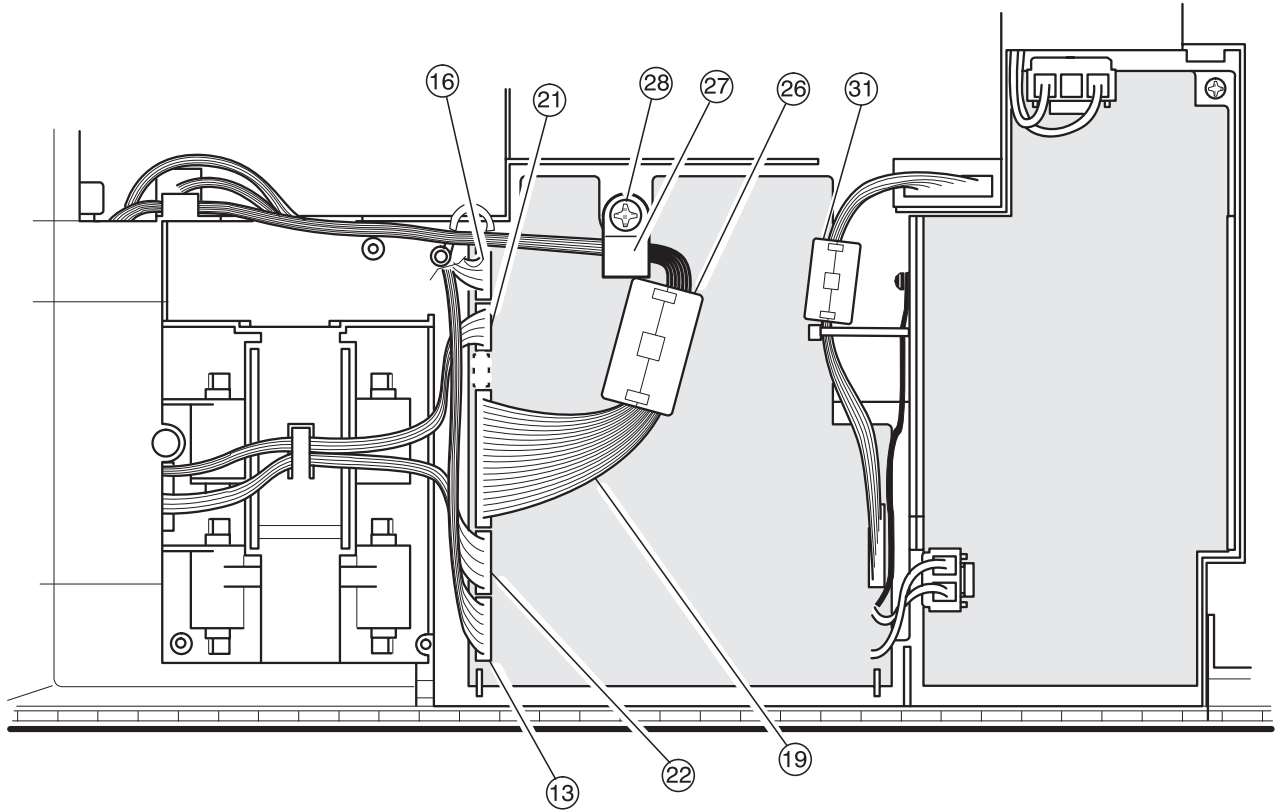

Fig. 9

15. Install the BOTTOM PLATE ②.

16. Install the PRINTER COVER ⑲.

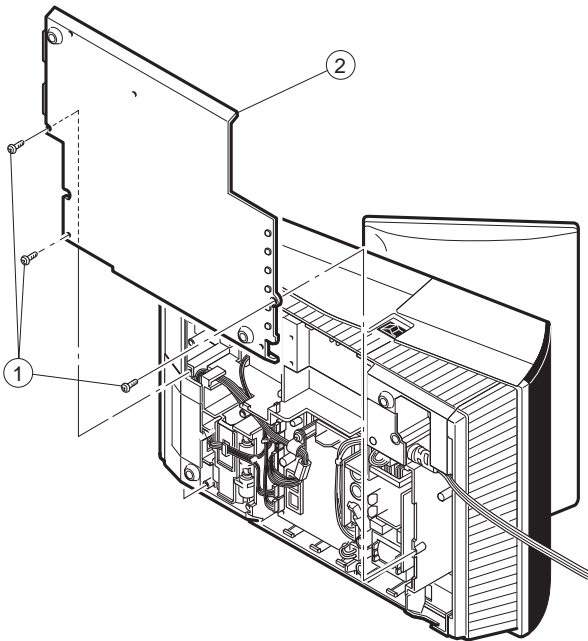

Fig. 10

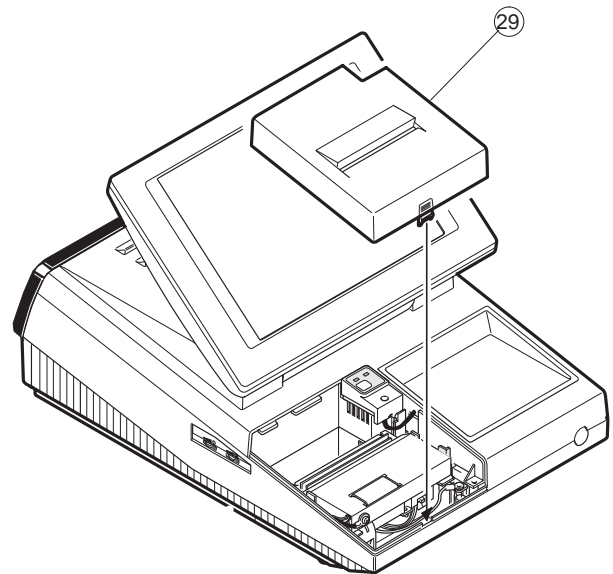
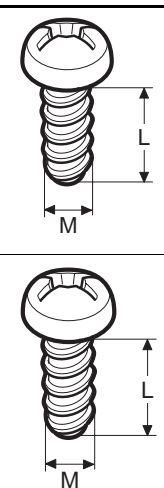

Fig. 11

1. LIST FOR SCREWS

No.	PARTS CODE	M [mm]	L [mm]
⑮	XEBSD30P08000	3	8
⑳			
㉓-a			
㉓-b			
㉓-c	XEBSD26P06000	2.6	6
㉓-d			
㉓-d	XEBSD26P08000	2.6	8
⑦	XHBSD30P06000	3	8
㉔			



2. INSTALLATION OF PAPER NEAR END SENSOR

[PARTS LIST]

No.	PARTS NAME	PARTS CODE	NOTE
1	PAPER NEAR END SENSOR	DUNTK3819BHZZ	SENSOR UNIT, FIXING SCREW
2	NEAR END SENSOR CONNECTOR	QCNCM6865RC0B	2 pin connector

1. Remove the BOTTOM PLATE .
2. Remove the PS+CONTROL PWB .
3. Solder the CONNECTOR ① to the PS+CONTROL PWB (No. CN1)
4. Install the NEAR END SENSOR UNIT ② to the CABINET , and fix it with the fixing SCREW ③ .

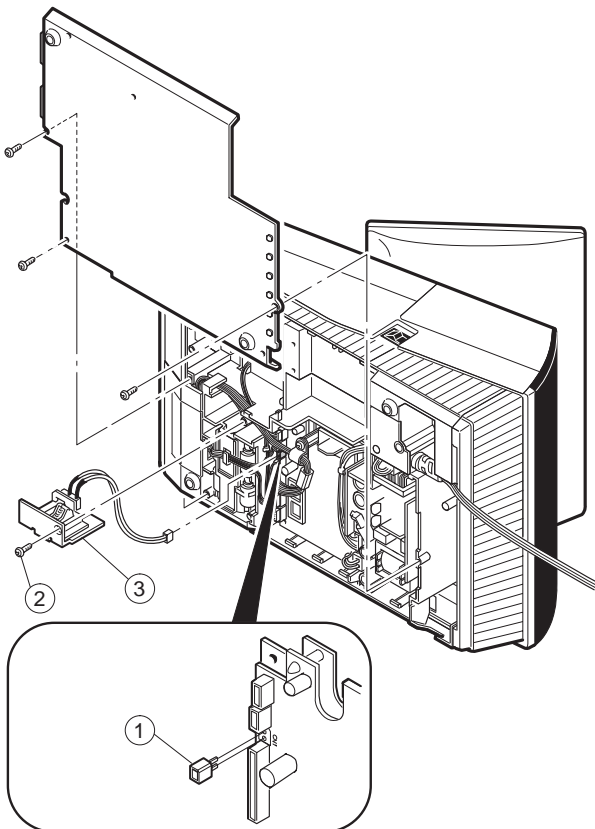
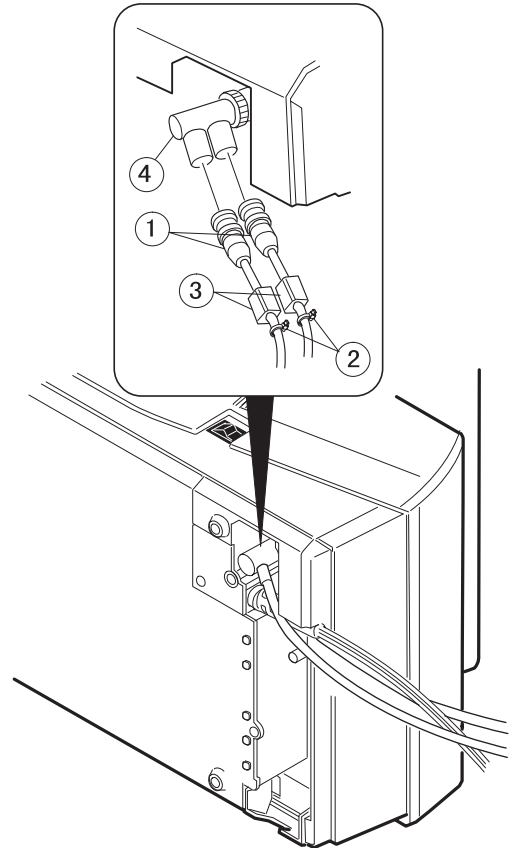

Fig. 12

16. SRN I/F: STANDARD

- 1) Connect to the SRN cable ① to the SRN connector ②.
 - 2) Install the Ferrite core ③ to the SRN cable ①.
 - 3) Install the Nylon band ④ to the SRN cable ①.
- * Connect the terminal resistor (50 ohm: QCNCM7145RCZZ) to the POSs at both ends and in front of the SRN in-line system.



17. RS232 I/F: STANDARD

- 1) Connect the RS232 cable ① to the connector.
- 2) Install the ferrite Core ② to RS232 cable.
- 3) Install the ferrite core ③ to the cables.

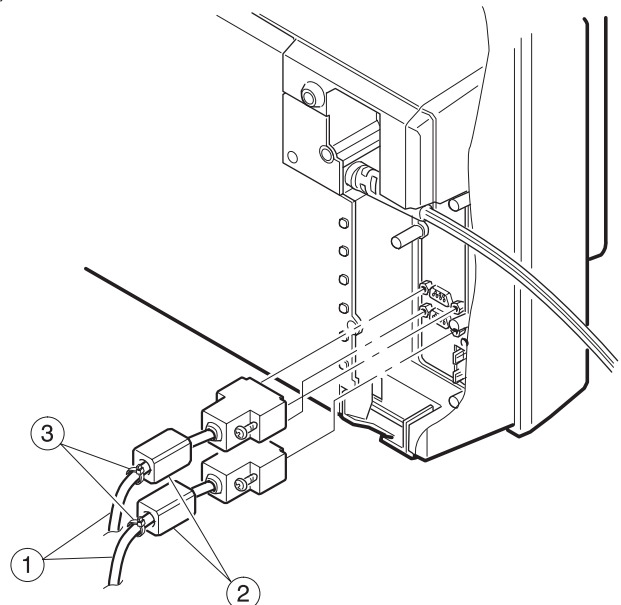

SHARP

COPYRIGHT © 1999 BY SHARP CORPORATION

All rights reserved.

Printed in Japan.

No part of this publication may be reproduced,
stored in a retrieval system, or transmitted.

In any form or by any means,
electronic, mechanical, photocopying, recording, or otherwise,
without prior written permission of the publisher.

SHARP CORPORATION
Information Systems Group
Quality & Reliability Control Center
Yamatokoriyama, Nara 639-1186, Japan

1999 March Printed in Japan ①